

11V

## REVIEW BY FORT BEND COUNTY COMMISSIONERS COURT

On this 23 day of APRIL, 2013, Commissioners Court came on to be heard and reviewed the accompanying notice of LAGRONE SERVICES, LTD.

Job Location CINCO TERRACE DRIVE, SPRING GREEN BOULEVARD

Dated 04/08/13 CASHIER'S CK. 6855300489, Permit No. 84332 to make use of certain Fort Bend County property subject to, "A Revised Order Regulating the Laying, Construction, Maintenance, and Repair of Buried Cables, Conduits, and Pole Lines, In, Under, Across or Along Roads, Streets, Highways, and Drainage Ditches in Fort Bend County, Texas, Under the Jurisdiction of the Commissioners Court of Fort Bend County, Texas," as passed by the Commissioners Court of Fort Bend County, Texas, date the 3<sup>rd</sup> day of August, 1987, recorded in Volume \_\_\_\_\_ of the Minutes of the Commissioners Court of Fort Bend County, Texas, to the extent that such order is not inconsistent with Article 1436a, Vernon's Texas Civil Statutes. Upon Motion of Commissioner Meyers, seconded by Commissioner Patterson, duly put and carried, it is ORDERED, ADJUDGED AND DECREED that said notice of said above purpose is hereby acknowledged by the Commissioners Court of Fort Bend County, Texas, and that said notice be placed on record according to the regulation order thereof.

Notes:

1. Evidence of review by the Commissioners Court must be kept on the job site and failure to do so constitutes grounds for job shutdown.
2. Written notices are required:
  - a. 48 hours in advance of construction start up, and
  - b. When construction is completed and ready for final inspection

Mail notices to: Permit Administrator  
Fort Bend County Engineering  
P.O. Box 1449  
Rosenberg, Texas 77471  
281-633-7500

3. This permit expires one (1) year from date of permit if construction has not commenced.

By Louis E. Hood 4/23/13  
Asst. County Engineer

By \_\_\_\_\_  
Drainage District Engineer/Manager

Presented to Commissioners Court and approved.

Recorded in Volume 4-23-13  
Minutes of Commissioners Court.

Clerk of Commissioners Court

By Sherry Fion  
Deputy

# COUNTY OF FORT BEND

## Engineering Department

P.O. BOX 1449  
Rosenberg, Texas 77471-1449

Johnny Ortega  
Permit Administrator

1124 Blume Road  
Phone: (281) 341-7500

### PERMIT APPLICATION REVIEW FORM FOR CABLE, CONDUIT, AND POLE LINE ACTIVITY IN FORT BEND COUNTY

PERMIT NO. 084332

The following "Notice of Proposed Cable, Conduit, and/or Pole Line activity in Fort Bend County" and accompanying attachments have been reviewed and the notice conforms to appropriate regulations set by Commissioner's Court of Fort Bend County, Texas.

- X   (1) Complete Application Form.
- X       a. Name of road, street, and/or drainage ditch affected.
- X       b. Vicinity map showing course of direction.
- X       c. Plans and specifications.

- X   (2) Bond:
- District Attorney, approval when applicable.
- Perpetual bond currently posted.
- No.
- Amount
- Performance bond submitted.
- No.
- Amount
- X       Cashier's Check.
- No. 6855300489
- Amount \$5,000.00

- (3) Verbal permission given for emergencies, to start construction before approved in Commissioner's Court.

                                 Precinct Engineer Acknowledgment                                  Date                                 

                                 Precinct Commissioner Acknowledgment                                  Date                                 

- (4)
- Drainage District Approval when applicable

We have reviewed this project and agree it meets minimum requirements.

  
Johnny Ortega CFM/Permit Administrator  
(REVISED 5/30/08)

04/08/2013  
Date

0068553

Office AU #

11-24

1210(8)

Operator I.D.: 6004547

# CASHIER'S CHECK

6855300489

April 03, 2013

PAY TO THE ORDER OF \*\*\*FORT BEND COUNTY\*\*\*

\*\*\*\$5,000.00\*\*

\*\*\*Five thousand dollars and no cents\*\*\*

WELLS FARGO BANK, N.A.

7344 LOUETTA RD  
SPRING, TX 77379

FOR INQUIRIES CALL (480) 394-3122

VOID IF OVER US \$ 5,000.00

*Richard Perry*

CONTROLLER

⑈6855300489⑈ ⑆121000248⑆486⑆ 512853⑈

04/25/2013 2:29 PM  
 >1113122655< 01111042032000 04/25/2013  
 BFT 111 111 109 Seq# 54  
 Account 1000000000  
 DDA Deposit 5,000.00  
 >1113122655<  
 Prosperity Bank  
 04/25/2013

APR 29 2013

[Transactions](#)[Summaries and Reports](#)[Rates](#)**Transaction Complete**

Contributions

[Print Transaction](#)

Withdrawals

Transaction Number: [REDACTED]

Transaction Date: Mon, Apr 29, 2013

Account Number: [REDACTED]

Bank Account Number: [REDACTED]

Portfolio Name: Texas CLASS

Account Name: CCM84332-LAGRONE SERVICES LTD

Bank Name: PROSPERITY BANK

Transfer Between Accounts

Transaction Type: Investment

Amount: \$5,000.00

Confirmation Sent To: CCCredit Group

Payment Method: ACH

Process Date: This transaction will be initiated on Apr 29, 2013, to settle on the next business day.

Transfer Between Participants

*All transactions are confirmed pending approval by Texas CLASS. A hardcopy confirmation of your transaction will follow. Please print this transaction for your records.*

Pending Transactions

# DEPOSIT

**PERMIT #** 84332

**STYLE:** Lagrone Services Ltd

**NAME PUT INTO TEXAS CLASS AS:** Lagrone Services Ltd

**DEPOSIT AMOUNT:** \$5,000.00

**DATE RECEIVED:** 4/23/2013

**DATE TRANSFERRED TO TEXAS CLASS:** 4/29/2013

**FORT BEND COUNTY ENGINEERING  
PERMIT DEPARTMENT  
CONSTRUCTION OF DRIVEWAYS AND CULVERTS ON COUNTY EASEMENTS AND RIGHT OF WAYS  
COMMERCIAL PIPE PERMIT APPLICATION  
P.O. BOX 1449 • 1124 BLUME ROAD  
ROSENBERG, TX 77471  
(Phone) 281-633-7502 or 7503 • (Fax) 281-342-7366**

**APPLICANT INFORMATION**

Application No. 84332  
(County Use Only)

Applicant Name LAGRONE SERVICES, LTD  
Applicant Mailing Address 13810 CHAMPION FOREST DR SUITE 145  
City HOUSTON State TX Zip 77069  
Work Phone 281-444-9275 Daytime Phone " "  
Property Owner's Name TERRACE SPRING GREEN, LLC Phone 713-458-5151  
Property Owner's Mailing Address 6363 WOODWAY SUITE 150  
City HOUSTON State TX Zip 77057

**LOCATION OF PROPERTY**

Subdivision RESERVE AT CINCO TERRACE Sec        Lot        Blk 1  
Physical Address 9727 SPRING GREEN BLVD KATY, TX 77454

(ATTACH A SITE MAP)

**SITE USE**

Driveway Curb & Gutter Section ☐ Driveway - Open Ditch Section ☐  
Culvert Only ☐ Other ☐

**DRIVEWAY REQUIREMENTS**

Length 20' minimum and 40' maximum Number of drives 4 1 median cut  
(See - Fort Bend County Procedures to be followed for Commercial Driveway, and Median Openings or Modifications)  
Available on website www.co-fort-bend.tx.us

Does project comply with Fort Bend County Lighting Regulation Yes (X) No ( )  
(See- Fort Bend County Outdoor Lighting Regulation on website www.co.fort-bend.tx.us )

- By signing and submitting this permit application, I am stating that I am the owner of this property and I am aware of and agree to abide by the Fort Bend County Regulations of Subdivisions and I am aware of Section 2, Item F in the Permits for the Construction of Driveways & Culverts on County Easements and Right of Ways in Fort Bend County, and am responsible to obtain all other required permits associated with the above mentioned property. Driveway and Pipe Permits shall provide that construction pursuant to the permit will be commenced within six months and be completed within nine months from the date of the permit and that fees collected for said permits shall not be refundable or transferable. I further understand the permit fee, in the form of CASH or PERSONAL CHECK or COMPANY CHECK or a CASHIERS CHECK or MONEY ORDER payable to FORT BEND COUNTY, must be attached.
- The undersigned applicant, agent or attorney hereby certifies to Commissioners' Court to be strictly bound to Commissioners' Court to construct the driveway and/or culvert in strict conformity with the plans, specifications, terms, provisions and conditions of the permit and any other written material incorporated by reference in this application.
- Other permits may be required for development. Please contact the Fort Bend County Road & Bridge Department for pipe sizing or the Fort Bend County Health Department for information on On-Site Sewage Facility permits prior to planning construction.
- Failure to possess or obtain required permits will result in legal action against the property owner as allowed by law.

Kory R LAGRONE  
Signature of Applicant, Agent or Attorney

4/2/13  
Date

KORY R LAGRONE  
Printed Name

LOCATED IN  
CITY OF HOUSTON ETJ, FORT BEND COUNTY, TEXAS

**75% SUBMITTAL TO CLIENT  
-NOT FOR CONSTRUCTION**

6/7/2013

SUBMITTAL TO FORT BEND COUNTY, CINCO SOUTHWEST MUD 1,  
CINCO SOUTHWEST MUD 2, AND FORT BEND COUNTY DRAINAGE DISTRICT

7/5/2011

SUBMITTAL TO PIPELINE COMPANY

7/20/2011

**SUBMITTAL TO FORT BEND COUNTY, CINCO SOUTHWEST MUD 1,  
CINCO SOUTHWEST MUD 2, AND FORT BEND COUNTY DRAINAGE DISTRICT**

8/8/2011

SUBMITTAL TO FORT BEND COUNTY, CINCO SOUTHWEST MUD 1,  
CINCO SOUTHWEST MUD 2, AND FORT BEND COUNTY DRAINAGE DISTRICT

11/11/2013

**SUBMITTAL TO FORT BEND COUNTY, CINCO SOUTHWEST MUD 1, CINCO SOUTHWEST MUD 2, AND FORT BEND COUNTY DRAINAGE DISTRICT**

3/19/2012

**REVISION 3**

6/8/2012

REVISION 2 - SITE PLAN CHANGE

8/13/2012

**REVISION 3**

8/20/2011

**REVISION 4**

9/5/2012

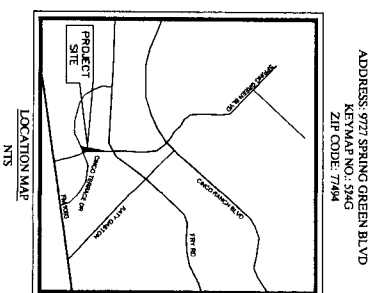

INDEX OF SHEETS	
SHEET NO.	DESCRIPTION
CIVIL ENGINEERING (A) (JINJISEY, LLC)	
000	COVER SHEET
C0-1	TOPOGRAHIC SURVEY
C0-2	GRAVITY FLOW SURVEY
C1-6	DIMENSION CONTROL PLAN (1 OF 2)
C1-7	DIMENSION CONTROL PLAN (2 OF 2)
C2-0	UTILITY PLAN
C3-0	GRADING PLAN (1 OF 2)
C3-1	GRADING PLAN (2 OF 2)
C4-0	STORM SEWER PLAN
C4-1	DRAINAGE AREA MAP
C5-0	PAVING PLAN
C5-1	GAS PIPELINE PAVING PROFILE
C5-2	MEDIAN DRAINING PLAN & PROFILE
C6-0	CONSTRUCTION DETAILS (1 OF 4)
C7-1	CONSTRUCTION DETAILS (2 OF 4)
C7-2	CONSTRUCTION DETAILS (3 OF 4)
C7-3	CONSTRUCTION DETAILS (4 OF 4)

DEVELOPER

DEVELOPER

**EXCEL COMMERCIAL REAL ESTATE  
ATTN: RICHARD RAINER  
6363 WOODWAY, SUITE 950**

713.458.5151

ARCHITECT

**OSBORN & VANE ARCHITECTS  
ATTN: BEN SUNDIN  
2000 BERING, SUITE 410  
HOUSTON, TX 77057  
713.781.5262**

**CIVIL ENGINEER**

**CIVIL ENGINEER**

6111 FM 1960 WEST, SUITE 208  
HOUSTON, TEXAS 77069

CONTACT: KEITH E. MCBRIDE

MEP

ATTN: ISRAEL MORENO  
HOUSTON, TX  
IMORENO@KME-INC.COM

**FORT BEND COUNTY ENGINEERING**  
**SIGNATURE VALID FOR ONE YEAR ONLY**

DATE: \_\_\_\_\_

CALL BEFORE YOU DIE  
TEXAS ONE CALL PARTICIPANTS REQUEST  
72 HOURS NOTICE BEFORE YOU DIE, DRILL  
OR BLAST - STOP CALL  
TEXAS ONE CALL SYSTEM  
1-800-245-4545

**CINCO TERRACE DRIVE  
RETAIL BUILDING**  
Katy, Texas

SHEET  
00.0



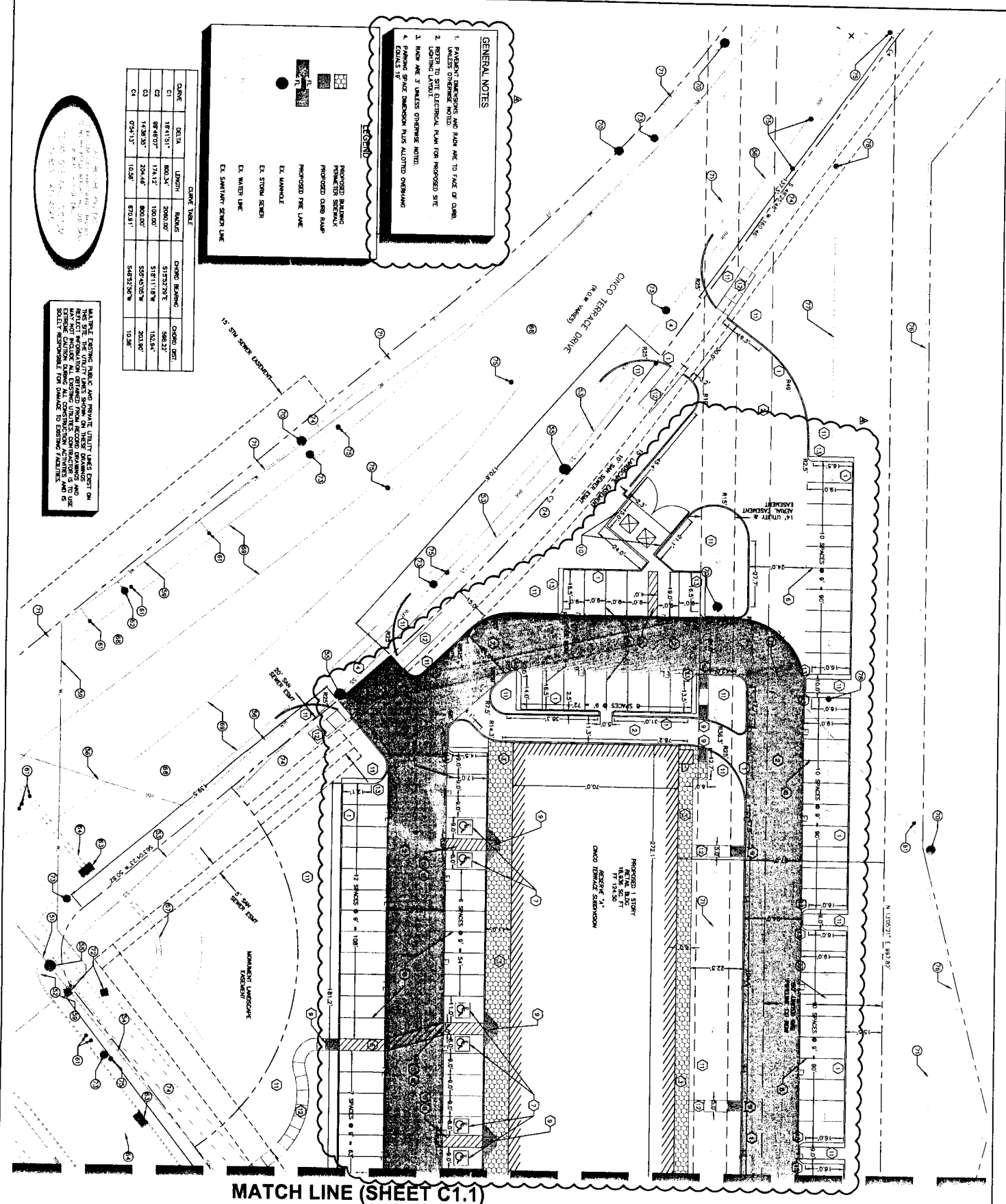

**MATCH LINE (SHEET C1.1)**

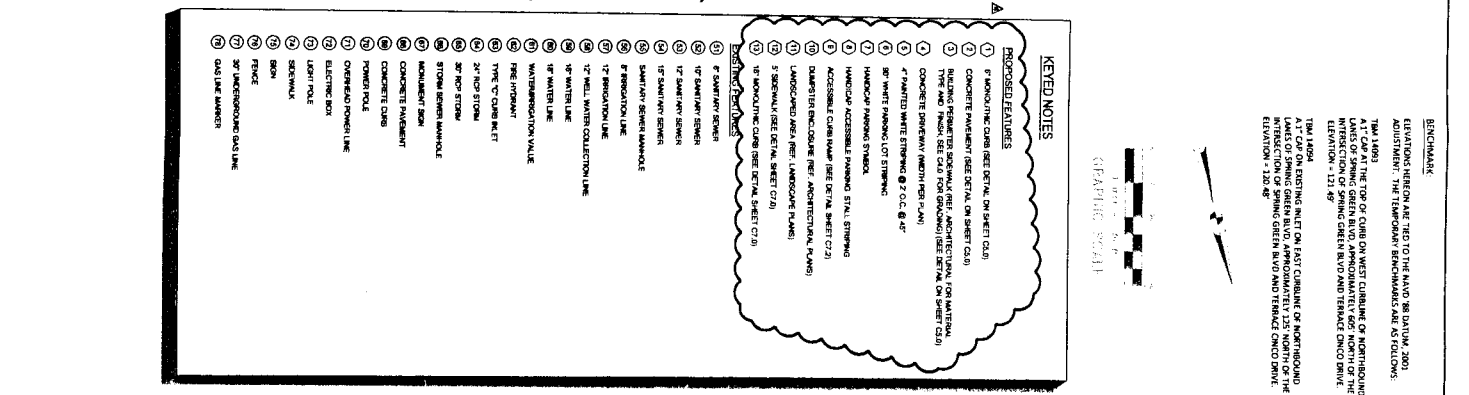

**BENCHMARK:**  
ELEVATIONS WERE OBTAINED BY THE MAAD 98 DATALOG. ADJUSTMENT: THE TEMPERATURE BENCHMARKS ARE AS FOLLOWS:

1. TM 16093	1. TM 16093
1.1 CAP AT THE TOP OF CURB ON WEST CUMBERLAND OF NORTHBOROUGH LANE OF SPRING GREEN BLVD, APPROXIMATELY 605' NORTH OF IT	1.1 CAP AT THE TOP OF CURB ON WEST CUMBERLAND OF NORTHBOROUGH LANE OF SPRING GREEN BLVD, APPROXIMATELY 605' NORTH OF IT
INTERSECTION OF SPRING GREEN BLVD AND TERRACE CIRCLE DRIVE	INTERSECTION OF SPRING GREEN BLVD AND TERRACE CIRCLE DRIVE
ELEVATION = 121.49'	ELEVATION = 121.49'
TM 16094	TM 16094
1.1 CAP ON EXISTING INLET ON EAST CUMBERLAND OF NORTHBOROUGH LANE OF SPRING GREEN BLVD, APPROXIMATELY 125' NORTH OF IT	1.1 CAP ON EXISTING INLET ON EAST CUMBERLAND OF NORTHBOROUGH LANE OF SPRING GREEN BLVD, APPROXIMATELY 125' NORTH OF IT
INTERSECTION OF SPRING GREEN BLVD AND TERRACE CIRCLE DRIVE	INTERSECTION OF SPRING GREEN BLVD AND TERRACE CIRCLE DRIVE
ELEVATION = 120.48'	ELEVATION = 120.48'

**CINCO TERRACE DRIVE  
RETAIL BUILDING**  
Katy, Texas

**DIMENSION CONTROL PLAN**  
**PLAN (1 OF 2)**



**ALJLindsey**  
Civil Engineers  
8111 FM 1960 W., Suite 206  
Houston, TX 77069  
281.301.5955  
FAX F-11526

4	REVISION 4	9.5.2012
No.	REVISIONS	DATE



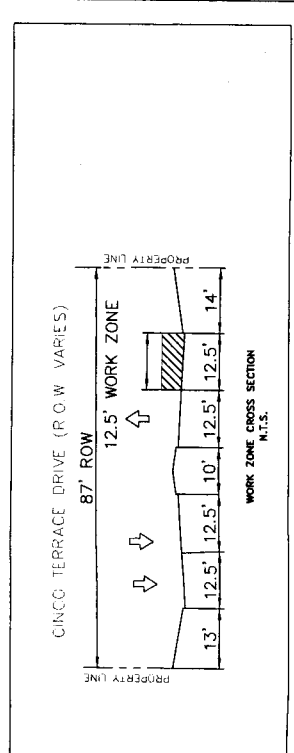
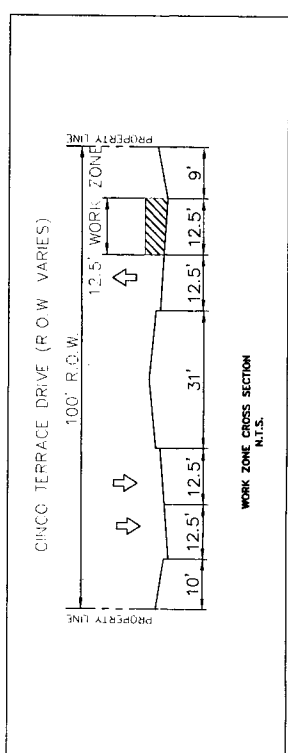
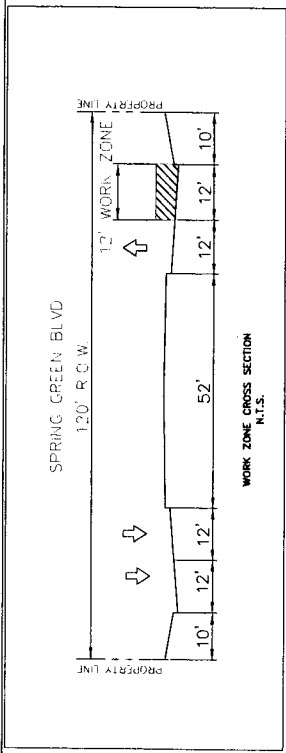
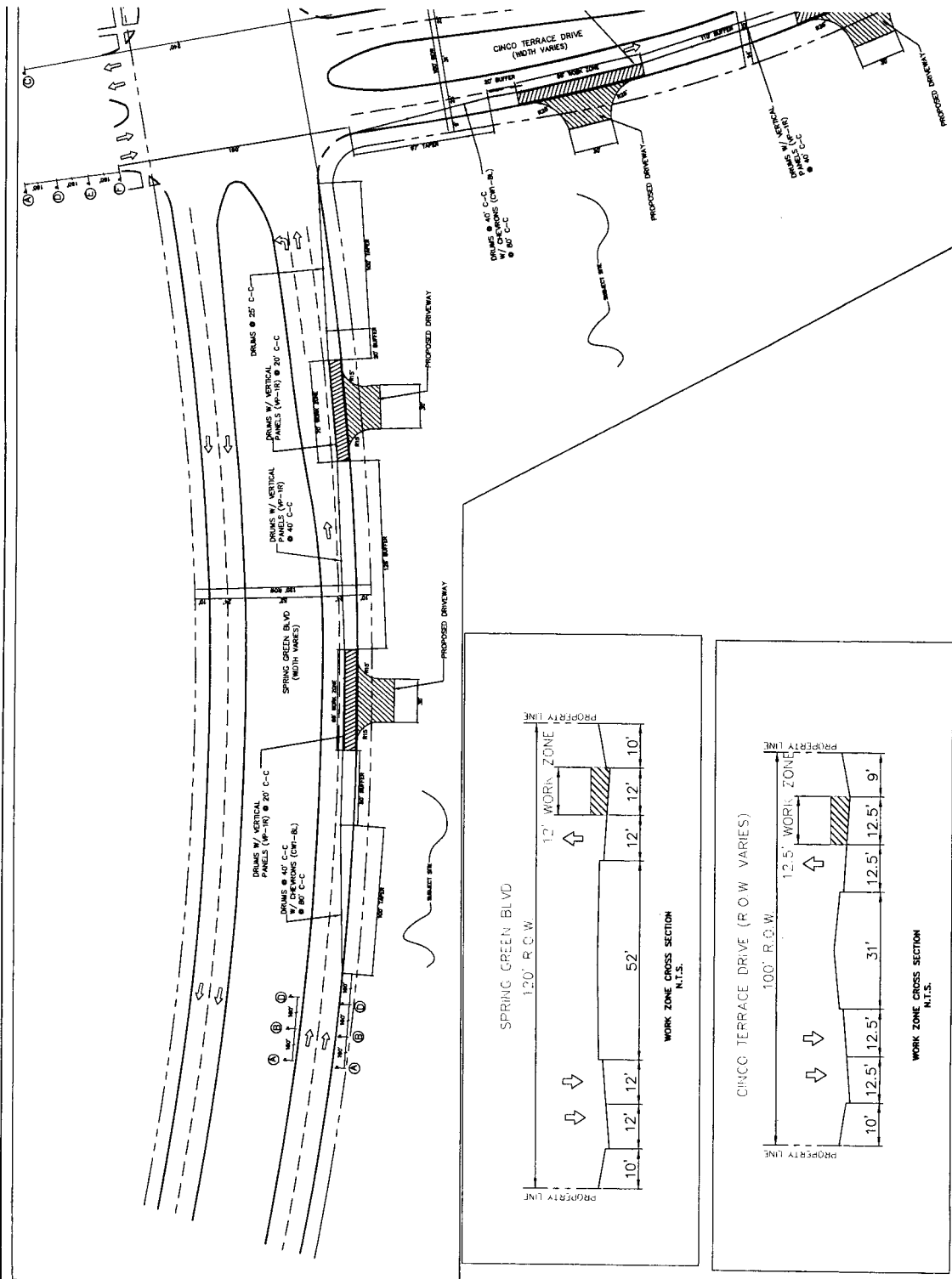

- TRAFFIC NOTES**
1. CONTRACTOR SHALL PROVIDE AND INSTALL TRAFFIC CONTROL DEVICES IN CONFORMANCE WITH THE LATEST EDITION OF THE MUTCD (REVISED - LATEST EDITION WITH REVISIONS) DURING CONSTRUCTION.
  2. NO LANES SHALL BE CLOSED FROM 7 A.M. TO 9 A.M. AND 4 P.M. TO 6:30 P.M. MONDAY THRU FRIDAY.
  3. OFF DUTY POLICE OFFICERS/AGENTS ARE REQUIRED TO DIRECT TRAFFIC WHEN LANES ARE CLOSED.
  4. CONTRACTOR SHALL COVER THE EXCAVATION WITH STEEL PLATES MATCHED PROPERLY TO THE EXISTING SURFACE. THE EXCAVATION SHALL BE PROTECTED BY A SAFETY FENCE, FEASIBLE USE TRAFFIC FOR 3/8" DIA. 3" SEPARATOR OR APPROVED EQUAL WITH SETTING AND BASE EXPOSED TO PAYMENT NEXT TO EXCAVATION DURING NON-WORKING HOURS.
  5. APPROVED COPIES OF "TRAFFIC CONTROL PLANS" SHALL BE AVAILABLE FOR INSPECTION AT THE PROJECT OFFICE.
  6. IF THE CONTRACTOR CHANGES TO USE A DIFFERENT METHOD OF TRAFFIC CONTROL PLAN DURING THE CONSTRUCTION THAN WHAT IS SUBMITTED IN THE CONTRACT DRAWINGS, ONE SHALL SUBMIT A NEW TRAFFIC CONTROL PLAN TO THE PROJECT OFFICE FOR APPROVAL.
  7. THESE PLANS SHALL BE DRAWN TO SCALE ON INDESTRUCTIBLE PAPER AND SEALED BY A LICENSED ENGINEER IN THE STATE OF TEXAS. THESE PLANS WILL BECOME A PART OF THE CONTRACT DRAWINGS.
  8. THE CONTRACTOR SHALL BE RESPONSIBLE FOR OBTAINING ALL NECESSARY PERMITS FROM THE PROJECT OFFICE PRIOR TO THE START OF CONSTRUCTION.

