

THE STATE OF TEXAS           §  
   §  
   §  
 COUNTY OF FORT BEND       §

JOINT PARTICIPATION AGREEMENT FOR DESIGN AND  
CONSTRUCTION OF WEST BELLFORT ROAD EXTENSION  
MOBILITY PROJECT NO. 741 - PHASE A

This Agreement, is made and entered into by and between Fort Bend County, a body corporate and politic under the laws of the State of Texas, by and through its Commissioners Court, hereinafter called "County," and Fort Bend County Municipal Utility District No. 194, hereinafter referred to as "District," a body corporate and politic under the laws of the State of Texas, and is effective as provided herein.

WHEREAS, in 2007 the citizens of the County voted to approve the issuance of general obligation bonds that allows the County to fund certain regional street and road improvements and associated drainage facilities that are funded in part by state or federal government; and

WHEREAS, the County and District agree that West Bellfort should be upgraded and constructed as a boulevard section between the Grand Parkway and Harlem Road (hereinafter referred to as the "Roadway");

WHEREAS, the County and the District have agreed to participate in the development and construction of the Roadway, with the District funding the segment from the east right of way line of the Grand Parkway to the connection with the existing asphalt roadway (hereinafter referred to as "the Project") in order to pay the District's pro rata share of the Roadway; and

WHEREAS, the County has requested that, as a part of this Project construction, the District construct additional storm sewer, (hereinafter referred to as "Additional Work") that will serve other segments of the Roadway, which segments will be constructed by the County following construction of the Project; and

WHEREAS, County will administer construction of the Project and Additional Work and District will reimburse County for the District's prorata share of all costs associated with the Project; and

NOW, THEREFORE, in consideration of the mutual covenants and agreements, and benefits to the parties hereto, County and District agree as follows:

1. Description of Project

The Project is shown on Exhibit A, attached hereto and incorporated herein for all purposes. The Additional Work is also shown on Exhibit A. The Project and Additional Work have been bid and the bid tabulations showing the respective pro rata costs of the Project and the Additional Work are shown on Exhibit B.

2. Period of the Agreement

This Agreement becomes effective on the date the construction contract for the Project and the Additional Work is signed by County and shall remain in effect until the work is completed and each party has paid its prorata share of all costs associated with the Project and the Additional Work.

3. Scope of Work

The Scope of the work shall be the design and construction of the Project and the Additional Work as authorized by County, and as described in attached Exhibits A and B, incorporated by reference as if set forth herein verbatim.

4. County's Responsibilities

- A. County shall prepare, or cause to be prepared, the drawings and specifications for the Project utilizing professional services contracted by the County with the District's Engineer.
- B. County shall advertise for construction bids, issue bid proposals, receive and tabulate the bids, and award and administer the contract for construction of the Project. Administration of the contract includes the responsibility for construction engineering and for issuance of any change orders, supplemental agreements, amendments, or additional work orders, which may become necessary subsequent to the award of the construction contract.
- C. County shall use its approved contract letting and award procedures to let and award the construction contract. District's Engineer shall be allowed to review construction bids prior to County's selection.
- D. Prior to their execution, District's Engineer shall be given the opportunity to review contract change orders that will result in an increase in cost to District.

- E. County shall provide District's Engineer one (1) set of reproducible "As Built" or "Record Drawings" of the construction plans upon completion of the Project.
- F. Upon completion of the Project, the County shall issue to District a "Notification of Completion," acknowledging that the Project has been completed.
- G. County will assume responsibility for the maintenance of the completed Project and the Additional Work, except for the storm sewer.
- H. In the future, when the District constructs additional detention in the regional detention pond that the District shares with Fort Bend County Municipal County District No. 146 to serve portions of West Bellfort outside of the scope of the Project, the County will pay the District for its pro rata share of such detention costs in accordance with the process as described in Section 5. C. below.

5. District's Responsibilities

- A. Within fifteen (15) days of execution of this agreement, District shall pay to County \$1,126,756.11 for the District's pro rata share of the Project and Additional Work.
- B. District shall dedicate the needed right-of-way and easements to the County and provide detention capacity for the Project at no cost to the County.
- C. When the District constructs the next phase of the regional detention pond, the District shall construct the detention needed for the County's portion of West Bellfort Road outside of the scope of the Project. The District will provide the County with a copy of the bid tabulation for review prior to award of the construction contract. After approval of the bid tabulation, the District shall invoice the County for its pro rata share of the detention costs.

6. Environmental Assessment and Mitigation

- A. County is responsible for the identification and assessment of any environmental problems associated with the Project governed by this Agreement.
- B. District is responsible for the cost of any environmental problems mitigation and remediation related to the Project, to the extent permitted

by law, if such mitigation and remediation is required by law. Any costs associated with environmental problems mitigation and remediation related to the Project shall be considered an additional cost and not included in the estimated costs as described Exhibit B.

7. Ownership of Documents

Upon completion or termination of this Agreement, all documents prepared by County shall remain the property of County. All data prepared under this Agreement shall be made available to District without restriction or limitation on their further use.

8. Default

In the event the District fails to make payment as required by this Agreement within ten (10) business days after written notice thereof from County, County shall have the following remedies in addition to County's other rights and remedies, at law or in equity:

(a) to refuse to accept the Project into its maintenance program; and/or

(b) to seek specific enforcement of this Agreement.

In the event of County's default under this Agreement, the District will be entitled to seek specific performance and/or any other remedy available to it at law or in equity.

9. Waiver

Waiver by either party of any breach of this Agreement, or the failure of either party to enforce any of the provisions of this Agreement, at any time, shall not in any way affect, limit or waive such party's right thereafter to enforce and compel strict compliance.

10. Dispute Resolution and Venue

A. In the event of a dispute related to the breach of this Agreement that cannot be settled through negotiation, County and District agree to submit the dispute to mediation.

B. In the event County or District desire to mediate any dispute, that party shall notify the other party in writing of the dispute desired to be mediated. If the parties are unable to resolve their differences within 10 days of the receipt of such notice, such dispute shall be submitted for mediation.



- C. All expenses associated with mediation shall be shared 50 percent (50%) by each party.
- D. The requirement to seek mediation shall be a condition required before filing an action at law or in equity. Any such action shall be filed in a court of competent jurisdiction in Fort Bend County, Texas, and the laws of Texas shall apply.
- E. This Agreement shall be construed in accordance with the laws of the State of Texas and shall be performable in Fort Bend County, Texas
- F. In any legal proceeding following mediation brought to enforce the terms of this Agreement, the prevailing party may recover its reasonable and necessary attorneys' fees from the non-prevailing party as permitted by Section 271.153 of the Texas Local Government Code, as it exists or may be amended.

#### 11. Amendments

Amendments and changes to this Agreement due to changes in the character of the work or terms of the Agreement, or responsibilities of the parties relating to the Project, may be enacted through a mutually agreed upon, written amendment between County and District.

#### 12. Notices

- A. All notices to either party by the other required under this Agreement shall be delivered personally or sent by certified or U.S. mail, postage prepaid, addressed to such party at the following addresses:

**County:** Fort Bend County Engineering Department  
P.O. Box 1449  
1124 Blume Road  
Rosenberg, Texas 77471  
Attn: County Engineer

**District:** Fort Bend County Municipal Utility District No. 194  
c/o Allen Boone Humphries Robinson LLP  
3200 Southwest Freeway, Suite 2600  
Houston, Texas 77027  
Attn: Lynne B. Humphries

- B. All notices shall be deemed given on the date so delivered or so deposited in the mail, unless otherwise provided herein. Either party may change the above address by sending written notice of the change to the other party. Either party may request in writing that such notices shall be delivered personally or by certified U.S. mail and such request shall be honored and carried out by the other party.

### 13. Legal Construction

In case one or more of the provisions contained in this Agreement shall for any reason be held invalid, illegal, or unenforceable in any respect, such invalidity, illegality or unenforceability shall not affect any other provisions and this Agreement shall be construed as if it did not contain the invalid, illegal, or unenforceable provision. This Agreement shall be deemed drafted equally by all parties hereto. The language of all parts of this Agreement shall be construed as a whole according to its fair meaning, and any presumption or principle that the language herein is to be construed against any party shall not apply. Headings in this Agreement are for the convenience of the parties and are not intended to be used in construing this document.

### 14. Responsibilities of the Parties

The parties agree that neither party is an agent, servant, or employee of the other party and each party agrees it is responsible for its individual acts and deeds as well as the acts and deeds of its contractors, employees, representatives, and agents.

### 15. Compliance with Laws

The parties shall comply with all federal, county, and local laws, statutes, ordinances, rules and regulations, and the orders and decrees of any courts or administrative bodies or tribunals in any manner affecting the performance of this Agreement.

### 16. Sole Agreement

This Agreement constitutes the sole and only agreement between the parties and supersedes any prior understandings or written or oral agreements respecting the Agreement's subject matter. This Agreement may be executed in a number of identical counterparts, each of which shall be deemed an original for all purposes. A facsimile signature will also be deemed to constitute an original if properly executed.

### 17. Inspection of Books and Records

The parties to this Agreement shall maintain all books, documents, papers, accounting records and other documentation relating to costs incurred under this Agreement and

shall make such materials available to County and District, or their duly authorized representatives for review and inspection at its office during the contract period and for four (4) years from the date of completion of work defined under this contract or until any impending litigation, or claims are resolved. Additionally, County and District and their duly authorized representatives shall have access to all the governmental records that are directly applicable to this Agreement for the purpose of making audits, examinations, excerpts, and transcriptions.

18. Signatory Warranty

The signatories to this Agreement warrant that each has the authority to enter into this Agreement on behalf of the party represented.

19. Sovereign Immunity

The parties agree that neither party has waived its sovereign immunity by entering into and performing its obligations under this Agreement.

20. No Third Party Beneficiaries

Nothing in this Agreement shall be construed to create any right in any third party not a signatory to this Agreement, and the parties do not intend to create any third party beneficiaries by entering into this Agreement.

21. Incorporation of Recitals

The representations, covenants and recitations set forth in the foregoing recitals of this Agreement are true and correct and are hereby incorporated into the body of this Agreement and adopted as findings of County and the Owner and/or its authorized representatives.

IN WITNESS WHEREOF, the parties have executed this Agreement and caused this Agreement to be effective on the date executed by County.

**FORT BEND COUNTY, TEXAS:**

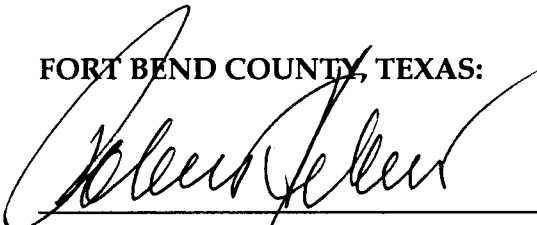
  
\_\_\_\_\_  
Robert E. Hebert, Fort Bend County Judge

11-6-2012

Date

Attest:

  
\_\_\_\_\_  
Dianne Wilson, County Clerk

Approved: COUNTY PROJECT MANAGER

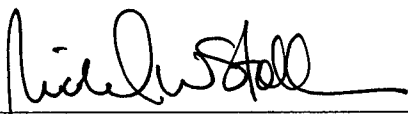
  
\_\_\_\_\_  
Richard W. Stolleis, PE, Fort Bend County Engineer

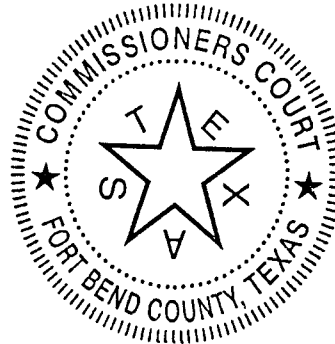

11/6/12

Date

DISTRICT:

FORT BEND COUNTY MUNICIPAL UTILITY DISTRICT NO. 194

  
\_\_\_\_\_  
President, Board of Directors

November 2, 2012

Date

Attest:

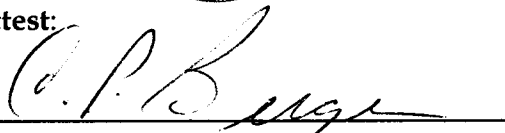
  
\_\_\_\_\_  
Secretary, Board of Directors  
Vice President

(SEAL)

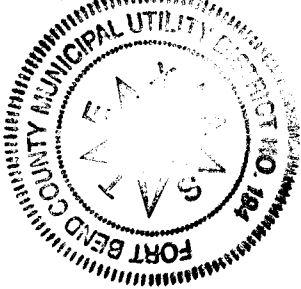

### Auditor's Certificate

I hereby certify that funds are available in the amount of \$ 185,395.35 to accomplish and pay the obligation of Fort Bend County under the foregoing contract.

A handwritten signature in dark ink, appearing to read 'Robert Ed Sturdivant', written over a horizontal line.

Robert Ed Sturdivant, County Auditor

### APPENDIX

The appendix attached to this Agreement consists of:

Exhibit "A"                      Project and Additional Work description and Map

Exhibit "B"                      Bid Project Costs and Proration



# EXHIBIT B

## Exhibit B West Belfort Cost Share for Storm Sewer Improvements

Project Title	Contractor	Construction Costs	Fort Bend County Share of Construction Costs	FBCMUD No. 194 Share of Construction Costs	Engineering Costs	Fort Bend County Share of Engineering Costs	FBCMUD No. 194 Share of Engineering Costs
Water, Sewer and Drainage Improvements for the 17 Acre Tract <sup>(1)</sup>	Clearwater Utilities	\$654,399.18	\$62,308.84	\$592,090.34	\$106,520.42	\$10,119.44	\$96,400.98 <sup>(2)</sup>
Water, Sewer, Drainage and Paving Improvements for LMF Commercial Reserve Section 4 "Reserve A-1" <sup>(3)</sup>	TDK	975,000.00	5,220.00	14,780.00 <sup>(4)</sup>	18,492.85	961.63	2,736.94 <sup>(5)</sup>
Drainage and Paving Improvements for West Belfort <sup>(6)</sup>	Mar Con Services	1,404,134.56	91,983.10	1,312,151.46	224,277.85	\$14,802.34	209,475.51 <sup>(7)</sup>
	<b>Total</b>	<b>\$3,033,533.74</b>	<b>\$159,511.94</b>	<b>\$1,919,021.80</b>	<b>\$349,291.12</b>	<b>\$25,883.41</b>	<b>\$308,613.43</b>

Amount FBCMUD No. 194 to Pay Fort Bend County **\$1,126,756.11**

<sup>(8)</sup>

### Notes:

- (1) Project was completed in February 2010. See Table No. 3 for construction cost details.
- (2) Fort Bend County share of engineering is based on the share of the construction costs.  $\$62,308.84 / \$654,399.18 \times 100 = 9.5\%$
- (3) Project was completed in 2011. See Table No. 2 for construction cost details.
- (4) Construction cost share shown is only for the storm sewer portion of the contract which totals \$20,000. The total construction cost contains other building items.
- (5) The engineering cost is only for the design of the water, sewer, drainage and paving improvements. The construction cost for these design items is  $\$80,000 + \$20,000 = \$100,000$ . Fort Bend County share for engineering is  $\$5,220 / \$100,000 \times 100 = 5.2\%$ . FBCMUD No. 194 cost share is  $\$14,780 / \$100,000 \times 100 = 14.8\%$ .
- (6) Project is under construction. See Table No. 1 for construction cost details.
- (7) Fort Bend County share of engineering is based on the share of the construction costs.  $\$91,983.10 / \$1,404,134.56 \times 100 = 6.6\%$  *{Total costs spent to date}*
- (8) The amount was determined by taking the FBCMUD No. 194 Share of the Mar Con Services contract and subtracting Fort Bend County's share of the construction and engineering costs.  $\$1,312,151.46 - 159,511.94 - 25,883.41 = \$1,126,756.11$



Bid Tabulation for Construction of Drainage and Paving Improvements  
for West Bellfort Road Widening for Fort Bend County  
Bids Received June 21, 2012

**BID 12-055 (Fort Bend County Cost Share)**

**Table No. 1**

Computation Notes on Page 10

Mar-Con Services				Fort Bend County		FBCMUD No. 194		
Item No.	Spec. No.	Description of Item	Quantity	Unit	Price	Extended Total	Pro Rata Share	Extended Total
SECTION I - WEST BELLFORT ROAD WITHIN TXDOT RIGHT-OF-WAY								
A. DRAINAGE ITEMS								
1.	460	24" Inlet Lead, To Include Adjusting Existing Inlet, Breaking Into Existing Inlet and Connect the Prop. 24" RCP	157	LF	\$64.70	\$10,157.90	0.0%	\$0.00
2.	472	Type "C" Inlet with an Additional Depth Up To 5 Feet (Stages I and II)	2	EA	\$1,750.60	\$3,501.20	0.0%	\$0.00
3.	465	Remove Existing 24" Storm Sewer Lead	144	LF	\$8.70	\$1,252.80	0.0%	\$0.00
4.	495	Remove and Dispose of Existing Storm Sewer Inlet, Including Manhole	4	EA	\$285.90	\$1,143.60	0.0%	\$0.00
5.	429	Trench Safety Systems, 5' to 10' Depth	157	LF	\$1.60	\$251.20	0.0%	\$0.00
DRAINAGE ITEMS SUBTOTAL						\$16,306.70		\$0.00
B. PAVING ITEMS								
6.	102	Clearing & Grubbing	0.6	AC	\$6,090.40	\$3,654.24	0.0%	\$0.00
7.	110	Roadway Excavation	2,650	CY	\$8.30	\$21,995.00	0.0%	\$0.00
8.	220	6-inch Lime Stabilized Subgrade	670	SY	\$3.20	\$2,144.00	0.0%	\$0.00
9.	221	Lime for Subgrade (8%) or (48 lbs per SY)	17	TON	\$159.90	\$2,718.30	0.0%	\$0.00
9a.	TXDOT Item 292	6" Cement Stabilized Base as per TXDOT Item 292-2224 "CEM TRT (PLNT MX)(CL N)(TY E)(GR 4)(6")"	670	SY	\$15.20	\$10,184.00	0.0%	\$0.00
9b.	TXDOT Item 292	Asph Stabilized Base (1" Bond Breaker) as Per TXDOT Item 292-2017 "ASPHALT STAB BASE (GR 4)(PG 64)"	37	TON	\$311.90	\$11,540.30	0.0%	\$0.00
10.	360	10-inch Reinforced Concrete Pavement (3,500 psi), To Include Standard Paving Header (Load Transfer Device), Saw Cutting, and any Block Out for Inlets 6-inch Concrete/ Rip Rap for Raised Median	670	SY	\$44.30	\$29,681.00	0.0%	\$0.00
11.	535	6-inch Concrete Curb	102	SY	\$48.40	\$4,936.80	0.0%	\$0.00
12.	530	Traffic Signs	580	LF	\$2.10	\$1,218.00	0.0%	\$0.00
13.	624, 646	Traffic Control Handling (All Phases)	1	EA	\$345.00	\$345.00	0.0%	\$0.00
14.	671	Relocate Existing Sign	4	MO	\$4,100.90	\$16,403.60	0.0%	\$0.00
15.	500	Remove & Dispose of Exist. Concrete Pavement, Island, Curb, and Wheelchair Ramp	1	EA	\$125.80	\$125.80	0.0%	\$0.00
16.	104	Remove & Dispose of Exist. Concrete Pavement.	375	SY	\$5.80	\$2,175.00	0.0%	\$0.00
17.	540	Remove & Dispose of Exist. Asphalt Pavement (surface and Base Material)	148	SY	\$5.80	\$858.40	0.0%	\$0.00
PAVING ITEMS SUBTOTAL						\$107,979.44		\$0.00
								\$107,979.44

Bid Tabulation for Construction of Drainage and Paving Improvements  
for West Belfort Road Widening for Fort Bend County  
Bids Received June 21, 2012

**BID 12-055 (Fort Bend County Cost Share)**

**Table No. 1**

Computation Notes on Page 10

Mar-Con Services				Fort Bend County		FBCMUD No. 194		
Item No.	Spec. No.	Description of Item	Quantity	Unit	Price	Extended Total	Pro Rata Share	Extended Total
C. TRAFFIC SIGNAL ITEMS - SH99 NBFR AT W BELLFORT								
18.	416 - 2032 (TXDOT)	DRILL SHAFT (TRF SIG POLE) (36 IN.)	31	LF	\$253.00	\$7,843.00	0.0%	\$7,843.00
19.	531 - 2005 (TXDOT)	CURB RAMP (TY 1)	1	EA	\$924.80	\$924.80	0.0%	\$924.80
20.	531 - 2011 (TXDOT)	CURB RAMP (TY 8)	2	EA	\$924.80	\$1,849.60	0.0%	\$1,849.60
21.	531 - 2014 (TXDOT)	CURB RAMP (TY 22)	1	EA	\$2,326.90	\$2,326.90	0.0%	\$2,326.90
22.	618 - 2034 (TXDOT)	CONDUIT (PVC) (SCHD 80) (2")	90	LF	\$5.80	\$522.00	0.0%	\$522.00
23.	618 - 2038 (TXDOT)	CONDUIT (PVC) (SCHD 80) (3")	470	LF	\$8.10	\$3,807.00	0.0%	\$3,807.00
24.	618 - 2039 (TXDOT)	CONDUIT (PVC) (SCHD 80) (3") (BORE)	500	LF	\$11.50	\$5,750.00	0.0%	\$5,750.00
25.	620 - 2009 (TXDOT)	ELEC CONDR (NO. 6) BARE	720	LF	\$1.00	\$720.00	0.0%	\$720.00
26.	621 - 2004 (TXDOT)	TRAY CABLE (4 CONDR) (12 AWG)	335	LF	\$1.70	\$569.50	0.0%	\$569.50
27.	624 - 2014 (TXDOT)	GROUND BOX TY D (162922) W/APRON	5	EA	\$649.80	\$3,249.00	0.0%	\$3,249.00
28.	682 - 2001 (TXDOT)	BACK PLATE (12 IN) (3 SEC)	4	EA	\$63.30	\$253.20	0.0%	\$253.20
29.	682 - 2002 (TXDOT)	BACK PLATE (12 IN) (4 SEC)	1	EA	\$74.80	\$74.80	0.0%	\$74.80
30.	682 - 2014 (TXDOT)	PED SIG SEC (12 IN) LED (2 INDICATIONS)	4	EA	\$414.00	\$1,656.00	0.0%	\$1,656.00
31.	682 - 2022 (TXDOT)	VEH SEC (12 IN) LED (GRN ARW)	1	EA	\$195.50	\$195.50	0.0%	\$195.50
32.	682 - 2023 (TXDOT)	VEH SEC (12 IN) LED (GRN)	4	EA	\$195.50	\$782.00	0.0%	\$782.00
33.	682 - 2024 (TXDOT)	VEH SEC (12 IN) LED (YEL ARW)	1	EA	\$184.00	\$184.00	0.0%	\$184.00
34.	682 - 2025 (TXDOT)	VEH SEC (12 IN) LED (YEL)	4	EA	\$195.50	\$782.00	0.0%	\$782.00
35.	682 - 2027 (TXDOT)	VEH SEC (12 IN) LED (RED)	6	EA	\$184.00	\$1,104.00	0.0%	\$1,104.00



Bid Tabulation for Construction of Drainage and Paving Improvements  
for West Bellfort Road Widening for Fort Bend County  
Bids Received June 21, 2012

**BID 12-055 (Fort Bend County Cost Share)**

**Table No. 1**

Computation Notes on Page 10

Item No.	Spec. No.	Description of Item	Quantity	Unit	Mar-Con Services		Fort Bend County		FRCMUD No. 194	
					Unit Price	Extended Total	Pro Rata Share	Extended Total	Pro Rata Share	Extended Total
36.	684 - 2007 (TXDOT)	TRAF SIG CBL (TY A) (12 AWG) (2 CONDR)	1.210	LF	\$1.00	\$1,210.00	0.0%	\$0.00	100.0%	\$1,210.00
37.	684 - 2009 (TXDOT)	TRAF SIG CBL (TY A) (12 AWG) (4 CONDR)	1.210	LF	\$1.30	\$1,573.00	0.0%	\$0.00	100.0%	\$1,573.00
38.	684 - 2012 (TXDOT)	TRAF SIG CBL (TY A) (12 AWG) (7 CONDR)	1.070	LF	\$2.00	\$2,140.00	0.0%	\$0.00	100.0%	\$2,140.00
39.	686 - 2039 (TXDOT)	INS TRAF SIG PL AM (S) 1 ARM (40')	1	EA	\$6,900.00	\$6,900.00	0.0%	\$0.00	100.0%	\$6,900.00
40.	686 - 2045 (TXDOT)	INS TRAF SIG PL AM (S) 1 ARM (44') LUM	1	EA	\$9,085.00	\$9,085.00	0.0%	\$0.00	100.0%	\$9,085.00
41.	687 - 2001 (TXDOT)	PED POLE ASSEMBLY	1	EA	\$1,069.50	\$1,069.50	0.0%	\$0.00	100.0%	\$1,069.50
42.	688 - 2001 (TXDOT)	PED DETECT (2 IN PUSH BTN)	4	EA	\$87.40	\$349.60	0.0%	\$0.00	100.0%	\$349.60
43.	6007 - 2001 (TXDOT)	REMOVING TRAFFIC SIGNALS (PARTIAL)	1	EA	\$1,897.50	\$1,897.50	0.0%	\$0.00	100.0%	\$1,897.50
44.	6266 - 2001 (TXDOT)	VIVDS PROCESSOR SYSTEM	1	EA	\$4,370.00	\$4,370.00	0.0%	\$0.00	100.0%	\$4,370.00
45.	6266 - 2002 (TXDOT)	VIVDS CAMERA ASSEMBLY	2	EA	\$1,523.80	\$3,047.60	0.0%	\$0.00	100.0%	\$3,047.60
46.	6266 - 2003 (TXDOT)	VIVDS SET - UP SYSTEM	1	EA	\$287.50	\$287.50	0.0%	\$0.00	100.0%	\$287.50
47.	6266 - 2005 (TXDOT)	VIVDS COMMUNICATION CABLE (COAXIAL)	700	LF	\$1.80	\$1,260.00	0.0%	\$0.00	100.0%	\$1,260.00
<b>TRAFFIC SIGNAL ITEMS - SH99 NBFR AT W BELLFORT SUBTOTAL</b>						<b>\$65,783.00</b>		<b>\$0.00</b>		<b>\$65,783.00</b>
<b>D. PAVEMENT MARKING RELATED ITEMS</b>										
48.	660	REFL PAV MRK TY I (W) 8" (SLD) (100MIL)	415	LF	\$1.30	\$539.50	0.0%	\$0.00	100.0%	\$539.50
49.	660	REFL PAV MRK TY I (W) 12" (SLD) (100MIL)	525	LF	\$3.30	\$1,732.50	0.0%	\$0.00	100.0%	\$1,732.50
50.	660	REFL PAV MRK TY I (W) 24" (SLD) (100MIL)	220	LF	\$5.60	\$1,232.00	0.0%	\$0.00	100.0%	\$1,232.00
51.	660	REFL PAV MRK TY I (Y) 4" (SLD) (100MIL)	680	LF	\$0.60	\$408.00	0.0%	\$0.00	100.0%	\$408.00
52.	660	REFL PAV MRK TY I (Y) 24" (SLD) (100MIL)	280	LF	\$5.60	\$1,568.00	0.0%	\$0.00	100.0%	\$1,568.00
53.	663	TRAFFIC BUTTON TY II - C - R	10	EA	\$4.40	\$44.00	0.0%	\$0.00	100.0%	\$44.00
54.	663	TRAFFIC BUTTON TY II - A - A	36	EA	\$4.40	\$158.40	0.0%	\$0.00	100.0%	\$158.40
55.	666	REFL PAV MRK TY I (W) (ARROW) (100MIL)	1	EA	\$184.00	\$184.00	0.0%	\$0.00	100.0%	\$184.00
56.	666	REFL PAV MRK TY I (W) (WORD) (100MIL)	1	EA	\$264.50	\$264.50	0.0%	\$0.00	100.0%	\$264.50
<b>PAVEMENT MARKING RELATED ITEMS SUBTOTAL</b>						<b>\$6,130.90</b>		<b>\$0.00</b>		<b>\$6,130.90</b>

**BID 12-055 (Fort Bend County Cost Share)**

Table No. 1

Computation Notes on Page 10

Mar-Con Services						Fort Bend County		FRCMUD No. 194		
Item No.	Spec. No.	Description of Item	Quantity	Unit	Price	Extended Total	Pro Rata Share	Extended Total	Pro Rata Share	Extended Total
E. EROSION & SEDIMENTATION CONTROL ITEMS										
57.	713	Reinforced Filter Fabric Fence	410	LF	\$1.30	\$533.00	0.0%	\$0.00	100.0%	\$533.00
58.	719	Filter Fence Barrier around Inlets (per Inlet)	3	EA	\$46.00	\$138.00	0.0%	\$0.00	100.0%	\$138.00
59.	741	Gravel Bag Barrier around Inlets	30	LF	\$4.00	\$120.00	0.0%	\$0.00	100.0%	\$120.00
60.	165	Turf Establishment by Hydromulch Seeding	0.3	AC	\$3,450.00	\$1,035.00	0.0%	\$0.00	100.0%	\$1,035.00
61.	751	SWPPP Inspection and Maintenance	4	MO	\$1,000.00	\$4,000.00	0.0%	\$0.00	100.0%	\$4,000.00
EROSION & SEDIMENTATION CONTROL ITEMS SUBTOTAL						\$5,826.00		\$0.00		\$5,826.00
F. SUPPLEMENTAL ITEMS										
62.	436	Well Point Dewatering System	50	LF	\$20.00	\$1,000.00	0.0%	\$0.00	100.0%	\$1,000.00
63.	402	Extra Bank Sand Backfill	10	CY	\$10.00	\$100.00	0.0%	\$0.00	100.0%	\$100.00
64.	433, SP 433	Cement Stabilized Sand (Based on 8-inch	10	SY	\$12.50	\$125.00	0.0%	\$0.00	100.0%	\$125.00
65.		Additional Cost for Bedding for Unsatisfactory Soil	50	LF	\$10.00	\$500.00	0.0%	\$0.00	100.0%	\$500.00
		Conditions per City of Houston Drawing No. 2317-02								
66.	360	Rapid Setting High Early Strength Concrete - 10-inch in Depth (3,500 psi). To Include Standard Paving Header (Load Transfer Device), and Saw Cutting	15	CY	\$300.00	\$4,500.00	0.0%	\$0.00	100.0%	\$4,500.00
SUPPLEMENTAL ITEMS SUBTOTAL						\$6,225.00		\$0.00		\$6,225.00
SECTION II - WEST BELLFORT ROAD WITHIN FORT BEND COUNTY RIGHT-OF-WAY										
G. DRAINAGE ITEMS										
67.	460	24" Inlet Lead	65	LF	\$59.20	\$3,848.00	0.0%	\$0.00	100.0%	\$3,848.00
68.	460, 431	24" Inlet Lead By Bore & Jack	95	LF	\$172.40	\$16,378.00	0.0%	\$0.00	100.0%	\$16,378.00
69.	460	30" Inlet Lead	39	LF	\$84.40	\$3,291.60	6.7% <sup>(1)</sup>	\$220.54	93.3%	\$3,071.06
70.	460, 431	30" Inlet Lead By Bore & Jack	41	LF	\$213.50	\$8,753.50	6.7% <sup>(1)</sup>	\$586.48	93.3%	\$8,167.02
71.	460	24" RCP Storm Sewer	401	LF	\$65.70	\$26,345.70	0.0%	\$0.00	100.0%	\$26,345.70
72.	460, 433	36" RCP Storm Sewer	504	LF	\$103.00	\$51,912.00	6.7% <sup>(1)</sup>	\$3,478.10	93.3%	\$48,433.90
73.	460, 433	54" RCP Storm Sewer, To Include Breaking into Exist. Storm Manhole and Connecting the Prop.	209	LF	\$219.20	\$45,812.80	33.5% <sup>(2a)</sup>	\$15,347.29	66.5%	\$30,465.51
		54" RCP								
460, 433		54" RCP Storm Sewer, To Include Breaking into Exist. Storm Manhole and Connecting the Prop.	200	LF	\$219.20	\$43,840.00	28.9% <sup>(2b)</sup>	\$12,669.76	71.1%	\$31,170.24
		54" RCP								
460, 433		54" RCP Storm Sewer, To Include Breaking into Exist. Storm Manhole and Connecting the Prop.	175	LF	\$219.20	\$38,360.00	26.8% <sup>(2c)</sup>	\$10,280.48	73.2%	\$28,079.52
		54" RCP								



Bid Tabulation for Construction of Drainage and Paving Improvements  
for West Bellfort Road Widening for Fort Bend County  
Bids Received June 21, 2012

**BID 12-055 (Fort Bend County Cost Share)**

**Table No. 1**

Computation Notes on Page 10

Mar-Con Services						Fort Bend County		FBCMUD No. 194		
Item No.	Spec. No.	Description of Item	Quantity	Unit	Price	Extended Total	Pro Rata Share	Extended Total	Pro Rata Share	Extended Total
74.	472	Type "B-B" Inlet with an Additional Depth Up To 5 Feet (Stages I and II)	2	EA	\$2,068.00	\$4,136.00	0.0%	\$0.00	100.0%	\$4,136.00
75.	472	Type "C-1" Inlet with an Additional Depth Up To 5 Feet and 5' Extension on Each Side (Stages I and II)	1	EA	\$2,534.70	\$2,534.70	6.7% <sup>(1)</sup>	\$169.82	93.3%	\$2,364.88
76.	472	Type "C-1" Curb Inlet with an Additional Depth Up To 5 Feet (Stages I and II)	2	EA	\$2,468.00	\$4,936.00	0.0%	\$0.00	100.0%	\$4,936.00
77.	472	Type "C-1" Curb Inlet with an Additional Depth Up To 5 Feet and 5' Extension on Each Side (Stages I and II)	1	EA	\$2,215.00	\$2,215.00	6.7% <sup>(1)</sup>	\$148.41	93.3%	\$2,066.60
78.	471	Type "M" Storm Sewer Manhole (Junction Box with Access)	1	EA	\$7,509.50	\$7,509.50	33.5% <sup>(2)</sup>	\$2,515.68	66.5%	\$4,993.82
79.	471	Type "C" Extra Depth Storm Sewer Manhole (48" pipe and larger)	2	EA	\$6,588.40	\$13,176.80	0.0%	\$0.00	100.0%	\$13,176.80
80.	429	Trench Safety Systems, 10' to 15' Depth	1,009	LF	\$1.30	\$1,311.70	3.6% <sup>(3)</sup>	\$47.30	96.4%	\$1,264.40
81.	429	Trench Safety Systems, 15' to 20' Depth	209	LF	\$1.30	\$271.70	33.5% <sup>(4)</sup>	\$91.02	66.5%	\$180.68
429		Trench Safety Systems, 15' to 20' Depth	200	LF	\$1.30	\$260.00	28.9% <sup>(4)</sup>	\$75.14	71.1%	\$184.86
429		Trench Safety Systems, 15' to 20' Depth	175	LF	\$1.30	\$227.50	26.8% <sup>(4)</sup>	\$60.97	73.2%	\$166.53
DRAINAGE ITEMS SUBTOTAL						\$275,120.50		\$45,690.99		\$229,429.50
H. PAVING ITEMS										
82.	102	Clearing & Grubbing	2.7	AC	\$44,940.60	\$121,339.62	0.0%	\$0.00	100.0%	\$121,339.62
83.	132	Embankment	92	CY	\$15.60	\$1,435.20	0.0%	\$0.00	100.0%	\$1,435.20
84.	110	Roadway Excavation, To include Roadside Ditch	6,325	CY	\$8.30	\$52,497.50	0.0%	\$0.00	100.0%	\$52,497.50
85.	220	8-inch Lime Stabilized Subgrade	7,510	SY	\$2.10	\$15,771.00	0.0%	\$0.00	100.0%	\$15,771.00
86.	221	Lime for Subgrade (8%) or (48 lbs per SY)	180	TON	\$158.70	\$28,566.00	0.0%	\$0.00	100.0%	\$28,566.00
87.	360	8-inch Reinforced Concrete Pavement (3,500 psi), To Include Standard Paving Header (Load Transfer Device), Saw Cutting, and any Block Out for Inlets	6,842	SY	\$34.50	\$236,049.00	0.0%	\$0.00	100.0%	\$236,049.00
88.	530	6-inch Concrete Curb	3,005	LF	\$2.10	\$6,310.50	0.0%	\$0.00	100.0%	\$6,310.50
89.	530	6-inch Concrete Dowelled on Curb	125	LF	\$5.60	\$700.00	0.0%	\$0.00	100.0%	\$700.00
90.	530	Channelized Mountable (3") Median Type I Curb and Gutter	32	LF	\$5.50	\$176.00	0.0%	\$0.00	100.0%	\$176.00
91.	535	3-inch Concrete/ Rip Rap within the Raised Median at Driveway	15	SY	\$50.40	\$756.00	0.0%	\$0.00	100.0%	\$756.00
92.	624, 646	Traffic Signs	4	EA	\$448.50	\$1,794.00	0.0%	\$0.00	100.0%	\$1,794.00
93.	464	6" Irrigation Sleeves	272	LF	\$9.90	\$2,692.80	0.0%	\$0.00	100.0%	\$2,692.80
94.	671	Traffic Control Handling (All Phases)	4	MO	\$2,765.50	\$11,062.00	0.0%	\$0.00	100.0%	\$11,062.00
95.	465	Remove Existing Culverts, Including any Safety End Treatments	243	LF	\$8.70	\$2,114.10	0.0%	\$0.00	100.0%	\$2,114.10

Bid Tabulation for Construction of Drainage and Paving Improvements  
for West Bellfort Road Widening for Fort Bend County  
Bids Received June 21, 2012

**BID 12-055 (Fort Bend County Cost Share)**

**Table No. 1**

Computation Notes on Page 10

Mar-Con Services					Fort Bend County		FBCMUD No. 194	
Item No.	Spec. No.	Description of Item	Quantity	Unit	Unit Price	Extended Total	Pro Rata Share	Extended Total
96.	500	Remove Existing Sign	5	EA	\$66.00	\$330.00	0.0%	\$330.00
97.	500	Relocate Existing Sign	2	EA	\$125.80	\$251.60	0.0%	\$251.60
98.	500	Relocate Existing Mailbox	1	EA	\$143.50	\$143.50	0.0%	\$143.50
99.	540	Remove & Dispose of Exist. Asphaltic Pavement (Surface and Base), Including any Dowelled on Curbs and All Driveways	3.603	SY	\$12.80	\$46,118.40	0.0%	\$46,118.40
PAVING ITEMS SUBTOTAL						\$528,107.22		\$528,107.22
I. ASPHALT TRANSITION RELATED ITEMS								
100.	102	Clearing & Grubbing	0.9	AC	\$3,894.00	\$3,504.60	0.0%	\$3,504.60
101.	132	Embankment	55	CY	\$15.90	\$874.50	0.0%	\$874.50
102.	110	Roadway Excavation, To include Roadside Ditch	610	CY	\$8.30	\$5,063.00	0.0%	\$5,063.00
103.	460	54" RCP Storm Sewer	26	LF	\$205.30	\$5,337.80	100.0% <sup>(5)</sup>	\$5,337.80
104.	460, 431	54" RCP Storm Sewer By Bore & Jack	32	LF	\$1,016.30	\$32,521.60	100.0% <sup>(5)</sup>	\$32,521.60
105.	472	Modified Type "AD" Inlet	2	EA	\$3,316.70	\$6,633.40	100.0% <sup>(5)</sup>	\$6,633.40
106.	360	4-inch Concrete Slope Paving for Modified Type "AD" Inlet as per Detail on Sheet 13 of 22	19	SY	\$94.70	\$1,799.30	100.0% <sup>(5)</sup>	\$1,799.30
107.	530	6" Concrete Dowelled on Curb	150	LF	\$5.60	\$840.00	0.0%	\$0.00
108.	340	3-inch Type "D" Hot Mix-Hot Laid Asphalt Concrete Paving (HMAC)	193	TON	\$110.90	\$21,403.70	0.0%	\$0.00
109.	250	5-inch Hot Mix Asphaltic Concrete Base Course (Black Base)	321	TON	\$91.90	\$29,499.90	0.0%	\$0.00
110.	220	8-inch Lime Stabilized Subgrade	1.128	SY	\$3.20	\$3,609.60	0.0%	\$0.00
111.	221	Lime for Subgrade (8%) or (48 lbs per SY)	24	TON	\$159.90	\$3,837.60	0.0%	\$0.00
112.	540	Remove & Dispose of Exist. Asphaltic Pavement (Surface and Base), Including All Driveways	423	SY	\$5.80	\$2,453.40	0.0%	\$0.00
ASPHALT TRANSITION RELATED ITEMS SUBTOTAL						\$117,378.40		\$46,292.10
J. TRAFFIC SIGNAL ITEMS FOR MEADOW RANCH PKWY AT W. BELLFORT - OPTION 2								
113.	416 - 2032 (TXDOT)	DRILL SHAFT (TRF SIG POLE) (36 IN.)	32	LF	\$253.00	\$8,096.00	0.0%	\$0.00
114.	416 - 2034 (TXDOT)	DRILL SHAFT (TRF SIG POLE) (48 IN.)	44	LF	\$391.00	\$17,204.00	0.0%	\$0.00
115.	502 - 2001 (TXDOT)	BARRICADES, SIGNS AND TRAFFIC HANDLING	1	MO	\$1,725.00	\$1,725.00	0.0%	\$0.00
116.	531 - 2010 (TXDOT)	CURB RAMP (TY 7)	1	EA	\$924.80	\$924.80	0.0%	\$0.00
117.	531 - 2011 (TXDOT)	CURB RAMP (TY 8)	3	EA	\$924.80	\$2,774.40	0.0%	\$0.00
								\$2,774.40



Bid Tabulation for Construction of Drainage and Paving Improvements  
for West Bellfort Road Widening for Fort Bend County  
Bids Received June 21, 2012

**BID 12-055 (Fort Bend County Cost Share)**

**Table No. 1**

Computation Notes on Page 10

Mar-Con Services				Fort Bend County			FBCMUD No. 194		
Item No.	Spec. No.	Description of Item	Quantity	Unit	Price	Extended Total	Pro Rata Share	Extended Total	Pro Rata Share
118.	618 - 2034 (TXDOT)	CONDUIT (PVC) (SCHD 80) (2")	125	LF	\$5.80	\$725.00	0.0%	\$0.00	100.0%
119.	618 - 2038 (TXDOT)	CONDUIT (PVC) (SCHD 80) (3")	150	LF	\$8.10	\$1,215.00	0.0%	\$0.00	100.0%
120.	619 - 2039 (TXDOT)	CONDUIT (PVC) (SCHD 80) (3") (BORE)	700	LF	\$11.50	\$8,050.00	0.0%	\$0.00	100.0%
121.	620 - 2009 (TXDOT)	ELEC CONDR (NO. 6) BARE	575	LF	\$1.00	\$575.00	0.0%	\$0.00	100.0%
122.	621 - 2010 (TXDOT)	ELEC CONDR (NO. 6) INSULATED	80	LF	\$1.20	\$96.00	0.0%	\$0.00	100.0%
123.	621 - 2002 (TXDOT)	TRAY CABLE (3 CONDOR) (12 AWG)	400	LF	\$1.70	\$680.00	0.0%	\$0.00	100.0%
124.	624 - 2014 (TXDOT)	GROUND BOX TY D (162922) W/APRON	5	EA	\$649.80	\$3,249.00	0.0%	\$0.00	100.0%
125.	628 - 2100 (TXDOT)	ELEC SRV TY D 120 / 240 070 (NS) SS (E) SP (O)	1	EA	\$3,795.00	\$3,795.00	0.0%	\$0.00	100.0%
126.	636 - 2001 (TXDOT)	ALUMINUM SIGN (TY A)	48	SF	\$19.60	\$940.80	0.0%	\$0.00	100.0%
127.	644 - 2004 (TXDOT)	INS SM RD SN SUP & AM TY 10BWG (1) SA (T)	3	EA	\$448.50	\$1,345.50	0.0%	\$0.00	100.0%
128.	666 - 2048 (TXDOT)	REFL PAV MRK TY I (W) 24" (SLD)	850	LF	\$5.80	\$4,930.00	0.0%	\$0.00	100.0%
129.	666 - 2195 (TXDOT)	PAVEMENT SEALER 24"	850	LF	\$0.80	\$680.00	0.0%	\$0.00	100.0%
130.	678 - 2006 (TXDOT)	PAV SURE PREP FOR MRK 24"	850	LF	\$0.30	\$255.00	0.0%	\$0.00	100.0%
131.	680 - 2003 (TXDOT)	INSTALL HWY TRAF SIG (SYSTEM)	1	EA	\$29,325.00	\$29,325.00	0.0%	\$0.00	100.0%
132.	682 - 2001 (TXDOT)	BACK PLATE (12 IN) (3 SEC)	8	EA	\$63.30	\$506.40	0.0%	\$0.00	100.0%
133.	682 - 2002 (TXDOT)	BACK PLATE (12 IN) (4 SEC)	5	EA	\$74.80	\$374.00	0.0%	\$0.00	100.0%
134.	682 - 2014 (TXDOT)	PED SIG SEC (12 IN) LED (2 INDICATIONS)	8	EA	\$414.00	\$3,312.00	0.0%	\$0.00	100.0%
135.	682 - 2022 (TXDOT)	VEH SEC (12 IN) LED (GRN ARW)	5	EA	\$195.50	\$977.50	0.0%	\$0.00	100.0%
136.	682 - 2023 (TXDOT)	VEH SEC (12 IN) LED (GRN)	8	EA	\$195.50	\$1,564.00	0.0%	\$0.00	100.0%

Bid Tabulation for Construction of Drainage and Paving Improvements  
for West Bellfort Road Widening for Fort Bend County  
Bids Received June 21, 2012

**BID 12-055 (Fort Bend County Cost Share)**

**Table No. 1**

Computation Notes on Page 10

Mar-Con Services				Fort Bend County			FBCMUD No. 194		
Item No.	Spec. No.	Description of Item	Quantity	Unit	Price	Extended Total	Pro Rata Share	Extended Total	Pro Rata Share
137.	682 - 2024 (TXDOT)	VEH SEC (12 IN) LED (YEL ARW)	5	EA	\$184.00	\$920.00	0.0%	\$0.00	100.0%
138.	682 - 2025 (TXDOT)	VEH SEC (12 IN) LED (YEL)	8	EA	\$195.50	\$1,564.00	0.0%	\$0.00	100.0%
139.	682 - 2026 (TXDOT)	VEH SEC (12 IN) LED (RED ARW)	10	EA	\$184.00	\$1,840.00	0.0%	\$0.00	100.0%
140.	682 - 2027 (TXDOT)	VEH SEC (12 IN) LED (RED)	8	EA	\$184.00	\$1,472.00	0.0%	\$0.00	100.0%
141.	682 - 2043 (TXDOT)	PED SIG SEC (12") (2 IND) (HOUSING ONLY)	8	EA	\$207.00	\$1,656.00	0.0%	\$0.00	100.0%
142.	684 - 2007 (TXDOT)	TRAF SIG CBL (TY A) (12 AWG) (2 CONDR)	1,450	LF	\$1.00	\$1,450.00	0.0%	\$0.00	100.0%
143.	684 - 2009 (TXDOT)	TRAF SIG CBL (TY A) (12 AWG) (4 CONDR)	1,450	LF	\$1.30	\$1,885.00	0.0%	\$0.00	100.0%
144.	684 - 2012 (TXDOT)	TRAF SIG CBL (TY A) (12 AWG) (7 CONDR)	3,000	LF	\$2.00	\$6,000.00	0.0%	\$0.00	100.0%
145.	686 - 2045 (TXDOT)	INS TRAF SIG PL AM (S) 1 ARM (44') LUM	2	EA	\$8,625.00	\$17,250.00	0.0%	\$0.00	100.0%
146.	686 - 2055 (TXDOT)	INS TRF SIG PL AM (S) 1 ARM (55')	1	EA	\$11,730.00	\$11,730.00	0.0%	\$0.00	100.0%
147.	686 - 2063 (TXDOT)	INS TRF SIG PL AM (S) 1 ARM (65')	1	EA	\$12,650.00	\$12,650.00	0.0%	\$0.00	100.0%
148.	687 - 2001 (TXDOT)	PEID POLE ASSEMBLY	2	EA	\$1,069.50	\$2,139.00	0.0%	\$0.00	100.0%
149.	688 - 2001 (TXDOT)	PEID DETECT (2 IN PUSH BTN)	8	EA	\$87.40	\$699.20	0.0%	\$0.00	100.0%
150.	6006 - 2001 (TXDOT)	SPREAD SPECTRUM RADIO	1	EA	\$4,485.00	\$4,485.00	0.0%	\$0.00	100.0%
151.	6006 - 2003 (TXDOT)	HELLAX CABLE	80	LF	\$3.20	\$256.00	0.0%	\$0.00	100.0%
152.	6006 - 2005 (TXDOT)	ANTENNA (UNI-DIRECTIONAL)	1	EA	\$759.00	\$759.00	0.0%	\$0.00	100.0%
153.	6266 - 2001 (TXDOT)	VIVDS PROCESSOR SYSTEM	1	EA	\$6,900.00	\$6,900.00	0.0%	\$0.00	100.0%
154.	6266 - 2002 (TXDOT)	VIVDS CAMERA ASSEMBLY	4	EA	\$1,495.00	\$5,980.00	0.0%	\$0.00	100.0%
155.	6266 - 2003 (TXDOT)	VIVDS SET - UP SYSTEM	1	EA	\$575.00	\$575.00	0.0%	\$0.00	100.0%



Bid Tabulation for Construction of Drainage and Paving Improvements  
for West Belfort Road Widening for Fort Bend County  
Bids Received June 21, 2012

**BID 12-055 (Fort Bend County Cost Share)**

**Table No. 1**

Computation Notes on Page 10

Mar-Con Services					Fort Bend County		FRCMUD No. 194	
Item No.	Spec. No.	Description of Item	Quantity	Unit	Unit Price	Extended Total	Pro Rata Share	Extended Total
156 .	6266 - 2005	VIVDS COMMUNICATION CABLE (TXDOT)	900	LF	\$1.80	\$1,620.00	0.0%	\$0.00
157 .	8260 - 2001	LED COUNTDOWN PEDESTRIAN MODULE (TXDOT)	8	EA	\$218.50	\$1,748.00	0.0%	\$0.00
TRAFFIC SIGNAL ITEMS FOR MEADOW RANCH PKWY AT W. BELLFORT - OPTION 2 SUBTOTAL						\$176,897.60		\$0.00
K. PAVEMENT MARKING RELATED ITEMS								
158 .	660	REFL PAV MKR TY I (W) 4" (SLD) (100MIL)	80	LF	\$0.60	\$48.00	0.0%	\$0.00
159 .	660	REFL PAV MKR TY I (W) 4" (BRK) (100MIL)	400	LF	\$0.60	\$240.00	0.0%	\$0.00
160 .	660	REFL PAV MKR TY I (W) 8" (SLD) (100MIL)	545	LF	\$1.30	\$708.50	0.0%	\$0.00
161 .	660	REFL PAV MKR TY I (Y) 4" (SLD) (100MIL)	1,060	LF	\$0.60	\$636.00	0.0%	\$0.00
162 .	660	REFL PAV MKR TY I (Y) 24" (SLD) (100MIL)	160	LF	\$6.20	\$992.00	0.0%	\$0.00
163 .	663	REFL PAV MKR TY II - C - R	30	EA	\$4.40	\$132.00	0.0%	\$0.00
164 .	663	TRAFFIC BUTTON TY II - A - A	58	EA	\$4.40	\$255.20	0.0%	\$0.00
165 .	666	REFL PAV MKR TY I (W) (ARROW) (100MIL)	6	EA	\$184.00	\$1,104.00	0.0%	\$0.00
166 .	666	REFL PAV MKR TY I (W) (WORD) (100MIL)	6	EA	\$264.50	\$1,587.00	0.0%	\$0.00
PAVEMENT MARKING RELATED ITEMS SUBTOTAL						\$5,702.70		\$0.00
L. EROSION & SEDIMENTATION CONTROL ITEMS								
167 .	713	Reinforced Filter Fabric Fence	3,600	LF	\$1.30	\$4,680.00	0.0%	\$0.00
168 .	719	Filter Fence Barrier around Inlets (per Inlet)	10	EA	\$46.00	\$460.00	0.0%	\$0.00
169 .	741	Gravel Bag Barrier around Inlets	100	LF	\$4.30	\$430.00	0.0%	\$0.00
170 .	165	Turf Establishment by Hydromulch Seeding	1.95	AC	\$1,112.10	\$2,168.60	0.0%	\$0.00
171 .	751	SWPPP Inspection and Maintenance	4	MO	\$1,000.00	\$4,000.00	0.0%	\$0.00
EROSION & SEDIMENTATION CONTROL ITEMS SUBTOTAL						\$11,738.60		\$0.00
M. SUPPLEMENTAL ITEMS								
172 .	436	Well Point Dewatering System	500	LF	\$20.00	\$10,000.00	0.0%	\$0.00
173 .	402	Extra Bank Sand Backfill	50	CY	\$10.00	\$500.00	0.0%	\$0.00
174 .	433, SP 433	Cement Stabilized Sand (Based on 8-inch	100	SY	\$12.50	\$1,250.00	0.0%	\$0.00
175 .		Additional Cost for Bedding for Unsatisfactory Soil Conditions per City of Houston Drawing No. 2317-02	100	LF	\$10.00	\$1,000.00	0.0%	\$0.00
176 .	360	Rapid Setting High Early Strength Concrete - 8-inch in Depth (3,500 psi), To Include Standard Paving Header (Load Transfer Device), and Saw	140	CY	\$262.70	\$36,778.00	0.0%	\$0.00
177 .	221	Additional Lime	100	TON	\$159.90	\$15,990.00	0.0%	\$0.00
178 .	624, 646	Traffic Signs	3	EA	\$448.50	\$1,345.50	0.0%	\$0.00

Bid Tabulation for Construction of Drainage and Paving Improvements  
for West Bellfort Road Widening for Fort Bend County  
Bids Received June 21, 2012

**BID 12-055 (Fort Bend County Cost Share)**

Table No. 1

Computation Notes on Page 10

				Mar-Con Services		Fort Bend County		FBCMUD No. 194		
Item No.	Spec. No.	Description of Item	Quantity	Unit	Price	Extended Total	Pro Rata Share	Extended Total	Pro Rata Share	Extended Total
178a.		Bracing/ Extra Trenching Effort for Construction of the Proposed 54" RCP, if the 16" Surface Waterline (NEBW/A) was already Constructed	1	LS	\$2,000.00	\$2,000.00	0.0%	\$0.00	100.0%	\$2,000.00
178b.		Bracing Existing Power Pole and Down Guy	7	EA	\$1,725.00	\$12,075.00	0.0%	\$0.00	100.0%	\$12,075.00
SUPPLEMENTAL ITEMS SUBTOTAL						\$80,938.50		\$0.00		\$80,938.50
TOTAL AMOUNT OF BASE BID						\$1,404,134.56		\$91,983.10		\$1,312,151.46

**Notes:**

Fort Bend County Share is based on acreage utilizing the storm sewer system. Please see Exhibit No. 1.

(1) Curb Inlet 10003 to MH 10005:  $0.78 \text{ Ac} / 11.59 \text{ Ac} \times 100 = 6.7\%$

(2a) MH 10005 to MH 10019 [209 ft]:  $13.18 / 39.39 \times 100 = 33.5\%$

(2b) MH 10019 to MH 10006 [200 ft]:  $13.18 / 45.56 \times 100 = 28.9\%$

(2c) MH 10006 to MH 10013 [175 ft]:  $13.18 / 49.24 \times 100 = 26.8\%$

(3) Trench Safety Share for 30 inch Inlet Lead and 36 inch RCP:  $.39 \text{ L.F.} \times 6.7\% + 504 \text{ L.F.} \times 6.7\% / 1,009 \text{ L.F.} \times 100 = 3.6\%$

(4) Length of 54 inch therefore pro rata share is the same as Item No. 73.

(5) Share is 100% for Fort Bend County because these items accommodate the drainage for the existing roadside ditch.

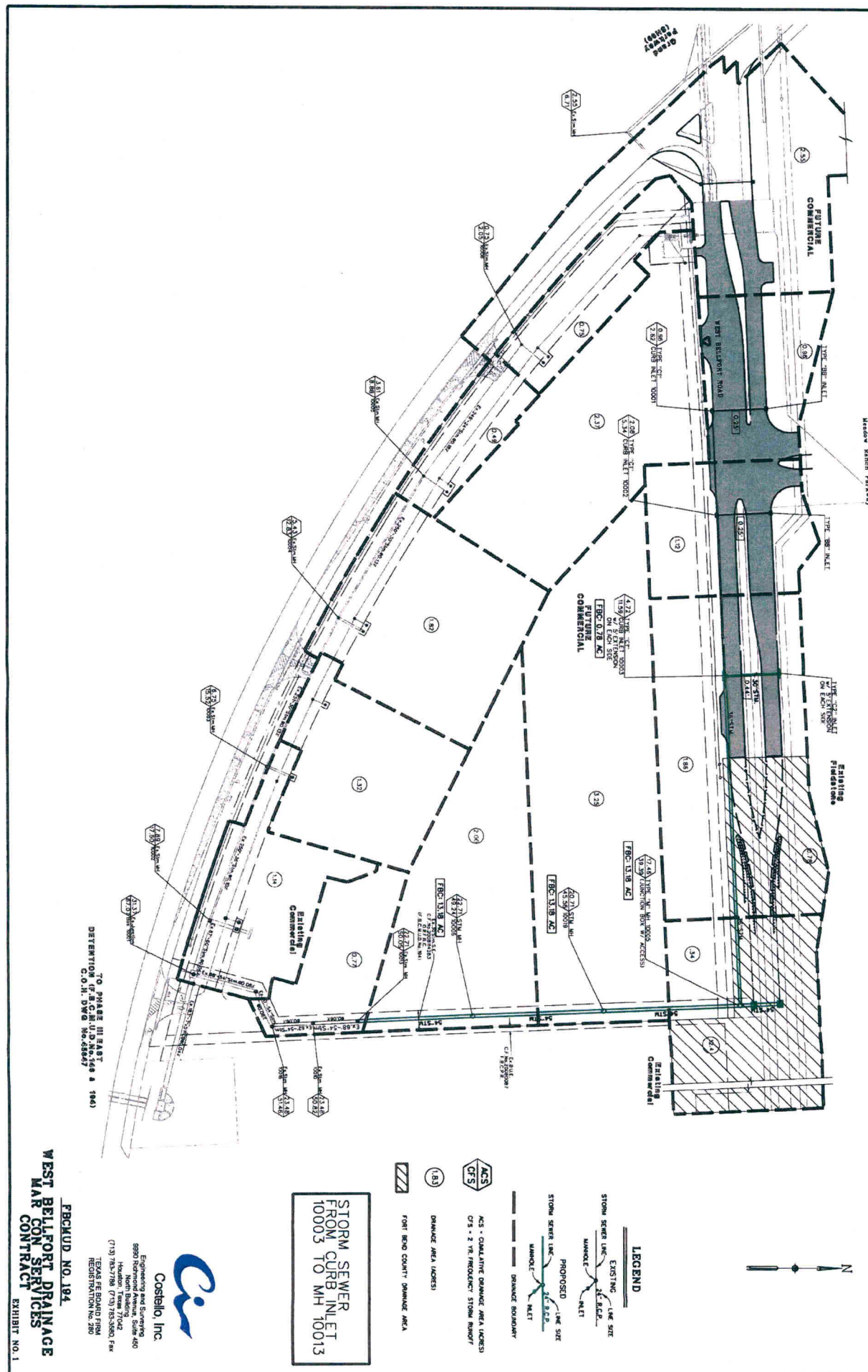



LMF Commercial Reserve Section 4 "Reserve A-1"  
 Project Completed: 2011  
**TDK Contract (Fort Bend County Share)**  
**Table No. 2**

Item No.	Description of Item	Quantity	Unit	TDK		Fort Bend County		FBCMUD No. 194	
				Price	Extended Total	Pro Rata Share	Extended Total	Pro Rata Share	Extended Total
1.	Mobilization	1	LS	\$48,750.00	\$48,750.00	0.0%	\$0.00	0.0%	\$0.00
2.	Site Work/ Storm Sewer / Lime Stabilize.	1	LS	\$80,000.00	\$80,000.00	0.0%	\$0.00	0.0%	\$0.00
3.	54" Storm Pipe	1	LS	\$20,000.00	\$20,000.00	26.1% <sup>(1)</sup>	\$5,220.00	73.9%	\$14,780.00
4.	Electrical Power / Light Poles	1	LS	\$82,400.00	\$82,400.00	0.0%	\$0.00	0.0%	\$0.00
5.	Paving / Sidewalk / Driveway	1	LS	\$116,000.00	\$116,000.00	0.0%	\$0.00	0.0%	\$0.00
6.	Building Slab	1	LS	\$56,000.00	\$56,000.00	0.0%	\$0.00	0.0%	\$0.00
7.	Steel Building	1	LS	\$97,600.00	\$97,600.00	0.0%	\$0.00	0.0%	\$0.00
8.	Stucco	1	LS	\$20,000.00	\$20,000.00	0.0%	\$0.00	0.0%	\$0.00
9.	Masonry / Block Wall / Stone / Cast Stone	1	LS	\$76,000.00	\$76,000.00	0.0%	\$0.00	0.0%	\$0.00
10.	Build up Roof/ Metal work for canopy	1	LS	\$78,400.00	\$78,400.00	0.0%	\$0.00	0.0%	\$0.00
11.	Drywall Framing	1	LS	\$28,000.00	\$28,000.00	0.0%	\$0.00	0.0%	\$0.00
12.	Plumbing	1	LS	\$52,000.00	\$52,000.00	0.0%	\$0.00	0.0%	\$0.00
13.	Dumpster and Gate	1	LS	\$8,400.00	\$8,400.00	0.0%	\$0.00	0.0%	\$0.00
14.	Landscaping	1	LS	\$24,000.00	\$24,000.00	0.0%	\$0.00	0.0%	\$0.00
15.	Storefront / Backdoors / Interior Doors/ Windows	1	LS	\$24,000.00	\$24,000.00	0.0%	\$0.00	0.0%	\$0.00
16.	Painting	1	LS	\$8,000.00	\$8,000.00	0.0%	\$0.00	0.0%	\$0.00
17.	Striping / Handicap Signs	1	LS	\$1,600.00	\$1,600.00	0.0%	\$0.00	0.0%	\$0.00
18.	Exterior Water Proofing	1	LS	\$7,600.00	\$7,600.00	0.0%	\$0.00	0.0%	\$0.00
19.	General Condition	1	LS	\$146,250.00	\$146,250.00	0.0%	\$0.00	0.0%	\$0.00
<b>TOTAL AMOUNT</b>					<b>\$975,000.00</b>		<b>\$5,220.00</b>		<b>\$14,780.00</b>

**Notes:**

Fort Bend County Share is based on acreage utilizing the storm sewer system. Please see **Exhibit No. 2.**

(1) MH 10013 to MH 10016: [(13.18 Ac / 50.05 ac x 68 ft) + (13.18 Ac / 50.82 ac x 62 ft)] / 130 ft x 100 = 26.1%

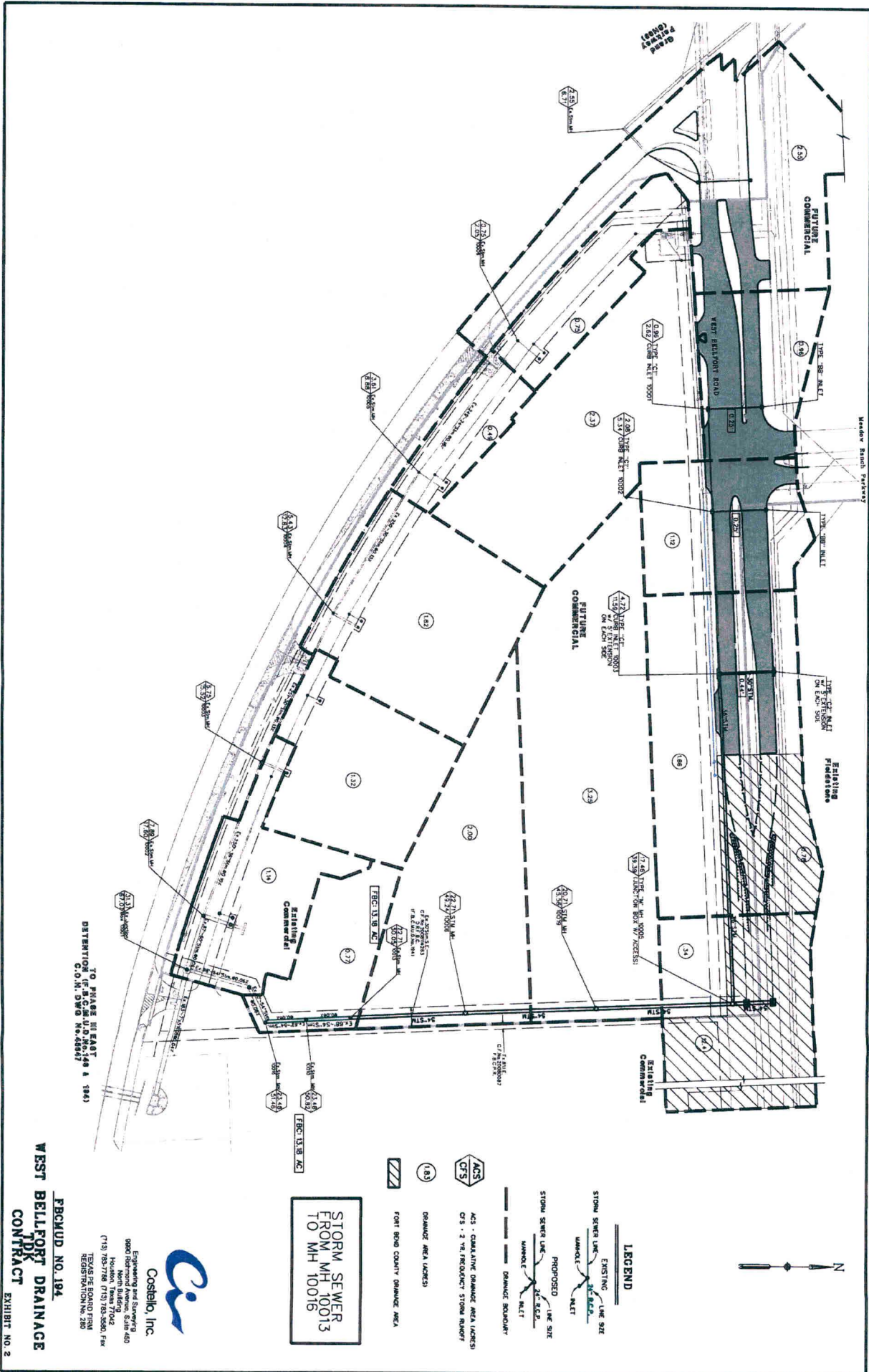



Water, Sewer, and Drainage Improvements  
for the 17 Acre Tract located in Fort Bend County MUD No. 194  
C.I. Job No.: 2007-010-103  
Project Completed: February 2010

**Clearwater Utilities Contract (Fort Bend County Share)**

**Table No. 3**

		Clearwater Utilities			Fort Bend County			FBCMUD No. 194		
Item No.	Description of Item	Quantity	Unit	Price	Extended Total	Pro Rata Share	Extended Total	Pro Rata Share	Extended Total	
SECTION I - UTILITIES ALONG MORTON ROAD AND STORM SEWER OUTFALL										
SECTION A. WATER ITEMS										
1.	12" PVC Water Line, Open Cut, All	600	LF	\$16.40	\$9,840.00	0.0%	\$0.00	100.0%	\$9,840.00	
2.	12" PVC Restrained Joint Water Line, Open Cut, All Depths, Including Fittings	122	LF	\$54.00	\$6,588.00	0.0%	\$0.00	100.0%	\$6,588.00	
3.	12" PVC Restrained Joint Water Line in 20" Steel Casing, All Depths	316	LF	\$105.00	\$33,180.00	0.0%	\$0.00	100.0%	\$33,180.00	
4.	12" PVC Restrained Joint Water Line in 20" Steel Casing, Bore and Jack, All Depths	265	LF	\$122.50	\$32,462.50	0.0%	\$0.00	100.0%	\$32,462.50	
5.	8" PVC Water Line, Open Cut, All Depths	20	LF	\$12.00	\$240.00	0.0%	\$0.00	100.0%	\$240.00	
6.	12" Gate Valve & Box	4	EA	\$1,425.00	\$5,700.00	0.0%	\$0.00	100.0%	\$5,700.00	
7.	8" Gate Valve & Box	1	EA	\$720.00	\$720.00	0.0%	\$0.00	100.0%	\$720.00	
8.	6" Gate Valve & Box	1	EA	\$510.00	\$510.00	0.0%	\$0.00	100.0%	\$510.00	
9.	12" Plug and Clamp	1	EA	\$200.00	\$200.00	0.0%	\$0.00	100.0%	\$200.00	
10.	8" Plug and Clamp	1	EA	\$140.00	\$140.00	0.0%	\$0.00	100.0%	\$140.00	
11.	2" Blow-Off Valve and Box	1	EA	\$460.00	\$460.00	0.0%	\$0.00	100.0%	\$460.00	
12.	Flush Valves	1	EA	\$1,670.00	\$1,670.00	0.0%	\$0.00	100.0%	\$1,670.00	
13.	12" x 8" Tee	1	EA	\$300.00	\$300.00	0.0%	\$0.00	100.0%	\$300.00	
14.	12" x 6" Tee	1	EA	\$235.00	\$235.00	0.0%	\$0.00	100.0%	\$235.00	
15.	12" x 45° Bend	4	EA	\$230.00	\$920.00	0.0%	\$0.00	100.0%	\$920.00	
16.	Remove Exist. 2" Blow off Valve & Box	1	EA	\$30.00	\$30.00	0.0%	\$0.00	100.0%	\$30.00	
17.	12" Wet Connection	1	EA	\$230.00	\$230.00	0.0%	\$0.00	100.0%	\$230.00	
18.	Trench Safety	1,058	LF	\$0.05	\$52.90	0.0%	\$0.00	100.0%	\$52.90	
Subtotal:					\$93,478.40		\$0.00		\$93,478.40	

Water, Sewer, and Drainage Improvements  
for the 17 Acre Tract located in Fort Bend County MUD No. 194  
C.I. Job No.: 2007-010-103  
Project Completed: February 2010  
**Clearwater Utilities Contract (Fort Bend County Share)**  
**Table No. 3**

Item		Clearwater Utilities			Fort Bend County		FBCMUD No. 194		
No.	Description of Item	Quantity	Unit	Price	Extended Total	Pro Rata Share	Extended Total	Pro Rata Share	Extended Total
SECTION B. SANITARY SEWER ITEMS									
19 .	8" PVC Sanitary Sewer, Open Cut, All	88	LF	\$56.70	\$4,989.60	0.0%	\$0.00	100.0%	\$4,989.60
20 .	18" PVC Sanitary Sewer, Open Cut, All	21	LF	\$32.00	\$672.00	0.0%	\$0.00	100.0%	\$672.00
Depths									
21 .	4" PVC Restrained Joint Sanitary Sewer Force Main, Open Cut, All Depths	20	LF	\$14.70	\$294.00	0.0%	\$0.00	100.0%	\$294.00
22 .	4" PVC Sanitary Sewer Force Main, Open Cut, All Depths	540	LF	\$5.00	\$2,700.00	0.0%	\$0.00	100.0%	\$2,700.00
23 .	4" PVC Sanitary Sewer Force Main, Bore and Jack, All Depths	60	LF	\$29.00	\$1,740.00	0.0%	\$0.00	100.0%	\$1,740.00
24 .	4" PVC Restrained Joint Sanitary Sewer Force Main in 20" Steel Casing, All Depths	524	LF	\$67.00	\$35,108.00	0.0%	\$0.00	100.0%	\$35,108.00
25 .	4" PVC Restrained Joint Sanitary Sewer Force Main in 20" Steel Casing, Bore and Jack, All Depths	237	LF	\$95.20	\$22,562.40	0.0%	\$0.00	100.0%	\$22,562.40
26 .	14" PVC Sanitary Sewer Force Main, Permanent Wall Joint, All Depths	10	LF	\$185.00	\$1,850.00	0.0%	\$0.00	100.0%	\$1,850.00
27 .	Sanitary Sewer Manhole	2	EA	\$1,640.00	\$3,280.00	0.0%	\$0.00	100.0%	\$3,280.00
28 .	Sanitary Sewer Force Main Discharge Manhole with All Related Fittings	1	LS	\$15,400.00	\$15,400.00	0.0%	\$0.00	100.0%	\$15,400.00
29 .	Connect Sanitary Sewer to Existing Sanitary Sewer Manhole	1	LS	\$1,100.00	\$1,100.00	0.0%	\$0.00	100.0%	\$1,100.00
30 .	Trench Safety System	1,253	LF	\$0.15	\$187.95	0.0%	\$0.00	100.0%	\$187.95
Subtotal:					\$89,883.95		\$0.00		\$89,883.95



Water, Sewer, and Drainage Improvements  
for the 17 Acre Tract located in Fort Bend County MUD No. 194  
C.I. Job No.: 2007-010-103  
Project Completed: February 2010  
**Clearwater Utilities Contract (Fort Bend County Share)**  
**Table No. 3**

		Clearwater Utilities		Fort Bend County		FRCMUD No. 194	
Item No.	Description of Item	Quantity	Unit	Extended Total	Pro Rata Share	Extended Total	Pro Rata Share
SECTION C. DRAINAGE ITEMS							
31 .	54" RCP Storm Sewer	158	LF	\$172.80	\$27,302.40	56.1% <sup>(1)</sup>	\$11,985.75
32 .	7' x 5' RCB Storm Sewer	184	LF	\$276.00	\$50,784.00	42.0% <sup>(2)</sup>	\$29,454.72
33 .	18" RCP Storm Sewer	20	LF	\$33.00	\$660.00	0.0%	\$660.00
34 .	Junction Box	1	EA	\$21,300.00	\$21,300.00	42.0% <sup>(2)</sup>	\$12,354.00
35 .	Concrete Headwall with Flared Wing	1	EA	\$12,800.00	\$12,800.00	42.0% <sup>(2)</sup>	\$7,424.00
36 .	4" Concrete Slope Paving	262	SY	\$35.50	\$9,301.00	42.0% <sup>(2)</sup>	\$5,394.58
37 .	Trench Safety System	342	LF	\$2.00	\$684.00	48.5% <sup>(3)</sup>	\$352.26
38 .	Traffic Control for Open Cut Construction of the 7' x 5' RCB Storm Sewer	1	LS	\$4,500.00	\$4,500.00	42.0% <sup>(2)</sup>	\$2,610.00
39 .	Remove and Replace Concrete Pavement	70	SY	\$75.00	\$5,250.00	42.0% <sup>(2)</sup>	\$3,045.00
40 .	Type "C" Storm Sewer Manhole (Greater than 42" pipe diameter)	2	EA	\$2,470.00	\$4,940.00	42.0% <sup>(2)</sup>	\$2,865.20
				Subtotal:	\$137,521.40		
SECTION II - LIFT STATION ITEMS							
1 .	Clearing and Grubbing	1	LS	\$850.00	\$850.00	0.0%	\$850.00
2 .	Grading of Lift Station Site	1	LS	\$1,200.00	\$1,200.00	0.0%	\$1,200.00
3 .	Lift Station		LS	\$191,500.00	\$0.00	0.0%	\$0.00
3a .	84" x 24vg RCP, Caissoned	1	LS	\$134,200.00	\$134,200.00	0.0%	\$134,200.00
3b .	Reinf. Structural Concrete	1	LS	\$16,000.00	\$16,000.00	0.0%	\$16,000.00
3c .	4" Pipe, Valves, Fittings, Supt's	1	LS	\$12,500.00	\$12,500.00	0.0%	\$12,500.00
3d .	2-4", 3hp pumps, c. paul, hatch	1.0	LS	\$16,000.00	\$16,000.00	0.0%	\$16,000.00
3e .	Paint Mechanical, Weld T-Lok	1	LS	\$4,600.00	\$4,600.00	0.0%	\$4,600.00
3f .	8" PVC influent Conn	2	EA	\$2,900.00	\$5,800.00	0.0%	\$5,800.00
3g .	6" Galv Pipe Bollard	4	EA	\$250.00	\$1,000.00	0.0%	\$1,000.00
3h .	O&M Manuals	1	LS	\$1,400.00	\$1,400.00	0.0%	\$1,400.00
4 .	Subgrade Stabilization	182	SY	\$7.15	\$1,301.30	0.0%	\$1,301.30



Water, Sewer, and Drainage Improvements  
for the 17 Acre Tract located in Fort Bend County MUD No. 194  
C.I. Job No.: 2007-010-103  
Project Completed: February 2010  
**Clearwater Utilities Contract (Fort Bend County Share)**  
**Table No. 3**

Item No.	Description of Item	Quantity	Unit	Clearwater Utilities		Fort Bend County		FBCMUD No. 194	
				Price	Extended Total	Pro Rata Share	Extended Total	Pro Rata Share	Extended Total
5.	Hydrated Lime	1.5	TO	\$160.00	\$240.00	0.0%	\$0.00	100.0%	\$240.00
6.	12 ft. Wide 6" Concrete Access Drive	98	SY	\$46.00	\$4,508.00	0.0%	\$0.00	100.0%	\$4,508.00
7.	Asphalt Portion of Access Drive	56	SY	\$31.00	\$1,736.00	0.0%	\$0.00	100.0%	\$1,736.00
8.	8' Tall Wood Fence	186	LF	\$49.50	\$9,207.00	0.0%	\$0.00	100.0%	\$9,207.00
9.	8' Tall x 16' Wide Wood Double Gate	1	EA	\$1,530.00	\$1,530.00	0.0%	\$0.00	100.0%	\$1,530.00
10.	Turf Establishment	1	LS	\$1,450.00	\$1,450.00	0.0%	\$0.00	100.0%	\$1,450.00
11.	Trench Safety Systems	1	LS	\$350.00	\$350.00	0.0%	\$0.00	100.0%	\$350.00
12.	Electrical System Installation	1	LS	\$9,400.00	\$9,400.00	0.0%	\$0.00	100.0%	\$9,400.00
13.	Telephone Automatic Dialer System	1	LS	\$1,800.00	\$1,800.00	0.0%	\$0.00	100.0%	\$1,800.00
14.	Controller Programming	1	LS	\$7,500.00	\$7,500.00	0.0%	\$0.00	100.0%	\$7,500.00
<b>Subtotal:</b>					<b>\$232,572.30</b>		<b>\$0.00</b>		<b>\$232,572.30</b>

#### SECTION III - OTHER ITEMS

##### A. EROSION & SEDIMENT CONTROL ITEMS

1.	Vehicle Entry/Exit	1	EA	\$1,115.00	\$1,115.00	0.0%	\$0.00	100.0%	\$1,115.00
2.	Sand Bag Barrier around Inlets (per Inlet)	4	EA	\$30.00	\$120.00	0.0%	\$0.00	100.0%	\$120.00
3.	Turf Establishment by Hydromulch	3.2	AC	\$1,250.00	\$4,000.00	0.0%	\$0.00	100.0%	\$4,000.00
4.	Straw Bale Fence		LF	\$8.00	\$0.00	0.0%	\$0.00	100.0%	\$0.00
5.	Reinforced Filter Fabric Fence	1,896	LF	\$1.15	\$2,180.40	0.0%	\$0.00	100.0%	\$2,180.40
<b>Subtotal:</b>					<b>\$7,415.40</b>		<b>\$0.00</b>		<b>\$7,415.40</b>

##### B. SUPPLEMENTAL ITEMS

6.	Well Pointing		LF	\$15.00	\$0.00	0.0%	\$0.00	100.0%	\$0.00
7.	Clearing and Grubbing		AC	\$900.00	\$0.00	0.0%	\$0.00	100.0%	\$0.00
8.	Wet Sand Bedding for Sanitary Sewer as per City of Houston Drawing No. 02317-01		LF	\$5.00	\$0.00	0.0%	\$0.00	100.0%	\$0.00

Water, Sewer, and Drainage Improvements  
for the 17 Acre Tract located in Fort Bend County MUD No. 194  
C.I. Job No.: 2007-010-103  
Project Completed: February 2010  
**Clearwater Utilities Contract (Fort Bend County Share)**  
**Table No. 3**

Item No.	Description of Item	Quantity	Unit	Clearwater Utilities		Fort Bend County		FBCMUD No. 194	
				Unit Price	Extended Total	Pro Rata Share	Extended Total	Pro Rata Share	Extended Total
9.	Additional Cost for Bedding for Unsatisfactory Soil Conditions per City of Houston Drawing No. 02317-02	LF		\$10.00	\$0.00	0.0%	\$0.00	100.0%	\$0.00
10.	Crushed Stone Sanitary Manhole Support as per City of Houston Drawing No. 02082-05	EA		\$100.00	\$0.00	0.0%	\$0.00	100.0%	\$0.00
11.	Bore and Jack	LF		\$25.00	\$0.00	0.0%	\$0.00	100.0%	\$0.00
12.	Brace Power Poles	EA		\$1,200.00	\$0.00	0.0%	\$0.00	100.0%	\$0.00
13.	Contingency to Adjust Utilities and Irrigation	2.2423	LS	\$2,000.00	\$4,484.60	13.9% <sup>(4)</sup>	\$623.36	86.1%	\$3,861.24
14.	Contingency to Replace Landscaping	1.1136	LS	\$2,000.00	\$2,227.26	13.9% <sup>(4)</sup>	\$309.59	86.1%	\$1,917.67
15.	Additional Excavation and Backfill for Structures		CY	\$5.00	\$0.00	0.0%	\$0.00	100.0%	\$0.00
16.	Additional Excavation, Trenching, and Backfill for Utilities	1	CY	\$6.00	\$6.00	0.0%	\$0.00	100.0%	\$6.00
17.	Additional Cement Stabilized Sand	33	CY	\$18.00	\$594.00	0.0%	\$0.00	100.0%	\$594.00
18.	Additional Reinforcing Steel		TO	\$850.00	\$0.00	0.0%	\$0.00	100.0%	\$0.00
19.	Additional Structural Concrete		CY	\$450.00	\$0.00	0.0%	\$0.00	100.0%	\$0.00
20.	Dewatering for Lift Station		LS	\$200.00	\$0.00	0.0%	\$0.00	100.0%	\$0.00
21.	Auxiliary Power to Test Lift Station		LS	\$175.00	\$0.00	0.0%	\$0.00	100.0%	\$0.00
22.	Orange Construction Fence	260	LF	\$1.60	\$416.00	0.0%	\$0.00	100.0%	\$416.00
23.	Dry Bore (within TXDOT right-of-way)	502	LF	\$160.00	\$80,320.00	0.0%	\$0.00	100.0%	\$80,320.00
24.	Centerpoint Energy costs for Power Service to the Lift Station		LS	\$2,500.00	\$0.00	0.0%	\$0.00	100.0%	\$0.00
25.	Construction Surveying	0.99996	LS	\$3,500.00	\$3,499.87	0.0%	\$0.00	100.0%	\$3,499.87
<b>TOTAL BASE BID ITEMS</b>				<b>Subtotal:</b>	<b>\$91,547.73</b>		<b>\$932.95</b>		<b>\$90,614.78</b>
					<b>\$652,419.18</b>		<b>\$62,308.84</b>		<b>\$590,110.34</b>

Water, Sewer, and Drainage Improvements  
 for the 17 Acre Tract located in Fort Bend County MUD No. 194  
 C.I. Job No.: 2007-010-103  
 Project Completed: February 2010  
**Clearwater Utilities Contract (Fort Bend County Share)**  
**Table No. 3**

Item No.	Description of Item	Quantity	Unit	Clearwater Utilities		Fort Bend County		FBCMUD No. 194	
				Price	Extended Total	Pro Rata Share	Extended Total	Pro Rata Share	Extended Total
	CHANGE ORDER NO. 1	1	LS	\$1,980.00	\$1,980.00	0.0%	\$0.00	100.0%	\$1,980.00
TOTAL AMOUNT					\$654,399.18		\$62,308.84		\$592,090.34

**Notes:**

Fort Bend County Share is based on acreage utilizing the storm sewer system. Please see Exhibit No. 3.

- (1) MH 10016 to Junction Box 10001:  $\frac{13.18 \text{ Ac}}{23.48 \text{ ac}} \times 100 = 56.1\%$
- (2) Junction Box 10001 to Outfall:  $\frac{13.18 \text{ Ac}}{31.37 \text{ Ac}} \times 100 = 42.0\%$
- (3) Trench Safety for 54 inch RCP and 7ft x 5 ft RCB:  $\frac{(158 \text{ LF} \times 56.1\% + 184 \text{ LF} \times 42.0\%)}{342 \times 100} = 48.5\%$
- (4) Supplemental Items needed to construct the 7 ft x 5 ft RCB and the water and sanitary force main along West Bellfort, therefore pro rata share of is 42%, the same as Section I, Item No. 32, for 33% of the item.  $\frac{42\% \times 33\%}{100} = 13.9\%$



