

FORT BEND COUNTY ENGINEERING
Fort Bend County, Texas

D. Jesse Hegemier
County Engineer

April 12, 2012

Commissioner Richard Morrison
Fort Bend County Precinct 1
1517 Eugene Heimann Circle, Suite 300
Richmond, Texas 77469

**RE: Williams Way Boulevard Mobility Bond Project #747 -Traffic Control Plan
Phase 1 (formerly Ranson Road)
From: from Lamar CISD Hutchinson Elementary to Pilgrim**

Dear Commissioner:

Fort Bend County Engineering has completed and recommends approval of the traffic control plan for the above referenced mobility project. The public hearing date for acceptance of the plan is being scheduled.

A copy of the traffic control plan is attached for your review. If you should have any questions, please give me a call.

Sincerely,



Steven L. Evans
Assistant to County Engineer

SLE/mjs

cc: Judge Robert E. Hebert, County Judge
Marc Grant - FBC Road & Bridge
Marc Grant - Signage Department
File

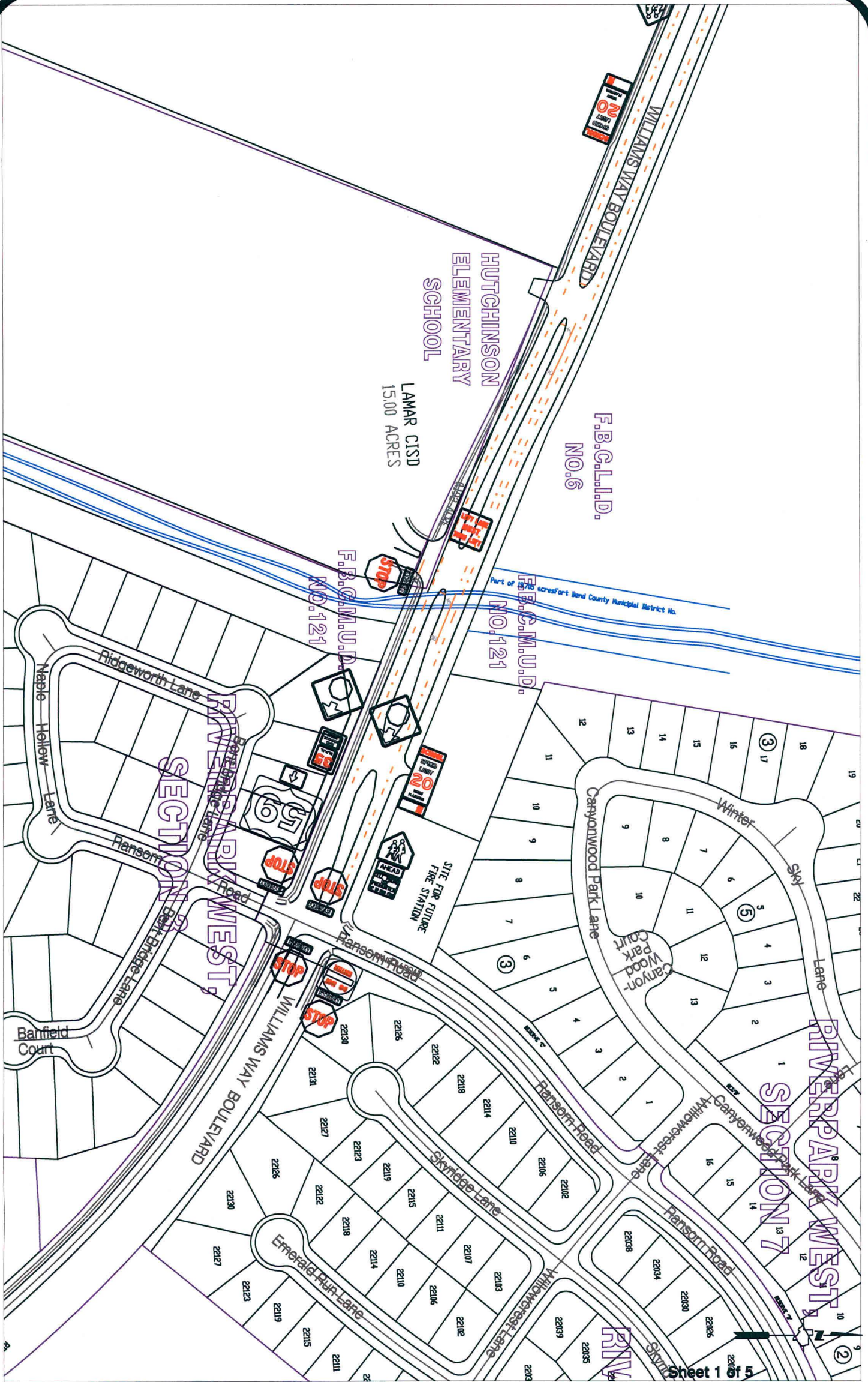

Sheet 1 of 5

Note:

The purpose of this traffic control plan is to establish traffic control for Williams Way Boulevard.

Drawn By :L. Brdecka

Date: 4-13-12

Approved By: Steven L. Evans

Date: 4-13-12

Scale

1" = 200'-0"

Williams Way Boulevard

**Control Map and
Traffic Sign Layout**

Fort Bend County Engineering Dept.
1124 Blume Road
Rosenberg, Texas 77471

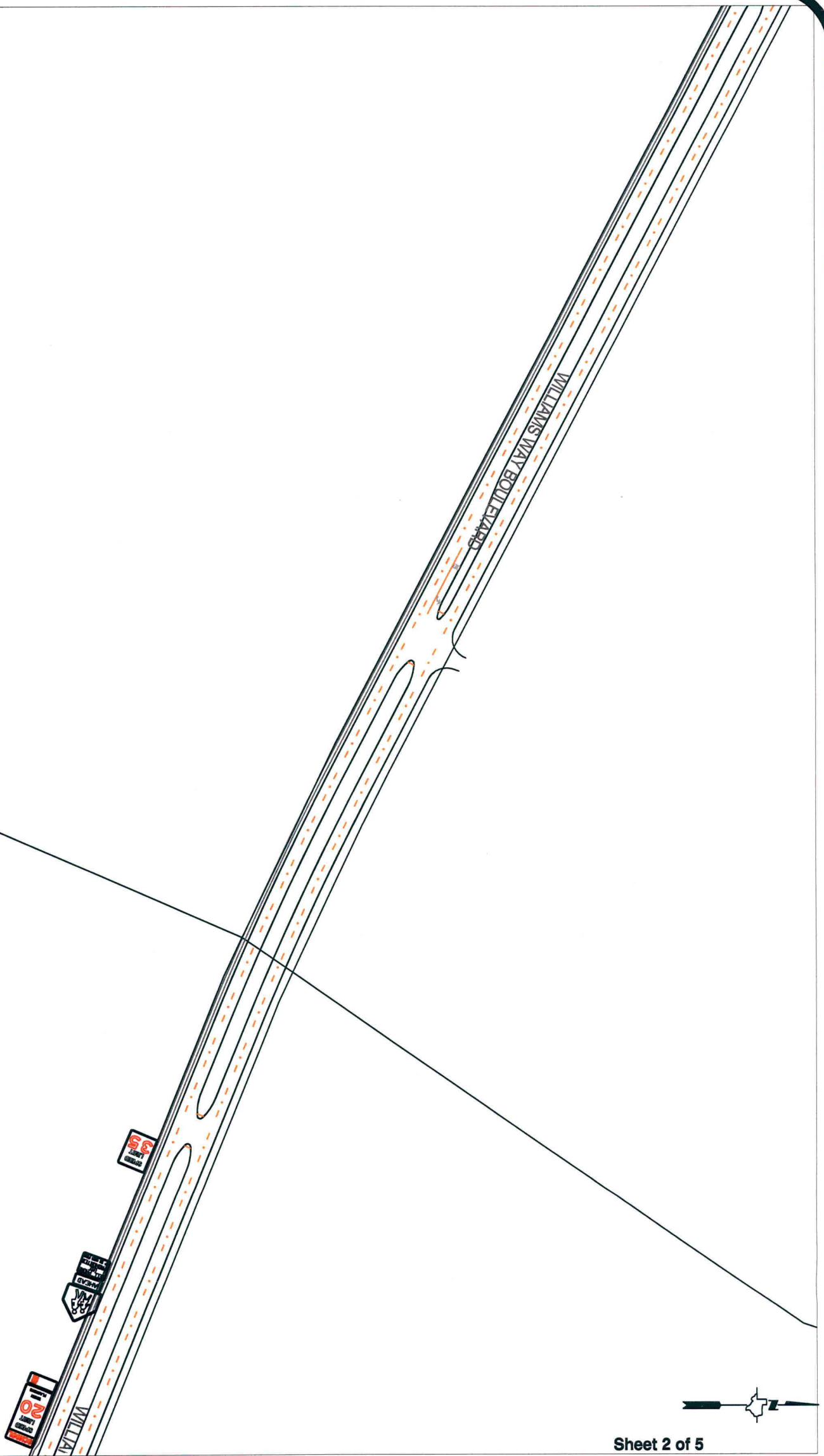

Sheet 2 of 5

Note:

The purpose of this traffic control plan is to establish traffic control for Williams Way Boulevard.

Drawn By :L. Brdecka
 Date: 4-13-12
 Approved By: Steven L. Evans
 Date: 4-13-12
 Scale
 1" = 200'-0"

**Williams Way Boulevard
 Control Map and
 Traffic Sign Layout**

Fort Bend County Engineering Dept.
 1124 Blume Road
 Rosenberg, Texas 77471

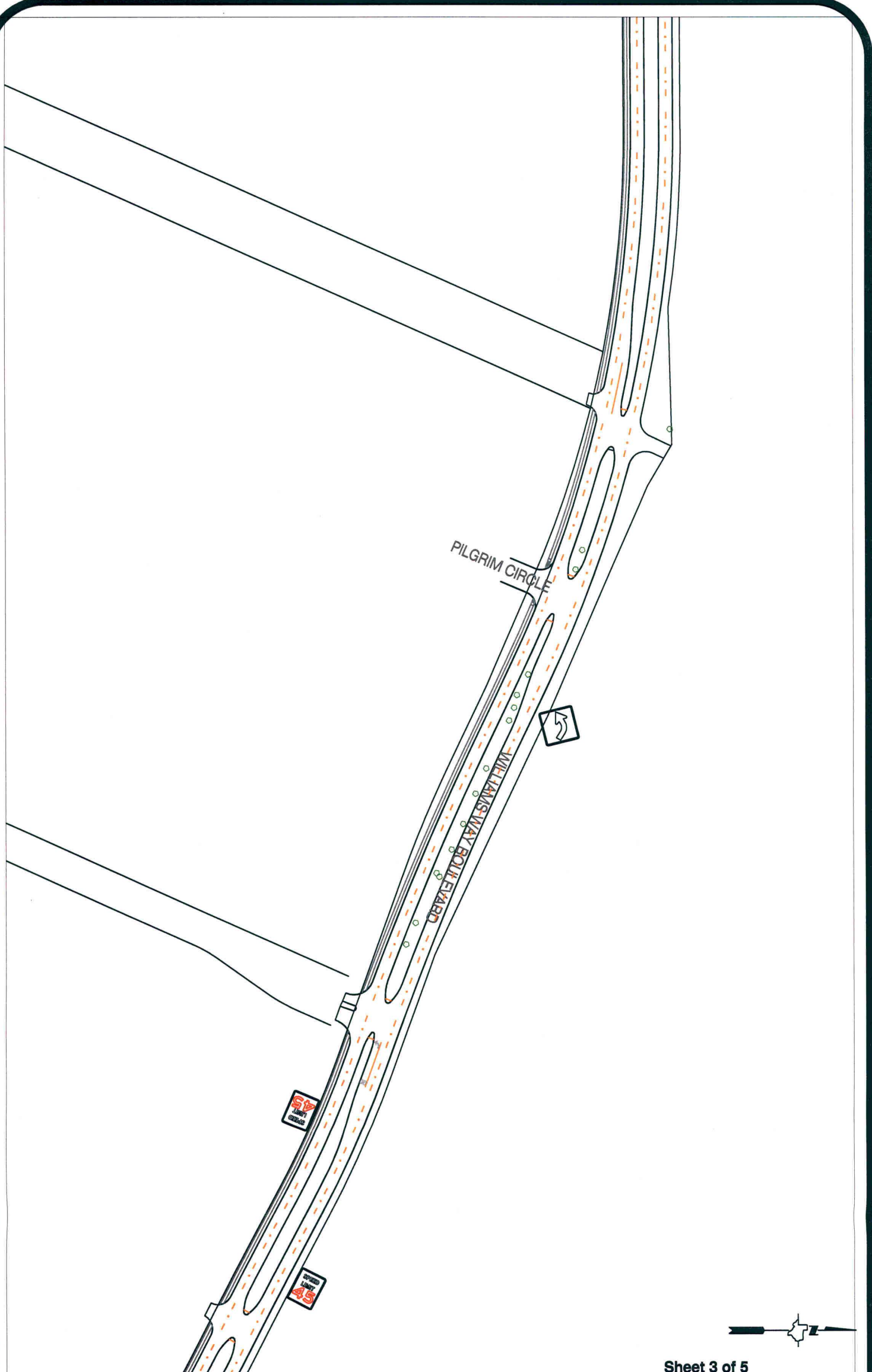

Sheet 3 of 5

Note:

The purpose of this traffic control plan is to establish traffic control for Williams Way Boulevard.

Drawn By :L. Brdecka
 Date: 4-13-12
 Approved By: Steven L. Evans
 Date: 4-13-12
 Scale

1" = 200'-0"

**Williams Way Boulevard
 Control Map and
 Traffic Sign Layout**

Fort Bend County Engineering Dept.
 1124 Blume Road
 Rosenberg, Texas 77471

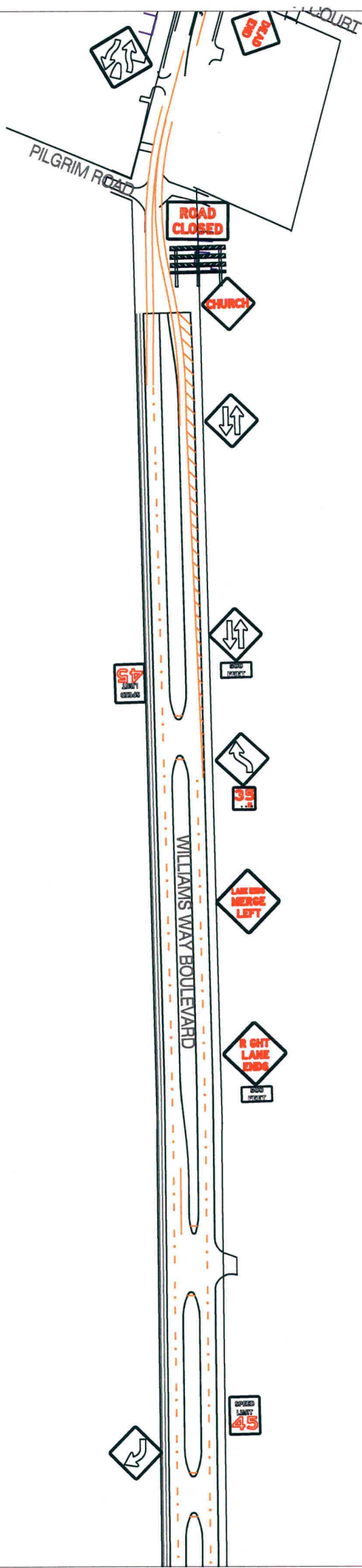

Note:

The purpose of this traffic control plan is to establish traffic control for Williams Way Boulevard.

Drawn By :L. Brdecka
 Date: 4-13-12
 Approved By: Steven L. Evans
 Date: 4-13-12
 Scale
 1" = 200'-0"

**Williams Way Boulevard
 Control Map and
 Traffic Sign Layout**

Fort Bend County Engineering Dept.
 1124 Blume Road
 Rosenberg, Texas 77471

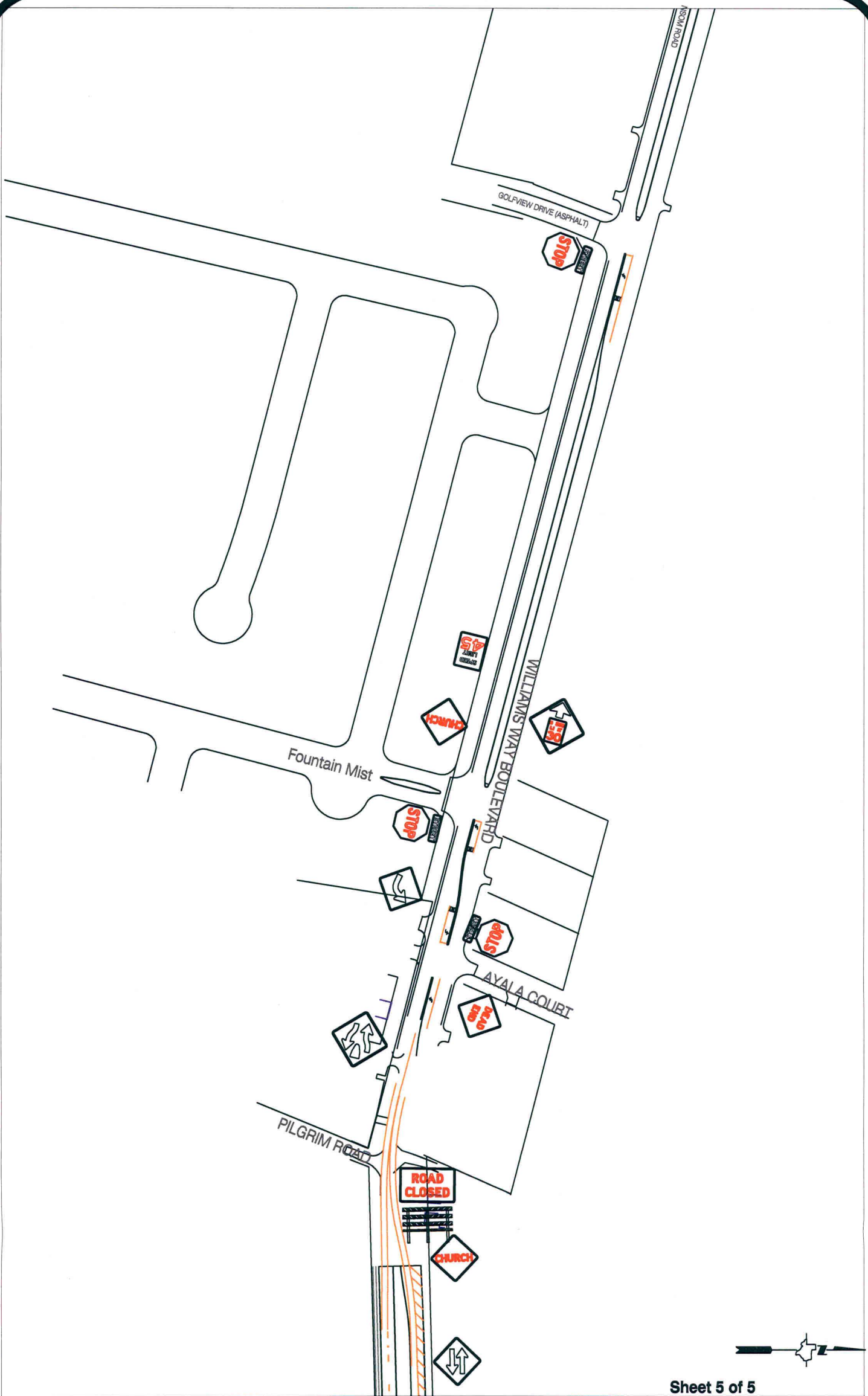

Note:

The purpose of this traffic control plan is to establish traffic control for Williams Way Boulevard.

Drawn By :L. Brdecka

Date: 4-13-12

Approved By: Steven L. Evans

Date: 4-13-12

Scale

1" = 200'-0"

**Williams Way Boulevard
Control Map and
Traffic Sign Layout**

Fort Bend County Engineering Dept.
1124 Blume Road
Rosenberg, Texas 77471