

REVIEW BY FORT BEND COUNTY COMMISSIONERS COURT

On this 01 day of MAY, 20 12, before the Fort Bend Commissioners Court came on to be heard and reviewed the accompanying notice of CENTERPOINT ENTEX

Job Location ROESNER ROAD

Dated 4/23/12 Bond No. 22-022-417, Permit No. 84132

to make use of certain Fort Bend County property subject to, "A Revised Order Regulating the Laying, Construction, Maintenance, and Repair of Buried Cables, Conduits, and Pole Lines, In, Under, Across or Along Roads, Streets, Highways, and Drainage Ditches in Fort Bend County, Texas, Under the Jurisdiction of the Commissioners Court of Fort Bend County, Texas," as passed by the Commissioners Court of Fort Bend County, Texas, date the 3rd day of August, 1987, recorded in Volume _____ of the Minutes of the Commissioners Court of Fort Bend County, Texas, to the extent that such order is not inconsistent with Article 1436a, Vernon's Texas Civil Statues. Upon Motion of Commissioner Meyers, seconded by Commissioner Prestage, duly put and carried, it is ORDERED, ADJUGED AND DECREED that said notice of said above purpose is hereby acknowledged by the Commissioners Court of Fort Bend County, Texas, and that said notice be placed on record according to the regulation order thereof.

Notes:

- 1. Evidence of review by the Commissioners Court must be kept on the job site and failure to do so constitutes grounds for job shutdown.
- 2. Written notices are required:
 - a. 48 hours in advance of construction start up, and
 - b. When construction is completed and ready for final inspection

Mail notices to: Permit Administrator
Fort Bend County Engineering
P.O. Box 1449
Rosenberg, Texas 77471
281-633-7500

- 3. This permit expires one (1) year from date of permit if construction has not commenced.

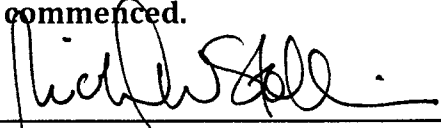
By 
County Engineer

By _____
Drainage District Engineer/Manager

Presented to Commissioners Court and approved.
Recorded in Volume 5-12
Minutes of Commissioners Court.

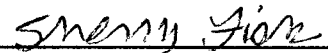
Clerk of Commissioners Court
By 
Deputy

COUNTY OF FORT BEND

Engineering Department

P.O. BOX 1449
Rosenberg, Texas 77471-1449

Johnny Ortega
Permit Administrator

1124 Blume Road
Phone: (281) 341-7500

PERMIT APPLICATION REVIEW FORM FOR CABLE, CONDUIT, AND POLE LINE ACTIVITY IN FORT BEND COUNTY

PERMIT NO. 084132

The following "Notice of Proposed Cable, Conduit, and/or Pole Line activity in Fort Bend County" and accompanying attachments have been reviewed and the notice conforms to appropriate regulations set by Commissioner's Court of Fort Bend County, Texas.

- (1) Complete Application Form.
- a. Name of road, street, and/or drainage ditch affected.
 - b. Vicinity map showing course of direction.
 - c. Plans and specifications.

- (2) Bond:
- _____ District Attorney, approval when applicable.
- Perpetual bond currently posted.
No. 22-022-417
Amount \$50,000.00
- _____ Performance bond submitted.
No. _____
Amount _____
- _____ Cashier's Check.
No. _____
Amount _____

- _____ (3) Verbal permission given for emergencies, to start construction before approved in Commissioner's Court.

_____ Precinct Engineer Acknowledgment _____ Date _____

_____ Precinct Commissioner Acknowledgment _____ Date _____

- _____ (4) _____
Drainage District Approval when applicable

We have reviewed this project and agree it meets minimum requirements.

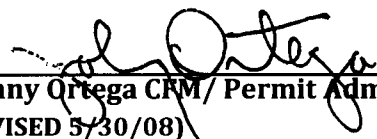

Johnny Ortega CFM/ Permit Administrator
(REVISED 5/30/08)

04/23/2012
Date

NOTICE OF PROPOSED CABLE, CONDUIT AND / OR POLE LINE ACTIVITY
IN, UNDER, ACROSS OR ALONG ROADS, STREETS, HIGHWAYS AND DRAINAGE DITCHES
IN FORT BEND COUNTY

APPLICANT'S JOB NO. WO #61435167
 PERMIT NO. 84132 PCT. NO. 3
 BOND NO. 22-082-417

Formal notice is hereby given that CENTERPOINT ENTEX proposes to lay, construct, maintain and / or repair cable, conduit, and / or pole line, in, under, across, or along roads, streets, highways and drainage ditches in Fort Bend County, as follows:

In, Under, or Across Roads, and / or Drainage Ditches

Road or Ditch Name	Distance & Direction From Nearest Intersection	Length of Crossing	Type of Construction			
			Bored:	Jacked:	Driven:	Cased
ROESNER Blk 2600	160' +/- EE Saddlehorn Trl	2'	yes			

Along Roads and / or Drainage Ditches

Road or Ditch Name	Distance & Direction From Nearest intersection	To	Distance

General Description

A 6" IP plastic natural gas main along Del Webb Blvd between River Fern Dr and Cone Flower Dr as shown on attached drawing.

The location and description of the proposed installation and appurtenances is more fully shown on the attached detail drawings. The laying, construction, maintenance and / or repair of the proposed installation shall be subject to "A Revised Order Regulating the Laying, Construction, Maintenance and / or Repair of Cables, Conduits, and / or Pole Lines, In, Under, Across, or Along Roads, Streets, Highways and Drainage Ditches in Fort Bend County, Texas, Under the Jurisdiction of the Commissioners Court of Fort Bend County, Texas," as passed by Commissioners Court of Fort Bend County, Texas, dated the 3rd. day of August, 1987, recorded in Volume 639 of the Minutes of the Commissioners Court of Fort Bend County, Texas.

To serve: 2635 SADDLEHORN TRL (RESIDENTIAL CUSTOMER)

Written notices are required: 1) 48 hours in advance of start of construction and 2) when construction is complete and ready for final inspection.

Mail To: Permit Administrator / Fort Bend County Engineering
 P. O. Box 1449, Rosenberg, Texas 77471

Violation of requirements shall constitute grounds for job shut down.

COMPANY NAME: CenterPoint Entex
 AGENT and / or OWNER
Ravinder Duggal
 (Signature)

NAME & TITLE: RAVINDER DUGGAL
Advanced Engineering Coordinator
 (Please Print)

DATE: April 10, 2012

ADDRESS: 1111 Louisiana - Ste. 1265 D
 (Street / P.O. Box)
Houston Texas 77002
 City State Zip

TELEPHONE NO: (713) 207-4621
 (Accessible 24 hrs/day, 7 days/week)

FORT BEND COUNTY PERMIT

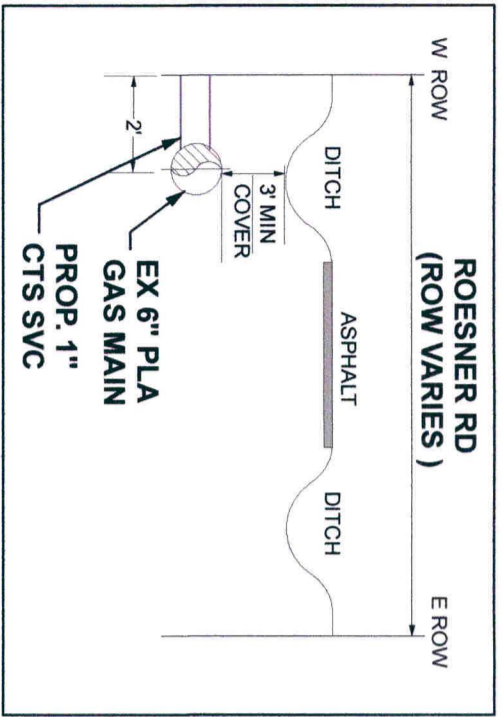

**FOR QUESTIONS CALL CENTERPOINT
GSC ELDON ELLISTON AT 713-962-2945**

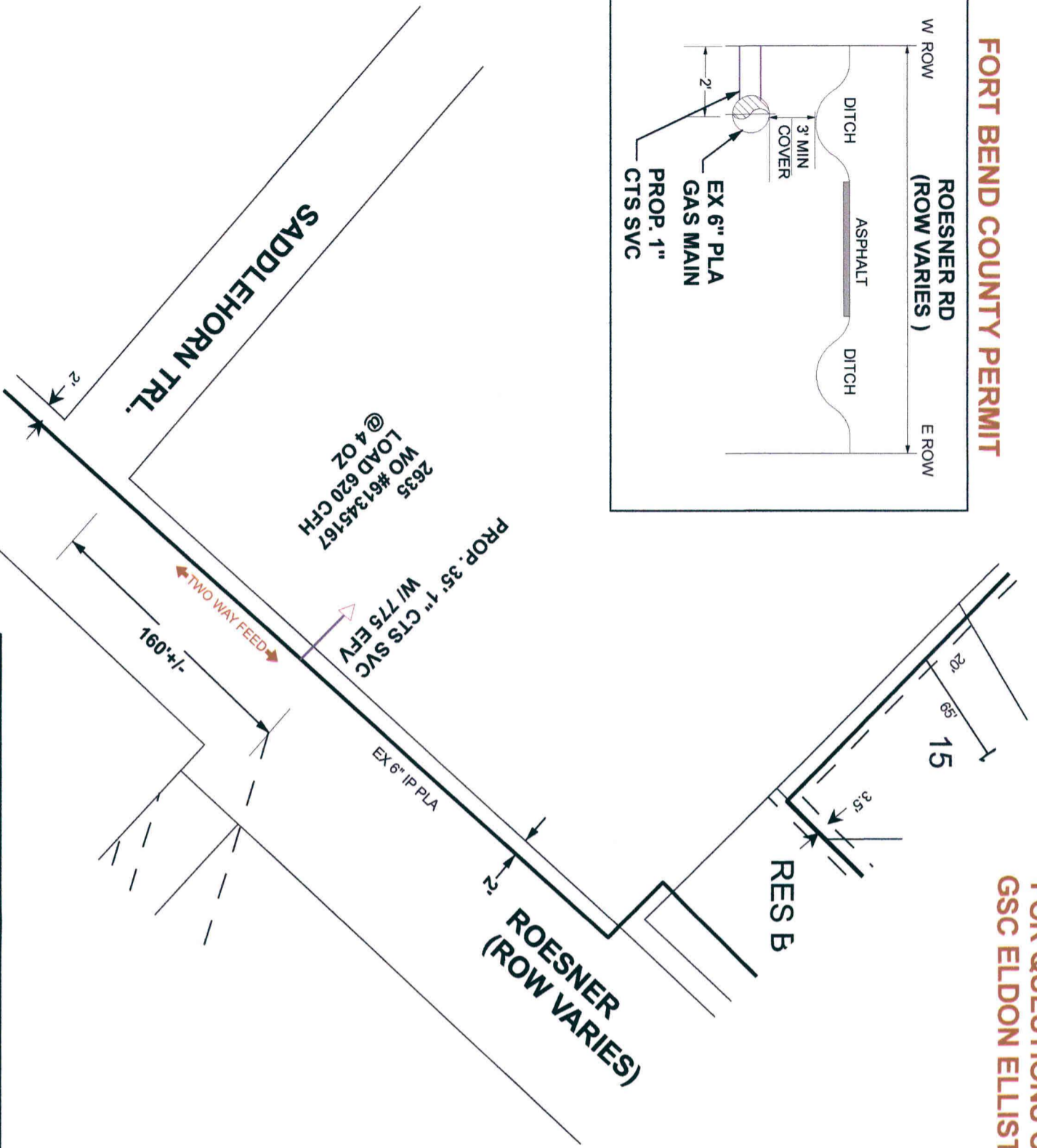

LOT NUMBER CHART

Material Number	Section	Main	Footage	Pipe Cat.	Lot Number	Fusion Method				
						EF	BF	SF	SDL	MECH
	A									
	B									
	C									
	D									
	E									
	F									
	G									
	ALL									

CenterPoint Energy
 PROPRIETARY AND CONFIDENTIAL
 TEXAS REGION - HOUSTON

W
N
E
S

PROJECT W# 61435167

FACET F30150714
 F30150712

OP MAP O30120712

KM 485J

LAMBERT 4357D3

TC 050

SZ 503

SOG 00151

LEGEND:
 EXIST. MAIN _____
 PROP. 1" CTS SVC 35'
 WO#61435167

GENERAL NOTES:

1- CRITERIA TO BE USED FOR TRACER WIRE SELECTION WHEN INSTALLING PLASTIC GAS LINES:
 A- USE #14 TRACER WIRE FOR ALL RESIDENTIAL SERVICE LINES.
 B- USE #14 TRACER WIRE FOR SHORT BORES UP TO 300' AND ALL OTHER NON-BORE INSTALLATIONS.
 C- USE #10 TRACER WIRE WITH ALL BORES LONGER THAN 300'.
 D- USE #8 TRACER WIRE AS NEEDED FOR LARGE BAYOU CROSSINGS AND OTHER EXTRAORDINARY SITUATIONS AND COMPLEX BORES. INSPECTOR APPROVAL REQUIRED PRIOR TO WORK.
 2- TEST PRESSURE 100 PSIG

2635 Saddlehorn Trl.

PURPOSE:
 TO SERVE 1 RES. CUSTOMER IN KATY, FT BEND COUNTY, TX.

DESIGNER: Ravinder Duggal
PHONE#: 713-207-4621
DRAWN BY: Rudy Diethel
DESIGN DATE: 3/30/2012

ESTIMATED COST:
CONTRIBUTION:
DATE NEEDED:
RECOMMENDED BY: RAVINDER DUGGAL
DATE: 4/10/2012
APPROVED BY:
DATE:

SCALE: 1" = 100'
SHEET: 1 OF 1