



**ALLGOOD CONSTRUCTION COMPANY, INC.**

UTILITY & PAVING CONTRACTOR

2647 JOANN STREET STAFFORD, TX 77477

(281) 499-9621 TELEPHONE \* (281) 261-5565 FAX

July 19, 2011

JUL 19 2011

Mr. Andy Meyers  
Fort Bend County, Precinct 3  
22333 Grand Corner Drive, Suite 105  
Katy, Texas 77494

RE: Greenbusch Road Improvements Phase Two  
Mobility Improvement Project No. 732  
Road Closure Request- Coffe Bend Drive and Shadow Forest Drive  
**REVISED DATES**

Commissioner Meyers:

Please accept this letter as our request for a road closure on the referenced project. These closures will affect Coffee Bend Drive east of Westheimer Parkway and Shadow Forest Drive east of Greenbusch Road. The closures are needed to facilitate the completion of these intersections. We are requesting the closure from July 27 – August 9, 2011.

All required detour signage and advance warning signs will be in place a week prior to closure. I can be reached at my office or by cell (281-808-5882) should you have any questions or require additional information. Thanks for your assistance on this matter.

Sincerely,

**ALLGOOD CONSTRUCTION COMPANY, INC.**



Roy Rodriguez  
Vice President

cc: Mr. Nathan Hatcher, Fort Bend County Engineering

**LEGEND**

- TEMPORARY DETOUR PAVEMENT (2" H.M.H.L. SURFACE WITH 8" BLACKBASE OVER COMPACTED SUBGRADE)
- CONSTRUCTION AREA
- CONSTRUCTION IN PREVIOUS PHASE
- DIRECTION OF TRAFFIC FLOW
- SIGN ON POST
- DRUMS WITH CHEVRONS (UNLESS OTHERWISE NOTED)
- DRUMS WITH VERTICAL PANELS (UNLESS OTHERWISE NOTED)
- LOW PROFILE CONCRETE BARRIER (LPCB)
- TYPE III BARRICADE WITH TWO TYPE A WARNING LIGHTS
- 4" CONSTRUCTION PAV. MKK. (WHITE SOLID) (REMOVABLE)
- 4" CONSTRUCTION PAV. MKK. (YELLOW SOLID) (REMOVABLE)
- 4" CONSTRUCTION PAV. MKK. (WHITE SOLID) (NON-REMOVABLE)
- 4" CONSTRUCTION PAV. MKK. (YELLOW SOLID) (NON-REMOVABLE)
- 4" CONSTRUCTION PAV. MKK. (WHITE DOT) (REMOVABLE)
- 4" CONSTRUCTION PAV. MKK. (YELLOW DOT) (REMOVABLE)
- CONSTRUCTION PAV. MKK. (YELLOW BROWN) (NON-REMOVABLE)
- 4" CONSTRUCTION PAV. MKK. (YELLOW BROWN) (REMOVABLE)
- 24" CONSTRUCTION PAV. MKK. (WHITE SOLID) (REMOVABLE)
- CONSTRUCTION PAV. MKK. (ARROW) (REMOVABLE)
- CONSTRUCTION PAV. MKK. (WORD) (REMOVABLE)

A	B	C	D	E	F	G	H	J	K	L
---	---	---	---	---	---	---	---	---	---	---

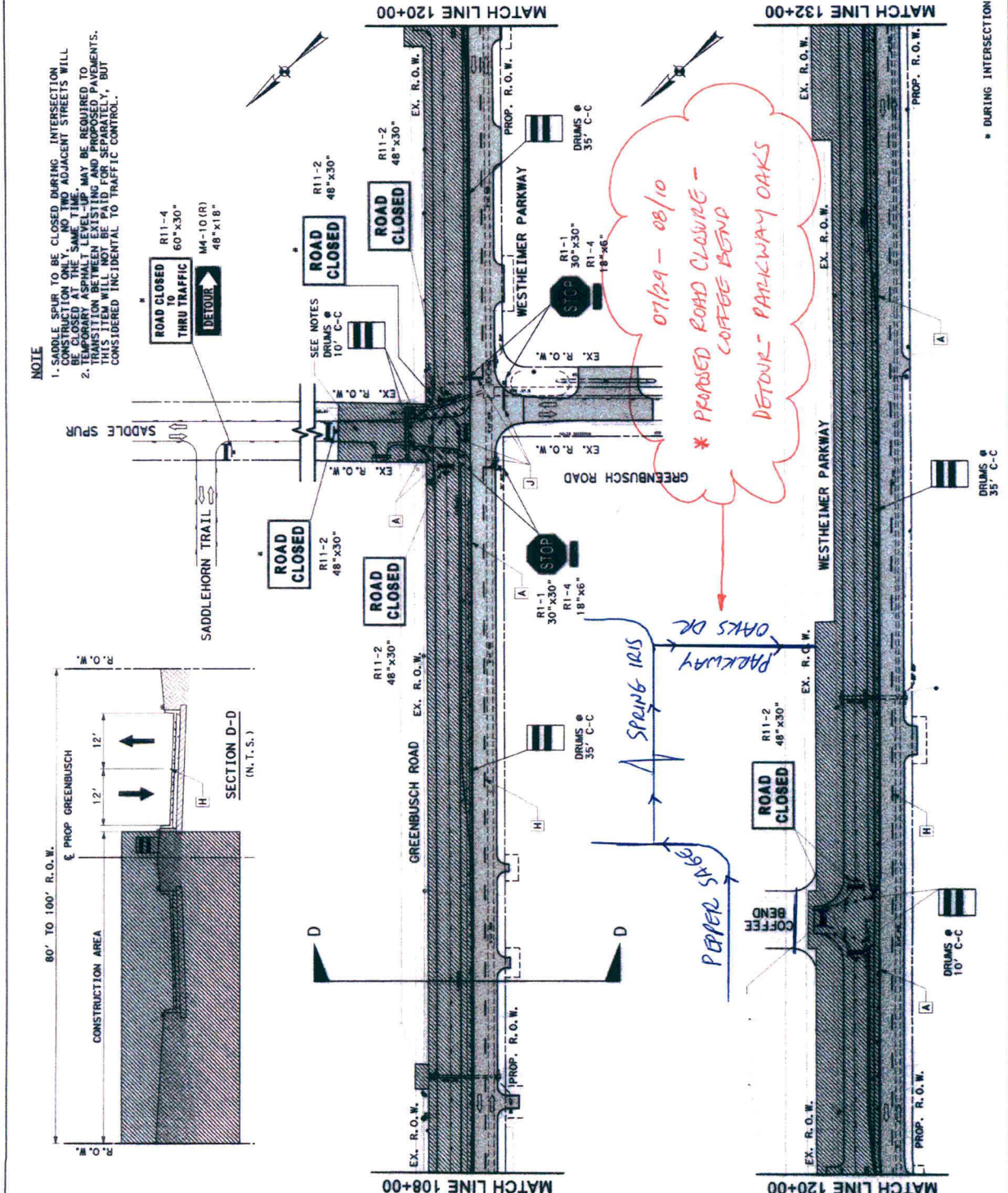

**NOTE**

- SADDLE SPUR TO BE CLOSED DURING INTERSECTION CONSTRUCTION ONLY. NO TWO ADJACENT STREETS WILL BE CLOSED AT THE SAME TIME. MAY BE REQUIRED TO TEMPORARILY SPHALT LEVELING AND REPOSED PAVEMENTS. THIS ITEM WILL NOT BE PAID FOR SEPARATELY, BUT CONSIDERED INCIDENTAL TO TRAFFIC CONTROL.

**SECTION D-D (IN T.S.)**

**TEDES** INFRASTRUCTURE GROUP  
 14320 Industrial Parkway, Suite 100  
 Houston, Texas 77040  
 Phone: 281.462.3262  
 Fax: 281.462.3263  
 www.tedes.com

**CobbFendley**  
 77462-3262  
 GREENBUSCH ROAD TO MILLS ROAD AT FALCON LANDING BLVD.  
 TRAFFIC CONTROL PLAN  
 PROJECT: STA 108+00 TO STA 132+00  
 DRAWN BY: JAC  
 CHECKED BY: JAC  
 DATE: 08/20/10  
 SHEET NO. OF 160 SHEETS  
 BARRIERY  
 SHEET # OF 160 SHEETS

\* DURING INTERSECTION CONSTRUCTION ONLY

**LEGEND**

- TEMPORARY DETOUR PAVEMENT (12" H. H. H. L. SURFACE WITH 8" BLACKBASE OVER COMPACTED SUBGRADE)
- CONSTRUCTION AREA
- CONSTRUCTION IN PREVIOUS PHASE
- DIRECTION OF TRAFFIC FLOW
- SIGN ON POST
- DRUMS WITH CHEVRONS (UNLESS OTHERWISE NOTED)
- DRUMS WITH VERTICAL PANELS (UNLESS OTHERWISE NOTED)
- LOW PROFILE CONCRETE BARRIER (LPCB)
- TYPE III BARRICADE WITH TWO TYPE A WARNING LIGHTS
- 4" CONSTRUCTION PAV. MKK. (WHITE SOLID) (REMOVABLE)
- 4" CONSTRUCTION PAV. MKK. (YELLOW SOLID) (REMOVABLE)
- 4" CONSTRUCTION PAV. MKK. (WHITE SOLID) (NON-REMOVABLE)
- 4" CONSTRUCTION PAV. MKK. (YELLOW SOLID) (NON-REMOVABLE)
- 4" CONSTRUCTION PAV. MKK. (WHITE DOT) (REMOVABLE)
- 4" CONSTRUCTION PAV. MKK. (YELLOW DOT) (REMOVABLE)
- 4" CONSTRUCTION PAV. MKK. (YELLOW BROKEN) (NON-REMOVABLE)
- 4" CONSTRUCTION PAV. MKK. (YELLOW BROKEN) (REMOVABLE)
- 24" CONSTRUCTION PAV. MKK. (WHITE SOLID) (REMOVABLE)
- CONSTRUCTION PAV. MKK. (ARROW) (REMOVABLE)
- CONSTRUCTION PAV. MKK. (WORD) (REMOVABLE)

**NOTE**

1. SHADOW FOREST DRIVE WILL BE CLOSED DURING INTERSECTION CONSTRUCTION ONLY. NO TWO ADJACENT STREETS WILL BE CLOSED AT THE SAME TIME.
2. TEMPORARY ASPHALT LEVEL-UP MAY BE REQUIRED TO MAINTAIN PROPER DRAINAGE AND TO BE PAID FOR SEPARATELY, BUT THIS ITEM WILL NOT BE PAID FOR SEPARATELY, BUT CONSIDERED INCIDENTAL TO TRAFFIC CONTROL.

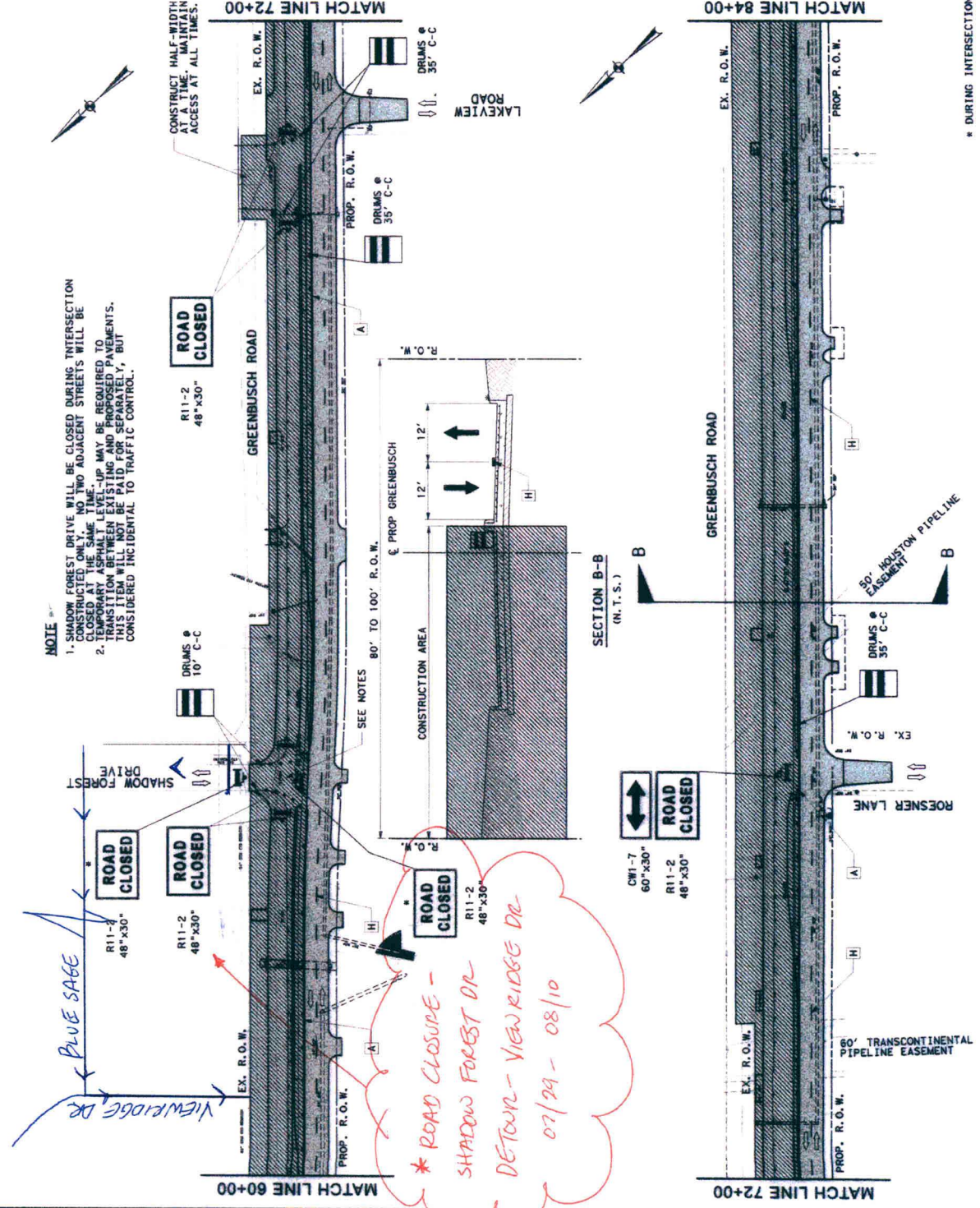

*\* ROAD CLOSURE - SHADOW FOREST DR DE-TOUR - VIEWRIDGE DR 07/29 - 08/10*

DATE	NO.	BY

TEXAS DEPARTMENT OF TRANSPORTATION  
CONSTRUCTION DIVISION

**CobbHendley**  
CONSULTING ENGINEERS  
15000 Rockledge Parkway, Suite 1100  
Houston, Texas 77058  
713.462.5242 | Fax 713.462.2801 | www.cobbhendley.com

**GREENBUSCH ROAD  
MILLS MANOR DRIVE TO  
FALCON LANDING BLVD.**

TRAFFIC CONTROL PLAN

STA. 60+00 TO STA. 84+00

DATE: 07/29/10  
DRAWN BY: J. JOHNSON  
CHECKED BY: J. JOHNSON  
PROJECT NO.: 04020001  
SHEET NO. OF 02 SHEETS

\* DURING INTERSECTION CONSTRUCTION ONLY