

**FORT BEND COUNTY ENGINEERING**

Fort Bend County, Texas

D. Jesse Hegemier  
County Engineer

October 29, 2010

Commissioner Grady Prestage  
Fort Bend County Precinct 2  
3030 Texas Parkway, Suite 213  
Missouri City, Texas 77459

**RE: Summer Park Subdivision - Traffic Control Plan**

**Take all appropriate action on Petition from the Summer Park Apartment Community requesting that Fort Bend County place signs at the locations reflected on the traffic control plan prohibiting overnight parking of commercial motor vehicles pursuant to Texas Transportation Code Ann. §545.307**

Dear Commissioner:

The Fort Bend County Engineering Department has completed a traffic control plan for the Summer Park Apartment Community to prohibit overnight truck parking of commercial motor vehicles within the subdivision. A petition has valid signatures of 26% of the residents within the subdivision. This meets the 25% required. Fort Bend Engineering has no objection to placing "Overnight Parking of Commercial Motor Vehicles is Prohibited" signs at the locations indicated on the attached traffic control plan, pursuant to Texas Transportation Code Ann. §545.307. The petition is dated October 28, 2010 and is on file in the Engineering Office.

The Engineering Department recommends acceptance of the traffic control plan as submitted. The public hearing date for acceptance of the plan is being scheduled. A copy of the traffic control plan is attached for your review. If you should have any questions, please give me a call.

Sincerely,



DeWayne O. Davis, P.E.  
Engineer III

DOD/mjs

cc: Judge Robert E. Hebert, County Judge  
Marc Grant - FBC Road & Bridge  
Marc Grant - Signage Department  
File

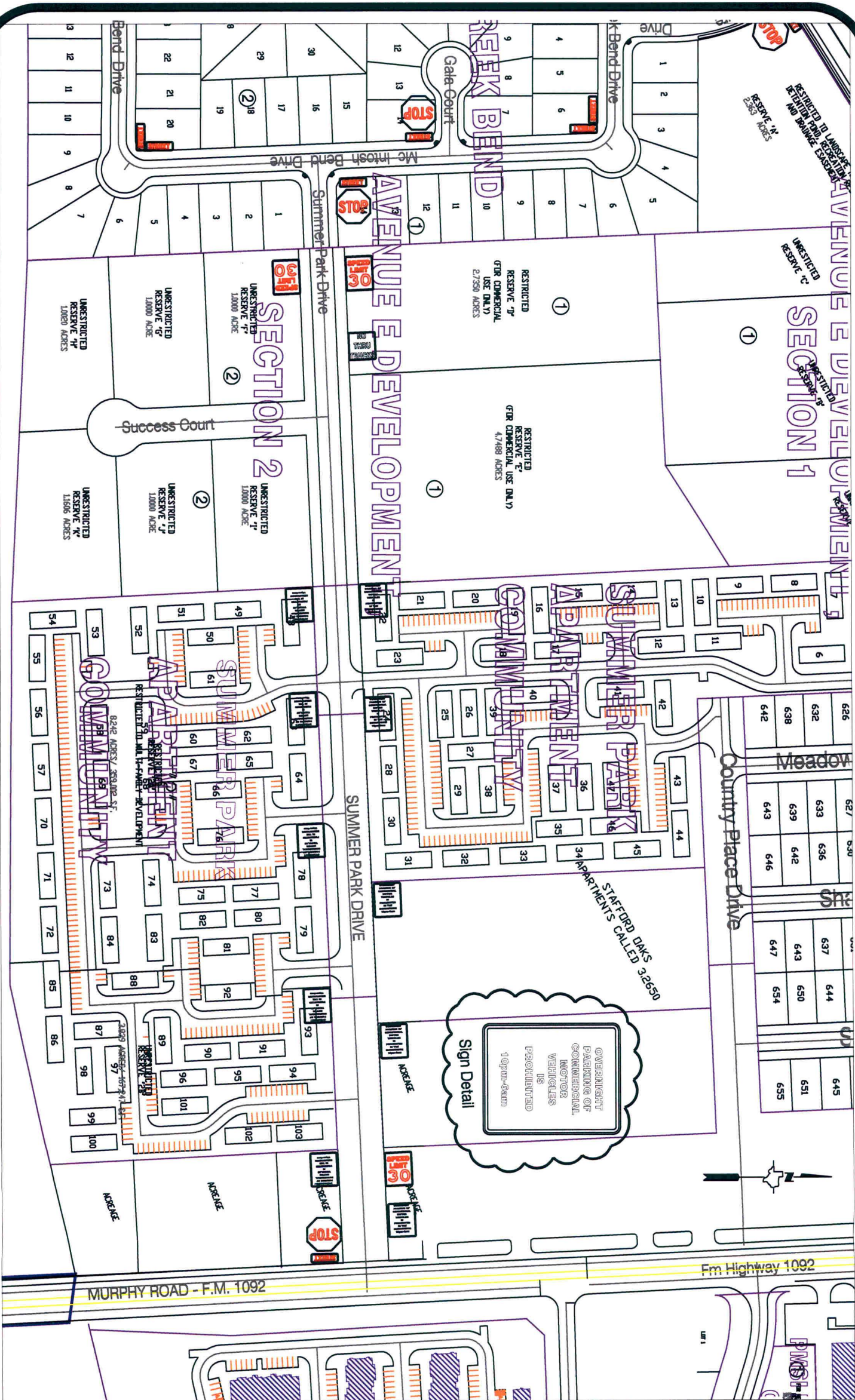

**Note:**

The purpose of this traffic control plan is to revise traffic control for Summer Park Drive with the addition of "No Overnight Parking Of Commercial Vehicles" signs as indicated.

Drawn By: L. Brdecka

Date: 9-30-10

Approved By: DeWayne Davis, P.E.

Date: 9-30-10

Scale

1" = 200'-0"

**Summer Park Drive  
Control Map and  
Traffic Sign Layout**

Fort Bend County Engineering Dept.  
1124 Blume Road  
Rosenberg, Texas 77471