

5B

FORT BEND COUNTY ENGINEERING

Fort Bend County, Texas

D. Jesse Hegemier
County Engineer

February 2, 2010

Commissioner Richard Morrison
Fort Bend County Precinct 1
1517 Eugene Heimann Circle, Suite 300
Richmond, Texas 77469

**RE: Revised Traffic Control Plan for Lamar CISD (Dickinson Elementary) in
Greatwood Glen, Section 2 to Establish "No Parking" Signs**

Dear Commissioner Morrison:

Lamar CISD has request a revision to the school zone traffic control at Lamar CISD (Dickinson Elementary) and recommend that "No Parking" signs be established. A revised traffic control plan is attached and a request for a public hearing is being scheduled.

If you should have any questions regarding this matter, please call me at 281-633-7537.

Sincerely,

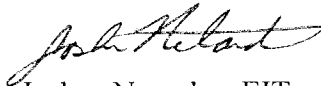

Joshua Netardus, EIT
Engineer I

JN/mjs

cc: Judge Robert E. Hebert, County Judge
Marc Grant - FBC Road & Bridge
Marc Grant - Signage Department
File

**Lamar CISD***A Proud Tradition • A Bright Future**RM / 1/13/10***J. Kevin McKeever**
Administrator for
Operations

January, 11 2010

The Honorable Richard Morrison
Fort Bend County Precinct 1
301 Jackson
Richmond, TX 77469

Tel: 832.223.0250
Fax: 832.223.0111
mckeever@lcisd.org
3911 Avenue I
Rosenberg, Texas 77471
www.lcisd.org

Re: Signing improvements for Lamar Consolidated ISD Dickinson Elementary

Dear Commissioner Morrison:

I have received complaints from Dickinson Elementary regarding inadequate sight distance for parents exiting the student drop-off/pick-up driveway because of parents parking on Greatwood Parkway between Sansbury Boulevard and the student drop-off/pick-up driveway. I asked Traffic Engineers, Inc. to observe arrival and dismissal and recommend improvements. The recommendations, which address additional issues observed by Traffic Engineers, Inc., are shown on the attached aerial and include:

1. Installation of "No Parking" signs on southbound Greatwood Parkway, between Sansbury Blvd. and the school driveway because of sight distance issues for parents exiting the school driveway caused by parents parked on Greatwood Parkway to walk their student to and from the school building. Installation of "No Parking" signs on southbound Greatwood Parkway, south of the school driveway. The inside southbound lane of Greatwood Parkway, south of the school driveway, was blocked at times because of vehicles u-turning at the median opening located south of the school driveway at the same time that vehicles were parked in the outside lane on Greatwood Parkway while the parents walked their student to or from the school building.
2. Installation of "No Parking" signs on northbound Greatwood Parkway, between Sansbury Blvd. and the median opening south of the school driveway because a few parents were observed parking on northbound Greatwood Parkway and walking their student to or from the school building.
3. Installation of "No Parking" signs on eastbound Sansbury Blvd. between Greatwood Parkway and the school driveway because a few parents were observed parking on eastbound Sansbury Blvd. and walking their student to or from the school building.
4. Installation of "No Parking" signs on westbound Sansbury Blvd. between Greatwood Parkway and Tara Plantation Drive because a few parents were observed parking on westbound Sansbury Blvd. and walking their student to or from the school building.
5. Installation of a "No U-Turn" sign on southbound Tara Plantation Drive at the median opening at Tara Boulevard and the school driveway. Parents were observed waiting in the median opening to U-turn and get in the queue of parent vehicles on northbound Tara Plantation Drive. They waited in the median opening until the queue was north of the school driveway. There is currently a "No U-Turn" sign on westbound Sansbury Blvd. at the Tara Plantation Drive median opening to prevent parents from U-turning to access the school driveway.

JAN 13 2010

I would like to request that Fort Bend County install the signs recommended by Traffic Engineers, Inc. as shown on the attached figure.

Sincerely,

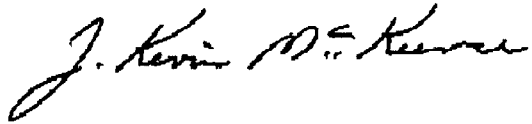
A handwritten signature in black ink, reading "J. Kevin D. Keener". The signature is written in a cursive style with a large initial "J" and a stylized "K".



1



2



3

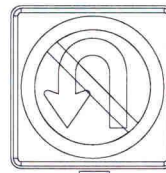

4



0 100 200
scale feet



TRAFFIC ENGINEERS, INC.

THE TEAM YOU CAN DEPEND ON

8323 Southwest Freeway, Suite 200, Houston, TX 77074
TEL (713) 270-8145/FAX (713) 270-8148

PROPOSED SIGNING
DICKINSON ELEMENTARY SCHOOL
FORT BEND COUNTY, TEXAS

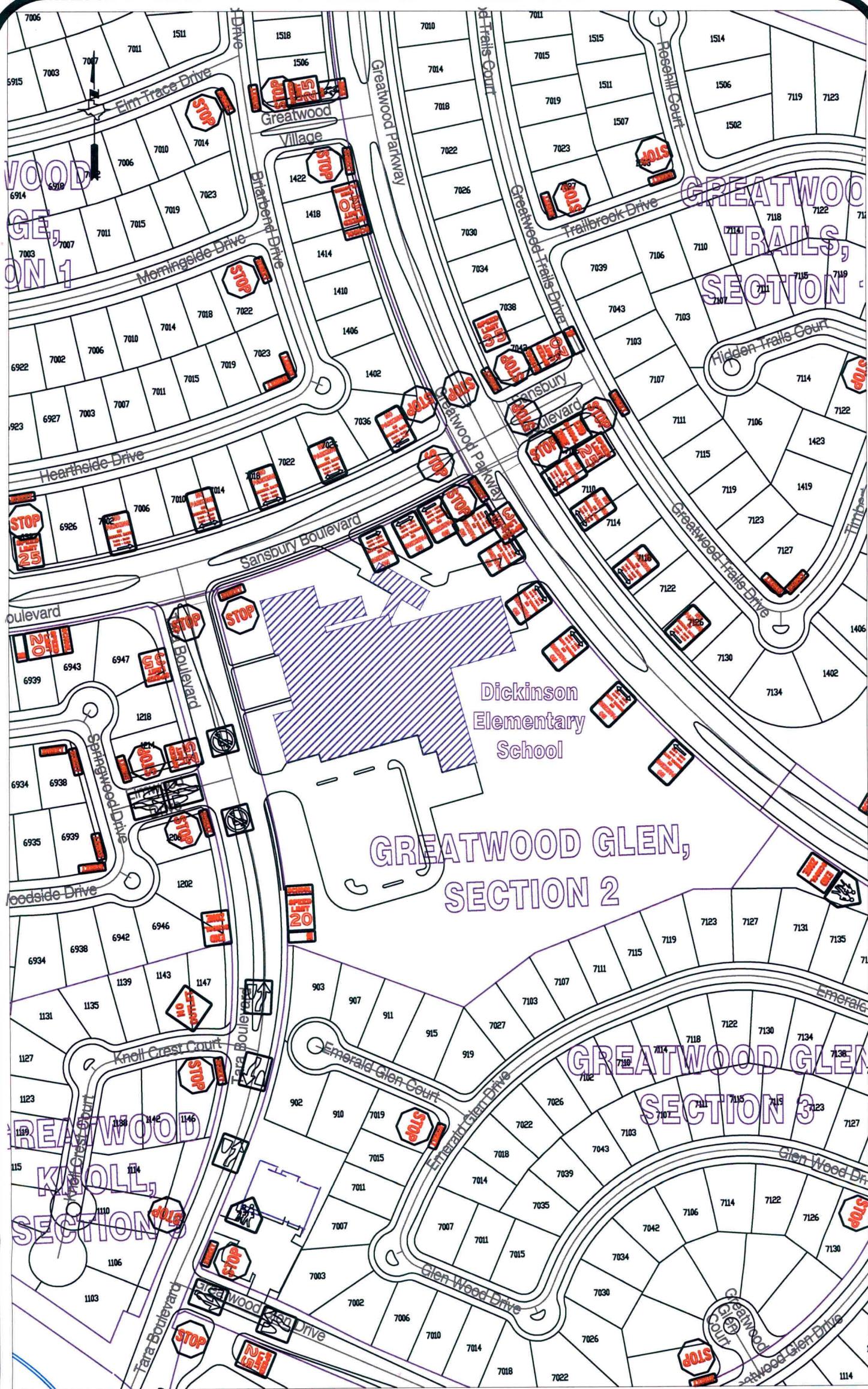

Note:

The purpose of this traffic control plan is to revise traffic control for Dickinson Elementary School (Greatwood Glen, Section 2) with the addition of "No Parking" signs.

Drawn By: L. Brdecka

Date: 2-2-10

Approved By: Josh Netardus

Date: 2-2-10

Scale

1" = 200'-0"

**Dickinson Elementary School
(Greatwood Glen, Section 2)
Control Map and Traffic Sign
Layout**

Fort Bend County Engineering Dept.
1124 Blume Road
Rosenberg, Texas 77471