

5B



FORT BEND COUNTY ENGINEERING

Fort Bend County, Texas

D. Jesse Hegemier
County Engineer

August 26, 2009

Commissioner W. A. "Andy" Meyers
Fort Bend County Precinct 3
1809 Eldridge Road
Sugar Land, Texas 77478

RE: Traffic/Safety Study for Fry Road to Establish "No U Turn" at the Intersection of Fry Road & Center Village Drive

Dear Commissioner Meyers:

Fort Bend County Engineering Department has conducted a traffic/safety study at the above referenced intersection regarding U Turn movements in the intersection resulting in congestion of the intersection impeding flow through traffic. It has been determined that "No U Turn" signs need to be installed on Fry Road to help prevent potential accidents within the intersection. Part of the problem is a result of the drop off and pick up of students at the Roosevelt Elementary school located at the intersection of Fry Road & Peek Road just to the east of Center Village Drive. A traffic control plan is attached and a request for a public hearing has been scheduled.

If you should have any questions regarding this matter, please call me at 281-633-7514.

Sincerely,

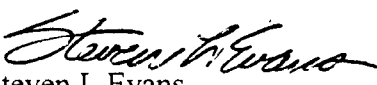
Steven L Evans
Assistant to County Engineer

SLE/mjs

cc: Judge Robert E. Hebert, County Judge
Marc Grant - FBC Road & Bridge
Marc Grant - Signage Department
File

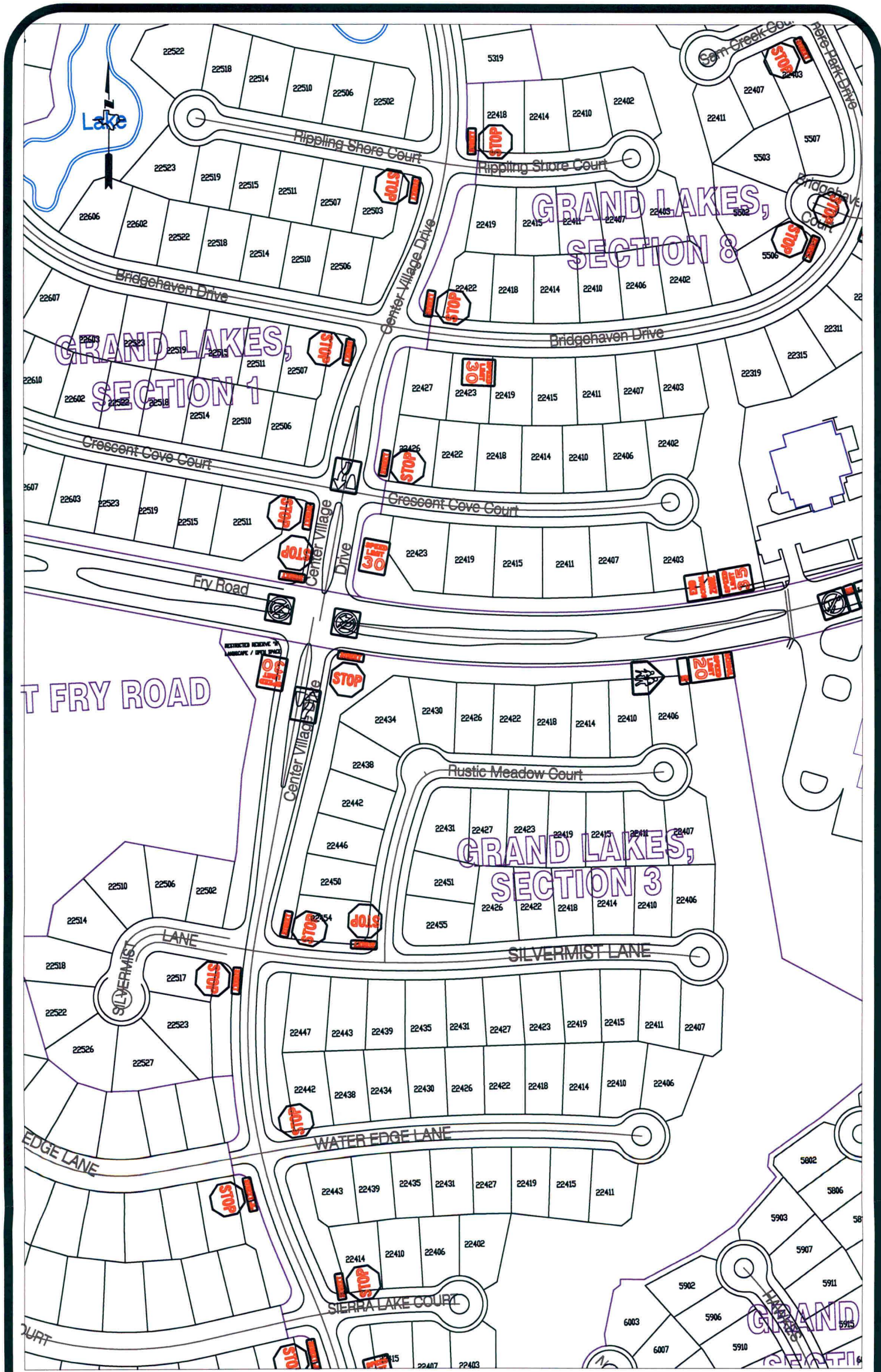

Note:

The purpose of this traffic control plan is to revise traffic control for the intersection of Fry Road and Center Village Drive with the addition of "No U Turn" signs.

Drawn By: L. Brdecka

Date: 8-26-09

Approved By: Steven L. Evans

Date: 8-26-09

Scale

1" = 200'-0"

**Fry Road at Center Village Drive
Control Map and
Traffic Sign Layout**

Fort Bend County Engineering Dept.
1124 Blume Road
Rosenberg, Texas 77471