



**PERMIT APPLICATION REVIEW FORM FOR
CABLE, CONDUIT, AND POLE LINE ACTIVITY
IN FORT BEND COUNTY**

**Fort Bend County
Engineering Department**
301 Jackson Suite 401
Richmond, Texas 77469
281.633.7500
Permits@fortbendcountytexas.gov

- Right of Way Permit**
- Commercial Driveway Permit**

Permit No: 2025-82815

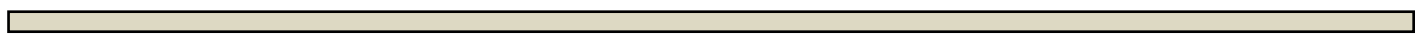

Applicant: Brian D Abbey/Burning Red Construction Development

Job Location Site: 19343 FM 1093 Rd, Richmond, TX 77407

Bond No. **Date of Bond:** 12/22/2025 **Amount:** \$10,000.00



The above applicant came to make use of certain Fort Bend County property subject to, "The Order Regulating the Laying, Construction, Maintenance, and Repair of Buried Cables, Conduits, and Pole Lines, In, Under, Across or Along Roads, Streets, Highways, and Drainage Ditches in Fort Bend County, Texas, Under the Jurisdiction of the Commissioners Court of Fort Bend County, Texas," as passed by the Commissioners Court of Fort Bend County, Texas, of the Minutes of the Commissioners Court of Fort Bend County, Texas, to the extent that such order is not inconsistent with Chapter 181, Vernon's Texas Statutes and Codes Annotated.



Notes:

1. Evidence of review by the Commissioners Court must be kept on the job site and failure to do so constitutes grounds for job shutdown.
2. Written notices are required, via email, for certain construction activities in County right-of-way. Contact permits@fbctx.gov for a copy of the notification procedure applicable to your project.
3. This permit expires one (1) year from date of permit if construction has not commenced.
4. This permit applies to work performed within right-of-ways owned and maintained by Fort Bend County only, and it is the responsibility of the applicant to acquire all other necessary permits and permissions.



On this 22nd day of January, 2026, Upon Motion of Commissioner _____, seconded by Commissioner _____, duly put and carried, it is ORDERED, ADJUDGED AND DECREED that said notice of said above purpose is hereby acknowledged by the Commissioners Court of Fort Bend County, Texas, and that said notice be placed on record according to the regulation order thereof.

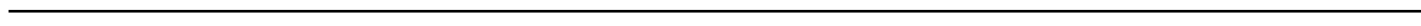

Signature
By: 
County Engineer

Presented to Commissioners Court and approved.
Date Recorded _____ Comm. Court No. _____

N/A
By: _____
Drainage District Engineer/Manager

Clerk of Commissioners Court
By: _____
Deputy





REVIEW BY FORT BEND COUNTY
COMMISSIONERS COURT

Fort Bend County
Engineering Department
301 Jackson Suite 401
Richmond, Texas 77469
281.633.7500
Permits@fortbendcountytexas.gov



Right of Way Permit



Commercial Driveway Permit

Permit No: 2025-82815

The following "Notice of Proposed Cable, Conduit, and/or Pole Line activity in Fort Bend County" and accompanying attachments have been reviewed and the notice conforms to appropriate regulations set by Commissioner's Court of Fort Bend County, Texas.

(1) COMPLETE APPLICATION FORM:

X
X
X

- a. Name of road, street, and/or drainage ditch affected.
- b. Vicinity map showing course of directions
- c. Plans and specifications

(2) BOND:

County Attorney, approval when applicable.

Perpetual bond currently posted.

Bond No: _____

Amount: _____

Performance bond submitted.

Bond No: _____

Amount: _____

Cashier's Check

Check No: XXXXXXXXXX

Amount: \$10,000.00

(3) DRAINAGE DISTRICT APPROVAL (WHEN APPLICABLE):

Drainage District Approval

Date

We have reviewed this project and agree it meets minimum requirements.

Permit Administrator

12/24/2025

Date

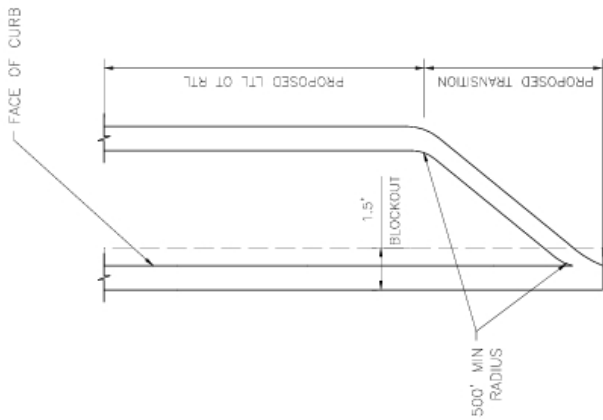

TURN LANE PLAN VIEW

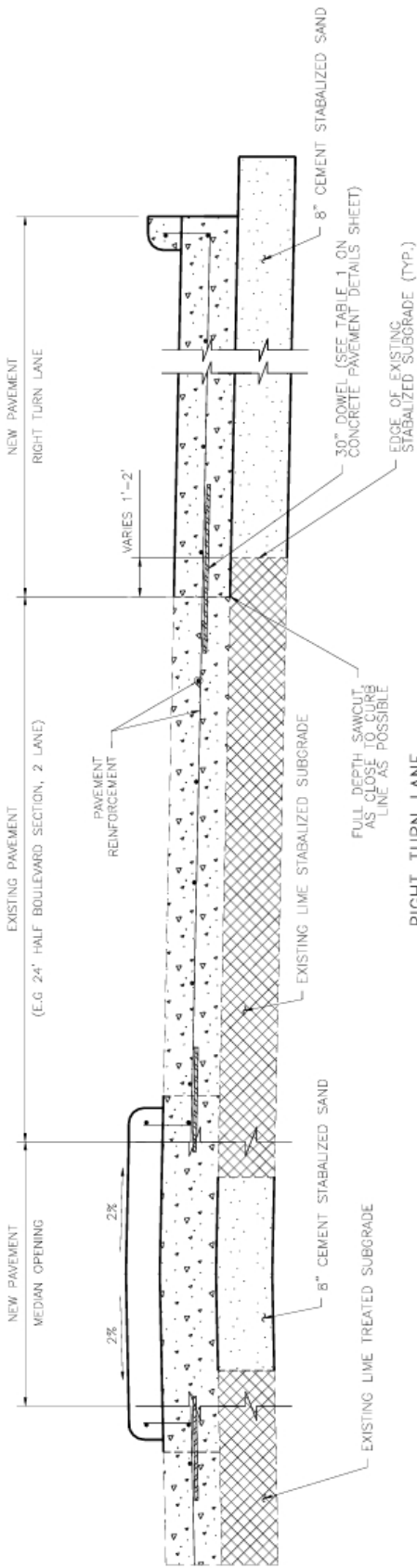

RIGHT TURN LANE
& MEDIAN OPENING

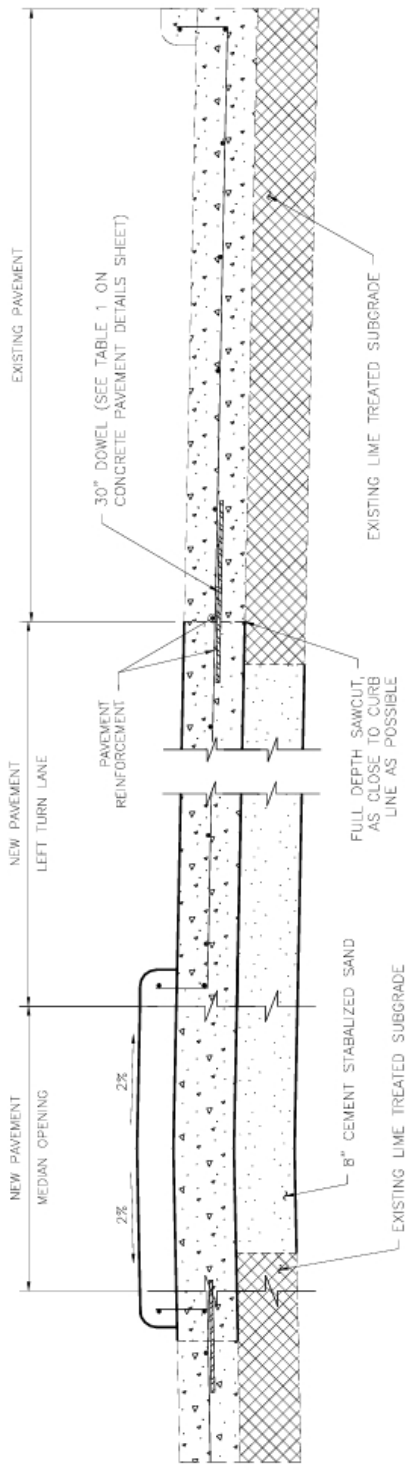

LEFT TURN LANE
& MEDIAN OPENING

NOTES

1. FOR CONCRETE PAVEMENT REINFORCEMENT AND JOINT DETAILS, SEE CONCRETE PAVEMENT DETAILS SHEET
2. ALL TURN LANE AND MEDIAN OPENINGS SHALL HAVE THE SAME SURFACE AS THE EXISTING STREET.



FORT BEND COUNTY
ENGINEERING DEPARTMENT

NO.	REVISIONS	DATE	NAME
1	ORIGINAL STANDARD ISSUED	3-1-22	RJS
2	ADDED NOTE 2	10-1-24	RJS

PROJECT TITLE:	
DRAWN BY:	INIT
CKD BY:	SHEET DESCRIPTION: TURN LANE &
SCALE:	AS NOTED
DATE:	APPROVED BY: MEDIAN OPENING DETAIL
10-1-24	

FBCD
STANDARD
08
SHEET NO:
/

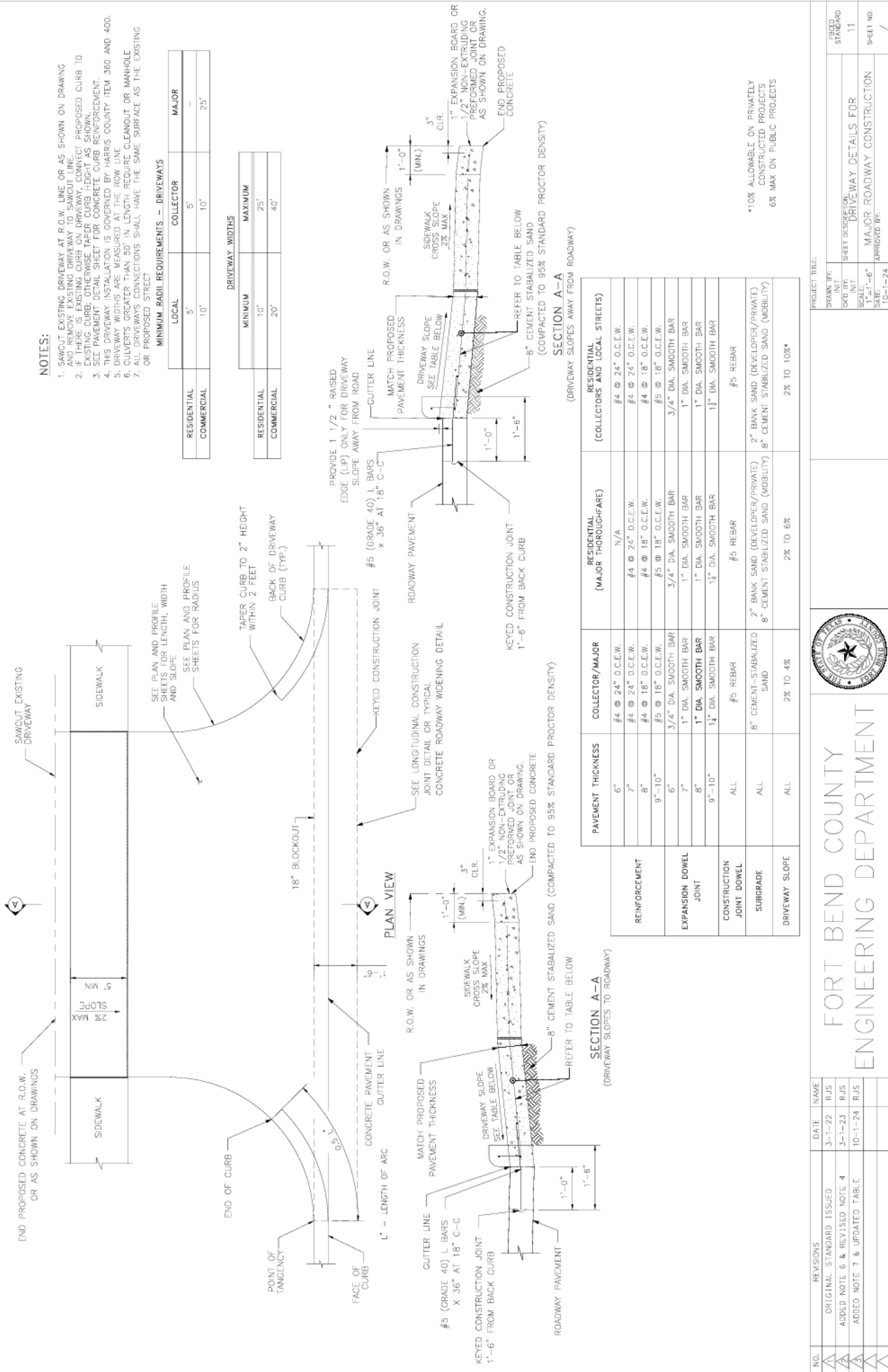

FORT BEND COUNTY ENGINEERING DEPARTMENT

NO.	REVISIONS	DATE	NAME
1	ORIGINAL STANDARD ISSUED	3-1-22	RJS
2	ADDED NOTE 6 & REVISED NOTE 4	3-1-23	RJS
3	ADDED NOTE 7 & UPDATED TABLE	10-1-24	RJS

PROJECT TITLE:	PROJECT NO:
DRIVEWAY DETAILS FOR MAJOR ROADWAY CONSTRUCTION	11
DATE: 10-1-24	APPROVED BY:
SCALE: 1"=6'	
DRAWN BY: INIT	
CHECK BY: INIT	
DESIGNED BY: INIT	
PROJECT NO: 11	SHEET NO: 7

*10% ALLOWABLE ON PRIVATELY CONSTRUCTED PROJECTS
6% MAX ON PUBLIC PROJECTS

- NOTES:**
1. PROPOSED DRIVEWAY AT 6" CONCRETE CURB SHALL MATCH EXISTING CURB AT POINT OF TANGENCY.
 2. PROPOSED DRIVEWAY SHALL BE BUILT WITH PORTLAND CEMENT CONCRETE, 5 1/2 SACK CEMENT MINIMUM PER CUBIC YARD, 3,500 PSI STRENGTH AT 28 DAYS. THIS DRIVEWAY INSTALLATION IS GOVERNED BY HARRIS COUNTY ITEM 400 AND 360.
 3. COMPACTION OF SUBGRADE TO 95% OF STANDARD PROCTOR DENSITY (ASTM D698) (± 2% OPTIMUM MOISTURE) FOR PROPOSED DRIVEWAY CONNECTION. THE COUNTY ENGINEER RESERVES THE RIGHT TO INSPECT AND REQUIRE LABORATORY TEST TO BE CONDUCTED.
 4. FOR COMMERCIAL DRIVEWAYS, USE 8" OF COMPACTED CEMENT STABILIZED SAND.
 5. A PROPOSED DRIVEWAY TO BE BUILT ON A CORNER LOT CANNOT BE LOCATED WITHIN ANY PORTION OF THE PUBLIC STREET CURB RADIUS (THE POINTS OF TANGENCY MAY BE THE SAME POINT ALONG THE STREET CURB LINE).
 6. PROPOSED DRIVEWAY REINFORCING STEEL SHALL BE TIED TO EXISTING REINFORCEMENT IN THE ADJACENT DRIVEWAY.
 7. EXISTING STREET REBAR IS CUT OFF, THEN #4 DOWEL BARS (18" LONG) NEED TO BE INSTALLED AT 24" SPACING EMBEDDED 9" INCHES AND EPOXIED OR MATCH EXISTING SPACING IF TIGHTER.
 8. 3" NON-METALLIC CHAIRS ARE REQUIRED.
 9. FOR CAPITAL IMPROVEMENT PROJECTS, THE SUBGRADE SHALL BE STABILIZED ACCORDING TO THE GEOTECHNICAL REPORT RECOMMENDATIONS.
 10. SAW AND SEAL ALL CONSTRUCTION JOINTS.
 11. SIDEWALK SLOPES SHALL COMPLY WITH THE TEXAS ACCESSIBILITY STANDARDS 403.3 "SLOPE"
 12. IF SIDEWALK IS EXISTING, SEE SECTION C-C.
 13. SIDEWALKS MAY BE REDUCED TO 4' IN FRONT OF SINGLE-FAMILY RESIDENTIAL LOTS WHEN A 5' PASSING AREA IS PROVIDED IN THE DRIVEWAY.
 14. FOR SIDEWALK DETAILS SEE SIDEWALK DETAILS SHEET
 15. DRIVEWAY WIDTHS ARE MEASURED AT THE ROW LINE
 16. CULVERTS GREATER THAN 50" IN LENGTH REQUIRE CLEANOUT OR MANHOLE
 17. ALL DRIVEWAYS SHALL HAVE THE SAME SURFACE AS THE EXISTING OR PROPOSED STREET.



DRIVEWAY AT 6" CONCRETE CURB
(IN RESIDENTIAL AREAS)
SCALE: 1" = 3'-0"

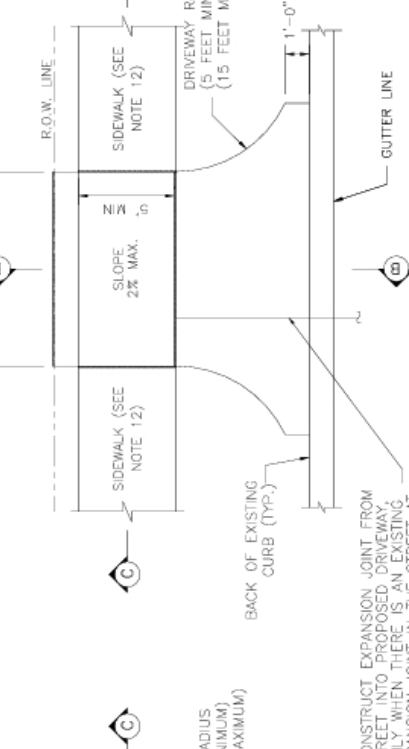

DRIVEWAY AT 4" x 12" CONCRETE CURB
(IN RESIDENTIAL AREAS)
SCALE: 1" = 3'-0"

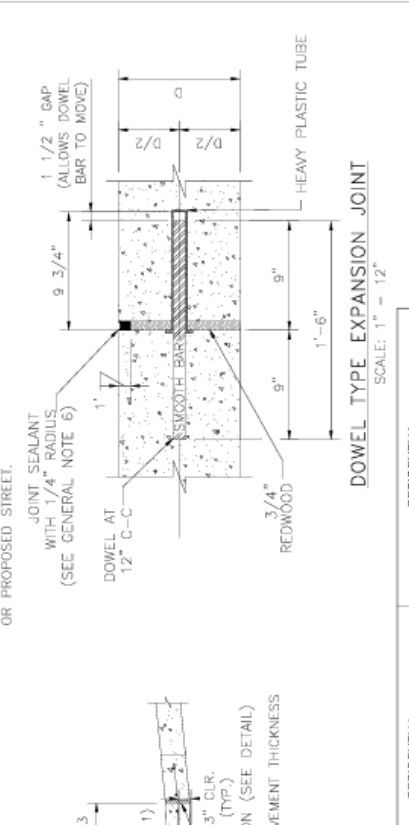

DOWEL TYPE EXPANSION JOINT
SCALE: 1" = 12"

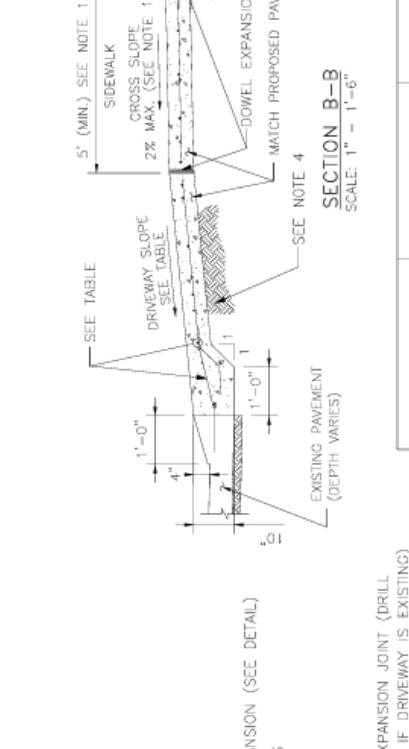

DOWEL TYPE EXPANSION JOINT
SCALE: 1" = 12"

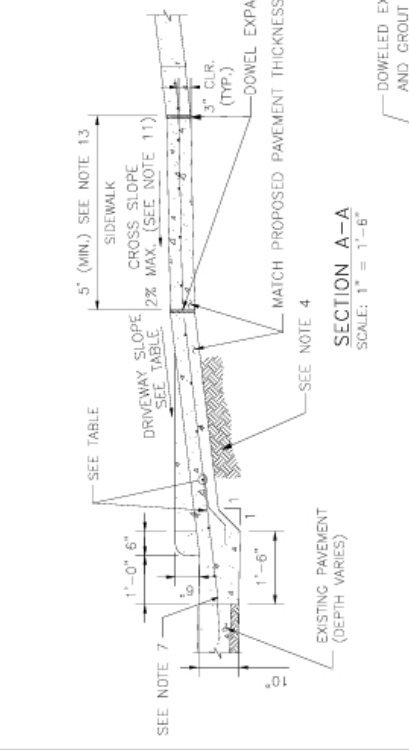

DOWEL TYPE EXPANSION JOINT
SCALE: 1" = 12"

	COLLECTOR/MAJOR	RESIDENTIAL (MAJOR THOROUGHFARE)	RESIDENTIAL (COLLECTORS AND LOCAL STREETS)
REINFORCEMENT	#4 @ 24" O.C.E.W.	N/A	#4 @ 24" O.C.E.W.
	#4 @ 24" O.C.E.W.	#4 @ 24" O.C.E.W.	#4 @ 24" O.C.E.W.
	#4 @ 18" O.C.E.W.	#4 @ 18" O.C.E.W.	#4 @ 18" O.C.E.W.
	#5 @ 18" O.C.E.W.	#5 @ 18" O.C.E.W.	#5 @ 18" O.C.E.W.
EXPANSION DOWEL	3/4" DIA. SMOOTH BAR	3/4" DIA. SMOOTH BAR	3/4" DIA. SMOOTH BAR
JOINT	1" DIA. SMOOTH BAR	1" DIA. SMOOTH BAR	1" DIA. SMOOTH BAR
CONSTRUCTION JOINT DOWEL	1 1/2" DIA. SMOOTH BAR	1 1/2" DIA. SMOOTH BAR	1 1/2" DIA. SMOOTH BAR
SUBGRADE	#5 REBAR	#5 REBAR	#5 REBAR
	8" CEMENT-STABILIZED SAND	2" BANK SAND (DEVELOPER/PRIVATE) 8" CEMENT STABILIZED SAND (MOBILITY)	2" BANK SAND (DEVELOPER/PRIVATE) 8" CEMENT STABILIZED SAND (MOBILITY)
DRIVEWAY SLOPE	2% TO 4%	2% TO 6%	2% TO 10%*

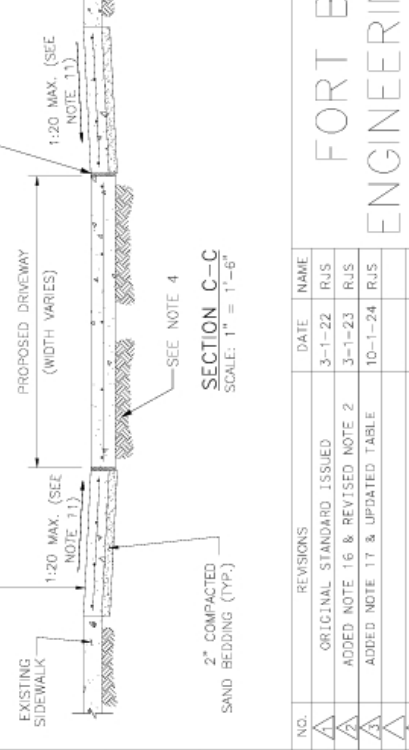
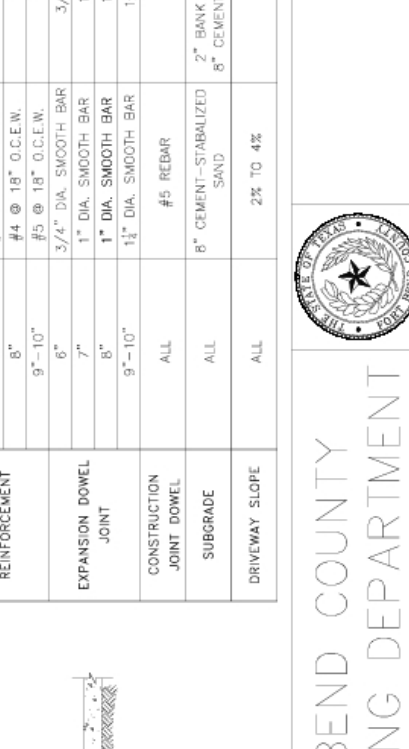

FORT BEND COUNTY
ENGINEERING DEPARTMENT

NO.	REVISIONS	DATE	NAME
1	ORIGINAL STANDARD ISSUED	3-1-22	RJS
2	ADDED NOTE 16 & REVISED NOTE 2	3-1-23	RJS
3	ADDED NOTE 17 & UPDATED TABLE	10-1-24	RJS

PROJECT TITLE:	PROJECT NO.:
DRIVEWAY DETAILS FOR RESIDENTIAL DRIVEWAYS	12
APPROVED BY:	SHEET NO.:
10-1-24	/

*10% ALLOWABLE ON PRIVATELY CONSTRUCTED PROJECTS
6% MAX ON PUBLIC PROJECTS

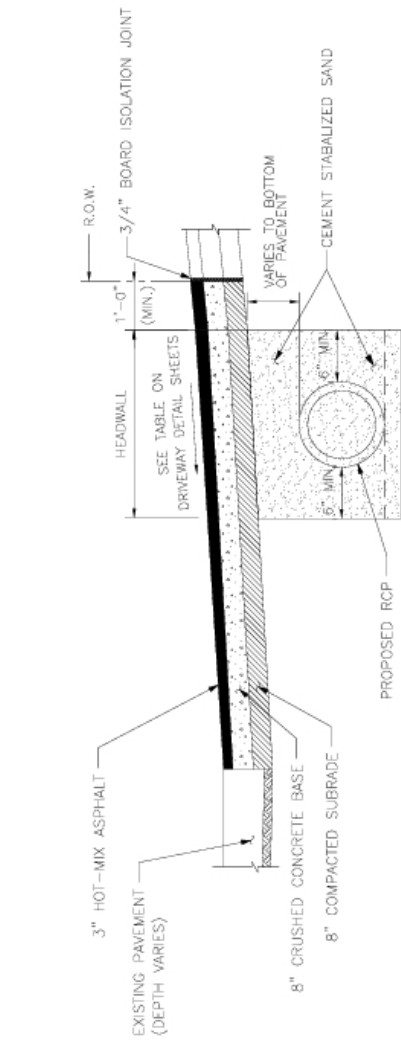

SECTION A-A FOR RESIDENTIAL DRIVEWAYS

NOTES:

1. MAINTAIN A MIN. OF 6" BETWEEN DRIVEWAY AND CULVERT
2. HEADWALLS ARE ONLY ALLOWED ON ROADWAYS WITH POSTED SPEED LIMITS OF 35 MPH OR LESS
3. ALL DRIVEWAY CONNECTIONS SHALL HAVE THE SAME SURFACE AS THE EXISTING OR PROPOSED STREET.

DRIVEWAY WIDTHS*

	MINIMUM	MAXIMUM
RESIDENTIAL	10'	25'
COMMERCIAL	20'	40'

*DRIVEWAY WIDTHS ARE MEASURED AT THE ROW LINE

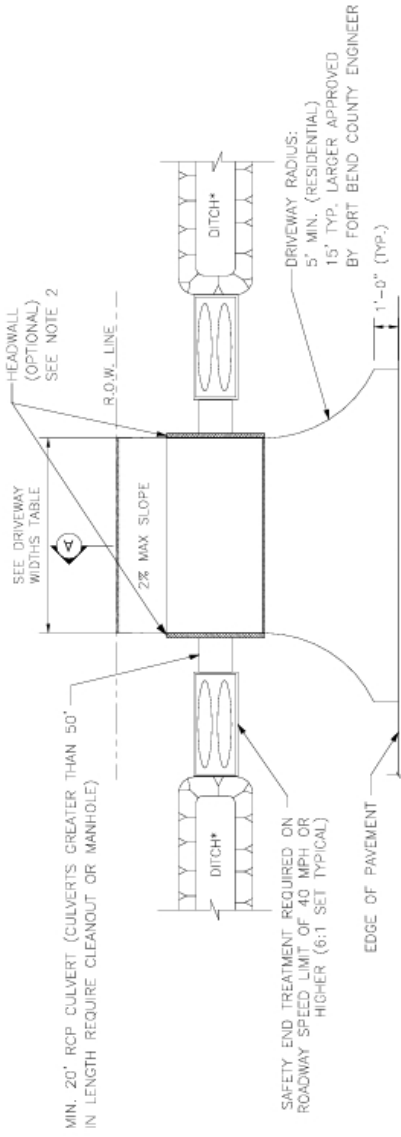

OPEN DITCH DRIVEWAY

*DITCH IS TO HAVE 4:1 SLOPE

MINIMUM RADII REQUIREMENTS - DRIVEWAYS

	LOCAL	COLLECTOR	MAJOR
RESIDENTIAL	5'	5'	-
COMMERCIAL	10'	10'	25'

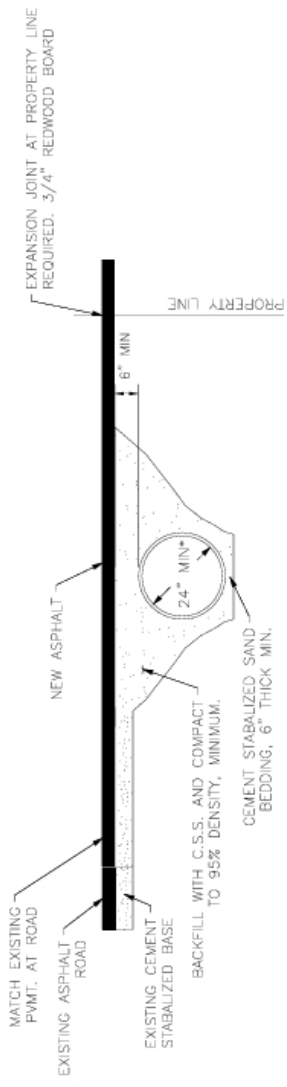

*OR AS APPROVED BY FBC ROAD & BRIDGE

ASPHALT APRON DETAIL - DRIVEWAY PROFILE

FOR CULVERT DRAINAGE

NO.	REVISIONS	DATE	NAME
1	ORIGINAL STANDARD ISSUED	3-1-22	RJS
2	UPDATED SECTION DETS. & NOTES 2 & 3	10-1-24	RJS
3			
4			

FORT BEND COUNTY
ENGINEERING DEPARTMENT

PROJECT TITLE:	
DRAWN BY:	INIT
CHKD BY:	INIT
SCALE:	AS NOTED
DATE:	10-1-24
APPROVED BY:	

ERICD STANDARD	1.3
SHEET DESCRIPTION:	ASPHALT DRIVEWAY DETAILS
SHEET NO.	/

SCORED CONTRACTION JOINT SPACING TO EQUAL WIDTH OF SIDEWALK

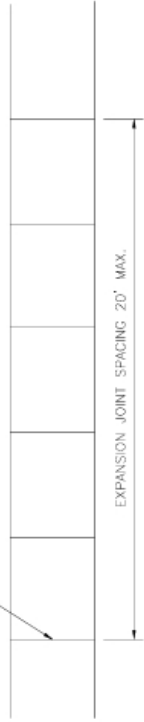

SIDEWALK JOINT DETAILS

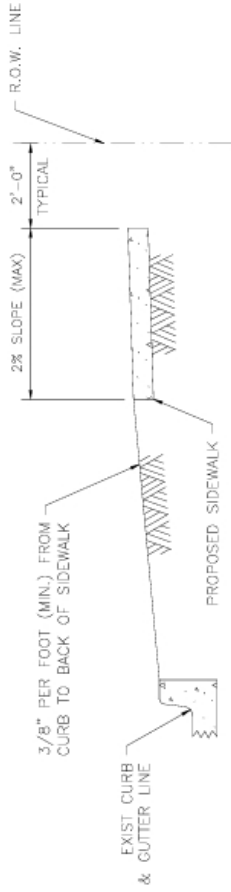

NOTES:

1. TYPICAL SIDEWALK WIDTH IS 5'. SIDEWALKS OF 4' WIDTH ARE ALLOWED IN FRONT OF SINGLE FAMILY HOMES IF ALL DRIVEWAYS PROVIDE A 5' AREA FOR PASSING. SIDEWALKS OF 4' WITH 5' X 5' PASSING ZONES MUST BE SPECIFICALLY APPROVED BY FORT BEND COUNTY
2. THE MAXIMUM WIDTH BETWEEN EXPANSION JOINTS SHALL NOT EXCEED 20'-0"
3. EXPANSION JOINT IS TO BE 1/2" THICK CLEAR HEART REDWOOD WITH DOWELS
4. SCORED CONTRACTION JOINTS SHALL BE EVERY 5' OR EQUAL TO SIDEWALK WIDTH
5. ALL EARTHEN AREAS ARE TO BE SODDED UNLESS SHOWN OTHERWISE ON DRAWINGS.
6. SIDEWALKS ARE TO BE REINFORCED CONCRETE (3500 PSI) WITH #4 BARS, 16" C-C LONGITUDINAL AND 18" C-C TRANSVERSE. SIDEWALKS NOT 5' IN WIDTH SHALL BE CONSTRUCTED AS DIRECTED BY THE ENGINEER OF RECORD.
7. USE RADIUS TOOL ON ALL EXPOSED EDGES.
8. MEMBRANE CURING COMPOUND IS REQUIRED AS DESCRIBED IN ITEM 802 IN THE HARRIS COUNTY STANDARD SPECIFICATIONS FOR CONSTRUCTION
9. SIDEWALK EXPANSION JOINTS SHALL CONFORM TO STREET EXPANSION JOINT STANDARDS
10. 6' SIDEWALK TO BE USED WHEN SIDEWALK RUNS ALONG THE BACK OF CURB AS DESCRIBES IN THE FBC DESIGN MANUAL

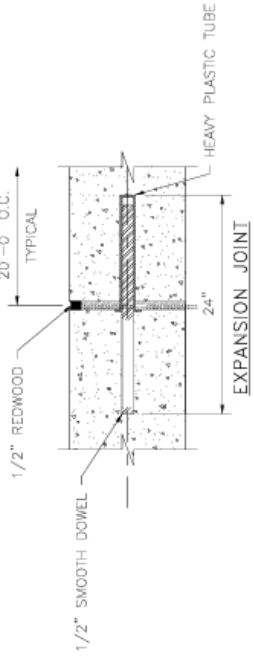

CONTRACTION JOINT SEAL

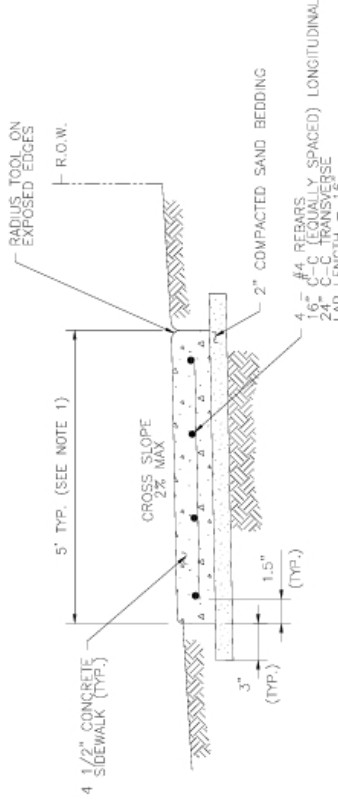
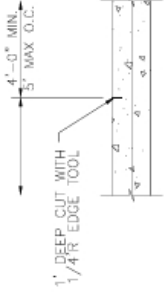

SIDEWALK CROSS SECTION

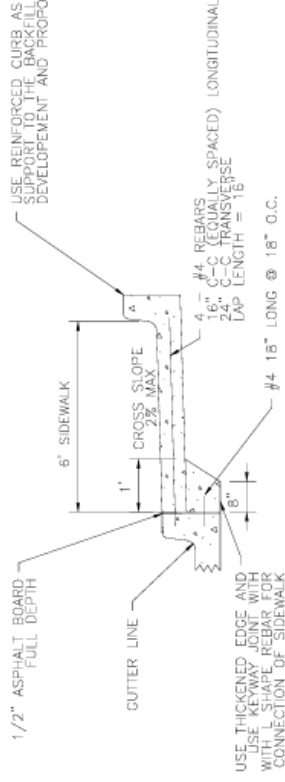

6' SIDEWALK DETAIL*
*REQUIRES FORT BEND COUNTY APPROVAL

NOTE:

BANK SAND IS DEFINED AS A WELL-GRADED SAND, FREE OF SILT, CLAY, LOAM, FRAGILE OR SOLUBLE MATERIALS AND ORGANIC MATTER, MEETING THE UNITED SOILS CLASSIFICATION SYSTEM GROUP SW CRITERIA W/ A PLASTICITY INDEX OF LESS THAN 10, AND NO MORE THAN 12% OF MATERIAL CAN PASS THE NO. 200 SIEVE.



**FORT BEND COUNTY
ENGINEERING DEPARTMENT**

NO.	REVISIONS	DATE	NAME
1	ORIGINAL STANDARD ISSUED	3-1-22	RJS
2	REVISED NOTE 6, 8 & CROSS SECTION DET.	3-1-23	RJS
3	ADD 6' SIDEWALK & REVISED SECT. DETS.	10-1-24	RJS

PROJECT TITLE:	SIDEWALK DETAILS
DRAWN BY:	INIT
CHKD BY:	INIT
SCALE:	AS NOTED
DATE:	10-1-24
APPROVED BY:	

FIELD STANDARD	14
SHEET NO.	/

