

# PLAT RECORDING SHEET

**PLAT NAME:** Milo Farms Wernecke Road Street Dedication and Reserve

**PLAT NO:** \_\_\_\_\_

**ACREAGE:** 6.506

**LEAGUE:** H.&T.C R.R. CO. Survey Section 85 and H.&T.C. R.R. CO. Survey, Section 90

**ABSTRACT NUMBER:** 247 and 507

**NUMBER OF BLOCKS:** 1

**NUMBER OF LOTS:** 0

**NUMBER OF RESERVES:** 1

**OWNERS:** ILS Properties II, LTD

\_\_\_\_\_  
**(DEPUTY CLERK)**

STATE OF TEXAS  
COUNTY OF FORT BEND

I (OR WE), MICHAEL INSELMANN, BEING OFFICERS OF ILS PROPERTIES II, LTD, OWNER (OR OWNERS) OF THE 6.507 TRACT DESCRIBED IN THE ABOVE AND FOREGOING MAP OF MILO FARMS WERNECKE ROAD STREET DEDICATION AND RESERVE, DO HEREBY MAKE AND ESTABLISH SAID SUBDIVISION AND DEVELOPMENT PLAT OF SAID PROPERTY ACCORDING TO ALL LINES, DEDICATIONS, RESTRICTIONS AND NOTATIONS ON SAID MAPS OR PLAT AND HEREBY DEDICATE TO THE USE OF THE PUBLIC FOREVER, ALL STREETS (EXCEPT THOSE STREETS DESIGNATED AS PRIVATE STREETS), ALLEYS, PARKS, WATER COURSES, DRAINS, EASEMENTS AND PUBLIC PLACES SHOWN THEREON FOR THE PURPOSES AND CONSIDERATIONS THEREIN EXPRESSED; AND DO HEREBY BIND MYSELF (OR OURSELVES), MY (OR OUR) HEIRS AND ASSIGNS TO WARRANT AND FOREVER DEFEND THE TITLE TO THE LAND SO DEDICATED.

FURTHER, OWNERS HAVE DEDICATED AND BY THESE PRESENTS DO DEDICATE TO THE USE OF THE PUBLIC FOR PUBLIC UTILITY PURPOSES FOREVER UNOBSTRUCTED AERIAL EASEMENTS. THE AERIAL EASEMENTS SHALL EXTEND HORIZONTALLY AN ADDITIONAL ELEVEN FEET, SIX INCHES (11'6") FOR TEN FEET (10'0") PERIMETER GROUND EASEMENTS OR SEVEN FEET, SIX INCHES (7'6") FOR FOURTEEN FEET (14'0") PERIMETER GROUND EASEMENTS OR FIVE FEET, SIX INCHES (5'6") FOR SIXTEEN FEET (16'0") PERIMETER GROUND EASEMENTS, FROM A PLANE SIXTEEN FEET (16'0") ABOVE GROUND LEVEL UPWARD, LOCATED ADJACENT TO AND ADJOINING SAID PUBLIC UTILITY EASEMENTS THAT ARE DESIGNATED WITH AERIAL EASEMENTS (U.E. AND A.E.) AS INDICATED AND DEPICTED HEREON, WHEREBY THE AERIAL EASEMENT TOTALS TWENTY-ONE FEET, SIX INCHES (21'6") IN WIDTH.

FURTHER, OWNERS HAVE DEDICATED AND BY THESE PRESENTS DO DEDICATE TO THE USE OF THE PUBLIC FOR PUBLIC UTILITY PURPOSES FOREVER UNOBSTRUCTED AERIAL EASEMENTS. THE AERIAL EASEMENTS SHALL EXTEND HORIZONTALLY AN ADDITIONAL TEN FEET (10'0") FOR TEN FEET (10'0") BACK-TO-BACK GROUND EASEMENTS, OR EIGHT FEET (8'0") FOR FOURTEEN FEET (14'0") BACK-TO-BACK GROUND EASEMENTS OR SEVEN FEET (7'0") FOR SIXTEEN FEET (16'0") BACK-TO-BACK GROUND EASEMENTS, FROM A PLANE SIXTEEN FEET (16'0") ABOVE GROUND LEVEL UPWARD, LOCATED ADJACENT TO BOTH SIDES AND ADJOINING ALL PUBLIC UTILITY EASEMENTS THAT ARE DESIGNATED WITH AERIAL EASEMENTS (U.E. AND A.E.) AS INDICATED AND DEPICTED HEREON, WHEREBY THE AERIAL EASEMENT TOTALS THIRTY FEET (30'0") IN WIDTH.

FURTHER, OWNERS DO HEREBY COVENANT AND AGREE THAT ALL OF THE PROPERTY WITHIN THE BOUNDARIES OF THIS PLAT SHALL BE RESTRICTED TO PREVENT THE DRAINAGE OF ANY SEPTIC TANKS INTO ANY PUBLIC OR PRIVATE STREET, ROAD OR ALLEY OR ANY DRAINAGE DITCH, EITHER DIRECTLY OR INDIRECTLY.

FURTHER, OWNERS DO HEREBY DEDICATE TO THE PUBLIC A STRIP OF LAND TWENTY (20) FEET WIDE ON EACH SIDE OF THE CENTER LINE OF ANY AND ALL BAYOUS, CREEKS, GULLIES, RAVINES, DRAWS AND DRAINAGE DITCHES LOCATED IN SAID SUBDIVISION, AS EASEMENTS FOR DRAINAGE PURPOSES. FORT BEND COUNTY OR ANY OTHER GOVERNMENTAL AGENCY SHALL HAVE THE RIGHT TO ENTER UPON SAID EASEMENT AT ANY AND ALL TIMES FOR THE PURPOSES OF CONSTRUCTION AND MAINTENANCE OF DRAINAGE FACILITIES AND STRUCTURES.

FURTHER, OWNERS DO HEREBY COVENANT AND AGREE THAT ALL OF THE PROPERTY WITHIN THE BOUNDARIES OF THIS SUBDIVISION AND ADJACENT TO ANY DRAINAGE EASEMENT, DITCH, GULLY, CREEK OR NATURAL DRAINAGE WAY SHALL HEREBY BE RESTRICTED TO KEEP SUCH DRAINAGE WAYS AND EASEMENTS CLEAR OF FENCES, BUILDINGS, EXCESSIVE VEGETATION AND OTHER OBSTRUCTIONS TO THE OPERATIONS AND MAINTENANCE OF THE DRAINAGE FACILITY AND THAT SUCH ABUTTING PROPERTY SHALL NOT BE PERMITTED TO DRAIN DIRECTLY INTO THIS EASEMENT EXCEPT BY MEANS OF AN APPROVED DRAINAGE STRUCTURE.

FURTHER, WE DO HEREBY CERTIFY THAT WE ARE THE OWNERS OF ALL PROPERTY IMMEDIATELY ADJACENT TO THE BOUNDARIES OF THE ABOVE AND FOREGOING SUBDIVISION OF MILO FARMS WERNECKE ROAD STREET DEDICATION AND RESERVE WHERE BUILDING SETBACK LINES OR PUBLIC UTILITY EASEMENTS ARE TO BE ESTABLISHED OUTSIDE THE BOUNDARIES OF THE ABOVE AND FOREGOING SUBDIVISION AND DO HEREBY MAKE AND ESTABLISH ALL BUILDING SETBACK LINES AND DEDICATE TO THE USE OF THE PUBLIC, ALL PUBLIC UTILITY EASEMENTS SHOWN IN SAID ADJACENT ACREAGE.

FURTHER, OWNERS DO HEREBY ACKNOWLEDGE THE RECEIPT OF THE ORDERS FOR REGULATION OF OUTDOOR LIGHTING IN THE UNINCORPORATED AREAS OF FORT BEND COUNTY, TEXAS; AND DO HEREBY COVENANT AND AGREE AND SHALL COMPLY WITH THIS ORDER AS ADOPTED BY FORT BEND COUNTY COMMISSIONERS COURT ON MARCH 23, 2004, AND ANY SUBSEQUENT AMENDMENTS.

IN TESTIMONY WHEREOF, FOLKLORE DEVELOPMENT, LLC, A TEXAS LIMITED LIABILITY COMPANY, HAS CAUSED THESE PRESENTS TO BE SIGNED BY MICHAEL INSELMANN, ITS MANAGER, HEREUNTO AUTHORIZED

THIS \_\_\_\_\_ DAY OF \_\_\_\_\_, 2025.

\_\_\_\_\_  
MICHAEL INSELMANN  
MANAGER

STATE OF TEXAS  
COUNTY OF \_\_\_\_\_

BEFORE ME, THE UNDERSIGNED AUTHORITY, ON THIS DAY PERSONALLY APPEARED MICHAEL INSELMANN, MANAGER, KNOWN TO ME TO BE THE PERSONS WHOSE NAMES ARE SUBSCRIBED TO THE FOREGOING INSTRUMENT AND ACKNOWLEDGE TO ME THAT THEY EXECUTED THE SAME FOR THE PURPOSES AND CONSIDERATIONS THEREIN EXPRESSED AND IN THE CAPACITY THEREIN AND HEREIN SET OUT, AND AS THE ACT AND DEED OF SAID CORPORATION.

GIVEN UNDER MY HAND AND SEAL OF OFFICE, THIS \_\_\_\_\_ DAY OF \_\_\_\_\_, 2025.

\_\_\_\_\_  
PRINT NAME:  
NOTARY PUBLIC IN AND FOR \_\_\_\_\_

I, JONATHAN FRANZ, AM AUTHORIZED (OR REGISTERED) UNDER THE LAWS OF THE STATE OF TEXAS TO PRACTICE THE PROFESSION OF SURVEYING AND HEREBY CERTIFY THAT THE ABOVE SUBDIVISION IS TRUE AND ACCURATE; WAS PREPARED FROM AN ACTUAL SURVEY OF THE PROPERTY MADE UNDER MY SUPERVISION ON THE GROUND; THAT, EXCEPT AS SHOWN ALL BOUNDARY CORNERS, ANGLE POINTS, POINTS OF CURVATURE AND OTHER POINTS OF REFERENCE HAVE BEEN MARKED WITH IRON (OR OTHER OBJECTS OF A PERMANENT NATURE) PIPES OR RODS HAVING A DIAMETER OF NOT LESS THAN FIVE EIGHTHS (5/8) INCH AND A LENGTH OF NOT LESS THAN THREE (3) FEET; AND THAT THE PLAT BOUNDARY CORNERS HAVE BEEN TIED TO THE TEXAS COORDINATE SYSTEM OF 1983, SOUTH CENTRAL ZONE.



\_\_\_\_\_  
JONATHAN FRANZ  
REGISTERED PROFESSIONAL LAND SURVEYOR  
TEXAS REGISTRATION NO. 6705

I, JESSE N. PASQUARELLI, A PROFESSIONAL ENGINEER REGISTERED IN THE STATE OF TEXAS, DO HEREBY CERTIFY THAT THIS PLAT MEETS ALL REQUIREMENTS OF FORT BEND COUNTY TO THE BEST OF MY KNOWLEDGE.

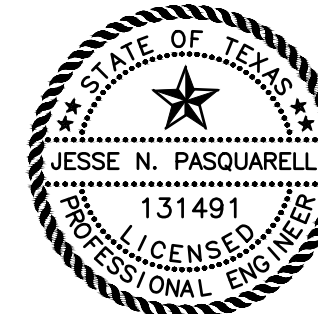

\_\_\_\_\_  
JESSE N. PASQUARELLI, P.E.  
REGISTERED PROFESSIONAL ENGINEER  
TEXAS REGISTRATION NUMBER 131491

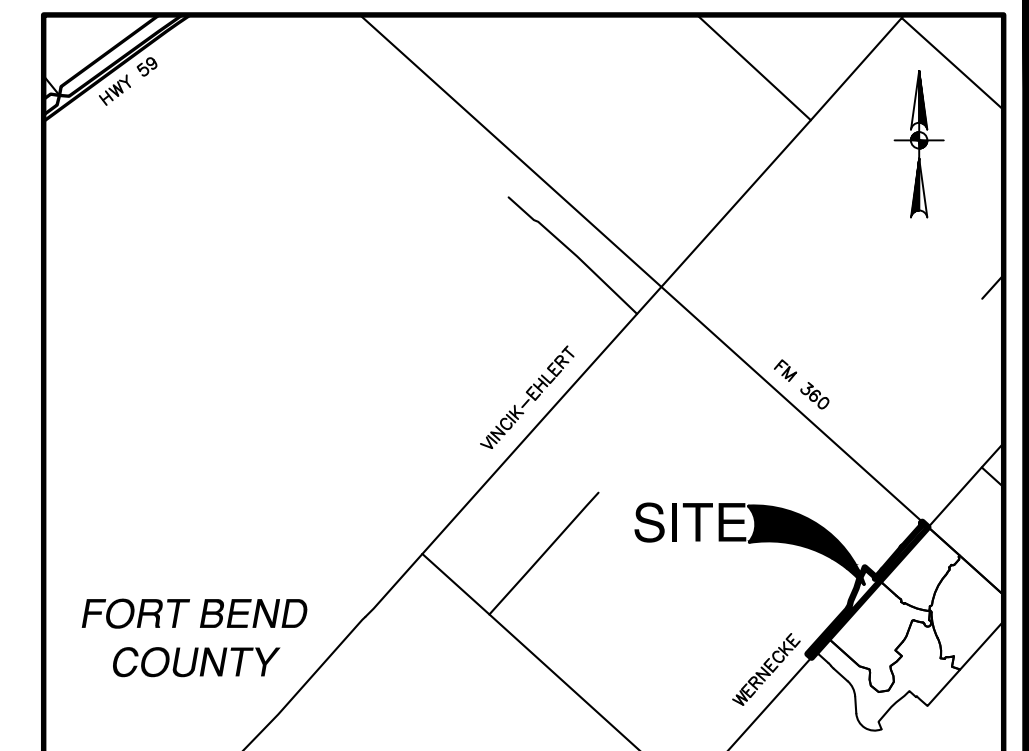

**LOCATION MAP**

NOT TO SCALE  
KEY MAP 642Y, 682B, & 682C  
ZIP CODE: 77471

I, J. STACY SLAWINSKI, FORT BEND COUNTY ENGINEER, DO HEREBY CERTIFY THAT THE PLAT OF THIS SUBDIVISION COMPLIES WITH ALL OF THE EXISTING RULES AND REGULATIONS OF THE OFFICE AS ADOPTED BY THE FORT BEND COUNTY COMMISSIONERS' COURT. HOWEVER, NO CERTIFICATION IS HEREBY GIVEN AS TO THE EFFECT OF DRAINAGE FROM THIS SUBDIVISION ON THE INTERCEPTING DRAINAGE ARTERY OR PARENT STREAM OR ON ANY OTHER AREA OR SUBDIVISION WITHIN THE WATERSHED.

\_\_\_\_\_  
J. STACY SLAWINSKI, P.E.  
FORT BEND COUNTY ENGINEER

APPROVED BY THE COMMISSIONERS' COURT OF FORT BEND COUNTY, TEXAS, THIS \_\_\_\_\_ DAY OF \_\_\_\_\_, 2025.

\_\_\_\_\_  
VINCENT M. MORALES, JR.  
PRECINCT 1, COUNTY COMMISSIONER

\_\_\_\_\_  
GRADY PRESTAGE  
PRECINCT 2, COUNTY COMMISSIONER

\_\_\_\_\_  
K.P. GEORGE  
COUNTY JUDGE

\_\_\_\_\_  
W. A. (ANDY) MEYERS  
PRECINCT 3, COUNTY COMMISSIONER

\_\_\_\_\_  
DEXTER L. MCCOY  
PRECINCT 4, COUNTY COMMISSIONER

I, LAURA RICHARD, COUNTY CLERK IN AND FOR FORT BEND COUNTY, HEREBY CERTIFY THAT THE FOREGOING INSTRUMENT WITH ITS CERTIFICATE OF AUTHENTICATION WAS FILED FOR RECORDATION IN

MY OFFICE ON \_\_\_\_\_, AT \_\_\_\_\_ O'CLOCK \_\_\_\_\_M., AND IN PLAT NUMBER \_\_\_\_\_ OF THE PLAT RECORDS OF FORT BEND COUNTY, TEXAS.

WITNESS MY HAND AND SEAL OF OFFICE, AT RICHMOND, TEXAS, THE DAY AND DATE LAST ABOVE WRITTEN.

\_\_\_\_\_  
LAURA RICHARD COUNTY CLERK  
FORT BEND COUNTY, TEXAS

BY \_\_\_\_\_  
DEPUTY

# MILO FARMS WERNECKE ROAD STREET DEDICATION AND RESERVE

A SUBDIVISION OF 6.506 ACRES SITUATED IN THE  
H.&T. C. R.R. CO. SURVEY, SECTION 85 ABSTRACT NO. 247 AND  
H.&T.C. R.R. CO. SURVEY, SECTION 90 ABSTRACT NO. 507,  
FORT BEND COUNTY, TEXAS.

AUGUST, 2025

1 RESERVE 1 BLOCK

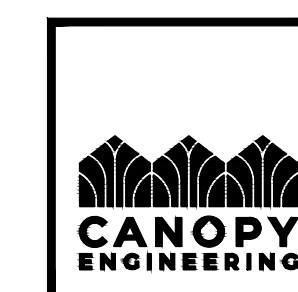

21322A PROVINCIAL BLVD  
KATY, TX 77480  
TEXAS REGISTERED FIRM NO.  
F-9409

**OWNER/DEVELOPER:**  
ILS PROPERTIES II, LTD  
3903 BELLAIRE BLVD, STE D  
HOUSTON, TX 77025  
832-483-1321

**PAPE-DAWSON**  
2107 CITYWEST BLVD, 3RD FLR | HOUSTON, TX 77042 | 713.428.2400  
TEXAS ENGINEERING FIRM #470 | TEXAS SURVEYING FIRM #10028800

