

September 9, 2025

Commissioner Dexter L. McCoy
Fort Bend County Precinct 4
1517 Eugene Heimann Circle, Suite 300
Richmond, TX 77469
281-243-4800

Re: Wernecke Road Phase 1 Improvements
Proposed Road Closure
Canopy Project No.: 008-01-2402A

Dear Commissioner McCoy,

Canopy Engineering is requesting permission to close Wernecke Road between the intersections of FM 360 and Meyer Road. To comply with the County's Major Thoroughfare Plan and Milo Farm's Development Agreement, Wernecke Road will be improved from its current two-lane configuration to a four-lane boulevard. The proposed closure will not restrict access to any existing residences along Wernecke Road. Detour signage will be placed as per the attached traffic control plan.

We are anticipating beginning repairs on this roadway in October 2025 with the road remaining closed until construction completion. Traffic control signage will be installed prior to commencing construction and will remain in place until construction has completed.

Should you have any questions or need any additional information concerning these plans, please call me at 832-331-4779.

Sincerely,



Jesse Pasquarelli, P.E.
Senior Project Manager
Canopy Engineering

Date: Wed, 10 Sep 2025 3:01pm
 Path Name: C:\Users\javier.alvarez\Box\Canopy\Projects\008\FBC\008\021 - Milo Farms\01 - Phase One\2450 Detention\04 Exhibits\11 TRAFFIC CONTROL PLAN.dwg

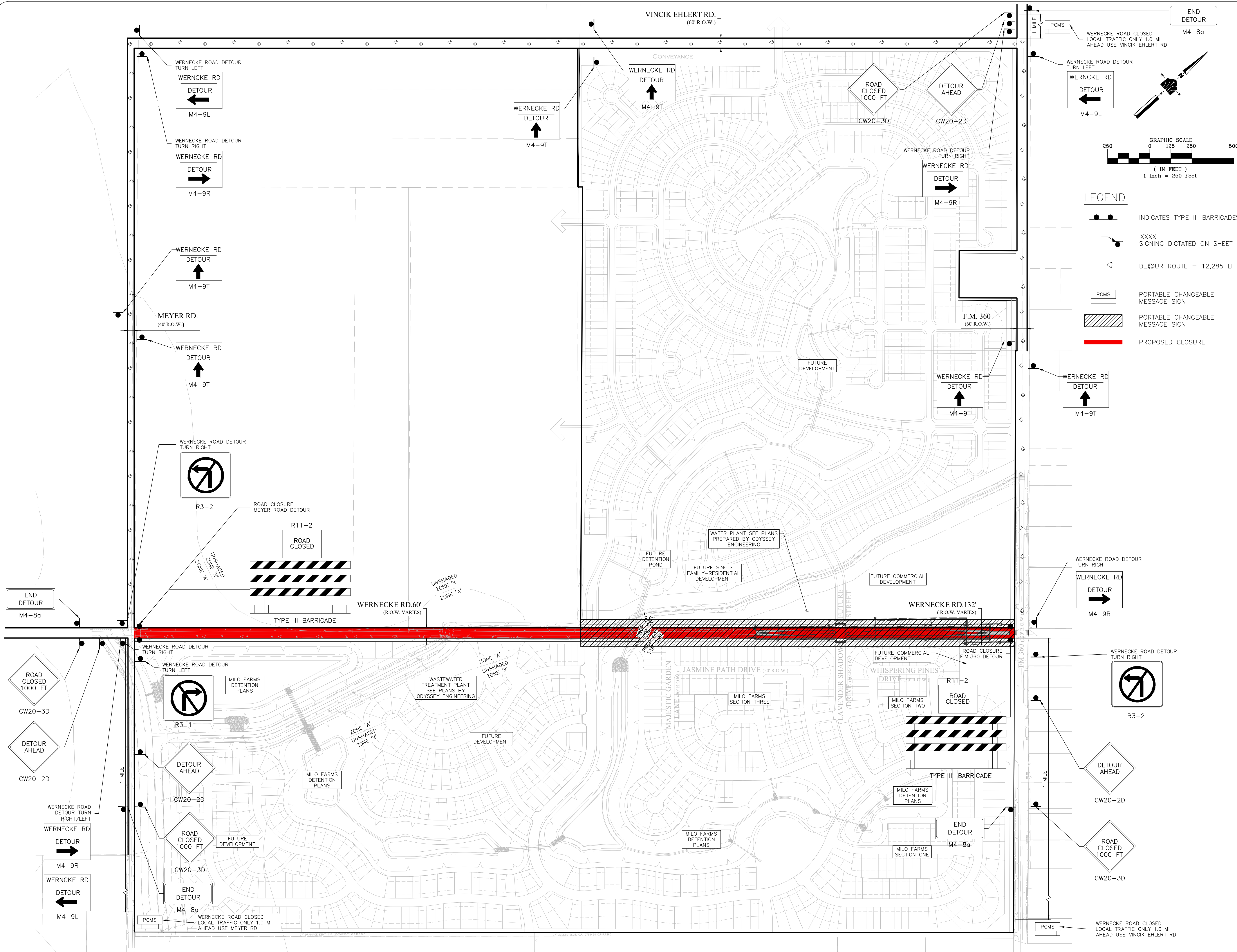

PROJECT BENCHMARK:
 HGSD 71 (NSD PID: AW5478)
 A FLANGE ENCASED STEEL ROD IN SLEEVE LOCATED APPROXIMATELY 89 FEET
 NORTHEAST OF THE CENTERLINE OF SH 36 AND 0.1 MILE SOUTH OF ITS
 INTERSECTION WITH FM 360 IN NEEDVILLE, TEXAS
 ELEVATION: 88.20' NAVD88

TEMPORARY BENCHMARK:
 MAG NAIL SET EASTERLY INTERSECTION OF BLAZE ROD AND FM 360
 ELEVATION: 100.66' NAVD88

FLOODPLAIN:
 THIS PROPERTY LIES PARTIALLY WITHIN ZONE A AS PER FIRM
 PANEL NO. 48157C0375M, DATED 12/21/2017
 100 THE BFE: 95.33' NAVD88

- NOTES:**
- 1) ALL UTILITIES ARE PROPOSED UNLESS OTHERWISE NOTED.
 - 2) THE CONTRACTOR SHALL FIELD VERIFY ALL EXISTING UTILITIES PRIOR TO CONSTRUCTION.
 - 3) CAUTION: THERE ARE EXISTING UTILITIES WITHIN THE PROJECT AREA. CONTRACTOR SHALL FIELD VERIFY LOCATION OF ALL EXISTING UTILITIES AFFECTING PROPOSED UTILITIES PRIOR TO CONSTRUCTION. IN THE EVENT OF CONFLICT BETWEEN EXISTING UTILITIES AND PROPOSED UTILITIES, THE CONTRACTOR SHALL SUSPEND CONSTRUCTION IN THE VICINITY OF THE CONFLICT, AND SHALL COMMENCE ONLY UPON AUTHORIZATION BY OWNER.
 - 4) CAUTION: WHILE WORKING ADJACENT TO AND IN THE VICINITY OF OVERHEAD G.S.U. TRANSMISSION LINES, CONTRACTOR IS TO EXERCISE EXTREME CAUTION WITH WORK ACTIVITIES. CONTRACTOR'S EQUIPMENT SHALL NOT EXCEED BOOM HEIGHT OF 15 FEET IN THE VICINITY OF G.S.U. TRANSMISSION LINES.
 - 5) PAVING CONTRACTOR SHALL TAKE EXTREME CAUTION IN SUBGRADE MANIPULATION IN THIS AREA. STORM SEWER PIPE IS IN OR WITHIN 6" OF SUBGRADE.
 - 6) CONTRACTOR TO PROVIDE SURVEYED "AS BUILT" DATA ON THE FLOWLINE AND CROSS SECTIONAL AREA OF ALL OVERFLOW SWALES MINIMUM EVERY 50'.
 - 7) CEMENT STABILIZED SAND FOR BACKFILL CROSSING ALL PAVEMENT SHALL BE INCIDENTAL.
 - 8) T.C.'S BASED ON 6" CURB. FOR 4" CURB, SUBTRACT 0.17'.

DATE	REVISION	BY

ENGINEER

RECORD DRAWING

THE PROJECT IS CONSTRUCTED IN GENERAL CONFORMANCE WITH THESE PLANS AND THE ELEVATIONS ON THESE DRAWINGS REPRESENT WHAT WAS CONSTRUCTED WITHIN ENGINEERING TOLERANCES

APPROVED: _____

TITLE: _____

DATE: _____

RECORD DRAWING

I CERTIFY THAT THIS DRAWING REFLECTS THE IMPROVEMENTS CONSTRUCTED AS TO SIZE, LOCATION AND GRADE AND THAT THE CONSTRUCTION WAS IN FULL COMPLIANCE WITH THE CONTRACT DOCUMENTS

INITIAL _____ DATE _____

FBC Engineering Approval

CANOPY ENGINEERING
 21322A PROVINCIAL BLVD
 KATY, TX 77450
 TEXAS REGISTERED FIRM NO. F-24529

COUNTY: FORT BEND COUNTY
DISTRICT: F.B.C.M.U.D. NO. 231

CLIENT: FOLKLORE DEVELOPMENT, LLC
 21322-A PROVINCIAL BLVD
 KATY, TX 77450

PROJECT: MILO FARMS
 WATER, DRAINAGE, AND PAVING AND APPURTENANCES
 WERNECKE ROAD EXPANSION PHASE 1

TRAFFIC CONTROL PLAN

CE Project No.: 008-01-2402	Scale: HORIZ: 1" = 250'	SHEET
Date: Aug 2025	VERT: 1" = 250'	11
Dwn By: MB		OF 32
Chkd By: JNP		

MILO FARMS, DRAINAGE AND PAVING AND APPURTENANCES, WERNECKE ROAD EXPANSION PH1, CANOPY PROJECT NO. 008-01-2402