

PLAT RECORDING SHEET

PLAT NAME: Sienna Section 76

PLAT NO: _____

ACREAGE: 39.417

LEAGUE: David Fitzgerald Survey and William Hall Survey

ABSTRACT NUMBER: 25 & 31

NUMBER OF BLOCKS: 3

NUMBER OF LOTS: 82

NUMBER OF RESERVES: 7

OWNERS: TOLL-GTIS Property Owner, LLC

(DEPUTY CLERK)

STATE OF TEXAS
COUNTY OF FORT BEND

WE, TOLL-GTIS PROPERTY OWNER, LLC, A TEXAS LIMITED LIABILITY COMPANY, ACTING BY AND THROUGH JIMMIE F. JENKINS, AUTHORIZED REPRESENTATIVE, OF TOLL-GTIS PROPERTY OWNER LLC, A TEXAS LIMITED LIABILITY COMPANY, OWNERS OF THE 39.417 ACRE TRACT DESCRIBED IN THE ABOVE AND FOREGOING PLAT OF SIENNA SECTION 76, DO HEREBY MAKE AND ESTABLISH SAID SUBDIVISION PLAT OF SAID PROPERTY ACCORDING TO ALL LINES, DEDICATIONS, RESTRICTIONS AND NOTATIONS ON SAID PLAT AND HEREBY DEDICATE TO THE USE OF THE PUBLIC FOREVER, ALL STREETS, ALLEYS, PARKS, WATER COURSES, DRAINS, EASEMENTS AND PUBLIC PLACES SHOWN THEREON FOR THE PURPOSES AND CONSIDERATIONS THEREIN EXPRESSED, AND DO HEREBY BIND OURSELVES, OUR HEIRS AND ASSIGNS TO WARRANT AND FOREVER DEFEND THE TITLE TO THE LAND SO DEDICATED.

WE, FURTHER ACKNOWLEDGE THAT THE DEDICATIONS AND/OR EXACTIONS MADE HEREIN ARE PROPORTIONAL TO THE IMPACT OF THE SUBDIVISION UPON THE PUBLIC SERVICES REQUIRED IN ORDER THAT THE DEVELOPMENT WILL COMPORT WITH THE PRESENT AND FUTURE GROWTH NEEDS OF THE CITY; WE, OUR SUCCESSORS AND ASSIGNEES HEREBY WAIVE ANY CLAIM, DAMAGE OR CAUSE OF ACTION THAT WE MAY HAVE AS A RESULT OF THE DEDICATION OR EXACTIONS MADE HEREIN.

FURTHER, OWNERS HAVE DEDICATED AND BY THESE PRESENTS DO DEDICATE TO THE USE OF THE PUBLIC FOR PUBLIC UTILITY PURPOSES FOREVER UNOBSTRUCTED AERIAL EASEMENTS, THE AERIAL EASEMENTS SHALL EXTEND HORIZONTALLY AN ADDITIONAL ELEVEN FEET, SIX INCHES (11'6") FOR TEN FEET (10'0") PERIMETER GROUND EASEMENTS OR SEVEN FEET, SIX INCHES (7'6") FOR FOURTEEN FEET (14'0") PERIMETER GROUND EASEMENTS OR FIVE FEET, SIX INCHES (5'6") FOR SIXTEEN FEET (16'0") PERIMETER GROUND EASEMENTS, FROM A PLANE SIXTEEN FEET (16'0") ABOVE GROUND LEVEL UPWARD, LOCATED ADJACENT TO AND ADJOINING SAID PUBLIC UTILITY EASEMENTS THAT ARE DESIGNATED WITH AERIAL EASEMENTS (U.E. AND A.E.) AS INDICATED AND DEPICTED, HEREON, WHEREBY THE AERIAL EASEMENT TOTALS TWENTY ONE FEET, SIX INCHES (21' 6") IN WIDTH.

FURTHER, OWNERS HAVE DEDICATED AND BY THESE PRESENTS DO DEDICATE TO THE USE OF THE PUBLIC FOR PUBLIC UTILITY PURPOSES FOREVER UNOBSTRUCTED AERIAL EASEMENTS, THE AERIAL EASEMENTS SHALL EXTEND HORIZONTALLY AN ADDITIONAL TEN FEET (10'0") FOR TEN FEET (10'0") BACK-TO-BACK GROUND EASEMENTS, OR EIGHT FEET (8'0") FOR FOURTEEN FEET (14'0") BACK-TO-BACK GROUND EASEMENTS OR SEVEN FEET (7'0") FOR SIXTEEN FEET (16'0") BACK-TO-BACK GROUND EASEMENTS, FROM A PLANE SIXTEEN FEET (16'0") ABOVE GROUND LEVEL UPWARD, LOCATED ADJACENT TO BOTH SIDES AND ADJOINING SAID PUBLIC UTILITY EASEMENTS THAT ARE DESIGNATED WITH AERIAL EASEMENTS (U.E. AND A.E.) AS INDICATED AND DEPICTED HEREON, WHEREBY THE AERIAL EASEMENT TOTALS THIRTY FEET (30'0") IN WIDTH.

FURTHER, WE DO HEREBY DECLARE THAT ALL PARCELS OF LAND DESIGNATED AS LOTS ON THIS PLAT ARE INTENDED FOR THE CONSTRUCTION OF SINGLE FAMILY RESIDENTIAL DWELLING UNITS THEREON AND SHALL BE RESTRICTED FOR SAME UNDER THE TERMS AND CONDITIONS OF SUCH RESTRICTIONS FILED SEPARATELY.

FURTHER, WE DO HEREBY COVENANT AND AGREE THAT ALL OF THE PROPERTY WITHIN THE BOUNDARIES OF THIS PLAT SHALL BE RESTRICTED TO PREVENT THE DRAINAGE OF ANY SEPTIC TANKS INTO ANY PUBLIC OR PRIVATE STREET, ROAD OR ALLEY OR ANY DRAINAGE DITCH, EITHER DIRECTLY OR INDIRECTLY.

FURTHER, WE DO HEREBY DEDICATE TO THE PUBLIC A STRIP OF LAND THIRTY (30) FEET WIDE ON EACH SIDE OF THE CENTER LINE OF ANY AND ALL BAYOUS, CREEKS, GULLIES, RAVINES, DRAWS AND DRAINAGE DITCHES LOCATED IN SAID SUBDIVISION, AS EASEMENTS FOR DRAINAGE PURPOSES FORT BEND COUNTY OR ANY OTHER GOVERNMENTAL AGENCY SHALL HAVE THE RIGHT TO ENTER UPON SAID EASEMENT AT ANY AND ALL TIMES FOR THE PURPOSES OF CONSTRUCTION AND MAINTENANCE OF DRAINAGE FACILITIES AND STRUCTURES.

FURTHER, WE DO HEREBY COVENANT AND AGREE THAT ALL OF THE PROPERTY WITHIN THE BOUNDARIES OF THIS SUBDIVISION AND ADJACENT TO ANY DRAINAGE EASEMENT, DITCH, GULLY, CREEK OR NATURAL DRAINAGE WAY SHALL HEREBY BE RESTRICTED TO KEEP SUCH DRAINAGE WAYS AND EASEMENTS CLEAR OF FENCES, BUILDINGS, EXCESSIVE VEGETATION AND OTHER OBSTRUCTIONS TO THE OPERATIONS AND MAINTENANCE OF THE DRAINAGE FACILITY AND THAT SUCH ABUTTING PROPERTY SHALL NOT BE PERMITTED TO DRAIN DIRECTLY INTO THIS EASEMENT EXCEPT BY MEANS OF AN APPROVED DRAINAGE STRUCTURE.

FURTHER, WE DO HEREBY CERTIFY THAT WE ARE THE OWNERS OF ALL PROPERTY IMMEDIATELY ADJACENT TO THE BOUNDARIES OF THE ABOVE AND FOREGOING SUBDIVISION OF SIENNA SECTION 76 WHERE BUILDING SETBACK LINES OR PUBLIC UTILITY EASEMENTS ARE TO BE ESTABLISHED OUTSIDE THE BOUNDARIES OF THE ABOVE AND FOREGOING SUBDIVISION AND DO HEREBY MAKE AND ESTABLISH ALL BUILDING SETBACK LINES AND DEDICATE TO THE USE OF THE PUBLIC, ALL PUBLIC UTILITY EASEMENTS SHOWN IN SAID ADJACENT ACREAGE.

FURTHER, WE DO HEREBY ACKNOWLEDGE THE RECEIPT OF THE "ORDERS FOR REGULATION OF OUTDOOR LIGHTING IN THE UNINCORPORATED AREAS OF FORT BEND COUNTY, TEXAS", AND DO HEREBY COVENANT AND AGREE AND SHALL COMPLY WITH THIS ORDER AS ADOPTED BY FORT BEND COUNTY COMMISSIONERS COURT ON MARCH 23, 2004 AND ANY SUBSEQUENT AMENDMENT.

IN TESTIMONY WHEREOF, TOLL-GTIS PROPERTY OWNER, LLC, A TEXAS LIMITED LIABILITY COMPANY, HAS CAUSED THESE PRESENTS TO BE SIGNED BY JIMMIE F. JENKINS, ITS AUTHORIZED REPRESENTATIVE, THEREUNTO AUTHORIZED

THIS _____ DAY OF _____, 2025.

TOLL-GTIS PROPERTY OWNER LLC
A TEXAS LIMITED LIABILITY COMPANY

BY: JIMMIE F. JENKINS, AUTHORIZED REPRESENTATIVE

STATE OF TEXAS
COUNTY OF HARRIS

BEFORE ME, THE UNDERSIGNED AUTHORITY, ON THIS DAY PERSONALLY APPEARED JIMMIE F. JENKINS, AUTHORIZED REPRESENTATIVE OF TOLL-GTIS PROPERTY OWNER LLC, A TEXAS LIMITED LIABILITY COMPANY, KNOWN TO ME TO BE THE PERSON WHOSE NAME IS SUBSCRIBED TO THE FOREGOING INSTRUMENT AND ACKNOWLEDGED TO ME THAT HE EXECUTED THE SAME FOR THE PURPOSES AND CONSIDERATIONS THEREIN EXPRESSED AND IN THE CAPACITY THEREIN AND HEREIN SET OUT.

GIVEN UNDER MY HAND AND SEAL OF OFFICE,

THIS _____ DAY OF _____, 2025.

NOTARY PUBLIC IN AND FOR THE STATE OF TEXAS

I, JON P. BORDOVSKY, A REGISTERED PROFESSIONAL LAND SURVEYOR, AM AUTHORIZED UNDER THE LAWS OF THE STATE OF TEXAS TO PRACTICE THE PROFESSION OF LAND SURVEYING AND HEREBY CERTIFY THAT THE ABOVE SUBDIVISION IS TRUE AND CORRECT, WAS PREPARED FROM AN ACTUAL SURVEY OF THE PROPERTY MADE UNDER MY SUPERVISION ON THE GROUND AND THAT ALL BOUNDARY CORNERS, ANGLES, POINTS OF CURVATURE AND OTHER POINTS OF REFERENCE HAVE BEEN MARKED WITH IRON (OR OTHER SUITABLE PERMANENT METAL) PIPES OR RODS HAVING AN OUTSIDE DIAMETER OF NOT LESS THAN FIVE-EIGHTHS (5/8) INCH WITH PLASTIC CAP MARKED "GBI PARTNERS" AND A LENGTH OF NOT LESS THAN THREE (3) FEET. (SEE NOTE #9)

JON P. BORDOVSKY, R.P.L.S.
REGISTERED PROFESSIONAL LAND SURVEYOR
TEXAS REGISTRATION NO. 6405



I, SCOTT FRANKOVICH, A PROFESSIONAL ENGINEER REGISTERED IN THE STATE OF TEXAS DO HEREBY CERTIFY THAT THIS PLAT MEETS ALL REQUIREMENTS OF FORT BEND COUNTY TO THE BEST OF MY KNOWLEDGE.

SCOTT FRANKOVICH, P.E.
LICENSED PROFESSIONAL ENGINEER
TEXAS LICENSE NO. 130312



STATE OF TEXAS
COUNTY OF FORT BEND

THIS IS TO CERTIFY THAT THE PLANNING AND ZONING COMMISSION OF THE CITY OF MISSOURI CITY, TEXAS, HAS APPROVED THIS PLAT AND SUBDIVISION OF SIENNA SECTION 76 IN CONFORMANCE WITH THE LAWS OF THE STATE OF TEXAS AND THE ORDINANCES OF THE CITY OF MISSOURI CITY AS SHOWN HEREON AND AUTHORIZED THE RECORDING OF THIS PLAT

THIS _____ DAY OF _____, 2025.

TIMOTHY R. HANEY, CHAIR

JOHN O'MALLEY, VICE CHAIR

NOTES:

- BENCHMARK: FOUND 4 INCH BRASS DISC LOCATED IN A POURED CONCRETE POST IN THE GRASSY AREA IN FRONT OF MISSOURI CITY FIRE STATION NUMBER 5 16.5 FEET FROM THE SIDE WALK. SURVEY MARKER NO. PCM-011 ELEV. = 59.97 (NAVD88 2001 ADJUSTMENT)
- T.B.M. INDICATES TEMPORARY BENCHMARK "X" CUT IN CONCRETE ELEV. = 58.53 (NAVD 88, 2001 ADJUSTMENT)
- ALL BEARINGS REFERENCED TO THE TEXAS COORDINATE SYSTEM, SOUTH CENTRAL ZONE (NAD83). COORDINATES SHOWN ARE GRID AND MAY BE CONVERTED TO SURFACE BY MULTIPLYING BY A FACTOR OF 0.999867651
- THIS PLAT WAS PREPARED TO MEET CITY OF MISSOURI CITY AND FORT BEND COUNTY REQUIREMENTS.
- THIS PLAT WAS PREPARED FROM INFORMATION FURNISHED BY CHARTER TITLE COMPANY, FILE NO. 2024-0139 DATED NOVEMBER 12, 2024 THE SURVEYOR HAS NOT ABSTRACTED THE ABOVE PROPERTY.
- THIS PLAT LIES WHOLLY WITHIN SIENNA PARKS & LEVEE IMPROVEMENT DISTRICT, FORT BEND SUBDIVISION DISTRICT, FORT BEND COUNTY, TEXAS. THE ETJ OF THE CITY OF MISSOURI CITY, FORT BEND COUNTY AND SIENNA MUNICIPAL UTILITY DISTRICT NO. 7.
- IN ACCORDANCE WITH FEDERAL EMERGENCY MANAGEMENT AGENCY FLOOD INSURANCE RATE MAP, MAP NO. 48157C 0435L, REVISED DATE APRIL 2, 2014, PROPERTY LIES WITHIN SHADED ZONE "X" DEFINED AS AREAS OF 0.2% ANNUAL CHANCE FLOOD. THIS AREA IS SHOWN AS BEING PROTECTED FROM THE 1% ANNUAL CHANCE OR GREATER FLOOD HAZARD BY A LEVEE SYSTEM. OVERTOPPING OR FAILURE OF ANY LEVEE SYSTEM IS POSSIBLE. LIA DOES NOT WARRANT NOR SUBSCRIBE TO THE ACCURACY OR SCALE OF SAID MAPS.
- THERE ARE NO PIPELINES OR PIPELINE EASEMENTS WITHIN THIS SUBDIVISION.
- FIVE-EIGHTHS (5/8) INCH IRON RODS WITH PLASTIC CAP MARKED "GBI PARTNERS" AND THREE (3) FEET IN LENGTH WILL BE SET ON ALL PERIMETER BOUNDARY CORNERS, UNLESS OTHERWISE NOTED. BLOCK CORNERS AND/OR STREET RIGHT-OF-WAYS HAVE NOT BEEN MONUMENTED.
- THE TOP OF ALL FLOOR SLABS SHALL BE A MINIMUM OF 62.48 FEET ABOVE MEAN SEA LEVEL (NAVD88 DATUM). IN ADDITION, NO TOP OF SLAB ELEVATION SHALL BE LESS THAN 24 INCHES ABOVE THE LOWEST TO OF CURB ADJACENT TO THE LOT IN WHICH IT LIES. IN THE ABSENCE OF A CURB, THE TOP OF SLAB ELEVATION SHALL BE NO LESS THAN 24 INCHES ABOVE HIGHEST NATURAL GROUND PERIMETER OF THE BUILDING FOUNDATION AND 12" ABOVE ANY DOWN GRADIENT ROADWAY OR DRAINAGE RESTRAINT, WHICHEVER IS HIGHER.
- THE DRAINAGE SYSTEM FOR THIS SUBDIVISION SHALL BE DESIGNED TO MEET THE REQUIREMENTS OF THE FORT BEND COUNTY DRAINAGE CRITERIA MANUAL WHICH ALLOWS STREET PONDING DURING INTENSE RAINFALL EVENTS.
- ALL DRAINAGE AND FLOODWAY EASEMENTS SHALL BE KEPT CLEAR OF FENCES, BUILDINGS, PLANTINGS, AND OTHER OBSTRUCTIONS TO THE OPERATIONS AND MAINTENANCE OF THE DRAINAGE FACILITY AS REQUIRED BY SUBSECTION 82-168(D) OF THE CODE OF ORDINANCES OF THE CITY OF MISSOURI CITY, TEXAS.
- ALL PROPERTY TO DRAIN INTO THE DRAINAGE EASEMENT ONLY THROUGH AN APPROVED DRAINAGE STRUCTURE.
- SHARED ACCESS AND PARKING FACILITIES SHALL BE PROVIDED AS REQUIRED UNDER THE PROVISIONS OF SUBSECTION 82-159 OF THE CODE OF ORDINANCES OF THE CITY OF MISSOURI CITY.
- ALL LOT LINES SHALL HAVE A MINIMUM FIVE (5) FOOT SIDE YARD SETBACK.
- A MINIMUM DISTANCE OF 10' SHALL BE MAINTAINED BETWEEN RESIDENTIAL DWELLINGS.
- THE CITY OF MISSOURI CITY SHALL NOT BE RESPONSIBLE FOR MAINTENANCE OF DRIVEWAYS, SIDEWALKS, EMERGENCY ACCESS EASEMENTS, RECREATIONAL AREAS, OPEN SPACE AND RESERVES; AND THE SIENNA COMMUNITY ASSOCIATION INC., (S.C.A.I.) HOMEOWNERS ASSOCIATION SHALL BE RESPONSIBLE FOR SUCH MAINTENANCE OF DRIVEWAYS, EMERGENCY ACCESS EASEMENTS, RECREATIONAL AREAS AND OPEN SPACES AS REQUIRED BY SECTION 3.C(14)OF THE PLATTING MANUAL OF THE CITY OF MISSOURI CITY (SEPTEMBER 2019).
- SIDEWALK SHALL BE BUILT OR CAUSED TO BE BUILT NOT LESS THAN 5- FEET IN WIDTH ON BOTH SIDES OF ALL DEDICATED RIGHTS-OF-WAY WITHIN SAID PLAT AND ON CONTIGUOUS RIGHT-OF-WAY OF ALL PERIMETER ROADS SURROUNDING SAID PLAT, IN ACCORDANCE WITH ADA REQUIREMENTS.
- SIDEWALKS SHALL BE BUILT AS REQUIRED BY SECTION 82-164 OF THE CODE OF ORDINANCES OF THE CITY OF MISSOURI CITY, TEXAS.
- DRIVEWAY APPROACHES SHALL BE PROVIDED IN ACCORDANCE WITH THE MISSOURI CITY DRIVEWAY APPROACH POLICY AS REQUIRED UNDER THE PROVISIONS OF SUBSECTION 82-160 OF THE CODE OF ORDINANCES OF THE CITY OF MISSOURI CITY, TEXAS.
- DRIVEWAY LOCATION - FOR THE LOTS ON THE INSIDE OF A KNUCKLE OR 90 DEGREE TURN, DRIVEWAY MUST BE PLACED ON THE LOT FRONTAGE ALONG THE INSIDE APPROACH LANE PRIOR TO THE RIGHT TURN, TO AVOID SIGHT OBSTRUCTION SAFETY HAZARDS.

- ALL REQUIRED UTILITY COMPANIES HAVE BEEN CONTACTED AND ALL PUBLIC UTILITY EASEMENTS AS SHOWN ON THE ABOVE AND FOREGOING PLAT CONSTITUTE ALL OF THE EASEMENTS REQUIRED BY THE UTILITY COMPANIES CONTACTED AT THE TIME OF PLATTING.
- ALL OF THE PROPERTY SUBDIVIDED IN THE ABOVE AND FOREGOING PLAT IS WITHIN THE ETJ BOUNDARIES OF THE CITY OF MISSOURI CITY, TEXAS.
- NO BUILDING OR OTHER PERMIT, EXCEPT PERMITS FOR CONSTRUCTION OF PUBLIC IMPROVEMENTS WILL BE ISSUED BY THE CITY OF MISSOURI CITY, TEXAS, FOR CONSTRUCTION WITHIN THIS SUBDIVISION UNTIL SUCH TIME AS ALL PUBLIC IMPROVEMENTS OF THE SUBDIVISION HAVE BEEN CONSTRUCTED BY THE DEVELOPER AND ACCEPTED BY THE CITY OR THE GUARANTEE OF CONSTRUCTION OF PUBLIC IMPROVEMENTS REQUIRED BY SECTION 82-206 OF THE CODE OF ORDINANCES OF THE CITY OF MISSOURI CITY, TEXAS, IS SUBMITTED TO AND APPROVED BY THE CITY.
- PRIOR TO THE BEGINNING OF THE ONE-YEAR MAINTENANCE PERIOD FOR UTILITIES AND PAVING BY FORT BEND COUNTY, ALL BLOCK CORNERS AND STREET RIGHT-OF-WAY WILL BE MONUMENTED.
- ADEQUATE FIRE FLOWS SHALL BE PROVIDED ALONG THE ENTIRE LENGTH OF THE PROPOSED WATER LINE.
- REQUIRED FIRE FLOWS SHALL BE PROVIDED BASED ON THE SIZE AND CONSTRUCTION OF ALL BUILDINGS AS REQUIRED BY THE INTERNATIONAL FIRE CODE AS ADOPTED BY THE CITY.
- THE PLACEMENT OF FIRE HYDRANTS SHALL BE PROVIDED BASED ON THE MINIMUM DISTANCE REQUIREMENTS AS ESTABLISHED IN THE INTERNATIONAL FIRE CODE AS ADOPTED BY THE CITY (500FT. FOR RESIDENTIAL DEVELOPMENT AND 300FT. FOR COMMERCIAL DEVELOPMENT). ALL FIRE HYDRANTS SHALL BE INSTALLED ACCORDING TO THE INTERNATIONAL FIRE CODE AS ADOPTED BY THE CITY.
- STREET LIGHTING SHALL BE DESIGNED AND INSTALLED IN ACCORDANCE WITH THE CITY OF MISSOURI CITY INFRASTRUCTURE DESIGN MANUAL, CHAPTER 4 STREET LIGHTING AND OVERHEAD UTILITIES. THE INSTALLATION, OPERATION, AND MAINTENANCE OF ORNAMENTAL STREET LIGHTS SHALL NOT BE THE RESPONSIBILITY OF THE CITY OF MISSOURI CITY, EXCEPT AS PROVIDED THEREIN.
- OWNERSHIP AND MAINTENANCE RESPONSIBILITY OF THE DRAINAGE RESERVES AND CHANNELS IS VESTED IN THE SIENNA PARKS & LEVEE IMPROVEMENT DISTRICT. THE OWNERSHIP AND MAINTENANCE RESPONSIBILITY OF LANDSCAPE RESERVES IS VESTED IN THE HOMEOWNERS ASSOCIATION (HOA).
- OWNERSHIP AND MAINTENANCE RESPONSIBILITY OF THE UTILITIES WITHIN THE SECTIONS IS VESTED IN SIENNA MUNICIPAL UTILITY DISTRICT NO. 7. THE OWNERSHIP AND MAINTENANCE RESPONSIBILITY OF THE UTILITIES ALONG BOULEVARDS AND MAJOR THOROUGHFARES IS VESTED IN THE SIENNA MUNICIPAL UTILITY DISTRICT NO. 5.
- IN ACCORDANCE WITH CENTERPOINT ENERGY ELECTRICAL SERVICE MANUAL, ARTICLE 421.2, ELECTRIC METERS SHALL BE LOCATED IN A POSITION THAT IS ACCESSIBLE AT ALL TIMES WITHOUT CUSTOMER ASSISTANCE. ACCESS TO THE METER SHALL NOT BE BLOCKED BY GATES, WALLS OR FENCES.
- THIS PLAT IS SUBORDINATED BY: U.S. BANK NATIONAL ASSOCIATION D/B/A HOUSING CAPITAL COMPANY, AS RECORDED IN FILE NO. _____ OF THE OFFICIAL RECORDS OF FORT BEND COUNTY, TEXAS.
- THIS PLAT LIES WITHIN LIGHTING ZONE 2.
- THIS PLAT IS SUBJECT TO VARIOUS BLANKET EASEMENTS AS SET FORTH BY THE RESTRICTIVE COVENANTS RECORDED UNDER F.N. 2015009259 AND 2019035843, F.B.C.O.R.
- SITE PLANS SHALL BE SUBMITTED TO FORT BEND COUNTY AND ANY OTHER APPLICABLE JURISDICTION FOR REVIEW AND APPROVAL DEVELOPMENT PERMITS AND ALL OTHER APPLICABLE PERMITS SHALL BE OBTAINED FROM FORT BEND COUNTY PRIOR TO BEGINNING CONSTRUCTION.
- ONE-FOOT RESERVE DEDICATED TO THE CITY IN FEE AS A BUFFER SEPARATION BETWEEN THE SIDE OR END OF STREETS WHERE SUCH STREETS ABUT ADJACENT ACREAGE TRACTS, THE CONDITION OF SUCH DEDICATION BEING THAT WHEN THE ADJACENT PROPERTY IS SUBDIVIDED PURSUANT TO A RECORDED PLAT, THE ONE-FOOT RESERVE SHALL THEREUPON BECOME VESTED IN THE PUBLIC FOR STREET RIGHT-OF-WAY PURPOSES AND THE FEE TITLE THERETO SHALL REVERT TO AND REVEST IN THE DEDICATOR, HIS HEIRS, ASSIGNS OR SUCCESSORS.
- ALL SLAB ELEVATIONS SHALL BE AT LEAST ONE FOOT ABOVE THE 100-YEAR FLOOD ELEVATION AS ESTABLISHED BY FEMA AS PER SECTION 3.C(13) OF THE PLATTING MANUAL OF THE CITY OF MISSOURI CITY (SEPTEMBER 2019).
- THIS PLAT IS SUBJECT TO A 3.844 ACRE CEMETERY PER FB-057, F.B.C.P. No. 20050238, AND FILE NUMBER 2005134010, F.B.C.O.P.R.; AND SHOWN HEREON AS RESERVE "D".

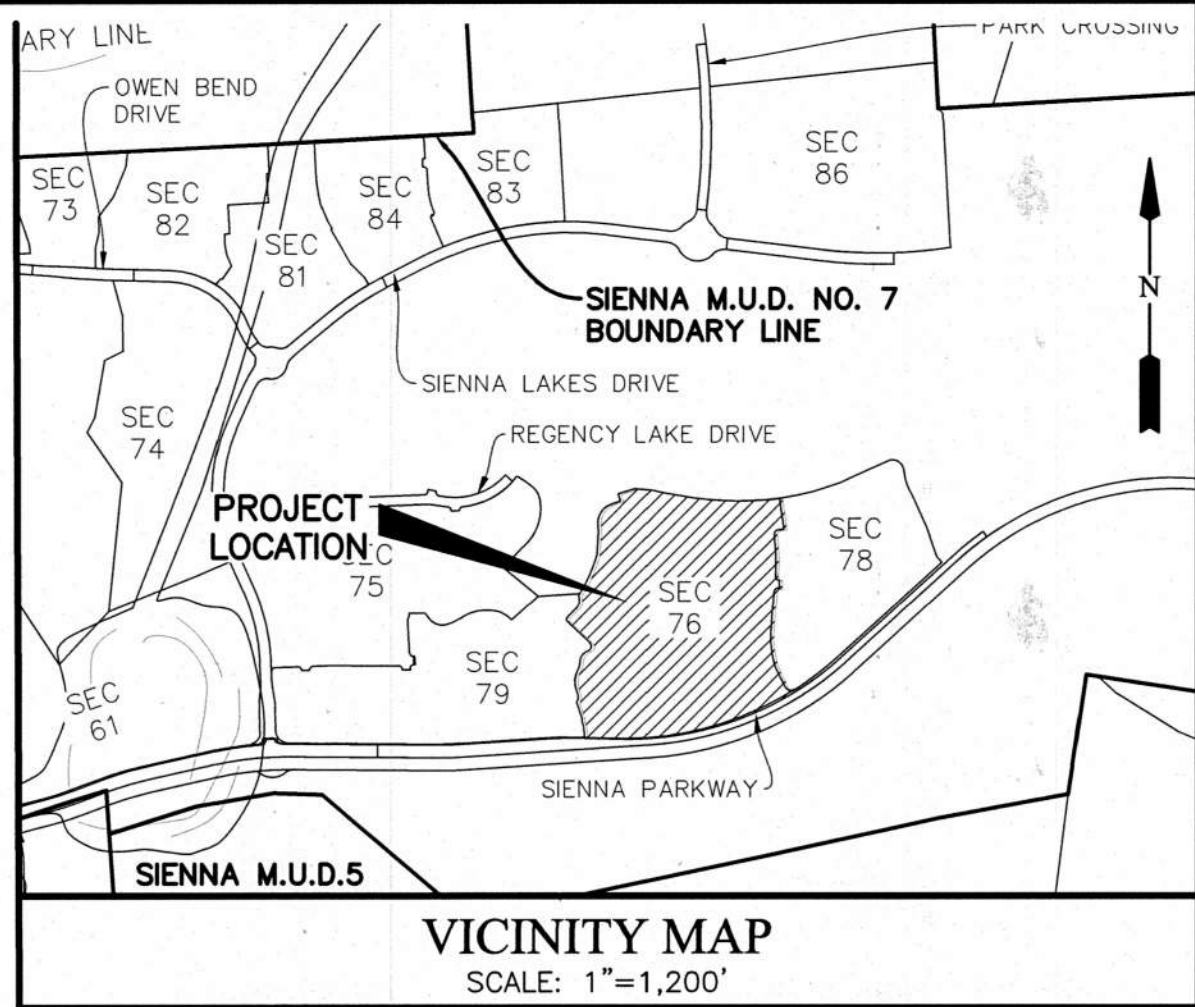

VICINITY MAP
SCALE: 1"=1,200'

KEY MAP NO. 650V

I, J. STACY SLAWINSKI, FORT BEND COUNTY ENGINEER, DO HEREBY CERTIFY THAT THE PLAT OF THIS SUBDIVISION COMPLIES WITH ALL OF THE EXISTING RULES AND REGULATIONS OF THIS OFFICE AS ADOPTED BY THE FORT BEND COUNTY COMMISSIONERS' COURT. HOWEVER, NO CERTIFICATION IS HEREBY GIVEN AS TO THE EFFECT OF DRAINAGE FROM THIS SUBDIVISION ON THE INTERCEPTING DRAINAGE ARTERY OR PARENT STREAM OR ON ANY OTHER AREA OR SUBDIVISION WITHIN THE WATERSHED.

J. STACY SLAWINSKI, P.E.
FORT BEND COUNTY ENGINEER

APPROVED BY THE COMMISSIONERS' COURT OF FORT BEND COUNTY, TEXAS,

THIS _____ DAY OF _____, 2025.

VINCENT M. MORALES, JR.
PRECINCT 1, COUNTY COMMISSIONER

GRADY PRESTAGE
PRECINCT 2, COUNTY COMMISSIONER

KP GEORGE
COUNTY JUDGE

W.A. (ANDY) MEYERS
PRECINCT 3, COUNTY COMMISSIONER

DEXTER L. McCOY
PRECINCT 4, COUNTY COMMISSIONER

I, LAURA RICHARD, COUNTY CLERK IN AND FOR FORT BEND COUNTY, HEREBY CERTIFY THAT THE

FOREGOING INSTRUMENT WITH ITS CERTIFICATE OF AUTHENTICATION WAS FILED FOR RECORDATION

IN MY OFFICE ON _____, 2025 AT _____ O'CLOCK _____ M. IN

PLAT NUMBER _____ OF THE PLAT RECORDS OF FORT BEND COUNTY, TEXAS.

WITNESS MY HAND AND SEAL OF OFFICE, AT RICHMOND, TEXAS, THE DAY AND DATE LAST ABOVE WRITTEN.

LAURA RICHARD, COUNTY CLERK
FORT BEND COUNTY, TEXAS

BY: DEPUTY

SIENNA SECTION 76

A SUBDIVISION OF 39.417 ACRES OF LAND SITUATED IN THE
DAVID FITZGERALD SURVEY, ABSTRACT 25, &
THE WILLIAM HALL SURVEY, ABSTRACT 31
FORT BEND COUNTY, TEXAS.

82 LOTS 7 RESERVES (13.902 ACRES) 3 BLOCKS

MAY 07, 2025

JOB NO. 1417-1576P

TOLL-GTIS PROPERTY OWNER, LLC

JIMMIE F. JENKINS, AUTHORIZED REPRESENTATIVE

10110 WEST SAM HOUSTON PARKWAY NORTH, SUITE 210, HOUSTON, TEXAS 77064
PH. (281) 894-8655

SURVEYOR:



GBI PARTNERS

4724 VISTA ROAD TBEPLS FIRM #10130300
PASADENA, TX 77505 GBSurvey@GBISurvey.com
PHONE: 281-499-4539 www.GBISurvey.com

JON BORDOVSKY, R.P.L.S.
REGISTERED PROFESSIONAL LAND SURVEYOR
TEXAS REGISTRATION NO. 6405

ENGINEER:

LJA Engineering, Inc.

1904 W. Grand Parkway North

Suite 100

Katy, Texas 77449

SCOTT FRANKOVICH, P.E.
LICENSED PROFESSIONAL ENGINEER
TEXAS REGISTRATION NO. 130312

Phone 713.953.5200

Fax 713.953.5026

FRN-F-1386

SHEET 1 OF 2

LINE TABLE			LINE TABLE		
LINE	BEARING	DISTANCE	LINE	BEARING	DISTANCE
L1	N 73°23'02" E	110.11'	L35	N 19°24'10" E	13.80'
L2	S 85°33'21" E	98.34'	L36	N 26°57'22" W	73.68'
L3	S 78°30'03" E	93.53'	L37	N 21°03'34" W	83.80'
L4	S 82°46'17" E	88.78'	L38	N 08°21'02" W	85.68'
L5	N 83°44'38" E	88.81'	L39	N 02°59'03" E	74.05'
L6	S 00°09'50" E	50.00'	L40	N 41°52'51" W	14.14'
L7	S 28°02'20" E	41.99'	L41	S 86°52'51" E	136.87'
L8	S 86°14'20" W	22.34'	L42	N 85°07'46" W	140.30'
L9	N 01°45'44" E	1.54'	L43	N 41°13'27" W	14.18'
L10	N 03°20'11" W	13.76'	L44	S 86°03'03" E	125.37'
L11	N 07°48'56" W	31.41'	L45	N 03°50'04" E	74.99'
L12	N 18°17'31" W	93.19'	L46	S 02°18'43" W	84.44'
L13	N 43°44'53" E	83.63'	L47	S 01°41'19" E	83.61'
L14	N 02°58'37" E	95.43'	L48	S 35°17'17" W	25.21'
L15	N 71°14'45" E	55.96'	L49	N 46°06'02" W	82.97'
L16	N 16°36'58" W	33.39'	L50	S 77°22'25" W	59.10'
L17	N 87°57'07" W	15.47'	L51	S 84°39'37" W	53.78'
L18	S 06°24'09" E	50.24'	L52	N 72°41'39" W	21.92'
L19	S 29°55'48" E	30.32'	L53	S 82°10'13" E	93.41'
L20	N 77°01'09" E	10.22'	L54	S 85°18'01" E	80.03'
L21	N 14°40'52" W	54.42'	L55	N 65°58'10" W	98.17'
L22	S 03°07'09" W	93.77'	L56	S 81°28'47" E	88.14'
L23	S 12°58'51" E	55.43'	L57	S 75°14'35" E	82.21'
L24	N 12°58'51" W	74.31'	L58	N 78°15'20" E	38.82'
L25	N 03°07'09" E	95.71'	L59	S 29°23'13" W	51.93'
L26	S 87°57'07" E	12.72'	L60	S 07°16'45" E	15.49'
L27	S 87°57'07" E	15.47'	L61	S 57°14'33" E	25.80'
L28	S 06°24'09" E	1.91'	L62	S 77°45'27" W	2.41'
L29	N 75°48'43" W	70.52'	L63	S 12°14'32" E	28.24'
L30	S 75°48'43" E	65.26'	L64	S 08°03'45" E	15.00'
L31	S 32°49'10" W	53.69'	L65	S 08°47'17" E	16.00'
L32	S 39°59'15" E	34.68'	L66	S 00°37'48" E	10.00'
L33	S 10°29'52" W	37.77'	L67	S 00°56'07" E	16.00'
L34	S 60°40'44" E	49.96'			

LEGEND	
B.L.	INDICATES BUILDING LINE
U.E.	INDICATES UTILITY EASEMENT
D.E.	INDICATES DRAINAGE EASEMENT
W.L.E.	INDICATES WATER LINE EASEMENT
S.S.E.	INDICATES SANITARY SEWER EASEMENT
STM.S.E.	INDICATES STORM SEWER EASEMENT
F.B.C.P.R.	INDICATES FORT BEND COUNTY PLAT RECORDS
F.B.C.O.R.	INDICATES FORT BEND COUNTY OFFICIAL RECORDS
F.B.C.O.P.R.	INDICATES FORT BEND COUNTY OFFICIAL PUBLIC RECORDS
F.B.C.D.R.	INDICATES FORT BEND COUNTY DEED RECORDS
F.N.	INDICATES FILE NUMBER
E.E.	INDICATES ELECTRICAL EASEMENT
R.O.W.	INDICATES RIGHT-OF-WAY
	INDICATES STREET NAME CHANGE

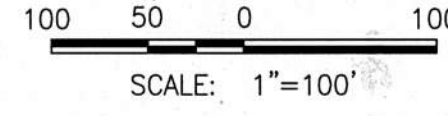

CURVE TABLE					
CURVE	RADIUS	DELTA	ARC	CHORD BEARING	CHORD
C1	2,025.00'	1°06'10"	38.98'	S 82°29'20" W	38.98'
C2	25.00'	89°26'39"	39.03'	S 38°19'06" W	35.18'
C3	1,530.00'	9°44'42"	260.22'	S 01°31'52" E	259.91'
C4	25.00'	93°30'18"	40.80'	S 43°24'41" E	36.42'
C5	1,125.00'	0°22'23"	7.33'	N 89°58'38" W	7.33'
C6	25.00'	85°58'58"	37.52'	S 47°13'05" W	34.09'
C7	670.00'	18°07'02"	211.86'	S 04°49'56" E	210.98'
C8	300.00'	14°08'54"	74.08'	S 20°57'53" E	73.89'
C9	300.00'	2°53'34"	15.15'	S 28°35'33" E	15.14'
C10	660.00'	3°44'05"	43.02'	S 27°00'49" E	43.01'
C11	40.00'	93°26'24"	65.23'	S 75°36'04" E	58.24'
C12	1,960.00'	28°33'36"	976.99'	S 71°57'32" W	966.91'
C13	2,000.00'	5°31'24"	192.80'	S 89°00'02" W	192.73'
C14	10.50'	92°49'44"	17.00'	N 34°10'56" E	15.20'
C15	82.55'	20°39'24"	29.76'	N 14°53'40" W	29.60'
C16	15.00'	9°33'18"	2.50'	N 20°26'43" W	2.50'
C17	70.74'	11°57'27"	14.76'	N 09°41'21" W	14.74'
C18	15.00'	11°57'59"	3.13'	N 02°16'19" E	3.13'
C19	37.38'	27°23'28"	17.87'	N 05°26'28" W	17.70'
C20	20.00'	44°33'49"	15.56'	N 03°59'23" E	15.17'
C21	58.71'	51°33'02"	52.83'	N 00°29'47" E	51.06'
C22	165.98'	54°42'14"	158.47'	N 02°59'24" E	152.52'
C23	75.41'	29°23'33"	38.69'	N 13°32'24" E	38.26'
C24	74.13'	7°15'59"	98.67'	N 36°14'15" E	91.55'
C25	30.66'	11°16'49"	62.52'	N 05°23'41" E	52.23'
C26	10.90'	80°54'50"	15.39'	N 01°15'07" W	14.14'
C27	69.54'	56°14'53"	68.27'	N 14°57'12" E	65.56'
C28	33.37'	50°14'33"	29.26'	N 05°39'14" E	28.33'
C29	925.03'	16°56'29"	273.52'	N 23°47'22" E	272.52'
C30	347.92'	13°42'07"	83.20'	N 00°16'40" E	83.01'
C31	124.32'	79°26'16"	172.36'	N 33°21'01" E	158.88'
C32	425.00'	1°53'35"	14.04'	N 15°40'10" W	14.04'
C33	2,000.00'	17°47'31"	621.05'	N 89°09'59" W	618.56'
C34	450.00'	7°40'53"	60.33'	N 84°06'40" W	60.28'
C35	50.00'	89°54'18"	78.46'	S 47°05'44" W	70.65'
C36	450.00'	40°10'08"	315.49'	S 22°13'39" W	309.06'
C37	50.00'	93°56'59"	81.99'	S 04°39'47" E	73.11'
C38	450.00'	34°08'08"	268.10'	S 68°42'20" E	264.15'
C39	1,100.00'	3°15'23"	62.52'	N 88°32'09" W	62.51'
C40	1,500.00'	11°05'44"	290.48'	N 81°21'35" W	290.03'
C41	1,500.00'	10°37'45"	278.27'	S 01°05'17" E	277.87'
C42	700.00'	34°09'23"	417.30'	S 12°51'06" E	411.15'
C43	450.00'	16°06'00"	126.45'	S 04°55'51" E	126.03'
C44	1,500.00'	13°19'37"	348.90'	S 02°43'10" E	348.11'
C45	40.00'	91°33'09"	63.92'	N 16°40'46" E	57.33'
C46	740.00'	1°38'24"	21.18'	N 28°16'37" W	21.18'
C47	300.00'	12°46'32"	66.89'	N 21°04'09" W	66.75'
C48	300.00'	2°23'09"	12.49'	N 15°52'27" W	12.49'

CURVE TABLE					
CURVE	RADIUS	DELTA	ARC	CHORD BEARING	CHORD
C49	730.00'	12°20'27"	157.23'	N 10°53'48" W	156.93'
C50	25.00'	81°02'50"	35.36'	N 45°14'59" W	32.49'
C51	25.00'	91°06'27"	39.75'	S 48°40'22" W	35.70'
C52	425.00'	16°06'00"	119.42'	S 04°55'51" E	119.03'
C53	25.00'	57°58'15"	25.29'	S 41°57'59" E	24.23'
C54	50.00'	274°33'18"	239.59'	S 66°19'32" E	67.84'
C55	25.00'	38°35'03"	15.96'	N 05°18'40" E	15.69'
C56	475.00'	16°06'00"	133.47'	N 04°55'51" W	133.04'
C57	25.00'	88°53'33"	38.79'	N 41°19'38" W	35.01'
C58	25.00'	90°16'58"	39.39'	S 49°05'07" W	35.44'
C59	1,475.00'	11°13'27"	288.92'	S 01°40'04" E	288.46'
C60	25.00'	47°18'52"	20.64'	S 30°56'11" E	20.06'
C61	50.00'	278°22'06"	241.18'	S 83°35'26" W	66.67'
C62	25.00'	48°59'52"	21.38'	N 17°16'33" E	20.73'
C63	1,525.00'	11°10'01"	297.22'	N 01°38'23" W	296.75'
C64	25.00'	89°43'02"	39.15'	N 40°54'11" E	35.27'
C65	475.00'	32°18'49"	267.89'	N 69°37'00" W	264.35'
C66	25.00'	35°38'08"	15.55'	N 71°16'39" W	15.30'
C67	50.00'	136°29'59"	119.12'	N 20°50'44" W	92.88'
C68	425.00'	45°15'41"	335.73'	N 24°46'25" E	327.07'
C69	25.00'	30°30'37"	13.31'	N 13°06'43" W	13.16'
C70	50.00'	150°55'32"	131.71'	N 47°05'44" E	96.80'
C71	25.00'	30°30'37"	13.31'	S 72°41'46" E	13.16'
C72	475.00'	7°40'53"	63.68'	S 84°06'40" E	63.63'
C73	1,975.00'	17°47'31"	613.29'	S 89°09'59" E	610.83'
C74	25.00'	89°54'18"	39.23'	N 47°05'44" E	35.33'
C75	425.00'	7°40'53"	56.98'	S 84°06'40" E	56.94'
C76	2,025.00'	13°36'50"	481.15'	S 87°04'39" E	480.02'
C77	25.00'	87°28'54"	38.17'	S 50°08'37" E	34.57'
C78	1,470.00'	9°49'48"	252.20'	S 01°29'15" E	251.89'
C79	25.00'	89°39'54"	39.12'	S 48°15'36" W	35.25'
C80	1,475.00'	11°05'44"	285.64'	N 81°21'35" W	285.19'
C81	25.00'	81°14'33"	35.45'	N 35°11'27" W	32.55'
C82	475.00'	3°17'15"	27.25'	N 03°47'12" E	27.25'
C83	25.00'	87°15'47"	38.08'	N 60°33'23" E	34.50'
C84	1,525.00'	11°05'44"	295.32'	S 81°21'35" E	294.86'
C85	25.00'	91°08'03"	39.76'	S 41°20'26" E	35.70'
C86	730.00'	11°19'40"	16.92'	S 03°33'46" W	16.92'
C87	25.00'	91°19'40"	39.85'	S 48°33'46" W	35.76'
C88	425.00'	34°08'08"	253.21'	N 68°42'20" W	249.48'
C89	25.00'	93°56'59"	40.99'	N 04°39'47" W	36.55'
C90	475.00'	25°23'14"	210.47'	N 29°37'06" E	208.75'
C91	2,035.00'	0°29'24"	17.40'	N 81°24'40" E	17.40'
C92	2,025.00'	0°16'59"	10.00'	N 81°47'46" E	10.00'
C93	1,970.00'	1°00'59"	34.95'	N 81°25'46" E	34.95'
C94	1,075.00'	0°47'58"	15.00'	N 89°26'11" E	15.00'
C95	1,114.00'	0°46'17"	15.00'	N 89°27'01" E	15.00'

SIENNA SECTION 76

A SUBDIVISION OF 39.417 ACRES OF LAND SITUATED IN THE
DAVID FITZGERALD SURVEY, ABSTRACT 25, &
THE WILLIAM HALL SURVEY, ABSTRACT 31
FORT BEND COUNTY, TEXAS.

82 LOTS 7 RESERVES (13.902 ACRES) 3 BLOCKS
MAY 12, 2025 JOB NO. 1417-1576P

TOLL-GTIS PROPERTY OWNER, LLC
JIMMIE F. JENKINS, AUTHORIZED REPRESENTATIVE
10110 WEST SAM HOUSTON PARKWAY NORTH, SUITE 210, HOUSTON, TEXAS 77064
PH. (281) 894-8655



GBI PARTNERS

4724 VISTA ROAD
PASADENA, TX 77505
PHONE: 281-499-4539

T&PELS FIRM #10130300
GBISurvey@GBISurvey.com
www.GBISurvey.com

SURVEYOR:

ENGINEER:

JON BORDOVSKY, R.P.L.S.
REGISTERED PROFESSIONAL LAND SURVEYOR
TEXAS REGISTRATION NO. 6405

SCOTT FRANKOVICH, P.E.
LICENSED PROFESSIONAL ENGINEER
TEXAS REGISTRATION NO. 130312