

PLAT RECORDING SHEET

PLAT NAME: Fort Bend ISD Mission Bend Elementary

PLAT NO: _____

ACREAGE: 10.479

LEAGUE: John Leverton Survey

ABSTRACT NUMBER: 402

NUMBER OF BLOCKS: 1

NUMBER OF LOTS: 0

NUMBER OF RESERVES: 1

OWNERS: Fort Bend Independent School District

(DEPUTY CLERK)

STATE OF TEXAS §
COUNTY OF FORT BEND §

We, Fort Bend Independent School District, acting by and through Kristin K. Tassin, President and David Hamilton, Secretary, being officers of Fort Bend Independent School District, owners hereinafter referred to as Owners of the 10.479 acre tract described in the above and foregoing map of Fort Bend ISD Mission Bend Elementary, do hereby make and establish said subdivision and development plan of said property according to all lines, dedications, restrictions and notations on said map or plat and hereby dedicate to the use of the public forever, all streets (except those streets designated as private streets), alleys, parks, water courses, drains, easements and public places shown thereon for the purposes and considerations therein expressed; and do hereby bind ourselves, our heirs, successors and assigns to warrant and forever defend the title on the land so dedicated.

FURTHER, Owners have dedicated and by these presents do dedicate to the use of the public for public utility purpose forever unobstructed aerial easements. The aerial easements shall extend horizontally an additional eleven feet, six inches (11' 6") for ten feet (10' 0") perimeter ground easements or seven feet, six inches (7' 6") for fourteen feet (14' 0") perimeter ground easements or five feet, six inches (5' 6") for sixteen feet (16' 0") perimeter ground easements, from a plane sixteen feet (16' 0") above the ground level upward, located adjacent to and adjoining said public utility easements that are designated with aerial easements (U.E. and A.E.) as indicated and depicted hereon, whereby the aerial easement totals twenty one feet, six inches (21' 6") in width.

FURTHER, Owners have dedicated and by these presents do dedicate to the use of the public for public utility purpose forever unobstructed aerial easements. The aerial easements shall extend horizontally an additional ten feet (10' 0") for ten feet (10' 0") back-to-back ground easements, or eight feet (8' 0") for fourteen feet (14' 0") back-to-back ground easements or seven feet (7' 0") for sixteen feet (16' 0") back-to-back ground easements, from a plane sixteen feet (16' 0") above ground level upward, located adjacent to both sides and adjoining said public utility easements that are designated with aerial easements (U.E. and A.E.) as indicated and depicted hereon, whereby the aerial easement totals thirty feet (30' 0") in width.

FURTHER, Owners do hereby covenant and agree that all of the property within the boundaries of this plat shall be restricted to prevent the drainage of any septic tanks into any public or private street, road or alley or any drainage ditch, either directly or indirectly.

FURTHER, Owners do hereby dedicate to the public a strip of land twenty (20) feet wide on each side of the center line of any and all bayous, creeks, gullies, ravines, draws and drainage ditches located in said subdivision, as easements for drainage purposes. Fort Bend County or any other governmental agency shall have the right to enter upon said easement at any and all times for the purposes of construction and maintenance of drainage facilities and structures.

FURTHER, Owners do hereby covenant and agree that all of the property within the boundaries of this subdivision and adjacent to any drainage easement, ditch, gully, creek or natural drainage way shall hereby be restricted to keep such drainage ways and easements clear of fences, buildings, excessive vegetation and other obstructions to the operations and maintenance of the drainage facility and that such abutting property shall not be permitted to drain directly into this easement except by means of an approved drainage structure.

FURTHER, Owners do hereby acknowledge the receipt of the "Orders for Regulation of Outdoor Lighting in the Unincorporated Areas of Fort Bend County, Texas", and do hereby covenant and agree and shall comply with this order as adopted by Fort Bend County Commissioners Court on March 23, 2004, and any subsequent amendments.

IN TESTIMONY WHEREOF, the Fort Bend Independent School District has caused these presents to be signed by Kristin K. Tassin, its President, thereunto authorized, attested by its Secretary, David Hamilton, this ____ day of _____, 2024.

Fort Bend Independent School District

By: _____
Kristin K. Tassin
President

By: _____
David Hamilton
Secretary

STATE OF TEXAS §
COUNTY OF FORT BEND §

BEFORE ME, the undersigned authority, on this day personally appeared Kristin K. Tassin, President and David Hamilton, Secretary of the Fort Bend Independent School District, known to me to be the person whose names are subscribed to the foregoing instrument and acknowledged to me that they executed the same for the purposes and considerations therein expressed and in the capacity therein and herein stated, and as the act and deed of said corporation.

GIVEN UNDER MY HAND AND SEAL OF OFFICE, this ____ day of _____, 2024.

Notary Public in and for _____ County, Texas

(Print Name)

I, Joel D. Walker, am registered under the laws of the State of Texas to practice the profession of surveying and hereby certify that the above subdivision is true and accurate; was prepared from an actual survey of the property made under my supervision on the ground; that, except as shown all boundary corners, angle points, points of curvature and other points of reference have been marked with iron (or other objects of a permanent nature) pipes or rods having an outside diameter of not less than five eighths (5/8) inch and a length of not less than three (3) feet; and that the plat boundary corners have been tied to the Texas Coordinate System of 1983, south central zone.

Joel D. Walker _____ Date
Texas Registration No. 5189



NOTES:

- The coordinates shown hereon are Texas South Central Zone No. 4204, State Plane Coordinates (NAD83) and may be brought to surface (Local Coordinates) by dividing the depicted coordinate by the following combined scale factor of 0.99988240889 (X>S.F.=SURFACE VALUE).
- Bearings depicted hereon are based on Texas State Plane Coordinate System, South Central Zone (NAD83).
- Site plans shall be submitted to Fort Bend County and any other applicable jurisdiction for review and approval to obtain a Development Permit. Development Permits and all other applicable permits shall be obtained from Fort Bend County prior to beginning construction.
- The top of all floor slabs shall be a minimum of 94.00 feet above mean sea level (NAVD88 datum). In addition, no top of slab elevation shall be less than 24 inches above the lowest top of curb adjacent to the lot in which it lies. In the absence of a curb, the top of slab elevation shall be no less than 24 inches above the highest natural ground along the perimeter of the building foundation and 12" above any down gradient roadway or drainage restraint, whichever is higher.
- All Drainage Easements to be kept clear of fences, buildings vegetation and other obstructions to the operations and maintenance of the drainage facility.
- All property to drain into the drainage easement only through an approved structure.
- This property lies within Zone "X" unshaded as per flood insurance rate maps, map number 48157C0135L, dated April 2, 2014.
- There are no known pipelines or pipeline easements within the limits of the Plat boundary.
- This plat lies within Light Zone LZ3 of the Fort Bend County Lighting Ordinance.
- The property lies within:
 - Fort Bend County
 - County Assistance District No. 9
 - Mission Bend MUD 1
 - Harris-Fort Bend ESD 100
 - Fort Bend County School District
 - City of Houston ETJ
 - Utilities Copmany - CenterPoint Enerergy
- Sidewalks shall be built or caused to be built no less than 5 feet in width on both sides of all dedicated Rights-of-Way within said Plat and on the contiguous Right-of-Way of all perimeter roads surrounding said Plat, in accordance with the A.D.A.
- The drainage system for this subdivision is designed in the accordance with the Fort Bend County Drainage Criteria Manual which allows street ponding with intense rainfall events.
- Unless otherwise indicated, the building lines [B.L.], whether one or more, shown on this subdivision plat are established to evidence compliance with applicable provisions of Chapter 42, Code of Ordinances, City of Houston, Texas, in effect at the time this plat was approved, which may be amended from time to time.
- Absent written authorization by the affected utilities, all utility and aerial easements must be kept unobstructed from any non-utility improvements or obstructions by the property owner. Any unauthorized improvements or obstructions may be removed by any public utility at the property owner's expense. While wooden posts and paneled wooden fences along the perimeter and back to back easements and alongside rear lots lines are permitted, they too may be removed by public utilities at the property owner's expense should they be an obstruction. Public Utilities may put said wooden posts and paneled wooden fences back up, but generally will not replace with new fencing.
- Fort Bend ISD Shall have ownership and maintenance responsibility for all on-site storm water detention and drainage facilities, including proposed pump operations.

I, Matthew Zamaripa, a Professional Engineer registered in the State of Texas do hereby certify that this plat meets all requirements of Fort Bend County to the best of my knowledge.

Matthew Zamaripa, P.E. _____ Date
Texas Registration No. 141705

This is to certify that the Planning Commission of the City of Houston, Texas, has approved this plat and subdivision of Fort Bend ISD Mission Bend Elementary in conformance with the laws of the State of Texas and the ordinances of the City of Houston, as shown hereon, and authorized the recording of this plat this ____ day of _____, 20__.

Lisa M. Clark, Chair or, M. Sonny Garza, Vice-Chair

Jennifer Ostliind, AICP, Secretary

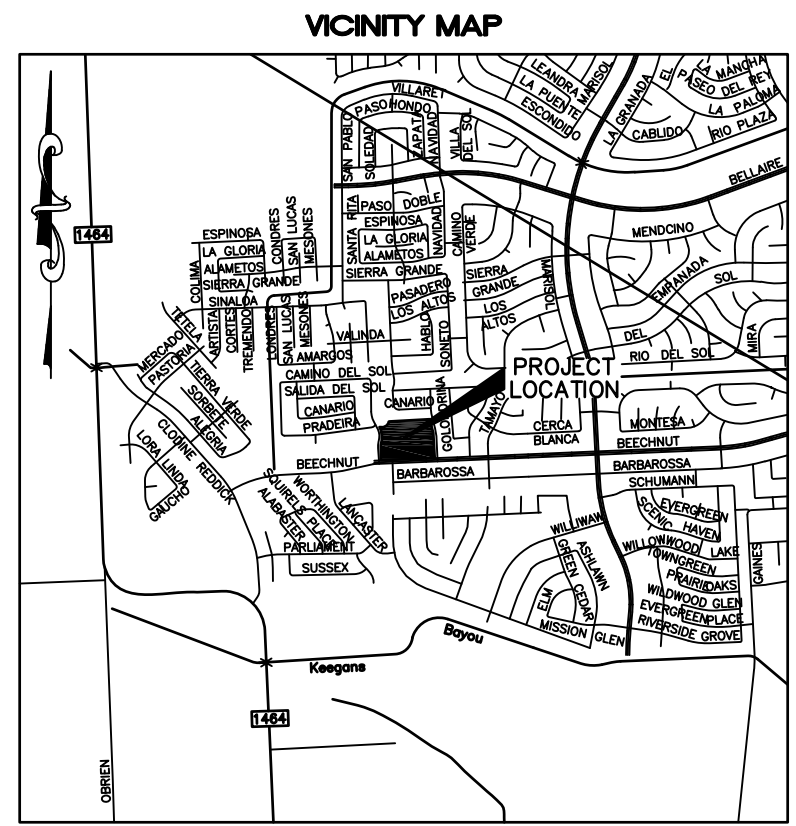

KEY MAP 527K
SCALE 1" = 3000'

I, J. Stacy Slawinski, Fort Bend County Engineer, do hereby certify that the plat of this subdivision complies with all of the existing rules and regulations of this office as adopted by the Fort Bend County Commissioners' Court. However, no certification is hereby given as to the effect of drainage from this subdivision on the intercepting drainage artery or parent stream or on any other area or subdivision within the watershed.

J. Stacy Slawinski
Fort Bend County Engineer

Approved by Commissioners' Court of Fort Bend County, Texas, this ____ day of _____, 2024.

Vincent M. Morales, Jr.
Precinct 1, County Commissioner

Grady Prestage
Precinct 2, County Commissioner

KP George
County Judge

W.A. "Andy" Meyers
Precinct 3, County Commissioner

Dexter L. McCoy
Precinct 4, County Commissioner

I, Laura Richard, County Clerk in and for Fort Bend County, hereby certify that the foregoing instrument with its certificate of authentication was filed for recordation in my office on _____, 20__, at _____ o'clock __.M. in Plat Number _____ of the plat records of Fort Bend County, Texas.

Witness my hand and seal of office, at Richmond, Texas. the day and date last above written.

Laura Richard
Clerk of the County
Fort Bend County, Texas

By: _____
Deputy

FORT BEND ISD MISSION BEND ELEMENTARY

A SUBDIVISION OF
10.479 ACRES
OUT OF THE
JOHN LEVERTON SURVEY,
ABSTRACT NO. 402
FORT BEND COUNTY, TEXAS

1 BLOCK 1 RESERVE

JUNE 2024



21020 PARK ROW _____ PHONE: (281) 509-8288
KATY, TEXAS 77449 _____ FAX: (281) 492-6026

CERTIFIED FIRM NO. 10073800

OWNER:
FORT BEND INDEPENDENT SCHOOL DISTRICT
16431 LEXINGTON BOULEVARD
SUGAR LAND, TEXAS 77479
281-684-1000

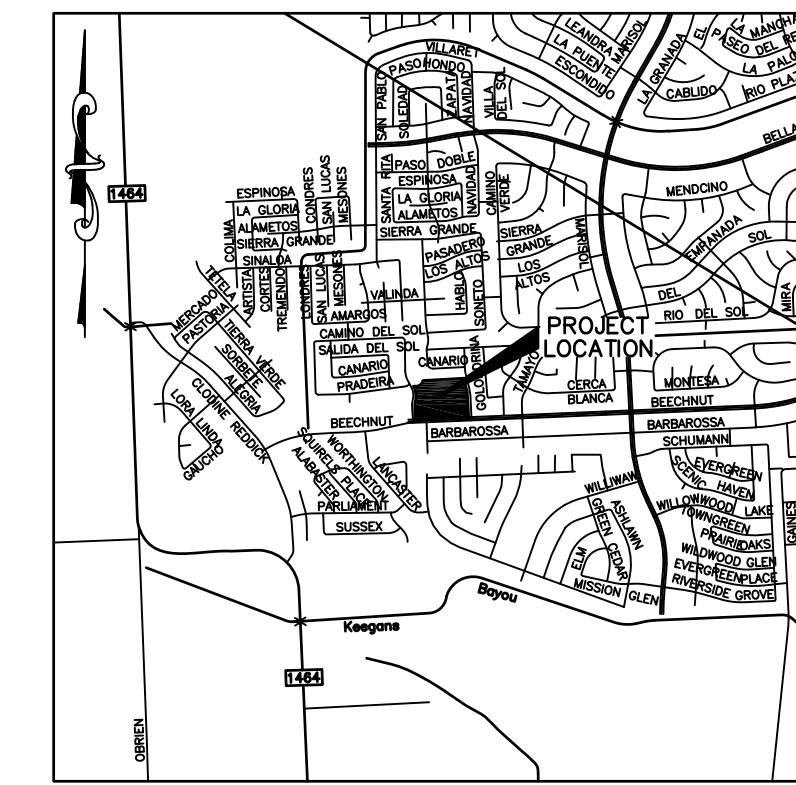

KEY MAP 527K
SCALE 1" = 3000'

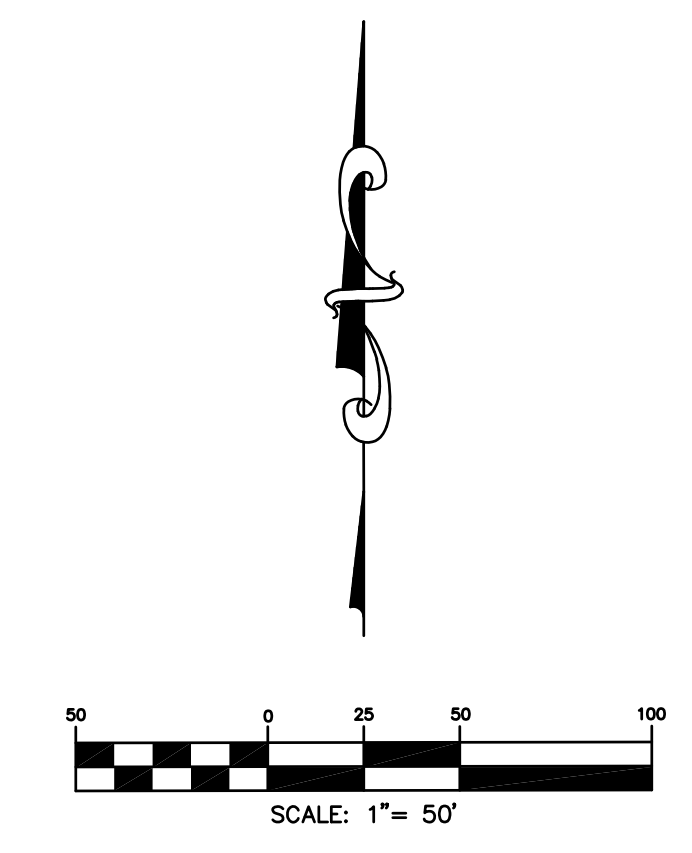

LINE TABLE

LINE	BEARING	LENGTH
L1	S42°33'09"W	14.14'
L2	N87°41'08"E	27.00'
L3	S42°33'10"W	35.36'
L4	S02°26'51"E	15.00'
L5	S87°33'11"W	15.00'

CURVE TABLE

CURVE	LENGTH	RADIUS	DELTA	CHORD BEARING	CHORD DISTANCE
C1	135.46'	85.00'	91°18'24"	N43°20'19"E	121.57'
C2	11.93'	1180.00'	0°34'46"	S13°58'00"E	11.93'

ABBREVIATIONS:

- B.L.—BUILDING LINE
- ESMT.—EASEMENT
- FND.—FOUND
- F.B.C.C.F.—FORT BEND COUNTY CLERK'S FILE
- F.B.C.D.R.—FORT BEND COUNTY DEED RECORDS
- F.B.C.P.R.—FORT BEND COUNTY PLAT RECORDS
- I.P.—IRON PIPE
- I.R.—IRON ROD
- No.—NUMBER
- PG.—PAGE
- R.O.W.—RIGHT-OF-WAY
- SQ. FT.—SQUARE FEET
- U.E.—UTILITY EASEMENT
- VOL.—VOLUME

FORT BEND ISD MISSION BEND ELEMENTARY

A SUBDIVISION OF
10.479 ACRES
OUT OF THE
JOHN LEVERTON SURVEY,
ABSTRACT No. 402
FORT BEND COUNTY, TEXAS

1 BLOCK 1 RESERVE

JUNE 2024



21020 PARK ROW KATY, TEXAS 77449
PHONE: (281) 509-8288
FAX: (281) 492-0026

CERTIFIED FIRM NO. 10073800

OWNER:
FORT BEND INDEPENDENT SCHOOL DISTRICT
16431 LEXINGTON BOULEVARD
SUGAR LAND, TEXAS 77479
281-684-1000

