

**PLAT RECORDING SHEET**

**PLAT NAME:** Sienna Retail Center

\_\_\_\_\_

**PLAT NO:** \_\_\_\_\_

**ACREAGE:** 7.735

\_\_\_\_\_

**LEAGUE:** David Fitzgerald League

\_\_\_\_\_

**ABSTRACT NUMBER:** 25

\_\_\_\_\_

**NUMBER OF BLOCKS:** 2

\_\_\_\_\_

**NUMBER OF LOTS:** 0

\_\_\_\_\_

**NUMBER OF RESERVES:** 6

\_\_\_\_\_

**OWNERS:** Toll-GTIS Property Owner, LLC

\_\_\_\_\_

\_\_\_\_\_  
**(DEPUTY CLERK)**



STATE OF TEXAS  
COUNTY OF FORT BEND

WE, TOLL-GTIS PROPERTY OWNER, LLC, A TEXAS LIMITED LIABILITY COMPANY, ACTING BY AND THROUGH JIMMIE F. JENKINS, AUTHORIZED REPRESENTATIVE, BEING AN OFFICER OF TOLL-GTIS PROPERTY OWNER, LLC, A TEXAS LIMITED LIABILITY COMPANY, OWNERS OF THE 7.735 ACRE TRACT DESCRIBED IN THE ABOVE AND FOREGOING PLAT OF SIENNA RETAIL CENTER, DO HEREBY MAKE AND ESTABLISH SAID SUBDIVISION PLAT OF SAID PROPERTY ACCORDING TO ALL LINES, DEDICATIONS, RESTRICTIONS AND NOTATIONS ON SAID PLAT AND HEREBY DEDICATE TO THE USE OF THE PUBLIC FOREVER, ALL STREETS, ALLEYS, PARKS, WATER COURSES, DRAINS, EASEMENTS AND PUBLIC PLACES SHOWN THEREON FOR THE PURPOSES AND CONSIDERATIONS THEREIN EXPRESSED; AND DO HEREBY BIND OURSELVES, OUR HEIRS AND ASSIGNS TO WARRANT AND FOREVER DEFEND THE TITLE TO THE LAND SO DEDICATED.

WE, FURTHER ACKNOWLEDGE THAT THE DEDICATIONS AND/OR EXACTIONS MADE HEREIN ARE PROPORTIONAL TO THE IMPACT OF THE SUBDIVISION UPON THE PUBLIC SERVICES REQUIRED IN ORDER THAT THE DEVELOPMENT WILL COMPORT WITH THE PRESENT AND FUTURE GROWTH NEEDS OF THE CITY; WE, OUR SUCCESSORS AND ASSIGNEES HEREBY WAIVE ANY CLAIM, DAMAGE OR CAUSE OF ACTION THAT WE MAY HAVE AS A RESULT OF THE DEDICATION OR EXACTIONS MADE HEREIN.

FURTHER, OWNERS HAVE DEDICATED AND BY THESE PRESENTS DO DEDICATE TO THE USE OF THE PUBLIC FOR PUBLIC UTILITY PURPOSES FOREVER UNOBSTRUCTED AERIAL EASEMENTS, THE AERIAL EASEMENTS SHALL EXTEND HORIZONTALLY AN ADDITIONAL ELEVEN FEET, SIX INCHES (11'6") FOR TEN FEET (10'0") PERIMETER GROUND EASEMENTS OR SEVEN FEET, SIX INCHES (7'6") FOR FOURTEEN FEET (14'0") PERIMETER GROUND EASEMENTS OR FIVE FEET, SIX INCHES (5'6") FOR SIXTEEN FEET (16'0") PERIMETER GROUND EASEMENTS, FROM A PLANE SIXTEEN FEET (16'0") ABOVE GROUND LEVEL UPWARD, LOCATED ADJACENT TO AND ADJOINING SAID PUBLIC UTILITY EASEMENTS THAT ARE DESIGNATED WITH AERIAL EASEMENTS (U.E. AND A.E.) AS INDICATED AND DEPICTED, HEREON, WHEREBY THE AERIAL EASEMENT TOTALS TWENTY ONE FEET, SIX INCHES (21' 6") IN WIDTH.

FURTHER, OWNERS HAVE DEDICATED AND BY THESE PRESENTS DO DEDICATE TO THE USE OF THE PUBLIC FOR PUBLIC UTILITY PURPOSE FOREVER UNOBSTRUCTED AERIAL EASEMENTS. THE AERIAL EASEMENTS SHALL EXTEND HORIZONTALLY AN ADDITIONAL TEN FEET (10'0") FOR TEN FEET (10'0") BACK-TO-BACK GROUND EASEMENTS, OR EIGHT FEET (8'0") FOR FOURTEEN FEET (14'0") BACK-TO-BACK GROUND EASEMENTS OR SEVEN FEET (7'0") FOR SIXTEEN FEET (16'0") BACK-TO-BACK GROUND EASEMENTS, FROM A PLANE SIXTEEN FEET (16'0") ABOVE GROUND LEVEL UPWARD, LOCATED ADJACENT TO BOTH SIDES AND ADJOINING SAID PUBLIC UTILITY EASEMENTS THAT ARE DESIGNATED WITH AERIAL EASEMENTS (U.E. AND A.E.) AS INDICATED AND DEPICTED HEREON, WHEREBY THE AERIAL EASEMENT TOTALS THIRTY FEET (30'0") IN WIDTH.

FURTHER, WE DO HEREBY COVENANT AND AGREE THAT ALL OF THE PROPERTY WITHIN THE BOUNDARIES OF THIS PLAT SHALL BE RESTRICTED TO PREVENT THE DRAINAGE OF ANY SEPTIC TANKS INTO ANY PUBLIC OR PRIVATE STREET, ROAD OR ALLEY OR ANY DRAINAGE DITCH, EITHER DIRECTLY OR INDIRECTLY.

FURTHER, WE DO HEREBY DEDICATE TO THE PUBLIC A STRIP OF LAND TWENTY (20) FEET WIDE ON EACH SIDE OF THE CENTER LINE OF ANY AND ALL BAYOUS, CREEKS, GULLIES, RAVINES, DRAWS AND DRAINAGE DITCHES LOCATED IN SAID SUBDIVISION, AS EASEMENTS FOR DRAINAGE PURPOSES. FORT BEND COUNTY OR ANY OTHER GOVERNMENTAL AGENCY SHALL HAVE THE RIGHT TO ENTER UPON SAID EASEMENT AT ANY AND ALL TIMES FOR THE PURPOSES OF CONSTRUCTION AND MAINTENANCE OF DRAINAGE FACILITIES AND STRUCTURES.

FURTHER, WE DO HEREBY COVENANT AND ACREE THAT ALL OF THE PROPERTY WITHIN THE BOUNDARIES OF THIS SUBDIVISION AND ADJACENT TO ANY DRAINAGE EASEMENT, DITCH, GULLY, CREEK OR NATURAL DRAINAGE WAY SHALL HEREBY BE RESTRICTED TO KEEP SUCH DRAINAGE WAYS AND EASEMENTS CLEAR OF FENCES, BUILDINGS, EXCESSIVE VEGETATION AND OTHER OBSTRUCTIONS TO THE OPERATIONS AND MAINTENANCE OF THE DRAINAGE FACILITY AND THAT SUCH ABUTTING PROPERTY SHALL NOT BE PERMITTED TO DRAIN DIRECTLY INTO THIS EASEMENT EXCEPT BY MEANS OF AN APPROVED DRAINAGE STRUCTURE.

FURTHER, WE DO HEREBY ACKNOWLEDGE THE RECEIPT OF THE "ORDERS FOR REGULATION OF OUTDOOR LIGHTING IN THE UNINCORPORATED AREAS OF FORT BEND COUNTY, TEXAS," AND DO HEREBY COVENANT AND AGREE AND SHALL COMPLY WITH THIS ORDER AS ADOPTED BY FORT BEND COUNTY COMMISSIONERS COURT ON MARCH 23, 2004 AND ANY SUBSEQUENT AMENDMENT.

IN TESTIMONY WHEREOF, TOLL-GTIS PROPERTY OWNER, LLC, A TEXAS LIMITED LIABILITY COMPANY, HAS CAUSED THESE PRESENTS TO BE SIGNED BY JIMMIE F. JENKINS, ITS AUTHORIZED REPRESENTATIVE, THEREUNTO AUTHORIZED,

THIS 3rd DAY OF October, 2023.

TOLL-GTIS PROPERTY OWNER, LLC  
A TEXAS LIMITED LIABILITY COMPANY

BY: J.F. Jenkins  
JIMMIE F. JENKINS, AUTHORIZED REPRESENTATIVE

STATE OF TEXAS  
COUNTY OF HARRIS

BEFORE ME, THE UNDERSIGNED AUTHORITY, ON THIS DAY PERSONALLY APPEARED JIMMIE F. JENKINS, AUTHORIZED REPRESENTATIVE OF TOLL-GTIS PROPERTY OWNER, LLC, A TEXAS LIMITED LIABILITY COMPANY, KNOWN TO ME TO BE THE PERSON WHOSE NAME IS SUBSCRIBED TO THE FOREGOING INSTRUMENT AND ACKNOWLEDGED TO ME THAT HE EXECUTED THE SAME FOR THE PURPOSES AND CONSIDERATIONS THEREIN EXPRESSED AND IN THE CAPACITY THEREIN AND HEREIN SET OUT.

GIVEN UNDER MY HAND AND SEAL OF OFFICE

THIS 3rd DAY OF October, 2023.

NOTARY PUBLIC IN AND FOR THE STATE OF TEXAS



I, JON P. BORDOVSKY, A REGISTERED PROFESSIONAL LAND SURVEYOR, AM AUTHORIZED UNDER THE LAWS OF THE STATE OF TEXAS TO PRACTICE THE PROFESSION OF LAND SURVEYING AND HEREBY CERTIFY THAT THE ABOVE SUBDIVISION IS TRUE AND CORRECT, WAS PREPARED FROM AN ACTUAL SURVEY OF THE PROPERTY MADE UNDER MY SUPERVISION ON THE GROUND AND THAT ALL BOUNDARY CORNERS, ANGLES, POINTS OF CURVATURE AND OTHER POINTS OF REFERENCE HAVE BEEN MARKED WITH IRON (OR OTHER SUITABLE PERMANENT METAL) PIPES OR RODS HAVING AN OUTSIDE DIAMETER OF NOT LESS THAN FIVE-EIGHTHS (5/8) INCH WITH PLASTIC CAP MARKED "GBI PARTNERS" AND A LENGTH OF NOT LESS THAN THREE (3) FEET. (SEE NOTE #9)

JON P. BORDOVSKY, R.P.L.S.  
REGISTERED PROFESSIONAL LAND SURVEYOR  
TEXAS REGISTRATION NO. 6405



I, ADAM M. HUTCHISON, A PROFESSIONAL ENGINEER REGISTERED IN THE STATE OF TEXAS DO HEREBY CERTIFY THAT THIS PLAT MEETS ALL REQUIREMENTS OF FORT BEND COUNTY TO THE BEST OF MY KNOWLEDGE.

ADAM M. HUTCHISON, P.E.  
LICENSED PROFESSIONAL ENGINEER  
TEXAS LICENSE NO. 102128



STATE OF TEXAS  
COUNTY OF FORT BEND

THIS IS TO CERTIFY THAT THE PLANNING AND ZONING COMMISSION OF THE CITY OF MISSOURI CITY, TEXAS, HAS APPROVED THIS PLAT AND SUBDIVISION OF SIENNA RETAIL CENTER IN CONFORMANCE WITH THE LAWS OF THE STATE OF TEXAS AND THE ORDINANCES OF THE CITY OF MISSOURI CITY AS SHOWN HEREON AND AUTHORIZED THE RECORDING OF THIS PLAT

THIS \_\_\_\_\_ DAY OF \_\_\_\_\_, 2023.

TIMOTHY R. HANEY  
CHAIR

JOHN O'MALLEY  
VICE CHAIR

NOTES:

- BENCHMARK: FOUND 3-1/2 INCH BRASS DISC LOCATED IN A POURED CONCRETE POST AT THE SOUTHWEST CORNER OF WATERS LAKE BOULEVARD AND THE EAST ENTRANCE TO THE RIDGE POINT HIGH SCHOOL IN SIENNA SURVEY MARKER NO. 11015.  
ELEV. = 59.15' (NAVD88 2001 ADJ.)
- T.B.M. = TEMPORARY BENCHMARK: SET BRASS DISK IN CONCRETE  
ELEV. = 56.90' (NAVD88, 2001 ADJ.)
- ALL BEARINGS REFERENCED TO THE TEXAS COORDINATE SYSTEM, SOUTH CENTRAL ZONE (NAD83). COORDINATES SHOWN ARE GRID AND MAY BE CONVERTED TO SURFACE BY APPLYING A FACTOR OF 0.999867651.
- THIS PLAT WAS PREPARED TO MEET CITY OF MISSOURI CITY AND FORT BEND COUNTY REQUIREMENTS.
- THIS PLAT WAS PREPARED FROM INFORMATION FURNISHED BY CHARTER TITLE COMPANY, FILE NO. 2023-0189 DATED APRIL 13, 2023. THE SURVEYOR HAS NOT ABSTRACTED THE ABOVE PROPERTY.
- THIS PLAT LIES WHOLLY WITHIN SIENNA PARKS & LEVEE IMPROVEMENT DISTRICT, FORT BEND SUBSIDENCE DISTRICT, FORT BEND COUNTY DRAINAGE DISTRICT, FORT BEND ISO, THE ETJ OF THE CITY OF MISSOURI CITY, FORT BEND COUNTY, AND SIENNA MUNICIPAL UTILITY DISTRICT NO. 4.
- IN ACCORDANCE WITH FEDERAL EMERGENCY MANAGEMENT AGENCY FLOOD INSURANCE RATE MAP, MAP NO. 48157C 0435L, REVISED DATE APRIL 2, 2014, PROPERTY LIES WITHIN SHADED ZONE "X" DEFINED AS AREAS OF 0.2% ANNUAL CHANCE FLOOD. THIS AREA IS SHOWN AS BEING PROTECTED FROM THE 1% ANNUAL CHANCE OR GREATER FLOOD HAZARD BY A LEVEE SYSTEM, OVERTOPPING OR FAILURE OF ANY LEVEE SYSTEM IS POSSIBLE. LIA DOES NOT WARRANT NOR SUBSCRIBE TO THE ACCURACY OR SCALE OF SAID MAPS.
- THERE ARE NO EXISTING OR PROPOSED PIPELINE EASEMENTS WITHIN THE LIMITS OF THE SUBDIVISION.
- FIVE EIGHTHS INCH (5/8") IRON RODS THREE FEET (3') IN LENGTH WITH A PLASTIC CAP MARKED "GBI PARTNERS" WILL BE SET ON ALL PERIMETER BOUNDARY CORNERS, LOT, BLOCK, AND RESERVE CORNERS WILL BE SET UPON COMPLETION OF ROAD CONSTRUCTION AND PRIOR TO LOT CONSTRUCTION.
- THE TOP OF ALL FLOOR SLABS SHALL BE A MINIMUM OF 56.83 FEET ABOVE MEAN SEA LEVEL (NAVD88 DATUM). IN ADDITION, NO TOP OF SLAB ELEVATION SHALL BE LESS THAN 24 INCHES ABOVE THE LOWEST TO OF CURB ADJACENT TO THE LOT IN LEVEE. IN THE ABSENCE OF A CURB, THE TOP OF SLAB ELEVATION SHALL BE NO LESS THAN 24 INCHES ABOVE HIGHEST NATURAL GROUND PERIMETER OF THE BUILDING FOUNDATION AND 12" ABOVE ANY DOWN GRADIENT ROADWAY OR DRAINAGE RESTRAINT, WHICHEVER IS HIGHER.
- ALL DRAINAGE AND FLOODWAY EASEMENTS SHALL BE KEPT CLEAR OF FENCES, BUILDINGS, PLANTINGS AND OTHER OBSTRUCTIONS TO THE OPERATIONS AND MAINTENANCE OF THE DRAINAGE FACILITY AS REQUIRED BY SUBSECTION 82-168(0) OF THE CODE OF ORDINANCES OF THE CITY OF MISSOURI CITY, TEXAS.
- THE DRAINAGE SYSTEM FOR THIS SUBDIVISION SHALL BE DESIGNED TO MEET THE REQUIREMENTS OF THE FORT BEND COUNTY DRAINAGE CRITERIA MANUAL WHICH ALLOWS STREET PONDING DURING INTENSE RAINFALL EVENTS.
- ALL PROPERTY TO DRAIN INTO THE DRAINAGE EASEMENT ONLY THROUGH AN APPROVED DRAINAGE STRUCTURE.
- THE CITY OF MISSOURI CITY SHALL NOT BE RESPONSIBLE FOR MAINTENANCE OF DRIVEWAYS, SIDEWALKS, EMERGENCY ACCESS EASEMENTS, RECREATIONAL AREAS, AND OPEN SPACE; AND THE SIENNA COMMUNITY ASSOCIATION, INC. SHALL BE RESPONSIBLE FOR SUCH MAINTENANCE OF DRIVEWAYS, SIDEWALKS, EMERGENCY ACCESS EASEMENTS, RECREATIONAL AREAS, AND OPEN SPACES AS REQUIRED BY SECTION 3.C(14) OF THE PLATTING MANUAL OF THE CITY OF MISSOURI CITY (SEPTEMBER 2019).
- SIDEWALKS SHALL BE BUILT OR CAUSED TO BE BUILT NOT LESS THAN 5- FEET IN WIDTH ON BOTH SIDES OF ALL DEDICATED RIGHTS-OF-WAY WITHIN SAID PLAT AND ON CONTIGUOUS RIGHT-OF-WAY OF ALL PERIMETER ROADS SURROUNDING SAID PLAT, IN ACCORDANCE WITH ADA REQUIREMENTS.
- SIDEWALKS SHALL BE CONSTRUCTED AS REQUIRED BY SECTION 82-164 OF THE CODE OF ORDINANCES OF THE CITY OF MISSOURI CITY, TEXAS.
- DRIVEWAY APPROACHES SHALL BE PROVIDED IN ACCORDANCE WITH THE MISSOURI CITY DRIVEWAY APPROACH POLICY AS REQUIRED UNDER THE PROVISIONS OF SUBSECTION 82-160 OF THE CODE OF ORDINANCES OF THE CITY OF MISSOURI CITY, TEXAS.
- IN ACCORDANCE WITH CENTERPOINT ENERGY ELECTRICAL SERVICE MANUAL, ARTICLE 421.2, ELECTRIC METERS SHALL BE LOCATED IN A POSITION THAT IS ACCESSIBLE AT ALL TIMES WITHOUT CUSTOMER ASSISTANCE. ACCESS TO THE METER SHALL NOT BE BLOCKED BY GATES, WALLS OR FENCES.
- ALL REQUIRED UTILITY COMPANIES HAVE BEEN CONTACTED AND ALL PUBLIC UTILITY EASEMENTS AS SHOWN ON THE ABOVE AND FOREGOING PLAT CONSTITUTE ALL OF THE EASEMENTS REQUIRED BY THE UTILITY COMPANIES CONTACTED AT THE TIME OF PLATTING.
- ALL OF THE PROPERTY SUBDIVIDED IN THE ABOVE AND FOREGOING PLAT IS WITHIN THE ETJ BOUNDARIES OF THE CITY OF MISSOURI CITY, TEXAS.
- NO BUILDING OR OTHER PERMIT, EXCEPT PERMITS FOR CONSTRUCTION OF PUBLIC IMPROVEMENTS WILL BE ISSUED BY THE CITY OF MISSOURI CITY, TEXAS, FOR CONSTRUCTION WITHIN THIS SUBDIVISION UNTIL SUCH TIME AS ALL PUBLIC IMPROVEMENTS OF THE SUBDIVISION HAVE BEEN CONSTRUCTED BY THE DEVELOPER AND ACCEPTED BY THE CITY OR THE GUARANTEE OF CONSTRUCTION OF PUBLIC IMPROVEMENTS REQUIRED BY SECTION 82-206 OF THE CODE OF ORDINANCES OF THE CITY OF MISSOURI CITY, TEXAS, IS SUBMITTED TO AND APPROVED BY THE CITY.
- PRIOR TO THE BEGINNING OF THE ONE-YEAR MAINTENANCE PERIOD FOR UTILITIES AND PAVING BY FORT BEND COUNTY, ALL BLOCK CORNERS AND STREET RIGHT-OF-WAY WILL BE MONUMENTED.
- ADEQUATE FIRE FLOWS SHALL BE PROVIDED ALONG THE ENTIRE LENGTH OF THE PROPOSED WATER LINE.
- REQUIRED FIRE FLOWS SHALL BE PROVIDED BASED ON THE SIZE AND CONSTRUCTION OF ALL BUILDINGS AS REQUIRED BY THE INTERNATIONAL FIRE CODE AS ADOPTED BY THE CITY.
- THE PLACEMENT OF FIRE HYDRANTS SHALL BE PROVIDED BASED ON THE MINIMUM DISTANCE REQUIREMENTS AS ESTABLISHED IN THE INTERNATIONAL FIRE CODE AS ADOPTED BY THE CITY (500FT. FOR RESIDENTIAL DEVELOPMENT AND 300FT. FOR COMMERCIAL DEVELOPMENT). ALL FIRE HYDRANTS SHALL BE INSTALLED ACCORDING TO THE INTERNATIONAL FIRE CODE AS ADOPTED BY THE CITY.
- THE DRIVEWAY FOR ANY LOT ON THE INSIDE OF A KNUCKLE MUST BE PLACED ALONG THE FRONTAGE PRIOR TO THE RIGHT TURN ON THE INSIDE APPROACH LANE TO AVOID SIGHT OBSTRUCTION SAFETY HAZARDS.
- STREET LIGHTING SHALL BE DESIGNED AND INSTALLED IN ACCORDANCE WITH THE CITY OF MISSOURI CITY INFRASTRUCTURE DESIGN MANUAL, CHAPTER 4 STREET LIGHTING AND OVERHEAD UTILITIES. THE INSTALLATION, OPERATION, AND MAINTENANCE OF ORNAMENTAL STREET LIGHTS SHALL NOT BE THE RESPONSIBILITY OF THE CITY OF MISSOURI CITY, EXCEPT AS PROVIDED THEREIN.
- THIS PLAT IS SUBORDINATED BY:  
U.S. BANK NATIONAL ASSOCIATION D/B/A HOUSING CAPITAL COMPANY, AS RECORDED IN FILE NO. \_\_\_\_\_ OF THE OFFICIAL RECORDS OF FORT BEND COUNTY, TEXAS.
- THIS PLAT LIES WITHIN LIGHTING ZONE 2.

30. THIS PLAT IS SUBJECT TO OVER AND ACROSS EASEMENTS AS SET FORTH BY THE RESTRICTED COVENANTS RECORDED UNDER FILE NO. 2015009259 AND 2019035843, F.B.C.O.R.

31. SITE PLANS SHALL BE SUBMITTED TO FORT BEND COUNTY AND ANY OTHER APPLICABLE JURISDICTION FOR REVIEW AND APPROVAL. DEVELOPMENT PERMITS AND ALL OTHER APPLICABLE PERMITS SHALL BE OBTAINED FROM FORT BEND COUNTY PRIOR TO BEGINNING CONSTRUCTION.

32. ALL SLAB ELEVATIONS SHALL BE ONE FOOT ABOVE THE 100 YEAR FLOOD ELEVATION ESTABLISHED BY FEMA AS PER SECTION 3.C(13) OF THE PLATTING MANUAL OF THE CITY OF MISSOURI CITY (SEPTEMBER 2019).

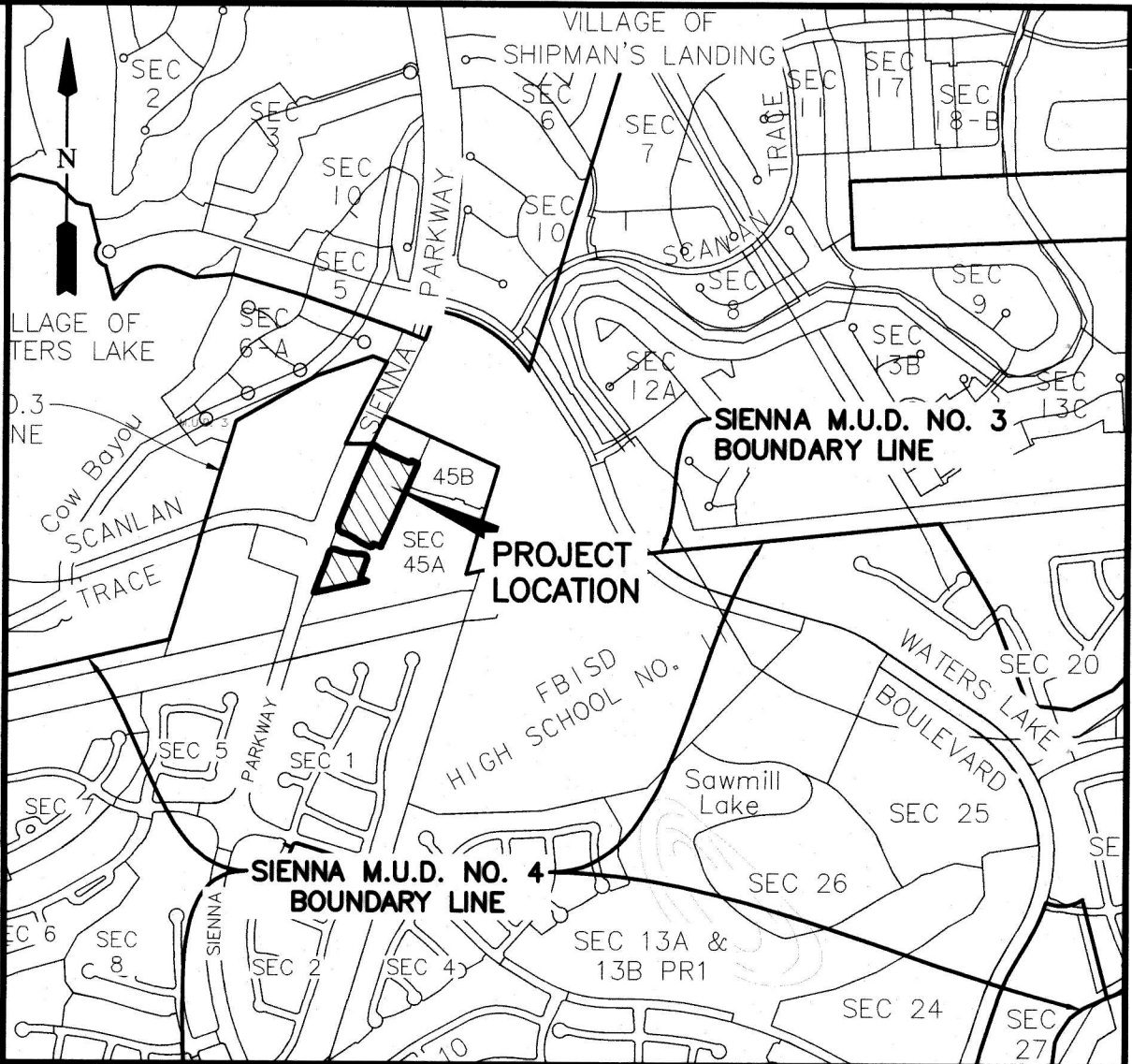

VICINITY MAP  
SCALE: 1"=1,200'

KEY MAP NO. 650P

I, J. STACY SLAWINSKI, FORT BEND COUNTY ENGINEER, DO HEREBY CERTIFY THAT THE PLAT OF THIS SUBDIVISION COMPLIES WITH ALL OF THE EXISTING RULES AND REGULATIONS OF THIS OFFICE AS ADOPTED BY THE FORT BEND COUNTY COMMISSIONERS' COURT. HOWEVER, NO CERTIFICATION IS HEREBY GIVEN AS TO THE EFFECT OF DRAINAGE FROM THIS SUBDIVISION ON THE INTERCEPTING DRAINAGE ARTERY OR PARENT STREAM OR ON ANY OTHER AREA OR SUBDIVISION WITHIN THE WATERSHED.

J. STACY SLAWINSKI, P.E.  
FORT BEND COUNTY ENGINEER

APPROVED BY THE COMMISSIONERS' COURT OF FORT BEND COUNTY, TEXAS,

THIS \_\_\_\_\_ DAY OF \_\_\_\_\_, 2023.

VINCENT M. MORALES, JR.  
PRECINCT 1, COUNTY COMMISSIONER

GRADY PRESTAGE  
PRECINCT 2, COUNTY COMMISSIONER

KP GEORGE  
COUNTY JUDGE

W.A. (ANDY) MEYERS  
PRECINCT 3, COUNTY COMMISSIONER

DEXTER L. MCCOY  
PRECINCT 4, COUNTY COMMISSIONER

I, LAURA RICHARD, COUNTY CLERK IN AND FOR FORT BEND COUNTY, HEREBY CERTIFY THAT THE

FOREGOING INSTRUMENT WITH ITS CERTIFICATE OF AUTHENTICATION WAS FILED FOR RECORDATION

IN MY OFFICE ON \_\_\_\_\_, 2023 AT \_\_\_\_\_ O'CLOCK \_\_\_\_\_ M. IN

PLAT NUMBER \_\_\_\_\_ OF THE PLAT RECORDS OF FORT BEND COUNTY, TEXAS.

WITNESS MY HAND AND SEAL OF OFFICE, AT RICHMOND, TEXAS. THE DAY AND DATE LAST ABOVE WRITTEN.

LAURA RICHARD, COUNTY CLERK  
FORT BEND COUNTY, TEXAS

BY: \_\_\_\_\_  
DEPUTY

## SIENNA RETAIL CENTER

A SUBDIVISION OF 7.735 ACRES OF LAND SITUATED IN THE  
DAVID FITZGERALD LEAGUE, ABSTRACT 25,  
FORT BEND COUNTY, TEXAS.

6 RESERVES (7.735 ACRES) 2 BLOCKS

SEPTEMBER 28, 2023

JOB NO. 1376-0020

OWNERS:

TOLL-GTIS PROPERTY OWNER, LLC

JIMMIE F. JENKINS, AUTHORIZED REPRESENTATIVE

10110 WEST SAM HOUSTON PARKWAY NORTH, SUITE 210, HOUSTON, TEXAS 77064

PH. (281) 894-8655

SURVEYOR:



GBI PARTNERS

4724 VISTA ROAD T8PELS FIRM #10130300  
PASADENA, TX 77505 GBI@gbipartners.com  
PHONE: 281-499-4539 www.GBISurvey.com

JON BORDOVSKY, R.P.L.S.  
REGISTERED PROFESSIONAL LAND SURVEYOR  
TEXAS REGISTRATION NO. 6405

ENGINEER:

LJA Engineering, Inc.

1904 W. Grand Parkway North Phone 713.953.5200  
Suite 100 Fax 713.953.5026  
Katy, Texas 77449 FRN - F-1386

ADAM M. HUTCHISON, P.E.  
LICENSED PROFESSIONAL ENGINEER  
TEXAS REGISTRATION NO. 102128

SHEET 1 OF 2

SIENNA RETAIL CENTER  
LJA JOB NO. 1376-0020



LAST SAVE: 9/28/2023 10:20 AM BY: LAUREL CHENEA - PLAT NO. 20130072 12:00 PM BY: LAUREL CHENEA  
FILE NAME: \\PROJUSK\PLATING\1376\PREP\SIENNA RETAIL CENTER.DWG



- LEGEND**
- B.L. INDICATES BUILDING LINE
  - U.E. INDICATES UTILITY EASEMENT
  - D.E. INDICATES DRAINAGE EASEMENT
  - W.L.E. INDICATES WATER LINE EASEMENT
  - S.S.E. INDICATES SANITARY SEWER EASEMENT
  - STM.S.E. INDICATES STORM SEWER EASEMENT
  - F.B.C.P.R. INDICATES FORT BEND COUNTY PLAT RECORDS
  - F.B.C.O.R. INDICATES FORT BEND COUNTY OFFICIAL RECORDS
  - F.B.C.O.P.R. INDICATES FORT BEND COUNTY OFFICIAL PUBLIC RECORDS
  - F.B.C.D.R. INDICATES FORT BEND COUNTY DEED RECORDS
  - F.N. INDICATES FILE NUMBER
  - RES. INDICATES RESERVE
  - F.M.E. INDICATES FORCE MAIN EASEMENT
  - P.O.B. INDICATES POINT OF BEGINNING
  - R.O.W. INDICATES RIGHT-OF-WAY
  - L.E. INDICATES LANDSCAPE EASEMENT

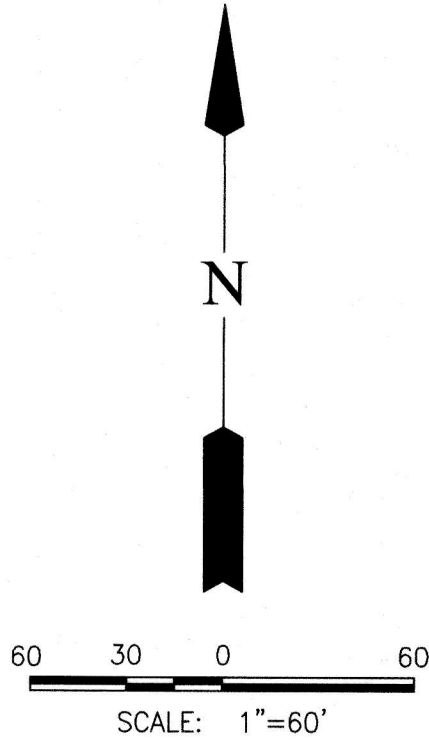

LINE TABLE		
LINE	BEARING	DISTANCE
L1	N 66°02'48" W	50.00'
L2	S 23°57'12" W	7.27'
L3	N 57°33'25" W	63.48'
L4	N 70°39'49" W	28.73'
L5	S 70°39'49" E	28.78'
L6	S 83°45'22" E	63.47'
L7	S 23°57'12" W	5.63'
L8	S 18°19'21" W	73.53'
L9	S 71°40'39" E	50.00'
L10	N 52°43'57" W	20.08'
L11	N 66°02'48" W	17.54'
L12	S 23°57'12" W	22.35'
L13	N 23°57'12" E	18.42'

CURVE TABLE				
CURVE	RADIUS	DELTA	ARC CHORD BEARING	CHORD
C1	25.00'	89°50'52"	S 68°52'38" W	35.31'
C2	300.00'	8°38'31"	N 61°52'40" W	45.21'
C3	300.00'	13°06'24"	N 64°06'37" W	68.48'
C4	35.00'	90°44'17"	N 25°17'40" W	49.82'
C5	7420.00'	6°08'14"	N 23°08'35" E	794.41'
C6	35.00'	90°44'14"	N 63°58'04" E	49.81'
C7	300.00'	13°05'33"	S 77°12'36" E	68.40'
C8	300.00'	6°44'36"	S 80°23'05" E	35.29'
C9	25.00'	100°57'59"	S 26°31'47" E	38.57'
C10	525.00'	5°37'50"	S 21°08'17" W	51.57'
C11	500.00'	3°31'40"	N 19°48'37" E	30.78'
C12	7420.00'	0°33'11"	N 18°19'22" E	71.62'
C13	18.50'	90°00'00"	S 68°57'12" W	26.16'
C14	98.50'	1°18'51"	N 59°23'23" W	22.84'
C15	101.50'	1°18'51"	N 59°23'23" W	23.53'
C16	74.50'	2°04'26"	S 12°24'59" W	29.80'
C17	50.50'	2°04'26"	S 12°24'59" W	20.20'
C18	48.50'	1°15'56"	N 14°19'14" E	16.23'
C19	76.50'	1°15'56"	N 14°19'14" E	25.60'
C20	18.50'	90°00'00"	N 21°02'48" W	26.16'

RESERVE TABLE			
RESERVE	ACREAGE	SQ.FT.	TYPE
A	1.343	58,486	RESTRICTED TO COMMERCIAL USE
B	0.704	30,681	RESTRICTED TO OPEN SPACE / ACCESS
C	2.799	121,944	RESTRICTED TO COMMERCIAL USE
D	1.044	45,478	RESTRICTED TO COMMERCIAL USE
E	0.360	15,693	RESTRICTED TO LANDSCAPE / OPEN SPACE / UTILITIES
F	1.484	64,640	RESTRICTED TO COMMERCIAL USE
TOTAL	7.735	336,922	

**SIENNA RETAIL CENTER**  
A SUBDIVISION OF 7.735 ACRES OF LAND SITUATED IN THE  
DAVID FITZGERALD LEAGUE, ABSTRACT 25,  
FORT BEND COUNTY, TEXAS.  
6 RESERVES (7.735 ACRES) 2 BLOCKS  
SEPTEMBER 28, 2023 JOB NO. 1376-0020  
OWNERS:  
TOLL-GTIS PROPERTY OWNER, LLC  
JIMMIE F. JENKINS, AUTHORIZED REPRESENTATIVE  
10110 WEST SAM HOUSTON PARKWAY NORTH, SUITE 210, HOUSTON, TEXAS 77064  
PH. (281) 894-8655

**SURVEYOR:**  
**GBI PARTNERS**  
4724 VISTA ROAD TPELS FIRM #10130300  
PASADENA, TX 77505 GBSurvey@GBISurvey.com  
PHONE: 281-499-4539 www.GBISurvey.com  
JON BORDOVSKY, R.P.L.S.  
REGISTERED PROFESSIONAL LAND SURVEYOR  
TEXAS REGISTRATION NO. 6405

**ENGINEER:**  
**LJA Engineering, Inc.**  
1904 W. Grand Parkway North  
Suite 100  
Katy, Texas 77449  
Phone 713.953.5200  
Fax 713.953.5026  
FRN - F-1386  
ADAM M. HUTCHISON, P.E.  
LICENSED PROFESSIONAL ENGINEER  
TEXAS REGISTRATION NO. 102128