



515 Reinhard St.
Rosenberg, TX 77471
832-600-7632

June 12, 2023

Re: Request for Temporary Road Lane Closure

To Whom it may concern:

On behalf of HTI Construction, Inc., we are requesting lane closure from Needville city limits which will include Highway 36 to Padon Rd. This lane will be designated for eastbound traffic only. The westbound lane will be closed at Padon Rd. and detour route will be designated from Padon Rd to Highway 36. Due to ongoing construction, this will be in effect for approximately 6 months.

We apologize for any inconvenience this may cause but greatly appreciate your cooperation. If you have any questions or concerns, please feel free to contact me at 832-600-7632.

Respectfully,

Thomas Gutierrez

Thomas Gutierrez
Vice President
832-600-7932

EXISTING POSTED SPEED LIMIT WITHIN PROJECT LIMITS = 30 MPH
 CONSTRUCTION ZONE DESIGN SPEED LIMIT = 30 MPH

NOTES:

1. ALL ADVANCE WARNING SIGNS TO BE SET PRIOR TO THE START OF CONSTRUCTION ACTIVITIES AND TO REMAIN IN PLACE UNTIL CONSTRUCTION ACTIVITIES ARE COMPLETED AND ACCEPTED BY FORT BEND COUNTY. THE CONTRACTOR WILL COORDINATE WITH FORT BENT COUNTY.
2. MAXIMUM PAVEMENT DROP-OFF SHALL NOT EXCEED 2".
3. ADVANCED SIGNING SHALL BE PLACED A MINIMUM OF TWO WEEKS IN ADVANCE TO INFORM OF POSSIBLE DELAY. CONTRACTOR SHALL NOTIFY THE FORT BEND COUNTY ENGINEERING DEPARTMENT AT LEAST TWO WEEKS PRIOR TO START OF ANY CONSTRUCTION.
4. IF WORK ZONE IS NEEDED TO STAY OVERNIGHT, DRUMS WITH VERTICAL PANELS AND TEMPORARY PAVEMENT MARKINGS SHALL BE IN PLACE FOR NIGHT TIME OPERATIONS AS DIRECTED BY THE ENGINEER
5. ACCESS TO EXISTING BUSINESSES OR RESIDENCES SHALL BE MAINTAINED AT ALL TIMES.
6. ALL PAVEMENT MARKINGS COVERED BY OVERLAY SHALL BE REPLACED BEFORE OPENING TO TRAFFIC.
7. SIGN R20-3T IS REQUIRED IN ADVANCE OF PROJECT LIMITS.

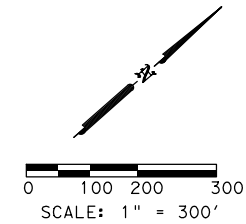

NO	REVISIONS	DATE	NAME
△	REVISION	/ /	INT

- SIGN ASSEMBLY
- EXIST. TRAFFIC DIRECTIONAL ARROW
- TYPE III BARRICADE
- CITY LIMITS

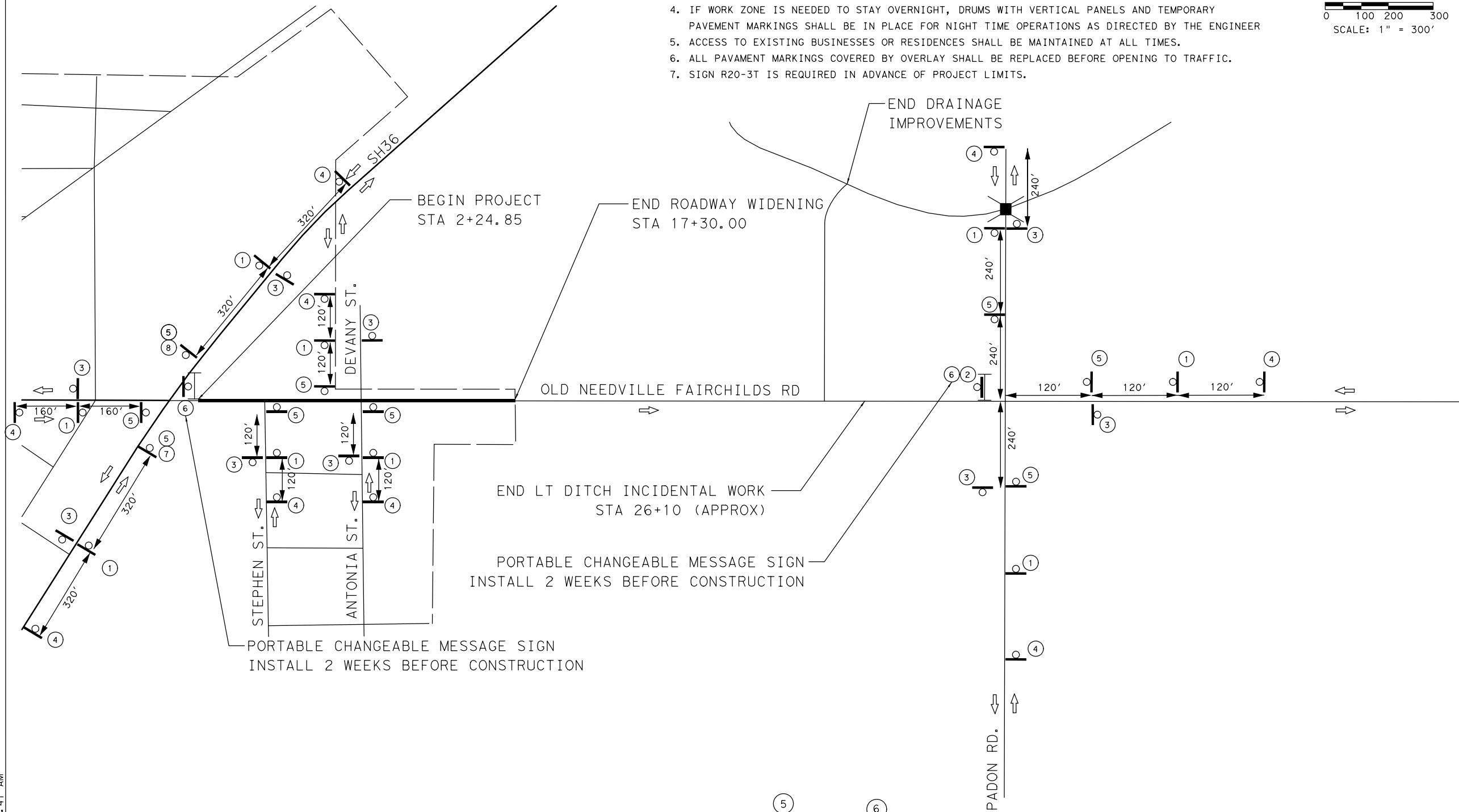

Murphy
8/18/2022



FORT BEND COUNTY
 2017 MOBILITY BOND PROJECT
 OLD NEEDVILLE FAIRCHILDS RD
 RECONSTRUCTION
 PROJECT NO. 17108

OLD NEEDVILLE FAIRCHILDS RD.
 TRAFFIC CONTROL PLAN
 ADVANCE WARNING SIGNS TCP 04

ISANI 10448 Westoffice Drive
 Houston, TX 77042
 P 713 747 2395 F 713 748 3748
 TBPE Firm Registration #4575



INFRASTRUCTURE
 TEXAS BOARD OF PROFESSIONAL ENGINEERS #: F-1582

PROJECT TITLE:	
DRAWN BY:	
CK'D BY:	SHEET DESCRIPTION:
SCALE:	
DATE:	APPROVED BY:
	SHEET NO: 20 / 120

FILE: P:\ACTIVE\18PV95\Working\Traffic Control Plan\95- TCP_AWS.DGN
DATE: 8/18/2022 11:54:41 AM

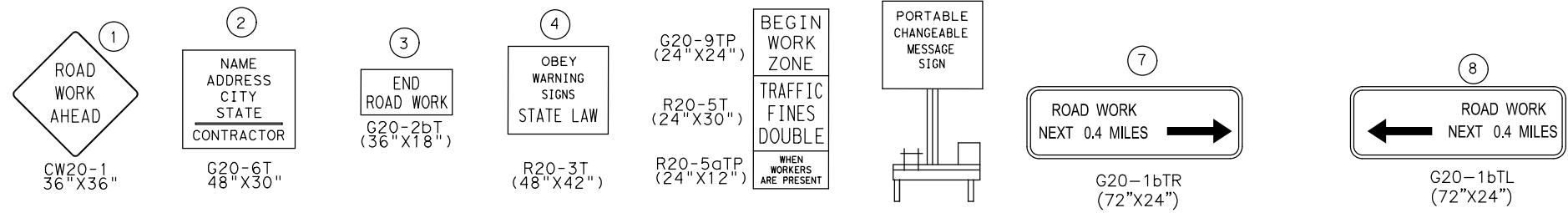

FILE: P:\ACTIVE\18PV95\Working\Traffic Control Plan\95-TCP_Detour plan.dgn
 DATE: 8/18/2022 11:54:41 AM

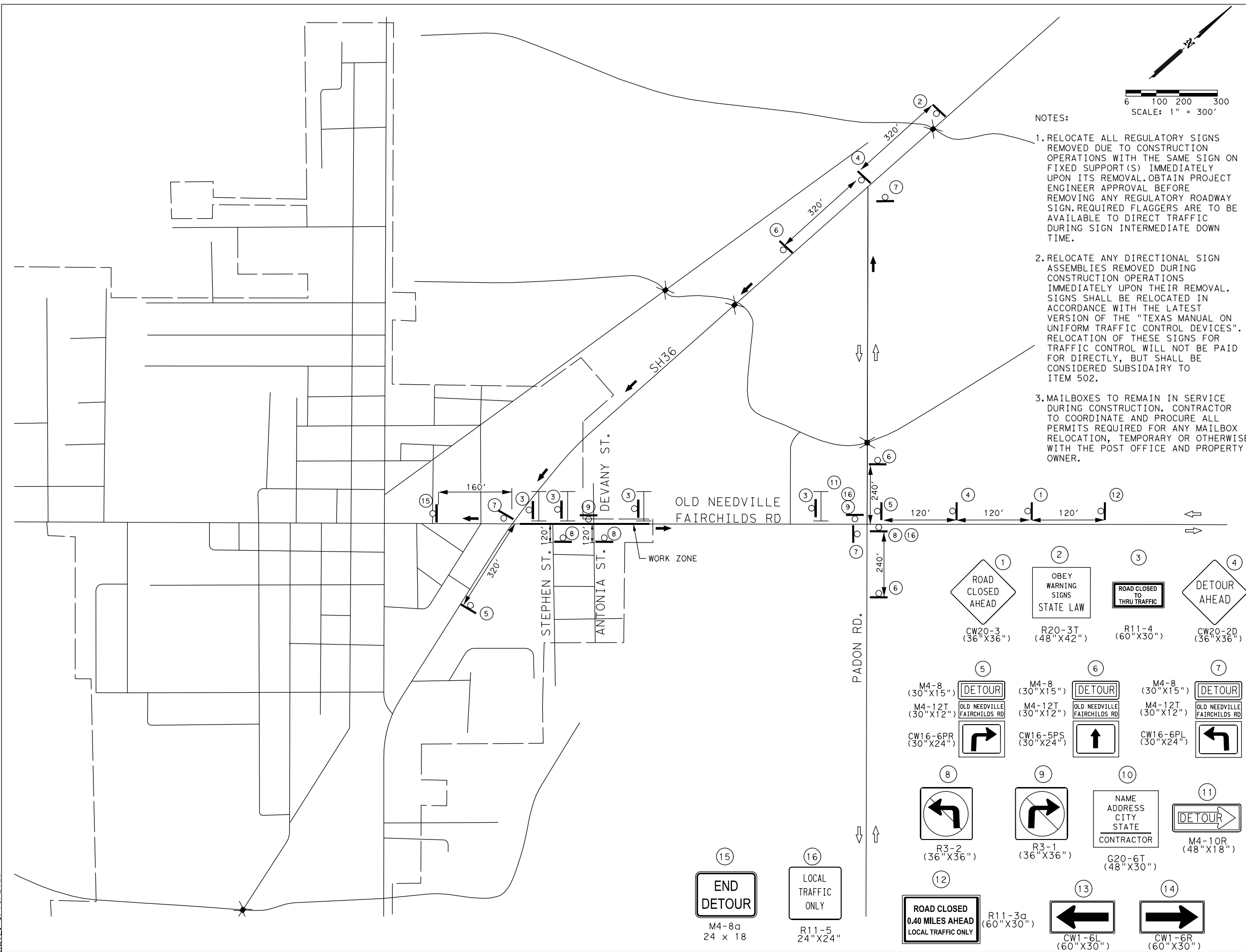

NOTES:

1. RELOCATE ALL REGULATORY SIGNS REMOVED DUE TO CONSTRUCTION OPERATIONS WITH THE SAME SIGN ON FIXED SUPPORT(S) IMMEDIATELY UPON ITS REMOVAL. OBTAIN PROJECT ENGINEER APPROVAL BEFORE REMOVING ANY REGULATORY ROADWAY SIGN. REQUIRED FLAGGERS ARE TO BE AVAILABLE TO DIRECT TRAFFIC DURING SIGN INTERMEDIATE DOWN TIME.
2. RELOCATE ANY DIRECTIONAL SIGN ASSEMBLIES REMOVED DURING CONSTRUCTION OPERATIONS IMMEDIATELY UPON THEIR REMOVAL. SIGNS SHALL BE RELOCATED IN ACCORDANCE WITH THE LATEST VERSION OF THE "TEXAS MANUAL ON UNIFORM TRAFFIC CONTROL DEVICES". RELOCATION OF THESE SIGNS FOR TRAFFIC CONTROL WILL NOT BE PAID FOR DIRECTLY, BUT SHALL BE CONSIDERED SUBSIDIARY TO ITEM 502.
3. MAILBOXES TO REMAIN IN SERVICE DURING CONSTRUCTION. CONTRACTOR TO COORDINATE AND PROCURE ALL PERMITS REQUIRED FOR ANY MAILBOX RELOCATION, TEMPORARY OR OTHERWISE, WITH THE POST OFFICE AND PROPERTY OWNER.

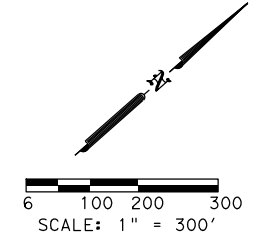

NO	REVISIONS	DATE	NAME
△	REVISION	/ /	INT

- SIGN ASSEMBLY
- PROP. DETOUR DIRECTIONAL ARROW
- TYPE III BARRICADE
- CITY LIMITS



Murphy
8/18/2022



FORT BEND COUNTY
 2017 MOBILITY BOND PROJECT
 OLD NEEDVILLE FAIRCHILDS RD
 RECONSTRUCTION
 PROJECT NO. 17108

OLD NEEDVILLE FAIRCHILDS RD.
 TRAFFIC CONTROL PLAN
 DETOUR LAYOUT
 TCP_05

ISANI
 10448 Westoffice Drive
 Houston, TX 77042
 P 713 747 2395 F 713 748 3748
 TBPE Firm Registration #4575



INFRASTRUCTURE
 TEXAS BOARD OF PROFESSIONAL ENGINEERS #: F-1582

PROJECT TITLE:		SHEET NO:	
DRAWN BY:	SHEET DESCRIPTION:	21 / 120	
DATE:	APPROVED BY:		

1 CW20-3 (36" X 36")	2 R20-3T (48" X 42")	3 R11-4 (60" X 30")	4 CW20-2D (36" X 36")
5 M4-8 (30" X 15") M4-12T (30" X 12") CW16-6PR (30" X 24")	6 M4-8 (30" X 15") M4-12T (30" X 12") CW16-5PS (30" X 24")	7 M4-8 (30" X 15") M4-12T (30" X 12") CW16-6PL (30" X 24")	
8 R3-2 (36" X 36")	9 R3-1 (36" X 36")	10 G20-6T (48" X 30")	11 M4-10R (48" X 18")
12 R11-3a (60" X 30")	13 CW1-6L (60" X 30")	14 CW1-6R (60" X 30")	
15 M4-8a 24 x 18	16 R11-5 24" X 24"		