



**COMMUNITY DEVELOPMENT &
REVITALIZATION**

**Hurricane Harvey Infrastructure
Application**

Texas General Land Office
P.O. Box 12873, Austin, Texas 78711-2873
1-844-893-8937 (Toll Free) or 512-475-5000
cdr@recovery.texas.gov

FBC ALERT2 Rain Gage Network - \$739,500
N. Rosenberg Water Distribution Impr Ph. 8 - \$447,802 (FBC-CDBG funding \$218,873)
Total GLO funding (CDBG-DR) = \$1,187,302

Fort Bend Co. _Amend01-20230608

APPLICANT NAME

Fort Bend

HGAC

COUNTY

COG/Regional Planning Commission

DR-4332 - 2017

Disaster Declaration Number(s) and Year



PROJECT DETAIL

PROJECT DETAIL must be completed for every proposed project.

A *project* is defined as a discrete combination of: entity (i.e., city or county), activity (i.e., water, sewer, etc.), beneficiary population, and national objective. A *site* is defined as a discrete location for activities within a project. A project can have one or more sites. For example, one water project that consists of three generators throughout a city consists of three sites, one for each generator.

Each Project Detail must provide sufficient information to clearly identify the proposed project, define the location, indicate whether acquisition (i.e. real property, easements or rights-of-way) is required, clearly describe the scope of work, specify the populations who will receive benefit from the project, identify environmental assessment information, and outline funding detail to include any non-CDBG-DR funds to be used.

1. Select the type of project proposed:

Flood and Drainage Facilities

2. Provide a title for the proposed project.

NOTE: For the title, the spelling and capitalization of the project title and any associated site number(s) identified in the application must be consistently used throughout the application to ensure clear identification of each project and site number. e.g., a project title of "Green Acres, Site 3" here should appear as "Green Acres, Site 3" at every other reference in this application. A reference to some other title such as "green acres subdivision" or "#3 Green Street" elsewhere in the application could cause delays in the eligibility review process.

Project Title:

FBC ALERT2 Rain Gage Network

3. Provide a physical address and the approximate GPS coordinates (in decimal degrees) for each proposed site along with project and beneficiary maps.

If the proposed project includes only one site, include the physical address and the GPS coordinates (in decimal degrees) for the site.

If the proposed project does not have a physical address, provide a site description.

If the proposed project includes more than one site, start with Site #1 from the drop-down list and **use the + button to add additional sites.**

Use sequential numbering for additional sites.

For proposed work involving a length of road, ditch, channel, etc., use the approximate midpoint coordinates for latitude and longitude, but identify the entire length of the proposed work and the assigned site number on the project map. Identify these type of sites in the application by completing the On-From-To fields. For instance, "On Main Street From Sycamore Street To Elm Street."

Attach project/site and beneficiary map(s) as described in the Application Guide.

Use the X button to remove a site as needed.

Site #	<input type="text"/>	Physical Address or Site Description	FBC ALERT2 Rain Gage Network - See attached map for project sites (30 locations)
--------	----------------------	--------------------------------------	----------------------------------------------------------------------------------

From:	<input type="text"/>	To:	<input type="text"/>
-------	----------------------	-----	----------------------

Latitude	<input type="text"/>	Longitude	<input type="text"/>
----------	----------------------	-----------	----------------------

Construction Completion Method: Contract

Provide a detailed description of the scope of work proposed. For proposed work involving a length of road, ditch, channel, etc., report the scope of the project in linear feet (lf).

Fort Bend County and the Fort Bend County Drainage District (FBCDD), in cooperation with the Harris County Flood Control District (HCFCD), would like to expand the existing Harris County ALERT2 Flood Warning System (FWS) (<https://www.harriscountyfws.org/>) in Fort Bend County. Currently, there is an incomplete network of rain/flood gauging stations in Fort Bend County, which are owned/maintained by Fort Bend

County, National Weather Service, City of Sugar Land, HCFCD, Texas Department of Transportation, and the Lower Colorado River Authority. This proposed project would add 30 ALERT2 rain/flood gauging stations.

Expanding the FWS in Fort Bend County will allow the County to have access to accurate, real-time rainfall and stage data to facilitate crucial decision making before, during, and after flooding incident. The proposed gauging stations will be connected to the existing FWS website and will be used to inform residents of imminent and current flooding conditions along roads and bayous and to better coordinate evacuation efforts. Two of the proposed stations are located where fatalities have occurred during recent events. There is a reasonable expectation that future loss of life or injury will be reduced or prevented by availability of the real-time data provided by the installation of gauging stations in these and other areas of Fort Bend County. Currently, the County relies on first responders or other County personnel in the field to report on road conditions. Many of the 30 gauging stations have been proposed near major roadways. Having an online resource to compare stage data with roadway elevations will allow the FBCDD to more quickly and safely identify inundated roadways and reroute evaluation efforts.

The 30 gauging stations will monitor stream and bayou water level with bubbler or radar sensors, or a pressure transducer. Rainfall data is transmitted every time 0.04 in. of rain is measured, while stage is transmitted every time level changes by 0.10 ft of water. Data from all stations in the FWS is transmitted from the gauging sites to three repeater stations in the Huffman, Galveston, and Clodine areas. The repeater stations pass the measurement data along to primary and backup base stations located at Houston Transtar and the Harris County Appraisal District. Once the data arrives at a base station it is ingested into the system's processing, archiving and dissemination software. The locations of the proposed FBC rain/flood gauging stations were chosen based on a number of factors:

- Proximity to major roadway stream crossings;
- Geographic distribution for optimum rainfall characterization;
- Areas of high population growth;
- Locations where fatalities have occurred during recent flood events; and
- Proximity to main evacuation routes.

The benefits of this project will not be isolated to active incidents however. FBCDD is currently updating Master Drainage Plans and floodplain studies on all local watersheds. Archived rainfall and corresponding flood level data will be invaluable to these studies and ensuring public and private infrastructure is adequately designed to minimize localized flooding in the future. In addition, the data from the gauges could be utilized in the on-going implementation of NWS Atlas 14 rainfall updates. Finally, the stage elevation data provided by these stations will allow the FBCDD to better document rainfall-runoff elevation response in the watersheds. Other data captured by the stations will also be able to calibrate a variety of hydraulic and hydrologic models the FBCDD uses to prioritize, site, design and construct flood mitigation projects in Fort Bend County.

The proposed budget includes equipment for the ALERT2 gauging stations, installation costs, and the labor costs to conduct the necessary performance assessment and calibration of equipment for two years. HCFCD has committed to doing the installation, performance assessment, and calibration on all installed equipment for a two-year period. HCFCD and FBCDD have an interlocal agreement on file that formalizes this arrangement.

NATIONAL OBJECTIVES

Choose one National Objective being met and provide justification of the beneficiary identification method used to meet that National Objective.

1. Activities benefiting low-to-moderate income persons.

Method(s) used to determine the beneficiaries:

LMI Area Benefit: LMI Housing Activity: LMI Limited Clientele: LMI Jobs:

2. Prevention/Elimination of Slums or Blighted areas. Area Basis Spot Basis

Has the proposed project area been officially designed as a slum or blighted area?

Yes No

If yes, what conditions are present in the area to designate and qualify the area as a slum or blighted area?

NA

Describe the boundaries of the slum or blighted area. (Do not use this field to document the Census Tract / Block Group data.)

NA

Enter the percentage of deteriorated buildings/properties in the area at the time it was designated a slum or blighted area.
[Enter value as a decimal number. Example: .2526 = 25.26%]

0.00%



If the activity qualifies for CDBG-DR assistance on the basis that public improvements throughout the area are in a general state of deterioration, enter a description of each type of improvement in the area and its condition at the time the area was designated a slum or blighted area.

NA

Enter the year the area was designated as a slum or blighted area. If the period during which such designations are valid has lapsed, the applicant entity must re-evaluate and re-designate the area.

3. Urgent Need

Do the existing conditions pose a serious and immediate threat to the health or welfare of the community?

Yes No

Were the existing conditions officially identified by the applicant as being of urgent need within 18 months of the event? If yes, provide that documentation.

Yes No

Is the applicant able to finance the project on their own? Or are other sources of funding available?

Yes No

Provide justification of the beneficiary identification method used to meet this National Objective:

NA

ACQUISITION/UNIFORM RELOCATION ASSISTANCE



Activities and projects assisted by CDBG-DR are subject to the Uniform Relocation Assistance and Real Property Acquisition Policies Act of 1970, as amended, (42 U.S.C. 4601 *et seq.*) ("URA") and section 104(d) of the HCD Act (42 U.S.C. 5304(d)) (Section 104(d)). The implementing regulations for the URA are at 49 CFR part 24. The regulations for Section 104(d) are at 24 CFR part 42, subpart C.

For the purpose of promoting the availability of decent, safe, and sanitary housing in response to Hurricane Harvey, HUD has waived the following URA and Section 104(d) requirements for subrecipients:

- a. *One-for-one replacement.* The one-for-one replacement requirements at section 104(d)(2)(A)(i) and (d)(3) of the HCD Act and 25 CFR 42.375 are waived in connections with funds utilized for lower-income dwelling units that are damaged by the disaster and deemed not suitable, per the definition provided by the GLO, for rehabilitation.
- b. *Relocation assistance.* The relocation assistance requirements at section 104(d)(2)(A) of the HCD Act and 24 CFR 42.350 are waived to the extent that they differ from the requirements of the URA. The URA and its implementing regulations are the sole standard for relocation assistance for projects in this program.
- c. *Arm's Length Voluntary Purchase.* The requirements at 49 CFR 24.101(b)(2)(i) and (ii) are waived to the extent that they apply to a purchase carried out by a person who uses CDBG-DR funds and does not have the power of eminent domain.
- d. *Rental Assistance for Displaced Persons.* Section 414 of the Stafford Act (42 U.S.C 5181) is waived and homeowner occupants and tenants displaced from their homes as a result of Hurricane Harvey who would have otherwise been displaced as a direct result of any acquisition, rehabilitation, or demolition of real property for a federally funded program or project may be eligible for replacement housing notwithstanding their inability to meet occupancy requirements prescribed in the URA.
- e. *Tenant-Based Rental Assistance.* Sections 204 and 205 of the URA, 49 CFR 24.2(a)(6)(vii) , 24.2(a)(6)(ix), and 24.402(b) are waived to the extent necessary to permit a grantee to meet all or a portion of the replacement housing payment obligation to a displaced tenant by offering rental housing assistance provided that comparable replacement dwellings are made available to the tenant in compliance with 49 CFR 24.204(a).
- f. *Moving Expenses.*
- g. *Optional Relocation Policies.* 24 CFR 570.606(d) is waived and grantees receiving CDBG-DR funds may, but are not required to, establish optional relocation policies.

Does the project require acquisition of property, purchase of easements, relocation, or any other activity requiring compliance with URA outside the listed waived activities? Yes No

If yes, has acquisition of the project site(s) been completed, in progress, or will need to be acquired?

Select acquisition status: Previously Acquired Acquisition in Progress To be Acquired

Describe the type and purpose of all acquisition (easements, real property, etc.) associated with the proposed project. For acquisitions "Previously Acquired" or "Acquisition in Progress," include detailed information and supporting documentation to ensure compliance with all URA, 42 U.S.C. § 4601 *et seq.* and environmental review processes.

NA

RESIDENTIAL ANTI-DISPLACEMENT AND RELOCATION ASSISTANCE PLAN



By signing this application, the signee certifies that they will establish and maintain a Residential Anti-displacement and Relocation Assistance Plan to minimize direct and indirect displacement of persons from their homes by including the steps noted below. Applicability of items on this checklist is dependent upon the proposed project objectives and related feasibility of each action.

- o Coordinate code enforcement with rehabilitation and housing assistance programs.
- o Evaluate housing codes and rehabilitation standards in reinvestment areas to prevent undue financial burden on established owners and tenants.
- o Stage rehabilitation of apartment units to remain in the building/complex during and after rehabilitation, working with empty units first.
- o Arrange for facilities to house persons who must be relocated temporarily during rehabilitation.
- o Adopt policies to identify and mitigate displacement resulting from intensive public investment in neighborhoods.
- o Adopt policies which provide protections for tenants faced with conversion to condominium or cooperative.
- o Adopt tax assessment policies, such as deferred tax payment plans, to reduce impact of increasing property tax assessments on lower income owner-occupants or tenants in revitalization areas.
- o Establish counseling centers to provide homeowners and tenants with information on assistance available to help them remain in their neighborhood.
- o Where feasible, give priority to rehabilitation of housing, as opposed to demolition, to avoid displacement.
- o If feasible, demolish or convert only dwelling units that are not occupied or vacant occupiable "dwelling units" (as defined in 24 CFR 42.305).
- o Target only those properties deemed essential to the need or success of the project.

PERMITS AND ADDITIONAL PROJECT INFORMATION

1. Does the project require any Federal, State, or other **permits, approvals, or waivers** to complete the proposed work? Yes No
 (i.e. Texas Department of Transportation, Texas Commission on Environmental Quality, U.S. Army Corps of Engineers, etc.)

If yes, describe the type and purpose of each permit and its association with the proposed project. Provide a copy of each permit already executed.

Permit Type:

Purpose of Permit:

2. Does the project require any type of ratified, legally binding **agreement** between the applicant and any other entity to provide continual operation upon completion? (i.e. Memoranda of Understanding, Interlocal Agreements, etc.) Yes No

If yes, describe the type and purpose of each agreement and its association with the proposed project. Provide a copy of each agreement already executed or drafted.

Agreement Type:

Purpose of Agreement:

3. For sewer and/or water facilities projects, does the applicant currently hold the Certificate of Convenience and Necessity (CCN) for the target area proposed in the application? If not, provide written documentation from the Public Utility Commission of Texas (PUC) verifying the application has been filed. Yes No N/A

ENVIRONMENTAL SPECIFIC INFORMATION

All funded applications MUST comply with federal regulations regarding environmental clearance before funds will be released.

NOTE: An Environmental Exemption form providing clearance for planning and administration activities must be attached.

1. What is the current status of the project? Not yet begun In progress Completed

2. Will the assistance requested have any negative impact(s) or effect(s) on the environment? YES NO

3. Is the proposed project likely to require an archaeological assessment? YES NO

4. Is the proposed site listed on the National Register of Historic Places? YES NO

5. Is the project in a designated flood hazard area or a designated wetland?
If Yes, attach a map showing the FIRM and/or list permitting requirements in "Other Project Approvals Required" below. YES NO
7. Is any project site located in a known critical habitat for endangered species? YES NO
8. Is any project site a known hazardous site? YES NO
9. Is any project site located on federal lands or at a federal installation? YES NO
10. Is any project site subject to or participating in Fixing America's Surface Transportation Action (FAST-41) (P.L. 114-94)? NO YES

11. What level of environmental review is likely needed for this project/site? Categorical Exclusion

Provide any additional detail or information relevant to Environmental Review:

Click here to ADD ANOTHER Project Detail
Click here to REMOVE the last Project Detail



TABLE 1 - CONTRACT BUDGET AND BENEFICIARY IDENTIFICATION

Provide comprehensive budget information to include construction, engineering, acquisition, environmental services, and administrative costs. Also include all other funds (FEMA, insurance, local, etc.) committed to the completion of the proposed projects.

A *project* is defined as a discrete combination of: entity (i.e., city or county), activity (i.e., water, sewer, etc.), beneficiary population, and national objective. A *site* is defined as a discrete location for activities within a project. A project can have one or more sites.

BUDGET TABLE:

Project Title:	Total Benes	LMI Benes	LMI %	CDBG-DR Construction	CDBG-DR Engineering	CDBG-DR Acquisition	CDBG-DR Environmental	CDBG-DR Admin	Total CDBG-DR Request	Other Funds	Activity Total
# 1 FBC ALERT2 Rain Gage Network	2,574,800	1,347,000	52.32%	\$739,500.00	\$0.00	\$0.00	\$0.00	\$0.00	\$739,500.00	\$0.00	\$739,500.00
# 2 N. Rosenberg Water Distribution Imp. Phase8	2,655,000	1,510,000	56.87%	\$447,802.00	\$0.00	\$0.00	\$0.00	\$0.00	\$447,802.00	\$218,873.00	\$666,675.00
SUMMARY TOTALS:	2,577,400	1,348,500	52.32%	\$1,187,302.00	\$0.00	\$0.00	\$0.00	\$0.00	\$1,187,302.00	\$218,873.00	\$1,406,175.00

Beneficiary Identification Method(s) Per Project:

1 Project Title: FBC ALERT2 Rain Gage Network

HUD National Objective: Benefiting low- and moderate- (L/M) income persons

Select One Benefit Type: City-wide Benefit County-wide Benefit Area Benefit Direct Benefit

Select Beneficiary Identification Method:

- SURVEY: An approved TxCDBG survey was used to identify the beneficiaries for this activity.
- HUD LMISD information was used to identify the beneficiaries for this activity.
- The required Census or Texas State Data Center map has been provided.

Provide the number of beneficiaries identified through each of the following methods for this activity:

TxCDBG Survey: 0 HUD LMISD: 0 Area Benefit: 0 Housing Activity: 0 Limited Clientele: 0

Race	# Non-Hispanic Beneficiaries	# Hispanic Beneficiaries	Total Activity Beneficiaries
	0	0	0
	0	0	0
Gender	Total Males	Total Females	Total Benes
	0	0	0

REQUIRED - Census Geographic Area Data
Identify the census tract and block group(s) in which the project will take place

County Code: 157

Census Tract (6-digit)	01	02	03	04	05	06	07	08	09	10
	<input type="checkbox"/>	<input type="checkbox"/>	<input type="checkbox"/>	<input type="checkbox"/>	<input type="checkbox"/>	<input type="checkbox"/>	<input type="checkbox"/>	<input type="checkbox"/>	<input type="checkbox"/>	<input type="checkbox"/>
Census Tract (6-digit)	01	02	03	04	05	06	07	08	09	10
	<input type="checkbox"/>	<input type="checkbox"/>	<input type="checkbox"/>	<input type="checkbox"/>	<input type="checkbox"/>	<input type="checkbox"/>	<input type="checkbox"/>	<input type="checkbox"/>	<input type="checkbox"/>	<input type="checkbox"/>



Project Title:

HUD National Objective

Select One Benefit Type: City-wide Benefit County-wide Benefit Area Benefit Direct Benefit

Select Beneficiary Identification Method:

SURVEY: An approved TxCDBG survey was used to identify the beneficiaries for this activity.

HUD LMISD information was used to identify the beneficiaries for this activity.

The required Census or Texas State Data Center map has been provided.

Provide the number of beneficiaries identified through each of the following methods for this activity:

TxCDBG Survey: 0 HUD LMISD: 0 Area Benefit: 0 Housing Activity: 0 Limited Clientele: 0

Race	# Non-Hispanic Beneficiaries	# Hispanic Beneficiaries	Total Activity Beneficiaries
	0	0	0
	<input type="text" value="0"/>	<input type="text" value="0"/>	<input type="text" value="0"/>
Gender	Total Males	Total Females	Total Benes
	0	0	0

REQUIRED - Census Geographic Area Data										
Identify the census tract and block group(s) in which the project will take place										
County Code <input type="text"/>										
<u>Census Tract (6-digit)</u>	01	02	03	04	05	06	07	08	09	10
	<input type="checkbox"/>	<input type="checkbox"/>	<input type="checkbox"/>	<input type="checkbox"/>	<input type="checkbox"/>	<input type="checkbox"/>	<input type="checkbox"/>	<input type="checkbox"/>	<input type="checkbox"/>	<input type="checkbox"/>

[Click here to ADD ANOTHER Table 1](#)
[Click here to REMOVE the last Table 1](#)



Fort Bend County Rainfall & Flood Gage Expansion (March 2023)

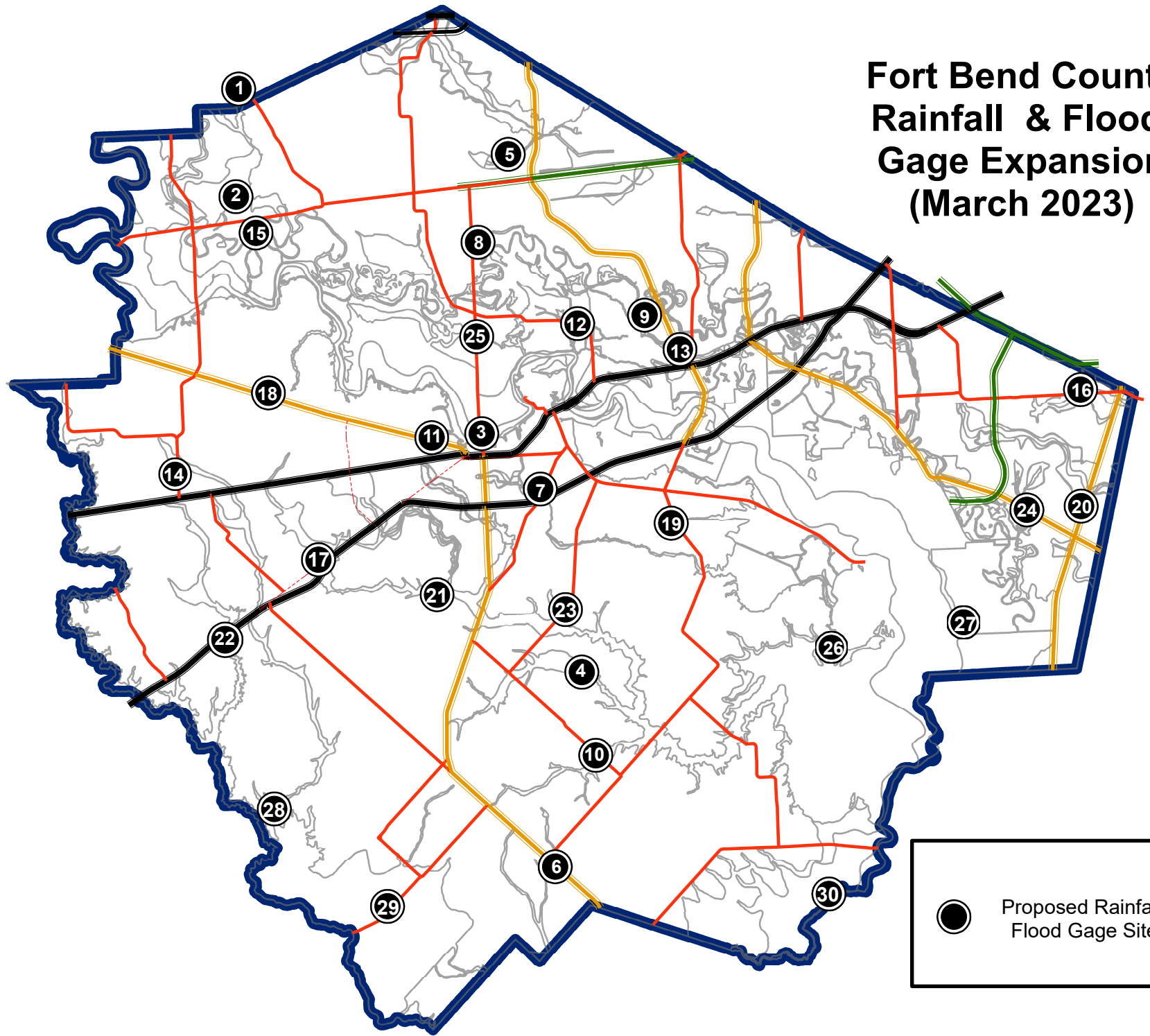

● Proposed Rainfall/
Flood Gage Site

Fort Bend County Proposed (30) ALERT2 Gages -March 2023

Site No.	Description (30 Total)	Lat	Long	Additional Notes:
1	Brookshire Creek at FM 359	29.75277	-95.94583	Major road, located just beyond county line in Waller Co.
2	Bessie's Creek at Pool Hill Rd.	29.70500	-95.94444	Fatality at this location during Harvey.
3	Brazos River at FM 723	29.56694	-95.81055	Provide Brazos River flood elevation data on major north/south thoroughfare and within city limits of Rosenberg.
4	Fairchilds Creek at Fairchilds Rd.	29.44638	-95.76166	Significantly impacted, including structural flooding, during May 2019 flood event.
5	Little Prong at Gaston Rd.	29.71194	-95.79916	Provide flow data along a major lateral of Willow Fork of Buffalo Bayou that is currently ungaged.
6	Guy Creek at SH36	29.34722	-95.77527	Provide rainfall data in the south portion of the County where we have little data. Area experienced significant flooding during recent events.
7	Dry Creek at FM 2218	29.53861	-95.77416	Provide rainfall and flood data within a significant watershed within city limits of Rosenberg.
8	Andrus Creek at FM 723	29.66750	95.81222	Provide stage data along a major lateral of Jones Creek that is experiencing significant development. Structural flooding has occurred nearby.
9	Oyster Creek at Harlem Rd.	29.63083	-95.71444	Major watershed rapidly developing. Harlem is a major north/south thoroughfare. No current data points in Upper Oyster Creek.
10	Deer Creek at FM 361	29.39805	-95.74194	Major lateral to Big Creek and area significantly impacted during May 2019 flood.
11	Robinowitz Ditch @ SH36	29.56527	-95.83333	Major roadway and developing watershed with high intensity industrial and critical drop structure at downstream end.
12	Jones Creek at FM 359	29.62666	-95.75472	Major road and rapidly developing watershed. Evacuation route for Pecan Grove. Would provide Brazos elevation data point.
13	Bullhead Bayou at Hwy 99	29.60694	-95.68722	Major road and rapidly developing watershed. Would provide critical Brazos elevation data for New Territory during extreme events.
14	Snake Creek at FM 1489	29.55972	-95.98972	Major roadway. No available rainfall data in the vicinity.
15	Orchard Creek at Weston Dr.	29.68305	-95.93555	Main entrance and access point for City of Weston Lakes. Roadway has been inundated during previous events.
16	Clear Creek at FM 2234	29.58111	-95.45944	Significant watershed and flooding occurs in the vicinity of the gage.
17	Cottonwood Creek at Hwy 59	29.50972	-95.89777	Large upstream watershed and major road.
18	Duvall Ditch at SH36	29.59305	-95.94083	Provide rainfall and elevation data to a major outfall channel serving the City of Orchard.
19	Gapps Slough at FM 762	29.52166	-95.69666	Major roadway, significant development in the watershed.
20	Mustang Bayou at FM 521	29.53000	-95.45222	Major roadway. Densely populated in the vicinity of the gage.
21	Cottonwood Creek at Spur 10	29.48972	-95.83277	Fatality at this location during Memorial Day 2015. Major evacuation route for hurricanes.
22	Turkey Creek at Hwy 59	29.46916	-95.96277	Large upstream watershed and major road.
23	Big Creek Lateral II-B-7 at FM2977	29.47388	-95.76666	Major roadway and rapidly developing watershed.
24	Long Point Creek at SH6	29.52166	-95.48888	Significant development in the area. Major regional evacuation route.
25	Briscoe Ditch at FM 723	29.61527	-95.81138	Major roadway with critical drop structure at downstream end. Would provide Brazos elevation data point.
26	Lower Dry Creek at Gubbels Rd.	29.46833	-95.60583	Lower end of major watershed. Would provide Brazos backwater data point.
27	Lower Oyster Creek at Sienna South	29.46527	-95.53194	Lower end of major watershed. Would provide Brazos backwater data point.
28	Snake Creek at Tierra Grande	29.36750	-95.93111	Significant development that becomes inaccessible with major flood events on San Bernard and Snake Creek.
29	Buffalo Creek at FM 442	29.34777	-95.85416	Significant watershed draining Needville. Would also provide San Bernard backwater data.
30	Cow Creek at Cow Creek Rd.	29.32250	-95.61472	No available rainfall data in the vicinity. Major access road between Fort Bend & Brazoria Co. Would provide Cow Creek and Brazos data.

BUDGET PROPOSAL SUMMARY EXPENDITURES DETAIL

PROGRAM TYPE:
(mark "X" under the category)

CDBG	HOME	ESG
X		

PROJECT TITLE:

North Rosenberg Water Distribution Imp. Ph.8

ORGANIZATION:

City of Rosenberg

CONTRACT PERIOD:

FROM	TO	No. of Beneficiaries
01/01/2021	12/31/2021	1510

DESCRIPTION	FUND SOURCES		
	FUNDING REQUEST	MATCHING OTHER*	TOTAL
1. Personnel			
2. Construction	587,425.00		\$ 587,425.00
3. Contingency		58,742.50	\$ 58,742.50
4. Professional Fees/Contract Services	79,250.00		\$ 79,250.00
5. Travel			
6. Lease Space			
7. Consumables and Supplies			
8. Rent, Lease, Purchase of Equipment			
9. Others			
TOTAL BUDGET	666,675.00	58,742.50	\$ 725,417.50

Beneficiary avg. cost / matching % / Admin %:	441.51	8.10%	0.00%
-----------------------------------------------	--------	-------	-------

Identify Sources of Other Funds:*

1. **City of Rosenberg**
2. _____
3. _____
4. _____
5. _____
6. _____
7. _____
8. _____

Amount of Funds:\$

\$		58,742.50
\$		
\$		
\$		
\$		
\$		
\$		
\$		
\$		
Subtotal: \$		58,742.50

X 
Signature of Authorized Agency Official

X 
Signature of Preparer

John Maresh, City Manager
Typed Name and Title

Melissa Pena, CIP Director
Typed Name and Title

*Letters of commitment must be submitted for all matching/other funds listed in budget.

Note: Use Excel to complete these forms. Please fill in the light gray/shaded cells.

PROJECT SCHEDULE

A schedule must be provided for each project. Highlight the projected length in months for each phase by clicking on the desired months. If a phase is not applicable, leave it blank. Projects are expected to be completed within 24 months following execution of the contract between the applicant and the GLO. Provide any comments regarding the schedule that may be helpful.

Project Title: **Fort Bend County - ALERT2 Rain Gage Network**

Eligible Activity: Flood and Drainage Facilities	HUD Activity #: 5
--------------------------------------------------	-------------------

September 2023	MONTHS:	0	1	2	3	4	5	6	7	8	9	10	11	12	13	14	15	16	17	18	19	20	21	22	23	24
Professional Procurement		■																								
Environmental Review			■	■																						
Acquisition		■																								
Engineering Design		■																								
Construction					■	■	■	■	■	■																
Closeout Completion											■															
Extended Activity		■																								

Comments:

Anticipate GLO contract execution - 9/2023
 Environmental review - complete 11/2023
 Equipments order - 11/2023 to 5/2024
 Construction (installation-6mths) - begin 5/2024 end 11/2024
 Closeout submit to GLO 11/30/2024
 Anticipate project completion 12/31/2024

[Click here to ADD ANOTHER Project Schedule](#)
[Click here to REMOVE the last Project Schedule](#)

LOCAL CERTIFICATIONS

Every Application must be signed by the authorized signatory. By signing this application, the signee authorizes the state or any of its duly authorized representatives to verify the information contained herein. It should be noted that 18 USC § 1001 states that any person who (1) knowingly or willfully falsifies, conceals, or covers up by any trick, scheme, or device of material fact, (2) makes any materially false, fictitious, or fraudulent statement or representation; or (3) makes or uses any false writing or document knowing the same to contain any materially false fact, fictitious, or fraudulent statement or is a federal offense and punishable under the law. Title 18, Section 1001 of the U.S. code states that a person is guilty of a FELONY for knowingly and willingly makes false statements to any department of the United States Government.

Each application for CDBG Disaster Recovery funding must also be accompanied by a completed and signed Application for Federal Assistance Standard Form 424 (SF-424).

Each applicant must comply with the provisions of the National Environmental Policy Act (NEPA), the Council on Environmental Quality (CEQ) regulations, the requirements set forth in title 24 of the Code of Federal Regulations (CFR) part 58, and applicable GLO-CDR policy directives. All applicable federal and state laws, including environmental, labor (Davis-Bacon), procurement procedures and contract requirements of 2 CFR 200.318 -200.326, and civil rights requirements apply to the use of these funds. Each applicant certifies, in compliance with with the requirements presented in Volume 83, Number 28 of the Federal Register effective February 9, 2018, that:

1. It has in effect and is following a residential anti-displacement and relocation assistance plan in connection with any activity assisted with funding under the CDBG-DR program;.
2. It is in compliance with restrictions on lobbying required by 24 CFR part 87, together with disclosure forms, if required by part 87;.
3. It will comply with the acquisition and relocation requirements of the Uniform Act (URA), as amended, and implementing regulations at 49 CFR part 24, except where waivers or alternative requirements are provided for in the Federal Register notice.
4. It will comply with section 3 of the Housing and Urban Development Act of 1968 (12 U.S.C. 1701u), and implementing regulations at 24 CFR part 135.
5. It is following a detailed citizen participation plan that satisfies the requirements of 24 CFR 91.105 Public Participation Plan as it pertains to local government administration of CDBG-DR funds. or 91.115 Public Participation Plan as it pertains to State administration of CDBG-DR funds., as applicable (except as provided for in notices providing waivers and alternative requirements for this grant). Also, each Unit of General Local Government (UGLG) receiving assistance from a state grantee must follow a detailed citizen participation plan that satisfies the requirements of 24 CFR 570.486 (except as provided for in notices providing waivers and alternative requirements for this grant).
 - a) Funds will be used solely for necessary expenses related to disaster relief, long-term recovery, restoration of infrastructure and housing, and economic revitalization in the most impacted and distressed areas for which the President declared a major disaster, DR 4332, pursuant to the Robert T. Stafford Disaster Relief and Emergency Assistance Act of 1974 (42 U.S.C. 5121 et seq.) related to the consequences of Hurricane Harvey.
6. The grant will be conducted and administered in conformity with title VI of the Civil Rights Act of 1964 (42 U.S.C. 2000d) and the Fair Housing Act (42 U.S.C. 3601 -3619) and implementing regulations, and that it will affirmatively further fair housing.
7. It has adopted the following policies:
 - a) A policy prohibiting the use of excessive force by law enforcement agencies within its jurisdiction against any individuals engaged in non-violent civil rights demonstrations; and
 - b) A policy of enforcing applicable state and local laws against physically barring entrance to or exit from a facility or location that is the subject of such nonviolent civil rights demonstrations within its jurisdiction.
8. It will not use CDBG-DR funds for any activity in an area identified as flood prone for land use or hazard mitigation planning purposes by the state, local, or tribal government, or delineated as a Special Flood Hazard Area in FEMA's most current flood advisory maps, unless it also ensures that the action is designed or modified to minimize harm to or within the floodplain, in accordance with Executive Order 11988 and 24 CFR part 55. The relevant data source for this provision is the state, local, and tribal government land use regulations and hazard mitigation plans and the latest issued FEMA data or guidance, which includes advisory data (such as Advisory Base Flood Elevations) or preliminary and final Flood Insurance Rate Maps.
9. Its activities concerning lead-based paint will comply with the requirements of 24 CFR part 35, subparts A, B, J, K, and R.
10. It will comply with applicable laws.
11. It will comply with the environmental requirements presented in 24 CFR Part 58.

Date

May 1, 2023

Printed Name

Title

Email

Phone Number

Authorized Signature



**FY 2020 Local Government Application Cover Sheet
Background Information**

Submitted by (Entity): City of Rosenberg Texas

Authorized Signature: *John Maresh

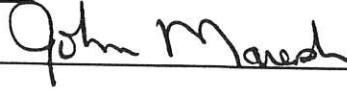

Title: City Manager

Contact Person: ** Melissa Peña, Program Director of Capital Projects

Address: P.O. Box 32, Rosenberg Texas 77471

(Area Code) Telephone: 832-595-3310 (Area Code) Fax: None

E-mail Address: mpena@rosenbergtx.gov

CDBG Funds Requested: \$666,675.00 Total Project Costs: \$725,417.50

Project Title: North Rosenberg Water Distribution Improvements – Phase VIII

Type of Project/Number of Beneficiaries/Service Area: (Check only one type of activity)

Type of activity:	Number of beneficiaries:	CDBG costs per beneficiary:
1. <input checked="" type="checkbox"/> Public Improvements/Facilities	Persons Assisted: <u>1510</u>	\$ <u>441.51</u> /person
2. <input type="checkbox"/> Housing	Households Assisted: _____	\$ _____ /household
3. <input type="checkbox"/> Public Services	Persons Assisted: _____	\$ _____ /person
4. <input type="checkbox"/> Economic Development	Persons Assisted: _____	\$ _____ /person

Checklist of Required Documents (Please check all items submitted. See page 10, Standard Required Documents for more information regarding the content of each item listed below.)

- 1. Signed and completed application cover sheet.
- 2. Project or Proposal Description/Narrative (See page 3 for requirements.)
- 3. Completed and signed computer-generated budget forms (See budget page handout).
- 4. Original and two (2) copies of cover sheet, proposal narrative, and budget forms.
- 5. Completed Project Summary Questions. (See page 3 for questions).
- 6. List of City Council/Board of Directors (Please include names, addresses, occupations and employers).
- 7. City Council's/Board's authorization to request funds. (City Resolution)
- 8. City Council's/Board's designation of authorized official* and contact person**.
- 9. Organization Chart.
- 10. Most recent financial statements and audit. (CD or zip drive digital copies of audit are preferred)
- 11. Completed and signed Conflict of Interest (COI) Disclosure Form and IRS 990 COI (See page 13-15).
- 12. Letters of Commitment for all matching/other funds. (Letters should be current; i.e. dated within thirty (30) days of an application's submission for funds. Do not send letters separately.)
- 13. Job Descriptions for all positions requesting CDBG funding.
- 14. Environmental Review Report Questions (see page 12)
- 15. Photographs of Project Site (public improvements and facilities only)
- 16. 2010 Low and Moderate Income Data, Map, and Flood Plain Map of Project Site
(Included as Exhibits 1-2 in Project Narrative)
(public improvements and facilities only)

Checklist of Support Documents

- NA 17. Citations issued by state or local regulatory agencies.
- NA 18. Results of lab testing, reports and studies.

Copier 2

North Rosenberg Water Distribution Improvements – Phase VIII

I. Project Description

A. Project Summary

The City of Rosenberg desires to **continue improving upon an aging potable water system in a 56.87% low-mod income area of our City**. The overall project area that has received CDBG support over the years is generally described as the area defined by the Brazos River as the northern boundary, Elm Street as the western boundary, Walnut Street and Avenue E as the southern boundary, and Avenue A, beyond 8th street as the eastern boundary. This Phase VIII (eight) will be focusing on completing qualifying waterlines within this low-mod project area. **(See Exhibit 1)**

This project is intended to service residents in **North Rosenberg** in the area indicated, and anticipates that **minimally 1510 residents will benefit from this project** as per figures indicated on the 2010 Census report for Block Group 2 Census Tract 6750 and 6753.

This project will significantly improve both potable water service and fire protection service to the residents in this low to moderate income area of the City.

The City of Rosenberg is **requesting \$666,675.00 in CDBG funds** for construction and engineering costs to address necessary potable water system infrastructure improvements in this area which currently meets the national standards for low and moderate income residents. Funding this project will assist the City of Rosenberg to develop a viable urban community by offering an improved living environment to residents of northern Rosenberg. Through sound management practices and effective administration, the CDBG grant fund will assist the City as we endeavor to address these essential infrastructure needs. The City of Rosenberg intends to provide \$58,743.00 for contingency funds for construction costs in excess of the grant amount. **This application amount is larger than prior requests so that we may be able to complete qualifying water line improvements in this area without extending this project into a further phase.**

B. Eligibility and Documentation of Compliance with CDBG National Objectives

This project complies with eligibility requirements of CDBG National objectives in that the entire project area will be served and benefit by the improvements to the potable water system. The project meets the identified needs of persons residing in an area where at least 51 % of the residents are considered low and moderate income. Per the attached 2010 census report, the project area is estimated to be a 56.87 % low and moderate income area. **(See Exhibit 2)**

The City anticipates that 1510 area residents will greatly benefit from this project. All figures were based on population tract No. 6750 and 6753 according to the 2010 Census Report and 2019 adjustments. The projected cost of construction and engineering is \$725,417.50 or approximately \$441.51 per resident.

The anticipated project is estimated to start design in February 2021 and is set for completion in August 2021. If funded, Melissa Peña, Program Director of Capital Projects, and Heriberto DeLeon, Utilities Director will supervise this project. An engineer will be chosen by the City using established policies, adherence to federal and state law, and in compliance with CDBG

professional procurement guidelines.

C. Project Details

The City of Rosenberg is requesting adequate funding to assist in this public improvement/infrastructure project. Replacing old potable water lines and associated connections will provide improved utility services to this area; and, thus provide improved service to the northern residential area of the City, included in the construction would be necessary traffic control and other infrastructure repairs as indicated in the attached budget.

For Phase VIII, approximately 8,965 linear feet of 4", 6" and 8" water main improvements are proposed to service this area. An estimated 85 services will be reconnected and approximately 7 new flushing valves will be installed. This work will also result in additional water service loops that will improve circulation and pressure for the entire low-mod neighborhood.

This project does not fall within the 100-Year Flood Plain. **(See Exhibit 1)**

All work for this project will be completed in established easements and rights-of-way, and all reclamation efforts will be completed for area residents as well as the necessary street repairs incurred during construction. Any required property, easements, and right-of-way procurement were completed prior to the submission of this application.

Costs associated with this project are more particularly described in the enclosed Budget Proposal Summary.

D. Entity Information

Background

The City of Rosenberg currently maintains a Public Work Department with 38 employees. City employees have extensive experience and appropriate licensure in infrastructure development, repair, and management.

The City currently maintains all water and sewer lines in the project area as defined by the previously established boundaries and per identification by low and moderate income blocks. As indicated, aging water infrastructure firmly establishes the residential need and the City's desire to seek a solution.

Personnel

No CDBG funding for this project will be used toward personnel costs.

Financial

The City of Rosenberg's accounting records for general governmental operations are maintained on a modified accrual basis, with the revenues being recorded when available and measurable, and expenditures being recorded when the services or goods are received and the liabilities are incurred. Accounting records for the City's utilities and other proprietary activities are maintained on an accrual basis.

In developing and evaluating the City's accounting system, consideration is given to the adequacy of internal accounting controls as deemed appropriate by the City Manager. The concept of reasonable assurance recognizes that: (1) the cost of a control should not exceed the benefits likely to be derived; and, (2) the evaluation of costs and benefits require estimates and judgments by the City Manager.

All internal control evaluations occur within the above framework. Internal accounting controls are designed to provide reasonable, but not absolute assurance regarding (1) safeguarding of assets against loss from unauthorized use or disposition; and, (2) the reliability of financial records for preparing financial statements and maintaining accountability for assets. The City believes that its internal accounting controls adequately safeguard and provide reasonable assurance from improper recording of financial transactions. The City's accounting controls are designed to provide reasonable assurance that errors or irregularities that could be material to the financial statements are prevented or would be detected within a timely period by employees in the normal course of performing their assigned duties.

The objective of budgetary control is to ensure compliance with legal provisions contained in the annual appropriated budget approved by the City Council. Annual appropriation budgets are adopted for the general, special revenue, debt service, enterprise, and internal service funds. The original budget is adopted by the City Council prior to the beginning of the fiscal year. Amendments to the original budget are also approved by the City Council and City Manager during the year. Budgets for capital project funds are normally budgeted on a project basis and not on a fiscal year basis.

Please refer to the City's enclosed budget for Fiscal Year 2019 for an itemized listing of all revenues and expenses.

The City also maintains an encumbrance accounting system as one method of accomplishing budgetary control. Open encumbrances are reported as reservations of fund balance as of September 30, 2019, and are generally re-appropriated as part of the subsequent year's budget. Otherwise, unspent and unencumbered budget appropriations lapse at year-end.

The City has past experience and a broad working knowledge of federal guidelines outlined in the OMB circulars, and has been a recipient of numerous grants through the Office of Justice Programs (OJP) as well as Community Development Block Grants and GLO Grants. The City has been commended for its record keeping through past site monitoring visits from the OJP.

Audit

As required by the City's Charter and the Governmental Accounting Standards Board (GASB), the financial statements of the City of Rosenberg are audited by Pattillo, Brown & Hill, L.L.P., a firm of certified public accountants on an annual basis. As always, the goal of the independent audit is to provide reasonable assurances that the financial statements of the City of Rosenberg are free of material misstatement. The independent audit involves examining on a test basis, evidence supporting the amounts and disclosures in the financial statements; assessing the accounting principles used and significant estimates made by management; and, evaluating the overall financial statement presentation.

Please refer to the enclosed Comprehensive Annual Financial Report (CAFR) for the year ended September 30, 2019. The independent Auditors Report can be found on pdf pages 19 through 21 of 175 on the attached CD. The CAFR will also give further detail regarding the financial reporting, recordkeeping, and accounting systems used throughout the City.

Insurance/Bond/Worker's Compensation

Insurance coverage for property, liability, and worker's compensation is provided by the Texas Municipal League Intergovernmental Risk Pool, a state insurance pool. Contributions to the Risk Pool for worker's compensation rates are based on the City's past claims history. The Risk Pool retains a limit of loss and reinsurance companies insure the risks beyond those limits. During the fiscal year, representatives from the Risk Pool physically review City facilities to identify possible risks. City employees also participate in Risk Pool sponsored safety

City of Rosenberg

North Rosenberg Water Distribution Improvements – Phase VIII
CDBG Application FY2020

training classes.

The following is a summary of liability coverage, including amounts:

	<u>Each Occurrence</u>	<u>Annual Aggregate</u>
General	\$1,000,000	\$ 2,000,000
Law Enforcement	\$5,000,000	\$10,000,000
Errors & Omissions	\$5,000,000	\$10,000,000
Automobile	\$1,000,000	N/A

The City's payroll is paid on a bi-weekly basis on Fridays. All applicable payroll taxes are deposited via ACH the same day as payroll is paid. The City files timely quarterly 941's as required, as well as W-2 reporting on an annual basis.

In addition to the above liability coverage, the City also has fidelity bond coverage for the City Manager, City Secretary, Tax Assessor/Collector, and Finance Director. Below is a listing of the individual amounts and insuring agencies pertaining to the aforementioned bonds:

	<u>Amount</u>	<u>Insuring Agency</u>
City Manager	\$ 50,000	The Hartford
City Secretary	\$ 50,000	The Hartford
Tax Assessor/Collector	\$100,000	The Hartford
Finance Director	\$100,000	The Hartford

E. Project Schedule

The project, if approved and funded, would commence as described below.

Engineering and Design Phase:	February 2021 through March 2021
Bidding and Contract Phase:	April 2021 through May 2021
Construction Phase:	June 2021 through August 2021

F. Property Information/Acquisition

No land acquisition necessary for this project.

EXHIBIT LIST:

1. Project Site Map with Flood Plain Reference (Exhibit 1)
2. 2010 Census Data (Exhibit 2)

BUDGET PROPOSAL SUMMARY EXPENDITURES DETAIL

PROGRAM TYPE:
(mark "X" under the category)

CDBG	HOME	ESG
X		

PROJECT TITLE:

North Rosenberg Water Distribution Imp. Ph.8

ORGANIZATION:

City of Rosenberg

CONTRACT PERIOD:

FROM	TO	No. of Beneficiaries
01/01/2021	12/31/2021	1510

DESCRIPTION	FUND SOURCES		
	FUNDING REQUEST	MATCHING OTHER*	TOTAL
1. Personnel			
2. Construction	587,425.00		\$ 587,425.00
3. Contingency		58,742.50	\$ 58,742.50
4. Professional Fees/Contract Services	79,250.00		\$ 79,250.00
5. Travel			
6. Lease Space			
7. Consumables and Supplies			
8. Rent, Lease, Purchase of Equipment			
9. Others			
TOTAL BUDGET	666,675.00	58,742.50	\$ 725,417.50

Beneficiary avg. cost / matching % / Admin %:	441.51	8.10%	0.00%
-----------------------------------------------	--------	-------	-------

Identify Sources of Other Funds:*

1. **City of Rosenberg**
2. _____
3. _____
4. _____
5. _____
6. _____
7. _____
8. _____

Amount of Funds:\$

\$		58,742.50
\$		
\$		
\$		
\$		
\$		
\$		
\$		
\$		
Subtotal: \$		58,742.50

X 
Signature of Authorized Agency Official

X 
Signature of Preparer

John Maresh, City Manager
Typed Name and Title

Melissa Pena, CIP Director
Typed Name and Title

*Letters of commitment must be submitted for all matching/other funds listed in budget.

Note: Use Excel to complete these forms. Please fill in the light gray/shaded cells.

**EXPENDITURES DETAIL
PERSONNEL EXPENSES DETAILS**

Detail for item #1 in Budget Proposal Summary

(Job descriptions for all CDBG / HOME funded positions must be included in proposal.)

1a. Personnel with benefits (full time employees)							
Position description	Hourly Rate	Hours worked weekly			Annual Salary (all sources)		Total
		Funding Request	Matching Other	Subtotal	Funding Request	Matching Other	
Subtotal: (Salaries for personnel with benefits)							

Fringe benefits: (Based on number of employees listed above.)							
Description of benefits	Rate	Prorate	Prorate	Subtotal	Estimated Amt.	Estimated Amt.	Total
FICA (Based on above annual salary)	7.65%						
Worker's Compensation							
Insurance							
Subtotal of fringe benefits							

1b. Personnel without benefits (Part-time)							
Position description	Hourly Rate	Hours worked weekly			Annual Salary (all sources)		Total
		Funding Request	Matching Other	Subtotal	Funding Request	Matching Other	
Subtotal: (Salaries for personnel without benefits)							

Total Personnel Salaries: (1a + 1b)			
--------------------------------------------	--	--	--

Supplemental information:

Use Excel to complete these forms. The light gray/shaded background cells need to be filled for automatic calculation.

EXPENDITURES DETAIL PROFESSIONAL FEES/CONTRACT SERVICES

Detail for item #4 in Budget Proposal Summary.

4. Professional Fees/Contract Services:							
Professional Fees/Contract Services	Flat Rate	Percentage			Annual Salary (all sources)		Total
		Funding Request	Matching Other	Subtotal Percent	Funding Request	Matching Other	
ENGINEERING, SURVEYING & TESTING	\$79,250.00	100%	0%	100%	\$79,250.00		\$79,250.00
Total Professional Fees/Contract Services					\$79,250.00		\$79,250.00

Supplemental information:

Use Excel to complete these forms. The light gray/shaded background cells need to be filled for automatic calculation.
 Flat rate: Professional fees charged by flat rate per service.

**EXPENDITURES DETAIL
TRAVEL EXPENSES DETAILS**

Detail for item #5 in Budget Proposal Summary

5. Travel Expenses Detail								
Travel description	Unit Price	Type of Unit*	Quantity			Estimated Amount		Total
			Funding Request	Matching Other	Subtotal	Funding Request	Matching Other	
mileage	\$0.575	mileage						
Total Travel Expenses								

Supplemental information:

Use Excel to complete these forms. The light gray/shaded background cells need to be filled for automatic calculation.
 * Type of Unit: miles, one-way, roundtrip, per day, etc...

EXPENDITURES DETAIL RENT, LEASE, PURCHASE OF EQUIPMENT

Detail for item #8 in Budget Proposal Summary

8. Rent, Lease, Purchase of Equipment Expenses Detail								
Rent, lease, purchase of equipment	Unit Price	Type of Unit*	Quantity			Estimated Amount		Total
			Funding Request	Matching Other	Subtotal	Funding Request	Matching Other	
Total Equipment Expenses								

Supplemental information:

Use Excel to complete these forms. The light gray/shaded background cells need to be filled for automatic calculation.
 * Type of unit: each, boxes, cases, gallons, etc...

**EXPENDITURES DETAIL
OTHERS EXPENSES DETAILS**

Detail for item #9 in Budget Proposal Summary

9. Others Expenses Detail								
Others description	Unit Price	Type of Unit*	Quantity			Estimated Amount		Total
			Funding Request	Matching Other	Subtotal	Funding Request	Matching Other	
Total Others Expenses								

Supplemental information:

Use Excel to complete these forms. The light gray/shaded background celis need to be filled for automatic calculation.
 * Type of unit: Please specify for each item - each, box, case, etc...

Exhibit 1

CITY OF ROSENBERG

FEMA MAP NUMBERS:
 48157C0230L
 48157C0235L
 48157C0240L
 48157C0245L

File Name: W:\FortBend\City\Resubmit\City Map\Phase 8\Water scope exhibit 6.dwg
 User: jlm
 Date: 03/19/2020, 10:08:25 AM
 Plot Date: Friday, March 27, 2020 9:32:07 AM

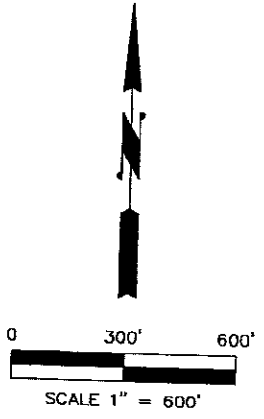

FORT BEND COUNTY KEY MAP 604 L&M

**NORTHSIDE ROSENBERG WATER
 DISTRIBUTION IMPROVEMENTS PHASE VIII
 CITY OF ROSENBERG
 FORT BEND COUNTY, TEXAS**

MARCH, 2020

LEGEND:

 - SCOPE OF WORK

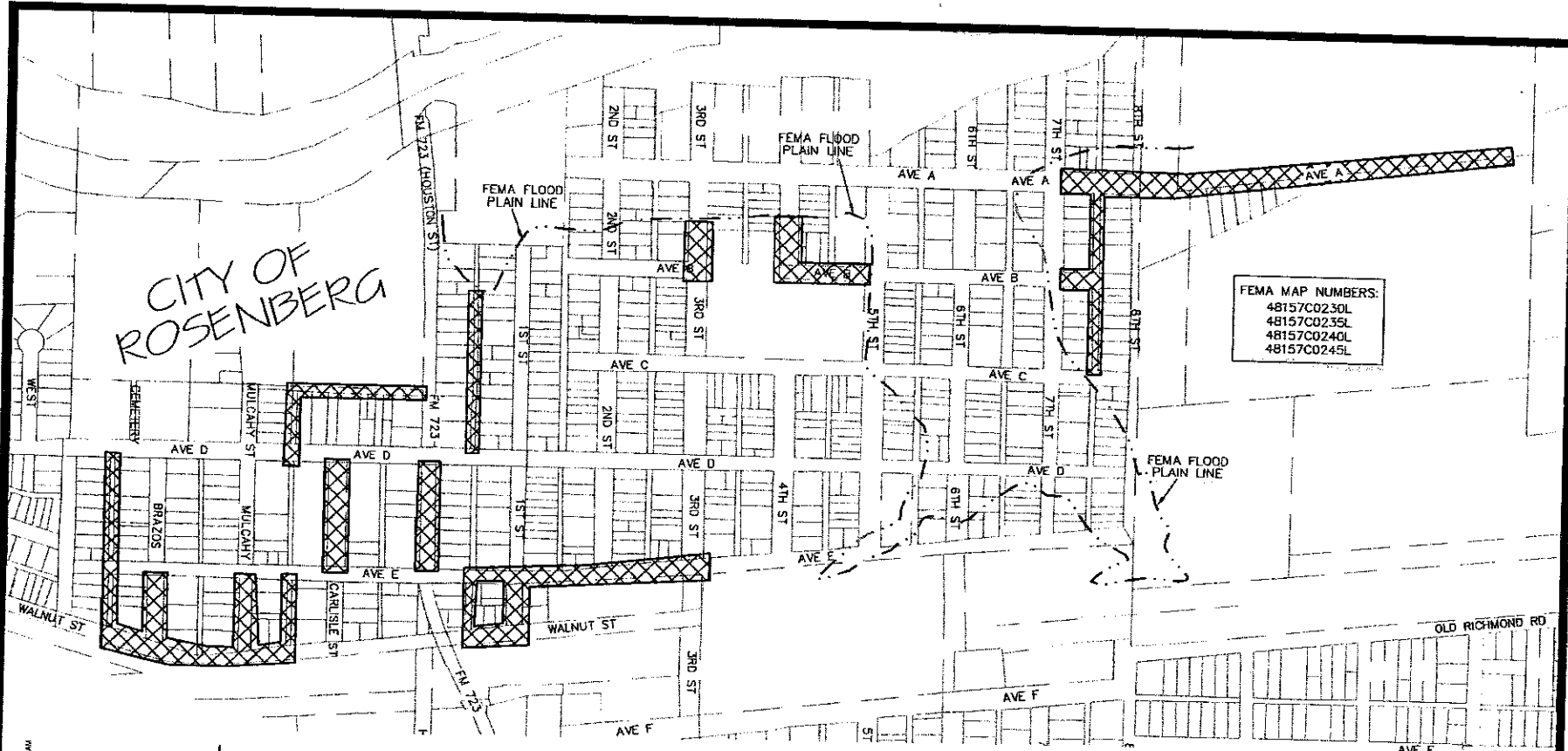

FIRM
FLOOD INSURANCE RATE MAP
FORT BEND COUNTY,
TEXAS
AND INCORPORATED AREAS

PANEL 230 OF 575
 (SEE MAP INDEX FOR FIRM PANEL LAYOUT)

CONTAINS:

COMMUNITY	NUMBER	PANEL	SUFFIX
FORT BEND COUNTY	480228	0230	L
ROSENBERG, CITY OF	480232	0230	L

Notice to User: The Map Number shown below should be used when placing map orders; the Community Number shown above should be used on insurance applications for the subject community.



MAP NUMBER
48157C0230L
MAP REVISED
APRIL 2, 2014

Federal Emergency Management Agency

FIRM
FLOOD INSURANCE RATE MAP
FORT BEND COUNTY,
TEXAS
AND INCORPORATED AREAS

PANEL 235 OF 575
 (SEE MAP INDEX FOR FIRM PANEL LAYOUT)

CONTAINS:

COMMUNITY	NUMBER	PANEL	SUFFIX
FORT BEND COUNTY	480228	0235	L
PEGAN (DIXIE) MUNICIPAL UTILITY DISTRICT	481428	0235	L
RICHMOND, CITY OF	480231	0235	L
ROSENBERG, CITY OF	480232	0235	L

Notice to User: The Map Number shown below should be used when placing map orders; the Community Number shown above should be used on insurance applications for the subject community.



MAP NUMBER
48157C0235L
MAP REVISED
APRIL 2, 2014

Federal Emergency Management Agency

FIRM
FLOOD INSURANCE RATE MAP
FORT BEND COUNTY,
TEXAS
AND INCORPORATED AREAS

PANEL 240 OF 575
 (SEE MAP INDEX FOR FIRM PANEL LAYOUT)

CONTAINS:

COMMUNITY	NUMBER	PANEL	SUFFIX
FORT BEND COUNTY	480228	0240	L
PLEAK VILLAGE OF	481815	0240	L
ROSENBERG, CITY OF	480232	0240	L

Notice to User: The Map Number shown below should be used when placing map orders; the Community Number shown above should be used on insurance applications for the subject community.



MAP NUMBER
48157C0240L
MAP REVISED
APRIL 2, 2014

Federal Emergency Management Agency

FIRM
FLOOD INSURANCE RATE MAP
FORT BEND COUNTY,
TEXAS
AND INCORPORATED AREAS

PANEL 245 OF 575
 (SEE MAP INDEX FOR FIRM PANEL LAYOUT)

CONTAINS:

COMMUNITY	NUMBER	PANEL	SUFFIX
FORT BEND COUNTY	480228	0245	L
PLEAK VILLAGE OF	481815	0245	L
RICHMOND, CITY OF	480231	0245	L
ROSENBERG, CITY OF	480232	0245	L

Notice to User: The Map Number shown below should be used when placing map orders; the Community Number shown above should be used on insurance applications for the subject community.



MAP NUMBER
48157C0245L
MAP REVISED
APRIL 2, 2014

Federal Emergency Management Agency

Rosenberg data 2019

CDBGUOGID	CDBGNAME	STUSAB	CDBGTY	STATE	COUNTY	COUNTYNAME	TRACT	BLKGRP	LOWMOD	LOWMODUNIV	LOWMODPCT	GEOID
489157	Fort Bend Cour	TX	61	48	157	Fort Bend Cour	675000	2	885	1880	47.07%	15000US481576750002
489157	Fort Bend Cour	TX	61	48	157	Fort Bend Cour	675300	3	625	775	80.65%	15000US481576753003
							Subtotal		1510	2655	56.87%	

