

# PLAT RECORDING SHEET

**PLAT NAME:** Crescent Spring Drive Street Dedication Section 2

**PLAT NO:** \_\_\_\_\_

**ACREAGE:** 0.272

**LEAGUE:** William Hall Survey

**ABSTRACT NUMBER:** 31

**NUMBER OF BLOCKS:** 0

**NUMBER OF LOTS:** 0

**NUMBER OF RESERVES:** 0

**OWNERS:** Sienna Parks & Levee Improvement District

\_\_\_\_\_  
**(DEPUTY CLERK)**

STATE OF TEXAS  
COUNTY OF FORT BEND

WE, SIENNA PARKS & LEVEE IMPROVEMENT DISTRICT OF FORT BEND COUNTY, TEXAS, ACTING BY AND THROUGH KEN BECKMAN, PRESIDENT BEING AN OFFICER OF SIENNA PARKS & LEVEE IMPROVEMENT DISTRICT OF FORT BEND COUNTY, TEXAS, OWNERS OF THE 0.272 ACRE TRACT DESCRIBED IN THE ABOVE AND FOREGOING PLAT OF CRESCENT SPRING DRIVE STREET DEDICATION SECTION 2, DO HEREBY MAKE AND ESTABLISH SAID SUBDIVISION PLAT OF SAID PROPERTY ACCORDING TO ALL LINES, DEDICATIONS, RESTRICTIONS AND NOTATIONS ON SAID PLAT AND HEREBY DEDICATE TO THE USE OF THE PUBLIC FOREVER, ALL STREETS, ALLEYS, PARKS, WATER COURSES, DRAINS, EASEMENTS AND PUBLIC PLACES SHOWN THEREON FOR THE PURPOSES AND CONSIDERATIONS THEREIN EXPRESSED, AND DO HEREBY BIND OURSELVES, OUR HEIRS AND ASSIGNS TO WARRANT AND FOREVER DEFEND THE TITLE TO THE LAND SO DEDICATED.

WE, FURTHER ACKNOWLEDGE THAT THE DEDICATIONS AND/OR EXACTIONS MADE HEREIN ARE PROPORTIONAL TO THE IMPACT OF THE SUBDIVISION UPON THE PUBLIC SERVICES REQUIRED IN ORDER THAT THE DEVELOPMENT WILL COMPORT WITH THE PRESENT AND FUTURE GROWTH NEEDS OF THE CITY, WE, OUR SUCCESSORS AND ASSIGNEES HEREBY MAKE ANY CLAIM, DAMAGE OR CAUSE OF ACTION THAT WE MAY HAVE AS A RESULT OF THE DEDICATION OR EXACTIONS MADE HEREIN.

FURTHER, OWNERS HAVE DEDICATED AND BY THESE PRESENTS DO DEDICATE TO THE USE OF THE PUBLIC FOR PUBLIC UTILITY PURPOSES FOREVER UNOBSTRUCTED AERIAL EASEMENTS, THE AERIAL EASEMENTS SHALL EXTEND HORIZONTALLY AN ADDITIONAL ELEVEN FEET, SIX INCHES (11'6") FOR TEN FEET (10'0") PERIMETER GROUND EASEMENTS OR SEVEN FEET, SIX INCHES (7'6") FOR FOURTEEN FEET (14'0") PERIMETER GROUND EASEMENTS OR FIVE FEET, SIX INCHES (5'6") FOR SIXTEEN FEET (16'0") PERIMETER GROUND EASEMENTS, FROM A PLANE SIXTEEN FEET (16'0") ABOVE GROUND LEVEL UPWARD, LOCATED ADJACENT TO AND ADJOINING SAID PUBLIC UTILITY EASEMENTS THAT ARE DESIGNATED WITH AERIAL EASEMENTS (U.E. AND A.E.) AS INDICATED AND DEPICTED, HEREON, WHEREBY THE AERIAL EASEMENT TOTALS TWENTY ONE FEET, SIX INCHES (21'6") IN WIDTH.

FURTHER, OWNERS HAVE DEDICATED AND BY THESE PRESENTS DO DEDICATE TO THE USE OF THE PUBLIC FOR PUBLIC UTILITY PURPOSES FOREVER UNOBSTRUCTED AERIAL EASEMENTS, THE AERIAL EASEMENTS SHALL EXTEND HORIZONTALLY AN ADDITIONAL TEN FEET (10'0") FOR TEN FEET (10'0") BACK-TO-BACK GROUND EASEMENTS, OR EIGHT FEET (8'0") FOR FOURTEEN FEET (14'0") BACK-TO-BACK GROUND EASEMENTS, OR SEVEN FEET (7'0") FOR SIXTEEN FEET (16'0") BACK-TO-BACK GROUND EASEMENTS, FROM A PLANE SIXTEEN FEET (16'0") ABOVE GROUND LEVEL UPWARD, LOCATED ADJACENT TO BOTH SIDES AND ADJOINING SAID PUBLIC UTILITY EASEMENTS THAT ARE DESIGNATED WITH AERIAL EASEMENTS (U.E. AND A.E.) AS INDICATED AND DEPICTED HEREON, WHEREBY THE AERIAL EASEMENT TOTALS THIRTY FEET (30'0") IN WIDTH.

FURTHER, WE DO HEREBY COVENANT AND AGREE THAT ALL OF THE PROPERTY WITHIN THE BOUNDARIES OF THIS PLAT SHALL BE RESTRICTED TO PREVENT THE DRAINAGE OF ANY SEPTIC TANKS INTO ANY PUBLIC OR PRIVATE STREET, ROAD OR ALLEY OR ANY DRAINAGE DITCH, EITHER DIRECTLY OR INDIRECTLY.

FURTHER, WE DO HEREBY DEDICATE TO THE PUBLIC A STRIP OF LAND TWENTY (20) FEET WIDE ON EACH SIDE OF THE CENTER LINE OF ANY AND ALL BAYOUS, CREEKS, GULLIES, RAVINES, DRAINS AND DRAINAGE DITCHES LOCATED IN SAID SUBDIVISION, AS EASEMENTS FOR DRAINAGE PURPOSES. FORT BEND COUNTY OR ANY OTHER GOVERNMENTAL AGENCY SHALL HAVE THE RIGHT TO ENTER UPON SAID EASEMENT AT ANY AND ALL TIMES FOR THE PURPOSES OF CONSTRUCTION AND MAINTENANCE OF DRAINAGE FACILITIES AND STRUCTURES.

FURTHER, WE DO HEREBY COVENANT AND AGREE THAT ALL OF THE PROPERTY WITHIN THE BOUNDARIES OF THIS SUBDIVISION AND ADJACENT TO ANY DRAINAGE EASEMENT, DITCH, GULLY, CREEK OR NATURAL DRAINAGE WAY SHALL HEREBY BE RESTRICTED TO KEEP SUCH DRAINAGE WAYS AND EASEMENTS CLEAR OF FENCES, BUILDINGS, EXCESSIVE VEGETATION AND OTHER OBSTRUCTIONS TO THE OPERATIONS AND MAINTENANCE OF THE DRAINAGE FACILITY AND THAT SUCH ADJUTING PROPERTY SHALL NOT BE PERMITTED TO DRAIN DIRECTLY INTO THIS EASEMENT EXCEPT BY MEANS OF AN APPROVED DRAINAGE STRUCTURE.

FURTHER, WE DO HEREBY CERTIFY THAT WE ARE THE OWNERS OF ALL PROPERTY IMMEDIATELY ADJACENT TO THE BOUNDARIES OF THE ABOVE AND FOREGOING SUBDIVISION OF CRESCENT SPRING DRIVE STREET DEDICATION SECTION 2 WHERE BUILDING SETBACK LINES OR PUBLIC UTILITY EASEMENTS ARE TO BE ESTABLISHED OUTSIDE THE BOUNDARIES OF THE ABOVE AND FOREGOING SUBDIVISION AND DO HEREBY MAKE AND ESTABLISH ALL BUILDING SETBACK LINES AND DEDICATE TO THE USE OF THE PUBLIC, ALL PUBLIC UTILITY EASEMENTS SHOWN IN SAID ADJACENT ACREAGE.

FURTHER, WE DO HEREBY ACKNOWLEDGE THE RECEIPT OF THE "ORDERS FOR REGULATION OF OUTDOOR LIGHTING IN THE UNINCORPORATED AREAS OF FORT BEND COUNTY, TEXAS", AND DO HEREBY COVENANT AND AGREE AND SHALL COMPLY WITH THIS ORDER AS ADOPTED BY FORT BEND COUNTY COMMISSIONERS COURT ON MARCH 23, 2004 AND ANY SUBSEQUENT AMENDMENT.

N TESTIMONY WHEREOF, SIENNA PARKS & LEVEE IMPROVEMENT DISTRICT OF FORT BEND COUNTY, TEXAS HAS CAUSED THESE PRESENTS TO BE SIGNED BY KEN BECKMAN, ITS PRESIDENT, THEREUNTO AUTHORIZED.

THIS 13 DAY OF March, 2023.

SIENNA PARKS & LEVEE IMPROVEMENT DISTRICT OF FORT BEND COUNTY, TEXAS

BY: Ken Beckman  
KEN BECKMAN, PRESIDENT

STATE OF TEXAS  
COUNTY OF HARRIS

BEFORE ME, THE UNDERSIGNED AUTHORITY, ON THIS DAY PERSONALLY APPEARED KEN BECKMAN, PRESIDENT OF SIENNA PARKS & LEVEE IMPROVEMENT DISTRICT OF FORT BEND COUNTY, TEXAS, KNOWN TO ME TO BE THE PERSON WHOSE NAME IS SUBSCRIBED TO THE FOREGOING INSTRUMENT AND ACKNOWLEDGED TO ME THAT HE EXECUTED THE SAME FOR THE PURPOSES AND CONSIDERATIONS THEREIN EXPRESSED AND IN THE CAPACITY THEREIN AND HEREIN SET OUT.

GIVEN UNDER MY HAND AND SEAL OF OFFICE,  
THIS 13th DAY OF March, 2023.

Jamie Ann Chapa  
NOTARY PUBLIC IN AND FOR THE STATE OF TEXAS



I, JON P. BORDOVSKY, A REGISTERED PROFESSIONAL LAND SURVEYOR, AM AUTHORIZED UNDER THE LAWS OF THE STATE OF TEXAS TO PRACTICE THE PROFESSION OF LAND SURVEYING AND HEREBY CERTIFY THAT THE ABOVE SUBDIVISION IS TRUE AND CORRECT, WAS PREPARED FROM AN ACTUAL SURVEY OF THE PROPERTY MADE UNDER MY SUPERVISION ON THE GROUND AND THAT ALL BOUNDARY CORNERS, ANGLES, POINTS OF CURVATURE AND OTHER POINTS OF REFERENCE HAVE BEEN MARKED WITH IRON (OR OTHER SUITABLE PERMANENT METAL) PIPES OR RODS HAVING AN OUTSIDE DIAMETER OF NOT LESS THAN FIVE-EIGHTHS (5/8) INCH WITH PLASTIC CAP MARKED "GBI PARTNERS" AND A LENGTH OF NOT LESS THAN THREE (3) FEET. (SEE NOTE #9)

Jon P. Bordovsky  
JON P. BORDOVSKY, R.P.L.S.  
REGISTERED PROFESSIONAL LAND SURVEYOR  
TEXAS REGISTRATION NO. 6405

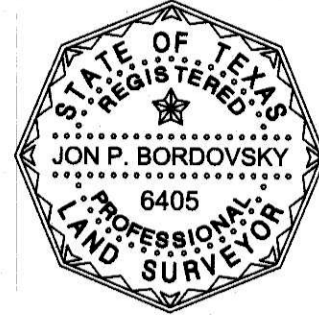

I, SCOTT FRANKOVICH, A PROFESSIONAL ENGINEER REGISTERED IN THE STATE OF TEXAS DO HEREBY CERTIFY THAT THIS PLAT MEETS ALL REQUIREMENTS OF FORT BEND COUNTY TO THE BEST OF MY KNOWLEDGE.

Scott Frankovich  
SCOTT FRANKOVICH, P.E.  
LICENSED PROFESSIONAL ENGINEER  
TEXAS LICENSE NO. 130312



STATE OF TEXAS  
COUNTY OF FORT BEND

THIS IS TO CERTIFY THAT THE PLANNING AND ZONING COMMISSION OF THE CITY OF MISSOURI CITY, TEXAS, HAS APPROVED THIS PLAT AND SUBDIVISION OF CRESCENT SPRING DRIVE STREET DEDICATION SECTION 2 IN CONFORMANCE WITH THE LAWS OF THE STATE OF TEXAS AND THE ORDINANCES OF THE CITY OF MISSOURI CITY AS SHOWN HEREON AND AUTHORIZED THE RECORDING OF THIS PLAT

THIS 23rd DAY OF March, 2023

Timothy R. Haney  
TIMOTHY R. HANEY, CHAIR

John R. Walley  
JOHN R. WALLEY, VICE CHAIR

NOTES:

- BENCHMARK: FOUND 4 INCH BRASS DISC LOCATED IN A POURED CONCRETE POST IN THE GRASSY AREA IN FRONT OF MISSOURI CITY FIRE STATION NUMBER 5 16.5 FEET FROM THE SIDE WALK. SURVEY MARKER NO. PCM-011 ELEV. = 59.97 (NAVD88 2001 ADJUSTMENT)
- T.B.M. INDICATES TEMPORARY BENCHMARK. FND 5/8 INCH IRON ROD WITH CAP MARKED "GBI PARTNERS" ELEV. = 53.78 (NAVD 88, 2001 ADJUSTMENT)
- ALL BEARINGS REFERENCED TO THE TEXAS COORDINATE SYSTEM, SOUTH CENTRAL ZONE (NAD83). COORDINATES SHOWN ARE GRID AND MAY BE CONVERTED TO SURFACE BY APPLYING A FACTOR OF 0.999867651
- THIS PLAT WAS PREPARED TO MEET CITY OF MISSOURI CITY AND FORT BEND COUNTY REQUIREMENTS.
- THIS PLAT WAS PREPARED FROM INFORMATION FURNISHED BY CHARTER TITLE COMPANY, FILE NO. 2022-0314 DATED MARCH 9, 2023 THE SURVEYOR HAS NOT ABSTRACTED THE ABOVE PROPERTY.
- THIS PLAT LIES WHOLLY WITHIN SIENNA PARKS & LEVEE IMPROVEMENT DISTRICT, FORT BEND SUBSIDENCE DISTRICT, FORT BEND COUNTY DRAINAGE DISTRICT, FORT BEND I.S.D., THE ETJ OF THE CITY OF MISSOURI CITY, FORT BEND COUNTY AND SIENNA MUNICIPAL UTILITY DISTRICT NO. 6.
- IN ACCORDANCE WITH FEDERAL EMERGENCY MANAGEMENT AGENCY FLOOD INSURANCE RATE MAP, MAP NO. 48157C 0435L, REVISED DATE APRIL 2, 2014, PROPERTY LIES WITHIN SHADED ZONE "X" DEFINED AS AREAS OF 0.2% ANNUAL CHANCE FLOOD. THIS AREA IS SHOWN AS BEING PROTECTED FROM THE 1% ANNUAL CHANCE OR GREATER FLOOD HAZARD BY A LEVEE SYSTEM, OVERTOPPING OR FAILURE OF ANY LEVEE SYSTEM IS POSSIBLE. LJA DOES NOT WARRANT NOR SUBSCRIBE TO THE ACCURACY OR SCALE OF SAID MAPS.
- THERE ARE NO PIPELINES OR PIPELINE EASEMENTS WITHIN THIS SUBDIVISION.
- FIVE-EIGHTHS (5/8) INCH IRON RODS WITH PLASTIC CAP MARKED "GBI PARTNERS" AND THREE (3) FEET IN LENGTH WILL BE SET ON ALL PERIMETER BOUNDARY CORNERS, UNLESS OTHERWISE NOTED. BLOCK CORNERS AND/OR STREET RIGHT-OF-WAYS HAVE NOT BEEN MONUMENTED.
- THE DRAINAGE SYSTEM FOR THIS SUBDIVISION SHALL BE DESIGNED TO MEET THE REQUIREMENTS OF THE FORT BEND COUNTY DRAINAGE CRITERIA MANUAL WHICH ALLOWS STREET PONDING DURING INTENSE RAINFALL EVENTS.
- ALL DRAINAGE AND FLOODWAY EASEMENTS SHALL BE KEPT CLEAR OF FENCES, BUILDINGS, PLANTINGS, AND OTHER OBSTRUCTIONS TO THE OPERATIONS AND MAINTENANCE OF THE DRAINAGE FACILITY AS REQUIRED BY SUBSECTION 82-168(D) OF THE CODE OF ORDINANCES OF THE CITY OF MISSOURI CITY, TEXAS.
- ALL PROPERTY TO DRAIN INTO THE DRAINAGE EASEMENT ONLY THROUGH AN APPROVED DRAINAGE STRUCTURE.
- SHARED ACCESS AND PARKING FACILITIES SHALL BE PROVIDED AS REQUIRED UNDER THE PROVISIONS OF SUBSECTION 82-159 OF THE CODE OF ORDINANCES OF THE CITY OF MISSOURI CITY.
- THE CITY OF MISSOURI CITY SHALL NOT BE RESPONSIBLE FOR MAINTENANCE OF DRIVEWAYS, SIDEWALKS, EMERGENCY ACCESS EASEMENTS, RECREATIONAL AREAS, OPEN SPACE AND RESERVES; AND THE SIENNA COMMUNITY ASSOCIATION INC., (S.C.A.I.) HOMEOWNERS ASSOCIATION SHALL BE RESPONSIBLE FOR SUCH MAINTENANCE OF DRIVEWAYS, EMERGENCY ACCESS EASEMENTS, RECREATIONAL AREAS AND OPEN SPACES AS REQUIRED BY SECTION 3.C(14) OF THE PLATTING MANUAL OF THE CITY OF MISSOURI CITY (SEPTEMBER 2019).
- SIDEWALK SHALL BE BUILT OR CAUSED TO BE BUILT NOT LESS THAN 5- FEET IN WIDTH ON BOTH SIDES OF ALL DEDICATED RIGHTS-OF-WAY WITHIN SAID PLAT AND ON CONTIGUOUS RIGHT-OF-WAY OF ALL PERIMETER ROADS SURROUNDING SAID PLAT, IN ACCORDANCE WITH ADA REQUIREMENTS.
- SIDEWALKS SHALL BE BUILT AS REQUIRED BY SECTION 82-164 OR THE CODE OF ORDINANCES OF THE CITY OF MISSOURI CITY, TEXAS.
- DRIVEWAY APPROACHES SHALL BE PROVIDED IN ACCORDANCE WITH THE MISSOURI CITY DRIVEWAY APPROACH POLICY AS REQUIRED UNDER THE PROVISIONS OF SUBSECTION 82-160 OF THE CODE OF ORDINANCES OF THE CITY OF MISSOURI CITY, TEXAS.
- DRIVEWAY LOCATION - FOR THE LOTS ON THE INSIDE OF A KNUCKLE OR 90 DEGREE TURN, DRIVEWAY MUST BE PLACED ON THE LOT FRONTAGE ALONG THE INSIDE APPROACH LANE PRIOR TO THE RIGHT TURN, TO AVOID SIGHT OBSTRUCTION SAFETY HAZARDS.
- ALL REQUIRED UTILITY COMPANIES HAVE BEEN CONTACTED AND ALL PUBLIC UTILITY EASEMENTS AS SHOWN ON THE ABOVE AND FOREGOING PLAT CONSTITUTE ALL OF THE EASEMENTS REQUIRED BY THE UTILITY COMPANIES CONTACTED AT THE TIME OF PLATTING.
- ALL OF THE PROPERTY SUBDIVIDED IN THE ABOVE AND FOREGOING PLAT IS WITHIN THE ETJ BOUNDARIES OF THE CITY OF MISSOURI CITY, TEXAS.

- NO BUILDING OR OTHER PERMIT, EXCEPT PERMITS FOR CONSTRUCTION OF PUBLIC IMPROVEMENTS WILL BE ISSUED BY THE CITY OF MISSOURI CITY, TEXAS, FOR CONSTRUCTION WITHIN THIS SUBDIVISION UNTIL SUCH TIME AS ALL PUBLIC IMPROVEMENTS OF THE SUBDIVISION HAVE BEEN CONSTRUCTED BY THE DEVELOPER AND ACCEPTED BY THE CITY OR THE GUARANTEE OF CONSTRUCTION OF PUBLIC IMPROVEMENTS REQUIRED BY SECTION 82-206 OF THE CODE OF ORDINANCES OF THE CITY OF MISSOURI CITY, TEXAS, IS SUBMITTED TO AND APPROVED BY THE CITY.
- PRIOR TO THE BEGINNING OF THE ONE-YEAR MAINTENANCE PERIOD FOR UTILITIES AND PAVING BY FORT BEND COUNTY, ALL BLOCK CORNERS AND STREET RIGHT-OF-WAY WILL BE MONUMENTED.
- ADEQUATE FIRE FLOWS SHALL BE PROVIDED ALONG THE ENTIRE LENGTH OF THE PROPOSED WATER LINE.
- REQUIRED FIRE FLOWS SHALL BE PROVIDED BASED ON THE SIZE AND CONSTRUCTION OF ALL BUILDINGS AS REQUIRED BY THE INTERNATIONAL FIRE CODE AS ADOPTED BY THE CITY.
- THE PLACEMENT OF FIRE HYDRANTS SHALL BE PROVIDED BASED ON THE MINIMUM DISTANCE REQUIREMENTS AS ESTABLISHED IN THE INTERNATIONAL FIRE CODE AS ADOPTED BY THE CITY (500FT. FOR RESIDENTIAL DEVELOPMENT AND 300FT. FOR COMMERCIAL DEVELOPMENT). ALL FIRE HYDRANTS SHALL BE INSTALLED ACCORDING TO THE INTERNATIONAL FIRE CODE AS ADOPTED BY THE CITY.
- STREET LIGHTING SHALL BE DESIGNED AND INSTALLED IN ACCORDANCE WITH THE CITY OF MISSOURI CITY INFRASTRUCTURE DESIGN MANUAL, CHAPTER 4 STREET LIGHTING AND OVERHEAD UTILITIES. THE INSTALLATION, OPERATION, AND MAINTENANCE OF ORNAMENTAL STREET LIGHTS SHALL NOT BE THE RESPONSIBILITY OF THE CITY OF MISSOURI CITY, EXCEPT AS PROVIDED THEREIN.
- OWNERSHIP AND MAINTENANCE RESPONSIBILITY OF THE DRAINAGE RESERVES AND CHANNELS IS VESTED IN THE SIENNA PARKS & LEVEE IMPROVEMENT DISTRICT. THE OWNERSHIP AND MAINTENANCE RESPONSIBILITY OF LANDSCAPE RESERVES IS VESTED IN THE HOMEOWNERS ASSOCIATION (HOA).
- OWNERSHIP AND MAINTENANCE RESPONSIBILITY OF THE UTILITIES WITHIN THE SECTIONS IS VESTED IN SIENNA MUNICIPAL UTILITY DISTRICT NO. 6. THE OWNERSHIP AND MAINTENANCE RESPONSIBILITY OF THE UTILITIES ALONG BOULEVARDS AND MAJOR THROUGHFARES IS VESTED IN THE SIENNA MUNICIPAL UTILITY DISTRICT NO. 5.
- IN ACCORDANCE WITH CENTERPOINT ENERGY ELECTRICAL SERVICE MANUAL, ARTICLE 421.2, ELECTRIC METERS SHALL BE LOCATED IN A POSITION THAT IS ACCESSIBLE AT ALL TIMES WITHOUT CUSTOMER ASSISTANCE. ACCESS TO THE METER SHALL NOT BE BLOCKED BY GATES, WALLS OR FENCES.
- THIS PLAT LIES WITHIN LIGHTING ZONE 2.
- SITE PLANS SHALL BE SUBMITTED TO FORT BEND COUNTY AND ANY OTHER APPLICABLE JURISDICTION FOR REVIEW AND APPROVAL. DEVELOPMENT PERMITS AND ALL OTHER APPLICABLE PERMITS SHALL BE OBTAINED FROM FORT BEND COUNTY PRIOR TO BEGINNING CONSTRUCTION.
- ONE-FOOT RESERVE DEDICATED TO THE CITY IN FEE AS A BUFFER SEPARATION BETWEEN THE SIDE OR END OF STREETS WHERE SUCH STREETS ADJACENT ACREAGE TRACTS, THE CONDITION OF SUCH DEDICATION BEING THAT WHEN THE ADJACENT PROPERTY IS SUBDIVIDED PURSUANT TO A RECORDED PLAT, THE ONE-FOOT RESERVE SHALL THEREUPON BECOME VESTED IN THE PUBLIC FOR STREET RIGHT-OF-WAY PURPOSES AND THE FEE TITLE THERETO SHALL REVERT TO AND REVEST IN THE DEDICATOR, HIS HEIRS, ASSIGNS OR SUCCESSORS.
- ALL SLAB ELEVATIONS SHALL BE AT LEAST ONE FOOT ABOVE THE 100-YEAR FLOOD ELEVATION AS ESTABLISHED BY FEMA AS PER SECTION 3.C(13) OF THE PLATTING MANUAL OF THE CITY OF MISSOURI CITY (SEPTEMBER 2019).

LEGEND

- B.L. INDICATES BUILDING LINE
- U.E. INDICATES UTILITY EASEMENT
- D.E. INDICATES DRAINAGE EASEMENT
- W.L.E. INDICATES WATER LINE EASEMENT
- S.S.E. INDICATES SANITARY SEWER EASEMENT
- STM.S.E. INDICATES STORM SEWER EASEMENT
- F.B.C.P.R. INDICATES FORT BEND COUNTY PLAT RECORDS
- F.B.C.O.R. INDICATES FORT BEND COUNTY OFFICIAL RECORDS
- F.B.C.O.P.R. INDICATES FORT BEND COUNTY OFFICIAL PUBLIC RECORDS
- F.B.C.D.R. INDICATES FORT BEND COUNTY DEED RECORDS
- F.N. INDICATES FILE NUMBER
- R.O.W. INDICATES RIGHT-OF-WAY

LINE	BEARING	DISTANCE
L1	S 09°01'54" E	90.00'
L2	N 09°01'54" W	60.00'
L3	N 27°05'09" W	59.31'
L4	N 69°03'09" W	68.67'
L5	S 20°56'51" W	20.00'

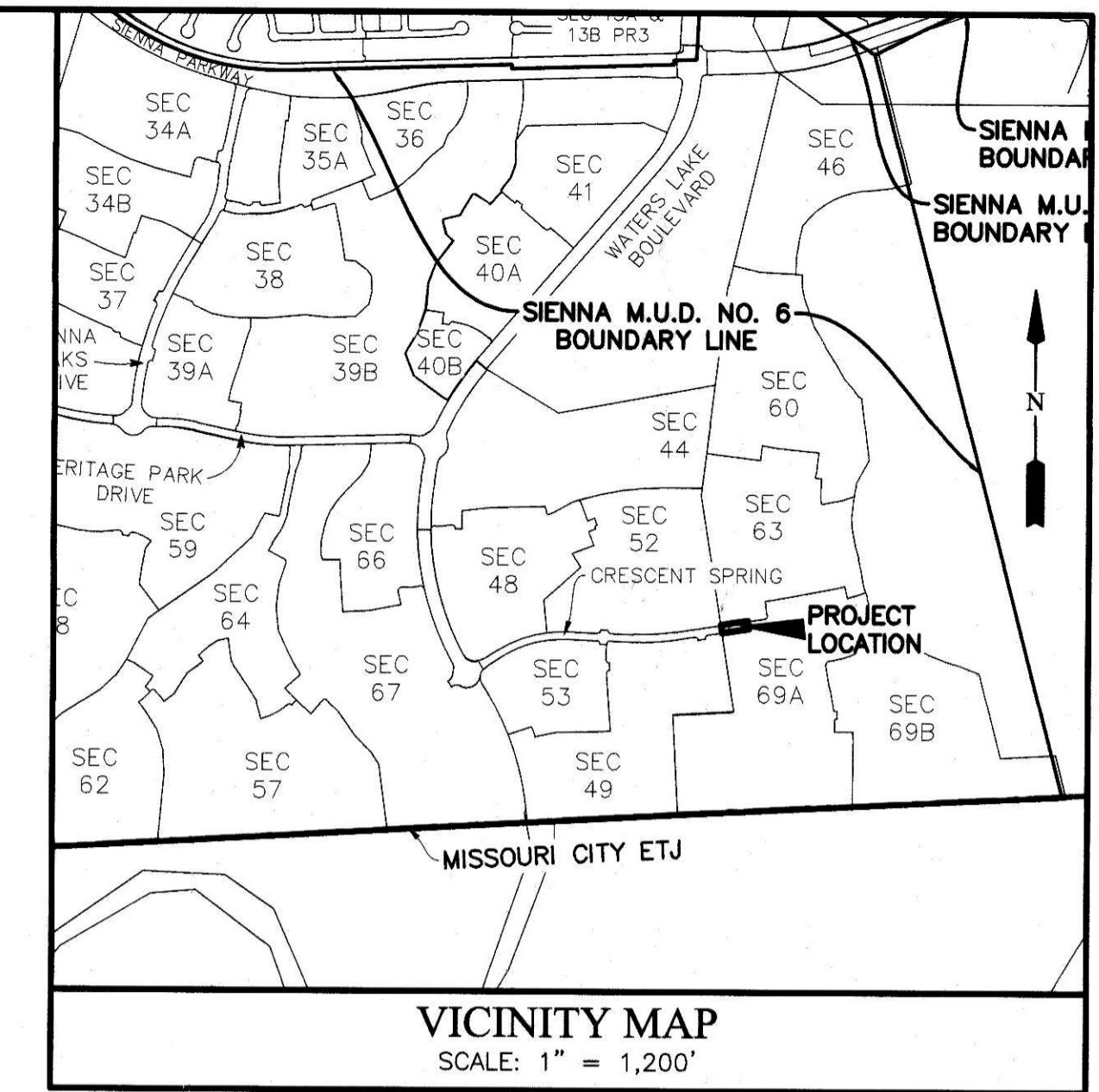
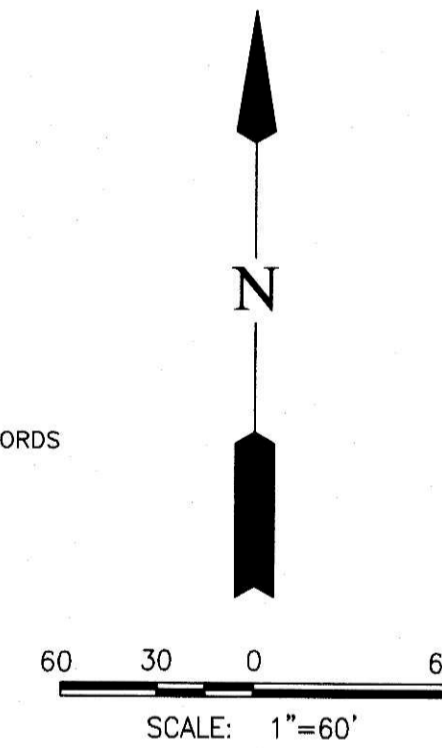

I, J. STACY SLAWINSKI, FORT BEND COUNTY ENGINEER, DO HEREBY CERTIFY THAT THE PLAT OF THIS SUBDIVISION COMPLIES WITH ALL OF THE EXISTING RULES AND REGULATIONS OF THIS OFFICE AS ADOPTED BY THE FORT BEND COUNTY COMMISSIONERS' COURT. HOWEVER, NO CERTIFICATION IS HEREBY GIVEN AS TO THE EFFECT OF DRAINAGE FROM THIS SUBDIVISION ON THE INTERCEPTING DRAINAGE ARTERY OR PARENT STREAM OR ON ANY OTHER AREA OR SUBDIVISION WITHIN THE WATERSHED.

J. Stacy Slawinski  
J. STACY SLAWINSKI, P.E.  
FORT BEND COUNTY ENGINEER

APPROVED BY THE COMMISSIONERS' COURT OF FORT BEND COUNTY, TEXAS,  
THIS \_\_\_\_\_ DAY OF \_\_\_\_\_, 2023.

Vincent M. Morales Jr.  
VINCENT M. MORALES, JR.  
PRECINCT 1, COUNTY COMMISSIONER

Grady Prestage  
GRADY PRESTAGE  
PRECINCT 2, COUNTY COMMISSIONER

KP George  
KP GEORGE  
COUNTY JUDGE

W.A. (Andy) Meyers  
W.A. (ANDY) MEYERS  
PRECINCT 3, COUNTY COMMISSIONER

Dexter L. McCoy  
DEXTER L. MCCOY  
PRECINCT 4, COUNTY COMMISSIONER

I, LAURA RICHARD, COUNTY CLERK IN AND FOR FORT BEND COUNTY, HEREBY CERTIFY THAT THE FOREGOING INSTRUMENT WITH ITS CERTIFICATE OF AUTHENTICATION WAS FILED FOR RECORDATION IN MY OFFICE ON \_\_\_\_\_, 2023 AT \_\_\_\_\_ O'CLOCK \_\_\_\_\_ M. IN PLAT NUMBER \_\_\_\_\_ OF THE PLAT RECORDS OF FORT BEND COUNTY, TEXAS.

WITNESS MY HAND AND SEAL OF OFFICE, AT RICHMOND, TEXAS. THE DAY AND DATE LAST ABOVE WRITTEN.

Laura Richard  
LAURA RICHARD, COUNTY CLERK  
FORT BEND COUNTY, TEXAS

BY: \_\_\_\_\_  
DEPUTY

### CRESCENT SPRING DRIVE STREET DEDICATION SECTION 2

A SUBDIVISION OF 0.272 ACRES OF LAND SITUATED IN THE  
WILLIAM HALL SURVEY, ABSTRACT 31,  
FORT BEND COUNTY, TEXAS.

MARCH 13, 2023 JOB NO. 1416-1802B

SIENNA PARKS & LEVEE IMPROVEMENT DISTRICT  
OF FORT BEND COUNTY, TEXAS  
KEN BECKMAN, PRESIDENT  
202 CENTURY SQUARE BLVD., SUGAR LAND, TEXAS 77478-3796  
PH. (281) 500-6050

SURVEYOR:



**GBI PARTNERS**  
4724 VISTA ROAD T8P8LS FIRM #10130300  
PASADENA, TX 77505 GBSurvey@GBISurvey.com  
PHONE: 281-499-4539 www.GBISurvey.com

JON BORDOVSKY, R.P.L.S.  
REGISTERED PROFESSIONAL LAND SURVEYOR  
TEXAS REGISTRATION NO. 6405

ENGINEER:

**LJA Engineering, Inc.**  
1904 W. Grand Parkway North Phone 713.953.5200  
Suite 100 Fax 713.953.5026  
Katy, Texas 77449 FRN-F-1386

SCOTT FRANKOVICH, P.E.  
REGISTERED PROFESSIONAL ENGINEER  
TEXAS REGISTRATION NO. 130312