

CHANGE ORDER

FORT BEND COUNTY ENGINEERING

- Distribution:
- FBC Engineering
 - FBC Judge
 - FBC Purchasing
 - Contractor
 - Consultant

Address: 301 Jackson Street
 Richmond, Texas 77469
Phone: 281-633-7500
Web site: www.FortBendCountyTx.gov

PROJECT:

- Traffic signals
- LJ at Lake Riverstone
- LJ at Winding Waters
- I University at Winding Waters

CHANGE ORDER NUMBER 2
 DATE 9/13/2022
 PROJECT NUMBER
 BID NO 22-014
 CONTRACT DATE 12/13/2021
 FBC PURCHASE ORDER NO 206833

CONTRACTOR:

Traffic Systems Construction Inc.

The contract is changed as follows:
 Concrete and signal item changes due to utility conflicts

Not valid until signed by Fort Bend County and Contractor.

The Original (**Contract Sum**) \$ 714,242.95
 Net change by previously authorized Change Orders \$ 68,587.95
 The (**Contract Sum**) Prior to this Change Order was \$ 782,830.90
 The (**Contract Sum**) will be increased **or** decreased **or** unchanged
 by this Change Order in the amount of \$ 136,927.48
 The new (**Contract Sum**) including this Change Order will be \$ \$919,758.38

The Contract Time will be increased **or** decreased **or** unchanged by 60 days.
 The Date of Substantial Completion as of this Change Order therefore is
 changed **or** unchanged to 11/10/2022.

Authorized:

Fort Bend County Engineering
 J. Stacy Slawinski, P.E.
 301 Jackson
 Richmond, Texas 77469

CONTRACTOR
 Traffic Systems Construction, Inc.
 Kenneth Morrison

Fort Bend County Judge
 Honorable KP George
 301 Jackson St., #719
 Richmond, Texas 77469

By: 
 (signature) 09/16/2022
 DATE: _____

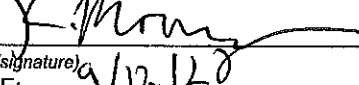
By: 
 (signature) 9/13/20
 DATE: _____

By: _____
 (signature)
 DATE: _____

Traffic Systems Construction, Inc.

P.O. BOX 1346 Dickinson, Texas 77539 Office (281) 337-1926 Fax No. 1 (281) 634-1937
www.trafficsci.com

CHANGE ORDER

DATE : 07/12/2022 No. 2
GENERAL CONTRACTOR : TSC
OWNER : FORT BEND COUNTY KM
PROJECT NUMBER : 22-014
LOCATION : UNIVERSITY BLVD
DESCRIPTION OF WORK : INSTALL LARGER GROUND BOXES ADJACENT TO TRAFFIC SIGNAL CONTROLLER TO FIT MULTIPLE CONDUIT STUB-UPS
PLEASE NOTE : ALL CHANGE ORDERS MUST BE APPROVED OR DENIED WITHIN 60 DAYS
AFTER 60 DAYS THE CHANGE ORDER PRICING WILL NO LONGER BE VALID
DUE TO MATERIAL SUPPLIER PRICE INCREASES.

COST BREAKDOWN

MATERIAL

ITEM	UNIT	QTY.	UNIT PRICE	TAXABLE	NON-TAXABLE
24X36X24 GROUND BOX	EA	3	\$705.00		\$2,115.00
CONCRETE	YD	1.5	\$175.00		\$262.50
GRAVEL	YD	1	\$58.00		\$58.00
GROUND ROD AND CLAMP	EA	3	\$26.95		\$80.85
DUCT SEAL	EA	3	\$13.50		\$40.50
FORM LUMBER 2" X 4"	EA	9	\$3.25		\$29.25
				SUBTOTAL	\$2,586.10
			PROFIT & COMPENSATION	15%	\$387.92
			MATERIAL TOTAL		\$2,974.02

EQUIPMENT

ITEM	UNIT	QTY.	UNIT PRICE	TAXABLE	NON-TAXABLE
FLATBED TRUCK	HR	15	\$34.65		\$519.75
TRAILER	HR	15	\$10.06		\$150.90
BACKHOE	HR	15	\$68.41		\$1,026.15
				SUBTOTAL	\$1,696.80
			PROFIT & COMPENSATION	15%	\$264.52
			EQUIPMENT TOTAL		\$1,951.32

LABOR

ITEM	UNIT	QTY.	UNIT PRICE	TAXABLE	NON-TAXABLE
SUPERVOR	HR	3	\$55.00		\$165.00
FOREMAN	HR	15	\$40.00		\$600.00
LABORER	HR	30	\$30.00		\$900.00
				SUBTOTAL	\$1,665.00
			PROFIT & COMPENSATION	15%	\$249.75
			LABOR BURDEN	55%	\$915.75
			LABOR TOTAL		\$2,830.50

GRAND TOTAL **\$7,755.84**

Traffic Systems Construction, Inc.

P.O. BOX 1346 Dickinson, Texas 77539 Office (281) 337-1926 Fax No. 1 (281) 534-1937
 www.trafficsci.com

CHANGE ORDER

DATE : 07/12/2022 No. 3
 GENERAL CONTRACTOR : TSC
 OWNER : FORT BEND COUNTY KM
 PROJECT NUMBER : 22-014
 LOCATION : UNIVERSITY BLVD AND WINDING WATERS
 DESCRIPTION OF WORK : RELOCATE LIGHT POLE AND FOUNDATION OUT OF THE PROPOSED INTERSECTION MODIFICATIONS
 PLEASE NOTE : ALL CHANGE ORDERS MUST BE APPROVED OR DENIED WITHIN 60 DAYS AFTER 60 DAYS THE CHANGE ORDER PRICING WILL NO LONGER BE VALID DUE TO MATERIAL SUPPLIER PRICE INCREASES.

COST BREAKDOWN

MATERIAL

ITEM	UNIT	QTY.	UNIT PRICE	TAXABLE	NON-TAXABLE
				SUBTOTAL	\$0.00
PROFIT & COMPENSATION				15%	\$0.00
				MATERIAL TOTAL	\$0.00

EQUIPMENT

ITEM	UNIT	QTY.	UNIT PRICE	TAXABLE	NON-TAXABLE
FLATBED TRUCK	HR	5	\$34.65		\$173.25
TRAILER	HR	5	\$10.06		\$50.30
BACKHOE	HR	5	\$68.41		\$342.05
				SUBTOTAL	\$565.60
PROFIT & COMPENSATION				15%	\$84.84
				EQUIPMENT TOTAL	\$650.44

LABOR

ITEM	UNIT	QTY.	UNIT PRICE	TAXABLE	NON-TAXABLE
SUPERVIOIR	HR	2	\$55.00		\$110.00
FOREMAN	HR	5	\$40.00		\$200.00
LABORER	HR	10	\$30.00		\$300.00
				SUBTOTAL	\$610.00
PROFIT & COMPENSATION				15%	\$91.50
LABOR BURDEN				55%	\$335.50
				LABOR TOTAL	\$1,037.00

GRAND TOTAL **\$1,687.44**

**TRAFFIC SYSTEMS CONSTRUCTION, INC.
DAILY WORK REPORT**

Date: 28 Job No.: 638 Location: WINDING WATERS UNIVERSITY

Yard Departure Time: 7:30 Job Site Arrival Time: 8:30 Job Site Departure Time: 6:00

Lunch From: 12:00 to 12:30 Foreman(s): Carlos Perez

Laborer(s) Carlos Jr and Justin Driver/Operator(s): _____

Did you talk to the inspector? Yes _____ No _____ Name: _____
If you talked to the inspector, what was discussed? _____

Work Performed: Please list the names of each person and a detailed description of the work they performed.

We move light pole Relocate 4' AWAY with Foundation
and Fixed Back the terminals and First Controller
form and set on used 15ft 4" Conduit and
17ft 3" Conduit and 25ft 2" Conduit

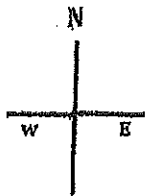

Truck #: 160
Trailer #: 39

Equipment #: Backhoe: _____ Bore Rig: _____
(Mark all that apply) Air Compressor: _____ Mini Excavator: _____
Arrow Board: _____ Light Tower: _____
Message Board: _____ Other: _____
Trencher: _____ Other: _____

****LABEL ALL STREET NAMES AND WORK COMPLETED IN THE DIAGRAM BELOW****

****This intersection drawing should be used to show locations where the crew drilled foundations, set poles, hung lights, installed pedestrian push buttons, controllers, pull boxes, etc.****

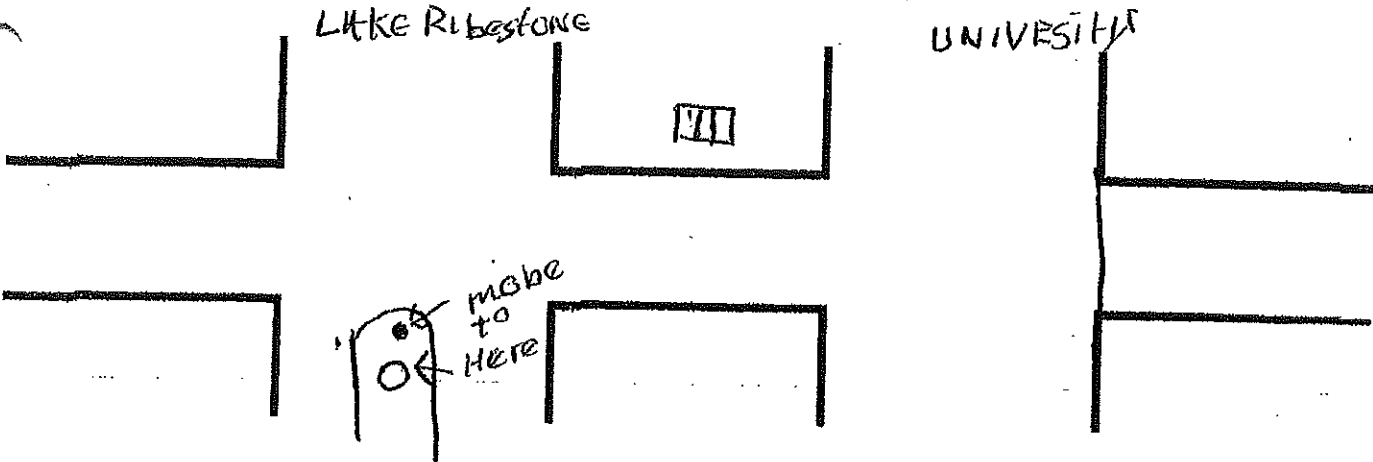

Did you encounter any problems such as equipment breakdown, rain, utilities not marked, wrong or absent materials? Was the job shut down? If yes to any of these, please describe: _____

Were there any accidents or injuries while on the job site? Ex. Broken utility line, crew member injured, car accident, etc. Yes _____ No _____ If yes, please provide a detailed description of the incident below.

I, _____ am responsible for the information on this form. To the best of my knowledge, this form is accurate and all work and materials used are accounted for. I understand that this document may be used in court if the need should arise.

Signature: Juan Carlos Perez Date: 6-98-22



WILDCAT

ELECTRIC SUPPLY

5535 HARVEY WILSON DR
HOUSTON, TX 77020

713-676-0600 Fax 713-676-1077

Quotation

QUOTE DATE	QUOTE NUMBER
07/12/22	S1632243
ORDER TO:	
WILDCAT ELECTRIC SUPPLY INC 5535 HARVEY WILSON DR HOUSTON, TX 77020 713-676-0600 Fax 713-676-1077	
PAGE NO.	
1	

QUOTE TO:
TRAFFIC SYSTEMS CONSTRUCTION
PO BOX 1346
DICKINSON, TX 77539

SHIP TO:
TRAFFIC SYSTEMS J647
HOLLISTER ST, BREEN DR,
FLEETWOOD CRK WAY, TANYARD CRK
HOUSTON, TX 77020

CUSTOMER NUMBER	CUSTOMER ORDER NUMBER	RELEASE NUMBER	SALES PERSON	
31330			JAMES KUENSTLE	
ORDER	SHIP VIA	TERMS	FREIGHT ALLOWED	
ISAAC BURCIAGA		NET 30 DAYS	No	
ORDER QT	DESCRIPTION	Net Price	Tax Price	
3ea	QUAZ PG2436BA24 BOX W/NO BASE 24-IN	705.000/ea	2115.00	
3ea	QUAZ PG2436H6714E "DANGER HIGH VOLTAGE TRAFFIC SIGNAL"	0.000/ea	0.00	
1ea	^MSC CONCRETE YARD 1.5	175.000/ea	175.00	
1ea	^MSC GRAVEL YARD .75	58.000/ea	58.00	
3ea	GR-ROD 6260 5/8 X10 COPPER-CLAD GROUND ROD	26.950/ea	80.85	
3ea	GR-ROD G-5 (GRC-58) 5/8-IN GROUND ROD CLAMP	0.000/ea	0.00	
3ea	EGS DC-10 1 LB DUCT SEAL COMPOUND	13.500/ea	40.50	
9ea	COX 2 X 4 X 8FT LUMBER	3.250/ea	29.25	
TAXES NOT INCLUDED				
Subtotal			2498.60	
Amount Due			2498.60	

This is a Quotation.

Prices are firm for 30 days, subject to change without notice after 30 days. Applicable taxes extra.

www.equipmentwatch.com

All prices shown in US dollars (\$)

Adjustments for Truck.2 in All Saved Models

July 12, 2022

Miscellaneous 4X2 20KGVW DSL
On-Highway Flatbed Trucks

Size Class:
19,501 - 26,000 GVW
Weight:
6826 lbs

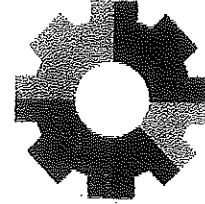

Configuration for 4X2 20KGVW DSL

Axle Configuration	4X2	Horsepower	200.0
Maximum Gross Vehicle Weight	20000.0 lbs	Power Mode	Diesel

Blue Book Rates

** FHWA Rate is equal to the monthly ownership cost divided by 176 plus the hourly estimated operating cost.

	Ownership Costs				Estimated Operating Costs Hourly USD \$28.46	FHWA Rate** Hourly USD \$35.65
	Monthly	Weekly	Daily	Hourly		
Published Rates	USD \$1,265.00	USD \$355.00	USD \$89.00	USD \$13.00		
Adjustments						
Region (Texas: 98.8%)	(USD \$15.18)	(USD \$4.28)	(USD \$1.07)	(USD \$0.16)		
Model Year (2007: 87%)	(USD \$162.44)	(USD \$45.59)	(USD \$11.43)	(USD \$1.67)		
Adjusted Hourly Ownership Cost (100%)	-	-	-	-		
Hourly Operating Cost (100%)						
Total:	USD \$1,087.38	USD \$306.16	USD \$76.50	USD \$11.17	USD \$28.46	USD \$34.64

Non-Active Use Rates

Standby Rate	Hourly	USD \$4.51
Idling Rate		USD \$28.54

Rate Element Allocation

Element	Percentage	Value
Depreciation (ownership)	54%	USD \$683.10/mo
Overhaul (ownership)	27%	USD \$341.55/mo
CFC (ownership)	5%	USD \$63.25/mo
Indirect (ownership)	14%	USD \$177.10/mo
Fuel (operating) @ USD 5.70	79%	USD \$22.36/hr

Revised Date: 3rd quarter 2022

These are the most accurate rates for the selected Revision Date(s). However, due to more frequent online updates, these rates may not match Rental Rate Blue Book Print. Visit the Cost Recovery Product Guide on our Help page for more information.

The equipment represented in this report has been exclusively prepared for STEVE KASS (sktsci@gmail.com)

www.equipmentwatch.com

All prices shown in US dollars (\$)

Adjustments for TRAILER.2 in All Saved Models

July 12, 2022

Miscellaneous 40
Float Trailers

Size Class:
All
Weight:
11000 lbs

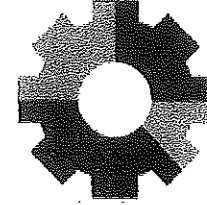

Configuration for 40

Capacity	40.0 t	Deck Length	40.0 ft
Number Of Axles	2.0	Number Of Tires	8.0
Power Mode	Manual		

Blue Book Rates

** FHWA Rate is equal to the monthly ownership cost divided by 176 plus the hourly estimated operating cost.

	Ownership Costs				Estimated Operating Costs Hourly USD \$4.75	FHWA Rate** Hourly USD \$10.69
	Monthly	Weekly	Daily	Hourly		
Published Rates	USD \$1,045.00	USD \$295.00	USD \$74.00	USD \$11.00		
Adjustments						
Region (Texas: 97%)	(USD \$31.35)	(USD \$8.85)	(USD \$2.22)	(USD \$0.33)		
Model Year (2011: 92.23%)	(USD \$78.80)	(USD \$22.25)	(USD \$5.58)	(USD \$0.83)		
Adjusted Hourly Ownership Cost (100%)	-	-	-	-		
Hourly Operating Cost (100%)						
Total:	USD \$934.85	USD \$263.90	USD \$66.20	USD \$9.84	USD \$4.75	USD \$10.08

Non-Active Use Rates

	Hourly
Standby Rate	USD \$3.61
Idling Rate	USD \$5.31

Rate Element Allocation

Element	Percentage	Value
Depreciation (ownership)	49%	USD \$512.05/mo
Overhaul (ownership)	32%	USD \$334.40/mo
CFC (ownership)	4%	USD \$41.80/mo
Indirect (ownership)	15%	USD \$156.75/mo

Fuel cost data is not available for these rates.

Revised Date: 3rd quarter 2022

These are the most accurate rates for the selected Revision Date(s). However, due to more frequent online updates, these rates may not match Rental Rate Blue Book Print. Visit the Cost Recovery Product Guide on our Help page for more information.

The equipment represented in this report has been exclusively prepared for STEVE KASS (sktsci@gmail.com)

www.equipmentwatch.com

All prices shown in US dollars (\$)

Adjustments for BACK HOE #3 in All Saved Models

July 12, 2022

Daere 310J (disc, 2012)
Tractor-Loader-Backhoes

Size Class:
14' to Under 16'
Weight:
14360 lbs

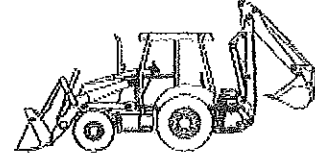

Configuration for 310J (disc, 2012)

Drive Power Mode	4WD Diesel	Operator Protection	ROPS
---------------------	---------------	---------------------	------

Blue Book Rates

** FHWA Rate is equal to the monthly ownership cost divided by 176 plus the hourly estimated operating cost.

	Ownership Costs				Estimated Operating Costs Hourly USD \$37.29	FHWA Rate** Hourly USD \$68.31
	Monthly	Weekly	Daily	Hourly		
Published Rates	USD \$5,460.00	USD \$1,530.00	USD \$385.00	USD \$58.00		
Adjustments						
Region (Houston, Texas: 100.3%)	USD \$16.38	USD \$4.59	USD \$1.15	USD \$0.17		
Model Year (2012: 100%)	-	-	-	-		
Adjusted Hourly Ownership Cost (100%)	-	-	-	-		
Hourly Operating Cost (100%)						
Total:	USD \$5,476.38	USD \$1,534.59	USD \$386.15	USD \$58.17	USD \$37.29	USD \$68.41

Non-Active Use Rates

	Hourly
Standby Rate	USD \$16.18
Idling Rate	USD \$49.76

Rate Element Allocation

Element	Percentage	Value
Depreciation (ownership)	30%	USD \$1,638.00/mo
Overhaul (ownership)	49%	USD \$2,675.40/mo
CFC (ownership)	7%	USD \$382.20/mo
Indirect (ownership)	15%	USD \$819.00/mo
Fuel (operating) @ USD 5.70	50%	USD \$18.64/hr

Revised Date: 3rd quarter 2022

These are the most accurate rates for the selected Revision Date(s). However, due to more frequent online updates, these rates may not match Rental Rate Blue Book Print. Visit the Cost Recovery Product Guide on our Help page for more information.

The equipment represented in this report has been exclusively prepared for STEVE KASS (sktsci@gmail.com)

TRAFFIC SYSTEMS CONSTRUCTION, INC.

STEVE KASS

PH. (281) 337-1926 FAX 1 (281) 337-2968

COUNTY: FORT BEND
PROJECT No. : 22-014
LOCATION: UNIVERSITY BOULEVARD
BID DATE: 07/21/2022

CHANGE ORDER 4
QUANTITY OVERUNS

BASE UNIT PRICES FOR:

\$41,097.40

ITEM NO.	DESCRIPTION	UNIT	QTY	UNIT BID	TOTAL
INTERSECTION #2----LJ PARKWAY AND WINDNIG WATERS					
B. PAVEMENT ITEMS					
2	CONC PVMT (CONC REINF - CRCP) (10")	SY	4.50	\$1,150.00	\$5,175.00
7	CONC SIDEWALKS (4")	EA	34.80	\$288.00	\$10,022.40
INTERSECTION #3----LJ PARKWAY AND AKE RIVERSTONE					
B. PAVEMENT ITEMS					
2	CONC PVMT (CONT REINF - CRCP) (10")	SY	14.00	\$1,850.00	\$25,900.00
					\$41,097.40

SPRING CREEK CONSTRUCTION, INC.
P.O. BOX 9574
SPRING, TX 77387-9574
(281) 367-5283

Invoice

DATE	INVOICE #
7/21/2022	530-22

BILL TO:
TRAFFIC SYSTEMS CONSTRUCTION
PO Box 1346
Dickinson, TX 77539-1346

P.O. NUMBER	TERMS	PROJECT
	Due on receipt	Univ Blvd

QUANTITY	DESCRIPTION	RATE	AMOUNT
----------	-------------	------	--------

This is to invoice you for the work performed on the Ft Bend Co project #B22-014 on University Blvd and on LJ Pkwy. Work performed 6/23 thru 7/20/22.
See breakdown below.

65,806.05

LJ PARKWAY @ WINDING WATERS:

- # 2. Conc pavement (10").
4 SY @ \$1000.00 / SY = \$4,000.00
- # 4. Adjust MH
1 EA @ \$ 525.00 / EA = \$ 525.00
- # 6. Conc curb.
14.5 LF @ \$ 20.00 / LF = \$ 290.00
- # 7. Conc sidewalks (4").
4 SY @ \$250.00 / SY = \$1,000.00
- # 8. Curb ramps (TY 7).
1 EA @ \$2350.00 / EA = \$2,350.00
- # 9. Curb ramps (TY 9).
1 EA @ \$2950.00 / EA = \$2,950.00
- C/O. Site prep + excavation.
1 LS @ \$2075.00 / LS = \$2,075.00
- C/O. 8" stab sand subgrade.
7 SY @ \$ 126.00 / SY = \$ 882.00
- C/O. Remove & dispose existing conc sidewalks/ramps.
10 SY @ \$ 48.50 / SY = \$ 485.00

TOTAL

Invoice

SPRING CREEK CONSTRUCTION, INC.

P.O. BOX 9574
 SPRING, TX 77367-9574
 (281) 367-5263

DATE	INVOICE #
7/21/2022	530-22

BILL TO:
 TRAFFIC SYSTEMS CONSTRUCTION
 PO Box 1346
 Dickinson, TX 77539-1346

P.O. NUMBER	TERMS	PROJECT
	Due on receipt	Univ Blvd

QUANTITY	DESCRIPTION	RATE	AMOUNT
----------	-------------	------	--------

OVER-RUN Quantities LJ & WW:
~~# 2. Conc pay 10"~~
~~4.5 SY @ \$1000.00 / SY = \$4,500.00~~
~~# 7. Conc sidewalks~~
~~34.80 SY @ \$250.00 / SY = \$8,700.00~~
 C/O. 8" stab sand subgrade.
 1.5 SY @ \$126.00 / SY = \$ 189.00
 C/O. Remove & dispose exist conc sidewalks/ramps.
 29.30 SY @ \$ 48.50 / SY = \$1,421.05

 SUBTOTAL LJ @ WW : = \$29,367.05

LJ PKWY @ LAKE RIVERSTONE:
 # 2. Conc pavement (10").
 5 SY @ \$1600.00 / SY = \$ 8000.00
 # 6. Conc curb.
 28 LF @ \$ 20.00 / LF = \$ 560.00
 C/O. Site prep & excavation.
 1 LS @ \$3085.00 / LS = \$3,085.00
 C/O. 8" stabilized sand subgrade.
 9.5 SY @ \$126.00 / SY = \$1,197.00

OVER-RUN Quantities LJ @ LR:
~~# 2. Conc pavement (10").~~
~~14 SY @ \$1600.00 / SY = \$22,400.00~~

TOTAL

Invoice

SPRING CREEK CONSTRUCTION, INC.
P.O. BOX 9574
SPRING, TX 77387-9574
(281) 367-5263

DATE	INVOICE #
7/21/2022	530-22

BILL TO:
TRAFFIC SYSTEMS CONSTRUCTION
PO Box 1346
Dickinson, TX 77539-1346

P.O. NUMBER	TERMS	PROJECT
	Due on receipt	Univ Blvd

QUANTITY	DESCRIPTION	RATE	AMOUNT
	C/O. 8" stabilized sand subgrade.		
	9.5 SY @ \$ 126.00 / SY	=	\$1,197.00
	SUBTOTAL LJ @ LR	=	\$36,439.00

TOTAL \$65,806.05

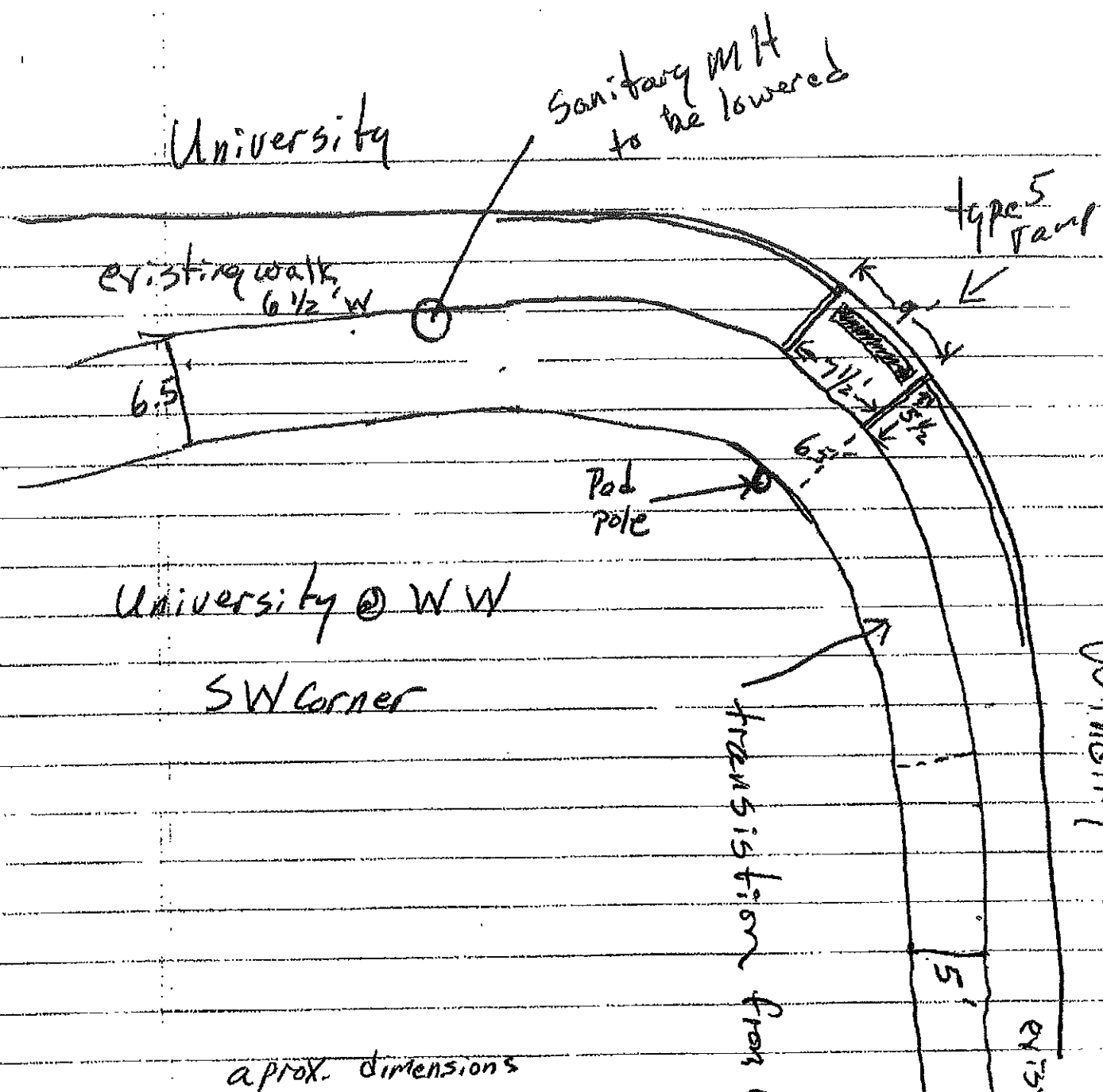

aprox. dimensions
aprox quantity

- Remove sidewalk 56 s.f.
- new sidewalk 50 s.f.
- adj San MH 1 ea
- type 5 ramp 1 ea

Traffic Systems Construction, Inc.

P.O. BOX 1346 Dickinson, Texas 77539 Office (281) 337-1926 Fax No. 1 (281) 534-1937
www.trafficsci.com

CHANGE ORDER

DATE : 08/26/2022 No. 5
 GENERAL CONTRACTOR : TSC
 OWNER : FORT BEND COUNTY KM
 PROJECT NUMBER : 22-014
 LOCATION : UNIVERSITY BLVD AND WINDING WATERS
 DESCRIPTION OF WORK : QUANTITY OVERRUNS FOR CONCRETE WORK AND
 NEW BID ITEM FOR TYPE 5 WHEELCHAIR RAMP
 PLEASE NOTE : ALL CHANGE ORDERS MUST BE APPROVED OR DENIED WITHIN 60 DAYS
 AFTER 60 DAYS THE CHANGE ORDER PRICING WILL NO LONGER BE VALID
 DUE TO MATERIAL SUPPLIER PRICE INCREASES.

COST BREAKDOWN

MATERIAL

ITEM	UNIT	QTY.	UNIT PRICE	TAXABLE	NON-TAXABLE
QUANTITY OVERRUNS	LS	1	\$73,111.80		\$73,111.80
				SUBTOTAL	\$0.00
			PROFIT & COMPENSATION	0%	\$0.00
			MATERIAL TOTAL		\$73,111.80

EQUIPMENT

ITEM	UNIT	QTY.	UNIT PRICE	TAXABLE	NON-TAXABLE
FLATBED TRUCK	HR	0	\$0.00		\$0.00
TRAILER	HR	0	\$0.00		\$0.00
BACKHOE	HR	0	\$0.00		\$0.00
				SUBTOTAL	\$0.00
			PROFIT & COMPENSATION	15%	\$0.00
			EQUIPMENT TOTAL		\$0.00

LABOR

ITEM	UNIT	QTY.	UNIT PRICE	TAXABLE	NON-TAXABLE
SUPERVIR	HR	0	\$0.00		\$0.00
FOREMAN	HR	0	\$0.00		\$0.00
LABORER	HR	0	\$0.00		\$0.00
				SUBTOTAL	\$0.00
			PROFIT & COMPENSATION	15%	\$0.00
			LABOR BURDEN	55%	\$0.00
			LABOR TOTAL		\$0.00

GRAND TOTAL \$73,111.80

TRAFFIC SYSTEMS CONSTRUCTION, INC.

STEVE KASS

PH. (281) 337-1926 FAX 1 (281) 337-2968

COUNTY: FORT BEND

PROJECT No. : 22-014

LOCATION: UNIVERSITY BOULEVARD

BID DATE: 10/19/2021

BASE UNIT PRICES FOR:

\$73,111.80

ITEM NO.	DESCRIPTION	UNIT	QTY	UNIT BID	TOTAL
----------	-------------	------	-----	----------	-------

UNIVERSITY BLVD. AT WINDING WATERS

ORIGINAL CONTRACT ITEM:

OVER RUN	CONC PVMT (CONT REINF - CRCP) (10")	SY	43.00	\$925.00	\$39,775.00
OVER RUN	CONC CURB (TY II)	LF	17.00	\$23.00	\$391.00
OVER RUN	CONC SIDEWALKS (4")	SY	48.00	\$167.00	\$8,016.00

PREVIOUS CHANGE ORDER & OVER-RUN:

OVER RUN	STABILIZED SAND (8" SUBGRADE)	EA	38.50	\$117.30	\$4,516.05
OVER RUN	REMOVE & DISPOSE EXISTING SIDEWALKS & RAMPS	SY	55.50	\$287.50	\$15,956.25

NEW ITEM:

NEW ITEM	TYPE 5 WC RAMP	EA	1.00	\$3,852.50	\$3,852.50
----------	----------------	----	------	------------	------------

LJ PARKWAY AT WINDING WATERS

ORIGINAL CONTRACT ITEM

OVER RUN	ADJUSTNG MANHOLES	EA	1.00	\$605.00	\$605.00
----------	-------------------	----	------	----------	----------

\$73,111.80

Invoice

SPRING CREEK CONSTRUCTION, INC.
 P.O. BOX 9574
 SPRING, TX 77387-9574
 (281) 367-5283

DATE	INVOICE #
8/25/2022	530-22 A

BILL TO:
TRAFFIC SYSTEMS CONSTRUCTION
 PO Box 1346
 Dickinson, TX 77539-1346

P.O. NUMBER	TERMS	PROJECT
	Due on receipt	Univ Blvd & @Winding Waters

QUANTITY	DESCRIPTION	RATE	AMOUNT
----------	-------------	------	--------

This is to invoice you for the work performed on the Ft Bend Co project #B22-014 on University @ Winding Waters. Work performed from 7/25/22 thru 8/25/22. See breakdown below. 78,621.00

- #2. Conc Pavement (10").
 5 SY @ \$ 800.00 / SY = \$ 4,000.00 ✓
- #6. Conc Curb.
 20 LF @ \$ 20.00 / LF = \$ 400.00 ✓
- #7. Conc Sidewalks (4").
 33 SY @ \$ 145.00 / SY = \$ 4,785.00 ✓
- #8. Curb Ramps (TY 7).
 1 EA @ \$2650.00 / EA = \$ 2,650.00 ✓

PREVIOUS CHANGE ORDER:

- Excavation.
 1 LS @ \$2315.00 / LS = \$ 2,315.00 ✓
 - Stabilized Sand (8" subgrade).
 9.5 SY @ \$102.00 / SY = \$ 969.00 ✓
 - Remove & Dispose existing sidewalk & ramps.
 0.5 SY @ \$250.00 / SY = \$ 125.00 ✓
- SUBTOTAL = \$15,244.00**

OVER-RUN QUANTITIES:

- #2. Conc Pavement (10').
 43 SY @ \$800.00 / SY = \$34,400.00 *

TOTAL

SPRING CREEK CONSTRUCTION, INC. P.O. BOX 9574 SPRING, TX 77387-9574 (281) 367-5283

Invoice

SPRING CREEK CONSTRUCTION, INC.
 P.O. BOX 9574
 SPRING, TX 77387-9574
 (281) 367-5283

DATE	INVOICE #
8/25/2022	530-22 A

BILL TO:

TRAFFIC SYSTEMS CONSTRUCTION
 PO Box 1346
 Dickinson, TX 77539-1346

P.O. NUMBER	TERMS	PROJECT
	Due on receipt	Univ Blvd & @ Winding Waters

QUANTITY	DESCRIPTION	RATE	AMOUNT
----------	-------------	------	--------

- #6. Conc curb.
 17 LF @ \$ 20.00 / LF = \$ 340.00 *
- #7. Conc Sidewalks.
 48 SY @ \$145.00 / SY = \$ 6,960.00 *
- #4. Adjust MH. (LJ Pkwy @ W.W. pay items)
 1 EA @ \$525.00 / EA = \$ 525.00 *

PREVIOUS CHANGE ORDER OVER-RUN ITEMS:

- Stabilized Sand (8" subgrade).
 38.5 SY @ \$102.00 / SY = \$ 3,927.00 *
- Remove & dispose existing sidewalks & ramps.
 55.5 SY @ \$250.00 / SY = \$ 13,875.00 *
- OVER-RUN SUBTOTAL = \$60,027.00**

NEW CHANGE ORDER ITEM:

- Type 5 WC ramp.
 1 EA @ \$3350.00 / EA = **\$3,350.00** *

TOTAL = \$78,621.00

TOTAL \$78,621.00

TRAFFIC SYSTEMS CONSTRUCTION, INC.

STEVE KASS

PH. (281) 337-1926 FAX 1 (281) 337-2968

COUNTY: FORT BEND

PROJECT No. : 22-014

LOCATION: UNIVERSITY BLVD

BID DATE: 07/12/2022

BASE UNIT PRICES FOR:

\$6,658.28

ITEM NO.	DESCRIPTION	UNIT	QTY	UNIT BID	TOTAL
1	3 (EA) 24x36x24 GROUND BOX W/ APRON	LS	1.00	\$7,755.84	\$7,755.84
2	RELOCATE EXISTING LIGHT POLE	LS	1.00	\$1,687.44	\$1,687.44

CREDITS

INTERSECTION #1 - UNIVERSITY BLVD

18	GROUND BOX TY D W/ APRON	EA	1.00	(\$925.00)	(\$925.00)
----	--------------------------	----	------	------------	------------

INTERSECTION #2 - WINDING WATERS

18	GROUND BOX TY D W/ APRON	EA	1.00	(\$935.00)	(\$935.00)
----	--------------------------	----	------	------------	------------

INTERSECTION #3 - LAKE RIVERSTONE

17	GROUND BOX TY D W/ APRON	EA	1.00	(\$925.00)	(\$925.00)
----	--------------------------	----	------	------------	------------

GRAND TOTAL

\$6,658.28

Traffic Systems Construction, Inc.

P.O. BOX 1346 Dickinson, Texas 77539 Office (281) 337-1926 Fax No. 1 (281) 634-1937
www.trafficsci.com

CHANGE ORDER

DATE : 08/30/2022 No. 6
GENERAL CONTRACTOR : TSC
OWNER : FORT BEND COUNTY KM
PROJECT NUMBER : 22-014
LOCATION : UNIVERSITY, WINDING WATERS AND LAKE RIVERSTONE
DESCRIPTION OF WORK : QUANTITY OVERRUNS FOR TRAFFIC SIGNAL WORK

PLEASE NOTE : ALL CHANGE ORDERS MUST BE APPROVED OR DENIED WITHIN 60 DAYS
AFTER 60 DAYS THE CHANGE ORDER PRICING WILL NO LONGER BE VALID
DUE TO MATERIAL SUPPLIER PRICE INCREASES.

COST BREAKDOWN

MATERIAL

ITEM	UNIT	QTY.	UNIT PRICE	TAXABLE	NON-TAXABLE
QUANTITY OVERRUNS	LS	1	\$11,485.00		\$11,485.00
				SUBTOTAL	\$0.00
				PROFIT & COMPENSATION	0%
				MATERIAL TOTAL	\$11,485.00

EQUIPMENT

ITEM	UNIT	QTY.	UNIT PRICE	TAXABLE	NON-TAXABLE
FLATBED TRUCK	HR	0	\$0.00		\$0.00
TRAILER	HR	0	\$0.00		\$0.00
BACKHOE	HR	0	\$0.00		\$0.00
				SUBTOTAL	\$0.00
				PROFIT & COMPENSATION	15%
				EQUIPMENT TOTAL	\$0.00

LABOR

ITEM	UNIT	QTY.	UNIT PRICE	TAXABLE	NON-TAXABLE
SUPERVIO	HR	0	\$0.00		\$0.00
FOREMAN	HR	0	\$0.00		\$0.00
LABORER	HR	0	\$0.00		\$0.00
				SUBTOTAL	\$0.00
				PROFIT & COMPENSATION	15%
				LABOR BURDEN	55%
				LABOR TOTAL	\$0.00
				GRAND TOTAL	\$11,485.00

TRAFFIC SYSTEMS CONSTRUCTION, INC.

STEVE KASS

PH. (281) 337-1926 FAX 1 (281) 337-2968

COUNTY: FORT BEND
PROJECT No. : 22-014
LOCATION: UNIVERSITY BOULEVARD
BID DATE: 08/30/2022

CHANGE ORDER 6
QUANTITY OVERUNS

BASE UNIT PRICES FOR:

\$11,485.00

ITEM NO.	DESCRIPTION	UNIT	QTY	UNIT BID	TOTAL
INTERSECTION #1 --UNIVERSITY BLVD.--					
11	CONDT (PVC) (SCHD 80) (2") (BORE)	LF	220.00	\$19.25	\$4,235.00
15	ELEC CONDR (NO. 8) BARE	LF	110.00	\$1.45	\$159.50
16	ELEC CONDR (NO. 4) INSUALTED	LF	425.00	\$2.35	\$998.75
INTERSECTION #2----LJ PARKWAY AND WINDNIG WATERS					
10	CONDT (PVC) (SCHD 80) (2")	LF	150.00	\$14.50	\$2,175.00
15	ELEC CONDR (NO. 8) BARE	LF	100.00	\$1.50	\$150.00
16	ELEC CONDR (NO. 4) INSUALTED	LF	425.00	\$2.45	\$1,041.25
INTERSECTION #3---LJ PARKWAY AND LAKE RIVERSTONE					
10	CONDT (PVC) (SCHD 80) (2")	LF	95.00	\$16.15	\$1,534.25
14	ELEC CONDR (NO. 8) BARE	LF	100.00	\$1.50	\$150.00
15	ELEC CONDR (NO. 4) INSUALTED	LF	425.00	\$2.45	\$1,041.25
					\$11,485.00