

**PLAT RECORDING SHEET**

**PLAT NAME:** Morales Subdivision

\_\_\_\_\_

**PLAT NO:** \_\_\_\_\_

**ACREAGE:** 3.74

**LEAGUE:** Joseph McCormick League

**ABSTRACT NUMBER:** 57

**NUMBER OF BLOCKS:** 1

**NUMBER OF LOTS:** 1

**NUMBER OF RESERVES:** 0

**OWNERS:** CMK Investments, Inc.

\_\_\_\_\_

\_\_\_\_\_

\_\_\_\_\_

\_\_\_\_\_

\_\_\_\_\_

\_\_\_\_\_

\_\_\_\_\_

\_\_\_\_\_  
**(DEPUTY CLERK)**

STATE OF TEXAS :  
COUNTY OF FORT BEND:

We, CMK INVESTMENTS, INC., acting by and through Christina Morales, President; hereinafter referred to as Owners of the 3.74 acre tract described in the above and foregoing map of MORALES SUBDIVISION, do hereby make and establish said subdivision and development plan of said property according to all lines, dedications, restrictions, and notations on said map or plat do hereby dedicate to the use of the public forever, all streets, alleys, parks, water courses, drains, easements, and public places shown thereon for the purposes and considerations therein expressed; and do hereby bind ourselves, our heirs, successors and assigns to warrant and forever defend the title to the land so dedicated.

FURTHER, Owners have dedicated and by these presents do dedicate to the use of the public for public utility purposes forever unobstructed aerial easements. The aerial easements shall extend horizontally an additional eleven feet, six inches (11' 6") for ten feet (10' 0") perimeter ground easements or seven feet, six inches (7' 6") for fourteen feet (14' 0") perimeter ground easements or five feet, six inches (5' 6") for sixteen feet (16' 0") perimeter ground easements, from a plane sixteen feet (16' 0") above ground level upward, located adjacent to and adjoining said public utility easements that are designed with aerial easements (U.E. and A.E.) as indicated and depicted hereon, whereby the aerial easement totals twenty one feet, six inches (21' 6") in width.

FURTHER, Owners have dedicated and by these presents do dedicate to the use of the public for public utility purposes forever unobstructed aerial easements. The aerial easements shall extend horizontally an additional ten feet (10' 0") for ten feet (10' 0") back-to-back ground easements or eight feet (8' 0") for fourteen feet (14' 0") back-to-back ground easements or seven feet (7' 0") for sixteen feet (16' 0") back-to-back ground easements, from a plane sixteen feet (16' 0") above ground level upward, located adjacent to both sides and adjoining said public utility easements that are designed with aerial easements (U.E. and A.E.) as indicated and depicted hereon, whereby the aerial easement totals thirty feet (30' 0") in width.

FURTHER, Owners do hereby declare that all parcels of land designated as lots on this plat are intended for the construction of single family residential dwelling units thereon and shall be restricted for same under the terms and conditions of such restrictions filed separately.

FURTHER, Owners do hereby covenant and agree that all of the property within the boundaries of this plat shall be restricted to prevent the drainage of any septic tank into any public or private street, road or alley or any drainage ditch, either directly or indirectly.

FURTHER, Owners do hereby dedicate to the public a strip of land twenty feet (20' 0") wide on each side of the center line of any and all bayous, creeks, gullies, ravines, draws, sloughs, or other natural drainage courses located in said plat, as easements for drainage purposes, giving Fort Bend County, or any other governmental agency, the right to enter upon said easement at any times for the purpose of construction and maintenance of drainage facilities and structures.

FURTHER, Owners do hereby covenant and agree that all of the property within the boundaries of this plat and adjacent to any drainage easement, ditch, gully, creek or natural drainage way is hereby restricted to keep such drainage ways and easements clear of fences, buildings, planting and other obstructions to the operations and maintenance of the drainage facility and that such abutting property shall not be permitted to drain directly into this easement except by means of an approved drainage structure.

FURTHER, Owners do hereby acknowledge the receipt of the "Orders for Regulation of Outdoor Lighting in the Unincorporated Areas of Fort Bend County, Texas," and do hereby covenant and agree and shall comply with this order as adopted by Fort Bend County Commissioners Court on March 23, 2004, and any subsequent amendments.

IN TESTIMONY WHEREOF THE, CMK INVESTMENTS, INC., has caused these presents to be signed by Christina Morales, President, thereunto authorized, this \_\_\_\_ day of \_\_\_\_\_, 2022.

CMK INVESTMENTS, INC.

By: \_\_\_\_\_  
Christina Morales, President

STATE OF TEXAS:  
COUNTY OF FORT BEND

BEFORE ME, the undersigned authority, on this day personally appeared Christina Morales, President of CMK INVESTMENTS, INC., known to me to be the person whose name is subscribed to the foregoing instrument, and acknowledged to me that she executed the same for the purposes and considerations therein expressed and in the capacity therein stated.

GIVEN UNDER MY HAND AND SEAL OF OFFICE, this \_\_\_\_ day of \_\_\_\_\_, 2022.

Notary Public in and for the State of Texas

My Commission Expires \_\_\_\_\_ Notary Public

I, Richard S. Willett, am authorized under the laws of the State of Texas to practice the profession of surveying and hereby certify that the above subdivision is true and accurate; was prepared from an actual survey of the property made under my supervision on the ground; that, except as shown, all boundary corners, angle points, points of curvature and other points of reference have been marked with iron rods having an outside diameter of five-eighths (5/8) inch and a length of three (3) feet; and that the plat boundary corners have been tied to the Texas Coordinate System of 1983, South Central Zone.



RICHARD S. WILLETT  
PROFESSIONAL LAND SURVEYOR  
NO. 4615

I, Osiel Perez-Angon, a Professional Engineer registered in the State of Texas, do hereby certify that this plat meets the requirements of Fort Bend County to the best of my knowledge.

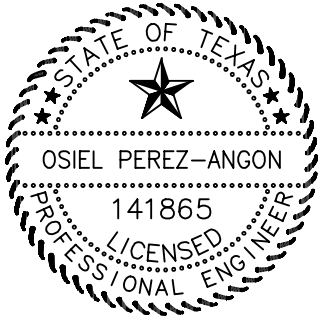

Osiel Perez-Angon, P.E.  
Texas Registration No. 141865

#### NOTES:

- THE COORDINATES AND BEARINGS SHOWN HEREON ARE TEXAS SOUTH CENTRAL ZONE, NO. 4204, STATE PLANE SURFACE COORDINATES (NAD '83) AND MAY BE BROUGHT TO GRID BY APPLYING THE FOLLOWING COMBINED SCALE 0.999866671.
- ACCORDING TO THE FEDERAL EMERGENCY MANAGEMENT AGENCY'S FLOOD INSURANCE RATE MAP FOR FORT BEND COUNTY, TEXAS AND INCORPORATED AREAS, COMMUNITY PANEL NO. 48157-C-0350 M, EFFECTIVELY DATED DECEMBER 21, 2017, THIS PROPERTY LIES IN ZONE "X", AN AREA DETERMINED TO BE OUTSIDE OF THE 0.2% ANNUAL CHANCE FLOODPLAIN.
- THE DRAINAGE SYSTEM FOR THIS SUBDIVISION SHALL BE DESIGNED TO MEET THE REQUIREMENTS OF THE FORT BEND COUNTY DRAINAGE CRITERIA MANUAL WHICH ALLOWS STREET PONDING WITH INTENSE RAINFALL EVENTS.
- ALL DRAINAGE EASEMENTS TO BE KEPT CLEAR OF FENCES, BUILDINGS, VEGETATION AND OTHER OBSTRUCTIONS TO THE OPERATION AND MAINTENANCE OF THE DRAINAGE FACILITY.
- THE TOP OF ALL FLOOR SLABS SHALL BE A MINIMUM OF 111.10 FEET ABOVE MEAN SEA LEVEL (NAVD '88). IN ADDITION, NO TOP OF SLAB ELEVATION SHALL BE LESS THAN 24 INCHES ABOVE THE LOWEST TOP OF CURB ADJACENT TO THE LOT IN WHICH IT LIES. IN THE ABSENCE OF A CURB, THE TOP OF SLAB ELEVATION SHALL BE NO LESS THAN 24 INCHES ABOVE THE HIGHEST NATURAL GROUND ALONG THE PERIMETER OF THE BUILDING FOUNDATION AND 12 INCHES ABOVE ANY DOWN GRADIENT ROADWAY OR DRAINAGE RESTRAINT, WHICHEVER IS HIGHER.
- ALL PROPERTY TO DRAIN INTO DRAINAGE EASEMENT ONLY THROUGH AN APPROVED DRAINAGE STRUCTURE.
- ALL OF THE PROPERTY SUBDIVIDED IN THE FOREGOING PLAT IS WHOLLY WITHIN THE LAMAR CONSOLIDATED INDEPENDENT SCHOOL DISTRICT, FORT BEND ESD NO. 8, AND FORT BEND COUNTY, TEXAS.
- THIS PROPERTY IS IN DESIGNATED LIGHTING ZONE LZ3.
- THERE ARE NO KNOWN PIPELINES OR KNOWN PIPELINE EASEMENTS LOCATED ON THE TRACT.
- ABSENT WRITTEN AUTHORIZATION BY THE AFFECTED UTILITIES, ALL UTILITY AND AERIAL EASEMENTS MUST BE KEPT UNOBSTRUCTED FROM ANY NON-UTILITY IMPROVEMENTS OR OBSTRUCTIONS BY THE PROPERTY OWNER. ANY UNAUTHORIZED IMPROVEMENTS OR OBSTRUCTIONS MAY BE REMOVED BY ANY PUBLIC UTILITY AT THE PROPERTY OWNER'S EXPENSE. WHILE WOODEN POSTS AND PANELED WOODEN FENCES ALONG THE PERIMETER AND BACK TO BACK EASEMENTS AND ALONGSIDE REAR LOTS LINES ARE PERMITTED, THEY TOO MAY BE REMOVED BY PUBLIC UTILITIES AT THE PROPERTY OWNER'S EXPENSE SHOULD THEY BE AN OBSTRUCTION. PUBLIC UTILITIES MAY PUT SAID WOODEN POSTS AND PANELED WOODEN FENCES BACK UP, BUT GENERALLY WILL NOT REPLACE WITH NEW FENCING.
- SITE PLANS SHALL BE SUBMITTED TO FORT BEND COUNTY AND ANY OTHER APPLICABLE JURISDICTION FOR REVIEW AND APPROVAL. DEVELOPMENT PERMITS AND ALL OTHER APPLICABLE PERMITS SHALL BE OBTAINED FROM FORT BEND COUNTY PRIOR TO BEGINNING CONSTRUCTION.
- A MINIMUM DISTANCE OF 10 FEET SHALL BE MAINTAINED BETWEEN RESIDENTIAL DWELLINGS.
- LAND USE WITHIN THE SUBDIVISION IS LIMITED TO AN AVERAGE IMPERVIOUSNESS OF NO MORE THAN 7.52% (12,251 SQ.FT.) FOR THIS LOT. THE DRAINAGE AND/OR DETENTION SYSTEM HAS BEEN DESIGNED WITH THE ASSUMPTION THAT THIS AVERAGE PERCENT IMPERVIOUSNESS WILL NOT BE EXCEEDED. IF THIS PERCENTAGE IS TO BE EXCEEDED A REPLAT AND/OR REDESIGN OF THE SYSTEM MAY BE NECESSARY.
- THIS RURAL SUBDIVISION EMPLOYS A NATURAL DRAINAGE SYSTEM WHICH IS INTENDED TO PROVIDE DRAINAGE FOR THE SUBDIVISION THAT IS SIMILAR TO THAT WHICH EXISTED UNDER PRE-DEVELOPMENT CONDITIONS. THUS, DURING LARGE STORM EVENTS, PONDING OF WATER SHOULD BE EXPECTED TO OCCUR IN THE SUBDIVISION TO THE EXTENT IT MAY HAVE PRIOR TO DEVELOPMENT, BUT SUCH PONDING SHOULD NOT REMAIN FOR AN EXTENDED PERIOD OF TIME.

#### LEGEND

- B.L. - BUILDING LINE
- EDNC. - EDCRETE
- ESMT - EASEMENT
- B.C.L. - DIRECTIONAL CONTROL LINE
- F.B.C.C.F. - FORT BEND COUNTY CLERK'S FILE
- F.B.C.D.R. - FORT BEND COUNTY DEED RECORDS
- F.B.C.O.R. - FORT BEND COUNTY OFFICIAL RECORDS
- F.B.C.P.R. - FORT BEND COUNTY PLAT RECORDS
- FND - FUND
- IP - IRON PIPE
- IR - IRON ROD
- U.E. - LANDSCAPE EASEMENT
- R.O.W. - RIGHT OF WAY
- SQ. FT. - SQUARE FEET
- U.E. - UTILITY EASEMENT
- V. - WITH

#### GRAPHIC SCALE

60 0 30 60 120 240

( IN FEET )

1 inch = 60 ft.

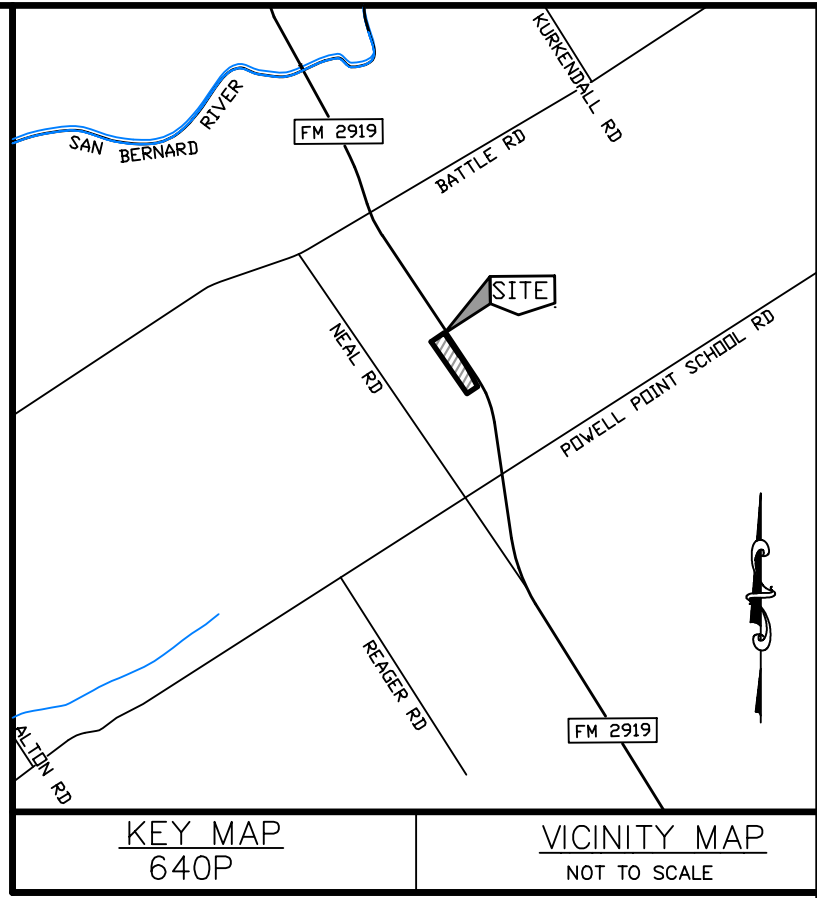

I, J. STACY SLAWINSKI, P.E., FORT BEND COUNTY ENGINEER, DO HEREBY CERTIFY THAT THE PLAT OF THIS SUBDIVISION COMPLIES WITH ALL OF THE EXISTING RULES AND REGULATIONS OF THIS OFFICE AS ADOPTED BY THE FORT BEND COUNTY COMMISSIONERS' COURT; HOWEVER, NO CERTIFICATION IS HEREBY GIVEN AS TO THE EFFECT OF DRAINAGE FROM THIS SUBDIVISION ON THE INTERCEPTING DRAINAGE ARTERY OR PARENT STREAM OR ON ANY OTHER AREA OR SUBDIVISION WITHIN THE WATERSHED.

J. STACY SLAWINSKI, P.E.,  
FORT BEND COUNTY ENGINEER

APPROVED BY THE COMMISSIONERS' COURT OF FORT BEND COUNTY, TEXAS THIS \_\_\_\_ DAY OF \_\_\_\_\_, 2022.

VINCENT M. MORALES, JR., COMMISSIONER  
PRECINCT 1

GRADY PRESTAGE, COMMISSIONER  
PRECINCT 2

KP GEORGE, COUNTY JUDGE

W. A. "ANDY" MEYERS, COMMISSIONER  
PRECINCT 3

KEN R. DEMERCHANT, COMMISSIONER  
PRECINCT 4

I, LAURA RICHARD, COUNTY CLERK IN AND FOR FORT BEND COUNTY, DO HEREBY CERTIFY THAT THE FOREGOING INSTRUMENT WITH ITS CERTIFICATE OF AUTHENTICATION WAS FILED FOR RECORDATION IN MY OFFICE ON \_\_\_\_\_, 2022, AT \_\_\_\_ O'CLOCK \_\_\_\_ M, IN PLAT NUMBER(S) \_\_\_\_\_ OF THE PLAT RECORDS OF SAID COUNTY.

WITNESS MY HAND AND SEAL OF OFFICE, AT RICHMOND, TEXAS, THE DAY AND DATE LAST ABOVE WRITTEN.

BY: \_\_\_\_\_  
LAURA RICHARD, COUNTY CLERK  
FORT BEND COUNTY, TEXAS

BY: \_\_\_\_\_  
DEPUTY

## MORALES SUBDIVISION

A SUBDIVISION OF A 3.74 ACRE TRACT OF LAND  
IN THE JOSEPH MCCORMICK LEAGUE,  
ABSTRACT NO. 57,  
FORT BEND COUNTY, TEXAS

1 LOT - 1 BLOCK - 0 RESERVES

~ OWNERS ~

**CMK INVESTMENTS, INC.**  
2901 Canal Street  
Houston, Texas 77003  
PHONE: 713.515.4779

~ SURVEYOR ~

**PRECISION SURVEYS**

PROFESSIONAL LAND SURVEYS  
1-800-LANDSURVEY  
www.precisionlandsurvey.com  
281-496-1586 FAX 281-496-1867  
950 THROUGHFALL STREET SUITE 150 HOUSTON, TEXAS 77079  
210-829-4941 FAX 210-829-1555  
1777 NE LOOP 410 SUITE 800 SAN ANTONIO, TEXAS 78217  
FIRM NO. 10063700

~ PLANNER ~

**McKIM&CREED**  
ENGINEERS, SURVEYORS, PLANNERS  
12718 Century Drive  
Stafford, Texas 77477  
281.491.2525  
www.mckimcreed.com  
TBEPLS Firm Registration No. 10177600  
JOB NO. 08956-0001  
JUNE 14, 2022

| DISTRICT NAMES             |              |
|----------------------------|--------------|
| COUNTY ASSISTANCE DISTRICT | N/A          |
| ESD                        | FB ESD NO. 8 |
| MUD                        | N/A          |
| LID                        | N/A          |
| DID                        | N/A          |
| SCHOOL                     | LAMAR CISD   |
| FIRE                       | N/A          |
| IMPACT FEE AREA            | N/A          |
| CITY OR CITY ETJ           | N/A          |
| UTILITIES CO.              | CENTERPOINT  |