



Fort Bend County Engineering
FORT BEND COUNTY, TEXAS

J. Stacy Slawinski, P.E.
County Engineer

June 30, 2022

Judge KP George
Fort Bend County Judge
301 Jackson Street, Suite 719
Richmond, Texas 77406-0148

Re: *Public Road Connection for Twilight Star Lane at FM 1464 for Haven at Mission Trace on behalf of Guefen Development Partners, LLC, and FBC MUD 30 – Sponsorship*

Honorable Judge George:

Fort Bend County Engineering Department has received and reviewed a request (letter attached) from Kimley-Horn & Associates, Inc., on behalf of Guefen Development Partners LLC., for Fort Bend County to sponsor a project for a public road connection for Twilight Star Lane at FM 1464. The road connection will provide a secondary point of access for the Haven at Mission Trace.

Any and all cost involved with the project will be borne by Guefen Development Partners, LLC., and FBC MUD 30. There will be no cost to Fort Bend County.

The Texas Department of Transportation requests that an agency, such as Fort Bend County, act as a sponsor for the project. This means that the permit for the work will be issued in the name of Fort Bend County and the County accepts responsibility for the terms and conditions of the permit.

We recommend acceptance of the sponsorship and request that this item be placed on the 07/12/2022 Commissioners Court agenda. We have prepared a letter to Texas Department of Transportation for the County Judges' signature.

If there are any questions please do not hesitate to call.

Sincerely,

Maggie Dalton
Development Services Manager

Attachment: Scope of Work

cc: Commissioner Ken R. DeMerchant, Pct. 4
File

DRAFT

(To be placed on Co. Judge stationery)
(Return executed document to Courtney
Velasquez- Engineering 281-633-7516)

May 23, 2022

Ms. Eliza Paul, P.E.
District Engineer, Houston District
Texas Department of Transportation
7600 Washington Ave.
Houston, TX 77007-1044
Eliza.paul@txdot.gov

Re: ***Public Road Connection for Twilight Star Lane at FM 1464 on behalf of
Guefen Development Partners, LLC. and FBC MUD 30 - Sponsorship***

Dear Ms. Paul:

Fort Bend County has received and reviewed a request (letter attached) from Kimley-Horn and Associates, Inc. for Fort Bend County to sponsor a Texas Department of Transportation project on behalf of Guefen Development Partners, LLC. and FBC MUD 30 for a public road connection for Twilight Star Lane at FM 1464, at no cost to the County.

The request was approved by Fort Bend County Commissioners Court at their meeting dated 07/12/2022. We request that a permit for the public road connection be issued with Fort Bend County as sponsor for this project.

If there are any questions or need for additional information, please call Maggie Dalton in our Engineering Department at 281-633-7515.

Sincerely,

KP George
Fort Bend County Judge

KPG/

Attachments: Resolution
Drawing

cc: Mr. Andy Hall, P.E., Kimley-Horn and Associates, Inc.
andy.hall@kimley-horn.com
Ms. Denese Laskowski, TxDOT denese.laskowski@txdot.gov
File

THE STATE OF TEXAS §

COUNTY OF FORT BEND §

**RESOLUTION TO SPONSOR A PROJECT FOR A PUBLIC ROAD CONNECTION
FOR TWILIGHT STAR LANE AT FM 1464 ON BEHALF OF GUEFEN
DEVELOPMENT PARTNERS LLC. AND FBC MUD 30**

On this _____ day of _____, 2022, the Commissioners Court, sitting as the governing body of Fort Bend County, Texas, at a regular meeting, upon motion of Commissioner _____, seconded by Commissioner _____, duly put and carried;

WHEREAS, the proposed sponsorship project includes the installation of a public road connection at Twilight Star Lane at FM 1464.

WHEREAS, the funding for such sponsorship of the project is to be provided through sources other than Fort Bend County.

NOW, THEREFORE, BE IT RESOLVED that Fort Bend County expresses its support and sponsorship of such project with the Texas Department of Transportation to cause such improvements to be made at Twilight Star Lane at FM 1464.

FORT BEND COUNTY

By: _____
KP George, County Judge

ATTEST:

Laura Richard, County Clerk



June 29, 2022

Honorable Judge KP George
Fort Bend County Judge
301 Jackson Street, Suite 719
Richmond, Texas 77469

Email: Maggie.dalton@fortbendcountytexas.gov
Development@fortbendcountytexas.gov

**RE: Fort Bend County Municipal Utility District No. 30
Request for Sponsorship Letter
Proposed Street Tie-In at FM 1464 for Haven at Mission Trace Development
Fort Bend County, TX**

Dear Honorable Judge KP George:

We respectfully request that Fort Bend County consider sponsoring the project referenced above. The Texas Department of Transportation ("TxDOT") will only consider a permit for the street tie-in of *Twilight Star* at FM 1464 if you agree to sponsor the work on behalf of Fort Bend County Municipal Utility District No. 30 (the "District"). This will provide the secondary point of access for the Haven at Mission Trace and Wither's Ridge Subdivision.

We are preparing the street connection permit application to submit to TxDOT for the proposed *Twilight Star* street tie-in to FM 1464. Guefen Development Partners, LLC, the developer, will fund the cost of the construction. There will be no expense to Fort Bend County. The attached construction plan drawings were prepared in accordance with TxDOT's street tie-in permit requirements.

Please contact me if you need further information or have any questions.

Sincerely,

KIMLEY-HORN AND ASSOCIATES, INC.

A handwritten signature in black ink, appearing to read "Andy Hall", written over a light blue horizontal line.

Andy Hall, P.E.
Project Manager

NO.	DATE	REVISION	APP.

LEGEND

REF. PAY MARK TYPED 1 (6) 8" SOLID

REF. PAY MARK TYPED 1 (4)

NON-REF. MARKED TRAMPING BUTTON (Y)

REF. PAY MARK TYPED 1 (6) 24" SOLID

REF. PAY MARK TYPED 1 (4) (4") (OLD) (OLD)

LEGEND

EX. ROW BOUNDARY

PROP. FLOW

PROP. WATER

PROP. SANITARY

EXISTING STORM

EXISTING WATER

EXISTING SANITARY

EXISTING GAS

EXISTING ELECTRIC

1	REF. PAY MARK TYPED 1 (6) 8" SOLID
2	REF. PAY MARK TYPED 1 (4)
3	NON-REF. MARKED TRAMPING BUTTON (Y)
4	REF. PAY MARK TYPED 1 (6) 24" SOLID
5	REF. PAY MARK TYPED 1 (4) (4") (OLD) (OLD)

1	REF. PAY MARK TYPED 1 (6) 8" SOLID
2	REF. PAY MARK TYPED 1 (4)
3	NON-REF. MARKED TRAMPING BUTTON (Y)
4	REF. PAY MARK TYPED 1 (6) 24" SOLID
5	REF. PAY MARK TYPED 1 (4) (4") (OLD) (OLD)

1	REF. PAY MARK TYPED 1 (6) 8" SOLID
2	REF. PAY MARK TYPED 1 (4)
3	NON-REF. MARKED TRAMPING BUTTON (Y)
4	REF. PAY MARK TYPED 1 (6) 24" SOLID
5	REF. PAY MARK TYPED 1 (4) (4") (OLD) (OLD)

NOTICE:

THE USER SHALL BE RESPONSIBLE FOR OBTAINING ALL NECESSARY PERMITS AND APPROVALS FROM THE APPROPRIATE AGENCIES. THE USER SHALL BE RESPONSIBLE FOR OBTAINING ALL NECESSARY PERMITS AND APPROVALS FROM THE APPROPRIATE AGENCIES. THE USER SHALL BE RESPONSIBLE FOR OBTAINING ALL NECESSARY PERMITS AND APPROVALS FROM THE APPROPRIATE AGENCIES.

VERIFICATION OF PRIVATE UTILITY LINES

Date: _____

CenterPoint Energy natural gas utilities shown (Gas service lines are not shown). This signature not to be used for permit verification.

Date: _____

CenterPoint Energy/Houston Electric Facilities Verification Only. (This signature verifies existing underground facilities - not to be used for permit verification.)

Kimley-Horn

17700 Katy Freeway, Suite 400 Houston, Texas 77079
Tel. No. (281) 587-1300

GUEFEN-HAVEN AT MISSION TRACE PUBLIC WORKS PLAN

TWILIGHT STAR & FM 1464 ROADWAY IMPROVEMENTS

NOTE: CITY SIGNATURES VALID FOR ONE YEAR ONLY AFTER DATE OF SIGNATURES

CITY OF HOUSTON
HOUSTON PUBLIC WORKS

WATER _____ STORM WATER QUALITY _____

WASTE WATER _____ FACILITIES _____

STORM WATER _____ TRANSPORTATION/STREET & BRIDGE _____

FILE NO. _____

VERT. 1" = 2'

HORIZ. 1" = 2'

SHEET NO. 10 OF 20 DRAWING SCALE

FOR CITY OF HOUSTON USE ONLY

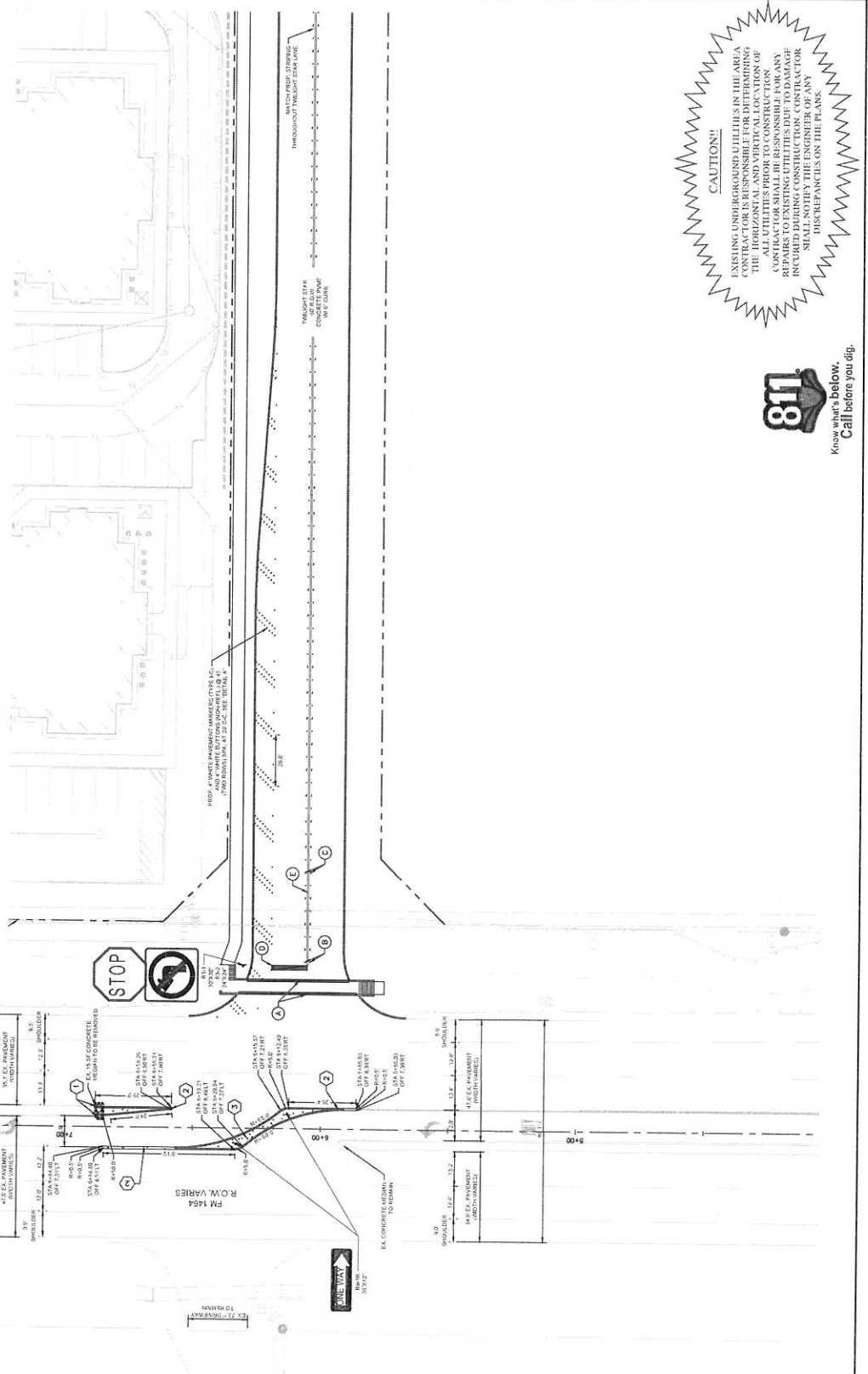

CAUTION!!

EXISTING UNDERGROUND UTILITIES IN THE AREA CONTRACTOR IS RESPONSIBLE FOR DETERMINING THE LOCATION AND DEPTH OF ALL UTILITIES PRIOR TO CONSTRUCTION. CONTRACTOR SHALL BE RESPONSIBLE FOR ANY REPAIRS TO EXISTING UTILITIES DUE TO DAMAGE INCURRED DURING CONSTRUCTION. CONTRACTOR SHALL NOTIFY THE ENGINEER OF ANY DISCREPANCIES ON THE PLANS.

811

Know what's below. Call before you dig.



GRAPHIC SCALE IN FEET
0 10 20 30 40

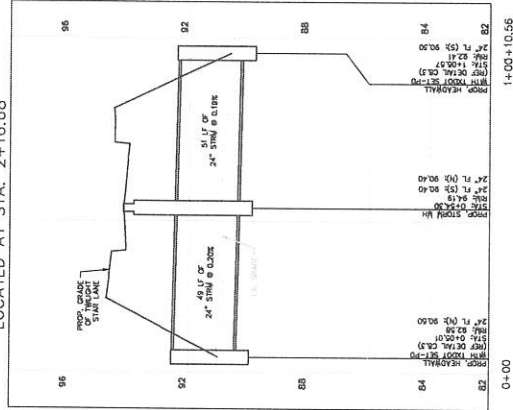
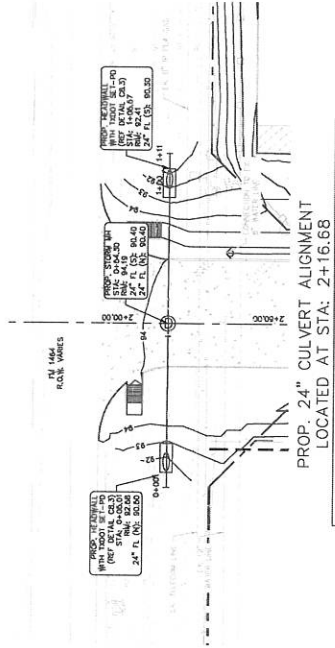

LEGEND	
---	EXISTING SANITARY
---	PROP. STORM
---	PROP. WATER
---	PROP. SANITARY
---	EXISTING STORM
---	EXISTING WATER
---	EXISTING SANITARY
---	EXISTING GAS
---	EXISTING ELECTRIC

NOTICE:
THE USER SHALL BE RESPONSIBLE FOR OBTAINING ALL NECESSARY PERMITS AND RIGHTS OF WAY PRIOR TO CONSTRUCTION. THE USER SHALL BE RESPONSIBLE FOR OBTAINING ALL NECESSARY PERMITS AND RIGHTS OF WAY PRIOR TO CONSTRUCTION. THE USER SHALL BE RESPONSIBLE FOR OBTAINING ALL NECESSARY PERMITS AND RIGHTS OF WAY PRIOR TO CONSTRUCTION.

VERIFICATION OF PRIVATE UTILITY LINES

Date: _____
CenterPoint Energy (gas utilities shown) (Gas service lines are not shown). This signature not to be used for conflict verification.
Signature valid for six months.

Date: _____
CenterPoint Energy (underground Electrical Facilities Verification ONLY) (This signature verifies existing underground facilities - not to be used for conflict verification).
Signature valid for six months.

Date: _____
Signature valid for six months.

Kimley-Horn
11700 Katy Freeway, Suite 600 Houston, Texas 77079
Tel. No. (281) 587-1300

GUEFEN-HAVEN AT MISSION TRACE PUBLIC WORKS PLAN CULVERT PLAN AND PROFILE

NOTE: CITY SIGNATURES VALID FOR ONE YEAR ONLY AFTER DATE OF SIGNATURES

CITY OF HOUSTON HOUSTON PUBLIC WORKS

WATER	STORM WATER QUALITY
WASTE WATER	FACILITIES
STORM WATER	STORM WATER
FILE NO.	STORM WATER
VERT. 1" = 2'	STORM WATER
SHEET NO. 03 OF 20	DRAWING SCALE
FOR CITY OF HOUSTON USE ONLY	

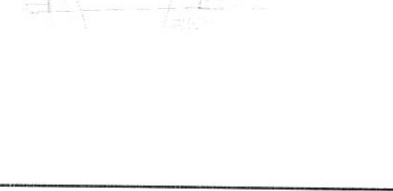

20

26

88

B4

62 1+00

LEGEND	
	UP FROM BOUNDARY
	FLOOD SCUM
	FLOOD WATER
	FLOOD SANDY

EXISTING STORM	
EXISTING DRYER	
EXISTING SHOWER	
EXISTING GAS	
EXISTING ELECTRIC	
PREP CONCRETE PAVT	
PROP 1" DOWELBAR	

CAUTION!

EXISTING UNDEGROUND UTILITIES IN THE AREA OF A CONTRACT ARE RESPONSIBLE FOR DETERMINING THE HORIZONTAL AND VERTICAL LOCATION OF ALL UTILITIES PRIOR TO CONSTRUCTION. CONTRACTORS ARE RESPONSIBLE FOR REPAIRS TO EXISTING UTILITIES DUE TO DAMAGE INCURRED DURING CONSTRUCTION. CONTRACTOR SHALL BE THE FINGERMAN OF ANY DISCREPANCIES ON THE PLANS.



Know what's below.
Call before you dig.

LEOPD	
EX FLOOR BOARDING	
PROP FORM	
PROP WATER	
PROP SANITARY	
EXISTING STORM	
EXISTING WATER	
EXISTING SANITARY	
EXISTING GAS	
EXISTING ELECTRIC	
PROP COGNATE PAINT	
PROP S. 200-204A	

NO.	DATE	REVISION

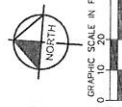

NOTICE:
 THE CITY OF HOUSTON HAS REVIEWED THIS PLAN AND APPROVED IT FOR THE CITY OF HOUSTON. THE CITY OF HOUSTON DOES NOT GUARANTEE THE ACCURACY OF THE INFORMATION PROVIDED HEREON. THE CITY OF HOUSTON DOES NOT GUARANTEE THE ACCURACY OF THE INFORMATION PROVIDED HEREON. THE CITY OF HOUSTON DOES NOT GUARANTEE THE ACCURACY OF THE INFORMATION PROVIDED HEREON.

VERIFICATION OF PRIVATE UTILITY LINES

Date: _____
 Signature: _____

Date: _____
 Signature: _____

Date: _____
 Signature: _____

Kimley-Horn
 17700 Katy Freeway, Suite 800 Houston, Texas 77059
 Tel: 281-477-1510 Fax: 281-477-1511
 TDEC Firm Registration # 4228
 TDEC No. (201) 297-5300

Kimley-Horn
 17700 Katy Freeway, Suite 800 Houston, Texas 77059
 Tel: 281-477-1510 Fax: 281-477-1511
 TDEC Firm Registration # 4228
 TDEC No. (201) 297-5300

GUEFFEN-HAVEN AT MISSION TRACE PUBLIC WORKS PLAN TWILIGHT STAR ROADWAY EXTENSION PLAN & PROFILE (2 OF 2)

CITY OF HOUSTON
 HOUSTON PUBLIC WORKS

NOTE: CITY SIGNATURES VALID FOR ONE YEAR ONLY AFTER DATE OF SIGNATURES

WATER	STORM WATER QUALITY
WASTE WATER	FAHUES
STORM WATER	TRAFFIC & TRANSPORTATION/STREET & BRIDGE
FILE NO.	HORZ. 1" = 20'
	VERT. 1" = 2'

SHEET NO. 05 OF 20 DRAWING SCALE FOR CITY OF HOUSTON USE ONLY

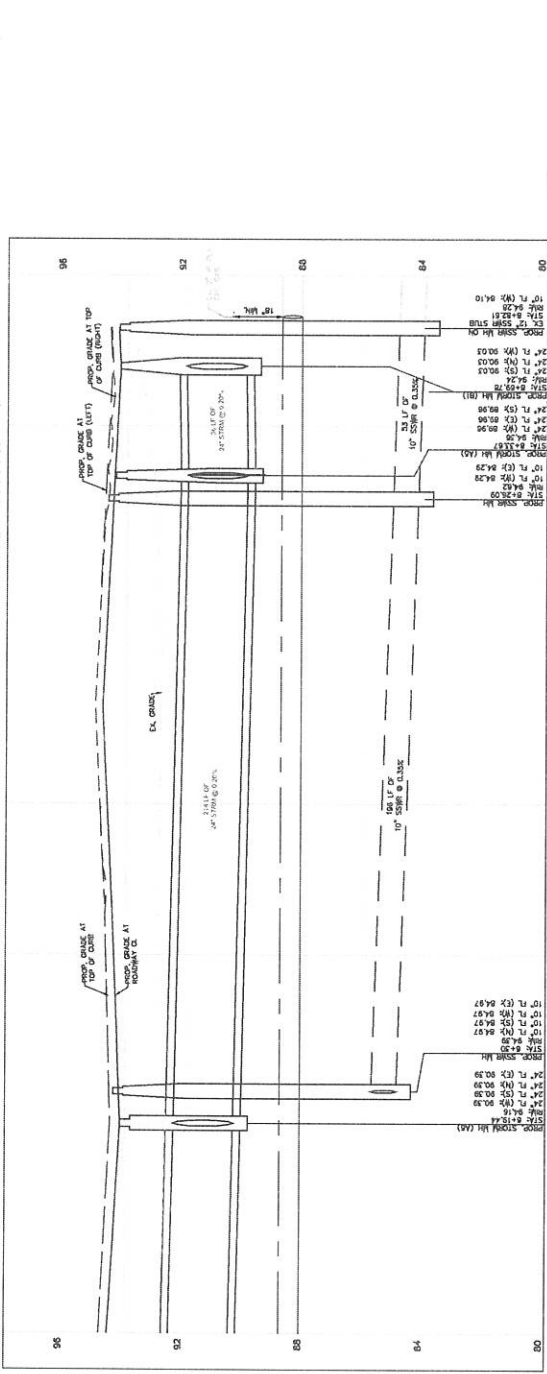
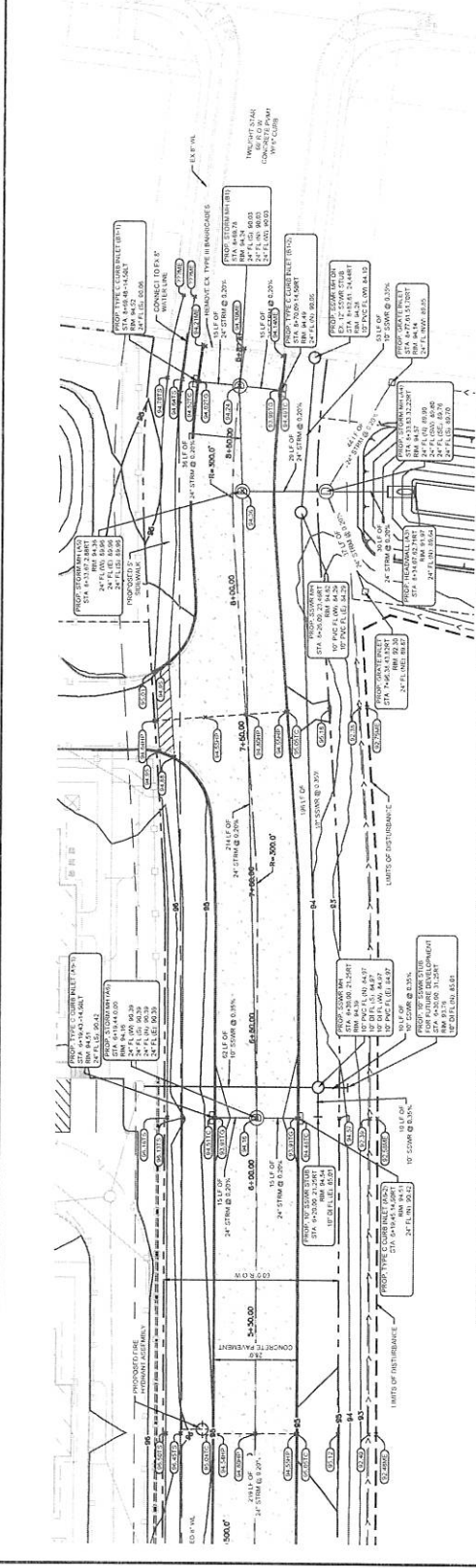

CAUTION!!
 EXISTING UNDERGROUND UTILITIES IN THE AREA CONTRACTOR IS RESPONSIBLE FOR DETERMINING THE LOCATION AND DEPTH OF ALL UTILITIES PRIOR TO CONSTRUCTION OF THE PROJECT. CONTRACTOR SHALL BE RESPONSIBLE FOR ANY REPAIRS TO EXISTING UTILITIES DUE TO DAMAGE INCURRED DURING CONSTRUCTION. CONTRACTOR SHALL NOTIFY THE ENGINEER OF ANY DISCREPANCIES ON THE PLANS.

811
 Know what's below. Call before you dig.

LEGEND

---	EXISTING ROADWAY
---	PROPOSED ROADWAY
---	PROPOSED WATER
---	PROPOSED SANITARY
---	EXISTING STORM
---	EXISTING WATER
---	EXISTING SANITARY
---	EXISTING GAS
---	EXISTING ELECTRIC
---	PROPOSED CONCRETE PAVEMENT
---	PROPOSED CONCRETE CURBSIDE