

PLAT RECORDING SHEET

PLAT NAME: Sienna Section 46

PLAT NO: _____

ACREAGE: 26.279

LEAGUE: William Hall Survey

ABSTRACT NUMBER: 31

NUMBER OF BLOCKS: 2

NUMBER OF LOTS: 62

NUMBER OF RESERVES: 8

OWNERS: Toll-GTIS Property Owner, LLC and Sienna Parks & Levee Improvement District

(DEPUTY CLERK)

STATE OF TEXAS
COUNTY OF FORT BEND

WE, TOLL-GTIS PROPERTY OWNER, LLC, A TEXAS LIMITED LIABILITY COMPANY, ACTING BY AND THROUGH JIMMIE F. JENKINS, AUTHORIZED REPRESENTATIVE, BEING AN OFFICER OF TOLL-GTIS PROPERTY OWNER, LLC, A TEXAS LIMITED LIABILITY COMPANY, AND WE, SIENNA PARKS & LEVEE IMPROVEMENT DISTRICT OF FORT BEND COUNTY, TEXAS, ACTING BY AND THROUGH KEN BECKMAN, PRESIDENT BEING AN OFFICER OF SIENNA PARKS & LEVEE IMPROVEMENT DISTRICT OF FORT BEND COUNTY, TEXAS, OWNERS OF THE 26.279 ACRE TRACT DESCRIBED IN THE ABOVE AND FOREGOING PLAT OF SIENNA SECTION 46, DO HEREBY MAKE AND ESTABLISH SAID SUBDIVISION PLAT OF SAID PROPERTY ACCORDING TO ALL LINES, DEDICATIONS, RESTRICTIONS AND NOTATIONS ON SAID PLAT AND HEREBY DEDICATE TO THE USE OF THE PUBLIC FOR EVER, ALL STREETS, ALLEYS, PARKS, WATER COURSES, DRAINS, EASEMENTS AND PUBLIC PLACES SHOWN THEREON FOR THE PURPOSES AND CONSIDERATIONS THEREIN EXPRESSED; AND DO HEREBY BIND OURSELVES, OUR HEIRS AND ASSIGNS TO WARRANT AND FOREVER DEFEND THE TITLE TO THE LAND SO DEDICATED.

WE FURTHER ACKNOWLEDGE THAT THE DEDICATIONS AND/OR EXACTIONS MADE HEREIN ARE PROPORTIONAL TO THE IMPACT OF THE SUBDIVISION UPON THE PUBLIC SERVICES REQUIRED IN ORDER THAT THE DEVELOPMENT WILL COMPORT WITH THE PRESENT AND FUTURE GROWTH NEEDS OF THE CITY; WE, OUR SUCCESSORS AND ASSIGNEES HEREBY WAIVE ANY CLAIM, DAMAGE OR CAUSE OF ACTION THAT WE MAY HAVE AS A RESULT OF THE DEDICATION OR EXACTIONS MADE HEREIN.

FURTHER, OWNERS HAVE DEDICATED AND BY THESE PRESENTS DO DEDICATE TO THE USE OF THE PUBLIC FOR PUBLIC UTILITY PURPOSES FOREVER UNOBSTRUCTED AERIAL EASEMENTS, THE AERIAL EASEMENTS SHALL EXTEND HORIZONTALLY AN ADDITIONAL ELEVEN FEET, SIX INCHES (11'6") FOR TEN FEET (10'0") PERIMETER GROUND EASEMENTS OR SEVEN FEET, SIX INCHES (7'6") FOR FOURTEEN FEET (14'0") PERIMETER GROUND EASEMENTS OR FIVE FEET, SIX INCHES (5'6") FOR SIXTEEN FEET (16'0") PERIMETER GROUND EASEMENTS, FROM A PLANE SIXTEEN FEET (16'0") ABOVE GROUND LEVEL UPWARD, LOCATED ADJACENT TO AND ADJOINING SAID PUBLIC UTILITY EASEMENTS THAT ARE DESIGNATED WITH AERIAL EASEMENTS (U.E. AND A.E.) AS INDICATED AND DEPICTED, HEREON, WHEREBY THE AERIAL EASEMENT TOTALS TWENTY ONE FEET, SIX INCHES (21' 6") IN WIDTH.

FURTHER, OWNERS HAVE DEDICATED AND BY THESE PRESENTS DO DEDICATE TO THE USE OF THE PUBLIC FOR PUBLIC UTILITY PURPOSES FOREVER UNOBSTRUCTED AERIAL EASEMENTS, THE AERIAL EASEMENTS SHALL EXTEND HORIZONTALLY AN ADDITIONAL TEN FEET (10'0") FOR TEN FEET (10'0") BACK-TO-BACK GROUND EASEMENTS, OR EIGHT FEET (8'0") FOR FOURTEEN FEET (14'0") BACK-TO-BACK GROUND EASEMENTS OR SEVEN FEET (7'0") FOR SIXTEEN FEET (16'0") BACK-TO-BACK GROUND EASEMENTS, FROM A PLANE SIXTEEN FEET (16'0") ABOVE GROUND LEVEL UPWARD, LOCATED ADJACENT TO BOTH SIDES AND ADJOINING SAID PUBLIC UTILITY EASEMENTS THAT ARE DESIGNATED WITH AERIAL EASEMENTS (U.E. AND A.E.) AS INDICATED AND DEPICTED HEREON, WHEREBY THE AERIAL EASEMENT TOTALS THIRTY FEET (30'0") IN WIDTH.

FURTHER, WE DO HEREBY DECLARE THAT ALL PARCELS OF LAND DESIGNATED AS LOTS ON THIS PLAT ARE INTENDED FOR THE CONSTRUCTION OF SINGLE FAMILY RESIDENTIAL DWELLING UNITS THEREON AND SHALL BE RESTRICTED FOR SAME UNDER THE TERMS AND CONDITIONS OF SUCH RESTRICTIONS FILED SEPARATELY.

FURTHER, WE DO HEREBY COVENANT AND AGREE THAT ALL OF THE PROPERTY WITHIN THE BOUNDARIES OF THIS PLAT SHALL BE RESTRICTED TO PREVENT THE DRAINAGE OF ANY SEPTIC TANKS INTO ANY PUBLIC OR PRIVATE STREET, ROAD OR ALLEY OR ANY DRAINAGE DITCH, EITHER DIRECTLY OR INDIRECTLY.

FURTHER, WE DO HEREBY DEDICATE TO THE PUBLIC A STRIP OF LAND TWENTY (20) FEET WIDE ON EACH SIDE OF THE CENTER LINE OF ANY AND ALL BAYOUS, CREEKS, GULLIES, RAVINES, DRAWS AND DRAINAGE DITCHES LOCATED IN SAID SUBDIVISION, AS EASEMENTS FOR DRAINAGE PURPOSES. FORT BEND COUNTY OR ANY OTHER GOVERNMENTAL AGENCY SHALL HAVE THE RIGHT TO ENTER UPON SAID EASEMENT AT ANY AND ALL TIMES FOR THE PURPOSES OF CONSTRUCTION AND MAINTENANCE OF DRAINAGE FACILITIES AND STRUCTURES.

FURTHER, WE DO HEREBY COVENANT AND AGREE THAT ALL OF THE PROPERTY WITHIN THE BOUNDARIES OF THIS SUBDIVISION AND ADJACENT TO ANY DRAINAGE EASEMENT, DITCH, GULLY, CREEK OR NATURAL DRAINAGE WAY SHALL HEREBY BE RESTRICTED TO KEEP SUCH DRAINAGE WAYS AND EASEMENTS CLEAR OF FENCES, BUILDINGS, EXCESSIVE VEGETATION AND OTHER OBSTRUCTIONS TO THE OPERATIONS AND MAINTENANCE OF THE DRAINAGE FACILITY AND THAT SUCH ABUTTING PROPERTY SHALL NOT BE PERMITTED TO DRAIN DIRECTLY INTO THIS EASEMENT EXCEPT BY MEANS OF AN APPROVED DRAINAGE STRUCTURE.

FURTHER, WE DO HEREBY CERTIFY THAT WE ARE THE OWNERS OF ALL PROPERTY IMMEDIATELY ADJACENT TO AND ADJOINING THE BOUNDARIES OF THE ABOVE AND FOREGOING SUBDIVISION OF SIENNA SECTION 46 WHERE PUBLIC UTILITY EASEMENTS ARE TO BE ESTABLISHED OUTSIDE THE BOUNDARIES OF THE ABOVE AND FOREGOING SUBDIVISION AND DO HEREBY MAKE AND ESTABLISH AND DEDICATE TO THE USE OF THE PUBLIC UTILITIES FOREVER ALL PUBLIC UTILITY EASEMENTS SHOWN IN SAID ADJACENT ACREAGE.

FURTHER, WE DO HEREBY ACKNOWLEDGE THE RECEIPT OF THE "ORDERS FOR REGULATION OF OUTDOOR LIGHTING IN THE UNINCORPORATED AREAS OF FORT BEND COUNTY, TEXAS", AND DO HEREBY COVENANT AND AGREE AND SHALL COMPLY WITH THIS ORDER AS ADOPTED BY FORT BEND COUNTY COMMISSIONERS' COURT ON MARCH 23, 2004 AND ANY SUBSEQUENT AMENDMENT.

IN TESTIMONY WHEREOF, TOLL-GTIS PROPERTY OWNER, LLC, A TEXAS LIMITED LIABILITY COMPANY, HAS CAUSED, THESE PRESENTS TO BE SIGNED BY JIMMIE F. JENKINS, ITS AUTHORIZED REPRESENTATIVE, THEREUNTO AUTHORIZED,
THIS 23rd DAY OF May, 2022.

TOLL-GTIS PROPERTY OWNER, LLC
A TEXAS LIMITED LIABILITY COMPANY

By: Jimmie F. Jenkins
JIMMIE F. JENKINS, AUTHORIZED REPRESENTATIVE

STATE OF TEXAS
COUNTY OF HARRIS

BEFORE ME, THE UNDERSIGNED AUTHORITY, ON THIS DAY PERSONALLY APPEARED JIMMIE F. JENKINS, AUTHORIZED REPRESENTATIVE OF TOLL-GTIS PROPERTY OWNER, LLC, A TEXAS LIMITED LIABILITY COMPANY, KNOWN TO ME TO BE THE PERSON WHOSE NAME IS SUBSCRIBED TO THE FOREGOING INSTRUMENT AND ACKNOWLEDGED TO ME THAT HE EXECUTED THE SAME FOR THE PURPOSES AND CONSIDERATIONS THEREIN EXPRESSED AND IN THE CAPACITY THEREIN AND HEREIN SET OUT.

GIVEN UNDER MY HAND AND SEAL OF OFFICE,
THIS 23rd DAY OF May, 2022.

Rachel Mayberry
NOTARY PUBLIC, STATE OF TEXAS
COM. EXPIRES 8/19/2023
NOTARY ID: 1303356-6
NOTARY PUBLIC IN AND FOR THE STATE OF TEXAS

IN TESTIMONY WHEREOF, SIENNA PARKS & LEVEE IMPROVEMENT DISTRICT OF FORT BEND COUNTY, TEXAS, HAS CAUSED THESE PRESENTS TO BE SIGNED BY KEN BECKMAN, ITS PRESIDENT, THEREUNTO AUTHORIZED,
THIS 24th DAY OF May, 2022.

SIENNA PARKS & LEVEE IMPROVEMENT DISTRICT
OF FORT BEND COUNTY, TEXAS
By: Ken Beckman
KEN BECKMAN, PRESIDENT

STATE OF TEXAS
COUNTY OF HARRIS

BEFORE ME, THE UNDERSIGNED AUTHORITY, ON THIS DAY PERSONALLY APPEARED KEN BECKMAN, PRESIDENT OF SIENNA PARKS & LEVEE IMPROVEMENT DISTRICT OF FORT BEND COUNTY, TEXAS, KNOWN TO ME TO BE THE PERSON WHOSE NAME IS SUBSCRIBED TO THE FOREGOING INSTRUMENT AND ACKNOWLEDGED TO ME THAT HE EXECUTED THE SAME FOR THE PURPOSES AND CONSIDERATIONS THEREIN EXPRESSED AND IN THE CAPACITY THEREIN AND HEREIN SET OUT.

GIVEN UNDER MY HAND AND SEAL OF OFFICE,
THIS 24th DAY OF May, 2022.

Laurie Ann Chapp
NOTARY PUBLIC IN AND FOR THE STATE OF TEXAS



I, JON P. BORDOVSKY, A REGISTERED PROFESSIONAL LAND SURVEYOR, AM AUTHORIZED UNDER THE LAWS OF THE STATE OF TEXAS TO PRACTICE THE PROFESSION OF LAND SURVEYING AND HEREBY CERTIFY THAT THE ABOVE SUBDIVISION IS TRUE AND CORRECT, WAS PREPARED FROM AN ACTUAL SURVEY OF THE PROPERTY MADE UNDER MY SUPERVISION ON THE GROUND AND THAT ALL BOUNDARY CORNERS, ANGLES, POINTS OF CURVATURE AND OTHER POINTS OF REFERENCE HAVE BEEN MARKED WITH IRON (OR OTHER SUITABLE PERMANENT METAL) PIPES OR RODS HAVING AN OUTSIDE DIAMETER OF NOT LESS THAN FIVE-EIGHTHS (5/8) INCH WITH PLASTIC CAP MARKED "GBI PARTNERS" AND A LENGTH OF NOT LESS THAN THREE (3) FEET. (SEE NOTE #10)

Jon P. Bordovsky
JON P. BORDOVSKY, R.P.L.S.
REGISTERED PROFESSIONAL LAND SURVEYOR
TEXAS REGISTRATION NO. 6405



I, SCOTT FRANKOVICH, A PROFESSIONAL ENGINEER REGISTERED IN THE STATE OF TEXAS DO HEREBY CERTIFY THAT THIS PLAT MEETS ALL REQUIREMENTS OF FORT BEND COUNTY TO THE BEST OF MY KNOWLEDGE.

Scott Frankovich
SCOTT FRANKOVICH, P.E.
LICENSED PROFESSIONAL ENGINEER
TEXAS LICENSE NO. 130312



STATE OF TEXAS
COUNTY OF FORT BEND

THIS IS TO CERTIFY THAT THE PLANNING AND ZONING COMMISSION OF THE CITY OF MISSOURI CITY, TEXAS, HAS APPROVED THIS PLAT AND SUBDIVISION OF SIENNA SECTION 46 IN CONFORMANCE WITH THE LAWS OF THE STATE OF TEXAS AND THE ORDINANCES OF THE CITY OF MISSOURI CITY AS SHOWN HEREON AND AUTHORIZED THE RECORDING OF THIS PLAT.

THIS _____ DAY OF _____, 2022.

SONYA BROWN-MARSHALL, CHAIRMAN

TIMOTHY R. HANEY, VICE CHAIRMAN

NOTES:

- 1. BENCHMARK: FOUND 4 INCH BRASS DISC LOCATED IN A POURED CONCRETE POST IN THE GRASSY AREA IN FRONT OF MISSOURI CITY FIRE STATION NUMBER 5 16.5 FEET FROM THE SIDE WALK.
SURVEY MARKER NO. PCM-011
ELEV. = 59.97 (NAVD88 2001 ADJUSTMENT)
- 2. T.B.M. INDICATES TEMPORARY BENCHMARK SET "X" CUT IN CONCRETE.
ELEV. = 57.47 (NAVD88, 2001 ADJUSTMENT)
- 3. ALL BEARINGS REFERENCED TO THE TEXAS COORDINATE SYSTEM, SOUTH CENTRAL ZONE (NAD83), COORDINATES SHOWN ARE GRID AND MAY BE CONVERTED TO SURFACE BY DIVIDING BY A FACTOR OF 0.999867651.
- 4. THIS PLAT WAS PREPARED TO MEET CITY OF MISSOURI CITY AND FORT BEND COUNTY REQUIREMENTS.
- 5. THIS PLAT WAS PREPARED FROM INFORMATION FURNISHED BY CHARTER TITLE COMPANY, FILE NO. 2021-0345 DATED APRIL 6, 2022. THE SURVEYOR HAS NOT ABSTRACTED THE ABOVE PROPERTY.
- 6. THIS PLAT LIES WHOLLY WITHIN SIENNA PARKS & LEVEE IMPROVEMENT DISTRICT, FORT BEND SUBDISTRICT, FORT BEND COUNTY DRAINAGE DISTRICT, FORT BEND ISD, THE ETJ OF THE CITY OF MISSOURI CITY, FORT BEND COUNTY, SIENNA MUNICIPAL UTILITY DISTRICT NO. 6 AND SIENNA MUNICIPAL UTILITY DISTRICT NO. 7.
- 7. IN ACCORDANCE WITH FEDERAL EMERGENCY MANAGEMENT AGENCY FLOOD INSURANCE RATE MAP NO. 48157C 0435L, REVISED DATE APRIL 2, 2014, PROPERTY LIES WITHIN SHADEN ZONE "X" DEFINED AS AREAS OF 0.2% ANNUAL CHANCE FLOOD. THIS AREA IS SHOWN AS BEING PROTECTED FROM THE 1% ANNUAL CHANCE OR GREATER FLOOD HAZARD BY A LEVEE SYSTEM, OVERTOPPING OR FAILURE OF ANY LEVEE SYSTEM IS POSSIBLE. THIS DOES NOT WARRANT OR SUBSCRIBE TO THE ACCURACY OR SCALE OF SAID MAPS.
- 8. ALL EXISTING AND PROPOSED PIPELINE EASEMENTS THROUGH THE SUBDIVISION HAVE BEEN SHOWN.
- 9. BUILDINGS SHALL BE SET BACK A MINIMUM DISTANCE OF 30 FEET FROM ANY PIPELINE OR 15 FEET FROM ANY PIPELINE EASEMENT, WHICHEVER DISTANCE IS GREATER.
- 10. FIVE EIGHTHS (5/8") IRON RODS THREE FEET (3') IN LENGTH WITH A PLASTIC CAP MARKED "GBI PARTNERS" WILL BE SET ON ALL PERIMETER BOUNDARY CORNERS, LOT, BLOCK, AND RESERVE CORNERS WILL BE SET UPON COMPLETION OF ROAD CONSTRUCTION AND PRIOR TO LOT CONSTRUCTION.
- 11. THE TOP OF ALL FLOOR SLABS FOR BLOCK 1, LOTS 1-3, BLOCK 2, LOTS 36-47 SHALL BE A MINIMUM OF 59.00 FEET (2001 ADJ.) ABOVE MEAN SEA LEVEL AND BLOCK 1, LOTS 4-15, BLOCK 2, LOTS 1-35 SHALL BE A MINIMUM OF 58.57 FEET (2001 ADJ.) ABOVE MEAN SEA LEVEL. IN ADDITION, NO TOP OF SLAB ELEVATION SHALL BE LESS THAN 24 INCHES ABOVE THE LOWEST TOP OF CURB ADJACENT TO THE LOT IN WHICH IT LIES. IN THE ABSENCE OF A CURB, THE TOP OF SLAB ELEVATION SHALL BE NO LESS THAN 24 INCHES ABOVE HIGHEST NATURAL GROUND PERIMETER OF THE BUILDING FOUNDATION AND 12" ABOVE ANY DOWN GRADIENT ROADWAY OR DRAINAGE RESTRAINT, WHICHEVER IS HIGHER.
- 12. ALL DRAINAGE AND FLOODWAY EASEMENTS SHALL BE KEPT CLEAR OF FENCES, BUILDINGS, PLANTINGS AND OTHER OBSTRUCTIONS TO THE OPERATIONS AND MAINTENANCE OF THE DRAINAGE FACILITY AS REQUIRED BY SUBSECTION 82-168(D) OF THE CODE OF ORDINANCES OF THE CITY OF MISSOURI CITY, TEXAS.
- 13. THE DRAINAGE SYSTEM FOR THIS SUBDIVISION SHALL BE DESIGNED TO MEET THE REQUIREMENTS OF THE FORT BEND COUNTY DRAINAGE CRITERIA MANUAL WHICH ALLOWS STREET PONDING DURING INTENSE RAINFALL EVENTS.
- 14. ALL PROPERTY TO DRAIN INTO THE DRAINAGE EASEMENT ONLY THROUGH AN APPROVED DRAINAGE STRUCTURE.
- 15. ALL LOT LINES SHALL HAVE A MINIMUM FIVE (5) FOOT SIDE YARD SETBACK.
- 16. A MINIMUM DISTANCE OF 10' SHALL BE MAINTAINED BETWEEN RESIDENTIAL DWELLINGS.
- 17. THE CITY OF MISSOURI CITY SHALL NOT BE RESPONSIBLE FOR MAINTENANCE OF DRIVEWAYS, SIDEWALKS, EMERGENCY ACCESS EASEMENTS, RECREATIONAL AREAS, AND OPEN SPACES AND THE SIENNA COMMUNITY ASSOCIATION SHALL BE RESPONSIBLE FOR SUCH MAINTENANCE OF DRIVEWAYS, SIDEWALKS, EMERGENCY ACCESS EASEMENTS, RECREATIONAL AREAS, AND OPEN SPACES AS REQUIRED BY SECTION 3.0(14) OF THE PLATTING MANUAL OF THE CITY OF MISSOURI CITY (SEPTEMBER 2019).
- 18. SIDEWALKS SHALL BE BUILT OR CAUSED TO BE BUILT NOT LESS THAN 5- FEET IN WIDTH ON BOTH SIDES OF ALL DEDICATED RIGHTS-OF-WAY WITH SAID PLAT AND ON CONTIGUOUS RIGHTS-OF-WAY OF ALL PERIMETER ROADS SURROUNDING SAID PLAT, IN ACCORDANCE WITH ADA REQUIREMENTS.
- 19. SIDEWALKS SHALL BE CONSTRUCTED AS REQUIRED BY SECTION 82-164 OF THE CODE OF ORDINANCES OF THE CITY OF MISSOURI CITY, TEXAS.
- 20. DRIVEWAY APPROACHES SHALL BE PROVIDED IN ACCORDANCE WITH THE MISSOURI CITY DRIVEWAY APPROACH POLICY AS REQUIRED UNDER THE PROVISIONS OF SUBSECTION 82-160 OF THE CODE OF ORDINANCES OF THE CITY OF MISSOURI CITY, TEXAS.
- 21. IN ACCORDANCE WITH CENTERPOINT ENERGY ELECTRICAL SERVICE MANUAL, ARTICLE 421.2, ELECTRIC METERS SHALL BE LOCATED IN A POSITION THAT IS ACCESSIBLE AT ALL TIMES WITHOUT CUSTOMER ASSISTANCE. ACCESS TO THE METER SHALL NOT BE BLOCKED BY GATES, WALLS OR FENCES.
- 22. ALL REQUIRED UTILITY COMPANIES HAVE BEEN CONTACTED AND ALL PUBLIC UTILITY EASEMENTS AS SHOWN BY THE ABOVE AND FOREGOING PLAT CONSTITUTE ALL OF THE EASEMENTS REQUIRED BY THE UTILITY COMPANIES CONTACTED AT THE TIME OF PLATTING.
- 23. ALL OF THE PROPERTY SUBDIVIDED IN THE ABOVE AND FOREGOING PLAT IS WITHIN THE ETJ BOUNDARIES OF THE CITY OF MISSOURI CITY, TEXAS.
- 24. NO BUILDING OR OTHER PERMIT, EXCEPT PERMITS FOR CONSTRUCTION OF PUBLIC IMPROVEMENTS WILL BE ISSUED BY THE CITY OF MISSOURI CITY, TEXAS, FOR CONSTRUCTION WITHIN THIS SUBDIVISION UNTIL SUCH TIME AS ALL PUBLIC IMPROVEMENTS OF THE SUBDIVISION HAVE BEEN CONSTRUCTED BY THE DEVELOPER AND ACCEPTED BY THE CITY OR THE GUARANTEE OF CONSTRUCTION OF PUBLIC IMPROVEMENTS REQUIRED BY SECTION 82-206 OF THE CODE OF ORDINANCES OF THE CITY OF MISSOURI CITY, TEXAS, IS SUBMITTED TO AND APPROVED BY THE CITY.
- 25. PRIOR TO THE BEGINNING OF THE ONE-YEAR MAINTENANCE PERIOD FOR UTILITIES AND PAVING BY FORT BEND COUNTY, ALL BLOCK CORNERS AND STREET RIGHT-OF-WAY WILL BE MONUMENTED.
- 26. ADEQUATE FIRE FLOWS SHALL BE PROVIDED ALONG THE ENTIRE LENGTH OF THE PROPOSED WATER LINE.
- 27. REQUIRED FIRE FLOWS SHALL BE PROVIDED BASED ON THE SIZE AND CONSTRUCTION OF ALL BUILDINGS AS REQUIRED BY THE INTERNATIONAL FIRE CODE AS ADOPTED BY THE CITY.
- 28. THE PLACEMENT OF FIRE HYDRANTS SHALL BE PROVIDED BASED ON THE MINIMUM DISTANCE REQUIREMENTS AS ESTABLISHED IN THE INTERNATIONAL FIRE CODE AS ADOPTED BY THE CITY (500FT. FOR RESIDENTIAL DEVELOPMENT AND 300FT. FOR COMMERCIAL DEVELOPMENT). ALL FIRE HYDRANTS SHALL BE INSTALLED ACCORDING TO THE INTERNATIONAL FIRE CODE AS ADOPTED BY THE CITY.
- 29. THE DRIVEWAY FOR ANY LOT ON THE INSIDE OF A KNUCKLE MUST BE PLACED ALONG THE FRONTAGE PRIOR TO THE RIGHT TURN ON THE INSIDE APPROACH LANE TO AVOID SIGHT OBSTRUCTION SAFETY HAZARDS.
- 30. STREET LIGHTING SHALL BE DESIGNED AND INSTALLED IN ACCORDANCE WITH THE CITY OF MISSOURI CITY INFRASTRUCTURE DESIGN MANUAL, CHAPTER 4 STREET LIGHTING AND OVERHEAD UTILITIES. THE INSTALLATION, OPERATION, AND MAINTENANCE OF ORNAMENTAL STREET LIGHTS SHALL NOT BE THE RESPONSIBILITY OF THE CITY OF MISSOURI CITY, EXCEPT AS PROVIDED THEREIN.
- 31. OWNERSHIP AND MAINTENANCE RESPONSIBILITY OF THE DRAINAGE RESERVES AND CHANNELS IS VESTED IN THE SIENNA PARKS & LEVEE IMPROVEMENT DISTRICT. THE OWNERSHIP AND MAINTENANCE RESPONSIBILITY OF LANDSCAPE RESERVES IS VESTED IN SIENNA MUNICIPAL UTILITY DISTRICT NO. 6 AND THE HOME OWNERS ASSOCIATION (HOA), RESPECTIVELY.
- 32. OWNERSHIP AND MAINTENANCE RESPONSIBILITY OF THE UTILITIES WITHIN THE SECTIONS IS VESTED IN SIENNA MUNICIPAL UTILITY DISTRICT NO. 6. THE OWNERSHIP AND MAINTENANCE RESPONSIBILITY OF THE UTILITIES ALONG BOULEVARDS AND MAJOR THOROUGHFARES IS VESTED IN THE SIENNA MUNICIPAL UTILITY DISTRICT NO. 5.

- 33. THIS PLAT IS SUBORDINATED BY: U.S. BANK NATIONAL ASSOCIATION D/B/A HOUSING CAPITAL COMPANY, AS RECORDED IN FILE NO. _____ OF THE OFFICIAL RECORDS OF FORT BEND COUNTY, TEXAS.
- 34. THIS PLAT LIES WITHIN LIGHTING ZONE 2.
- 35. ONE-FOOT RESERVE DEDICATED TO THE CITY IN FEE AS A BUFFER SEPARATION BETWEEN THE SIDE OR END OF STREETS WHERE SUCH STREETS ABUT ADJACENT ACREAGE TRACTS. THE CONDITION OF SUCH DEDICATION BEING THAT WHEN THE ADJACENT PROPERTY IS SUBDIVIDED PURSUANT TO A RECORDED PLAT, THE ONE-FOOT RESERVE SHALL THEREUPON BECOME VESTED IN THE PUBLIC FOR STREET RIGHT-OF-WAY PURPOSES AND THE FEE TITLE THERETO SHALL REVERT TO AND REVEST IN THE DEDICATOR, HIS HEIRS, ASSIGNS OR SUCCESSORS.
- 36. THIS PLAT IS SUBJECT TO OVER AND ACROSS EASEMENTS AS SET FORTH BY THE RESTRICTED COVENANTS RECORDED UNDER FILE NO. 2015009259 AND 2019035843, F.B.C.O.R.
- 37. SITE PLANS SHALL BE SUBMITTED TO FORT BEND COUNTY AND ANY OTHER APPLICABLE JURISDICTION FOR REVIEW AND APPROVAL. DEVELOPMENT PERMITS AND ALL OTHER APPLICABLE PERMITS SHALL BE OBTAINED FROM FORT BEND COUNTY PRIOR TO BEGINNING CONSTRUCTION.
- 38. ALL SLAB ELEVATIONS SHALL BE AT LEAST ONE FOOT ABOVE THE 100 YEAR FLOOD ELEVATION ESTABLISHED BY FEMA AS PER SECTION 3.C(13) OF THE PLATTING MANUAL CITY OF MISSOURI CITY (SEPTEMBER 2019).
- 39. THE TURNAROUND EASEMENT IS TEMPORARY AND SHALL AUTOMATICALLY TERMINATE AND BE OF NO FURTHER FORCE AND EFFECT ON THE DATE ON WHICH A PLAT IS RECORDED THAT ENCOMPASSES THE EASEMENT TRACT AND DEDICATES THE SAME FOR USE AS PUBLIC RIGHT-OF-WAY. IN SUCH EVENT, THE EASEMENT TRACT SHALL IMMEDIATELY BECOME PART OF THE PUBLIC RIGHT-OF-WAY DEDICATED BY SUCH PLAT.

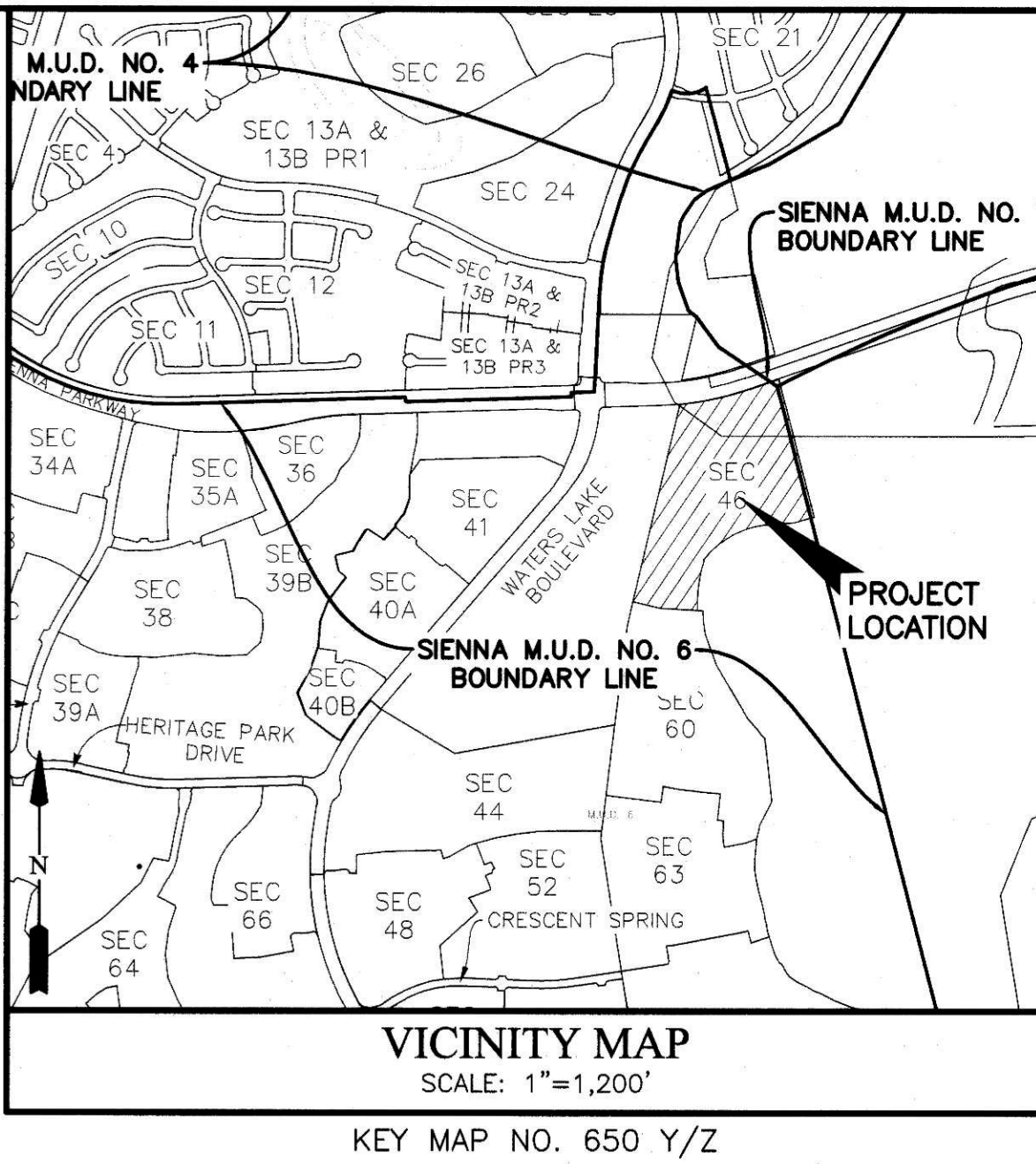

I, J. STACY SLAWINSKI, FORT BEND COUNTY ENGINEER, DO HEREBY CERTIFY THAT THE PLAT OF THIS SUBDIVISION COMPLIES WITH ALL OF THE EXISTING RULES AND REGULATIONS OF THIS OFFICE AS ADOPTED BY THE FORT BEND COUNTY COMMISSIONERS' COURT. HOWEVER, NO CERTIFICATION IS HEREBY GIVEN AS TO THE EFFECT OF DRAINAGE FROM THIS SUBDIVISION ON THE INTERCEPTING DRAINAGE ARTERY OR PARENT STREAM OR ON ANY OTHER AREA OR SUBDIVISION WITHIN THE WATERSHED.

J. STACY SLAWINSKI, P.E.
FORT BEND COUNTY ENGINEER

APPROVED BY THE COMMISSIONERS' COURT OF FORT BEND COUNTY, TEXAS,
THIS _____ DAY OF _____, 2022.

VINCENT M. MORALES, JR. COUNTY COMMISSIONER
GRADY PRESTAGE COUNTY COMMISSIONER

KP GEORGE COUNTY JUDGE

W.A. (ANDY) MEYERS COUNTY COMMISSIONER
KEN R. DEMERCHANT COUNTY COMMISSIONER

I, LAURA RICHARD, COUNTY CLERK IN AND FOR FORT BEND COUNTY, HEREBY CERTIFY THAT THE FOREGOING INSTRUMENT WITH ITS CERTIFICATE OF AUTHENTICATION WAS FILED FOR RECORDATION IN MY OFFICE ON _____, 2022 AT _____ O'CLOCK _____ M. IN PLAT NUMBER _____ OF THE PLAT RECORDS OF FORT BEND COUNTY, TEXAS.

WITNESS MY HAND AND SEAL OF OFFICE, AT RICHMOND, TEXAS, THE DAY AND DATE LAST ABOVE WRITTEN.

LAURA RICHARD, COUNTY CLERK
FORT BEND COUNTY, TEXAS

By: _____
DEPUTY

SIENNA SECTION 46

A SUBDIVISION OF 26.279 ACRES OF LAND SITUATED IN THE WILLIAM HALL SURVEY, ABSTRACT 31, FORT BEND COUNTY, TEXAS.

62 LOTS 8 RESERVES (9.360 ACRES) 2 BLOCKS
SEPTEMBER 8, 2021 JOB NO. 1416-1546P

OWNERS:
TOLL-GTIS PROPERTY OWNER, LLC
JIMMIE F. JENKINS, AUTHORIZED REPRESENTATIVE
10110 WEST SAM HOUSTON PARKWAY NORTH, SUITE 210, HOUSTON, TEXAS 77064
PH. (281) 894-8655

SIENNA PARKS & LEVEE IMPROVEMENT DISTRICT
OF FORT BEND COUNTY, TEXAS
KEN BECKMAN, PRESIDENT
202 CENTURY SQUARE BLVD., SUGAR LAND, TEXAS 77478-3796
PH. (281) 500-6050

SURVEYOR:
GBI PARTNERS
LAND SURVEYING CONSULTANTS
4784 VISTA ROAD • PASADENA, TX 77065
PHONE: 281-499-4539 • GBSurvey@GBISurvey.com
TBPELS FROM # 10190300 • www.GBISurvey.com

ENGINEER:
LJA Engineering, Inc.
1904 W. Grand Parkway North
Suite 100
Katy, Texas 77449
FRN-F-1386

JON BORDOVSKY, R.P.L.S.
REGISTERED PROFESSIONAL LAND SURVEYOR
TEXAS REGISTRATION NO. 6405

SCOTT FRANKOVICH, P.E.
LICENSED PROFESSIONAL ENGINEER
TEXAS REGISTRATION NO. 130312



LINE TABLE			LINE TABLE			CURVE TABLE					
LINE	BEARING	DISTANCE	LINE	BEARING	DISTANCE	CURVE	RADIUS	DELTA	ARC	CHORD BEARING	CHORD
L1	S 75°31'23" W	145.00'	L42	N 59°22'58" E	62.46'	C1	2110.00'	13°47'58"	508.18'	N 77°32'37" E	506.96'
L2	S 84°10'27" W	140.65'	L43	N 88°19'51" E	82.20'	C2	618.75'	53°55'35"	582.36'	S 63°14'51" W	561.10'
L3	S 19°19'22" E	52.14'	L44	N 01°40'09" W	20.00'	C3	1073.32'	19°17'38"	361.43'	S 07°41'08" W	359.73'
L4	S 04°22'33" E	83.34'	L45	S 86°30'25" W	96.09'	C4	1000.00'	4°50'46"	84.58'	S 16°53'59" E	84.55'
L5	S 12°37'39" E	69.81'	L46	N 01°54'32" W	20.00'	C5	750.00'	10°06'04"	132.22'	S 09°25'35" E	132.05'
L6	S 89°33'27" E	44.99'	L47	S 80°40'07" E	74.42'	C6	500.00'	8°15'06"	72.01'	S 08°30'06" E	71.95'
L7	N 45°17'47" W	51.37'	L48	S 14°19'53" W	25.88'	C7	50.00'	90°00'46"	78.55'	S 32°22'44" W	70.72'
L8	S 14°28'36" E	9.35'	L49	S 61°48'42" E	75.14'	C8	1000.00'	7°32'56"	131.75'	S 73°36'39" W	131.66'
L9	S 76°45'33" W	108.56'	L50	S 13°11'18" W	25.88'	C9	450.00'	66°17'18"	520.63'	S 36°41'32" W	492.07'
L10	S 19°19'22" E	25.10'	L51	S 81°48'42" E	75.09'	C10	750.00'	5°23'40"	70.61'	S 74°03'44" W	70.59'
L11	S 04°22'33" E	83.34'	L52	S 88°19'51" W	76.36'	C11	450.00'	17°44'06"	139.29'	S 80°13'57" W	138.74'
L12	S 12°37'39" E	62.23'	L53	S 86°30'25" W	89.46'	C12	30.00'	89°58'01"	47.11'	S 25°39'38" W	42.41'
L13	S 58°33'27" E	28.41'	L54	S 60°40'07" E	74.92'	C13	500.00'	15°18'53"	133.65'	S 11°39'58" W	133.25'
L14	N 58°33'27" W	28.88'	L55	S 02°11'45" E	108.12'	C14	300.00'	10°28'07"	54.81'	S 09°14'33" E	54.74'
L15	N 45°17'47" W	7.03'	L56	N 87°48'15" E	15.00'	C15	775.00'	10°06'04"	136.63'	S 09°25'35" E	136.45'
L16	S 45°17'47" W	7.03'	L57	N 02°11'45" W	106.61'	C16	475.00'	8°15'06"	68.41'	S 08°30'06" E	68.35'
L17	N 12°37'39" E	69.81'	L58	S 04°01'51" W	35.20'	C17	25.00'	45°55'48"	20.04'	S 35°35'33" E	19.51'
L18	N 04°22'33" W	83.34'	L59	S 07°10'26" E	60.72'	C18	50.00'	180°00'00"	157.08'	S 31°26'33" W	100.00'
L19	S 76°45'33" W	51.05'	L60	S 83°01'13" W	5.00'	C19	25.00'	44°19'43"	19.34'	N 80°43'18" W	18.86'
L20	N 76°45'33" E	58.23'	L61	S 07°10'26" W	23.06'	C20	975.00'	7°16'39"	123.84'	S 73°28'31" W	123.76'
L21	N 19°19'22" W	35.11'	L62	S 15°03'49" E	88.46'	C21	425.00'	66°17'18"	491.70'	S 36°41'32" W	464.74'
L22	N 41°53'03" E	67.59'	L63	S 01°24'15" E	15.34'	C22	475.00'	32°31'43"	269.67'	N 19°48'45" E	266.07'
L23	N 12°55'49" E	67.59'	L64	S 88°35'45" W	20.00'	C23	25.00'	81°22'23"	35.51'	N 04°36'35" W	32.60'
L24	S 59°28'37" E	14.14'	L65	N 01°24'15" W	3.46'	C24	50.00'	180°00'00"	157.08'	N 44°42'13" E	100.00'
L25	N 10°16'54" W	139.92'	L66	N 82°49'28" W	50.76'	C25	25.00'	81°22'23"	35.51'	S 85°58'58" E	32.60'
L26	S 08°34'19" E	142.59'	L67	S 82°49'28" E	52.05'	C26	475.00'	16°30'21"	136.84'	N 61°35'01" E	136.37'
L27	S 30°43'57" E	14.39'	L68	N 05°17'58" W	81.92'	C27	1025.00'	7°32'56"	135.05'	N 73°36'39" E	134.95'
L28	S 13°16'29" W	132.29'	L69	N 15°03'49" W	75.14'	C28	25.00'	90°00'46"	59.28'	S 32°22'44" E	35.36'
L29	N 38°30'43" W	20.00'	L70	S 69°20'17" W	1.97'	C29	525.00'	8°15'06"	75.61'	N 08°30'06" W	75.54'
L30	S 65°03'42" W	20.00'	L71	N 20°39'43" W	20.00'	C30	725.00'	0°39'06"	8.25'	N 04°42'06" W	8.25'
L31	N 14°30'08" W	134.47'	L72	N 69°20'17" E	2.82'	C31	25.00'	98°12'48"	42.85'	N 54°08'03" W	37.80'
L32	S 15°19'48" E	134.24'	L73	N 21°42'43" W	89.84'	C32	725.00'	5°23'40"	68.26'	S 74°03'44" W	68.23'
L33	S 59°25'57" W	20.00'	L74	N 16°35'55" W	95.58'	C33	475.00'	10°58'43"	91.02'	S 76°51'15" W	90.88'
L34	N 32°52'58" W	20.00'	L75	S 78°27'31" W	3.85'	C34	25.00'	44°54'02"	19.59'	S 59°53'36" W	19.09'
L35	N 14°28'37" W	120.14'	L76	N 11°32'29" W	20.00'	C35	500.00'	27°10'49"	241.01'	N 04°28'00" W	66.80'
L36	N 88°55'21" W	14.28'	L77	N 78°27'31" E	3.73'	C36	25.00'	52°04'42"	22.72'	S 72°24'57" E	21.95'
L37	N 81°25'33" E	80.76'	L78	N 07°10'26" W	14.69'	C37	425.00'	10°10'49"	75.51'	N 76°27'18" E	75.41'
L38	N 80°44'06" E	56.36'	L79	N 07°10'26" W	63.08'	C38	775.00'	5°23'40"	72.97'	N 74°03'44" E	72.94'
L39	S 79°23'45" E	58.96'	L80	N 04°01'51" E	37.44'	C39	25.00'	90°00'00"	39.27'	N 31°45'33" E	35.36'
L40	N 88°09'07" E	50.88'	L81	N 68°55'01" E	10.68'	C40	725.00'	1°14'10"	15.64'	N 13°51'32" W	15.84'
L41	N 72°16'47" E	58.58'	L82	S 66°55'01" W	20.38'	C41	25.00'	89°59'59"	39.27'	N 59°28'36" W	35.36'
						C42	25.00'	57°10'52"	24.95'	S 46°55'58" W	23.93'
						C43	50.00'	27°45'21'0"	239.87'	N 24°13'23" W	67.64'
						C44	25.00'	37°41'18"	16.44'	S 85°37'57" E	16.15'
						C45	25.00'	92°41'51"	40.45'	N 29°10'29" E	36.18'
						C46	300.00'	9°53'15"	51.77'	N 22°07'04" W	51.71'
						C47	500.00'	7°44'19"	67.53'	N 23°11'32" W	67.48'
						C48	30.00'	88°07'32"	46.14'	N 63°23'08" W	41.73'

1 CALLED 0.1148 ACRES CARL BOWLES F.N. 9843357, F.B.C.O.P.R.

2 CALLED 0.1148 ACRES KELLY D. SHIPLEY F.N. 2018043730, F.B.C.O.P.R.

3 CALLED 0.1148 ACRES JAMES CONDREY F.N. 90707634, F.B.C.O.P.R.

4 CALLED 0.1148 ACRES JAMES W. FEUERBACH F.N. 2005029934, F.B.C.O.P.R.

5 CALLED 0.1148 ACRES ROBBIE L. BATES F.N. 9667404, F.B.C.O.P.R.

RESERVE	ACREAGE	SQ.FT.	TYPE	MAINTENANCE/OWNERSHIP
A	1.461	63,627	RESTRICTED TO LANDSCAPE	SIENNA COMMUNITY ASSOCIATION INC. (S.C.A.I.)/SIENNA MUNICIPAL UTILITY DISTRICT NO. 5
B	0.282	12,266	RESTRICTED TO LANDSCAPE	SIENNA COMMUNITY ASSOCIATION INC. (S.C.A.I.)/SIENNA MUNICIPAL UTILITY DISTRICT NO. 5
C	0.061	2,674	RESTRICTED TO LANDSCAPE	SIENNA COMMUNITY ASSOCIATION INC. (S.C.A.I.)/SIENNA MUNICIPAL UTILITY DISTRICT NO. 5
D	0.265	11,525	RESTRICTED TO DRAINAGE	SIENNA PARKS & LEVEE IMPROVEMENT DISTRICT
E	0.038	1,637	RESTRICTED TO LANDSCAPE	SIENNA COMMUNITY ASSOCIATION INC. (S.C.A.I.)/SIENNA MUNICIPAL UTILITY DISTRICT NO. 5
F	0.012	535	RESTRICTED TO DRAINAGE	SIENNA MUNICIPAL UTILITY DISTRICT NO. 6
G	0.493	21,493	RESTRICTED TO LANDSCAPE	SIENNA COMMUNITY ASSOCIATION INC. (S.C.A.I.)/SIENNA MUNICIPAL UTILITY DISTRICT NO. 5
H	6.748	293,959	RESTRICTED TO DRAINAGE/LANDSCAPE	SIENNA PARKS & LEVEE IMPROVEMENT DISTRICT
TOTAL	9.360	407,716		

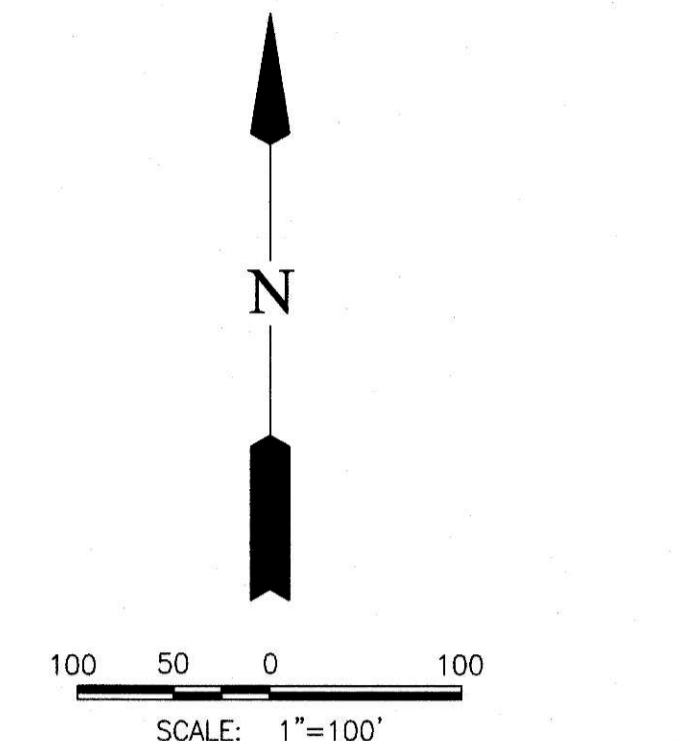
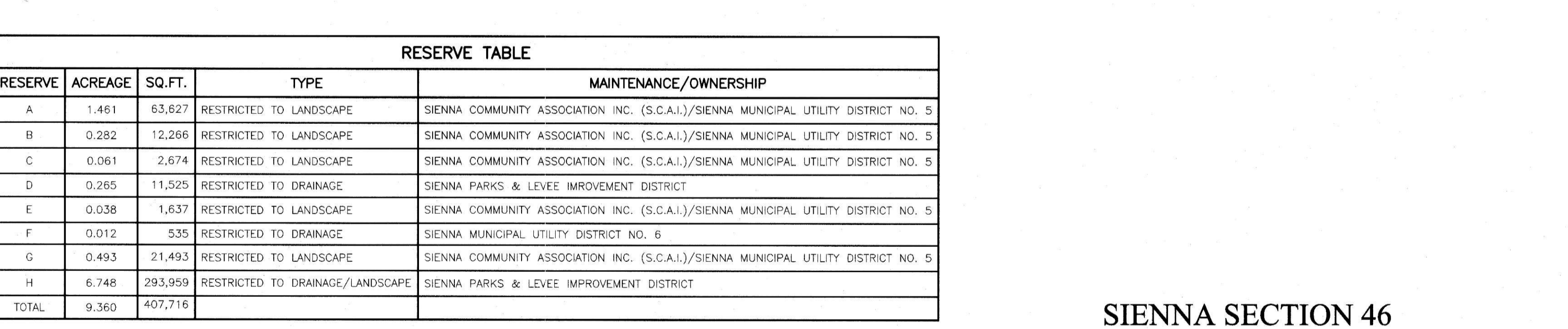

- LEGEND**
- B.L. INDICATES BUILDING LINE
 - U.E. INDICATES UTILITY EASEMENT
 - D.E. INDICATES DRAINAGE EASEMENT
 - W.L.E. INDICATES WATER LINE EASEMENT
 - P.O.B. INDICATES POINT OF BEGINNING
 - S.S.E. INDICATES SANITARY SEWER EASEMENT
 - S.T.S.E. INDICATES STORM SEWER EASEMENT
 - A.E. INDICATES AERIAL EASEMENT
 - M.U.D. INDICATES MUNICIPAL UTILITY DISTRICT
 - E.E. INDICATES ELECTRICAL EASEMENT
 - U.V.E. INDICATES UNOBSTRUCTED VISIBILITY EASEMENT
 - F.B.C.C.F. INDICATES FORT BEND COUNTY CLERK FILE
 - F.B.C.P.R. INDICATES FORT BEND COUNTY PLAT RECORDS
 - F.B.C.O.R. INDICATES FORT BEND COUNTY OFFICIAL RECORDS
 - F.B.C.O.P.R. INDICATES FORT BEND COUNTY PUBLIC RECORDS
 - F.B.C.D.R. INDICATES FORT BEND COUNTY DEED RECORDS
 - F.N. INDICATES FILE NUMBER
 - NO. INDICATES NUMBER
 - VOL. INDICATES VOLUME
 - PG. INDICATES PAGE
 - R.O.W. INDICATES STREET NAME CHANGE
 - INDICATES RIGHT-OF-WAY
 - TEMP. INDICATES TEMPORARY
 - RES. INDICATES RESERVE

SIENNA SECTION 46

A SUBDIVISION OF 26.279 ACRES OF LAND SITUATED IN THE WILLIAM HALL SURVEY, ABSTRACT 31, FORT BEND COUNTY, TEXAS.

82 LOTS 8 RESERVES (9.360 ACRES) 2 BLOCKS
MAY 10, 2022 JOB NO. 1416-1546P

OWNERS:
TOLL-GTIS PROPERTY OWNER, LLC
JIMMIE F. JENKINS, AUTHORIZED REPRESENTATIVE
10110 WEST SAM HOUSTON PARKWAY NORTH, SUITE 210, HOUSTON, TEXAS 77064
PH. (281) 894-8655

SIENNA PARKS & LEVEE IMPROVEMENT DISTRICT
OF FORT BEND COUNTY, TEXAS
KEN BECKMAN, PRESIDENT
202 CENTURY SQUARE BLVD., SUGAR LAND, TEXAS 77478-3796
PH. (281) 500-6050

SURVEYOR:
GBI PARTNERS
LAND SURVEYING CONSULTANTS
4784 VISTA ROAD - PASADENA, TX 77050
PHONE: 281-499-4539 • GBSurvey@GBISurvey.com
TRESPASS FIRM # 10130800 • www.GBISurvey.com

ENGINEER:
LJA Engineering, Inc.
1904 W. Grand Parkway North
Suite 100
Katy, Texas 77449
SCOTT FRANKOVICH, P.E.
LICENSED PROFESSIONAL ENGINEER
TEXAS REGISTRATION NO. 130312

Phone 713.953.5200
Fax 713.953.5026
FRN-F-1386

JON BORDOVSKY, R.P.L.S.
REGISTERED PROFESSIONAL LAND SURVEYOR
TEXAS REGISTRATION NO. 6405

SCOTT FRANKOVICH, P.E.
LICENSED PROFESSIONAL ENGINEER
TEXAS REGISTRATION NO. 130312