



Fort Bend County Engineering
FORT BEND COUNTY, TEXAS

J. Stacy Slawinski, P.E.
County Engineer

April 21, 2022

Commissioner Vincent M. Morales, Jr.
Fort Bend County Precinct 1
22333 Grand Corner Drive
Katy, Texas 77494

RE: Skinner Lane at McCrary Road – All-Way Stop Control

Dear Commissioner:

The Fort Bend County Engineering Department has completed a review of the operational conditions at the intersection of Skinner Lane at McCrary Road in response to a request for all-way stop control. The intersection currently operates with stop control on McCrary Road. Both roadways have posted speed of 35 mph. Skinner Lane is identified as a Collector in the 2015 Fort Bend County Major Thoroughfare Plan.

Traffic counts were collected and used to evaluate the intersection for all-way stop control based on the warrants specified in the Texas Manual on Uniform Traffic Control Devices. Based on the data collected, traffic volumes warrant all-way stop control at the intersection. The updated traffic control plan is attached.

Based on the above results, Engineering recommends the conversion of the intersection to all-way stop control. If you have any questions please do not hesitate to contact me at 281-633-7528 or chris.debaillon@fortbendcountytexas.gov.

Regards,

Chris Debaillon, PE, PTOE
Assistant County Engineer – Traffic

cc: Judge KP George, County Judge
Scotty Wieghat - FBC Road & Bridge
Brian Fields - FBC Road & Bridge
Major Rudy Castaneda – FBC Sheriff's Office Rudy.Castaneda@fortbendcountytexas.gov
Major Manuel Zamora – FBC Sheriff's Office Manuel.Zamora@fortbendcountytexas.gov
File

Attachments

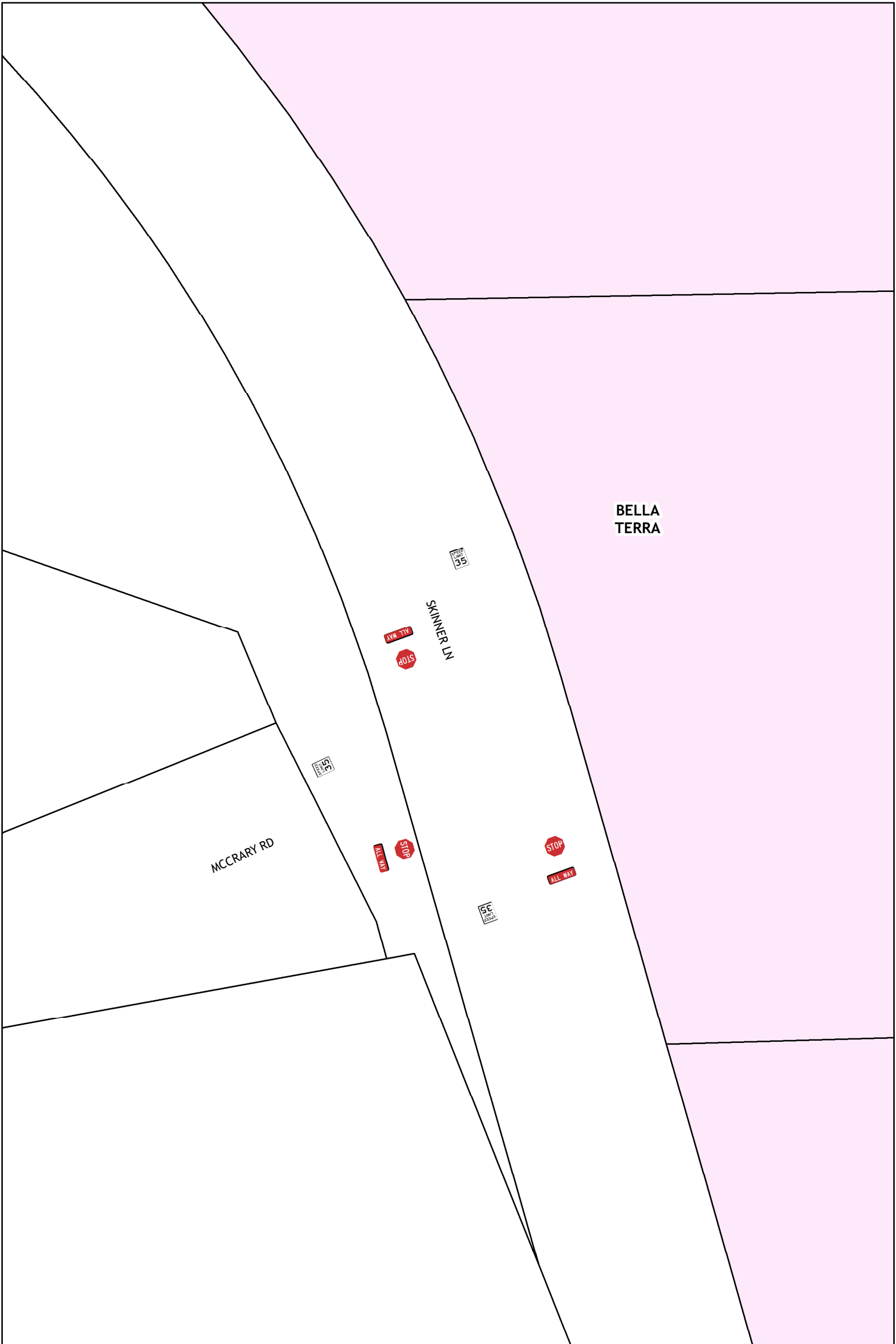

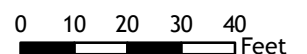

Skinner Ln. at McCrary Rd.



Plan by: Engineering GIS
Date: 4/21/2022

Plan Approved by: Chris Debaillon, PE PTOE
Date: CD 4/21/2022

Sign Legend

-  All Way Plaque (Written)
-  Stop
-  Speed Limit 35 mph



Notes:
The purpose of this traffic control plan is to establish traffic control for Skinner Ln. at McCrary Rd.