



Fort Bend County Engineering  
FORT BEND COUNTY, TEXAS

J. Stacy Slawinski, P.E.  
County Engineer

February 1, 2022

Commissioner Grady Prestage  
Fort Bend County Precinct 2  
303 Texas Parkway, Suite 213  
Missouri City, Texas 77459

**RE: Greatwood Lake, Section 2B - Traffic Control Plan  
Greatwood Lake, Section 3**

Dear Commissioner:

The Construction Completion letters was issued on 1/24/2022 and 1/21/2022, which started the one year maintenance period. Fort Bend County Engineering has completed and recommends approval of the traffic control plan for the above referenced subdivision. The public hearing date for acceptance of the plan is being scheduled.

A copy of the traffic control plan is attached for your review. If you should have any questions, please give me a call.

Sincerely,

A handwritten signature in blue ink, appearing to read "Chris Debaillon".

Chris Debaillon, PE, PTOE  
Assistant County Engineer – Traffic

CD/gyl

cc: Judge KP George, County Judge  
Scott Wieghat - FBC Road & Bridge  
Brian Fields - Signage Department  
Major Rudy Castaneda – FBC Sheriff's Office [Rudy.Castaneda@fortbendcountytexas.gov](mailto:Rudy.Castaneda@fortbendcountytexas.gov)  
Major Manuel Zamora – FBC Sheriff's Office [Manuel.Zamora@fortbendcountytexas.gov](mailto:Manuel.Zamora@fortbendcountytexas.gov)  
File

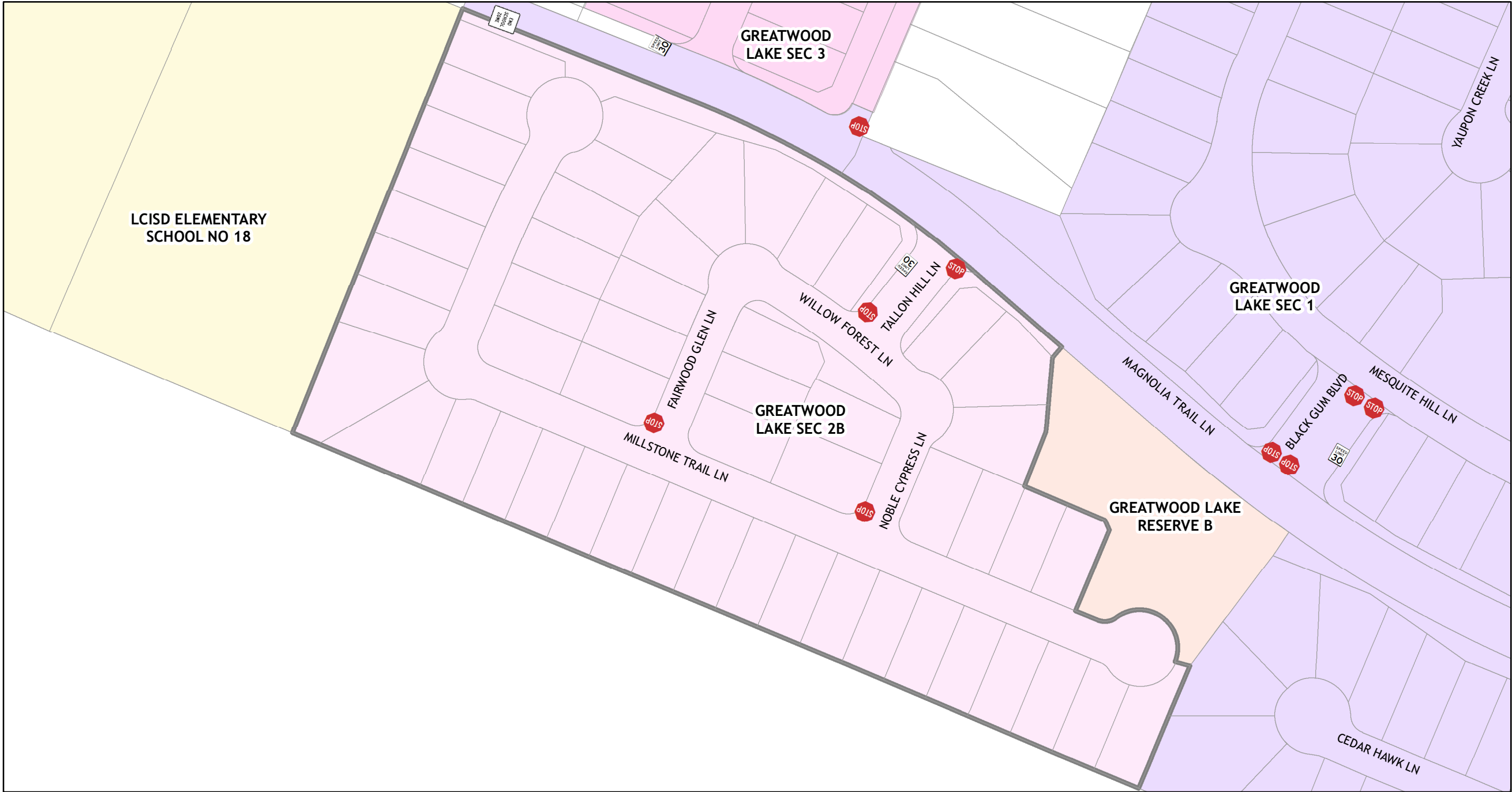

Plan by: Engineering GIS  
Date: 2/3/2022

Plan Approved by: Chris Debailon, PE PTOE  
Date: CD 2/3/2022

## Greatwood Lake, Section 2B

### Sign Legend



School Zone (End)



Speed Limit 30 mph



Stop

0 40 80 120 160 Feet



Notes:  
The purpose of this traffic control plan is to establish traffic control for Greatwood Lake, Section 2B.

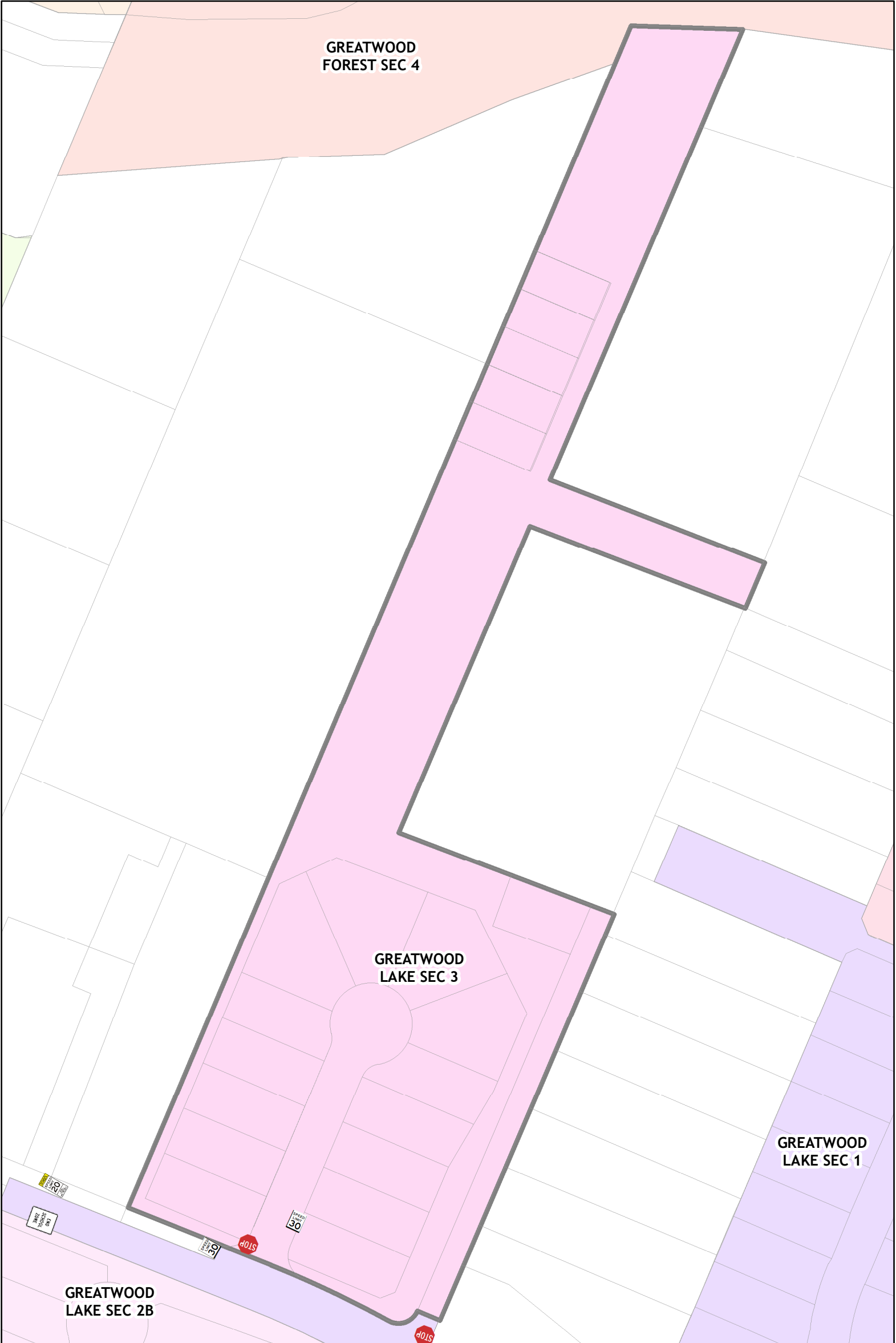



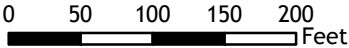

Greatwood Lake, Section 3



Plan by: Engineering GIS  
Date: 2/7/2022

Plan Approved by: Chris Debaillon, PE PTOE  
Date: CD 2/7/2022

Sign Legend			
	School Zone (End)		Speed Limit 30 mph
	School Zone - 20 mph		Stop

Notes:  
The purpose of this traffic control plan is to establish traffic control for Greatwood Lake, Section 3.