



Fort Bend County Engineering
FORT BEND COUNTY, TEXAS

J. Stacy Slawinski, P.E.
County Engineer

December 13, 2021

Commissioner Vincent M. Morales, Jr.
Fort Bend County Precinct 1
1517 Eugene Heimann Circle
Richmond, TX 77469

Commissioner Grady Prestage
Fort Bend County Precinct 2
303 Texas Parkway, Suite 213
Missouri City, Texas 77489

**RE: Addition of "NO PARKING" signs on Benton Road in Walnut Creek Section 15,
Irby Cobb Blvd STD Section 2, and Walnut Creek Section 16**

Dear Commissioners:

At the request of the Walnut Creek HOA, Fort Bend County Engineering Department has completed the traffic control plan to prohibit parking on: the east side of the Benton Road concrete asphalt transition in Walnut Creek Section 15, the stub-outs for future southbound Benton Road in Irby Cobb Blvd Std Section 2, and the stub-out for the future Benton Road median opening in Walnut Creek Section 16. This prohibition will be in effect all day. The public hearing date for acceptance for the plan will be scheduled on the next available Commissioner's Court Agenda.

A copy of the traffic control plan is attached for your review. If we can be of further assistance please do not hesitate to contact me at 281-633-7528 or chris.debaillon@fortbendcountytexas.gov.

Sincerely,

Chris Debaillon, PE, PTOE
Assistant County Engineer - Traffic

cc: Judge KP George, County Judge
Scott Wieghat - FBC Road & Bridge
Brian Fields - FBC Road & Bridge
Major Rudy Castaneda – FBC Sheriff's Office Rudy.Castandea@fortbendcountytexas.gov
Major Manuel Zamora – FBC Sheriff's Office Manuel.Zamora@fortbendcountytexas.gov
File

301 Jackson St., Suite 401, Richmond, TX 77469
Phone 281-633-7500

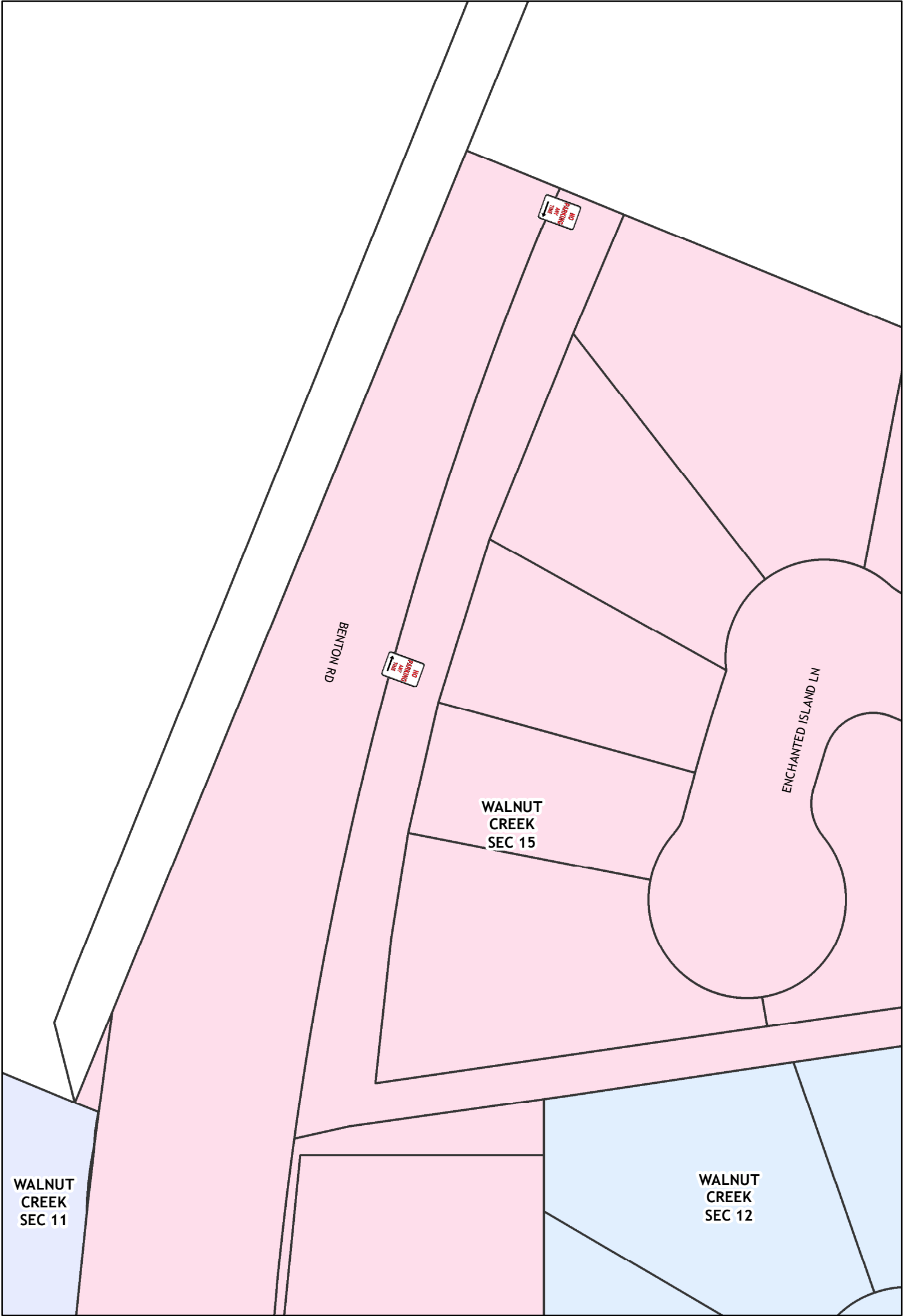



Benton Rd at Walnut Creek Subd



Plan by: Engineering GIS
Date: 12/13/2021

Plan Approved by: Chris Debaillon, PE PTOE
Date: CD 12/13/2021

Sign Legend

No Parking Any Time (Left Arrow)

No Parking Any Time (Right Arrow)

0 10 20 30 40 50
Feet

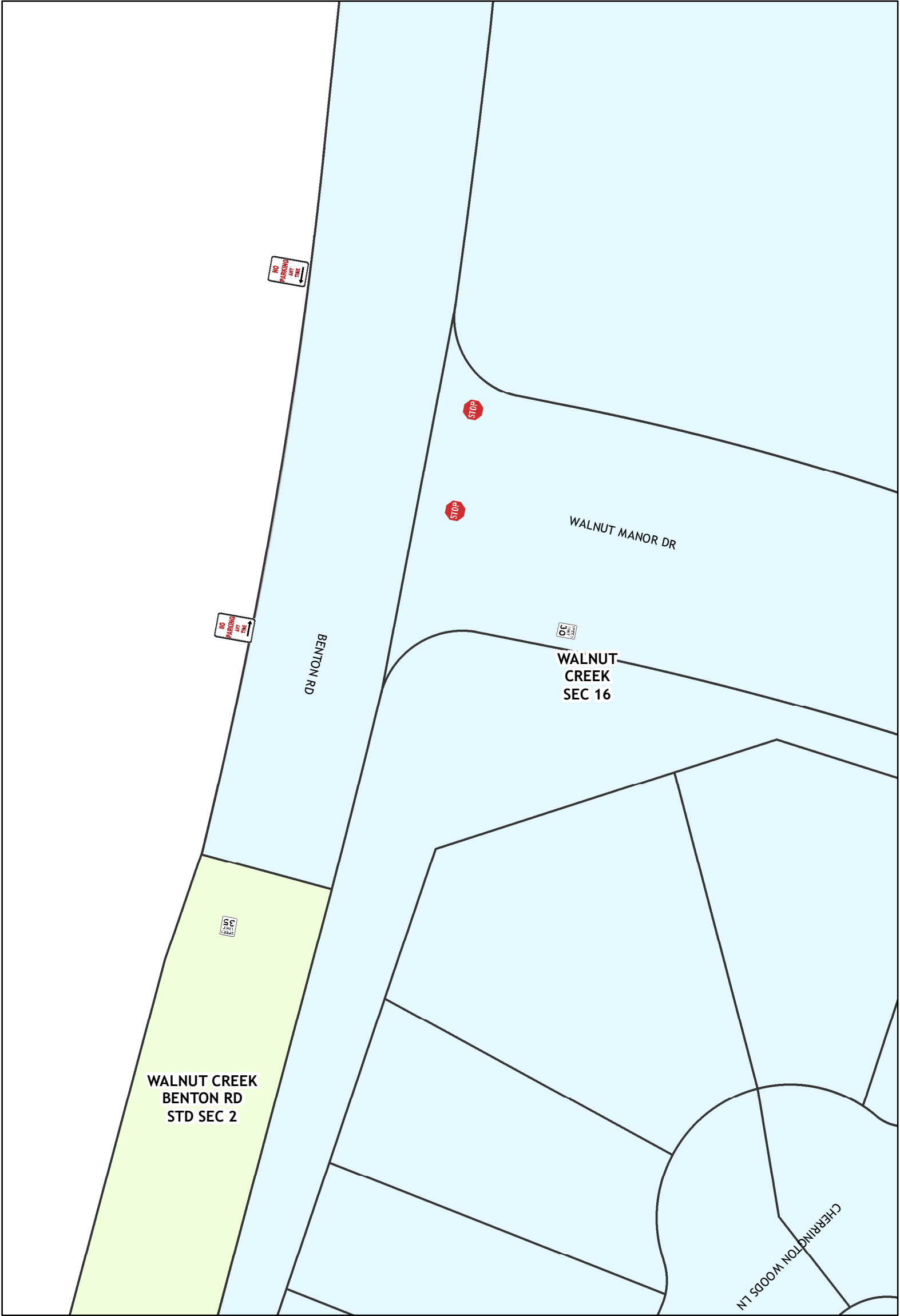

Notes:
The purpose of this traffic control plan is to establish traffic control for Benton Rd with the addition of "No Parking Any Time" signs.



Benton Rd at Walnut Manor Dr

Sign Legend



No Parking Any Time (Left Arrow)



No Parking Any Time (Right Arrow)



Speed Limit 30 mph



Speed Limit 35 mph



Stop

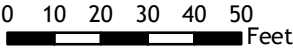

Notes:
The purpose of this traffic control plan is to establish traffic control for Benton Rd with the addition of "No Parking Any Time" signs.



Plan by: Engineering GIS
Date: 12/13/2021

Plan Approved by: Chris Debaillon, PE PTOE
Date: CD 12/13/2021

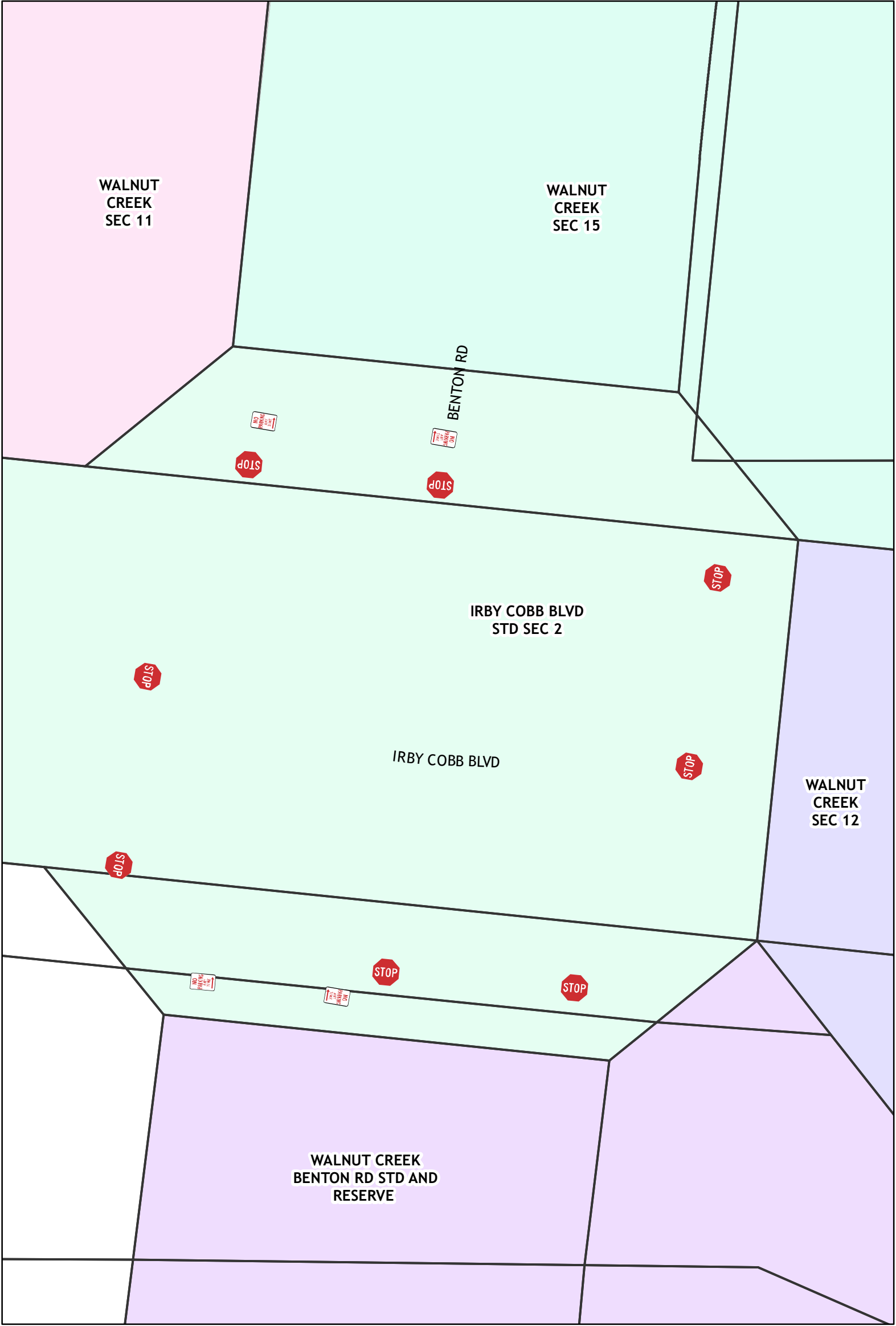

Plan by: Engineering GIS
Date: 12/13/2020

Plan Approved by: Chris Debaillon, PE PTOE
Date: CD 12/13/2021

Irby Cobb Blvd. STD Section 2
(Revised)



Stop



No Parking Any Time (Right Arrow)



No Parking Any Time (Left Arrow)

Sign Legend

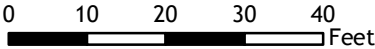

Notes:
The purpose of this traffic control plan is to revise traffic control for Irby Cobb Blvd. STD Section 2 with the addition of "No Parking Any Time" signs.