

PLAT RECORDING SHEET

PLAT NAME: Resort at Harvest Green

PLAT NO: _____

ACREAGE: 10.245

LEAGUE: William Morton One and One-Half League Grant

ABSTRACT NUMBER: 62

NUMBER OF BLOCKS: 1

NUMBER OF LOTS: 0

NUMBER OF RESERVES: 1

OWNERS: Grand Parkway 1358 LP

(DEPUTY CLERK)

F:\Clients\0313-Edison_Equity_Management\0313-2102_Harvest_Green_Drawings\Survey\Plat\Resort @ Harvest Green.dwg Oct 06, 2021-9:16am Terra Associates Inc., Michael Jenkins

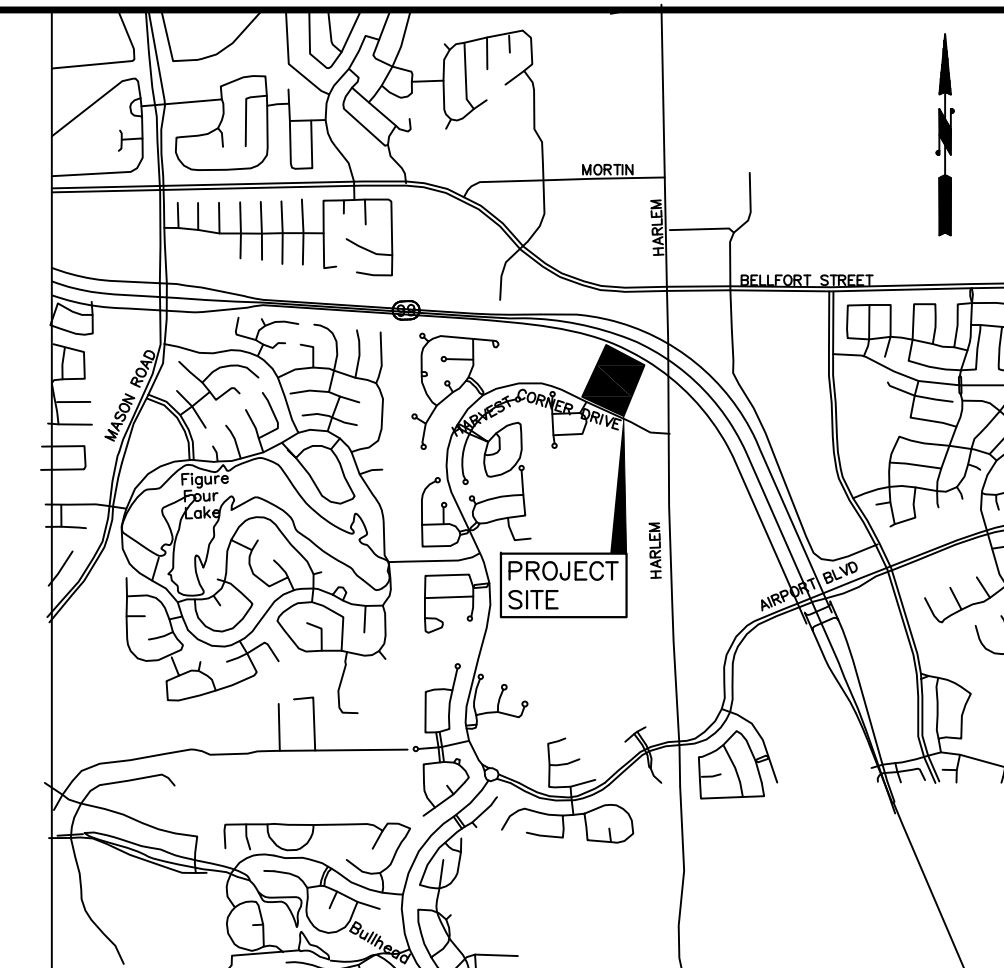
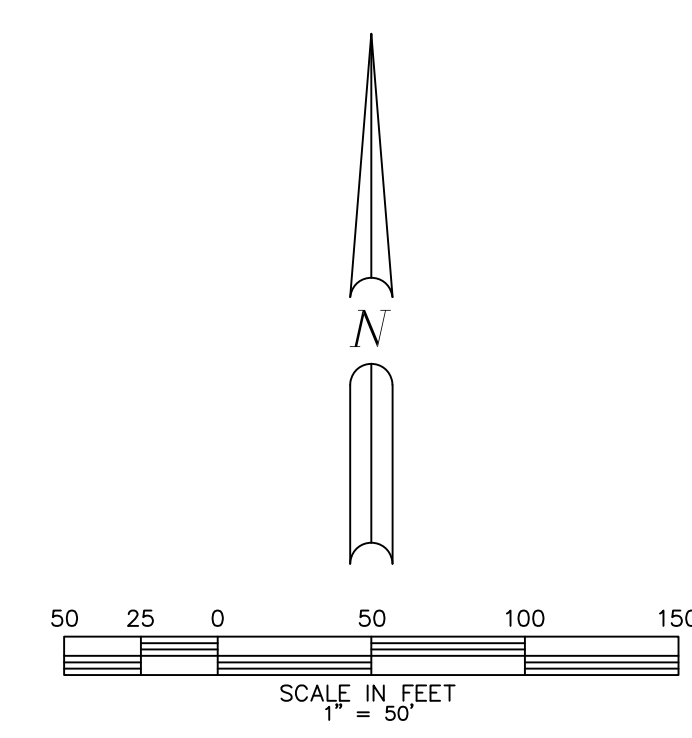

Vicinity Map (not to scale)
KEY MAP: 526 Y

ABBREVIATIONS LEGEND

DOC.	DOCUMENT
D.E.	DRAINAGE EASEMENT
ESMT.	EASEMENT
FC	FILM CODE
FND	FOUND
H.C.A.D.	HARRIS COUNTY APPRAISAL DISTRICT
H.C.C.F.	HARRIS COUNTY CLERK'S FILE
H.C.D.R.	HARRIS COUNTY DEED RECORDS
H.C.M.R.	HARRIS COUNTY MAP RECORDS
IR	IRON ROD
NO.	NUMBER
R.O.W.	RIGHT OF WAY
SAN	SANITARY SEWER
SEW	SEWER
STM	STORM SEWER
VOL. PG.	VOLUME AND PAGE

NOTES:

1. THE COORDINATES SHOWN HEREON ARE TEXAS SOUTH CENTRAL ZONE NO. 4204 STATE PLANE GRID COORDINATES (NAD83) AND MAY BE BROUGHT TO SURFACE BY APPLYING THE FOLLOWING COMBINED SCALE: 0.9998700169.
2. ALL BEARINGS BASED ON THE TEXAS COORDINATE SYSTEM, SOUTH CENTRAL ZONE (NAD 83).
3. UNLESS OTHERWISE INDICATED, THE BUILDING LINES (B.L.), WHETHER ONE OR MORE, SHOWN ON THIS SUBDIVISION PLAT ARE ESTABLISHED TO EVIDENCE COMPLIANCE WITH THE APPLICABLE PROVISIONS OF CHAPTER 42, CODE OF ORDINANCES, CITY OF HOUSTON, TEXAS, IN EFFECT AT THE TIME THIS PLAT WAS APPROVED, WHICH MAY BE AMENDED FROM TIME TO TIME.
4. THE BUILDING LINE REQUIREMENTS ESTABLISHED BY CHAPTER 42 ARE MINIMUM STANDARDS. WHERE DEED RESTRICTIONS PROVIDE FOR A GREATER BUILDING SETBACK, THE DEED RESTRICTIONS SHALL CONTROL OVER THE PROVISIONS OF THIS DIVISION.
5. ABSENT WRITTEN AUTHORIZATION BY THE AFFECTED UTILITIES, ALL UTILITY AND AERIAL EASEMENTS MUST BE KEPT UNOBSTRUCTED FROM ANY NON-UTILITY IMPROVEMENTS OR OBSTRUCTIONS BY THE PROPERTY OWNER. ANY UNAUTHORIZED IMPROVEMENTS OR OBSTRUCTIONS MAY BE REMOVED BY ANY PUBLIC UTILITY AT THE PROPERTY OWNER'S EXPENSE. WHILE WOODEN POSTS AND PANELED WOODEN FENCES ALONG THE PERIMETER AND BACK TO BACK EASEMENTS AND ALONGSIDE REAR LOTS LINES ARE PERMITTED, THEY TOO MAY BE REMOVED BY PUBLIC UTILITIES AT THE PROPERTY OWNER'S EXPENSE SHOULD THEY BE AN OBSTRUCTION. PUBLIC UTILITIES MAY PUT SAID WOODEN POSTS AND PANELED WOODEN FENCES BACK UP, BUT GENERALLY WILL NOT REPLACE WITH NEW FENCING.
6. ALL NON-PERIMETER EASEMENTS ON PROPERTY LINES ARE CENTERED UNLESS OTHERWISE NOTED.
7. THIS TRACT LIES IN ZONE "X" (UNSHADED), DESIGNATED AS "AREAS DETERMINED TO BE OUTSIDE THE 0.2% ANNUAL CHANCE FLOODPLAIN", AS PER THE NATIONAL FLOOD INSURANCE PROGRAM FIRM PANEL NUMBER 4802280140 L, PUBLISHED MAP REVISED DATE APRIL 2, 2014.
8. ALL PROPERTY TO DRAIN INTO THE DRAINAGE EASEMENT ONLY THROUGH AN APPROVED DRAINAGE STRUCTURE.
9. ALL OF THE PROPERTY SUBDIVIDED IN THE FOREGOING PLAT IS WITHIN THE INCORPORATED BOUNDARIES OF THE CITY OF HOUSTON, TEXAS' ETJ.
10. THIS PROPERTY LIES WHOLLY WITHIN FORT BEND COUNTY, FORT BEND MUD 134D AND FORT BEND INDEPENDENT SCHOOL DISTRICT.
11. ALL PIPELINE EASEMENTS WITHIN THE PLATTED AREA ARE SHOWN HEREON.
12. SIDEWALKS SHALL BE BUILT OR CAUSED TO BE BUILT NOT LESS THAN 5 FEET IN WIDTH ON BOTH SIDES OF ALL DEDICATED RIGHT-OF-WAY WITHIN SAID PLAT AND WITH THE EXCEPTION OF THE GRAND PARKWAY (SH 99) ON THE CONTIGUOUS RIGHT-OF-WAY OF ALL PERIMETER ROADS SURROUNDING SAID PLAT, IN ACCORDANCE WITH ADA REQUIREMENTS.
13. THE TOP OF ALL FLOOR SLABS SHALL BE A MINIMUM OF 93.01 FEET ABOVE MEAN SEA LEVEL (NAVD 88 DATUM). IN ADDITION, NO TOP OF SLAB ELEVATION SHALL BE LESS THAN 24 INCHES ABOVE THE LOWEST TOP OF CURB ADJACENT TO THE LOT IN WHICH IT LIES. IN THE ABSENCE OF A CURB, THE TOP OF SLAB ELEVATION SHALL BE NO LESS THAN 24 INCHES ABOVE THE HIGHEST NATURAL GROUND ALONG THE PERIMETER OF THE BUILDING FOUNDATION AND 12 INCHES ABOVE ANY DOWN GRADIENT ROADWAY OR DRAINAGE RESTRAINT, WHICHEVER IS HIGHER.
14. THE DRAINAGE SYSTEM FOR THIS SUBDIVISION IS DESIGNED IN ACCORDANCE WITH THE "FORT BEND COUNTY DRAINAGE CRITERIA MANUAL" WHICH ALLOWS STREET PONDING WITH INTENSE RAINFALL EVENTS.
15. THE LIGHTING ZONE IS LZ3.
16. ALL DRAINAGE EASEMENTS TO BE KEPT CLEAR OF FENCES, BUILDINGS, VEGETATION AND OTHER OBSTRUCTIONS FOR THE PURPOSE OF THE OPERATION AND MAINTENANCE OF THE DRAINAGE FACILITY.
17. THE CONTOURS SHOWN HEREON ARE PER CONDITIONS PRIOR TO THE ADDITION OF FILL.
18. THIS TRACT IS SUBJECT TO THE TERMS, CONDITIONS AND PROVISIONS AS SET OUT BY THE "REGULATIONS OF FORT BEND COUNTY FOR THE PLACEMENT OF SIGNS VISIBLE FROM THE MAIN-TRAVELED WAY OF A TOLL ROAD", AS ADOPTED BY COMMISSIONER COURT ON JANUARY 24, 2006, AND AS AMENDED ON AUGUST 27, 2013.
19. SITE PLANS SHALL BE SUBMITTED TO FORT BEND COUNTY AND ANY OTHER APPLICABLE JURISDICTION FOR REVIEW AND APPROVAL TO OBTAIN A DEVELOPMENT PERMIT. DEVELOPMENT PERMITS AND ALL OTHER APPLICABLE PERMITS SHALL BE OBTAINED FROM FORT BEND COUNTY PRIOR TO BEGINNING CONSTRUCTION.
20. THE PROPERTY OWNER SHALL HAVE OWNERSHIP AND MAINTENANCE RESPONSIBILITY FOR ALL ON-SITE STORM WATER DETENTION FACILITIES AND THIS RESPONSIBILITY SHALL TRANSFER TO ALL FUTURE OWNERS UPON OWNERSHIP CHANGE.
21. ACCESS TO GRAND PARKWAY (SH 99) IS DENIED.
22. ALL FUTURE DEVELOPMENT SHOULD VERIFY THAT THE MINIMUM SLAB ELEVATION IS AT LEAST 12" ABOVE THE MAXIMUM EXTREME EVENT PONDING ELEVATION WITHIN THE SITE.

RESTRICTED RESERVE "D"
0.5173 ACRES (22,531 SQ. FT.)
(F.B.C.C.F. No. 20180128)

BLOCK 1
HARVEST GREEN
SEC 16
(PLAT NO. 20170181, P.R.F.B.C.)

FRESH SAGE CROSSING
(50' R.O.W.)
(PLAT NO. 20170181, F.B.C.P.R.)

BLOCK 2
HARVEST GREEN
SEC 16
(PLAT NO. 20170181, P.R.F.B.C.)

RESTRICTED RESERVE "E"
0.4185 ACRES (18,140 SQ. FT.)
(F.B.C.C.F. No. 20180128)

LEMNON LILY LANE
(50' R.O.W.)
(PLAT NO. 20170181, F.B.C.P.R.)

BLOCK 1
HARVEST GREEN
SEC 16
(PLAT NO. 20170181, P.R.F.B.C.)

HARVEST CORNER DRIVE
(60' R.O.W.)
(PLAT NO. 20170065, F.B.C.P.R.)

RESTRICTED RESERVE "A"
10.245 ACRES (446,261 SQ. FT.)
(F.B.C.C.F. No. 20180128)

BLOCK 1
UNRESTRICTED RESERVE "A"
1.47 ACRES (63,908 SQ. FT.)
(F.B.C.C.F. No. 20180128)

RESTRICTED RESERVE "B"
2.1097 ACRES (91,898 SQ. FT.)
(F.B.C.C.F. No. 20170181)

6.2171 ACRES
LIDL US OPERATIONS, LLC
(F.B.C.C.F. No. 2017069660)

GRAND PARKWAY
(S.H. 99)
(400' R.O.W.)
(F.B.C.C.F. NO. 91448229)

L=572.59'
R=2664.79'
Δ=12°18'40"
Ch=S64°03'42"E
571.48'

P.O.B.
FND 5/8" IRC-GBI
X=3,011,369.81
Y=13,801,482.10

OWNERS:
GRAND PARKWAY 1358, L.P.
A TEXAS LIMITED PARTNERSHIP
2103 MDALIA OHLON CT
RICHMOND, TX 77408

ENGINEER:
TERRA
ASSOCIATES, INC.
1448 N. LOOP WEST - SUITE 450
HOUSTON, TEXAS 77008
TEL. (713) 993-0333
FAX (713) 993-0743
TBPE REGISTRATION NO. F-003832

SURVEYOR:
TEJAS SURVEYING, INC.
1810 FIRST OAKS STREET, SUITE 220
RICHMOND, TX 77408
(281) 240-9099
TBPLS FIRM NO. 10031300

RESORT AT HARVEST GREEN

A SUBDIVISION BEING 10.245 ACRES (446,241 SQUARE FEET)
OF LAND SITUATED IN THE WILLIAM MORTON ONE AND ONE
HALF LEAGUE GRANT, ABSTRACT NUMBER 62, FORT BEND
COUNTY, TEXAS

OCTOBER, 2021
1 BLOCK 1 RESERVE

STATE OF TEXAS
COUNTY OF FORT BEND

WE, GRAND PARKWAY 1358, L.P., A TEXAS LIMITED PARTNERSHIP, ACTING BY AND THROUGH JOHNSON 1358 GP LLC, A TEXAS LIMITED LIABILITY COMPANY, ITS GENERAL PARTNER, REPRESENTED HEREIN BY JERRY ULKE, VICE PRESIDENT, OWNER, HEREINAFTER REFERRED TO AS OWNERS OF THE 10.245 ACRE TRACT DESCRIBED IN THE ABOVE AND FOREGOING MAP OF RESORT AT HARVEST GREEN, DO HEREBY MAKE AND ESTABLISH SAID SUBDIVISION AND DEVELOPMENT PLAN OF SAID PROPERTY ACCORDING TO ALL LINES, DEDICATIONS, RESTRICTIONS AND NOTATIONS ON SAID MAPS OR PLAT AND HEREBY DEDICATE TO THE USE OF THE PUBLIC FOREVER, ALL STREETS (EXCEPT THOSE STREETS DESIGNATED AS PRIVATE STREETS OR PERMANENT ACCESS EASEMENTS), ALLEYS, PARKS, WATER COURSES, DRAINS, EASEMENTS AND PUBLIC PLACES SHOWN THEREON FOR THE PURPOSES AND CONSIDERATIONS THEREIN EXPRESSED; AND DO HEREBY BIND OURSELVES, OUR HEIRS, SUCCESSORS AND ASSIGNS TO WARRANT AND FOREVER DEFEND THE TITLE ON THE LAND SO DEDICATED.

FURTHER, OWNERS HAVE DEDICATED AND BY THESE PRESENTS DO DEDICATE TO THE USE OF THE PUBLIC FOR PUBLIC UTILITY PURPOSES FOREVER UNOBSTRUCTED AERIAL EASEMENTS SHALL EXTEND HORIZONTALLY AN ADDITIONAL ELEVEN FEET, SIX INCHES (11' 6") FOR TEN FEET (10' 0") PERIMETER GROUND EASEMENTS OR SEVEN FEET, SIX INCHES (7' 6") FOR FOURTEEN FEET (14' 0") PERIMETER GROUND EASEMENTS OR FIVE FEET, SIX INCHES (5' 6") FOR SIXTEEN FEET (16' 0") PERIMETER GROUND EASEMENTS, FROM A PLANE SIXTEEN FEET (16' 0") ABOVE THE GROUND LEVEL UPWARD, LOCATED ADJACENT TO AND ADJOINING SAID PUBLIC UTILITY EASEMENTS THAT ARE DESIGNATED WITH AERIAL EASEMENTS (U.E. AND A.E.) AS INDICATED AND DEPICTED HEREON, WHEREBY THE AERIAL EASEMENT TOTALS TWENTY ONE FEET, SIX INCHES (21' 6") IN WIDTH.

FURTHER, OWNERS HAVE DEDICATED AND BY THESE PRESENTS DO DEDICATE TO THE USE OF THE PUBLIC FOR PUBLIC UTILITY PURPOSE FOREVER UNOBSTRUCTED AERIAL EASEMENTS. THE AERIAL EASEMENTS SHALL EXTEND HORIZONTALLY AN ADDITIONAL TEN FEET (10' 0") FOR TEN FEET (10' 0") BACK-TO-BACK GROUND EASEMENTS, OR EIGHT FEET (8' 0") FOR FOURTEEN FEET (14' 0") BACK-TO-BACK GROUND EASEMENTS OR SEVEN FEET (7' 0") FOR SIXTEEN FEET (16' 0") BACK-TO-BACK GROUND EASEMENTS, FROM A PLANE SIXTEEN FEET (16' 0") ABOVE THE GROUND LEVEL UPWARD, LOCATED ADJACENT TO BOTH SIDES AND ADJOINING SAID PUBLIC UTILITY EASEMENTS THAT ARE DESIGNATED WITH AERIAL EASEMENTS (U.E. AND A.E.) AS INDICATED AND DEPICTED HEREON, WHEREBY THE AERIAL EASEMENT TOTALS THIRTY FEET (30' 0") IN WIDTH.

FURTHER, OWNERS DO HEREBY COVENANT AND AGREE THAT ALL OF THE PROPERTY WITHIN THE BOUNDARIES OF THIS PLAT IS HEREBY RESTRICTED TO PREVENT THE DRAINAGE OF ANY SEPTIC TANKS INTO ANY PUBLIC OR PRIVATE STREET, ROAD OR ALLEY OR ANY DRAINAGE DITCH, EITHER DIRECTLY OR INDIRECTLY.

FURTHER, OWNERS DO HEREBY DEDICATE TO THE PUBLIC A STRIP OF LAND TWENTY (20) FEET WIDE ON EACH SIDE OF THE CENTER LINE OF ANY AND ALL BAYOUS, CREEKS, GULLIES, RAVINES, DRAINS AND DRAINAGE DITCHES LOCATED IN SAID SUBDIVISION, AS EASEMENTS FOR DRAINAGE PURPOSES. FORT BEND COUNTY OR ANY OTHER GOVERNMENTAL AGENCY SHALL HAVE THE RIGHT TO ENTER UPON SAID EASEMENT AT ANY AND ALL TIMES FOR THE PURPOSES OF CONSTRUCTION AND MAINTENANCE OF DRAINAGE FACILITIES AND STRUCTURES.

FURTHER, OWNERS DO HEREBY COVENANT AND AGREE THAT ALL OF THE PROPERTY WITHIN THE BOUNDARIES OF THIS PLAT AND ADJACENT TO ANY DRAINAGE EASEMENT, DITCH, GULLY, CREEK OR NATURAL DRAINAGE WAY SHALL HEREBY BE RESTRICTED TO KEEP SUCH DRAINAGE WAYS AND EASEMENTS CLEAR OF FENCES, BUILDINGS, PLANTING AND OTHER OBSTRUCTIONS TO THE OPERATIONS AND MAINTENANCE OF THE DRAINAGE FACILITY AND THAT SUCH ADJUTING PROPERTY SHALL NOT BE PERMITTED TO DRAIN DIRECTLY INTO THIS EASEMENT EXCEPT BY MEANS OF AN APPROVED DRAINAGE STRUCTURE.

FURTHER, WE DO HEREBY ACKNOWLEDGE THE RECEIPT OF THE "ORDERS FOR REGULATION OF OUTDOOR LIGHTING IN THE UNINCORPORATED AREAS OF FORT BEND COUNTY, TEXAS", AND DO HEREBY COVENANT AND AGREE AND SHALL COMPLY WITH THIS ORDER AS ADOPTED BY FORT BEND COUNTY COMMISSIONERS COURT ON MARCH 23, 2004 AND ANY SUBSEQUENT AMENDMENTS.

IN TESTIMONY WHEREOF, THE GRAND PARKWAY 1358, L.P., A TEXAS LIMITED PARTNERSHIP, ACTING BY AND THROUGH JOHNSON 1358 GP LLC, A TEXAS LIMITED LIABILITY COMPANY, ITS GENERAL PARTNER, HAS CAUSED THESE PRESENTS TO BE SIGNED BY JERRY ULKE, ITS VICE PRESIDENT, THIS _____ DAY OF _____, 2021.

GRAND PARKWAY 1358, L.P. A TEXAS LIMITED PARTNERSHIP

BY: JOHNSON 1358 GP LLC
A TEXAS LIMITED LIABILITY COMPANY
ITS GENERAL PARTNER

BY: _____
JERRY ULKE
VICE PRESIDENT

STATE OF TEXAS
COUNTY OF FORT BEND

BEFORE ME, THE UNDERSIGNED AUTHORITY, ON THIS DAY PERSONALLY APPEARED JERRY ULKE, VICE PRESIDENT OF JOHNSON 1358 GP LLC, A TEXAS LIMITED LIABILITY COMPANY, GENERAL PARTNER OF GRAND PARKWAY 1358, L.P., A TEXAS LIMITED PARTNERSHIP, KNOWN TO ME TO BE THE PERSON WHOSE NAME IS SUBSCRIBED TO THE FOREGOING INSTRUMENT AND ACKNOWLEDGED TO ME THAT THEY EXECUTED THE SAME FOR THE PURPOSES AND CONSIDERATIONS THEREIN EXPRESSED.

GIVEN UNDER MY HAND AND SEAL OF OFFICE, THIS _____ DAY OF _____, 2021.

NOTARY PUBLIC IN AND FOR THE STATE OF TEXAS
PRINT NAME: _____
MY COMMISSION EXPIRES: _____

I, RANDY S. MCCLENDON, AM REGISTERED UNDER THE LAWS OF THE STATE OF TEXAS TO PRACTICE THE PROFESSION OF SURVEYING AND HEREBY CERTIFY THAT THE ABOVE SUBDIVISION IS TRUE AND ACCURATE; WAS PREPARED FROM AN ACTUAL SURVEY OF THE PROPERTY MADE UNDER MY SUPERVISION ON THE GROUND; THAT, EXCEPT AS SHOWN ALL BOUNDARY CORNERS, ANGLE POINTS, POINTS OF CURVATURE AND OTHER POINTS OF REFERENCE HAVE BEEN MARKED WITH IRON (OR OTHER OBJECTS OF A PERMANENT NATURE) PIPES OR RODS HAVING AN OUTSIDE DIAMETER OF NOT LESS THAN FIVE EIGHTHS (5/8) INCH AND A LENGTH OF NOT LESS THAN THREE (3) FEET; AND THAT THE PLAT BOUNDARY CORNERS HAVE BEEN TIED TO THE TEXAS COORDINATE SYSTEM OF 1983, SOUTH CENTRAL ZONE.

RANDY S. MCCLENDON
REGISTERED PROFESSIONAL LAND SURVEYOR
TEXAS REGISTRATION NO. 4079

I, DAVID A. SEPULVEDA, A PROFESSIONAL ENGINEER LICENSED IN THE STATE OF TEXAS, DO HEREBY CERTIFY THAT THIS PLAT MEETS ALL REQUIREMENTS OF FORT BEND COUNTY TO THE BEST OF MY KNOWLEDGE.

DAVID A. SEPULVEDA
LICENSED PROFESSIONAL ENGINEER NO. 84006

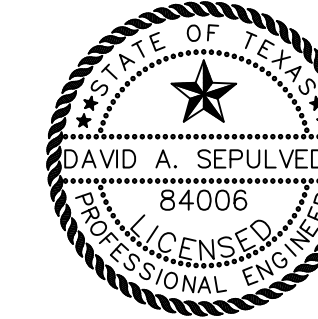

THIS IS TO CERTIFY THAT THE PLANNING COMMISSION OF THE CITY OF HOUSTON, TEXAS, HAS APPROVED THIS PLAT AND SUBDIVISION OF RESORT AT HARVEST GREEN IS IN CONFORMANCE WITH THE LAWS OF THE STATE OF TEXAS AND THE ORDINANCES OF THE CITY OF HOUSTON, AS SHOWN HEREON, AND AUTHORIZED THE RECORDING OF THIS PLAT THIS _____ DAY OF _____, 2021.

BY: _____
MARTHA L. STEIN (OR) M. SONNY GARZA
CHAIR OR VICE CHAIRMAN

BY: _____
MARGARET WALLACE BROWN, AICP, CNU-A
SECRETARY

I, J. STACY SLAWNSKI, P.E., FORT BEND COUNTY ENGINEER, DO HEREBY CERTIFY THAT THE PLAT OF THIS SUBDIVISION COMPLIES WITH ALL OF THE EXISTING RULES AND REGULATIONS OF THIS OFFICE AS ADOPTED BY THE FORT BEND COUNTY COMMISSIONERS' COURT. HOWEVER, NO CERTIFICATION IS HEREBY GIVEN AS TO THE EFFECT OF DRAINAGE FROM THIS SUBDIVISION ON THE INTERCEPTING DRAINAGE ARTERY OR PARENT STREAM OR ON ANY OTHER AREA OR SUBDIVISION WITHIN THE WATERSHED.

J. STACY SLAWNSKI, P.E.
FORT BEND COUNTY ENGINEER

APPROVED BY COMMISSIONERS' COURT OF FORT BEND COUNTY, TEXAS, THIS THE _____ DAY OF _____, 2021.

VINCENT M. MORALES, JR.
PRECINCT 1, COUNTY COMMISSIONER

GRADY PRESTAGE
PRECINCT 2, COUNTY COMMISSIONER

KP GEORGE
COUNTY JUDGE

W.A. "ANDY" MEYERS
PRECINCT 3, COUNTY COMMISSIONER

KEN R. DEMERCHANT
PRECINCT 4, COUNTY COMMISSIONER

I, LAURA RICHARD, COUNTY CLERK IN AND FOR FORT BEND COUNTY, HEREBY CERTIFY THAT THE FOREGOING INSTRUMENT WITH ITS CERTIFICATE OF AUTHENTICATION WAS FILED FOR RECORDATION IN MY OFFICE ON _____, 2021, AT _____ O'CLOCK ____M., IN PLAT NUMBER _____ OF THE PLAT RECORDS OF FORT BEND COUNTY, TEXAS.

WITNESS MY HAND AND SEAL OF OFFICE, AT RICHMOND, TEXAS. THE DAY AND DATE LAST ABOVE WRITTEN.

LAURA RICHARD, COUNTY CLERK
FORT BEND COUNTY, TEXAS

DEPUTY

OWNERS:

GRAND PARKWAY 1358, L.P.
A TEXAS LIMITED PARTNERSHIP
2103 MDALIA OHLON CT
RICHMOND, TX 77408

ENGINEER:

TERRA
ASSOCIATES, INC.
1448 N. LOOP WEST - SUITE 450
HOUSTON, TEXAS 77006
TEL. (713) 993-0333
FAX (713) 993-0743
TBPE REGISTRATION NO. F-003832

SURVEYOR:

TEJAS SURVEYING, INC.
1810 FIRST OAKS STREET, SUITE 220
RICHMOND, TX 77408
(281) 240-9099
TBPLS FIRM No. 10031300

RESORT AT HARVEST GREEN

A SUBDIVISION BEING 10.245 ACRES (446,241 SQUARE FEET)
OF LAND SITUATED IN THE WILLIAM MORTON ONE AND ONE
HALF LEAGUE GRANT, ABSTRACT NUMBER 62, FORT BEND
COUNTY, TEXAS

OCTOBER, 2021
1 BLOCK 1 RESERVE

TAI PROJECT NO. 0313-2102

SHEET 2 OF 2