



Fort Bend County Engineering
FORT BEND COUNTY, TEXAS

J. Stacy Slawinski, P.E.
County Engineer

October 17, 2019

Commissioner Vincent M. Morales, Jr.
Fort Bend County Precinct 1
1517 Eugene Heimann Circle, Suite 300
Richmond, Texas 77469

RE: Temporary Road Closure – Victoria Garden Drive and Musket Ridge Drive for Storm Sewer Repairs within Pecan Grove MUD, Permit #APP-34273

Dear Commissioner:

Odyssey Engineering Group is requesting temporary road closure of Victoria Garden Drive and Musket Ridge Drive for storm sewer repairs, within Pecan Grove MUD, pursuant to Section 251.011 of the Texas Transportation Code. The request for temporary road closure is from November 6, 2019 until the project is completed.

The request will be placed on the November 5, 2019 Commissioners Court agenda. The detours and traffic control plan is attached. Advance warning signage will be posted prior to the road closure.

Should you have any questions please do not hesitate to call me at 281-633-7515.

Sincerely,

Rick J. Staigle, P.E., PTOE
First Assistant County Engineer

RJS/mjs

Attachment: Detour map

cc: Ms. Sarah L. Abrams, P.E., Odyssey Engineering, Inc. sabrams@odysseyeg.com
Mr. Justin R. Ring, P.E., Odyssey Engineering, Inc. jring@odysseyeg.com
Ms. Angela L. Howes, P.E., Odyssey Engineering, Inc. ahowes@odysseyeg.com
Mr. Wesley Crawford, FBC Engineering
Mr. Brian Fields, FBC Road & Bridge
Mr. Jose Ramirez, FBC Permit Coordinator Permits@fortbendcountytexas.gov
Mr. Chris Debaillon, P.E., PTOE, Assistant County Engineer -Traffic
Major Chad Norvell, FBC Sheriff's Office Chad.norvell@fortbendcountytexas.gov
File

301 Jackson St., Suite 401, Richmond, TX 77469
Phone 281-633-7500

October 17, 2019

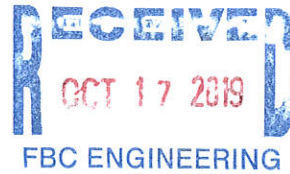

Fort Bend County Engineering
301 Jackson St, Suite 480
Richmond, Texas 77469

Re: Victoria Garden Drive and Musket Ridge Drive Storm Sewer Repair
Traffic Control Plan for Temporary Road Closure
Pecan Grove Municipal Utility District
17-020-103

To Whom It May Concern,

Pecan Grove Municipal Utility District is constructing drainage improvements along Victoria Garden Drive. The contractor, HTI Construction, needs to close portions of Victoria Garden Drive and Musket Ridge Drive, near Bullhead slough, to all but local traffic. We propose the lane closure from November 6, 2019 to November 27, 2019. HTI Construction will be removing a section of the existing storm sewer and replacing with larger storm sewer to alleviate ponding in the intersection of Victoria Garden Drive and Musket Ridge Drive.

Attached is the Traffic Control plan for your reference which has been reviewed and approved by Fort Bend County. Please let me know if you have any questions.

Sincerely,

A handwritten signature in blue ink that appears to read "Angela H".

Angela L. Howes, P.E.
Senior Project Manager

NOTES:

- A. CONTRACTOR TO OBTAIN FORT BEND COUNTY PERFORMANCE BOND
- B. DIGITAL MESSAGE BOARDS WITH DETOUR DATES TO BE PLACED TWO WEEKS IN ADVANCE TO IMPLEMENTING DETOUR PLAN.

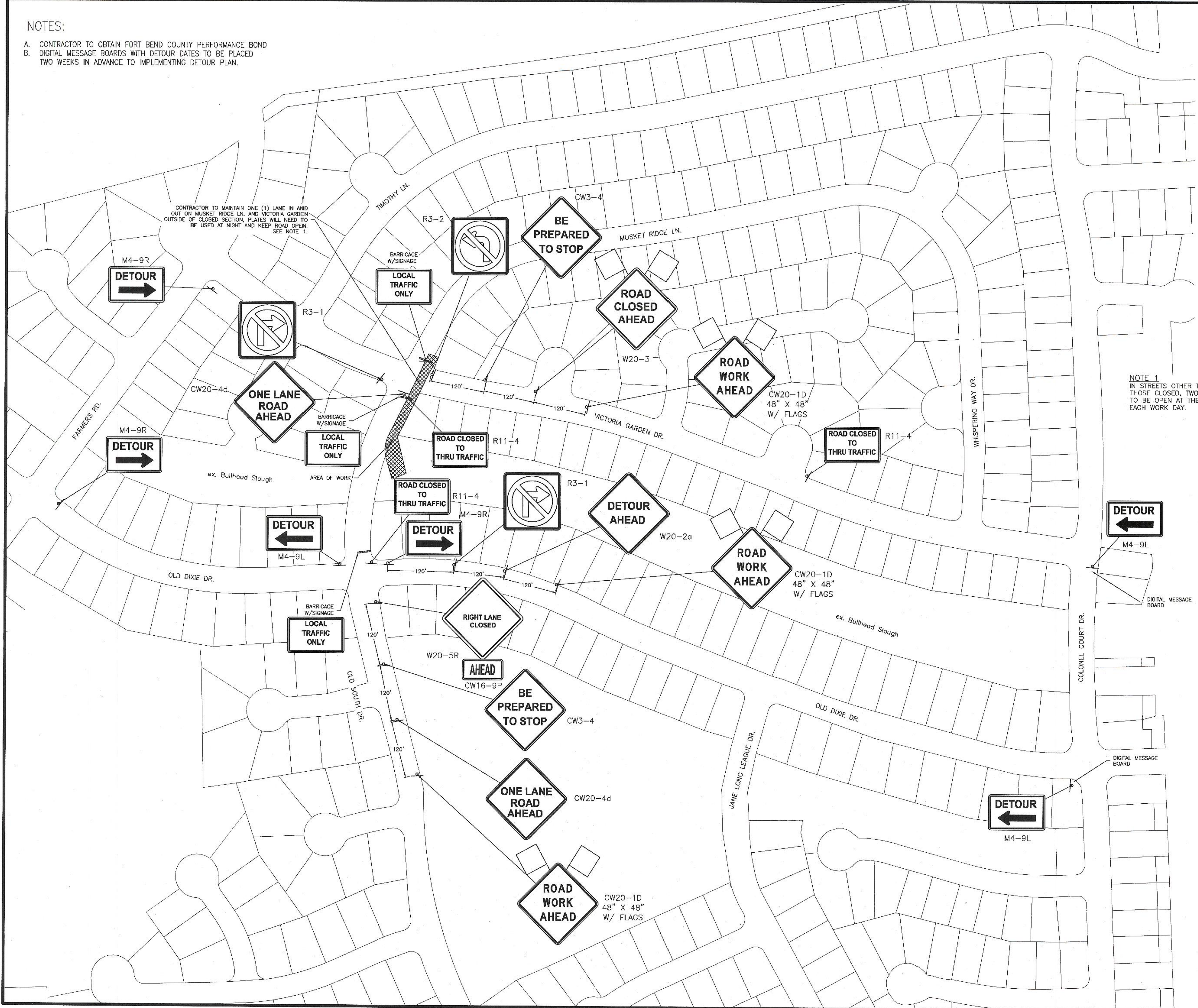
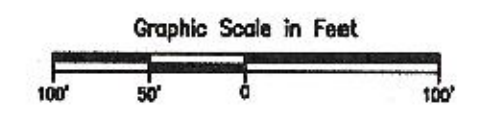

CONTRACTOR TO MAINTAIN ONE (1) LANE IN AND OUT ON MUSKET RIDGE LN. AND VICTORIA GARDEN DRIVE. OUTSIDE OF CLOSED SECTION. PLATES WILL NEED TO BE USED AT NIGHT AND KEEP ROAD OPEN. SEE NOTE 1.

NOTE 1
IN STREETS OTHER THAN THOSE CLOSED, TWO LANES TO BE OPEN AT THE END OF EACH WORK DAY.

BENCHMARK(S) / FLOODPLAIN		

APPR.	REVISION	DATE

APPROVED: Angela H.
Development Coordinator
DATE: 8/6/19



CITY OF RICHMOND APPROVALS
DIRECTOR OF PUBLIC WORKS: HOWARD CHRISTIAN
CITY ENGINEER: KALUZA, INC.

ODYSSEY ENGINEERING GROUP
2500 Tanglewilde Street, Suite 480
Houston, Texas 77063
t: 281.306.0240 | www.odysseyeg.com
TBPE No. F-17637

CITY OF RICHMOND FORT BEND COUNTY, TEXAS
800 Morton
Richmond, Texas 77489
(281) 342-0559



PECAN GROVE M.U.D.
STORM SEWER REPAIR VICTORIA GARDEN DRIVE

TRAFFIC CONTROL LAYOUT

SURV. _____	DATE _____	JOB NO. 17-020-103
DSGN. <u>AW</u>	DATE <u>6/2019</u>	FILE: TRAFFIC CONTROL LAYOUT
OWN. <u>AW</u>	DATE <u>6/2019</u>	PLOT SCALE: 1:1
CHKD. <u>JBR</u>	DATE <u>6/2019</u>	IMAGE NO.
APPR. <u>JBR</u>	DATE <u>6/2019</u>	
SCALE: HORIZ. 1" = 100'		SHEET 5 OF 12 SHEETS

C:\17-020-103\Drawings\Layouts\TRAFFIC CONTROL LAYOUT.dwg Aug 02, 2019-8:17am Edited by: jdelosantos