

PLAT RECORDING SHEET

PLAT NAME: Sienna Plantation Section 25

PLAT NO: _____

ACREAGE: 26.732

LEAGUE: David Fitzgerald League

ABSTRACT NUMBER: 25

NUMBER OF BLOCKS: 3

NUMBER OF LOTS: 77

NUMBER OF RESERVES: 8

OWNERS: TOLL-GTIS Property Owner, LLC and Sienna Plantation Levee

Improvements District

(DEPUTY CLERK)

STATE OF TEXAS
COUNTY OF FORT BEND

WE, TOLL-GTIS PROPERTY OWNER, LLC, A TEXAS LIMITED LIABILITY COMPANY, ACTING BY AND THROUGH JIMMIE F. JENKINS, AUTHORIZED REPRESENTATIVE, OF TOLL-GTIS PROPERTY OWNER LLC, A TEXAS LIMITED LIABILITY COMPANY, AND WE, SIENNA PLANTATION LEVEE IMPROVEMENT DISTRICT OF FORT BEND COUNTY, TEXAS, ACTING BY AND THROUGH KEN BECKMAN, PRESIDENT BEING AN OFFICER OF SIENNA PLANTATION LEVEE IMPROVEMENT DISTRICT OF FORT BEND COUNTY, TEXAS, OWNERS OF THE 26.732 ACRE TRACT DESCRIBED IN THE ABOVE AND FOREGOING PLAT OF SIENNA PLANTATION SECTION 25, DO HEREBY MAKE AND ESTABLISH SAID SUBDIVISION PLAT OF SAID PROPERTY ACCORDING TO ALL LINES, DEDICATIONS, RESTRICTIONS AND NOTATIONS ON SAID PLAT AND HEREBY DEDICATE TO THE USE OF THE PUBLIC FOREVER, ALL STREETS, ALLEYS, PARKS, WATER COURSES, DRAINS, EASEMENTS AND PUBLIC PLACES SHOWN THEREON FOR THE PURPOSES AND CONSIDERATIONS THEREIN EXPRESSED, AND DO HEREBY BIND OURSELVES, OUR HEIRS AND ASSIGNS TO WARRANT AND FOREVER DEFEND THE TITLE TO THE LAND SO DEDICATED.

WE, FURTHER ACKNOWLEDGE THAT THE DEDICATIONS AND/OR EXACTIONS MADE HEREIN ARE PROPORTIONAL TO THE IMPACT OF THE SUBDIVISION UPON THE PUBLIC SERVICES REQUIRED IN ORDER THAT THE DEVELOPMENT WILL COMPORT WITH THE PRESENT AND FUTURE GROWTH NEEDS OF THE CITY, WE, OUR SUCCESSORS AND ASSIGNEES HEREBY WAIVE ANY CLAIM, DAMAGE OR CAUSE OF ACTION THAT WE MAY HAVE AS A RESULT OF THE DEDICATION OR EXACTIONS MADE HEREIN.

FURTHER, OWNERS HAVE DEDICATED AND BY THESE PRESENTS DO DEDICATE TO THE USE OF THE PUBLIC FOR PUBLIC UTILITY PURPOSES FOREVER UNOBSTRUCTED AERIAL EASEMENTS, THE AERIAL EASEMENTS SHALL EXTEND HORIZONTALLY AN ADDITIONAL ELEVEN FEET, SIX INCHES (11'6") FOR TEN FEET (10'0") PERIMETER GROUND EASEMENTS OR SEVEN FEET, SIX INCHES (7'6") FOR FOURTEEN FEET (14'0") PERIMETER GROUND EASEMENTS OR FIVE FEET, SIX INCHES (5'6") FOR SIXTEEN FEET (16'0") PERIMETER GROUND EASEMENTS, FROM A PLANE SIXTEEN FEET (16'0") ABOVE GROUND LEVEL UPWARD, LOCATED ADJACENT TO AND ADJOINING SAID PUBLIC UTILITY EASEMENTS THAT ARE DESIGNATED WITH AERIAL EASEMENTS (U.E. AND A.E.) AS BACK-TO-BACK GROUND EASEMENTS, FROM A PLANE SIXTEEN FEET (16'0") ABOVE GROUND LEVEL UPWARD, LOCATED ADJACENT TO AND ADJOINING SAID PUBLIC UTILITY EASEMENTS THAT ARE DESIGNATED WITH AERIAL EASEMENTS (U.E. AND A.E.) AS INDICATED AND DEPICTED HEREON, WHEREBY THE AERIAL EASEMENT TOTALS THIRTY ONE FEET, SIX INCHES (21' 6") IN WIDTH.

FURTHER, OWNERS HAVE DEDICATED AND BY THESE PRESENTS DO DEDICATE TO THE USE OF THE PUBLIC FOR PUBLIC UTILITY PURPOSES FOREVER UNOBSTRUCTED AERIAL EASEMENTS, THE AERIAL EASEMENTS SHALL EXTEND HORIZONTALLY AN ADDITIONAL TEN FEET (10'0") FOR TEN FEET (10'0") BACK-TO-BACK GROUND EASEMENTS, OR EIGHT FEET (8'0") FOR FOURTEEN FEET (14'0") BACK-TO-BACK GROUND EASEMENTS OR SEVEN FEET (7'0") FOR SIXTEEN FEET (16'0") BACK-TO-BACK GROUND EASEMENTS, FROM A PLANE SIXTEEN FEET (16'0") ABOVE GROUND LEVEL UPWARD, LOCATED ADJACENT TO BOTH SIDES AND ADJOINING SAID PUBLIC UTILITY EASEMENTS THAT ARE DESIGNATED WITH AERIAL EASEMENTS (U.E. AND A.E.) AS INDICATED AND DEPICTED HEREON, WHEREBY THE AERIAL EASEMENT TOTALS THIRTY FEET (30'0") IN WIDTH.

FURTHER, WE DO HEREBY DECLARE THAT ALL PARCELS OF LAND DESIGNATED AS LOTS ON THIS PLAT ARE INTENDED FOR THE CONSTRUCTION OF SINGLE FAMILY RESIDENTIAL DWELLING UNITS THEREON AND SHALL BE RESTRICTED FOR SAME UNDER THE TERMS AND CONDITIONS OF SUCH RESTRICTIONS FILED SEPARATELY.

FURTHER, WE DO HEREBY COVENANT AND AGREE THAT ALL OF THE PROPERTY WITHIN THE BOUNDARIES OF THIS PLAT SHALL BE RESTRICTED TO PREVENT THE DRAINAGE OF ANY SEPTIC TANKS INTO ANY PUBLIC OR PRIVATE STREET, ROAD OR ALLEY OR ANY DRAINAGE DITCH, EITHER DIRECTLY OR INDIRECTLY.

FURTHER, WE DO HEREBY DEDICATE TO THE PUBLIC A STRIP OF LAND THIRTY (30) FEET WIDE ON EACH SIDE OF THE CENTER LINE OF ANY AND ALL BAYOUS, CREEKS, GULLIES, RAVINES, DRAWS AND DRAINAGE DITCHES LOCATED IN SAID SUBDIVISION, AS EASEMENTS FOR DRAINAGE PURPOSES. FORT BEND COUNTY OR ANY OTHER GOVERNMENTAL AGENCY SHALL HAVE THE RIGHT TO ENTER UPON SAID EASEMENT AT ANY AND ALL TIMES FOR THE PURPOSES OF CONSTRUCTION AND MAINTENANCE OF DRAINAGE FACILITIES AND STRUCTURES.

FURTHER, WE DO HEREBY COVENANT AND AGREE THAT ALL OF THE PROPERTY WITHIN THE BOUNDARIES OF THIS SUBDIVISION AND ADJACENT TO ANY DRAINAGE EASEMENT, DITCH, GULLY, CREEK OR NATURAL DRAINAGE WAY SHALL HEREBY BE RESTRICTED TO KEEP SUCH DRAINAGE WAYS AND EASEMENTS CLEAR OF FENCES, BUILDINGS, EXCESSIVE VEGETATION AND OTHER OBSTRUCTIONS TO THE OPERATIONS AND MAINTENANCE OF THE DRAINAGE FACILITY AND THAT SUCH ADJUTING PROPERTY SHALL NOT BE PERMITTED TO DRAIN DIRECTLY INTO THIS EASEMENT EXCEPT BY MEANS OF AN APPROVED DRAINAGE STRUCTURE.

FURTHER, WE DO HEREBY CERTIFY THAT WE ARE THE OWNERS OF ALL PROPERTY IMMEDIATELY ADJACENT TO THE BOUNDARIES OF THE ABOVE AND FOREGOING SUBDIVISION OF SIENNA PLANTATION SECTION 25 WHERE BUILDING SETBACK LINES OR PUBLIC UTILITY EASEMENTS ARE TO BE ESTABLISHED OUTSIDE THE BOUNDARIES OF THE ABOVE AND FOREGOING SUBDIVISION AND DO HEREBY MAKE AND ESTABLISH ALL BUILDING SETBACK LINES AND DEDICATE TO THE USE OF THE PUBLIC, ALL PUBLIC UTILITY EASEMENTS SHOWN IN SAID ADJACENT ACREAGE.

FURTHER, WE DO HEREBY ACKNOWLEDGE THE RECEIPT OF THE "ORDERS FOR REGULATION OF OUTDOOR LIGHTING IN THE UNINCORPORATED AREAS OF FORT BEND COUNTY, TEXAS," AND DO HEREBY COVENANT AND AGREE AND SHALL COMPLY WITH THIS ORDER AS ADOPTED BY FORT BEND COUNTY COMMISSIONERS' COURT ON MARCH 23, 2004 AND ANY SUBSEQUENT AMENDMENT.

IN TESTIMONY WHEREOF, TOLL-GTIS PROPERTY OWNER, LLC, A TEXAS LIMITED LIABILITY COMPANY, HAS CAUSED THESE PRESENTS TO BE SIGNED BY JIMMIE F. JENKINS, ITS AUTHORIZED REPRESENTATIVE, THEREUNTO AUTHORIZED.

THIS 31st DAY OF July, 2019.

TOLL-GTIS PROPERTY OWNER LLC
A TEXAS LIMITED LIABILITY COMPANY

BY: *Jimmie F. Jenkins*
JIMMIE F. JENKINS, AUTHORIZED REPRESENTATIVE

STATE OF TEXAS
COUNTY OF HARRIS

BEFORE ME, THE UNDERSIGNED AUTHORITY, ON THIS DAY PERSONALLY APPEARED JIMMIE F. JENKINS, AUTHORIZED REPRESENTATIVE OF TOLL-GTIS PROPERTY OWNER LLC, A TEXAS LIMITED LIABILITY COMPANY, KNOWN TO ME TO BE THE PERSON WHOSE NAME IS SUBSCRIBED TO THE FOREGOING INSTRUMENT AND ACKNOWLEDGED TO ME THAT HE EXECUTED THE SAME FOR THE PURPOSES AND CONSIDERATIONS THEREIN EXPRESSED AND IN THE CAPACITY THEREIN AND HEREIN SET OUT.

GIVEN UNDER MY HAND AND SEAL OF OFFICE,
THIS 21st DAY OF July, 2019.

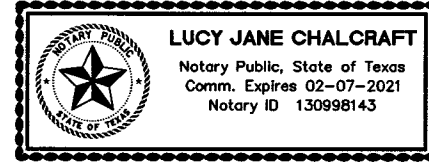

Lucy Jane Chalcraft
NOTARY PUBLIC IN AND FOR THE STATE OF TEXAS

IN TESTIMONY WHEREOF, SIENNA PLANTATION LEVEE IMPROVEMENT DISTRICT OF FORT BEND COUNTY, TEXAS, HAS CAUSED THESE PRESENTS TO BE SIGNED BY KEN BECKMAN, ITS PRESIDENT, THEREUNTO AUTHORIZED.

THIS 5th DAY OF August, 2019.

SIENNA PLANTATION LEVEE IMPROVEMENT DISTRICT
OF FORT BEND COUNTY, TEXAS

BY: *Ken Beckman*
KEN BECKMAN, PRESIDENT

STATE OF TEXAS
COUNTY OF HARRIS

BEFORE ME, THE UNDERSIGNED AUTHORITY, ON THIS DAY PERSONALLY APPEARED KEN BECKMAN, PRESIDENT OF SIENNA PLANTATION LEVEE IMPROVEMENT DISTRICT OF FORT BEND COUNTY, TEXAS, KNOWN TO ME TO BE THE PERSON WHOSE NAME IS SUBSCRIBED TO THE FOREGOING INSTRUMENT AND ACKNOWLEDGED TO ME THAT HE EXECUTED THE SAME FOR THE PURPOSES AND CONSIDERATIONS THEREIN EXPRESSED AND IN THE CAPACITY THEREIN AND HEREIN SET OUT.

GIVEN UNDER MY HAND AND SEAL OF OFFICE,
THIS 5th DAY OF August, 2019.



Marie Ezure
NOTARY PUBLIC IN AND FOR THE STATE OF TEXAS

I, AMANDA CARRIAGE, A PROFESSIONAL ENGINEER REGISTERED IN THE STATE OF TEXAS DO HEREBY CERTIFY THAT THIS PLAT MEETS ALL REQUIREMENTS OF FORT BEND COUNTY TO THE BEST OF MY KNOWLEDGE.

Amanda Carriage
AMANDA CARRIAGE, P.E.
LICENSED PROFESSIONAL ENGINEER
TEXAS LICENSE NO. 105912



I, JON P. BORDOVSKY, A REGISTERED PROFESSIONAL LAND SURVEYOR, AM AUTHORIZED UNDER THE LAWS OF THE STATE OF TEXAS TO PRACTICE THE PROFESSION OF LAND SURVEYING AND HEREBY CERTIFY THAT THE ABOVE SUBDIVISION IS TRUE AND CORRECT WAS PREPARED FROM AN ACTUAL SURVEY OF THE PROPERTY MADE UNDER MY SUPERVISION ON THE GROUND AND THAT ALL BOUNDARY CORNERS, ANGLES, POINTS OF CURVATURE AND OTHER POINTS OF REFERENCE HAVE BEEN MARKED WITH IRON (OR OTHER SUITABLE PERMANENT METAL) PIPES OR RODS HAVING AN OUTSIDE DIAMETER OF NOT LESS THAN FIVE-EIGHTHS (5/8) INCH WITH PLASTIC CAP MARKED "GBI PARTNERS" AND A LENGTH OF NOT LESS THAN THREE (3) FEET (SEE NOTE 9).

JON P. BORDOVSKY, R.P.L.S.
REGISTERED PROFESSIONAL LAND SURVEYOR
TEXAS REGISTRATION NO. 6405

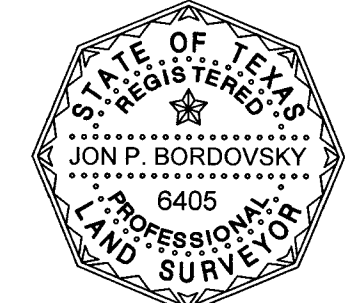

STATE OF TEXAS
COUNTY OF FORT BEND

THIS IS TO CERTIFY THAT THE PLANNING AND ZONING COMMISSION OF THE CITY OF MISSOURI CITY, TEXAS, HAS APPROVED THIS PLAT AND SUBDIVISION OF SIENNA PLANTATION SECTION 25 IN CONFORMANCE WITH THE LAWS OF THE STATE OF TEXAS AND THE ORDINANCES OF THE CITY OF MISSOURI CITY AS SHOWN HEREON AND AUTHORIZED THE RECORDING OF THIS PLAT

THIS 14th DAY OF August, 2019.

Sonya Brown-Marshall
SONYA BROWN-MARSHALL, CHAIRMAN

Timothy R. Haney
TIMOTHY R. HANEY, VICE CHAIRMAN

NOTES:

- BENCHMARK: FOUND 4 INCH BRASS DISC LOCATED IN A POURED CONCRETE POST IN THE GRASSY AREA IN FRONT OF MISSOURI CITY FIRE STATION NUMBER 5 16.5 FEET FROM THE SIDE WALK. SURVEY MARKER NO. PCM-011 ELEV. = 59.97 (NAVD88 2001 ADJUSTMENT)
- T.B.M. INDICATES TEMPORARY BENCHMARK FND. 5/8 INCH IRON ROD WITH CAP MARKED "GBI PARTNERS" ELEV. = 58.81 2001 ADJUSTMENT
- ALL BEARINGS REFERENCED TO THE TEXAS COORDINATE SYSTEM, SOUTH CENTRAL ZONE (NAD83). COORDINATES SHOWN ARE SURFACE AND MAY BE CONVERTED TO GRID BY MULTIPLYING BY A FACTOR OF 0.999867651
- THIS PLAT WAS PREPARED TO MEET CITY OF MISSOURI CITY AND FORT BEND COUNTY REQUIREMENTS.
- THIS PLAT WAS PREPARED FROM INFORMATION FURNISHED BY STEWART TITLE COMPANY, FILE NO. 375372 DATED MAY 9, 2019 THE SURVEYOR HAS NOT ABSTRACTED THE ABOVE PROPERTY.
- THIS PLAT LIES WHOLLY WITHIN SIENNA PLANTATION MUNICIPAL UTILITY DISTRICT NO. 4, SIENNA PLANTATION LEVEE IMPROVEMENT DISTRICT, FORT BEND SUBSIDENSE DISTRICT, FORT BEND COUNTY DRAINAGE DISTRICT, THE ETJ OF THE CITY OF MISSOURI CITY AND FORT BEND COUNTY.
- BY GRAPHICAL PLOTTING THE SUBJECT TRACT LIES WITHIN ZONE "X" (SHADED ON THE FIRM MAP), ZONE "X" (SHADED) IS DEFINED AS "AREAS OF 0.2% ANNUAL CHANCE FLOOD; AREA OF 1% ANNUAL CHANCE FLOOD WITH AVERAGE DEPTHS OF LESS THAN 1 FOOT OR WITH DRAINAGE AREAS LESS THAN 1 SQUARE MILE; AND AREAS PROTECTED BY LEVEES FROM 1% ANNUAL CHANCE FLOOD." NOTE: 1" READS AS FOLLOWS: "THIS AREA IS SHOWN AS BEING PROTECTED FROM THE 1-PERCENT-ANNUAL-CHANCE OR GREATER FLOOD HAZARD BY LEVEE SYSTEM. OVERTOPPING OR FAILURE OF ANY LEVEE SYSTEM IS POSSIBLE." AS SHOWN ON FEDERAL EMERGENCY MANAGEMENT AGENCY FLOOD INSURANCE RATE MAP, MAP NUMBER 48157C 045SL, MAP REVISED APRIL 2, 2014. "LJA DOES NOT WARRANT NOR SUBSCRIBE TO THE ACCURACY OR SCALE OF SAID MAPS".
- THERE ARE NO PIPELINES OR PIPELINE EASEMENTS WITHIN THIS SUBDIVISION.
- FIVE-EIGHTHS (5/8) INCH IRON RODS WITH PLASTIC CAP MARKED "GBI PARTNERS" AND THREE (3) FEET IN LENGTH WILL BE SET ON ALL PERIMETER BOUNDARY CORNERS, UNLESS OTHERWISE NOTED. BLOCK CORNERS AND/OR STREET RIGHT-OF-WAYS HAVE NOT BEEN MONUMENTED.
- THE MINIMUM SLAB ELEVATION SHALL BE ELEVATED TO OR ABOVE A HEIGHT WHICH IS HIGHER OF EIGHTEEN (18) INCH ABOVE HIGHEST FINISHED FLOOR OR TWO FEET ABOVE THE MAXIMUM ONE PERCENT ANNUAL FLOOD RISK FLOODPLAIN PONDING ELEVATION IN THE NEAREST DRAINAGE SYSTEM AS PER SECTION 42 - ARTICLE III OF THE MISSOURI CITY CODE OF ORDINANCES. THE TOP OF ALL FLOOR SLABS FOR LOTS 1-6 OF BLOCK 1 SHALL BE A MINIMUM OF 58.15 (2001 ADJ.) AND THE TOP OF ALL FLOOR SLABS FOR LOTS 1-11, 51, AND 52 OF BLOCK 2 AND LOTS 1-4 AND 17-19 OF BLOCK 3 SHALL BE A MINIMUM OF 56.85 (2001 ADJ.) AND THE TOP OF ALL OTHER LOTS SHALL BE MINIMUM OF 56.50 (2001 ADJ.) ABOVE MEAN SEA LEVEL. THE TOP OF SLAB ELEVATION AT ANY POINT ON THE PERIMETER OF THE SLAB SHALL NOT BE LESS THAN 18 INCHES ABOVE NATURAL GROUND. ALL SLAB ELEVATIONS SHALL BE ONE FOOT ABOVE THE 100-YEAR FLOOD ELEVATION AS ESTABLISHED BY FEMA AS PER SECTION 82-97(11).
- THE DRAINAGE SYSTEM FOR THIS SUBDIVISION SHALL BE DESIGNED TO MEET THE REQUIREMENTS OF THE FORT BEND COUNTY DRAINAGE CRITERIA MANUAL WHICH ALLOWS STREET PONDING DURING INTENSE RAINFALL EVENTS.
- ALL DRAINAGE AND FLOODWAY EASEMENTS SHALL BE KEPT CLEAR OF FENCES, BUILDINGS, PLANTINGS, AND OTHER OBSTRUCTIONS TO THE OPERATIONS AND MAINTENANCE OF THE DRAINAGE FACILITY AS REQUIRED BY SUBSECTION 82-168(D) OF THE CODE OF ORDINANCES OF THE CITY OF MISSOURI CITY, TEXAS.
- ALL PROPERTY TO DRAIN INTO THE DRAINAGE EASEMENT ONLY THROUGH AN APPROVED DRAINAGE STRUCTURE.
- ALL LOT LINES SHALL HAVE A MINIMUM FIVE (5) FOOT SIDE YARD SETBACK.
- A MINIMUM DISTANCE OF 10' SHALL BE MAINTAINED BETWEEN RESIDENTIAL DWELLINGS.
- THE CITY OF MISSOURI CITY SHALL NOT BE RESPONSIBLE FOR MAINTENANCE OF DRIVEWAYS, SIDEWALKS, EMERGENCY ACCESS EASEMENTS, RECREATIONAL AREAS, OPEN SPACE AND RESERVES.
- SIDEWALK SHALL BE BUILT OR CAUSED TO BE BUILT NOT LESS THAN 5-FEET IN WIDTH ON BOTH SIDES OF ALL DEDICATED RIGHTS-OF-WAY WITHIN SAID PLAT AND ON CONTIGUOUS RIGHT-OF-WAY OF ALL PERIMETER ROADS SURROUNDING SAID PLAT, IN ACCORDANCE WITH ADA REQUIREMENTS.
- SIDEWALKS SHALL BE BUILT AS REQUIRED BY SECTION 82-164 OR THE CODE OF ORDINANCES OF THE CITY OF MISSOURI CITY, TEXAS.
- DRIVEWAY APPROACHES SHALL BE PROVIDED IN ACCORDANCE WITH THE MISSOURI CITY DRIVEWAY APPROACH POLICY AS REQUIRED UNDER THE PROVISIONS OF SUBSECTION 82-160 OF THE CODE OF ORDINANCES OF THE CITY OF MISSOURI CITY, TEXAS.
- DRIVEWAY LOCATION - FOR THE LOTS ON THE INSIDE OF A KNUCKLE OR 90 DEGREE TURN, DRIVEWAY MUST BE PLACED ON THE LOT FRONTAGE ALONG THE INSIDE APPROACH LANE PRIOR TO THE RIGHT TURN, TO AVOID SIGHT OBSTRUCTION SAFETY HAZARDS.
- ALL REQUIRED UTILITY COMPANIES HAVE BEEN CONTACTED AND ALL PUBLIC UTILITY EASEMENTS AS SHOWN ON THE ABOVE AND FOREGOING PLAT CONSTITUTE ALL OF THE EASEMENTS REQUIRED BY THE UTILITY COMPANIES CONTACTED AT THE TIME OF PLATTING.
- GAS METER LOCATION: GAS METERS SHALL BE LOCATED IN AN AREA ACCESSIBLE WITHOUT CUSTOMER ASSISTANCE, AND NOT BLOCKED BY FENCES, WALLS OR GATES. FOR FURTHER INFORMATION PLEASE CONTACT SIENERGY AT 281-778-6250.
- ALL OF THE PROPERTY SUBDIVIDED IN THE ABOVE AND FOREGOING PLAT IS WITHIN THE ETJ BOUNDARIES OF THE CITY OF MISSOURI CITY, TEXAS.
- NO BUILDING OR OTHER PERMIT, EXCEPT PERMITS FOR CONSTRUCTION OF PUBLIC IMPROVEMENTS WILL BE ISSUED BY THE CITY OF MISSOURI CITY, TEXAS, FOR CONSTRUCTION WITHIN THIS SUBDIVISION UNTIL SUCH TIME AS SUCH IMPROVEMENTS OF THE SUBDIVISION HAVE BEEN CONSTRUCTED BY THE DEVELOPER AND ACCEPTED BY THE CITY OR THE GUARANTEE OF CONSTRUCTION OF PUBLIC IMPROVEMENTS REQUIRED BY SECTION 82-206 OF THE CODE OF ORDINANCES OF THE CITY OF MISSOURI CITY, TEXAS, IS SUBMITTED TO AND APPROVED BY THE CITY.
- PRIOR TO THE BEGINNING OF THE ONE-YEAR MAINTENANCE PERIOD FOR UTILITIES AND PAVING BY FORT BEND COUNTY, ALL BLOCK CORNERS AND STREET RIGHT-OF-WAY WILL BE MONUMENTED.
- ADEQUATE FIRE FLOWS SHALL BE PROVIDED ALONG THE ENTIRE LENGTH OF THE PROPOSED WATER LINE.
- REQUIRED FIRE FLOWS SHALL BE PROVIDED BASED ON THE SIZE AND CONSTRUCTION OF ALL BUILDINGS AS REQUIRED BY THE INTERNATIONAL FIRE CODE AS ADOPTED BY THE CITY.
- THE PLACEMENT OF FIRE HYDRANTS SHALL BE PROVIDED BASED ON THE MINIMUM DISTANCE REQUIREMENTS AS ESTABLISHED IN THE INTERNATIONAL FIRE CODE AS ADOPTED BY THE CITY (300FT. FOR RESIDENTIAL DEVELOPMENT AND 300FT. FOR COMMERCIAL DEVELOPMENT). ALL FIRE HYDRANTS SHALL BE INSTALLED ACCORDING TO THE INTERNATIONAL FIRE CODE AS ADOPTED BY THE CITY.
- STREET LIGHTING SHALL BE DESIGNED AND INSTALLED IN ACCORDANCE WITH THE CITY OF MISSOURI CITY INFRASTRUCTURE DESIGN MANUAL, CHAPTER 4 STREET LIGHTING AND OVERHEAD UTILITIES. THE INSTALLATION, OPERATION, AND MAINTENANCE OF ORNAMENTAL STREET LIGHTS SHALL NOT BE THE RESPONSIBILITY OF THE CITY OF MISSOURI CITY, EXCEPT AS PROVIDED THEREIN.
- OWNERSHIP AND MAINTENANCE RESPONSIBILITY OF THE DRAINAGE RESERVES AND CHANNELS IS VESTED IN THE SIENNA PLANTATION LEVEE IMPROVEMENT DISTRICT. THE OWNERSHIP AND MAINTENANCE RESPONSIBILITY OF LANDSCAPE RESERVES IS VESTED IN THE SIENNA PLANTATION MUNICIPAL UTILITY DISTRICT NO. 5.
- OWNERSHIP AND MAINTENANCE RESPONSIBILITY OF THE UTILITIES WITHIN THE SECTIONS IS VESTED IN SIENNA PLANTATION MUNICIPAL UTILITY DISTRICT NO. 4. THE OWNERSHIP AND MAINTENANCE RESPONSIBILITY OF THE UTILITIES ALONG BOULEVARDS AND MAJOR THOROUGHFARES IS VESTED IN THE SIENNA PLANTATION MUNICIPAL UTILITY DISTRICT NO. 5.
- IN ACCORDANCE WITH CENTERPOINT ENERGY ELECTRICAL SERVICE MANUAL, ARTICLE 421.2, ELECTRIC METERS SHALL BE LOCATED IN A POSITION THAT IS ACCESSIBLE AT ALL TIMES WITHOUT CUSTOMER ASSISTANCE. ACCESS TO THE METER SHALL NOT BE BLOCKED BY GATES, WALLS OR FENCES.
- THE TEMPORARY DRAINAGE EASEMENT AND RIGHT-OF-WAY SHALL EXPIRE AND TERMINATE AT SUCH TIME AS OTHER DRAINAGE IMPROVEMENTS HAVE BEEN CONSTRUCTED WITHIN PERMANENT EASEMENTS OR RIGHT-OF-WAY AS SUCH IMPROVEMENTS AS TO PROVIDE SUCH ALTERNATE ROUTE OF DRAINAGE OF STORM WATER FLOWING FROM PORTIONS OF SIENNA PLANTATION. AT SUCH TIME AS SUCH ALTERNATE DRAINAGE ROUTE IS PROVIDED AND CONSTRUCTED, THE TEMPORARY EASEMENT AND RIGHT-OF-WAY SHALL AUTOMATICALLY CEASE, AND TERMINATE AS PER DEED RECORDED IN VOLUME 0277, PAGES 216-232, FOR FORT BEND COUNTY DEED RECORDS. THE ABOVE REFERENCED EASEMENT WILL DISSOLVE ONCE THE PLAT IS RECORDED.

- THIS PLAT IS SUBORDINATED BY: ALYSSA PRATKA, VICE PRESIDENT, U.S. BANK NATIONAL ASSOCIATION D/B/A HOUSING CAPITAL COMPANY, AS RECORDED IN FILE NO. _____ OF THE OFFICIAL RECORDS OF FORT BEND COUNTY, TEXAS.
- THIS PLAT LIES WITHIN LIGHTING ZONE 2.
- THIS PLAT IS SUBJECT TO VARIOUS BLANKET EASEMENTS AS SET FORTH BY THE RESTRICTIVE COVENANTS RECORDED UNDER F.N. 2015009259, F.B.C.O.R.
- U.V.E. INDICATES UNOBSTRUCTED VIEW EASEMENT. FORT BEND COUNTY SHALL BE RESPONSIBLE FOR ENFORCING U.V.E. REQUIREMENTS WITHIN THE PUBLIC RIGHT-OF-WAY AND SIENNA PLANTATION COMMUNITY ASSOCIATION, INC. SHALL ENFORCE AREAS OUTSIDE OF RIGHT-OF-WAY.
- SITE PLANS SHALL BE SUBMITTED TO FORT BEND COUNTY AND ANY OTHER APPLICABLE JURISDICTION FOR REVIEW AND APPROVAL. DEVELOPMENT PERMITS AND ALL OTHER APPLICABLE PERMITS SHALL BE OBTAINED FROM FORT BEND COUNTY PRIOR TO BEGINNING CONSTRUCTION.
- ONE-FOOT RESERVE DEDICATED TO THE CITY IN FEE AS A BUFFER SEPARATION BETWEEN THE SIDE OR END OF STREETS WHERE SUCH STREETS ABUT ADJACENT ACREAGE TRACTS, THE CONDITION OF SUCH DEDICATION BEING THAT WHEN THE ADJACENT PROPERTY IS SUBDIVIDED PURSUANT TO A RECORDED PLAT, THE ONE-FOOT RESERVE SHALL THEREUPON BECOME VESTED IN THE PUBLIC FOR STREET RIGHT-OF-WAY PURPOSES AND THE FEE TITLE THERETO SHALL REVERT TO AND REVEST IN THE DEDICATOR, HIS HEIRS, ASSIGNS OR SUCCESSORS.

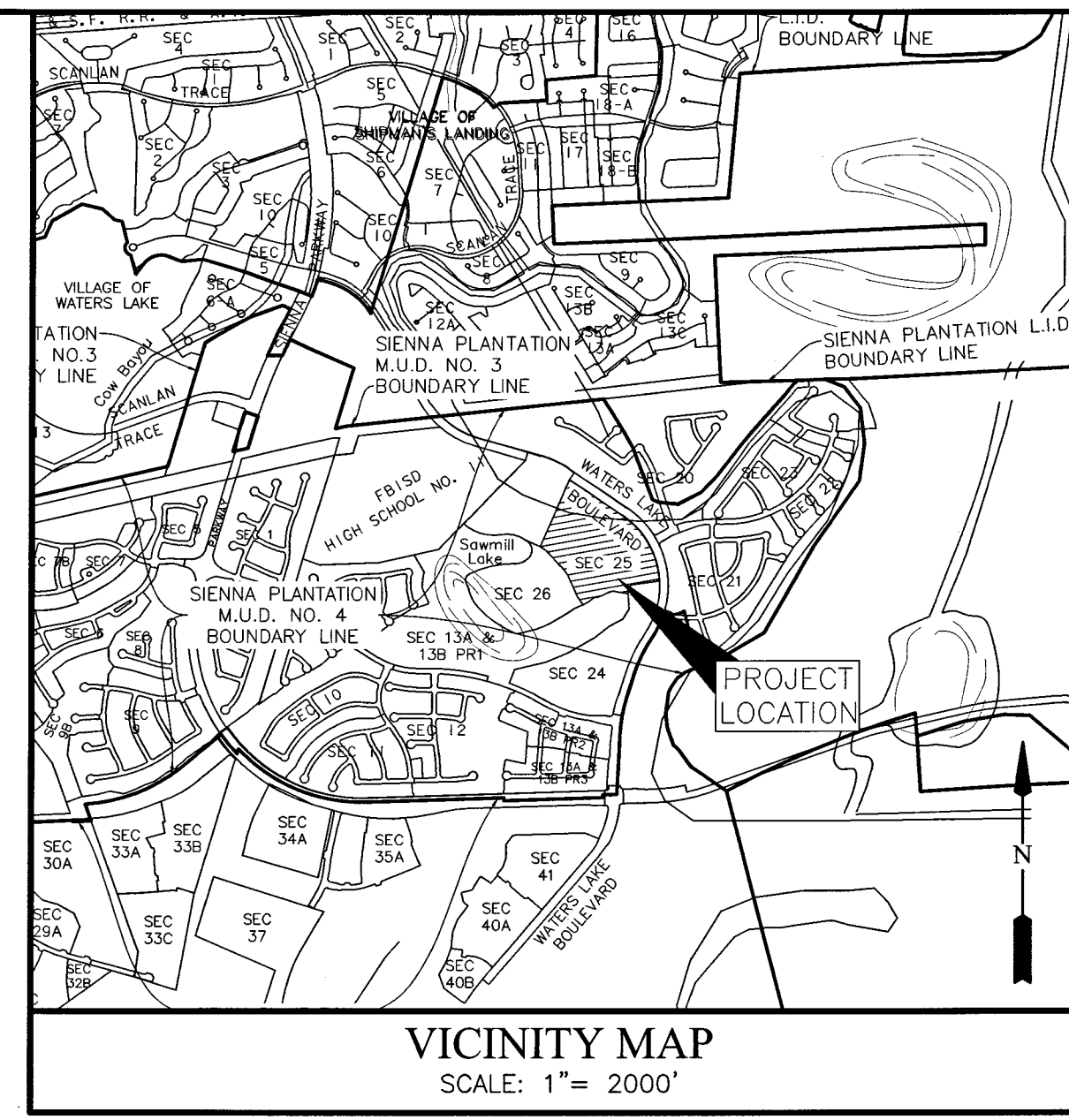

I, J. STACY SLAWINSKI, FORT BEND COUNTY ENGINEER, DO HEREBY CERTIFY THAT THE PLAT OF THIS SUBDIVISION COMPLIES WITH ALL OF THE EXISTING RULES AND REGULATIONS OF THIS OFFICE AS ADOPTED BY THE FORT BEND COUNTY COMMISSIONERS' COURT. HOWEVER, NO CERTIFICATION IS HEREBY GIVEN AS TO THE EFFECT OF DRAINAGE FROM THIS SUBDIVISION ON THE INTERCEPTING DRAINAGE ARTERY OR PARENT STREAM OR ON ANY OTHER AREA OR SUBDIVISION WITHIN THE WATERSHED.

J. STACY SLAWINSKI, P.E.
FORT BEND COUNTY ENGINEER

APPROVED BY THE COMMISSIONERS' COURT OF FORT BEND COUNTY, TEXAS,
THIS _____ DAY OF _____, 2019.

VINCENT M. MORALES, JR. PRECINCT 1, COUNTY COMMISSIONER
GRADY PRESTAGE PRECINCT 2, COUNTY COMMISSIONER

KP GEORGE COUNTY JUDGE

W.A. (ANDY) MEYERS PRECINCT 3, COUNTY COMMISSIONER
KEN R. DEMERCHANT PRECINCT 4, COUNTY COMMISSIONER

I, LAURA RICHARD, COUNTY CLERK IN AND FOR FORT BEND COUNTY, HEREBY CERTIFY THAT THE FOREGOING INSTRUMENT WITH ITS CERTIFICATE OF AUTHENTICATION WAS FILED FOR RECORDATION IN MY OFFICE ON _____ 2019 AT _____ O'CLOCK _____ M. IN PLAT NUMBER _____ OF THE PLAT RECORDS OF FORT BEND COUNTY, TEXAS.

WITNESS MY HAND AND SEAL OF OFFICE, AT RICHMOND, TEXAS. THE DAY AND DATE LAST ABOVE WRITTEN.

LAURA RICHARD, COUNTY CLERK
FORT BEND COUNTY, TEXAS

BY: _____
DEPUTY

SIENNA PLANTATION SECTION 25

A SUBDIVISION OF 26.732 ACRES OF LAND SITUATED IN THE DAVID FITZGERALD LEAGUE, ABSTRACT 25, FORT BEND COUNTY, TEXAS. BEING A PARTIAL REPLAT OF RESERVE F IN SIENNA PLANTATION SECTION 13A & 13B PARTIAL REPLAT No. 1, A SUBDIVISION RECORDED IN PLAT NO. 20170186, FORT BEND COUNTY OFFICIAL PLAT RECORDS

77 LOTS 8 RESERVES (3.055 ACRES) 3 BLOCKS
JULY 31, 2019 JOB NO. 1414-1525P

TOLL-GTIS PROPERTY OWNER, LLC
JIMMIE F. JENKINS, AUTHORIZED REPRESENTATIVE
10110 WEST SAM HOUSTON PARKWAY NORTH, SUITE 210, HOUSTON, TEXAS 77064
PH. (281) 894-8655

SIENNA PLANTATION LEVEE IMPROVEMENT DISTRICT
OF FORT BEND COUNTY, TEXAS
KEN BECKMAN, PRESIDENT
202 CENTURY SQUARE BLVD., SUGAR LAND, TEXAS 77478-3796
PH. (281) 500-6050

SURVEYORS:
GBI PARTNERS, L.P.
LAND SURVEYING CONSULTANTS
4784 VISTA ROAD - PASADENA, TX 77805
PHONE: 281-498-4039 • CBlawvey@GBIpartners.com
TRIPLE FIRM #110180000 • www.GBIsurvey.com

LJA Engineering, Inc.
1904 W. Grand Parkway North
Suite 100
Katy, Texas 77449
Phone 713.953.5200
Fax 713.953.5026
FRN-F1386

