

STATE OF TEXAS

§

§

COUNTY OF FORT BEND

§

**SECOND AMENDMENT TO AGREEMENT FOR  
PROFESSIONAL ENGINEERING SERVICES  
BENTON ROAD-SEGMENT 1**

**THIS SECOND AMENDMENT**, is made and entered into by and between Fort Bend County (hereinafter "County"), a body corporate and politic under the laws of the State of Texas, and McDonough Engineering Corporation, Inc., (hereinafter "Engineer"), a company authorized to conduct business in the State of Texas.

WHEREAS, the parties executed and accepted that certain Agreement for Professional Engineering Services on May 22, 2018, pursuant to SOQ 14-025 (hereinafter "Agreement"); as amended by document dated April 2, 2019, (hereinafter "Amendment"); and

WHEREAS, the parties desire to further amend the Agreement to include additional services to be provided by Engineer.

**NOW, THEREFORE**, the parties do mutually agree as follows:

1. Services to be rendered under the Agreement shall be amended to include professional engineering services for requested revisions to Benton Road to accommodate for future configuration and buildout, as described in the Proposal dated June 27, 2019, attached hereto as Exhibit A and incorporated herein for purposes.
2. County shall pay Engineer an additional five thousand one hundred fifty-five dollars and no/100 (\$5,155.00), for the additional services to be rendered under this Second Amendment.
3. The Maximum Compensation payable to Engineer for Services to be rendered is hereby increased to an amount not to exceed six hundred eight thousand one hundred three dollars and 60/100 (\$608,103.60), allocated as follows:
  - A. \$472,322.00 under the Agreement
  - B. \$130,626.60 under the Amendment; and
  - C. \$5,155.00 under this Second Amendment.
4. In no case shall the amount paid by County for all Services under the Agreement, the Amendment and this Second Amendment exceed the Maximum Compensation without a written agreement signed by the parties.

Except as provided herein, all terms and conditions of the Agreement, the Amendment and this Second Amendment shall remain unchanged.

IN WITNESS WHEREOF, the parties hereto have signed or have caused their respective names to be signed to multiple counterparts to be effective on the date signed by the final party.

**FORT BEND COUNTY**

**MCDONOUGH ENGINEERING CORPORATION**

\_\_\_\_\_  
KP George, County Judge

  
\_\_\_\_\_  
Ranney McDonough, President

\_\_\_\_\_  
Date

2-9-19  
\_\_\_\_\_  
Date

ATTEST:

\_\_\_\_\_  
Laura Richard, County Clerk

APPROVED:

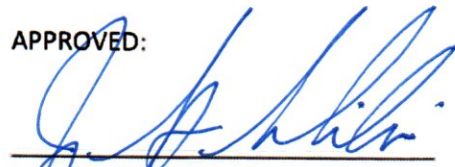
  
\_\_\_\_\_  
J. Stacy Slawinski, P.E.,  
Fort Bend County Engineer

APPROVED AS TO LEGAL FORM:

  
\_\_\_\_\_  
Huma N. Ahmed, Assistant County Attorney

hna I:\AGREEMENTS\2019 Agreements\Engineering\Road Construction\Benton\17110\Second Amendment.docx

**AUDITOR'S CERTIFICATE**

I hereby certify that funds are available in the amount of \$\_\_\_\_\_ to accomplish and pay the obligation of Fort Bend County under this contract.

\_\_\_\_\_  
Robert Ed Sturdivant, County Auditor

# EXHIBIT A



McDONOUGH ENGINEERING CORPORATION  
Civil Engineers

## EXHIBIT "A" SCOPE OF SERVICES

June 27, 2019

Binkley & Barfield, Inc.  
Tommy V. Cromer, P.E.  
1710 Seamist Dr.  
Houston, TX 77008

Attn: Kevin A. Mineo, P.E.

RE: Proposal for Professional Engineering Services- Amendment No. 2  
Benton Road: From FM 762 to 300' South of Reading Road  
Precinct 1  
Fort Bend County  
MEC Project No. 17110

### **PROPOSED SCOPE**

In response to an additional scoping item requested by Fort Bend County, a scope change for the Benton Road project has been prepared.

The requested revision will curve the proposed horizontal alignment of Benton Road to the east, beginning approximately 730 LF south of FM 762 intersection, to accommodate for future configuration and buildout of Benton Road at the intersection.

### **BASIC SERVICES**

1. This revision will require 2 additional parcels for ROW taking, revisions to the previously prepared parcel maps, a drainage easement, and additional survey for the portion of the new alignment which is outside of the limits of the previously collected survey in the original scope and alignment, as further outlined in the attached scope of work from Jones and Carter.

### **Cost Summary**

A level of effort estimate is enclosed in the attached proposal from Jones and Carter based on the scope of work further described therein. The total Lump Sum Fee for Scope Amendment No. 2 is \$5,155.00.



6330 West Loop South, Suite 150  
Bellaire, Texas 77401  
Tel: 713.777.5337  
Fax: 713.777.5976  
[www.jonescarter.com](http://www.jonescarter.com)

June 18, 2019

Mr. Javier Casas, P.E.  
Senior Project Manager  
McDonough Engineering Corp.  
5625 Schumacher  
Houston, TX 77057  
[javierC@mectx.com](mailto:javierC@mectx.com)

Re: Benton Road – Additional Services

Dear Mr. Casas,

Thank you for considering this proposal for Surveying Services on the above referenced project. Our understanding is McDonough Engineering Corp. (MEC) has been contacted by Fort Bend County as part of the 2017 Mobility Bond Program to provide engineering services for the Benton Road project. We also understand Jones & Carter, Inc. (JCI) will contract with MEC to provide additional surveying services. Based on our project understanding we have prepared the following scope of services and fee proposal for your consideration.

Right of entry:

- We will utilize existing right of entry letters already obtained for the subject tracts.

Project Control:

- We will utilize existing horizontal and vertical control previously established for this project.

Topographic Survey:

- Topographic data will be acquired at +/- 100' grid intervals including all grade breaks and major changes, as visible. We will need to do a significant amount of brush cutting to gain access to the area requested.

Proposed Right-of-Way Maps and Parcels:

- We will add this new topographic information into the existing topographic electronic file.



Mr. Javier Casas  
June 18, 2019  
Page 2

Deliverables:

- We will provide a 3-D TIN file of the grade break lines, and an ASCII file of points used for creating the model. Plots of the triangles for QA/QC checks will be provided upon request.

We also understand additional work will be required for revised parcels and drainage easements, per the attached exhibit. Services for the revised parcels and drainage easements are already included within previous Survey authorizations for this project.

These services can be completed for a Lump Sum fee of \$5,155.00. A Level of Effort worksheet is attached. The Topographic Survey can be completed within thirty (30) days upon receipt of your written authorization to proceed.

Again Mr. Casas, thank you for considering this proposal. If these terms are agreeable, please indicate by signing in the space provided below. We look forward to working with you on this project.

Sincerely,

Chris D. Kalkomey  
Registered Professional Land Surveyor  
No. 5869

CDK/mon  
E:\Surveying\proposals\MDE Engineering estimate\_Benton Road\_add topo.docx  
Enclosure

**APPROVED BY:**  
Lump Sum fee of \$5,155.00

\_\_\_\_\_  
Signature of Authorization

\_\_\_\_\_  
Print Name and Title

\_\_\_\_\_  
Date

Jones and Carter, Inc.

Level of Effort for Benton Road Project - Williams Way additional services

11/26/18

Design Phase Surveying Services

Task:	General Description:	Service Description: Hourly Rates:							Lump Sum Fee	Total Hours	Total Cost
		2-Man Field Crew	3-Man Field Crew	Survey Tech 2	Project Surveyor 4	RPLS	CAD Operator 5	Admin IV			
Deed Research	Research deeds & easements of adjoining, roadways, County right of way									N/A	
Deed Plot	Plot deeds, easements and existing rights-of-way										
Right-of-Entry	Letters to land owners per tax rolls										
Control	Establish control based on Texas Coordinate System of 1983, South Central Zone										
Additional Topographic Survey & Boundary Ties	Gather field data Provide plan view in DWG format at 1"=20' scale Provide DTM		20			1	10			31	\$5,155.00
Metes & Bounds and survey for parcels										N/A	
Metes & Bounds and exhibits for easements										N/A	
Total Hours:			20			1	10			31	
Total Cost:			\$4,100.00			\$185.00	\$870.00				\$5,155.00

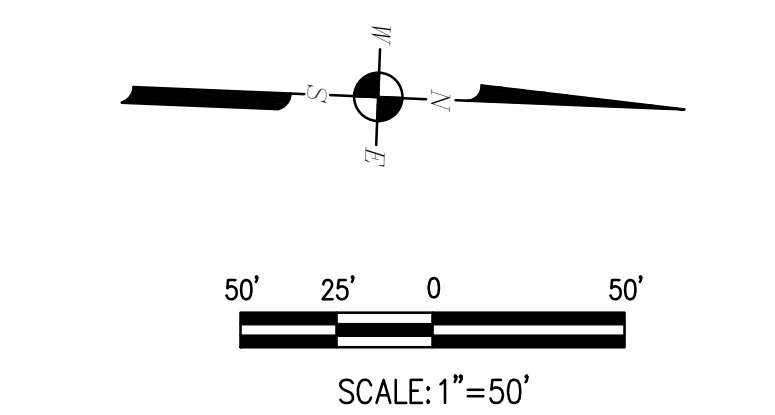


**INTERIM REVIEW ONLY**  
 This document is **INCOMPLETE** and is released for the purpose of **INTERIM REVIEW ONLY**. It is not to be used for **BIDDING, PERMIT** or **CONSTRUCTION**.  
 Engineer: Connor McBride, P.E.  
 License No. 122323  
 TX Firm Registration No. F-000340

  
**McDONOUGH**  
 Civil Engineers ▼ Project Managers  
 TBPLS Registration No. 10103900  
 TBPE Registration No. F-000340  
 5625 Schumacher Lane (713) 975-9990  
 Houston, Texas 77057 www.mectx.com