



Fort Bend County Engineering  
FORT BEND COUNTY, TEXAS

Richard W. Stolleis, P.E.  
County Engineer

March 27, 2019

Commissioner Grady Prestage  
Fort Bend County Precinct 2  
3030 Texas Parkway, Suite 213  
Missouri City, Texas 77459

**RE: Extension of Temporary Road Closure (One Way Traffic Switch) – Ludwig Lane  
(Mobility Project #13208) from Dulles Ave. to Brand Lane**

Dear Commissioner:

We are requesting an extension of temporary road closure of Ludwig Lane from Dulles Ave. to Brand Lane, for conversion to one-way traffic heading eastbound from Dulles Ave. to Brand Lane, pursuant to Section 251.011 of the Texas Transportation Code. Closure dates began August 6, 2018 to April 15, 2019. Due to unanticipated utility conflicts we are requesting the closure be extended to May 30, 2019.

The request will be placed on the April 9, 2019 Commissioners Court agenda. The detour and traffic control plan are attached. Should you have any questions please do not hesitate to call me at 281-633-7508.

Sincerely,

J. Stacy Slawinski, P.E.  
Assistant County Engineer - Projects

Attachment: Detour map

cc: Mr. Brian Conrad, Conrad Construction Co., Ltd. [brianconrad@hotmail.com](mailto:brianconrad@hotmail.com)  
Mr. Epi Salazar, SES Horizon, Inc. [epi.salazar@seshorizon.com](mailto:epi.salazar@seshorizon.com)  
Mr. Jason Kirby, FBC WDID No. 2 [jkirby@fbcwcid2.com](mailto:jkirby@fbcwcid2.com)  
Mr. Tyler Byrd, Centerpoint [tyler.byrd@centerpointenergy.com](mailto:tyler.byrd@centerpointenergy.com)  
Mr. Wesley Crawford, FBC Engineering  
Mr. Brian Fields, FBC Road & Bridge  
Major Chad Norvell, FBC Sheriff's Office [Chad.Norvell@fortbendcountytexas.gov](mailto:Chad.Norvell@fortbendcountytexas.gov)  
File

FOR REDUCED PLANS  
Original scale in inches

PLOTTED ON: 11/19/2017 5:14 PM  
FILE NAME: F:\LUDWIG\CON\PROJECT APPROACH SIGNING.DWG

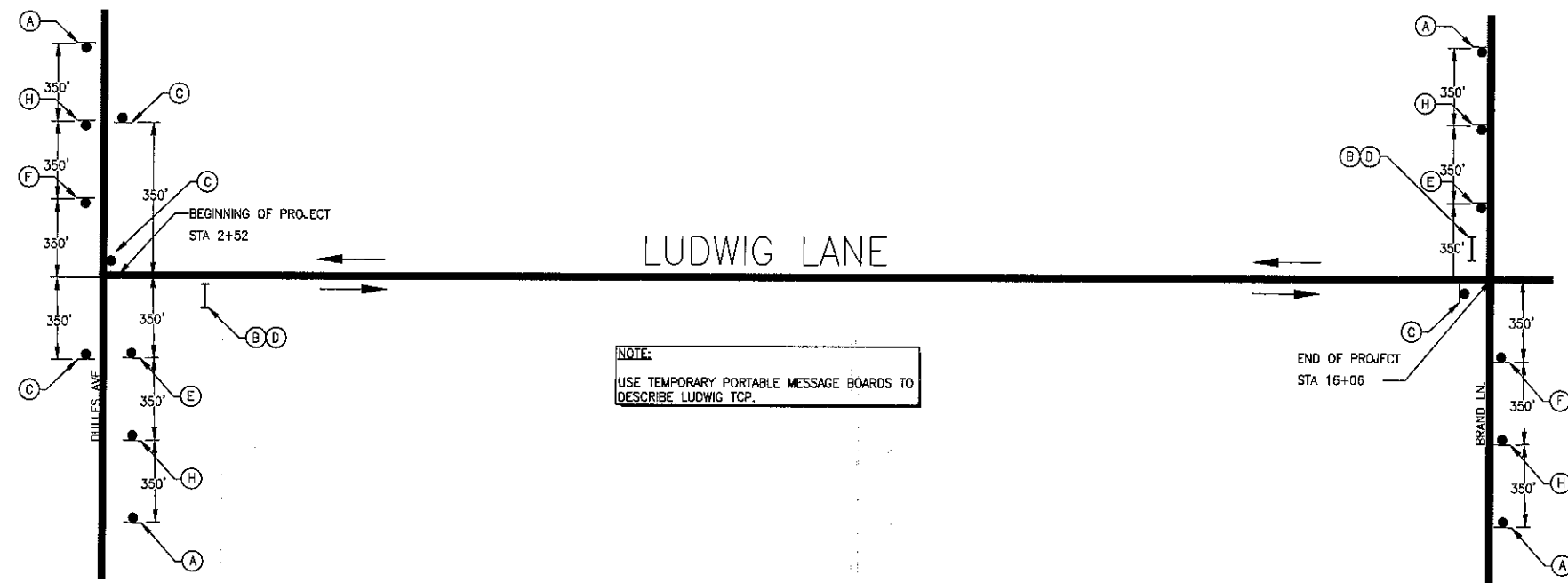

**NOTE:**  
USE TEMPORARY PORTABLE MESSAGE BOARDS TO DESCRIBE LUDWIG TCP.

**SIGNS**

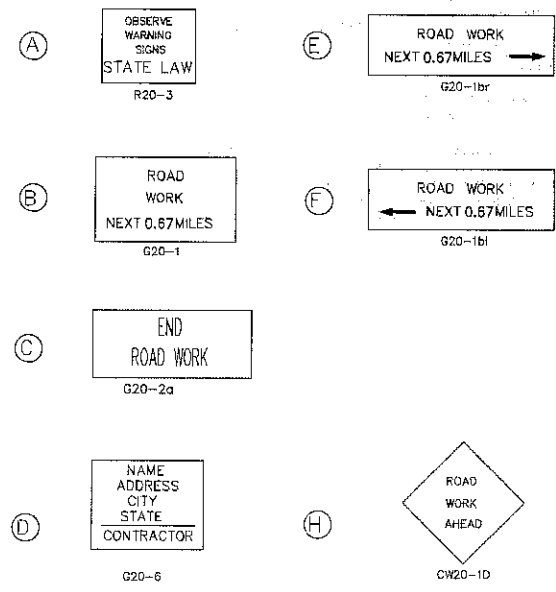

EXISTING POSTED SPEED LIMIT = 30  
CONSTRUCTION ZONE DESIGN SPEED LIMIT = 30

**NOTES**

- ALL ADVANCED WARNING SIGNS TO BE SET PRIOR TO START OF CONSTRUCTION ACTIVITIES AND TO REMAIN IN PLACE UNTIL ALL CONSTRUCTION ACTIVITIES ARE COMPLETE AND ACCEPTED BY FORT BEND COUNTY. THE CONTRACTOR WILL COORDINATE WITH THE FORT BEND COUNTY PUBLIC INFRASTRUCTURE DEPARTMENT, ENGINEERING DIVISION IN ESTABLISHING TRAFFIC ROUTES AND LOCATION OF SIGNS.
- LANE CLOSURES SHALL BE DURING OFF PEAK HOURS ONLY MON-FRI 9AM-3PM (WESTBOUND) MON-FRI 9AM-4PM (EASTBOUND)
- ALL SIGNS MARKED (\*) SHALL HAVE WARNING FLAGS MOUNTED ON TOP OF THE SIGN.
- MAX. PAVEMENT DROP-OFF SHALL NOT EXCEED 2'.
- POLICE SHALL BE NEEDED TO CONTROL TRAFFIC AT ALL MAJOR INTERSECTIONS.
- ALL FLAGGERS SHALL BE IN RADIO CONTACT WITH EACH OTHER AT ALL TIMES.
- ALL PAVEMENT MARKINGS COVERED BY OVERLAY SHALL BE REPLACED BEFORE OPENING TO TRAFFIC
- ADVANCE SIGNING SHALL BE PLACED A MINIMUM OF TWO WEEKS IN ADVANCE TO INFORM OF POSSIBLE DELAY. CONTRACTOR SHALL NOTIFY THE FORT BEND COUNTY ENGINEERING DEPARTMENT AT LEAST TWO WEEKS PRIOR TO ANY CONSTRUCTION.
- ALL PORTABLE SIGNING, DRUMS AND CONES SHALL BE REMOVED AT THE END OF EACH DAY.
- AS OVERLAY IS COMPLETED ALL CHANNELIZATION SHALL BE MOVED ON TO LANE LINES TO OPEN CENTER LEFT TURN LANE TO TRAFFIC.
- IF WORK ZONE IS NEEDED OVERNIGHT ALL CONES OR TUBULAR MARKERS SHALL BE REPLACED WITH DRUMS W/VP'S AND TEMPORARY PAVEMENT MARKINGS SHALL BE IN PLACE FOR NIGHTTIME OPERATION AS DIRECTED BY THE ENGINEER.
- SIGN R20-3 IS REQUIRED IN ADVANCE OF PROJECT LIMITS.
- ACCESS TO EXISTING BUSINESSES OR RESIDENCES SHALL BE MAINTAINED AT ALL TIMES.

**CONSTRUCTION WARNING SIGN SPACING**

Posted Speed or 85% Speed (MPH)	X Min. Distance (feet)
30 or less	120
35	160
40	240
45	320
50	400
55	500
65	750

X-SIGN SPACING  
L-TAPER  
2X-TANGENT

\* 85th Percentile Speed may be used on roads where traffic speeds normally exceed the posted speed limit.  
\*\* Taper lengths have been rounded off.

**LEGEND**

- CONSTRUCTION AREA
- OPEN TO TRAFFIC
- HEAVY WORK VEHICLE
- FLASHING ARROW BOARD (OPTIONAL)
- SIGN POST
- TUBULAR MARKERS, CONES OR DRUMS
- FLAGGER
- X = SIGN SPACING
- L = TAPER LENGTH
- YY DISTANCE TO BE DETERMINED BY ENGINEER.

**TYPICAL TRANSITION LENGTHS AND SUGGESTED MAXIMUM SPACING OF DEVICES**

Posted Speed	Formula	Minimum Desirable Taper Lengths			Suggested Maximum Spacing of Device	
		10' Offset	11' Offset	12' Offset	On a Taper	On a Tangent
30	L = WS <sup>2</sup> /60	150'	165'	180'	30'	60'-75'
35		205'	225'	245'	35'	70'-90'
40	L = WS	265'	295'	320'	40'	80'-100'
45		450'	495'	540'	45'	90'-110'
50		500'	550'	600'	50'	100'-125'
55		550'	605'	660'	55'	110'-140'
60		600'	660'	720'	60'	120'-150'
65		650'	715'	780'	65'	130'-175'

NO.	REVISIONS	DATE	NAME

**FORT BEND COUNTY  
ENGINEERING DEPARTMENT**



**SES HORIZON CONSULTING ENGINEERS, INC.**  
TEXAS REGISTERED ENGINEERING FIRM F-003922  
10101 Southwest Freeway, Suite 400 Houston, Texas 77074  
(713) 988-5504, Fax (713) 988-4441 www.seshorizon.com

SES HORIZON CONSULTING ENGINEERS, INC.  
TEXAS REGISTERED ENGINEERING FIRM F-003922

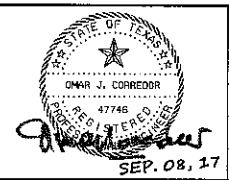

PROJECT TITLE: LUDWIG LANE- FROM DULLES AVENUE TO BRAND LANE FORT BEND COUNTY PROJECT 13208			
DRAWN BY:	SHEET DESCRIPTION: PROJECT APPROACH SIGNING	JOB NO:	
CHK'D BY:		FILE NAME:	
SCALE:	N.T.S.	FILE NO:	
DATE: 11/09/2017	APPROVED BY:	SITING:	57 / 93

FOR REDUCED PLANS  
Original scale in inches

PLOTTED ON 11/13/2017 5:45 PM  
FILE NAME: F:\LUDWIG\CAD\TYPICAL\DETOUR MAP.DWG

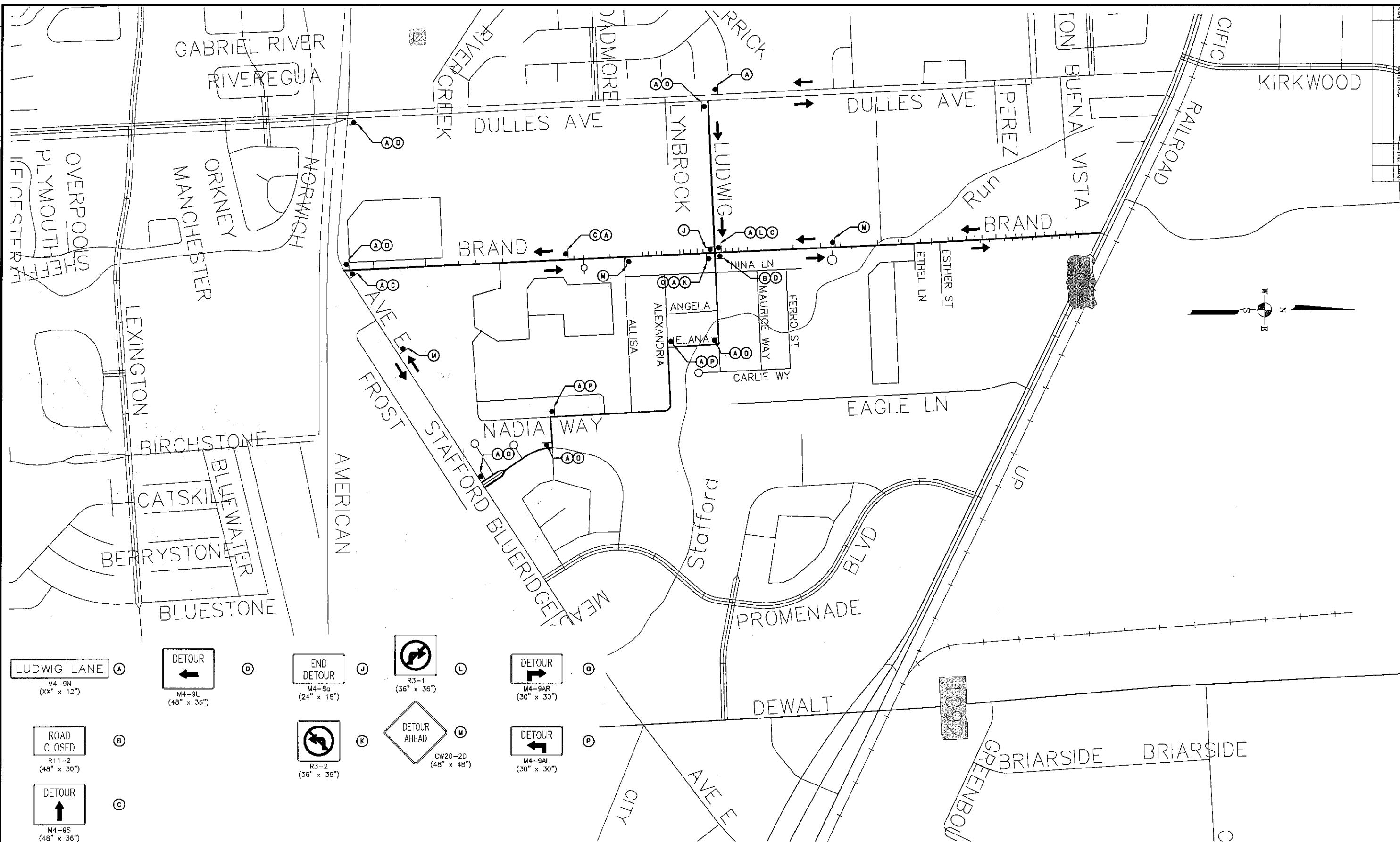

LUDWIG LANE M4-9N (XX" x 12")	DETOUR M4-9L (48" x 36")	END DETOUR M4-8a (24" x 18")	R3-1 (36" x 36")	DETOUR M4-9AR (30" x 30")
ROAD CLOSED R11-2 (48" x 30")	DETOUR M4-9S (48" x 36")	R3-2 (36" x 36")	DETOUR AHEAD CW20-2D (48" x 48")	DETOUR M4-9AL (30" x 30")

NO.	REVISIONS	DATE	NAME

FORT BEND COUNTY  
ENGINEERING DEPARTMENT



**SES HORIZON**  
CONSULTING ENGINEERS, INC.  
10101 Southwest Freeway, Suite 400 Houston, Texas 77074  
(713) 988-5504, Fax (713) 988-4441 www.seshorizon.com

SES HORIZON CONSULTING  
ENGINEERS, INC.  
TEXAS REGISTERED  
ENGINEERING FIRM  
F-003922

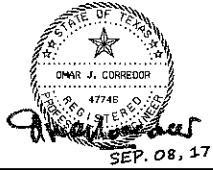

PROJECT TITLE: LUDWIG LANE- FROM DULLES AVENUE TO BRAND LANE FORT BEND COUNTY PROJECT 13208		JOB NO.:
DRAWN BY:	SHEET DESCRIPTION: DETOUR MAP LAYOUT	FILE NAME:
DATE: 11/09/2017	SCALE: 1" = 400'	FILE NO.:
APPROVED BY:	DATE: 11/09/2017	SHEET NO.: 58 / 93