



**REVIEW BY FORT BEND COUNTY  
COMMISSIONERS COURT**

**Fort Bend County  
Engineering Department**  
301 Jackson Suite 401  
Richmond, Texas 77469  
281.633.7500  
[Permits@fortbendcountytx.gov](mailto:Permits@fortbendcountytx.gov)

- Right of Way Permit**
- Commercial Driveway Permit**

Permit No: 2018-22596

**Applicant:** AT&T Texas/Black & Veatch

**Job Location Site:** 1226 US 90A E, Richmond, TX 77406

**Bond No.** XXXXXXXXXX **Date of Bond:** 11/28/2017 **Amount:** \$50,000.00

The above applicant came to make use of certain Fort Bend County property subject to, "The Order Regulating the Laying, Construction, Maintenance, and Repair of Buried Cables, Conduits, and Pole Lines, In, Under, Across or Along Roads, Streets, Highways, and Drainage Ditches in Fort Bend County, Texas, Under the Jurisdiction of the Commissioners Court of Fort Bend County, Texas," as passed by the Commissioners Court of Fort Bend County, Texas, of the Minutes of the Commissioners Court of Fort Bend County, Texas, to the extent that such order is not inconsistent with Chapter 181, Vernon's Texas Statutes and Codes Annotated.

**Notes:**

1. Evidence of review by the Commissioners Court must be kept on the job site and failure to do so constitutes grounds for job shutdown.
2. Written notices are required:
  - a. 48 hours in advance of construction start up, and
  - b. When construction is completed and ready for final inspection, submit notification to Permit Administrator thru [MyGovernmentOnline.org](http://MyGovernmentOnline.org) portal.
3. This permit expires one (1) year from date of permit if construction has not commenced.

On this 28th day of August, 2018, Upon Motion of Commissioner \_\_\_\_\_, seconded by Commissioner \_\_\_\_\_, duly put and carried, it is ORDERED, ADJUDGED AND DECREED that said notice of said above purpose is hereby acknowledged by the Commissioners Court of Fort Bend County, Texas, and that said notice be placed on record according to the regulation order thereof.

**Signature**

By:   
County Engineer

Presented to Commissioners Court and approved.

Date Recorded \_\_\_\_\_ Comm. Court No. \_\_\_\_\_

Clerk of Commissioners Court

By: N/A  
Drainage District Engineer/Manager

By: \_\_\_\_\_  
Deputy



**PERMIT APPLICATION REVIEW FORM FOR  
CABLE, CONDUIT, AND POLE LINE ACTIVITY  
IN FORT BEND COUNTY**

**Fort Bend County  
Engineering Department**  
301 Jackson Suite 401  
Richmond, Texas 77469  
281.633.7500  
[Permits@fortbendcountytx.gov](mailto:Permits@fortbendcountytx.gov)

- Right of Way Permit**  
 **Commercial Driveway Permit**

Permit No: 2018-22596

The following "Notice of Proposed Cable, Conduit, and/or Pole Line activity in Fort Bend County" and accompanying attachments have been reviewed and the notice conforms to appropriate regulations set by Commissioner's Court of Fort Bend County, Texas.

**(1) COMPLETE APPLICATION FORM:**

- a. Name of road, street, and/or drainage ditch affected.  
 b. Vicinity map showing course of directions  
 c. Plans and specifications

**(2) BOND:**

- County Attorney, approval when applicable.
- Perpetual bond currently posted.      Bond No:                           Amount: \$50,000.00
- Performance bond submitted.      Bond No:                           Amount:
- Cashier's Check      Check No:                           Amount:

**(3) DRAINAGE DISTRICT APPROVAL (WHEN APPLICABLE):**

\_\_\_\_\_  
Drainage District Approval

\_\_\_\_\_  
Date

**We have reviewed this project and agree it meets minimum requirements.**

  
\_\_\_\_\_  
Permit Administrator

8/17/2018  
\_\_\_\_\_  
Date



DESIGN ENGINEER CONTACT:  
CHRISTIAN LIBEBELE  
BLACK & VEATCH  
(469) 513-3203  
LIBEBELE@BV.COM

FORT BEND COUNTY  
PERMIT  
SHOWN ON PRINT 56, 57, 42

DESIGN SUMMARY:  
-BORE AND PLACE FIBER  
-PLACE ONE (1) PEDESTAL

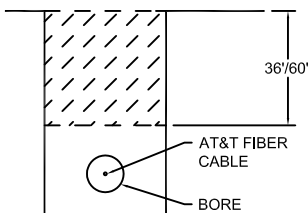

BORE DETAIL NTS

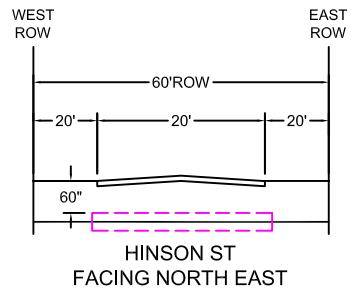

TYPICAL BORE CROSS-SECTION NTS

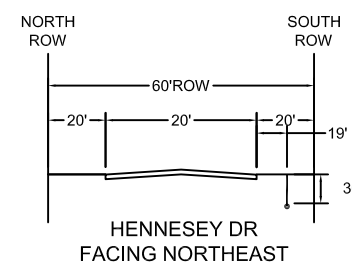

TYPICAL CROSS-SECTION NTS

# FORT BEND COUNTY NOTIFICATION

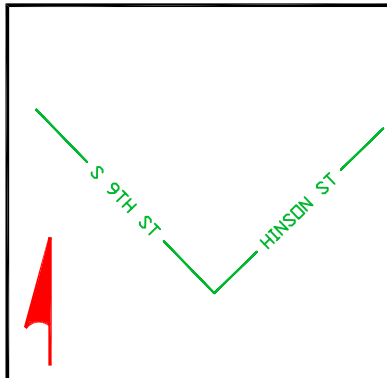
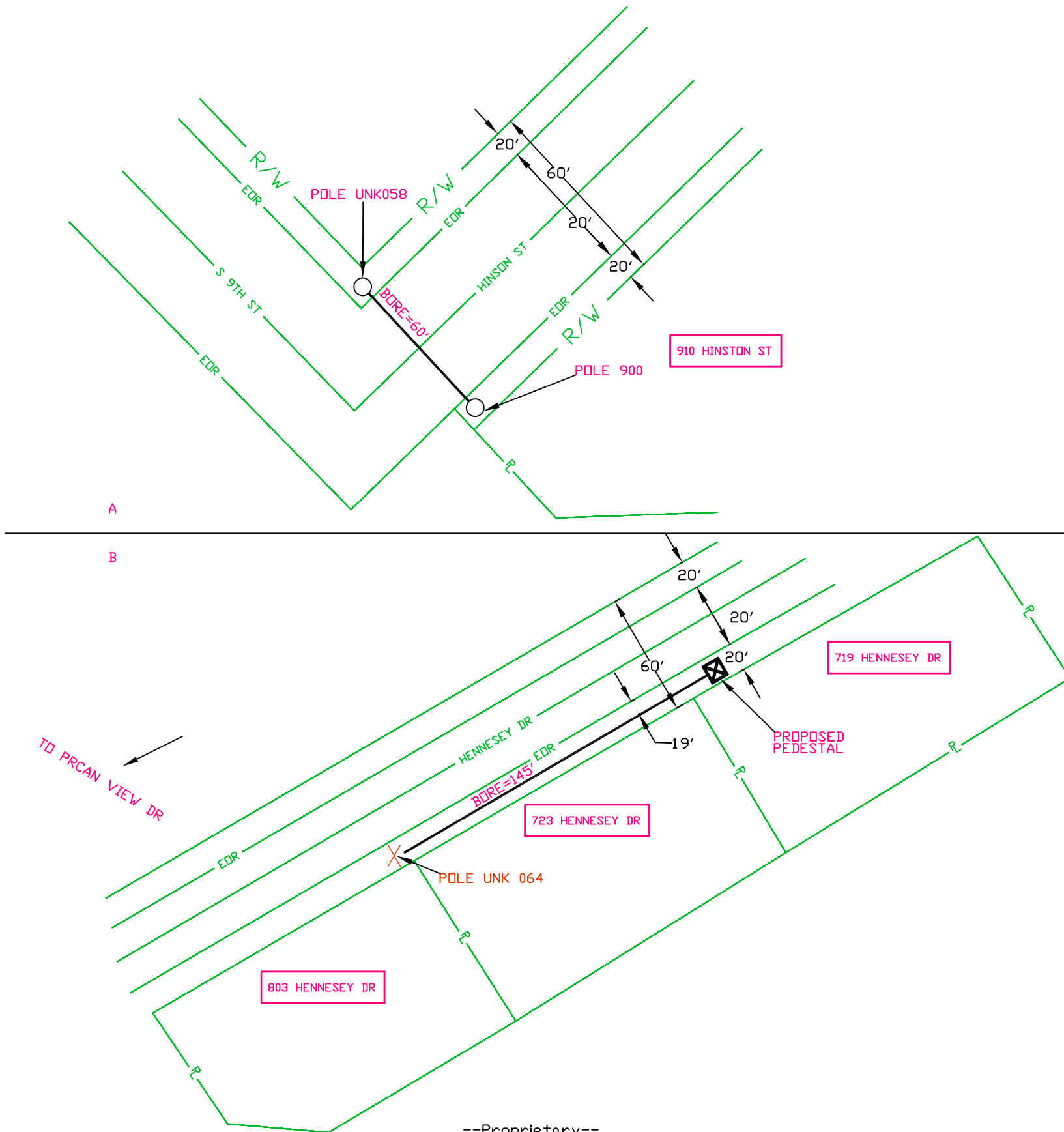

APPROXIMATE LOCATION MAP

WORK DONE IN FORT BEND COUNTY RIGHT OF WAY - PRINT FOR INFORMATIONAL PURPOSES ONLY

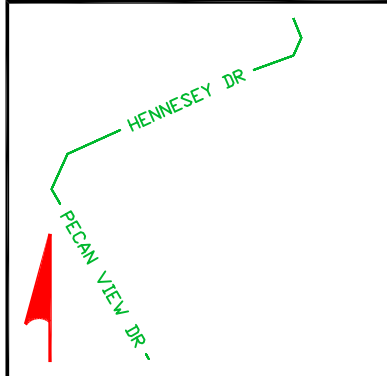

APPROXIMATE LOCATION MAP

WORK DONE IN FORT BEND COUNTY RIGHT OF WAY - PRINT FOR INFORMATIONAL PURPOSES ONLY

SPECIAL CIRCUITS N  
6203 FORWARDED N  
PERMIT REQUIRED Y

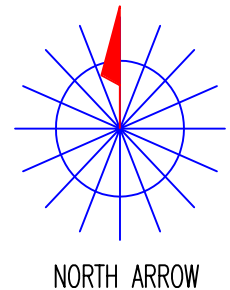

OPERATING RANGE OF JOB STEPS

TASK \_\_\_\_\_ TO \_\_\_\_\_

MFRC

TRANSMISSION ZONE  
RZ 0 CZ 0 TAPER CODE 1620PB

CAUTION HIGH VOLTAGE  
KV 0.00 AERIAL N BURIED N

HIGHWAY PERMIT NO.

Utility CO  
REP NAME  
REP TEL NO.  
POLE CONTACTS (+) 0 (-) 0

Utility CO  
REP NAME  
REP TEL NO.  
POLE CONTACTS (+) 0 (-) 0

Utility CO  
REP NAME  
REP TEL NO.  
POLE CONTACTS (+) 0 (-) 0

PROJECT NO A01A6ZG

TOT.PRINTS 121 PRINT NO. 105  
NPA/NNX: 281-232 PRT:281232

EXCH. RICH-ROSE

TAX DIST. FG009

GEO LOC. W89232

ENGR. DG DRAWN LF

TELEPHONE NO. (713) 213-2691

REC. REF.

MAP REF. 605D, 606A

SCALE NONE

ISSUE DATE

PROJ TITLE LIGHTGIG-1620PB-DIST-RR

REV. NUMBER

DATE REV.

--Proprietary--  
Not for use or disclosure outside the AT&T companies except under written agreement.

**BLACK & VEATCH**

DESIGN ENGINEER CONTACT:  
CHRISTIAN LIBEBELE  
BLACK & VEATCH  
(469) 513-3203  
LIBEBELE@BV.COM

FORT BEND COUNTY  
PERMIT #  
SHOWN ON PRINT 41

DESIGN SUMMARY:  
-BORE AND PLACE FIBER  
-PLACE ONE (1) PEDESTAL

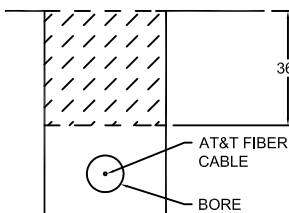

BORE DETAIL

NTS

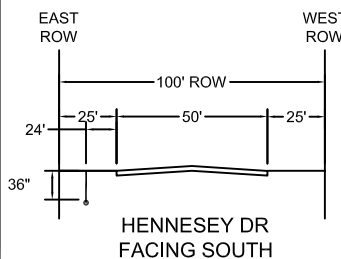

TYPICAL CROSS-SECTION

NTS

FORT BEND COUNTY NOTIFICATION

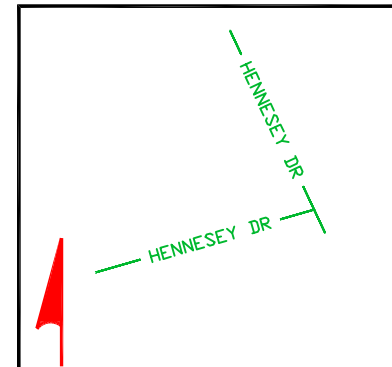
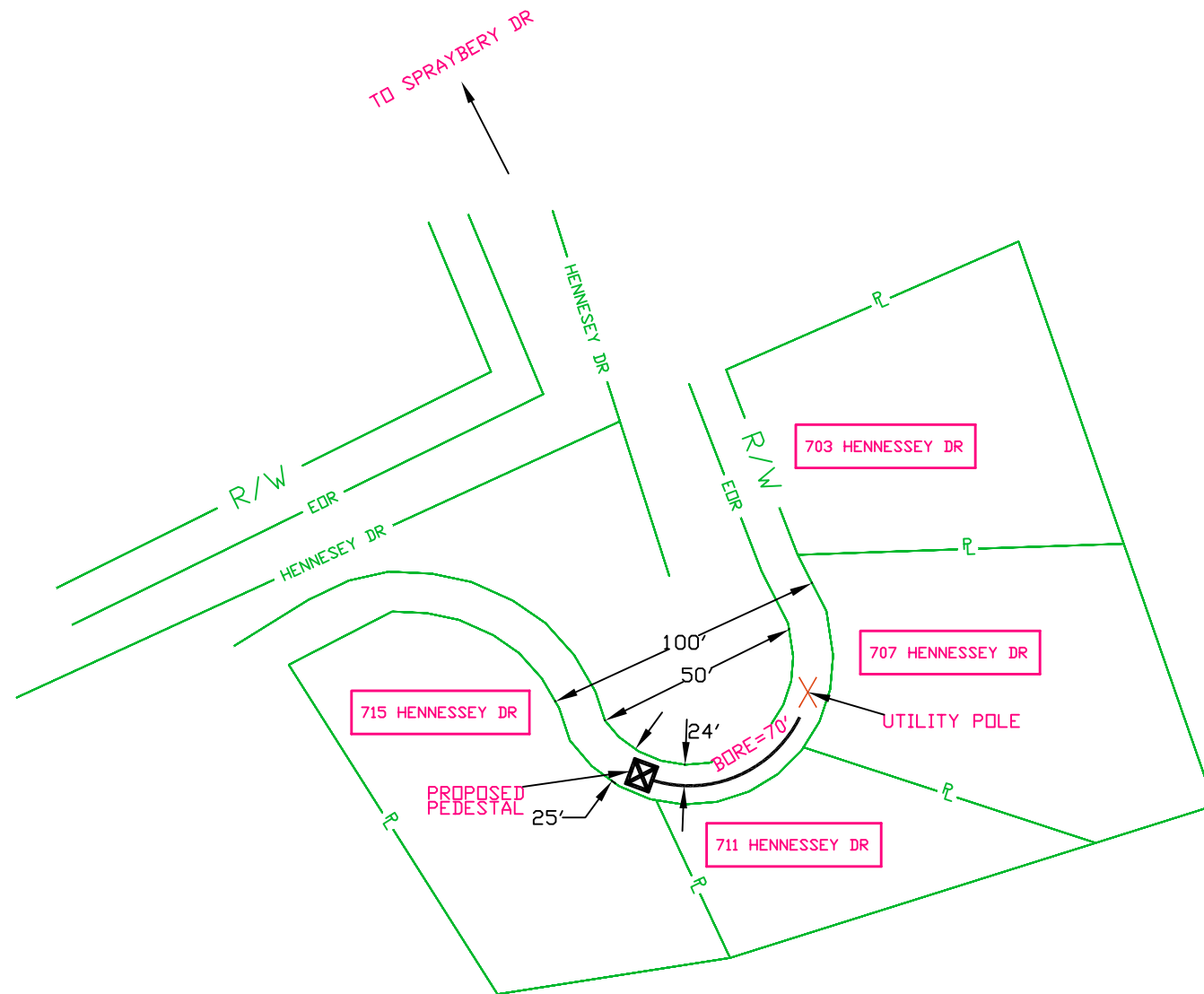

APPROXIMATE LOCATION MAP

WORK DONE IN FORT BEND COUNTY RIGHT OF WAY - PRINT FOR INFORMATIONAL PURPOSES ONLY

SPECIAL CIRCUITS N  
6203 FORWARDED N  
PERMIT REQUIRED Y

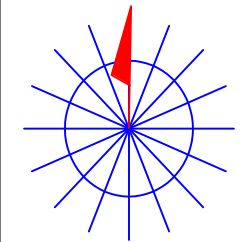

NORTH ARROW

OPERATING RANGE OF JOB STEPS

TASK \_\_\_\_\_ TO \_\_\_\_\_

MFRC

TRANSMISSION ZONE  
RZ 0 CZ 0 TAPER CODE 1620PB

CAUTION HIGH VOLTAGE  
KV 0.00 AERIAL N BURIED N

HIGHWAY PERMIT NO.

Utility CO  
REP NAME  
REP TEL NO.  
POLE CONTACTS (+) 0 (-) 0

Utility CO  
REP NAME  
REP TEL NO.  
POLE CONTACTS (+) 0 (-) 0

Utility CO  
REP NAME  
REP TEL NO.  
POLE CONTACTS (+) 0 (-) 0

PROJECT NO A01A6ZG

TOT.PRINTS 121 PRINT NO. 106

NPA/NNX: 281-232 PRT:281232

EXCH. RICH-ROSE

TAX DIST. FG009

GEO LOC. W89232

ENGR. DG DRAWN LF

TELEPHONE NO. (713) 213-2691

REC. REF.

MAP REF. 606A

SCALE NONE

ISSUE DATE

PROJ TITLE LIGHTGIG-1620PB-DIST-RR

REV. NUMBER

DATE REV.



LOCATE ALL UTILITIES BEFORE DIGGING: 1-800-344-8377 OR 811

**BLACK & VEATCH**

DESIGN ENGINEER CONTACT:  
CHRISTIAN LIBEBELE  
BLACK & VEATCH  
(469) 513-3203  
LIBEBELE@BV.COM

FORT BEND COUNTY  
PERMIT #  
SHOWN ON PRINT 87

DESIGN SUMMARY:  
-BORE AND PLACE FIBER

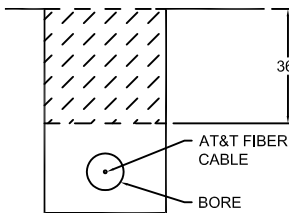

BORE DETAIL

NTS

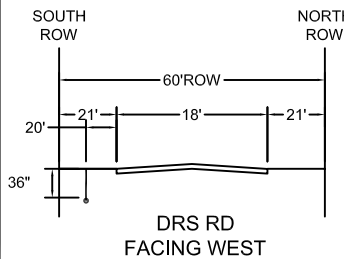

TYPICAL CROSS-SECTION

NTS

FORT BEND COUNTY NOTIFICATION

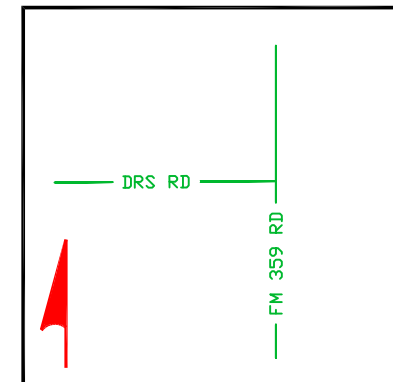
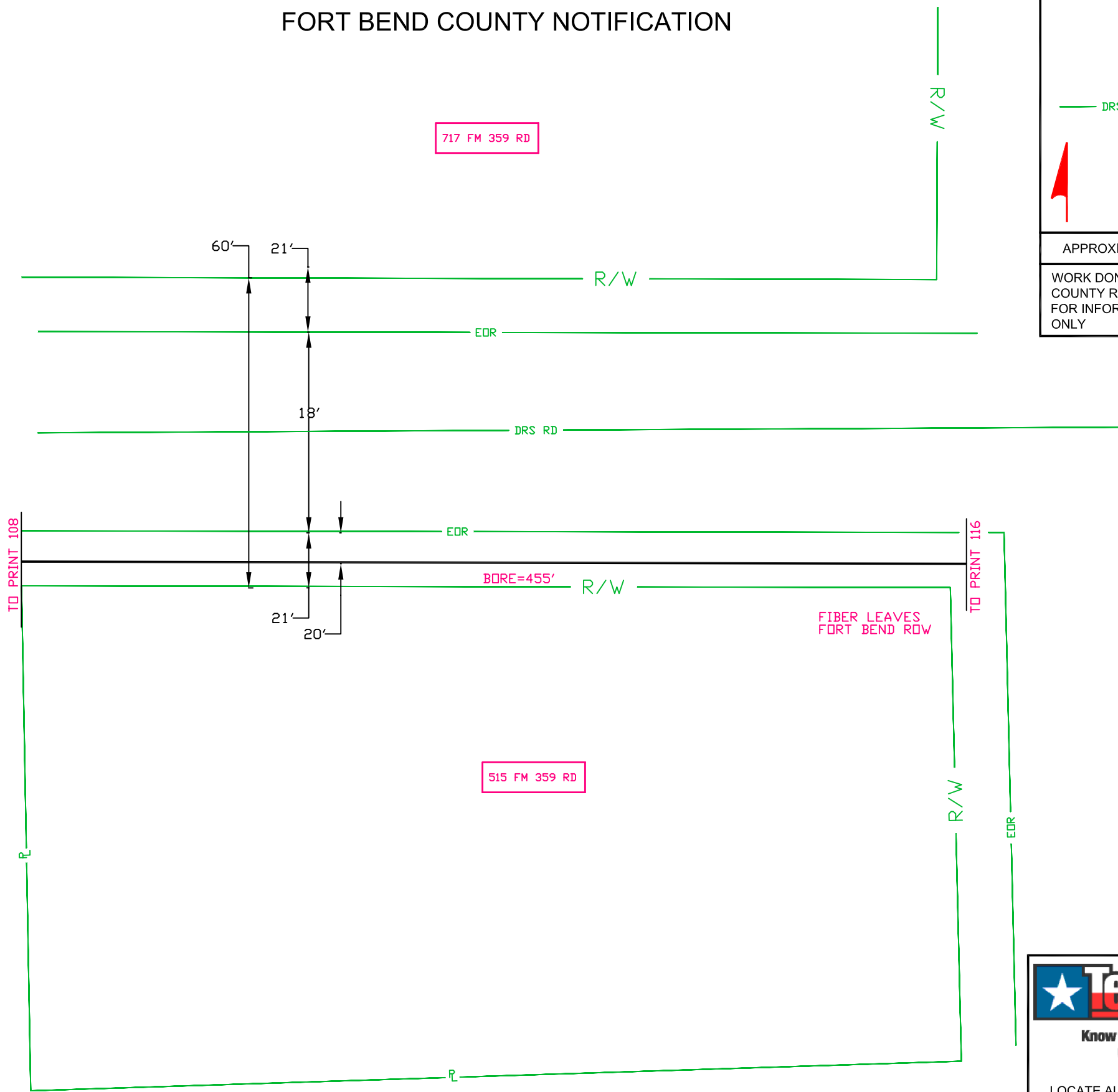

APPROXIMATE LOCATION MAP

WORK DONE IN FORT BEND COUNTY RIGHT OF WAY - PRINT FOR INFORMATIONAL PURPOSES ONLY

SPECIAL CIRCUITS N  
6203 FORWARDED N  
PERMIT REQUIRED Y

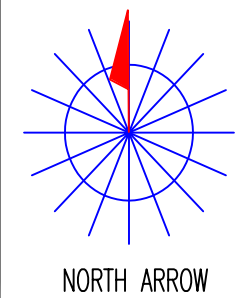

OPERATING RANGE OF JOB STEPS  
TASK \_\_\_\_\_ TO \_\_\_\_\_  
MFRC

TRANSMISSION ZONE  
RZ 0 CZ 0 TAPER CODE 1620PB

CAUTION HIGH VOLTAGE  
KV 0.00 AERIAL N BURIED N

HIGHWAY PERMIT NO.

Utility CO  
REP NAME  
REP TEL NO.  
POLE CONTACTS (+) 0 (-) 0

Utility CO  
REP NAME  
REP TEL NO.  
POLE CONTACTS (+) 0 (-) 0

Utility CO  
REP NAME  
REP TEL NO.  
POLE CONTACTS (+) 0 (-) 0

PROJECT NO A01A6ZG

TOT.PRINTS 121 PRINT NO. 107  
NPA/NNX: 281-232 PRT:281232  
EXCH. RICH-ROSE  
TAX DIST. FG009  
GEO LOC. W89232  
ENGR. DG DRAWN LF  
TELEPHONE NO. (713) 213-2691

REC. REF.  
MAP REF. 565V, 566S  
SCALE NONE  
ISSUE DATE  
PROJ TITLE LIGHTGIG-1620PB-DIST-RR  
REV. NUMBER  
DATE REV.

--Proprietary--  
Not for use or disclosure outside the AT&T companies except under written agreement.

**BLACK & VEATCH**

DESIGN ENGINEER CONTACT:  
CHRISTIAN LIBEBELE  
BLACK & VEATCH  
(469) 513-3203  
LIBEBELE@BV.COM

FORT BEND COUNTY  
PERMIT #  
SHOWN ON PRINT 88 & 89

DESIGN SUMMARY:  
-BORE AND PLACE FIBER  
-PLACE SEVEN (7) PEDESTALS

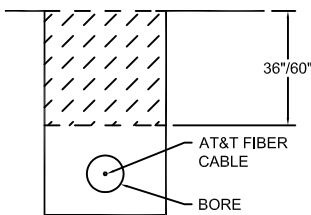

BORE DETAIL NTS

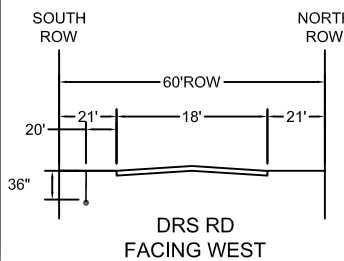

TYPICAL CROSS-SECTION NTS

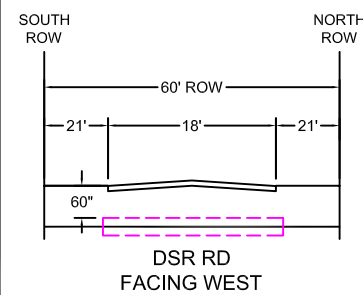

TYPICAL BORE CROSS-SECTION NTS

FORT BEND COUNTY NOTIFICATION

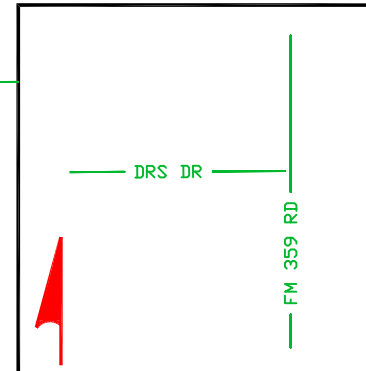
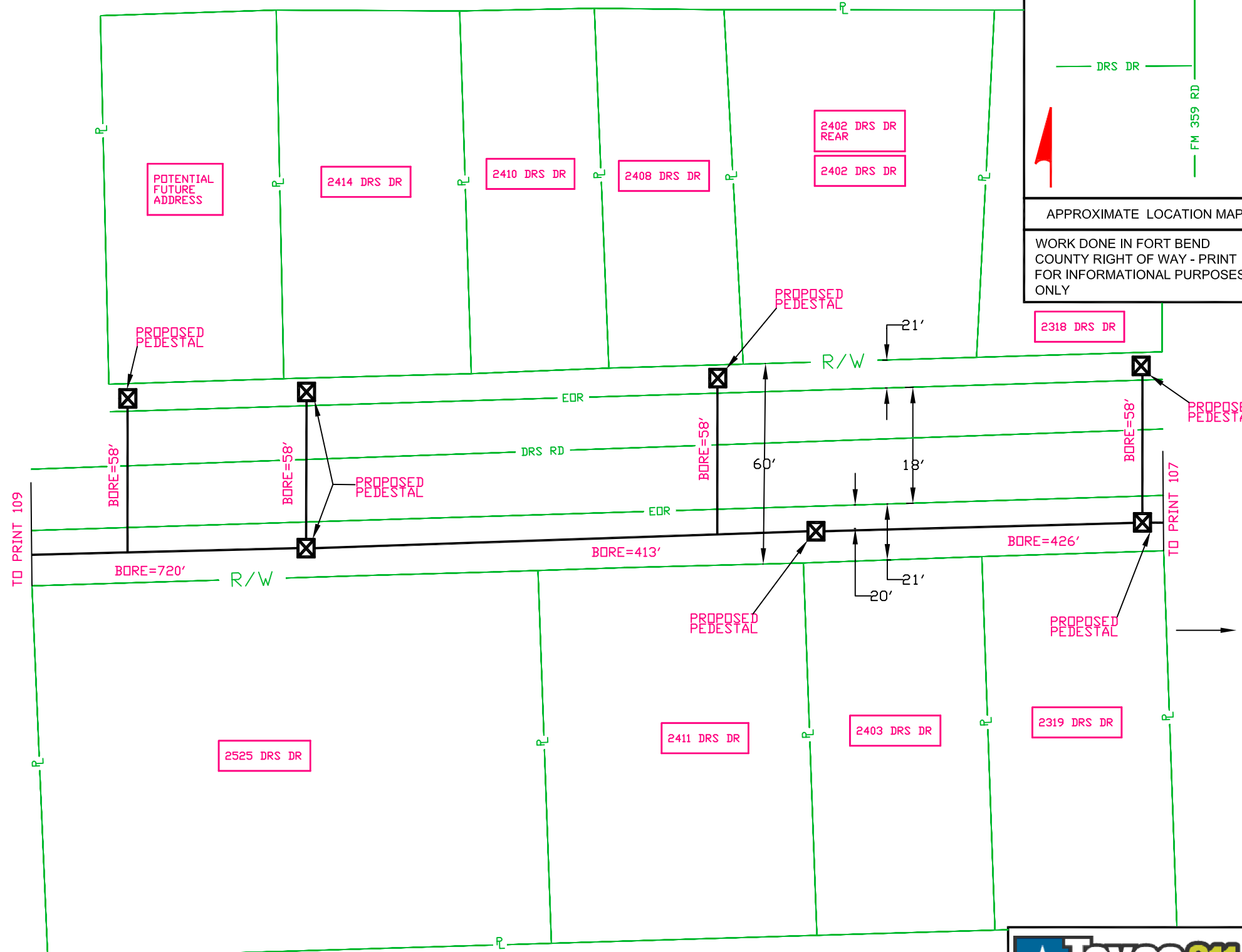

APPROXIMATE LOCATION MAP

WORK DONE IN FORT BEND COUNTY RIGHT OF WAY - PRINT FOR INFORMATIONAL PURPOSES ONLY

SPECIAL CIRCUITS N  
6203 FORWARDED N  
PERMIT REQUIRED Y

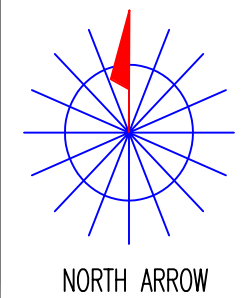

OPERATING RANGE OF JOB STEPS  
TASK \_\_\_\_\_ TO \_\_\_\_\_  
MFRC

TRANSMISSION ZONE  
RZ 0 CZ 0 TAPER CODE 1620PB

CAUTION HIGH VOLTAGE  
KV 0.00 AERIAL N BURIED N

HIGHWAY PERMIT NO.

Utility CO  
REP NAME  
REP TEL NO.  
POLE CONTACTS (+) 0 (-) 0

Utility CO  
REP NAME  
REP TEL NO.  
POLE CONTACTS (+) 0 (-) 0

Utility CO  
REP NAME  
REP TEL NO.  
POLE CONTACTS (+) 0 (-) 0

PROJECT NO A01A6ZG

TOT.PRINTS 121 PRINT NO. 108  
NPA/NNX: 281-232 PRT:281232  
EXCH. RICH-ROSE  
TAX DIST. FG009  
GEO LOC. W89232  
ENGR. DG DRAWN LF  
TELEPHONE NO. (713) 213-2691

REC. REF.  
MAP REF. 565V, 566S  
SCALE NONE  
ISSUE DATE  
PROJ TITLE LIGHTGIG-1620PB-DIST-RR  
REV. NUMBER  
DATE REV.

--Proprietary--  
Not for use or disclosure outside the AT&T companies except under written agreement.

**BLACK & VEATCH**

DESIGN ENGINEER CONTACT:  
CHRISTIAN LIBEBELE  
BLACK & VEATCH  
(469) 513-3203  
LIBEBELEC@BV.COM

FORT BEND COUNTY  
PERMIT #  
SHOWN ON PRINT 90 & 91

DESIGN SUMMARY:  
-BORE AND PLACE CABLE  
-PLACE FOUR (4) PEDESTALS

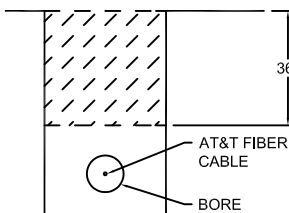

BORE DETAIL NTS

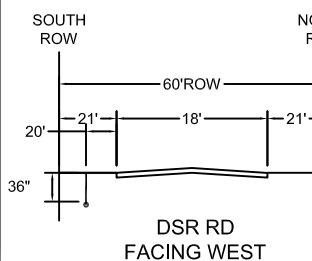

TYPICAL CROSS-SECTION NTS

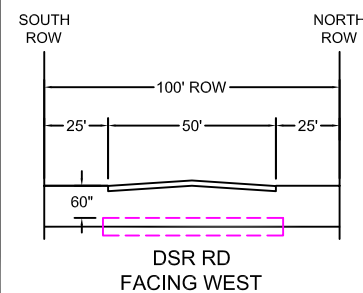

TYPICAL BORE CROSS-SECTION NTS

FORT BEND COUNTY NOTIFICATION

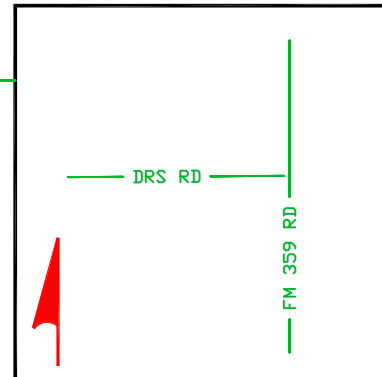
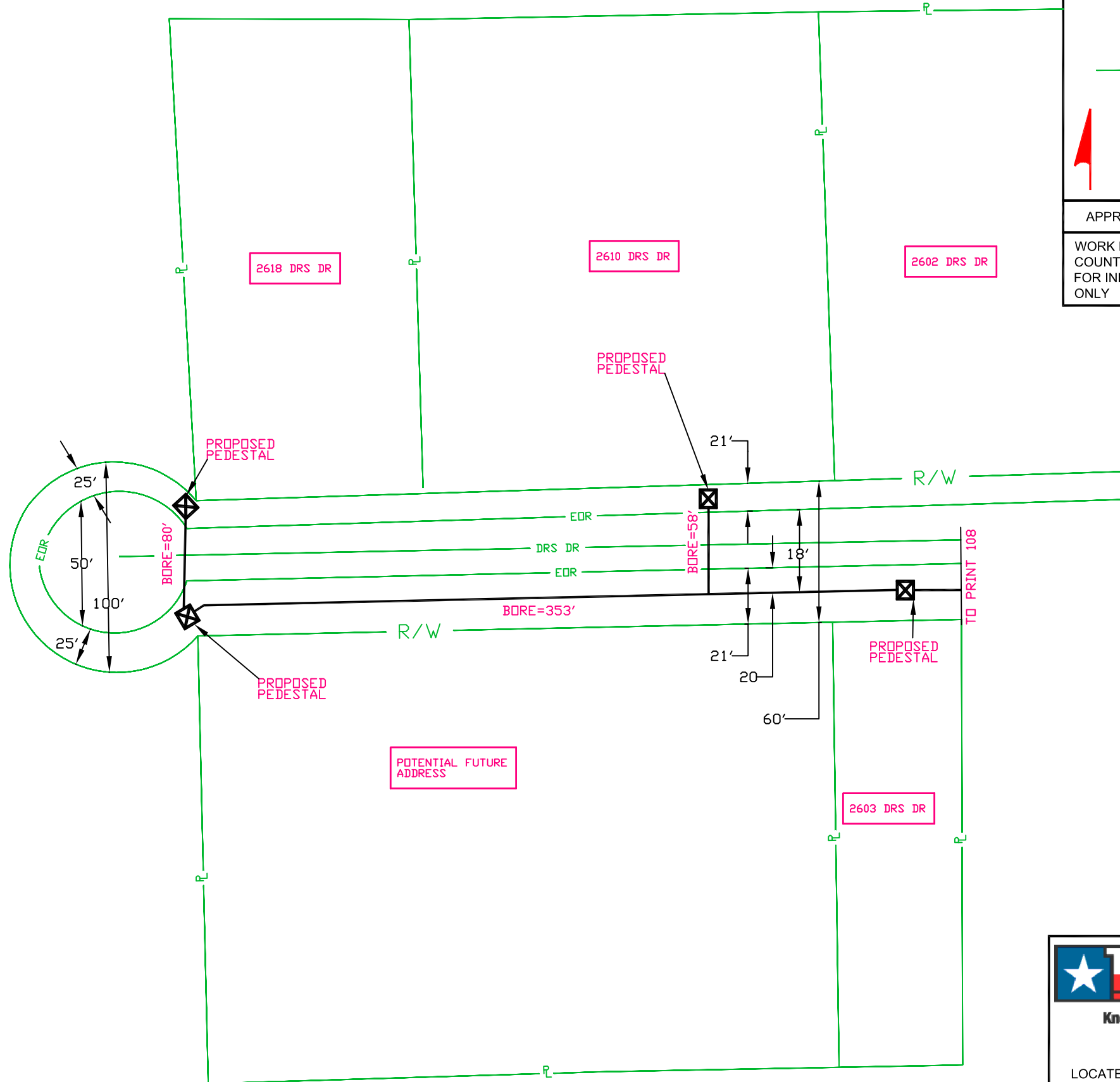

APPROXIMATE LOCATION MAP

WORK DONE IN FORT BEND COUNTY RIGHT OF WAY - PRINT FOR INFORMATIONAL PURPOSES ONLY

SPECIAL CIRCUITS N  
6203 FORWARDED N  
PERMIT REQUIRED Y

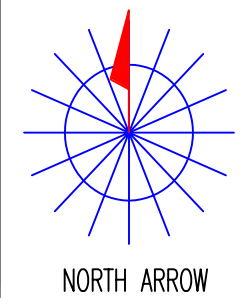

OPERATING RANGE OF JOB STEPS  
TASK \_\_\_\_\_ TO \_\_\_\_\_  
MFRC

TRANSMISSION ZONE  
RZ 0 CZ 0 TAPER CODE 1620PB

CAUTION HIGH VOLTAGE  
KV 0.00 AERIAL N BURIED N

HIGHWAY PERMIT NO.

Utility CO  
REP NAME  
REP TEL NO.  
POLE CONTACTS (+) 0 (-) 0

Utility CO  
REP NAME  
REP TEL NO.  
POLE CONTACTS (+) 0 (-) 0

Utility CO  
REP NAME  
REP TEL NO.  
POLE CONTACTS (+) 0 (-) 0

PROJECT NO A01A6ZG

TOT.PRINTS 121 PRINT NO. 109  
NPA/NNX: 281-232 PRT:281232  
EXCH. RICH-ROSE  
TAX DIST. FG009  
GEO LOC. W89232  
ENGR. DG DRAWN LF  
TELEPHONE NO. (713) 213-2691

REC. REF.  
MAP REF. 565V  
SCALE NONE  
ISSUE DATE  
PROJ TITLE LIGHTGIG-1620PB-DIST-RR  
REV. NUMBER  
DATE REV.

--Proprietary--  
Not for use or disclosure outside the AT&T companies except under written agreement.



# BLACK & VEATCH

DESIGN ENGINEER CONTACT:  
CHRISTIAN LIBEBELE  
BLACK & VEATCH  
(469) 513-3203  
LIBEBELE@BV.COM

FORT BEND COUNTY  
PERMIT #  
SHOWN ON PRINT 67, 68, & 69

DESIGN SUMMARY:  
-BORE AND PLACE FIBER

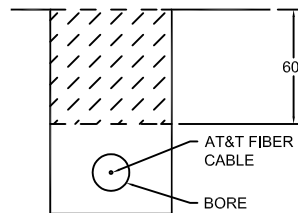

BORE DETAIL

NTS

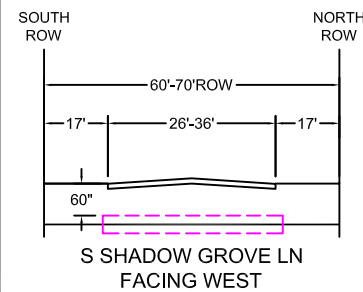

TYPICAL BORE  
CROSS-SECTION

NTS

## FORT BEND COUNTY NOTIFICATION

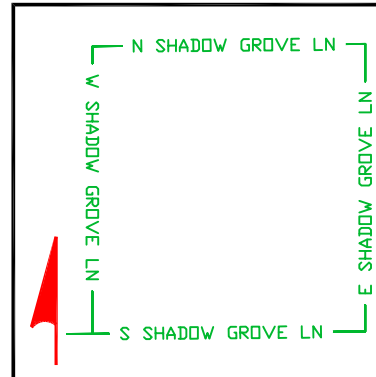
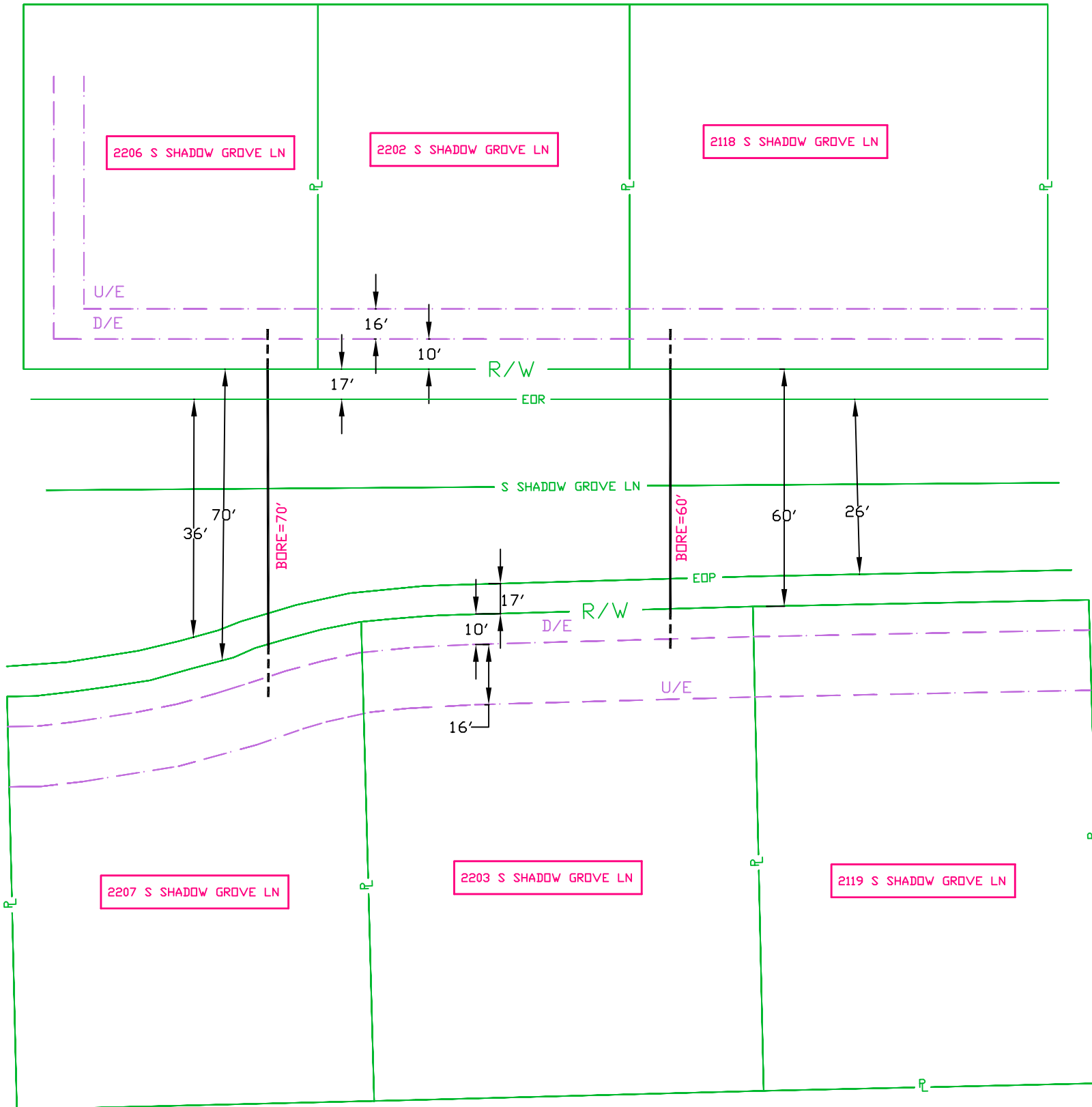

APPROXIMATE LOCATION MAP

WORK DONE IN FORT BEND  
COUNTY RIGHT OF WAY - PRINT  
FOR INFORMATIONAL PURPOSES  
ONLY

SPECIAL  
CIRCUITS N  
6203  
FORWARDED N  
PERMIT  
REQUIRED Y

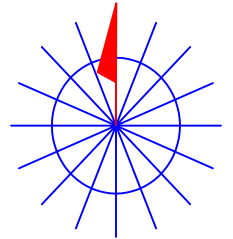

NORTH ARROW

OPERATING RANGE OF JOB STEPS

TASK \_\_\_\_\_ TO \_\_\_\_\_

MFRC

TRANSMISSION ZONE  
RZ 0 CZ 0 TAPER CODE 1620PB

CAUTION HIGH VOLTAGE  
KV 0.00 AERIAL N BURIED N

HIGHWAY PERMIT NO.

Utility CO  
REP NAME  
REP TEL NO.  
POLE CONTACTS (+) 0 (-) 0

Utility CO  
REP NAME  
REP TEL NO.  
POLE CONTACTS (+) 0 (-) 0

Utility CO  
REP NAME  
REP TEL NO.  
POLE CONTACTS (+) 0 (-) 0

PROJECT NO A01A6ZG

TOT.PRINTS 121 PRINT NO. 110

NPA/NNX: 281-232 PRT:281232

EXCH. RICH-ROSE

TAX DIST. FG009

GEO LOC. W89232

ENGR. DG DRAWN LF

TELEPHONE NO. (713) 213-2691

REC. REF.

MAP REF. 566S

SCALE NONE

ISSUE DATE

PROJ TITLE LIGHTGIG-1620PB-DIST-RR

REV. NUMBER

DATE REV.



LOCATE ALL UTILITIES BEFORE  
DIGGING: 1-800-344-8377 OR 811

--Proprietary--

Not for use or disclosure outside the AT&T companies except under written agreement.



# BLACK & VEATCH

DESIGN ENGINEER CONTACT:  
CHRISTIAN LIBEBELE  
BLACK & VEATCH  
(469) 513-3203  
LIBEBELE@BV.COM

FORT BEND COUNTY  
PERMIT TBD  
SHOWN ON PRINT 69

DESIGN SUMMARY:  
-BORE AND PLACE FIBER

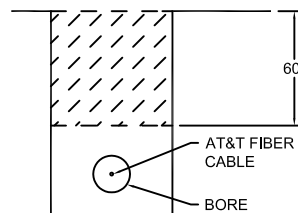

BORE DETAIL NTS

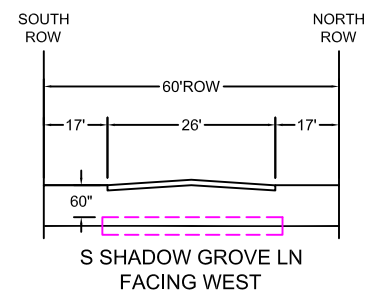

TYPICAL BORE CROSS-SECTION NTS

## FORT BEND COUNTY NOTIFICATION

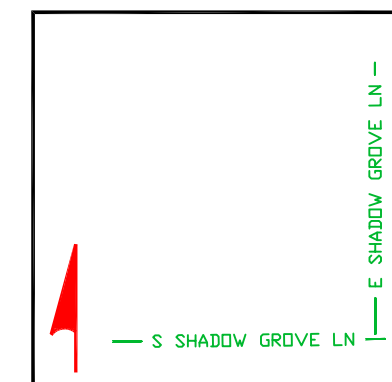
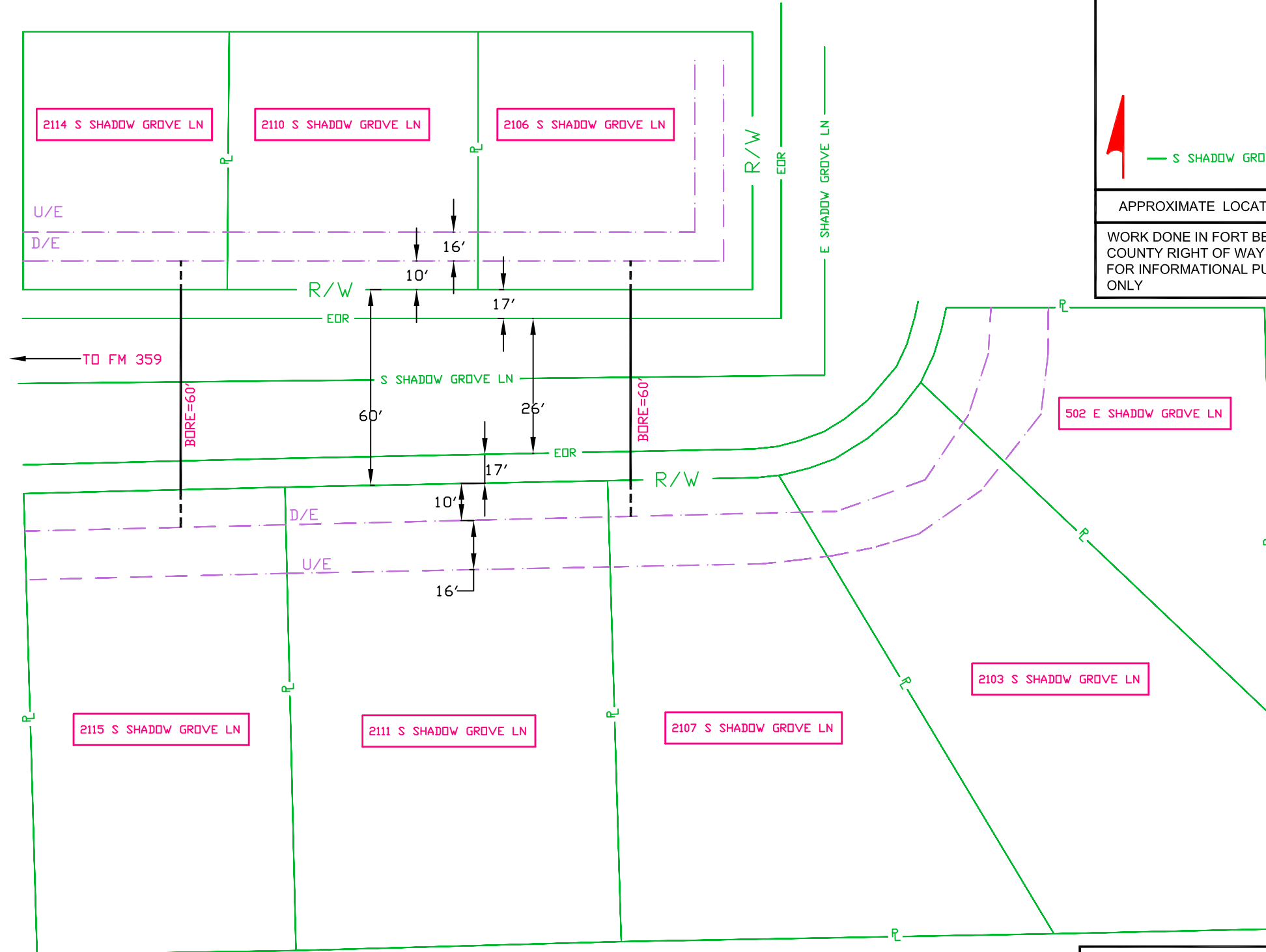

WORK DONE IN FORT BEND COUNTY RIGHT OF WAY - PRINT FOR INFORMATIONAL PURPOSES ONLY

SPECIAL CIRCUITS N  
6203 FORWARDED N  
PERMIT REQUIRED Y

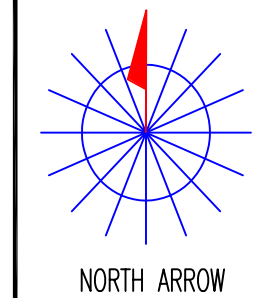

OPERATING RANGE OF JOB STEPS  
TASK \_\_\_\_\_ TO \_\_\_\_\_  
MFRC

TRANSMISSION ZONE  
RZ 0 CZ 0 TAPER CODE 1620PB

CAUTION HIGH VOLTAGE  
KV 0.00 AERIAL N BURIED N

HIGHWAY PERMIT NO.

Utility CO  
REP NAME  
REP TEL NO.  
POLE CONTACTS (+) 0 (-) 0

Utility CO  
REP NAME  
REP TEL NO.  
POLE CONTACTS (+) 0 (-) 0

Utility CO  
REP NAME  
REP TEL NO.  
POLE CONTACTS (+) 0 (-) 0

PROJECT NO A01A6ZG

TOT.PRINTS 121 PRINT NO. 111  
NPA/NNX: 281-232 PRT:281232  
EXCH. RICH-ROSE  
TAX DIST. FG009  
GEO LOC. W89232  
ENGR. DG DRAWN LF  
TELEPHONE NO. (713) 213-2691

REC. REF.  
MAP REF. 566S  
SCALE NONE  
ISSUE DATE  
PROJ TITLE LIGHTGIG-1620PB-DIST-RR  
REV. NUMBER  
DATE REV.



**BLACK & VEATCH**

DESIGN ENGINEER CONTACT:  
CHRISTIAN LIBEBELE  
BLACK & VEATCH  
(469) 513-3203  
LIBEBELE@BV.COM

FORT BEND COUNTY  
PERMIT TBD  
SHOWN ON PRINT 71 & 72

DESIGN SUMMARY:  
-BORE AND PLACE FIBER

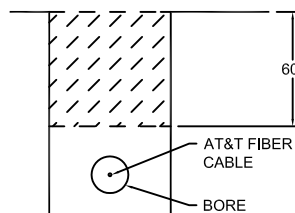

BORE DETAIL

NTS

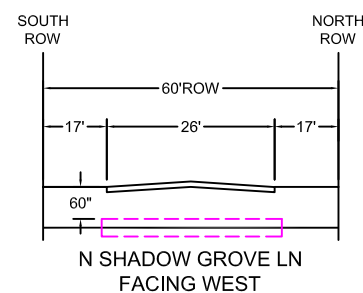

TYPICAL BORE CROSS-SECTION

NTS

FORT BEND COUNTY NOTIFICATION

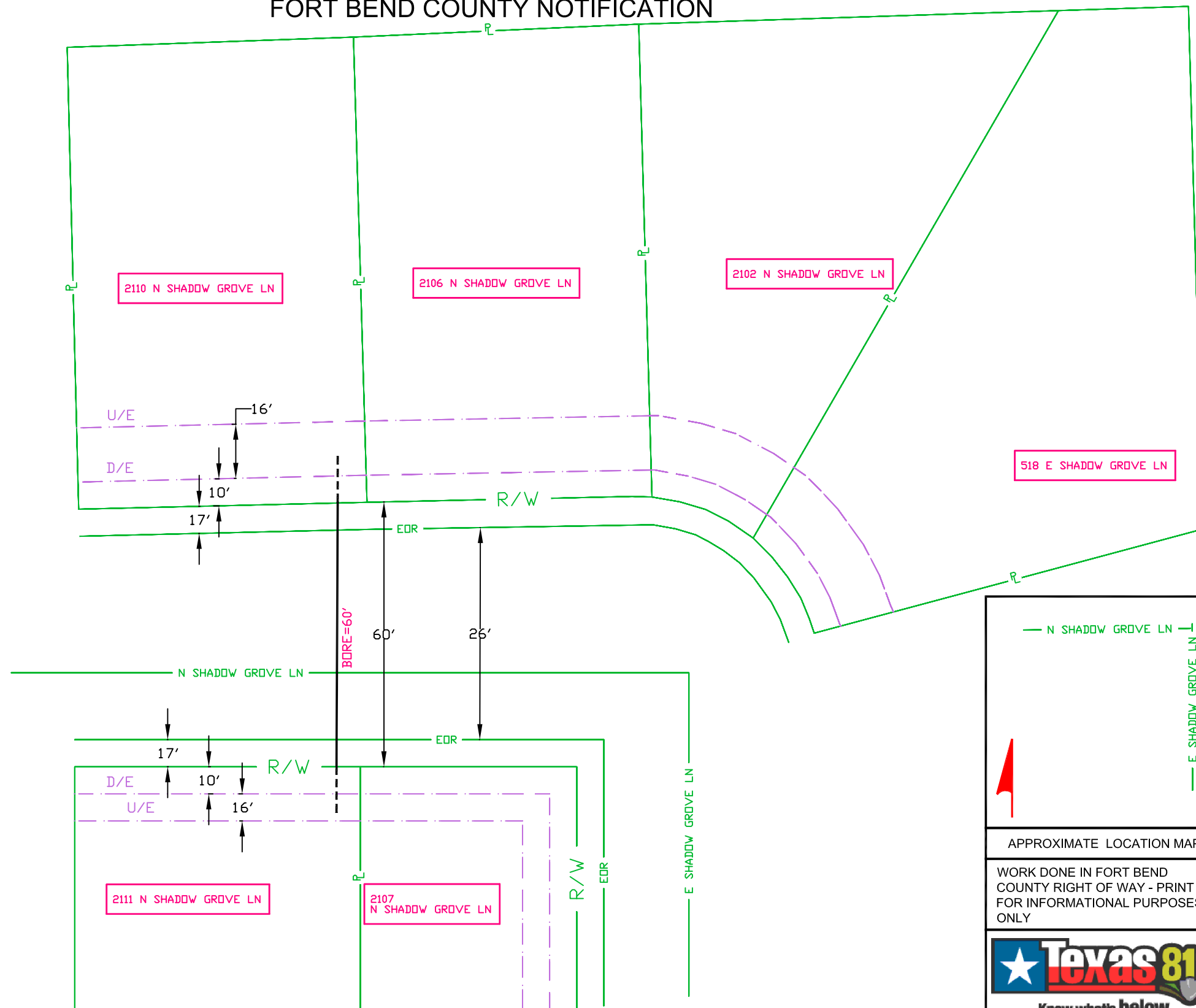

SPECIAL CIRCUITS N  
6203 FORWARDED N  
PERMIT REQUIRED Y

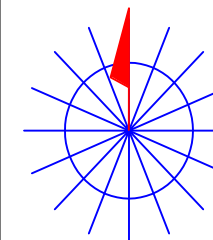

NORTH ARROW

OPERATING RANGE OF JOB STEPS

TASK \_\_\_\_\_ TO \_\_\_\_\_

MFRC

TRANSMISSION ZONE  
RZ 0 CZ 0 TAPER CODE 1620PB

CAUTION HIGH VOLTAGE  
KV 0.00 AERIAL N BURIED N

HIGHWAY PERMIT NO.

Utility CO  
REP NAME  
REP TEL NO.  
POLE CONTACTS (+) 0 (-) 0

Utility CO  
REP NAME  
REP TEL NO.  
POLE CONTACTS (+) 0 (-) 0

Utility CO  
REP NAME  
REP TEL NO.  
POLE CONTACTS (+) 0 (-) 0

PROJECT NO A01A6ZG

TOT.PRINTS 121 PRINT NO. 112  
NPA/NNX: 281-232 PRT:281232

EXCH. RICH-ROSE  
TAX DIST. FG009

GEO LOC. W89232

ENGR. DG DRAWN LF

TELEPHONE NO. (713) 213-2691

REC. REF.  
MAP REF. 566S

SCALE NONE

ISSUE DATE

PROJ TITLE LIGHTGIG-1620PB-DIST-RR

REV. NUMBER

DATE REV.

APPROXIMATE LOCATION MAP

WORK DONE IN FORT BEND COUNTY RIGHT OF WAY - PRINT FOR INFORMATIONAL PURPOSES ONLY

LOCATE ALL UTILITIES BEFORE DIGGING: 1-800-344-8377 OR 811

--Proprietary--

Not for use or disclosure outside the AT&T companies except under written agreement.



# BLACK & VEATCH

DESIGN ENGINEER CONTACT:  
CHRISTIAN LIBEBELE  
BLACK & VEATCH  
(469) 513-3203  
LIBEBELECBV.COM

FORT BEND COUNTY  
PERMIT TBD  
SHOWN ON PRINT 72 & 73

DESIGN SUMMARY:  
-BORE AND PLACE FIBER

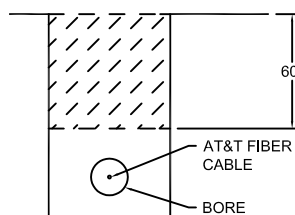

BORE DETAIL NTS

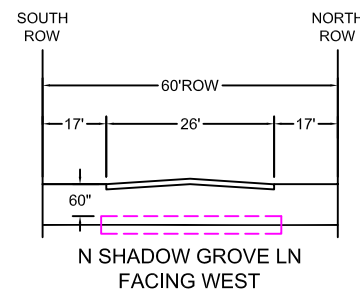

TYPICAL BORE CROSS-SECTION NTS

## FORT BEND COUNTY NOTIFICATION

— N SHADOW GROVE LN —  
E SHADOW GROVE LN

APPROXIMATE LOCATION MAP

WORK DONE IN FORT BEND COUNTY RIGHT OF WAY - PRINT FOR INFORMATIONAL PURPOSES ONLY

SPECIAL CIRCUITS N  
6203 FORWARDED N  
PERMIT REQUIRED Y

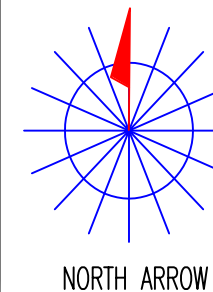

OPERATING RANGE OF JOB STEPS

TASK \_\_\_\_\_ TO \_\_\_\_\_

MFRC

TRANSMISSION ZONE  
RZ 0 CZ 0 TAPER CODE 1620PB

CAUTION HIGH VOLTAGE  
KV 0.00 AERIAL N BURIED N

HIGHWAY PERMIT NO.

Utility CO  
REP NAME  
REP TEL NO.  
POLE CONTACTS (+) 0 (-) 0

Utility CO  
REP NAME  
REP TEL NO.  
POLE CONTACTS (+) 0 (-) 0

Utility CO  
REP NAME  
REP TEL NO.  
POLE CONTACTS (+) 0 (-) 0

PROJECT NO A01A6ZG

TOT.PRINTS 121 PRINT NO. 113  
NPA/NNX: 281-232 PRT:281232

EXCH. RICH-ROSE

TAX DIST. FG009

GEO LOC. W89232

ENGR. DG DRAWN LF

TELEPHONE NO. (713) 213-2691

REC. REF.

MAP REF. 566S

SCALE NONE

ISSUE DATE

PROJ TITLE LIGHTGIG-1620PB-DIST-RR

REV. NUMBER

DATE REV.

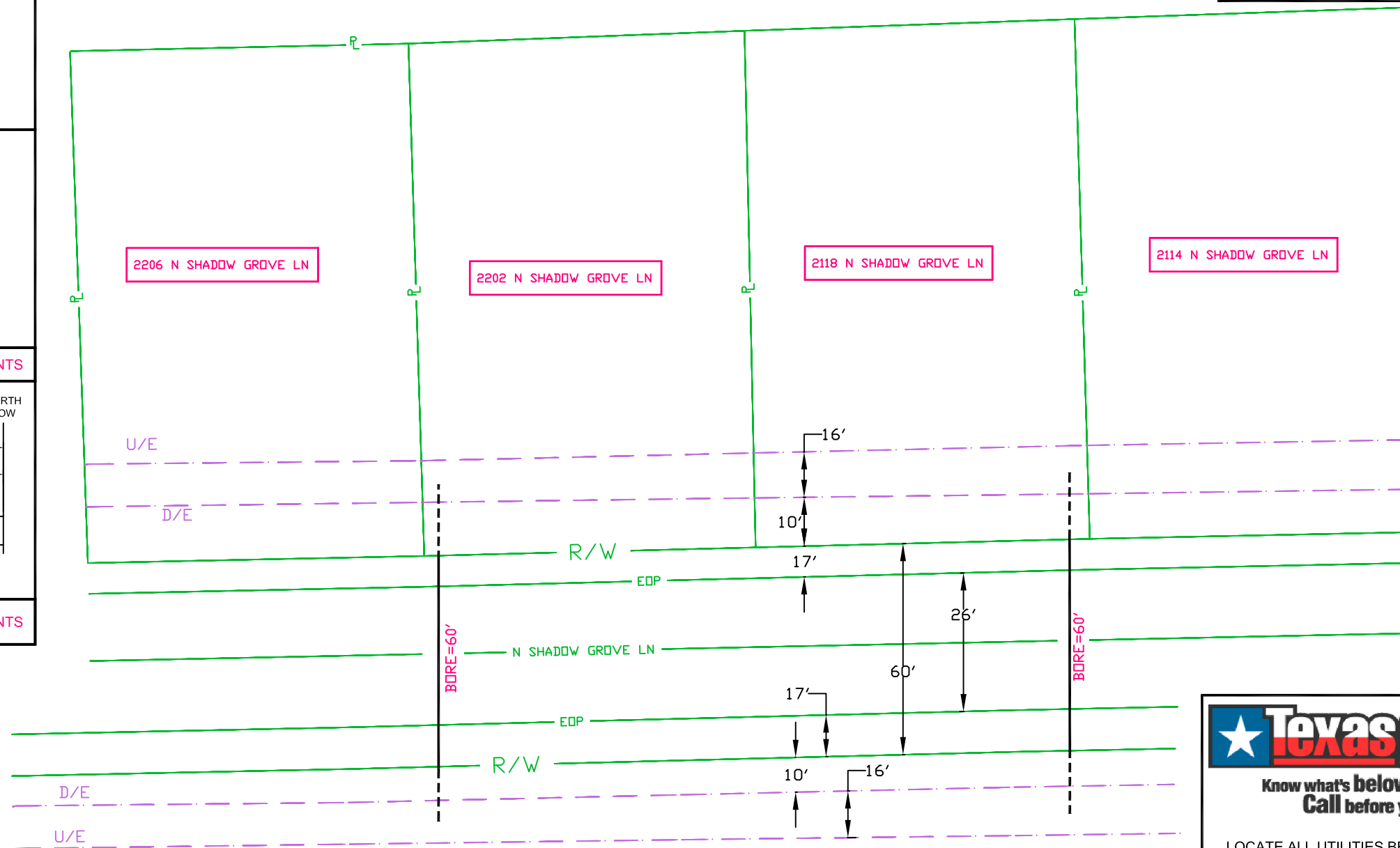

--Proprietary--

Not for use or disclosure outside the AT&T companies except under written agreement.

LOCATE ALL UTILITIES BEFORE DIGGING: 1-800-344-8377 OR 811

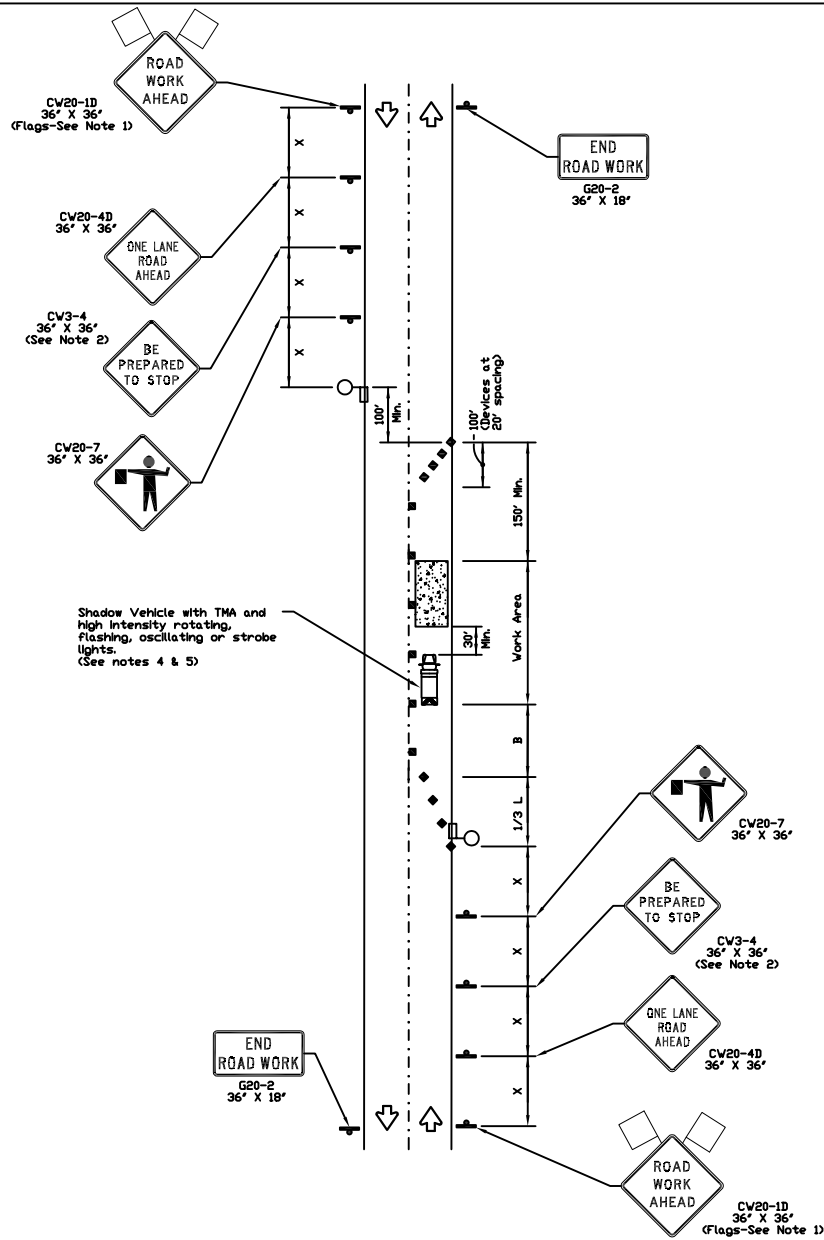

**ONE-LANE TWO-WAY SINGLE LANE CLOSURE  
CONTROL WITH FLAGGERS  
(ON STRAIGHT SECTION OF ROADWAY)**

TRAFFIC CONTROL PLAN SECTION SHALL BE  
COMPLETED BY ENGINEER

ROADWAY	POSTED SPEED	TAPER LENGTH	SPACING CHANNELIZING DEVICES		SIGN SPACING	BUFFER SPACE
			TAPER	TANGENT		
DRS DR	35	225'	35'	70'	160'	120'
HINSON ST	30	165'	30'	60'	120'	90'
S SHADOW GROVE LN	30	165'	30'	60'	120'	90'
N SHADOW GROVE LN	30	165'	30'	60'	120'	90'
HENESEY DR	30	165'	30'	60'	120'	90'

**LEGEND**

	Type 3 Barricade		Channelizing Devices
	Heavy Work Vehicle		Truck Mounted Attenuator (TMA)
	Trailer Mounted Flashing Arrow Board		Portable Changeable Message Sign (PCMS)
	Sign		Traffic Flow
	Flag		Flagger

Posted Speed 's	Formula	Minimum Desirable Taper Lengths 'L'			Suggested Maximum Spacing of Channelizing Devices		Minimum Sign Spacing 'X' Distance	Suggested Longitudinal Buffer Space 'B'
		10' Offset	11' Offset	12' Offset	On a Taper	On a Tangent		
30	L = $\frac{V^2}{60}$	150'	165'	180'	30'	60'	120'	90'
35		205'	225'	245'	35'	70'	160'	120'
40		265'	295'	320'	40'	80'	240'	155'
45	L = VS	450'	495'	540'	45'	90'	320'	195'
50		500'	550'	600'	50'	100'	400'	240'
55		550'	605'	660'	55'	110'	500'	295'
60	L = VS	600'	660'	720'	60'	120'	600'	350'
65		650'	715'	780'	65'	130'	700'	410'
70		700'	770'	840'	70'	140'	800'	475'
75	L = VS	750'	825'	900'	75'	150'	900'	540'
75		750'	825'	900'	75'	150'	900'	540'

\* Conventional Roads Only  
\*\* Taper lengths have been rounded off.  
L=Length of Taper(FT) V=Width of Offset(FT) S=Posted Speed(MPH)

- GENERAL NOTES**
- Flags attached to signs where shown are OPTIONAL.
  - All traffic control devices illustrated are REQUIRED, except those denoted with the triangle symbol are OPTIONAL.
  - Inactive work vehicles or other equipment should be parked near the right-of-way line and not parked on the paved shoulder.
  - A Shadow Vehicle with a TMA should be used anytime it can be positioned 30 to 100 feet in advance of the area of crew exposure without adversely affecting the performance or quality of the work. If workers are no longer present but road or work conditions require the traffic control to remain in place, Type 3 Barricades or other channelizing devices may be substituted for the Shadow Vehicle and TMA. Additional Shadow Vehicles with TMAs may be positioned off the paved surface, next to those shown in order to protect wider work spaces.
  - Contractor shall provide and install traffic control devices in conformance with part VI of Texas Manual on Uniform Traffic Control Devices (TMUTCD - Latest edition with revisions) during construction.
  - Flaggers should use two-way radios or other methods of communication to control traffic.
  - Length of work space should be based on the ability of flaggers to communicate.
  - If the work space is located near horizontal or vertical curve, the buffer distances should be increased in order to maintain adequate stopping sight distances to the flagger and a queue of stopped vehicles (see table above).
  - Channelizing devices on the center-line may be omitted when a pilot car is leading traffic and approved by the Engineer.
  - Flaggers should use 24" STOP/SLOW paddles to control traffic. Flags should be limited to emergency situations.
  - No lanes shall be blocked from 7am to 9am and 4pm to 6:30pm Monday thru Friday.
  - Off duty police officers required to direct traffic when applicable.
  - If project is within 400 feet from a signalized intersection, the Contractor shall contact Harris County Engineering Department, Traffic Signal Maintenance at (713) 861-3210 five (5) days prior to the start of construction.

SPECIAL CIRCUITS N  
6203 FORWARDED N  
PERMIT REQUIRED Y

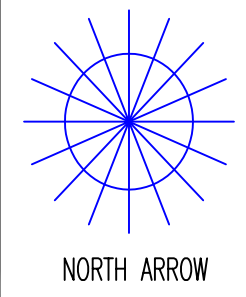

OPERATING RANGE OF JOB STEPS  
TASK \_\_\_\_\_ TO \_\_\_\_\_  
MFRC

TRANSMISSION ZONE  
RZ 0 CZ 0 TAPER CODE 1620PB

CAUTION HIGH VOLTAGE  
KV 0.00 AERIAL N BURIED N

HIGHWAY PERMIT NO.  
Utility CO  
REP NAME  
REP TEL NO.  
POLE CONTACTS (+) 0 (-) 0

Utility CO  
REP NAME  
REP TEL NO.  
POLE CONTACTS (+) 0 (-) 0

Utility CO  
REP NAME  
REP TEL NO.  
POLE CONTACTS (+) 0 (-) 0

PROJECT NO A01A6ZG

TOT.PRINTS 121 PRINT NO. 121  
NPA/NNX: 281-232 PRT:281232  
EXCH. RICH-ROSE  
TAX DIST. FG009  
GEO LOC. W89232  
ENGR. DG DRAWN LF  
TELEPHONE NO. (713) 213-2691

REC. REF.  
MAP REF.  
SCALE NONE  
ISSUE DATE  
PROJ TITLE LIGHTGIG-1620PB-DIST-RR  
REV. NUMBER  
DATE REV.

NO.	REVISIONS	DATE	NAME
1	UPDATED DEPARTMENT NAME & GENERAL NOTES	4/16/15	BSH

FORT BEND COUNTY  
ENGINEERING DEPARTMENT

FOR INTERIM REVIEW ONLY  
DOCUMENT INCOMPLETE:  
NOT INTENDED FOR CONSTRUCTION,  
BIDDING, OR PERMIT PURPOSES  
ENGINEER: NAME  
P.E. SERIAL No. NUMBER  
DATE: / /

PROJECT TITLE:  
DRAWN BY: BSH HCED STANDARD 39  
CK'D BY: BSH SHEET DESCRIPTION: TRAFFIC CONTROL PLAN (ONE-LANE, TWO-WAY OPERATION)  
SCALE: N.T.S.  
DATE: 6/26/14 APPROVED BY: SHEET NO: /