



Fort Bend County Engineering
FORT BEND COUNTY, TEXAS

Richard W. Stolleis, P.E.
County Engineer

May 30, 2018

Commissioner W. A. "Andy" Meyers
Fort Bend County Precinct 3
22333 Grand Corner Drive
Katy, Texas 77494

RE: Churchill Farms Subdivision – "No Thru Trucks" Signs

Dear Commissioner Meyers:

Fort Bend County Engineering Department has evaluated the request for No Thru Truck signs at the following locations within the Churchill Farms subdivision:

- Westbound Churchill Farms Boulevard, west of FM 1463
- Southbound Winston Ridge Lane, south of FM 1463
- Eastbound Satton Ranch Lane, east of the Fulshear City Limit

Through truck traffic currently cutting through the Churchill Farms subdivision will be adequately served by remaining on major thoroughfares in the area.

The attached Traffic Control Plan (TCP) shows the proposed locations for the "No Thru Trucks" signs.

The attached Commissioners Court Order establishes the thru truck restriction and imposes a criminal penalty for its violation.

If we can be of further assistance please do not hesitate to contact me at 281-633-7528 or chris.debaillon@fortbendcountytexas.gov.

Sincerely,

A handwritten signature in blue ink, appearing to read "Chris Debaillon".

Chris Debaillon, PE, PTOE
Assistant County Engineer - Traffic

CDD/mjs

cc: Judge Robert E. Hebert, County Judge
Marc Grant - FBC Road & Bridge
Brian Fields - Signage Department
File

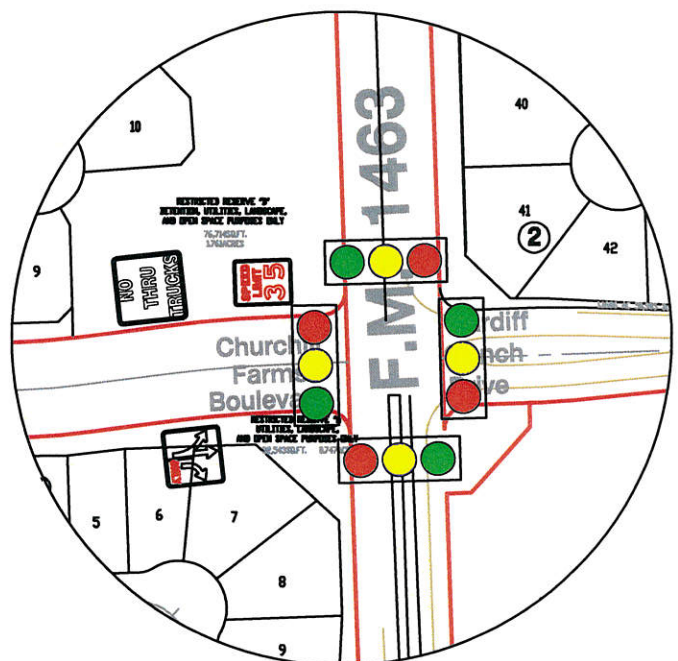
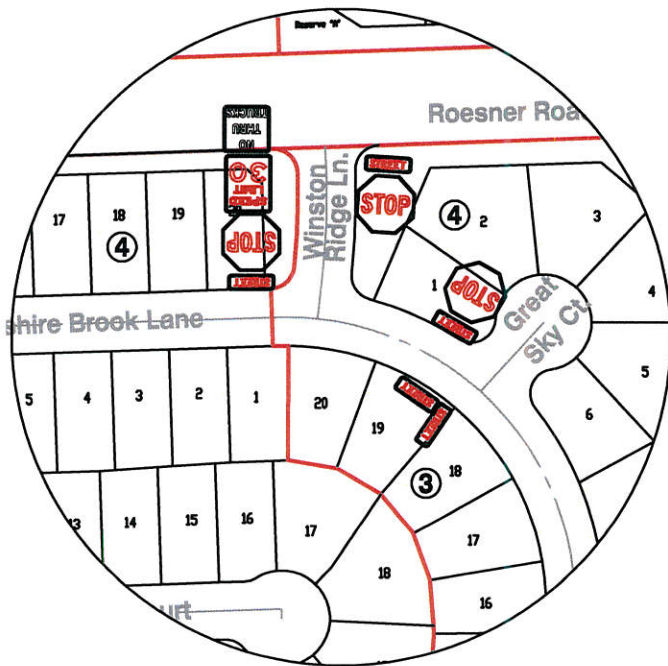
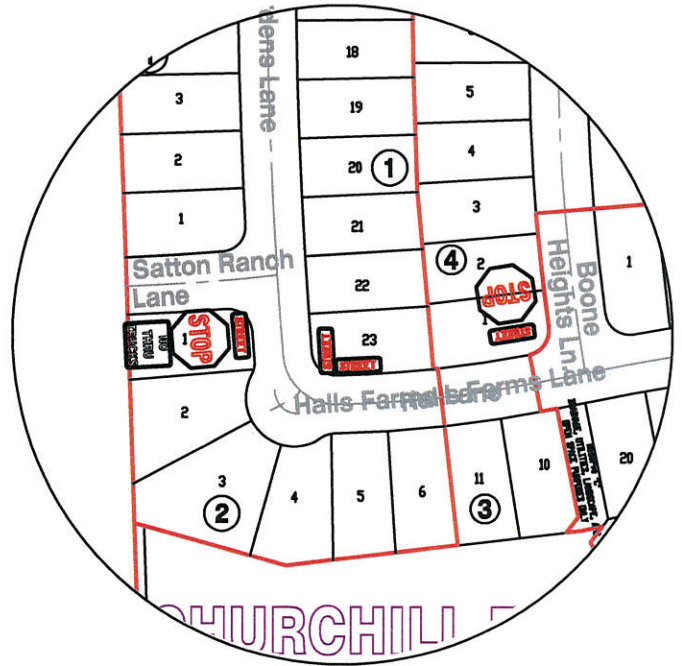

Note:

The purpose of this traffic control plan is to revise traffic control for Churchill Farms Subdivision with the addition of "No Thru Trucks" (R5-2) as indicated on the drawing.

Drawn By: L. Brdecka

Date: 5-21-18

Approved By: Chris Deballion, PE PTOE

Date: 5/25/18

Scale
1" = 200'-0"

**Churchill Farms Subdivision
(Revised) Control Map and
Traffic Sign Layout**

Fort Bend County Engineering Dept.
301 Jackson Street
Richmond, Texas 77469

**AN ORDER OF THE COMMISSIONERS COURT OF FORT BEND COUNTY, TEXAS
IMPOSING THRU TRUCKS RESTRICTION ON
SATTON RANCH LANE
IN PRECINCT 3
AND IMPOSING A CRIMINAL PENALTY FOR
VIOLATION OF THIS ORDER**

WHEREAS, the Commissioners Court of Fort Bend County, Texas has determined that imposing a Thru Trucks restriction on Satton Ranch Lane in Precinct 3 would be a valuable law enforcement tool of benefit to the public by lessening the danger to the public, increasing the efficiency of traffic flow and control, and decreasing the number of accidents to which public safety agencies must respond at the expense of the taxpayers; and

WHEREAS, Section 251.151 of the Texas Transportation Code establishes authority for the Commissioners Court of Fort Bend County to regulate traffic on a county road that is under the jurisdiction of the Commissioners Court; and

WHEREAS, Section 251.155(a) of the Texas Transportation Code establishes authority for the Commissioners Court of Fort Bend County to adopt regulations establishing a system of traffic control devices in restricted traffic zones; and

WHEREAS, Section 251.161 of the Texas Transportation Code establishes authority for the Commissioners Court of Fort Bend County to impose a criminal penalty for violations of said regulations; and

WHEREAS, a public hearing as required by Texas Transportation Code Section 251.152 was held on July 10, 2018, prior to the Commissioners Court of Fort Bend County imposing a Thru Trucks restriction on Satton Ranch Lane, which is a public road located in the unincorporated area of Fort Bend County; and

WHEREAS, the Commissioners Court of Fort Bend County finds and determines that it is necessary for safety to the public to impose a Thru Trucks restriction for traffic flow on Satton Ranch Lane located in Precinct 3.

NOW, THEREFORE, BE IT ORDERED BY THE COMMISSIONERS COURT OF FORT BEND COUNTY, TEXAS:

Article I. Definitions

Section 1.1 In this Order, the following words and phrases shall have the meaning ascribed in this Section 1.1:

Commissioners Court: Fort Bend County, Texas, acting by and through its Commissioners Court.

Person: An individual, company, partnership, firm, corporation, association, or other legal entity.

Thru Truck: A Truck accessing Churchill Farms Boulevard or Winston Ridge Lane from FM 1463 which then travels on Satton Ranch Lane west of Norwich Gardens Lane, or a Truck accessing Norwich Gardens Lane from Satton Ranch Lane and then travels to FM 1463 from Winston Ridge Lane or Churchill Farms Lane.

Truck: A motor vehicle or combination of motor vehicles used to transport construction materials or debris.

Article II. Thru Trucks Restriction

Section 2.1 The Commissioners Court of Fort Bend County, Texas, imposes a restriction prohibiting Thru Trucks traveling on Satton Ranch Lane, from the intersection of Satton Ranch Lane and Norwich Gardens Lane, to the Fulshear City Limit. Only trucks with a destination accessible solely by travel on Satton Ranch Lane are permitted.

Section 2.2 The Commissioners Court of Fort Bend County, Texas, shall cause signs to be installed along Satton Ranch Lane, Winston Ridge Lane, and Churchill Farms Boulevard designating the Thru Trucks restriction imposed by this Order.

Section 2.3 The signs must be within 100 feet of the intersections described in Section 2.1 or located according to standards established in the manual adopted by the Texas Transportation Commission under Section 544.001 of the Texas Transportation Code. The signs must be easily readable to any operator of a motor vehicle approaching the intersections.

Article III. Offense

Section 3.1 It shall be unlawful for any person to operate a Truck in violation of this Order.

Section 3.2 A person commits a misdemeanor offense punishable by a fine not to exceed \$200.00 if the person operates a Truck in violation of this Order, as authorized by Section 251.161(b) of the Texas Transportation Code.

Article IV. Effective Date

Section 4.1 The effective date of this Order shall be July 17, 2018.

Article V. General Provisions

Section 5.1 All orders or parts of orders inconsistent with the terms of this Order are hereby repealed; provided, however, that such repeal shall be only to the extent of such inconsistency of other orders regulating and governing the subject matter covered by this Order.

Section 5.2 If any provision, section, exception, subsections, paragraph, sentence, clause, or phrase of this Order, or the application of same to any person or set of circumstances, shall for any reason be held unconstitutional, void, or invalid, such provision(s) of this Order or its(their) application to other sets of circumstances are declared to be severable.

Approved by the Commissioners Court of Fort Bend County, Texas, this _____ day of _____, 2018.

FORT BEND COUNTY, TEXAS

By: _____
Robert E. Hebert, County Judge

ATTEST:

Laura Richard, County Clerk

CERTIFICATE FOR ORDER

THE STATE OF TEXAS §
§
COUNTY OF FORT BEND §

On this the _____ day of _____, 2018, at a **Regular Session** meeting of the Commissioners Court of Fort Bend County, Texas, there came on for consideration and approval a motion for the Commissioners Court to approve and adopt "An Order of the Commissioners Court of Fort Bend County, Texas Imposing Thru Trucks Restriction on Satton Ranch Lane in Precinct 3 and Imposing a Criminal Penalty for Violation of This Order," in accordance with the Order attached hereto and incorporated herein. The authority for imposing said traffic regulations derives from Chapter 251, Subchapter E, Texas Transportation Code. A public hearing as required by Texas Transportation Code Section 251.152 was held on this date.

Motion was made by Commissioner _____ and seconded by Commissioner _____ that said Commissioners Court does hereby approve and adopt the attached Order for Fort Bend County.

Said Motion being put to vote, it carried by a vote of ____ "aye" votes to ____ "nay" votes.

THEREFORE, ITS IS HEREBY APPROVED AND ORDERED that the attached "Order of the Commissioners Court of Fort Bend County, Texas Imposing Thru Trucks Restriction on Satton Ranch Lane in Precinct 3 and Imposing a Criminal Penalty for Violation of This Order" shall be implemented and applicable, effective July 17, 2018, under the authority of Section 251.151 of the Texas Transportation Code, thereby prohibiting through traffic by trucks used to transport construction materials on Satton Ranch Lane in Precinct 3, Fort Bend County, Texas.

SIGNED AND SEALED this _____ day of _____, 2018.

County Clerk
(SEAL)

County Judge