



**PERMIT APPLICATION REVIEW FORM FOR
CABLE, CONDUIT, AND POLE LINE ACTIVITY
IN FORT BEND COUNTY**

**Fort Bend County
Engineering Department**
301 Jackson Suite 401
Richmond, Texas 77469
281.633.7500
Permits@fortbendcountytx.gov

- Right of Way Permit**
 Commercial Driveway Permit

Permit No: 2018-18571

The following "Notice of Proposed Cable, Conduit, and/or Pole Line activity in Fort Bend County" and accompanying attachments have been reviewed and the notice conforms to appropriate regulations set by Commissioner's Court of Fort Bend County, Texas.

(1) COMPLETE APPLICATION FORM:

- a. Name of road, street, and/or drainage ditch affected.
 b. Vicinity map showing course of directions
 c. Plans and specifications

(2) BOND:

- County Attorney, approval when applicable.
- Perpetual bond currently posted. Bond No: Amount: \$100,000.00
- Performance bond submitted. Bond No: Amount:
- Cashier's Check Check No: Amount:

(3) DRAINAGE DISTRICT APPROVAL (WHEN APPLICABLE):

Drainage District Approval

Date

We have reviewed this project and agree it meets minimum requirements.

Charles O. Ay

Permit Administrator

2/19/2018

Date



**REVIEW BY FORT BEND COUNTY
COMMISSIONERS COURT**

**Fort Bend County
Engineering Department**
301 Jackson Suite 401
Richmond, Texas 77469
281.633.7500
Permits@fortbendcountytx.gov

Right of Way Permit

Commercial Driveway Permit

Permit No: 2018-18571

Applicant: Comcast of Houston, LLC

Job Location Site: 1319 Circle Lake Drive, Katy, TX 77494

Bond No. **Date of Bond:** 7/24/2007 **Amount:** \$100,000.00

The above applicant came to make use of certain Fort Bend County property subject to, "The Order Regulating the Laying, Construction, Maintenance, and Repair of Buried Cables, Conduits, and Pole Lines, In, Under, Across or Along Roads, Streets, Highways, and Drainage Ditches in Fort Bend County, Texas, Under the Jurisdiction of the Commissioners Court of Fort Bend County, Texas," as passed by the Commissioners Court of Fort Bend County, Texas, of the Minutes of the Commissioners Court of Fort Bend County, Texas, to the extent that such order is not inconsistent with Chapter 181, Vernon's Texas Statutes and Codes Annotated.

Notes:

1. Evidence of review by the Commissioners Court must be kept on the job site and failure to do so constitutes grounds for job shutdown.
2. Written notices are required:
 - a. 48 hours in advance of construction start up, and
 - b. When construction is completed and ready for final inspection, submit notification to Permit Administrator thru MyGovernmentOnline.org portal.
3. This permit expires one (1) year from date of permit if construction has not commenced.

On this 27th day of February, 2018, Upon Motion of Commissioner _____, seconded by Commissioner _____, duly put and carried, it is ORDERED, ADJUDGED AND DECREED that said notice of said above purpose is hereby acknowledged by the Commissioners Court of Fort Bend County, Texas, and that said notice be placed on record according to the regulation order thereof.

Signature

Presented to Commissioners Court and approved.

By: 
County Engineer

Date Recorded _____ Comm. Court No. _____

By: N/A
Drainage District Engineer/Manager

Clerk of Commissioners Court

By: _____
Deputy

NOTE: CONTRACTOR SHALL BORE ALL DRIVEWAYS.

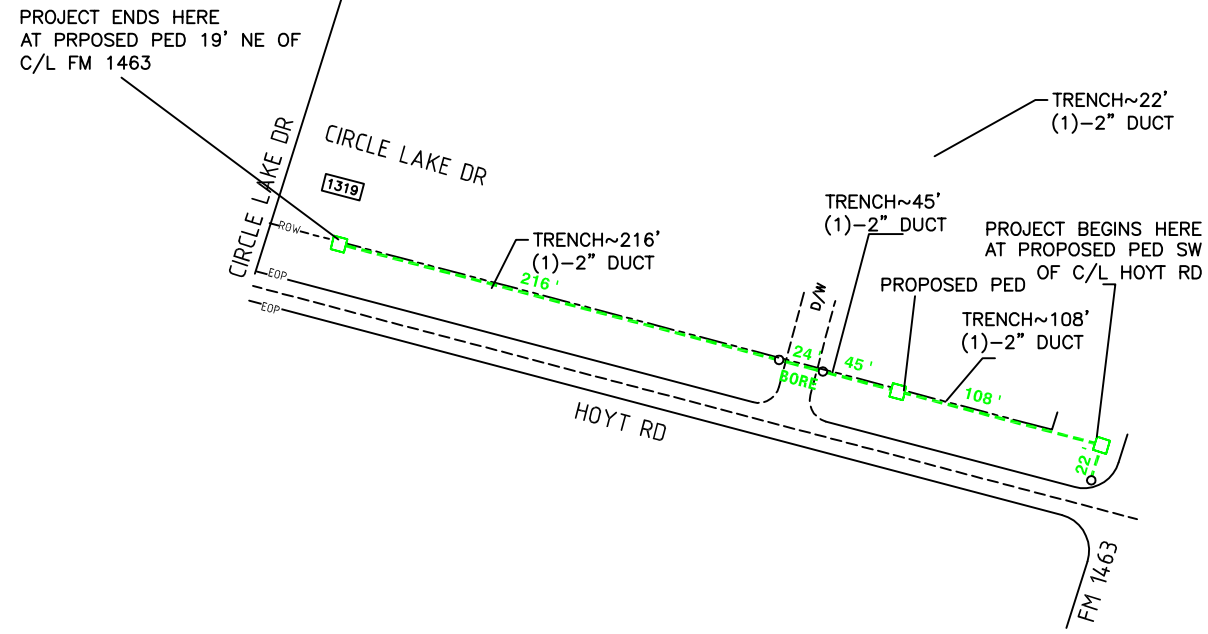
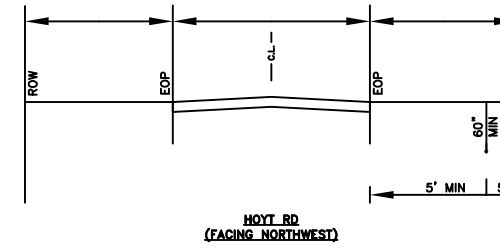

- NOTES:
1. THE CONTRACTOR SHALL CONTACT TEXAS ONE CALL SYSTEM AT 1-800-245-4545 MIN. 48 HOURS BEFORE DIGGING
 2. THE CONTRACTOR SHALL DETERMINE THE EXACT LOCATION OF ALL UNDERGROUND FACILITIES BEFORE COMMENCING WORK AND AGREE TO BE FULLY RESPONSIBLE FOR ALL DAMAGES CAUSED BY HIS FAILURE TO EXACTLY LOCATE AND PRESERVE ALL UNDERGROUND FACILITIES.
 3. NO MORE TRENCH OPENED AT ONE TIME THAN CAN BE BACKFILLED AND COMPACTED IN 10" LIFTS AT THE END OF EACH DAY. (NO TRENCH LEFT OPENED OVERNIGHT)
 4. ALL EXCESS EXCAVATION TO BE REMOVED FROM THE ROAD RIGHT-OF-WAY AT THE END OF EACH DAY.
 5. DITCHES TO BE OPENED AT THE END OF EACH DAY TO ASSURE ADEQUATE DRAINAGE.
 6. ROAD MUST BE KEPT OPEN TO TRAFFIC AND CONTRACTOR MUST PROVIDE ADEQUATE FLAGMEN, SIGNALS, ETC., TO PROVIDE COMPLETE SAFETY TO THE PUBLIC.
 7. IF IT BECOMES NECESSARY FOR EQUIPMENT TO OPERATE ON A PORTION OF THE PAVEMENT, PRECAUTIONS MUST BE TAKEN TO PREVENT ANY DAMAGE WHATSOEVER TO THE PAVEMENT.
 8. CONDITION OF ROAD UPON COMPLETION OF JOB SHALL BE AS GOOD OR BETTER THAN PRIOR TO STARTING.
 9. CONTRACTOR SHALL COMPLY WITH ALL APPLICABLE NATIONAL ELECTRICAL SAFETY CODE (NEC) REQUIREMENTS, CENTERPOINT ENERGY ELECTRIC POLE ATTACHMENT GUIDELINES & PROCEDURES AND ALL APPLICABLE LOCAL REQUIREMENTS AND REGULATIONS FOR PLACEMENT OF AERIAL CABLE FACILITIES. 18' MIN. VERTICAL CLEARANCE



COMCAST TO START AT SW OF C/L HOYT RD AND CONTINUE NW 437' WITH DIRECTIONAL BORE AND TRENCH, PLACING 3 PEDS AS SHOWN. INSTALL CONDUIT AND PULL CABLE THROUGH. TOTAL FOOTAGE 437'.

67896 - 1319 HOYT RD - FORT BEND

DESIGNED BY: TRUENET COMMUNICATIONS
 DRAWN BY: WTB
 DWG. NO.
 SHEET NO. 1 OF 1

LAMBERT:
 DATE: 02/08/2018
 KEY MAP NO:
 SCALE: NTS



DISCLAIMER: The use of this standard is governed by the "Texas Engineering Practice Act". No warranty of any kind is made by TxDOT for any purpose whatsoever. TxDOT assumes no responsibility for the conversion of this standard to other formats or for incorrect results or damages resulting from its use.

Warning sign and rumble strip sequence in opposite direction is same as below

Flagger to Flagger (Length of Work Area)	ADT	# of Rumble Strip Arrays
1/8 Mile	< 4,500	1
	≥ 4,500	2
1/4 Mile	< 3,500	1
	≥ 3,500	2
1/2 Mile	< 2,600	1
	≥ 2,600	2
1 Mile	< 1,600	1
	≥ 1,600	2
> 1 Mile	N/A	2

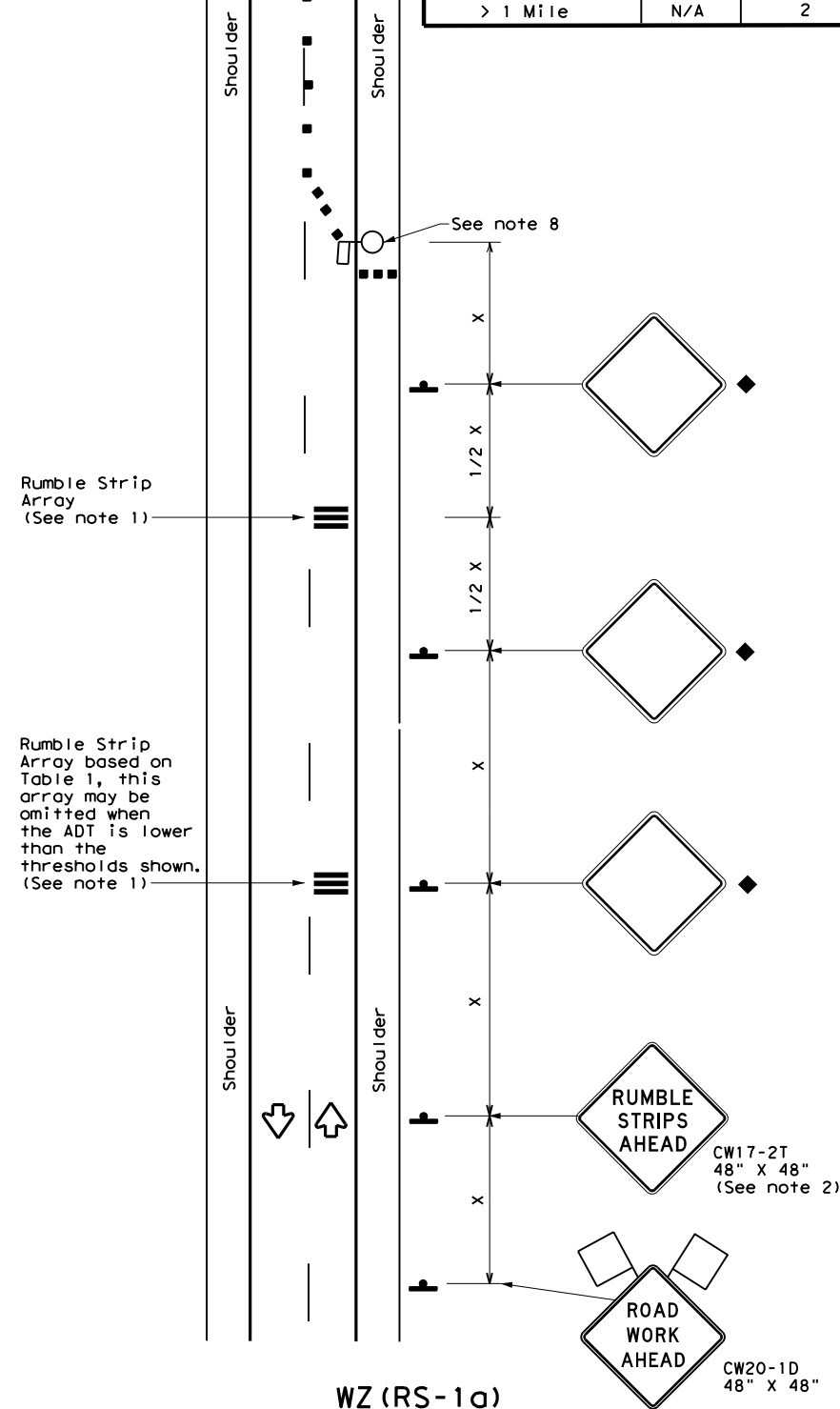

WZ (RS-1a)
75 mph or Less
RUMBLE STRIPS ON ONE-LANE TWO-WAY APPLICATION

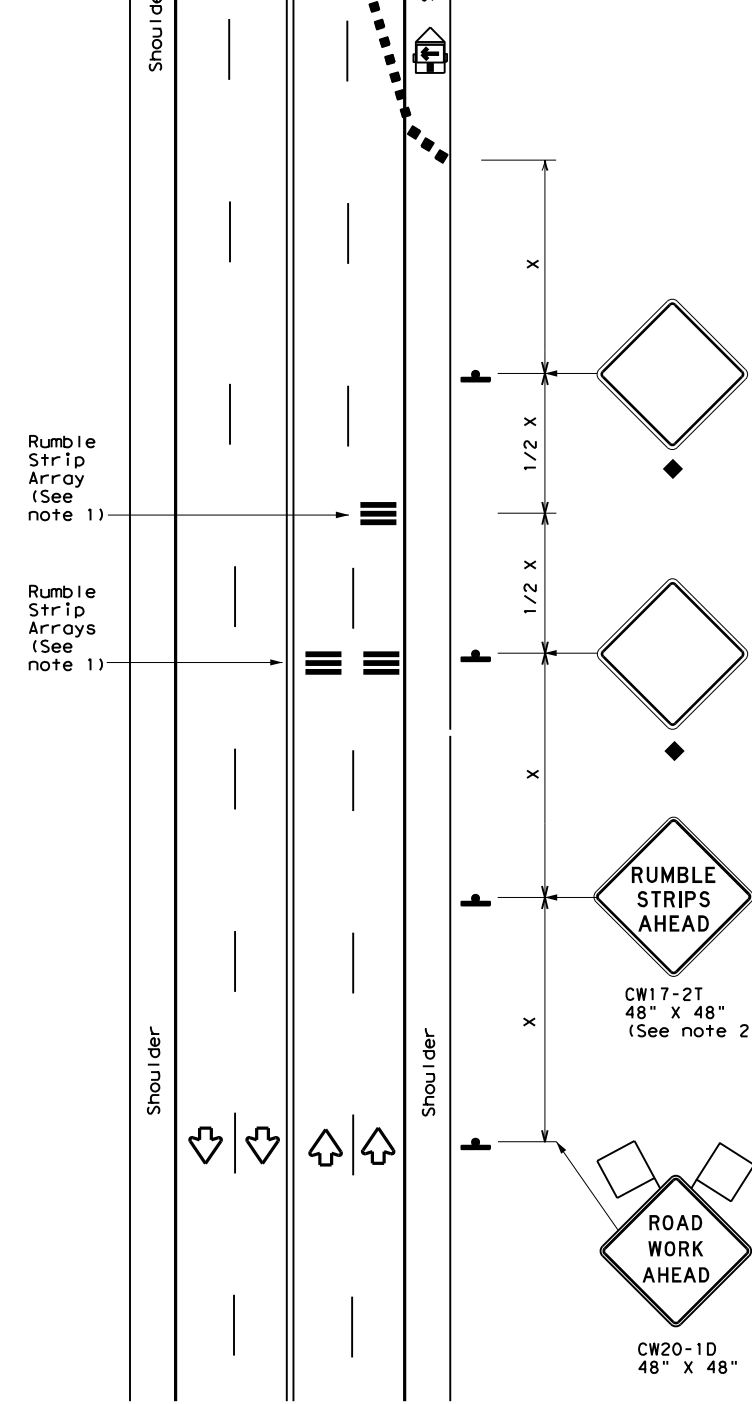

WZ (RS-1b)
75 mph or Less
RUMBLE STRIPS FOR LANE CLOSURE ON CONVENTIONAL ROADWAY

GENERAL NOTES

- Each Rumble Strip Array should consist of three rumble strips spaced center to center at the spacing shown in Table 2, placed transverse across the lane at locations shown.
- The CW17-2T "RUMBLE STRIPS AHEAD" sign should be located after the CW20-1D "ROAD WORK AHEAD" sign and spaced as shown. If traffic is observed to be queuing, or is expected to queue beyond the Rumble Strips, the CW17-2T sign and the first Rumble Strip Array may be located upstream of the CW20-1D sign as necessary to provide needed warning.
- Temporary Rumble Strips will be considered subsidiary to Item 502, and shall be a product listed on the Compliant Work Zone Traffic Control Devices.
- Removal of the Temporary Rumble Strips should be accomplished before removing the advance warning signs.
- Temporary Rumble Strips should not be used on horizontal curves, loose gravel, soft or bleeding asphalt, heavily rutted pavements or unpaved surfaces.
- Temporary Rumble Strips shall be installed and maintained as per manufacturer's recommendations.
- This standard sheet shall be used in conjunction with other appropriate TCP standard, TMUTCD typical application or project specific detail for the project.
- The one-lane two-way application may utilize a flagger, an AFAD or a portable traffic signal.
- Temporary Rumble Strips may be used on freeways or expressways based on engineering judgment.

Speed	Approximate distance between strips in an Array
≤ 40 MPH	10'
> 40 MPH & ≤ 55 MPH	15'
> 55 MPH	20'

	Type 3 Barricade		Channelizing Devices
	Heavy Work Vehicle		Truck Mounted Attenuator (TMA)
	Trailer Mounted Flashing Arrow Panel		Portable Changeable Message Sign (PCMS)
	Sign		Traffic Flow
	Flag		Flagger

Posted Speed *	Formula	Minimum Desirable Taper Lengths **			Suggested Maximum Spacing of Channelizing Devices		Minimum Sign Spacing "x" Distance	Suggested Longitudinal Buffer Space "B"
		10' Offset	11' Offset	12' Offset	On a Taper	On a Tangent		
30	L = WS ² / 60	150'	165'	180'	30'	60'	120'	90'
35		205'	225'	245'	35'	70'	160'	120'
40		265'	295'	320'	40'	80'	240'	155'
45	L = WS	450'	495'	540'	45'	90'	320'	195'
50		500'	550'	600'	50'	100'	400'	240'
55		550'	605'	660'	55'	110'	500'	295'
60		600'	660'	720'	60'	120'	600'	350'
65		650'	715'	780'	65'	130'	700'	410'
70	700'	770'	840'	70'	140'	800'	475'	
75	750'	825'	900'	75'	150'	900'	540'	

* Conventional Roads Only
 ** Taper lengths have been rounded off.
 L=Length of Taper (FT) W=Width of Offset (FT)
 S=Posted Speed (MPH)

MOBILE	SHORT DURATION	SHORT TERM STATIONARY	INTERMEDIATE TERM STATIONARY	LONG TERM STATIONARY
	✓	✓		

◆ Signs are for illustrative purposes only. Signs required may vary depending on the TCP, TMUTCD Typical Application, or project specific details for the project.

Texas Department of Transportation
 Traffic Operations Division Standard

TEMPORARY RUMBLE STRIPS

WZ (RS) - 16

FILE: wzrs16.dgn DN: TxDOT CK: TxDOT DW: TxDOT CK: TxDOT
 © TxDOT November 2012 CONT SECT JOB HIGHWAY
 REVISIONS
 2-14 DIST COUNTY SHEET NO.
 4-16

DATE:
FILE:



Installation Application
Online version 4/2006

Notice of Proposed Installation Utility Line On TxDOT Highway Right of Way

To the Texas Transportation Commission
c/o District Engineer
Texas Department of Transportation
Houston District, Texas

Date 2/2/2018
Application No. HOU20180202111818

Formal notice is hereby given that Comcast of Houston, LLC
proposes to install a utility facility within the right-of-way of FM1463
in Fort Bend County, Texas as follows: (details are shown on page 2)

COMCAST TO START AT EXISTING PED 323' SW OF C/L HOYT RD AND CONTINUE NE WITH 312' OF TRENCH AND DIRECTIONAL BORE AS NOTED. INSTALL CONDUIT AND PULL CABLE THROUGH. TOTAL FOOTAGE 312'.

The line will be constructed and maintained on the highway right-of-way as shown on the attached drawing and in accordance with the rules, regulations and policies of the Texas Department of Transportation (TxDOT), and all governing laws, including but not limited to the "Federal Clean Water Act," the "National Endangered Species Act," and the "Federal Historic Preservation Act." Upon request by TxDOT, proof of compliance with all governing laws, rules and regulations will be submitted to TxDOT before commencement of construction.

Our firm will use Best Management Practices to minimize erosion and sedimentation resulting from the proposed installation, and we will revegetate the project area as indicated under "Revegetation Special Provisions."

Our firm will ensure that traffic control measures complying with applicable portions of the Texas Manual of Uniform Traffic Control Devices will be installed and maintained for the duration of this installation.

The location and description of the proposed installation and appurtenances is more fully shown by 1 files containing drawings and other pertinent information uploaded to the website.

Construction will begin on or after February 9, 2018 and end on or before April 9, 2018.

I certify that I am authorized to represent the Firm listed below, and that our Firm agrees to the conditions/provisions included in this notice.

Utility Installation Owner Comcast of Houston, LLC
By Juan Jimenez
Title Permit Coordinatator
Address 7033 Airport Blvd.
Houston, TX 77061
Phone No. 281-624-3015
E-mail address juan_jimenez@cable.comcast.com

Application Details

Application No. HOU20180202111818
Date 2/2/2018
Utility Installation Owner Comcast of Houston, LLC
By Juan Jimenez
TxDOT District Houston District
County Fort Bend
Route FM1463
Control Section 018810
Description COMCAST TO START AT EXISTING PED 323'
SW OF C/L HOYT RD AND CONTINUE NE
WITH 312' OF TRENCH AND DIRECTIONAL
BORE AS NOTED. INSTALL CONDUIT AND
PULL CABLE THROUGH. TOTAL FOOTAGE
312'.
Attachments 67896 - 1319 HOYT LN - TXDOT.PDF

TxDOT - Houston District
CHECKLIST FOR REVIEW OF NOTICES OF PROPOSED INSTALLATION
Online version 08/2017

Yes No N/A

Are the utility plans legible, drawn to scale, and accurately dimensioned?

Is the location of the proposed utility facility clearly shown on the plans?

Is the profile of the bore shown on drawings?

Is the right of way line clearly shown and the distance of the utility line from the edge of pavement shown on the plans?

Do the plans show how the proposed installations connect to existing infrastructures on both ends of the proposed utility?

Do the plans show the required slack coil to be placed in adjacent vault/handhole/manhole/ductbank? Minimum of 50' of slack coil for installations greater than 500' or minimum of 100' of slack coil for installations greater than 1,000'.

For aerial installations, do the plans clearly show and differentiate between existing poles and new poles?

For aerial installations, do the plans call out the vertical and/or horizontal clearance?

Are other existing utility lines shown on the plans? Including vertical elevations and horizontal alignments.

It is understood that a copy of the permit MUST be on the job site during any construction.

It is understood that it responsibility of the utility owner to contact TxDOT 48 hrs prior to the start of construction using the UIR System. It is also the owners to responsibility to contact TxDOT once the construction is complete.

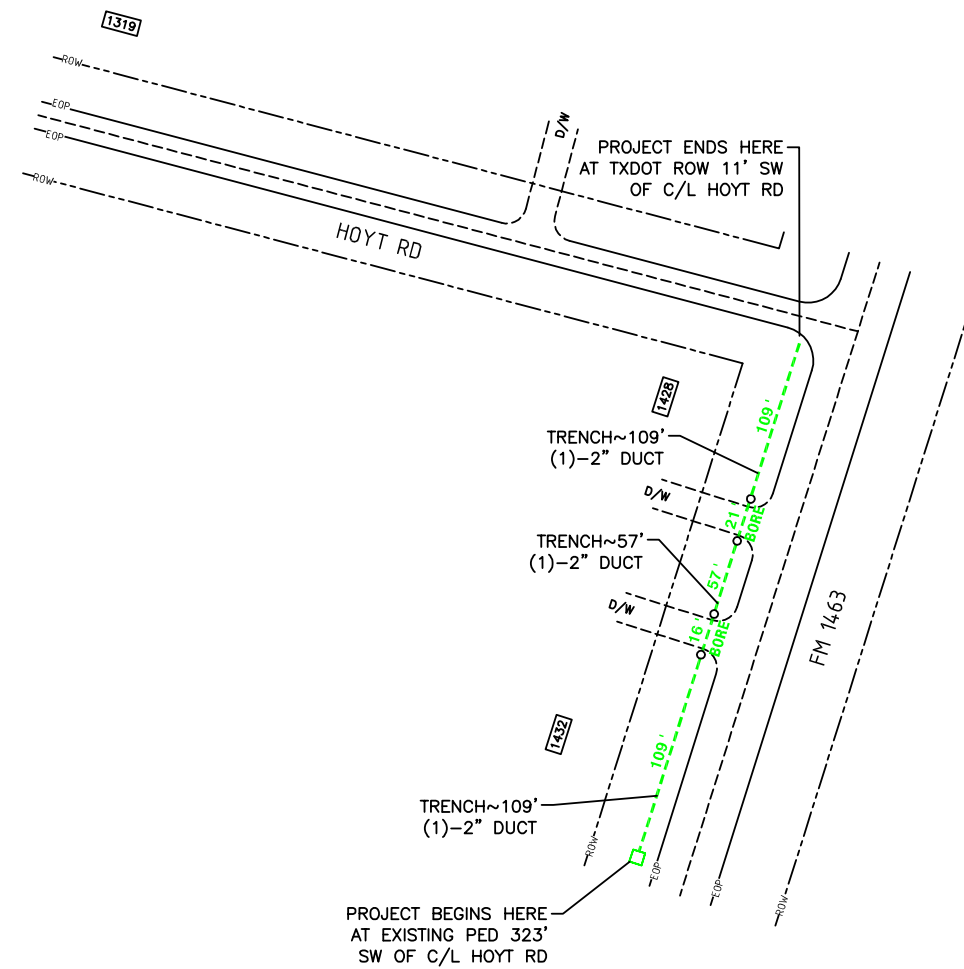

NOTE: CONTRACTOR SHALL
BORE ALL DRIVEWAYS.

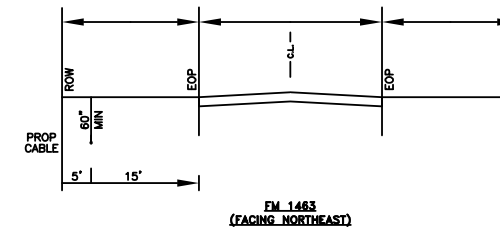

NOTES:

1. THE CONTRACTOR SHALL CONTACT TEXAS ONE CALL SYSTEM AT 1-800-245-4545 MIN. 48 HOURS BEFORE DIGGING
2. THE CONTRACTOR SHALL DETERMINE THE EXACT LOCATION OF ALL UNDERGROUND FACILITIES BEFORE COMMENCING WORK AND AGREE TO BE FULLY RESPONSIBLE FOR ALL DAMAGES CAUSED BY HIS FAILURE TO EXACTLY LOCATE AND PRESERVE ALL UNDERGROUND FACILITIES.
3. NO MORE TRENCH OPENED AT ONE TIME THAN CAN BE BACKFILLED AND COMPACTED IN 10" LIFTS AT THE END OF EACH DAY. (NO TRENCH LEFT OPENED OVERNIGHT)
4. ALL EXCESS EXCAVATION TO BE REMOVED FROM THE ROAD RIGHT-OF-WAY AT THE END OF EACH DAY.
5. DITCHES TO BE OPENED AT THE END OF EACH DAY TO ASSURE ADEQUATE DRAINAGE.
6. ROAD MUST BE KEPT OPEN TO TRAFFIC AND CONTRACTOR MUST PROVIDE ADEQUATE FLAGMEN, SIGNALS, ETC., TO PROVIDE COMPLETE SAFETY TO THE PUBLIC.
7. IF IT BECOMES NECESSARY FOR EQUIPMENT TO OPERATE ON A PORTION OF THE PAVEMENT, PRECAUTIONS MUST BE TAKEN TO PREVENT ANY DAMAGE WHATSOEVER TO THE PAVEMENT.
8. CONDITION OF ROAD UPON COMPLETION OF JOB SHALL BE AS GOOD OR BETTER THAN PRIOR TO STARTING.
9. CONTRACTOR SHALL COMPLY WITH ALL APPLICABLE NATIONAL ELECTRICAL SAFETY CODE (NEC) REQUIREMENTS, CENTERPOINT ENERGY ELECTRIC POLE ATTACHMENT GUIDELINES & PROCEDURES AND ALL APPLICABLE LOCAL REQUIREMENTS AND REGULATIONS FOR PLACEMENT OF AERIAL CABLE FACILITIES. 18' MIN. VERTICAL CLEARANCE



COMCAST TO START AT EXISTING PED 323' SW OF C/L HOYT RD AND CONTINUE NE WITH 312' OF TRENCH AND DIRECTIONAL BORE AS NOTED. INSTALL CONDUIT AND PULL CABLE THROUGH. TOTAL FOOTAGE 312'.

67896 - 1319 HOYT RD - TXDOT

DESIGNED BY: TRUENET
COMMUNICATIONS
DRAWN BY: WTB
DWG. NO.
SHEET NO. 1 OF 1

LAMBERT:
DATE: 02/02/2018
KEY MAP NO:
SCALE: NTS

