



**PERMIT APPLICATION REVIEW FORM FOR  
CABLE, CONDUIT, AND POLE LINE ACTIVITY  
IN FORT BEND COUNTY**

**Fort Bend County  
Engineering Department**  
301 Jackson Suite 401  
Richmond, Texas 77469  
281.633.7500  
[Permits@fortbendcountytx.gov](mailto:Permits@fortbendcountytx.gov)

- Right of Way Permit**  
 **Commercial Driveway Permit**

Permit No: 2018-18535

The following "Notice of Proposed Cable, Conduit, and/or Pole Line activity in Fort Bend County" and accompanying attachments have been reviewed and the notice conforms to appropriate regulations set by Commissioner's Court of Fort Bend County, Texas.

**(1) COMPLETE APPLICATION FORM:**

- a. Name of road, street, and/or drainage ditch affected.  
 b. Vicinity map showing course of directions  
 c. Plans and specifications

**(2) BOND:**

- County Attorney, approval when applicable.
- Perpetual bond currently posted.      Bond No:                           Amount: \$50,000.00
- Performance bond submitted.      Bond No:                           Amount:
- Cashier's Check      Check No:                           Amount:

**(3) DRAINAGE DISTRICT APPROVAL (WHEN APPLICABLE):**

\_\_\_\_\_  
Drainage District Approval

\_\_\_\_\_  
Date

**We have reviewed this project and agree it meets minimum requirements.**

*Charles O. Ay*

\_\_\_\_\_  
Permit Administrator

2/16/2018

\_\_\_\_\_  
Date



**REVIEW BY FORT BEND COUNTY  
COMMISSIONERS COURT**

**Fort Bend County  
Engineering Department**  
301 Jackson Suite 401  
Richmond, Texas 77469  
281.633.7500  
[Permits@fortbendcountytx.gov](mailto:Permits@fortbendcountytx.gov)

- Right of Way Permit**
- Commercial Driveway Permit**

Permit No: 2018-18535

**Applicant:** AT&T Texas/Black & Veatch

**Job Location Site:** 8002 Vista Del Sol Drive, Houston, TX 77083

**Bond No.**                      **Date of Bond:** 11/28/2017 **Amount:** \$50,000.00

The above applicant came to make use of certain Fort Bend County property subject to, "The Order Regulating the Laying, Construction, Maintenance, and Repair of Buried Cables, Conduits, and Pole Lines, In, Under, Across or Along Roads, Streets, Highways, and Drainage Ditches in Fort Bend County, Texas, Under the Jurisdiction of the Commissioners Court of Fort Bend County, Texas," as passed by the Commissioners Court of Fort Bend County, Texas, of the Minutes of the Commissioners Court of Fort Bend County, Texas, to the extent that such order is not inconsistent with Chapter 181, Vernon's Texas Statutes and Codes Annotated.

**Notes:**

1. Evidence of review by the Commissioners Court must be kept on the job site and failure to do so constitutes grounds for job shutdown.
2. Written notices are required:
  - a. 48 hours in advance of construction start up, and
  - b. When construction is completed and ready for final inspection, submit notification to Permit Administrator thru [MyGovernmentOnline.org](http://MyGovernmentOnline.org) portal.
3. This permit expires one (1) year from date of permit if construction has not commenced.

On this 27th day of February, 2018, Upon Motion of Commissioner \_\_\_\_\_, seconded by Commissioner \_\_\_\_\_, duly put and carried, it is ORDERED, ADJUDGED AND DECREED that said notice of said above purpose is hereby acknowledged by the Commissioners Court of Fort Bend County, Texas, and that said notice be placed on record according to the regulation order thereof.

**Signature**

Presented to Commissioners Court and approved.

By:   
County Engineer

Date Recorded \_\_\_\_\_ Comm. Court No. \_\_\_\_\_

By: N/A  
Drainage District Engineer/Manager

Clerk of Commissioners Court

By: \_\_\_\_\_  
Deputy



**BLACK & VEATCH**

DESIGN ENGINEER CONTACT:  
VLAD CHERNENKO  
BLACK & VEATCH  
(303) 264-0587  
CHERNENKOV@BV.COM

FORT BEND COUNTY  
PERMIT #  
SHOWN ON PRINT 18

DESIGN SUMMARY:  
-BORE AND PLACE FIBER.

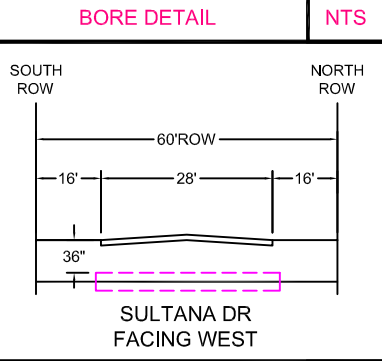
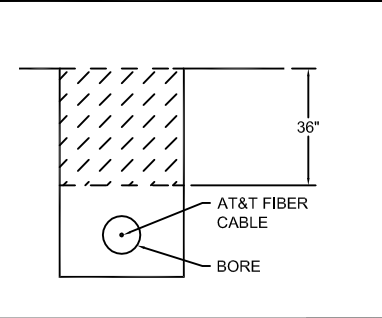

FORT BEND COUNTY NOTIFICATION

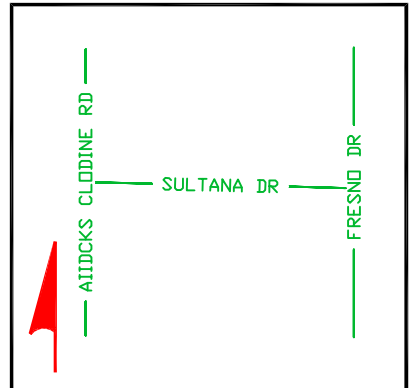
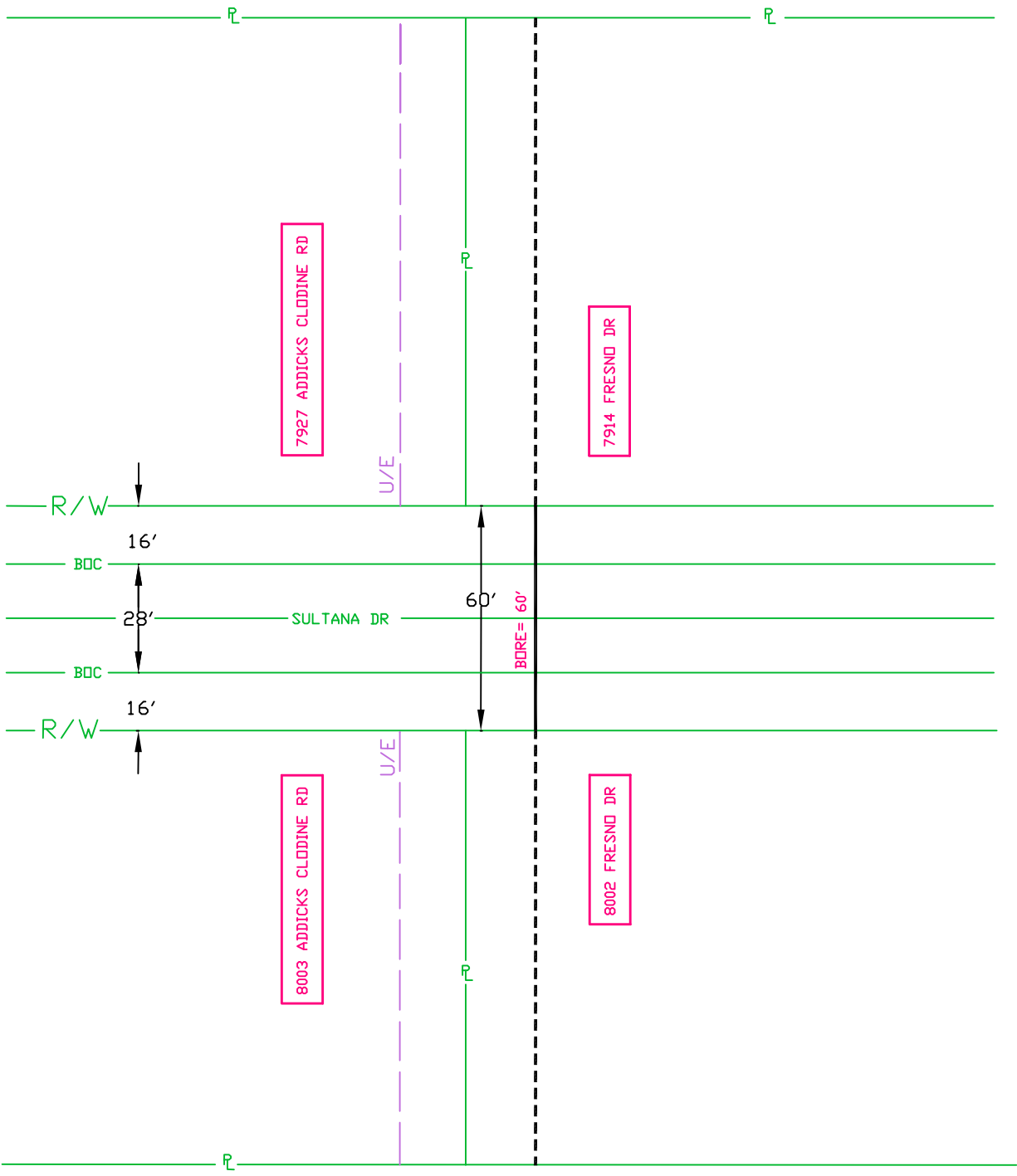

WORK DONE IN FORT BEND  
COUNTY RIGHT OF WAY - PRINT  
FOR INFORMATIONAL PURPOSES  
ONLY

SPECIAL  
CIRCUITS N  
6203  
FORWARDED N  
PERMIT  
REQUIRED Y

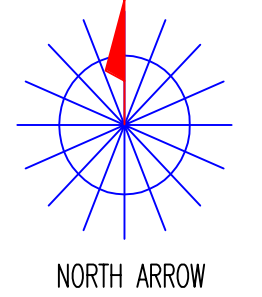

OPERATING RANGE OF JOB STEPS  
TASK \_\_\_\_\_ TO \_\_\_\_\_  
MFRC

TRANSMISSION ZONE  
RZ 0 CZ 0 TAPER CODE 1166PA

CAUTION HIGH VOLTAGE  
KV 0.00 AERIAL N BURIED N

HIGHWAY PERMIT NO.

Utility CO  
REP NAME  
REP TEL NO.  
POLE CONTACTS (+) 0 (-) 0

Utility CO  
REP NAME  
REP TEL NO.  
POLE CONTACTS (+) 0 (-) 0

Utility CO  
REP NAME  
REP TEL NO.  
POLE CONTACTS (+) 0 (-) 0

PROJECT NO A012X6Q

TOT.PRINTS 67 PRINT NO. 53  
NPA/NNX: 281-498 PRT:281498  
EXCH. ALIEF  
TAX DIST. FG071  
GEO LOC. W85498  
ENGR. SS DRAWN JW  
TELEPHONE NO. (281) 320-3812  
REC. REF.  
MAP REF.  
SCALE NONE  
ISSUE DATE  
PROJ TITLE LIGHTGIG-1166PA--DIST-AF  
REV. NUMBER  
DATE REV.

--Proprietary--  
Not for use or disclosure outside the AT&T companies except under written agreement.



**BLACK & VEATCH**

DESIGN ENGINEER CONTACT:  
VLAD CHERNENKO  
BLACK & VEATCH  
(303) 264-0587  
CHERNENKOV@BV.COM

FORT BEND COUNTY  
PERMIT #  
SHOWN ON PRINT 12

DESIGN SUMMARY:  
-BORE AND PLACE FIBER.

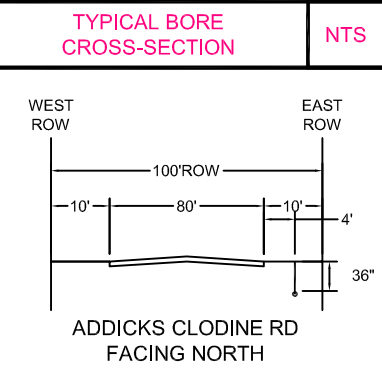
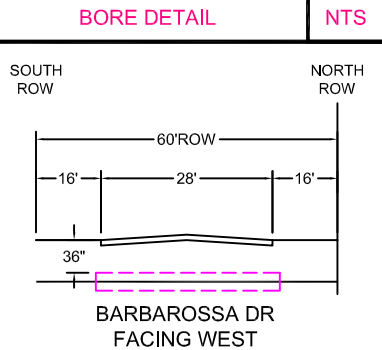
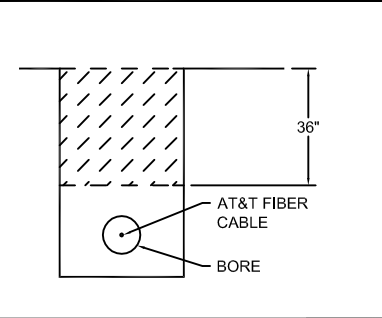

FORT BEND COUNTY NOTIFICATION

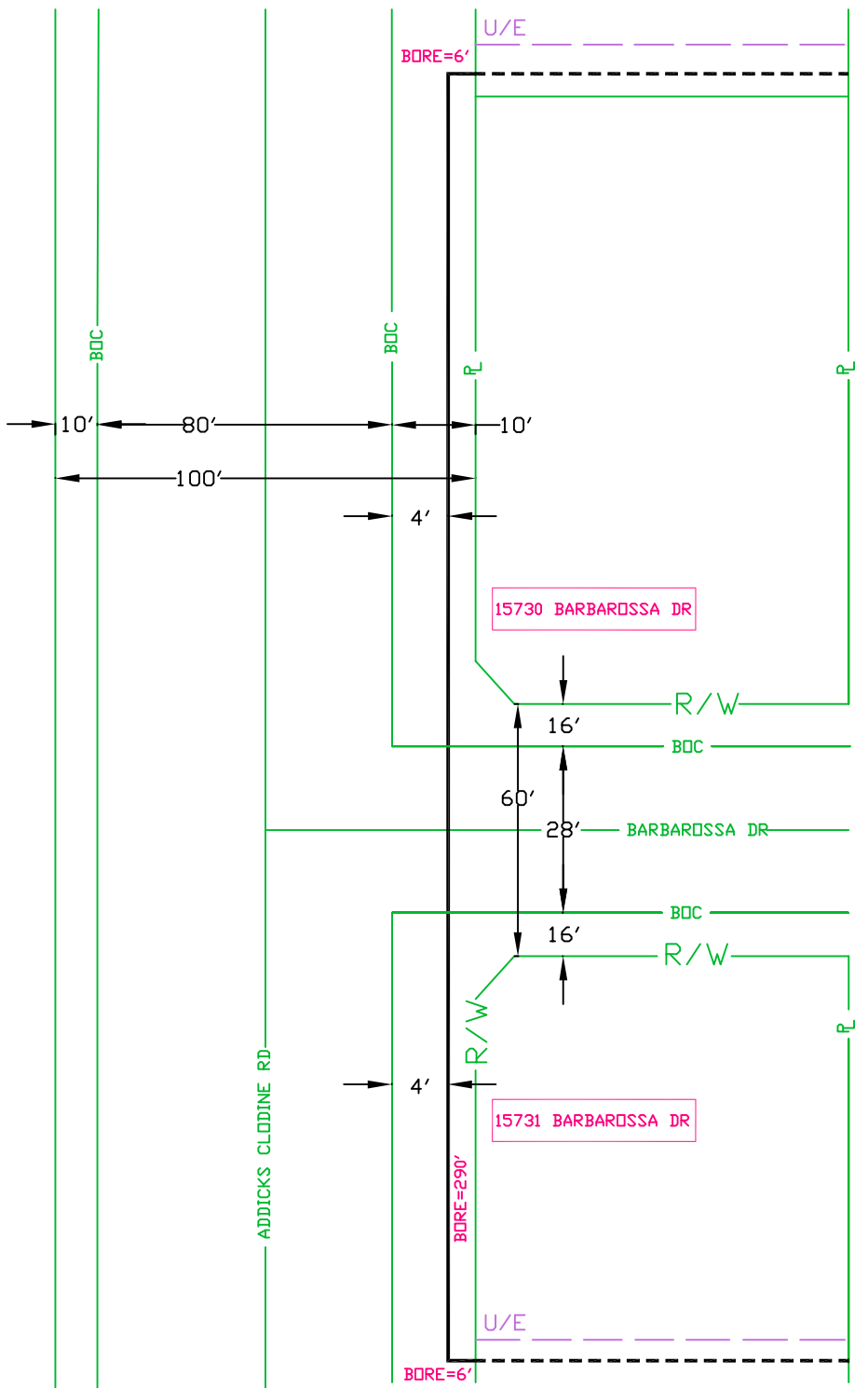

APPROXIMATE LOCATION MAP

WORK DONE IN FORT BEND COUNTY RIGHT OF WAY - PRINT FOR INFORMATIONAL PURPOSES ONLY

SPECIAL CIRCUITS N  
6203 FORWARDED N  
PERMIT REQUIRED Y

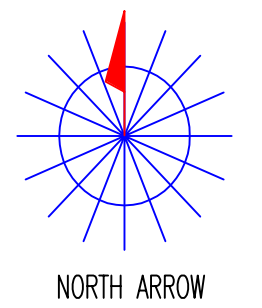

OPERATING RANGE OF JOB STEPS  
TASK \_\_\_\_\_ TO \_\_\_\_\_  
MFRC

TRANSMISSION ZONE  
RZ 0 CZ 0 TAPER CODE 1166PA

CAUTION HIGH VOLTAGE  
KV 0.00 AERIAL N BURIED N

HIGHWAY PERMIT NO.

Utility CO  
REP NAME  
REP TEL NO.  
POLE CONTACTS (+) 0 (-) 0

Utility CO  
REP NAME  
REP TEL NO.  
POLE CONTACTS (+) 0 (-) 0

Utility CO  
REP NAME  
REP TEL NO.  
POLE CONTACTS (+) 0 (-) 0

PROJECT NO A012X6Q

TOT.PRINTS 67 PRINT NO. 54  
NPA/NNX: 281-498 PRT:281498  
EXCH. ALIEF  
TAX DIST. FG071  
GEO LOC. W85498  
ENGR. SS DRAWN JW  
TELEPHONE NO. (281) 320-3812  
REC. REF.  
MAP REF.  
SCALE NONE  
ISSUE DATE  
PROJ TITLE LIGHTGIG-1166PA--DIST-AF  
REV. NUMBER  
DATE REV.

--Proprietary--  
Not for use or disclosure outside the AT&T companies except under written agreement.

**BLACK & VEATCH**  
 DESIGN ENGINEER CONTACT:  
 VLAD CHERNENKO  
 BLACK & VEATCH  
 (303) 264-0587  
 CHERNENKOV@BV.COM

FORT BEND COUNTY  
 PERMIT #  
 SHOWN ON PRINT 27 & 28

DESIGN SUMMARY:  
 -BORE AND PLACE FIBER.

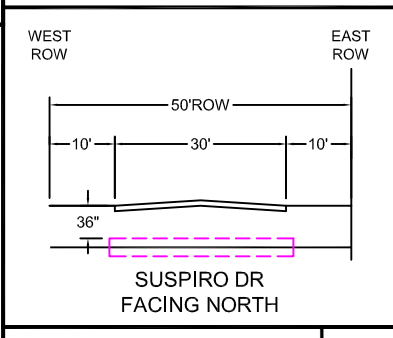
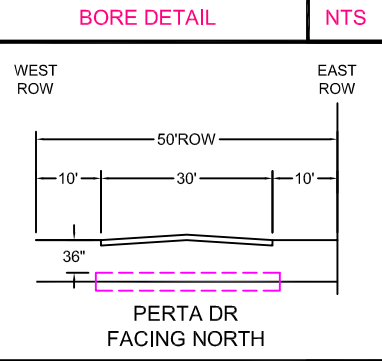
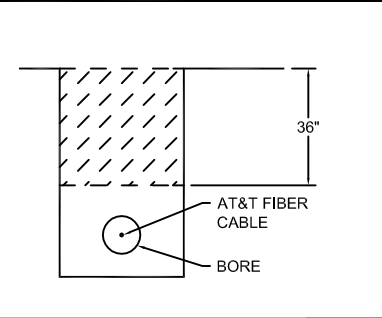

# FORT BEND COUNTY NOTIFICATION

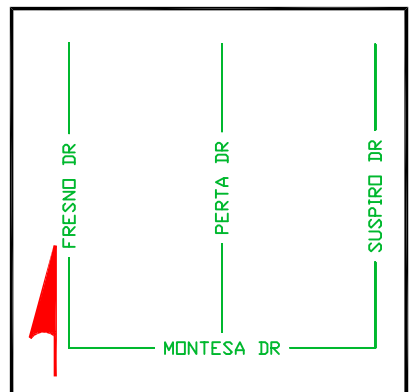

WORK DONE IN FORT BEND COUNTY RIGHT OF WAY - PRINT FOR INFORMATIONAL PURPOSES ONLY

SPECIAL CIRCUITS N  
 6203 FORWARDED N  
 PERMIT REQUIRED Y

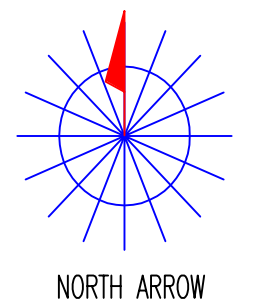

OPERATING RANGE OF JOB STEPS  
 TASK \_\_\_\_\_ TO \_\_\_\_\_  
 MFRC

TRANSMISSION ZONE  
 RZ 0 CZ 0 TAPER CODE 1166PA

CAUTION HIGH VOLTAGE  
 KV 0.00 AERIAL N BURIED N

HIGHWAY PERMIT NO.

Utility CO  
 REP NAME  
 REP TEL NO.  
 POLE CONTACTS (+) 0 (-) 0

Utility CO  
 REP NAME  
 REP TEL NO.  
 POLE CONTACTS (+) 0 (-) 0

Utility CO  
 REP NAME  
 REP TEL NO.  
 POLE CONTACTS (+) 0 (-) 0

PROJECT NO A012X6Q

TOT.PRINTS 67 PRINT NO.55  
 NPA/NNX: 281-498 PRT:281498  
 EXCH. ALIEF  
 TAX DIST. FG071  
 GEO LOC. W85498  
 ENGR. SS DRAWN JW  
 TELEPHONE NO. (281) 320-3812  
 REC. REF.  
 MAP REF.  
 SCALE NONE  
 ISSUE DATE  
 PROJ TITLE LIGHTGIG-1166PA--DIST-AF  
 REV. NUMBER  
 DATE REV.

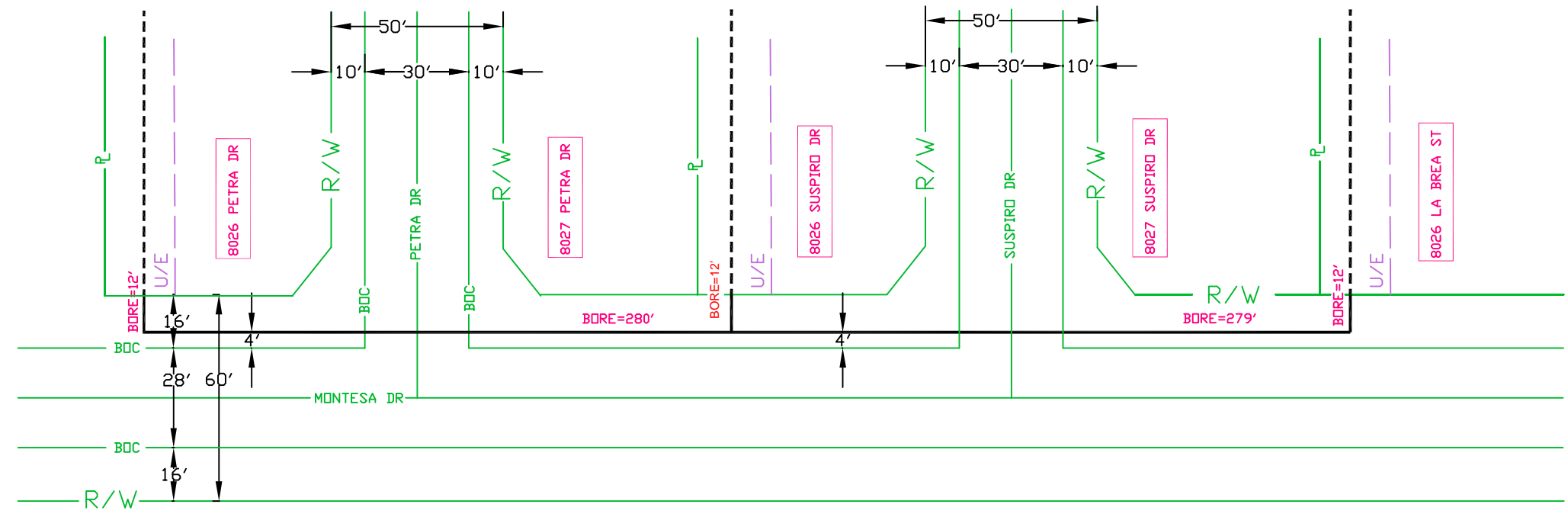

--Proprietary--  
 Not for use or disclosure outside the AT&T companies except under written agreement.

**BLACK & VEATCH**  
 DESIGN ENGINEER CONTACT:  
 VLAD CHERNENKO  
 BLACK & VEATCH  
 (303) 264-0587  
 CHERNENKOV@BV.COM

FORT BEND COUNTY  
 PERMIT #  
 SHOWN ON PRINT 4

DESIGN SUMMARY:  
 -BORE AND PLACE FIBER.

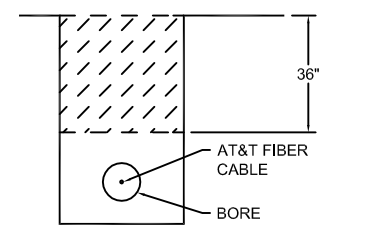

BORE DETAIL NTS

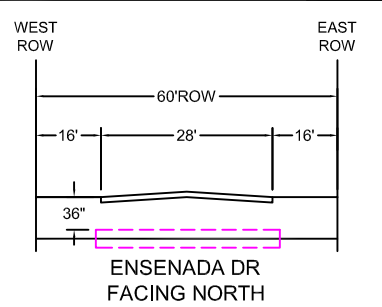

TYPICAL BORE CROSS-SECTION NTS

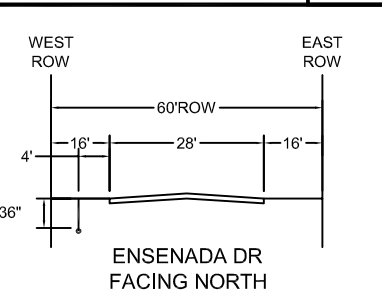

TYPICAL CROSS-SECTION NTS

TYPICAL BORE CROSS-SECTION NTS

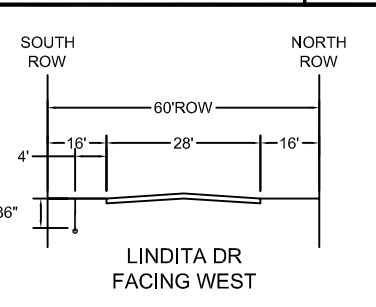

TYPICAL CROSS-SECTION NTS

FORT BEND COUNTY NOTIFICATION

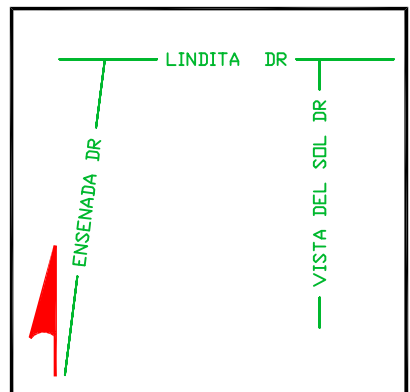

WORK DONE IN FORT BEND COUNTY RIGHT OF WAY - PRINT FOR INFORMATIONAL PURPOSES ONLY

SPECIAL CIRCUITS N  
 6203 FORWARDED N  
 PERMIT REQUIRED Y

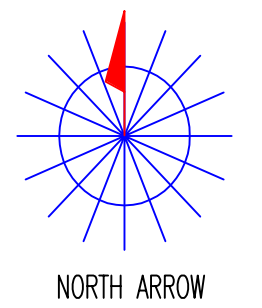

OPERATING RANGE OF JOB STEPS  
 TASK \_\_\_\_ TO \_\_\_\_  
 MFRC

TRANSMISSION ZONE  
 RZ 0 CZ 0 TAPER CODE 1166PA

CAUTION HIGH VOLTAGE  
 KV 0.00 AERIAL N BURIED N

HIGHWAY PERMIT NO.

Utility CO  
 REP NAME  
 REP TEL NO.  
 POLE CONTACTS (+) 0 (-) 0

Utility CO  
 REP NAME  
 REP TEL NO.  
 POLE CONTACTS (+) 0 (-) 0

Utility CO  
 REP NAME  
 REP TEL NO.  
 POLE CONTACTS (+) 0 (-) 0

PROJECT NO A012X6Q

TOT.PRINTS 67 PRINT NO.56  
 NPA/NNX: 281-498 PRT:281498  
 EXCH. ALIEF  
 TAX DIST. FG071  
 GEO LOC. W85498  
 ENGR. SS DRAWN JW  
 TELEPHONE NO. (281) 320-3812  
 REC. REF.  
 MAP REF.  
 SCALE NONE  
 ISSUE DATE  
 PROJ TITLE LIGHTGIG-1166PA--DIST-AF  
 REV. NUMBER  
 DATE REV.

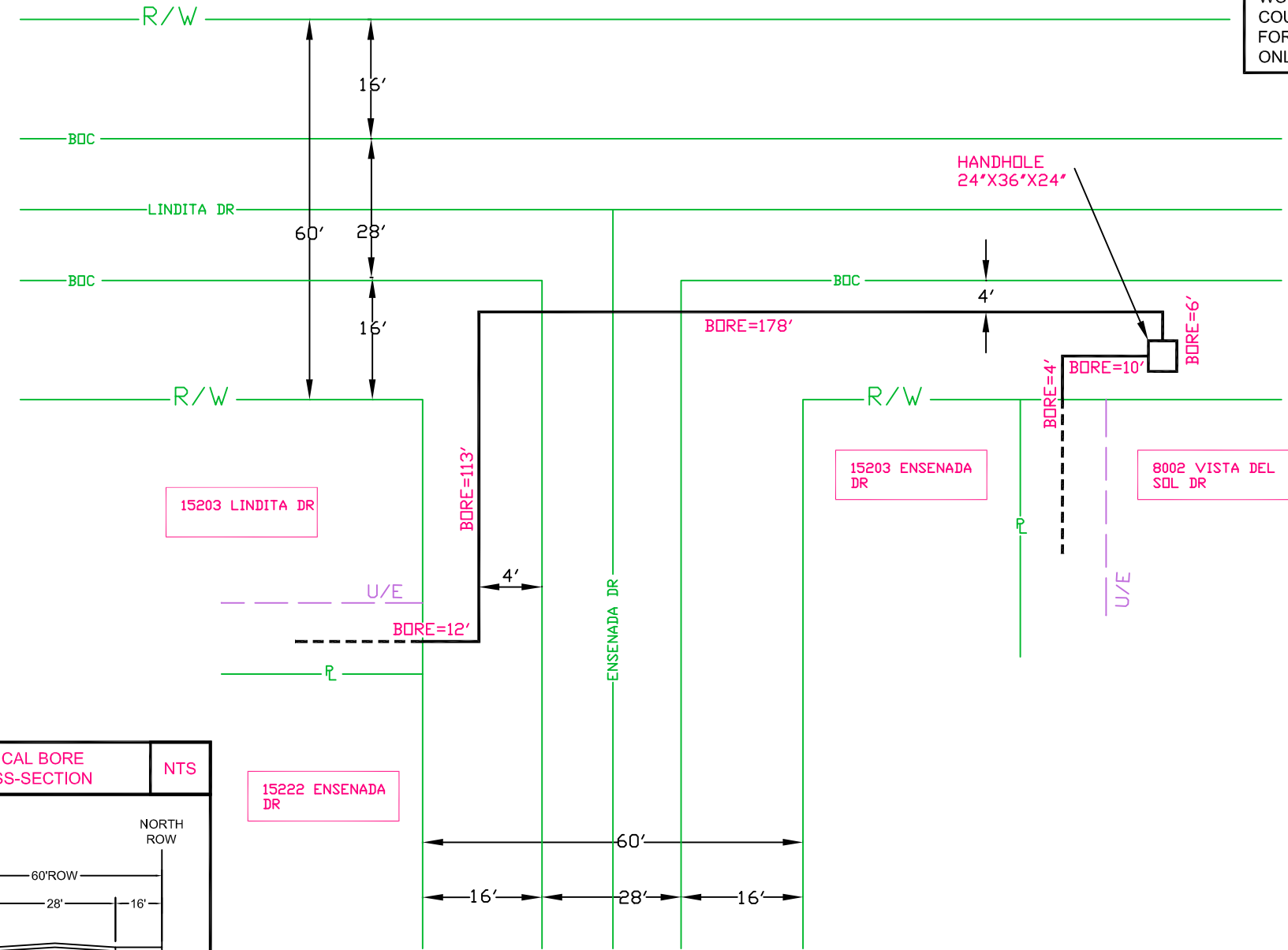

--Proprietary--  
 Not for use or disclosure outside the AT&T companies except under written agreement.

**BLACK & VEATCH**  
 DESIGN ENGINEER CONTACT:  
 VLAD CHERNENKO  
 BLACK & VEATCH  
 (303) 264-0587  
 CHERNENKOV@BV.COM

FORT BEND COUNTY  
 PERMIT #  
 SHOWN ON PRINT 8

DESIGN SUMMARY:  
 -BORE AND PLACE FIBER.

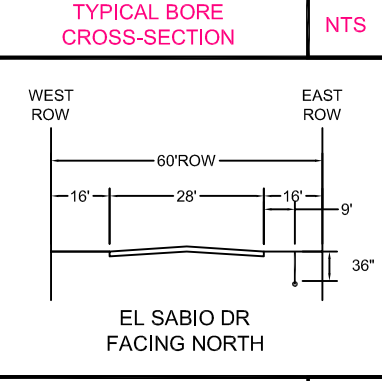
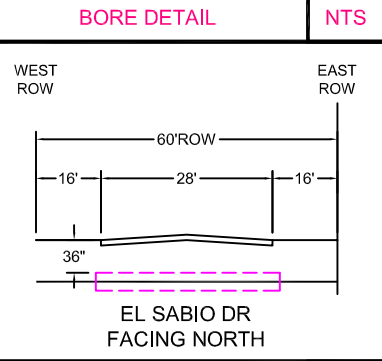
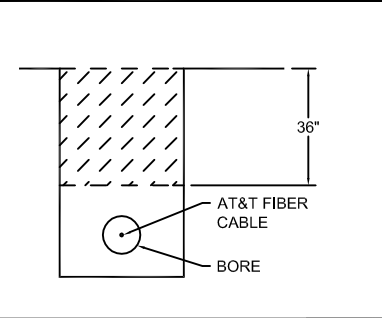

# FORT BEND COUNTY NOTIFICATION

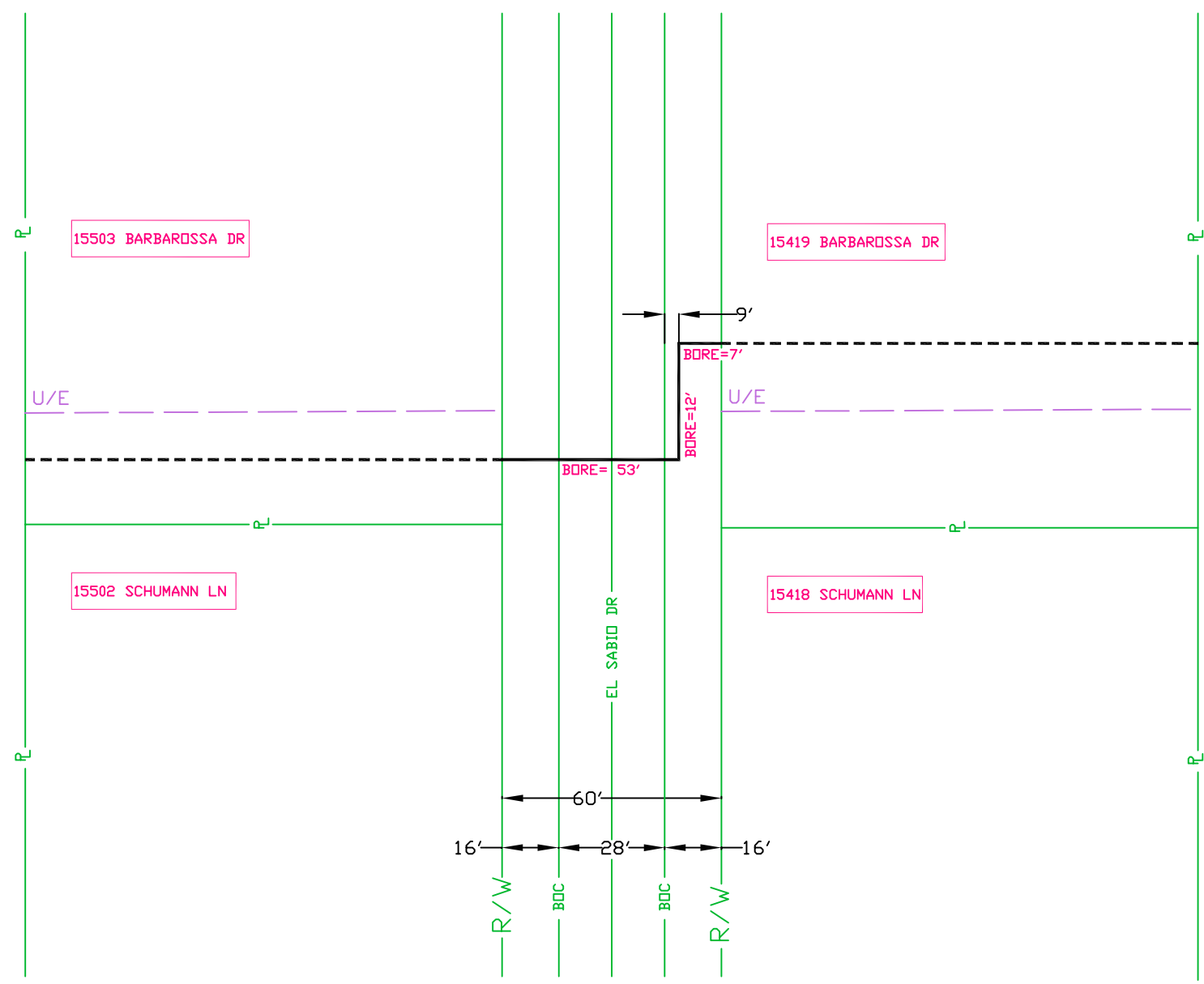

APPROXIMATE LOCATION MAP

WORK DONE IN FORT BEND COUNTY RIGHT OF WAY - PRINT FOR INFORMATIONAL PURPOSES ONLY

SPECIAL CIRCUITS N  
 6203 FORWARDED N  
 PERMIT REQUIRED Y

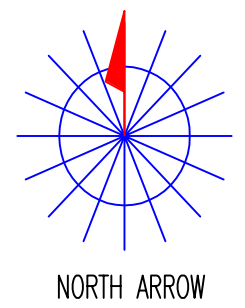

OPERATING RANGE OF JOB STEPS  
 TASK \_\_\_\_ TO \_\_\_\_  
 MFRC

TRANSMISSION ZONE  
 RZ 0 CZ 0 TAPER CODE 1166PA

CAUTION HIGH VOLTAGE  
 KV 0.00 AERIAL N BURIED N

HIGHWAY PERMIT NO.

Utility CO  
 REP NAME  
 REP TEL NO.  
 POLE CONTACTS (+) 0 (-) 0

Utility CO  
 REP NAME  
 REP TEL NO.  
 POLE CONTACTS (+) 0 (-) 0

Utility CO  
 REP NAME  
 REP TEL NO.  
 POLE CONTACTS (+) 0 (-) 0

PROJECT NO A012X6Q

TOT.PRINTS 67 PRINT NO. 57  
 NPA/NNX: 281-498 PRT:281498  
 EXCH. ALIEF  
 TAX DIST. FG071  
 GEO LOC. W85498  
 ENGR. SS DRAWN JW  
 TELEPHONE NO. (281) 320-3812  
 REC. REF.  
 MAP REF.  
 SCALE NONE  
 ISSUE DATE  
 PROJ TITLE LIGHTGIG-1166PA--DIST-AF  
 REV. NUMBER  
 DATE REV.

--Proprietary--  
 Not for use or disclosure outside the AT&T companies except under written agreement.



# BLACK & VEATCH

DESIGN ENGINEER CONTACT:  
VLAD CHERNENKO  
BLACK & VEATCH  
(303) 264-0587  
CHERNENKOV@BV.COM

FORT BEND COUNTY  
PERMIT #  
SHOWN ON PRINT 14

DESIGN SUMMARY:  
-BORE AND PLACE FIBER.

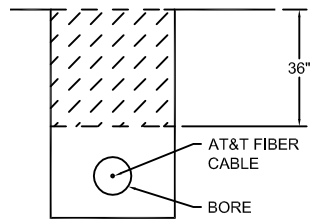

BORE DETAIL

NTS

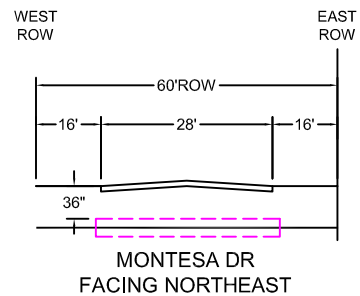

TYPICAL BORE  
CROSS-SECTION

NTS

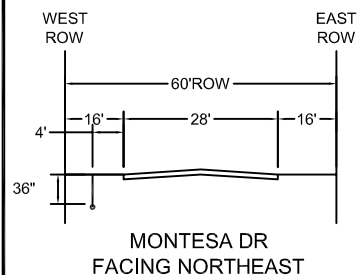

TYPICAL CROSS-SECTION

NTS

## FORT BEND COUNTY NOTIFICATION

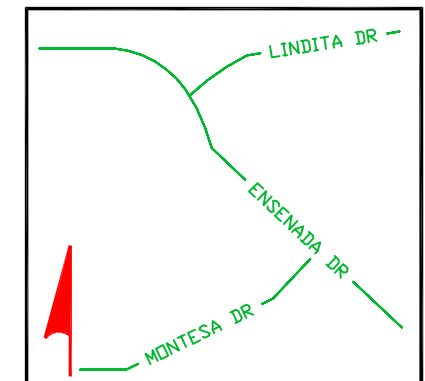
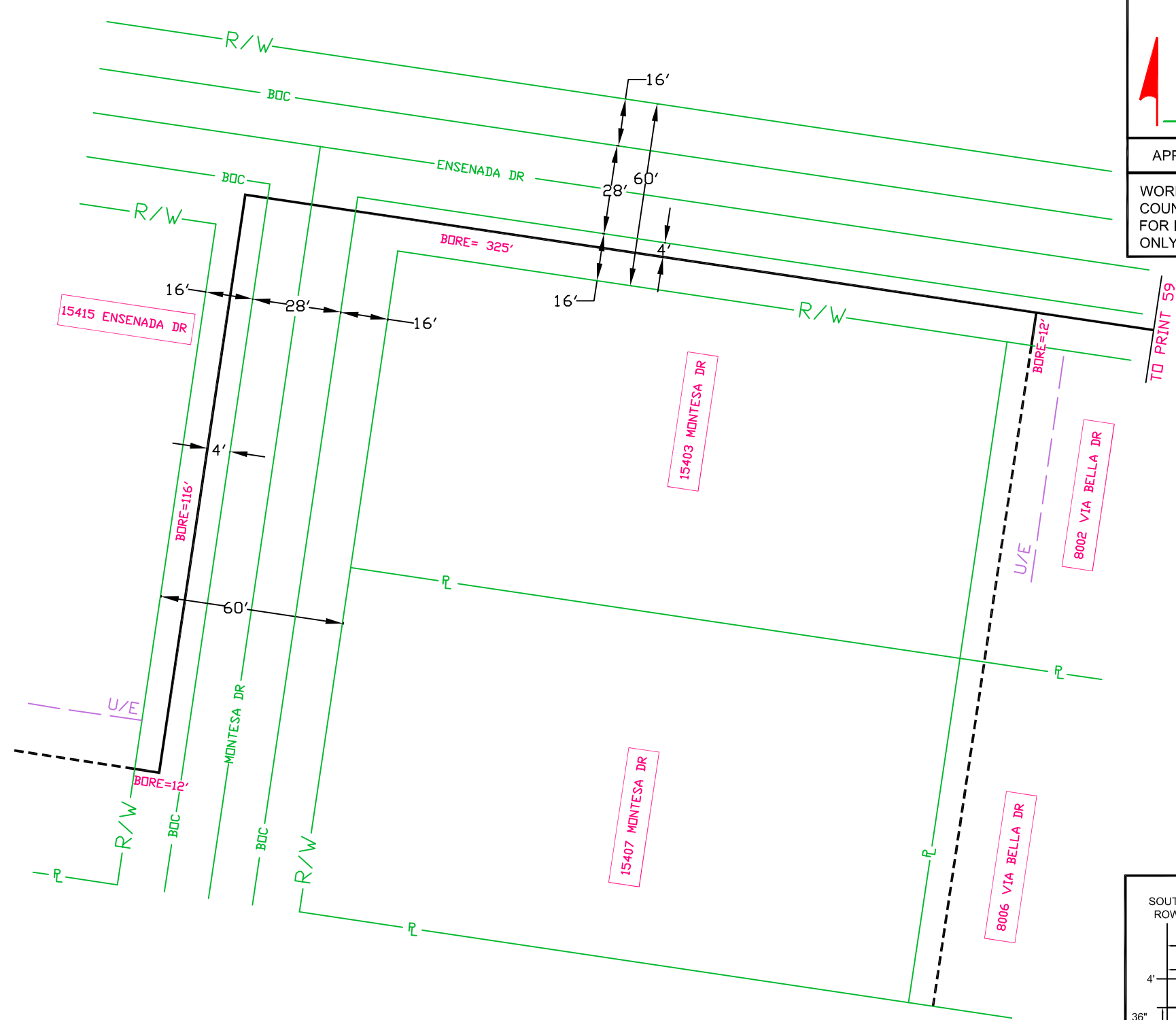

APPROXIMATE LOCATION MAP  
WORK DONE IN FORT BEND  
COUNTY RIGHT OF WAY - PRINT  
FOR INFORMATIONAL PURPOSES  
ONLY

SPECIAL  
CIRCUITS N  
6203  
FORWARDED N  
PERMIT  
REQUIRED Y

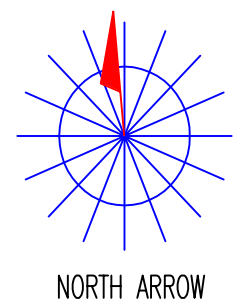

OPERATING RANGE OF JOB STEPS  
TASK \_\_\_\_\_ TO \_\_\_\_\_  
MFRC

TRANSMISSION ZONE  
RZ 0 CZ 0 TAPER CODE 1166PA

CAUTION HIGH VOLTAGE  
KV 0.00 AERIAL N BURIED N

HIGHWAY PERMIT NO.

Utility CO  
REP NAME  
REP TEL NO.  
POLE CONTACTS (+) 0 (-) 0

Utility CO  
REP NAME  
REP TEL NO.  
POLE CONTACTS (+) 0 (-) 0

Utility CO  
REP NAME  
REP TEL NO.  
POLE CONTACTS (+) 0 (-) 0

PROJECT NO A012X6Q

TOT.PRINTS 67 PRINT NO. 58  
NPA/NNX: 281-498 PRT:281498  
EXCH. ALIEF  
TAX DIST. FG071  
GEO LOC. W85498  
ENGR. SS DRAWN JW  
TELEPHONE NO. (281) 320-3812

REC. REF.  
MAP REF.  
SCALE NONE  
ISSUE DATE  
PROJ TITLE LIGHTGIG-1166PA--DIST-AF  
REV. NUMBER  
DATE REV.

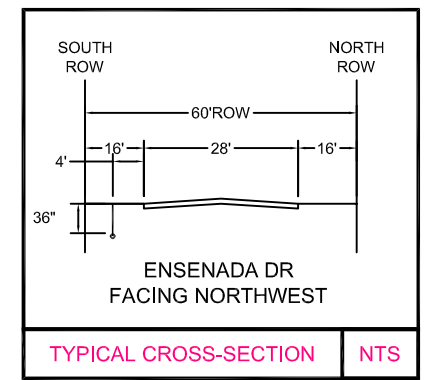

TYPICAL CROSS-SECTION

NTS

--Proprietary--  
Not for use or disclosure outside the AT&T companies except under written agreement.



# BLACK & VEATCH

DESIGN ENGINEER CONTACT:  
VLAD CHERNENKO  
BLACK & VEATCH  
(303) 264-0587  
CHERNENKOV@BV.COM

FORT BEND COUNTY  
PERMIT #  
SHOWN ON PRINT 7 & 14

DESIGN SUMMARY:  
-BORE AND PLACE FIBER.

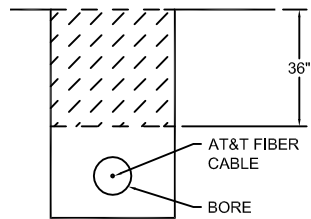

BORE DETAIL

NTS

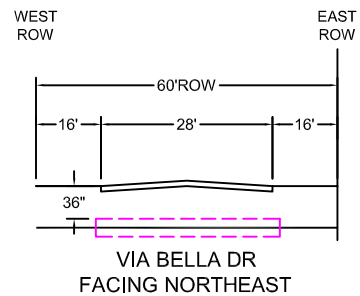

TYPICAL BORE CROSS-SECTION

NTS

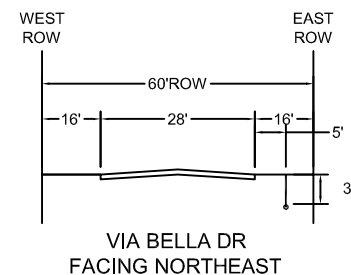

TYPICAL CROSS-SECTION

NTS

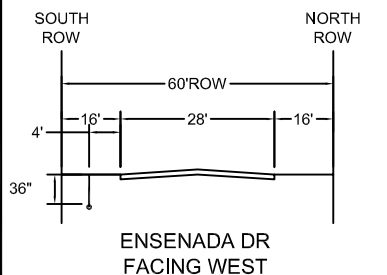

TYPICAL CROSS-SECTION

NTS

## FORT BEND COUNTY NOTIFICATION

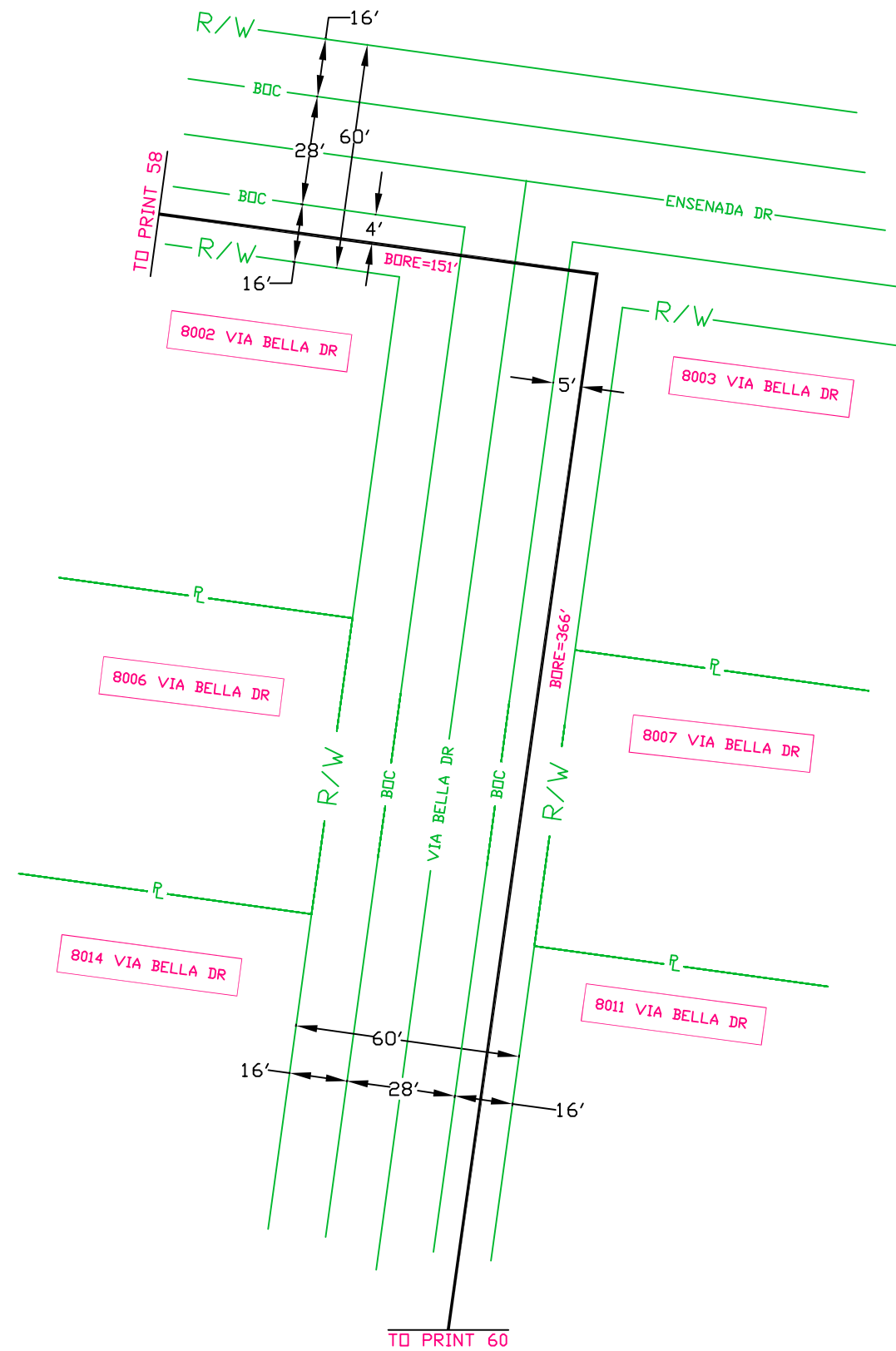

TO PRINT 60

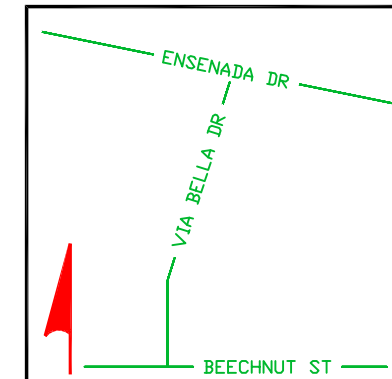

APPROXIMATE LOCATION MAP

WORK DONE IN FORT BEND COUNTY RIGHT OF WAY - PRINT FOR INFORMATIONAL PURPOSES ONLY

SPECIAL CIRCUITS N  
6203 FORWARDED N  
PERMIT REQUIRED Y

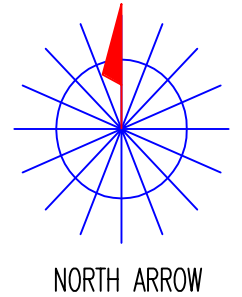

OPERATING RANGE OF JOB STEPS

TASK \_\_\_\_\_ TO \_\_\_\_\_

MFRC

TRANSMISSION ZONE  
RZ 0 CZ 0 TAPER CODE 1166PA

CAUTION HIGH VOLTAGE  
KV 0.00 AERIAL N BURIED N

HIGHWAY PERMIT NO.

Utility CO  
REP NAME  
REP TEL NO.  
POLE CONTACTS (+) 0 (-) 0

Utility CO  
REP NAME  
REP TEL NO.  
POLE CONTACTS (+) 0 (-) 0

Utility CO  
REP NAME  
REP TEL NO.  
POLE CONTACTS (+) 0 (-) 0

PROJECT NO A012X6Q

TOT.PRINTS 67 PRINT NO. 59

NPA/NNX: 281-498 PRT:281498

EXCH. ALIEF

TAX DIST. FG071

GEO LOC. W85498

ENGR. SS DRAWN JW

TELEPHONE NO. (281) 320-3812

REC. REF.

MAP REF.

SCALE NONE

ISSUE DATE

PROJ TITLE LIGHTGIG-1166PA--DIST-AF

REV. NUMBER

DATE REV.

--Proprietary--

Not for use or disclosure outside the AT&T companies except under written agreement.



**BLACK & VEATCH**

DESIGN ENGINEER CONTACT:  
VLAD CHERNENKO  
BLACK & VEATCH  
(303) 264-0587  
CHERNENKOV@BV.COM

FORT BEND COUNTY  
PERMIT #  
SHOWN ON PRINT 7 & 8

DESIGN SUMMARY:  
-BORE AND PLACE FIBER.  
-PLACE (1) ONE 24"X36"X24" FIBER  
HANDHOLE.  
-PLACE (1) ONE PEDESTAL.

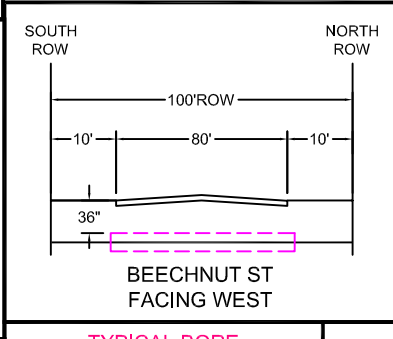
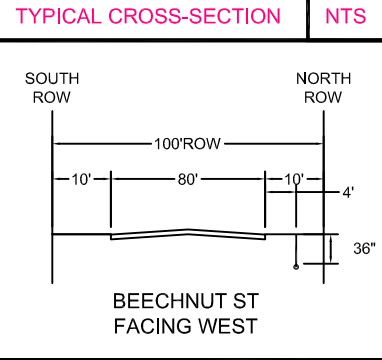
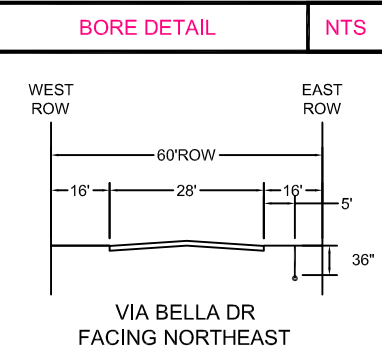
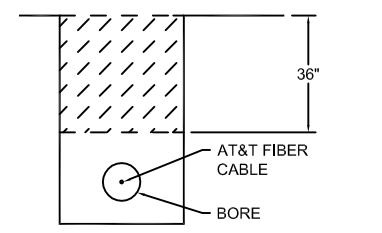

# FORT BEND COUNTY NOTIFICATION

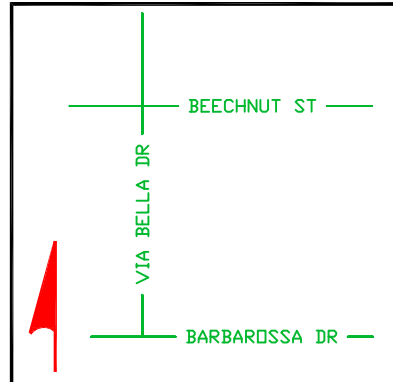
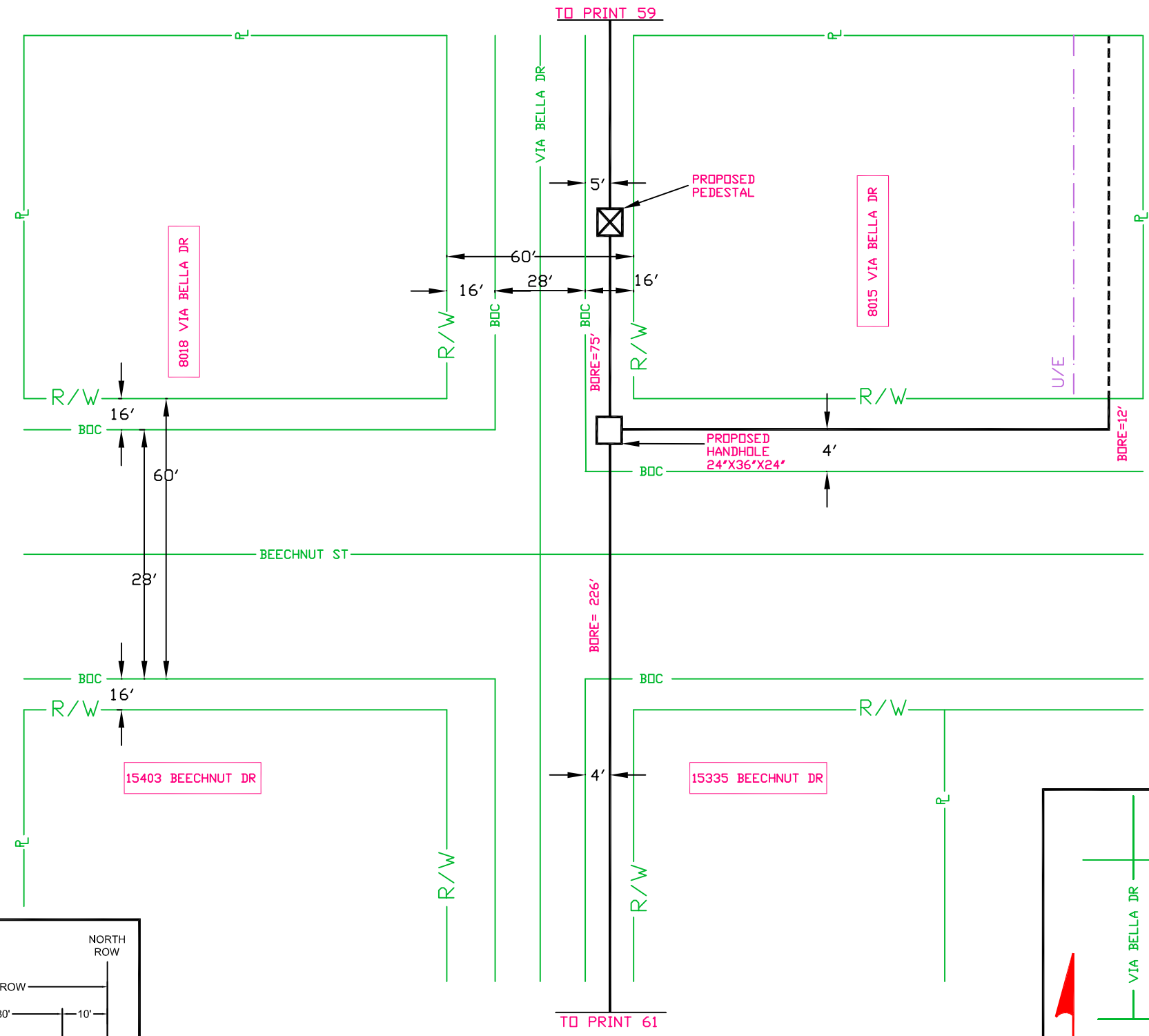

WORK DONE IN FORT BEND COUNTY RIGHT OF WAY - PRINT FOR INFORMATIONAL PURPOSES ONLY

SPECIAL CIRCUITS N  
6203 FORWARDED N  
PERMIT REQUIRED Y

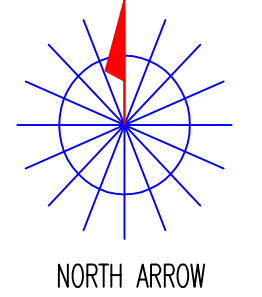

OPERATING RANGE OF JOB STEPS  
TASK \_\_\_\_\_ TO \_\_\_\_\_  
MFRC

TRANSMISSION ZONE  
RZ 0 CZ 0 TAPER CODE 1166PA

CAUTION HIGH VOLTAGE  
KV 0.00 AERIAL N BURIED N

HIGHWAY PERMIT NO.

Utility CO  
REP NAME  
REP TEL NO.  
POLE CONTACTS (+) 0 (-) 0

Utility CO  
REP NAME  
REP TEL NO.  
POLE CONTACTS (+) 0 (-) 0

Utility CO  
REP NAME  
REP TEL NO.  
POLE CONTACTS (+) 0 (-) 0

PROJECT NO A012X6Q

TOT.PRINTS 67 PRINT NO. 60  
NPA/NNX: 281-498 PRT:281498  
EXCH. ALIEF  
TAX DIST. FG071  
GEO LOC. W85498  
ENGR. SS DRAWN JW  
TELEPHONE NO. (281) 320-3812  
REC. REF.  
MAP REF.  
SCALE NONE  
ISSUE DATE  
PROJ TITLE LIGHTGIG-1166PA--DIST-AF  
REV. NUMBER  
DATE REV.

--Proprietary--  
Not for use or disclosure outside the AT&T companies except under written agreement.



**BLACK & VEATCH**

DESIGN ENGINEER CONTACT:  
VLAD CHERNENKO  
BLACK & VEATCH  
(303) 264-0587  
CHERNENKOV@BV.COM

FORT BEND COUNTY  
PERMIT #  
SHOWN ON PRINT 8

DESIGN SUMMARY:  
-BORE AND PLACE FIBER.  
-PLACE (1) ONE PROPOSED  
PEDESTAL.

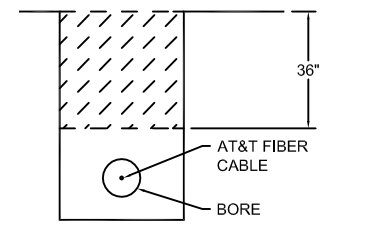

BORE DETAIL NTS

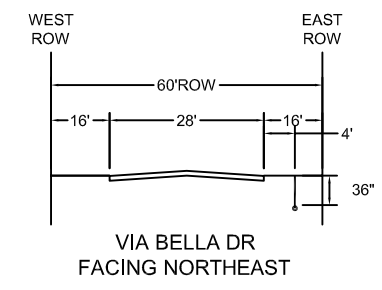

TYPICAL CROSS-SECTION NTS

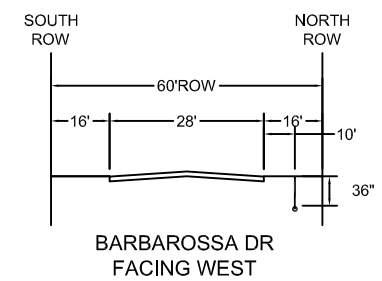

TYPICAL CROSS-SECTION NTS

# FORT BEND COUNTY NOTIFICATION

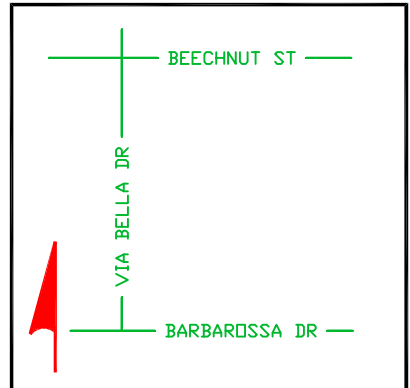
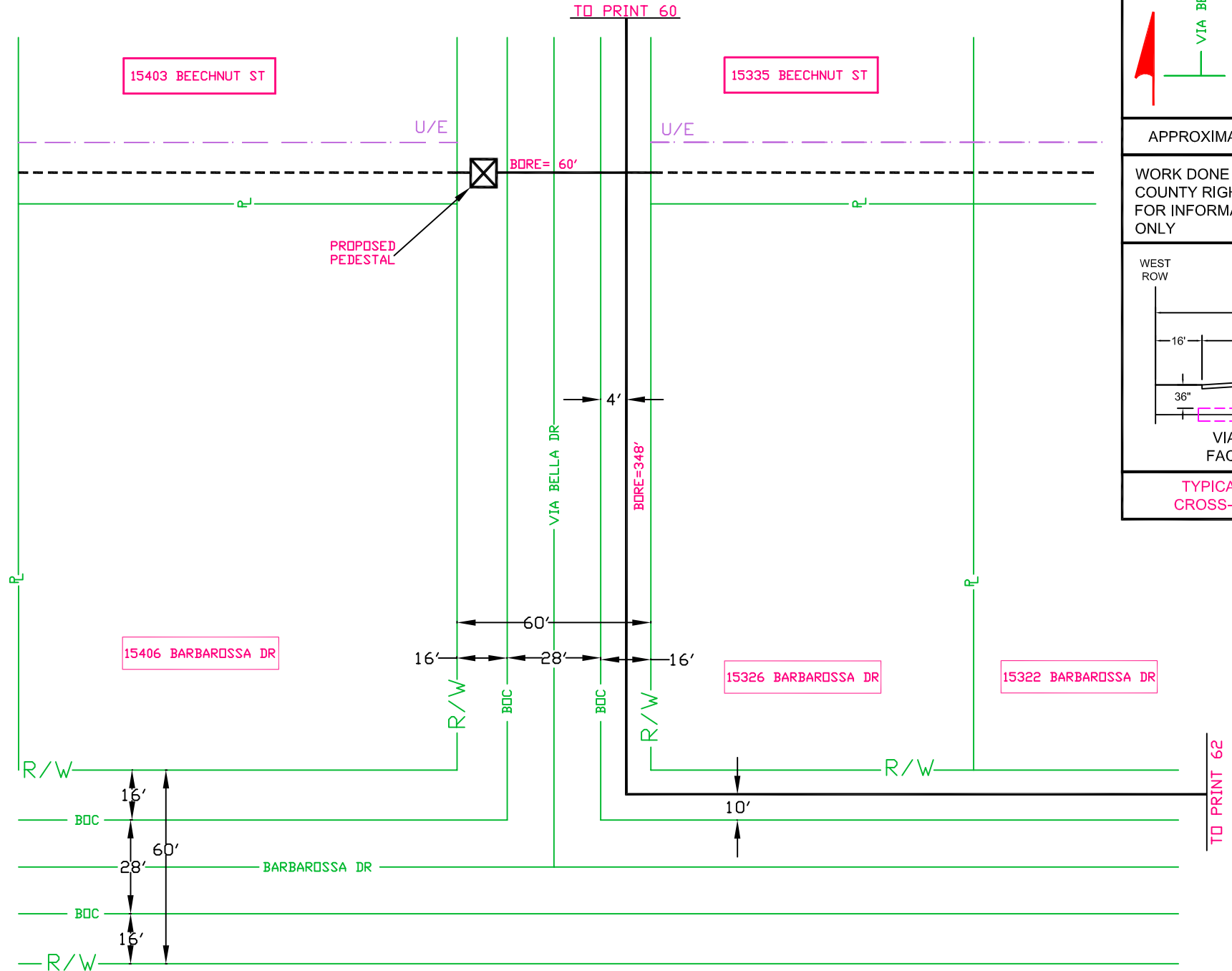

WORK DONE IN FORT BEND COUNTY RIGHT OF WAY - PRINT FOR INFORMATIONAL PURPOSES ONLY

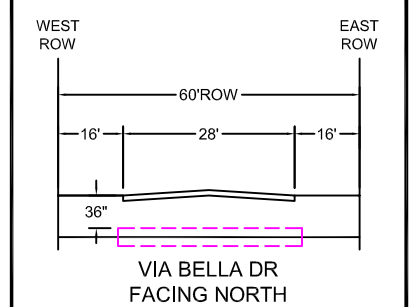

TYPICAL BORE CROSS-SECTION NTS

SPECIAL CIRCUITS N  
6203 FORWARDED N  
PERMIT REQUIRED Y

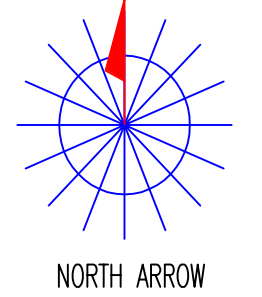

OPERATING RANGE OF JOB STEPS  
TASK \_\_\_\_\_ TO \_\_\_\_\_  
MFRC

TRANSMISSION ZONE  
RZ 0 CZ 0 TAPER CODE 1166PA

CAUTION HIGH VOLTAGE  
KV 0.00 AERIAL N BURIED N

HIGHWAY PERMIT NO.

Utility CO  
REP NAME  
REP TEL NO.  
POLE CONTACTS (+) 0 (-) 0

Utility CO  
REP NAME  
REP TEL NO.  
POLE CONTACTS (+) 0 (-) 0

Utility CO  
REP NAME  
REP TEL NO.  
POLE CONTACTS (+) 0 (-) 0

PROJECT NO A012X6Q

TOT.PRINTS 67 PRINT NO. 61  
NPA/NNX: 281-498 PRT:281498  
EXCH. ALIEF  
TAX DIST. FG071  
GEO LOC. W85498  
ENGR. SS DRAWN JW  
TELEPHONE NO. (281) 320-3812  
REC. REF.  
MAP REF.  
SCALE NONE  
ISSUE DATE  
PROJ TITLE LIGHTGIG-1166PA--DIST-AF  
REV. NUMBER  
DATE REV.

--Proprietary--  
Not for use or disclosure outside the AT&T companies except under written agreement.



DESIGN ENGINEER CONTACT:  
VLAD CHERNENKO  
BLACK & VEATCH  
(303) 264-0587  
CHERNENKOV@BV.COM

FORT BEND COUNTY  
PERMIT #  
SHOWN ON PRINT 8, 13 & 21

DESIGN SUMMARY:  
-BORE AND PLACE FIBER.

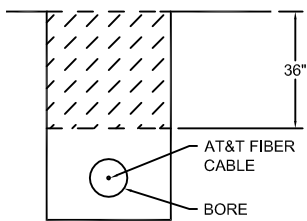

BORE DETAIL NTS

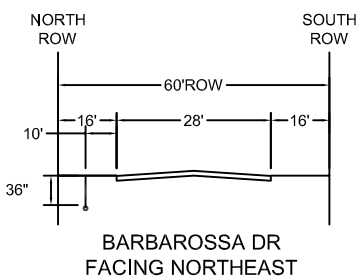

TYPICAL CROSS-SECTION NTS

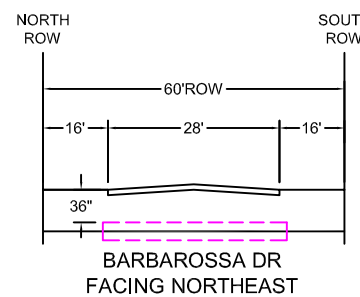

TYPICAL BORE CROSS-SECTION NTS

# FORT BEND COUNTY NOTIFICATION

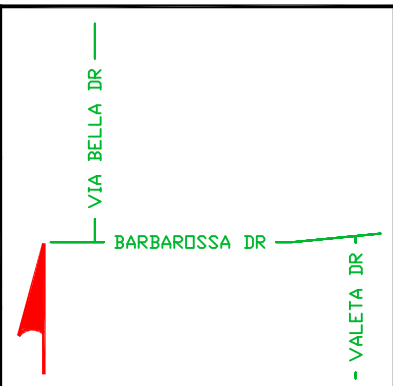

APPROXIMATE LOCATION MAP

WORK DONE IN FORT BEND  
COUNTY RIGHT OF WAY - PRINT  
FOR INFORMATIONAL PURPOSES  
ONLY

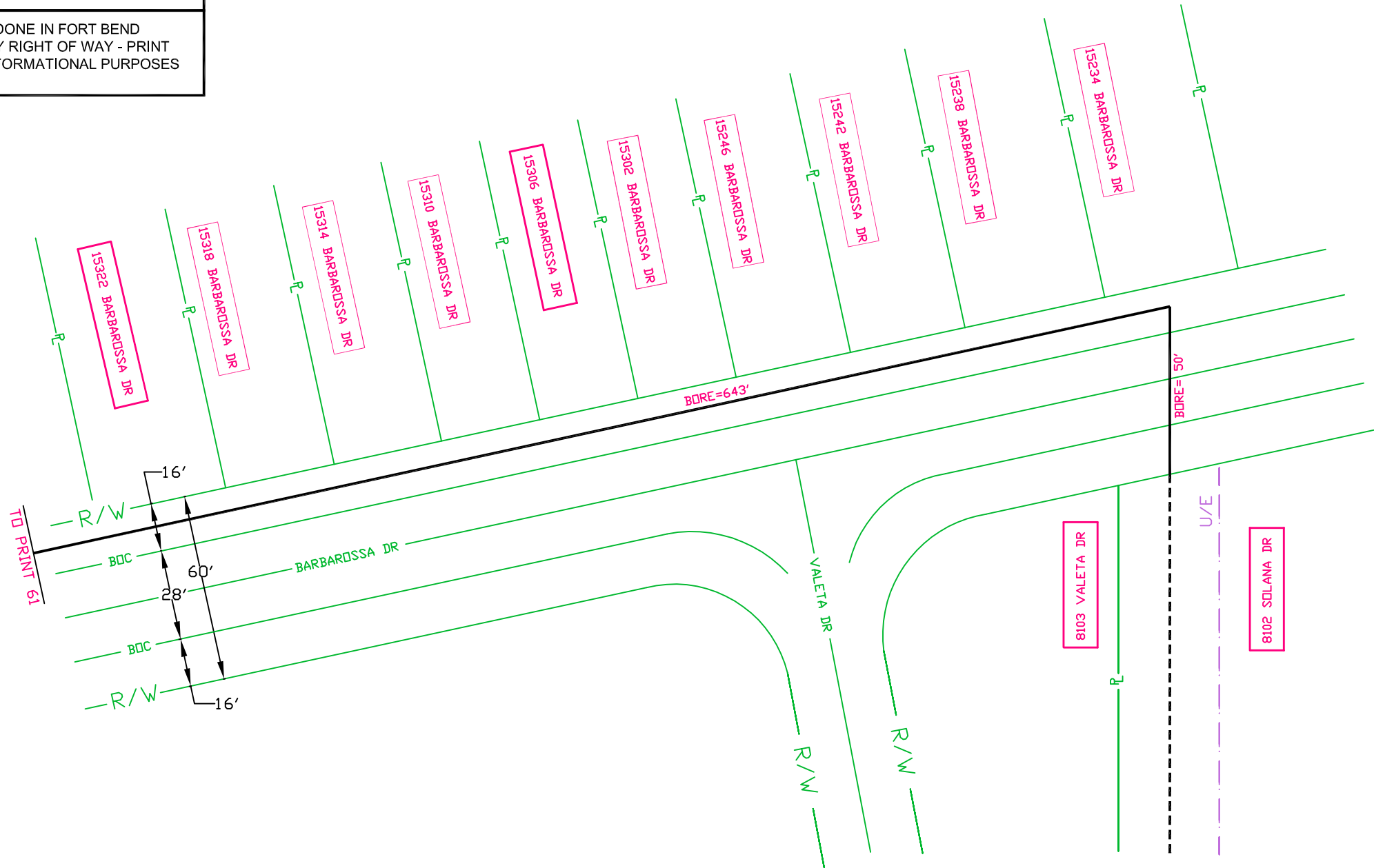

SPECIAL CIRCUITS N  
6203 FORWARDED N  
PERMIT REQUIRED Y

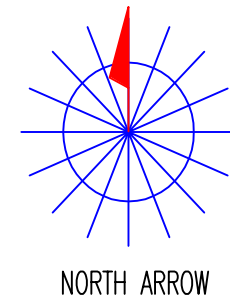

OPERATING RANGE OF JOB STEPS  
TASK \_\_\_\_ TO \_\_\_\_  
MFRC

TRANSMISSION ZONE  
RZ 0 CZ 0 TAPER CODE 1166PA

CAUTION HIGH VOLTAGE  
KV 0.00 AERIAL N BURIED N

HIGHWAY PERMIT NO.

Utility CO  
REP NAME  
REP TEL NO.  
POLE CONTACTS (+) 0 (-) 0

Utility CO  
REP NAME  
REP TEL NO.  
POLE CONTACTS (+) 0 (-) 0

Utility CO  
REP NAME  
REP TEL NO.  
POLE CONTACTS (+) 0 (-) 0

PROJECT NO A012X6Q

TOT.PRINTS 67 PRINT NO. 62  
NPA/NNX: 281-498 PRT:281498  
EXCH. ALIEF  
TAX DIST. FG071  
GEO LOC. W85498  
ENGR. SS DRAWN JW  
TELEPHONE NO. (281) 320-3812  
REC. REF.  
MAP REF.  
SCALE NONE  
ISSUE DATE  
PROJ TITLE LIGHTGIG-1166PA--DIST-AF  
REV. NUMBER  
DATE REV.



# BLACK & VEATCH

DESIGN ENGINEER CONTACT:  
VLAD CHERNENKO  
BLACK & VEATCH  
(303) 264-0587  
CHERNENKOV@BV.COM

FORT BEND COUNTY  
PERMIT #  
SHOWN ON PRINT 37

DESIGN SUMMARY:  
-BORE AND PLACE FIBER.

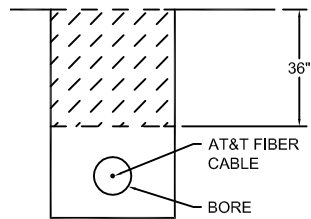

BORE DETAIL

NTS

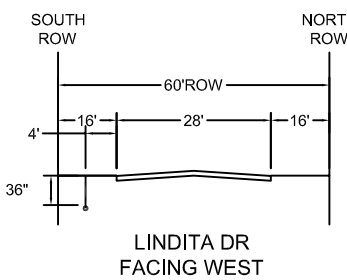

TYPICAL CROSS-SECTION

NTS

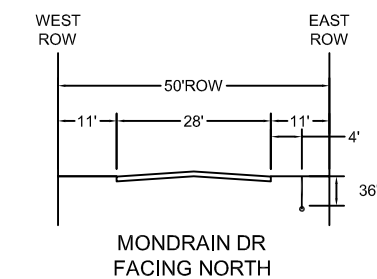

TYPICAL CROSS-SECTION

NTS

## FORT BEND COUNTY NOTIFICATION

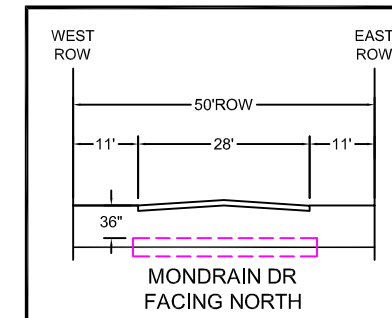
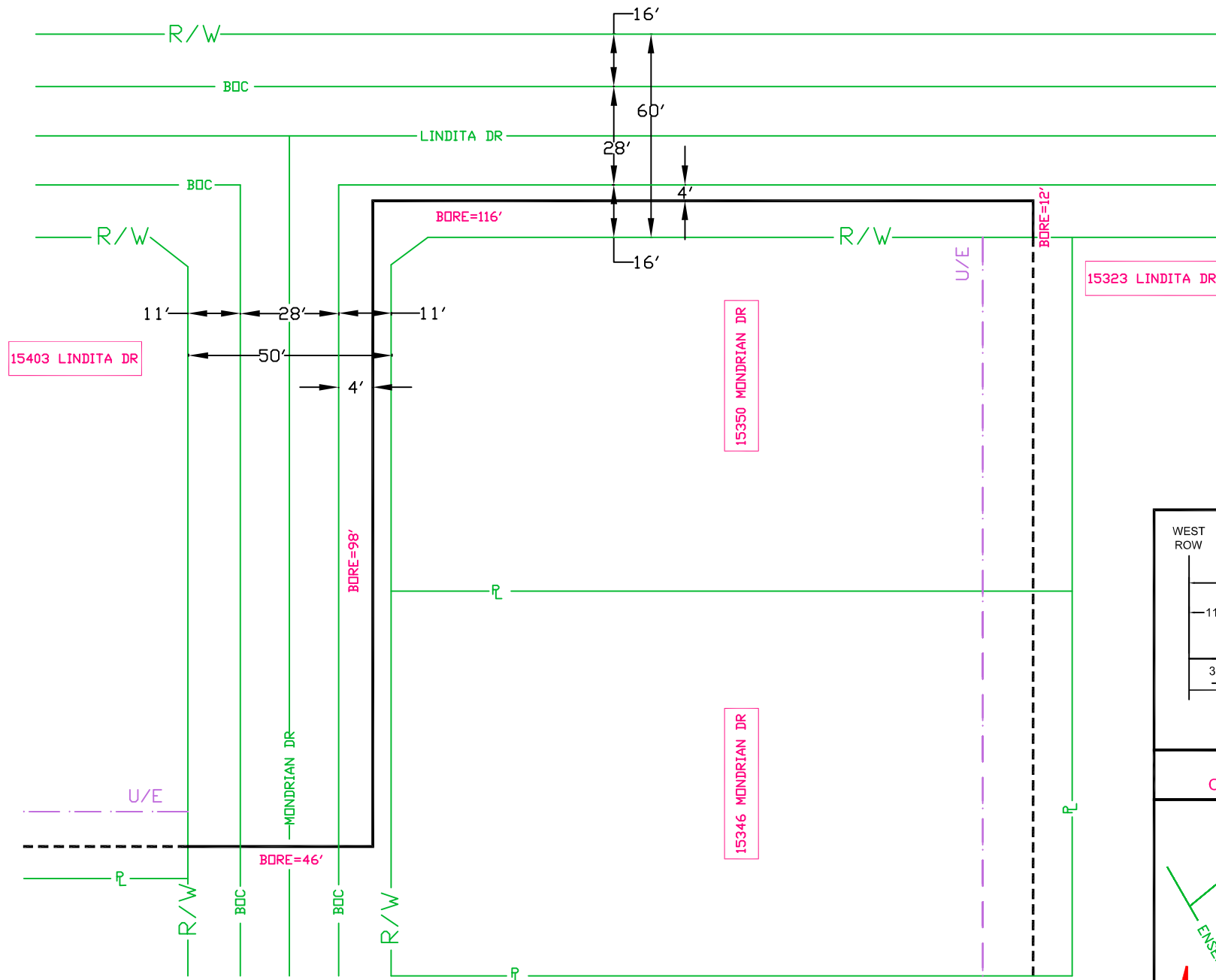

TYPICAL BORE CROSS-SECTION

NTS

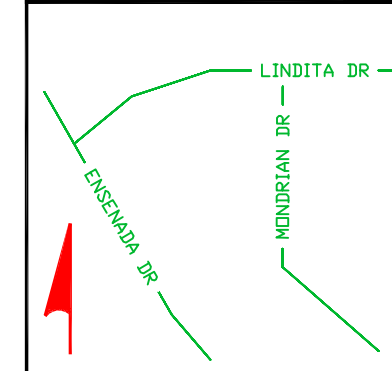

APPROXIMATE LOCATION MAP

WORK DONE IN FORT BEND COUNTY RIGHT OF WAY - PRINT FOR INFORMATIONAL PURPOSES ONLY

SPECIAL CIRCUITS N  
6203 FORWARDED N  
PERMIT REQUIRED Y

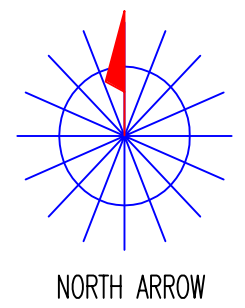

OPERATING RANGE OF JOB STEPS  
TASK \_\_\_\_ TO \_\_\_\_  
MFRC

TRANSMISSION ZONE  
RZ 0 CZ 0 TAPER CODE 1166PA

CAUTION HIGH VOLTAGE  
KV 0.00 AERIAL N BURIED N

HIGHWAY PERMIT NO.

Utility CO  
REP NAME  
REP TEL NO.  
POLE CONTACTS (+) 0 (-) 0

Utility CO  
REP NAME  
REP TEL NO.  
POLE CONTACTS (+) 0 (-) 0

Utility CO  
REP NAME  
REP TEL NO.  
POLE CONTACTS (+) 0 (-) 0

PROJECT NO A012X6Q

TOT.PRINTS 67 PRINT NO. 63  
NPA/NNX: 281-498 PRT:281498  
EXCH. ALIEF  
TAX DIST. FG071  
GEO LOC. W85498

ENGR. SS DRAWN JW  
TELEPHONE NO. (281) 320-3812  
REC. REF.  
MAP REF.  
SCALE NONE  
ISSUE DATE  
PROJ TITLE LIGHTGIG-1166PA--DIST-AF  
REV. NUMBER  
DATE REV.

--Proprietary--  
Not for use or disclosure outside the AT&T companies except under written agreement.

**BLACK & VEATCH**  
 DESIGN ENGINEER CONTACT:  
 VLAD CHERNENKO  
 BLACK & VEATCH  
 (303) 264-0587  
 CHERNENKOV@BV.COM

FORT BEND COUNTY  
 PERMIT #  
 SHOWN ON PRINT 39

DESIGN SUMMARY:  
 -BORE AND PLACE FIBER.

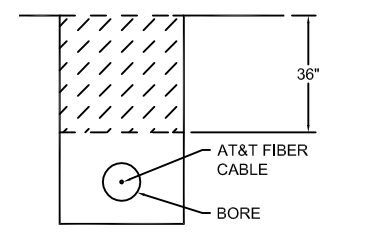

BORE DETAIL NTS

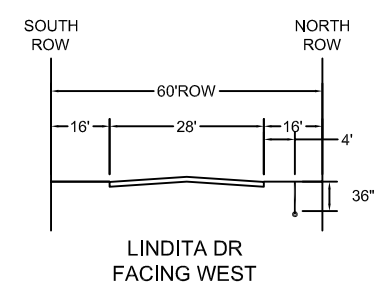

TYPICAL CROSS-SECTION NTS

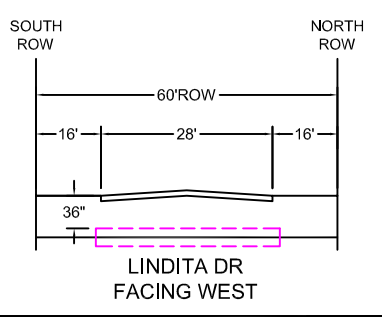

TYPICAL BORE CROSS-SECTION NTS

FORT BEND COUNTY NOTIFICATION

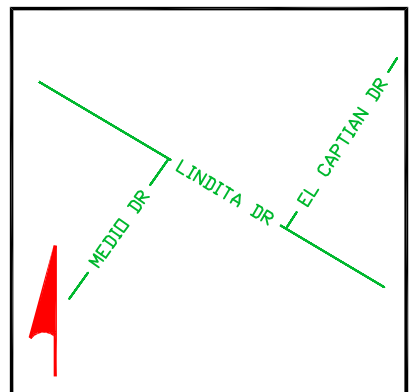
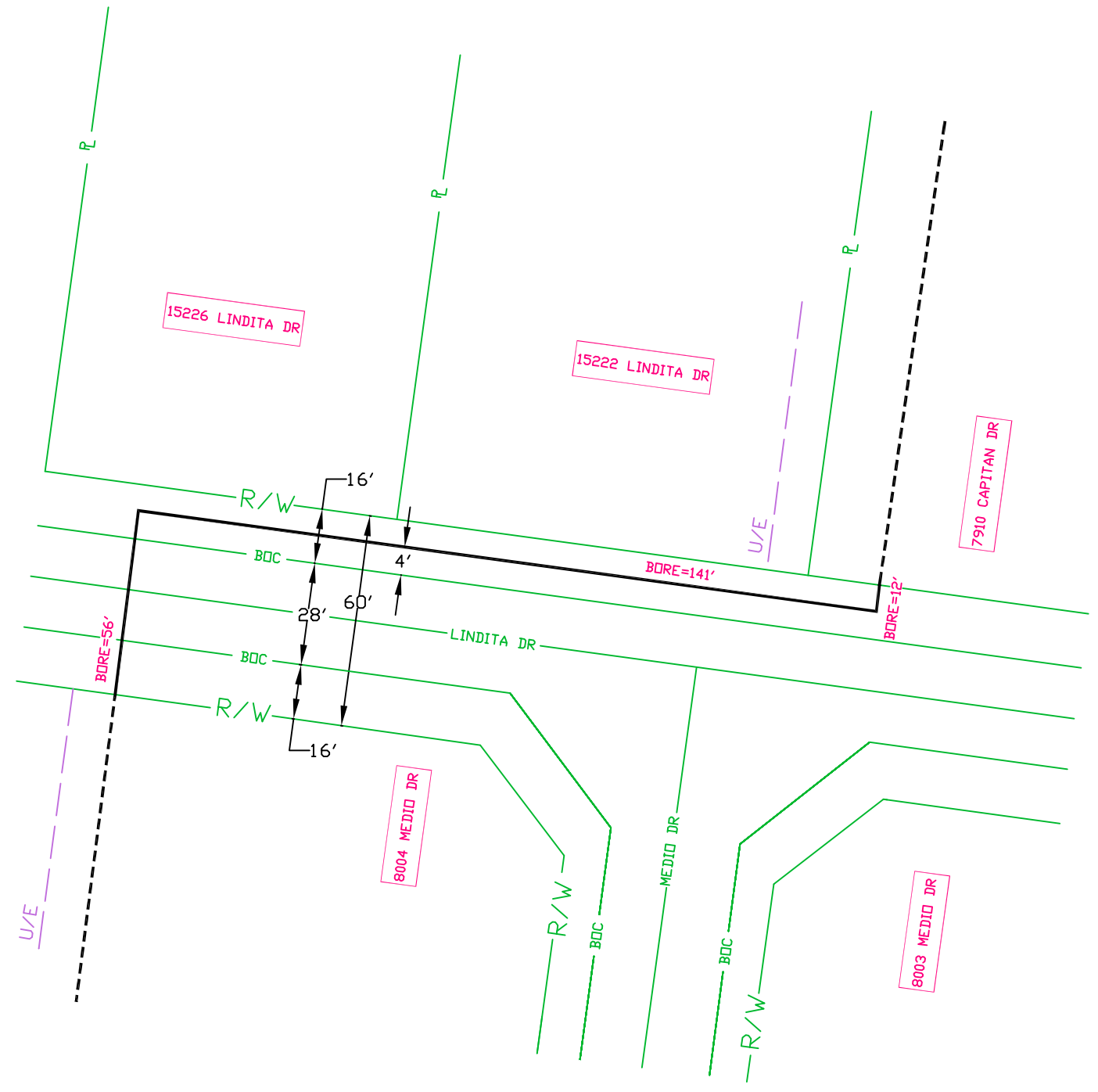

APPROXIMATE LOCATION MAP  
 WORK DONE IN FORT BEND COUNTY RIGHT OF WAY - PRINT FOR INFORMATIONAL PURPOSES ONLY

SPECIAL CIRCUITS N  
 6203 FORWARDED N  
 PERMIT REQUIRED Y

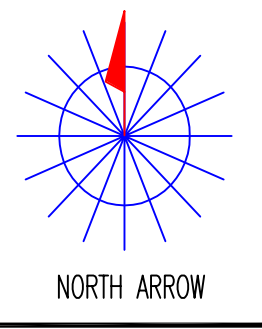

OPERATING RANGE OF JOB STEPS  
 TASK \_\_\_\_\_ TO \_\_\_\_\_  
 MFRC

TRANSMISSION ZONE  
 RZ 0 CZ 0 TAPER CODE 1166PA

CAUTION HIGH VOLTAGE  
 KV 0.00 AERIAL N BURIED N

HIGHWAY PERMIT NO.

Utility CO  
 REP NAME  
 REP TEL NO.  
 POLE CONTACTS (+) 0 (-) 0

Utility CO  
 REP NAME  
 REP TEL NO.  
 POLE CONTACTS (+) 0 (-) 0

Utility CO  
 REP NAME  
 REP TEL NO.  
 POLE CONTACTS (+) 0 (-) 0

PROJECT NO A012X6Q

TOT.PRINTS 67 PRINT NO. 64  
 NPA/NNX: 281-498 PRT:281498  
 EXCH. ALIEF  
 TAX DIST. FG071  
 GEO LOC. W85498  
 ENGR. SS DRAWN JW  
 TELEPHONE NO. (281) 320-3812  
 REC. REF.  
 MAP REF.  
 SCALE NONE  
 ISSUE DATE  
 PROJ TITLE LIGHTGIG-1166PA--DIST-AF  
 REV. NUMBER  
 DATE REV.

--Proprietary--  
 Not for use or disclosure outside the AT&T companies except under written agreement.



**BLACK & VEATCH**

DESIGN ENGINEER CONTACT:  
VLAD CHERNENKO  
BLACK & VEATCH  
(303) 264-0587  
CHERNENKOV@BV.COM

FORT BEND COUNTY  
PERMIT #  
SHOWN ON PRINT 32

DESIGN SUMMARY:  
-BORE AND PLACE FIBER.

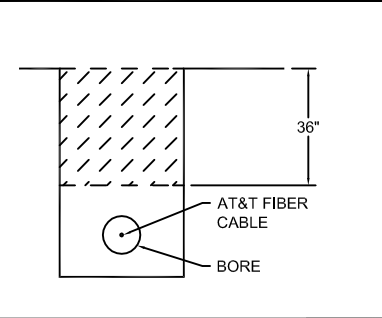

NTS

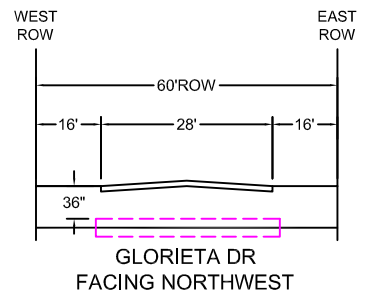

NTS

FORT BEND COUNTY NOTIFICATION

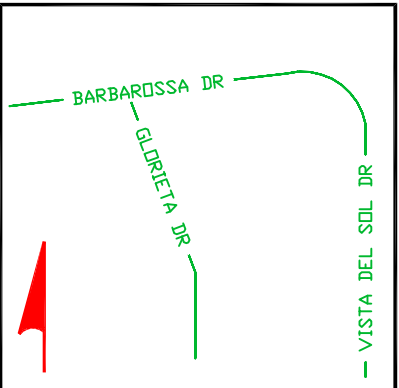

WORK DONE IN FORT BEND COUNTY RIGHT OF WAY - PRINT FOR INFORMATIONAL PURPOSES ONLY

SPECIAL CIRCUITS N  
6203 FORWARDED N  
PERMIT REQUIRED Y

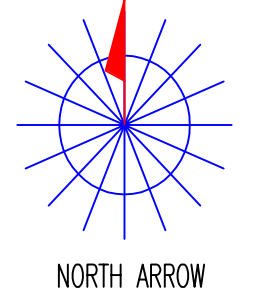

OPERATING RANGE OF JOB STEPS  
TASK \_\_\_\_\_ TO \_\_\_\_\_  
MFRC

TRANSMISSION ZONE  
RZ 0 CZ 0 TAPER CODE 1166PA

CAUTION HIGH VOLTAGE  
KV 0.00 AERIAL N BURIED N

HIGHWAY PERMIT NO.

Utility CO  
REP NAME  
REP TEL NO.  
POLE CONTACTS (+) 0 (-) 0

Utility CO  
REP NAME  
REP TEL NO.  
POLE CONTACTS (+) 0 (-) 0

Utility CO  
REP NAME  
REP TEL NO.  
POLE CONTACTS (+) 0 (-) 0

PROJECT NO A012X6Q

TOT.PRINTS 67 PRINT NO. 65  
NPA/NNX: 281-498 PRT:281498  
EXCH. ALIEF  
TAX DIST. FG071  
GEO LOC. W85498  
ENGR. SS DRAWN JW  
TELEPHONE NO. (281) 320-3812  
REC. REF.  
MAP REF.  
SCALE NONE  
ISSUE DATE  
PROJ TITLE LIGHTGIG-1166PA--DIST-AF  
REV. NUMBER  
DATE REV.

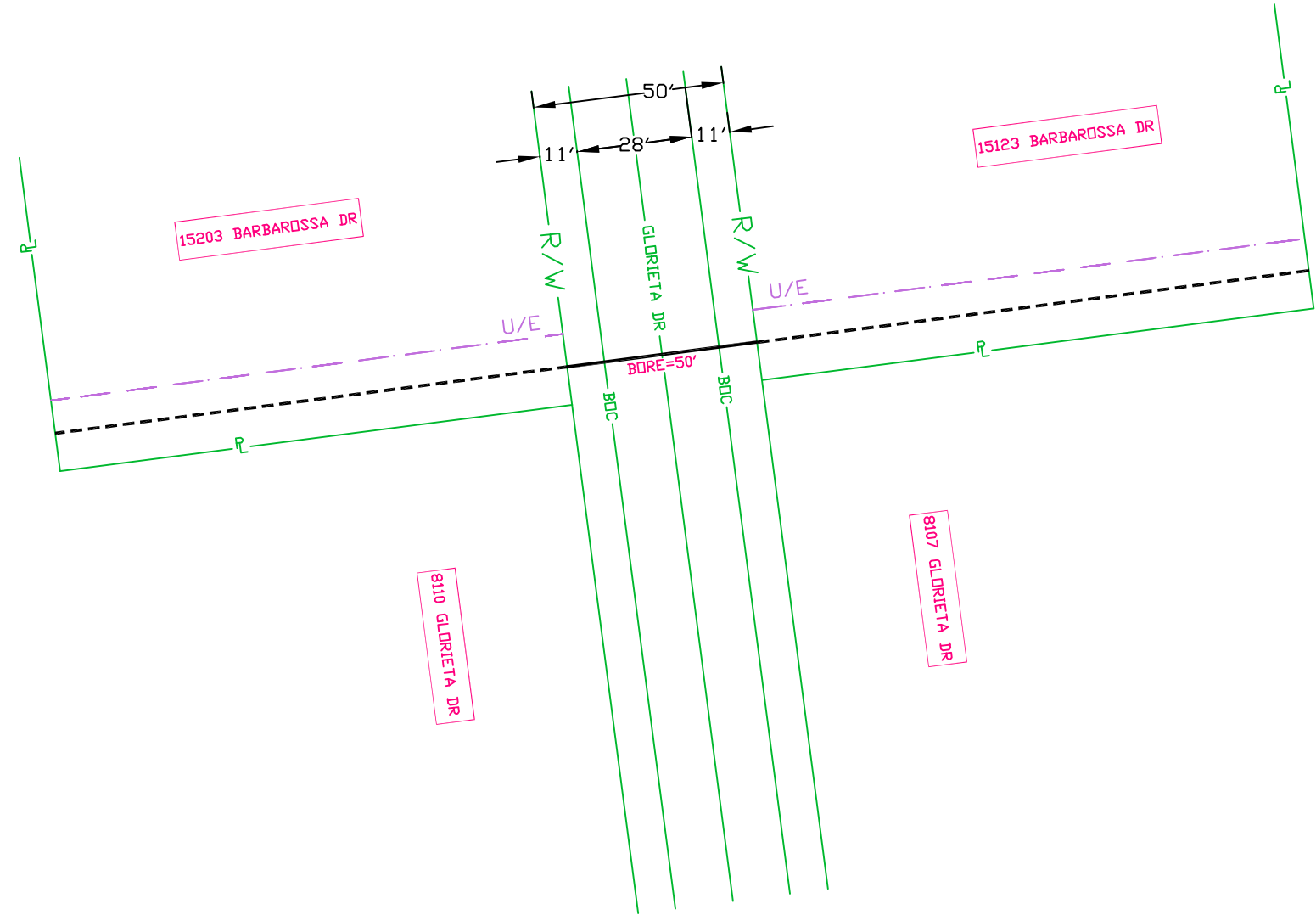

--Proprietary--  
Not for use or disclosure outside the AT&T companies except under written agreement.



**TRAFFIC CONTROL PLAN SECTION SHALL BE COMPLETED BY ENGINEER**

ROADWAY	POSTED SPEED	TAPER LENGTH	SPACING CHANNELIZING DEVICES		SIGN SPACING	BUFFER SPACE
			TAPER	TANGENT		
BEACHNUT ST	30	150'	30'	60'	120'	90'
ADDICKS CLODINE RD	30	180'	30'	60'	120'	90'

LEGEND			
	Type 3 Barricade		Channelizing Devices
	Heavy Work Vehicle		Truck Mounted Attenuator (TMA)
	Trailer Mounted Flashing Arrow Board		Portable Changeable Message Sign (PCMS)
	Sign		Traffic Flow
	Flag		Flagger

Posted Speed *	Formula	Minimum Desirable Taper Lengths "L"			Suggested Maximum Spacing of Channelizing Devices		Minimum Sign Spacing "X" Distance	Suggested Longitudinal Buffer Space "B"
		10' Offset	11' Offset	12' Offset	On a Taper	On a Tangent		
30	$L = \frac{WS^2}{60}$	150'	165'	180'	30'	60'	120'	90'
35		205'	225'	245'	35'	70'	160'	120'
40	L=WS	265'	295'	320'	40'	80'	240'	155'
45		450'	495'	540'	45'	90'	320'	195'
50	L=WS	500'	550'	600'	50'	100'	400'	240'
55		550'	605'	660'	55'	110'	500'	295'
60	L=WS	600'	660'	720'	60'	120'	600'	350'
65		650'	715'	780'	65'	130'	700'	410'
70	L=WS	700'	770'	840'	70'	140'	800'	475'
75		750'	825'	900'	75'	150'	900'	540'

\* Conventional Roads Only  
 \*\* Taper lengths have been rounded off.  
 L=Length of Taper(FT) W=Width of Offset(FT) S=Posted Speed(MPH)

**GENERAL NOTES**

- Flags attached to signs where shown are OPTIONAL.
- All traffic control devices illustrated are REQUIRED, except those denoted with the triangle symbol are OPTIONAL.
- Inactive work vehicles or other equipment should be parked near the right-of-way line and not parked on the paved shoulder.
- A Shadow Vehicle with a TMA should be used anytime it can be positioned 30 to 100 feet in advance of the area of crew exposure without adversely affecting the performance or quality of the work. If workers are no longer present but road or work conditions require the traffic control to remain in place, Type 3 Barricades or other channelizing devices may be substituted for the Shadow Vehicle and TMA.
- Additional Shadow Vehicles with TMAs may be positioned off the paved surface, next to those shown in order to protect wider work spaces.
- Contractor shall provide and install traffic control devices in conformance with part VI of Texas Manual on Uniform Traffic Control Devices (TMUTCD - Latest edition with revisions) during construction.
- No lanes shall be blocked from 7am to 9am and 4pm to 6:30pm Monday thru Friday.
- Off duty police officers/flaggers are required to direct traffic when applicable.
- If project is within 400 feet from a signalized intersection, the Contractor shall contact Harris County Engineering Department, Traffic Signal Maintenance at (713) 881-3210 five (5) days prior to the start of construction.

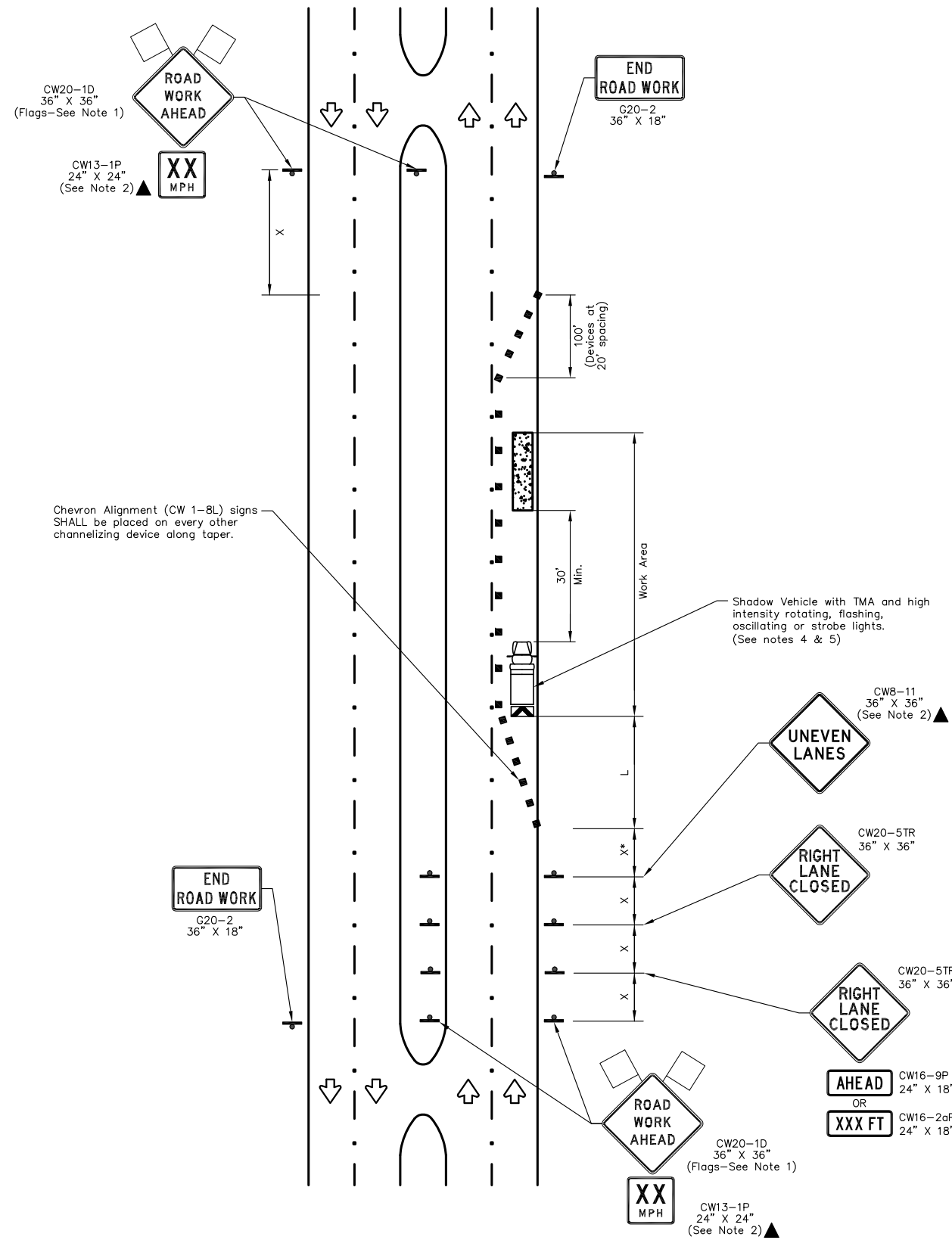

**RIGHT LANE CLOSURE (4 LANE BOULEVARD ROAD)**

NO.	REVISIONS	DATE	NAME
▲	UPDATED DEPARTMENT NAME & GENERAL NOTES	4/16/15	BSH
▲			
▲			
▲			

**FORT BEND COUNTY ENGINEERING DEPARTMENT**



CONSULTANT LOGO/INFORMATION

ENGINEERS SEAL

PROJECT TITLE:		HCED STANDARD
DRAWN BY:	BSH	41
CK'D BY:	BSH	SHEET DESCRIPTION:
SCALE:	N.T.S.	TRAFFIC CONTROL PLAN (RIGHT LANE CLOSURE)
DATE:	6/26/14	APPROVED BY:
		SHEET NO:
		/

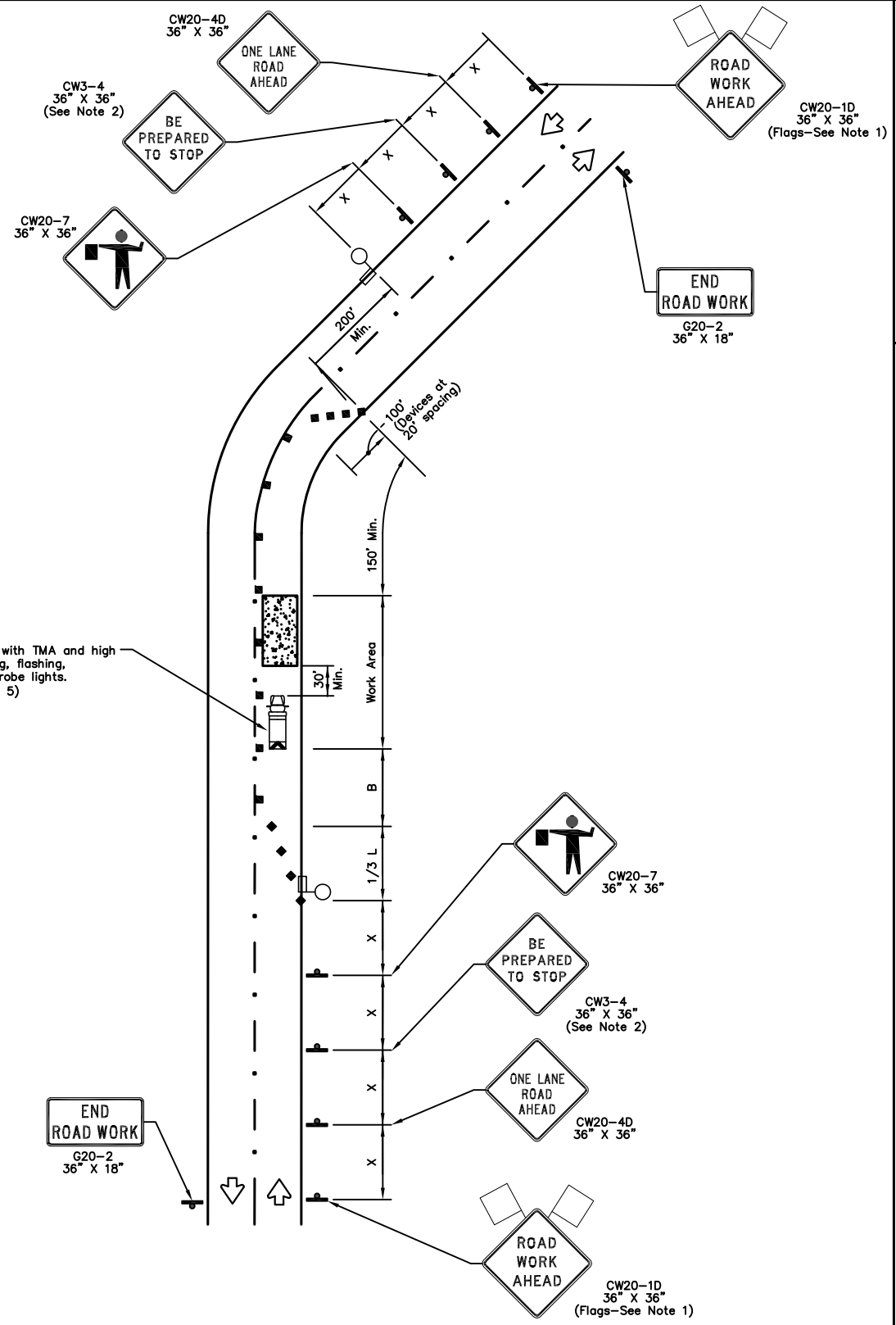

**ONE-LANE TWO-WAY SINGLE LANE CLOSURE  
CONTROL WITH FLAGGERS  
(ON CURVED SECTION OF ROADWAY)**

**TRAFFIC CONTROL PLAN SECTION SHALL BE  
COMPLETED BY ENGINEER**

ROADWAY	POSTED SPEED	TAPER LENGTH	SPACING CHANNELIZING DEVICES		SIGN SPACING	BUFFER SPACE
			TAPER	TANGENT		
LINDITA DR	30	180'	30'	60'	120'	90'
MONTESA DR	30	180'	30'	60'	120'	90'

LEGEND			
	Type 3 Barricade		Channelizing Devices
	Heavy Work Vehicle		Truck Mounted Attenuator (TMA)
	Trailer Mounted Flashing Arrow Board		Portable Changeable Message Sign (PCMS)
	Sign		Traffic Flow
	Flag		Flagger

Posted Speed *	Formula	Minimum Desirable Taper Lengths "L"			Suggested Maximum Spacing of Channelizing Devices		Minimum Sign Spacing "X" Distance	Suggested Longitudinal Buffer Space "B"
		10' Offset	11' Offset	12' Offset	On a Taper	On a Tangent		
30	L = WS <sup>2</sup> / 60	150'	165'	180'	30'	60'	120'	90'
35		205'	225'	245'	35'	70'	160'	120'
40	L=WS	265'	295'	320'	40'	80'	240'	155'
45		450'	495'	540'	45'	90'	320'	195'
50	L=WS	500'	550'	600'	50'	100'	400'	240'
55		550'	605'	660'	55'	110'	500'	295'
60	L=WS	600'	660'	720'	60'	120'	600'	350'
65		650'	715'	780'	65'	130'	700'	410'
70	L=WS	700'	770'	840'	70'	140'	800'	475'
75		750'	825'	900'	75'	150'	900'	540'

\* Conventional Roads Only  
 \*\* Taper lengths have been rounded off.  
 L=Length of Taper(FT) W=Width of Offset(FT) S=Posted Speed(MPH)

**GENERAL NOTES**

- Flags attached to signs where shown are OPTIONAL.
- All traffic control devices illustrated are REQUIRED, except those denoted with the triangle symbol are OPTIONAL.
- Inactive work vehicles or other equipment should be parked near the right-of-way line and not parked on the paved shoulder.
- A Shadow Vehicle with a TMA should be used anytime it can be positioned 30 to 100 feet in advance of the area of crew exposure without adversely affecting the performance or quality of the work. If workers are no longer present but road or work conditions require the traffic control to remain in place, Type 3 Barricades or other channelizing devices may be substituted for the Shadow Vehicle and TMA.
- Additional Shadow Vehicles with TMAs may be positioned off the paved surface, next to those shown in order to protect wider work spaces.
- Contractor shall provide and install traffic control devices in conformance with part VI of Texas Manual on Uniform Traffic Control Devices (TMUTCD - Latest edition with revisions) during construction.
- Flaggers should use two-way radios or other methods of communication to control traffic.
- Length of work space should be based on the ability of flaggers to communicate.
- If the work space is located near horizontal or vertical curve, the buffer distances should be increased in order to maintain adequate stopping sight distances to the flagger and a queue of stopped vehicles (see table above).
- Channelizing devices on the center-line may be omitted when a pilot car is leading traffic and approved by the Engineer.
- Flaggers should use 24" STOP/SLOW paddles to control traffic. Flags should be limited to emergency situations.
- No lanes shall be blocked from 7am to 9am and 4pm to 6:30pm Monday thru Friday.
- Off duty police officers required to direct traffic when applicable.
- If project is within 400 feet from a signalized intersection, the Contractor shall contact Harris County Engineering Department, Traffic Signal Maintenance at (713) 881-3210 five (5) days prior to the start of construction.

NO.	REVISIONS	DATE	NAME
▲	UPDATED DEPARTMENT NAME & GENERAL NOTES	4/16/15	BSH
▲			
▲			
▲			

**FORT BEND COUNTY  
ENGINEERING DEPARTMENT**



CONSULTANT  
LOGO/INFORMATION

ENGINEERS  
SEAL

PROJECT TITLE:		HCED STANDARD 39
DRAWN BY: BSH	SHEET DESCRIPTION: TRAFFIC CONTROL PLAN (ONE-LANE, TWO-WAY OPERATION)	
CK'D BY: BSH	SCALE: N.T.S.	SHEET NO: /
DATE: 6/26/14	APPROVED BY:	

TRAFFIC CONTROL PLAN SECTION SHALL BE COMPLETED BY ENGINEER

ROADWAY	POSTED SPEED	TAPER LENGTH	SPACING CHANNELIZING DEVICES		SIGN SPACING	BUFFER SPACE
			TAPER	TANGENT		
VIA BELLA DR	30	180'	30'	60'	120'	90'
BARBAROSSA DR	30	180'	30'	60'	120'	90'
EL SABIO DR	30	180'	30'	60'	120'	90'
GLORIETA DR	30	180'	30'	60'	120'	90'
WINKLEMAN RD	30	180'	30'	60'	120'	90'

LEGEND			
	Type 3 Barricade		Channelizing Devices
	Heavy Work Vehicle		Truck Mounted Attenuator (TMA)
	Trailer Mounted Flashing Arrow Board		Portable Changeable Message Sign (PCMS)
	Sign		Traffic Flow
	Flag		Flagger

Posted Speed *	Formula	Minimum Desirable Taper Lengths "L"			Suggested Maximum Spacing of Channelizing Devices		Minimum Sign Spacing "X" Distance	Suggested Longitudinal Buffer Space "B"
		10' Offset	11' Offset	12' Offset	On a Taper	On a Tangent		
30	$L = \frac{WS^2}{60}$	150'	165'	180'	30'	60'	120'	90'
35		205'	225'	245'	35'	70'	160'	120'
40	L=WS	265'	295'	320'	40'	80'	240'	155'
45		450'	495'	540'	45'	90'	320'	195'
50	L=WS	500'	550'	600'	50'	100'	400'	240'
55		550'	605'	660'	55'	110'	500'	295'
60	L=WS	600'	660'	720'	60'	120'	600'	350'
65		650'	715'	780'	65'	130'	700'	410'
70	L=WS	700'	770'	840'	70'	140'	800'	475'
75		750'	825'	900'	75'	150'	900'	540'

\* Conventional Roads Only  
 \*\* Taper lengths have been rounded off.  
 L=Length of Taper(FT) W=Width of Offset(FT) S=Posted Speed(MPH)

GENERAL NOTES

- Flags attached to signs where shown are OPTIONAL.
- All traffic control devices illustrated are REQUIRED, except those denoted with the triangle symbol are OPTIONAL.
- Inactive work vehicles or other equipment should be parked near the right-of-way line and not parked on the paved shoulder.
- A Shadow Vehicle with a TMA should be used anytime it can be positioned 30 to 100 feet in advance of the area of crew exposure without adversely affecting the performance or quality of the work. If workers are no longer present but road or work conditions require the traffic control to remain in place, Type 3 Barricades or other channelizing devices may be substituted for the Shadow Vehicle and TMA.
- Additional Shadow Vehicles with TMAs may be positioned off the paved surface, next to those shown in order to protect wider work spaces.
- Contractor shall provide and install traffic control devices in conformance with part VI of Texas Manual on Uniform Traffic Control Devices (TMUTCD - Latest edition with revisions) during construction.
- Flaggers should use two-way radios or other methods of communication to control traffic.
- Length of work space should be based on the ability of flaggers to communicate.
- If the work space is located near horizontal or vertical curve, the buffer distances should be increased in order to maintain adequate stopping sight distances to the flagger and a queue of stopped vehicles (see table above).
- Channelizing devices on the center-line may be omitted when a pilot car is leading traffic and approved by the Engineer.
- Flaggers should use 24" STOP/SLOW paddles to control traffic. Flags should be limited to emergency situations.
- No lanes shall be blocked from 7am to 9am and 4pm to 6:30pm Monday thru Friday.
- Off duty police officers required to direct traffic when applicable.
- If project is within 400 feet from a signalized intersection, the Contractor shall contact Harris County Engineering Department, Traffic Signal Maintenance at (713) 881-3210 five (5) days prior to the start of construction.

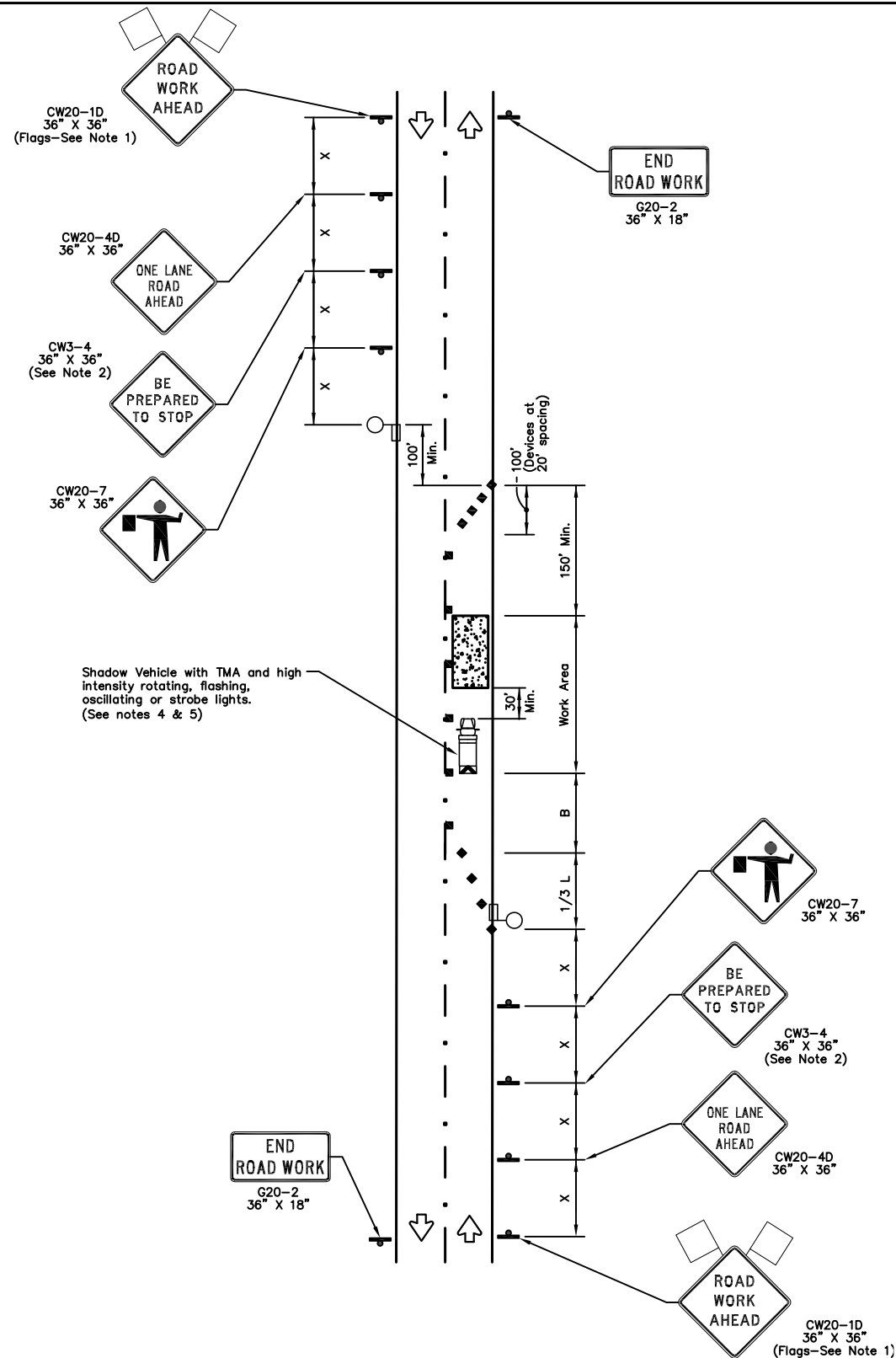

ONE-LANE TWO-WAY SINGLE LANE CLOSURE  
 CONTROL WITH FLAGGERS  
 (ON STRAIGHT SECTION OF ROADWAY)

NO.	REVISIONS	DATE	NAME
1	UPDATED DEPARTMENT NAME & GENERAL NOTES	4/16/15	BSH
2			
3			
4			

**FORT BEND COUNTY**  
**ENGINEERING DEPARTMENT**



CONSULTANT  
 LOGO/INFORMATION

ENGINEERS  
 SEAL

PROJECT TITLE:		
DRAWN BY: BSH	SHEET DESCRIPTION: TRAFFIC CONTROL PLAN (ONE-LANE, TWO-WAY OPERATION)	HCD STANDARD 39
CK'D BY: BSH		
SCALE: N.T.S.		SHEET NO: /
DATE: 6/26/14	APPROVED BY:	