



**PERMIT APPLICATION REVIEW FORM FOR
CABLE, CONDUIT, AND POLE LINE ACTIVITY
IN FORT BEND COUNTY**

**Fort Bend County
Engineering Department**
301 Jackson Suite 401
Richmond, Texas 77469
281.633.7500
Permits@fortbendcountytx.gov

- Right of Way Permit**
 Commercial Driveway Permit

Permit No: 2016-8509

The following "Notice of Proposed Cable, Conduit, and/or Pole Line activity in Fort Bend County" and accompanying attachments have been reviewed and the notice conforms to appropriate regulations set by Commissioner's Court of Fort Bend County, Texas.

(1) COMPLETE APPLICATION FORM:

- a. Name of road, street, and/or drainage ditch affected.
 b. Vicinity map showing course of directions
 c. Plans and specifications

(2) BOND:

- County Attorney, approval when applicable.
- Perpetual bond currently posted. Bond No: Amount: \$50,000.00
- Performance bond submitted. Bond No: Amount:
- Cashier's Check Check No: Amount:

(3) DRAINAGE DISTRICT APPROVAL (WHEN APPLICABLE):

Drainage District Approval

Date

We have reviewed this project and agree it meets minimum requirements.

Charles O. Ay

Permit Administrator

12/21/2017

Date



**REVIEW BY FORT BEND COUNTY
COMMISSIONERS COURT**

**Fort Bend County
Engineering Department**
301 Jackson Suite 401
Richmond, Texas 77469
281.633.7500
Permits@fortbendcountytx.gov

Right of Way Permit

Commercial Driveway Permit

Permit No: 2016-8509

Applicant: AT & T

Job Location Site: Powerline Road, Richmond, TX 77469

Bond No. **Date of Bond:** 11/28/2017 **Amount:** \$50,000.00

The above applicant came to make use of certain Fort Bend County property subject to, "The Order Regulating the Laying, Construction, Maintenance, and Repair of Buried Cables, Conduits, and Pole Lines, In, Under, Across or Along Roads, Streets, Highways, and Drainage Ditches in Fort Bend County, Texas, Under the Jurisdiction of the Commissioners Court of Fort Bend County, Texas," as passed by the Commissioners Court of Fort Bend County, Texas, of the Minutes of the Commissioners Court of Fort Bend County, Texas, to the extent that such order is not inconsistent with Chapter 181, Vernon's Texas Statutes and Codes Annotated.

Notes:

1. Evidence of review by the Commissioners Court must be kept on the job site and failure to do so constitutes grounds for job shutdown.
2. Written notices are required:
 - a. 48 hours in advance of construction start up, and
 - b. When construction is completed and ready for final inspection, submit notification to Permit Administrator thru MyGovernmentOnline.org portal.
3. This permit expires one (1) year from date of permit if construction has not commenced.

On this 2nd day of January, 2018, Upon Motion of Commissioner _____, seconded by Commissioner _____, duly put and carried, it is ORDERED, ADJUDGED AND DECREED that said notice of said above purpose is hereby acknowledged by the Commissioners Court of Fort Bend County, Texas, and that said notice be placed on record according to the regulation order thereof.

Signature

Presented to Commissioners Court and approved.

By: 
County Engineer

Date Recorded _____ Comm. Court No. _____

By: N/A
Drainage District Engineer/Manager

Clerk of Commissioners Court

By: _____
Deputy

USE OF MINI-TRACKS & BACKHOE FOR LONG/SHORT LINES SHALL BE PROHIBITED.

NOTICE
NOTIFY THE PERMIT OFFICE
48 HOURS IN ADVANCE OF
CONSTRUCTION

1 (AFMW-600)
45X; 0'; 1991



UNDERGROUND UTILITIES HAVE BEEN PLOTTED FROM AVAILABLE RECORDS AND FIELD OBSERVATIONS BUT ARE NOT NECESSARILY EXACT. THEREFORE, UTILITY LOCATIONS WILL BE VERIFIED AT LEAST 100' IN ADVANCE OF TRENCHES, PLOWING OR BORING, SO THAT CHANGES IN CABLE PLACEMENT CAN BE MADE IN THE EVENT OF CONFLICT.

BY TXDOT UNTIL FURTHER NOTICE...

SPECIAL CIRCUITS N
6203 FORWARDED N
PERMIT REQUIRED Y

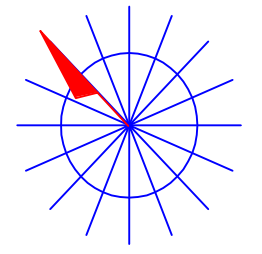

NORTH ARROW

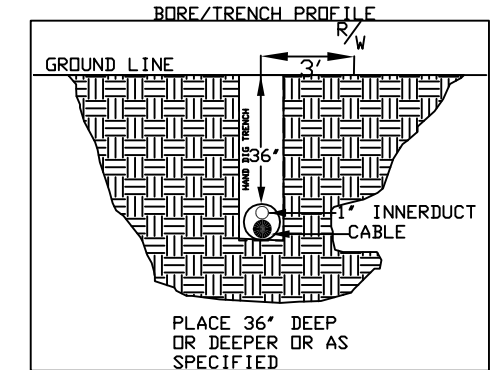
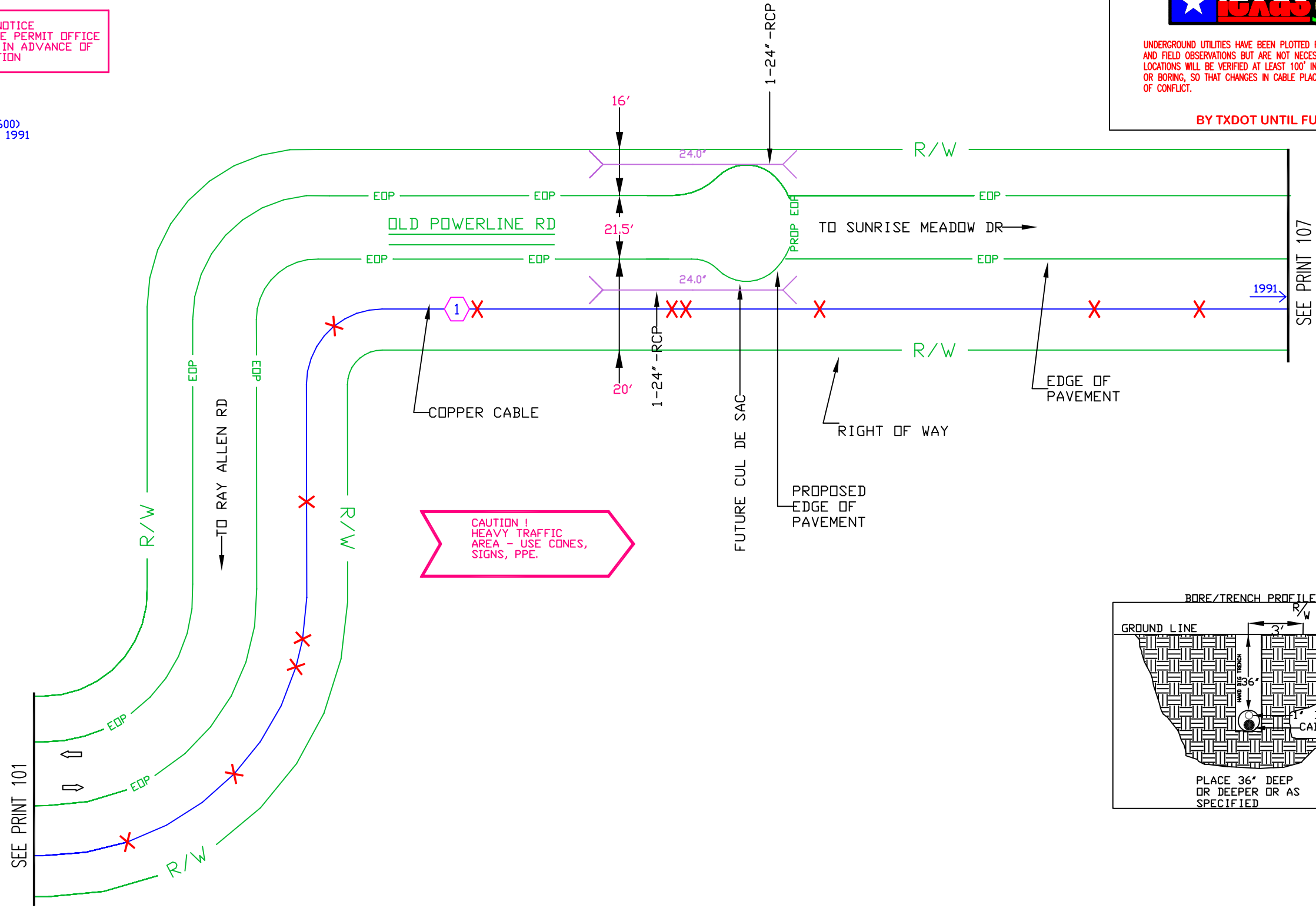

SEE PRINT 101

SEE PRINT 107

CONTRACTORS:

THE LOCATIONS OF EXISTING TELEPHONE UTILITIES ARE SHOWN IN AN APPROXIMATE WAY ONLY AND HAVE NOT BEEN INDEPENDENTLY VERIFIED BY THE OWNER OR ITS REPRESENTATIVE. THE CONTRACTOR SHALL DETERMINE THE EXACT LOCATION OF ALL EXISTING UTILITIES BEFORE COMMENCING WORK, AND AGREES TO BE FULLY RESPONSIBLE FOR ANY AND ALL DAMAGES WHICH MIGHT BE OCCASIONED BY THE CONTRACTOR'S FAILURE TO EXACTLY LOCATE AND PRESERVE ANY AND ALL UTILITIES. 48 HOURS PRIOR TO EXCAVATING FOR NON-TELEPHONE UTILITIES LOCATES CALL 811

--Proprietary--

Not for use or disclosure outside the AT&T companies except under written agreement.

OPERATING RANGE OF JOB STEPS	
TASK _____	TO _____
MFRC 45C	
TRANSMISSION ZONE	
RZ 0	CZ 0 TAPER CODE
CAUTION HIGH VOLTAGE	
KV 7.20	AERIAL Y BURIED N
HIGHWAY PERMIT NO.	
Utility CO	CENT - CENTER POINT
REP NAME	
REP TEL NO.	(713) 207-2222
POLE CONTACTS	(+) 0 (-) 0
Utility CO	
REP NAME	
REP TEL NO.	
POLE CONTACTS	(+) 0 (-) 0
Utility CO	
REP NAME	
REP TEL NO.	
POLE CONTACTS	(+) 0 (-) 0

PROJECT NO A00ESJG	
TOT.PRINTS 0	PRINT NO. 106
NPA/NNX: 281-232	PRT:281232
EXCH. RICH-ROSE	
TAX DIST. FG009	
GEO LOC. W89232	
ENGR. CC	DRAWN DP
TELEPHONE NO. (713) 218-8177	
REC. REF. 225-265-72-1	
MAP REF. 645 K	
SCALE NONE	
ISSUE DATE	
PROJ TITLE POWERLINE RD PROJECT	
REV. NUMBER	
DATE REV.	

POWERLINE RD AND SPICE SPRINGS LN	SCALE: NONE EVD: A00ESJG NPANNX: 281232 - RICH ROSE
	CFA DESIGN ENG: DEVIN PULLIAM DATE: 07-07-2016 KEY MAP: 645 K PLAT: 106-107 DWG NAME: POWERLINE RD PROJECT

USE OF MINI-TRACKS & BACKHOE FOR LONG/SHORT LINES SHALL BE PROHIBITED.

NOTICE
NOTIFY THE PERMIT OFFICE
48 HOURS IN ADVANCE OF
CONSTRUCTION

1 (AFMW-600)
45X; 0'; 1991

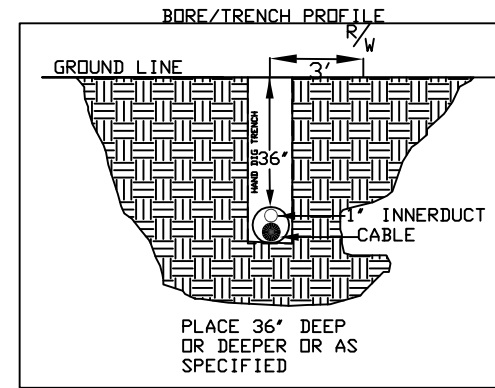

UNDERGROUND UTILITIES HAVE BEEN PLOTTED FROM AVAILABLE RECORDS AND FIELD OBSERVATIONS BUT ARE NOT NECESSARILY EXACT. THEREFORE, UTILITY LOCATIONS WILL BE VERIFIED AT LEAST 100' IN ADVANCE OF TRENCHES, PLOWING OR BORING, SO THAT CHANGES IN CABLE PLACEMENT CAN BE MADE IN THE EVENT OF CONFLICT.

BY TXDOT UNTIL FURTHER NOTICE...

SPECIAL CIRCUITS N
6203 FORWARDED N
PERMIT REQUIRED Y

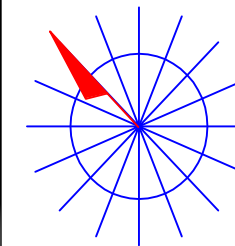

NORTH ARROW

OPERATING RANGE OF JOB STEPS

TASK _____ TO _____

MFRC 45C

TRANSMISSION ZONE
RZ 0 CZ 0 TAPER CODE

CAUTION HIGH VOLTAGE
KV 7.20 AERIAL Y BURIED N

HIGHWAY PERMIT NO.

Utility CO CENT - CENTER POINT
REP NAME
REP TEL NO. (713) 207-2222
POLE CONTACTS (+) 0 (-) 0

Utility CO
REP NAME
REP TEL NO.
POLE CONTACTS (+) 0 (-) 0

Utility CO
REP NAME
REP TEL NO.
POLE CONTACTS (+) 0 (-) 0

PROJECT NO A00ESJG

TOT.PRINTS 0 PRINT NO. 107

NPA/NNX: 281-232 PRT:281232

EXCH. RICH-ROSE

TAX DIST. FG009

GEO LOC. W89232

ENGR. CC DRAWN DP

TELEPHONE NO. (713) 218-8177

REC. REF. 225-265-72-1

MAP REF. 645 K

SCALE NONE

ISSUE DATE

PROJ TITLE POWERLINE RD PROJECT

REV. NUMBER

DATE REV.

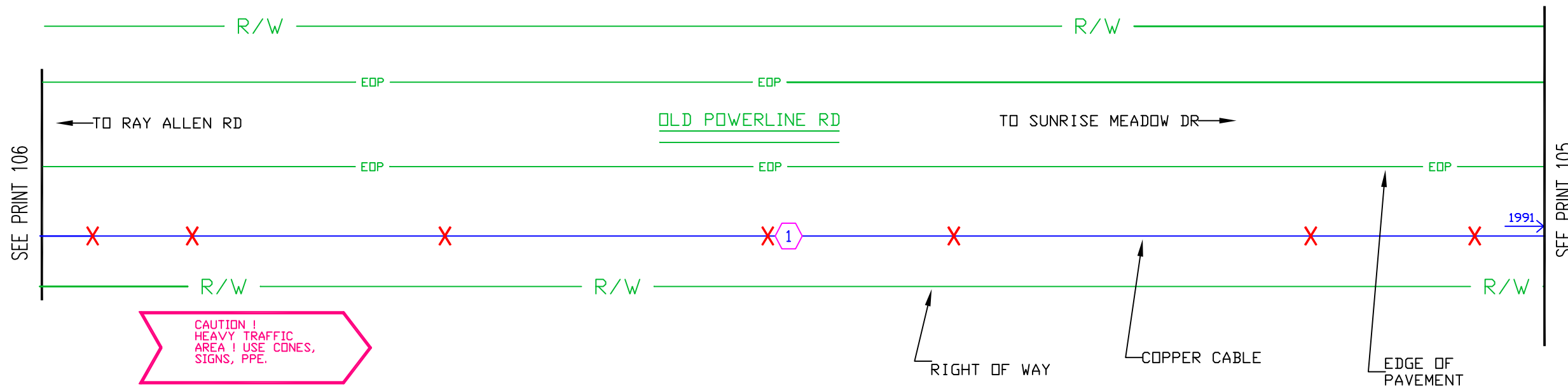

CONTRACTORS:

THE LOCATIONS OF EXISTING TELEPHONE UTILITIES ARE SHOWN IN AN APPROXIMATE WAY ONLY AND HAVE NOT BEEN INDEPENDENTLY VERIFIED BY THE OWNER OR ITS REPRESENTATIVE. THE CONTRACTOR SHALL DETERMINE THE EXACT LOCATION OF ALL EXISTING UTILITIES BEFORE COMMENCING WORK, AND AGREES TO BE FULLY RESPONSIBLE FOR ANY AND ALL DAMAGES WHICH MIGHT BE OCCASIONED BY THE CONTRACTOR'S FAILURE TO EXACTLY LOCATE AND PRESERVE ANY AND ALL UTILITIES. 48 HOURS PRIOR TO EXCAVATING FOR NON-TELEPHONE UTILITIES LOCATES CALL 811

--Proprietary--

Not for use or disclosure outside the AT&T companies except under written agreement.

POWERLINE RD AND SPICE SPRINGS LN	SCALE: NONE
	EVD: A00ESJG NPANX: 281232 - RICH ROSE
CobbFendley	CFA DESIGN ENG: DEVIN PULLIAM
	DATE: 07-07-2016
	KEY MAP: 645 K
	PLAT: 107-107
	DWG NAME: POWERLINE RD PROJECT

WIRE CENTER CLLI : RSBGTXR
CABLE TYPE IDF & ACCESS

NO SPLICING PERFORMED
ON THIS PRINT.

USE OF MINI-TRACKS & BACKHOE
FOR LONG/SHORT LINES
SHALL BE PROHIBITED.

NOTICE
NOTIFY THE PERMIT OFFICE
48 HOURS IN ADVANCE OF
CONSTRUCTION

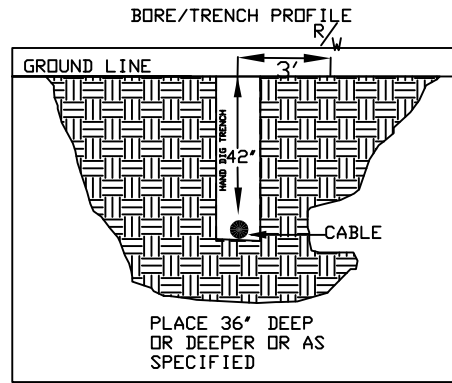

UNDERGROUND UTILITIES HAVE BEEN PLOTTED FROM AVAILABLE RECORDS AND FIELD OBSERVATIONS BUT ARE NOT NECESSARILY EXACT. THEREFORE, UTILITY LOCATIONS WILL BE VERIFIED AT LEAST 100' IN ADVANCE OF TRENCHES, PLOWING OR BORING, SO THAT CHANGES IN CABLE PLACEMENT CAN BE MADE IN THE EVENT OF CONFLICT.

BY TXDOT UNTIL FURTHER NOTICE...

SPECIAL CIRCUITS N
6203 FORWARDED N
PERMIT REQUIRED Y

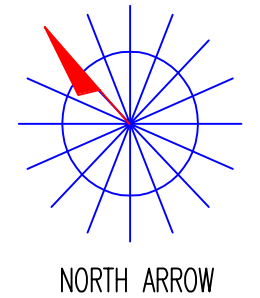

1 PRINT 2

1 ANMW-600
45C; 0'
129, 851-900
129, 1951-2000
A, 101-600

2 PRINT 6

2 ANMW-50
45C; 0'
A, 26-50
394P, 301-325

3 PRINT 2

4 (AFMW-600)
45X; 0'; 1991
(129, 851-900)
(129, 1951-2000)
(A, 101-600)

4 PRINT 6

3 (AFAW-50)
45X; 0'; 1979
(A, 26-50)
(394P, 301-325)

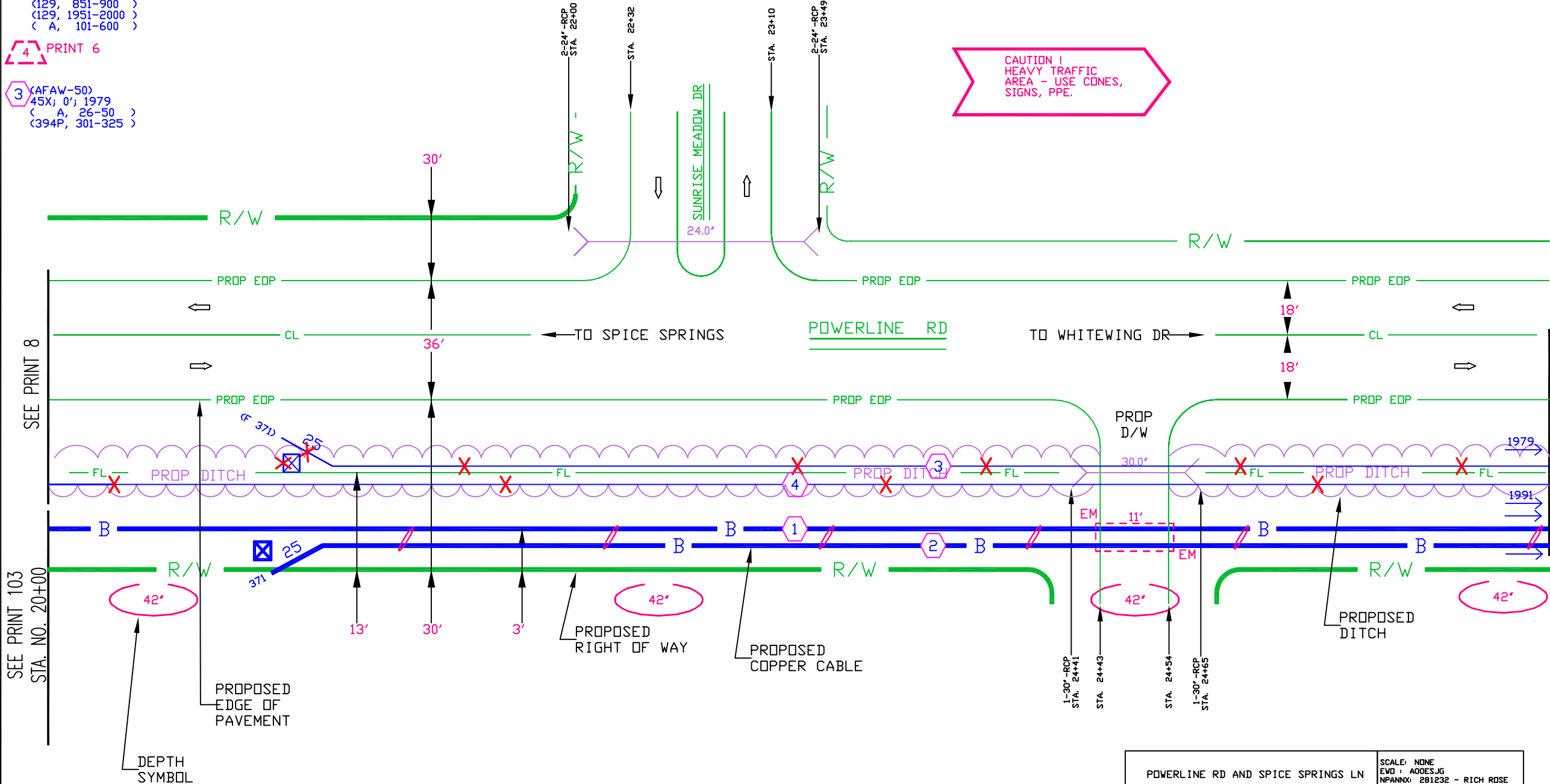

CAUTION!
HEAVY TRAFFIC
AREA - USE CONES,
SIGNS, PPE.

OPERATING RANGE OF JOB STEPS
TASK _____ TO _____
MFRC 45C

TRANSMISSION ZONE
RZ 0 CZ 0 TAPER CODE

CAUTION HIGH VOLTAGE
KV 7.20 AERIAL Y BURIED N

HIGHWAY PERMIT NO.

Utility CO CENT - CENTER POINT
REP NAME
REP TEL NO. (713) 207-2222
POLE CONTACTS (+) 0 (-) 0

Utility CO
REP NAME
REP TEL NO.
POLE CONTACTS (+) 0 (-) 0

Utility CO
REP NAME
REP TEL NO.
POLE CONTACTS (+) 0 (-) 0

PROJECT NO A00ESJG

TOT.PRINTS 0 PRINT NO. 104
NPA/NNX: 281-232 PRT:281232
EXCH. RICH-ROSE
TAX DIST. FG009
GEO LOC. W89232
ENGR. CC DRAWN DP
TELEPHONE NO. (713) 218-8177

REC. REF. 225-265-72-1
MAP REF. 645 K
SCALE NONE
ISSUE DATE
PROJ TITLE POWERLINE RD PROJECT
REV. NUMBER
DATE REV.

POWERLINE RD AND SPICE SPRINGS LN

SCALE: NONE
EWD: A00ESJG
NPANNX: 281232 - RICH ROSE

CFA DESIGN ENG: DEVIN PULLIAM
DATE: 07-07-2016
KEY MAP: 645 K
PLAT: 104-107
DWG NAME: POWERLINE RD PROJECT

NEW FIBER HANHOLE @ GRADE
W/COVER - 17"x30"x34"

NOTE: AT&T CONTRACTOR-PLACE
HAND HOLE AS CLOSE AS
POSSIBLE TO R.O.W.

USE OF MINI-TRACKS & BACKHOE
FOR LONG/SHORT LINES
SHALL BE PROHIBITED.

NOTICE
NOTIFY THE PERMIT OFFICE
48 HOURS IN ADVANCE OF
CONSTRUCTION

- 1 AFMW-600
45M; 0'; 1991
- 2 ANMW-600
45C; 2200'
- 3 XAFMW-600
45X; 2200'; 1991

FORT BEND COUNTY
PERMIT DRAWING

PLACING COPPER CABLE BY WAY
OF TRENCH AND BORE. RETIRING
IN PLACE 2 COPPER CABLES IN
CONFLICT WITH ROAD WAY
CONSTRUCTION. APPROX. 2,900'
OF COPPER CABLE PLACED ON
THIS PROJECT IN THE
SOUTH-EAST BOUND RIGHT OF
WAY OF POWERLINE RD.

BEFORE YOU DIG
Texas 811.com

UNDERGROUND UTILITIES HAVE BEEN PLOTTED FROM AVAILABLE RECORDS
AND FIELD OBSERVATIONS BUT ARE NOT NECESSARILY EXACT. THEREFORE, UTILITY
LOCATIONS WILL BE VERIFIED AT LEAST 100' IN ADVANCE OF TRENCHES, PLOWING
OR BORING, SO THAT CHANGES IN CABLE PLACEMENT CAN BE MADE IN THE EVENT
OF CONFLICT.

BY TXDOT UNTIL FURTHER NOTICE...

SPECIAL CIRCUITS N
6203 FORWARDED N
PERMIT REQUIRED Y

NORTH ARROW

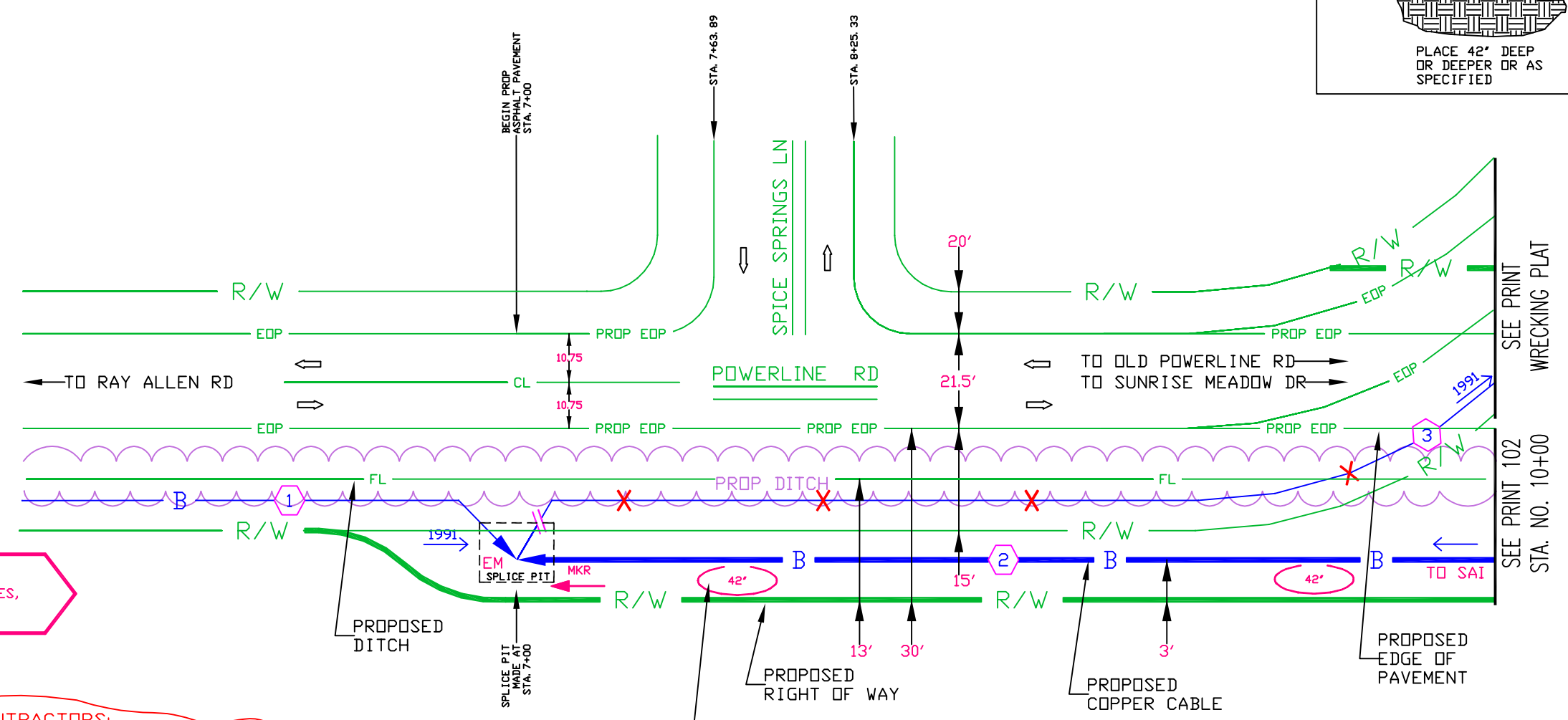
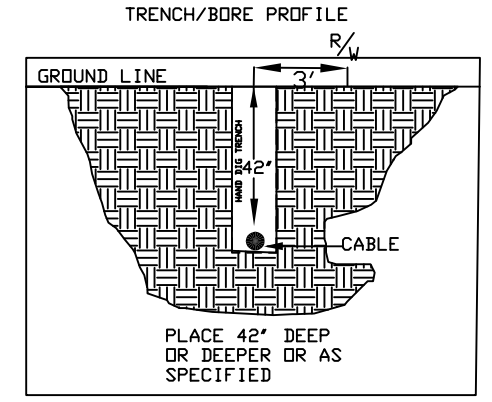

CAUTION!
HEAVY TRAFFIC
AREA - USE CONES,
SIGNS, PPE.

CONTRACTORS:

THE LOCATIONS OF EXISTING TELEPHONE UTILITIES ARE SHOWN
IN AN APPROXIMATE WAY ONLY AND HAVE NOT BEEN
INDEPENDENTLY VERIFIED BY THE OWNER OR ITS REPRESENTATIVE.
THE CONTRACTOR SHALL DETERMINE THE EXACT LOCATION OF ALL EXISTING
UTILITIES BEFORE COMMENCING WORK, AND AGREES TO BE FULLY RESPONSIBLE
FOR ANY AND ALL DAMAGES WHICH MIGHT BE OCCASIONED BY THE
CONTRACTOR'S FAILURE TO EXACTLY LOCATE AND PRESERVE ANY AND ALL UTILITIES.
48 HOURS PRIOR TO EXCAVATING
FOR NON-TELEPHONE UTILITIES LOCATES
CALL 811

POWERLINE RD AND SPICE SPRINGS LN

SCALE: NONE
EVD: A00ESJG
NPANNX: 281232 - RICH ROSE

CobbFendley

CFA DESIGN ENG DEVIN PULLIAM
DATE: 07-07-2016
KEY MAP: 645 K
PLAT: 101-109
DWG NAME: POWERLINE RD PROJECT

OPERATING RANGE OF JOB STEPS
TASK _____ TO _____
MFRC 45C

TRANSMISSION ZONE
RZ 0 CZ 0 TAPER CODE

CAUTION HIGH VOLTAGE
KV 7.20 AERIAL Y BURIED N

HIGHWAY PERMIT NO.

Utility CO **CENT - CENTER POINT**
REP NAME
REP TEL NO. (713) 207-2222
POLE CONTACTS (+) 0 (-) 0

Utility CO
REP NAME
REP TEL NO.
POLE CONTACTS (+) 0 (-) 0

Utility CO
REP NAME
REP TEL NO.
POLE CONTACTS (+) 0 (-) 0

PROJECT NO **A00ESJG**

TOT.PRINTS 0 PRINT NO. 101
NPA/NNX: 281-232 PRT:281232
EXCH. **RICH-ROSE**
TAX DIST. **FG009**
GEO LOC. **W89232**
ENGR. **CC** DRAWN **DP**
TELEPHONE NO. (713) 218-8177
REC. REF. 225-265-72-1
MAP REF. 645 K
SCALE **NONE**
ISSUE DATE
PROJ TITLE **POWERLINE RD PROJECT**
REV. NUMBER
DATE REV.

USE OF MINI-TRACKS & BACKHOE FOR LONG/SHORT LINES SHALL BE PROHIBITED.

NOTICE
NOTIFY THE PERMIT OFFICE
48 HOURS IN ADVANCE OF
CONSTRUCTION

- 1 ANMW-600
45C; 2000'
- 2 AFMW-600
45M; 0'; 1991
- 3 ANMW-50
45C; 700'
- 4 AFAW-50
45M; 0'; 1979
- 5 AFAW-50
45X; 700'; 1979

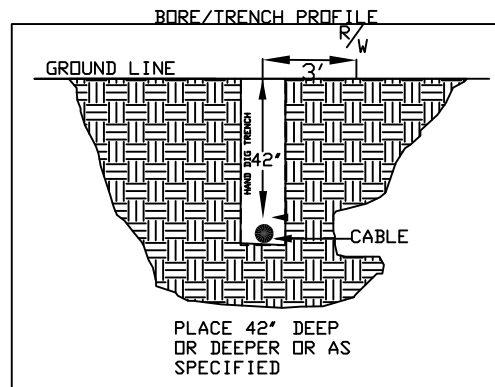

BEFORE YOU DIG
Texas 811.com

UNDERGROUND UTILITIES HAVE BEEN PLOTTED FROM AVAILABLE RECORDS AND FIELD OBSERVATIONS BUT ARE NOT NECESSARILY EXACT. THEREFORE, UTILITY LOCATIONS WILL BE VERIFIED AT LEAST 100' IN ADVANCE OF TRENCHES, PLOWING OR BORING, SO THAT CHANGES IN CABLE PLACEMENT CAN BE MADE IN THE EVENT OF CONFLICT.

BY TXDOT UNTIL FURTHER NOTICE...

SPECIAL CIRCUITS N
6203 N
FORWARDED N
PERMIT Y
REQUIRED Y

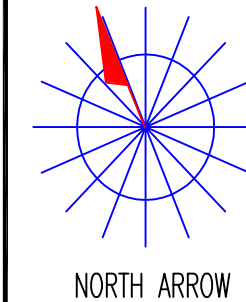

CAUTION!
HEAVY TRAFFIC
AREA - USE CONES,
SIGNS, PPE.

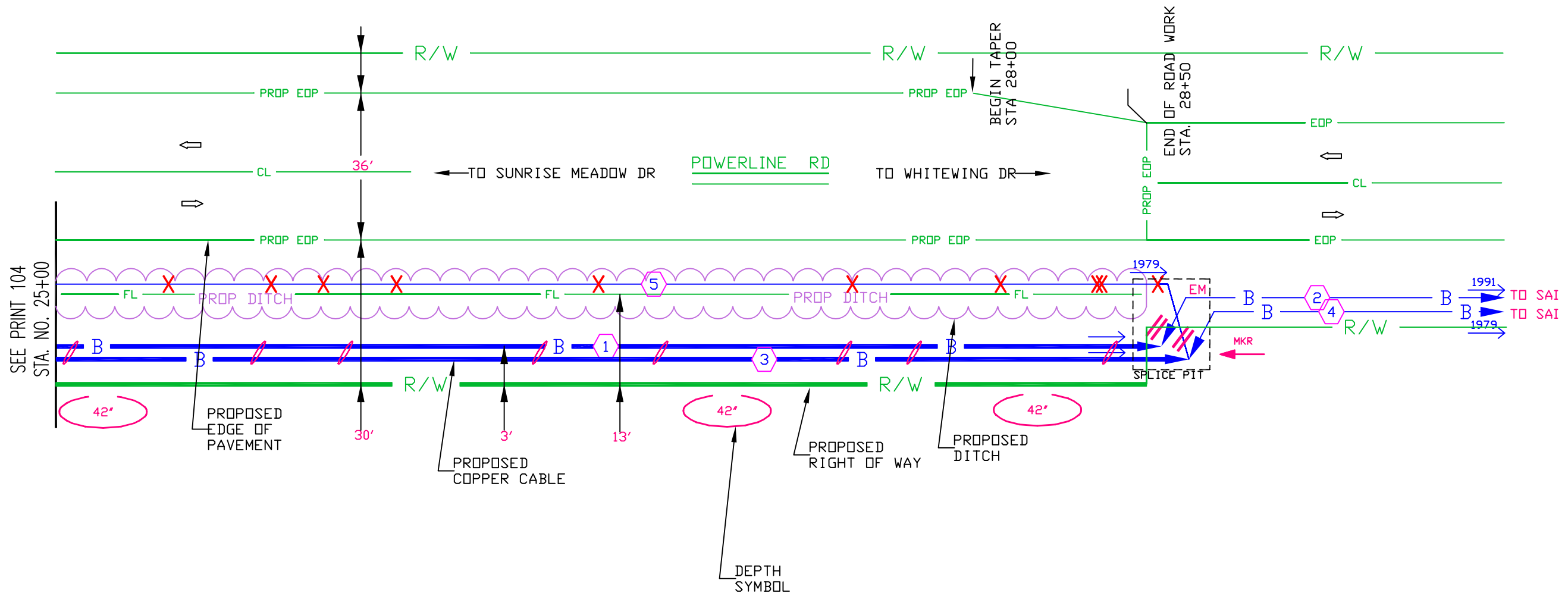

SEE PRINT 104
STA. NO. 25+00

CONTRACTORS:

THE LOCATIONS OF EXISTING TELEPHONE UTILITIES ARE SHOWN IN AN APPROXIMATE WAY ONLY AND HAVE NOT BEEN INDEPENDENTLY VERIFIED BY THE OWNER OR ITS REPRESENTATIVE. THE CONTRACTOR SHALL DETERMINE THE EXACT LOCATION OF ALL EXISTING UTILITIES BEFORE COMMENCING WORK, AND AGREES TO BE FULLY RESPONSIBLE FOR ANY AND ALL DAMAGES WHICH MIGHT BE OCCASIONED BY THE CONTRACTOR'S FAILURE TO EXACTLY LOCATE AND PRESERVE ANY AND ALL UTILITIES. 48 HOURS PRIOR TO EXCAVATING

FOR NON-TELEPHONE UTILITIES LOCATES CALL 811

--Proprietary--
Not for use or disclosure outside the AT&T companies except under written agreement.

OPERATING RANGE OF JOB STEPS
TASK _____ TO _____
MFCR 45C

TRANSMISSION ZONE
RZ 0 CZ 0 TAPER CODE

CAUTION HIGH VOLTAGE
KV 7.20 AERIAL Y BURIED N

HIGHWAY PERMIT NO.

Utility CO CENT - CENTER POINT
REP NAME
REP TEL NO. (713) 207-2222
POLE CONTACTS (+) 0 (-) 0

Utility CO
REP NAME
REP TEL NO.
POLE CONTACTS (+) 0 (-) 0

Utility CO
REP NAME
REP TEL NO.
POLE CONTACTS (+) 0 (-) 0

PROJECT NO A00ESJG

TOT.PRINTS 0 PRINT NO. 105
NPA/NNX: 281-232 PRT:281232
EXCH. RICH-ROSE
TAX DIST. FG009
GEO LOC. W89232
ENGR. CC DRAWN DP
TELEPHONE NO. (713) 218-8177
REC. REF. 225-265-72-1
MAP REF. 645 K
SCALE NONE
ISSUE DATE
PROJ TITLE POWERLINE RD PROJECT
REV. NUMBER
DATE REV.

POWERLINE RD AND SPICE SPRINGS LN

SCALE: NONE
EVD: A00ESJG
NPANNX: 281232 - RICH ROSE

CobbFendley

CFA DESIGN ENGR: DEVIN PULLIAM
DATE: 07-07-2016
KEY MAP: 645 K
PLAT: 105-107
DWG NAME: POWERLINE RD PROJECT

USE OF MINI-TRACKS & BACKHOE FOR LONG/SHORT LINES SHALL BE PROHIBITED.

NOTICE
NOTIFY THE PERMIT OFFICE
48 HOURS IN ADVANCE OF
CONSTRUCTION

1 ANMW-600
45C; 0'



UNDERGROUND UTILITIES HAVE BEEN PLOTTED FROM AVAILABLE RECORDS AND FIELD OBSERVATIONS BUT ARE NOT NECESSARILY EXACT. THEREFORE, UTILITY LOCATIONS WILL BE VERIFIED AT LEAST 100' IN ADVANCE OF TRENCHES, PLOWING OR BORING, SO THAT CHANGES IN CABLE PLACEMENT CAN BE MADE IN THE EVENT OF CONFLICT.

BY TXDOT UNTIL FURTHER NOTICE...

SPECIAL CIRCUITS N
6203 FORWARDED N
PERMIT REQUIRED Y

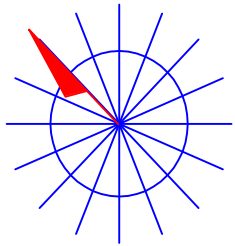

NORTH ARROW

OPERATING RANGE OF JOB STEPS

TASK _____ TO _____

MFRC 45C

TRANSMISSION ZONE
RZ 0 CZ 0 TAPER CODE

CAUTION HIGH VOLTAGE
KV 7.20 AERIAL Y BURIED N

HIGHWAY PERMIT NO.

Utility CO CENT - CENTER POINT
REP NAME
REP TEL NO. (713) 207-2222
POLE CONTACTS (+) 0 (-) 0

Utility CO
REP NAME
REP TEL NO.
POLE CONTACTS (+) 0 (-) 0

Utility CO
REP NAME
REP TEL NO.
POLE CONTACTS (+) 0 (-) 0

PROJECT NO A00ESJG

TOT.PRINTS 15 PRINT NO. 102

NPA/NNX: 281-232 PRT:281232

EXCH. RICH-ROSE

TAX DIST. FG009

GEO LOC. W89232

ENGR. CC DRAWN DP

TELEPHONE NO. (713) 218-8177

REC. REF. 225-265-72-1

MAP REF. 645 K

SCALE NONE

ISSUE DATE

PROJ TITLE POWERLINE RD PROJECT

REV. NUMBER

DATE REV.

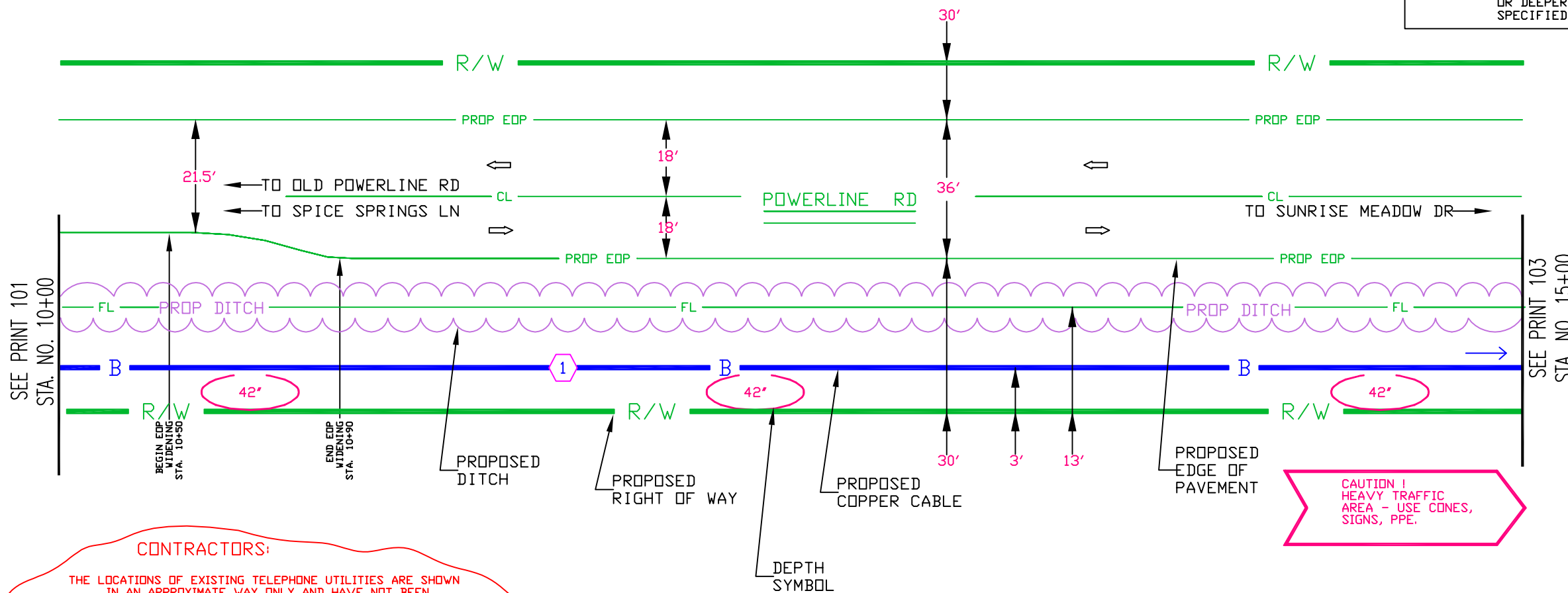
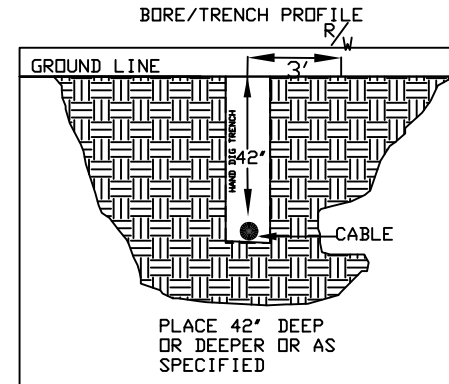

SEE PRINT 101
STA. NO. 10+00

SEE PRINT 103
STA. NO. 15+00

CAUTION!
HEAVY TRAFFIC
AREA - USE CONES,
SIGNS, PPE.

CONTRACTORS:

THE LOCATIONS OF EXISTING TELEPHONE UTILITIES ARE SHOWN IN AN APPROXIMATE WAY ONLY AND HAVE NOT BEEN INDEPENDENTLY VERIFIED BY THE OWNER OR ITS REPRESENTATIVE. THE CONTRACTOR SHALL DETERMINE THE EXACT LOCATION OF ALL EXISTING UTILITIES BEFORE COMMENCING WORK, AND AGREES TO BE FULLY RESPONSIBLE FOR ANY AND ALL DAMAGES WHICH MIGHT BE OCCASIONED BY THE CONTRACTOR'S FAILURE TO EXACTLY LOCATE AND PRESERVE ANY AND ALL UTILITIES. 48 HOURS PRIOR TO EXCAVATING FOR NON-TELEPHONE UTILITIES LOCATES CALL 811

DEPTH SYMBOL

--Proprietary--

Not for use or disclosure outside the AT&T companies except under written agreement.

POWERLINE RD AND SPICE SPRINGS LN	SCALE: NONE EWD: A00ESJG NPA/NNX: 281232 - RICH ROSE
	CFA DESIGN ENG: DEVIN PULLIAM DATE: 07-07-2016 KEY MAP: 645 K PLAT: 102-107 DWG NAME: POWERLINE RD PROJECT

USE OF MINI-TRACKS & BACKHOE FOR LONG/SHORT LINES SHALL BE PROHIBITED.

NOTICE
NOTIFY THE PERMIT OFFICE
48 HOURS IN ADVANCE OF
CONSTRUCTION

1 ANMW-600
45C; 0'



UNDERGROUND UTILITIES HAVE BEEN PLOTTED FROM AVAILABLE RECORDS AND FIELD OBSERVATIONS BUT ARE NOT NECESSARILY EXACT. THEREFORE, UTILITY LOCATIONS WILL BE VERIFIED AT LEAST 100' IN ADVANCE OF TRENCHES, PLOWING OR BORING, SO THAT CHANGES IN CABLE PLACEMENT CAN BE MADE IN THE EVENT OF CONFLICT.

BY TXDOT UNTIL FURTHER NOTICE...

SPECIAL CIRCUITS N
6203 FORWARDED N
PERMIT REQUIRED Y

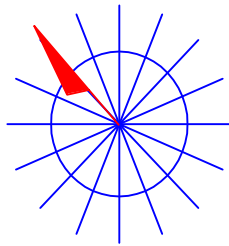

NORTH ARROW

OPERATING RANGE OF JOB STEPS

TASK _____ TO _____

MFRC 45C

TRANSMISSION ZONE
RZ 0 CZ 0 TAPER CODE

CAUTION HIGH VOLTAGE
KV 7.20 AERIAL Y BURIED N

HIGHWAY PERMIT NO.

Utility CO CENT - CENTER POINT
REP NAME
REP TEL NO. (713) 207-2222
POLE CONTACTS (+) 0 (-) 0

Utility CO
REP NAME
REP TEL NO.
POLE CONTACTS (+) 0 (-) 0

Utility CO
REP NAME
REP TEL NO.
POLE CONTACTS (+) 0 (-) 0

PROJECT NO A00ESJG

TOT.PRINTS 0 PRINT NO. 103

NPA/NNX: 281-232 PRT: 281232

EXCH. RICH-ROSE

TAX DIST. FG009

GEO LOC. W89232

ENGR. CC DRAWN DP

TELEPHONE NO. (713) 218-8177

REC. REF. 225-265-72-1

MAP REF. 645 K

SCALE NONE

ISSUE DATE

PROJ TITLE POWERLINE RD PROJECT

REV. NUMBER

DATE REV.

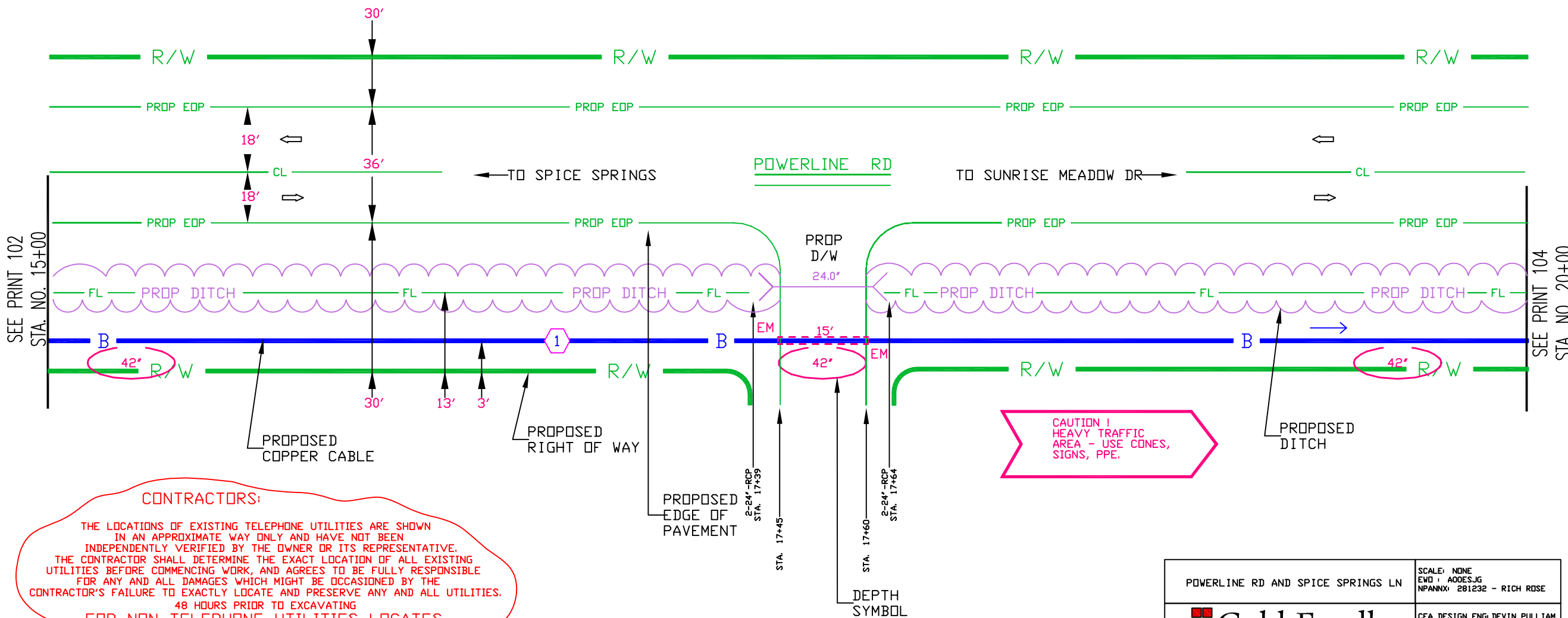
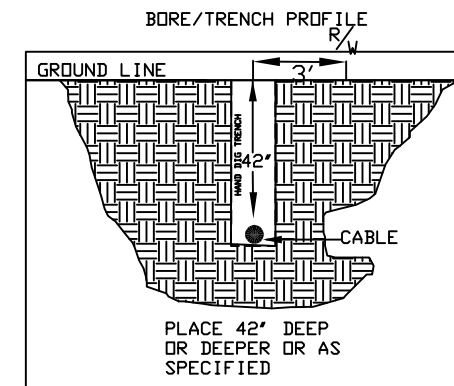

CAUTION!
HEAVY TRAFFIC
AREA - USE CONES,
SIGNS, PPE.

CONTRACTORS:
THE LOCATIONS OF EXISTING TELEPHONE UTILITIES ARE SHOWN IN AN APPROXIMATE WAY ONLY AND HAVE NOT BEEN INDEPENDENTLY VERIFIED BY THE OWNER OR ITS REPRESENTATIVE. THE CONTRACTOR SHALL DETERMINE THE EXACT LOCATION OF ALL EXISTING UTILITIES BEFORE COMMENCING WORK, AND AGREES TO BE FULLY RESPONSIBLE FOR ANY AND ALL DAMAGES WHICH MIGHT BE OCCASIONED BY THE CONTRACTOR'S FAILURE TO EXACTLY LOCATE AND PRESERVE ANY AND ALL UTILITIES.
48 HOURS PRIOR TO EXCAVATING
FOR NON-TELEPHONE UTILITIES LOCATES
CALL 811

--Proprietary--
Not for use or disclosure outside the AT&T companies except under written agreement.

POWERLINE RD AND SPICE SPRINGS LN

SCALE: NONE
END: A00ESJG
NPA/NNX: 281232 - RICH ROSE

CobbFendley

CFA DESIGN ENGR DEVIN PULLIAM
DATE: 07-07-2016
KEY MAP: 645 K
PLAT: 103-107
DWG NAME: POWERLINE RD PROJECT