

## PLAT RECORDING SHEET

PLAT NAME: Avalon at Sienna Plantation, Section 6

PLAT NO: \_\_\_\_\_

ACREAGE: 12.413

LEAGUE: Moses Shipman Survey

ABSTRACT NUMBER: 86

NUMBER OF BLOCKS: 1

NUMBER OF LOTS: 49

NUMBER OF RESERVES: 13

OWNERS: Taylor Morrison of Texas Inc.

\_\_\_\_\_  
(DEPUTY CLERK)

STATE OF TEXAS  
COUNTY OF FORT BEND

WE, TAYLOR MORRISON OF TEXAS, INC., A TEXAS CORPORATION, ACTING BY AND THROUGH ROBERT L. SKINNER, AUTHORIZED AGENT, BEING AN OFFICER OF TAYLOR MORRISON OF TEXAS, INC., OWNERS OF THE 12.413 ACRE TRACT DESCRIBED IN THE ABOVE AND FOREGOING PLAT OF AVALON AT SIENNA PLANTATION SECTION 6, DO HEREBY MAKE AND ESTABLISH SAID SUBDIVISION PLAT OF SAID PROPERTY ACCORDING TO ALL LINES, DEDICATIONS, RESTRICTIONS AND NOTATIONS ON SAID PLAT AND HEREBY DEDICATE TO THE USE OF THE PUBLIC FOREVER, ALL STREETS, (EXCEPT THOSE STREETS DESIGNATED AS PRIVATE STREETS, OR PERMANENT ACCESS EASEMENTS), ALLEYS, PARKS, WATER COURSES, DRAINS, EASEMENTS AND PUBLIC PLACES SHOWN THEREON FOR THE PURPOSES AND CONSIDERATIONS THEREIN EXPRESSED; AND DO HEREBY BIND OURSELVES, OUR HEIRS AND ASSIGNS TO WARRANT AND FOREVER DEFEND THE TITLE TO THE LAND SO DEDICATED.

WE, FURTHER ACKNOWLEDGE THAT THE DEDICATIONS AND/OR EXACTIONS MADE HEREIN ARE PROPORTIONAL TO THE IMPACT OF THE SUBDIVISION UPON THE PUBLIC SERVICES REQUIRED IN ORDER THAT THE DEVELOPMENT WILL COMPORT WITH THE PRESENT AND FUTURE GROWTH NEEDS OF THE CITY; WE, OUR SUCCESSORS AND ASSIGNEES HEREBY WAIVE ANY CLAIM, DAMAGE OR CAUSE OF ACTION THAT WE MAY HAVE AS A RESULT OF THE DEDICATION OR EXACTIONS MADE HEREIN.

FURTHER, OWNERS HAVE DEDICATED AND BY THESE PRESENTS DO DEDICATE TO THE USE OF THE PUBLIC FOR PUBLIC UTILITY PURPOSES FOREVER UNOBSTRUCTED AERIAL EASEMENTS. THE AERIAL EASEMENTS SHALL EXTEND HORIZONTALLY AN ADDITIONAL ELEVEN FEET, SIX INCHES (11'6") FOR TEN FEET (10'0") PERIMETER GROUND EASEMENTS OR SEVEN FEET, SIX INCHES (7'6") FOR FOURTEEN FEET (14'0") PERIMETER GROUND EASEMENTS OR FIVE FEET, SIX INCHES (5'6") FOR SIXTEEN FEET (16'0") PERIMETER GROUND EASEMENTS, FROM A PLANE SIXTEEN FEET (16'0") ABOVE GROUND LEVEL UPWARD, LOCATED ADJACENT TO AND ADJOINING SAID PUBLIC UTILITY EASEMENTS THAT ARE DESIGNATED WITH AERIAL EASEMENTS (U.E. AND A.E.) AS INDICATED AND DEPICTED, HEREON, WHEREBY THE AERIAL EASEMENT TOTALS TWENTY ONE FEET, SIX INCHES (21' 6") IN WIDTH.

FURTHER, OWNERS HAVE DEDICATED AND BY THESE PRESENTS DO DEDICATE TO THE USE OF THE PUBLIC FOR PUBLIC UTILITY PURPOSES FOREVER UNOBSTRUCTED AERIAL EASEMENTS. THE AERIAL EASEMENTS SHALL EXTEND HORIZONTALLY AN ADDITIONAL TEN FEET (10'0") FOR TEN FEET (10'0") BACK-TO-BACK GROUND EASEMENTS, OR EIGHT FEET (8'0") FOR FOURTEEN FEET (14'0") BACK-TO-BACK GROUND EASEMENTS OR SEVEN FEET (7'0") FOR SIXTEEN FEET (16'0") BACK-TO-BACK GROUND EASEMENTS, FROM A PLANE SIXTEEN FEET (16'0") ABOVE GROUND LEVEL UPWARD, LOCATED ADJACENT TO BOTH SIDES AND ADJOINING SAID PUBLIC UTILITY EASEMENTS THAT ARE DESIGNATED WITH AERIAL EASEMENTS (U.E. AND A.E.) AS INDICATED AND DEPICTED HEREON, WHEREBY THE AERIAL EASEMENT TOTALS THIRTY FEET (30'0") IN WIDTH.

FURTHER, WE DO HEREBY DECLARE THAT ALL PARCELS OF LAND DESIGNATED AS LOTS ON THIS PLAT ARE INTENDED FOR THE CONSTRUCTION OF SINGLE FAMILY RESIDENTIAL DWELLING UNITS THEREON AND SHALL BE RESTRICTED FOR SAME UNDER THE TERMS AND CONDITIONS OF SUCH RESTRICTIONS FILED SEPARATELY.

FURTHER, WE DO HEREBY COVENANT AND AGREE THAT ALL OF THE PROPERTY WITHIN THE BOUNDARIES OF THIS PLAT SHALL BE RESTRICTED TO PREVENT THE DRAINAGE OF ANY SEPTIC TANKS INTO ANY PUBLIC OR PRIVATE STREET, ROAD OR ALLEY OR ANY DRAINAGE DITCH, EITHER DIRECTLY OR INDIRECTLY.

FURTHER, WE DO HEREBY DEDICATE TO THE PUBLIC A STRIP OF LAND TWENTY (20) FEET WIDE ON EACH SIDE OF THE CENTER LINE OF ANY AND ALL BAYOUS, CREEKS, GULLIES, RAVINES, DRAWS AND DRAINAGE DITCHES LOCATED IN SAID SUBDIVISION, AS EASEMENTS FOR DRAINAGE PURPOSES. FORT BEND COUNTY OR ANY OTHER GOVERNMENTAL AGENCY SHALL HAVE THE RIGHT TO ENTER UPON SAID EASEMENT AT ANY AND ALL TIMES FOR THE PURPOSES OF CONSTRUCTION AND MAINTENANCE OF DRAINAGE FACILITIES AND STRUCTURES.

FURTHER, WE DO HEREBY COVENANT AND AGREE THAT ALL OF THE PROPERTY WITHIN THE BOUNDARIES OF THIS SUBDIVISION AND ADJACENT TO ANY DRAINAGE EASEMENT, DITCH, GULLY, CREEK OR NATURAL DRAINAGE WAY SHALL HEREBY BE RESTRICTED TO KEEP SUCH DRAINAGE WAYS AND EASEMENTS CLEAR OF FENCES, BUILDINGS, EXCESSIVE VEGETATION AND OTHER OBSTRUCTIONS TO THE OPERATIONS AND MAINTENANCE OF THE DRAINAGE FACILITY AND THAT SUCH ABUTTING PROPERTY SHALL NOT BE PERMITTED TO DRAIN DIRECTLY INTO THIS EASEMENT EXCEPT BY MEANS OF AN APPROVED DRAINAGE STRUCTURE.

FURTHER, WE DO HEREBY ACKNOWLEDGE THE RECEIPT OF THE "ORDERS FOR REGULATION OF OUTDOOR LIGHTING IN THE UNINCORPORATED AREAS OF FORT BEND COUNTY, TEXAS", AND DO HEREBY COVENANT AND AGREE AND SHALL COMPLY WITH THIS ORDER AS ADOPTED BY FORT BEND COUNTY COMMISSIONERS COURT ON MARCH 23, 2004 AND ANY SUBSEQUENT AMENDMENT.

IN TESTIMONY WHEREOF, TAYLOR MORRISON OF TEXAS, INC., HAS CAUSED THESE PRESENTS TO BE SIGNED BY ROBERT L. SKINNER, AUTHORIZED AGENT, THEREUNTO AUTHORIZED,

THIS \_\_\_\_\_ DAY OF \_\_\_\_\_, 2017.

TAYLOR MORRISON OF TEXAS, INC.

BY: \_\_\_\_\_  
ROBERT L. SKINNER, AUTHORIZED AGENT

STATE OF TEXAS  
COUNTY OF HARRIS

BEFORE ME, THE UNDERSIGNED AUTHORITY, ON THIS DAY PERSONALLY APPEARED ROBERT L. SKINNER, AUTHORIZED AGENT OF TAYLOR MORRISON OF TEXAS, INC., KNOWN TO ME TO BE THE PERSON WHOSE NAME IS SUBSCRIBED TO THE FOREGOING INSTRUMENT AND ACKNOWLEDGED TO ME THAT HE EXECUTED THE SAME FOR THE PURPOSES AND CONSIDERATIONS THEREIN EXPRESSED AND IN THE CAPACITY THEREIN AND HEREIN SET OUT.

GIVEN UNDER MY HAND AND SEAL OF OFFICE,

THIS \_\_\_\_\_ DAY OF \_\_\_\_\_, 2017.

NOTARY PUBLIC IN AND FOR THE STATE OF TEXAS

I, JON P. BORDOVSKY, A REGISTERED PROFESSIONAL LAND SURVEYOR, AM AUTHORIZED UNDER THE LAWS OF THE STATE OF TEXAS TO PRACTICE THE PROFESSION OF LAND SURVEYING AND HEREBY CERTIFY THAT THE ABOVE SUBDIVISION IS TRUE AND CORRECT, WAS PREPARED FROM AN ACTUAL SURVEY OF THE PROPERTY MADE UNDER MY SUPERVISION ON THE GROUND AND THAT ALL BOUNDARY CORNERS, ANGLES, POINTS OF CURVATURE AND OTHER POINTS OF REFERENCE HAVE BEEN MARKED WITH IRON (OR OTHER SUITABLE PERMANENT METAL) PIPES OR RODS HAVING AN OUTSIDE DIAMETER OF NOT LESS THAN FIVE-EIGHTHS (5/8) INCH WITH PLASTIC CAP MARKED "GBI PARTNERS" AND A LENGTH OF NOT LESS THAN THREE (3) FEET (SEE NOTE 9).

JON P. BORDOVSKY, R.P.L.S.  
REGISTERED PROFESSIONAL LAND SURVEYOR  
TEXAS REGISTRATION NO. 6405

I, AMANDA CARRIAGE, A PROFESSIONAL ENGINEER REGISTERED IN THE STATE OF TEXAS DO HEREBY CERTIFY THAT THIS PLAT MEETS ALL REQUIREMENTS OF FORT BEND COUNTY TO THE BEST OF MY KNOWLEDGE.

AMANDA CARRIAGE, P.E.  
LICENSED PROFESSIONAL ENGINEER  
TEXAS LICENSE NO. 105912

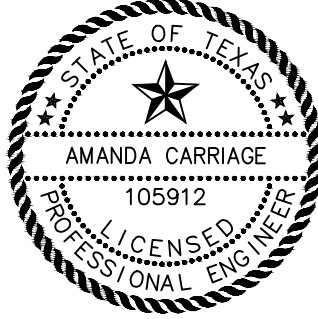

STATE OF TEXAS  
COUNTY OF FORT BEND

THIS IS TO CERTIFY THAT THE PLANNING AND ZONING COMMISSION OF THE CITY OF MISSOURI CITY, TEXAS, HAS APPROVED THIS PLAT AND SUBDIVISION OF AVALON AT SIENNA PLANTATION SECTION 6 IN CONFORMANCE WITH THE LAWS OF THE STATE OF TEXAS AND THE ORDINANCES OF THE CITY OF MISSOURI CITY AS SHOWN HEREON AND AUTHORIZED THE RECORDING OF THIS PLAT

THIS \_\_\_\_\_ DAY OF \_\_\_\_\_, 2017.

SONYA BROWN-MARSHALL, CHAIRMAN

TIMOTHY HANEY, VICE CHAIRMAN

NOTES:

- BENCHMARK: FND. 4 INCH BRASS DISC SET IN CONCRETE AT THE SOUTHWESTERN CORNER OF THE INTERSECTION SIENNA PARKWAY AND TRAMMEL-FRESNO ROAD. SURVEY MARKER NO. PCM-003  
ELEV.= 66.07 2001 ADJUSTMENT
- T.B.M. INDICATES TEMPORARY BENCHMARK  
FND. 5/8 INCH IRON ROD WITH CAP MARKED "LJA ENG"
- ALL BEARINGS REFERENCED TO THE TEXAS STATE PLANE COORDINATE SYSTEM, SOUTH CENTRAL ZONE (NAD83). COORDINATES SHOWN ARE GRID AND MAY BE CONVERTED TO SURFACE BY DIVIDING BY A FACTOR OF 0.99986797.
- THIS PLAT WAS PREPARED TO MEET CITY OF MISSOURI CITY AND FORT BEND COUNTY REQUIREMENTS.
- THIS PLAT WAS PREPARED FROM INFORMATION FURNISHED BY STEWART TITLE COMPANY, FILE NO. 1790291CPL, DATED JUNE 02, 2017. THE SURVEYOR HAS NOT ABSTRACTED THE ABOVE PROPERTY.
- THIS PLAT LIES WHOLLY WITHIN THE SIENNA PLANTATION MUNICIPAL UTILITY DISTRICT NO. 12, SIENNA PLANTATION LEVEE IMPROVEMENT DISTRICT, FORT BEND SUBSIDENCE DISTRICT, FORT BEND COUNTY DRAINAGE DISTRICT, THE ETJ OF THE CITY OF MISSOURI CITY AND FORT BEND COUNTY.
- IN ACCORDANCE WITH FEDERAL EMERGENCY MANAGEMENT AGENCY (FEMA) FLOOD INSURANCE RATE MAP (FRM) NO. 48157C 0295L, REVISED APRIL 2, 2014, PROPERTY LIES WITHIN SHADED ZONE "X" AS DEFINED AS AREAS OF 0.2% ANNUAL CHANCE FLOOD AND ZONE "ae" AS DEFINED AS AREAS OF THE 1% ANNUAL CHANCE FLOOD (100-YEAR FLOOD). LJA DOES NOT WARRANT NOR SUBSCRIBE TO THE ACCURACY OR SCALE OF SAID MAPS.
- THERE ARE NO PIPELINES AND/OR PIPELINE EASEMENTS WITHIN THE LIMITS OF THE SUBDIVISION.
- FIVE EIGHTHS INCH (5/8") IRON RODS THREE FEET (3') IN LENGTH WITH A PLASTIC CAP MARKED "GBI PARTNERS" WILL BE SET ON ALL PERIMETER BOUNDARY CORNERS, LOT, BLOCK, AND RESERVE CORNERS WILL BE SET UPON COMPLETION OF ROAD CONSTRUCTION AND PRIOR TO LOT CONSTRUCTION.
- THE TOP OF ALL FLOOR SLABS SHALL BE A MINIMUM OF 60.78 FEET ABOVE MEAN SEA LEVEL. FEMA REGULATIONS SECTION 82-97(11) REQUIRES THE MINIMUM SLAB ELEVATION SHALL BE SET ONE FOOT ABOVE THE 100-YEAR FLOOD ELEVATION. THE CITY OF MISSOURI CITY CODE OF ORDINANCES SECTION 42, ARTICLE III REQUIRES THE MINIMUM SLAB ELEVATION SHALL BE ELEVATED TO OR ABOVE A HEIGHT WHICH IS HIGHER OF EIGHTEEN INCHES ABOVE HIGHEST ADJACENT GRADE, OR TWELVE INCHES ABOVE THE MAXIMUM ONE PERCENT ANNUAL FLOOD RISK FLOODPLAIN PONDING ELEVATION IN THE NEAREST DRAINAGE SYSTEM. FORT BEND COUNTY FLOODPLAIN REGULATIONS ARTICLE 5, SECTION B REQUIRES THAT THE MINIMUM SLAB BE SET AT AN ELEVATION EIGHTEEN INCHES ABOVE THE BASE FLOOD ELEVATION WHICH IS MORE STRINGENT AND THEREFORE USED TO DETERMINE THE MINIMUM SLAB ELEVATION. THE TOP OF SLAB ELEVATION AT ANY POINT ON THE PERIMETER OF THE SLAB SHALL NOT BE LESS THAN EIGHTEEN (18) INCHES ABOVE NATURAL GROUND.
- THE DRAINAGE SYSTEM FOR THIS SUBDIVISION SHALL BE DESIGNED TO MEET THE REQUIREMENTS OF THE FORT BEND COUNTY DRAINAGE CRITERIA MANUAL WHICH ALLOWS STREET PONDING DURING INTENSE RAINFALL EVENTS.
- ALL DRAINAGE AND FLOODWAY EASEMENTS SHALL BE KEPT CLEAR OF FENCES, BUILDINGS, PLANTINGS, AND OTHER OBSTRUCTIONS TO THE OPERATIONS AND MAINTENANCE OF THE DRAINAGE FACILITY AS REQUIRED BY SUBSECTION 82-168(D) OF THE CODE OF ORDINANCES OF THE CITY OF MISSOURI CITY, TEXAS.
- ALL PROPERTY TO DRAIN INTO THE DRAINAGE EASEMENT ONLY THROUGH AN APPROVED DRAINAGE STRUCTURE.
- INDICATES ZERO LOT LINE SIDE OF THE LOT AND A 5 FOOT MAINTENANCE ACCESS EASEMENT AND IS DEDICATED IN THE ABUTTING LOT ALONG THE SIDE PROPERTY LINES OF EACH ZERO LOT LINE.
- A MINIMUM DISTANCE OF 10' SHALL BE MAINTAINED BETWEEN RESIDENTIAL DWELLINGS FOR LOTS 13-31, BLOCK 1 ONLY.
- THE CITY OF MISSOURI CITY SHALL NOT BE RESPONSIBLE FOR MAINTENANCE OF DRIVEWAYS, SIDEWALKS, EMERGENCY ACCESS EASEMENTS, RECREATIONAL AREAS, OPEN SPACE AND RESERVES.
- SIDEWALK SHALL BE BUILT OR CAUSED TO BE BUILT NOT LESS THAN 5-FEET IN WIDTH ON BOTH SIDES OF ALL DEDICATED RIGHTS-OF-WAY WITHIN SAID PLAT AND ON CONTIGUOUS RIGHT-OF-WAY OF ALL PERIMETER ROADS SURROUNDING SAID PLAT, IN ACCORDANCE WITH ADA REQUIREMENTS.
- SIDEWALKS SHALL BE BUILT AS REQUIRED BY SECTION 82-164 OR THE CODE OF ORDINANCES OF THE CITY OF MISSOURI CITY, TEXAS.
- DRIVEWAY APPROACHES SHALL BE PROVIDED IN ACCORDANCE WITH THE MISSOURI CITY DRIVEWAY APPROACH POLICY AS REQUIRED UNDER THE PROVISIONS OF SUBSECTION 82-160 OF THE CODE OF ORDINANCES OF THE CITY OF MISSOURI CITY, TEXAS.
- DRIVEWAY LOCATION - FOR THE LOTS ON THE INSIDE OF A KNUCKLE OR 90 DEGREE TURN, DRIVEWAY MUST BE PLACED ON THE LOT FRONTAGE ALONG THE INSIDE APPROACH LANE PRIOR TO THE RIGHT TURN, TO AVOID SIGHT OBSTRUCTION SAFETY HAZARDS.
- ALL REQUIRED UTILITY COMPANIES HAVE BEEN CONTACTED AND ALL PUBLIC UTILITY EASEMENTS AS SHOWN ON THE ABOVE AND FOREGOING PLAT CONSTITUTE ALL OF THE EASEMENTS REQUIRED BY THE UTILITY COMPANIES CONTACTED AT THE TIME OF PLATTING.
- GAS METER LOCATION: GAS METERS SHALL BE LOCATED IN AN AREA ACCESSIBLE WITHOUT CUSTOMER ASSISTANCE, AND NOT BLOCKED BY FENCES, WALLS OR GATES. FOR FURTHER INFORMATION PLEASE CONTACT SIENERGY AT 281-778-8250.
- ALL OF THE PROPERTY SUBDIVIDED IN THE ABOVE AND FOREGOING PLAT IS WITHIN THE ETJ BOUNDARIES OF THE CITY OF MISSOURI CITY, TEXAS.
- NO BUILDING OR OTHER PERMIT, EXCEPT PERMITS FOR CONSTRUCTION OF PUBLIC IMPROVEMENTS WILL BE ISSUED BY THE CITY OF MISSOURI CITY, TEXAS, FOR CONSTRUCTION WITHIN THIS SUBDIVISION UNTIL SUCH TIME AS ALL PUBLIC IMPROVEMENTS OF THE SUBDIVISION HAVE BEEN CONSTRUCTED BY THE DEVELOPER AND ACCEPTED BY THE CITY OR THE GUARANTEE OF CONSTRUCTION OF PUBLIC IMPROVEMENTS REQUIRED BY SECTION 82-206 OF THE CODE OF ORDINANCES OF THE CITY OF MISSOURI CITY, TEXAS, IS SUBMITTED TO AND APPROVED BY THE CITY.
- PRIOR TO THE BEGINNING OF THE ONE-YEAR MAINTENANCE PERIOD FOR UTILITIES AND PAVING BY FORT BEND COUNTY, ALL BLOCK CORNERS AND STREET RIGHT-OF-WAY WILL BE MONUMENTED.
- ADEQUATE FIRE FLOWS SHALL BE PROVIDED ALONG THE ENTIRE LENGTH OF THE PROPOSED WATER LINE.
- REQUIRED FIRE FLOWS SHALL BE PROVIDED BASED ON THE SIZE AND CONSTRUCTION OF ALL BUILDINGS AS REQUIRED BY THE INTERNATIONAL FIRE CODE AS ADOPTED BY THE CITY.
- THE PLACEMENT OF FIRE HYDRANTS SHALL BE PROVIDED BASED ON THE MINIMUM DISTANCE REQUIREMENTS AS ESTABLISHED IN THE INTERNATIONAL FIRE CODE AS ADOPTED BY THE CITY (300FT. FOR RESIDENTIAL DEVELOPMENT AND 300FT. FOR COMMERCIAL DEVELOPMENT). ALL FIRE HYDRANTS SHALL BE INSTALLED ACCORDING TO THE INTERNATIONAL FIRE CODE AS ADOPTED BY THE CITY.
- STREET LIGHTING SHALL BE DESIGNED AND INSTALLED IN ACCORDANCE WITH THE CITY OF MISSOURI CITY INFRASTRUCTURE DESIGN MANUAL, CHAPTER 4 STREET LIGHTING AND OVERHEAD UTILITIES. THE INSTALLATION, OPERATION, AND MAINTENANCE OF ORNAMENTAL STREET LIGHTS SHALL NOT BE THE RESPONSIBILITY OF THE CITY OF MISSOURI CITY, EXCEPT AS PROVIDED THEREIN.
- OWNERSHIP AND MAINTENANCE RESPONSIBILITY OF THE DRAINAGE RESERVES AND CHANNELS IS VESTED IN THE SIENNA PLANTATION LEVEE IMPROVEMENT DISTRICT. THE OWNERSHIP AND MAINTENANCE RESPONSIBILITY OF LANDSCAPE RESERVES IS VESTED IN THE SIENNA PLANTATION RESIDENTIAL ASSOCIATION, INC. (S.P.R.A.I.) OR THE SIENNA PLANTATION MANAGEMENT DISTRICT.

- OWNERSHIP AND MAINTENANCE RESPONSIBILITY OF THE UTILITIES WITHIN THE SECTIONS IS VESTED IN SIENNA PLANTATION MUNICIPAL UTILITY DISTRICT NO. 12. THE OWNERSHIP AND MAINTENANCE RESPONSIBILITY OF THE UTILITIES ALONG BOULEVARDS AND MAJOR THOROUGHFARES IS VESTED IN THE SIENNA PLANTATION MUNICIPAL UTILITY DISTRICT NO. 1.
- IN ACCORDANCE WITH CENTER POINT ENERGY ELECTRICAL SERVICE MANUAL, ARTICLE 421.2, ELECTRIC METERS SHALL BE LOCATED IN A POSITION THAT IS ACCESSIBLE AT ALL TIMES WITHOUT CUSTOMER ASSISTANCE. ACCESS TO THE METER SHALL NOT BE BLOCKED BY GATES, WALLS OR FENCES.
- THIS PLAT LIES WITHIN LIGHTING ZONE 2.
- ALL PAVING ISLANDS WITH THE RIGHTS-OF-WAY OF THIS PLAT WILL BE MAINTAINED BY THE SIENNA PLANTATION RESIDENTIAL ASSOCIATION, INC. (S.P.R.A.I.) AND IS NOT THE RESPONSIBILITY OF THE CITY OF MISSOURI CITY OR FORT BEND COUNTY.
- PRIMARY ACCESS TO LOTS 1-4 & 48-49, BLOCK 1 SHALL BE FROM THE ADJACENT ALLEYS PLATTED AS RESERVES HEREON AND THAT SUCH ACCESS SHALL NOT BE DENIED.
- U.V.E. INDICATES UNOBSTRUCTED VIEW EASEMENT. FORT BEND COUNTY SHALL BE RESPONSIBLE FOR ENFORCING U.V.E. REQUIREMENTS WITHIN THE PUBLIC RIGHT-OF-WAY AND SIENNA PLANTATION COMMUNITY ASSOCIATION, INC. SHALL ENFORCE AREAS OUTSIDE OF RIGH-OF-WAY.
- THIS PLAT IS SUBORDINATED BY:  
ALVIN SAN MIGUEL, VICE PRESIDENT/GENERAL MANAGER, SIENNA 325, L.P., AS RECORDED IN FILE NO. \_\_\_\_\_ OF THE OFFICIAL RECORDS OF FORT BEND COUNTY, TEXAS.
- SITE PLANS SHALL BE SUBMITTED TO FORT BEND COUNTY AND ANY OTHER APPLICABLE JURISDICTION FOR REVIEW AND APPROVAL. DEVELOPMENT PERMITS AND ALL OTHER APPLICABLE PERMITS SHALL BE OBTAINED FROM FORT BEND COUNTY PRIOR TO BEGINNING CONSTRUCTION.

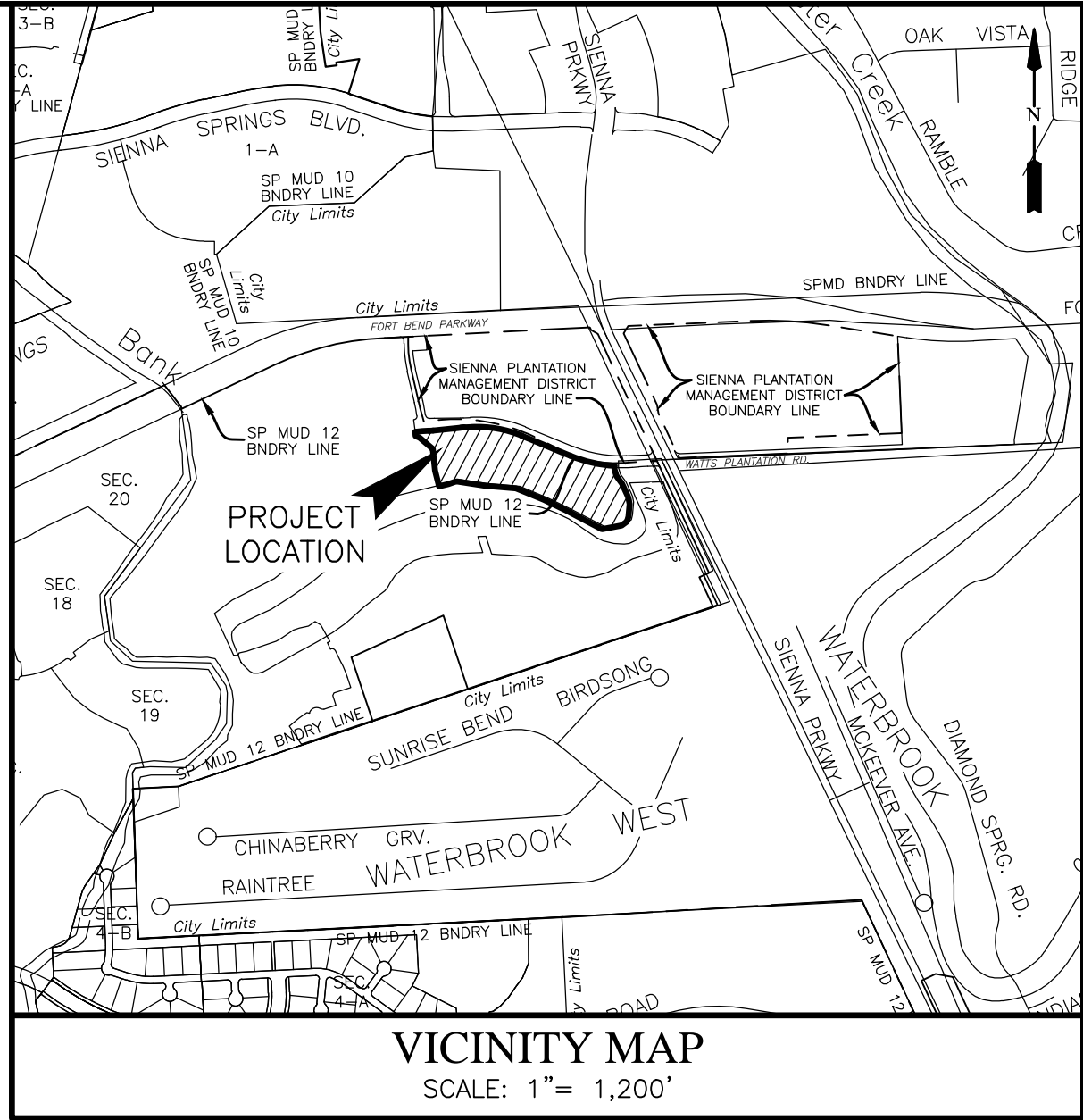

KEY MAP NO. 650-A

I, RICHARD W. STOLLEIS, FORT BEND COUNTY ENGINEER, DO HEREBY CERTIFY THAT THE PLAT OF THIS SUBDIVISION COMPLIES WITH ALL OF THE EXISTING RULES AND REGULATIONS OF THIS OFFICE AS ADOPTED BY THE FORT BEND COUNTY COMMISSIONERS' COURT. HOWEVER, NO CERTIFICATION IS HEREBY GIVEN AS TO THE EFFECT OF DRAINAGE FROM THIS SUBDIVISION ON THE INTERCEPTING DRAINAGE ARTERY OR PARENT STREAM OR ON ANY OTHER AREA OR SUBDIVISION WITHIN THE WATERSHED.

RICHARD W. STOLLEIS, P.E.  
FORT BEND COUNTY ENGINEER

APPROVED BY THE COMMISSIONERS' COURT OF FORT BEND COUNTY, TEXAS,

THIS \_\_\_\_\_ DAY OF \_\_\_\_\_, 2017.

VINCENT M. MORALES, JR.  
PRECINCT 1, COUNTY COMMISSIONER

GRADY PRESTAGE  
PRECINCT 2, COUNTY COMMISSIONER

ROBERT E. HEBERT  
COUNTY JUDGE

W. A. (ANDY) MEYERS  
PRECINCT 3, COUNTY COMMISSIONER

JAMES PATTERSON  
PRECINCT 4, COUNTY COMMISSIONER

I, LAURA RICHARD, COUNTY CLERK IN AND FOR FORT BEND COUNTY, HEREBY CERTIFY THAT THE FOREGOING

INSTRUMENT WITH ITS CERTIFICATE OF AUTHENTICATION WAS FILED FOR RECORDATION IN MY OFFICE ON

\_\_\_\_\_, 2017 AT \_\_\_\_\_ O'CLOCK \_\_\_\_M. IN PLAT NUMBER \_\_\_\_\_ OF

THE PLAT RECORDS OF FORT BEND COUNTY, TEXAS.

WITNESS MY HAND AND SEAL OF OFFICE, AT RICHMOND, TEXAS. THE DAY AND DATE LAST ABOVE WRITTEN.

LAURA RICHARD, COUNTY CLERK  
FORT BEND COUNTY, TEXAS

BY: \_\_\_\_\_  
DEPUTY



SURVEYORS:

**GBI PARTNERS, L.P.**

LAND SURVEYING CONSULTANTS  
13340 S. GESSNER RD. - MISSOURI CITY, TX 77489  
PHONE: 281-499-4539 - www.gbisurevey.com  
TBPLS FIRM # 10130300

JON P. BORDOVSKY, R.P.L.S.  
REGISTERED PROFESSIONAL LAND SURVEYOR  
TEXAS REGISTRATION NO. 6405

ENGINEER:

LJA Engineering, Inc.  
1904 W. Grand Parkway North  
Suite 100  
Katy, Texas 77449

Phone 713.953.5200  
Fax 713.953.5026  
FRN-F-1386

AMANDA CARRIAGE  
LICENSED PROFESSIONAL ENGINEER,  
TEXAS REGISTRATION NO. 105912



