



Fort Bend County Engineering
FORT BEND COUNTY, TEXAS

Richard W. Stolleis, P.E.
County Engineer

August 14, 2017

Commissioner W. A. "Andy" Meyers
Fort Bend County Precinct 3
22333 Grand Corner Drive
Katy, Texas 77494

RE: Temporary Road Closure, Revised Detour Plan – Crossover Road

Dear Commissioner:

Engineering recommends a revision of the detour plan for the temporary closure of Crossover Road. This closure, from Katy Flewellen to 1,600-feet west of Katy Flewellen, was requested by Newland Communities and approved by Commissioners Court on May 23, 2017, pursuant to Section 251.011 of the Texas Transportation Code.

The original detour plan directs traffic to use the local streets within Cinco Ranch Northwest, Section 15, to access Cinco Trace Boulevard from Crossover Road and vice versa. The proposed revised detour plan directs traffic to remain on area Major Thoroughfares (FM 1463, Cinco Trace Boulevard) and Collectors (Westridge Creek Lane).

This item will be placed on the next available Court agenda. The revised detour plan is attached. Should you have any questions please do not hesitate to call me at 281-633-7528.

Sincerely,

A handwritten signature in blue ink, appearing to read "Chris Debaillon".

Chris Debaillon, PE, PTOE
Assistant County Engineer - Traffic

Attachment: Detour map

cc: Mr. Alan Bauer, Newland Communities abauer@kbhome.com
Mr. Wesley Crawford, FBC Engineering
Mr. Brian Fields, FBC Road & Bridge
File

301 Jackson St., Suite 401, Richmond, TX 77469
Phone 281-633-7500

- ① CROSSOVER RD
DETOUR
M4-9R
(30"x24")
- ② CROSSOVER RD
DETOUR
M4-9L
(30"x24")
- ③ END
DETOUR
M4-8a
(24"x18")
- ④ CROSSOVER RD
DETOUR
AHEAD
CW20-2D
(36"x36")
- ⑤ ROAD
CLOSED
R11-2
(48"x30")
- ⑥ ROAD CLOSED
TO
THRU TRAFFIC
R11-4
(60"x30")
- ⑦ CROSSOVER RD
DETOUR
M4-9S
(30"x24")

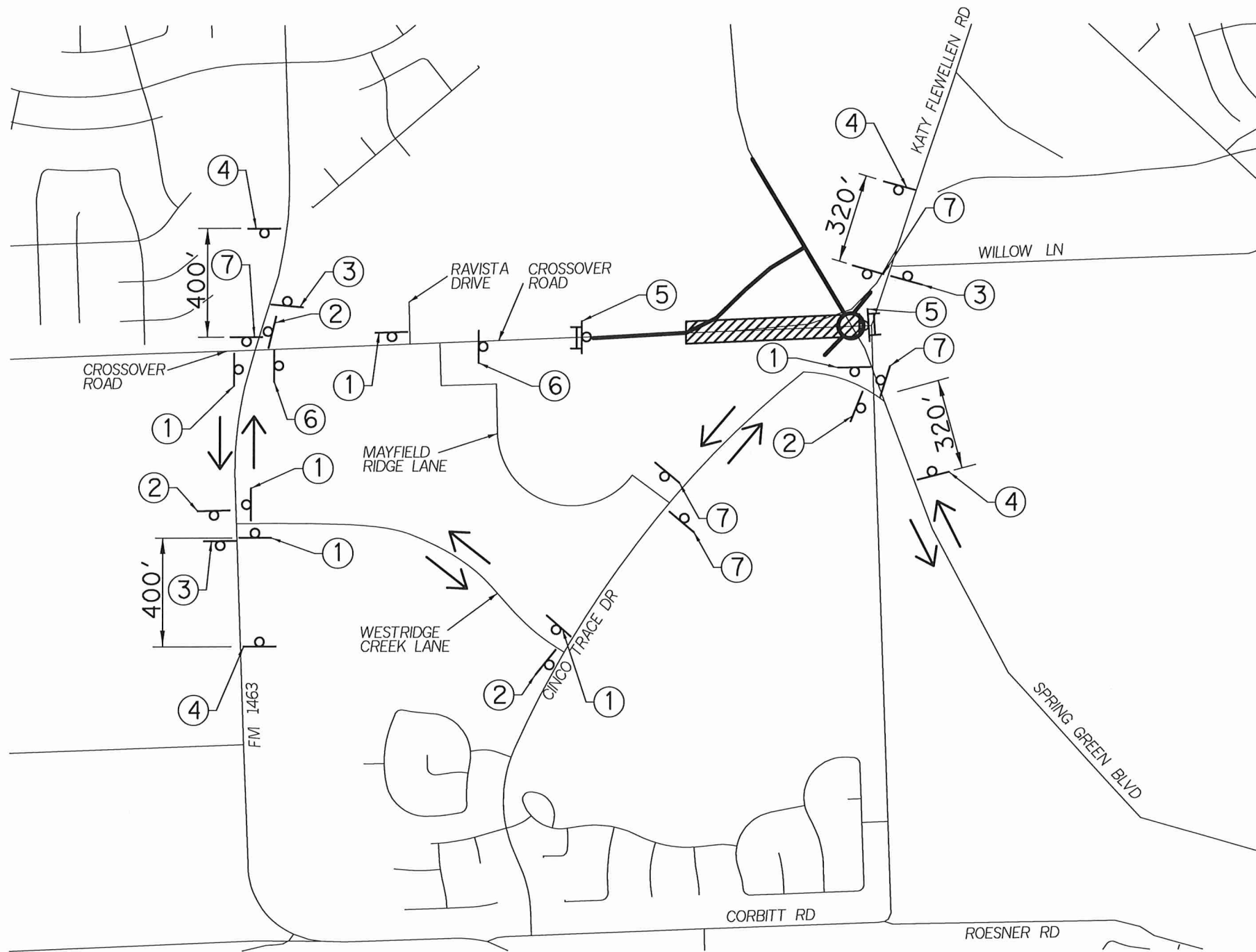

LEGEND

-
- TYPE III BARRICADE
-
-
- TRAFFIC MOVEMENT
-
-
- ADVISORY SIGNS

REV	DATE	BY	DESCRIPTION



8/16/2017

FORT BEND COUNTY
ENGINEERING DIVISION

BGE BGE, Inc.
10777 Westheimer, Suite 400, Houston, TX 77042
Tel: 281-558-8700 • www.browngay.com
TBPE Registration No. F-1046

CROSSOVER ROAD
CROSSOVER
ROAD
DETOUR PLAN

SHEET 1 OF 1

DESIGNED BY: MS
DRAWN BY: HW
DATE: 8/16/2017
SHEET NO:

NOTE:
RIGHT OF WAY WILL BE ABANDONED ON
CROSSOVER ROAD APPROXIMATELY 1,500'
EAST OF THE INTERSECTION OF KATY
FLEWELLEN ROAD AT CROSSOVER ROAD

FORT BEND COUNTY
N. T. S.