



Fort Bend County Engineering
FORT BEND COUNTY, TEXAS

Richard W. Stolleis, P.E.
County Engineer

July 28, 2017

Commissioner Vincent M. Morales, Jr.
Fort Bend County Precinct 1
1517 Eugene Heimann Circle
Richmond, TX 77469

RE: Sweetgrass Circle in Del Webb Richmond – “SPEED LIMIT 30”

Dear Commissioner Morales:

Fort Bend County Engineering Department has completed the traffic control plan to place a speed limit of 30 miles per hour on Sweetgrass Circle within the Del Webb-Richmond subdivision, as shown on the traffic control plan. The road currently has a speed limit of 35 mph and a 28-foot cross-section with several pedestrian crossings at uncontrolled intersections. Given the characteristics of the roadway, and a recent speed study that revealed an 85th percentile speed of 32 mph, Engineering recommends lowering the speed limit on Sweetgrass Circle to 30 mph. The public hearing date for acceptance for the plan will be scheduled on the next available Commissioner's Court Agenda.

A copy of the traffic control plan is attached for your review. If we can be of further assistance please do not hesitate to contact me at 281-633-7528 or chris.debaillon@fortbendcountytexas.gov.

Sincerely,

Chris Debaillon, PE, PTOE
Assistant County Engineer - Traffic

cc: Judge Robert E. Hebert, County Judge
Marc Grant - FBC Road & Bridge
Brian Fields - Signage Department
File

301 Jackson St., Suite 401, Richmond, TX 77469
Phone 281-633-7500

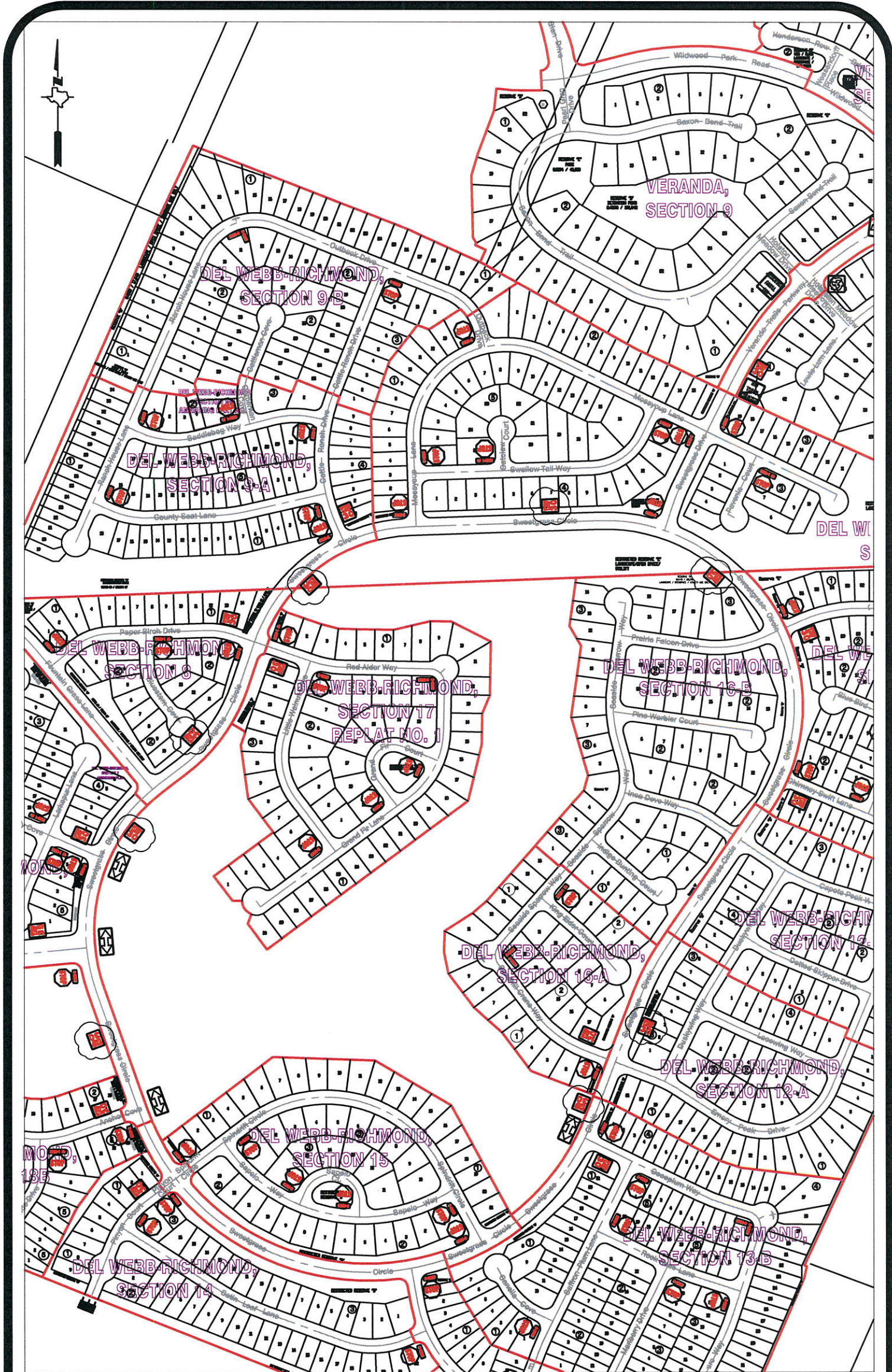

Note:

The purpose of this traffic control plan is to establish traffic control for Del Webb - Richmond, Sweetgrass Circle, with the addition of 30 m.p.h. (R2-1) signs as indicated on the drawing.

Drawn By: L. Brdecka

Date: 7-27-17

Approved By: Chris Deballon, PE PTOE

Date: 7/28/17

Scale

1" = 400'-0"

**Del Webb - Richmond
Sweetgrass Circle
Control Map and Traffic Sign Layout**

Fort Bend County Engineering Dept.
301 Jackson Street
Richmond, Texas 77489