

CenterPoint Energy Houston Electric, LLC
Applicable: Entire Service Area

CNP 8038

6.3 AGREEMENTS AND FORMS

6.3.1 FACILITIES EXTENSION AGREEMENT

This Facilities Extension Agreement is entered into by and between _____, herein called "Retail Customer" and CenterPoint Energy Houston Electric, LLC, herein called "Company" (hereinafter referred to as Agreement) for the construction, extension, installation, modification, repair, upgrade, conversion, relocation, de-energization or removal of Company's Delivery System, including temporary facilities (hereinafter referred to as facilities extension or extension), as described herein.

This Agreement covers the facilities extension to Retail Customer location at _____
Cane Island Parkway

The Company agrees to accept payment of \$14,794.82 _____ Dollars to be paid by the Retail Customer, as a Non-Refundable Construction Payment in connection with the Retail Customer request to extend Company facilities to the above described location as follows: Removal of overhead facilities within easement

Overheads	\$1,813.61
Materials and Supplies Expense	\$1,981.21
Outside services Expense	\$11,000.00

- Unless otherwise stated by Company in writing, the Non-Refundable Construction Payment amount above is valid for twelve months.

In consideration of said Non-Refundable Payment, to be paid to Company by Retail Customer prior to commencement of construction, Company agrees to install and operate lines and equipment necessary to distribute electric service to the identified location under the following General Conditions:

- Company shall at all times have title to and complete ownership and control over facilities installed by Company.
- Retail Customer must make satisfactory payment arrangements (if payment is required to extend Company facilities) and sign and return this Agreement before Company can proceed with the requested extension.

CenterPoint Energy Houston Electric, LLC
Applicable: Entire Service Area

CNP 8038

- Extension of service facilities is contingent on acquisition of all necessary easements and rights of way.

Nothing herein contained within this Agreement shall be construed as a waiver or relinquishment by Company of any right that it has or may hereafter have to discontinue service for or on account of default in the payment of any bill owing or to become owing thereafter for any other reason or cause stated in Company's Tariff.

This Agreement shall not be binding upon Company unless and until it is signed by an authorized representative of the Company.

CenterPoint Energy Houston Electric, LLC

Retail Customer

By 

William F Wilcox Jr

(name printed or typed)

By _____

(name printed or typed)

Title Staff Service Consultant

Title _____

Date 05/25/2017

Date _____

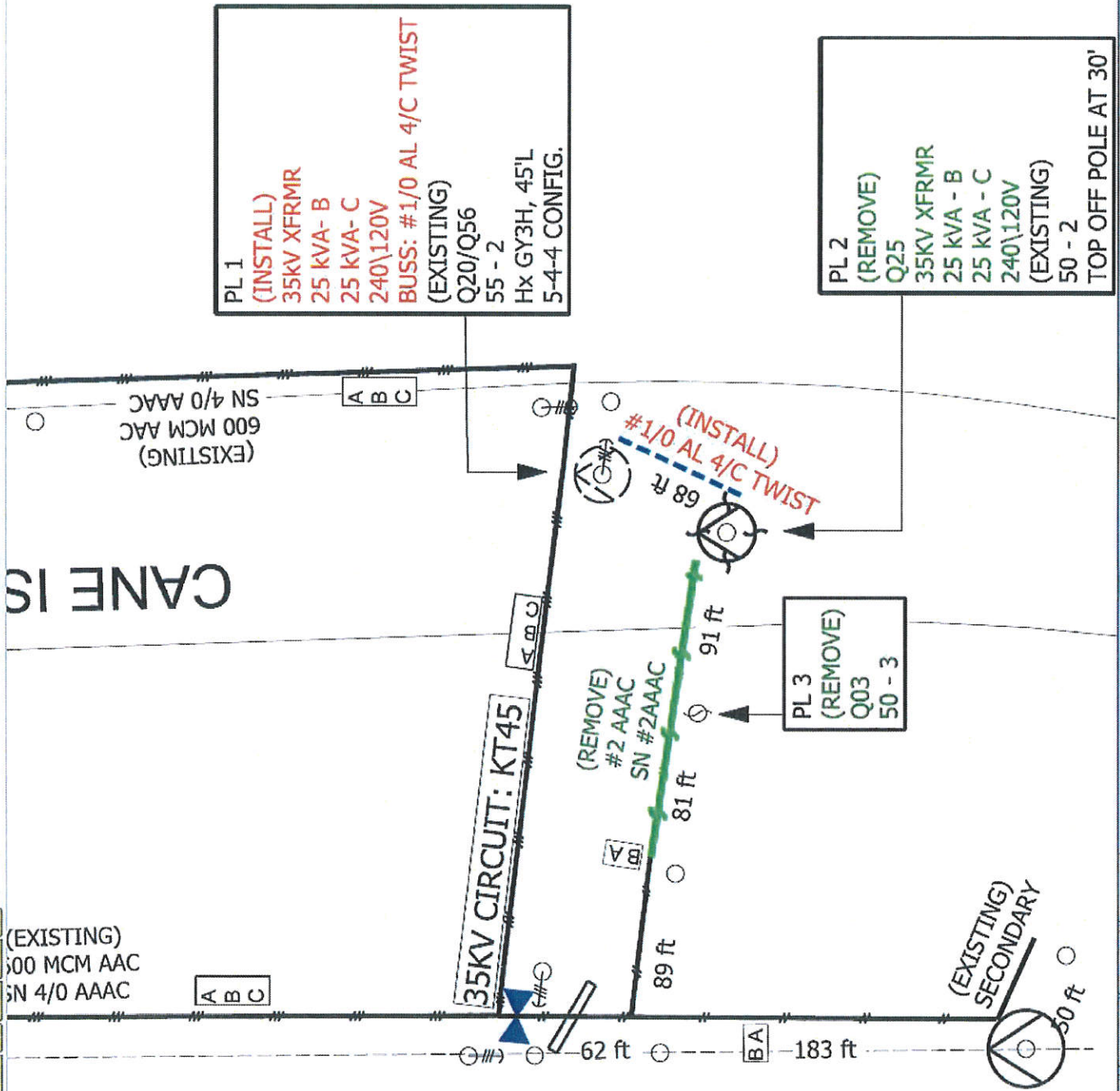

6/9/92
7655(12-92)

Job IF 86637
Map 4257 A
S/C KATY

EASEMENT

STATE OF TEXAS }

KNOW ALL PERSONS BY THESE PRESENTS:

COUNTY OF FT BEND }

THAT, WAYNE S. SHELLENBERG, d/b/a SHELLENBERG ENTERPRIZES, herein called Grantor, whether one or more, for and in consideration of the sum of ONE DOLLAR (\$1.00) CASH to Grantor paid by Reliant Energy HL&P, a division of Reliant Energy, Incorporated a/k/a Houston Industries Incorporated, herein called Grantee, whose principal address is P. O. Box 1700, Houston, Texas 77251, has **GRANTED, SOLD AND CONVEYED** and by these presents, does **GRANT, SELL AND CONVEY** unto said Grantee, its successors and assigns, an easement for electric distribution facilities (consisting of all necessary and desirable equipment and appurtenances) at, below and from ground level upward, located on, under, over, and across the following described lands, to wit:

That certain tract of land in the THOMAS CRESAP Survey, Abstract 369, FT BEND County, Texas, described in a deed recorded in VOL 1866 PG 1256 of the Official Records of said County.

The easement herein granted is ten (10) feet wide, being centered on the electric distribution facilities as subsequently constructed within said tract, save and except the service drop extending to Grantor's structure located on said tract, together with unobstructed aerial easements ten (10) feet wide, beginning at a plane sixteen (16) feet above the ground and extending upward, located on both sides of and adjoining said 10-foot wide easement.

The easement herein granted shall apply only insofar as the boundaries of the above described property will permit. Grantee further reserves the right to extend service to adjacent land owners from electric distribution facilities built within the easement herein granted if said easement is located near Grantor's property line.

Grantee shall also have rights of ingress and egress to and from said easement, together with reasonable working space, for the purposes of erecting, installing, operating, maintaining, replacing, inspecting, and removing said electric distribution facilities, together with the additional right to remove from said easement and land adjoining thereto, all bushes, trees and parts thereof, or other structures which, in the opinion of Grantee, endanger or may interfere with the efficiency, safe and proper operation, and maintenance of said electric distribution facilities.

TO HAVE AND TO HOLD the above described easement, together with all and singular the rights and appurtenances thereto in anywise belonging, unto Grantee, its successors or assigns, forever, and Grantor does hereby bind Grantor and Grantor's heirs, and legal representatives, to warrant and forever defend all and singular the above described easement and rights unto said Grantee, its successors and assigns, against every person whomsoever lawfully claiming or to claim the same or any part thereof.

EXECUTED this 31th day of MARCH, 2000.

WAYNE SHELLENBERG d/b/a SHELLENBERG ENTERPRIZES

BY: 

WAYNE SHELLENBERG
(Name typed or printed)

STATE OF TEXAS }

COUNTY OF FORT }
BEND

This instrument was acknowledged before me on March 31, 2000, by
WAYNE SHELLENBERG d/b/a
SHELLENBERG ENTERPRIZES, on behalf of said corporation.



Mary Colley
Notary's Signature

MARY COLLEY
(Name typed or printed)

Commission Expires: 2-03-02

7656(1-93)

Job IF 86637
Map 4257A
S/C KATY

**ATTACHMENT
AFFIDAVIT**

STATE OF TEXAS }

COUNTY OF FT BEND }

BEFORE me the undersigned authority on this day personally appeared WAYNE SHELLENBERG d/b/a SHELLENBERG ENTERPRIZES, hereinafter referred to as Affiant, who being duly sworn, deposes and says that Affiant is the current owner of the tract of land described in an easement instrument executed by the same on even date herewith, said tract of land is further described as follows:

That certain tract of land in the THOMAS CRESAP Survey, Abstract 369, FT BEND County, Texas, described in a deed recorded in VOL 1866 PG 1256 of the Official Records of said County.

Affiant further says that the said premises have been held by Affiant, that possession thereof has been peaceable and undisturbed, and that the title thereto has never been disputed or questioned to Affiant's knowledge, nor does Affiant know of any facts by reason of which said possession or title might be disturbed or questioned, or by reason of which any claim to said premises, or any part thereof, might arise or be set up adverse to this Affiant.

AS PER ORIGINAL

EXECUTED this 30th day of MARCH, 2000.

WAYNE SHELLENBERG d/b/a SHELLENBERG ENTERPRIZES

BY:

Wayne Shellenberg

WAYNE SHELLENBERG
(Name typed or printed)

SUBSCRIBED and SWORN before me this 31 day of March, 2000.

Patsy L. Jackson

Notary's Signature

PATSY L. JACKSON
(Name typed or printed)

Commission Expires 10-3-2002

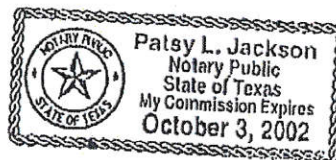

RETURN TO:
SURVEYING & MAPPING DIVISION
RELIANT ENERGY HL&P
P. O. BOX 1700
HOUSTON, TEXAS 77251

KATY SERVICE CENTER

SERVICE TO WAYNE SCHEUBERG SERVICE ADDRESS # 27333 #1 KATY FRWY.

CUSTOMER CONTACT GARY WOODS. PHONE NUMBER 281-934-2058

PREPARED BY SHORT DATE 3-17-00.

GLN 4257 A CIRCUIT _____ KEY MAP _____ COUNTY FT. BEND

REQUESTED DATE _____ CREW LEADER _____ COMPLETION _____

WORK ORDER IF 86637

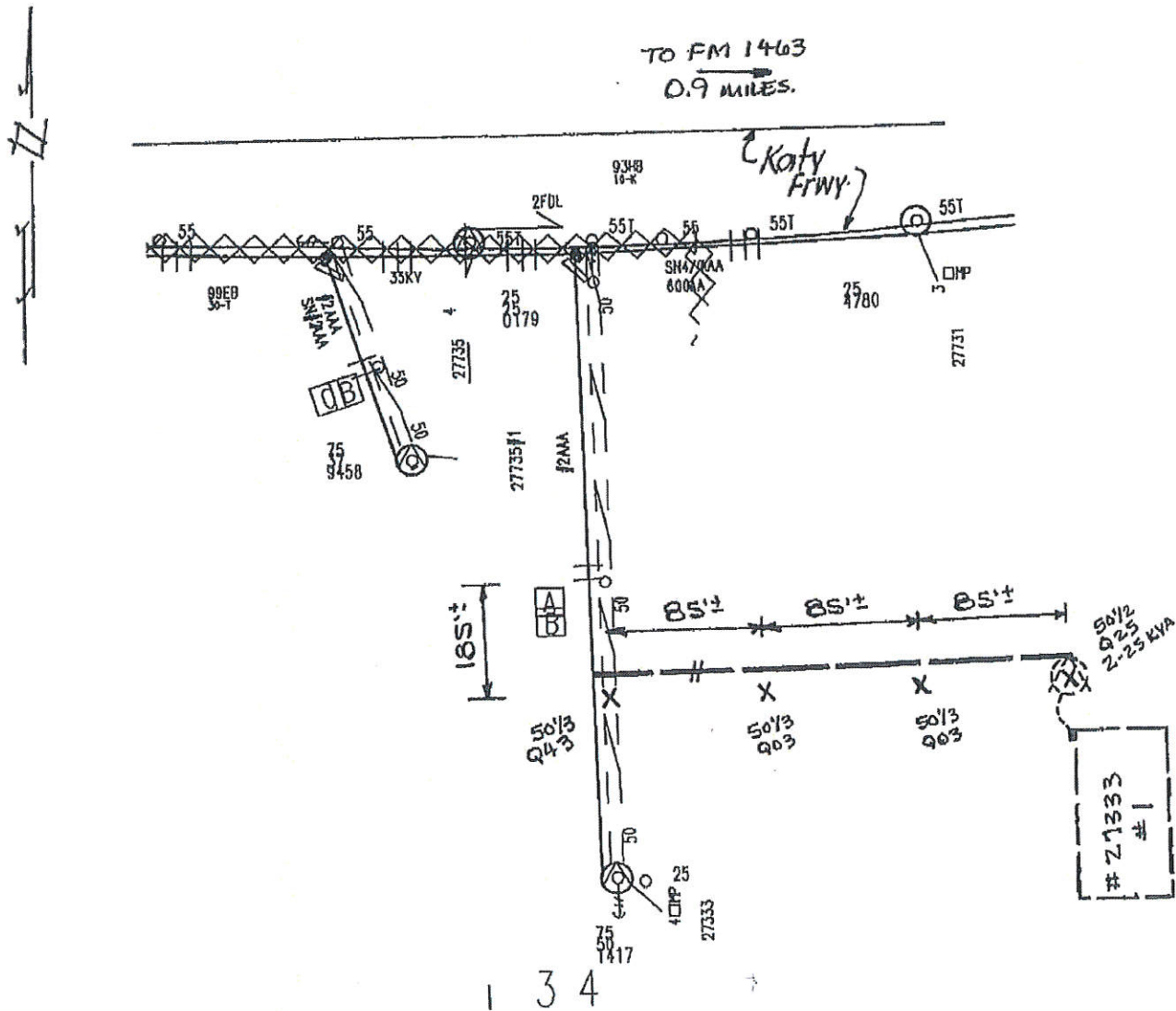

The intent of this Exhibit is to pictorially show the approximate location of the easement. It is not intended as an actual survey. Calls shown are references only. No statement is made to the validity of these calls.

FILED AND RECORDED
OFFICIAL PUBLIC RECORDS

THIS DOCUMENT WAS FILED
BY AND RETURNED TO:
SURVEYING & MAPPING DIVISION
RELIANT ENERGY HL&P
P.O. BOX 1700
HOUSTON, TX 77251-1700

Dianne Wilson

05-16-2000 01:25 PM 2000039430
TD \$19.00
DIANNE WILSON, COUNTY CLERK
FORT BEND COUNTY, TEXAS

CERTIFICATE OF INTERESTED PARTIES

FORM 1295

1 of 1

Complete Nos. 1 - 4 and 6 if there are interested parties.
Complete Nos. 1, 2, 3, 5, and 6 if there are no interested parties.

OFFICE USE ONLY CERTIFICATION OF FILING

1 Name of business entity filing form, and the city, state and country of the business entity's place of business.

CenterPoint Energy Houston Electric, LLC
Houston, TX United States

Certificate Number:
2017-238324

Date Filed:
07/18/2017

2 Name of governmental entity or state agency that is a party to the contract for which the form is being filed.

Fort Bend County

Date Acknowledged:

3 Provide the identification number used by the governmental entity or state agency to track or identify the contract, and provide a description of the services, goods, or other property to be provided under the contract.

13306 - 07/25/2017

Remove overhead facilities in easements.

4	Name of Interested Party	City, State, Country (place of business)	Nature of interest (check applicable)	
			Controlling	Intermediary

5 Check only if there is NO Interested Party.



6 AFFIDAVIT

I swear, or affirm, under penalty of perjury, that the above disclosure is true and correct.

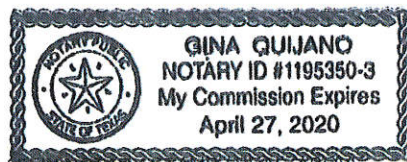

AFFIX NOTARY STAMP / SEAL ABOVE

Cynthia Martinez
Signature of authorized agent of contracting business entity

Sworn to and subscribed before me, by the said Cynthia Martinez this the 19th day of July, 2017, to certify which, witness my hand and seal of office.

Gina Quijano
Signature of officer administering oath

Gina Quijano
Printed name of officer administering oath

Exec. Asst.
Title of officer administering oath