



**REVIEW BY FORT BEND COUNTY**  
**COMMISSIONERS COURT**

**Fort Bend County**  
**Engineering Department**  
301 Jackson Suite 401  
Richmond, Texas 77469  
281.633.7500  
[Permits@fortbendcountytx.gov](mailto:Permits@fortbendcountytx.gov)

Right of Way Permit

Commercial Driveway Permit

Permit No: 2017-14693

**Applicant:** The Redeemed Christian Church of God Mercy Hall

**Job Location Site:** 24814 Saddlespur Lane, katy, TX 77494

**Bond No.** 63259010      **Date of Bond:** 6/29/2017      **Amount:** \$5,000.00

The above applicant came to make use of certain Fort Bend County property subject to, "The Order Regulating the Laying, Construction, Maintenance, and Repair of Buried Cables, Conduits, and Pole Lines, In, Under, Across or Along Roads, Streets, Highways, and Drainage Ditches in Fort Bend County, Texas, Under the Jurisdiction of the Commissioners Court of Fort Bend County, Texas," as passed by the Commissioners Court of Fort Bend County, Texas, of the Minutes of the Commissioners Court of Fort Bend County, Texas, to the extent that such order is not inconsistent with Chapter 181, Vernon's Texas Statutes and Codes Annotated.

**Notes:**

1. Evidence of review by the Commissioners Court must be kept on the job site and failure to do so constitutes grounds for job shutdown.
2. Written notices are required:
  - a. 48 hours in advance of construction start up, and
  - b. When construction is completed and ready for final inspection, submit notification to Permit Administrator thru [MyGovernmentOnline.org](http://MyGovernmentOnline.org) portal.
3. This permit expires one (1) year from date of permit if construction has not commenced.

On this 18th day of July, 2017, Upon Motion of Commissioner \_\_\_\_\_, seconded by Commissioner \_\_\_\_\_, duly put and carried, it is ORDERED, ADJUDGED AND DECREED that said notice of said above purpose is hereby acknowledged by the Commissioners Court of Fort Bend County, Texas, and that said notice be placed on record according to the regulation order thereof.

**Signature**

Presented to Commissioners Court and approved.

By: *Charles O. Ay*  
County Engineer

Date Recorded \_\_\_\_\_ Comm. Court No. \_\_\_\_\_

Clerk of Commissioners Court

By: N/A

By: \_\_\_\_\_

Drainage District Engineer/Manager

Deputy



**PERMIT APPLICATION REVIEW FORM FOR  
CABLE, CONDUIT, AND POLE LINE ACTIVITY  
IN FORT BEND COUNTY**

**Fort Bend County  
Engineering Department**  
301 Jackson Suite 401  
Richmond, Texas 77469  
281.633.7500  
[Permits@fortbendcountytx.gov](mailto:Permits@fortbendcountytx.gov)

- Right of Way Permit  
 Commercial Driveway Permit

Permit No: 2017-14693

The following "Notice of Proposed Cable, Conduit, and/or Pole Line activity in Fort Bend County" and accompanying attachments have been reviewed and the notice conforms to appropriate regulations set by Commissioner's Court of Fort Bend County, Texas.

**(1) COMPLETE APPLICATION FORM:**

- a. Name of road, street, and/or drainage ditch affected.  
 b. Vicinity map showing course of directions  
 c. Plans and specifications

**(2) BOND:**

- County Attorney, approval when applicable.
- Perpetual bond currently posted.      Bond No: \_\_\_\_\_      Amount: \_\_\_\_\_
- Performance bond submitted.      Bond No: 63259010      Amount: \$5,000.00
- Cashier's Check      Check No: \_\_\_\_\_      Amount: \_\_\_\_\_

**(3) DRAINAGE DISTRICT APPROVAL (WHEN APPLICABLE):**

\_\_\_\_\_  
Drainage District Approval

\_\_\_\_\_  
Date

**We have reviewed this project and agree it meets minimum requirements.**

*Charles O. Ay*

\_\_\_\_\_  
Permit Administrator

*7/10/17*

\_\_\_\_\_  
Date



This bond is payable at the County Courthouse in the County of Fort Bend and State of Texas.

It is understood that at any time Fort Bend County deems itself insecure under this bond, it may require further and/or additional bonds of the principal.

EXECUTED this 29th day of June, 2017.

The Redeemed Christian Church of God  
Mercy Hall  
PRINCIPAL



BY

WESTERN SURETY COMPANY  
SURETY

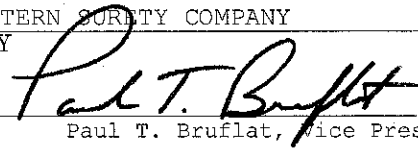

BY

Paul T. Bruflat, Vice President

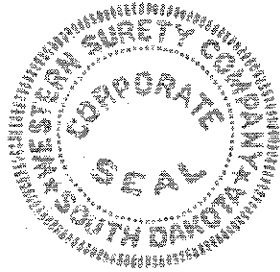

# Western Surety Company

## POWER OF ATTORNEY

### KNOW ALL MEN BY THESE PRESENTS:

That WESTERN SURETY COMPANY, a corporation organized and existing under the laws of the State of South Dakota, and authorized and licensed to do business in the States of Alabama, Alaska, Arizona, Arkansas, California, Colorado, Connecticut, Delaware, District of Columbia, Florida, Georgia, Hawaii, Idaho, Illinois, Indiana, Iowa, Kansas, Kentucky, Louisiana, Maine, Maryland, Massachusetts, Michigan, Minnesota, Mississippi, Missouri, Montana, Nebraska, Nevada, New Hampshire, New Jersey, New Mexico, New York, North Carolina, North Dakota, Ohio, Oklahoma, Oregon, Pennsylvania, Rhode Island, South Carolina, South Dakota, Tennessee, Texas, Utah, Vermont, Virginia, Washington, West Virginia, Wisconsin, Wyoming, and the United States of America, does hereby make, constitute and appoint

Paul T. Bruflat of Sioux Falls,  
State of South Dakota, its regularly elected Vice President,  
as Attorney-in-Fact, with full power and authority hereby conferred upon him to sign, execute, acknowledge and deliver for and on its behalf as Surety and as its act and deed, the following bond:

Cable, Conduit and/or Pole line Activity in, under, across or along County Roads County  
One of Fort Bend

bond with bond number 63259010

for The Redeemed Christian Church of God Mercy Hall  
as Principal in the penalty amount not to exceed: \$ 5,000.00

Western Surety Company further certifies that the following is a true and exact copy of Section 7 of the by-laws of Western Surety Company duly adopted and now in force, to-wit:

Section 7. All bonds, policies, undertakings, Powers of Attorney, or other obligations of the corporation shall be executed in the corporate name of the Company by the President, Secretary, any Assistant Secretary, Treasurer, or any Vice President, or by such other officers as the Board of Directors may authorize. The President, any Vice President, Secretary, any Assistant Secretary, or the Treasurer may appoint Attorneys-in-Fact or agents who shall have authority to issue bonds, policies, or undertakings in the name of the Company. The corporate seal is not necessary for the validity of any bonds, policies, undertakings, Powers of Attorney or other obligations of the corporation. The signature of any such officer and the corporate seal may be printed by facsimile.

In Witness Whereof, the said WESTERN SURETY COMPANY has caused these presents to be executed by its  
Vice President with the corporate seal affixed this 29th day of June,  
2017.

ATTEST

L. Nelson

L. Nelson, Assistant Secretary

WESTERN SURETY COMPANY

By

Paul T. Bruflat

Paul T. Bruflat, Vice President

STATE OF SOUTH DAKOTA }  
COUNTY OF MINNEHAHA } ss

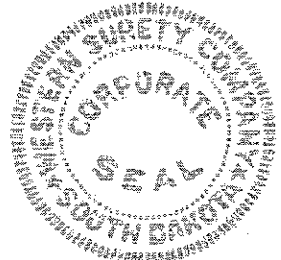

On this 29th day of June, 2017, before me, a Notary Public, personally appeared  
Paul T. Bruflat and L. Nelson

who, being by me duly sworn, acknowledged that they signed the above Power of Attorney as Vice President  
and Assistant Secretary, respectively, of the said WESTERN SURETY COMPANY, and acknowledged said instrument to be the  
voluntary act and deed of said Corporation.

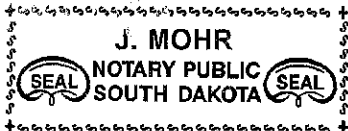

My Commission Expires June 23, 2021

J. Mohr

Notary Public

To validate bond authenticity, go to [www.cnasurety.com](http://www.cnasurety.com) > Owner/Obligee Services > Validate Bond Coverage.



Figure: 28 TAC §1.601(a)(3)

**IMPORTANT NOTICE**

- 1 To obtain information or make a complaint:
- 2 You may contact Western Surety Company, Surety Bonding Company of America or Universal Surety of America at 605-336-0850.
- 3 You may call Western Surety Company's, Surety Bonding Company of America's or Universal Surety of America's toll-free telephone number for information or to make a complaint at:

**1-800-331-6053**

- 4 You may also write to Western Surety Company, Surety Bonding Company of America or Universal Surety of America at:

P.O. Box 5077  
Sioux Falls, SD 57117-5077

- 5 You may contact the Texas Department of Insurance to obtain information on companies, coverages, rights or complaints at:

**1-800-252-3439**

- 6 You may write the Texas Department of Insurance:

P.O. Box 149104  
Austin, TX 78714-9104  
Fax: (512) 490-1007  
Web: [www.tdi.texas.gov](http://www.tdi.texas.gov)  
E-Mail: [ConsumerProtection@tdi.texas.gov](mailto:ConsumerProtection@tdi.texas.gov)

- 7 **PREMIUM OR CLAIM DISPUTES:**  
Should you have a dispute concerning your premium or about a claim you should contact Western Surety Company, Surety Bonding Company of America or Universal Surety of America first. If the dispute is not resolved, you may contact the Texas Department of Insurance.

- 8 **ATTACH THIS NOTICE TO YOUR POLICY:**  
This notice is for information only and does not become a part or condition of the attached document.

**AVISO IMPORTANTE**

Para obtener informacion o para someter una queja:

Puede comunicarse con Western Surety Company, Surety Bonding Company of America o Universal Surety of America al 605-336-0850.

Usted puede llamar al numero de telefono gratis de Western Surety Company's, Surety Bonding Company of America's o Universal Surety of America's para informacion o para someter una queja al:

**1-800-331-6053**

Usted tambien puede escribir a Western Surety Company, Surety Bonding Company of America o Universal Surety of America:

P.O. Box 5077  
Sioux Falls, SD 57117-5077

Puede comunicarse con el Departamento de Seguros de Texas para obtener informacion acerca de companias, coberturas, derechos o quejas al:

**1-800-252-3439**

Puede escribir al Departamento de Seguros de Texas:

P.O. Box 149104  
Austin, TX 78714-9104  
Fax: (512) 490-1007  
Web: [www.tdi.texas.gov](http://www.tdi.texas.gov)  
E-Mail: [ConsumerProtection@tdi.texas.gov](mailto:ConsumerProtection@tdi.texas.gov)

**DISPUTAS SOBRE PRIMAS O RECLAMOS:**  
Si tiene una disputa concerniente a su prima o a un reclamo, debe comunicarse con el Western Surety Company, Surety Bonding Company of America o Universal Surety of America primero. Si no se resuelve la disputa, puede entonces comunicarse con el departamento (TDI).

**UNA ESTE AVISO A SU POLIZA:** Este aviso es solo para proposito de informacion y no se convierte en parte o condicion del documento adjunto.

# REDEEMED CHRISTIAN CHURCH OF GOD MERCY HALL PROJECT 24814 SADDLESPUR LANE KATY, TX 77494

## SHEET INDEX

- 1. COVER SHEET
- 2. SITE /DEMO PLAN
- 3. SITE DRAINAGE PLAN
- 4. SITE GRADING PLAN
- 5. PAVING PLAN
- 6. DETAILS
- 7. CIVIL DETAILS 1
- 8. CIVIL DETAILS 2
- 9. CIVIL DETAILS 3
- 10. CIVIL DETAILS 4
- 11. PHOTOMETRIC LIGHTING
- 12. PLAT

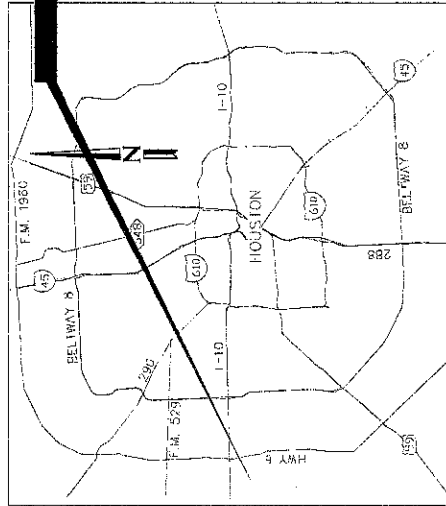

AERIAL MAP



Fort Bend County Engineering  
FOR FORT BEND COUNTY TEXAS

Richard W. Smith, P.E.  
County Engineer

**Fort Bend County Construction - General Notes**

1. Fort Bend County areas are limited to the Fire Construction Division.
2. Contractor shall notify Fort Bend County Engineering Department 48 hours prior to commencing construction and shall provide a copy of the approved plans to the County Engineer's office.
3. Contractor is responsible for obtaining all permits required from Fort Bend County prior to commencing construction of any improvements within County road right-of-way.
4. All paving improvements shall be constructed in accordance with Fort Bend County "Rules, Regulations and Specifications for Paving" and shall be installed in accordance with the specifications in County Engineer's manual.
5. All steel utility, catch and run and other structures shall be installed back of curb.
6. A continuous, impervious curb shall be used in the curb.
7. All concrete pavement shall be 1 1/2" thick concrete with a minimum compressive strength of 3000 psi at 28 days.
8. All concrete shall be finished with a broom finish.
9. All concrete structures shall be placed in blocks of single family lots only. All other areas shall be 6" reinforced concrete.
10. S.A.P. - 1/2" rebar shall be placed in concrete with 2000 PSI concrete and 2000 PSI concrete with 2000 PSI concrete.
11. A.S.P. - 1/2" rebar shall be placed in concrete with 2000 PSI concrete and 2000 PSI concrete with 2000 PSI concrete.
12. A.S.P. - 1/2" rebar shall be placed in concrete with 2000 PSI concrete and 2000 PSI concrete with 2000 PSI concrete.
13. All utilities are set back in accordance with the "Standard Utility Ordinance", as currently amended, that be observed. The Contractor shall be responsible for providing adequate flagmen, signing, lighting and warning devices, etc., during construction - roadway and right-of-way.
14. Street lighting shall be 120-120" with automatic glare shielding per Texas Manual on Uniform Traffic Control Devices.
15. Street lighting shall be on a 6" high 1/2" thick white reflective grade background. Street signs shall be approved and dimensioned with appropriate signs of 6" minimum and dimensions of 6" minimum. The height of the signs shall be approved by the County Engineer. The height of the signs shall be approved by the County Engineer.
16. A 1/2" rebar shall be placed in concrete with 2000 PSI concrete and 2000 PSI concrete with 2000 PSI concrete.

Notes: Fort Bend County rules supersede any conflicting ones.

300 Jackson St., Suite 400, Houston, TX 77009  
Phone: 713-438-2200

www.fortbendcounty.com/Engineering/Group2014/Forms



**NEJU ENGINEERING SERVICES, INC.**  
10000 Katy Road, Suite 200  
Katy, TX 77494  
Phone: 281-341-1234  
Fax: 281-341-1234  
TELE NO. F-8029

DRAWING SCALE	
DATE	6/23/17
ENGINEER	Richard W. Smith, P.E.
DATE	6/23/17
APPROVED	[Signature]
DATE	6/23/17

FOR FORT BEND COUNTY - ENGINEER  
ENGINEER: *Richard W. Smith, P.E.*  
DATE: 6/23/17  
THESE SIGNATURES ARE VOID IF CONSTRUCTION HAS NOT COMMENCED IN (1) YEAR FROM DATE OF APPROVAL  
APPROVED: [Signature]  
DATE: 6/23/17





**REDEEMED CHRISTIAN CHURCH OF GOD - MERCY HALL**

24814 SADDLESPUR LANE, KATY, TX 77494

PROJECT NO. 03029717

DATE: 6/12/17

PHASE: PRELIMINARY

DRAWING NO. C2-0

SHEET 3 OF 11

DEVELOPMENT COORDINATOR / DATE: [Signature] 6/12/17

CONTRACTOR SHALL COORDINATE WITH FSC ROAD & BRIDGE FOR INSTALLATION OF CURBENTS, CALL 281-542-1512

**REDEEMED CHRISTIAN CHURCH OF GOD - MERCY HALL**

24814 SADDLESPUR LANE, KATY, TX 77494

PROJECT NO. 03029717

DATE: 6/12/17

PHASE: PRELIMINARY

DRAWING NO. C2-0

SHEET 3 OF 11

DEVELOPMENT COORDINATOR / DATE: [Signature] 6/12/17

CONTRACTOR SHALL COORDINATE WITH FSC ROAD & BRIDGE FOR INSTALLATION OF CURBENTS, CALL 281-542-1512

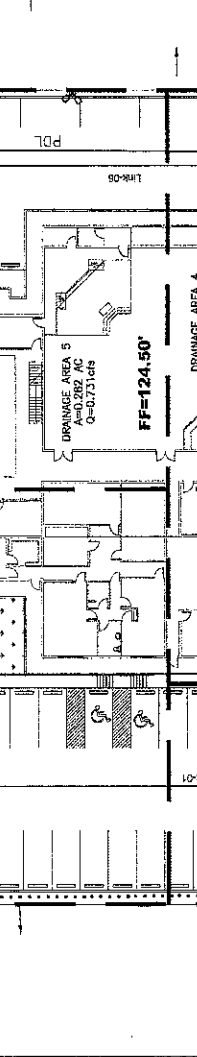
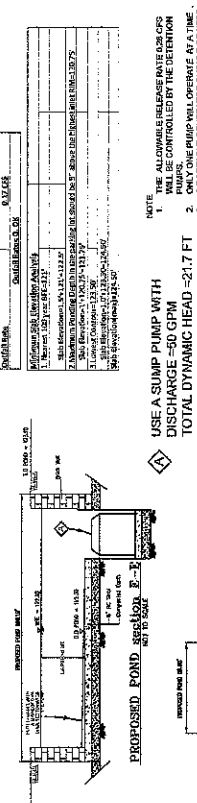
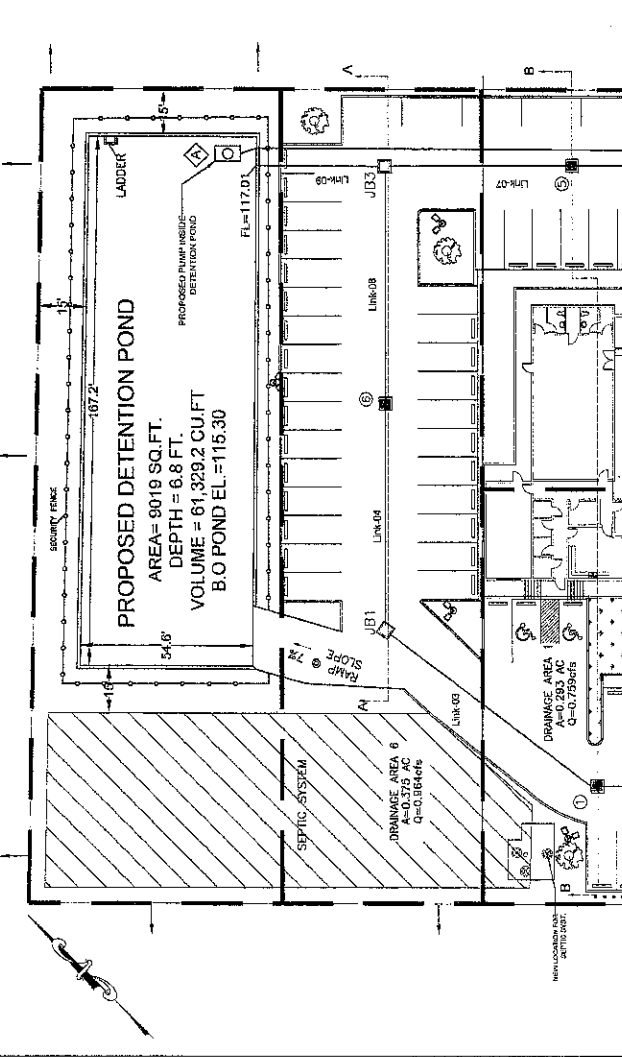

**NOTE:**

1. THE ALLOWABLE RELEASE RATE (ARR) WILL BE CONTROLLED BY THE DETENTION
2. ONLY ONE PUMP WILL OPERATE AT A TIME.
3. A PORTABLE GENERATOR SHOULD BE KEPT ON SITE AT ALL TIMES.
4. THE OWNER IS RESPONSIBLE FOR MAINTENANCE OF ALL DETENTION FACILITIES.

**USE A SUMP PUMP WITH DISCHARGE = 30 GPM TOTAL DYNAMIC HEAD = 21.7 FT MANUFACTURER - FLYGT NAME - FLYGT READY PUMPS MODEL - READY 85**

**MINIMUM SIZES:**

1. 18" DIA. 10' MIN. DEPTH
2. 18" DIA. 10' MIN. DEPTH
3. 18" DIA. 10' MIN. DEPTH
4. 18" DIA. 10' MIN. DEPTH
5. 18" DIA. 10' MIN. DEPTH
6. 18" DIA. 10' MIN. DEPTH
7. 18" DIA. 10' MIN. DEPTH
8. 18" DIA. 10' MIN. DEPTH
9. 18" DIA. 10' MIN. DEPTH
10. 18" DIA. 10' MIN. DEPTH
11. 18" DIA. 10' MIN. DEPTH
12. 18" DIA. 10' MIN. DEPTH
13. 18" DIA. 10' MIN. DEPTH
14. 18" DIA. 10' MIN. DEPTH
15. 18" DIA. 10' MIN. DEPTH
16. 18" DIA. 10' MIN. DEPTH
17. 18" DIA. 10' MIN. DEPTH
18. 18" DIA. 10' MIN. DEPTH
19. 18" DIA. 10' MIN. DEPTH
20. 18" DIA. 10' MIN. DEPTH

**CONTRACTOR SHALL COORDINATE WITH FSC ROAD & BRIDGE FOR INSTALLATION OF CURBENTS, CALL 281-542-1512**

**KEYED NOTES**

- CONSTRUCT NEW DRIVEWAY AS SHOWN
- SAW CUT AND REMOVE EXISTING CONCRETE CURB
- LIGHT POLE TYPICAL

**NOTE:**  
CONTRACTOR SHALL FIELD VERIFY THE LOCATIONS OF EXISTING UTILITIES AND GROUND ELEVATIONS. A PHOTOCELL "ON" ASTRONOMIC TIME SWITCH SHALL BE INSTALLED AT THE LIGHT POLE. THE CONTROL PANEL "OFF" WILL CONTROL EXTERIOR LIGHTING.

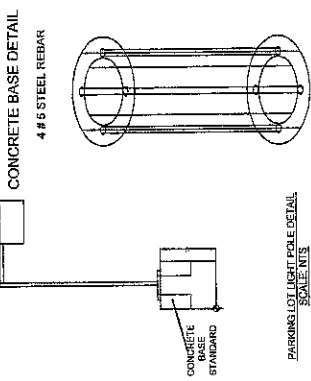

Model	Ready #4	Ready #5
Product code	2006212	2006212
Part number	110652	110652
Volume (yd³)	0.6605	1.10082
Weight (lb)	294	512
Height (ft)	17.2	20.2
Weight (lb)	17.2	20.2
Height (ft)	17.2	20.2
Weight (lb)	17.2	20.2
Height (ft)	17.2	20.2
Weight (lb)	17.2	20.2
Height (ft)	17.2	20.2

**STATION OPERATION TABLES**

RISING LEVEL CYCLE		PUMPED IN OPERATION	
WATER LEVEL ELEVATION	115.30	PUMP #1 ON	ALL PUMP IS OFF
WATER LEVEL ELEVATION	115.30	PUMP #2 ON	ALL PUMP IS ON
WATER LEVEL ELEVATION	115.30	PUMP #1 OFF	ALL PUMP IS ON
WATER LEVEL ELEVATION	115.30	PUMP #2 OFF	ALL PUMP IS ON
WATER LEVEL ELEVATION	115.30	ALARM	ALL PUMP IS ON
FALLING LEVEL CYCLE		PUMPED IN OPERATION	
WATER LEVEL ELEVATION	115.30	PUMP #1 ON	ONE PUMP OFF, ONE PUMP ON
WATER LEVEL ELEVATION	115.30	PUMP #2 ON	ONE PUMP OFF, ONE PUMP ON
WATER LEVEL ELEVATION	115.30	PUMP #1 OFF	ONE PUMP OFF, ONE PUMP ON
WATER LEVEL ELEVATION	115.30	PUMP #2 OFF	ONE PUMP OFF, ONE PUMP ON
WATER LEVEL ELEVATION	115.30	ALARM	ONE PUMP OFF, ONE PUMP ON

REDEEMED CHRISTIAN CHURCH OF GOD  
MERCY HALL  
24814 SADDLESPUR LANE  
KATY, TEXAS 77494

PRINTED  
NO. \_\_\_\_\_  
DATE \_\_\_\_\_  
DESCRIPTION / REVISION \_\_\_\_\_

DRAWING NAME  
**SITE GRADING PLAN**

SCALE: 1"=20'  
PROJECT NO.: 0703007  
DATE: 07/03/07  
PHASE: \_\_\_\_\_  
DRAWING NO.: C3-0  
SHEET 4 OF 11

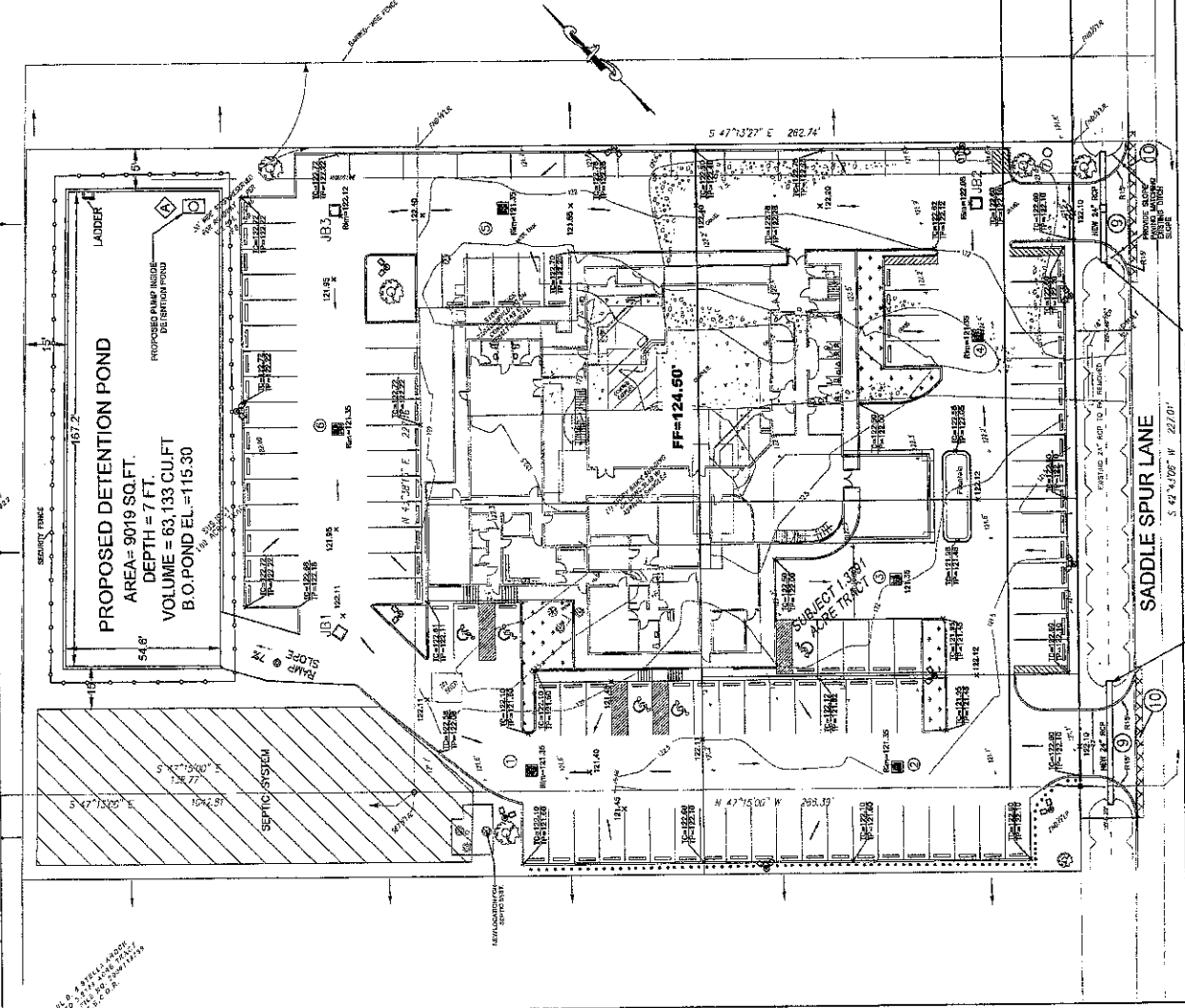

SECTION ALONG SUMP PUMP  
DEVELOPMENT COORDINATOR: *[Signature]* DATE: 6/22/07

NEU ENGINEERING SERVICES, INC  
 12000 WEST 12TH STREET, SUITE 100  
 HOUSTON, TEXAS 77070  
 TEL: 281-462-1111  
 FAX: 281-462-1112  
 TP&E NO. P-8029



REDEEMED CHRISTIAN CHURCH OF GOD  
 MERCY HALL  
 24814 SADDLESPUR LANE  
 KATY, TEXAS 77494

NO.	DATE	DESCRIPTION / REVISION

DRAWING NAME:  
**PAVING PLAN**

SCALE: 1"=20'

PROJECT NO.: 080200P  
 DATE: PHASE:

DRAWING NO.: C4-0

SHEET 5 OF 11

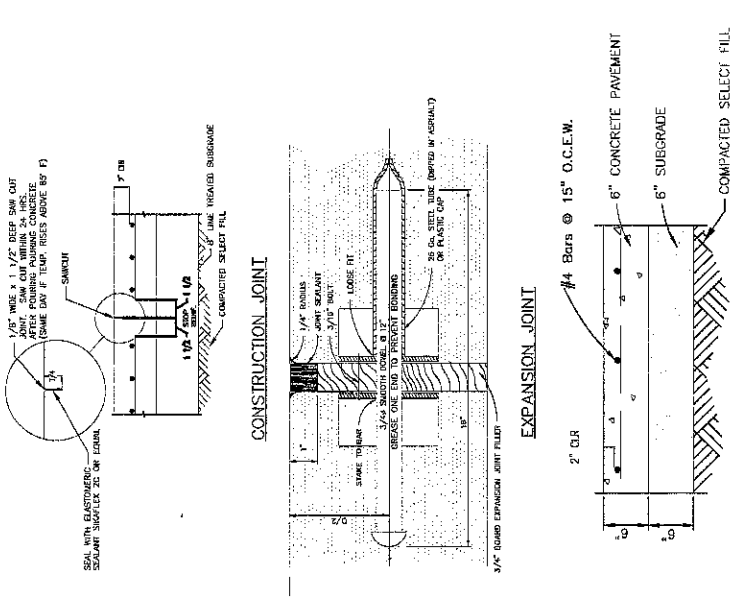

**6" CONCRETE FIRELANE PAVEMENT**

1. SUBGRADE TO BE STABILIZED WITH 7% LIME IN ACCORDANCE WITH TxDOT SPECIFICATION ITEM 260. COMPACT LIME TREATED SUBGRADE TO 95% STANDARD PROCTOR DENSITY PER ASTM D-698. EXTEND LIME TREATED SUBGRADE 5' PAST PAVING LIMITS.

2. SUBGRADE PREPARATION  
 A MINIMUM 1' FOOT OF TOP SOIL BE REMOVED AND WASTED. SUBGRADE PREPARATION SHOULD EXTEND A MINIMUM OF 2 FEET BEYOND THE PAVING PERIMETER. SUBGRADE PREPARATION INCLUDE REMOVAL OF VEGETATION, ROOTS, AS WELL AS DEBRIS. THE EXPOSED SURFACE SHOULD THEN BE PROOF-ROLLED IN ACCORDANCE WITH THE 2004 TxDOT STANDARD SPECIFICATIONS ITEM 216. THE SURFACE SHOULD BE CHECKED BY QUALIFIED GEOTECHNICAL PROFESSIONALS TO IDENTIFY ANY WEAK OR DRY SOILS, AND DELETERIOUS MATERIALS. THESE MATERIALS SHOULD BE REMOVED AND REPLACED WITH SELECT FILL IN ACCORDANCE WITH NOTE 3.

3. SELECT FILL SHOULD CONSIST OF A NON-ACTIVE INORGANIC SANDY LEAN CLAY, HAVING A PI BETWEEN 8 AND 20 PERCENT, AND NOT MORE THAN 50 PERCENT RETAINED ON NO. 200 SIEVE. IF ON-SITE FAT CLAY WITH PI GREATER THAN 20 ARE TO BE USED AS SELECT FILL, THEY SHOULD BE STABILIZED WITH AT LEAST 7 PERCENT HYDRATED LIME BY DRY SOIL WEIGHT. THE PERCENTAGE OF LIME SHOULD BE DETERMINED BY TESTING TO OBTAIN THE BEST STABILIZATION. THE PERCENTAGE OF ACTUAL LIME CONTENT PRIOR TO CONSTRUCTION LIME STABILIZATION SHOULD BE IN ACCORDANCE WITH CITY OF HOUSTON STANDARD CONSTRUCTION SPECIFICATIONS SECTION 02336. ALL SELECT FILL SHOULD BE TESTED PRIOR TO USE TO CONFIRM THAT IT MEETS THE SELECT FILL CRITERIA. THE FILL SHOULD BE PLACED IN LAYER LIFTS NOT EXCEEDING 8 INCHES IN THICKNESS. THE FILL SHOULD BE COMPACTED TO A MINIMUM 95% OF THE ASTM D-698 MAXIMUM DRY UNIT WEIGHT AND AT A MOISTURE CONTENT BETWEEN OPTIMUM AND 3% WET OF OPTIMUM.

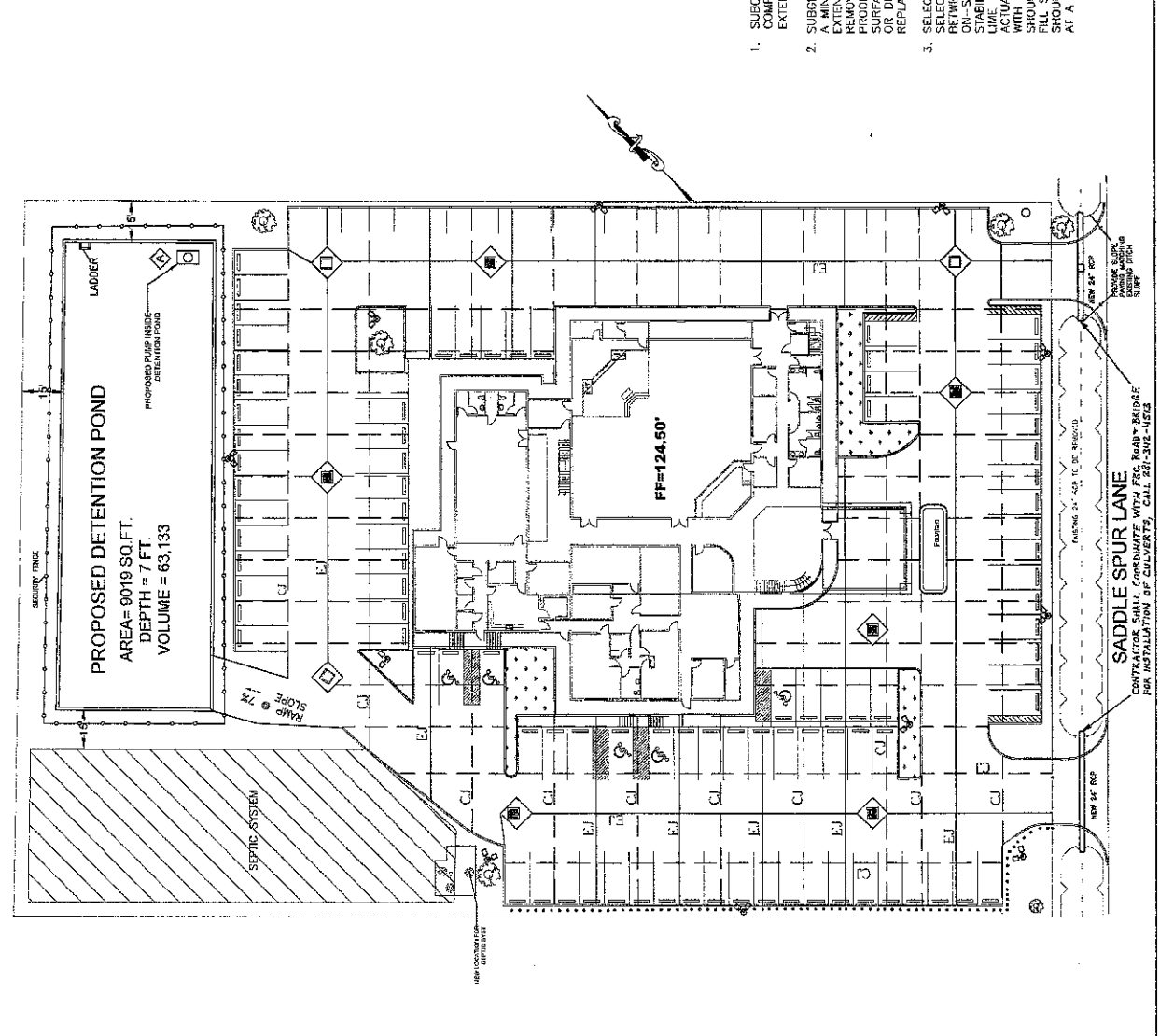

DEVELOPMENT COORDINATOR: *[Signature]* DATE: 4/24/14

**SADDLE SPUR LANE**  
 CONTRACTOR SHALL COORDINATE WITH FSC ROAD\* BARRAGE  
 FOR INSTALLATION OF CULVERTS. CALL 281-342-4424

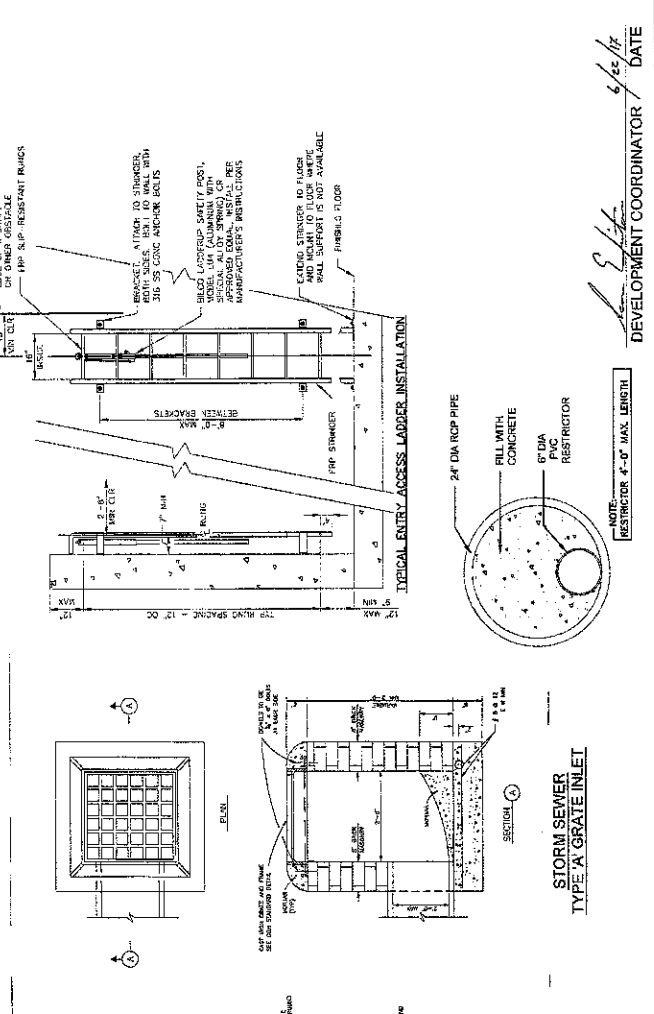
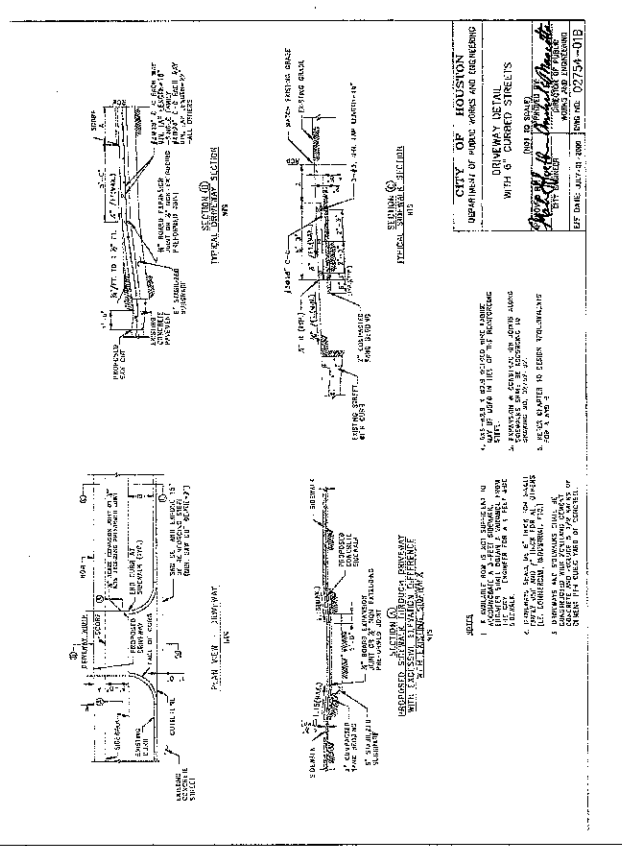
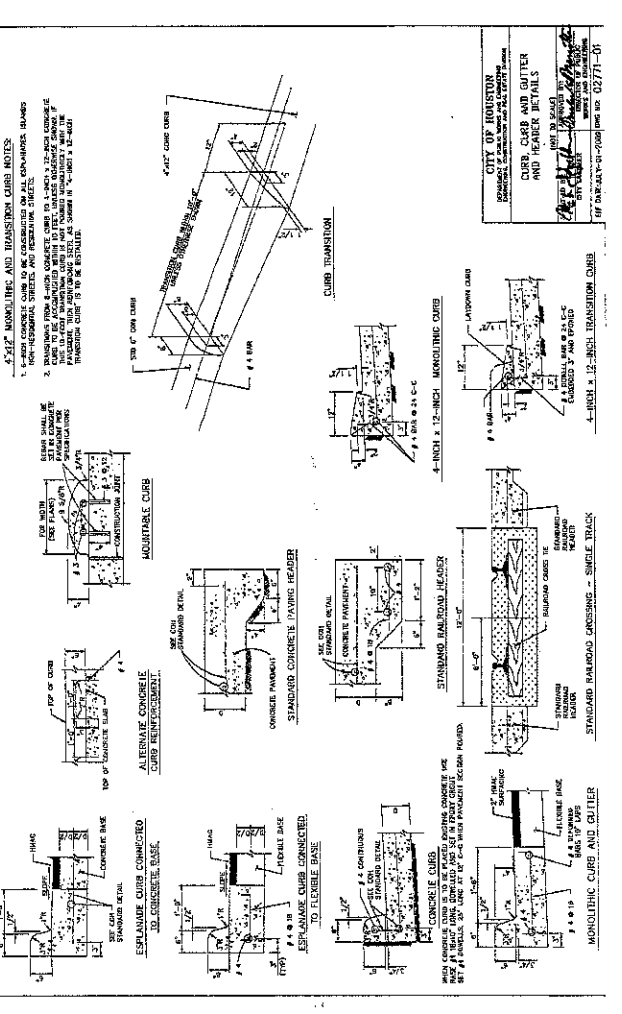

## Multipurpose. Multiple use. Made for the duration

Whether it's for construction or for long-term use, you'll find the right solution for any job. Our products are designed to last, and they're built to last.

**Highly versatile**  
 Our products are designed to be used in a variety of applications. They're built to last, and they're built to last.

**Compact and lightweight**  
 Our products are designed to be compact and lightweight. They're built to last, and they're built to last.

**Engineered for long-term use**  
 Our products are designed to be engineered for long-term use. They're built to last, and they're built to last.

**40 lb**

**NOTE:**  
 1. WEIGHTS ARE BASED ON THE WEIGHT OF THE PRODUCT AS SHOWN IN THE DRAWING.  
 2. SUBJECT TO APPROVAL BY THE LOCAL AUTHORITY.

Product Name	Weight (lb)	Dimensions (in)
4" x 4" x 4" (3000)	40	4" x 4" x 4"
4" x 4" x 6" (3000)	60	4" x 4" x 6"
4" x 4" x 8" (3000)	80	4" x 4" x 8"
4" x 4" x 10" (3000)	100	4" x 4" x 10"
4" x 4" x 12" (3000)	120	4" x 4" x 12"
4" x 4" x 14" (3000)	140	4" x 4" x 14"
4" x 4" x 16" (3000)	160	4" x 4" x 16"
4" x 4" x 18" (3000)	180	4" x 4" x 18"
4" x 4" x 20" (3000)	200	4" x 4" x 20"
4" x 4" x 22" (3000)	220	4" x 4" x 22"
4" x 4" x 24" (3000)	240	4" x 4" x 24"
4" x 4" x 26" (3000)	260	4" x 4" x 26"
4" x 4" x 28" (3000)	280	4" x 4" x 28"
4" x 4" x 30" (3000)	300	4" x 4" x 30"



REDEEMED CHRISTIAN CHURCH  
 OF GOD  
 MERCY HALL  
 24814 SADDLEPUR LANE  
 KATY, TEXAS 77494

NO.	DATE	DESCRIPTION / REVISION

DRAWING NAME:  
**CIVIL DETAILS**

SCALE:  
 PROJECT NO.:  
 DATE: 1/22/08  
 DRAWING NO.:  
 CS-0

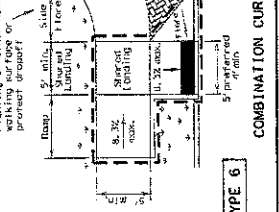
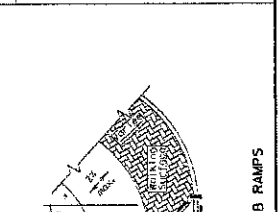
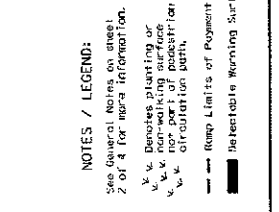
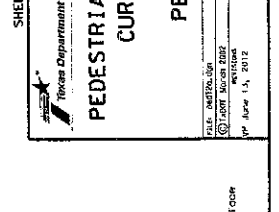
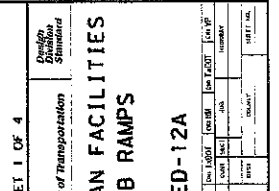
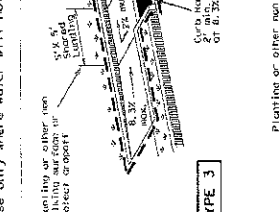
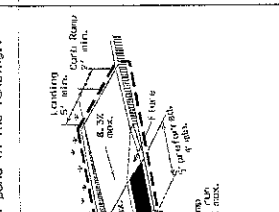
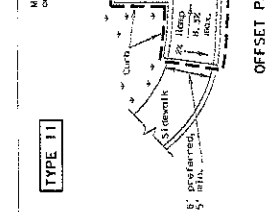
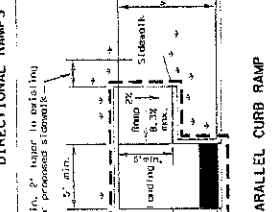
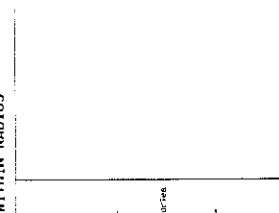
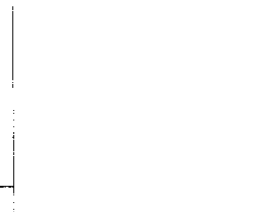
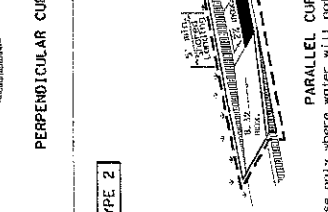
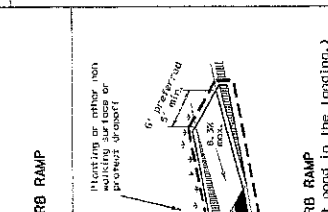
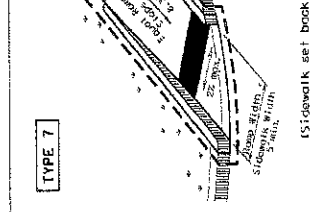
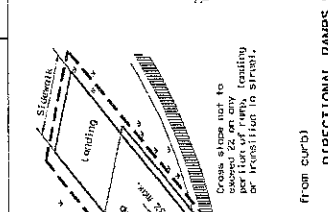
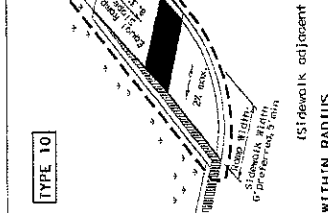
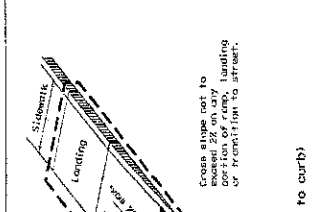
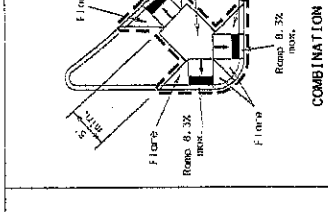
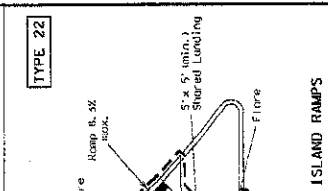
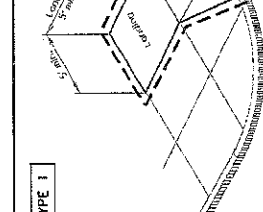
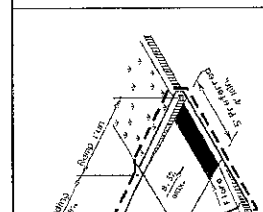
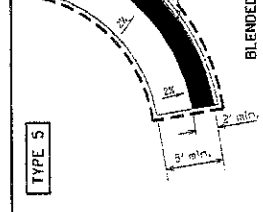
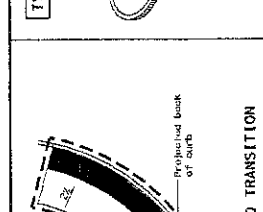
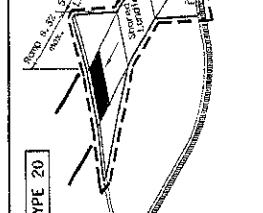
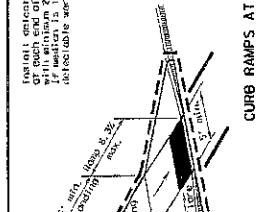
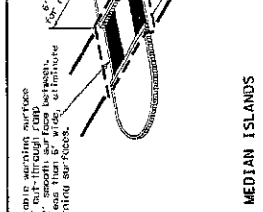
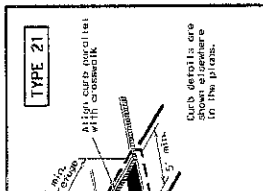

**NOTES / LEGEND:**  
 See General Notes on sheet 2 of 4 for more information.  
 - - - - - Denotes planting or non-walking surface.  
 - - - - - Denotes circulation path.  
 - - - - - Ramp Limits of Payment.  
 - - - - - Detectable Warning Surface.



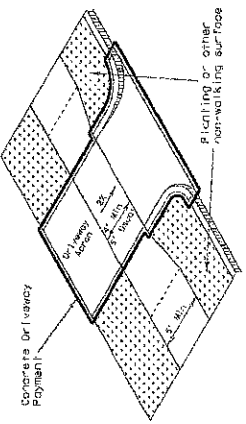

Setback sidewalk

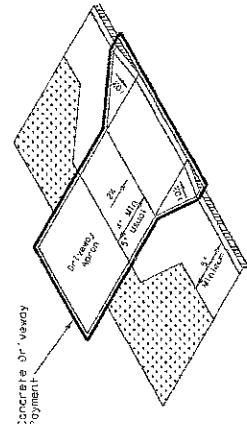

Apron offset sidewalk

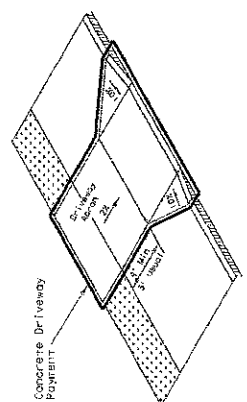

Side sidewalk

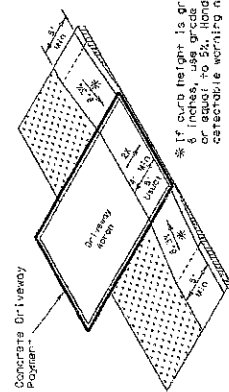

Ramp sidewalk

**SIDEWALK TREATMENT AT DRIVEWAYS**

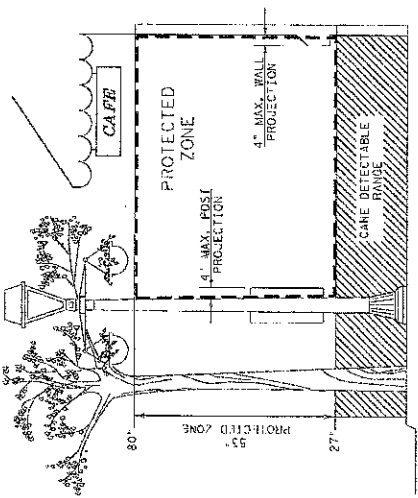

**PROTECTED ZONE**

In pedestrian circulation area, maximum 4" projection for post or wall mounted objects between 27" and 80" above the surface.

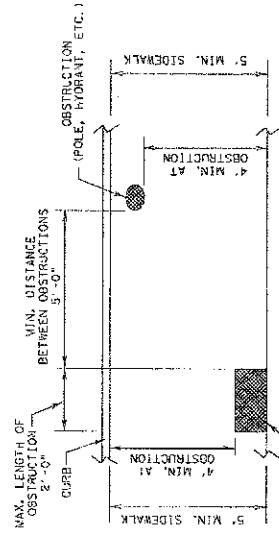

**PLAN VIEW**

**PLACEMENT OF STREET FIXTURES**

(ITEMS NOT INTENDED FOR PUBLIC USE - MINIMUM 4" x 4" CLEAR GROUND SPACE REQUIRED AT PUBLIC USE FIXTURES.)

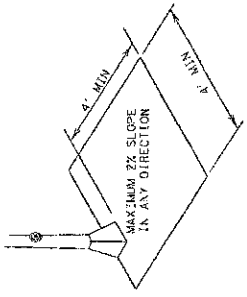

**CLEAR GROUND SPACE ADJACENT TO PEDESTRIAN PUSH BUTTON**

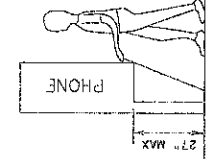

Providing objects of a height  $\leq 27"$  are detectable by cane and do not require additional treatment.

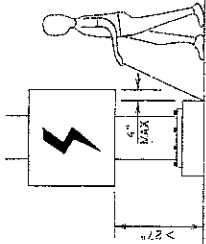

When an obstruction of a height greater than 27" from the surface would create a projection of more than 4" into the pedestrian circulation area, contact additional curb or foundation at the bottom to provide a maximum 4" overhang.

**DETECTION BARRIER FOR VERTICAL CLEARANCE  $< 80"$**

SHEET 3 OF 4

Texas Department of Transportation  
Division  
Standard

**PEDESTRIAN FACILITIES  
CURB RAMP**

PED-12A

DATE: 06/24/19	REVISED: 06/24/19	BY: JST	CHK: JST	APP: JST
PROJECT NO.: 10270016	DATE: 06/24/19	BY: JST	CHK: JST	APP: JST
DRAWING NO.: C8-0	SHEET NO.:	DATE:	BY:	CHK:

NEPU ENGINEERING SERVICES, INC.  
17777 Briarwood Court, Suite 530  
Houston, Texas 77058  
Phone: 281.281.1000  
Fax: 281.281.1001  
Toll Free: 1-800-800-8009



REDEEMED CHRISTIAN CHURCH  
OF GOD  
MERCY HALL  
24814 SADDLESPUR LANE  
KATY, TEXAS 77494

NO.	DATE	DESCRIPTION / REVISION	BY	CHK	APP

PRINTED  
DRAWING NAME:  
CIVIL DETAILS

SCALE:  
PROJECT NO.: 10270016  
DATE: 06/24/19  
DRAWING NO.: C8-0  
SHEET 9 OF 11

DEVELOPMENT COORDINATOR / DATE: 6/24/19

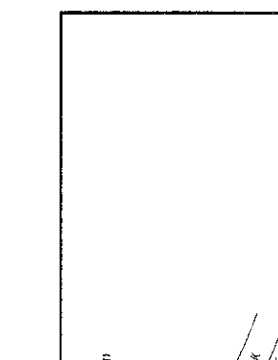

NEU ENGINEERING SERVICES, INC.  
 2111 W. 19th Street, Suite 100  
 Irving, Texas 75039  
 Phone: 972.251.1988  
 Fax: 972.251.1989  
 TDP# NO. F-0029

REDEEMED CHRISTIAN CHURCH  
 OF GOD  
 MERCY HALL  
 24814 SADDLESPUR LANE  
 KATY, TEXAS 77494

NO.	DATE	DESCRIPTION / REVISION	PREPARED BY

CIVIL DETAILS  
 DRAWING NAME

PROJECT NO.:  
 DATE: 10/12/08  
 PHASE:  
 DRAWING NO.: C9-0

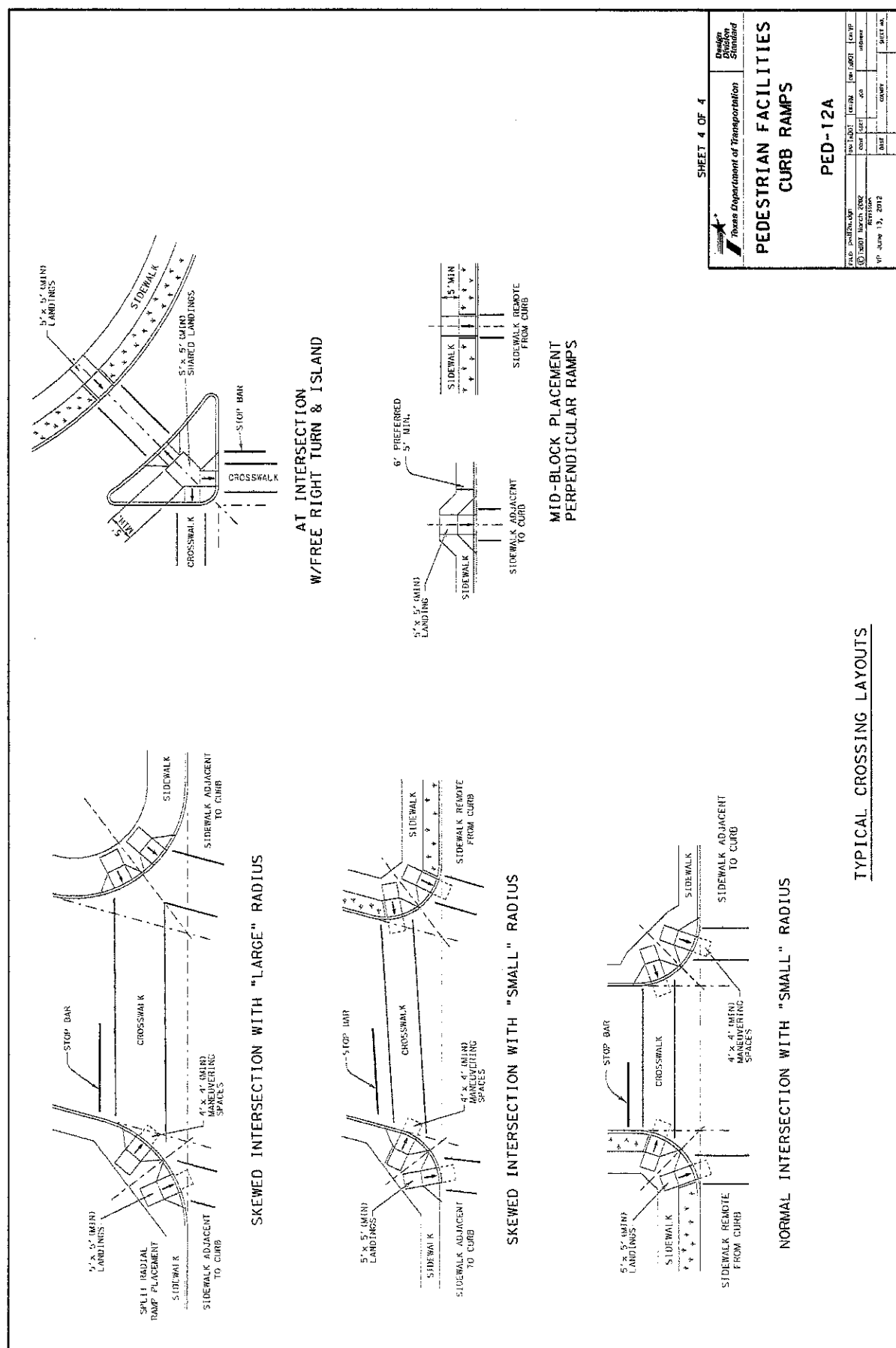

SHEET 4 OF 4

Texas Department of Transportation  
 Design Division  
 Standard

**PEDESTRIAN FACILITIES  
 CURB RAMPS**

**PED-12A**

FILE NUMBER	DATE	BY	CHKD	DATE	BY	CHKD	DATE	BY	CHKD

REVISED: 10/12/08  
 DATE: 10/12/08  
 PHASE: 10/12/08  
 DRAWING NO.: C9-0

TYPICAL CROSSING LAYOUTS

6/22/17  
 DEVELOPMENT COORDINATOR: BATE

DISCLAIMER: The use of this Standard is governed by the Texas Statewide Practice Act. No warranty of any kind is made by TxDOT for any design, construction, or other services provided by the consultant. The consultant shall be responsible for the design, construction, or other services provided by the consultant. The consultant shall be responsible for the design, construction, or other services provided by the consultant. The consultant shall be responsible for the design, construction, or other services provided by the consultant.

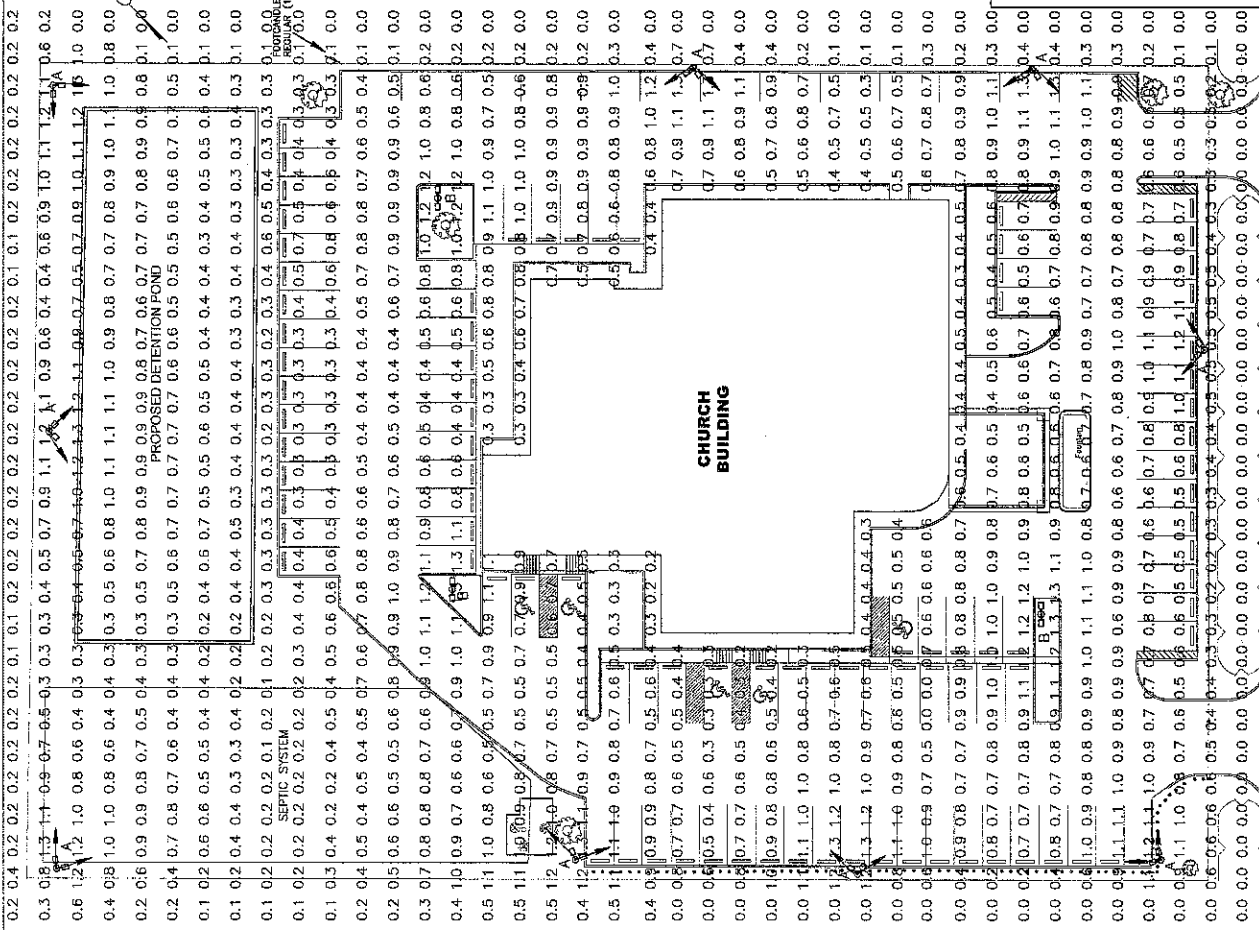

**LUMINAIRE SCHEDULE**

SYMBOL	QTY	LABEL	ARRANGEMENT	LUMENS	DESCRIPTION
61	9	A	FORWARD-THROUGH-DRIP	6192	FFPRV-2-A15-T3-30-0-30° POLE
62	3	B	D180°	6192	FFPRV-2-A15-T3-30-0-30° POLE

LABEL	CALC. TYPE	UNITS	AVG.	MAX.	MIN.
	ILLUMINANCE	FC	0.54	1.3	0.00

**ONE FIXTURE CONFIGURATION SHEET, CONFIGURATION TABLE, WATTAGE, SEPARATE ZONE ZONES USE AS POLE!**

Fixture	Mounting Height (ft)	Beam Spread (ft)	Beam Diameter (ft)	Beam Angle (deg)	Beam Spread (ft)	Beam Diameter (ft)	Beam Angle (deg)	Beam Spread (ft)	Beam Diameter (ft)	Beam Angle (deg)
FFPRV-A15-T3-30-0-30°	10	10	10	30	17.3	17.3	30	17.3	17.3	30
FFPRV-A15-T3-30-0-30°	15	15	15	30	25.9	25.9	30	25.9	25.9	30
FFPRV-A15-T3-30-0-30°	20	20	20	30	34.6	34.6	30	34.6	34.6	30
FFPRV-A15-T3-30-0-30°	25	25	25	30	43.3	43.3	30	43.3	43.3	30
FFPRV-A15-T3-30-0-30°	30	30	30	30	52.0	52.0	30	52.0	52.0	30
FFPRV-A15-T3-30-0-30°	35	35	35	30	60.6	60.6	30	60.6	60.6	30
FFPRV-A15-T3-30-0-30°	40	40	40	30	69.3	69.3	30	69.3	69.3	30
FFPRV-A15-T3-30-0-30°	45	45	45	30	77.9	77.9	30	77.9	77.9	30
FFPRV-A15-T3-30-0-30°	50	50	50	30	86.6	86.6	30	86.6	86.6	30
FFPRV-A15-T3-30-0-30°	55	55	55	30	95.2	95.2	30	95.2	95.2	30
FFPRV-A15-T3-30-0-30°	60	60	60	30	103.9	103.9	30	103.9	103.9	30
FFPRV-A15-T3-30-0-30°	65	65	65	30	112.5	112.5	30	112.5	112.5	30
FFPRV-A15-T3-30-0-30°	70	70	70	30	121.2	121.2	30	121.2	121.2	30
FFPRV-A15-T3-30-0-30°	75	75	75	30	129.8	129.8	30	129.8	129.8	30
FFPRV-A15-T3-30-0-30°	80	80	80	30	138.4	138.4	30	138.4	138.4	30
FFPRV-A15-T3-30-0-30°	85	85	85	30	147.1	147.1	30	147.1	147.1	30
FFPRV-A15-T3-30-0-30°	90	90	90	30	155.7	155.7	30	155.7	155.7	30
FFPRV-A15-T3-30-0-30°	95	95	95	30	164.4	164.4	30	164.4	164.4	30
FFPRV-A15-T3-30-0-30°	100	100	100	30	173.0	173.0	30	173.0	173.0	30
FFPRV-A15-T3-30-0-30°	105	105	105	30	181.6	181.6	30	181.6	181.6	30
FFPRV-A15-T3-30-0-30°	110	110	110	30	190.3	190.3	30	190.3	190.3	30
FFPRV-A15-T3-30-0-30°	115	115	115	30	198.9	198.9	30	198.9	198.9	30
FFPRV-A15-T3-30-0-30°	120	120	120	30	207.5	207.5	30	207.5	207.5	30
FFPRV-A15-T3-30-0-30°	125	125	125	30	216.2	216.2	30	216.2	216.2	30
FFPRV-A15-T3-30-0-30°	130	130	130	30	224.8	224.8	30	224.8	224.8	30
FFPRV-A15-T3-30-0-30°	135	135	135	30	233.4	233.4	30	233.4	233.4	30
FFPRV-A15-T3-30-0-30°	140	140	140	30	242.1	242.1	30	242.1	242.1	30
FFPRV-A15-T3-30-0-30°	145	145	145	30	250.7	250.7	30	250.7	250.7	30
FFPRV-A15-T3-30-0-30°	150	150	150	30	259.3	259.3	30	259.3	259.3	30
FFPRV-A15-T3-30-0-30°	155	155	155	30	268.0	268.0	30	268.0	268.0	30
FFPRV-A15-T3-30-0-30°	160	160	160	30	276.6	276.6	30	276.6	276.6	30
FFPRV-A15-T3-30-0-30°	165	165	165	30	285.2	285.2	30	285.2	285.2	30
FFPRV-A15-T3-30-0-30°	170	170	170	30	293.9	293.9	30	293.9	293.9	30
FFPRV-A15-T3-30-0-30°	175	175	175	30	302.5	302.5	30	302.5	302.5	30
FFPRV-A15-T3-30-0-30°	180	180	180	30	311.1	311.1	30	311.1	311.1	30
FFPRV-A15-T3-30-0-30°	185	185	185	30	319.8	319.8	30	319.8	319.8	30
FFPRV-A15-T3-30-0-30°	190	190	190	30	328.4	328.4	30	328.4	328.4	30
FFPRV-A15-T3-30-0-30°	195	195	195	30	337.0	337.0	30	337.0	337.0	30
FFPRV-A15-T3-30-0-30°	200	200	200	30	345.7	345.7	30	345.7	345.7	30
FFPRV-A15-T3-30-0-30°	205	205	205	30	354.3	354.3	30	354.3	354.3	30
FFPRV-A15-T3-30-0-30°	210	210	210	30	362.9	362.9	30	362.9	362.9	30
FFPRV-A15-T3-30-0-30°	215	215	215	30	371.6	371.6	30	371.6	371.6	30
FFPRV-A15-T3-30-0-30°	220	220	220	30	380.2	380.2	30	380.2	380.2	30
FFPRV-A15-T3-30-0-30°	225	225	225	30	388.8	388.8	30	388.8	388.8	30
FFPRV-A15-T3-30-0-30°	230	230	230	30	397.5	397.5	30	397.5	397.5	30
FFPRV-A15-T3-30-0-30°	235	235	235	30	406.1	406.1	30	406.1	406.1	30
FFPRV-A15-T3-30-0-30°	240	240	240	30	414.7	414.7	30	414.7	414.7	30
FFPRV-A15-T3-30-0-30°	245	245	245	30	423.4	423.4	30	423.4	423.4	30
FFPRV-A15-T3-30-0-30°	250	250	250	30	432.0	432.0	30	432.0	432.0	30
FFPRV-A15-T3-30-0-30°	255	255	255	30	440.6	440.6	30	440.6	440.6	30
FFPRV-A15-T3-30-0-30°	260	260	260	30	449.3	449.3	30	449.3	449.3	30
FFPRV-A15-T3-30-0-30°	265	265	265	30	457.9	457.9	30	457.9	457.9	30
FFPRV-A15-T3-30-0-30°	270	270	270	30	466.5	466.5	30	466.5	466.5	30
FFPRV-A15-T3-30-0-30°	275	275	275	30	475.2	475.2	30	475.2	475.2	30
FFPRV-A15-T3-30-0-30°	280	280	280	30	483.8	483.8	30	483.8	483.8	30
FFPRV-A15-T3-30-0-30°	285	285	285	30	492.4	492.4	30	492.4	492.4	30
FFPRV-A15-T3-30-0-30°	290	290	290	30	501.0	501.0	30	501.0	501.0	30
FFPRV-A15-T3-30-0-30°	295	295	295	30	509.7	509.7	30	509.7	509.7	30
FFPRV-A15-T3-30-0-30°	300	300	300	30	518.3	518.3	30	518.3	518.3	30
FFPRV-A15-T3-30-0-30°	305	305	305	30	526.9	526.9	30	526.9	526.9	30
FFPRV-A15-T3-30-0-30°	310	310	310	30	535.5	535.5	30	535.5	535.5	30
FFPRV-A15-T3-30-0-30°	315	315	315	30	544.2	544.2	30	544.2	544.2	30
FFPRV-A15-T3-30-0-30°	320	320	320	30	552.8	552.8	30	552.8	552.8	30
FFPRV-A15-T3-30-0-30°	325	325	325	30	561.4	561.4	30	561.4	561.4	30
FFPRV-A15-T3-30-0-30°	330	330	330	30	570.0	570.0	30	570.0	570.0	30
FFPRV-A15-T3-30-0-30°	335	335	335	30	578.7	578.7	30	578.7	578.7	30
FFPRV-A15-T3-30-0-30°	340	340	340	30	587.3	587.3	30	587.3	587.3	30
FFPRV-A15-T3-30-0-30°	345	345	345	30	595.9	595.9	30	595.9	595.9	30
FFPRV-A15-T3-30-0-30°	350	350	350	30	604.5	604.5	30	604.5	604.5	30
FFPRV-A15-T3-30-0-30°	355	355	355	30	613.2	613.2	30	613.2	613.2	30
FFPRV-A15-T3-30-0-30°	360	360	360	30	621.8	621.8	30	621.8	621.8	30
FFPRV-A15-T3-30-0-30°	365	365	365	30	630.4	630.4	30	630.4	630.4	30
FFPRV-A15-T3-30-0-30°	370	370	370	30	639.0	639.0	30	639.0	639.0	30
FFPRV-A15-T3-30-0-30°	375	375	375	30	647.7	647.7	30	647.7	647.7	30
FFPRV-A15-T3-30-0-30°	380	380	380	30	656.3	656.3	30	656.3	656.3	30
FFPRV-A15-T3-30-0-30°	385	385	385	30	664.9	664.9	30	664.9	664.9	30
FFPRV-A15-T3-30-0-30°	390	390	390	30	673.5	673.5	30	673.5	673.5	30
FFPRV-A15-T3-30-0-30°	395	395	395	30	682.2	682.2	30	682.2	682.2	30
FFPRV-A15-T3-30-0-30°	400	400	400	30	690.8	690.8	30	690.8	690.8	30
FFPRV-A15-T3-30-0-30°	405	405	405	30	699.4	699.4	30	699.4	699.4	30
FFPRV-A15-T3-30-0-30°	410	410	410	30	708.0	708.0	30	708.0	708.0	30
FFPRV-A15-T3-30-0-30°	415	415	415	30	716.7	716.7	30	716.7	716.7	30
FFPRV-A15-T3-30-0-30°	420	420	420	30	725.3	725.3	30	725.3	725.3	30
FFPRV-A15-T3-30-0-30°	425	425	425	30	733.9	733.9	30	733.9	733.9	30
FFPRV-A15-T3-30-0-30°	430	430	430	30	742.5	742.5	30	742.5	742.5	30
FFPRV-A15-T3-30-0-30°	435	435	435	30	751.2	751.2	30	751.2	751.2	30
FFPRV-A15-T3-30-0-30°	440	440	440	30	759.8	759.8	30	759.8	759.8	30
FFPRV-A15-T3-30-0-30°	445	445	445	30	768.4	768.4	30	768.4	768.4	30
FFPRV-A15-T3-30-0-30°	450	450	450	30	777.0	777.0	30	777.0	777.0	30
FFPRV-A15-T3-30-0-30°	455	455	455	30	785.7	785.7	30	785.7	785.7	30
FFPRV-A15-T3-30-0-30°	460	460	460	30	794.3	794.3	30	794.3	794.3	30
FFPRV-A15-T3-30-0-30°	465	465	465	30	802.9	802.9	30	802.9	802.9	30
FFPRV-A15-T3-30-0-30°	470	470	470	30	811.5	811.5	30	811.5	811.5	30
FFPRV-A15-T3-30-0-30°	475	475	475	30	820.2	820.2	30	820.2	820.2	30
FFPRV-A15										