

NOTICE OF CONFIDENTIALITY RIGHTS: IF YOU ARE A NATURAL PERSON, YOU MAY REMOVE OR STRIKE ANY OR ALL OF THE FOLLOWING INFORMATION FROM ANY INSTRUMENT THAT TRANSFERS AN INTEREST IN REAL PROPERTY BEFORE IT IS FILED FOR RECORD IN THE PUBLIC RECORDS: YOUR SOCIAL SECURITY NUMBER OR YOUR DRIVER'S LICENSE NUMBER.

PUBLIC ROAD RIGHT-OF-WAY DEDICATION

(First Street – 0.101 acres)

STATE OF TEXAS

§

§

COUNTY OF FORT BEND

§

JUAN JOSE GAYTAN GALLEGOS, an individual, whose address is 1811 City Hall Dr., #702, Rosenberg TX 77471, and **LETICIA MARIE GAYTAN**, an individual, whose address is 1811 City Hall Dr., #702, Rosenberg TX 77471 ("Grantors"), in consideration of the sum of Ten Dollars (\$10.00) and other good and valuable consideration, the receipt and sufficiency of which are hereby acknowledged, has GRANTED, BARGAINED, DEDICATED, and CONVEYED and does GRANT, BARGAIN, DEDICATE AND CONVEY to the **COUNTY OF FORT BEND, TEXAS**, a body politic organized under the laws of the State of Texas whose address is 301 Jackson Street, Richmond, Texas 77469 ("Grantee"), the real property in Fort Bend County, Texas, fully described in Exhibit "A" and depicted on Exhibit "B" attached hereto (the "Right-of-Way Tract") for the following purposes:

- (a) the right to survey, construct, maintain, operate, repair, replace and reconstruct a road over the Right-of-Way Tract and appurtenant facilities and improvements;
- (b) the right to bring in or dispose of soil from the Right-of-Way Tract; and
- (c) the right to bring upon the Right-of-Way Tract all machinery and equipment necessary to efficiently prosecute the work.

TO HAVE AND TO HOLD the Right-of-Way Tract, together with all and singular the rights, privileges and appurtenances to it in any way belonging to Grantee, its successors, and its assigns forever, subject to any and all matters affecting the Right-of-Way Tract of record in the Office of the County Clerk of Fort Bend County, Texas.

And Grantor binds itself, its successors, and its assigns to WARRANT AND FOREVER DEFEND all and singular the title to the Right-of-Way Tract to Grantee, its successors and its assigns against any person lawfully claiming or to claim the same or any part of it, by, through or under Grantor, but not otherwise.

If current ad valorem taxes on the Right-of-Way Tract have not been prorated at the time of execution and delivery of this dedication instrument, Grantor and Grantee shall be responsible for the payment of their respective shares thereof based on the period of ownership.

EXECUTED this 25th day of October, 20 16.

GRANTOR:

JUAN JOSE GAYTAN GALLEGOS,
an individual

By: 
Juan Jose Gaytan Gallegos

THE STATE OF TEXAS §
 §
COUNTY OF Fort Bend §

Before me on this day, personally appeared **JUAN JOSE GAYTAN GALLEGOS**, an individual, proved to me to be the person whose name is subscribed to the foregoing instrument and acknowledged to me that she executed the instrument for the purposes and consideration expressed therein, by proper authority, and in the capacity stated in the instrument.

Given under my hand and seal of office this 25th day of October, 20 16.

Notary Public in and for the State of Texas



EXECUTED this 25th day of October, 20 16.

GRANTOR:

LETICIA MARIE GAYTAN,
an individual

By: *Leticia Marie Gaytan*
Leticia Marie Gaytan

THE STATE OF TEXAS §
 §
COUNTY OF Int Bend §

Before me on this day, personally appeared **LETICIA MARIE GAYTAN**, an individual, proved to me to be the person whose name is subscribed to the foregoing instrument and acknowledged to me that she executed the instrument for the purposes and consideration expressed therein, by proper authority, and in the capacity stated in the instrument.

Given under my hand and seal of office this 25th day of October, 20 16.

Monica Harris
Notary Public in and for the State of Texas

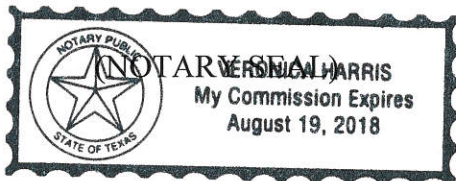

AGREED AND ACCEPTED as of the ____ day of _____, 20____.

GRANTEE:

FORT BEND COUNTY, TEXAS,
a body politic organized under the laws of the State
of Texas

By: _____
Robert E. Hebert, Fort Bend County Judge

THE STATE OF TEXAS §
 §
COUNTY OF FORT BEND §

This instrument was acknowledged before me on the ____ day of _____,
20____, by Robert E. Hebert, County Judge of Fort Bend County, Texas, a body politic
organized under the laws of the State of Texas, for and on behalf of such body politic.

Notary Public in and for the State of Texas

(NOTARY SEAL)

After recording return to:
Fort Bend County- Kendleton USDA 1st Street
c/o Johnson Petrov LLP
2929 Allen Parkway, Suite 3150
Houston, Texas 77019
Attention: Martye Kendrick

Attachments:
Exhibit "A"- Legal Description of the Right-of-Way Tract
Exhibit "B"- Survey of the Right-of-Way Tract

Exhibit "A"
Legal Description of the Right-of-Way Tract
EXHIBIT

PARCEL 3:

A TRACT OR PARCEL CONTAINING 0.101 ACRES (4,409 SQ. FT.) OF LAND, SITUATED IN THE ISAAC MCGARY LEAGUE, ABSTRACT NO. 58, FORT BEND COUNTY, TEXAS, SAID 0.101 ACRE TRACT BEING OUT OF AND A PORTION OF A CALLED 0.673 ACRE TRACT, CONVEYED TO FAYE FISHER ACCORDING TO FORT BEND COUNTY APPRAISAL DISTRICT NUMBER (F.B.C.A.D NO.) 0058-04-850-0000-908, SAID 0.101 ACRES BEING MORE PARTICULARLY DESCRIBED BY METES AND BOUNDS AS FOLLOWS; ALL BEARINGS ARE BASED ON TEXAS STATE COORDINATE SYSTEM, SOUTH CENTRAL ZONE, NAD88:

COMMENCING AT A 5/8 INCH IRON ROD SET MARKING THE MOST WESTERLY END OF A CUTBACK LINE OF THE INTERSECTION OF THE NORTHEAST RIGHT-OF-WAY LINE OF F.M. 2919 (100 FEET IN WIDTH) AND THE NORTHWEST RIGHT-OF-WAY LINE OF BRAXTON ROAD (70 FEET IN WIDTH BASED ON TXDOT RIGHT-OF-WAY MAP), SAME BEING THE MOST WESTERLY SOUTHWEST CORNER OF A CALLED 2.000 ACRE TRACT CONVEYED TO THE CITY OF KENDLETON AS DESCRIBED IN A DEED RECORDED IN F.B.C.C.F. NO. 9865229;

THENCE, NORTH 32 DEGREES 14 MINUTES 59 SECONDS WEST, ALONG THE NORTHEAST RIGHT-OF-WAY LINE OF SAID F.M. 2919, A DISTANCE OF 12.82 FEET TO A 5/8 INCH IRON PIPE SET MARKING THE BEGINNING OF A TANGENT CURVE TO THE LEFT;

THENCE, CONTINUING ALONG THE NORTHEAST RIGHT-OF-WAY LINE OF SAID F.M. 2919 IN A NORTHWESTERLY DIRECTION OF SAID CURVE TO THE LEFT, A DISTANCE OF 349.63 FEET HAVING A RADIUS OF 2914.93 FEET, SUBTENDING A CENTRAL ANGLE OF 06 DEGREES 52 MINUTES 20 SECONDS WITH A CHORD BEARING AND DISTANCE OF NORTH 35 DEGREES 48 MINUTES 43 SECONDS WEST, 349.42 FEET TO A 5/8 INCH IRON ROD SET MARKING THE NORTHWEST CORNER OF A CALLED 2.000 ACRE TRACT CONVEYED TO THE CITY OF KENDLETON AS DESCRIBED IN A DEED RECORDED IN F.B.C.C.F. NO. 9865229;

THENCE, NORTH 53 DEGREES 42 MINUTES 31 SECONDS EAST, DEPARTING THE NORTHEASTERLY RIGHT-OF-WAY LINE OF SAID F.M. 2919, AT 184.46 FEET PASSING THE COMMON NORTHEAST CORNER OF A CALLED 2.000 ACRE TRACT AND THE NORTHWEST CORNER OF A CALLED 2.000 ACRE TRACT CONVEYED TO CLEVELAND ROY PETITT AS DESCRIBED IN A DEED RECORDED IN F.B.C.C.F. NO. 2008055106, AT 405.80 FEET PASSING THE NORTHEAST CORNER OF SAID CLEVELAND ROY PETITT TRACT AND CONTINUING IN ALL A TOTAL DISTANCE OF 1078.01 FEET TO A 5/8 INCH IRON ROD SET FOR THE BEGINNING OF A CURVE TO THE LEFT;

THENCE, IN A NORTHEASTERLY DIRECTION ALONG A CURVE TO THE LEFT, A DISTANCE OF 222.17 FEET HAVING A RADIUS OF 1235.00 FEET, SUBTENDING A CENTRAL ANGLE OF 10 DEGREES 18 MINUTES 26 SECONDS WITH A CHORD BEARING AND DISTANCE OF NORTH 48 DEGREES 33 MINUTES 17 SECONDS EAST, 221.87 FEET TO A 5/8 INCH IRON ROD SET MARKING THE END OF SAID CURVE AND FOR A POINT OF TANGENCY;

THENCE, NORTH 43 DEGREES 24 MINUTES 04 SECONDS EAST, A DISTANCE OF 129.39 FEET TO A 5/8 INCH IRON ROD SET MARKING THE BEGINNING POINT OF A TANGENT CURVE TO THE RIGHT;

THENCE, IN A NORTHEASTERLY DIRECTION ALONG A CURVE TO THE RIGHT, A DISTANCE OF 70.94 FEET HAVING A RADIUS OF 1165.00 FEET, SUBTENDING A CENTRAL ANGLE OF 03 DEGREES 29 MINUTES 20 SECONDS WITH A CHORD BEARING AND DISTANCE OF NORTH 45 DEGREES 08 MINUTES 44 SECONDS EAST, 70.93 FEET TO A 5/8

INCH IRON ROD SET ON THE SOUTHWESTERLY LINE OF A CALLED 1.85 ACRE TRACT CONVEYED TO CARLYLE KING ACCORDING TO F.B.C.A.D. NO. 0058-02-590-000-908;

THENCE, NORTH 34 DEGREES 03 MINUTES 42 SECONDS WEST, ALONG THE SOUTHWESTERLY LINE OF SAID CALLED 1.85 ACRE TRACT, A DISTANCE OF 31.23 FEET TO A 5/8 INCH IRON ROD SET ON THE SOUTH LINE OF AFORESAID 0.179 ACRE TRACT MARKING THE NORTHWEST CORNER OF SAID CALLED 1.85 ACRE TRACT;

THENCE, NORTH 53 DEGREES 11 MINUTES 23 SECONDS EAST, ALONG THE SOUTH LINE OF SAID 0.179 ACRE TRACT, A DISTANCE OF 5.78 FEET TO A 5/8 INCH IRON ROD SET MARKING THE COMMON SOUTH CORNER OF SAID 0.179 ACRE TRACT AND A CALLED 0.673 ACRE TRACT CONVEYED TO FAYE FISHER ACCORDING THE F.B.C.A.D. NO. 0058-04-850-0000-908, SAME BEING THE SOUTH CORNER AND **POINT OF BEGINNING** OF THE HEREIN DESCRIBED TRACT;

THENCE, NORTH 34 DEGREES 45 MINUTES 47 SECONDS WEST, ALONG THE COMMON NORTHEASTERLY LINE OF SAID CALLED 0.179 ACRE TRACT AND THE SOUTHWESTERLY LINE OF SAID CALLED 0.673 ACRE TRACT, A DISTANCE 40.10 FEET TO A 5/8 INCH IRON ROD SET ON SAID COMMON LINE AND THE BEGINNING POINT OF A NON-TANGENT CURVE TO THE RIGHT MARKING THE WEST CORNER OF THE HEREIN DESCRIBED TRACT;

THENCE, IN A NORTHEASTERLY DIRECTION ALONG A CURVE TO THE RIGHT, DEPARTING SAID COMMON LINE AND THROUGH AND ACROSS SAID CALLED 0.673 ACRE TRACT, A DISTANCE OF 101.53 FEET HAVING A RADIUS OF 1235.00 FEET, SUBTENDING A CENTRAL ANGLE OF 04 DEGREES 42 MINUTES 37 SECONDS WITH A CHORD BEARING AND DISTANCE OF NORTH 50 DEGREES 00 MINUTES 35 SECONDS EAST, 101.50 FEET TO A 5/8 INCH IRON ROD SET ON THE COMMON NORTHEASTERLY LINE OF SAID CALLED 0.673 ACRE TRACT AND THE SOUTHWESTERLY LINE OF A CALLED 0.147 ACRE TRACT CONVEYED TO JAMES HARRIS ACCORDING TO F.B.C.A.D. NO. 0058-03-100-0000-908 MARKING THE NORTH CORNER OF THE HEREIN DESCRIBED TRACT;

THENCE, SOUTH 34 DEGREES 45 MINUTES 47 SECONDS WEST, ALONG THE COMMON LINE OF SAID TRACTS OF LAND, A DISTANCE OF 45.74 FEET TO A 5/8 INCH IRON ROD SET ON THE NORTHWESTERLY LINE OF SAID CALLED 1.85 ACRE TRACT MARKING THE SOUTH CORNER OF SAID CALLED 0.147 ACRE TRACT, SAME BEING THE COMMON EAST CORNER OF SAID 0.673 ACRE TRACT AND OF THE HEREIN DESCRIBED TRACT;

THENCE, SOUTH 53 DEGREES 11 MINUTES 23 SECONDS WEST, ALONG THE COMMON SOUTHEASTERLY LINE OF SAID CALLED 0.673 ACRE TRACT AND THE NORTHWESTERLY LINE OF SAID CALLED 1.85 ACRE TRACT, A DISTANCE OF 101.15 FEET TO THE **POINT OF BEGINNING** OF HEREIN DESCRIBED TRACT AND CONTAINING 0.101 ACRES OR 4,409 SQUARE FEET OF LAND.

10/30/15
GEORG R. LARDIZABAL, RPLS 6051
GGC SURVEY, PLLC, FIRM NO. 10146000
TEL. 832-729-7256
4419 ZIMMERLY COURT
SUGAR LAND, TX 77479

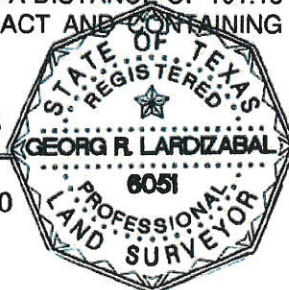

Exhibit "B"

Survey of the Right-of-Way Tract

