



Fort Bend County Engineering  
FORT BEND COUNTY, TEXAS

Richard W. Stolleis, P.E.  
County Engineer

May 16, 2016

Commissioner W. A. "Andy" Meyers  
Fort Bend County Precinct 3  
22333 Grand Corner Drive  
Katy, Texas 77494

**RE: Mobility Project 748, FM 1093/ Westpark Toll Road Expansion Project  
Approval of Temporary Road Closure of: Canal Road, Katy Gaston Road (Phase 3-  
road), Cinco Terrace Drive, Spring Green Blvd., and Katy Gaston Road (Phase 2-bridge)**

Dear Commissioner:

Fort Bend County Engineering is requesting approval for a temporary road closure of Canal Road, Katy Gaston Road (Phase 3-road), Cinco Terrace Drive, Spring Green Blvd. and Katy Gaston Road (Phase 2-bridge), within the FM1093/Westpark Toll Road Expansion Project during construction. The closure date is May 25th, 2016 and intermittent closures from now to the end of the project. Maps depicting the area, and detour routes are attached.

If this meets your approval, we will place it on the May 24th agenda.

Sincerely,

*Rick J. Staigle, PE, PTOE*

Rick J. Staigle, PE, PTOE  
First Assistant County Engineer

RJS/mjs

Attachment: Maps

cc: Mr. Mike Stone, PMP, PSP, Mike Stone Associates, Inc., [MikeStone@mikestoneassociates.com](mailto:MikeStone@mikestoneassociates.com)  
Mr. Michael Kaspar, P.E., Dannenbaum Engineering Corp., [Michael.Kaspar@dannenbaum.com](mailto:Michael.Kaspar@dannenbaum.com)  
File

**LEGEND**  
  
 AREA OF WORK  
 DIRECTION OF TRAFFIC FLOW  
 SIGN  
 TYPE III BARRICADE

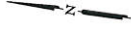

**NOTES:**  
 1. DURING PHASE 1B DETOUR CANAL RD TRAFFIC IN ORDER TO CONSTRUCT INTERSECTION WITH BELLA TERRA PKWY.  
 2. THIS DETOUR ONLY TO BE USED DURING WEEKENDS, FRIDAY NIGHT 10:00 PM TO MONDAY MORNING 5:00 AM.

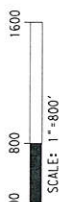

REV	DATE	BY	DESCRIPTION
<b>FM 1093 WESTPARK EXTENSION</b> <b>TRAFFIC CONTROL PLAN</b> <b>PHASE 1A</b> <b>CANAL RD DETOUR</b>			
DESIGNED BY: IS	DRAWN BY: NL	CHECKED BY: RME	SHEET NO. 1 OF 1
COUNTY: FORT BEND	SEC: 03	JOB: 1042	HWY NO.: FM 1093
DATE: 8/19/2015			

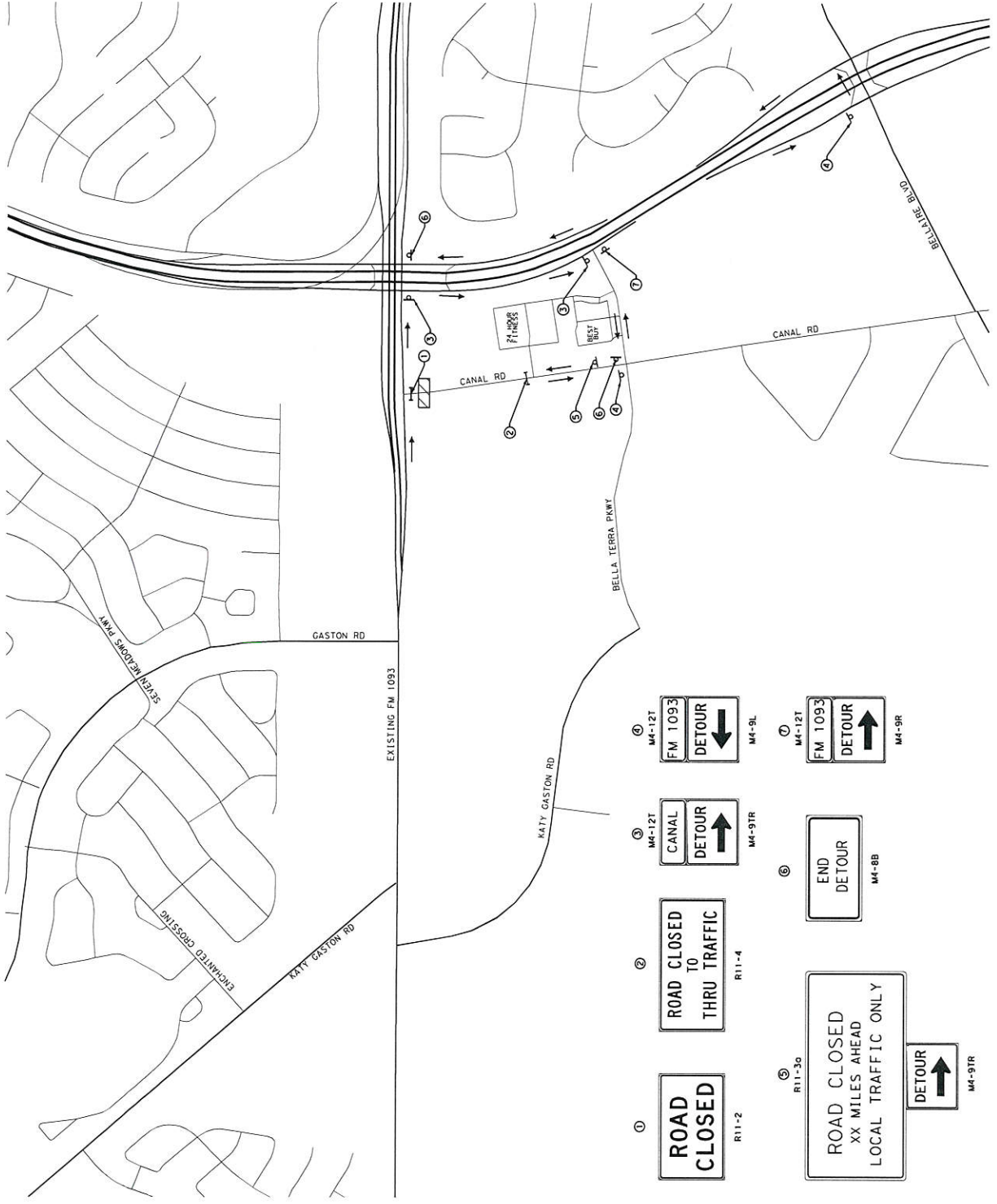

 R11-2	 R11-30	 R11-4	 M4-12T	 M4-9L	 M4-9R
 M4-9TR	 M4-8B	 M4-9TR			

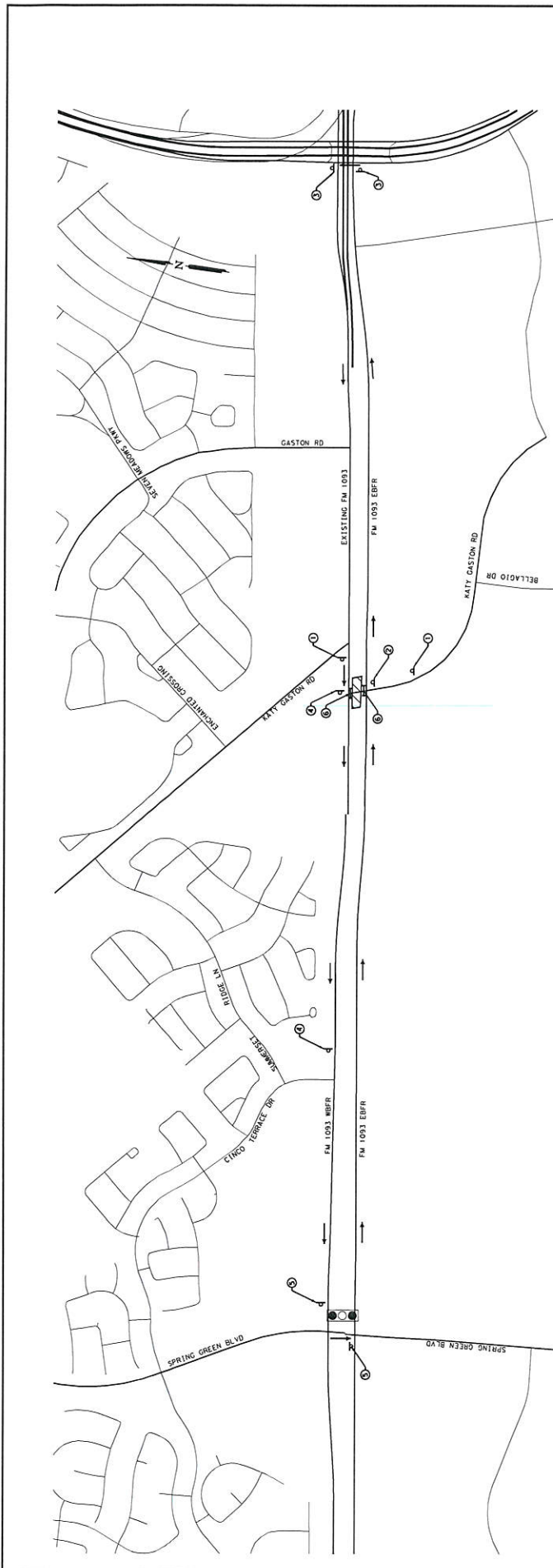

- LEGEND**
- ▭ AREA OF WORK
  - DIRECTION OF TRAFFIC FLOW
  - ⊥ STOP
  - TYPE III BARRICADE
- NOTES:**
1. DURING PHASE 3 DETOUR KATY GASTON RD TRAFFIC IN BOTH DIRECTIONS TO BE STOPPED DURING WEEKENDS.
  2. THIS DETOUR IS TO BE IN EFFECT DURING WEEKENDS, FRIDAY NIGHT 10:00 PM TO MONDAY MORNING 5:00 AM.

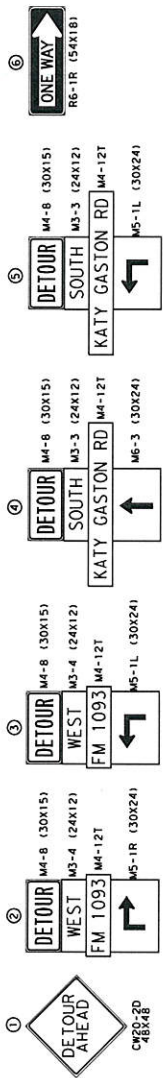

REV	DATE	BY	DESCRIPTION

Matthew J. Lister  
Professional Engineer  
License No. 01553  
State of Texas

Texas Department of Transportation

8/31/2015

**klotz associates**  
Texas PE Firm Reg. # F-929

**FM 1093 WESTPARK EXTENSION**  
**TRAFFIC CONTROL PLAN**  
**KATY GASTON RD DETOUR**

SHEET 1 OF 1

DESIGNED BY: JS	DRAWN BY: NL
CHECKED BY: RME	CHECKED BY: RME
COUNTY: TARRANT	SEC: 03
JOB: 11258	HWY NO.: 03
DATE: 8/19/2015	SHEET NO.: 0086





**LEGEND**  
 [Hatched Box] AREA OF WORK  
 [Arrow] DIRECTION OF TRAFFIC FLOW  
 [Symbol] SLOPE  
 [Symbol] TYPE III BARRICADE

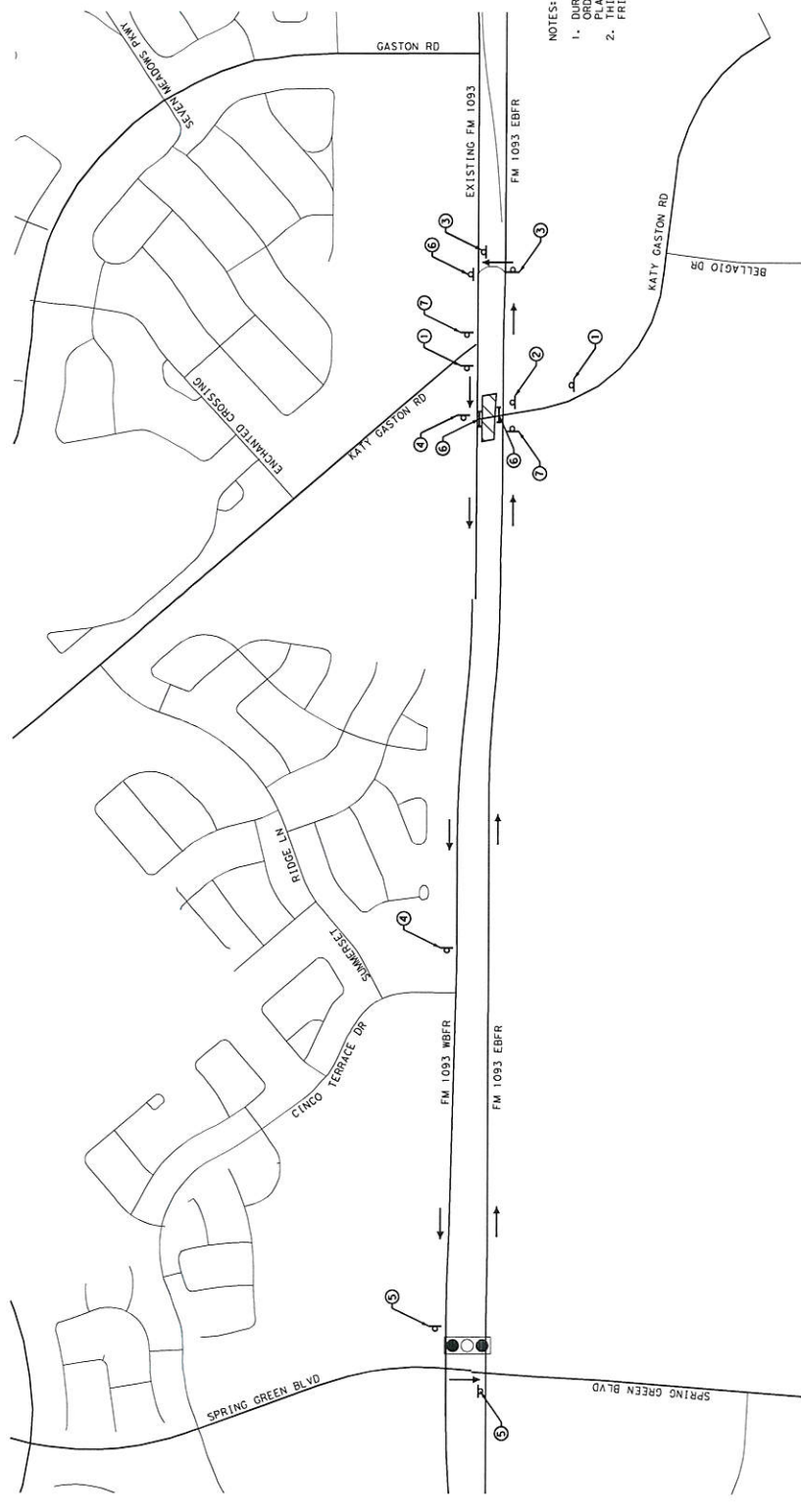

**NOTES:**  
 1. DURING PHASE 2 DETOUR KATY GASTON RD TRAFFIC IN BOTH DIRECTIONS WILL BE PLACED ON THE BRIDGE. THIS DETOUR ONLY TO BE USED DURING WEEKENDS.  
 2. FRIDAY NIGHT 10:00 PM TO MONDAY MORNING 5:00 AM.



REV	DATE	BY	DESCRIPTION



B/31/2015  
 Texas Department of Transportation

**kiotz associates**  
 Texas PE Firm Reg. # F-929

**FM 1093 WESTPARK EXTENSION  
 TRAFFIC CONTROL PLAN  
 PHASE 2  
 BRIDGE DETOUR**

SHEET 1 OF 1

DESIGNED BY: IS	DRAWN BY: NL	CHECKED BY: RME
COUNTY: TARRANT	SEC: 03	JOB: FHW 1093
FORT BEND 1238	03	042 FM 1093
		1089

