

REVIEW BY FORT BEND COUNTY COMMISSIONERS COURT

On this 24th day of May, 2016, Commissioners Court came on to be heard and reviewed the accompanying notice of DVL Enterprises, LLC
Job Location Sienna Parkway at Waters Lake Blvd, Missouri City, Tx, TX 77447
Date 5/12/2016 Bond No. HICSW-10-A218-0013, Permit No. 2016-7077 to make use of certain Fort Bend County property subject to, "A Revised Order Regulating the Laying, Construction, Maintenance, and Repair of Buried Cables, Conduits, and Pole Lines, In, Under, Across or Along Roads, Streets, Highways, and Drainage Ditches in Fort Bend County, Texas, Under the Jurisdiction of the Commissioners Court of Fort Bend County, Texas," as passed by the Commissioners Court of Fort Bend County, Texas the 3rd day of August, 1987, recorded in Volume _____ of the Minutes of the Commissioners Court of Fort Bend County, Texas, to the extent that such order is not inconsistent with Article 1436a, Vernon's Texas Civil Statutes. Upon Motion of Commissioner _____, seconded by Commissioner _____, duly put and carried, it is ORDERED, ADJUDGED AND DECREED that said notice of said above purpose is hereby acknowledged by the Commissioners Court of Fort Bend County, Texas, and that said notice be placed on record according to the regulation order thereof.

Notes:

1. Evidence of review by the Commissioners Court must be kept on the job site and failure to do so constitutes grounds for job shutdown.
2. Written notices are required:
 - a. 48 hours in advance of construction start up, and
 - b. when construction is completed and ready for final inspectionMail notices to: Permit Administrator
Fort Bend County Engineering
301 Jackson Street
Richmond, Texas 77469
281-633-7500
3. This permit expires one (1) year from date of permit if construction has not commenced.

By: 
County Engineer

Presented to Commissioners Court and approved.
Recorded in Volume _____

By: N/A
Drainage District Engineer/Manager

Minutes of Commissioners Court

Clerk of Commissioners Court

By: _____
Deputy

PERFORMANCE BOND

BOND NO. HICSW-10-A218-0013

STATE OF TEXAS

Contract Date April 19, 2016

COUNTY OF FORT BEND

Date Bond Executed April 19, 2016

PRINCIPAL DVL Enterprises, L.L.C.

SURETY Hudson Insurance Company

OWNER Sienna Plantation Municipal Utility District No. 5

PENAL SUM OF BOND (in words and figures) one hundred twenty-two thousand, four hundred sixty and 00/100th Dollars (\$122,460.00), being 100 percent of the Contract Price.

CONTRACT for Sienna Parkway Northbound Left Turn Lane at Waters Lake Boulevard for Sienna Plantation Municipal Utility District No. 5, Fort Bend County, Texas (the "Contract").

KNOW ALL PERSONS BY THESE PRESENTS, that we, Principal and Surety above named, are held and firmly bound unto Owner, its successors and assigns, in the penal sum of the amount stated above, for the payment of which sum well and truly to be made, we bind ourselves and our respective heirs, executors, administrators, officers, directors, shareholders, partners, successors, and assigns, jointly and severally, firmly by these presents.

WHEREAS, Principal entered into that certain Contract with Owner, dated the same date as this bond, which Contract is expressly incorporated herein for all purposes.

NOW, THEREFORE, THE CONDITIONS OF THIS OBLIGATION IS SUCH, that if Principal well and truly performs the work in accordance with the plans, specifications and any other contract documents, during the original term of the Contract and any extensions thereof that may be granted by Owner, with or without notice to Surety, and during the life of any guaranty or warranty required under the Contract, then this obligation is void; otherwise it is to remain in full force and effect. Should the Principal fail to faithfully and strictly perform the work as required by the Contract in all its terms, the Surety will be liable for all damages, losses, expenses and liabilities that the Owner may suffer in consequence thereof.

This bond is given in compliance with the provisions of Chapter 2253 of the Texas Government Code, as amended, which is incorporated herein by this reference. However, all of the express provisions contained herein and in the Contract are applicable whether or not within the scope of said statute.

Surety hereby agrees, for value received, that no change, extension of time, alteration or addition to the terms of the Contract or to work performed under the Contract, or to the plans, specifications or drawings accompanying the Contract, will in any way affect its obligations on this bond and it does hereby waive notice of any such change, extension of time, alteration or addition to the terms of the Contract or to the work to be performed thereunder.

The bound parties have executed this instrument pursuant to authority of their respective governing body, to be effective on the same date of the Contract.

DVL Enterprises, L.L.C.
PRINCIPAL
By [Signature]
Name Daniel Lee
Title owner
Address 4022 Cedar Forest
Kingwood, Texas 77339

ATTEST
By [Signature]
Name Daniel Guzman
Title Assistant

(SEAL)

Hudson Insurance Company
SURETY
By [Signature]
Name Michele Bonnin
Title Attorney-In-Fact

ATTEST
By [Signature]
Name Erica Anne Cox
Title Account Manager

(SEAL)

Physical Address:
100 William Street, 5th Floor
New York, New York 10038
Mailing Address:
100 William Street, 5th Floor
New York, New York 10038
Telephone: (212) 978-2800

Local Recording Agent Personal Identification Number:
1220468

Surety must attach its original Power of Attorney to this bond.

CERTIFICATE AS TO CORPORATE PRINCIPAL

I, _____, certify that I am the secretary of the corporation named as Principal in the Bond; that _____, who signed the bond on behalf of Principal, was then _____ of the corporation; that I know his or her signature, and his or her signature is genuine; and that the Bond was duly signed for and on behalf of the corporation by authority of its governing body.

_____ (Corporate Seal)



POWER OF ATTORNEY

KNOW ALL MEN BY THESE PRESENTS: That HUDSON INSURANCE COMPANY, a corporation of the State of Delaware, with offices at 100 William Street, New York, New York, 10038, has made, constituted and appointed, and by these presents, does make, constitute and appoint

Erica Anne Cox, Jillian McKenzie, Michele Bonnin, Shelly Bolender of the State of Texas

its true and lawful Attorney(s)-in-Fact, at New York, New York, each of them alone to have full power to act without the other or others, to make, execute and deliver on its behalf, as Surety, bonds and undertakings given for any and all purposes, also to execute and deliver on its behalf as aforesaid renewals, extensions, agreements, waivers, consents or stipulations relating to such bonds or undertakings provided, however, that no single bond or undertaking shall obligate said Company for any portion of the penal sum thereof in excess of the sum of Ten Million Dollars (\$10,000,000.00).

Such bonds and undertakings when duly executed by said Attorney(s)-in-Fact, shall be binding upon said Company as fully and to the same extent as if signed by the President of said Company under its corporate seal attested by its Secretary.

In Witness Whereof, HUDSON INSURANCE COMPANY has caused these presents to be of its Executive Vice President thereunto duly signed, on this 20th day of November, 2014 at New York, New York.



Attest: [Signature] Dina Daskalakis Corporate Secretary

HUDSON INSURANCE COMPANY

By: [Signature] Christopher T. Suarez Executive Vice President

STATE OF NEW YORK COUNTY OF NEW YORK SS.

On the 20th day of November, 2014 before me personally came Christopher T. Suarez to me known, who being by me duly sworn did depose and say that he is an Executive Vice President of HUDSON INSURANCE COMPANY, the Corporation described herein and which executed the above instrument, that he knows the seal of said Corporation, that the seal affixed to said instrument is such corporate seal, that it was so affixed by order of the Board of Directors of said Corporation, and that he attests to his name thereto by like order.

(Notarial Seal)

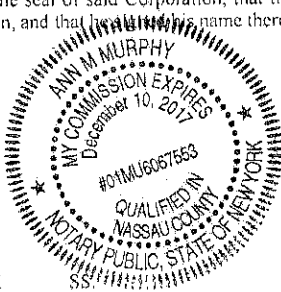

[Signature] ANN M. MURPHY Notary Public, State of New York No. 01MU6067553 Qualified in Nassau County Commission Expires December 10, 2017

CERTIFICATION

STATE OF NEW YORK COUNTY OF NEW YORK

The undersigned Dina Daskalakis hereby certifies:

That the original resolution, of which the following is a true and correct copy, was duly adopted by unanimous written consent of the Board of Directors of Hudson Insurance Company dated July 27th, 2007, and has not since been revoked, amended or modified:

"RESOLVED, that the President, the Executive Vice Presidents, the Senior Vice Presidents and the Vice Presidents shall have the authority and discretion, to appoint such agent or agents, or attorney or attorneys-in-fact, for the purpose of carrying on this Company's surety business, and to empower such agent or agents, or attorney or attorneys-in-fact, to execute and deliver, under this Company's seal or otherwise, bonds obligations, and recognizances, whether made by this Company as surety thereon or otherwise, indemnity contracts, contracts and certificates, and any and all other contracts and undertakings made in the course of this Company's surety business, and renewals, extensions, agreements, waivers, consents or stipulations regarding undertakings so made; and

FURTHER RESOLVED, that the signature of any such Officer of the Company and the Company's seal may be affixed by facsimile to any power of attorney or certification given for the execution of any bond, undertaking, recognizance, contract of indemnity or other written obligation in the nature thereof or related thereto, such signature and seal when so used whether heretofore or hereafter, being hereby adopted by the Company as the original signature of such officer and the original seal of the Company, to be valid and binding upon the Company with the same force and effect as though manually affixed."

THAT the above and foregoing is a full, true and correct copy of Power of Attorney issued by said Company, and of the whole of the original and that the said Power of Attorney is still in full force and effect and has not been revoked, and furthermore that the Resolution of the Board of Directors, set forth in the said Power of Attorney is now in force.

Witness the hand of the undersigned and the seal of said Corporation this ___ day of ___, 20__



[Signature] Dina Daskalakis, Corporate Secretary

CONSTRUCTION PLANS FOR SIENNA PARKWAY NORTHBOUND LEFT TURN LANE AT WATERS LAKE BOULEVARD TO SERVE SIENNA PLANTATION MUNICIPAL UTILITY DISTRICT NO.5 CITY OF MISSOURI CITY, FORT BEND COUNTY, TEXAS

JOB NO. 1415-1550 DATE: DECEMBER 2015
 SP MUD NO.5 TCEQ PWS ID # 0790490

NOTES

1. THESE PLANS WERE PREPARED BY A REGISTERED PROFESSIONAL ENGINEER IN ACCORDANCE WITH THE TEXAS PROFESSIONAL ENGINEERING ACT AND THE TEXAS PROFESSIONAL ENGINEERING BOARD RULES AND REGULATIONS AND APPLICABLE AND CURRENTLY APPLICABLE CODES AND ORDINANCES.
2. CONTRACTOR SHALL VERIFY THE EXISTING AND PROPOSED CONDITIONS AND LOCATIONS OF ALL UTILITIES AND STRUCTURES TO BE MAINTAINED OR REMOVED.
3. CONTRACTOR SHALL VERIFY THE EXISTING AND PROPOSED CONDITIONS AND LOCATIONS OF ALL UTILITIES AND STRUCTURES TO BE MAINTAINED OR REMOVED.
4. CONTRACTOR SHALL VERIFY THE EXISTING AND PROPOSED CONDITIONS AND LOCATIONS OF ALL UTILITIES AND STRUCTURES TO BE MAINTAINED OR REMOVED.
5. CONTRACTOR SHALL VERIFY THE EXISTING AND PROPOSED CONDITIONS AND LOCATIONS OF ALL UTILITIES AND STRUCTURES TO BE MAINTAINED OR REMOVED.
6. CONTRACTOR SHALL VERIFY THE EXISTING AND PROPOSED CONDITIONS AND LOCATIONS OF ALL UTILITIES AND STRUCTURES TO BE MAINTAINED OR REMOVED.
7. CONTRACTOR SHALL VERIFY THE EXISTING AND PROPOSED CONDITIONS AND LOCATIONS OF ALL UTILITIES AND STRUCTURES TO BE MAINTAINED OR REMOVED.
8. CONTRACTOR SHALL VERIFY THE EXISTING AND PROPOSED CONDITIONS AND LOCATIONS OF ALL UTILITIES AND STRUCTURES TO BE MAINTAINED OR REMOVED.
9. CONTRACTOR SHALL VERIFY THE EXISTING AND PROPOSED CONDITIONS AND LOCATIONS OF ALL UTILITIES AND STRUCTURES TO BE MAINTAINED OR REMOVED.
10. CONTRACTOR SHALL VERIFY THE EXISTING AND PROPOSED CONDITIONS AND LOCATIONS OF ALL UTILITIES AND STRUCTURES TO BE MAINTAINED OR REMOVED.
11. CONTRACTOR SHALL VERIFY THE EXISTING AND PROPOSED CONDITIONS AND LOCATIONS OF ALL UTILITIES AND STRUCTURES TO BE MAINTAINED OR REMOVED.
12. CONTRACTOR SHALL VERIFY THE EXISTING AND PROPOSED CONDITIONS AND LOCATIONS OF ALL UTILITIES AND STRUCTURES TO BE MAINTAINED OR REMOVED.
13. CONTRACTOR SHALL VERIFY THE EXISTING AND PROPOSED CONDITIONS AND LOCATIONS OF ALL UTILITIES AND STRUCTURES TO BE MAINTAINED OR REMOVED.
14. CONTRACTOR SHALL VERIFY THE EXISTING AND PROPOSED CONDITIONS AND LOCATIONS OF ALL UTILITIES AND STRUCTURES TO BE MAINTAINED OR REMOVED.
15. CONTRACTOR SHALL VERIFY THE EXISTING AND PROPOSED CONDITIONS AND LOCATIONS OF ALL UTILITIES AND STRUCTURES TO BE MAINTAINED OR REMOVED.

- SHEET INDEX**
1. COVER SHEET
 2. GENERAL CONSTRUCTION NOTES 1-WC-1-15
 3. GENERAL CONSTRUCTION NOTES 1-WC-2-15
 4. PROPOSED PAVEMENT IMPROVEMENTS
 5. PROPOSED WORKING AND POLLUTION PREVENTION LAYOUT
 6. TEMPORARY TRAFFIC CONTROL PLAN
 7. TRAFFIC SIGNAL, INTERSECTIONS, AND/OR
 8. CONCRETE PAVEMENT CONSTRUCTION DETAILS - WC-1-15
 9. SEWERAL CURB CONSTRUCTION DETAILS - WC-1-15
 10. ASPHALT PAVEMENT CONSTRUCTION DETAILS - WC-1-15
 11. SAND/AGGREGATE CONSTRUCTION DETAILS - WC-2-15
 12. SOIL CONSTRUCTION DETAILS - WC-2-15
 13. TROOP RECREATION FACILITIES DETAILS

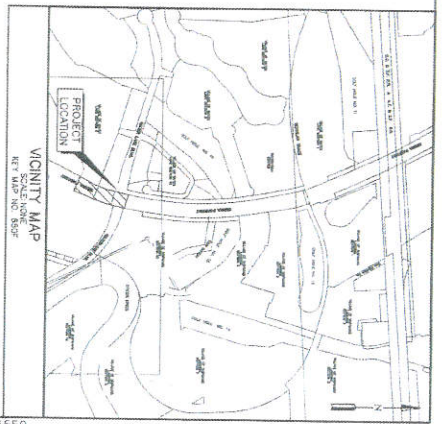

PAVE RECORD DRAWING

THESE PLANS SHOW THE PAVED RECORD DRAWING FOR THE PROJECT. THE CONTRACTOR SHALL VERIFY THE EXISTING AND PROPOSED CONDITIONS AND LOCATIONS OF ALL UTILITIES AND STRUCTURES TO BE MAINTAINED OR REMOVED.

DATE: 12/21/15

BY: [Signature]

APPROVED FOR CONSTRUCTION
 BY: _____ DATE: _____



LJA ENGINEERING, INC.
 2829 Briarpark Drive
 Suite 600
 Houston, Texas 77042-3703
 Phone: 713.953.5206
 Fax: 713.953.5026
 FRN-F-1386



MISSOURI CITY
 DEPARTMENT OF PUBLIC WORKS

APPROVED FOR CONSTRUCTION
 BY: [Signature]
 DATE: 12/21/15

BID SET

Missouri State Board of Engineers and Surveyors License No. 1415-1550

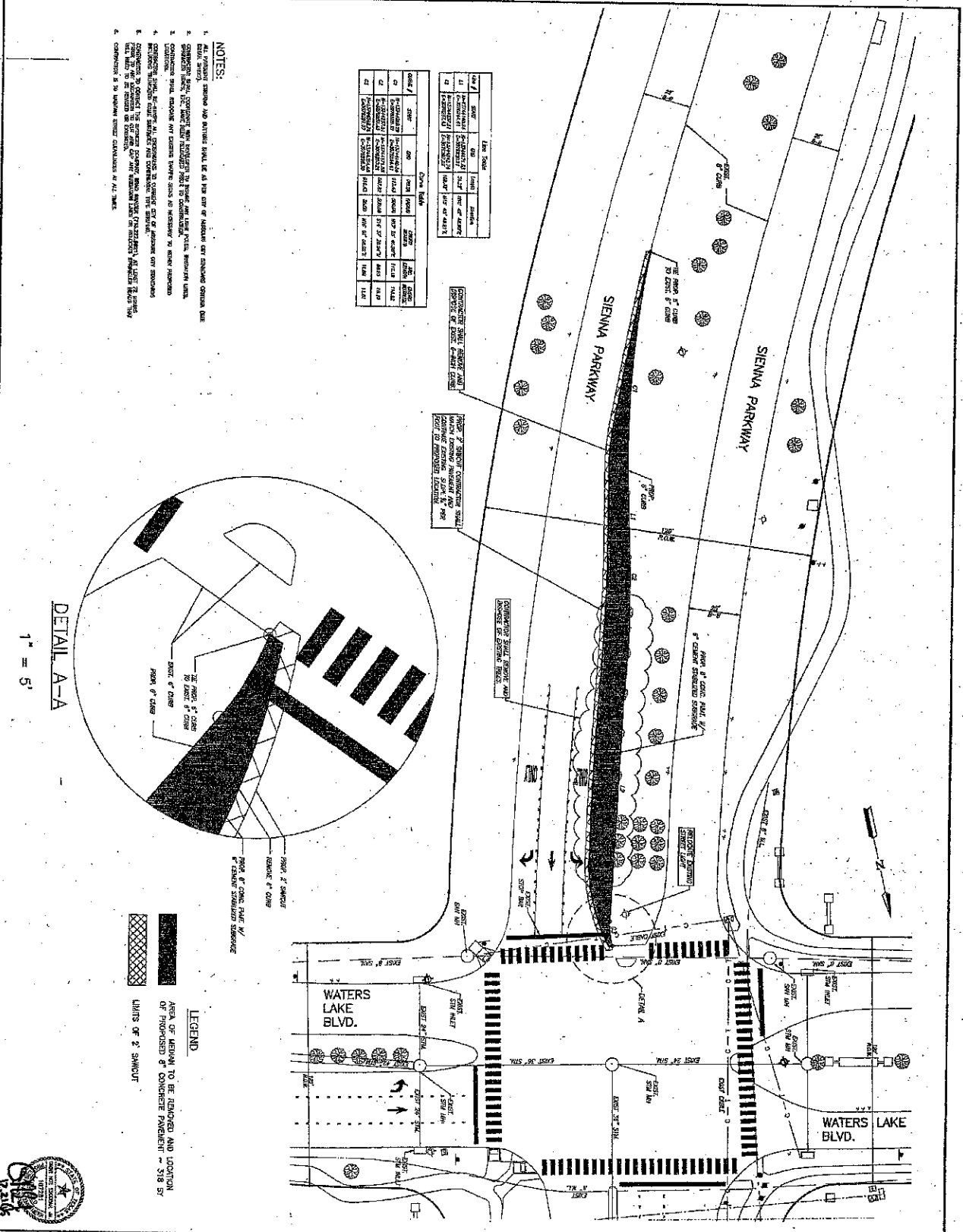

NO.	TYPE	DATE	BY	REVISION
1	PREPARED	11/15/11	J. L. HARRIS	INITIAL DESIGN
2	REVISED	11/15/11	J. L. HARRIS	REVISED PLAN
3	REVISED	11/15/11	J. L. HARRIS	REVISED PLAN
4	REVISED	11/15/11	J. L. HARRIS	REVISED PLAN
5	REVISED	11/15/11	J. L. HARRIS	REVISED PLAN
6	REVISED	11/15/11	J. L. HARRIS	REVISED PLAN
7	REVISED	11/15/11	J. L. HARRIS	REVISED PLAN
8	REVISED	11/15/11	J. L. HARRIS	REVISED PLAN
9	REVISED	11/15/11	J. L. HARRIS	REVISED PLAN
10	REVISED	11/15/11	J. L. HARRIS	REVISED PLAN

- NOTES:**
1. ALL DIMENSIONS SHOWN AND NOTED SHALL BE AS SHOWN UNLESS OTHERWISE NOTED.
 2. CONSTRUCTION SHALL BE IN ACCORDANCE WITH THE MISSOURI STATE BOARD OF ENGINEERS AND SURVEYORS LICENSE NO. 1415-1550.
 3. CONSTRUCTION SHALL BE IN ACCORDANCE WITH THE MISSOURI STATE BOARD OF ENGINEERS AND SURVEYORS LICENSE NO. 1415-1550.
 4. CONSTRUCTION SHALL BE IN ACCORDANCE WITH THE MISSOURI STATE BOARD OF ENGINEERS AND SURVEYORS LICENSE NO. 1415-1550.
 5. CONSTRUCTION SHALL BE IN ACCORDANCE WITH THE MISSOURI STATE BOARD OF ENGINEERS AND SURVEYORS LICENSE NO. 1415-1550.
 6. CONSTRUCTION SHALL BE IN ACCORDANCE WITH THE MISSOURI STATE BOARD OF ENGINEERS AND SURVEYORS LICENSE NO. 1415-1550.
 7. CONSTRUCTION SHALL BE IN ACCORDANCE WITH THE MISSOURI STATE BOARD OF ENGINEERS AND SURVEYORS LICENSE NO. 1415-1550.
 8. CONSTRUCTION SHALL BE IN ACCORDANCE WITH THE MISSOURI STATE BOARD OF ENGINEERS AND SURVEYORS LICENSE NO. 1415-1550.
 9. CONSTRUCTION SHALL BE IN ACCORDANCE WITH THE MISSOURI STATE BOARD OF ENGINEERS AND SURVEYORS LICENSE NO. 1415-1550.
 10. CONSTRUCTION SHALL BE IN ACCORDANCE WITH THE MISSOURI STATE BOARD OF ENGINEERS AND SURVEYORS LICENSE NO. 1415-1550.

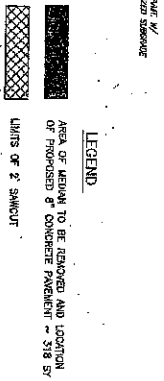
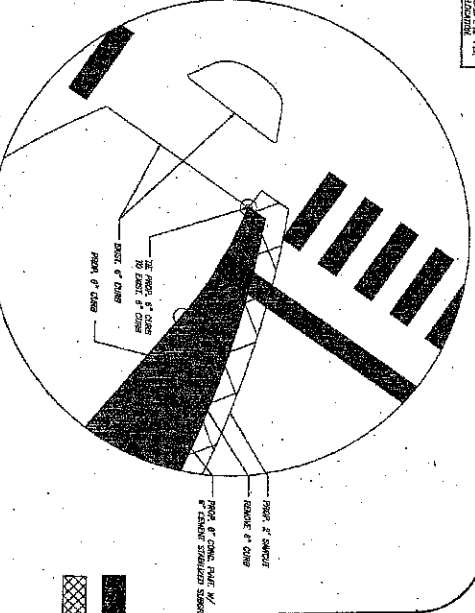

MISSOURI CITY TEXAS
DEPARTMENT OF PUBLIC WORKS

SIENNA PARKWAY NORTHBOUND LEFT TURN LANE AT WATERS LAKE BLVD

PROPOSED PAVEMENT IMPROVEMENTS

DATE: 11/15/11

APPROVED: [Signature]

DESIGNED BY: J. L. HARRIS

SCALE: 1" = 5'

SHEET NO. 4 OF 19

PAVE RECORD DRAWING

THIS DRAWING IS A RECORD DRAWING AND IS NOT TO BE USED FOR CONSTRUCTION. IT IS THE RESPONSIBILITY OF THE CONTRACTOR TO VERIFY ALL DIMENSIONS AND CONDITIONS IN THE FIELD AND TO CORRECT ANY ERRORS OR OMISSIONS. THE CONTRACTOR SHALL BE RESPONSIBLE FOR OBTAINING ALL NECESSARY PERMITS AND APPROVALS FROM THE APPROPRIATE AGENCIES.

DATE: 11/15/11

SCALE: 1" = 5'

SHEET NO. 4 OF 19

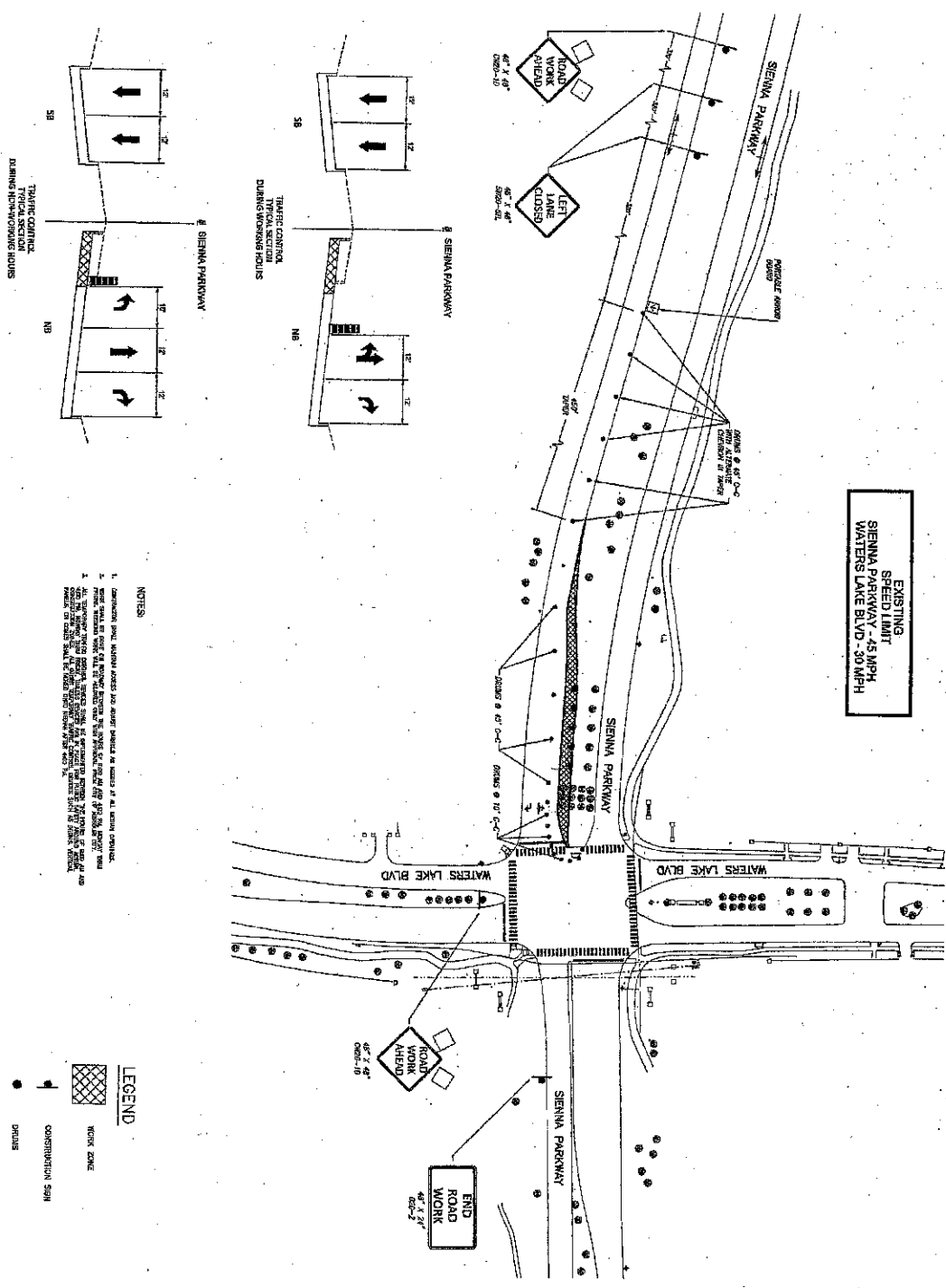

EXISTING
SPEED LIMIT
SIENNA PARKWAY - 45 MPH
WATERS LAKE BLVD - 30 MPH

- NOTES
1. CONSTRUCTION SHALL MAINTAIN ACCESS FOR ADJACENT PROPERTIES AND TRAFFIC AT ALL TIMES UNLESS OTHERWISE SPECIFIED.
 2. ALL WORK SHALL BE COMPLETED WITHIN THE SPECIFIED TIME FRAME. DELAYS SHALL BE REPORTED TO THE PROJECT MANAGER IMMEDIATELY.
 3. ALL SIGNAGE SHALL BE INSTALLED PRIOR TO THE START OF WORK AND REMOVED IMMEDIATELY UPON COMPLETION OF WORK.
 4. THE CONTRACTOR SHALL BE RESPONSIBLE FOR OBTAINING ALL NECESSARY PERMITS AND APPROVALS FROM THE APPROPRIATE AGENCIES.
 5. THE CONTRACTOR SHALL MAINTAIN CLEAR ACCESS TO ALL PUBLIC UTILITIES AND SERVICES AT ALL TIMES.
 6. ALL MATERIALS AND EQUIPMENT SHALL BE STORED IN AN APPROPRIATE MANNER TO AVOID OBSTRUCTION OF TRAFFIC.
 7. THE CONTRACTOR SHALL BE RESPONSIBLE FOR THE PROTECTION OF ALL EXISTING UTILITIES AND STRUCTURES.
 8. ALL WORK SHALL BE COMPLETED IN ACCORDANCE WITH THE MISSOURI STATE BOARD OF PROFESSIONAL ENGINEERS' STANDARDS AND PRACTICES.

- LEGEND
- WORK ZONE
 - CONSTRUCTION SIGN
 - DRIVER
 - TRAFFIC DIRECTION



<p>MISSOURI CITY T E X A S DEPARTMENT OF PUBLIC WORKS</p> <p>APPROVED: <i>[Signature]</i> DATE: 1/1/15</p>	<p>PAVE RECORD DRAWING</p> <p>THIS DRAWING IS A RECORD DRAWING OF THE PAVED WORK SHOWN ON THE PREVIOUS DRAWING. IT IS NOT TO BE USED FOR CONSTRUCTION. THE CONTRACTOR SHALL BE RESPONSIBLE FOR OBTAINING ALL NECESSARY PERMITS AND APPROVALS FROM THE APPROPRIATE AGENCIES.</p>	<p>PROJECT NO. 1415-1550</p> <p>DATE: 1/1/15</p> <p>SCALE: 1" = 40'</p>	<p>PROJECT MANAGER: [Name]</p> <p>PROJECT ENGINEER: [Name]</p> <p>PROJECT SUPERVISOR: [Name]</p>
<p>MISSOURI CITY T E X A S DEPARTMENT OF PUBLIC WORKS</p> <p>APPROVED: <i>[Signature]</i> DATE: 1/1/15</p>	<p>PROJECT NO. 1415-1550</p> <p>DATE: 1/1/15</p> <p>SCALE: 1" = 40'</p>	<p>PROJECT MANAGER: [Name]</p> <p>PROJECT ENGINEER: [Name]</p> <p>PROJECT SUPERVISOR: [Name]</p>	<p>PROJECT NO. 1415-1550</p> <p>DATE: 1/1/15</p> <p>SCALE: 1" = 40'</p>

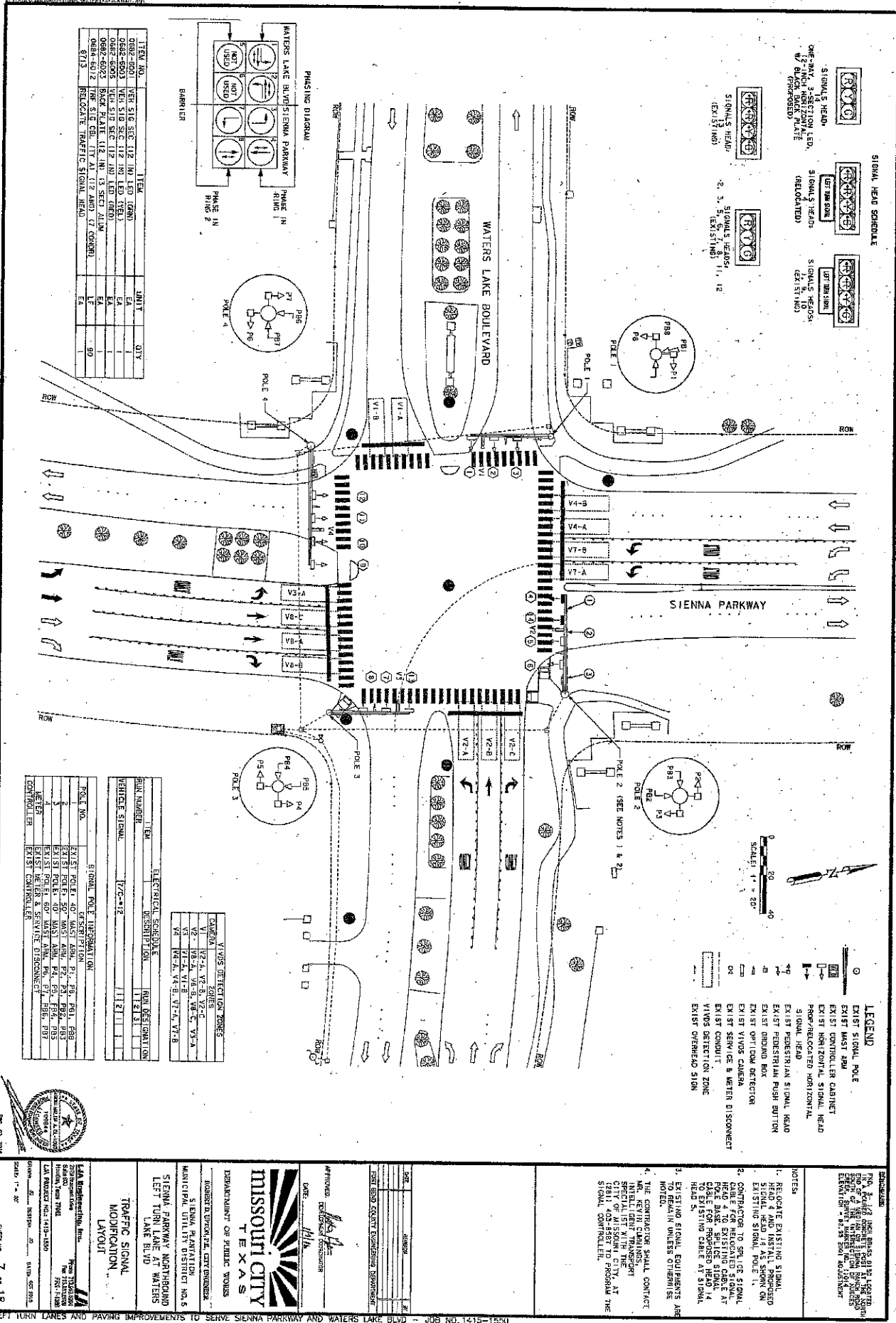

PHASING DIAGRAM

ITEM NO.	YEAR	UNIT	QTY
0682-2001	VEH SIG SEC 1/2 IN LED (GRN)	EA	1
0682-2003	VEH SIG SEC 1/2 IN LED (YEL)	EA	1
0682-2005	VEH SIG SEC 1/2 IN LED (RED)	EA	1
0882-2023	BLACK PLATE 1/2 IN 13 SECT ALUM	EA	1
0884-1012	TRN SIG CBL 17Y 21 112 AMP 17 CONDUIT	LF	90
5113	RELOCATE TRAFFIC SIGNAL HEAD	EA	1

SIGNAL HEAD SCHEDULE

SIGNAL HEAD	DESCRIPTION	EXISTING
SIGNAL HEAD 1	SIGNAL HEAD 1 (EXISTING)	1
SIGNAL HEAD 2	SIGNAL HEAD 2 (EXISTING)	1
SIGNAL HEAD 3	SIGNAL HEAD 3 (EXISTING)	1
SIGNAL HEAD 4	SIGNAL HEAD 4 (EXISTING)	1

ELECTRICAL SCHEDULE

ITEM	DESCRIPTION	QTY
1	VEHICLE SIGNAL	11
2	VEHICLE SIGNAL	11
3	VEHICLE SIGNAL	11
4	VEHICLE SIGNAL	11
5	VEHICLE SIGNAL	11
6	VEHICLE SIGNAL	11
7	VEHICLE SIGNAL	11
8	VEHICLE SIGNAL	11
9	VEHICLE SIGNAL	11
10	VEHICLE SIGNAL	11
11	VEHICLE SIGNAL	11
12	VEHICLE SIGNAL	11
13	VEHICLE SIGNAL	11
14	VEHICLE SIGNAL	11
15	VEHICLE SIGNAL	11
16	VEHICLE SIGNAL	11
17	VEHICLE SIGNAL	11
18	VEHICLE SIGNAL	11
19	VEHICLE SIGNAL	11
20	VEHICLE SIGNAL	11
21	VEHICLE SIGNAL	11
22	VEHICLE SIGNAL	11
23	VEHICLE SIGNAL	11
24	VEHICLE SIGNAL	11
25	VEHICLE SIGNAL	11
26	VEHICLE SIGNAL	11
27	VEHICLE SIGNAL	11
28	VEHICLE SIGNAL	11
29	VEHICLE SIGNAL	11
30	VEHICLE SIGNAL	11
31	VEHICLE SIGNAL	11
32	VEHICLE SIGNAL	11
33	VEHICLE SIGNAL	11
34	VEHICLE SIGNAL	11
35	VEHICLE SIGNAL	11
36	VEHICLE SIGNAL	11
37	VEHICLE SIGNAL	11
38	VEHICLE SIGNAL	11
39	VEHICLE SIGNAL	11
40	VEHICLE SIGNAL	11
41	VEHICLE SIGNAL	11
42	VEHICLE SIGNAL	11
43	VEHICLE SIGNAL	11
44	VEHICLE SIGNAL	11
45	VEHICLE SIGNAL	11
46	VEHICLE SIGNAL	11
47	VEHICLE SIGNAL	11
48	VEHICLE SIGNAL	11
49	VEHICLE SIGNAL	11
50	VEHICLE SIGNAL	11
51	VEHICLE SIGNAL	11
52	VEHICLE SIGNAL	11
53	VEHICLE SIGNAL	11
54	VEHICLE SIGNAL	11
55	VEHICLE SIGNAL	11
56	VEHICLE SIGNAL	11
57	VEHICLE SIGNAL	11
58	VEHICLE SIGNAL	11
59	VEHICLE SIGNAL	11
60	VEHICLE SIGNAL	11
61	VEHICLE SIGNAL	11
62	VEHICLE SIGNAL	11
63	VEHICLE SIGNAL	11
64	VEHICLE SIGNAL	11
65	VEHICLE SIGNAL	11
66	VEHICLE SIGNAL	11
67	VEHICLE SIGNAL	11
68	VEHICLE SIGNAL	11
69	VEHICLE SIGNAL	11
70	VEHICLE SIGNAL	11
71	VEHICLE SIGNAL	11
72	VEHICLE SIGNAL	11
73	VEHICLE SIGNAL	11
74	VEHICLE SIGNAL	11
75	VEHICLE SIGNAL	11
76	VEHICLE SIGNAL	11
77	VEHICLE SIGNAL	11
78	VEHICLE SIGNAL	11
79	VEHICLE SIGNAL	11
80	VEHICLE SIGNAL	11
81	VEHICLE SIGNAL	11
82	VEHICLE SIGNAL	11
83	VEHICLE SIGNAL	11
84	VEHICLE SIGNAL	11
85	VEHICLE SIGNAL	11
86	VEHICLE SIGNAL	11
87	VEHICLE SIGNAL	11
88	VEHICLE SIGNAL	11
89	VEHICLE SIGNAL	11
90	VEHICLE SIGNAL	11
91	VEHICLE SIGNAL	11
92	VEHICLE SIGNAL	11
93	VEHICLE SIGNAL	11
94	VEHICLE SIGNAL	11
95	VEHICLE SIGNAL	11
96	VEHICLE SIGNAL	11
97	VEHICLE SIGNAL	11
98	VEHICLE SIGNAL	11
99	VEHICLE SIGNAL	11
100	VEHICLE SIGNAL	11

VIVOS DETECTION ZONES

ZONE	DESCRIPTION
V1	WATER'S LAKE BOULEVARD
V2	SIENNA PARKWAY
V3	WATER'S LAKE BOULEVARD
V4	SIENNA PARKWAY
V5	WATER'S LAKE BOULEVARD
V6	SIENNA PARKWAY
V7	WATER'S LAKE BOULEVARD
V8	SIENNA PARKWAY
V9	WATER'S LAKE BOULEVARD
V10	SIENNA PARKWAY
V11	WATER'S LAKE BOULEVARD
V12	SIENNA PARKWAY
V13	WATER'S LAKE BOULEVARD
V14	SIENNA PARKWAY
V15	WATER'S LAKE BOULEVARD
V16	SIENNA PARKWAY
V17	WATER'S LAKE BOULEVARD
V18	SIENNA PARKWAY
V19	WATER'S LAKE BOULEVARD
V20	SIENNA PARKWAY
V21	WATER'S LAKE BOULEVARD
V22	SIENNA PARKWAY
V23	WATER'S LAKE BOULEVARD
V24	SIENNA PARKWAY
V25	WATER'S LAKE BOULEVARD
V26	SIENNA PARKWAY
V27	WATER'S LAKE BOULEVARD
V28	SIENNA PARKWAY
V29	WATER'S LAKE BOULEVARD
V30	SIENNA PARKWAY
V31	WATER'S LAKE BOULEVARD
V32	SIENNA PARKWAY
V33	WATER'S LAKE BOULEVARD
V34	SIENNA PARKWAY
V35	WATER'S LAKE BOULEVARD
V36	SIENNA PARKWAY
V37	WATER'S LAKE BOULEVARD
V38	SIENNA PARKWAY
V39	WATER'S LAKE BOULEVARD
V40	SIENNA PARKWAY
V41	WATER'S LAKE BOULEVARD
V42	SIENNA PARKWAY
V43	WATER'S LAKE BOULEVARD
V44	SIENNA PARKWAY
V45	WATER'S LAKE BOULEVARD
V46	SIENNA PARKWAY
V47	WATER'S LAKE BOULEVARD
V48	SIENNA PARKWAY
V49	WATER'S LAKE BOULEVARD
V50	SIENNA PARKWAY

LEGEND

- EXIST SIGNAL POLE
- EXIST MAST ARM
- EXIST CONTROLLER CABINET
- EXIST NON-ZONAL SIGNAL HEAD
- PROP/RELOCATED HORIZONTAL SIGNAL HEAD
- EXIST PEDESTRIAN SIGNAL HEAD
- EXIST PEDESTRIAN PUSH BUTTON
- EXIST GROUND BOX
- EXIST OPTIC DETECTOR
- EXIST VIVOS CAMERA
- EXIST SERVICE & WATER DISCONNECT
- EXIST CONDUIT
- VIVOS DETECTION ZONE
- EXIST OVERHEAD SIGN

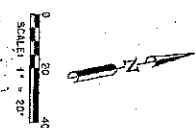

MISSOURI CITY TEXAS
 DEPARTMENT OF PUBLIC WORKS
 ROBERT D. BROWN, CITY ENGINEER
 SIENNA PARKWAY NORTHBOUND LEFT TURN LANE AT WATERS LAKE BLVD
 TRAFFIC SIGNAL MODIFICATION LAYOUT
 LAM Engineering Inc.
 10000 N. Loop West, Suite 1000
 Houston, Texas 77040
 LA PROJECT NO. 1415-1550
 SHEET NO. 7 OF 18
 DATE: 1-4-20

APPROVED: [Signature]
 PROJECT ENGINEER
 CITY OF MISSOURI CITY, TEXAS
 SPECIALIST WITH THE CITY ENGINEER PROGRAM THE SIGNAL CONTROLLER.
 NOTES:
 1. RELOCATE EXISTING SIGNAL HEAD 4 AND INSTALL PROPOSED EXISTING SIGNAL HEAD 4 AT EXISTING SIGNAL POLE 1.
 2. CONTRACTOR TO SPlice SIGNAL HEAD 4 TO EXISTING SIGNAL AT POLE 1 AND PROPOSED SIGNAL 4 TO EXISTING SIGNAL AT POLE 1.
 3. EXISTING SIGNAL EQUIPMENT IS TO REMAIN UNLESS OTHERWISE NOTED.
 4. THE CONTRACTOR SHALL CONTACT MR. KEVIN CHAMBERS, SPECIALIST WITH THE CITY OF MISSOURI CITY, AT THE SIGNAL CONTROLLER.

NOTES:
 1. RELOCATE EXISTING SIGNAL HEAD 4 AND INSTALL PROPOSED EXISTING SIGNAL HEAD 4 AT EXISTING SIGNAL POLE 1.
 2. CONTRACTOR TO SPlice SIGNAL HEAD 4 TO EXISTING SIGNAL AT POLE 1 AND PROPOSED SIGNAL 4 TO EXISTING SIGNAL AT POLE 1.
 3. EXISTING SIGNAL EQUIPMENT IS TO REMAIN UNLESS OTHERWISE NOTED.
 4. THE CONTRACTOR SHALL CONTACT MR. KEVIN CHAMBERS, SPECIALIST WITH THE CITY OF MISSOURI CITY, AT THE SIGNAL CONTROLLER.

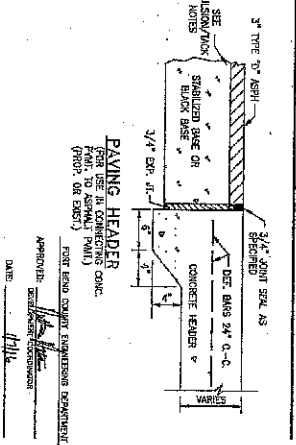
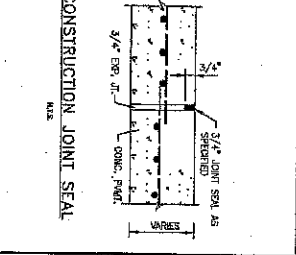
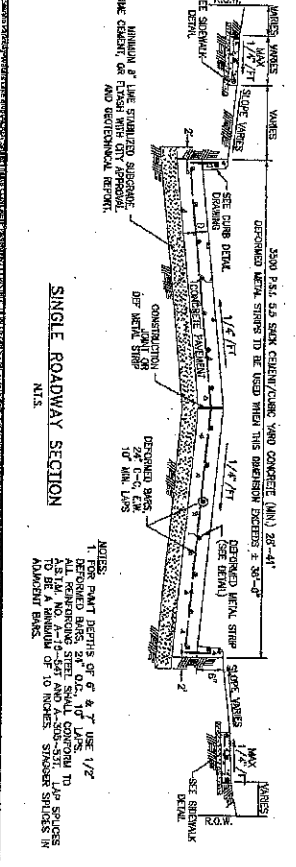
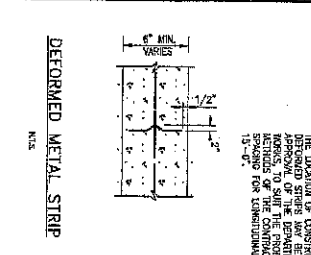
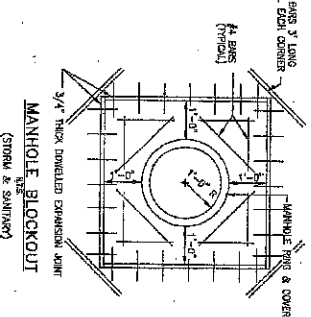
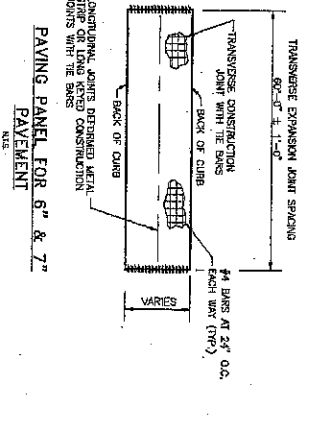
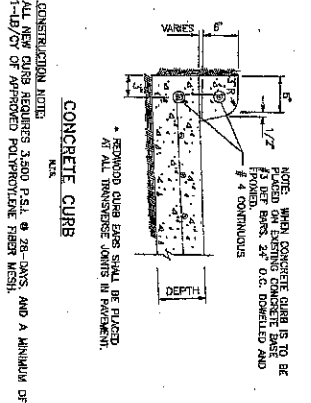
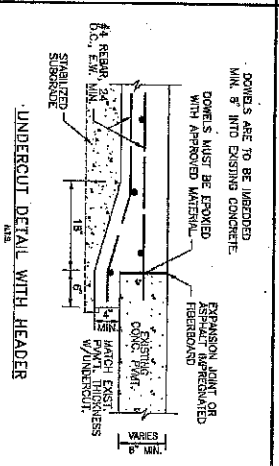
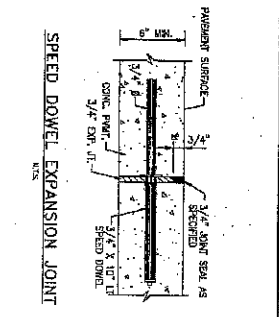
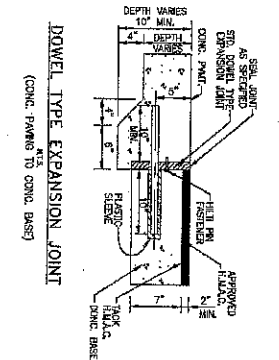
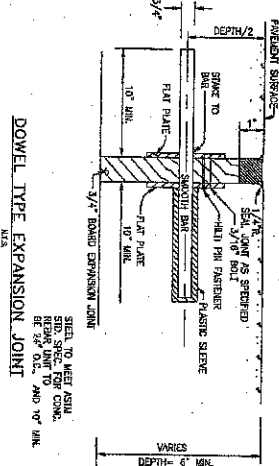
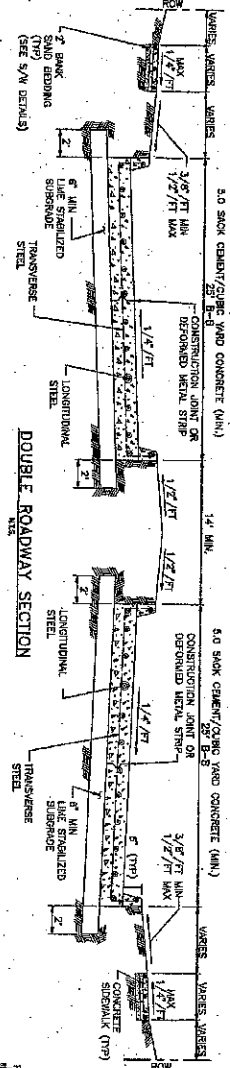

- CONSTRUCTION NOTES:**
1. 8 INCH 1.5S BARS SHALL BE USED FOR CONCRETE 3000 PSI. MINIMUM COVER SHALL BE 4 INCHES FOR ALL. SEE 14.01 OF THE STANDARD SPECIFICATIONS FOR ROADWAY STRUCTURES.
 2. 7 INCH 1.5S BARS SHALL BE USED FOR CONCRETE 3000 PSI MINIMUM COVER SHALL BE 4 INCHES FOR ALL. SEE 14.01 OF THE STANDARD SPECIFICATIONS FOR ROADWAY STRUCTURES.
 3. 6 INCH 1.5S BARS SHALL BE USED FOR CONCRETE 3000 PSI MINIMUM COVER SHALL BE 4 INCHES FOR ALL. SEE 14.01 OF THE STANDARD SPECIFICATIONS FOR ROADWAY STRUCTURES.
 4. PROPOSED EXPANSION JOINTS ARE LOCATED AT INTERVALS OF APPROX. 30 FEET. JOINT REPAIR SHALL BE DONE WITH SPECIAL JOINT REPAIR MIXTURE (SEE 14.01 OF THE STANDARD SPECIFICATIONS FOR ROADWAY STRUCTURES).
 5. FOR EXPANSION JOINTS USE 1/2\"/>

THE LOCATION OF CONSTRUCTION JOINTS AND DEFORMED STRIPS MAY BE VARIOUS WITH THE ABOVE INDICATED LOCATIONS TO SUIT THE PROPOSED CONSTRUCTION METHODS. CONSULT THE CONTRACTOR. INTERVALS ARE 15'-00\"/>

MISSOURI CITY
T. B. X. A. S.
DEPARTMENT OF PUBLIC WORKS
SUBDIVISION OF PUBLIC UTILITIES ENGINEER

DATE: _____
DRAWN BY: _____
CHECKED BY: _____
APPROVED BY: _____

CONSTRUCTION PLANS FOR:
SIENNA PLANTATION MUNICIPAL
UTILITY DISTRICT NO. 5
T.C.E.D. P.W.S. No. 07504-00

SIENNA PARKWAY NORTHBOUND
LEFT TURN LANE AT
WATERS LAKE BOULEVARD

NO. 14-15
SHEET 8 OF 19

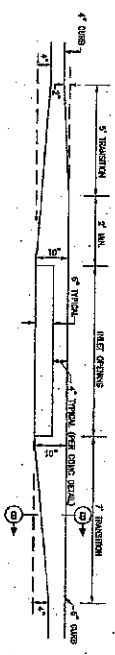

TYPICAL CURB TRANSITION FOR INLET INSTALLATION

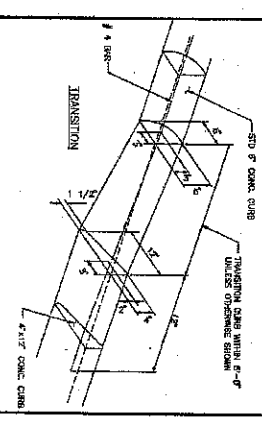

TYPICAL CONCRETE CURB REINFORCING

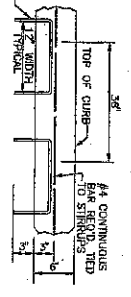

TYPICAL CONCRETE CURB

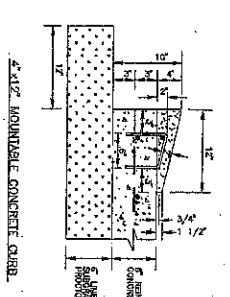

4\"/>

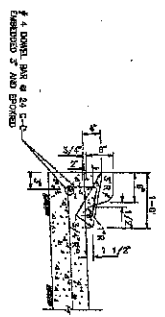

4\"/>

- 4\"/>**
- 5-8 INCH CONCRETE CURB TO BE CONSTRUCTED ON ALL DRIVEWAYS, SIDEWALKS, AND TRANSITION CURBS. CURB SHALL BE CONSTRUCTED WITH 4\"/>
 - ALL 4\"/>
 - TRANSITIONS FROM 4\"/>
 - 10' OR APPROVED TYPE WASH PER C-711 ALL NEW CURB.

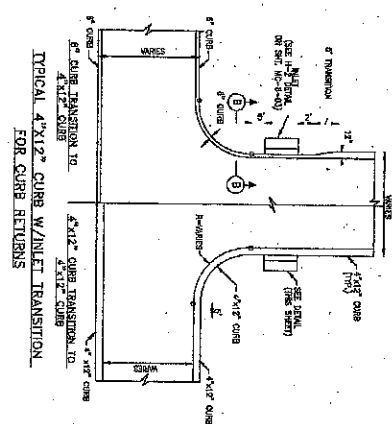

TYPICAL 4\"/>

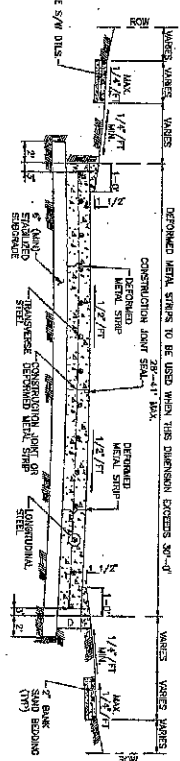

TYPICAL SINGLE ROADWAY SECTION FOR CONCRETE PAVEMENT WITH 4\"/>

- CONSTRUCTION NOTES:**
- 5 INCH, 5.5 SLACK CEMENT PER CUBIC YARD CONCRETE 3000 PSI MINIMUM ACCEPTABLE PAVEMENT CONSTRUCTION FOR RESIDENTIAL STREETS.
 - 7 INCH, 6.5 SLACK CEMENT PER CUBIC YARD CONCRETE 3000 PSI MINIMUM ACCEPTABLE PAVEMENT CONSTRUCTION FOR COLLECTOR AND THROUGHFARE STREETS.
 - TRANSVERSE EXPANSION JOINTS ARE REQUIRED AT MAXIMUM SPACING OF 60'-0\"/>
 - CONCRETE SHALL BE PLACED AND FINISHED WITH A FINISH OF 1/4\"/>
 - STREET WATER POLLUTION PREVENTION SHALL BE OBSERVED, CONSTRUCTED, MAINTAINED AND SHALL BE IN TOTAL COMPLIANCE WITH THE STORM WATER CONTROL MANUAL OF THE CITY OF MISSOURI CITY.
 - UNDESIRABLE SUBGRADE SHALL BE ENHANCED AND REPLACED WITH CELEST SPREADDED SOIL.
 - USE 1\"/>
 - DOOR SHALL BE 3/4\"/>
 - IF IS THE CONTRACTOR'S RESPONSIBILITY TO NOTIFY THE CITY OF MISSOURI CITY OF ANY BARRIER PROBLEMS PRIOR TO CONSTRUCTION OF DRIVEWAY.
 - REFER TO GENERAL, C.S.S. AND PAVEMENT NOTES.
 - 10' OR APPROVED POLYPROPYLENE FIBER BLENDED CEMENT CONCRETE CURB REQUIRED.

PAVING RECORD DRAWING

NO. _____ DATE _____

ENGINEER _____

RESIDENTIAL CURB CONSTRUCTION DETAILS

MISSOURI CITY DEPARTMENT OF PUBLIC WORKS REGISTERED ENGINEER, STATE OF MISSOURI

CONSTRUCTION PLANS FOR: SIENNA PLANTATION MUNICIPAL UTILITY DISTRICT NO. 5 T.C.E.B. P.M.S. NO. 0790480

SIENNA PARKWAY NORTHBOUND LEFT TURN LANE AT WATERS LAKE BOULEVARD

DATE: 11/14/80

APPROVED: _____

DESIGN: _____

MC-18-15 SHEET 9 OF 18

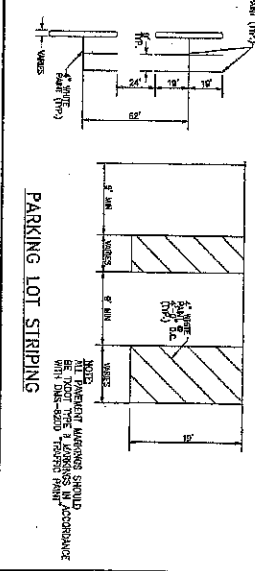
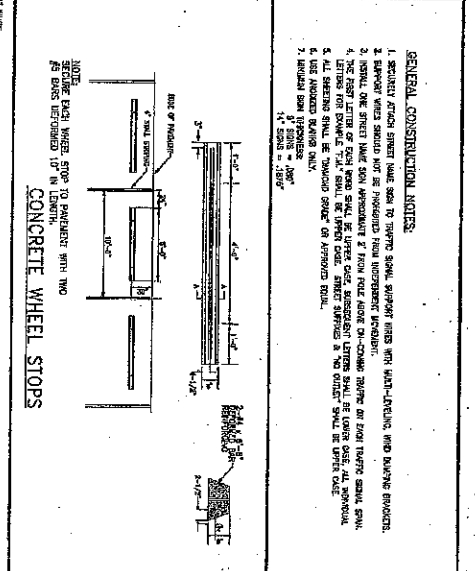
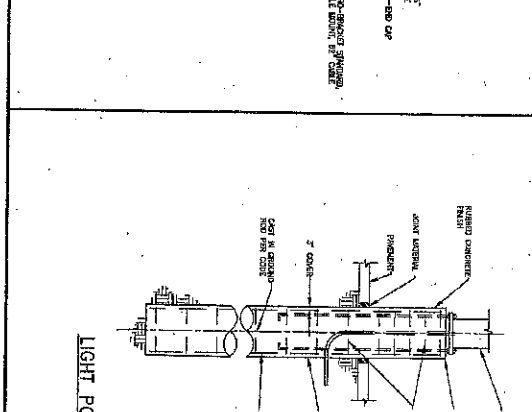
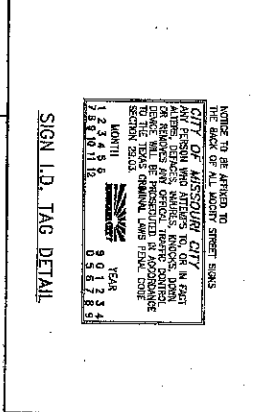
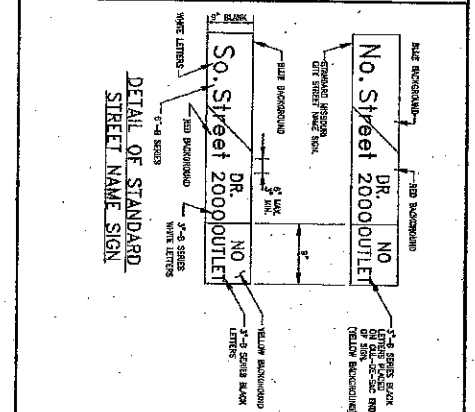
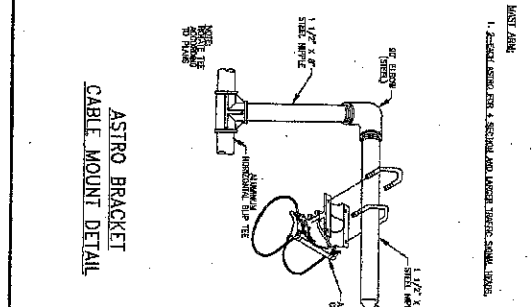
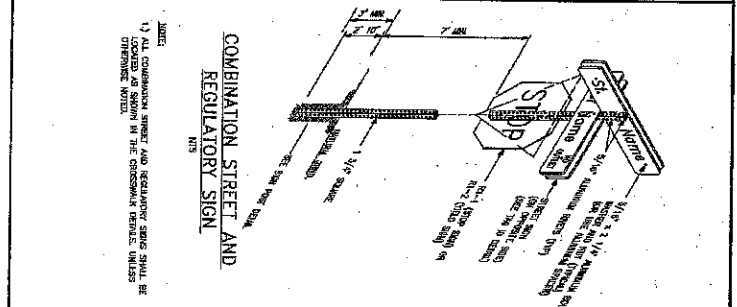
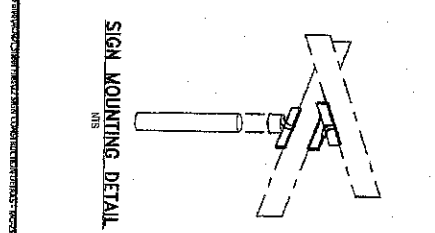
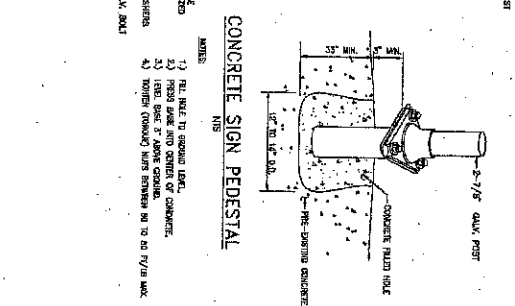
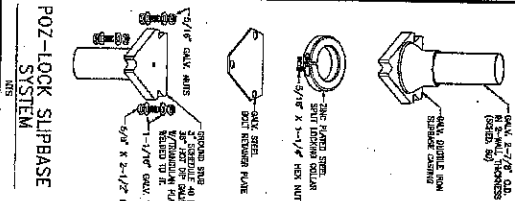
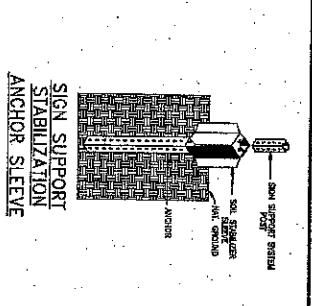
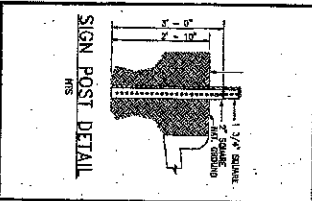

GENERAL CONSTRUCTION NOTES:

- SECURITY ARCH SIGNAGE SHALL BE PROVIDED WITH VEHICLE-RESISTANT, IMPACT-RESISTANT, AND BURGLAR-RESISTANT.
- SECURITY ARCH SIGNAGE SHALL NOT BE PROVIDED FROM IMPROPER INSTALLATION.
- SECURITY ARCH SIGNAGE SHALL BE PROVIDED FROM IMPROPER INSTALLATION.
- LETTERS FOR SECURITY ARCH SIGNAGE SHALL BE PROVIDED FROM IMPROPER INSTALLATION.
- ALL SECURITY ARCH SIGNAGE SHALL BE PROVIDED FROM IMPROPER INSTALLATION.
- ALL SECURITY ARCH SIGNAGE SHALL BE PROVIDED FROM IMPROPER INSTALLATION.
- ALL SECURITY ARCH SIGNAGE SHALL BE PROVIDED FROM IMPROPER INSTALLATION.
- ALL SECURITY ARCH SIGNAGE SHALL BE PROVIDED FROM IMPROPER INSTALLATION.

MISSOURI CITY
DEPARTMENT OF PUBLIC WORKS
1221 S. MAIN ST., MISSOURI CITY, MO 64110

CONSTRUCTION PLANS FOR:
SIENNA PLANTATION MUNICIPAL
T.O.E.D. P.W.S. NO. 0790480

**SIENNA PARKWAY NORTHBOUND
LEFT TURN LANE AT
WATERS LAKE BOULEVARD**

DATE: 11/11/11
JOB NO: MC-25-15
SHEET 12 OF 19

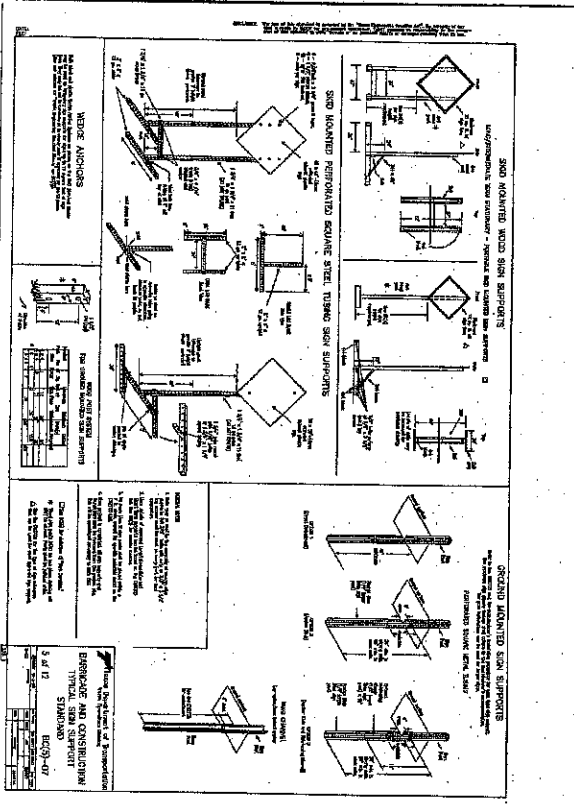

RECOMMENDED PHASES AND TONNAGES FOR PAVE MESSAGES DURING ROADWORK ACTIVITIES

Phase 1 - Double Lane

Phase	Message	Phase 1 - Double Lane	Phase 2 - Single Lane	Phase 3 - Single Lane
Phase 1 - Double Lane	1. AHEAD WORK AHEAD	1000	1000	1000
	2. ROAD CLOSED	1000	1000	1000
	3. ROAD CLOSED	1000	1000	1000
	4. ROAD CLOSED	1000	1000	1000
Phase 2 - Single Lane	1. AHEAD WORK AHEAD	1000	1000	1000
	2. ROAD CLOSED	1000	1000	1000
	3. ROAD CLOSED	1000	1000	1000
	4. ROAD CLOSED	1000	1000	1000
Phase 3 - Single Lane	1. AHEAD WORK AHEAD	1000	1000	1000
	2. ROAD CLOSED	1000	1000	1000
	3. ROAD CLOSED	1000	1000	1000
	4. ROAD CLOSED	1000	1000	1000

Notes: 1. The above tonnage is based on a 1000 lb. sign. 2. The above tonnage is based on a 1000 lb. sign. 3. The above tonnage is based on a 1000 lb. sign. 4. The above tonnage is based on a 1000 lb. sign.

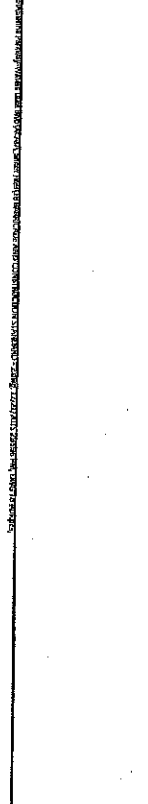
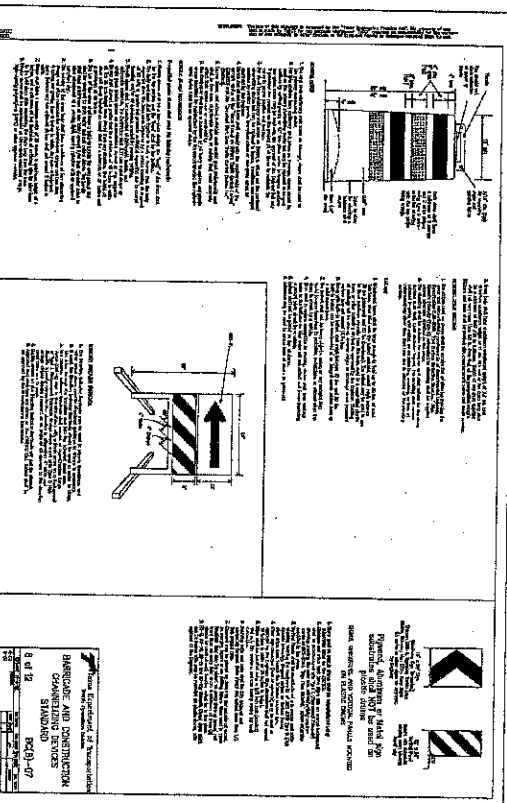
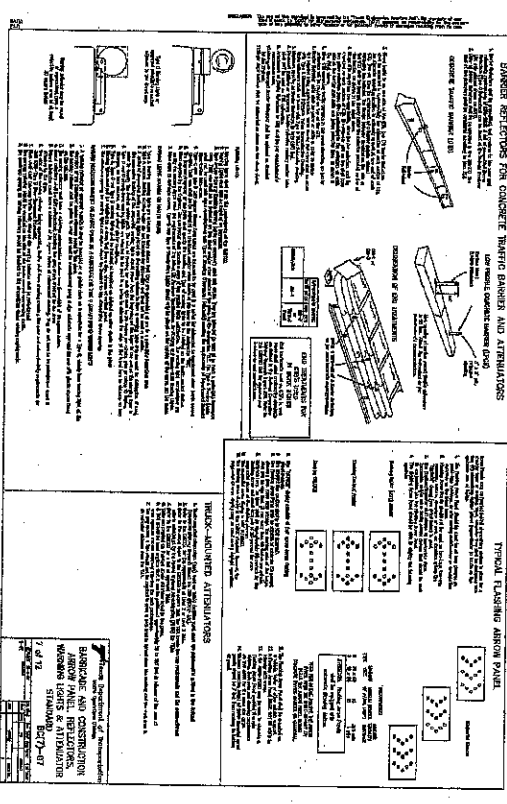

PAVE RECORD DRAWING

THIS DRAWING IS TO BE USED FOR THE RECORD OF THE PAVING WORK. IT IS TO BE SUBMITTED TO THE ENGINEER IN CHARGE OF THE PROJECT WITH THE PAVING CONTRACT. IT IS TO BE KEPT ON FILE WITH THE PROJECT RECORDS.

DATE: 9/18/18

BY: [Signature]

APPROVED: [Signature]

DATE: 9/18/18

FOR: MISSOURI DEPARTMENT OF TRANSPORTATION

MISSOURI DEPARTMENT OF TRANSPORTATION

DESIGN DIVISION

DESIGNER: [Name]

CHECKER: [Name]

DATE: 9/18/18

MISSOURI DEPARTMENT OF TRANSPORTATION

DESIGN DIVISION

DESIGNER: [Name]

CHECKER: [Name]

DATE: 9/18/18

MISSOURI DEPARTMENT OF TRANSPORTATION

DESIGN DIVISION

DESIGNER: [Name]

CHECKER: [Name]

DATE: 9/18/18

MISSOURI DEPARTMENT OF TRANSPORTATION

DESIGN DIVISION

DESIGNER: [Name]

CHECKER: [Name]

DATE: 9/18/18

MISSOURI DEPARTMENT OF TRANSPORTATION

DESIGN DIVISION

DESIGNER: [Name]

CHECKER: [Name]

DATE: 9/18/18

MISSOURI DEPARTMENT OF TRANSPORTATION

DESIGN DIVISION

DESIGNER: [Name]

CHECKER: [Name]

DATE: 9/18/18

MISSOURI DEPARTMENT OF TRANSPORTATION

DESIGN DIVISION

DESIGNER: [Name]

CHECKER: [Name]

DATE: 9/18/18

MISSOURI DEPARTMENT OF TRANSPORTATION

DESIGN DIVISION

DESIGNER: [Name]

CHECKER: [Name]

DATE: 9/18/18

MISSOURI DEPARTMENT OF TRANSPORTATION

DESIGN DIVISION

DESIGNER: [Name]

CHECKER: [Name]

DATE: 9/18/18

MISSOURI DEPARTMENT OF TRANSPORTATION

DESIGN DIVISION

DESIGNER: [Name]

CHECKER: [Name]

DATE: 9/18/18

