

REVIEW BY FORT BEND COUNTY COMMISSIONERS COURT

On this 26th day of April, 2016, Commissioners Court came on to be heard and reviewed the accompanying notice of All City Permits / Lonnie Lischka Company, LP Job Location FBC MUD #132, Houston, TX 77406 Date 4/7/2016 Bond No. LPM9210918, Permit No. 2016-6495 to make use of certain Fort Bend County property subject to, "A Revised Order Regulating the Laying, Construction, Maintenance, and Repair of Buried Cables, Conduits, and Pole Lines, In, Under, Across or Along Roads, Streets, Highways, and Drainage Ditches in Fort Bend County, Texas, Under the Jurisdiction of the Commissioners Court of Fort Bend County, Texas," as passed by the Commissioners Court of Fort Bend County, Texas the 3rd day of August, 1987, recorded in Volume _____ of the Minutes of the Commissioners Court of Fort Bend County, Texas, to the extent that such order is not inconsistent with Article 1436a, Vernon's Texas Civil Statutes. Upon Motion of Commissioner _____, seconded by Commissioner _____, duly put and carried, it is ORDERED, ADJUDGED AND DECREED that said notice of said above purpose is hereby acknowledged by the Commissioners Court of Fort Bend County, Texas, and that said notice be placed on record according to the regulation order thereof.

Notes:

1. Evidence of review by the Commissioners Court must be kept on the job site and failure to do so constitutes grounds for job shutdown.
2. Written notices are required:
 - a. 48 hours in advance of construction start up, and
 - b. when construction is completed and ready for final inspection
 Mail notices to: Permit Administrator
 Fort Bend County Engineering
 301 Jackson Street
 Richmond, Texas 77469
 281-633-7500
3. This permit expires one (1) year from date of permit if construction has not commenced.

By: Charles O. Day
fo County Engineer

Presented to Commissioners Court and approved.
Recorded in Volume _____
Minutes of Commissioners Court

By: _____
Drainage District Engineer/Manager

Clerk of Commissioners Court

By: _____
Deputy

County of Fort Bend

Engineering Department

301 Jackson Street
Richmond, Texas 77469

Johnny Ortega
Permit Administrator

Phone: (281) 633-7500

Permit Application Review Form For Cable, Conduit, and Pole Line Activity In Fort Bend County

Permit No. 2016-6495

The following "Notice of Proposed Cable, Conduit, and/or Pole Line activity in Fort Bend County" and accompanying attachments have been reviewed and the notice conforms to appropriate regulations set by Commissioner's Court of Fort Bend County, Texas.

- (1) Complete Application Form:
- a. Name of road, street, and/or drainage ditch affected.
- b. Vicinity map showing course of directions
- c. Plans and specifications
- (2) Bond:
- District Attorney, approval when applicable.
- Perpetual bond currently posted.
- No: LPM9210918
- Amount: \$50,000.00
- Performance bond submitted.
- No:
- Amount:
- Cashier's Check
- No:
- Amount:
- (3) Verbal permission given for emergencies, to start construction before approved in Commissioner's Court.

Precinct Engineer Acknowledgment

Date

Precinct Commissioner Acknowledgment

Date

(4)

Drainage District Approval when applicable

We have reviewed this project and agree it meets minimum requirements.



Johnny Ortega CFM/Permit Administrator



Date

THIS PLAN AND THE INFORMATION CONTAINED HEREON ARE THE PROPERTY OF COSTELLO & ASSOCIATES, INC. AND ARE NOT TO BE REPRODUCED OR TRANSMITTED IN ANY FORM OR BY ANY MEANS, ELECTRONIC OR MECHANICAL, INCLUDING PHOTOCOPYING, RECORDING, OR BY ANY INFORMATION STORAGE AND RETRIEVAL SYSTEM, WITHOUT THE WRITTEN PERMISSION OF COSTELLO & ASSOCIATES, INC.

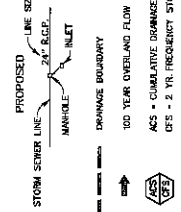
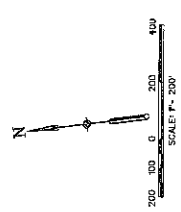

ETV DETENTION PLANS INFORMATION

1. STORM WATER DETENTION PLANS IS PROVIDED IN: DETENTION POND PHASE I IMPROVEMENTS FOR SENDERO ENGINEERING FIRM, COSTELLO, INC. DATE AND SIGNED BY: OCTOBER 28, 2015, JONN VANDERWILT, P.E.

2. STORM WATER DRAINAGE DESIGN REPORT REPORT TITLE: DRAINAGE ANALYSIS FOR THE DEVELOPMENT OF THE 937 ACRE SENDERO TRACT DATE: OCTOBER 26, 2015 ENGINEERING FIRM: COSTELLO, INC. DATE OF ACKNOWLEDGEMENT BY: FORT BEND COUNTY DRAINAGE DISTRICT.

| | | |
|--|---|--|
| APPROVED: <i>[Signature]</i> DATE: 11/15/15 REGISTERED PROFESSIONAL ENGINEER NO. 111223 STATE OF TEXAS | CITY OF HOUSTON DEPARTMENT OF PUBLIC WORKS AND INFRASTRUCTURE 1100 WEST 19TH STREET HOUSTON, TEXAS 77019 PHONE: 713-835-2151 FAX: 713-835-2152 | FILE NO.: DRAWING SCALE: 1" = 200' SHEET NO.: 3 OF 26 |
|--|---|--|

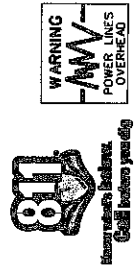

FORT BEND COUNTY MUD 132
SENDERO DETENTION PHASE I
OVERALL DRAINAGE LAYOUT

Engineering and Surveying
9890 Richmond Avenue, Suite 400 N
Houston, Texas 77042
(713) 752-7750 / (713) 760-8888, Fax
1985-FIRM REG. NO. 80488



| | |
|---------------------------------------|----------------|
| DESIGNED BY: <i>[Signature]</i> | DATE: 10-28-15 |
| DESIGN CHECKED BY: <i>[Signature]</i> | |
| DRAWN BY: | |
| CADD CHECKED BY: | |
| SHAWBY CHECKED BY: | |
| CAUSE BY: | |
| QUADREVISIONS BY: | |

| NO. | REVISION | DATE | BY |
|-----|----------|------|----|
| | | | |
| | | | |
| | | | |

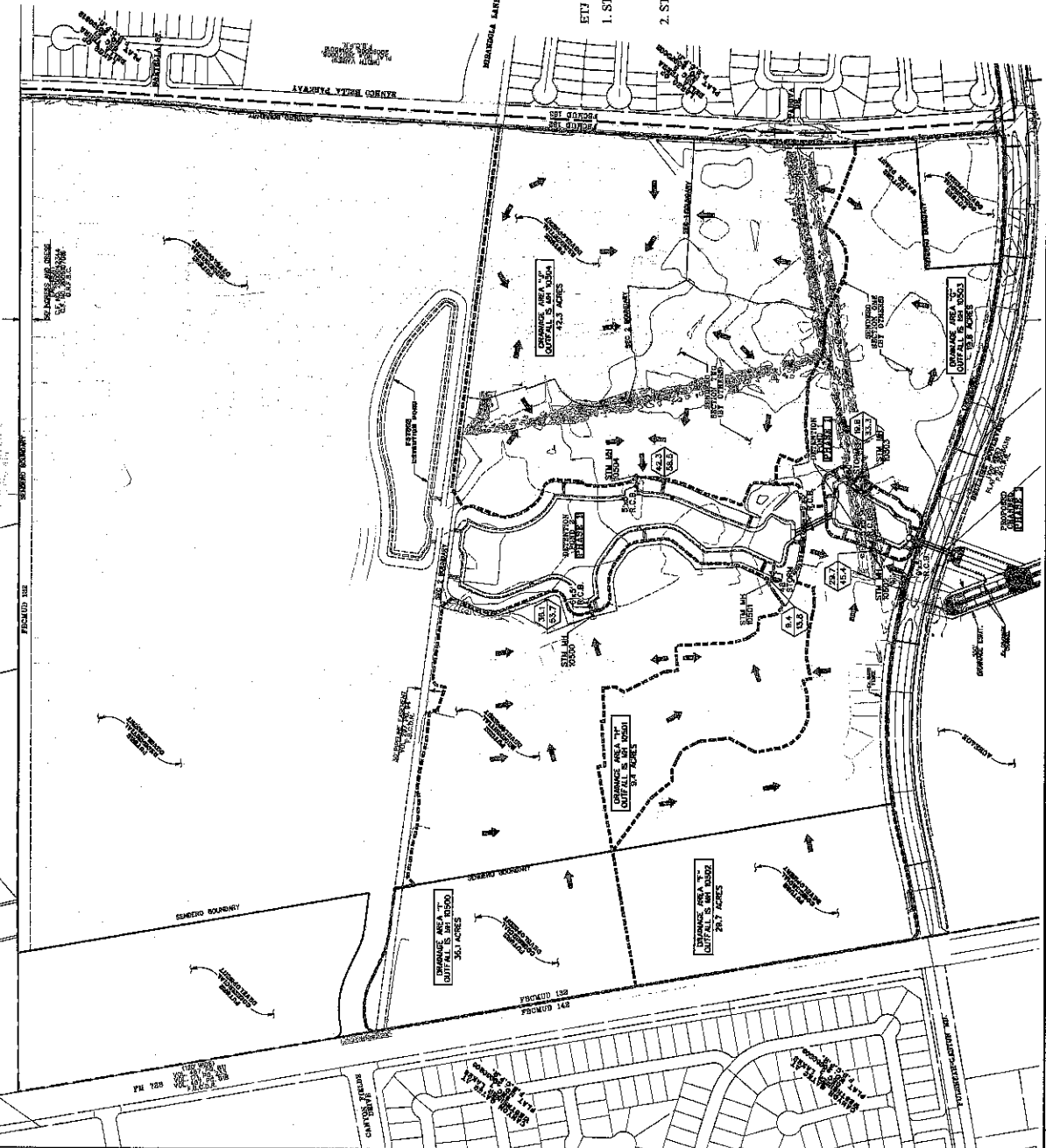

THIS PLAN AND SPECIFICATIONS SHALL BE CONSIDERED TO BE THE ENTIRE CONTRACT DOCUMENTS FOR THE PROJECT. THE CONTRACTOR SHALL BE RESPONSIBLE FOR OBTAINING ALL NECESSARY PERMITS AND APPROVALS FROM THE CITY OF HOUSTON AND THE STATE OF TEXAS. THE CONTRACTOR SHALL BE RESPONSIBLE FOR OBTAINING ALL NECESSARY PERMITS AND APPROVALS FROM THE CITY OF HOUSTON AND THE STATE OF TEXAS. THE CONTRACTOR SHALL BE RESPONSIBLE FOR OBTAINING ALL NECESSARY PERMITS AND APPROVALS FROM THE CITY OF HOUSTON AND THE STATE OF TEXAS.

FOR CONTROL SEE SHEET 2
 FOR GRADING OF ENTIRE SITE,
 SEE OVERLAY & GRADING LAYOUT
 SHEET 8
 EXISTING CONTOURS INDICATED ON
 THIS SHEET ARE TO BE MAINTAINED
 CLEARING & STRIPPING.



CAUTION!
 EXISTING GROUND
 GAS PIPELINE

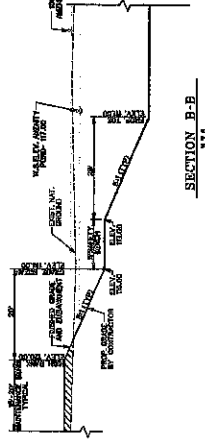
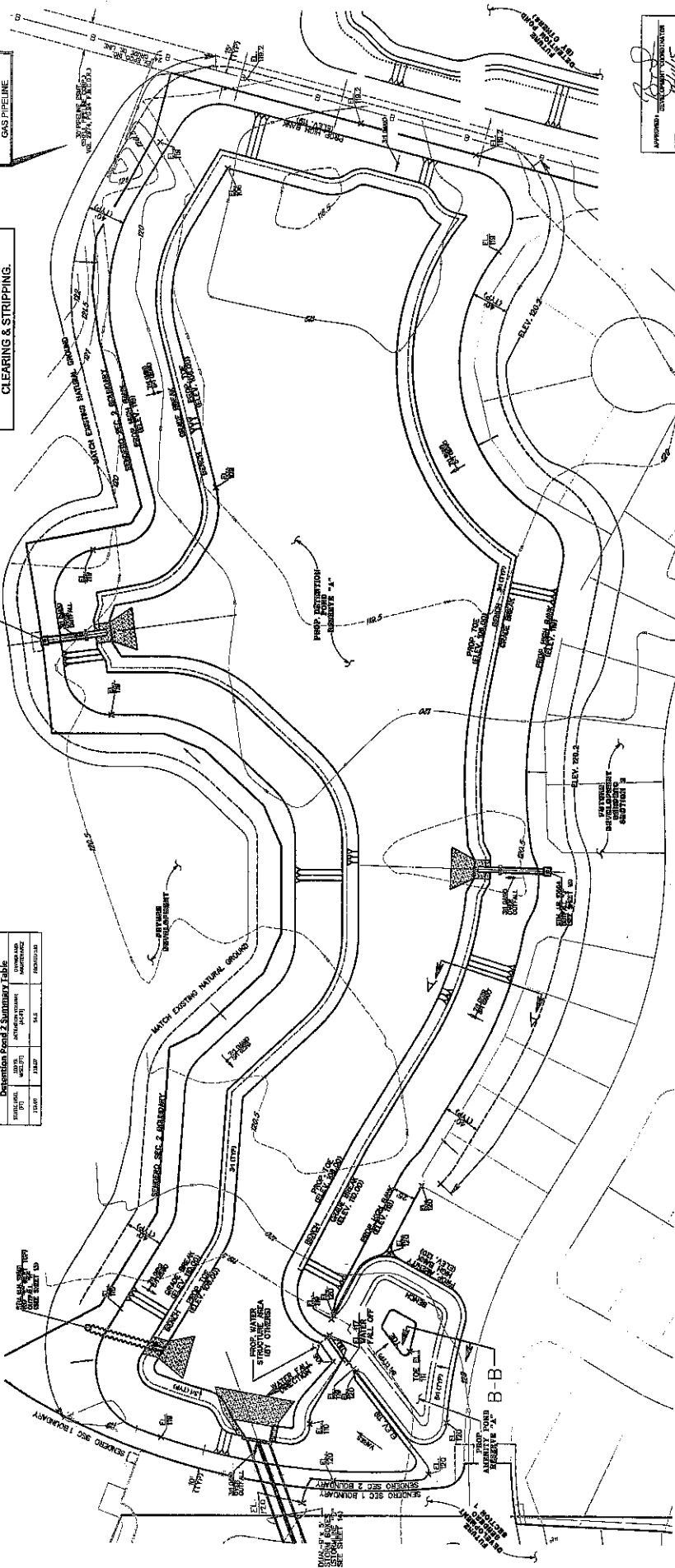

SECTION A-A

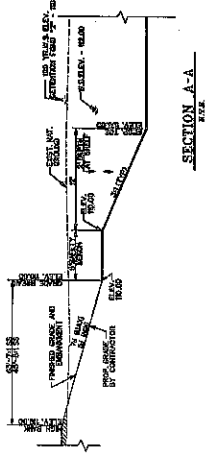

SECTION B-B

| Detention Pond 2 Summary Table | | | |
|--------------------------------|----------|--------------------------|----|
| NO. | DATE | DESCRIPTION | BY |
| 1 | 10/15/05 | ISSUED FOR PERMITS | JK |
| 2 | 11/15/05 | REVISED FOR GRADING | JK |
| 3 | 12/15/05 | REVISED FOR CONSTRUCTION | JK |

APPROVED: [Signature]
 DATE: 11/15/05
 CITY OF HOUSTON
 PUBLIC WORKS DEPARTMENT
 PROJECT: FORT BEND COUNTY MUD 132
 SHEET: 8 OF 26



FORT BEND COUNTY MUD 132
 SENDERO DETENTION PHASE 1
 DETENTION POND "2"
 GRADING LAYOUT

Engineering and Surveying
 8980 Richmond Avenue, Suite 460 N
 Houston, Texas 77042
 (713) 782-7788 (713) 782-3880, Fax
 TEXAS FIRM REG. NO. 280
 TEP'S FIRM REG. NO. 10466



DESIGNED BY: JK
 DRAWN BY: JK
 CHECKED BY: JK
 DATE: 11-20-05

| NO. | DATE | BY | REVISION |
|-----|------|----|----------|
| | | | |
| | | | |

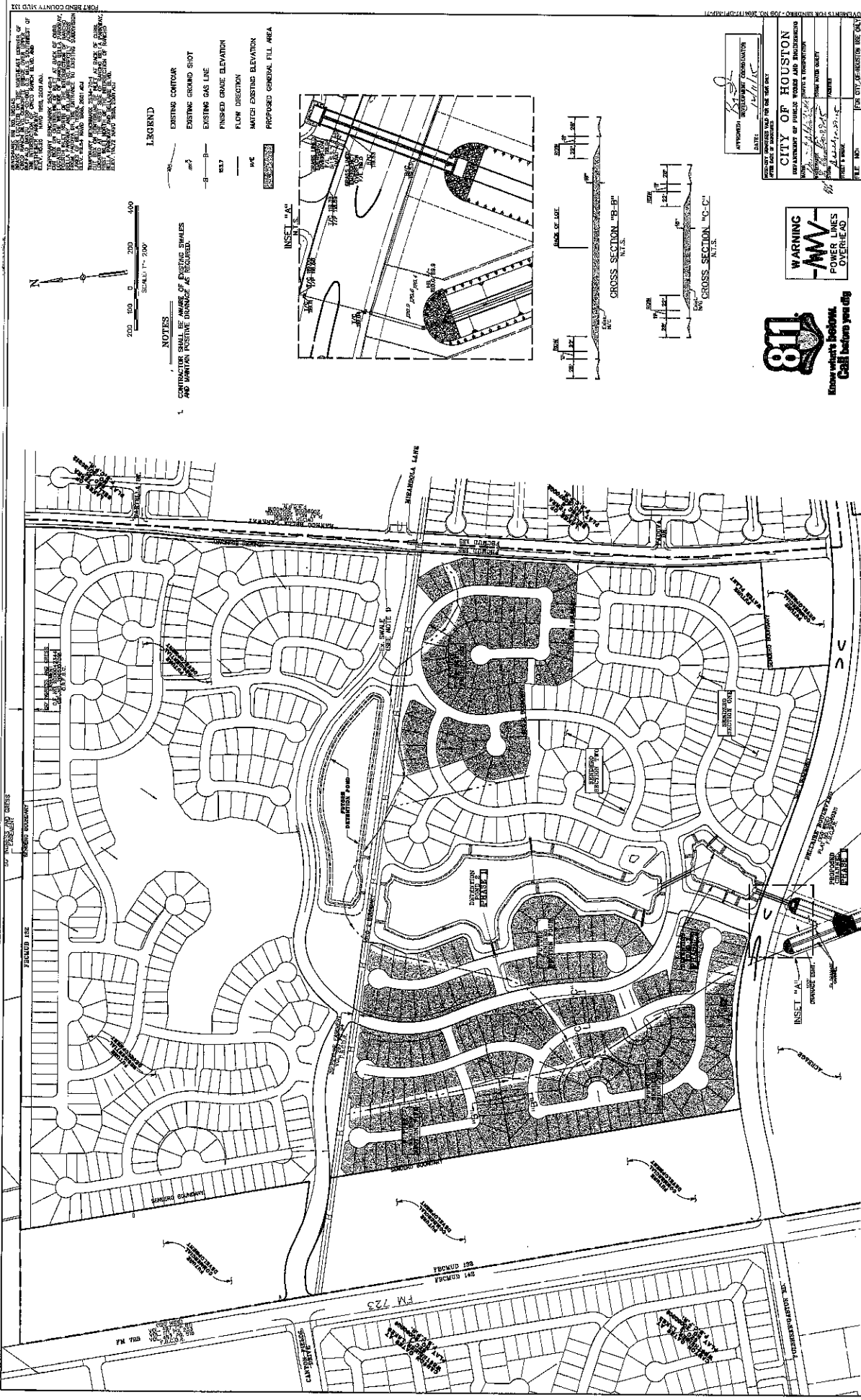

| | | | |
|---|--|---|--|
| <p>NOTES</p> <p>CONTRACTOR SHALL BE AWARE OF EXISTING SHALES AND MAINTAIN POSITIVE DRAINAGE AS REQUIRED.</p> | | <p>LEGEND</p> <p>EXISTING CONTOUR</p> <p>EXISTING GROUND SHOT</p> <p>EXISTING GAS LINE</p> <p>FINISHED GRADE ELEVATION</p> <p>FLOW DIRECTION</p> <p>MATCH EXISTING ELEVATION</p> <p>PROPOSED GENERAL FILL AREA</p> | |
| <p>200 100 0 100 200</p> <p>SCALE: 1" = 200'</p> | | <p>INSET "A-A"</p> <p>INSET "B-B"</p> <p>INSET "C-C"</p> | |
| <p>APPROVED: [Signature]</p> <p>DATE: 11/11/11</p> | | <p>APPROVED: [Signature]</p> <p>DATE: 11/11/11</p> | |
| <p>CITY OF HOUSTON</p> <p>ENGINEERING DEPARTMENT</p> <p>34931</p> | | <p>FOR CITY OF HOUSTON USE ONLY</p> <p>FILE NO:</p> <p>DRAWING SCALE: 1" = 200'</p> <p>SHEET NO: 9 of 26</p> | |
| <p>WARNING</p> <p>811</p> <p>Know what's below.</p> <p>Call before you dig.</p> | | <p>Costello</p> <p>Engineering and Surveying</p> <p>9890 Richmond Avenue, Suite 450 N</p> <p>Houston, Texas 77042</p> <p>(713) 752-7788 (FAX) 752-5560, Fax</p> <p>TABLES FROM REG. NO. 008</p> | |
| <p>DESIGNED BY: [Signature]</p> <p>DRAWN BY: [Signature]</p> <p>CHECKED BY: [Signature]</p> <p>DATE: 12-21-11</p> | | <p>FORT BEND COUNTY MUD 132</p> <p>SANDER DETENTION PHASE 1</p> <p>OVERALL FILL & GRADING LAYOUT</p> | |

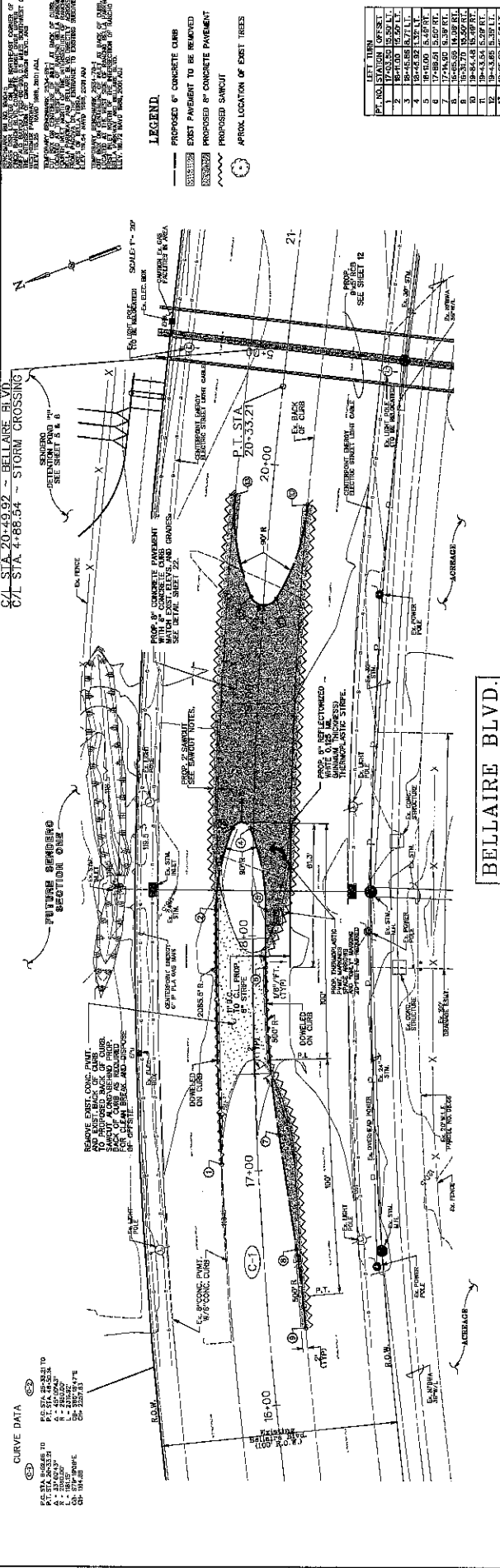

| PT. NO. | STATION | OFFSET |
|---------|---------|-----------|
| 1 | 15+00 | 15.00 FT. |
| 2 | 16+00 | 16.00 FT. |
| 3 | 16+50 | 16.50 FT. |
| 4 | 17+00 | 17.00 FT. |
| 5 | 17+50 | 17.50 FT. |
| 6 | 18+00 | 18.00 FT. |
| 7 | 18+50 | 18.50 FT. |
| 8 | 19+00 | 19.00 FT. |
| 9 | 19+50 | 19.50 FT. |
| 10 | 20+00 | 20.00 FT. |
| 11 | 20+50 | 20.50 FT. |
| 12 | 21+00 | 21.00 FT. |

| PT. NO. | STATION | OFFSET |
|---------|---------|-----------|
| 1 | 22+00 | 22.00 FT. |
| 2 | 22+50 | 22.50 FT. |
| 3 | 23+00 | 23.00 FT. |
| 4 | 23+50 | 23.50 FT. |
| 5 | 24+00 | 24.00 FT. |
| 6 | 24+50 | 24.50 FT. |
| 7 | 25+00 | 25.00 FT. |
| 8 | 25+50 | 25.50 FT. |
| 9 | 26+00 | 26.00 FT. |
| 10 | 26+50 | 26.50 FT. |
| 11 | 27+00 | 27.00 FT. |
| 12 | 27+50 | 27.50 FT. |
| 13 | 28+00 | 28.00 FT. |

| PT. NO. | STATION | OFFSET |
|---------|---------|-----------|
| 1 | 29+00 | 29.00 FT. |
| 2 | 29+50 | 29.50 FT. |
| 3 | 30+00 | 30.00 FT. |
| 4 | 30+50 | 30.50 FT. |
| 5 | 31+00 | 31.00 FT. |
| 6 | 31+50 | 31.50 FT. |
| 7 | 32+00 | 32.00 FT. |
| 8 | 32+50 | 32.50 FT. |
| 9 | 33+00 | 33.00 FT. |
| 10 | 33+50 | 33.50 FT. |
| 11 | 34+00 | 34.00 FT. |
| 12 | 34+50 | 34.50 FT. |
| 13 | 35+00 | 35.00 FT. |

| PT. NO. | STATION | OFFSET |
|---------|---------|-----------|
| 1 | 36+00 | 36.00 FT. |
| 2 | 36+50 | 36.50 FT. |
| 3 | 37+00 | 37.00 FT. |
| 4 | 37+50 | 37.50 FT. |
| 5 | 38+00 | 38.00 FT. |
| 6 | 38+50 | 38.50 FT. |
| 7 | 39+00 | 39.00 FT. |
| 8 | 39+50 | 39.50 FT. |
| 9 | 40+00 | 40.00 FT. |
| 10 | 40+50 | 40.50 FT. |
| 11 | 41+00 | 41.00 FT. |
| 12 | 41+50 | 41.50 FT. |
| 13 | 42+00 | 42.00 FT. |

| PT. NO. | STATION | OFFSET |
|---------|---------|-----------|
| 1 | 43+00 | 43.00 FT. |
| 2 | 43+50 | 43.50 FT. |
| 3 | 44+00 | 44.00 FT. |
| 4 | 44+50 | 44.50 FT. |
| 5 | 45+00 | 45.00 FT. |
| 6 | 45+50 | 45.50 FT. |
| 7 | 46+00 | 46.00 FT. |
| 8 | 46+50 | 46.50 FT. |
| 9 | 47+00 | 47.00 FT. |
| 10 | 47+50 | 47.50 FT. |
| 11 | 48+00 | 48.00 FT. |
| 12 | 48+50 | 48.50 FT. |
| 13 | 49+00 | 49.00 FT. |

| PT. NO. | STATION | OFFSET |
|---------|---------|-----------|
| 1 | 50+00 | 50.00 FT. |
| 2 | 50+50 | 50.50 FT. |
| 3 | 51+00 | 51.00 FT. |
| 4 | 51+50 | 51.50 FT. |
| 5 | 52+00 | 52.00 FT. |
| 6 | 52+50 | 52.50 FT. |
| 7 | 53+00 | 53.00 FT. |
| 8 | 53+50 | 53.50 FT. |
| 9 | 54+00 | 54.00 FT. |
| 10 | 54+50 | 54.50 FT. |
| 11 | 55+00 | 55.00 FT. |
| 12 | 55+50 | 55.50 FT. |
| 13 | 56+00 | 56.00 FT. |

| PT. NO. | STATION | OFFSET |
|---------|---------|-----------|
| 1 | 57+00 | 57.00 FT. |
| 2 | 57+50 | 57.50 FT. |
| 3 | 58+00 | 58.00 FT. |
| 4 | 58+50 | 58.50 FT. |
| 5 | 59+00 | 59.00 FT. |
| 6 | 59+50 | 59.50 FT. |
| 7 | 60+00 | 60.00 FT. |
| 8 | 60+50 | 60.50 FT. |
| 9 | 61+00 | 61.00 FT. |
| 10 | 61+50 | 61.50 FT. |
| 11 | 62+00 | 62.00 FT. |
| 12 | 62+50 | 62.50 FT. |
| 13 | 63+00 | 63.00 FT. |

| PT. NO. | STATION | OFFSET |
|---------|---------|-----------|
| 1 | 64+00 | 64.00 FT. |
| 2 | 64+50 | 64.50 FT. |
| 3 | 65+00 | 65.00 FT. |
| 4 | 65+50 | 65.50 FT. |
| 5 | 66+00 | 66.00 FT. |
| 6 | 66+50 | 66.50 FT. |
| 7 | 67+00 | 67.00 FT. |
| 8 | 67+50 | 67.50 FT. |
| 9 | 68+00 | 68.00 FT. |
| 10 | 68+50 | 68.50 FT. |
| 11 | 69+00 | 69.00 FT. |
| 12 | 69+50 | 69.50 FT. |
| 13 | 70+00 | 70.00 FT. |

| PT. NO. | STATION | OFFSET |
|---------|---------|-----------|
| 1 | 71+00 | 71.00 FT. |
| 2 | 71+50 | 71.50 FT. |
| 3 | 72+00 | 72.00 FT. |
| 4 | 72+50 | 72.50 FT. |
| 5 | 73+00 | 73.00 FT. |
| 6 | 73+50 | 73.50 FT. |
| 7 | 74+00 | 74.00 FT. |
| 8 | 74+50 | 74.50 FT. |
| 9 | 75+00 | 75.00 FT. |
| 10 | 75+50 | 75.50 FT. |
| 11 | 76+00 | 76.00 FT. |
| 12 | 76+50 | 76.50 FT. |
| 13 | 77+00 | 77.00 FT. |

| PT. NO. | STATION | OFFSET |
|---------|---------|-----------|
| 1 | 78+00 | 78.00 FT. |
| 2 | 78+50 | 78.50 FT. |
| 3 | 79+00 | 79.00 FT. |
| 4 | 79+50 | 79.50 FT. |
| 5 | 80+00 | 80.00 FT. |
| 6 | 80+50 | 80.50 FT. |
| 7 | 81+00 | 81.00 FT. |
| 8 | 81+50 | 81.50 FT. |
| 9 | 82+00 | 82.00 FT. |
| 10 | 82+50 | 82.50 FT. |
| 11 | 83+00 | 83.00 FT. |
| 12 | 83+50 | 83.50 FT. |
| 13 | 84+00 | 84.00 FT. |

| PT. NO. | STATION | OFFSET |
|---------|---------|-----------|
| 1 | 85+00 | 85.00 FT. |
| 2 | 85+50 | 85.50 FT. |
| 3 | 86+00 | 86.00 FT. |
| 4 | 86+50 | 86.50 FT. |
| 5 | 87+00 | 87.00 FT. |
| 6 | 87+50 | 87.50 FT. |
| 7 | 88+00 | 88.00 FT. |
| 8 | 88+50 | 88.50 FT. |
| 9 | 89+00 | 89.00 FT. |
| 10 | 89+50 | 89.50 FT. |
| 11 | 90+00 | 90.00 FT. |
| 12 | 90+50 | 90.50 FT. |
| 13 | 91+00 | 91.00 FT. |

| PT. NO. | STATION | OFFSET |
|---------|---------|-----------|
| 1 | 92+00 | 92.00 FT. |
| 2 | 92+50 | 92.50 FT. |
| 3 | 93+00 | 93.00 FT. |
| 4 | 93+50 | 93.50 FT. |
| 5 | 94+00 | 94.00 FT. |
| 6 | 94+50 | 94.50 FT. |
| 7 | 95+00 | 95.00 FT. |
| 8 | 95+50 | 95.50 FT. |
| 9 | 96+00 | 96.00 FT. |
| 10 | 96+50 | 96.50 FT. |
| 11 | 97+00 | 97.00 FT. |
| 12 | 97+50 | 97.50 FT. |
| 13 | 98+00 | 98.00 FT. |

| PT. NO. | STATION | OFFSET |
|---------|---------|------------|
| 1 | 99+00 | 99.00 FT. |
| 2 | 99+50 | 99.50 FT. |
| 3 | 100+00 | 100.00 FT. |
| 4 | 100+50 | 100.50 FT. |
| 5 | 101+00 | 101.00 FT. |
| 6 | 101+50 | 101.50 FT. |
| 7 | 102+00 | 102.00 FT. |
| 8 | 102+50 | 102.50 FT. |
| 9 | 103+00 | 103.00 FT. |
| 10 | 103+50 | 103.50 FT. |
| 11 | 104+00 | 104.00 FT. |
| 12 | 104+50 | 104.50 FT. |
| 13 | 105+00 | 105.00 FT. |

| PT. NO. | STATION | OFFSET |
|---------|---------|------------|
| 1 | 106+00 | 106.00 FT. |
| 2 | 106+50 | 106.50 FT. |
| 3 | 107+00 | 107.00 FT. |
| 4 | 107+50 | 107.50 FT. |
| 5 | 108+00 | 108.00 FT. |
| 6 | 108+50 | 108.50 FT. |
| 7 | 109+00 | 109.00 FT. |
| 8 | 109+50 | 109.50 FT. |
| 9 | 110+00 | 110.00 FT. |
| 10 | 110+50 | 110.50 FT. |
| 11 | 111+00 | 111.00 FT. |
| 12 | 111+50 | 111.50 FT. |
| 13 | 112+00 | 112.00 FT. |

| PT. NO. | STATION | OFFSET |
|---------|---------|------------|
| 1 | 113+00 | 113.00 FT. |
| 2 | 113+50 | 113.50 FT. |
| 3 | 114+00 | 114.00 FT. |
| 4 | 114+50 | 114.50 FT. |
| 5 | 115+00 | 115.00 FT. |
| 6 | 115+50 | 115.50 FT. |
| 7 | 116+00 | 116.00 FT. |
| 8 | 116+50 | 116.50 FT. |
| 9 | 117+00 | 117.00 FT. |
| 10 | 117+50 | 117.50 FT. |
| 11 | 118+00 | 118.00 FT. |
| 12 | 118+50 | 118.50 FT. |
| 13 | 119+00 | 119.00 FT. |

| PT. NO. | STATION | OFFSET |
|---------|---------|------------|
| 1 | 120+00 | 120.00 FT. |
| 2 | 120+50 | 120.50 FT. |
| 3 | 121+00 | 121.00 FT. |
| 4 | 121+50 | 121.50 FT. |
| 5 | 122+00 | 122.00 FT. |
| 6 | 122+50 | 122.50 FT. |
| 7 | 123+00 | 123.00 FT. |
| 8 | 123+50 | 123.50 FT. |
| 9 | 124+00 | 124.00 FT. |
| 10 | 124+50 | 124.50 FT. |
| 11 | 125+00 | 125.00 FT. |
| 12 | 125+50 | 125.50 FT. |
| 13 | 126+00 | 126.00 FT. |

| PT. NO. | STATION | OFFSET |
|---------|---------|------------|
| 1 | 127+00 | 127.00 FT. |
| 2 | 127+50 | 127.50 FT. |
| 3 | 128+00 | 128.00 FT. |
| 4 | 128+50 | 128.50 FT. |
| 5 | 129+00 | 129.00 FT. |
| 6 | 129+50 | 129.50 FT. |
| 7 | 130+00 | 130.00 FT. |
| 8 | 130+50 | 130.50 FT. |
| 9 | 131+00 | 131.00 FT. |
| 10 | 131+50 | 131.50 FT. |
| 11 | 132+00 | 132.00 FT. |
| 12 | 132+50 | 132.50 FT. |
| 13 | 133+00 | 133.00 FT. |

| PT. NO. | STATION | OFFSET |
|---------|---------|------------|
| 1 | 134+00 | 134.00 FT. |
| 2 | 134+50 | 134.50 FT. |
| 3 | 135+00 | 135.00 FT. |
| 4 | 135+50 | 135.50 FT. |
| 5 | 136+00 | 136.00 FT. |
| 6 | 136+50 | 136.50 FT. |
| 7 | 137+00 | 137.00 FT. |
| 8 | 137+50 | 137.50 FT. |
| 9 | 138+00 | 138.00 FT. |
| 10 | 138+50 | 138.50 FT. |
| 11 | 139+00 | 139.00 FT. |
| 12 | 139+50 | 139.50 FT. |
| 13 | 140+00 | 140.00 FT. |

| PT. NO. | STATION | OFFSET |
|---------|---------|------------|
| 1 | 141+00 | 141.00 FT. |
| 2 | 141+50 | 141.50 FT. |
| 3 | 142+00 | 142.00 FT. |
| 4 | 142+50 | 142.50 FT. |
| 5 | 143+00 | 143.00 FT. |
| 6 | 143+50 | 143.50 FT. |
| 7 | 144+00 | 144.00 FT. |
| 8 | 144+50 | 144.50 FT. |
| 9 | 145+00 | 145.00 FT. |
| 10 | 145+50 | 145.50 FT. |
| 11 | 146+00 | 146.00 FT. |
| 12 | 146+50 | 146.50 FT. |
| 13 | 147+00 | 147.00 FT. |

| PT. NO. | STATION | OFFSET |
|---------|---------|------------|
| 1 | 148+00 | 148.00 FT. |
| 2 | 148+50 | 148.50 FT. |
| 3 | 149+00 | 149.00 FT. |
| 4 | 149+50 | 149.50 FT. |
| 5 | 150+00 | 150.00 FT. |
| 6 | 150+50 | 150.50 FT. |
| 7 | 151+00 | 151.00 FT. |
| 8 | 151+50 | 151.50 FT. |
| 9 | 152+00 | 152.00 FT. |
| 10 | 152+50 | 152.50 FT. |
| 11 | 153+00 | 153.00 FT. |
| 12 | 153+50 | 153.50 FT. |
| 13 | 154+00 | 154.00 FT. |

| PT. NO. | STATION | OFFSET |
|---------|---------|------------|
| 1 | 155+00 | 155.00 FT. |
| 2 | 155+50 | 155.50 FT. |
| 3 | 156+00 | 156.00 FT. |
| 4 | 156+50 | 156.50 FT. |
| 5 | 157+00 | 157.00 FT. |
| 6 | 157+50 | 157.50 FT. |
| 7 | 158+00 | 158.00 FT. |
| 8 | 158+50 | 158.50 FT. |
| 9 | 159+00 | 159.00 FT. |
| 10 | 159+50 | 159.50 FT. |
| 11 | 160+00 | 160.00 FT. |
| 12 | 160+50 | 160.50 FT. |
| 13 | 161+00 | 161.00 FT. |

| PT. NO. | STATION | OFFSET |
|---------|---------|------------|
| 1 | 162+00 | 162.00 FT. |
| 2 | 162+50 | 162.50 FT. |
| 3 | 163+00 | 163.00 FT. |
| 4 | 163+50 | 163.50 FT. |
| 5 | 164+00 | 164.00 FT. |
| 6 | 164+50 | 164.50 FT. |
| 7 | 165+00 | 165.00 FT. |
| 8 | 165+50 | 165.50 FT. |
| 9 | 166+00 | 166.00 FT. |
| 10 | 166+50 | 166.50 FT. |
| 11 | 167+00 | 167.00 FT. |
| 12 | 167+50 | 167.50 FT. |
| 13 | 168+00 | 168.00 FT. |

| PT. NO. | STATION | OFFSET |
|---------|---------|------------|
| 1 | 169+00 | 169.00 FT. |
| 2 | 169+50 | 169.50 FT. |
| 3 | 170+00 | 170.00 FT. |
| 4 | 170+50 | 170.50 FT. |
| 5 | 171+00 | 171.00 FT. |
| 6 | 171+50 | 171.50 FT. |
| 7 | 172+00 | 172.00 FT. |
| 8 | 172+50 | 172.50 FT. |
| 9 | 173+00 | 173.00 FT. |
| 10 | 173+50 | 173.50 FT. |
| 11 | 174+00 | 174.00 FT. |
| 12 | 174+50 | 174.50 FT. |
| 13 | 175+00 | 175.00 FT. |

| PT. NO. | STATION | OFFSET |
|---------|---------|------------|
| 1 | 176+00 | 176.00 FT. |
| 2 | 176+50 | 176 |

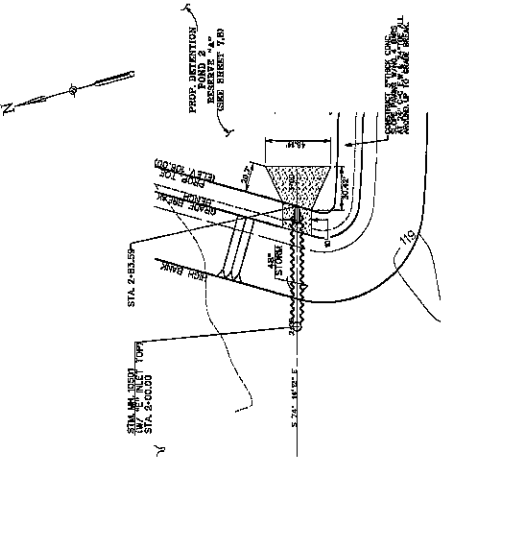
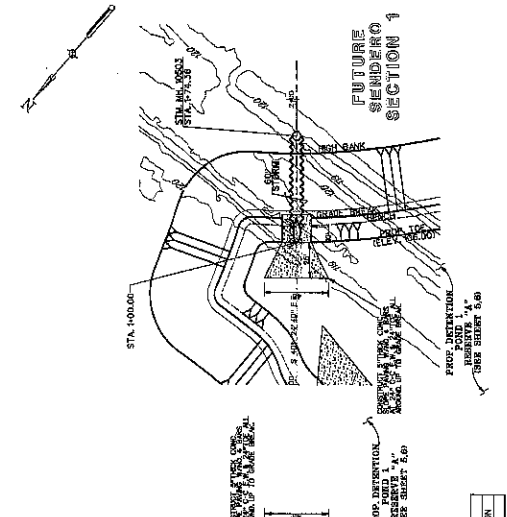
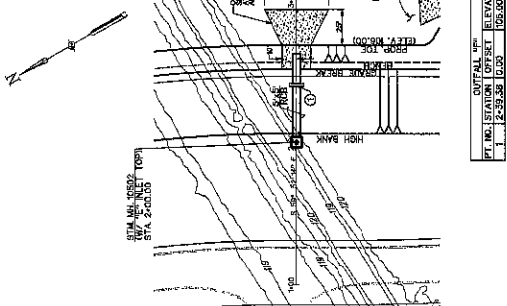

OUTFALL "F"

OUTFALL "G"

OUTFALL "H"

CONTRACTOR TO FIELD VERIFY LOCATION AND ELEVATION OF EXISTING UTILITIES PRIOR TO STARTING CONSTRUCTION

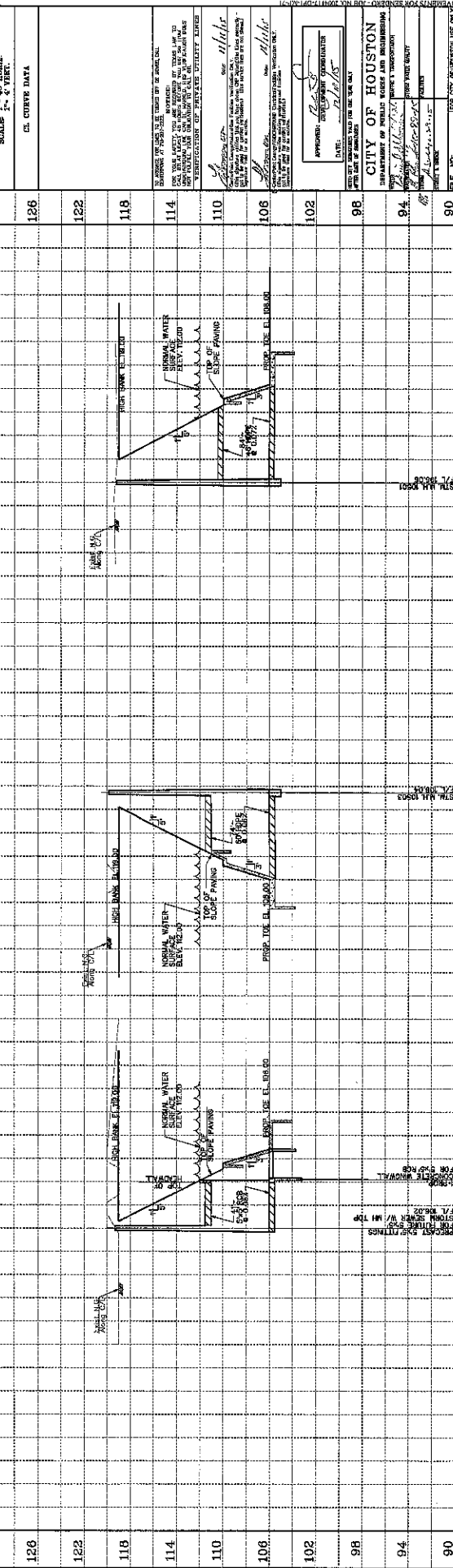

| | | | | |
|---|---|---|---|--|
| DRAWING SCALE HORIZ: 1"=40' VERT: 1"=4' SHEET NO. 13 OF 26 | CITY OF HOUSTON DEPARTMENT OF PUBLIC WORKS AND ENGINEERING DATE: 11/11/2011 APPROVED: [Signature] PROJECT: SENDERO DEPRESSION PHASE 1 | FORT BEND COUNTY MUD 132 SENDERO DEPRESSION PHASE 1 PLAN AND PROFILE OUTFALL "F", OUTFALL "G" & OUTFALL "H" | Engineering and Surveying 9990 Richmond Avenue, Suite 400 N Houston, Texas 77042 (713) 783-7800 (713) 783-8500, Fax INFO@COSTELLO-SURVEYING.COM TBS-FH-B-REG-NO. 00288 | COSTELLO SURVEYING DRAWN BY: [Signature] CHECKED BY: [Signature] SURVEY CHECKED BY: [Signature] DATE: 11/11/2011 |
|---|---|---|---|--|

SCALE: 1" = 40' HORIZ.
1" = 4' VERT.
C.S. CURVE DATA

FOR CITY OF HOUSTON USE ONLY
 FILE NO.:
 DRAWING NO.:
 SHEET NO. 13 OF 26

APPROVED: [Signature]
 DATE: 11/11/2011
 PROJECT: SENDERO DEPRESSION PHASE 1

CITY OF HOUSTON
 DEPARTMENT OF PUBLIC WORKS AND ENGINEERING

FORT BEND COUNTY MUD 132
 SENDERO DEPRESSION PHASE 1

PLAN AND PROFILE
 OUTFALL "F", OUTFALL "G"
 & OUTFALL "H"

Engineering and Surveying
 9990 Richmond Avenue, Suite 400 N
 Houston, Texas 77042
 (713) 783-7800 (713) 783-8500, Fax
 INFO@COSTELLO-SURVEYING.COM
 TBS-FH-B-REG-NO. 00288

COSTELLO SURVEYING
 DRAWN BY: [Signature]
 CHECKED BY: [Signature]
 SURVEY CHECKED BY: [Signature]
 DATE: 11/11/2011

DRAWING SCALE
 HORIZ: 1"=40'
 VERT: 1"=4'
 SHEET NO. 13 OF 26

CONTRACTOR SHALL VERIFY ALL EXISTING UTILITIES PRIOR TO STARTING CONSTRUCTION. CONTRACTOR SHALL EXCAVATE AS INDICATED IN ORDER TO EXPOSE ALL UTILITIES AND PROVIDE ADEQUATE PROTECTION. THE CONTRACTOR SHALL BE RESPONSIBLE FOR OBTAINING ALL NECESSARY PERMITS FROM THE CITY OF HOUSTON AND THE UTILITY COMPANIES. THE CONTRACTOR SHALL BE RESPONSIBLE FOR OBTAINING ALL NECESSARY PERMITS FROM THE CITY OF HOUSTON AND THE UTILITY COMPANIES. THE CONTRACTOR SHALL BE RESPONSIBLE FOR OBTAINING ALL NECESSARY PERMITS FROM THE CITY OF HOUSTON AND THE UTILITY COMPANIES.

- NOTES**
- 1. INDICATED ALL UTILITIES CLEARANCE.
 - 2. CONTRACTOR SHALL EXCAVATE AS INDICATED IN ORDER TO EXPOSE ALL UTILITIES AND PROVIDE ADEQUATE PROTECTION. THE CONTRACTOR SHALL BE RESPONSIBLE FOR OBTAINING ALL NECESSARY PERMITS FROM THE CITY OF HOUSTON AND THE UTILITY COMPANIES.

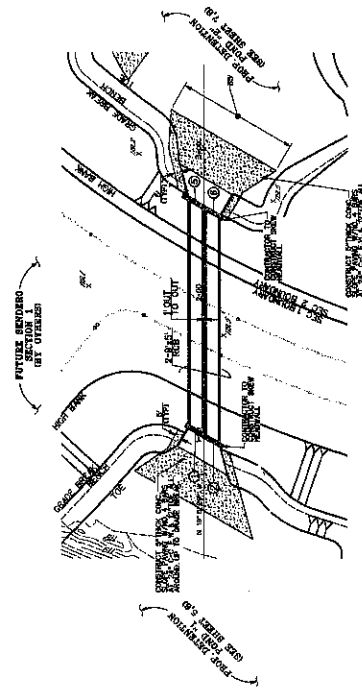

| STATION | COMMENTS |
|---------|------------------|
| 1+00.00 | 1.32' RT. 158.00 |
| 2+00.00 | 1.32' RT. 158.00 |
| 3+00.00 | 1.32' RT. 158.00 |
| 4+00.00 | 1.32' RT. 158.00 |
| 5+00.00 | 1.32' RT. 158.00 |
| 6+00.00 | 1.32' RT. 158.00 |



STORMLINE "D"

CONTRACTOR TO FIELD VERIFY LOCATION AND ELEVATION OF EXISTING UTILITIES PRIOR TO STARTING CONSTRUCTION

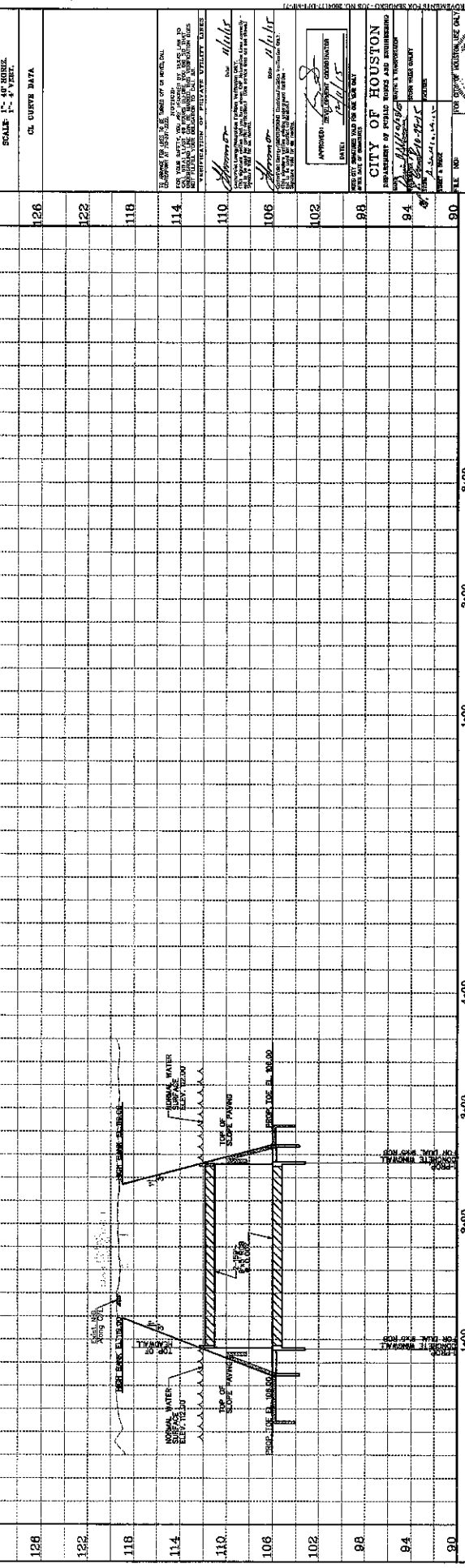

| | |
|---------------------------------|----------------|
| DESIGNED BY: <i>[Signature]</i> | DATE: 12-28-15 |
| DRAWN BY: <i>[Signature]</i> | DATE: 12-28-15 |
| CHECKED BY: <i>[Signature]</i> | DATE: 12-28-15 |
| DATE: 12-28-15 | DATE: 12-28-15 |

DESIGNED BY: *[Signature]*

DESIGNED SCALE: 3/4" = 1'-0"

VERTICAL SCALE: 1" = 4'

SHEET 14 OF 26

Costello

Engineering and Surveying
8980 Richmond Avenue, Suite 400 N
Houston, Texas 77042
(713) 755-7758 (713) 785-3556, Fax
TBPPE FIRM REG. NO. 280
TBPES FIRM REG. NO. 100468

CITY OF HOUSTON
DEPARTMENT OF PUBLIC WORKS
STORMWATER DIVISION

APPROVED: *[Signature]* DATE: 1/15/16
LEVEL: *[Signature]*

FOR CITY OF HOUSTON USE ONLY

FOR THE CITY OF HOUSTON, THE ENGINEER HAS REVIEWED THE POLLUTION PREVENTION PLAN FOR THE PROJECT AND HAS FOUND IT TO BE IN ACCORDANCE WITH THE CITY OF HOUSTON'S POLLUTION PREVENTION PLAN REQUIREMENTS. THE CITY OF HOUSTON'S POLLUTION PREVENTION PLAN REQUIREMENTS ARE SET FORTH IN THE CITY OF HOUSTON'S POLLUTION PREVENTION PLAN MANUAL, WHICH IS AVAILABLE TO THE PUBLIC AT THE OFFICE OF THE CITY ENGINEER, 1000 WEST 19TH STREET, SUITE 1000, HOUSTON, TEXAS 77002. THE CITY ENGINEER'S REVIEW IS LIMITED TO THE TECHNICAL ASPECTS OF THE PLAN AND DOES NOT CONSTITUTE A GUARANTEE OF THE ACCURACY OR COMPLETENESS OF THE INFORMATION PROVIDED HEREON. THE CONTRACTOR SHALL BE RESPONSIBLE FOR MAINTAINING THE POLLUTION PREVENTION PLAN THROUGHOUT THE PROJECT AND FOR NOTIFYING THE CITY ENGINEER OF ANY CHANGES TO THE PLAN. THE CITY ENGINEER'S REVIEW IS LIMITED TO THE TECHNICAL ASPECTS OF THE PLAN AND DOES NOT CONSTITUTE A GUARANTEE OF THE ACCURACY OR COMPLETENESS OF THE INFORMATION PROVIDED HEREON. THE CONTRACTOR SHALL BE RESPONSIBLE FOR MAINTAINING THE POLLUTION PREVENTION PLAN THROUGHOUT THE PROJECT AND FOR NOTIFYING THE CITY ENGINEER OF ANY CHANGES TO THE PLAN.

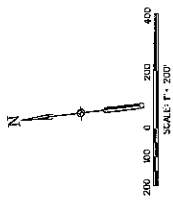

**POLLUTION PREVENTION PLAN
LEGEND**

- INLET PROTECTION BARRIER
- REINFORCED FILTER FABRIC BARRIER
- STABILIZED CONSTRUCTION ACCESS

- NOTES:**
1. PLACE FILTER FABRIC SILT FENCE 4'-6 FEET AROUND ALL INLETS.
 2. ALL SOIL STOCKPILES OF SIGNIFICANT SIZE SHALL BE ENCOMPASSED BY A SILT FENCE.
 3. ALL INCREASED SWALES TO BE CONSTRUCTED BY THE CONTRACTOR SHALL BE PLACED ACROSS THE ENTIRE SWALE, JUST UPSTREAM OF THE ORIGINAL LOCATION.
 4. CONTRACTOR SHALL MAINTAIN THE AREA FOR THE PROJECT AND BE LOCATED BY THE CONTRACTOR WHEN IN USE BY THE CONTRACTOR. THE LOCATION OF THE WASH-DOWN IS AT THE CONTRACTOR'S OPTION.
 5. ALL SWEEP FEATURES INDICATED ON THIS PLAN.
 6. ESTABLISH TIME FOR ALL AREA'S DISTURBED DURING CONSTRUCTION TO CONTINUE WITHIN 14 DAYS.
 7. UPON PROJECT COMPLETION AND FINAL STABILIZATION, ALL SILT FENCE SHALL BE REMOVED AND DISPOSED OF.

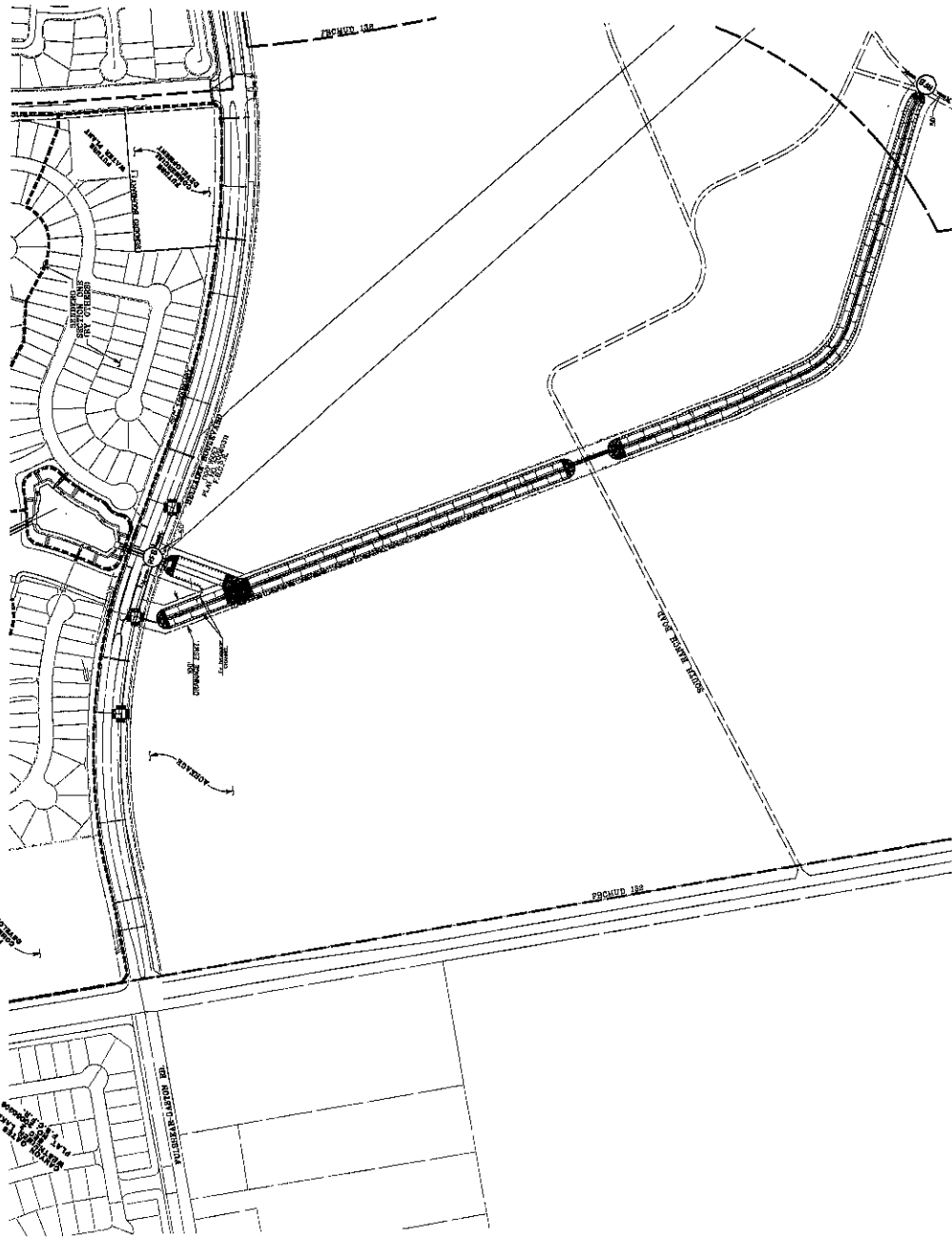

APPROVED: DATE: _____

CITY OF HOUSTON
ENGINEER

FOR THE CITY OF HOUSTON, THE ENGINEER HAS REVIEWED THE POLLUTION PREVENTION PLAN FOR THE PROJECT AND HAS FOUND IT TO BE IN ACCORDANCE WITH THE CITY OF HOUSTON'S POLLUTION PREVENTION PLAN REQUIREMENTS. THE CITY OF HOUSTON'S POLLUTION PREVENTION PLAN REQUIREMENTS ARE SET FORTH IN THE CITY OF HOUSTON'S POLLUTION PREVENTION PLAN MANUAL, WHICH IS AVAILABLE TO THE PUBLIC AT THE OFFICE OF THE CITY ENGINEER, 1000 WEST 19TH STREET, SUITE 1000, HOUSTON, TEXAS 77002. THE CITY ENGINEER'S REVIEW IS LIMITED TO THE TECHNICAL ASPECTS OF THE PLAN AND DOES NOT CONSTITUTE A GUARANTEE OF THE ACCURACY OR COMPLETENESS OF THE INFORMATION PROVIDED HEREON. THE CONTRACTOR SHALL BE RESPONSIBLE FOR MAINTAINING THE POLLUTION PREVENTION PLAN THROUGHOUT THE PROJECT AND FOR NOTIFYING THE CITY ENGINEER OF ANY CHANGES TO THE PLAN. THE CITY ENGINEER'S REVIEW IS LIMITED TO THE TECHNICAL ASPECTS OF THE PLAN AND DOES NOT CONSTITUTE A GUARANTEE OF THE ACCURACY OR COMPLETENESS OF THE INFORMATION PROVIDED HEREON. THE CONTRACTOR SHALL BE RESPONSIBLE FOR MAINTAINING THE POLLUTION PREVENTION PLAN THROUGHOUT THE PROJECT AND FOR NOTIFYING THE CITY ENGINEER OF ANY CHANGES TO THE PLAN.

811
Know what's below.
Call before you dig.

WARNING
-M-V-
POWER LINES
OVERHEAD

FOR THE CITY OF HOUSTON, THE ENGINEER HAS REVIEWED THE POLLUTION PREVENTION PLAN FOR THE PROJECT AND HAS FOUND IT TO BE IN ACCORDANCE WITH THE CITY OF HOUSTON'S POLLUTION PREVENTION PLAN REQUIREMENTS. THE CITY OF HOUSTON'S POLLUTION PREVENTION PLAN REQUIREMENTS ARE SET FORTH IN THE CITY OF HOUSTON'S POLLUTION PREVENTION PLAN MANUAL, WHICH IS AVAILABLE TO THE PUBLIC AT THE OFFICE OF THE CITY ENGINEER, 1000 WEST 19TH STREET, SUITE 1000, HOUSTON, TEXAS 77002. THE CITY ENGINEER'S REVIEW IS LIMITED TO THE TECHNICAL ASPECTS OF THE PLAN AND DOES NOT CONSTITUTE A GUARANTEE OF THE ACCURACY OR COMPLETENESS OF THE INFORMATION PROVIDED HEREON. THE CONTRACTOR SHALL BE RESPONSIBLE FOR MAINTAINING THE POLLUTION PREVENTION PLAN THROUGHOUT THE PROJECT AND FOR NOTIFYING THE CITY ENGINEER OF ANY CHANGES TO THE PLAN. THE CITY ENGINEER'S REVIEW IS LIMITED TO THE TECHNICAL ASPECTS OF THE PLAN AND DOES NOT CONSTITUTE A GUARANTEE OF THE ACCURACY OR COMPLETENESS OF THE INFORMATION PROVIDED HEREON. THE CONTRACTOR SHALL BE RESPONSIBLE FOR MAINTAINING THE POLLUTION PREVENTION PLAN THROUGHOUT THE PROJECT AND FOR NOTIFYING THE CITY ENGINEER OF ANY CHANGES TO THE PLAN.

Costello

Engineering and Surveying
9690 Richmond Avenue, Suite 450 N
Houston, Texas 77042
(713) 782-7788 (713) 782-5880 Fax
STATE FIRM REG. NO. 260
TENTH FIRM REG. NO. 100466

FORT BEND COUNTY MUD 132
SENDER DETENTION PHASE 1
POLLUTION PREVENTION LAYOUT
DETENTION POND 1
AND OFFSITE CHANNEL IMPROVEMENTS

DATE: _____ BY: _____

DESIGNED BY: DATE: _____

DRAWN BY: DATE: _____

CHECKED BY: DATE: _____

APPROVED BY: DATE: _____

| | | | |
|-----|----------|------|----|
| NO. | REVISION | DATE | BY |
| | | | |
| | | | |
| | | | |
| | | | |

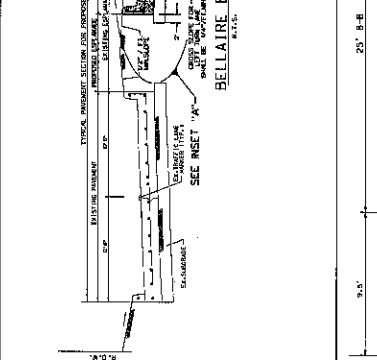
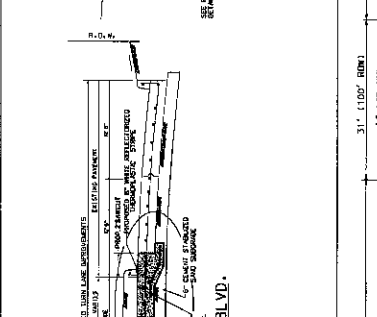
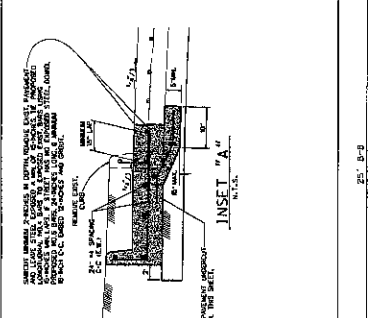
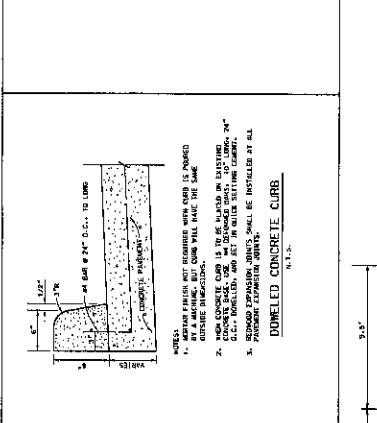
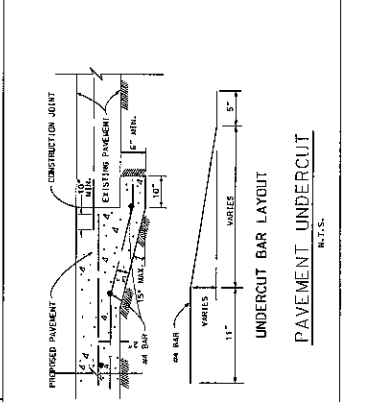
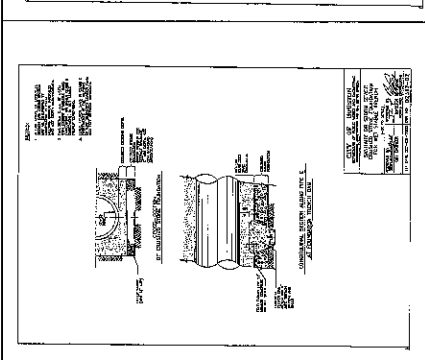
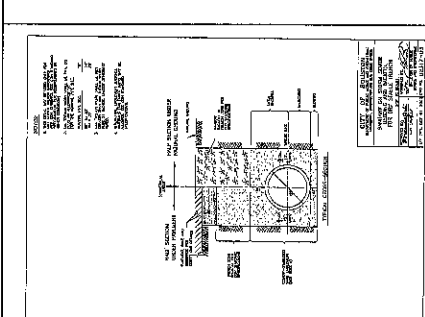
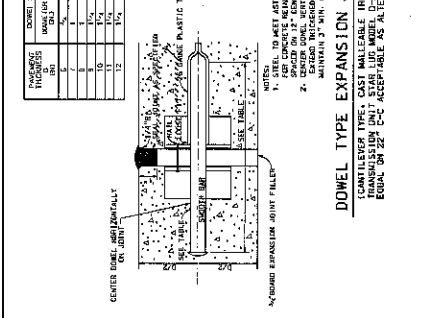
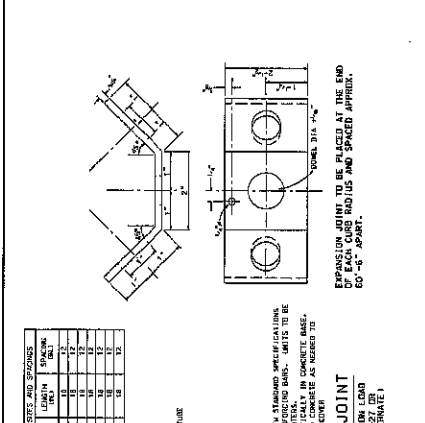
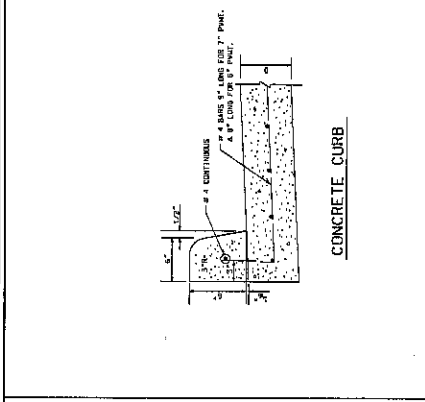

NOTES:

- ALL REINFORCING BARS SHALL BE EPOXY COATED UNLESS OTHERWISE NOTED.
- THE LOCATION OF CONSTRUCTION JOINTS AND SPACED APPROX. 60'-0" APART SHALL BE AS SHOWN ON THE DRAWINGS. THE CONTRACTOR SHALL BE RESPONSIBLE FOR THE LOCATION OF CONSTRUCTION JOINTS.
- ALL EXISTING AREAS ARE TO BE RETAINED.
- CONTRACTOR MAY SAW CUT IN LIEU OF REINFORCED METAL STRIP.

CITY OF HOUSTON
 DEPARTMENT OF PUBLIC WORKS AND ENGINEERING
 PROJECT NO. 111-2121
 SHEET NO. 22 OF 26
 DATE: NOV 22, 2016

CONCRETE TO CONCRETE STANDARD PAVEMENT JUNCTION

Engineering and Surveying
 8950 Northwest Loop West, Suite 460 N
 Houston, Texas 77049
 (713) 783-7788 (713) 783-3880, Fax
 (713) 783-7788 (713) 783-3880, Fax
 TBSLS FIRM REG. NO. 280
 TBSLS FIRM REG. NO. 100488

CONCRETE TO CONCRETE STANDARD PAVEMENT JUNCTION

APPROVED BY: [Signature]
 DESIGN CHECKED BY: [Signature]
 DRAWN BY: [Signature]
 CHECKED BY: [Signature]
 QUANTITY BY: [Signature]

CONCRETE TO CONCRETE STANDARD PAVEMENT JUNCTION

APPROVED BY: [Signature]
 DESIGN CHECKED BY: [Signature]
 DRAWN BY: [Signature]
 CHECKED BY: [Signature]
 QUANTITY BY: [Signature]

CONCRETE TO CONCRETE STANDARD PAVEMENT JUNCTION

APPROVED BY: [Signature]
 DESIGN CHECKED BY: [Signature]
 DRAWN BY: [Signature]
 CHECKED BY: [Signature]
 QUANTITY BY: [Signature]

CONCRETE TO CONCRETE STANDARD PAVEMENT JUNCTION

APPROVED BY: [Signature]
 DESIGN CHECKED BY: [Signature]
 DRAWN BY: [Signature]
 CHECKED BY: [Signature]
 QUANTITY BY: [Signature]

