

REVIEW BY FORT BEND COUNTY COMMISSIONERS COURT

On this 22nd day of March, 2016, Commissioners Court came on to be heard and reviewed the accompanying notice of AT&T Texas

Job Location Farmer Rd, Richmond, TX 77406

Date 3/1/2016 Bond No. CH1-001686693-01, Permit No. 2016-5747 to make use of certain Fort Bend County property subject to, "A Revised Order Regulating the Laying, Construction, Maintenance, and Repair of Buried Cables, Conduits, and Pole Lines, In, Under, Across or Along Roads, Streets, Highways, and Drainage Ditches in Fort Bend County, Texas, Under the Jurisdiction of the Commissioners Court of Fort Bend County, Texas," as passed by the Commissioners Court of Fort Bend County, Texas the 3rd day of August, 1987, recorded in Volume _____ of the Minutes of the Commissioners Court of Fort Bend County, Texas, to the extent that such order is not inconsistent with Article 1436a, Vernon's Texas Civil Statutes. Upon Motion of Commissioner _____, seconded by Commissioner _____,

_____ , duly put and carried, it is ORDERED, ADJUDGED AND DECREED that said notice of said above purpose is hereby acknowledged by the Commissioners Court of Fort Bend County, Texas, and that said notice be placed on record according to the regulation order thereof.

Notes:

1. Evidence of review by the Commissioners Court must be kept on the job site and failure to do so constitutes grounds for job shutdown.
2. Written notices are required:
 - a. 48 hours in advance of construction start up, and
 - b. when construction is completed and ready for final inspection
 Mail notices to: Permit Administrator
 Fort Bend County Engineering
 301 Jackson Street
 Richmond, Texas 77469
 281-633-7500
3. This permit expires one (1) year from date of permit if construction has not commenced.

By: _____
County Engineer

Presented to Commissioners Court and approved.
Recorded In Volume

Minutes of Commissioners Court

By: _____
Drainage District Engineer/Manager

Clerk of Commissioners Court

By: _____
Deputy

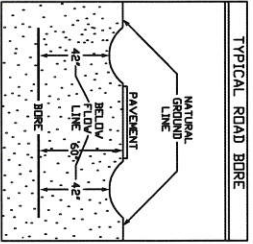

LEGEND

	PROPOSED BURIED FIBER
	EXISTING BURIED CABLE
	EDGE OF PAVEMENT/CONCRETE
	RIGHT OF WAY
	POWER POLE
	EXISTING PEDESTAL

FORT BEND COUNTY NOTIFICATION

ATTN CONTRACT:
MIKE BRIDGES
FOR FORT BEND COUNTY
REF: 201-341-4312

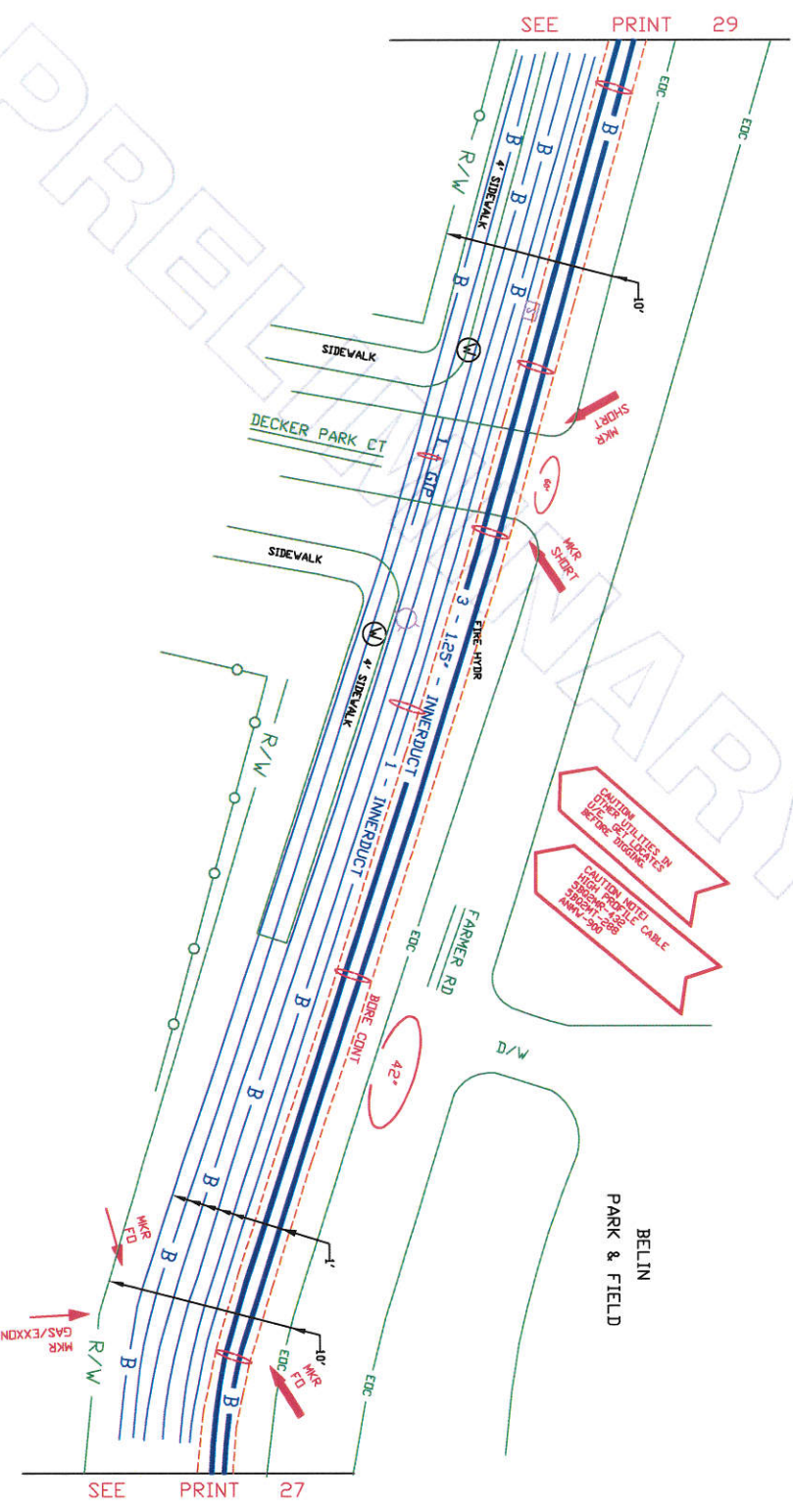
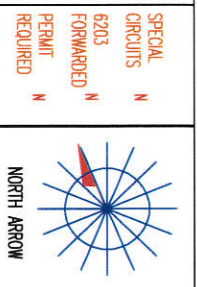

Not for use or disclosure outside the AT&T companies except under written agreement.

SPECIAL CIRCUITS	N
FORWARDED PERMIT REQUIRED	N
OPERATING RANGE OF JOB STEPS	TASK _____ TO _____
MFR	TRANSMISSION ZONE
RZ 0	CZ 0
CAUTION HIGH VOLTAGE BURIED	TAPER CODE 16365
AV 1200	PERM 1
HIGHWAY PERMIT NO.	
UTILITY CO	REP NAME
REP TEL NO.	REP TEL NO.
POLE CONTACTS (+) 0	POLE CONTACTS (-) 0
UTILITY CO	REP NAME
REP TEL NO.	REP TEL NO.
POLE CONTACTS (+) 0	POLE CONTACTS (-) 0
PROJECT NO A00K61	PRINT NO. 28
TOT PRINTS 42	NPA/NNX: 281-232
EXCH: RICH-RDCE	TAX. DIST. 16005
GEO LOC. V08232	ENGR. HB
TELEPHONE NO. (281) 341-4312	REC. REF. 232-280-34
MAP REF. 566E	SCALE NINE
ISSUE DATE	PROJ. TITLE R1526 D1 FBR RLF
REV. NUMBER	REV. NUMBER
DATE REV.	

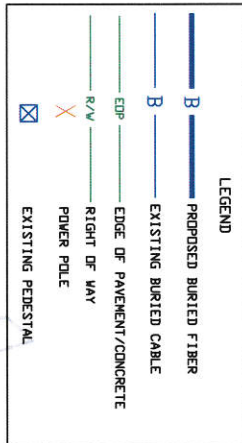
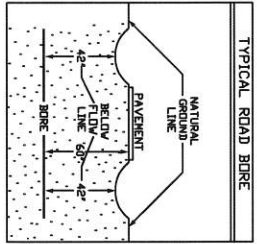

FORT BEND COUNTY NOTIFICATION

AT&T CONTACT:
 HIGGINS/BOUSSARD
 HIGGINS/DSP PLNG & ENG DESIGN
 281-341-4312

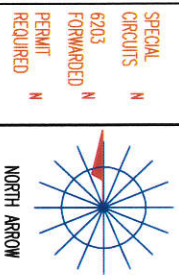

SPECIAL CIRCUITS N
 6203 FORWARDED N
 PERMIT REQUIRED N

OPERATING RANGE OF JOB STEPS
 TASK _____ TO _____

MFRG
 TRANSMISSION ZONE
 RZ 0 CZ 0 PAPER CODE 16365

CAUTION HIGH VOLTAGE BURED N
 KY 1200 AERIAL Y

HIGHWAY PERMIT NO.

UTILITY CO. CNT - CENTER POINT
 REP NAME
 REP TEL NO.
 POLE CONTACTS (+) 0 (-) 0

UTILITY CO.
 REP NAME
 REP TEL NO.
 POLE CONTACTS (+) 0 (-) 0

UTILITY CO.
 REP NAME
 REP TEL NO.
 POLE CONTACTS (+) 0 (-) 0

PROJECT NO. A00AKGL

TOT. PRINTS 4 PRINT NO. 29
 NPA/MNX: 281-432 PRT:281232
 EXCH: RICH-RDSE
 TAX DIST. 7005
 GEO LOC. 089232
 ENGR. NR DRAWING DIV
 TELEPHONE NO. (281) 341-4312
 REC. REF. 232-280-34
 MAP REF. 566E
 SCALE NONE
 ISSUE DATE
 PROJ. TITLE R15206 DLT FRP RTF
 REV. NUMBER
 DATE REV.

SEE PRINT 30

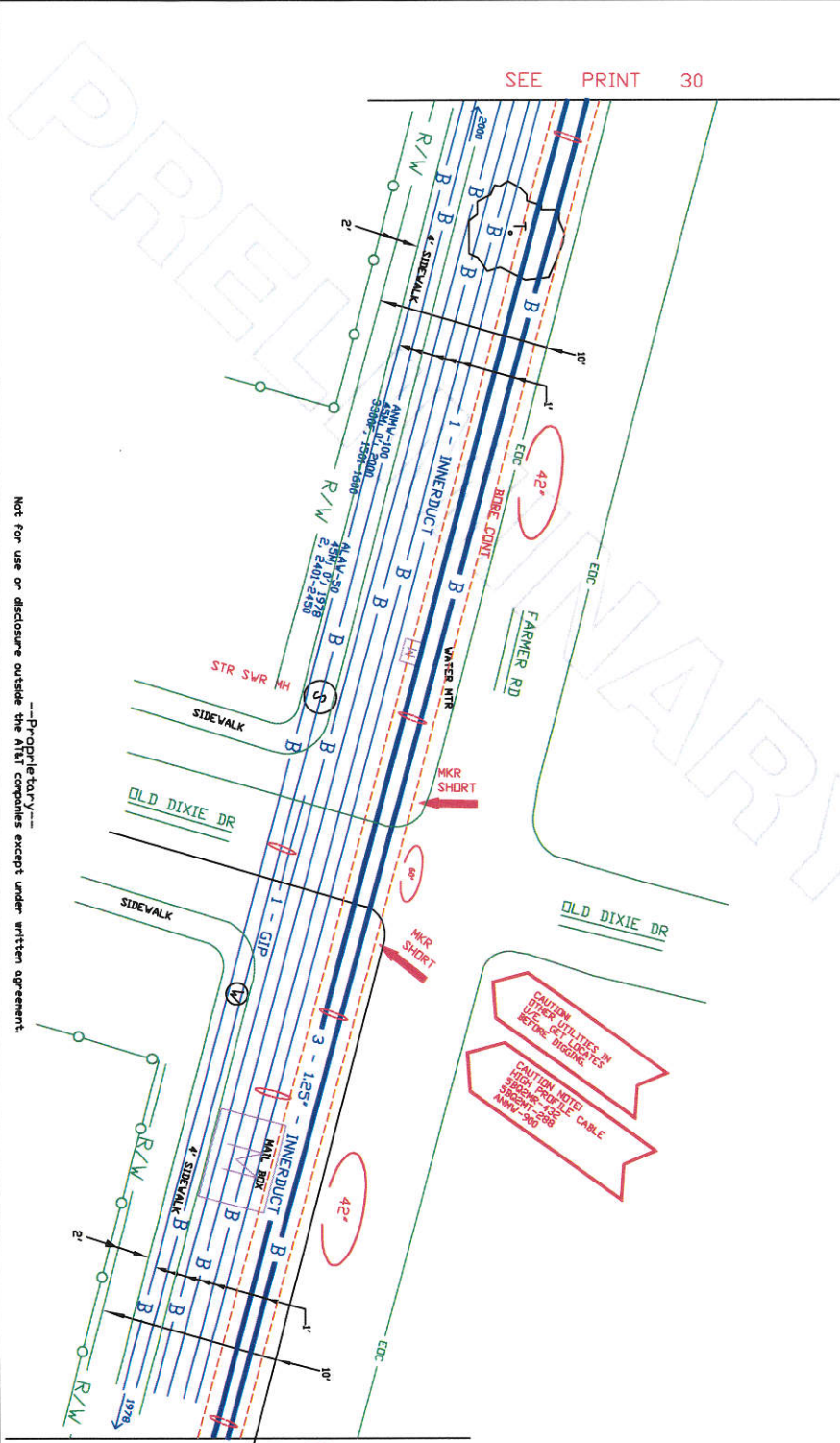

Not for use or disclosure outside the AT&T companies except under written agreement.

Proprietary

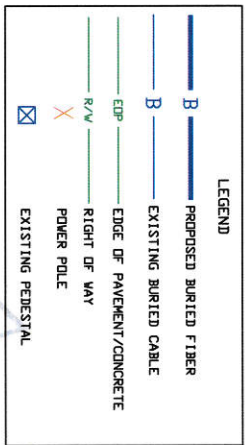
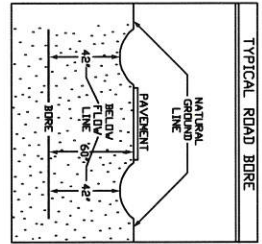

FORT BEND COUNTY NOTIFICATION

AT&T CONTRACT:
HIGH PRESSURE
281-241-4312

CAUTION: UNLITTES BY HIGH PRESSURE WATER. USE OF HOT WATER IS PROHIBITED.
CAUTION: BATTERIES IN HIGH PRESSURE WATER. BATTERIES IN WATER ARE PROHIBITED.

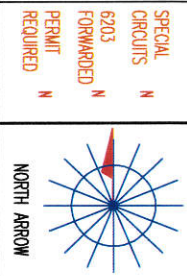
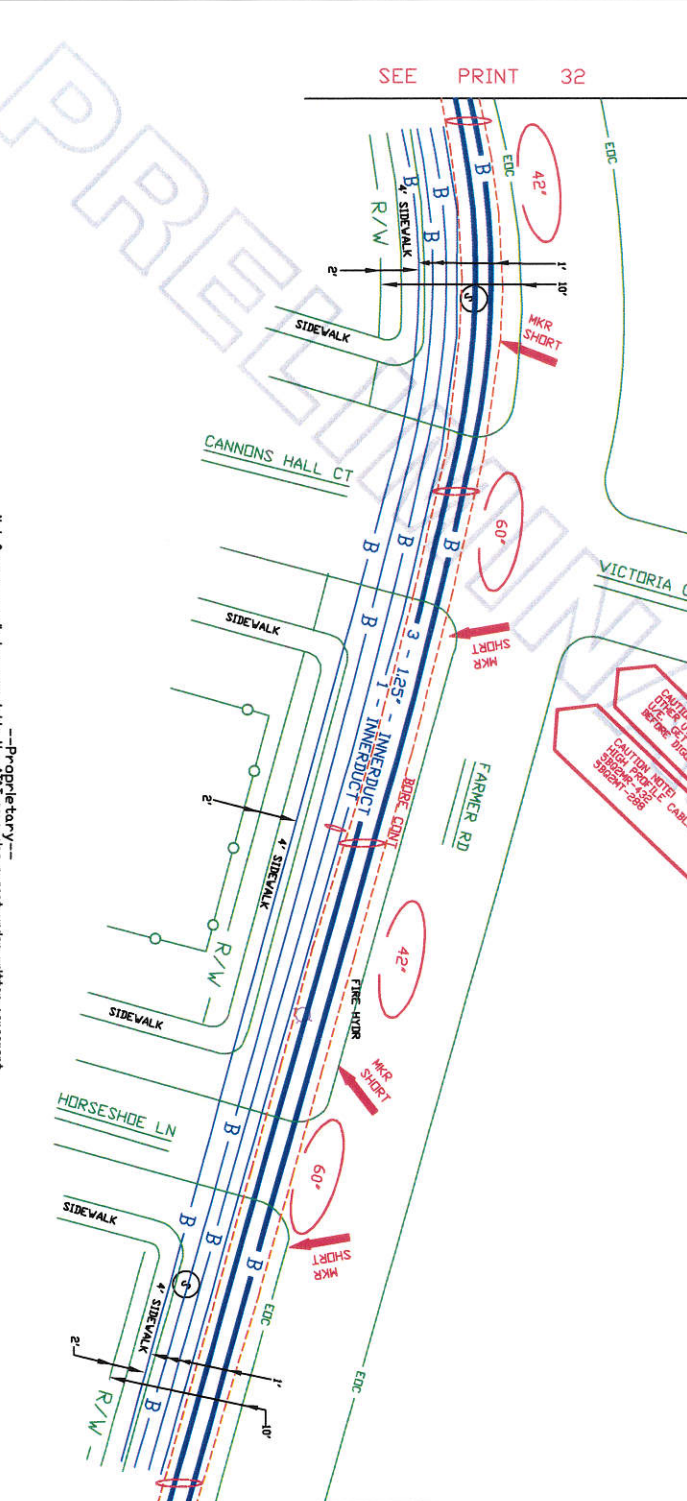

SPECIAL CIRCUITS N
6203 N
FORWARDED N
PERMIT N
REQUIRED N

OPERATING RANGE OF JOB STEPS
TASK _____ TO _____

TRANSMISSION ZONE
RZ 0 CZ 0 TAPER CODE 16365

CAUTION HIGH VOLTAGE BURED N
KV 138V AERIAL Y

HIGHWAY PERMIT NO.

UTILITY CO. CENT - CENTER POINT
REP NAME
REP TEL NO.
POLE CONTACTS (+) 0 (-) 0

UTILITY CO.
REP NAME
REP TEL NO.
POLE CONTACTS (+) 0 (-) 0

PROJECT NO. A00AKL
REP NAME
REP TEL NO.
POLE CONTACTS (+) 0 (-) 0

TOT. PRINTS 42 PRINT NO. 31
NPA/MNX: 281-22 PRT:281232
EXCH. RICH-RIDE
TAX DIST. F005
GEO LOC. W89232
ENGR. HB DRAWN/DV
TELEPHONE NO. (281) 341-4312
REC. REF. 232-280-34
MAP REF. 366E
SCALE NONE
ISSUE DATE
PROJ. TITLE R13206 DIT FOR RLF
REV. NUMBER
DATE REV.

Not for use or disclosure outside the AT&T companies except under written agreement.

PRELIMINARY

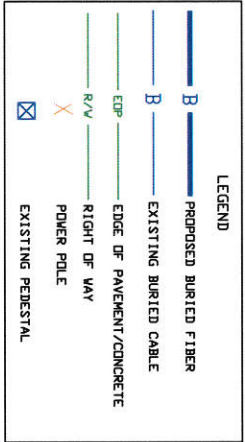
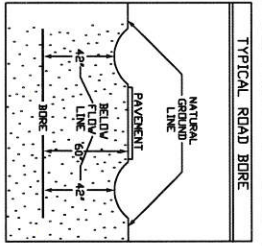

FORT BEND COUNTY NOTIFICATION

AT&T CONTRACT
 MAKE ENCLOSURE
 281C-341-4312
 & ENG DESIGN

CAUTION: OTHER UTILITIES IN ROW. GET LOCATED BEFORE DIGGING.

CAUTION: POLE-TO-POLE HIGH PROFILE CABLE. 281C-341-4312 & 281C-341-4312

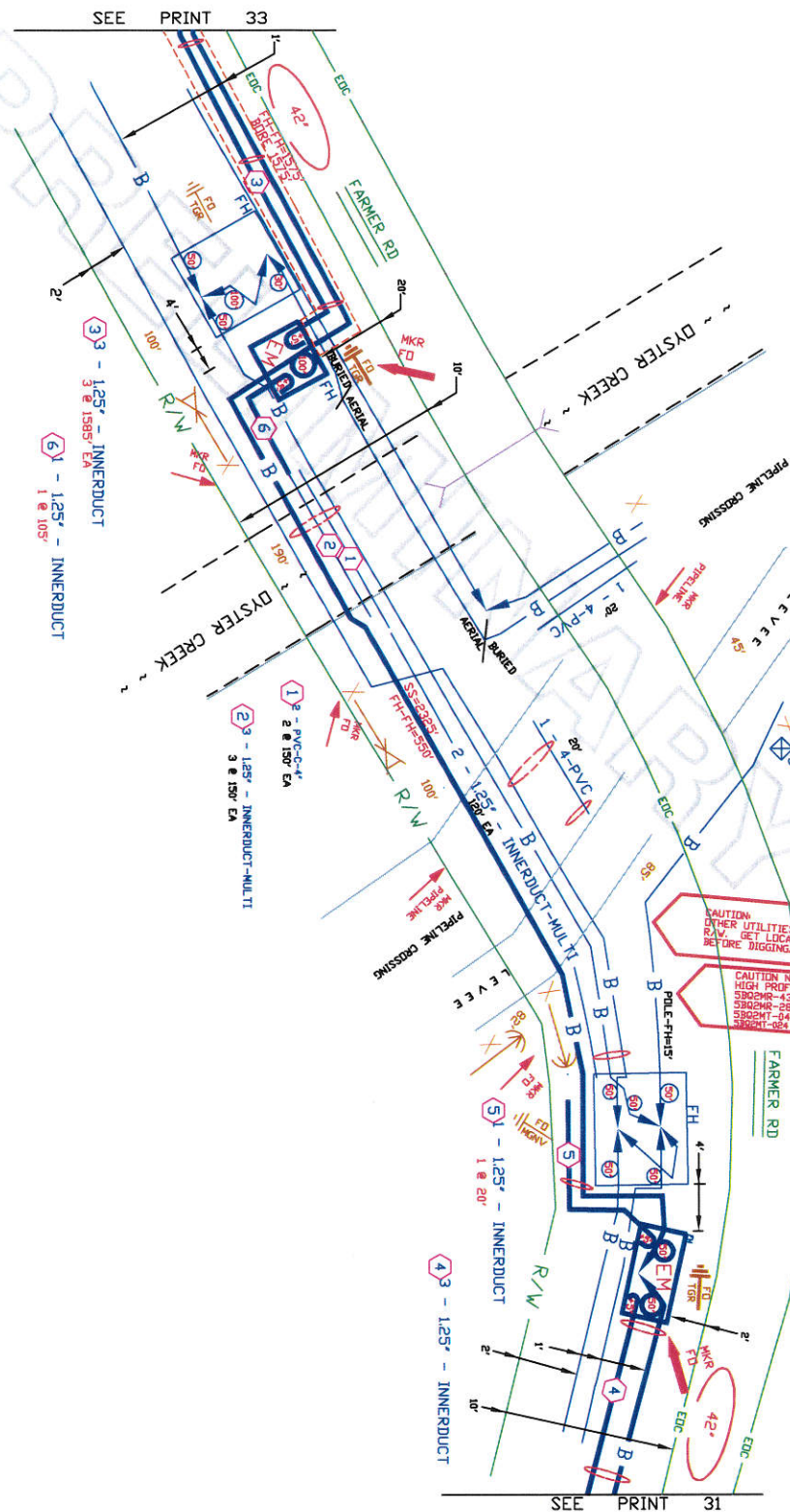

SEE PRINT 33

SEE PRINT 31

Not for use or disclosure outside the AT&T companies except under written agreement.

--Proprietary--

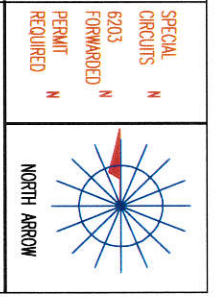

SPECIAL CIRCUITS N

6203 N

FORWARDED N

PERMIT REQUIRED N

OPERATING RANGE OF JOB STEPS

TASK _____ TO _____

MFR _____

TRANSMISSION ZONE

RZ 0 C2 0

PAPER CODE 163605

CAUTION HIGH VOLTAGE BURIED

KV 720

AERIAL 1

HIGHWAY PERMIT NO.

UTILITY CO 3201 - CENTER POINT

REP NAME

REP TEL NO.

POLE CONTACTS (+) 0 (-) 0

UTILITY CO

REP NAME

REP TEL NO.

POLE CONTACTS (+) 0 (-) 0

PROJECT NO A000K1

POLE CONTACTS (+) 0 (-) 0

TOT. PRINTS 42 PRINT NO. 32

NPA/ANNY: 281-722 PRT:281232

EXCH: RICH-RIDE

TAX DIST. F0004

GEO LOC. W09232

ENGR. HB DRAWN/DV

TELEPHONE NO. (281) 341-4312

REC. REF. 232-280-34

MAP REF. 566F

SCALE NONE

ISSUE DATE

PROJ TITLE RT3206 DLT FR R/F

REV. NUMBER

DATE REV.

PRELIMINARY

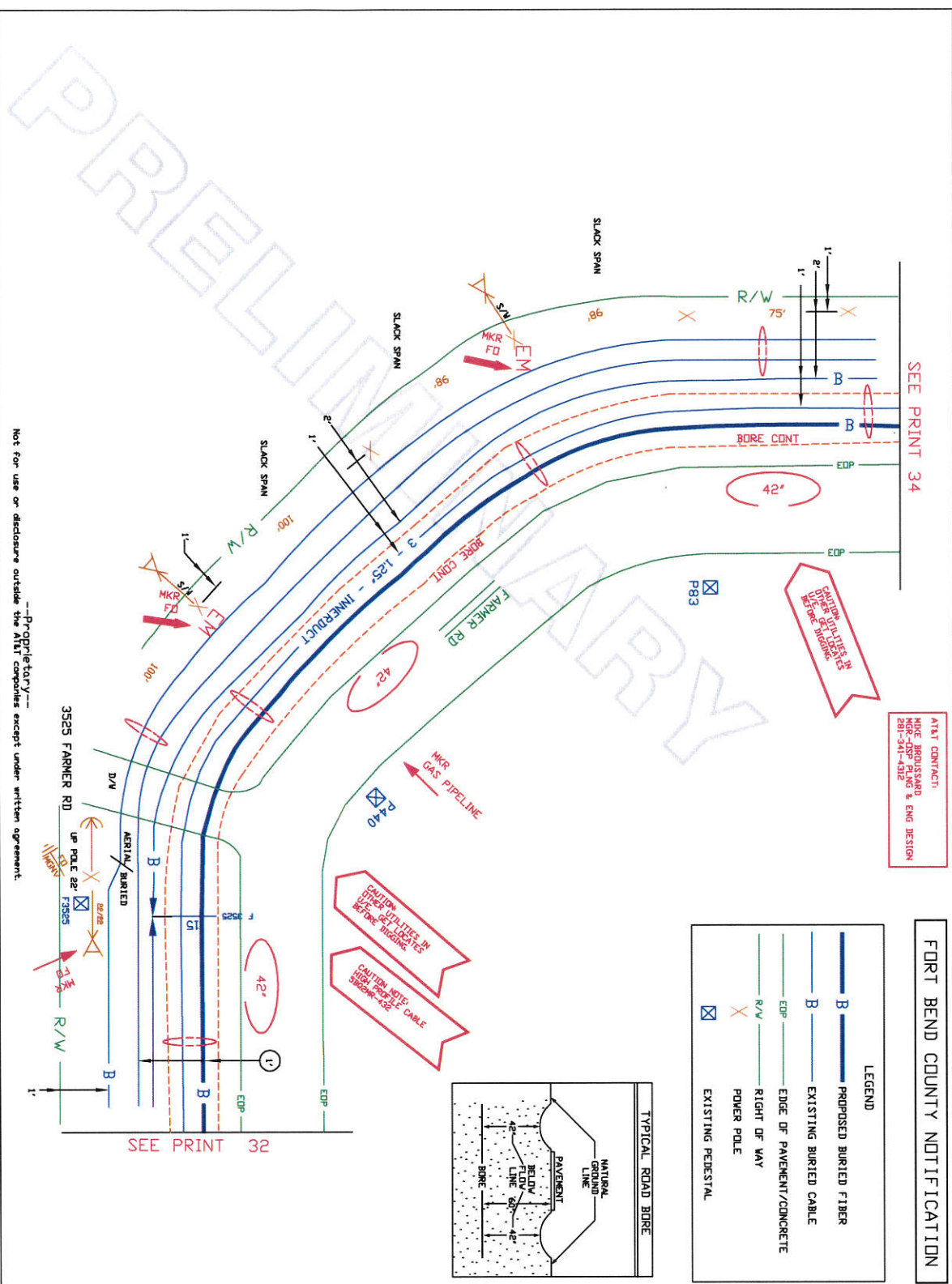

AT&T CONTRACT:
 MRC APPROVED
 MGR-437 PLNG & ENG DESIGN
 281-341-4312

FORT BEND COUNTY NOTIFICATION

LEGEND

	PROPOSED BURIED FIBER
	EXISTING BURIED CABLE
	EDGE OF PAVEMENT/CONCRETE
	RIGHT OF WAY
	POWER POLE
	EXISTING PEDESTAL

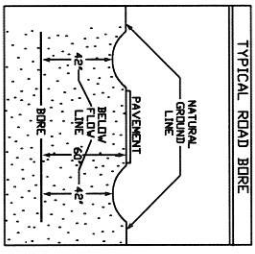

SPECIAL CIRCUITS

6203	FORWARDED	N
PERMIT	REQUIRED	N

NORTH ARROW

OPERATING RANGE OF JOB STEPS
 TASK _____ TO _____

MRC

TRANSMISSION ZONE
 RZ 0 CZ 0 TAPER CODE 16365

CAUTION HIGH VOLTAGE BURIED N
 KY 13.00 AERIAL Y

HIGHWAY PERMIT NO.

UTILITY CO. **CENT - CENTER POINT**

REP NAME
 REP TEL NO.
 POLE CONTRACTS (+) 0 (-) 0

UTILITY CO.
 REP NAME
 REP TEL NO.
 POLE CONTRACTS (+) 0 (-) 0

UTILITY CO.
 REP NAME
 REP TEL NO.
 POLE CONTRACTS (+) 0 (-) 0

PROJECT NO. **A04AKAL**

TOT PRINTS **42** PRINT NO. **33**
 NPA/MNK: 281-282 PRT:281232
 EXCH: RICH-ROSE
 TAX DIST: F0004
 GEO LOC: 089232
 ENGR: NB DRAWN/DW
 TELEPHONE NO. (281) 341-4312
 REC. REF: 232-280-34
 MAP REF: 566E
 SCALE: NONE
 ISSUE DATE
 PROJ TITLE: **RT206 DIT FR R/F**
 REV. NUMBER
 DATE REV.

Proprietary
 Not for use or disclosure outside the AT&T companies except under written agreement.

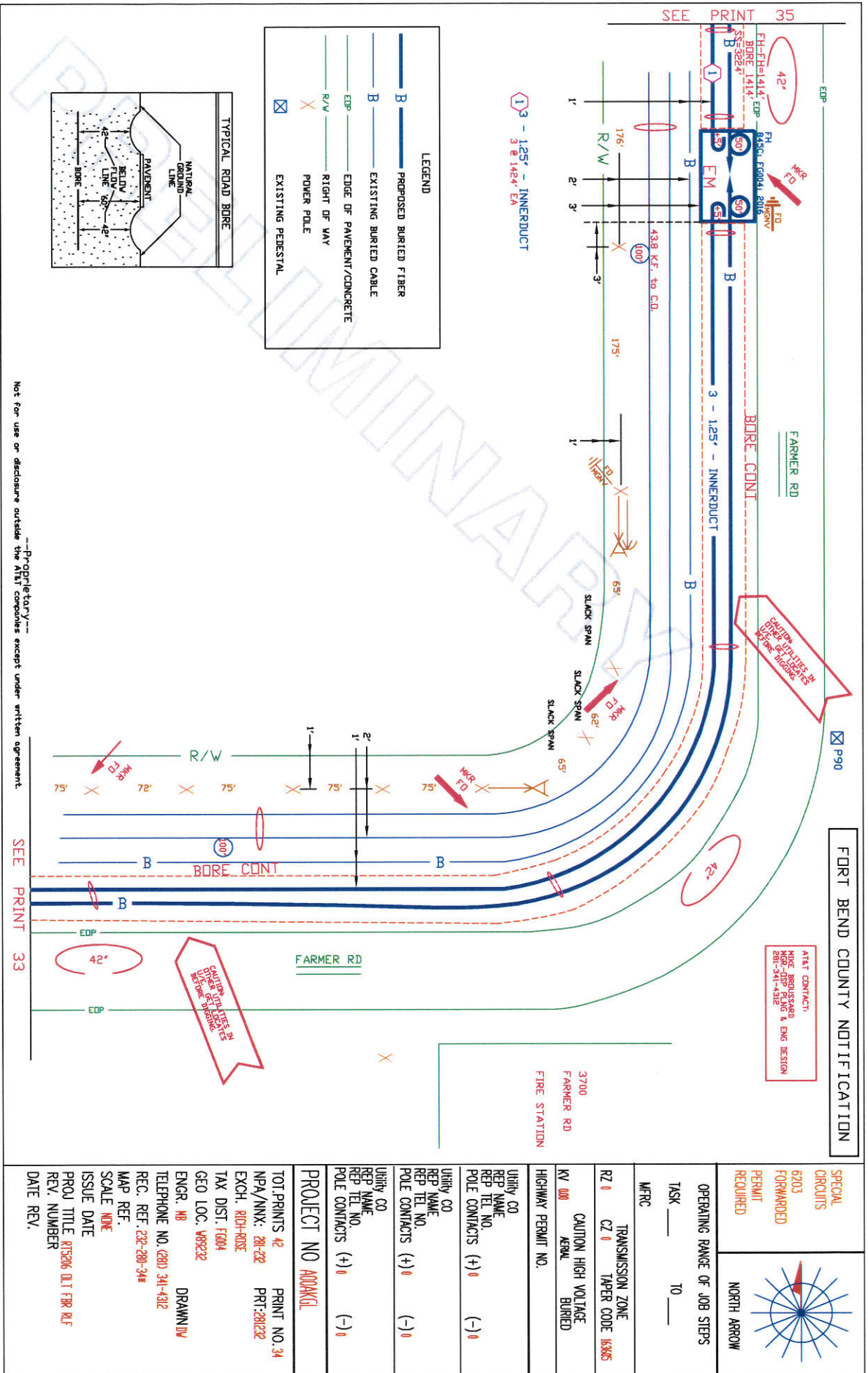

Proprietary
 Not for use or disclosure outside the AIT companies except under written agreement.

SPECIAL CIRCUITS 6203 FORWARDED PERMIT REQUIRED		 NORTH ARROW	
OPERATING RANGE OF JOB STEPS TASK _____ TO _____			
MERC	TRANSMISSION ZONE		
RZ 0	CZ 0 TAPER CODE 16385		
KV 000	CAUTION HIGH VOLTAGE BURIED		
HIGHWAY PERMIT NO.			
Utility CO	REP NAME	REP TEL NO.	POLE CONTACTS (+) 0 (-) 0
Utility CO	REP NAME	REP TEL NO.	POLE CONTACTS (+) 0 (-) 0
Utility CO	REP NAME	REP TEL NO.	POLE CONTACTS (+) 0 (-) 0
PROJECT NO A00AKG1			
TOT. PRINTS 42		PRINT NO. 34	
NPA/NNX: 281-232		PRT: 281232	
EXCH: RICH-RDSE			
TAX DIST. F0004			
GEO LOC. V89232			
ENGR: HB DRAWN/DIV			
TELEPHONE NO. (281) 341-4312			
REC. REF. 232-280-34#			
MAP REF. SCALE NINE			
ISSUE DATE			
PROJ. TITLE RT5206 D1T FR RLT			
REV. NUMBER			
DATE REV.			

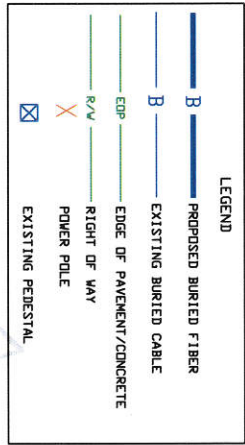
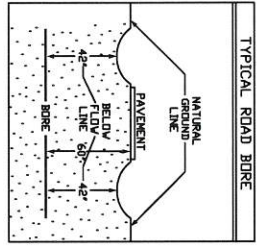

FORT BEND COUNTY NOTIFICATION

ATTN: CONTRACTOR
 HIRE RESOURCES
 4357 W. 13th St. #1310
 Fort Bend, TX 77437

SPECIAL CIRCUITS
 6203 N
 FORWARDED N
 PERMIT REQUIRED N

NORTH ARROW

OPERATING RANGE OF JOB STEPS
 TASK _____ TO _____

MFRG
 TRANSMISSION ZONE
 RZ 0 CZ 0 PAPER CODE 16366

CAUTION HIGH VOLTAGE BURIED
 KY 1300 AERIAL Y

HIGHWAY PERMIT NO.
 Utility CO DENI - CENTER POINT
 REP NAME
 REP TEL NO.
 POLE CONTRACTS (+) 0 (-) 0

Utility CO
 REP NAME
 REP TEL NO.
 POLE CONTRACTS (+) 0 (-) 0

Utility CO
 REP NAME
 REP TEL NO.
 POLE CONTRACTS (+) 0 (-) 0

PROJECT NO A00KGL

TOT. PRINTS 42 PRINT NO. 35
 NPA/MNX: 261-232 PRT:281232
 EXCH: RICH-RDCE
 TAX DIST. F004
 GEO LOC. 409232
 ENGR. NB DRAWN/DIV
 TELEPHONE NO. (281) 341-4312
 REC. REF. 232-280-34
 MAP REF. 566E
 SCALE NONE
 ISSUE DATE
 PROJ TITLE RT5206 DLT FR RLF
 REV. NUMBER
 DATE REV.

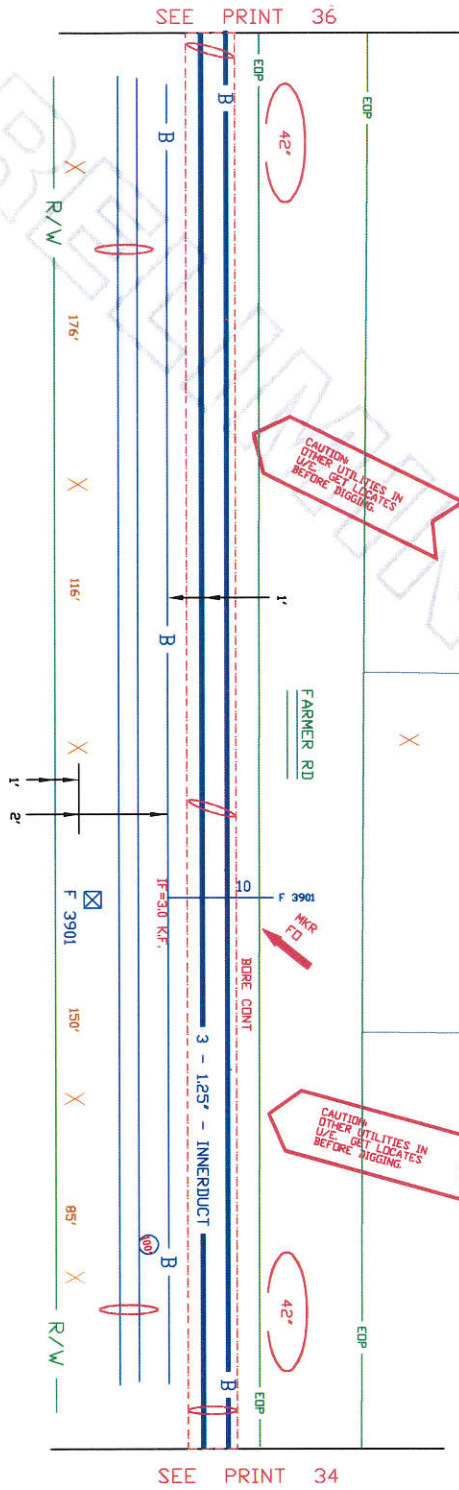

SEE PRINT 36

SEE PRINT 34

Not for use or disclosure outside the Aflac companies except under written agreement.

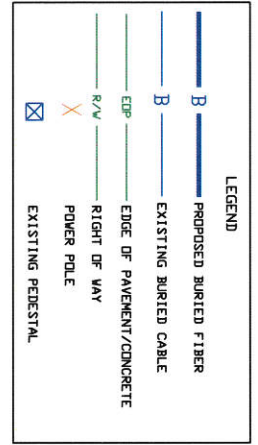
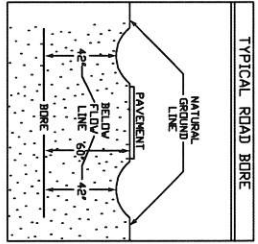

FORT BEND COUNTY NOTIFICATION

AT&T CONTRACT#
 MDCR BR055348
 MGR-OSP RING & ENG DESIGN
 280-341-4312

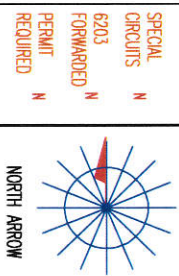

SPECIAL CIRCUITS N
 6203 N
 FORWARDED N
 PERMIT N
 REQUIRED N

OPERATING RANGE OF JOB STEPS
 TASK _____ TO _____

MFRIC TRANSMISSION ZONE
 RZ 0 CZ 0 TAPER CODE 16385

CAUTION HIGH VOLTAGE BURIED N
 AERIAL Y

CAUTION HIGH VOLTAGE BURIED N

UTILITY CO. DATE - CENTER POINT

UTILITY CO. DATE - CENTER POINT

UTILITY CO. DATE - CENTER POINT

UTILITY CO. DATE - CENTER POINT

UTILITY CO. DATE - CENTER POINT

UTILITY CO. DATE - CENTER POINT

UTILITY CO. DATE - CENTER POINT

UTILITY CO. DATE - CENTER POINT

UTILITY CO. DATE - CENTER POINT

UTILITY CO. DATE - CENTER POINT

UTILITY CO. DATE - CENTER POINT

UTILITY CO. DATE - CENTER POINT

UTILITY CO. DATE - CENTER POINT

UTILITY CO. DATE - CENTER POINT

UTILITY CO. DATE - CENTER POINT

UTILITY CO. DATE - CENTER POINT

UTILITY CO. DATE - CENTER POINT

UTILITY CO. DATE - CENTER POINT

UTILITY CO. DATE - CENTER POINT

UTILITY CO. DATE - CENTER POINT

UTILITY CO. DATE - CENTER POINT

UTILITY CO. DATE - CENTER POINT

UTILITY CO. DATE - CENTER POINT

UTILITY CO. DATE - CENTER POINT

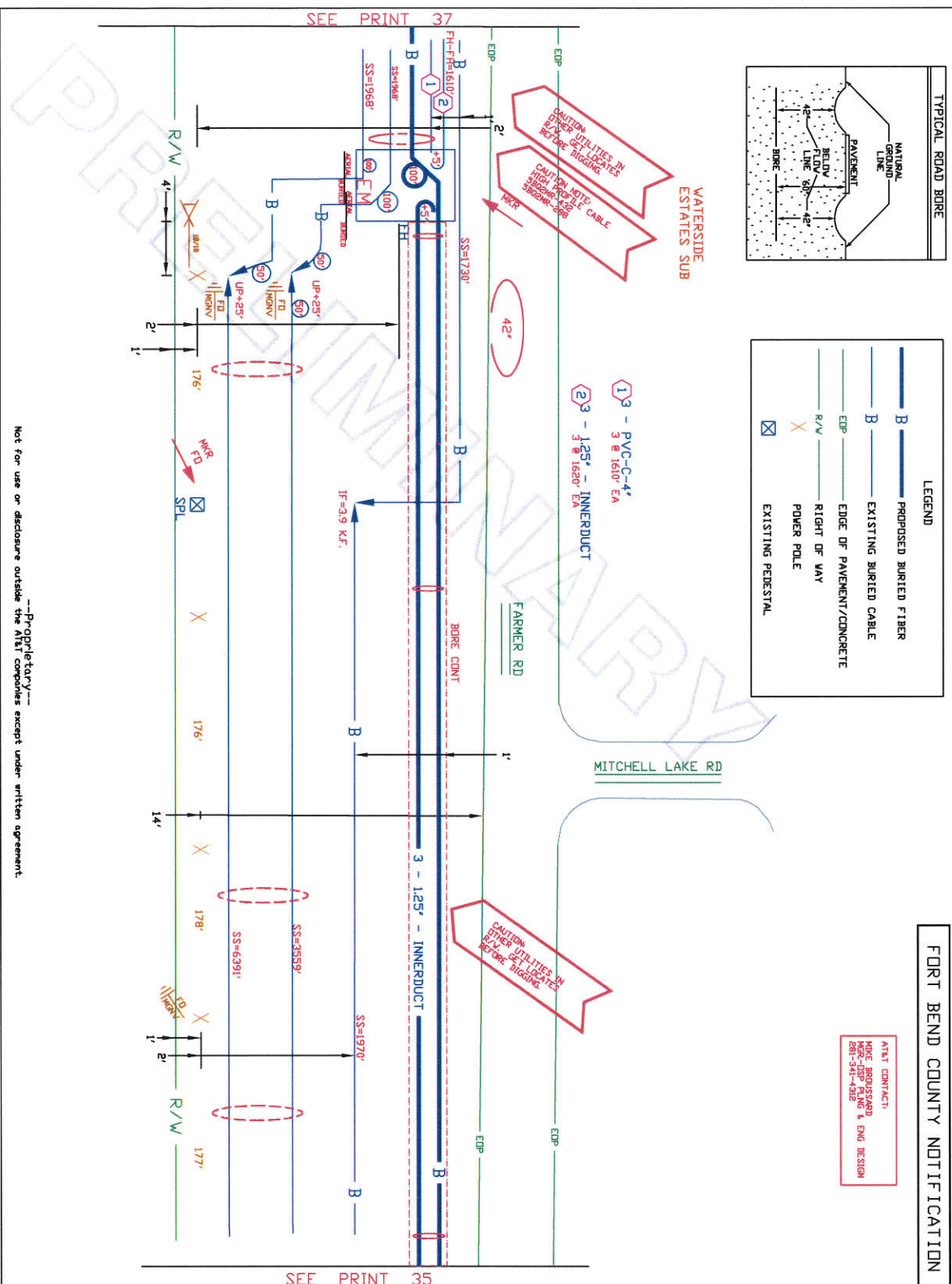

TOT. PRINTS 42	PRINT NO. 36
NPA/NNX: 281-222	PRT:281232
EXCH: RICH-RDCE	
TAX DIST: T004	
GEO LOC: W89232	
ENGR: HB	DRAWN/DIV
TELEPHONE NO. (281) 341-4312	
REC. REF: 232-281-35	
MAP REF: 364	
SCALE NINE	
ISSUE DATE	
PROJ. TITLE R15266 DLT FRP RLF	
REV. NUMBER	
DATE REV.	

Not for use or disclosure outside the AT&T companies except under written agreement.

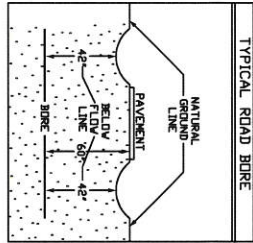

LEGEND

- B — PROPOSED BURIED FIBER
- B — EXISTING BURIED CABLE
- EDP — EDGE OF PAVEMENT/CONCRETE
- R/V/W — RIGHT OF WAY
- X — POWER POLE
- ☒ — EXISTING PEDESTAL

FORT BEND COUNTY NOTIFICATION

ATTN CONTRACT:
MINE ABANDONED
R/W - 341-4312
ENG DESIGN

CAUTION: UTILITIES IN R/W - GET LOCATED BEFORE DIGGING

CAUTION NOTE: HIGH PROFILE CABLE. SINKING - 432. SINKING - 286

CAUTION: UTILITIES IN R/W - GET LOCATED BEFORE DIGGING

CAUTION NOTE: HIGH PROFILE CABLE. SINKING - 432. SINKING - 286

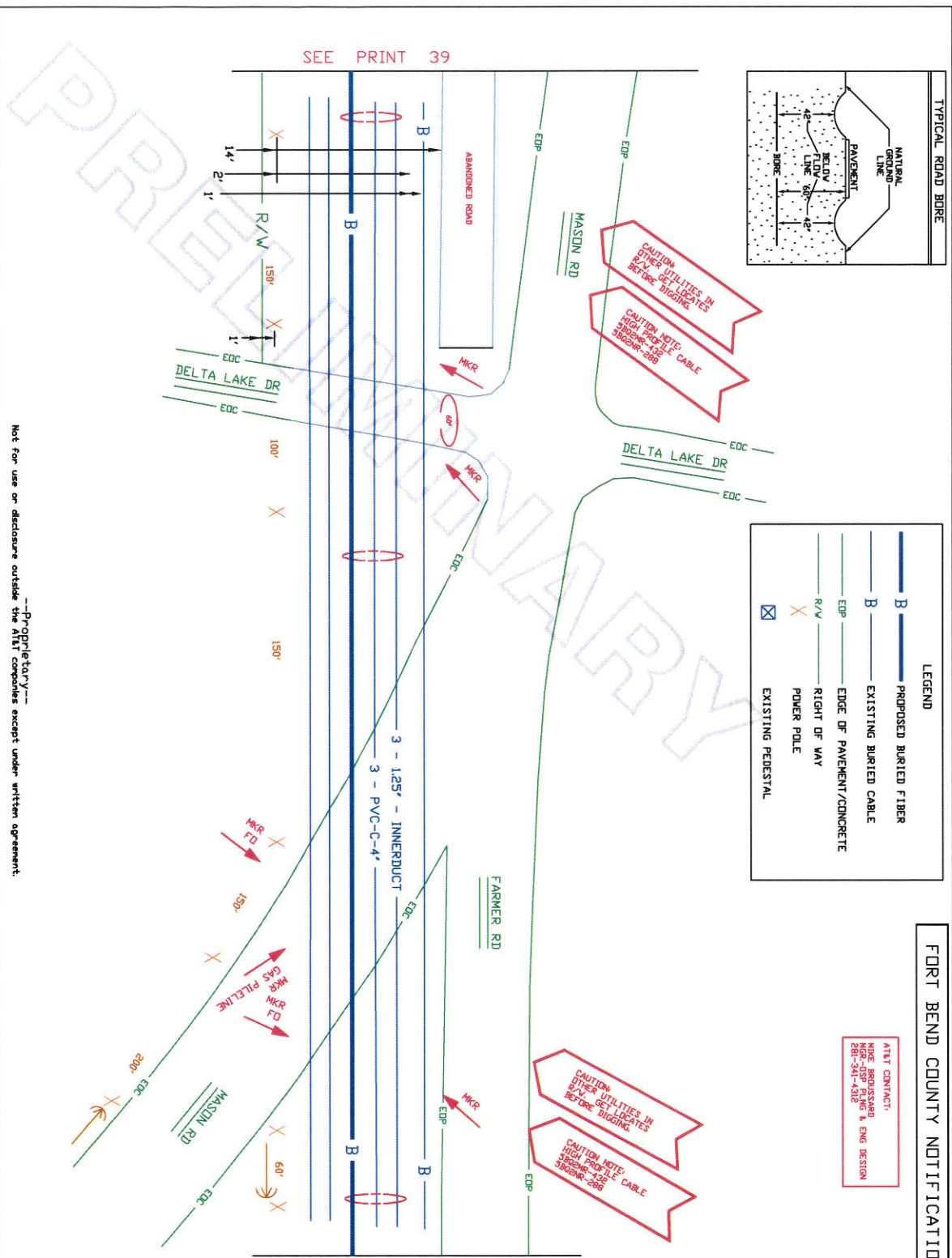

Not for use or disclosure outside the Altair companies except under written agreement.

SPECIAL CIRCUITS	N	
6203 FORWARDED PERMIT REQUIRED	N	

OPERATING RANGE OF JOB STEPS
TASK _____ TO _____

TRANSMISSION ZONE
RZ 0 C2 0 PAPER CODE 16365

CAUTION HIGH VOLTAGE BURIED
KV/100 AERIAL 1

UTILITY CO: CENI - CENTER POINT
REP NAME: REP TEL NO.
POLE CONTACTS (+) 0 (-) 0

UTILITY CO: REP NAME: REP TEL NO.
POLE CONTACTS (+) 0 (-) 0

PROJECT NO: A00AKGL
PRINT NO. 38
NPA/MNY: 281-22 PRT: 281222
EXCH: RICH-RDCE

TAX DIST: F0004
GEO LOC: 809222
ENGR: HB DRAWN: DV
TELEPHONE NO: (281) 341-4312
REC. REF: 232-280-55
MAP REF: 5664
SCALE: NONE
ISSUE DATE
PROJ TITLE: RT3206 DLT FR R/F
REV. NUMBER
DATE REV.

TYPICAL ROAD BORE

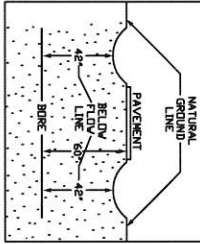

FORT BEND COUNTY NOTIFICATION

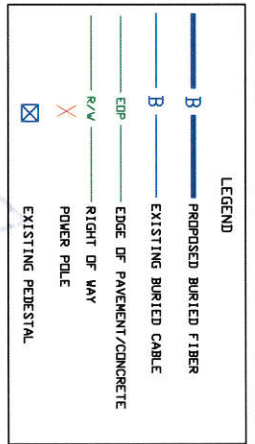

AT&T CONTRACT:
MILE AROUND
281-341-4312
& ENG DESIGN

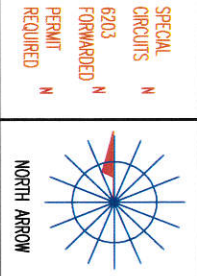

SPECIAL CIRCUITS N

6203 FORWARDED N

PERMIT N

REQUIRED N

OPERATING RANGE OF JOB STEPS

TASK _____ TO _____

MFR

TRANSMISSION ZONE

RZ 0 CZ 0 TAPER CODE 16365

CAUTION HIGH VOLTAGE BURIED N

AVL 1200 AERIAL Y

HIGHWAY PERMIT NO.

UTILITY CO ENT - CONTR POINT

REP NAME

REP TEL NO

POLE CONTRACTS (+) 0 (-) 0

UTILITY CO

REP NAME

REP TEL NO

POLE CONTRACTS (+) 0 (-) 0

PROJECT NO A00AKGL

TOT PRINTS 42 PRINT NO. 39

NPA/ANNX: 281-222 PRT:280232

EXCH: RICH-RIDE

TAX DIST: T08M4

GEO LOC: W08232

ENGR: HB DRAWN: DW

TELEPHONE NO: (281) 341-4312

REC. REF: 232-280-35

MAP REF: 5654

SCALE: NONE

ISSUE DATE

PROJ TITLE: 875206 DLT FR R/F

REV. NUMBER

DATE REV.

Not for use or disclosure outside the AT&T companies except under written agreement.

LONG MEADOW FARMS SUB

SEE PRINT 40

SEE PRINT 38

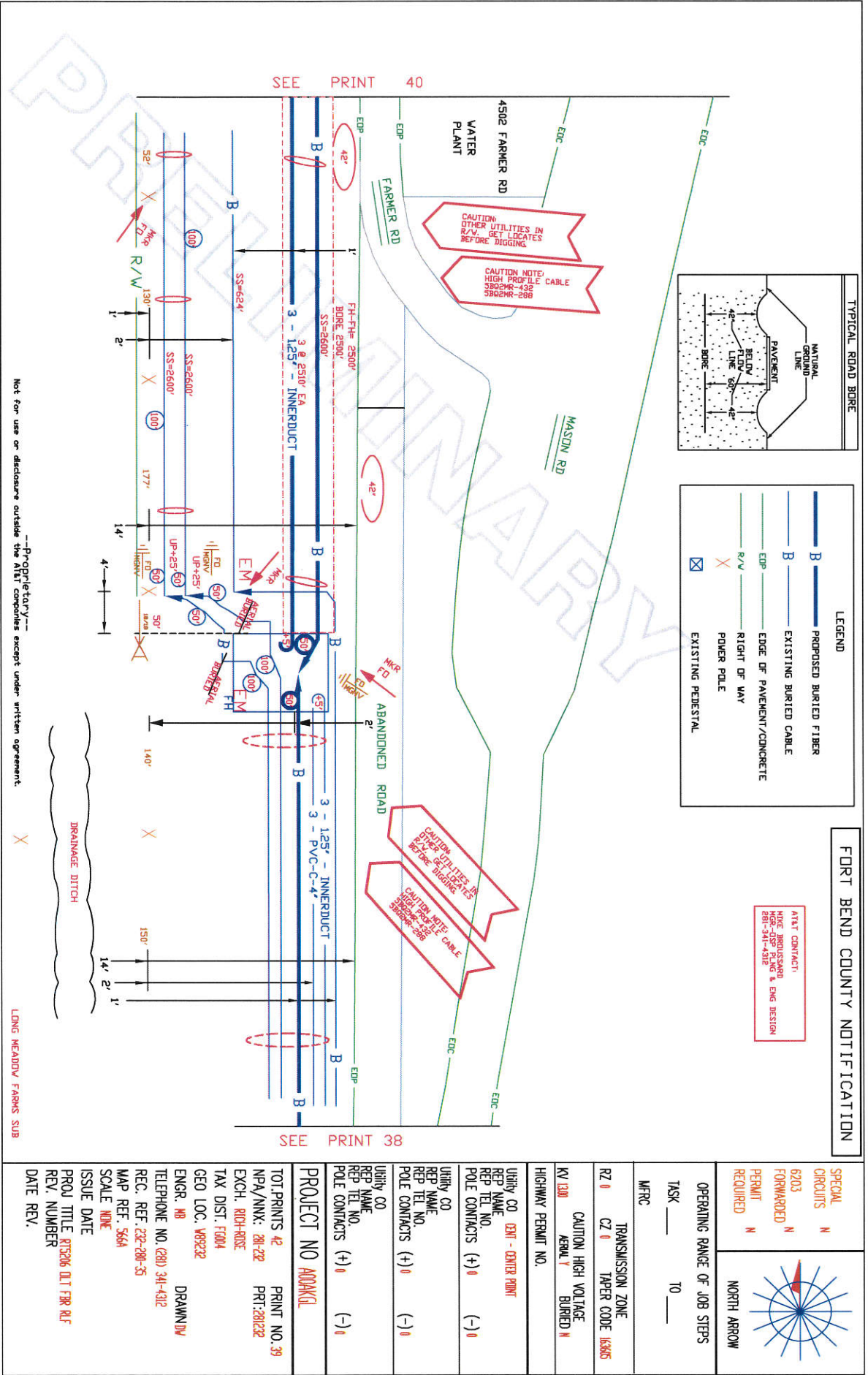

LEGEND

- B — PROPOSED BURIED FIBER
- B — EXISTING BURIED CABLE
- EOP — EDGE OF PAVEMENT/CONCRETE
- R/W — RIGHT OF WAY
- X — POWER POLE
- X — EXISTING PEDESTAL

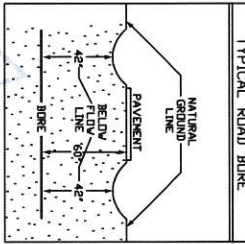

FORT BEND COUNTY NOTIFICATION

ATTN CONTACT:
 MIKE BROUSSARD
 MGR-DSP PLNG & ENG DESIGN
 281-341-4312

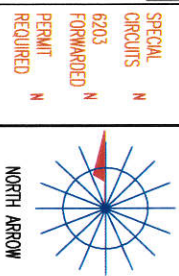

SPECIAL CIRCUITS

6203	N
FORWARDED	N
PERMIT REQUIRED	N

OPERATING RANGE OF JOB STEPS
 TASK _____ TO _____

MFR

TRANSMISSION ZONE
 RZ 0 CZ 0 TAPER CODE 16365

CAUTION HIGH VOLTAGE BURIED N
 KY 13.00 AERIAL Y

HIGHWAY PERMIT NO.

UTILITY CO. CNT - CENTER POINT
 REP NAME
 REP TEL NO.
 POLE CONTRACTS (+) 0 (-) 0

UTILITY CO.
 REP NAME
 REP TEL NO.
 POLE CONTRACTS (+) 0 (-) 0

UTILITY CO.
 REP NAME
 REP TEL NO.
 POLE CONTRACTS (+) 0 (-) 0

PROJECT NO. A00AKGL

TOT. PRINTS 42 PRINT NO. 40
 NPA/NNX: 281-232 PRT:281232
 EXCH: RICH-R02E
 TAX DIST: T0004
 GEO LOC: 889232
 ENGR: NB DRAWN/DIV
 TELEPHONE NO. (281) 341-4312
 REC. REF: 232-280-37-3
 MAP REF: 3264
 SCALE: NDE
 ISSUE DATE
 PROJ. TITLE: R15206 DLT FRP RLF
 REV. NUMBER
 DATE REV.

Not for use or disclosure outside the AIT companies except under written agreement.
 Proprietary

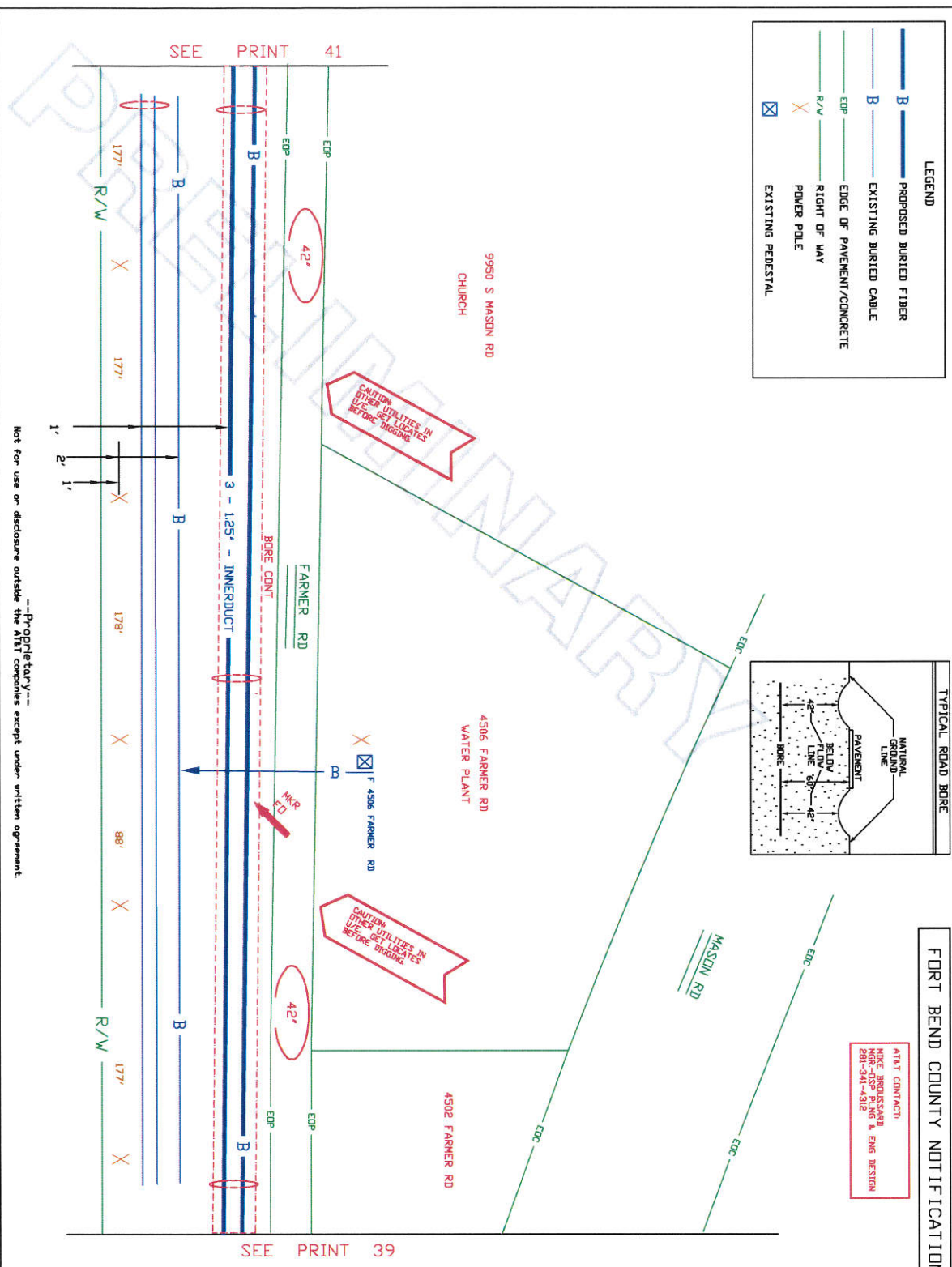

SEE PRINT 41

SEE PRINT 39

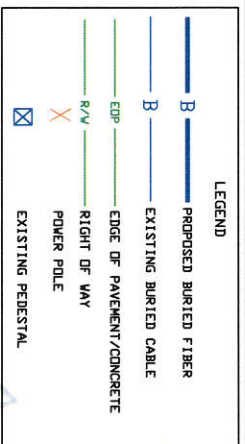
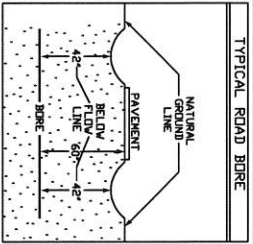

FORT BEND COUNTY NOTIFICATION

ATTN CONTACT:
 KINC BROUSSARD
 NCR-OSP PLNG & ENG DESIGN
 281-341-4312

CAUTION UTILITIES IN THIS AREA GET LOCATED BEFORE DIGGING

CAUTION UTILITIES IN THIS AREA GET LOCATED BEFORE DIGGING

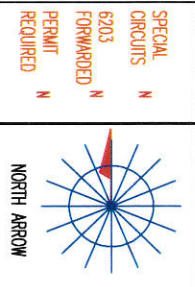
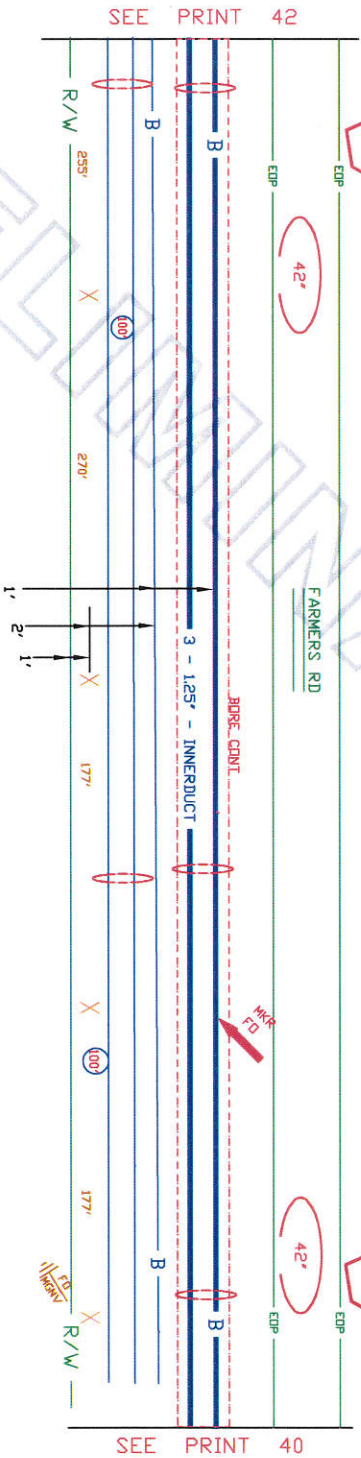

OPERATING RANGE OF JOB STEPS
 TASK _____ TO _____

MFRC

TRANSMISSION ZONE
 RZ 0 C2 0 PAPER CODE 18385

CAUTION HIGH VOLTAGE BURIED
 KV 13.80 AERIAL 7

HIGHWAY PERMIT NO.

UTILITY CO DENT - CENTER POINT
 REP NAME
 REP TEL NO.
 POLE CONTACTS (+) 0 (-) 0

UTILITY CO
 REP NAME
 REP TEL NO.
 POLE CONTACTS (+) 0 (-) 0

UTILITY CO
 REP NAME
 REP TEL NO.
 POLE CONTACTS (+) 0 (-) 0

PROJECT NO A00AKGL

TOT PRINTS 42 PRINT NO. 41
 NPA/MNY: 281-732 PRT:281232

EXCH: RICH-RDCE

TAX DIST: F0004

GEO LOC: W99232

ENGR: HB

DRAWN: DW

TELEPHONE NO. (281) 341-4312

REC. REF: 232-280-37-3

MAP REF: 3264

SCALE NONE

ISSUE DATE

PROJ TITLE R15206 DLT FRM RJF

REV. NUMBER

DATE REV.

Not for use or disclosure outside the AT&T companies except under written agreement.

PRELIMINARY

