

**REVIEW BY FORT BEND COUNTY COMMISSIONERS COURT**

On this 8th day of March, 2016, Commissioners Court came on to be heard and reviewed the accompanying notice of LECON, Inc.

Job Location 1323 Bittersweet Dr., Richmond, TX 77406

Date 2/22/2016 Bond No. no bond required, Permit No. 2016-5641 to make use of certain Fort Bend County property subject to, "A Revised Order Regulating the Laying, Construction, Maintenance, and Repair of Buried Cables, Conduits, and Pole Lines, In, Under, Across or Along Roads, Streets, Highways, and Drainage Ditches in Fort Bend County, Texas, Under the Jurisdiction of the Commissioners Court of Fort Bend County, Texas," as passed by the Commissioners Court of Fort Bend County, Texas the 3rd day of August, 1987, recorded in Volume \_\_\_\_\_ of the Minutes of the Commissioners Court of Fort Bend County, Texas, to the extent that such order is not inconsistent with Article 1436a, Vernon's Texas Civil Statutes. Upon Motion of Commissioner \_\_\_\_\_, seconded by Commissioner \_\_\_\_\_,

duly put and carried, it is ORDERED, ADJUDGED AND DECREED that said notice of said above purpose is hereby acknowledged by the Commissioners Court of Fort Bend County, Texas, and that said notice be placed on record according to the regulation order thereof.

Notes:

1. Evidence of review by the Commissioners Court must be kept on the job site and failure to do so constitutes grounds for job shutdown.
2. Written notices are required:
  - a. 48 hours in advance of construction start up, and
  - b. when construction is completed and ready for final inspection

Mail notices to: Permit Administrator  
Fort Bend County Engineering  
301 Jackson Street  
Richmond, Texas 77469  
281-633-7500

3. This permit expires one (1) year from date of permit if construction has not commenced.

By: Charles O. Wolf  
for County Engineer

Presented to Commissioners Court and approved.  
Recorded in Volume \_\_\_\_\_

By: N/A  
Drainage District Engineer/Manager

Minutes of Commissioners Court

Clerk of Commissioners Court

By: \_\_\_\_\_  
Deputy



CONFORMED CONSTRUCTION SET

# CONSTRUCTION

OF

# THE GROVE 4 & 5 DRAINAGE IMPROVEMENTS

IN

# FORT BEND COUNTY, TEXAS

FOR

# PECAN GROVE MUNICIPAL UTILITY DISTRICT

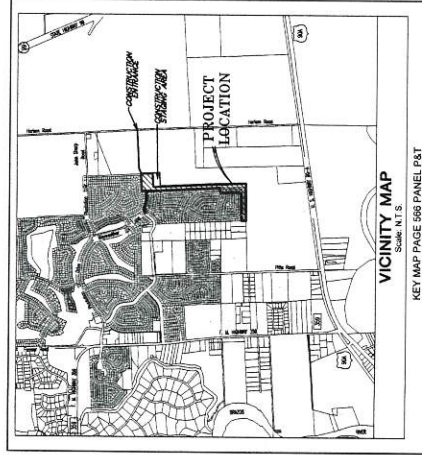
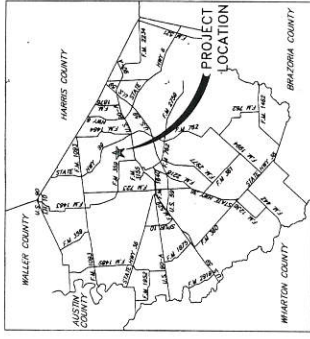

### INDEX OF DRAWINGS

SHEET No.	TITLE
1	COVER SHEET & INDEX
2	PROJECT OVERALL & PREVENTION PREVENTION DETAILS
3	CONSTRUCTION NOTES
<b>PLAN &amp; PROFILE OUTFALL WATER</b>	
4	PLAN & PROFILE BASELINE A
5	PLAN & PROFILE BASELINE B
6	PLAN & PROFILE BASELINE C
7	PLAN & PROFILE BASELINE D
8	PLAN & PROFILE BASELINE E
9	PLAN & PROFILE BASELINE F
10	PLAN & PROFILE BASELINE G
11	PLAN & PROFILE BASELINE H
12	PLAN & PROFILE BASELINE I
13	PLAN & PROFILE BASELINE J
14	PLAN & PROFILE BASELINE K
15	PLAN & PROFILE BASELINE L
16	PLAN & PROFILE BASELINE M
17	PLAN & PROFILE BASELINE N
<b>MISCELLANEOUS DETAILS</b>	
18	CITY OF RICHMOND STANDARD CONSTRUCTION DETAILS - STORM SEWER
19	CITY OF RICHMOND STANDARD CONSTRUCTION DETAILS - SANITARY SEWER
20	CITY OF RICHMOND STANDARD CONSTRUCTION DETAILS - PAVING I
21	CITY OF RICHMOND STANDARD CONSTRUCTION DETAILS - PAVING II
22	CITY OF RICHMOND STANDARD CONSTRUCTION DETAILS - PAVING III
23	TRAFFIC CONTROL PLAN
24	

CITY OF RICHMOND, TEXAS  
APPROVED BY: *TERRA VELA*  
City Manager

DATE: 11/24/14  
DATE: 11/24/14  
DATE: 11/24/14  
DATE: 11/24/14

NOTE: Approval Void After One Year From Date Signed. If Construction Has Not Begun.

### NOTES:

- These plans were prepared to meet or exceed the specifications and requirements of City of Richmond and Fort Bend County as currently amended.
- Approval by Fort Bend County will be deemed void if construction has not begun within one year of approval date.
- Construction will be monitored under the supervision of a licensed professional engineer of JONES & CARTER, INC.
- Contractor shall notify the Fort Bend County Engineering Department at least 48 hours prior to commencement at construction@fortbendcountytx.gov.



CALL BEFORE YOU DIG!!  
TEXAS 811 (Dig TESS)  
www.dig811.com  
LONE STAR NOTIFICATION CENTER  
1-800-665-5344

FORT BEND COUNTY ENGINEER  
ENGINEER: *Chris W. Kaldrey*  
DATE: 12/2/14  
DATE OF APPROVAL: 12/2/14  
DATE OF CONSTRUCTION: 11/24/14  
DATE OF SIGNATURE: 11/24/14

PECAN GROVE MUNICIPAL UTILITY DISTRICT  
NOVEMBER 2014  
PROJECT NUMBER 00034-0368-01

JONES & CARTER, INC.  
ENGINEERS - PLANNERS - SURVEYORS  
1401 Rossburg Road, Houston, Texas 77057 (281) 242-2623

PECAN GROVE MUNICIPAL UTILITY DISTRICT - THE GROVE 4 & 5 DRAINAGE IMPROVEMENTS

JONES & CARTER, INC.  
ENGINEERS - PLANNERS - SURVEYORS  
SHEET: 1  
OF: 24



**DISCLAIMER**

THIS DRAWING IS THE PROPERTY OF JAMES H. HARRIS & ASSOCIATES, INC. (JHA) AND IS NOT TO BE REPRODUCED OR TRANSMITTED IN ANY FORM OR BY ANY MEANS, ELECTRONIC OR MECHANICAL, INCLUDING PHOTOCOPYING, RECORDING, OR BY ANY INFORMATION STORAGE AND RETRIEVAL SYSTEM, WITHOUT THE WRITTEN PERMISSION OF JHA. THE USER OF THIS DRAWING AGREES TO HOLD JHA HARMLESS FROM AND AGAINST ALL CLAIMS, DAMAGES, LOSSES AND EXPENSES, INCLUDING REASONABLE ATTORNEY'S FEES, ARISING OUT OF OR RESULTING FROM THE USE OF THIS DRAWING.

**DATE:** 12/21/14  
**APPROVED:** [Signature]  
**DESIGNER:** [Signature]

**PROJECT:** THE GROVE 4, 5 & 6  
**DRAINAGE IMPROVEMENTS**  
**POLLUTION PREVENTION**  
**DETAILS**

**CLIENT:** J.C. JONES & COMPANY, INC.  
**PROJECT:** JONES PLANNING & DEVELOPMENT  
**ADDRESS:** 10000 N. LOOP WEST, SUITE 1000, DALLAS, TEXAS 75243

**DATE:** 12/21/14  
**APPROVED:** [Signature]  
**DESIGNER:** [Signature]

**PROJECT:** THE GROVE 4, 5 & 6  
**DRAINAGE IMPROVEMENTS**  
**POLLUTION PREVENTION**  
**DETAILS**

**CLIENT:** J.C. JONES & COMPANY, INC.  
**PROJECT:** JONES PLANNING & DEVELOPMENT  
**ADDRESS:** 10000 N. LOOP WEST, SUITE 1000, DALLAS, TEXAS 75243

**DATE:** 12/21/14  
**APPROVED:** [Signature]  
**DESIGNER:** [Signature]

**PROJECT:** THE GROVE 4, 5 & 6  
**DRAINAGE IMPROVEMENTS**  
**POLLUTION PREVENTION**  
**DETAILS**

**CLIENT:** J.C. JONES & COMPANY, INC.  
**PROJECT:** JONES PLANNING & DEVELOPMENT  
**ADDRESS:** 10000 N. LOOP WEST, SUITE 1000, DALLAS, TEXAS 75243

**DATE:** 12/21/14  
**APPROVED:** [Signature]  
**DESIGNER:** [Signature]

**PROJECT:** THE GROVE 4, 5 & 6  
**DRAINAGE IMPROVEMENTS**  
**POLLUTION PREVENTION**  
**DETAILS**

**CLIENT:** J.C. JONES & COMPANY, INC.  
**PROJECT:** JONES PLANNING & DEVELOPMENT  
**ADDRESS:** 10000 N. LOOP WEST, SUITE 1000, DALLAS, TEXAS 75243

**DATE:** 12/21/14  
**APPROVED:** [Signature]  
**DESIGNER:** [Signature]

**PROJECT:** THE GROVE 4, 5 & 6  
**DRAINAGE IMPROVEMENTS**  
**POLLUTION PREVENTION**  
**DETAILS**

**CLIENT:** J.C. JONES & COMPANY, INC.  
**PROJECT:** JONES PLANNING & DEVELOPMENT  
**ADDRESS:** 10000 N. LOOP WEST, SUITE 1000, DALLAS, TEXAS 75243

**DATE:** 12/21/14  
**APPROVED:** [Signature]  
**DESIGNER:** [Signature]

**PROJECT:** THE GROVE 4, 5 & 6  
**DRAINAGE IMPROVEMENTS**  
**POLLUTION PREVENTION**  
**DETAILS**

**CLIENT:** J.C. JONES & COMPANY, INC.  
**PROJECT:** JONES PLANNING & DEVELOPMENT  
**ADDRESS:** 10000 N. LOOP WEST, SUITE 1000, DALLAS, TEXAS 75243

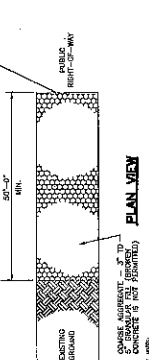
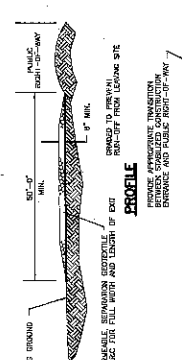
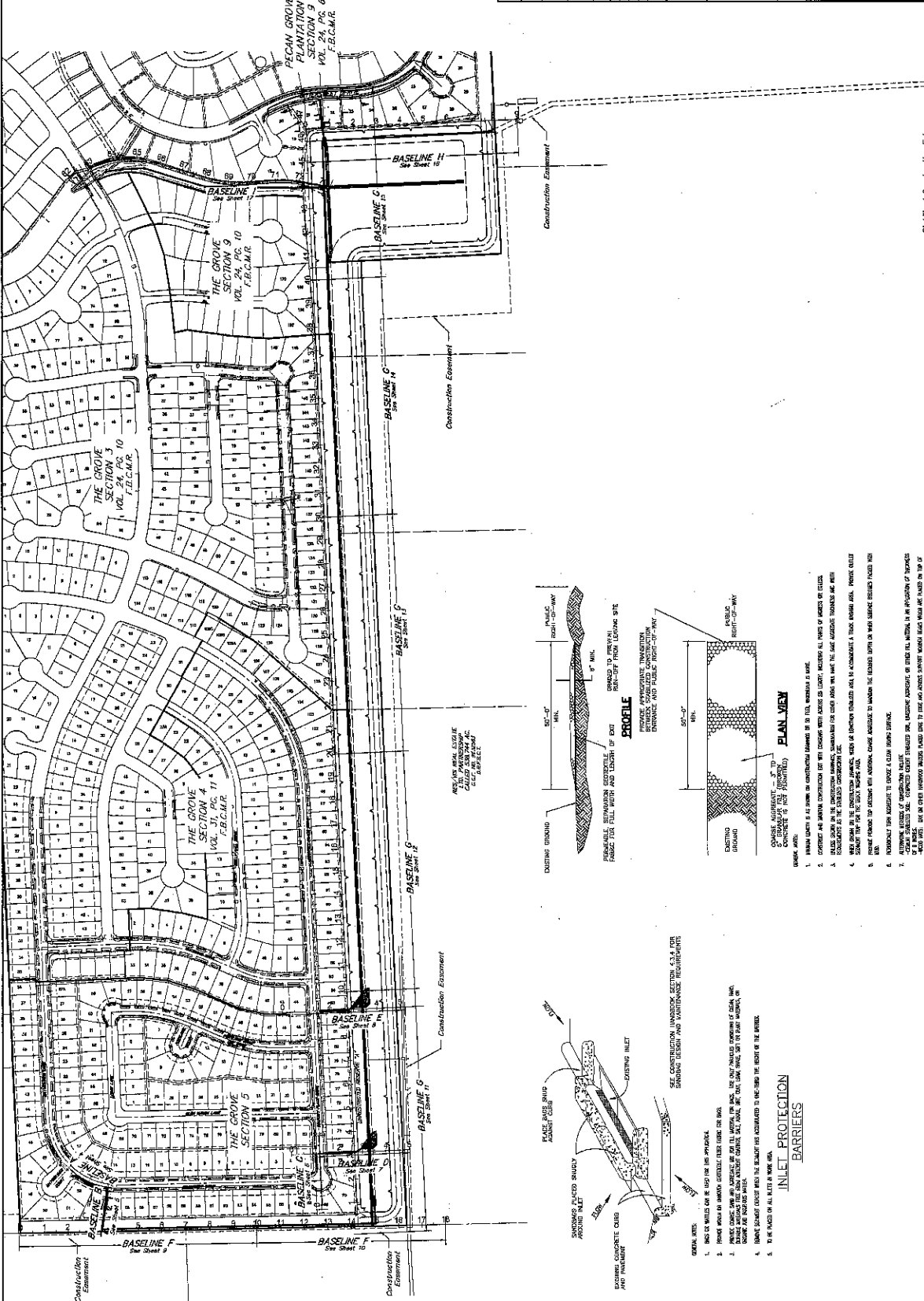

- GENERAL NOTES:**
1. STABILIZATION SHALL BE PLACED TO PREVENT FLOODING FROM FULL FLOW AND TO BE PROTECTED FROM DAMAGE TO EXISTING INFRASTRUCTURE.
  2. STABILIZATION SHALL BE PLACED TO PREVENT FLOODING FROM FULL FLOW AND TO BE PROTECTED FROM DAMAGE TO EXISTING INFRASTRUCTURE.
  3. STABILIZATION SHALL BE PLACED TO PREVENT FLOODING FROM FULL FLOW AND TO BE PROTECTED FROM DAMAGE TO EXISTING INFRASTRUCTURE.
  4. STABILIZATION SHALL BE PLACED TO PREVENT FLOODING FROM FULL FLOW AND TO BE PROTECTED FROM DAMAGE TO EXISTING INFRASTRUCTURE.
  5. STABILIZATION SHALL BE PLACED TO PREVENT FLOODING FROM FULL FLOW AND TO BE PROTECTED FROM DAMAGE TO EXISTING INFRASTRUCTURE.
  6. STABILIZATION SHALL BE PLACED TO PREVENT FLOODING FROM FULL FLOW AND TO BE PROTECTED FROM DAMAGE TO EXISTING INFRASTRUCTURE.
  7. STABILIZATION SHALL BE PLACED TO PREVENT FLOODING FROM FULL FLOW AND TO BE PROTECTED FROM DAMAGE TO EXISTING INFRASTRUCTURE.
  8. STABILIZATION SHALL BE PLACED TO PREVENT FLOODING FROM FULL FLOW AND TO BE PROTECTED FROM DAMAGE TO EXISTING INFRASTRUCTURE.
  9. STABILIZATION SHALL BE PLACED TO PREVENT FLOODING FROM FULL FLOW AND TO BE PROTECTED FROM DAMAGE TO EXISTING INFRASTRUCTURE.
  10. STABILIZATION SHALL BE PLACED TO PREVENT FLOODING FROM FULL FLOW AND TO BE PROTECTED FROM DAMAGE TO EXISTING INFRASTRUCTURE.

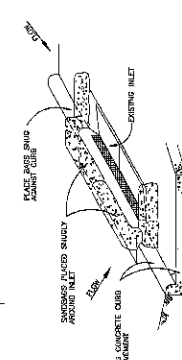

- GENERAL NOTES:**
1. BARRIERS SHALL BE PLACED TO PREVENT FLOODING FROM FULL FLOW AND TO BE PROTECTED FROM DAMAGE TO EXISTING INFRASTRUCTURE.
  2. BARRIERS SHALL BE PLACED TO PREVENT FLOODING FROM FULL FLOW AND TO BE PROTECTED FROM DAMAGE TO EXISTING INFRASTRUCTURE.
  3. BARRIERS SHALL BE PLACED TO PREVENT FLOODING FROM FULL FLOW AND TO BE PROTECTED FROM DAMAGE TO EXISTING INFRASTRUCTURE.
  4. BARRIERS SHALL BE PLACED TO PREVENT FLOODING FROM FULL FLOW AND TO BE PROTECTED FROM DAMAGE TO EXISTING INFRASTRUCTURE.
  5. BARRIERS SHALL BE PLACED TO PREVENT FLOODING FROM FULL FLOW AND TO BE PROTECTED FROM DAMAGE TO EXISTING INFRASTRUCTURE.

**STABILIZED CONSTRUCTION ENTRANCE**



**DATE:** 12/21/14  
**APPROVED:** [Signature]  
**DESIGNER:** [Signature]





**BENCHMARK**  
 THE BENCHMARK FOR THIS PROJECT IS THE  
 CORNER OF THE INTERSECTION OF BITTERSWEET DRIVE  
 AND DEERFIELD ROAD. THE BENCHMARK IS  
 A 6" DIA. IRON PIPE SET IN A 24" DIA. CONCRETE  
 FOUNDATION. THE BENCHMARK IS 1.50' ABOVE  
 BENCHMARK CORNER.  
 ELEVATION = 65.87' (NAVD 83)

**T.B.M. 1**  
 THE BENCHMARK FOR THIS PROJECT IS THE  
 CORNER OF THE INTERSECTION OF BITTERSWEET DRIVE  
 AND DEERFIELD ROAD. THE BENCHMARK IS  
 A 6" DIA. IRON PIPE SET IN A 24" DIA. CONCRETE  
 FOUNDATION. THE BENCHMARK IS 1.50' ABOVE  
 BENCHMARK CORNER.  
 ELEVATION = 65.87' (NAVD 83)

**T.B.M. 2**  
 THE BENCHMARK FOR THIS PROJECT IS THE  
 CORNER OF THE INTERSECTION OF BITTERSWEET DRIVE  
 AND DEERFIELD ROAD. THE BENCHMARK IS  
 A 6" DIA. IRON PIPE SET IN A 24" DIA. CONCRETE  
 FOUNDATION. THE BENCHMARK IS 1.50' ABOVE  
 BENCHMARK CORNER.  
 ELEVATION = 65.87' (NAVD 83)

**T.B.M. 3**  
 THE BENCHMARK FOR THIS PROJECT IS THE  
 CORNER OF THE INTERSECTION OF BITTERSWEET DRIVE  
 AND DEERFIELD ROAD. THE BENCHMARK IS  
 A 6" DIA. IRON PIPE SET IN A 24" DIA. CONCRETE  
 FOUNDATION. THE BENCHMARK IS 1.50' ABOVE  
 BENCHMARK CORNER.  
 ELEVATION = 65.87' (NAVD 83)

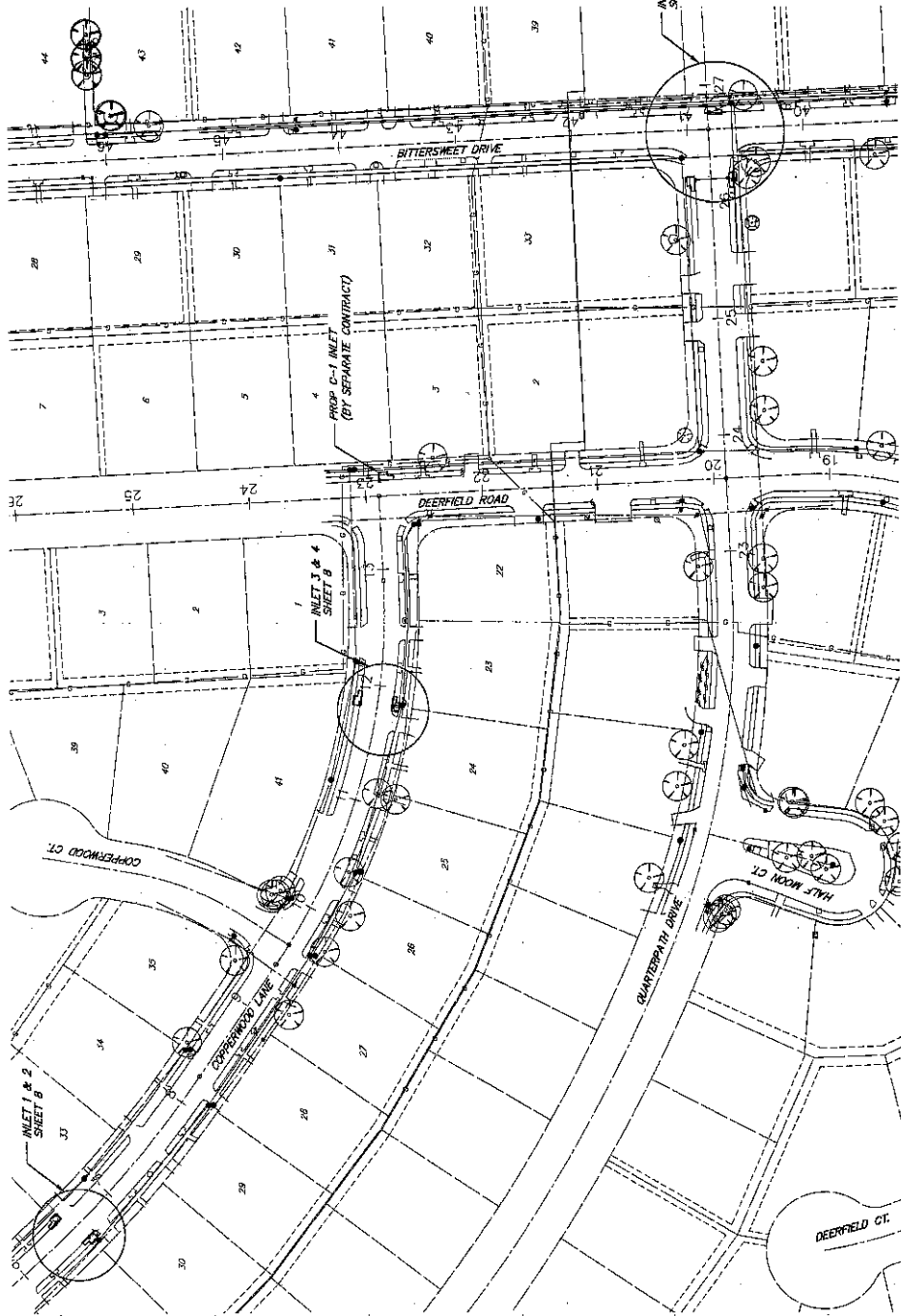

APPROVED: *[Signature]*  
 DEVELOPMENT COORDINATOR

DATE: 1/1/15

**PRIVATE UTILITY LINES SHOWN**  
 ARE BASED ON THE RECORD DRAWINGS OF THE  
 UTILITY LINES. THE LOCATION OF THE  
 UTILITY LINES IS NOT GUARANTEED.  
 THE ENGINEER HAS CONDUCTED VISUAL  
 INSPECTIONS OF THE UTILITY LINES  
 AND HAS FOUND THEM TO BE IN  
 ACCORDANCE WITH THE RECORD  
 DRAWINGS. THE ENGINEER HAS NOT  
 CONDUCTED ANY OTHER INVESTIGATION  
 OF THE UTILITY LINES. THE  
 ENGINEER HAS NOT GUARANTEED THE  
 LOCATION OR DEPTH OF THE  
 UTILITY LINES. THE ENGINEER HAS  
 NOT GUARANTEED THE LOCATION OR  
 DEPTH OF THE UTILITY LINES.

NO.	DATE	REVISIONS	APP.

PECAN GROVE MUD  
 FORT BEND COUNTY, TEXAS

PECAN GROVE PLANTATION 4 & 5  
 DRAINAGE IMPROVEMENTS  
 COPPERWOOD LANE &  
 BITTERSWEET INLET  
 OVERALL PLAN

**J.C. JONES & CARTER, P.C.**  
 1100 WEST 11TH STREET, SUITE 100  
 FORT WORTH, TEXAS 76102  
 (817) 339-1100  
 www.jcjonesandcarter.com

SCALE: 1" = 40'  
 DATE: 1/1/15  
 DRAWN BY: JEC  
 CHECKED BY: JEC  
 PROJECT NO.: 15000-0001-01  
 SHEET NO.: 3  
 OF 28

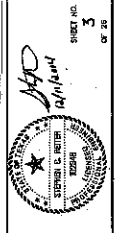

**BENCHMARK**

N253 Mcgrove Rd, N254 Street Cap to Top of HWY End of  
 the NE 1/4 Section 5, T15N, R15E, S15W, 1/4 Mile SW of Highway 101, S15  
 and 1/4 Mile NE of Richmond Court Road,  
 Elevation = 82.88 (NAVD 83)

**TEAM "A"**  
 DESIGNER: J. W. HARRIS  
 CHECKED: J. W. HARRIS  
 DATE: 12/1/14

**TEAM "B"**  
 DESIGNER: J. W. HARRIS  
 CHECKED: J. W. HARRIS  
 DATE: 12/1/14

**TEAM "C"**  
 DESIGNER: J. W. HARRIS  
 CHECKED: J. W. HARRIS  
 DATE: 12/1/14

**NOTE:**  
 THIS PLAN SHALL BE CONSIDERED VALID ONLY IN THE  
 PROJECT AREA, UNLESS TO THE CONTRARY INDICATED BY  
 THE CONTRACT DOCUMENTS. THE CONTRACTOR SHALL BE  
 RESPONSIBLE FOR VERIFYING THE ACCURACY OF ALL DATA  
 PROVIDED TO THE ENGINEER AND FOR OBTAINING ALL NECESSARY  
 PERMITS AND APPROVALS FROM THE APPROPRIATE AGENCIES.  
 PRIVATE COURTESY

APPROVED: *J. W. Harris*  
 DATE: 12/1/14

SCALE: 1" = 20'

**PRIVATE UTILITY LINES SHOWN**  
 ARE BASED ON RECORD DRAWINGS AND FIELD SURVEY.  
 THE CONTRACTOR SHALL VERIFY THE LOCATION AND DEPTH OF ALL  
 UTILITIES PRIOR TO CONSTRUCTION.

**THE GROVE 4 & 5  
 PRIVATE UTILITY LINES  
 PLAN & PROFILE  
 BASELINE A  
 STA 1+00 - 3+00**

**J. W. HARRIS ENGINEERING & SURVEYING**  
 1500 N. F.W. V. ROAD, SUITE 100  
 FORT WORTH, TEXAS 76104  
 PHONE: (817) 251-1111  
 FAX: (817) 251-1112  
 WWW: JWHE.COM

**THE GROVE 4 & 5  
 PRIVATE UTILITY LINES  
 PLAN & PROFILE  
 BASELINE A  
 STA 1+00 - 3+00**

**J. W. HARRIS ENGINEERING & SURVEYING**  
 1500 N. F.W. V. ROAD, SUITE 100  
 FORT WORTH, TEXAS 76104  
 PHONE: (817) 251-1111  
 FAX: (817) 251-1112  
 WWW: JWHE.COM

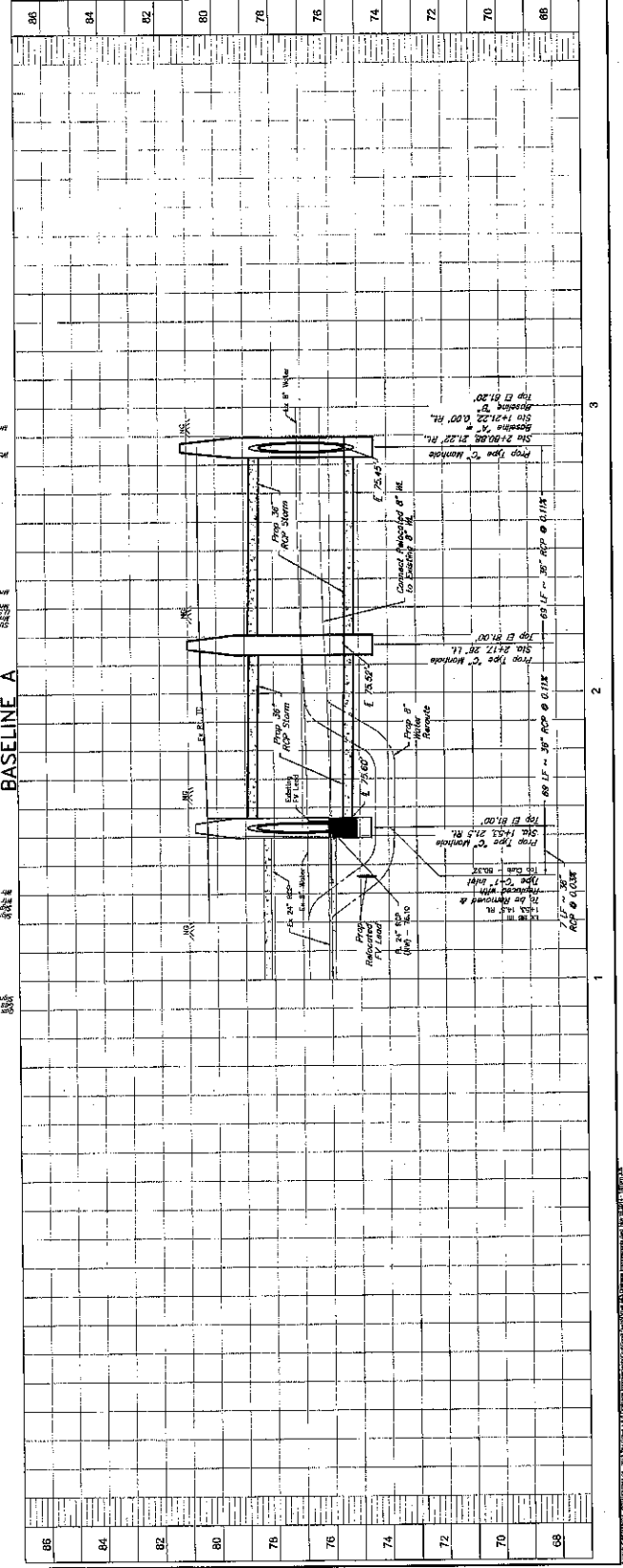
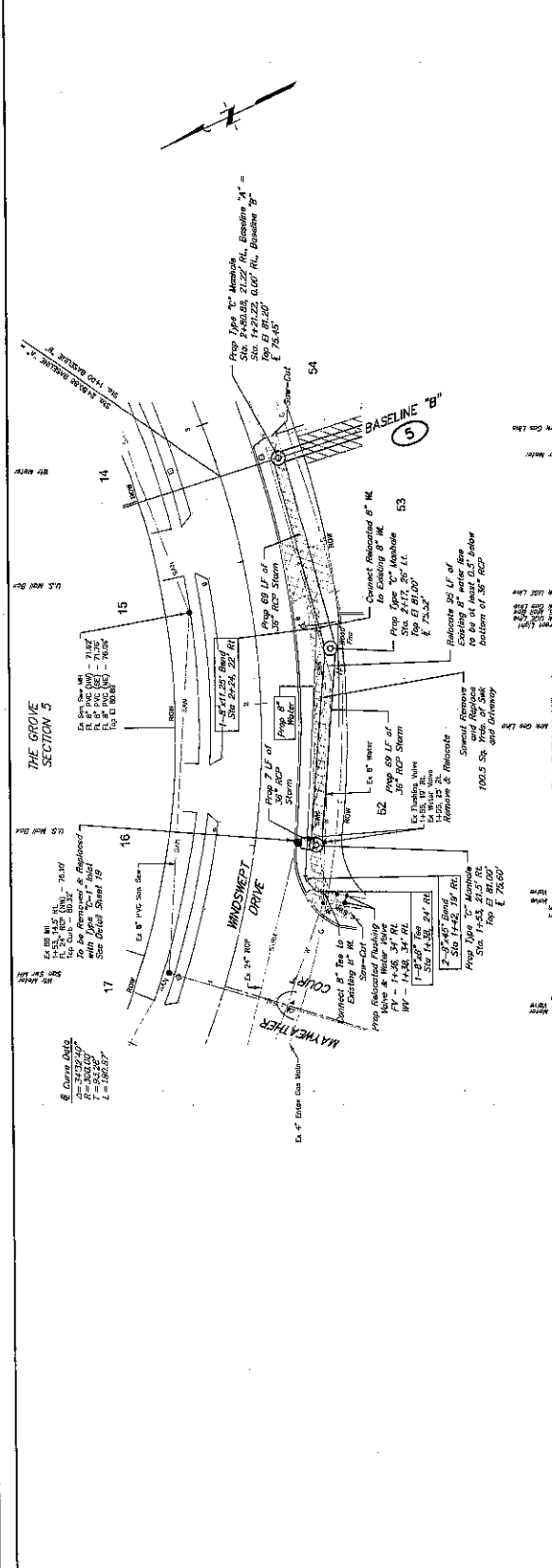



**REVISIONS**

NO. 1. REVISION: No. 1, Add, Remove, Change in Type of Work, Etc. of any item shown on this drawing. All changes shall be shown by a note referring to the location of the change on the drawing. All changes shall be made in pencil.

NO. 2. REVISION: No. 2, Add, Remove, Change in Type of Work, Etc. of any item shown on this drawing. All changes shall be shown by a note referring to the location of the change on the drawing. All changes shall be made in pencil.

NO. 3. REVISION: No. 3, Add, Remove, Change in Type of Work, Etc. of any item shown on this drawing. All changes shall be shown by a note referring to the location of the change on the drawing. All changes shall be made in pencil.

NO. 4. REVISION: No. 4, Add, Remove, Change in Type of Work, Etc. of any item shown on this drawing. All changes shall be shown by a note referring to the location of the change on the drawing. All changes shall be made in pencil.

NO. 5. REVISION: No. 5, Add, Remove, Change in Type of Work, Etc. of any item shown on this drawing. All changes shall be shown by a note referring to the location of the change on the drawing. All changes shall be made in pencil.

DATE: 1/21/14

APPROVED: [Signature]

SCALE: 1" = 30'

PROJECT: THE GROVE A & B  
 DRAINAGE IMPROVEMENTS  
 PLAN & PROFILE  
 BASELINE B  
 STA 1+00 - 3+50

PECAN GROVE MUNICIPAL UTILITY DISTRICT  
 FORT BEND COUNTY, TEXAS

THE GROVE A & B  
 ENGINEER: JAMES B. CARTER, P.E.  
 ENGINEER NUMBER: 12853  
 DATE: AUGUST 2014  
 JOB NO.: 08034-008-01  
 SHEET NO.: 5  
 OF 5

PECAN GROVE LEVEE

10' Construction Easement

10' Utility Easement

WINDSWEEP DRIVE

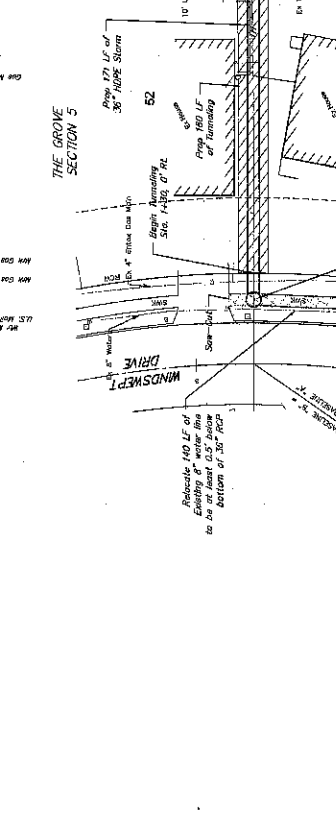
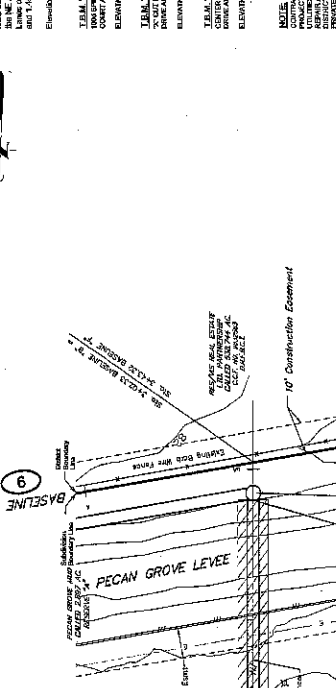

NO.	DESCRIPTION	DATE
1	AS SHOWN	
2	AS SHOWN	
3	AS SHOWN	
4	AS SHOWN	
5	AS SHOWN	

STATION	ELEVATION	DESCRIPTION
1+00	78.45	Prop. 12" Manhole
1+10	78.45	Prop. 12" Manhole
1+20	78.45	Prop. 12" Manhole
1+30	78.45	Prop. 12" Manhole
1+40	78.45	Prop. 12" Manhole
1+50	78.45	Prop. 12" Manhole
2+00	78.45	Prop. 12" Manhole
2+10	78.45	Prop. 12" Manhole
2+20	78.45	Prop. 12" Manhole
2+30	78.45	Prop. 12" Manhole
2+40	78.45	Prop. 12" Manhole
2+50	78.45	Prop. 12" Manhole
3+00	78.45	Prop. 12" Manhole
3+10	78.45	Prop. 12" Manhole
3+20	78.45	Prop. 12" Manhole
3+30	78.45	Prop. 12" Manhole
3+40	78.45	Prop. 12" Manhole
3+50	78.45	Prop. 12" Manhole

PECAN GROVE LEVEE  
 10' Construction Easement  
 10' Utility Easement  
 WINDSWEEP DRIVE

THE GROVE A & B  
 DRAINAGE IMPROVEMENTS  
 PLAN & PROFILE  
 BASELINE B  
 STA 1+00 - 3+50

PECAN GROVE MUNICIPAL UTILITY DISTRICT  
 FORT BEND COUNTY, TEXAS

THE GROVE A & B  
 ENGINEER: JAMES B. CARTER, P.E.  
 ENGINEER NUMBER: 12853  
 DATE: AUGUST 2014  
 JOB NO.: 08034-008-01  
 SHEET NO.: 5  
 OF 5

DATE: 1/21/14

APPROVED: [Signature]

SCALE: 1" = 30'

PROJECT: THE GROVE A & B  
 DRAINAGE IMPROVEMENTS  
 PLAN & PROFILE  
 BASELINE B  
 STA 1+00 - 3+50

PECAN GROVE MUNICIPAL UTILITY DISTRICT  
 FORT BEND COUNTY, TEXAS

THE GROVE A & B  
 ENGINEER: JAMES B. CARTER, P.E.  
 ENGINEER NUMBER: 12853  
 DATE: AUGUST 2014  
 JOB NO.: 08034-008-01  
 SHEET NO.: 5  
 OF 5

PECAN GROVE LEVEE  
 10' Construction Easement  
 10' Utility Easement  
 WINDSWEEP DRIVE

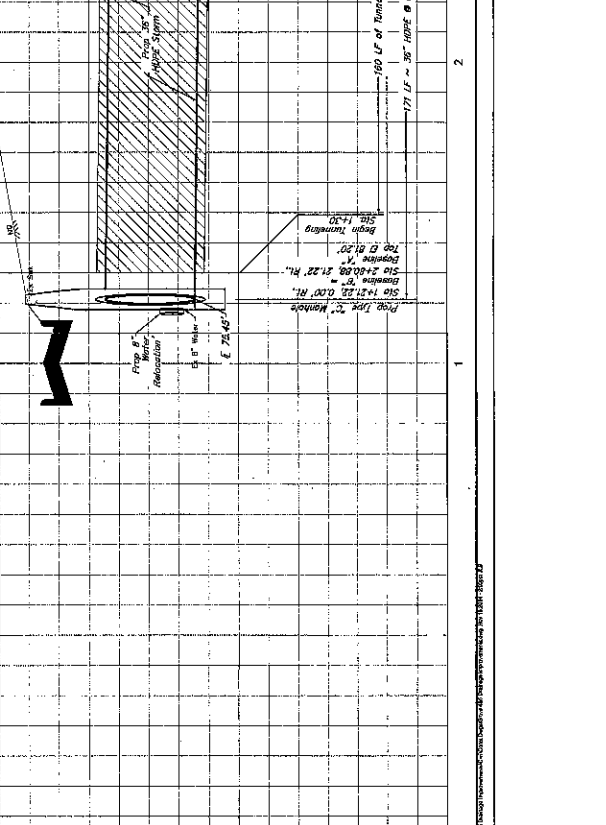
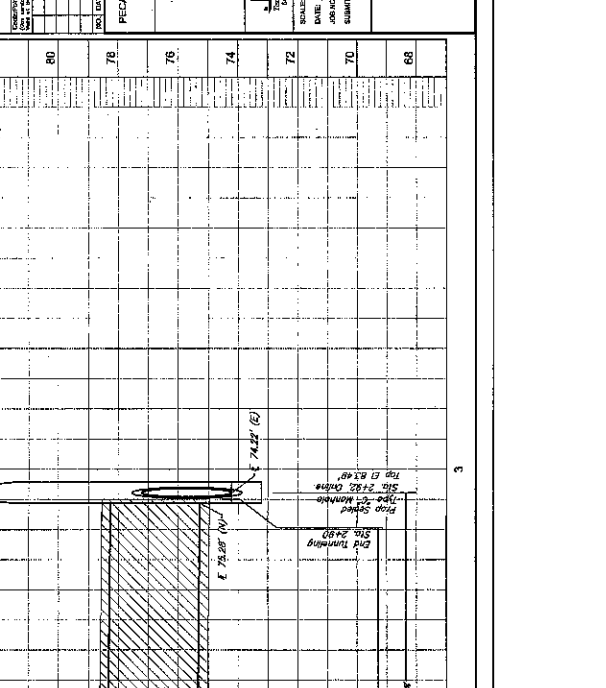

STATION	ELEVATION	DESCRIPTION
1+00	78.45	Prop. 12" Manhole
1+10	78.45	Prop. 12" Manhole
1+20	78.45	Prop. 12" Manhole
1+30	78.45	Prop. 12" Manhole
1+40	78.45	Prop. 12" Manhole
1+50	78.45	Prop. 12" Manhole
2+00	78.45	Prop. 12" Manhole
2+10	78.45	Prop. 12" Manhole
2+20	78.45	Prop. 12" Manhole
2+30	78.45	Prop. 12" Manhole
2+40	78.45	Prop. 12" Manhole
2+50	78.45	Prop. 12" Manhole
3+00	78.45	Prop. 12" Manhole
3+10	78.45	Prop. 12" Manhole
3+20	78.45	Prop. 12" Manhole
3+30	78.45	Prop. 12" Manhole
3+40	78.45	Prop. 12" Manhole
3+50	78.45	Prop. 12" Manhole

PECAN GROVE LEVEE  
 10' Construction Easement  
 10' Utility Easement  
 WINDSWEEP DRIVE







REVISIONS

1. NCS (Movement No. 1089), Blaine Camp II, Top of NW End of Section 5, Township 34N, Range 10E, Meridian 10E, Section 5, T.34N. R.10E. M.10E, NE of Intersection of Highway 100 and U.S. Hwy 30A, 3.1 Miles NE of Junction of FM 509 and 1.45 Miles NE of Pecan Grove House.  
Elevation = 82.88 (NAVD 88)

2. THE GROVE SECTION 5  
Prop. 10' LF of 12" Steel Casing  
See Sheet 12

3. THE GROVE SECTION 5  
Prop. 10' LF of 12" Steel Casing  
See Sheet 12

4. THE GROVE SECTION 5  
Prop. 10' LF of 12" Steel Casing  
See Sheet 12

5. THE GROVE SECTION 5  
Prop. 10' LF of 12" Steel Casing  
See Sheet 12

6. THE GROVE SECTION 5  
Prop. 10' LF of 12" Steel Casing  
See Sheet 12

7. THE GROVE SECTION 5  
Prop. 10' LF of 12" Steel Casing  
See Sheet 12

8. THE GROVE SECTION 5  
Prop. 10' LF of 12" Steel Casing  
See Sheet 12

9. THE GROVE SECTION 5  
Prop. 10' LF of 12" Steel Casing  
See Sheet 12

10. THE GROVE SECTION 5  
Prop. 10' LF of 12" Steel Casing  
See Sheet 12

TABLE 1  
ELEVATION DATA  
ELEVATION = 82.88 (NAVD 88)

TABLE 2  
ELEVATION DATA  
ELEVATION = 82.88 (NAVD 88)

TABLE 3  
ELEVATION DATA  
ELEVATION = 82.88 (NAVD 88)

TABLE 4  
ELEVATION DATA  
ELEVATION = 82.88 (NAVD 88)

TABLE 5  
ELEVATION DATA  
ELEVATION = 82.88 (NAVD 88)

TABLE 6  
ELEVATION DATA  
ELEVATION = 82.88 (NAVD 88)

TABLE 7  
ELEVATION DATA  
ELEVATION = 82.88 (NAVD 88)

TABLE 8  
ELEVATION DATA  
ELEVATION = 82.88 (NAVD 88)

TABLE 9  
ELEVATION DATA  
ELEVATION = 82.88 (NAVD 88)

TABLE 10  
ELEVATION DATA  
ELEVATION = 82.88 (NAVD 88)

NOTE:  
CONTRACTOR SHALL USE CAUTION WHEN EXCAVATING IN  
PROXIMITY TO EXISTING UTILITIES. ALL UTILITIES SHALL BE  
LOCATED AND DEPTH DETERMINED PRIOR TO EXCAVATION.  
THE CONTRACTOR SHALL BE RESPONSIBLE FOR OBTAINING ALL  
NECESSARY PERMITS AND COORDINATING WITH ALL  
UTILITY OWNERS.  
PRIVATE OWNERS

APPROVED: *[Signature]*  
DATE: 7/21/14

SCALE: 1" = 20'  
PRIVATE UTILITY LINES SHOWN  
BASED ON THE LATEST AVAILABLE RECORDS.  
THE CONTRACTOR SHALL VERIFY THE LOCATION AND DEPTH OF ALL  
UTILITIES PRIOR TO EXCAVATION.  
THE CONTRACTOR SHALL BE RESPONSIBLE FOR OBTAINING ALL  
NECESSARY PERMITS AND COORDINATING WITH ALL  
UTILITY OWNERS.  
PRIVATE OWNERS

THE GROVE 4 & 5  
DRAINAGE IMPROVEMENTS  
PLAN & PROFILE  
BASELINE D  
STA 1+00 - 5+00

J.C. JONES & CARTER, INC.  
ENGINEER PLUMBER - MECHANICAL  
1015 S. GARDNER ST. SUITE 100  
DALLAS, TEXAS 75215  
PHONE: (214) 343-1111  
FAX: (214) 343-1112  
WWW.JONESANDCARTER.COM

DATE: 7/21/14  
PROJECT NO.: 14-001  
SHEET NO.: 5  
TOTAL SHEETS: 7

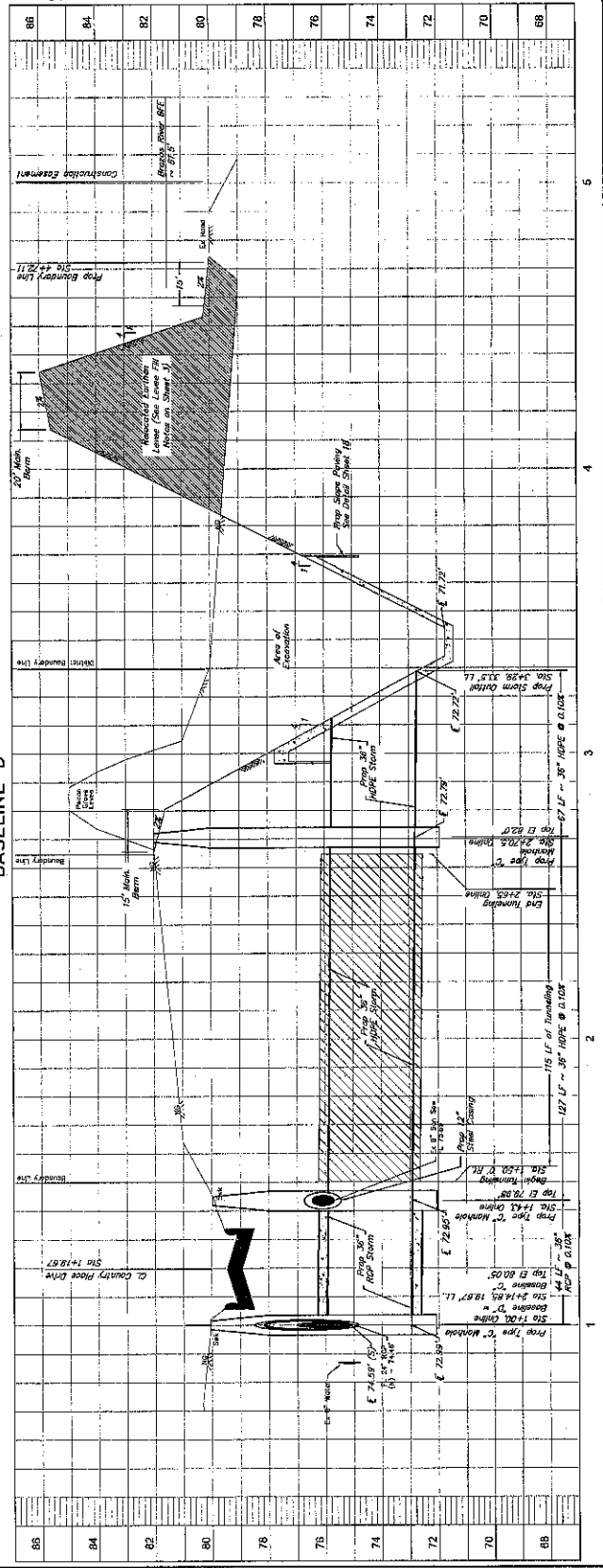
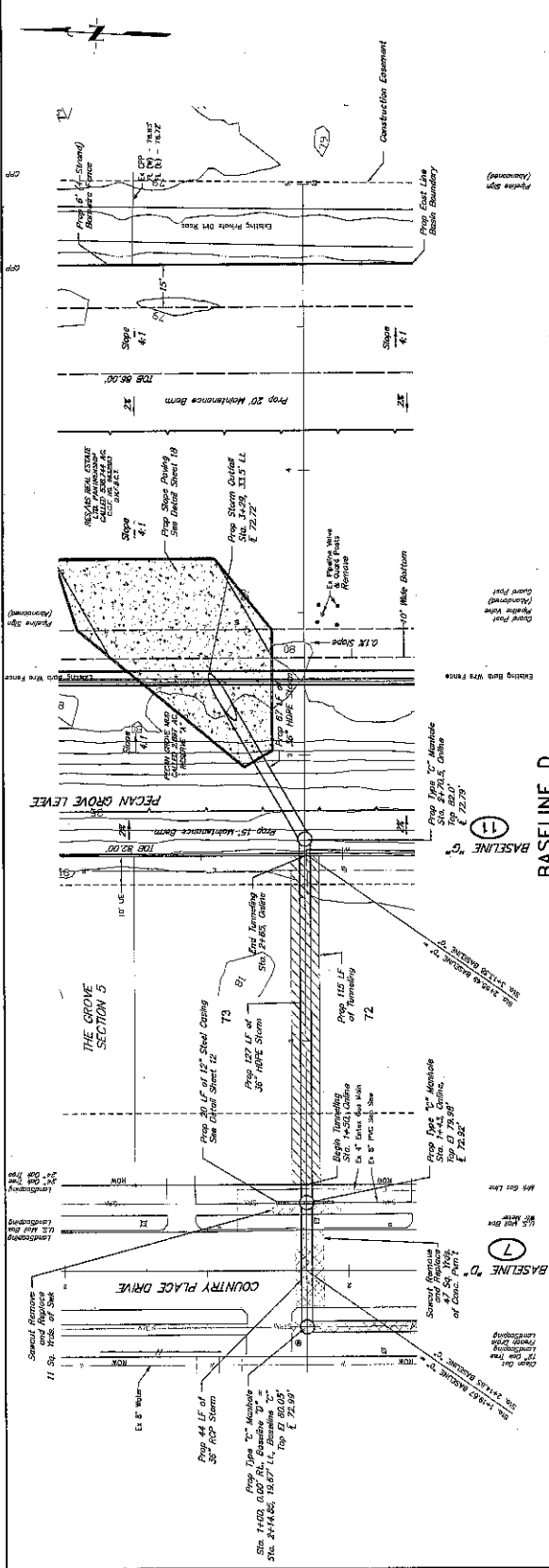

86  
84  
82  
80  
78  
76  
74  
72  
70  
68

1  
2  
3  
4  
5

**BENCH MARK**  
 ALL BENCH MARKS SHOWN ON THIS PLAN ARE TO BE USED AS CHECKED POINTS FOR THE SURVEY. THE BENCH MARK DATA IS TO BE USED TO CHECK THE SURVEY. THE BENCH MARK DATA IS TO BE USED TO CHECK THE SURVEY. THE BENCH MARK DATA IS TO BE USED TO CHECK THE SURVEY.

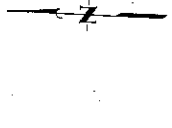

APPROVED: *[Signature]*  
 SURVEYOR  
 DATE: 2/10/15

PRIVATE UTILITY LINES SHOWN  
 ARE NOT TO BE CONSIDERED AS GUARANTEED OR WARRANTED. THE USER OF THIS PLAN SHALL BE RESPONSIBLE FOR VERIFYING THE LOCATION AND DEPTH OF ALL UTILITIES BEFORE ANY CONSTRUCTION.

NO.	DATE	REVISIONS	APP.

PECAN GROVE M.U.D.  
 FORT BEND COUNTY, TEXAS  
 PECAN GROVE PLANTATION 4 & 5  
 DRAINAGE IMPROVEMENTS  
 NORTH BASIN  
 CROSS SECTION

J.C. JONES & CARTER, INC.  
 6555 West Loop South, Suite 100, Houston, Texas 77037  
 DATE: 2/10/15  
 DRAWN BY: JEM  
 CHECKED BY: JEM  
 SCALE: 1" = 40'



SHEET NO. 7  
 OF 25

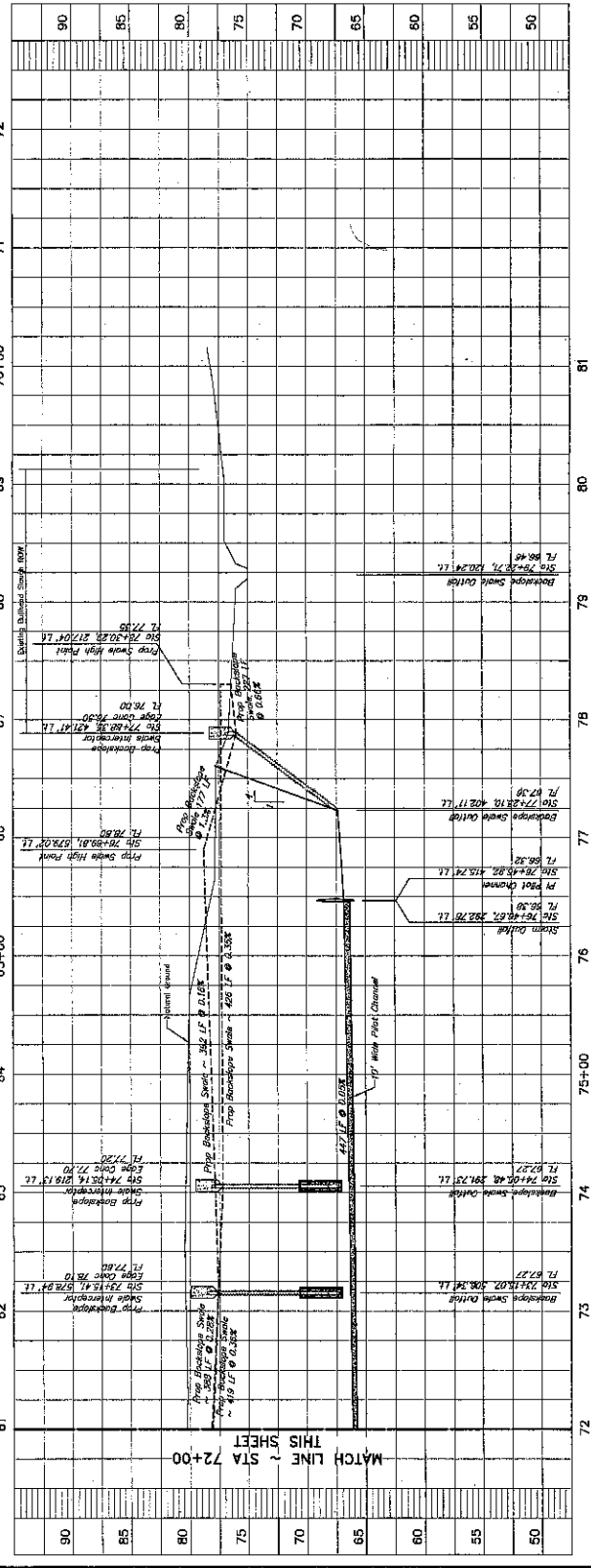
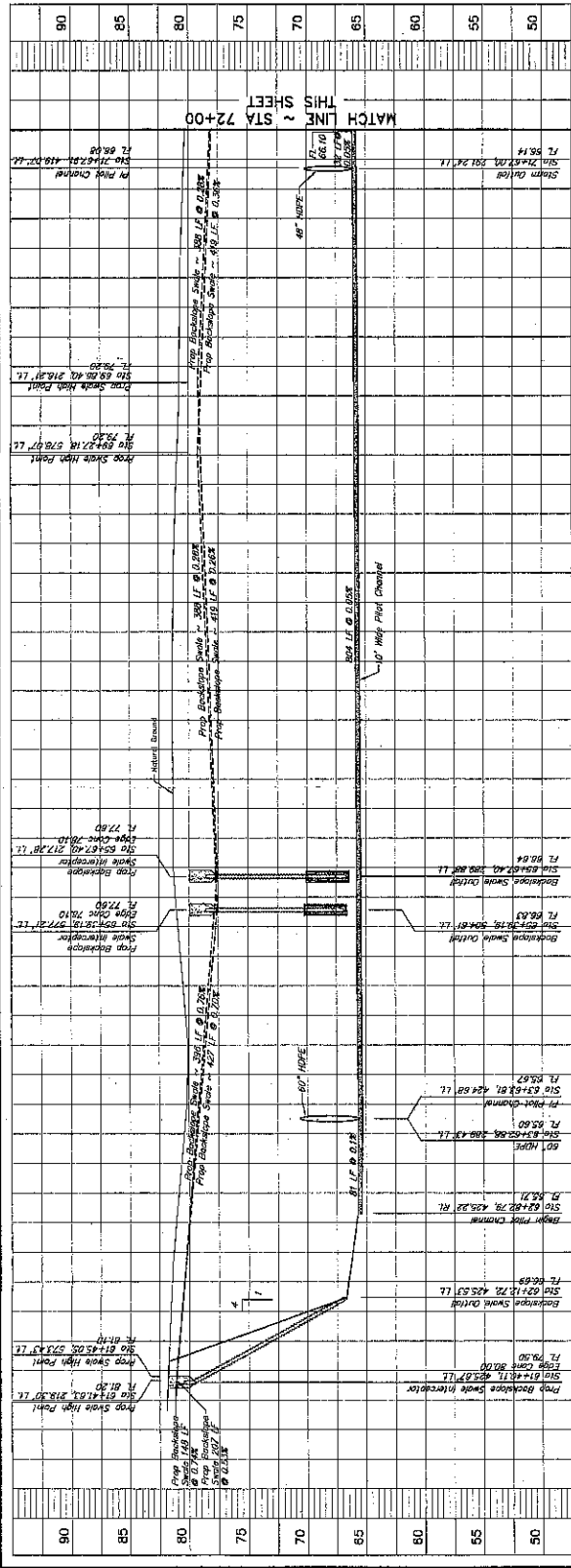

www.jonesandcarter.com

**REVISIONS**

NCS (Movement No. 1084, Basin Cap in Top of NW Cor of Lot 11, Section 4, T&M, 11th & 12th Sts., City of Fort Worth, Texas, and 1.45 Miles NE of Richland Court House, T&M 118) (NAD 83)

T&M 118  
 DATE: 10/22/14  
 ELEVATION: 1083 (NAD 83)

T&M 118  
 DATE: 10/22/14  
 ELEVATION: 1083 (NAD 83)

T&M 118  
 DATE: 10/22/14  
 ELEVATION: 1083 (NAD 83)

T&M 118  
 DATE: 10/22/14  
 ELEVATION: 1083 (NAD 83)

**NOTE:** CONTRACTOR SHALL USE CALL TO DETERMINE EXISTING CONDITIONS AND SHALL BE RESPONSIBLE FOR OBTAINING ALL NECESSARY PERMITS AND APPROVALS FROM ALL APPLICABLE AGENCIES. CONTRACTOR SHALL BE RESPONSIBLE FOR OBTAINING ALL NECESSARY PERMITS AND APPROVALS FROM ALL APPLICABLE AGENCIES. CONTRACTOR SHALL BE RESPONSIBLE FOR OBTAINING ALL NECESSARY PERMITS AND APPROVALS FROM ALL APPLICABLE AGENCIES.

APPROVED: *[Signature]*  
 DATE: 10/22/14

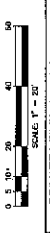

**PRIVATE UTILITY LINES SHOWN**  
 ALL PRIVATE UTILITY LINES SHOWN ARE BASED ON RECORD DRAWINGS AND FIELD SURVEY. CONTRACTOR SHALL VERIFY ALL PRIVATE UTILITY LINES PRIOR TO CONSTRUCTION.

NO.	DATE	REVISIONS	BY
1	10/22/14	ISSUED FOR PERMITTING	JK

THE GROVE 4 & 5  
 DRAINAGE IMPROVEMENTS  
 PLAN & PROFILE  
 BASELINE E  
 STA 1+00 - 5+00

JC JONES & ASSOCIATES  
 ENGINEERS, ARCHITECTS & PLANNERS  
 1000 W. CALDWAY  
 FORT WORTH, TEXAS 76102  
 PHONE: 817.335.1234  
 FAX: 817.335.1235  
 WWW: JONESANDASSOCIATES.COM

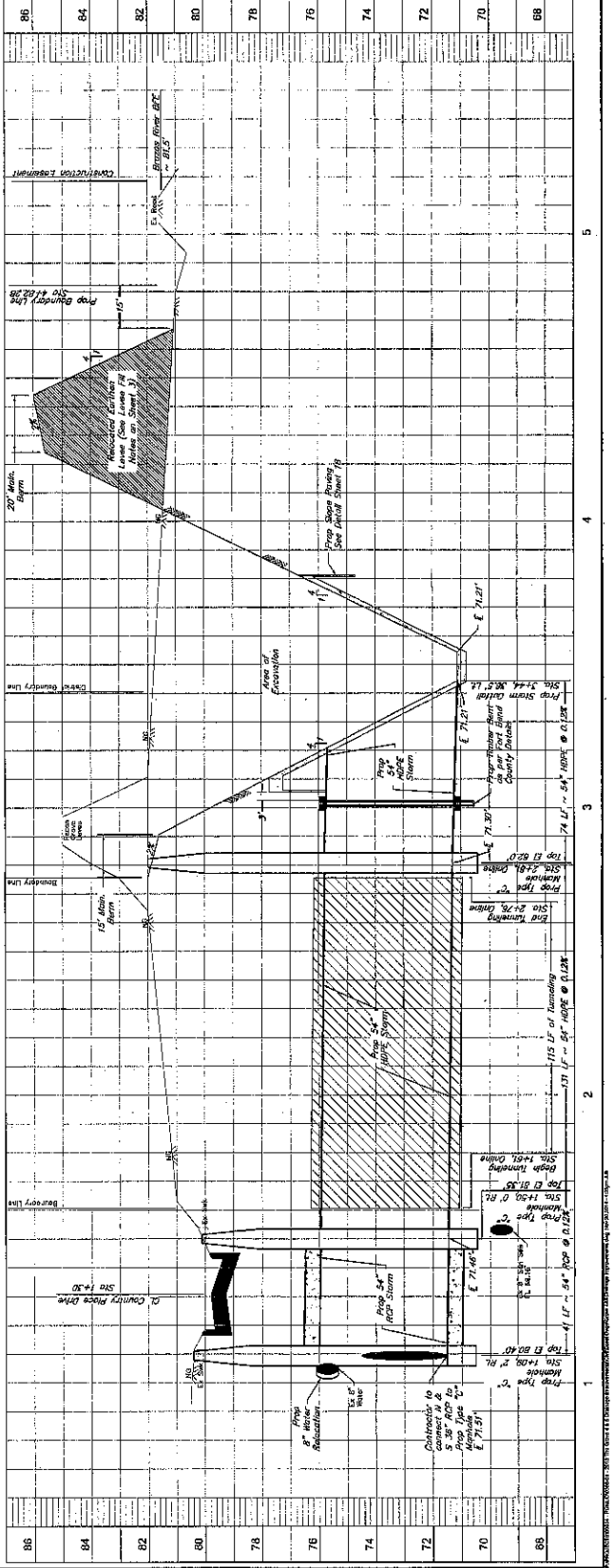
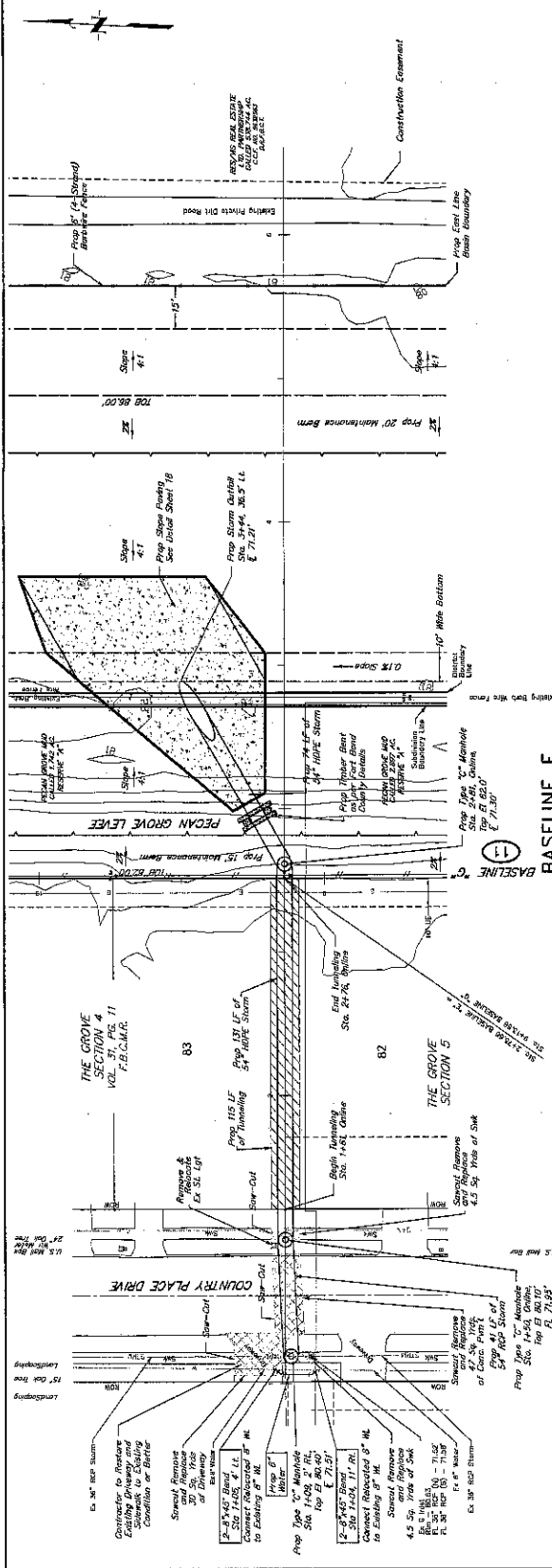

PEACAN GROVE MUNICIPAL UTILITY DISTRICT  
 FORT WORTH COUNTY, TEXAS

THE GROVE 4 & 5  
 DRAINAGE IMPROVEMENTS  
 PLAN & PROFILE  
 BASELINE E  
 STA 1+00 - 5+00

J.C. JONES & ASSOCIATES  
 ENGINEERS, ARCHITECTS & PLANNERS  
 1000 W. CALDWAY  
 FORT WORTH, TEXAS 76102  
 PHONE: 817.335.1234  
 FAX: 817.335.1235  
 WWW: JONESANDASSOCIATES.COM

PROJ: 2014-001-001-01  
 SHEET: 1 OF 1  
 DATE: 10/22/14







**BENCHMARK**

NEED Measurement No. 1004, Brass City in Top of NW 1/4 of Sec. 10, T. 10 N., R. 10 E., S. 10 E., 10th Meridian, Garza County, Texas, 1.45 Miles NE of Richmond, Texas. Elevation = 82.80' (NAVD 83)

**TERMS:**  
 1. THE CONTRACTOR SHALL BE RESPONSIBLE FOR OBTAINING ALL NECESSARY PERMITS FROM THE APPROPRIATE AGENCIES.  
 2. THE CONTRACTOR SHALL BE RESPONSIBLE FOR OBTAINING ALL NECESSARY EASEMENTS FROM THE PROPERTY OWNERS.  
 3. THE CONTRACTOR SHALL BE RESPONSIBLE FOR OBTAINING ALL NECESSARY RIGHTS-OF-WAY FROM THE APPROPRIATE AGENCIES.  
 4. THE CONTRACTOR SHALL BE RESPONSIBLE FOR OBTAINING ALL NECESSARY UTILITIES FROM THE APPROPRIATE AGENCIES.  
 5. THE CONTRACTOR SHALL BE RESPONSIBLE FOR OBTAINING ALL NECESSARY RECORDS FROM THE APPROPRIATE AGENCIES.

**NOTES:**  
 1. THE CONTRACTOR SHALL BE RESPONSIBLE FOR OBTAINING ALL NECESSARY PERMITS FROM THE APPROPRIATE AGENCIES.  
 2. THE CONTRACTOR SHALL BE RESPONSIBLE FOR OBTAINING ALL NECESSARY EASEMENTS FROM THE PROPERTY OWNERS.  
 3. THE CONTRACTOR SHALL BE RESPONSIBLE FOR OBTAINING ALL NECESSARY RIGHTS-OF-WAY FROM THE APPROPRIATE AGENCIES.  
 4. THE CONTRACTOR SHALL BE RESPONSIBLE FOR OBTAINING ALL NECESSARY UTILITIES FROM THE APPROPRIATE AGENCIES.  
 5. THE CONTRACTOR SHALL BE RESPONSIBLE FOR OBTAINING ALL NECESSARY RECORDS FROM THE APPROPRIATE AGENCIES.

**APPROVED:** [Signature]  
 DATE: 1/14/14

**SCALE:** 1" = 50'  
 0 10 20 30 40 50 60 70 80 90 100

**PRIVATE UTILITY LINES SHOWN**  
 BASED ON RECORD DRAWINGS AND FIELD SURVEY DATA.  
 DATE: 1/14/14

**PECAN GROVE MUNICIPAL UTILITY DISTRICT**  
 FORT BEND COUNTY, TEXAS

**THE GROVE 4 & 5**  
 DRAINAGE IMPROVEMENTS  
**PLAN & PROFILE**  
**BASELINE F**  
**STA 10+00 - 17+00**

**J.C. JONES & SONS**  
 ENGINEERS & ARCHITECTS  
 1411 West 10th Street, Suite 100, Fort Worth, Texas 76102  
 Phone: (817) 339-1111  
 Fax: (817) 339-1112

**DATE:** 1/14/14  
**SCALE:** 1" = 50'  
**PROJECT NO.:** 14-001  
**DRAWING NO.:** 14-001-01  
**DATE:** 1/14/14

**DESIGNED BY:** [Name]  
**CHECKED BY:** [Name]  
**DATE:** 1/14/14

**PROJECT NO.:** 14-001  
**DRAWING NO.:** 14-001-01  
**DATE:** 1/14/14

**PROJECT NO.:** 14-001  
**DRAWING NO.:** 14-001-01  
**DATE:** 1/14/14

**PROJECT NO.:** 14-001  
**DRAWING NO.:** 14-001-01  
**DATE:** 1/14/14

**PROJECT NO.:** 14-001  
**DRAWING NO.:** 14-001-01  
**DATE:** 1/14/14

**PROJECT NO.:** 14-001  
**DRAWING NO.:** 14-001-01  
**DATE:** 1/14/14

**PROJECT NO.:** 14-001  
**DRAWING NO.:** 14-001-01  
**DATE:** 1/14/14

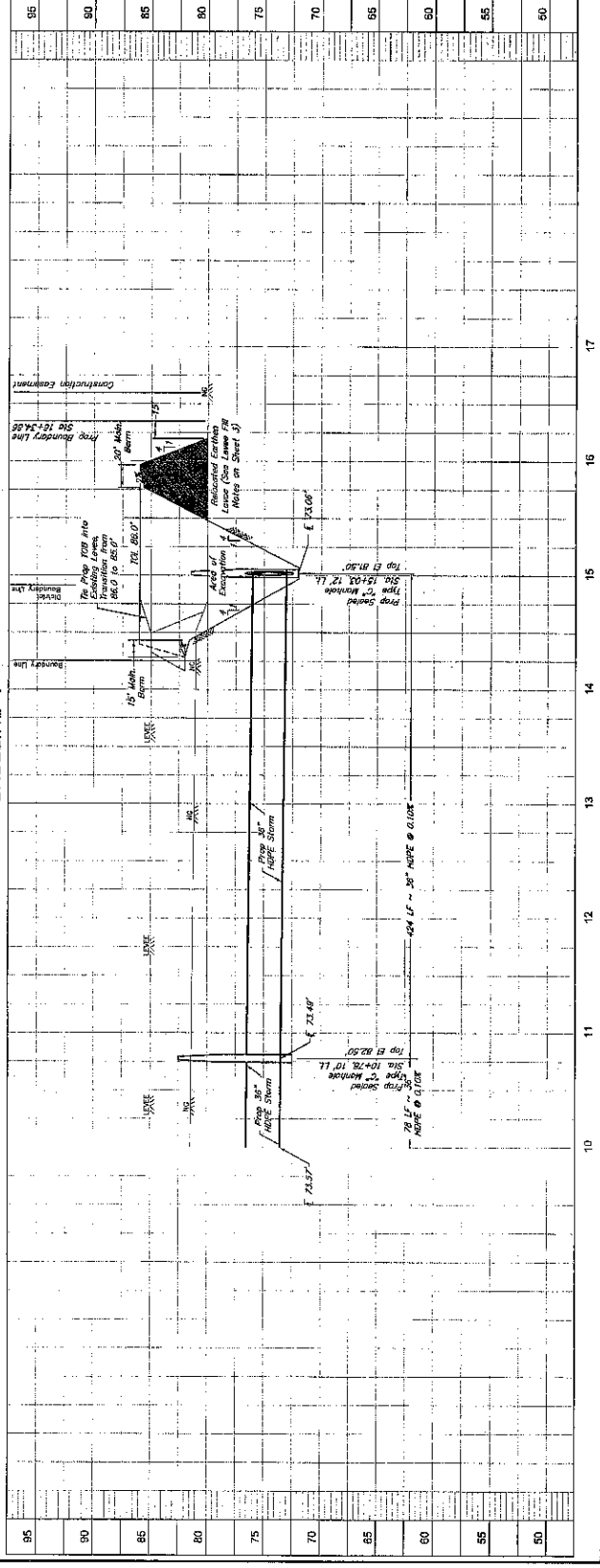
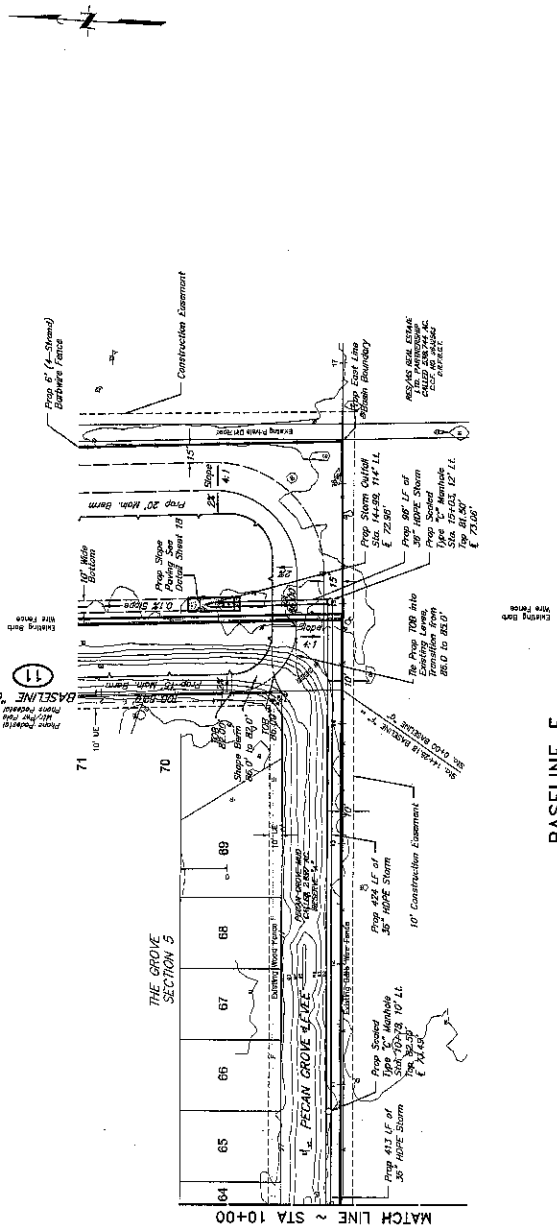

**PECAN GROVE MUNICIPAL UTILITY DISTRICT**  
 FORT BEND COUNTY, TEXAS

**THE GROVE 4 & 5**  
 DRAINAGE IMPROVEMENTS  
**PLAN & PROFILE**  
**BASELINE F**  
**STA 10+00 - 17+00**

**J.C. JONES & SONS**  
 ENGINEERS & ARCHITECTS  
 1411 West 10th Street, Suite 100, Fort Worth, Texas 76102  
 Phone: (817) 339-1111  
 Fax: (817) 339-1112

**DATE:** 1/14/14  
**SCALE:** 1" = 50'  
**PROJECT NO.:** 14-001  
**DRAWING NO.:** 14-001-01  
**DATE:** 1/14/14

**DESIGNED BY:** [Name]  
**CHECKED BY:** [Name]  
**DATE:** 1/14/14

**PROJECT NO.:** 14-001  
**DRAWING NO.:** 14-001-01  
**DATE:** 1/14/14

**BENCH MARK**  
 1. ELEVATION OF THE TOP OF THE CURB OF THE SIDEWALK OF A CONCRETE ROADWAY SHALL BE THE BENCH MARK FOR THE LOCATION OF THE CURB OF THE SIDEWALK OF A CONCRETE ROADWAY.  
 2. ELEVATION OF THE TOP OF THE CURB OF A CONCRETE ROADWAY SHALL BE THE BENCH MARK FOR THE LOCATION OF THE CURB OF THE SIDEWALK OF A CONCRETE ROADWAY.  
 3. ELEVATION OF THE TOP OF THE CURB OF A CONCRETE ROADWAY SHALL BE THE BENCH MARK FOR THE LOCATION OF THE CURB OF THE SIDEWALK OF A CONCRETE ROADWAY.

**LEGEND**  
 1. ELEVATION OF THE TOP OF THE CURB OF A CONCRETE ROADWAY SHALL BE THE BENCH MARK FOR THE LOCATION OF THE CURB OF THE SIDEWALK OF A CONCRETE ROADWAY.  
 2. ELEVATION OF THE TOP OF THE CURB OF A CONCRETE ROADWAY SHALL BE THE BENCH MARK FOR THE LOCATION OF THE CURB OF THE SIDEWALK OF A CONCRETE ROADWAY.  
 3. ELEVATION OF THE TOP OF THE CURB OF A CONCRETE ROADWAY SHALL BE THE BENCH MARK FOR THE LOCATION OF THE CURB OF THE SIDEWALK OF A CONCRETE ROADWAY.

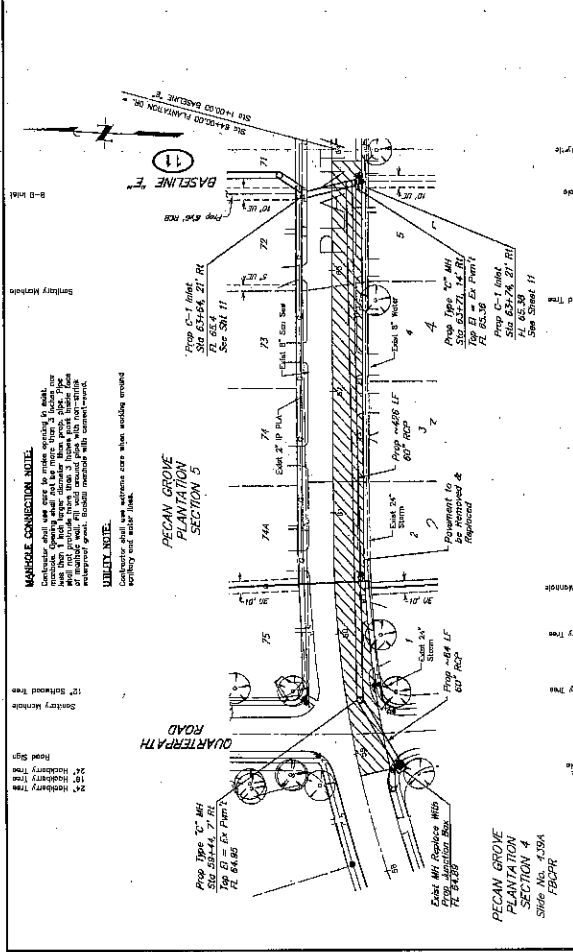
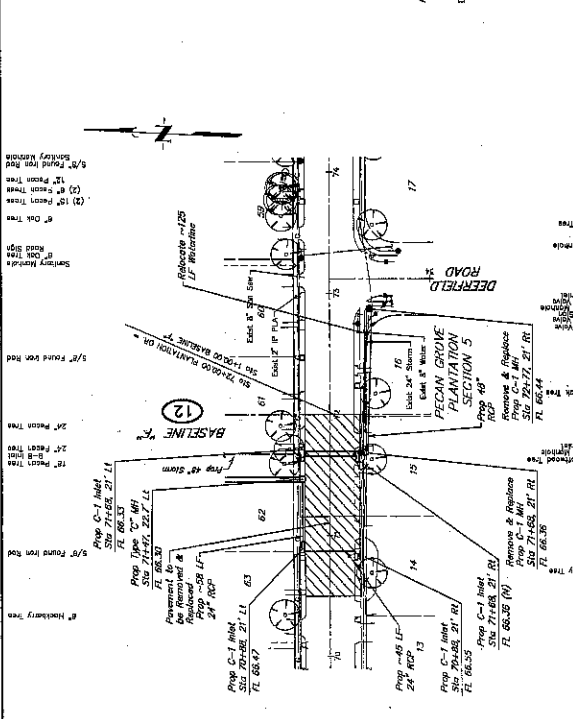

**PRIVATE UTILITY LINES SHOWN**  
 ALL UTILITIES SHOWN ARE BASED ON RECORD DRAWINGS AND FIELD SURVEY. THE ENGINEER HAS CONDUCTED VISUAL INSPECTIONS OF THE UTILITIES SHOWN AND HAS FOUND THEM TO BE IN SUBSTANTIAL ACCORD WITH THE RECORD DRAWINGS AND FIELD SURVEY. THE ENGINEER HAS NOT CONDUCTED TESTS OF THE UTILITIES SHOWN AND HAS NOT GUARANTEED THE ACCURACY OF THE UTILITIES SHOWN.

**APPROVED:** [Signature]  
**DATE:** 2/1/15

**LEGEND**  
 1. ELEVATION OF THE TOP OF THE CURB OF A CONCRETE ROADWAY SHALL BE THE BENCH MARK FOR THE LOCATION OF THE CURB OF THE SIDEWALK OF A CONCRETE ROADWAY.  
 2. ELEVATION OF THE TOP OF THE CURB OF A CONCRETE ROADWAY SHALL BE THE BENCH MARK FOR THE LOCATION OF THE CURB OF THE SIDEWALK OF A CONCRETE ROADWAY.  
 3. ELEVATION OF THE TOP OF THE CURB OF A CONCRETE ROADWAY SHALL BE THE BENCH MARK FOR THE LOCATION OF THE CURB OF THE SIDEWALK OF A CONCRETE ROADWAY.

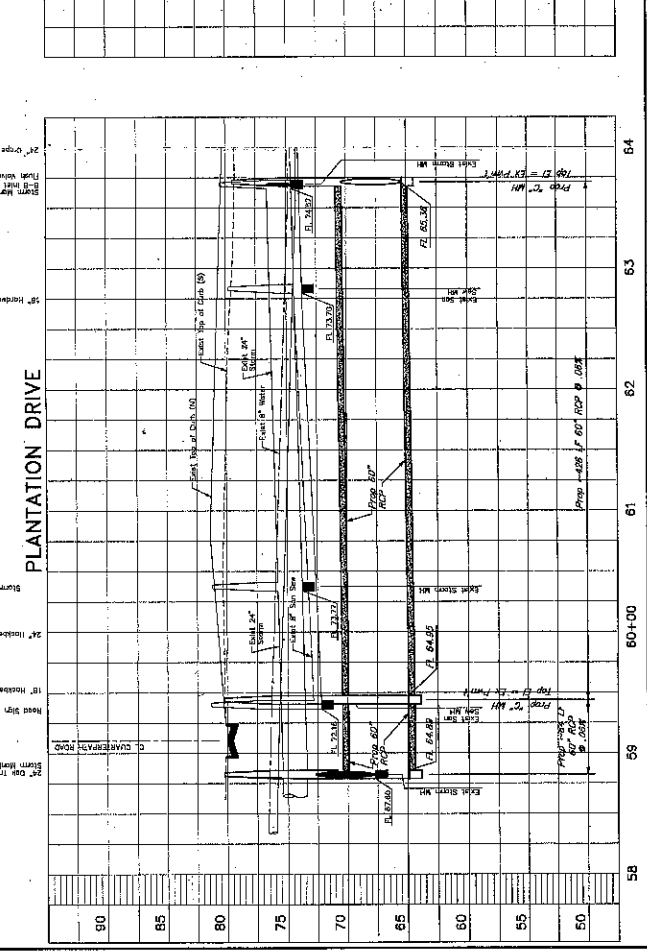
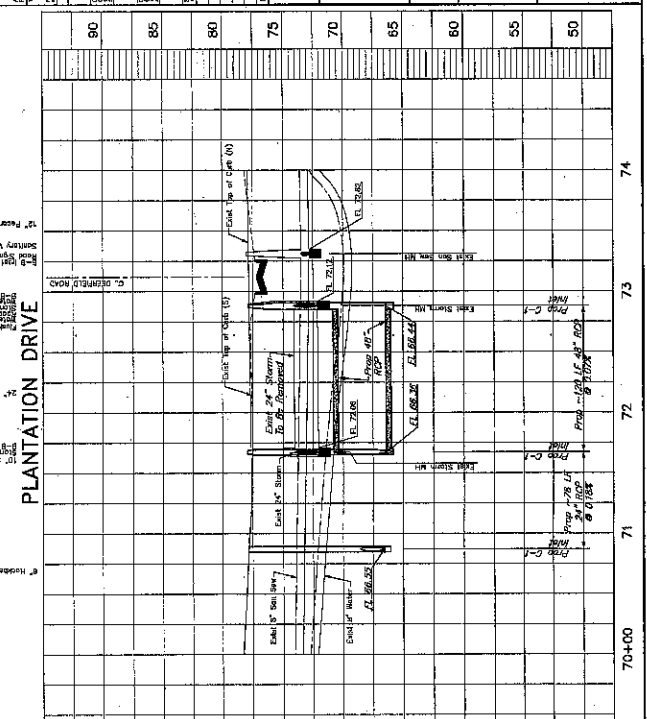

**PECAN GROVE PLANTATION 4 & 5**  
 PLANTATION DRIVE  
 STA 58+00 TO STA 64+00  
 STA 70+00 TO STA 74+00

**J.C. JONES & CARTER, INC.**  
 ENGINEERS AND ARCHITECTS  
 1500 N. G. ST. W. SUITE 200  
 FORT WORTH, TEXAS 76102  
 PHONE: 817-335-1111  
 FAX: 817-335-1112

**STATE OF TEXAS**  
 ENGINEER'S SEAL  
 J.C. JONES & CARTER, INC.  
 ENGINEERS AND ARCHITECTS  
 LICENSE NO. 10110

**PECAN GROVE PLANTATION SECTION 4**  
 SHEET NO. 439A  
 FBCPR

**PECAN GROVE PLANTATION SECTION 5**  
 SHEET NO. 439B  
 FBCPR







**BENCH MARK**  
 BENCH MARK IS A POINT OF KNOWN ELEVATION OF THE SURFACE OF THE GROUND OR AN OBJECT THEREON. THE BENCH MARK IS A POINT OF KNOWN ELEVATION OF THE SURFACE OF THE GROUND OR AN OBJECT THEREON. THE BENCH MARK IS A POINT OF KNOWN ELEVATION OF THE SURFACE OF THE GROUND OR AN OBJECT THEREON.

**TERMINAL**  
 TERMINAL IS A POINT OF KNOWN ELEVATION OF THE SURFACE OF THE GROUND OR AN OBJECT THEREON. THE TERMINAL IS A POINT OF KNOWN ELEVATION OF THE SURFACE OF THE GROUND OR AN OBJECT THEREON. THE TERMINAL IS A POINT OF KNOWN ELEVATION OF THE SURFACE OF THE GROUND OR AN OBJECT THEREON.

**TERMINAL**  
 TERMINAL IS A POINT OF KNOWN ELEVATION OF THE SURFACE OF THE GROUND OR AN OBJECT THEREON. THE TERMINAL IS A POINT OF KNOWN ELEVATION OF THE SURFACE OF THE GROUND OR AN OBJECT THEREON. THE TERMINAL IS A POINT OF KNOWN ELEVATION OF THE SURFACE OF THE GROUND OR AN OBJECT THEREON.

**TERMINAL**  
 TERMINAL IS A POINT OF KNOWN ELEVATION OF THE SURFACE OF THE GROUND OR AN OBJECT THEREON. THE TERMINAL IS A POINT OF KNOWN ELEVATION OF THE SURFACE OF THE GROUND OR AN OBJECT THEREON. THE TERMINAL IS A POINT OF KNOWN ELEVATION OF THE SURFACE OF THE GROUND OR AN OBJECT THEREON.

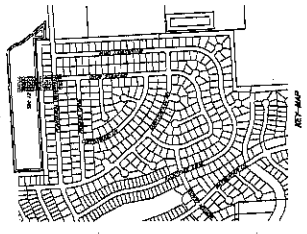

**LEGEND**  
 ALL FILL SHALL BE PLACED AS SHOWN IN MAXIMUM OF 4" LAYERS AT 4' INTERVALS TO THE MAXIMUM HEIGHT AS SHOWN. ALL FILL SHALL BE PLACED AS SHOWN IN MAXIMUM OF 4" LAYERS AT 4' INTERVALS TO THE MAXIMUM HEIGHT AS SHOWN.

**UTILITY NOTE**  
 CONDUCTOR SHALL BE 1/2" MINIMUM IN DIAMETER. CONDUCTOR SHALL BE 1/2" MINIMUM IN DIAMETER. CONDUCTOR SHALL BE 1/2" MINIMUM IN DIAMETER. CONDUCTOR SHALL BE 1/2" MINIMUM IN DIAMETER.

**MANHOLE CONNECTION NOTE**  
 CONDUCTOR SHALL BE 1/2" MINIMUM IN DIAMETER. CONDUCTOR SHALL BE 1/2" MINIMUM IN DIAMETER. CONDUCTOR SHALL BE 1/2" MINIMUM IN DIAMETER. CONDUCTOR SHALL BE 1/2" MINIMUM IN DIAMETER.

**UTILITY NOTE**  
 CONDUCTOR SHALL BE 1/2" MINIMUM IN DIAMETER. CONDUCTOR SHALL BE 1/2" MINIMUM IN DIAMETER. CONDUCTOR SHALL BE 1/2" MINIMUM IN DIAMETER. CONDUCTOR SHALL BE 1/2" MINIMUM IN DIAMETER.

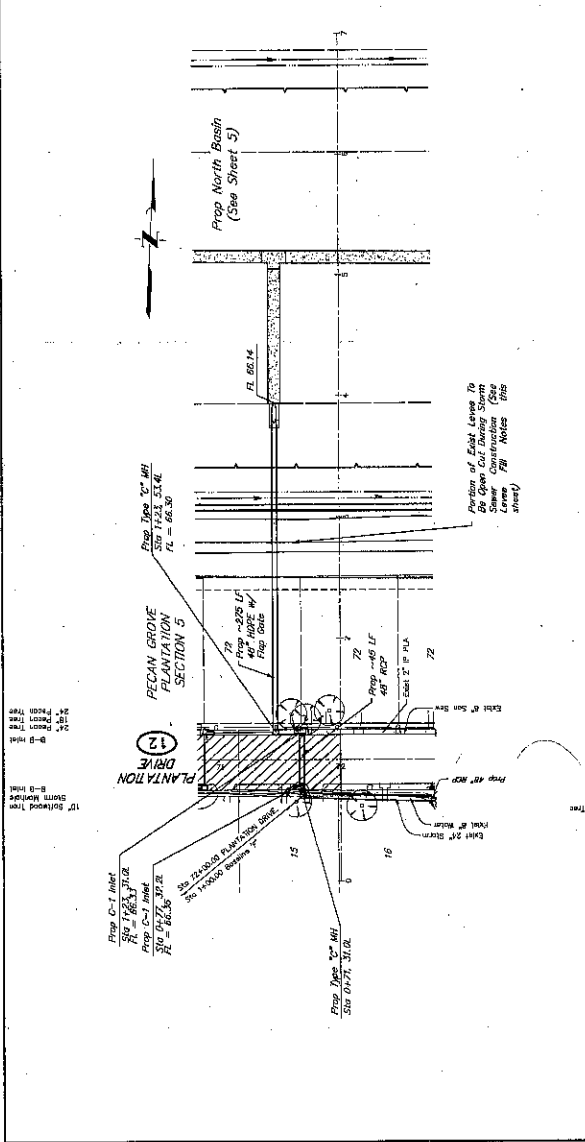

**PRIVATE UTILITY LINES SHOWN**  
 PRIVATE UTILITY LINES SHOWN ARE FOR INFORMATION ONLY. THE ENGINEER HAS NOT INVESTIGATED THE DEPTH OR LOCATION OF THESE LINES. THE ENGINEER HAS NOT INVESTIGATED THE DEPTH OR LOCATION OF THESE LINES. THE ENGINEER HAS NOT INVESTIGATED THE DEPTH OR LOCATION OF THESE LINES.

**APPROVED:** [Signature]  
**DATE:** 12/15/2011

**LEGEND**  
 Limits of government to be shown and required.

**PROJECT INFORMATION**  
 PROJECT NAME: PECAN GROVE PLANTATION 4 & 5 DRAINAGE IMPROVEMENTS  
 CLIENT: J.C. JONES & CARTER, INC.  
 ADDRESS: 1200 AL. CASKY, FORT BEND COUNTY, TEXAS 78122  
 PHONE: (832) 835-1111  
 FAX: (832) 835-1111

**DESIGNER**  
 DESIGNER: J.C. JONES & CARTER, INC.  
 ADDRESS: 1200 AL. CASKY, FORT BEND COUNTY, TEXAS 78122  
 PHONE: (832) 835-1111  
 FAX: (832) 835-1111

**DATE**  
 DATE: 12/15/2011

**SCALE**  
 SCALE: 1" = 40'

**SHEET NO.**  
 SHEET NO.: 12 OF 28

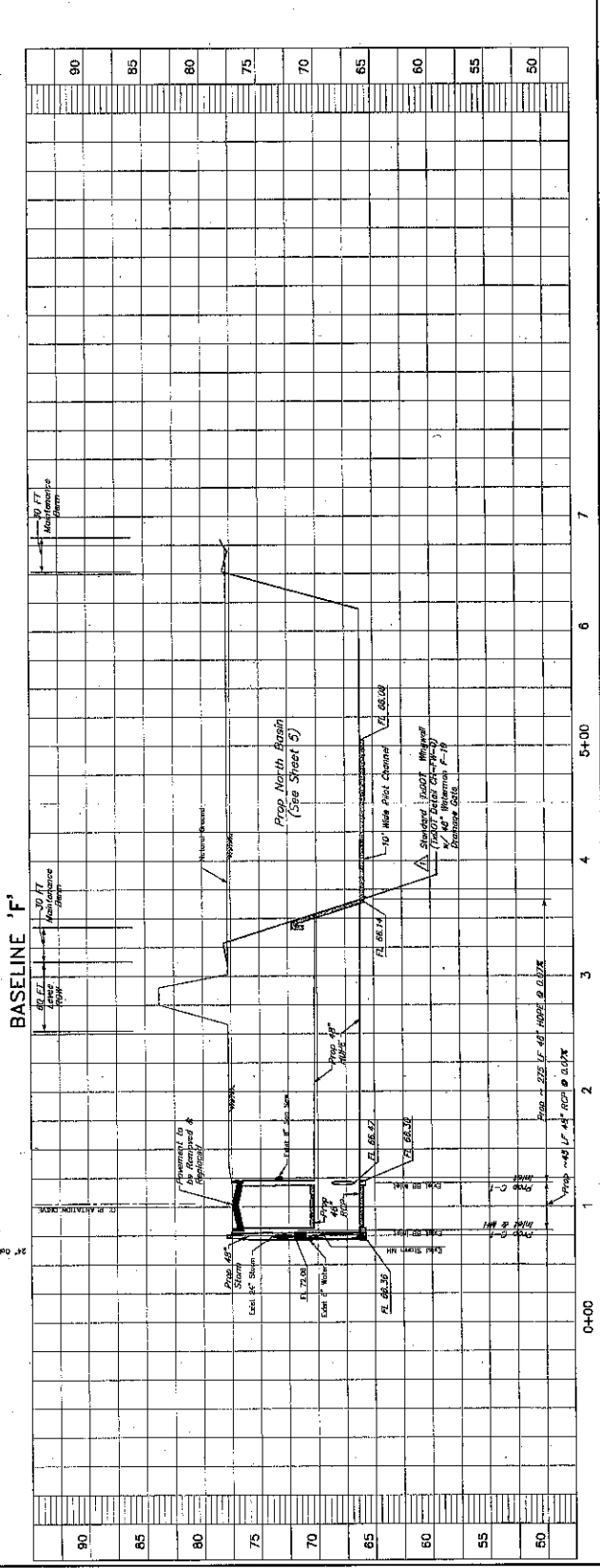







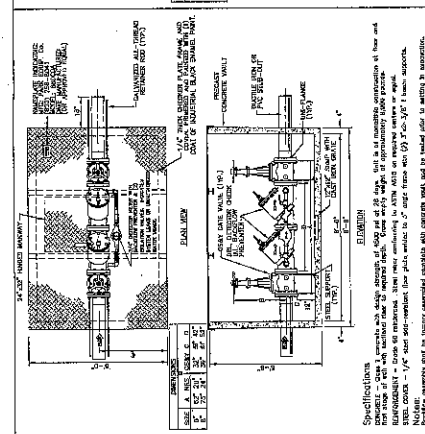
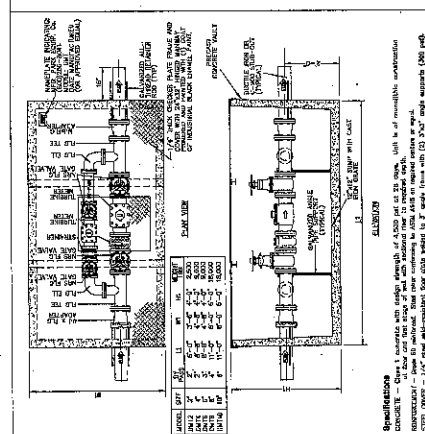
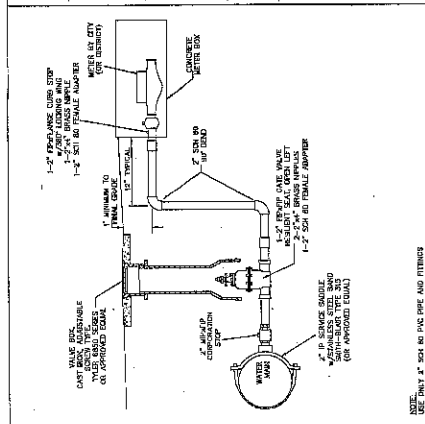
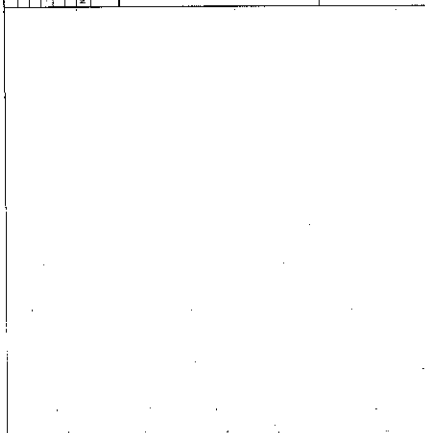

**1. DOUBLE CHECK DETECTOR ASSEMBLY**

Specifications:

- 1. Check detector assembly shall be of the type which is self-cleaning and which will operate in the presence of hard water.
- 2. Check detector assembly shall be of the type which is self-cleaning and which will operate in the presence of hard water.
- 3. Check detector assembly shall be of the type which is self-cleaning and which will operate in the presence of hard water.
- 4. Check detector assembly shall be of the type which is self-cleaning and which will operate in the presence of hard water.

**2. DOMESTIC TURBINE WATER METER ASSEMBLY**

Specifications:

- 1. Domestic turbine water meter shall be of the type which is self-cleaning and which will operate in the presence of hard water.
- 2. Domestic turbine water meter shall be of the type which is self-cleaning and which will operate in the presence of hard water.
- 3. Domestic turbine water meter shall be of the type which is self-cleaning and which will operate in the presence of hard water.
- 4. Domestic turbine water meter shall be of the type which is self-cleaning and which will operate in the presence of hard water.

**3. 2" WATER SERVICE CONNECTION**

Specifications:

- 1. Water service connection shall be of the type which is self-cleaning and which will operate in the presence of hard water.
- 2. Water service connection shall be of the type which is self-cleaning and which will operate in the presence of hard water.
- 3. Water service connection shall be of the type which is self-cleaning and which will operate in the presence of hard water.
- 4. Water service connection shall be of the type which is self-cleaning and which will operate in the presence of hard water.

**4. RESIDENTIAL WATER METER AND SERVICE LINE**

Specifications:

- 1. Residential water meter and service line shall be of the type which is self-cleaning and which will operate in the presence of hard water.
- 2. Residential water meter and service line shall be of the type which is self-cleaning and which will operate in the presence of hard water.
- 3. Residential water meter and service line shall be of the type which is self-cleaning and which will operate in the presence of hard water.
- 4. Residential water meter and service line shall be of the type which is self-cleaning and which will operate in the presence of hard water.

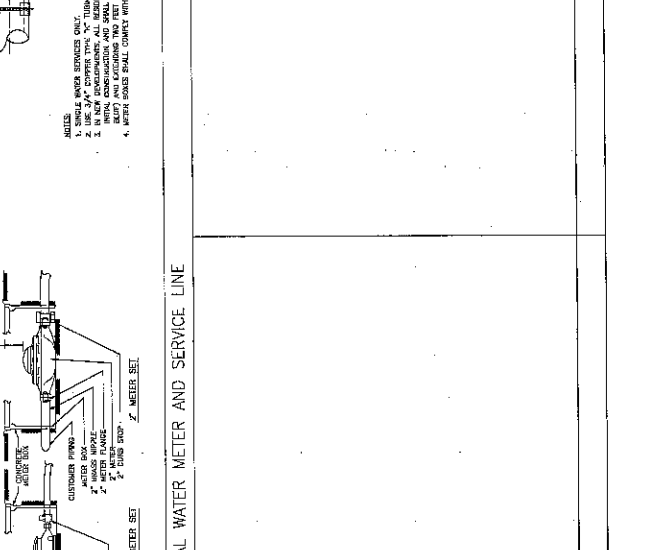
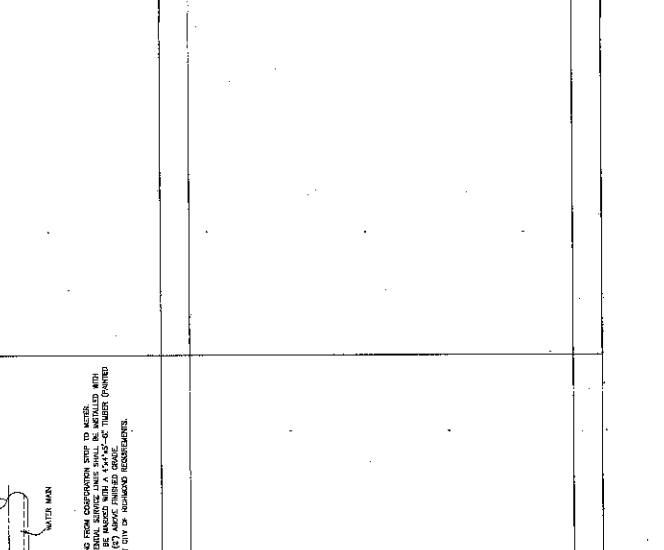
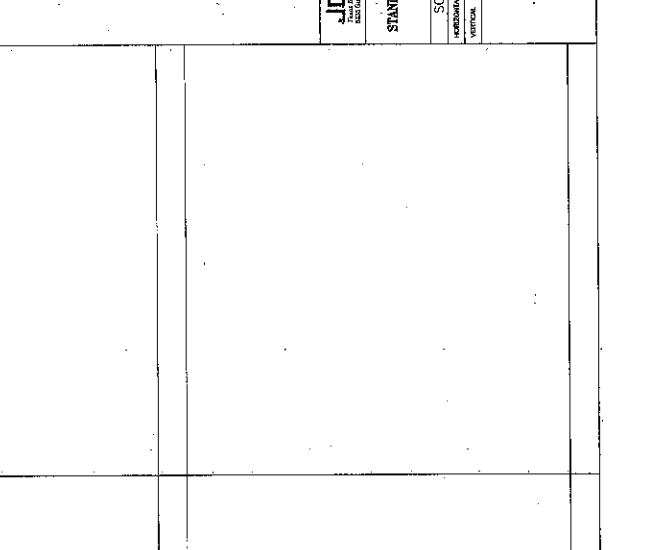

REVISIONS:

- 1. NCS Measurement of 1/2" Bench Chain to the NE End of the NE Corner of a Concrete Bridge Abutment. Elevation: 148.15. Prop. Sta. 40+00.00. Station of Junction of P.M. 208 and 209. (P.M. 208)
- 2. Prop. Sta. 40+00.00. Station of Junction of P.M. 208 and 209. (P.M. 208)
- 3. Prop. Sta. 40+00.00. Station of Junction of P.M. 208 and 209. (P.M. 208)
- 4. Prop. Sta. 40+00.00. Station of Junction of P.M. 208 and 209. (P.M. 208)
- 5. Prop. Sta. 40+00.00. Station of Junction of P.M. 208 and 209. (P.M. 208)
- 6. Prop. Sta. 40+00.00. Station of Junction of P.M. 208 and 209. (P.M. 208)
- 7. Prop. Sta. 40+00.00. Station of Junction of P.M. 208 and 209. (P.M. 208)
- 8. Prop. Sta. 40+00.00. Station of Junction of P.M. 208 and 209. (P.M. 208)
- 9. Prop. Sta. 40+00.00. Station of Junction of P.M. 208 and 209. (P.M. 208)
- 10. Prop. Sta. 40+00.00. Station of Junction of P.M. 208 and 209. (P.M. 208)
- 11. Prop. Sta. 40+00.00. Station of Junction of P.M. 208 and 209. (P.M. 208)
- 12. Prop. Sta. 40+00.00. Station of Junction of P.M. 208 and 209. (P.M. 208)
- 13. Prop. Sta. 40+00.00. Station of Junction of P.M. 208 and 209. (P.M. 208)
- 14. Prop. Sta. 40+00.00. Station of Junction of P.M. 208 and 209. (P.M. 208)
- 15. Prop. Sta. 40+00.00. Station of Junction of P.M. 208 and 209. (P.M. 208)
- 16. Prop. Sta. 40+00.00. Station of Junction of P.M. 208 and 209. (P.M. 208)
- 17. Prop. Sta. 40+00.00. Station of Junction of P.M. 208 and 209. (P.M. 208)
- 18. Prop. Sta. 40+00.00. Station of Junction of P.M. 208 and 209. (P.M. 208)
- 19. Prop. Sta. 40+00.00. Station of Junction of P.M. 208 and 209. (P.M. 208)
- 20. Prop. Sta. 40+00.00. Station of Junction of P.M. 208 and 209. (P.M. 208)
- 21. Prop. Sta. 40+00.00. Station of Junction of P.M. 208 and 209. (P.M. 208)
- 22. Prop. Sta. 40+00.00. Station of Junction of P.M. 208 and 209. (P.M. 208)
- 23. Prop. Sta. 40+00.00. Station of Junction of P.M. 208 and 209. (P.M. 208)
- 24. Prop. Sta. 40+00.00. Station of Junction of P.M. 208 and 209. (P.M. 208)

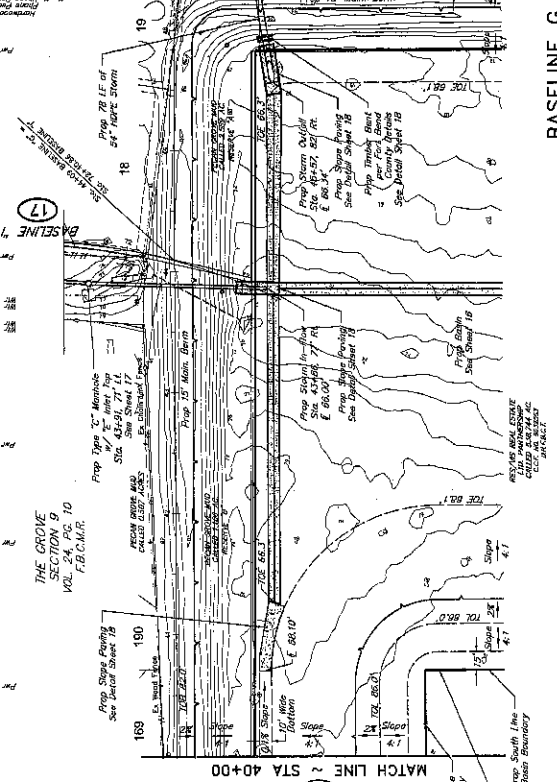
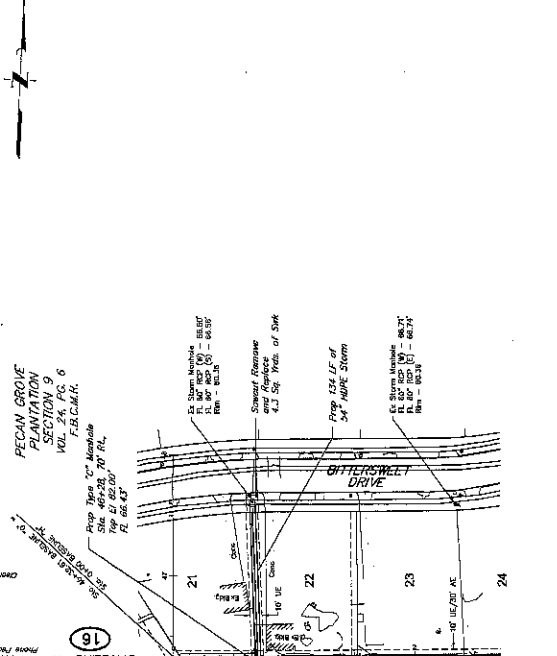

**PRIVATE UTILITY LINES SHOWN**  
 MAINTAINED BY THE PROPERTY OWNER(S)

DATE: 12/2/18

APPROVED: [Signature]

REVISIONS: [Table with columns for No., Date, and Description]

PECAN GROVE MUNICIPAL UTILITY DISTRICT  
 FORT BEND COUNTY, TEXAS

THE GROVE 4 & 5  
 DRAINAGE IMPROVEMENTS  
 PLAN & PROFILE  
 BASELINE G  
 STA 40+00 - 48+00

J.C. JONES & CARTER, INC.  
 ENGINEERS & PLANNERS  
 11000 FORT BEND COUNTY ROAD 2009, SUITE 100  
 FORT BEND COUNTY, TEXAS 78122-1009  
 PHONE: (281) 340-1009  
 FAX: (281) 340-1010

SCALE: 1" = 40' HORIZ. 1" = 4' VERT.

DATE: 12/2/18  
 DRAWN BY: J.C.J.  
 CHECKED BY: J.C.J.  
 PROJECT: 18-0001-001-01  
 SHEET NO.: 15  
 TOTAL SHEETS: 24















1	DATE	BY	REVISION
2	DATE	BY	REVISION
3	DATE	BY	REVISION
4	DATE	BY	REVISION
5	DATE	BY	REVISION

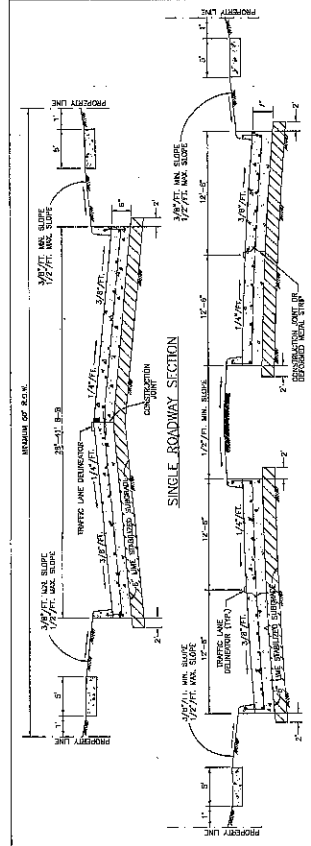
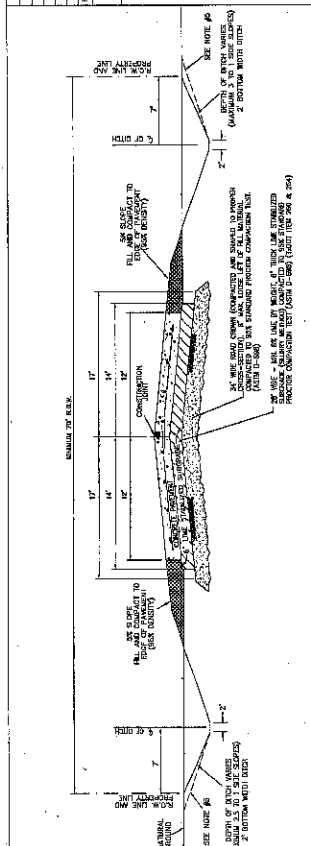

1. STANDARD CONCRETE CURB AND GUTTER STREET CROSS-SECTIONS

APPROVED: *[Signature]*  
DATE: 2/24/15

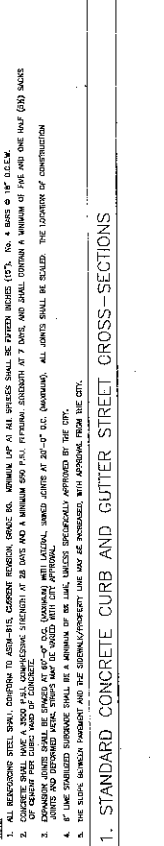
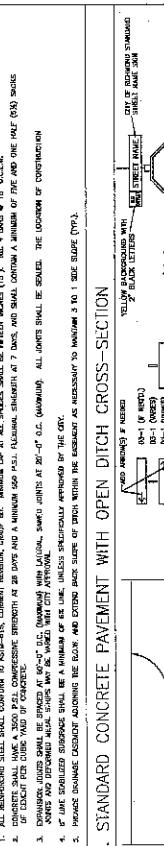

3. STANDARD ASPHALT PAVEMENT WITH OPEN DITCH CROSS-SECTION

APPROVED: *[Signature]*  
DATE: 2/24/15

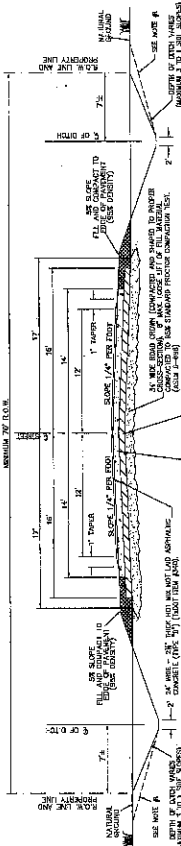
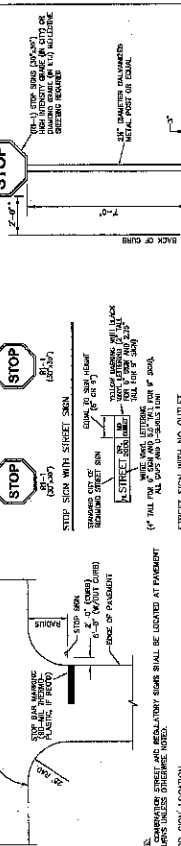

4. TRAFFIC SIGNAGE

APPROVED: *[Signature]*  
DATE: 2/24/15

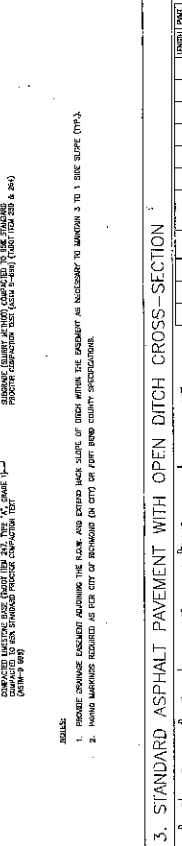
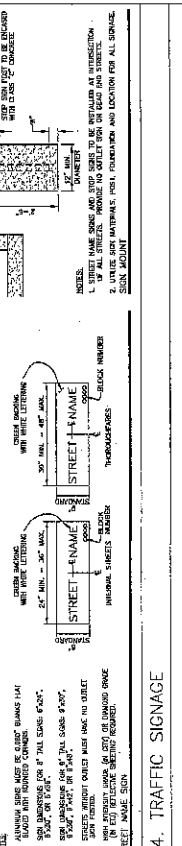

5. SLOPED END TREATMENT

**J.C. JONES & CARTER, INC.**  
ENGINEERS-PLANNERS-ARCHITECTS  
CITY OF RICHMOND  
STANDARD CONSTRUCTION DETAILS

SCALE: 1" = 10'-0"

SHEET 3 OF 3

NO.	MIN. CURB HEIGHT	MIN. GUTTER WIDTH	MIN. PAVEMENT THICKNESS	MIN. DITCH WIDTH	MIN. DITCH DEPTH	MIN. SLOPE	MIN. CURB RADIUS	MIN. GUTTER RADIUS	MIN. PAVEMENT RADIUS	MIN. DITCH RADIUS	MIN. SLOPE RADIUS	MIN. CURB RADIUS	MIN. GUTTER RADIUS	MIN. PAVEMENT RADIUS	MIN. DITCH RADIUS	MIN. SLOPE RADIUS
1	4"	12"	4"	12"	12"	1:1	10'	10'	10'	10'	10'	10'	10'	10'	10'	10'
2	4"	12"	4"	12"	12"	1:1	10'	10'	10'	10'	10'	10'	10'	10'	10'	10'
3	4"	12"	4"	12"	12"	1:1	10'	10'	10'	10'	10'	10'	10'	10'	10'	10'
4	4"	12"	4"	12"	12"	1:1	10'	10'	10'	10'	10'	10'	10'	10'	10'	10'
5	4"	12"	4"	12"	12"	1:1	10'	10'	10'	10'	10'	10'	10'	10'	10'	10'
6	4"	12"	4"	12"	12"	1:1	10'	10'	10'	10'	10'	10'	10'	10'	10'	10'
7	4"	12"	4"	12"	12"	1:1	10'	10'	10'	10'	10'	10'	10'	10'	10'	10'
8	4"	12"	4"	12"	12"	1:1	10'	10'	10'	10'	10'	10'	10'	10'	10'	10'
9	4"	12"	4"	12"	12"	1:1	10'	10'	10'	10'	10'	10'	10'	10'	10'	10'
10	4"	12"	4"	12"	12"	1:1	10'	10'	10'	10'	10'	10'	10'	10'	10'	10'

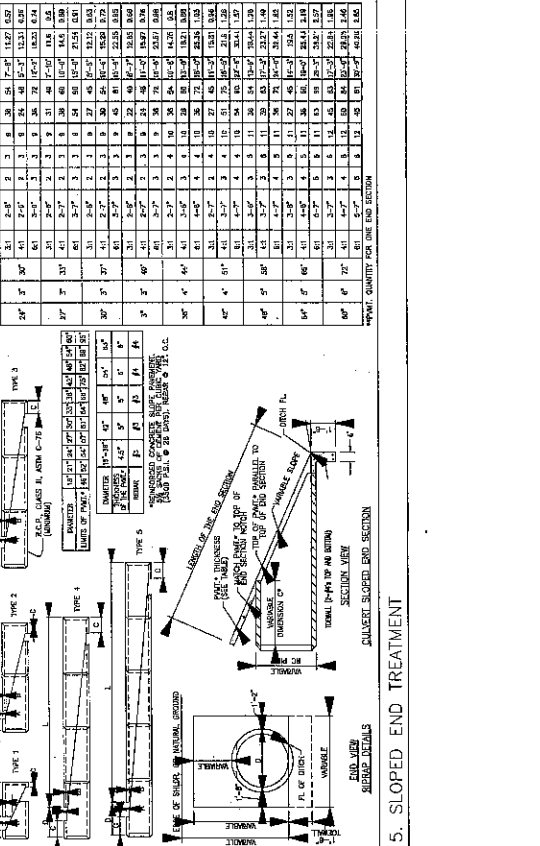

6. TYPE 'H' BARRICADE















**BENCH MARK**  
 ANY WORKMAN SHOULD BE ABLE TO LOCATE THE BENCH MARK ON THE SURFACE OF THE GROUND. THE BENCH MARK IS TO BE PLACED IN A CONSPICUOUS LOCATION AND SHALL BE PROTECTED BY A FENCE AND SIGN. THE BENCH MARK SHALL BE A 6" X 6" X 36" GALVANNEAL STEEL PIPE SET IN A 12" X 12" X 36" CONCRETE FOUNDATION. THE BENCH MARK SHALL BE SET TO THE ELEVATION OF THE GROUND SURFACE AT THE POINT OF INTERSECTION OF THE BENCH MARK AND THE CENTERLINE OF THE ROAD.  
 ELEVATION = 82.98'  
 (DRAWN BY)

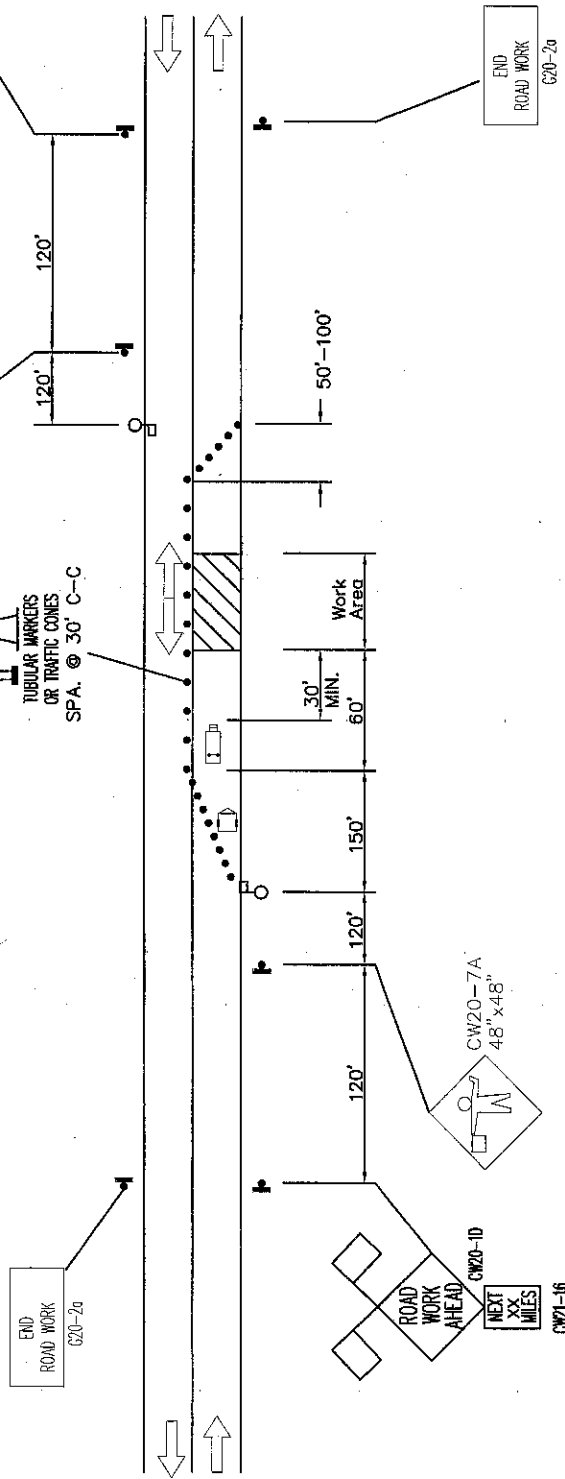
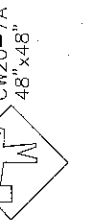
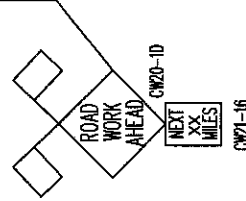
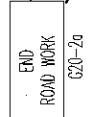
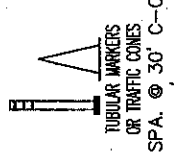
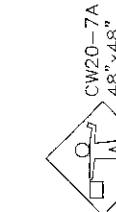
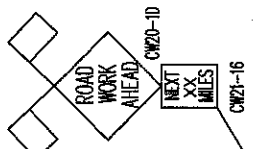

- LEGEND**
- CONSTRUCTION AREA
  - OPEN TO TRAFFIC
  - HEAVY VEHIC VEHICLE
  - FLASHING ARROW BOARD (OPTIONAL)
  - SIGN POST
  - TUBULAR MARKERS CONES OR DRUMS
  - FLAGGER

DAYTIME ONLY  
 TYPICAL FLAGGING / MOVING OPERATION  
 FOR CONSTRUCTION ALONG BITTERSWEET DRIVE (TWO LOCATIONS) AND  
 DAYTIME ONLY CONSTRUCTION ALONG PLANTATION DRIVE,  
 DURING PHASE 1 STEP 2 CONSTRUCTION  
 WHEN CONNECTION TO THE NEW STORM SEWER AND  
 INLET RECONSTRUCTION AREAS

APPROVED: DEVELOPMENT COORDINATOR  
 DATE: 2/21/15

**PRIVATE UTILITY LINES SHOWN**  
 PLANS AND ELEVATIONS OF ALL UTILITIES SHOWN ARE BASED ON RECORD DRAWINGS AND FIELD SURVEY. THE CONTRACTOR SHALL VERIFY THE LOCATION AND DEPTH OF ALL UTILITIES PRIOR TO CONSTRUCTION. THE CONTRACTOR SHALL BE RESPONSIBLE FOR PROTECTING ALL UTILITIES.

NO.	DATE	REVISIONS	APP.

PECAN GROVE M.I.D.  
 FORT BEND COUNTY, TEXAS  
 PECAN GROVE PLANTATION 4 & 5  
 DRAINAGE IMPROVEMENTS  
 TRAFFIC CONTROL PLAN  
 TYPICAL FLAGGING OR  
 MOVING OPERATION

J.C. JONES & CARTER, INC.  
 REGISTERED PROFESSIONAL ENGINEERS  
 LICENSE NO. 43180 (P.E.)  
 LICENSE NO. 43181 (P.E.)  
 LICENSE NO. 43182 (P.E.)  
 LICENSE NO. 43183 (P.E.)  
 LICENSE NO. 43184 (P.E.)  
 LICENSE NO. 43185 (P.E.)  
 LICENSE NO. 43186 (P.E.)  
 LICENSE NO. 43187 (P.E.)  
 LICENSE NO. 43188 (P.E.)  
 LICENSE NO. 43189 (P.E.)  
 LICENSE NO. 43190 (P.E.)  
 LICENSE NO. 43191 (P.E.)  
 LICENSE NO. 43192 (P.E.)  
 LICENSE NO. 43193 (P.E.)  
 LICENSE NO. 43194 (P.E.)  
 LICENSE NO. 43195 (P.E.)  
 LICENSE NO. 43196 (P.E.)  
 LICENSE NO. 43197 (P.E.)  
 LICENSE NO. 43198 (P.E.)  
 LICENSE NO. 43199 (P.E.)  
 LICENSE NO. 43200 (P.E.)

SCALE: \_\_\_\_\_ DATE: \_\_\_\_\_  
 DRAWN BY: \_\_\_\_\_  
 CHECKED BY: \_\_\_\_\_  
 SUBMITTED: \_\_\_\_\_  
 PERM. NO.: \_\_\_\_\_  
 DATE: \_\_\_\_\_  
  
 SHEET NO. 22 OF 25





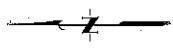

APPROVED: *[Signature]*  
 DEVELOPMENT COORDINATOR  
 DATE: 12/14/14

PRIVATE UTILITY LINES SHOWN  
 EXISTING ON THE SITE AND ADJACENT PROPERTIES  
 ARE NOT TO BE CONSIDERED AS A GUARANTEE OF  
 ACCURACY BY THE ENGINEER.  
 THE ENGINEER HAS CONDUCTED VISUAL INSPECTIONS  
 OF THE SITE AND ADJACENT PROPERTIES.  
 THE ENGINEER HAS NOT CONDUCTED ANY  
 TESTS OR ANALYSES OF THE UTILITY LINES.  
 THE ENGINEER HAS NOT CONDUCTED ANY  
 TESTS OR ANALYSES OF THE UTILITY LINES.  
 THE ENGINEER HAS NOT CONDUCTED ANY  
 TESTS OR ANALYSES OF THE UTILITY LINES.

NO.	DATE	REVISIONS

PECAN GROVE MUNICIPAL UTILITY DISTRICT  
 FORT BEND COUNTY, TEXAS

THE GROVE 2 & S  
 DRAINAGE IMPROVEMENTS  
**TRAFFIC CONTROL PLAN**

J.C. JONES & CARTER, INC.  
 ENGINEERS, PLANNERS, SURVEYORS  
 10000 Katy Road, Houston, Texas 77055  
 SCALE: 1"=200'  
 DATE: OCTOBER 2014  
 JOB NO.: 2013-12-02-01  
 DRAWING NO.:  
 SUBMITTED:

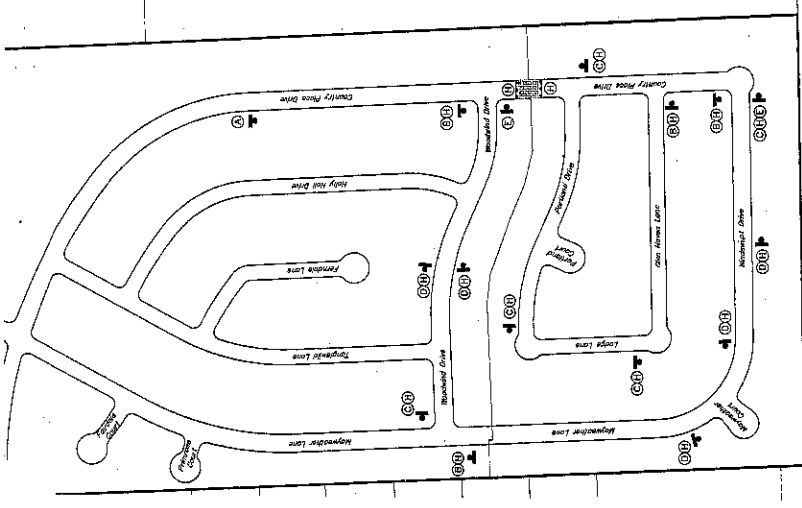

Traffic Control for Closure of  
 Country Place Drive

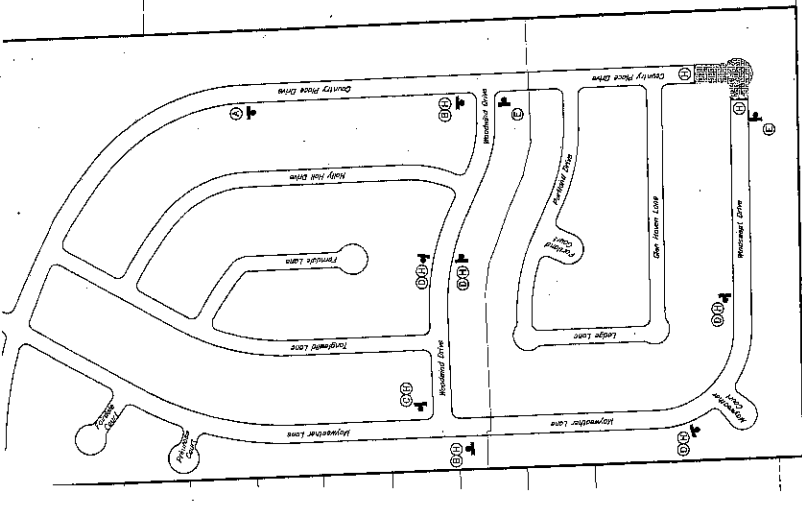

Traffic Control for Closure of  
 Myrtlewood Drive & Country Place Drive

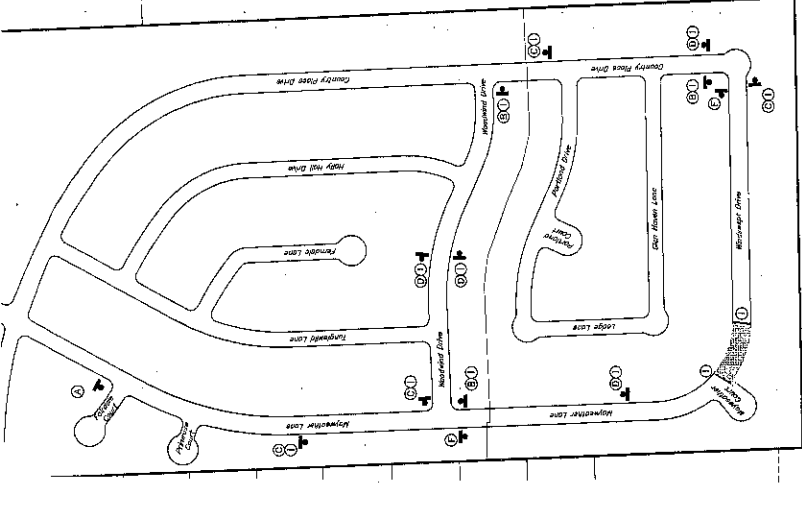

Traffic Control for Closure of  
 Myrtlewood Drive

**TRAFFIC CONTROL LEGEND**  
 Marking Road Closed - Detour  
 Construction Barikade  
 Detour Arrows - Direction Arrows  
 Construction Barikade

**TRAFFIC CONTROL CONSTRUCTION SEQUENCE**

④	⑤	⑥
ROAD CLOSED	DETOUR	ROAD CLOSED
DETOUR	ROAD CLOSED	DETOUR
ROAD CLOSED	DETOUR	ROAD CLOSED
DETOUR	ROAD CLOSED	DETOUR
ROAD CLOSED	DETOUR	ROAD CLOSED





