

REVIEW BY FORT BEND COUNTY COMMISSIONERS COURT

On this 26th day of January, 2016, Commissioners Court came on to be heard and reviewed the accompanying notice of CIVE

Job Location Williams Way Blvd & Wildwood Park Road, Richmond, TX 77469

Date Bond No. 6842202279, Permit No. 2016-4960 to make use of certain Fort Bend County property subject to, "A Revised Order Regulating the Laying, Construction, Maintenance, and Repair of Buried Cables, Conduits, and Pole Lines, In, Under, Across or Along Roads, Streets, Highways, and Drainage Ditches in Fort Bend County, Texas, Under the Jurisdiction of the Commissioners Court of Fort Bend County, Texas," as passed by the Commissioners Court of Fort Bend County, Texas the 3rd day of August, 1987, recorded in Volume _____ of the Minutes of the Commissioners Court of Fort Bend County, Texas, to the extent that such order is not inconsistent with Article 1436a, Vernon's Texas Civil Statutes. Upon Motion of Commissioner _____, seconded by Commissioner _____,

_____ duly put and carried, it is ORDERED, ADJUDGED AND DECREED that said notice of said above purpose is hereby acknowledged by the Commissioners Court of Fort Bend County, Texas, and that said notice be placed on record according to the regulation order thereof.

Notes:

1. Evidence of review by the Commissioners Court must be kept on the job site and failure to do so constitutes grounds for job shutdown.
2. Written notices are required:
 - a. 48 hours in advance of construction start up, and
 - b. when construction is completed and ready for final inspectionMail notices to: Permit Administrator
Fort Bend County Engineering
301 Jackson Street
Richmond, Texas 77469
281-633-7500
3. This permit expires one (1) year from date of permit if construction has not commenced.

By: _____

County Engineer

N/A

By: _____

Drainage District Engineer/Manager

Presented to Commissioners Court and approved.
Recorded in Volume _____

Minutes of Commissioners Court

Clerk of Commissioners Court

By: _____

Deputy

Engineering Department

Phone: (281) 633-7500

Permit No. 2016-4960

X (1) Complete Application Form:

X c. Plans and specifications

Perpetual bond currently posted.

Amount:

Performance bond submitted.

Amount:

No: 6842202279

Amount: \$5,000.00

Date _____

Date _____

Drainage District Approval when applicable

J. Ortega CFM

Date _____

CONSTRUCTION PLANS FOR PAVING AND APPURTENANCES (PRIVATE ON-SITE)

TO SERVE

WILLIAMS CROSSING

FORT BEND COUNTY MUD NO. 121

RICHMOND, TEXAS 77469

**DESIGN JOB NO. 2233-0001
APRIL, 2015**

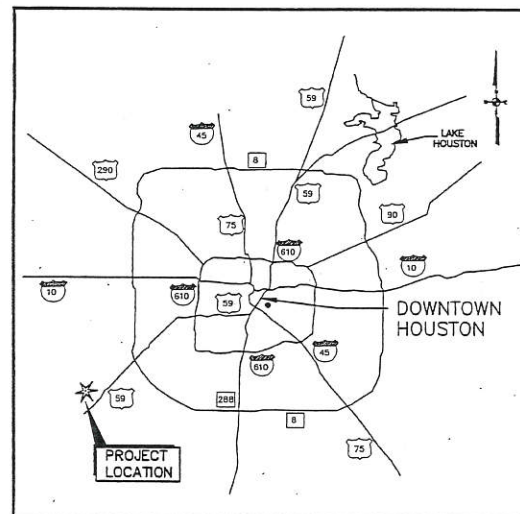

LOCATION MAP
SCALE: N.T.S.

FLOODPLAIN INFORMATION

THIS PROPERTY LIES IN SHADED ZONE "X" AS PER THE FLOOD INSURANCE RATE MAPS, COMMUNITY PANEL NO. 480228 0240 J, EFFECTIVE DATE JANUARY 3, 1997.

BENCHMARK NOTE

BENCHMARK: SUGAR LAND RM 010 IS A 3" BRASS CAP LOCATED APPROX. 2,900 FEET EAST OF THE INTERSECTION OF HWY 59 SOUTHBOUND AND GRAND PARKWAY (SH 99) BETWEEN THE FEEDER ROAD AND STAR FURNITURE PARKING LOT.
ELEV.=72.97 FEET, NAVD 88, 2001 ADJ.

TBM "A": BOX CUT ON SOUTHEAST CORNER OF A CURB INLET ON THE SOUTH SIDE OF WILDWOOD PARK ROAD APPROX. 400 FEET EAST OF THE INTERSECTION OF WILLIAMS WAY BLVD. AND WILDWOOD PARK ROAD.
ELEV.=72.60 FEET, NAVD 88, 2001 ADJ.

INDEX OF DRAWINGS

1. COVER SHEET
2. GENERAL NOTES
3. TOPOGRAPHIC MAP
4. DIMENSIONAL CONTROL PLAN
5. GRADING PLAN
6. RIGHT TURN LANE
7. TRAFFIC CONTROL PLAN WILLIAMS WAY BLVD.
8. TRAFFIC CONTROL PLAN WILDWOOD PARK ROAD
9. DRAINAGE AREA MAP AND CALCULATIONS
10. STORM WATER POLLUTION PREVENTION PLAN
11. STORM WATER POLLUTION PREVENTION PLAN DETAILS
12. PAVING DETAILS
13. PAVEMENT MARKING DETAILS

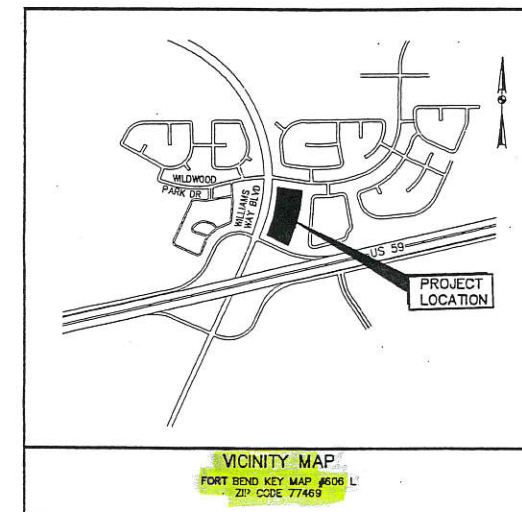

VICINITY MAP
FORT BEND KEY MAP #606 L
ZIP CODE 77469

CITY OF RICHMOND

APPROVED: *Terrri Vela*
TERRI VELA
CITY MANAGER

DATE: 4/17/15

APPROVED: *Kelly R. Kaluza*
KELLY R. KALUZA
CITY ENGINEER

DATE: 4/20/15

FORT BEND COUNTY ENGINEERING DEPARTMENT

APPROVED: *Richard W. Stollis*
RICHARD W. STOLLIS P.E.

DATE: 5/7/15

THESE SIGNATURES ARE VOID IF CONSTRUCTION HAS NOT COMMENCED IN 1 YEAR FROM DATE OF APPROVAL

APPROVED: *Gregory J. Patch*
GREGORY J. PATCH
DEVELOPMENT COORDINATOR

DATE: 5/7/15

LJA Engineering Inc.
2929 Briarpark Drive
Suite 600
Houston, Texas 77042

Phone 713.953.5200
Fax 713.953.5026
FRN - F-1386



LEGEND

EXISTING STORM SEWER LINE AND MANHOLE & INLETS	—●—
PROPOSED CATCH BASIN	□
PROPOSED JUNCTION BOX	□
PROPOSED STORM SEWER IN	—
PROPOSED TYPE C INLET	—
EXISTING ELEVATION	—
PROPOSED FINISH GRADE	—
PROPOSED TOP OF WALL ELEVATION	—
PROPOSED TOP OF CURB ELEVATION	—
PROPOSED TOP OF SIDEWALK ELEVATION	—
PROPOSED TOP OF GRATE ELEVATION	—
PROPOSED TOP OF PAVEMENT ELEVATION	—
PROPOSED GUTTER ELEVATION	—
PROPOSED HIGH POINT	—
PROPOSED GRADE BREAK	—
PROPOSED GRADE DIRECTION	—

THE RELOCATION OF EXISTING TREES, LANDSCAPING, SPRINKLER SYSTEMS, WATER METERS, FIRE HYDRANTS, MANHOLES, AND PIPELINE AT DRIVEWAYS (IF APPLICABLE) ARE TO BE REINSTALLED AS RECOMMENDED AND RETURNED TO THERE ORIGINAL STATE.

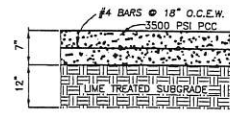

CONCRETE PAVEMENT CROSS SECTION

GENERAL NOTES:

IMPORTANT NOTE: ALL PROPOSED PAVEMENT ELEVATIONS NOTED ARE TO FINISHED PAVEMENT GRADE. FOR TOP OF CURB GRADE, WHERE APPLICABLE, ADD 6"

- CONTRACTOR SHALL MAINTAIN SITE DRAINAGE AT ALL TIMES.
- ALL MATERIALS FROM DEMOLITION/REMOVALS AS WELL AS EXCESS MATERIALS FROM THE EXCAVATIONS SHALL BECOME THE PROPERTY OF THE CONTRACTOR WHO SHALL DISPOSE OFF-SITE IN A LAWFUL MANNER.
- GRADE PAVINGS UNIFORMLY BETWEEN INDICATED ELEVATIONS. ADJUST ELEVATIONS AS DIRECTED BY THE ENGINEER AND AS REQUIRED TO ACHIEVE POSITIVE DRAINAGE AND PLEASING APPEARANCE THROUGHOUT.
- ADJUST EXISTING STRUCTURES (JUNCTION BOXES, VALVE BOXES, PULL BOXES, ETC.) AS REQUIRED TO CONFORM TO NEW FINISHED GRADES.

GRADING NOTES:

- CONTRACTOR TO COORDINATE RELOCATION OF EXISTING LIGHT STANDARDS.
- CONTRACTOR TO MATCH ELEVATION AT EXISTING PAVEMENT.
- CONTRACTOR TO FULL DEPTH SAWCUT PER FORT BEND COUNTY STANDARDS AND SPECIFICATIONS AND TIE IN PROPOSED CONCRETE PAVEMENT. CONTRACTOR SHALL DOWEL (SEE TABLE 1 SHEET 9) INTO THE CENTER OF EXISTING PAVING AND EPOXY WITH "PO-ROC" OR APPROVED EQUAL DOWELS SHALL BE EMBEDDED A MINIMUM OF 9".
- CONTRACTOR TO INSTALL 6" CURB. SEE SHEET 12.
- CONSTRUCT 8" REINFORCED CONCRETE OVER 8" STABILIZED SUBGRADE WITH JOINT CONTROL. PER FORT BEND COUNTY STANDARDS. SEE PAVEMENT SECTION DETAIL ON SHEET 12.
- CONTRACTOR TO REMOVE EXISTING CURB.
- FOR STRIPING SEE PAVEMENT MARKING DETAILS, SHEET 13.
- TRAFFIC FLOW ARROW, SEE PAVEMENT MARKING DETAILS, SHEET 13.
- SLOPE 2% TOWARDS EDGE OF PAVEMENT.

GRADING NOTES:

- EXISTING STORM SEWER MANHOLE ADJUST RIM ELEVATION TO MATCH PROPOSED GRADE.
- CONCRETE SIDEWALK SEE DETAIL SHEET 12.
- CONTRACTOR TO RELOCATE EXISTING FIRE HYDRANT AND WATER VALVE APPROXIMATELY 75' UP TO THE NORTH AND REUSE EXISTING FITTINGS. SEE NOTE 16.
- ADA ACCESS & PEDESTRIAN RAMP SEE DETAIL SHEET 13.
- CONCRETE PAVEMENT SHALL BE 7" THICK WITH 12" LIME STABILIZED SUBGRADE PER GEOTECHNICAL REPORT, SEE DETAILS ON SHEET 12.
- STORM SEWER INLET.
- NO CURB.
- CONTRACTOR CONVERT EXISTING "C" INLET TO PROPOSED 4 GRATE INLET. SEE DETAIL ON SHEET 6.
- LOCATION OF RELOCATED FIRE HYDRANT AND VALVE.
- GUY WIRE RELOCATION BY OTHERS.

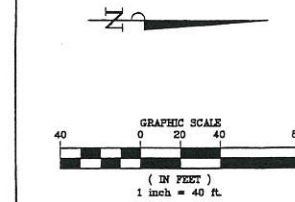

FLOODPLAIN INFORMATION:
THIS PROPERTY LIES IN SHADED ZONE "X" AS PER THE FLOOD INSURANCE RATE MAPS, COMMUNITY PANEL NO. 480228 0240 J, EFFECTIVE DATE JANUARY 3, 1997

BENCHMARK: SUBM LAND RM 010 IS A 3" BRASS IAN LOCATED APPROX. 2,900 FEET EAST OF THE INTERSECTION OF HWY 59 SOUTHBOUND AND GRAND PARKWAY (SH 99) BETWEEN THE FEEDER ROAD AND STAR FURNITURE PARKING LOT.
ELEV.=72.97 FEET, NAVD 88, 2001 ADJ.

BM "A": BOX CUT ON SOUTHEAST CORNER OF A CURB INLET ON THE SOUTH SIDE OF WILDWOOD PARK ROAD APPROX. 400 FEET EAST OF THE INTERSECTION OF WILLIAMS WAY BLVD. AND WILDWOOD PARK ROAD.
ELEV.=72.60 FEET, NAVD 88, 2001 ADJ.



DATE	REVISION

FORT BEND COUNTY ENGINEERING DEPARTMENT

APPROVED: _____
DEVELOPMENT COORDINATOR

DATE: _____

NOTE:
IN CASE OF CONFLICT BETWEEN DETAILS SHOWN ON THIS SHEET AND THE COUNTY OF FORT BEND DESIGN STANDARDS, THE MORE STRINGENT SHALL APPLY.

CITY OF RICHMOND
FORT BEND COUNTY, TEXAS

WILLIAMS CROSSING

GRADING PLAN

LJA Engineering Inc.
2828 Briarpark Drive
Suite 600
Houston, Texas 77042-3703
Phone 713.953.5200
Fax 713.953.5025
FRN-F-1386

LJA PROJECT NO.: 2233-0001

SUBMITTED: _____
SCALE: 1"=40'
DATE: MAY, 2015
SURVEYED BY: _____
F B NO: _____

DESIGNED BY: GJP
DRAWN BY: DLO
SHEET NO. 5 OF 13 SHEETS
CITY DWG NO: _____

ISSUE FOR CONSTRUCTION - 7-21-15

WILLIAMS CROSSING - CITY OF RICHMOND, TX : 2233-0001

WILLIAMS WAY BLVD
POSTED SPEED LIMIT = 35 M.P.H.

IMPORTANT NOTE: DRIVEWAYS AND MEDIAN OPENINGS MUST
REMAIN ACCESSIBLE AT ALL TIMES.

IMPORTANT NOTE: ALL LANE CLOSURES SHALL BE BETWEEN
THE HOURS OF 8AM AND 4PM. ALL LANES SHALL REMAIN
OPEN FROM 5AM TO 9AM AND 4PM TO 8PM
MONDAY-SATURDAY.

TRAFFIC NOTES

1. CONTRACTOR SHALL PROVIDE AND INSTALL TRAFFIC CONTROL DEVICES IN CONFORMANCE WITH PART VI OF THE TEXAS MANUAL ON UNIFORM TRAFFIC CONTROL DEVICES (TEXAS MUTCD, MOST RECENT EDITION WITH REVISIONS) DURING CONSTRUCTION.
 - 2a. NO LANES SHALL BE CLOSED DURING THE HOURS OF 7:00 AM TO 9:00 AM AND 4:00 PM TO 8:00 PM MONDAY THRU FRIDAY.
 - 2b. NO LANES SHALL BE CLOSED IN RESIDENTIAL AREA FROM 7 PM TO 7 AM.
 3. CONTRACTOR SHALL MAINTAIN ONE LANE OF TRAFFIC IN EACH DIRECTION DURING WORKING HOURS.
 4. CONTRACTOR SHALL COVER OPEN EXCAVATIONS WITH STEEL PLATES ANCHORED PROPERLY DURING NON-WORKING HOURS AND OPEN LANES FOR NORMAL TRAFFIC FLOW.
 5. OFF-DUTY UNIFORMED POLICE OFFICER(S)/FLAGGER(S) IS/ARE REQUIRED TO DIRECT TRAFFIC WHEN LANES ARE CLOSED.
 6. IF THE CONTRACTOR CHOOSES TO USE A DIFFERENT METHOD OF "TRAFFIC CONTROL PLANS" DURING THE CONSTRUCTION THAN WHAT IS OUTLINED IN THE CONTRACT DRAWINGS, (SHE SHALL BE RESPONSIBLE TO PREPARE AND SUBMIT AN ALTERNATE SET OF PLANS TO PLAN REVIEW SECTION FOR APPROVAL TEN WORKING DAYS PRIOR TO IMPLEMENTATION.
 - * THESE PLANS SHALL BE DRAWN TO SCALE ON REPRODUCIBLE MYLARS AND SEALED BY A LICENSED ENGINEER IN THE STATE OF TEXAS. PLANS WILL BECOME A PART OF THE CONTRACT DRAWINGS.
 7. APPROVED COPIES OF "TRAFFIC CONTROL PLANS" AND LANE/SIDEWALK CLOSURE PERMITS SHALL BE AVAILABLE FOR INSPECTION AT JOB SITE AT ALL TIMES.
 8. ALL EXISTING DRIVES TO REMAIN OPERATIONAL DURING CONSTRUCTION.
- CONTRACTOR MUST SECURE "LANE/SIDEWALK CLOSURE PERMIT" FROM CITY'S TRAFFIC MANAGEMENT AND MAINTENANCE BRANCH BEFORE CLOSING A LANE/SIDEWALK. THE REQUEST MUST BE MADE AT LEAST THREE BUSINESS DAYS PRIOR TO THE DATE FOR WHICH THE CLOSURE IS SOUGHT. NOTE THAT WORKING HOURS MAY BE RESTRICTED OR THE REQUEST MAY BE DENIED. CALL 713-937-7249 FOR AN APPLICATION.

LEGEND

1. C20-20 (36" x 36")
2. DRUMS
• 45" C-C
• W/ C/W-BL
• 90" C-C
3. DRUMS W/
VP-IL
• 40" C-C
4. DRUMS
• 25" C-C
5. C920-10 (36" x 36")
6. C20-5.0 (36" x 36")
7. C20-21 (36" x 36")

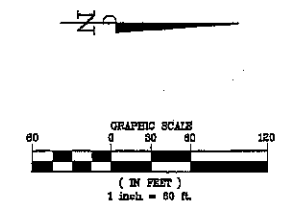

FLOODPLAIN INFORMATION:
THIS PROPERTY LIES IN SHADED ZONE "X" AS PER THE FLOOD INSURANCE RATE MAPS, COMMUNITY PANEL NO. 480228 0240 4, EFFECTIVE DATE JANUARY 3, 1997.

REMARKS:
BENCHMARK: SUGAR LAKE RM 916 IS A 6" BRASS CUP LOCATED APPROX. 2,800 FEET EAST OF THE INTERSECTION OF HWY 59 SOUTHBOUND AND GRAND PARKWAY (SH 69) BETWEEN THE FEEDER ROAD AND STAR FURNITURE PARKING LOT.
ELEV.=72.97 FEET, NAVD 83, 2001 ADJ.

TBM "A": BOX CUT ON SOUTHEAST CORNER OF A CURB INLET ON THE SOUTH SIDE OF WILLOWOOD PARK ROAD APPROX. 400 FEET EAST OF THE INTERSECTION OF WILLIAMS WAY BLVD. AND WILLOWOOD PARK ROAD.
ELEV.=72.60 FEET, NAVD 83, 2001 ADJ.



DATE	REVISION

FORT BEND COUNTY ENGINEERING DEPARTMENT

APPROVED: _____
DEVELOPMENT COORDINATOR

DATE: _____

NOTE:
IN CASE OF CONFLICT BETWEEN DETAILS SHOWN ON THIS SHEET AND THE COUNTY OF FORT BEND DESIGN STANDARDS, THE MORE STRINGENT SHALL APPLY.

CITY OF RICHMOND
FORT BEND COUNTY, TEXAS

WILLIAMS CROSSING

TRAFFIC CONTROL PLAN
WILLIAMS WAY BLVD.

LJA Engineering Inc.
2828 Briarpark Drive
Suite 600
Houston, Texas 77042-3703
Phone 713.953.5200
Fax 713.953.5026
FRN-F-1386

LJA PROJECT NO.: 2233-0001

SUBMITTED: _____
SCALE: 1"=60'
DATE: MAY, 2015
SURVEYED BY: _____
F & NO: _____

DESIGNED BY: GJP
DRAWN BY: DLO
SHEET NO. 7 OF 13 SHEETS
CITY DWG NO: _____

ISSUE FOR CONSTRUCTION - 7-21-15

WILLIAMS CROSSING - CITY OF RICHMOND, TX : 2233-0001

WILLIAMS WAY BLVD
POSTED SPEED LIMIT = 30 M.P.H.

IMPORTANT NOTE: DRIVEWAYS AND MEDIAN OPENINGS MUST
REMAIN ACCESSIBLE AT ALL TIMES.

IMPORTANT NOTE: ALL LANE CLOSURES SHALL BE BETWEEN
THE HOURS OF 5AM AND 4PM. ALL LANES SHALL REMAIN
OPEN FROM 5AM TO 9AM AND 4PM TO 8PM
MONDAY-SATURDAY.

- TRAFFIC NOTES**
1. CONTRACTOR SHALL PROVIDE AND INSTALL TRAFFIC CONTROL DEVICES IN CONFORMANCE WITH PART IV OF THE TEXAS MANUAL ON UNIFORM TRAFFIC CONTROL DEVICES (TEXAS MUTCD), MOST RECENT EDITION WITH REVISIONS DURING CONSTRUCTION.
 - 2a. NO LANES SHALL BE CLOSED DURING THE HOURS OF 7:00 AM TO 9:00 AM AND 4:00 PM TO 8:00 PM MONDAY THRU FRIDAY.
 - 2b. NO LANES SHALL BE CLOSED IN RESIDENTIAL AREA FROM 7 PM TO 7 AM.
 3. CONTRACTOR SHALL MAINTAIN ONE LANE OF TRAFFIC IN EACH DIRECTION DURING WORKING HOURS.
 4. CONTRACTOR SHALL COVER OPEN EXCAVATIONS WITH STEEL PLATES ANCHORED PROPERLY DURING NON-WORKING HOURS, AND OPEN LANES FOR NORMAL TRAFFIC FLOW.
 5. OFF-DUTY UNIFORMED POLICE OFFICER(S)/LABORER(S) IS/ARE REQUIRED TO DIRECT TRAFFIC WHEN LANES ARE CLOSED.
 6. IF THE CONTRACTOR CHOOSES TO USE A DIFFERENT METHOD OF "TRAFFIC CONTROL PLANS" DURING THE CONSTRUCTION THAN WHAT IS OUTLINED IN THE CONTRACT DRAWINGS, (S)HE SHALL BE RESPONSIBLE TO PREPARE AND SUBMIT AN ALTERNATE SET OF PLANS TO PLAN REVIEW SECTION FOR APPROVAL TEN WORKING DAYS PRIOR TO IMPLEMENTATION.
 - * THESE PLANS SHALL BE DRAWN TO SCALE ON REPRODUCIBLE MYLARS AND SEALED BY A LICENSED ENGINEER IN THE STATE OF TEXAS. PLANS WILL BECOME A PART OF THE CONTRACT DRAWINGS.
 7. APPROVED COPIES OF "TRAFFIC CONTROL PLANS" AND LANE/SIDEWALK CLOSURE PERMITS SHALL BE AVAILABLE FOR INSPECTION AT JOB SITE AT ALL TIMES.
 8. ALL EXISTING DRIVES TO REMAIN OPERATIONAL DURING CONSTRUCTION.
- CONTRACTOR MUST SECURE "LANE/SIDEWALK CLOSURE PERMITS" FROM CITY'S TRAFFIC MANAGEMENT AND MAINTENANCE BRANCH BEFORE CLOSING A LANE/SIDEWALK. THE REQUEST MUST BE MADE AT LEAST THREE BUSINESS DAYS PRIOR TO THE DATE FOR WHICH THE CLOSURE IS SOUGHT. NOTE THAT WORKING HOURS MAY BE RESTRICTED OR THE REQUEST MAY BE DENIED. CALL 713-637-7280 FOR AN APPLICATION.

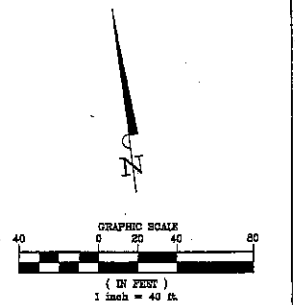
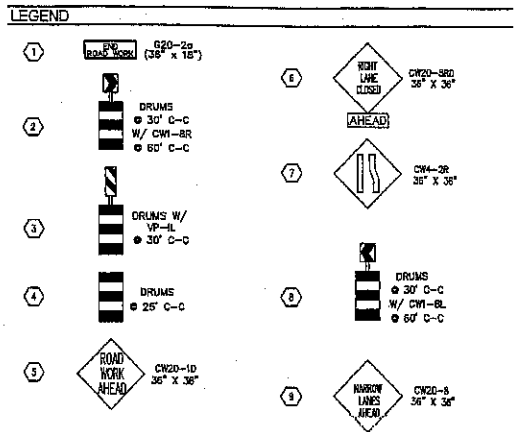

FLOODPLAIN INFORMATION:
THIS PROPERTY LIES IN SHADED ZONE "X" AS PER THE FLOOD INSURANCE RATE MAPS, COMMUNITY PANEL NO. 480228 0240 4, EFFECTIVE DATE JANUARY 3, 1997.

BENCHMARKS:
BENCHMARK SURAB LIND RM 016 IS A 3" BRASS BAP LOCATED APPROX. 2,800 FEET EAST OF THE INTERSECTION OF HWY 55 SOUTHBOUND AND GRAND PARKWAY (SH 99) BETWEEN THE FEEDER ROAD AND STAR FURNITURE PARKING LOT.
ELEV.=72.97 FEET, NAVD 83, 2001 ADJ.

ITEM "A": BOX CUT ON SOUTHEAST CORNER OF A CURB INLET ON THE SOUTH SIDE OF WILDBROOK PARK ROAD APPROX. 400 FEET EAST OF THE INTERSECTION OF WILLIAMS WAY BLVD. AND WILDBROOK PARK ROAD.
ELEV.=72.69 FEET, NAVD 83, 2001 ADJ.

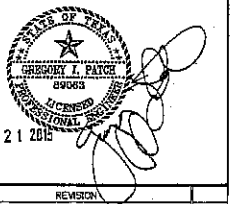

DATE	REVISION

FORT BEND COUNTY ENGINEERING DEPARTMENT

APPROVED: _____
DEVELOPMENT COORDINATOR

DATE: _____

NOTE:
IN CASE OF CONFLICT BETWEEN DETAILS SHOWN ON THIS SHEET AND THE COUNTY OF FORT BEND DESIGN STANDARDS, THE MORE STRINGENT SHALL APPLY.

CITY OF RICHMOND
FORT BEND COUNTY, TEXAS

WILLIAMS CROSSING

TRAFFIC CONTROL PLAN
WILDBROOK PARK ROAD

LJA Engineering Inc.
2929 Briarpark Drive
Suite 600
Houston, Texas 77042-3703
Phone 713.953.5200
Fax 713.953.5026
FRN-F-1386

LJA PROJECT NO.: 2233-0001

SUBMITTED: _____	DESIGNED BY: GJP
SCALE: 1"=40'	DRAWN BY: DLD
DATE: MAY, 2015	SHEET NO. 8 OF 13 SHEETS
SURVEYED BY: _____	CITY DWS NO: _____
F B NO: _____	

ISSUE FOR CONSTRUCTION - 7-21-15

WILLIAMS CROSSING - CITY OF RICHMOND, TX : 2233-0001

8
Date/Time: May 20, 2015, 3:06pm User Name: jef
File Name: J:\Projects\2233\0001\2233-0001-TCP.dwg