

**REVIEW BY FORT BEND COUNTY COMMISSIONERS COURT**

On this 5th day of January, 2016, Commissioners Court came on to be heard and reviewed the accompanying notice of Hurtado Construction

Job Location Trails at Seabourne Park Section 3, Rosenberg, TX 77471

Date 12/7/2015 Bond No. 58S207278, Permit No. 2015-4448 to make use of certain Fort Bend County property subject to, "A Revised Order Regulating the Laying, Construction, Maintenance, and Repair of Buried Cables, Conduits, and Pole Lines, In, Under, Across or Along Roads, Streets, Highways, and Drainage Ditches in Fort Bend County, Texas, Under the Jurisdiction of the Commissioners Court of Fort Bend County, Texas," as passed by the Commissioners Court of Fort Bend County, Texas the 3rd day of August, 1987, recorded in Volume \_\_\_\_\_ of the Minutes of the Commissioners Court of Fort Bend County, Texas, to the extent that such order is not inconsistent with Article 1436a, Vernon's Texas Civil Statutes. Upon Motion of Commissioner \_\_\_\_\_, seconded by Commissioner \_\_\_\_\_, duly put and carried, it is ORDERED, ADJUDGED AND

DECREED that said notice of said above purpose is hereby acknowledged by the Commissioners Court of Fort Bend County, Texas, and that said notice be placed on record according to the regulation order thereof.

Notes:

1. Evidence of review by the Commissioners Court must be kept on the job site and failure to do so constitutes grounds for job shutdown.
2. Written notices are required:
  - a. 48 hours in advance of construction start up, and
  - b. when construction is completed and ready for final inspection

Mail notices to: Permit Administrator  
Fort Bend County Engineering  
301 Jackson Street  
Richmond, Texas 77469  
281-633-7500
3. This permit expires one (1) year from date of permit if construction has not commenced.

By: *Rick J. Stangle, PE, PTOE*  
for County Engineer

Presented to Commissioners Court and approved.  
Recorded in Volume \_\_\_\_\_

Minutes of Commissioners Court

By: *Mark Vayh*  
Drainage District Engineer/Manager

Clerk of Commissioners Court

By: \_\_\_\_\_  
Deputy

# County of Fort Bend

Engineering Department

301 Jackson Street  
Richmond, Texas 77469

Johnny Ortega  
Permit Administrator

Phone: (281) 633-7500

## Permit Application Review Form For Cable, Conduit, and Pole Line Activity In Fort Bend County

Permit No. 2015-4448

The following "Notice of Proposed Cable, Conduit, and/or Pole Line activity in Fort Bend County" and accompanying attachments have been reviewed and the notice conforms to appropriate regulations set by Commissioner's Court of Fort Bend County, Texas.

- (1) Complete Application Form:
- a. Name of road, street, and/or drainage ditch affected.
- b. Vicinity map showing course of directions
- c. Plans and specifications
- (2) Bond:
- District Attorney, approval when applicable.
- Perpetual bond currently posted.
- No: \_\_\_\_\_
- Amount: \_\_\_\_\_
- Performance bond submitted.
- No: 58S207278
- Amount: \$10,000.00
- Cashier's Check
- No: \_\_\_\_\_
- Amount: \_\_\_\_\_
- (3) Verbal permission given for emergencies, to start construction before approved in Commissioner's Court.

\_\_\_\_\_  
Precinct Engineer Acknowledgment

\_\_\_\_\_  
Date

\_\_\_\_\_  
Precinct Commissioner Acknowledgment

\_\_\_\_\_  
Date

(4)

\_\_\_\_\_  
Drainage District Approval when applicable

**We have reviewed this project and agree it meets minimum requirements.**

*Johnny Ortega CFM*

\_\_\_\_\_  
Johnny Ortega CFM/Permit Administrator

*1/5/16*  
\_\_\_\_\_  
Date



GENERAL CONSTRUCTION NOTES

- 1. ALL WORK SHALL BE ACCORDING TO THE CITY OF DENVER SPECIFICATIONS FOR CONSTRUCTION OF WATER MAINS...
2. ALL WORK SHALL BE ACCORDING TO THE CITY OF DENVER SPECIFICATIONS FOR CONSTRUCTION OF SEWER MAINS...
3. ALL WORK SHALL BE ACCORDING TO THE CITY OF DENVER SPECIFICATIONS FOR CONSTRUCTION OF STORM SEWER MAINS...

STORM SEWER CONSTRUCTION NOTES

- 1. STORM SEWER CONSTRUCTION SHALL BE ACCORDING TO THE CITY OF DENVER SPECIFICATIONS FOR CONSTRUCTION OF STORM SEWER MAINS...
2. ALL STORM SEWER MAINS SHALL BE 18" DIA. UNLESS OTHERWISE SPECIFIED...
3. ALL STORM SEWER MAINS SHALL BE 18" DIA. UNLESS OTHERWISE SPECIFIED...

PAVING CONSTRUCTION NOTES

- 1. ALL PAVING SHALL BE ACCORDING TO THE CITY OF DENVER SPECIFICATIONS FOR CONSTRUCTION OF PAVEMENT...
2. ALL PAVING SHALL BE ACCORDING TO THE CITY OF DENVER SPECIFICATIONS FOR CONSTRUCTION OF PAVEMENT...
3. ALL PAVING SHALL BE ACCORDING TO THE CITY OF DENVER SPECIFICATIONS FOR CONSTRUCTION OF PAVEMENT...

CONCRETE CONSTRUCTION NOTES

- 1. ALL CONCRETE SHALL BE ACCORDING TO THE CITY OF DENVER SPECIFICATIONS FOR CONSTRUCTION OF CONCRETE...
2. ALL CONCRETE SHALL BE ACCORDING TO THE CITY OF DENVER SPECIFICATIONS FOR CONSTRUCTION OF CONCRETE...
3. ALL CONCRETE SHALL BE ACCORDING TO THE CITY OF DENVER SPECIFICATIONS FOR CONSTRUCTION OF CONCRETE...

WATER MAIN CONSTRUCTION NOTES

- 1. ALL WATER MAINS SHALL BE ACCORDING TO THE CITY OF DENVER SPECIFICATIONS FOR CONSTRUCTION OF WATER MAINS...
2. ALL WATER MAINS SHALL BE ACCORDING TO THE CITY OF DENVER SPECIFICATIONS FOR CONSTRUCTION OF WATER MAINS...
3. ALL WATER MAINS SHALL BE ACCORDING TO THE CITY OF DENVER SPECIFICATIONS FOR CONSTRUCTION OF WATER MAINS...

SANITARY SEWER CONSTRUCTION NOTES

- 1. ALL SANITARY SEWER MAINS SHALL BE ACCORDING TO THE CITY OF DENVER SPECIFICATIONS FOR CONSTRUCTION OF SANITARY SEWER MAINS...
2. ALL SANITARY SEWER MAINS SHALL BE ACCORDING TO THE CITY OF DENVER SPECIFICATIONS FOR CONSTRUCTION OF SANITARY SEWER MAINS...
3. ALL SANITARY SEWER MAINS SHALL BE ACCORDING TO THE CITY OF DENVER SPECIFICATIONS FOR CONSTRUCTION OF SANITARY SEWER MAINS...

SPECIAL CONSTRUCTION NOTES

- 1. SPECIAL CONSTRUCTION NOTES SHALL BE ACCORDING TO THE CITY OF DENVER SPECIFICATIONS FOR CONSTRUCTION OF SPECIAL CONSTRUCTION...
2. SPECIAL CONSTRUCTION NOTES SHALL BE ACCORDING TO THE CITY OF DENVER SPECIFICATIONS FOR CONSTRUCTION OF SPECIAL CONSTRUCTION...

CONCRETE CONSTRUCTION NOTES

- 1. CONCRETE CONSTRUCTION NOTES SHALL BE ACCORDING TO THE CITY OF DENVER SPECIFICATIONS FOR CONSTRUCTION OF CONCRETE...
2. CONCRETE CONSTRUCTION NOTES SHALL BE ACCORDING TO THE CITY OF DENVER SPECIFICATIONS FOR CONSTRUCTION OF CONCRETE...

PAVING CONSTRUCTION NOTES

- 1. PAVING CONSTRUCTION NOTES SHALL BE ACCORDING TO THE CITY OF DENVER SPECIFICATIONS FOR CONSTRUCTION OF PAVEMENT...
2. PAVING CONSTRUCTION NOTES SHALL BE ACCORDING TO THE CITY OF DENVER SPECIFICATIONS FOR CONSTRUCTION OF PAVEMENT...

CONCRETE CONSTRUCTION NOTES

- 1. CONCRETE CONSTRUCTION NOTES SHALL BE ACCORDING TO THE CITY OF DENVER SPECIFICATIONS FOR CONSTRUCTION OF CONCRETE...
2. CONCRETE CONSTRUCTION NOTES SHALL BE ACCORDING TO THE CITY OF DENVER SPECIFICATIONS FOR CONSTRUCTION OF CONCRETE...

WATER MAIN CONSTRUCTION NOTES

- 1. WATER MAIN CONSTRUCTION NOTES SHALL BE ACCORDING TO THE CITY OF DENVER SPECIFICATIONS FOR CONSTRUCTION OF WATER MAINS...
2. WATER MAIN CONSTRUCTION NOTES SHALL BE ACCORDING TO THE CITY OF DENVER SPECIFICATIONS FOR CONSTRUCTION OF WATER MAINS...

SANITARY SEWER CONSTRUCTION NOTES

- 1. SANITARY SEWER CONSTRUCTION NOTES SHALL BE ACCORDING TO THE CITY OF DENVER SPECIFICATIONS FOR CONSTRUCTION OF SANITARY SEWER MAINS...
2. SANITARY SEWER CONSTRUCTION NOTES SHALL BE ACCORDING TO THE CITY OF DENVER SPECIFICATIONS FOR CONSTRUCTION OF SANITARY SEWER MAINS...

GENERAL CONSTRUCTION NOTES

- 1. ALL WORK SHALL BE ACCORDING TO THE CITY OF DENVER SPECIFICATIONS FOR CONSTRUCTION OF WATER MAINS...
2. ALL WORK SHALL BE ACCORDING TO THE CITY OF DENVER SPECIFICATIONS FOR CONSTRUCTION OF WATER MAINS...

STORM SEWER CONSTRUCTION NOTES

- 1. STORM SEWER CONSTRUCTION SHALL BE ACCORDING TO THE CITY OF DENVER SPECIFICATIONS FOR CONSTRUCTION OF STORM SEWER MAINS...
2. STORM SEWER CONSTRUCTION SHALL BE ACCORDING TO THE CITY OF DENVER SPECIFICATIONS FOR CONSTRUCTION OF STORM SEWER MAINS...

PAVING CONSTRUCTION NOTES

- 1. PAVING CONSTRUCTION NOTES SHALL BE ACCORDING TO THE CITY OF DENVER SPECIFICATIONS FOR CONSTRUCTION OF PAVEMENT...
2. PAVING CONSTRUCTION NOTES SHALL BE ACCORDING TO THE CITY OF DENVER SPECIFICATIONS FOR CONSTRUCTION OF PAVEMENT...

CONCRETE CONSTRUCTION NOTES

- 1. CONCRETE CONSTRUCTION NOTES SHALL BE ACCORDING TO THE CITY OF DENVER SPECIFICATIONS FOR CONSTRUCTION OF CONCRETE...
2. CONCRETE CONSTRUCTION NOTES SHALL BE ACCORDING TO THE CITY OF DENVER SPECIFICATIONS FOR CONSTRUCTION OF CONCRETE...

WATER MAIN CONSTRUCTION NOTES

- 1. WATER MAIN CONSTRUCTION NOTES SHALL BE ACCORDING TO THE CITY OF DENVER SPECIFICATIONS FOR CONSTRUCTION OF WATER MAINS...
2. WATER MAIN CONSTRUCTION NOTES SHALL BE ACCORDING TO THE CITY OF DENVER SPECIFICATIONS FOR CONSTRUCTION OF WATER MAINS...

SANITARY SEWER CONSTRUCTION NOTES

- 1. SANITARY SEWER CONSTRUCTION NOTES SHALL BE ACCORDING TO THE CITY OF DENVER SPECIFICATIONS FOR CONSTRUCTION OF SANITARY SEWER MAINS...
2. SANITARY SEWER CONSTRUCTION NOTES SHALL BE ACCORDING TO THE CITY OF DENVER SPECIFICATIONS FOR CONSTRUCTION OF SANITARY SEWER MAINS...

PAPE-DAWSON ENGINEERS logo and contact information including address and phone number.

Table with columns for DATE, TIME, and DESCRIPTION, containing project schedule details.

THE TRAILS AT SEABOURNE PARKE SECTION THREE

CONSTRUCTION NOTES



CITY OF ROSENBERG DEPARTMENT OF PUBLIC WORKS AND ENGINEERING







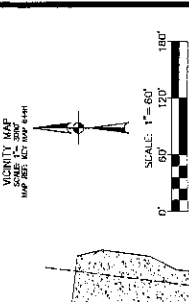
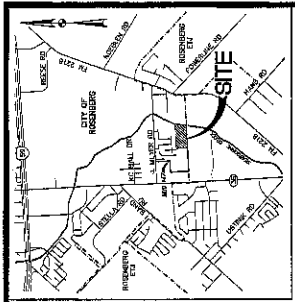

REMARKS:  
BASED ON THE AS-BUILT RECORDS  
AND SURVEY DATA FROM THE FIELD AND  
PROPERTY RECORDS. THE EXISTING SEWER  
LINE IS TO BE REMOVED AND REPLACED  
WITH THE NEW LINE AS SHOWN ON THIS PLAN.

**PAPE-DAWSON ENGINEERS**  
REGISTERED PROFESSIONAL ENGINEERS  
1000 W. 10TH STREET, SUITE 100  
DALLAS, TEXAS 75201  
TEL: 972-443-1100  
FAX: 972-443-1101  
WWW.PAPE-DAWSON.COM

**THE TRAILS AT SEABOURNE PARKE SECTION THREE**  
CITY OF ROSENBERG, TEXAS

LOT 1000'S - TEXAS, LLC  
TRAILS AT SEABOURNE PARKE  
PORTION OF 27.141 ACRES  
OF NO. 20020152 EBCOOP  
7/13/13 AND  
2014051923  
FHCDD#

**SANITARY SEWER LAYOUT**  
CITY OF ROSENBERG  
DEPARTMENT OF PUBLIC WORKS AND ENGINEERING

FORT BEND COUNTY MUNICIPAL UTILITY NO. 147  
SEABOURNE PARKE  
15,630 SQUARE FEET  
CF NO. 20040109  
FHCDD#

WAYNE L. REA, II &  
JOHN P. FUGER  
REGISTERED PROFESSIONAL ENGINEERS  
CF NO. 200098974  
FHCDD#

REGISTERED PROFESSIONAL ENGINEERS  
CITY OF ROSENBERG

DRAWING SCALE: 1" = 40'  
SHEET NO. 6 OF 27

**LEGEND**

	PLAT BOUNDARY		PROPOSED 12" SANITARY SEWER
	EXISTING 12" SANITARY SEWER		PROPOSED 8" SANITARY SEWER
	EXISTING 8" SANITARY SEWER		PROPOSED 6" SANITARY SEWER
	EXISTING 4" SANITARY SEWER		PROPOSED 3" SANITARY SEWER
	EXISTING 2" SANITARY SEWER		PROPOSED 1.5" SANITARY SEWER
	EXISTING 1" SANITARY SEWER		PROPOSED 0.75" SANITARY SEWER
	EXISTING 0.75" SANITARY SEWER		PROPOSED 0.5" SANITARY SEWER
	EXISTING 0.5" SANITARY SEWER		PROPOSED 0.25" SANITARY SEWER
	EXISTING 0.25" SANITARY SEWER		PROPOSED 0.125" SANITARY SEWER
	EXISTING 0.125" SANITARY SEWER		PROPOSED 0.0625" SANITARY SEWER
	EXISTING 0.0625" SANITARY SEWER		PROPOSED 0.03125" SANITARY SEWER
	EXISTING 0.03125" SANITARY SEWER		PROPOSED 0.015625" SANITARY SEWER
	EXISTING 0.015625" SANITARY SEWER		PROPOSED 0.0078125" SANITARY SEWER
	EXISTING 0.0078125" SANITARY SEWER		PROPOSED 0.00390625" SANITARY SEWER
	EXISTING 0.00390625" SANITARY SEWER		PROPOSED 0.001953125" SANITARY SEWER
	EXISTING 0.001953125" SANITARY SEWER		PROPOSED 0.0009765625" SANITARY SEWER
	EXISTING 0.0009765625" SANITARY SEWER		PROPOSED 0.00048828125" SANITARY SEWER
	EXISTING 0.00048828125" SANITARY SEWER		PROPOSED 0.000244140625" SANITARY SEWER
	EXISTING 0.000244140625" SANITARY SEWER		PROPOSED 0.0001220703125" SANITARY SEWER
	EXISTING 0.0001220703125" SANITARY SEWER		PROPOSED 0.00006103515625" SANITARY SEWER
	EXISTING 0.00006103515625" SANITARY SEWER		PROPOSED 0.000030517578125" SANITARY SEWER
	EXISTING 0.000030517578125" SANITARY SEWER		PROPOSED 0.0000152587890625" SANITARY SEWER
	EXISTING 0.0000152587890625" SANITARY SEWER		PROPOSED 0.00000762939453125" SANITARY SEWER
	EXISTING 0.00000762939453125" SANITARY SEWER		PROPOSED 0.000003814697265625" SANITARY SEWER
	EXISTING 0.000003814697265625" SANITARY SEWER		PROPOSED 0.0000019073486328125" SANITARY SEWER
	EXISTING 0.0000019073486328125" SANITARY SEWER		PROPOSED 0.00000095367431640625" SANITARY SEWER
	EXISTING 0.00000095367431640625" SANITARY SEWER		PROPOSED 0.000000476837158203125" SANITARY SEWER
	EXISTING 0.000000476837158203125" SANITARY SEWER		PROPOSED 0.0000002384185791015625" SANITARY SEWER
	EXISTING 0.0000002384185791015625" SANITARY SEWER		PROPOSED 0.00000011920928955078125" SANITARY SEWER
	EXISTING 0.00000011920928955078125" SANITARY SEWER		PROPOSED 0.000000059604644775390625" SANITARY SEWER
	EXISTING 0.000000059604644775390625" SANITARY SEWER		PROPOSED 0.0000000298023223876953125" SANITARY SEWER
	EXISTING 0.0000000298023223876953125" SANITARY SEWER		PROPOSED 0.00000001490116119384765625" SANITARY SEWER
	EXISTING 0.00000001490116119384765625" SANITARY SEWER		PROPOSED 0.000000007450580596923828125" SANITARY SEWER
	EXISTING 0.000000007450580596923828125" SANITARY SEWER		PROPOSED 0.0000000037252902984619140625" SANITARY SEWER
	EXISTING 0.0000000037252902984619140625" SANITARY SEWER		PROPOSED 0.00000000186264514923095703125" SANITARY SEWER
	EXISTING 0.00000000186264514923095703125" SANITARY SEWER		PROPOSED 0.000000000931322574615478515625" SANITARY SEWER
	EXISTING 0.000000000931322574615478515625" SANITARY SEWER		PROPOSED 0.00000000046566128730773928125" SANITARY SEWER
	EXISTING 0.00000000046566128730773928125" SANITARY SEWER		PROPOSED 0.000000000232830643653869640625" SANITARY SEWER
	EXISTING 0.000000000232830643653869640625" SANITARY SEWER		PROPOSED 0.0000000001164153218269348203125" SANITARY SEWER
	EXISTING 0.0000000001164153218269348203125" SANITARY SEWER		PROPOSED 0.00000000005820766091346741015625" SANITARY SEWER
	EXISTING 0.00000000005820766091346741015625" SANITARY SEWER		PROPOSED 0.000000000029103830456733705078125" SANITARY SEWER
	EXISTING 0.000000000029103830456733705078125" SANITARY SEWER		PROPOSED 0.0000000000145519152283668525390625" SANITARY SEWER
	EXISTING 0.0000000000145519152283668525390625" SANITARY SEWER		PROPOSED 0.00000000000727595761418342626953125" SANITARY SEWER
	EXISTING 0.00000000000727595761418342626953125" SANITARY SEWER		PROPOSED 0.000000000003637978807091713134765625" SANITARY SEWER
	EXISTING 0.000000000003637978807091713134765625" SANITARY SEWER		PROPOSED 0.0000000000018189894035458565673928125" SANITARY SEWER
	EXISTING 0.0000000000018189894035458565673928125" SANITARY SEWER		PROPOSED 0.00000000000090949470177292828369640625" SANITARY SEWER
	EXISTING 0.00000000000090949470177292828369640625" SANITARY SEWER		PROPOSED 0.00000000000045474735088641418184765625" SANITARY SEWER
	EXISTING 0.00000000000045474735088641418184765625" SANITARY SEWER		PROPOSED 0.000000000000227373675443207090923828125" SANITARY SEWER
	EXISTING 0.000000000000227373675443207090923828125" SANITARY SEWER		PROPOSED 0.0000000000001136868377216035454619140625" SANITARY SEWER
	EXISTING 0.0000000000001136868377216035454619140625" SANITARY SEWER		PROPOSED 0.00000000000005684341888072727295703125" SANITARY SEWER
	EXISTING 0.00000000000005684341888072727295703125" SANITARY SEWER		PROPOSED 0.000000000000028421709440363636478515625" SANITARY SEWER
	EXISTING 0.000000000000028421709440363636478515625" SANITARY SEWER		PROPOSED 0.00000000000001421085472018181823928125" SANITARY SEWER
	EXISTING 0.00000000000001421085472018181823928125" SANITARY SEWER		PROPOSED 0.000000000000007105427360090909119640625" SANITARY SEWER
	EXISTING 0.000000000000007105427360090909119640625" SANITARY SEWER		PROPOSED 0.0000000000000035527136800454545978515625" SANITARY SEWER
	EXISTING 0.0000000000000035527136800454545978515625" SANITARY SEWER		PROPOSED 0.000000000000001776356840022727298928125" SANITARY SEWER
	EXISTING 0.000000000000001776356840022727298928125" SANITARY SEWER		PROPOSED 0.0000000000000008881784200113636494640625" SANITARY SEWER
	EXISTING 0.0000000000000008881784200113636494640625" SANITARY SEWER		PROPOSED 0.00000000000000044408921000568182473203125" SANITARY SEWER
	EXISTING 0.00000000000000044408921000568182473203125" SANITARY SEWER		PROPOSED 0.000000000000000222044605002840912366015625" SANITARY SEWER
	EXISTING 0.000000000000000222044605002840912366015625" SANITARY SEWER		PROPOSED 0.0000000000000001110223025001420455617828125" SANITARY SEWER
	EXISTING 0.0000000000000001110223025001420455617828125" SANITARY SEWER		PROPOSED 0.00000000000000005551115125000710227814140625" SANITARY SEWER
	EXISTING 0.00000000000000005551115125000710227814140625" SANITARY SEWER		PROPOSED 0.0000000000000000277555756250003551117071015625" SANITARY SEWER
	EXISTING 0.0000000000000000277555756250003551117071015625" SANITARY SEWER		PROPOSED 0.0000000000000000138777878125000177555853551078125" SANITARY SEWER
	EXISTING 0.0000000000000000138777878125000177555853551078125" SANITARY SEWER		PROPOSED 0.000000000000000006938893906250000887779267751015625" SANITARY SEWER







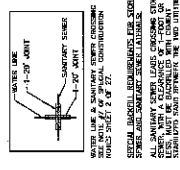
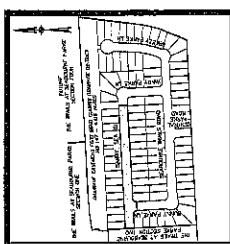

WATER LINE & SANITARY SEWER CROSSING: PROVIDE 18" CLEARANCE OVER WATER LINE. PROVIDE 18" CLEARANCE UNDER SANITARY SEWER LINE.

SPECIAL BACKFILL REQUIREMENTS FOR STORM SEWER: PROVIDE 24" MINIMUM COVER OVER STORM SEWER. PROVIDE 18" MINIMUM COVER OVER SANITARY SEWER.

MINIMUM COVER REQUIREMENTS: PROVIDE 18" MINIMUM COVER OVER ALL SEWER LINES. PROVIDE 24" MINIMUM COVER OVER STORM SEWER.

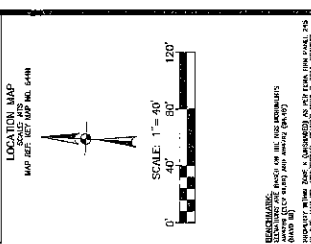

WATER METER SHALL BE SET ONE (1) FOOT INSIDE ROW OR IN ADJACENT WATER LINE EASEMENT.

CONTRACTOR TO TRANSFER CURB HEIGHT AT EACH END OF WATER METER TO EXISTING CURB. TRANSITION DETAIL ON SHEET 78 OF 77.

CONTRACTOR SHALL VERIFY ALL EXISTING UTILITIES AND PROVIDE PROTECTIVE CASING AS REQUIRED. PROVIDE PROTECTIVE CASING FOR ALL EXISTING UTILITIES TO BE DELETED OR RELOCATED.

CONTRACTOR SHALL VERIFY ALL EXISTING UTILITIES AND PROVIDE PROTECTIVE CASING AS REQUIRED. PROVIDE PROTECTIVE CASING FOR ALL EXISTING UTILITIES TO BE DELETED OR RELOCATED.

CONTRACTOR SHALL VERIFY ALL EXISTING UTILITIES AND PROVIDE PROTECTIVE CASING AS REQUIRED. PROVIDE PROTECTIVE CASING FOR ALL EXISTING UTILITIES TO BE DELETED OR RELOCATED.

CONTRACTOR SHALL VERIFY ALL EXISTING UTILITIES AND PROVIDE PROTECTIVE CASING AS REQUIRED. PROVIDE PROTECTIVE CASING FOR ALL EXISTING UTILITIES TO BE DELETED OR RELOCATED.

CONTRACTOR SHALL VERIFY ALL EXISTING UTILITIES AND PROVIDE PROTECTIVE CASING AS REQUIRED. PROVIDE PROTECTIVE CASING FOR ALL EXISTING UTILITIES TO BE DELETED OR RELOCATED.

CONTRACTOR SHALL VERIFY ALL EXISTING UTILITIES AND PROVIDE PROTECTIVE CASING AS REQUIRED. PROVIDE PROTECTIVE CASING FOR ALL EXISTING UTILITIES TO BE DELETED OR RELOCATED.

CONTRACTOR SHALL VERIFY ALL EXISTING UTILITIES AND PROVIDE PROTECTIVE CASING AS REQUIRED. PROVIDE PROTECTIVE CASING FOR ALL EXISTING UTILITIES TO BE DELETED OR RELOCATED.

CONTRACTOR SHALL VERIFY ALL EXISTING UTILITIES AND PROVIDE PROTECTIVE CASING AS REQUIRED. PROVIDE PROTECTIVE CASING FOR ALL EXISTING UTILITIES TO BE DELETED OR RELOCATED.

CONTRACTOR SHALL VERIFY ALL EXISTING UTILITIES AND PROVIDE PROTECTIVE CASING AS REQUIRED. PROVIDE PROTECTIVE CASING FOR ALL EXISTING UTILITIES TO BE DELETED OR RELOCATED.

CONTRACTOR SHALL VERIFY ALL EXISTING UTILITIES AND PROVIDE PROTECTIVE CASING AS REQUIRED. PROVIDE PROTECTIVE CASING FOR ALL EXISTING UTILITIES TO BE DELETED OR RELOCATED.

CONTRACTOR SHALL VERIFY ALL EXISTING UTILITIES AND PROVIDE PROTECTIVE CASING AS REQUIRED. PROVIDE PROTECTIVE CASING FOR ALL EXISTING UTILITIES TO BE DELETED OR RELOCATED.

CONTRACTOR SHALL VERIFY ALL EXISTING UTILITIES AND PROVIDE PROTECTIVE CASING AS REQUIRED. PROVIDE PROTECTIVE CASING FOR ALL EXISTING UTILITIES TO BE DELETED OR RELOCATED.

CONTRACTOR SHALL VERIFY ALL EXISTING UTILITIES AND PROVIDE PROTECTIVE CASING AS REQUIRED. PROVIDE PROTECTIVE CASING FOR ALL EXISTING UTILITIES TO BE DELETED OR RELOCATED.

CONTRACTOR SHALL VERIFY ALL EXISTING UTILITIES AND PROVIDE PROTECTIVE CASING AS REQUIRED. PROVIDE PROTECTIVE CASING FOR ALL EXISTING UTILITIES TO BE DELETED OR RELOCATED.

CONTRACTOR SHALL VERIFY ALL EXISTING UTILITIES AND PROVIDE PROTECTIVE CASING AS REQUIRED. PROVIDE PROTECTIVE CASING FOR ALL EXISTING UTILITIES TO BE DELETED OR RELOCATED.

CONTRACTOR SHALL VERIFY ALL EXISTING UTILITIES AND PROVIDE PROTECTIVE CASING AS REQUIRED. PROVIDE PROTECTIVE CASING FOR ALL EXISTING UTILITIES TO BE DELETED OR RELOCATED.

CONTRACTOR SHALL VERIFY ALL EXISTING UTILITIES AND PROVIDE PROTECTIVE CASING AS REQUIRED. PROVIDE PROTECTIVE CASING FOR ALL EXISTING UTILITIES TO BE DELETED OR RELOCATED.

CONTRACTOR SHALL VERIFY ALL EXISTING UTILITIES AND PROVIDE PROTECTIVE CASING AS REQUIRED. PROVIDE PROTECTIVE CASING FOR ALL EXISTING UTILITIES TO BE DELETED OR RELOCATED.

CONTRACTOR SHALL VERIFY ALL EXISTING UTILITIES AND PROVIDE PROTECTIVE CASING AS REQUIRED. PROVIDE PROTECTIVE CASING FOR ALL EXISTING UTILITIES TO BE DELETED OR RELOCATED.

CONTRACTOR SHALL VERIFY ALL EXISTING UTILITIES AND PROVIDE PROTECTIVE CASING AS REQUIRED. PROVIDE PROTECTIVE CASING FOR ALL EXISTING UTILITIES TO BE DELETED OR RELOCATED.

CONTRACTOR SHALL VERIFY ALL EXISTING UTILITIES AND PROVIDE PROTECTIVE CASING AS REQUIRED. PROVIDE PROTECTIVE CASING FOR ALL EXISTING UTILITIES TO BE DELETED OR RELOCATED.

CONTRACTOR SHALL VERIFY ALL EXISTING UTILITIES AND PROVIDE PROTECTIVE CASING AS REQUIRED. PROVIDE PROTECTIVE CASING FOR ALL EXISTING UTILITIES TO BE DELETED OR RELOCATED.

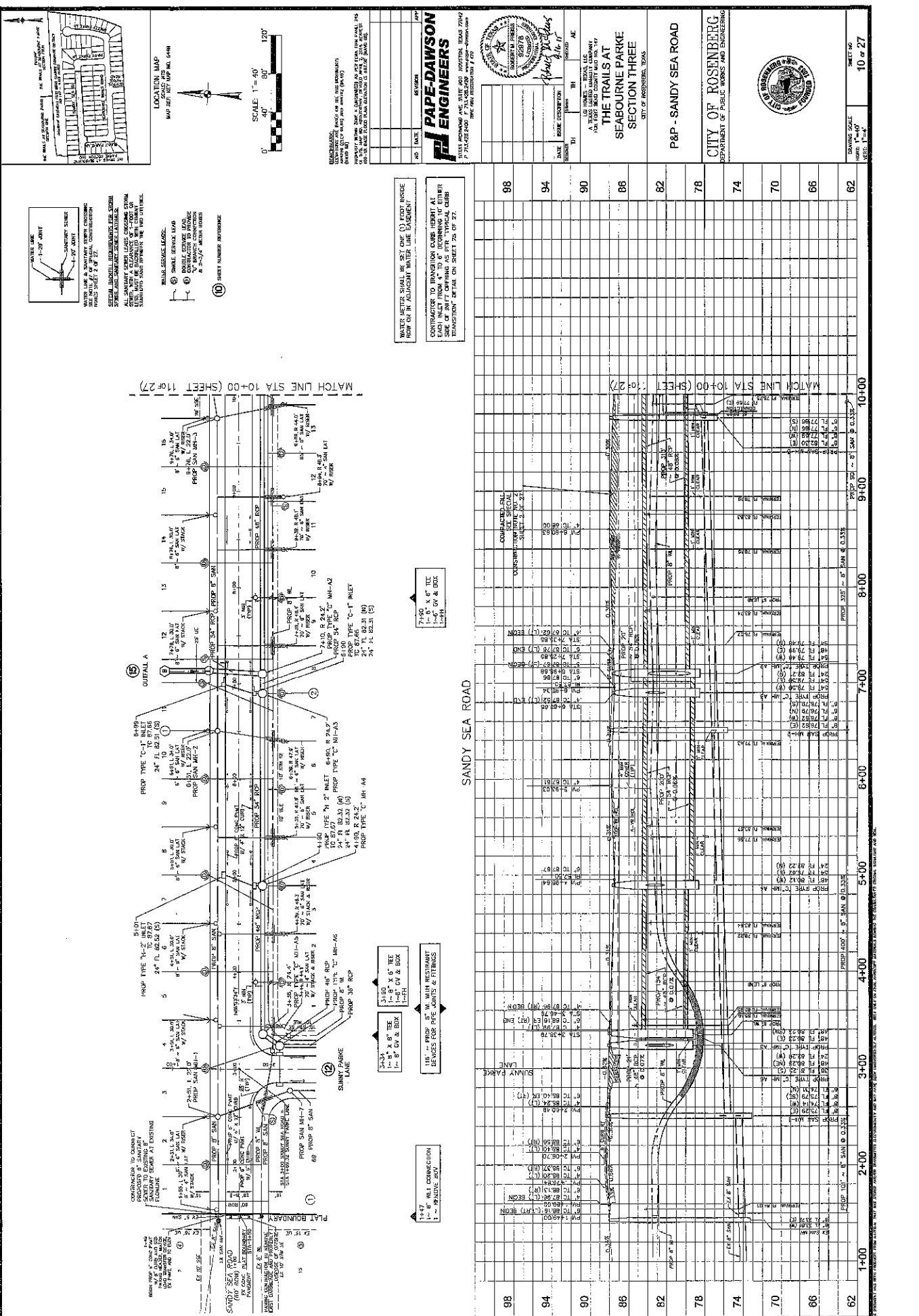

STATION	DESCRIPTION	DATE	BY	CHECKED
1+00	PROPOSED 12" DIA. SANITARY SEWER	10/27/20	J. DAWSON	J. DAWSON
2+00	PROPOSED 12" DIA. SANITARY SEWER	10/27/20	J. DAWSON	J. DAWSON
3+00	PROPOSED 12" DIA. SANITARY SEWER	10/27/20	J. DAWSON	J. DAWSON
4+00	PROPOSED 12" DIA. SANITARY SEWER	10/27/20	J. DAWSON	J. DAWSON
5+00	PROPOSED 12" DIA. SANITARY SEWER	10/27/20	J. DAWSON	J. DAWSON
6+00	PROPOSED 12" DIA. SANITARY SEWER	10/27/20	J. DAWSON	J. DAWSON
7+00	PROPOSED 12" DIA. SANITARY SEWER	10/27/20	J. DAWSON	J. DAWSON
8+00	PROPOSED 12" DIA. SANITARY SEWER	10/27/20	J. DAWSON	J. DAWSON
9+00	PROPOSED 12" DIA. SANITARY SEWER	10/27/20	J. DAWSON	J. DAWSON
10+00	PROPOSED 12" DIA. SANITARY SEWER	10/27/20	J. DAWSON	J. DAWSON

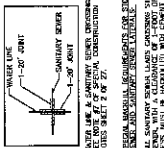

ALL UTILITY LEADS SHALL BE IDENTIFIED IN THE FIELD BY MARKING THE LEAD WITH A FLAG OR SIGN. THE LEAD SHALL BE MARKED WITH A FLAG OR SIGN AT EVERY CROSSING AND AT EVERY POINT WHERE THE LEAD IS TO BE OPENED FOR REPAIR OR MAINTENANCE. THE LEAD SHALL BE MARKED WITH A FLAG OR SIGN AT EVERY POINT WHERE THE LEAD IS TO BE OPENED FOR REPAIR OR MAINTENANCE.

- 1. WATER SERVICE LEAD
- 2. 12" DIAMETER LEAD
- 3. 18" DIAMETER LEAD
- 4. 24" DIAMETER LEAD
- 5. 30" DIAMETER LEAD
- 6. 36" DIAMETER LEAD
- 7. 42" DIAMETER LEAD
- 8. 48" DIAMETER LEAD
- 9. 54" DIAMETER LEAD
- 10. 60" DIAMETER LEAD
- 11. 66" DIAMETER LEAD
- 12. 72" DIAMETER LEAD
- 13. 78" DIAMETER LEAD
- 14. 84" DIAMETER LEAD
- 15. 90" DIAMETER LEAD
- 16. 96" DIAMETER LEAD
- 17. 102" DIAMETER LEAD
- 18. 108" DIAMETER LEAD
- 19. 114" DIAMETER LEAD
- 20. 120" DIAMETER LEAD

WINDY PARKE LANE  
 SEABOARD TRAILS  
 MATCH LINE STA 101+00 (SHEET 10-D-27)

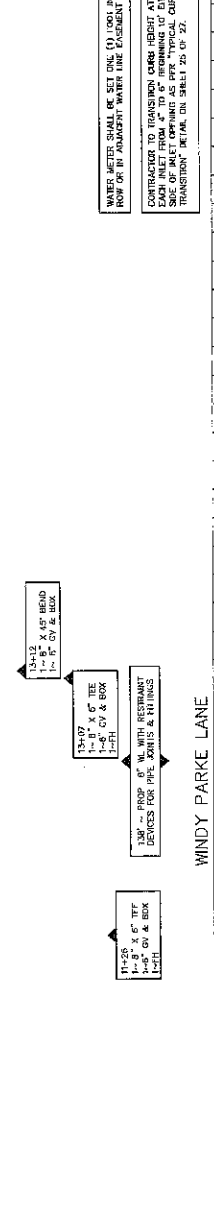

13'-0" X 6" TIE  
 1'-0" DIAMETER  
 WITH RESTRAINT  
 DEVICES FOR PIPE JOINTS & FITTINGS

13'-0" X 6" TIE  
 1'-0" DIAMETER  
 WITH RESTRAINT  
 DEVICES FOR PIPE JOINTS & FITTINGS

13'-0" X 6" TIE  
 1'-0" DIAMETER  
 WITH RESTRAINT  
 DEVICES FOR PIPE JOINTS & FITTINGS

13'-0" X 6" TIE  
 1'-0" DIAMETER  
 WITH RESTRAINT  
 DEVICES FOR PIPE JOINTS & FITTINGS

13'-0" X 6" TIE  
 1'-0" DIAMETER  
 WITH RESTRAINT  
 DEVICES FOR PIPE JOINTS & FITTINGS

13'-0" X 6" TIE  
 1'-0" DIAMETER  
 WITH RESTRAINT  
 DEVICES FOR PIPE JOINTS & FITTINGS

13'-0" X 6" TIE  
 1'-0" DIAMETER  
 WITH RESTRAINT  
 DEVICES FOR PIPE JOINTS & FITTINGS

13'-0" X 6" TIE  
 1'-0" DIAMETER  
 WITH RESTRAINT  
 DEVICES FOR PIPE JOINTS & FITTINGS

13'-0" X 6" TIE  
 1'-0" DIAMETER  
 WITH RESTRAINT  
 DEVICES FOR PIPE JOINTS & FITTINGS

13'-0" X 6" TIE  
 1'-0" DIAMETER  
 WITH RESTRAINT  
 DEVICES FOR PIPE JOINTS & FITTINGS

13'-0" X 6" TIE  
 1'-0" DIAMETER  
 WITH RESTRAINT  
 DEVICES FOR PIPE JOINTS & FITTINGS

13'-0" X 6" TIE  
 1'-0" DIAMETER  
 WITH RESTRAINT  
 DEVICES FOR PIPE JOINTS & FITTINGS

13'-0" X 6" TIE  
 1'-0" DIAMETER  
 WITH RESTRAINT  
 DEVICES FOR PIPE JOINTS & FITTINGS

13'-0" X 6" TIE  
 1'-0" DIAMETER  
 WITH RESTRAINT  
 DEVICES FOR PIPE JOINTS & FITTINGS

13'-0" X 6" TIE  
 1'-0" DIAMETER  
 WITH RESTRAINT  
 DEVICES FOR PIPE JOINTS & FITTINGS

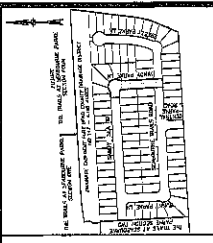

LOCATION MAP  
 MAP NOT TO SCALE  
 SCALE: 1" = 40'

SCALE: 1" = 40'  
 0' 40' 80' 120'

NO DATE  
 NO DRAWING  
 NO SHEET

PAPE-DAWSON  
 ENGINEERS  
 1000 NORTH WINDY PARKE LANE  
 NORMAN, OKLAHOMA 73069

THE TRAILS AT  
 SEABOARD TRAILS  
 SECTION THREE  
 CITY OF NORMAN, OKLAHOMA



CITY OF NORMAN  
 DEPARTMENT OF PUBLIC WORKS AND ENGINEERING

P&P - WINDY PARKE LANE

CITY OF NORMAN  
 DEPARTMENT OF PUBLIC WORKS AND ENGINEERING



DRAWING SCALE  
 1" = 40'

SHEET NO.  
 11 OF 27

98	94	90	86	82	78	74	70	66	62
15+00	14+00	13+00	12+00	11+00	10+00	9+00	8+00	7+00	6+00

15+00  
 14+00  
 13+00  
 12+00  
 11+00  
 10+00

15+00  
 14+00  
 13+00  
 12+00  
 11+00  
 10+00

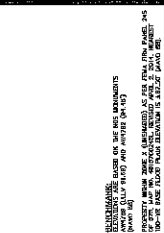
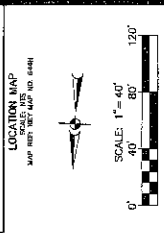
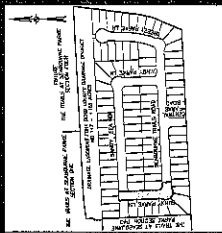

**LOCATION MAP**  
MAP REF: 100-100-100-100

**SCALE: 1" = 40'**  
0 40 80 120

**GENERAL NOTES:**

1. ALL SANITARY SEWER LINES SHALL BE 12" DIA. UNLESS OTHERWISE SHOWN.

2. ALL SANITARY SEWER LINES SHALL BE 12" DIA. UNLESS OTHERWISE SHOWN.

3. ALL SANITARY SEWER LINES SHALL BE 12" DIA. UNLESS OTHERWISE SHOWN.

4. ALL SANITARY SEWER LINES SHALL BE 12" DIA. UNLESS OTHERWISE SHOWN.

5. ALL SANITARY SEWER LINES SHALL BE 12" DIA. UNLESS OTHERWISE SHOWN.

6. ALL SANITARY SEWER LINES SHALL BE 12" DIA. UNLESS OTHERWISE SHOWN.

7. ALL SANITARY SEWER LINES SHALL BE 12" DIA. UNLESS OTHERWISE SHOWN.

8. ALL SANITARY SEWER LINES SHALL BE 12" DIA. UNLESS OTHERWISE SHOWN.

9. ALL SANITARY SEWER LINES SHALL BE 12" DIA. UNLESS OTHERWISE SHOWN.

10. ALL SANITARY SEWER LINES SHALL BE 12" DIA. UNLESS OTHERWISE SHOWN.

**GENERAL NOTES:**

1. ALL SANITARY SEWER LINES SHALL BE 12" DIA. UNLESS OTHERWISE SHOWN.

2. ALL SANITARY SEWER LINES SHALL BE 12" DIA. UNLESS OTHERWISE SHOWN.

3. ALL SANITARY SEWER LINES SHALL BE 12" DIA. UNLESS OTHERWISE SHOWN.

4. ALL SANITARY SEWER LINES SHALL BE 12" DIA. UNLESS OTHERWISE SHOWN.

5. ALL SANITARY SEWER LINES SHALL BE 12" DIA. UNLESS OTHERWISE SHOWN.

6. ALL SANITARY SEWER LINES SHALL BE 12" DIA. UNLESS OTHERWISE SHOWN.

7. ALL SANITARY SEWER LINES SHALL BE 12" DIA. UNLESS OTHERWISE SHOWN.

8. ALL SANITARY SEWER LINES SHALL BE 12" DIA. UNLESS OTHERWISE SHOWN.

9. ALL SANITARY SEWER LINES SHALL BE 12" DIA. UNLESS OTHERWISE SHOWN.

10. ALL SANITARY SEWER LINES SHALL BE 12" DIA. UNLESS OTHERWISE SHOWN.

**GENERAL NOTES:**

1. ALL SANITARY SEWER LINES SHALL BE 12" DIA. UNLESS OTHERWISE SHOWN.

2. ALL SANITARY SEWER LINES SHALL BE 12" DIA. UNLESS OTHERWISE SHOWN.

3. ALL SANITARY SEWER LINES SHALL BE 12" DIA. UNLESS OTHERWISE SHOWN.

4. ALL SANITARY SEWER LINES SHALL BE 12" DIA. UNLESS OTHERWISE SHOWN.

5. ALL SANITARY SEWER LINES SHALL BE 12" DIA. UNLESS OTHERWISE SHOWN.

6. ALL SANITARY SEWER LINES SHALL BE 12" DIA. UNLESS OTHERWISE SHOWN.

7. ALL SANITARY SEWER LINES SHALL BE 12" DIA. UNLESS OTHERWISE SHOWN.

8. ALL SANITARY SEWER LINES SHALL BE 12" DIA. UNLESS OTHERWISE SHOWN.

9. ALL SANITARY SEWER LINES SHALL BE 12" DIA. UNLESS OTHERWISE SHOWN.

10. ALL SANITARY SEWER LINES SHALL BE 12" DIA. UNLESS OTHERWISE SHOWN.

**GENERAL NOTES:**

1. ALL SANITARY SEWER LINES SHALL BE 12" DIA. UNLESS OTHERWISE SHOWN.

2. ALL SANITARY SEWER LINES SHALL BE 12" DIA. UNLESS OTHERWISE SHOWN.

3. ALL SANITARY SEWER LINES SHALL BE 12" DIA. UNLESS OTHERWISE SHOWN.

4. ALL SANITARY SEWER LINES SHALL BE 12" DIA. UNLESS OTHERWISE SHOWN.

5. ALL SANITARY SEWER LINES SHALL BE 12" DIA. UNLESS OTHERWISE SHOWN.

6. ALL SANITARY SEWER LINES SHALL BE 12" DIA. UNLESS OTHERWISE SHOWN.

7. ALL SANITARY SEWER LINES SHALL BE 12" DIA. UNLESS OTHERWISE SHOWN.

8. ALL SANITARY SEWER LINES SHALL BE 12" DIA. UNLESS OTHERWISE SHOWN.

9. ALL SANITARY SEWER LINES SHALL BE 12" DIA. UNLESS OTHERWISE SHOWN.

10. ALL SANITARY SEWER LINES SHALL BE 12" DIA. UNLESS OTHERWISE SHOWN.

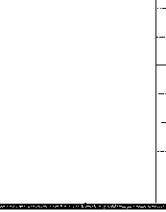
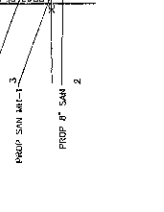
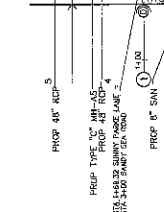
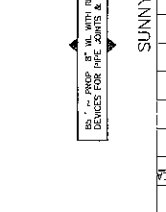
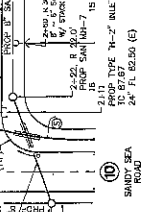
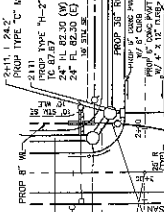
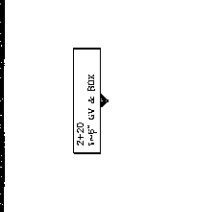
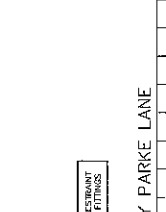
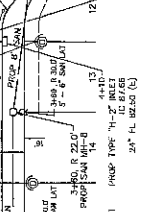
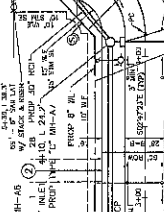
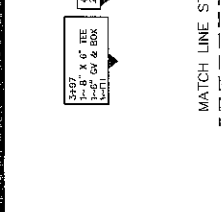
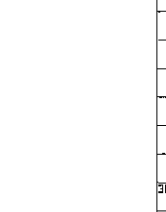
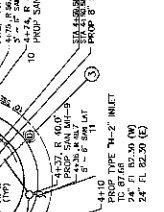
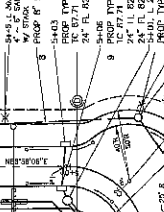
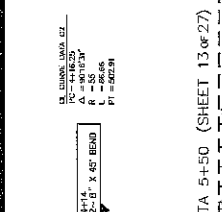
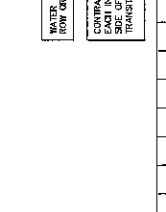
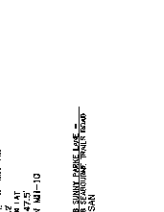
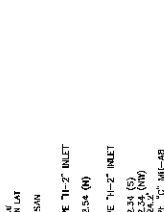
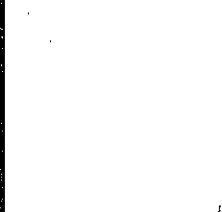

**PAPE-DAWSON ENGINEERS**

10000 W. 10th Street, Suite 200, Greenwood, Oklahoma 73050-7700  
P.O. Box 10000, Greenwood, Oklahoma 73050-7700  
TEL: (405) 875-1111 FAX: (405) 875-1112  
WWW.PAPE-DAWSON.COM

**THE TRAILS AT SEABOURNE PARKE SECTION THREE**  
CITY OF HOUSTON, TEXAS

**P&P - SUNNY PARKE LANE**

**CITY OF ROSENBERG**  
DEPARTMENT OF PUBLIC WORKS AND ENGINEERING

**PROJECT NO. 100-100-100-100**

**SHEET NO. 12 OF 27**

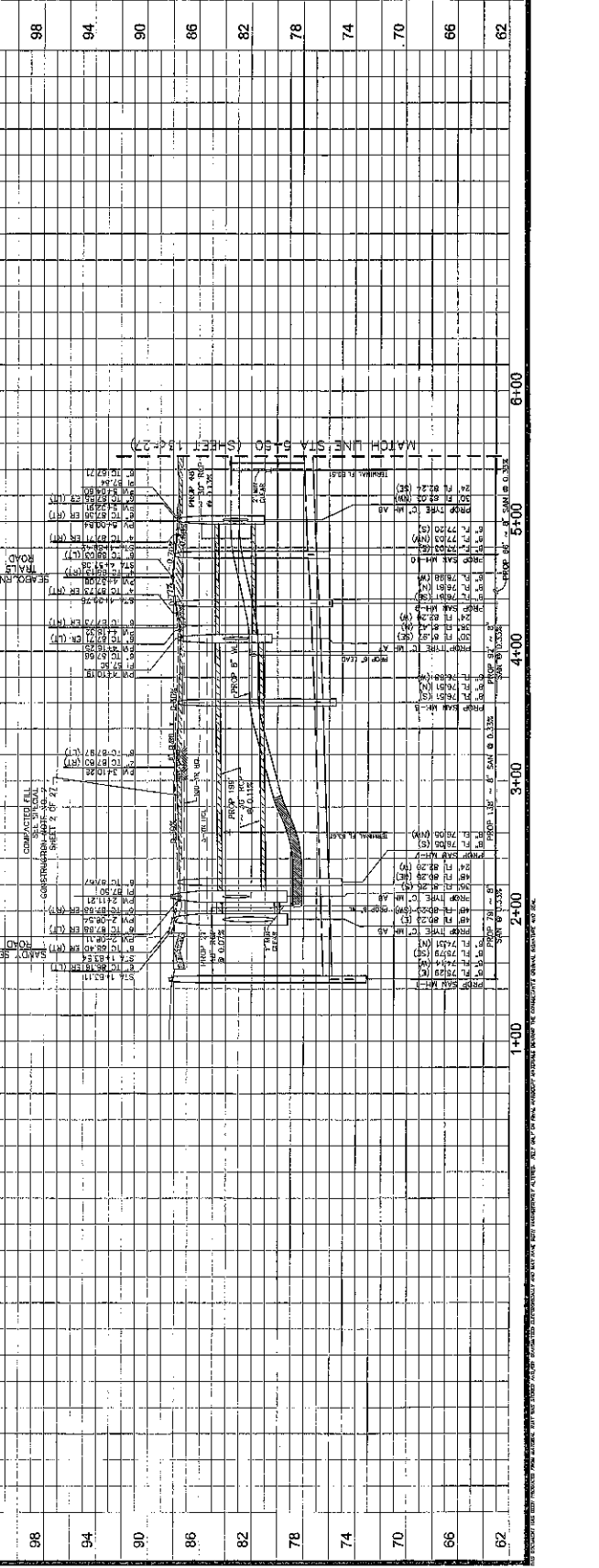

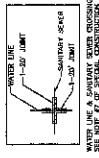
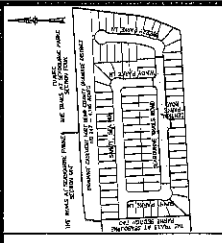

WATER LINE A SUSTAINABLE WATER CROSSING WITH A 12" COVER. ALL WATER MAINS SHALL BE INSTALLED WITH A 12" COVER. ALL WATER MAINS SHALL BE INSTALLED WITH A 12" COVER. ALL WATER MAINS SHALL BE INSTALLED WITH A 12" COVER.

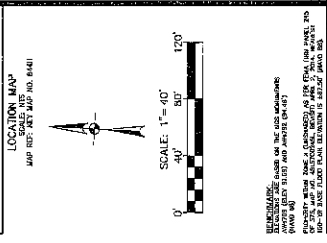

WATER SERVICE LEAD, SINGLE SERVICE LEAD, DOUBLE SERVICE LEAD, 12" BRASS CONNECTION, & 2-1/2" METE TONES. BEST PRACTICE DISTANCE.

**PAPE-DAWSON ENGINEERS**  
 4101 W. 11TH AVENUE, SUITE 100, DENVER, CO 80202  
 (303) 733-1100  
 www.pape-dawson.com

**CITY OF ROSENBERG**  
 DEPARTMENT OF PUBLIC WORKS AND ENGINEERING  
 P&P - SEABOURNE TRAILS ROAD  
 THE TRAILS AT SEABOURNE PARKE SECTION THREE  
 CITY OF ROSENBERG, TEXAS

PROJECT NO. 1507 AND SHEET 04-03  
 SHEET NO. 13 OF 27  
 DRAWING SCALE: AS SHOWN  
 DATE: 11-14-17

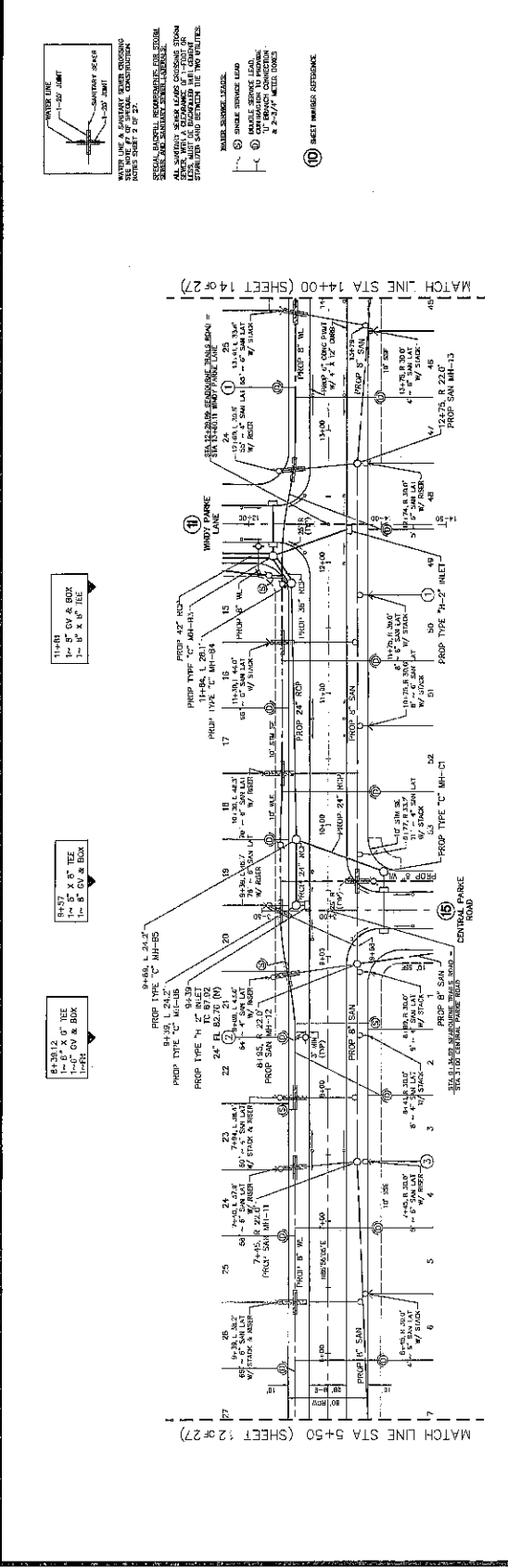

CONTRACTOR SHALL MAINTAIN THE EXISTING (1) FOOT MINIMUM CLEARANCE TO TRANSITION CURB HEIGHT AT EACH INLET FROM 4" TO 6" BEGINNING TO EITHER SIDE OF THE CURB. TRANSITION DETAIL USE SHEET 20 OF 27.

22" - 24" PROP. WITH RESTRICTION LENSES FOR PIPE JOINTS & FITTINGS

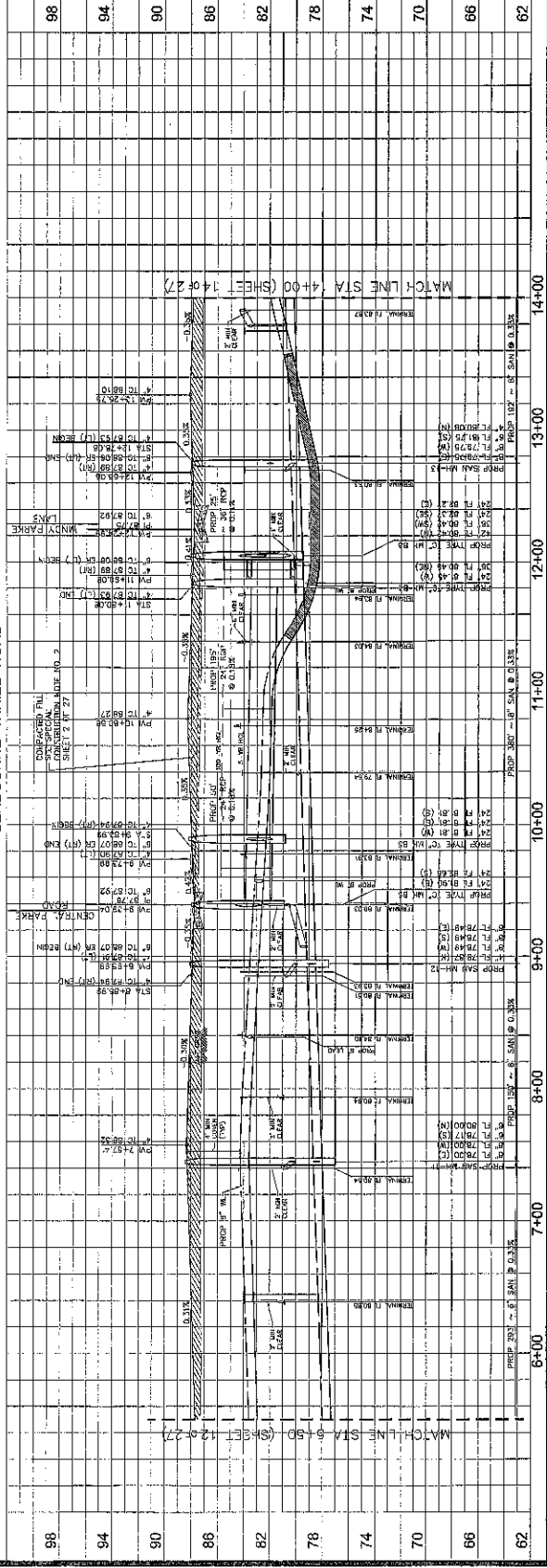

SEABOURNE TRAILS ROAD  
 MATCH LINE STA 14+00 (SHEET 14 OF 27)  
 MATCH LINE STA 14+00 (SHEET 14 OF 27)  
 MATCH LINE STA 5+50 (SHEET 12 OF 27)  
 MATCH LINE STA 5+50 (SHEET 12 OF 27)

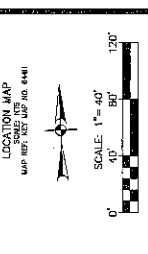
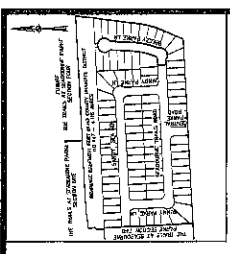

NO.	DATE	REVISION	BY

**PAPE-DAWSON ENGINEERS**  
 4000 WINDYBROOK AVE. SUITE 200 WASHINGTON, TEXAS 77062  
 P.O. BOX 10000 HOUSTON, TEXAS 77255  
 TEL: 281-291-1100 FAX: 281-291-1101  
 WWW.PAPE-DAWSON.COM

THE TRAILS AT SEABOURNE PARK  
 SECTION THREE  
 CITY OF HOUSTON, TEXAS

P&P - BREEZY PARKE LANE  
 CITY OF ROSENBERG  
 DEPARTMENT OF PUBLIC WORKS AND ENGINEERING

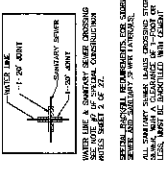
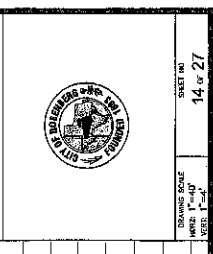

WATER METER SHALL BE SET ONE (1) FOOT INSIDE ROW OR IN ADJACENT WATER ERE EASEMENT.  
 CONTRACTOR TO TRANSFER CURB HEIGHT AT EACH INLET FROM 1\"/>



WATER METER LEAVE.  
 SINGLE SERVICE LEAD  
 CONNECTION TO MAIN  
 1/2\"/>

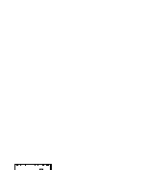

WATER METER LEAVE.  
 SINGLE SERVICE LEAD  
 CONNECTION TO MAIN  
 1/2\"/>



WATER METER LEAVE.  
 SINGLE SERVICE LEAD  
 CONNECTION TO MAIN  
 1/2\"/>

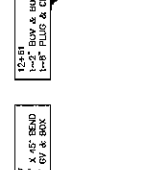

WATER METER LEAVE.  
 SINGLE SERVICE LEAD  
 CONNECTION TO MAIN  
 1/2\"/>

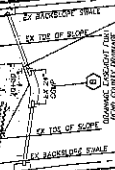

WATER METER LEAVE.  
 SINGLE SERVICE LEAD  
 CONNECTION TO MAIN  
 1/2\"/>

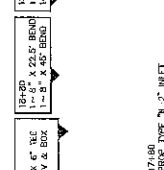

WATER METER LEAVE.  
 SINGLE SERVICE LEAD  
 CONNECTION TO MAIN  
 1/2\"/>



WATER METER LEAVE.  
 SINGLE SERVICE LEAD  
 CONNECTION TO MAIN  
 1/2\"/>

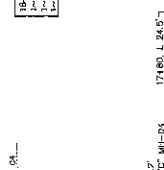

WATER METER LEAVE.  
 SINGLE SERVICE LEAD  
 CONNECTION TO MAIN  
 1/2\"/>

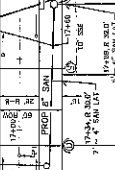

WATER METER LEAVE.  
 SINGLE SERVICE LEAD  
 CONNECTION TO MAIN  
 1/2\"/>

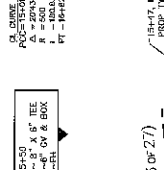

WATER METER LEAVE.  
 SINGLE SERVICE LEAD  
 CONNECTION TO MAIN  
 1/2\"/>

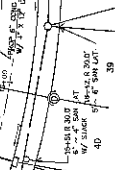

WATER METER LEAVE.  
 SINGLE SERVICE LEAD  
 CONNECTION TO MAIN  
 1/2\"/>

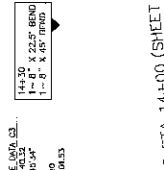

WATER METER LEAVE.  
 SINGLE SERVICE LEAD  
 CONNECTION TO MAIN  
 1/2\"/>

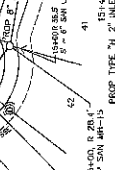

WATER METER LEAVE.  
 SINGLE SERVICE LEAD  
 CONNECTION TO MAIN  
 1/2\"/>



WATER METER LEAVE.  
 SINGLE SERVICE LEAD  
 CONNECTION TO MAIN  
 1/2\"/>

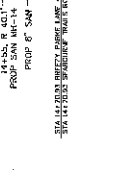

WATER METER LEAVE.  
 SINGLE SERVICE LEAD  
 CONNECTION TO MAIN  
 1/2\"/>

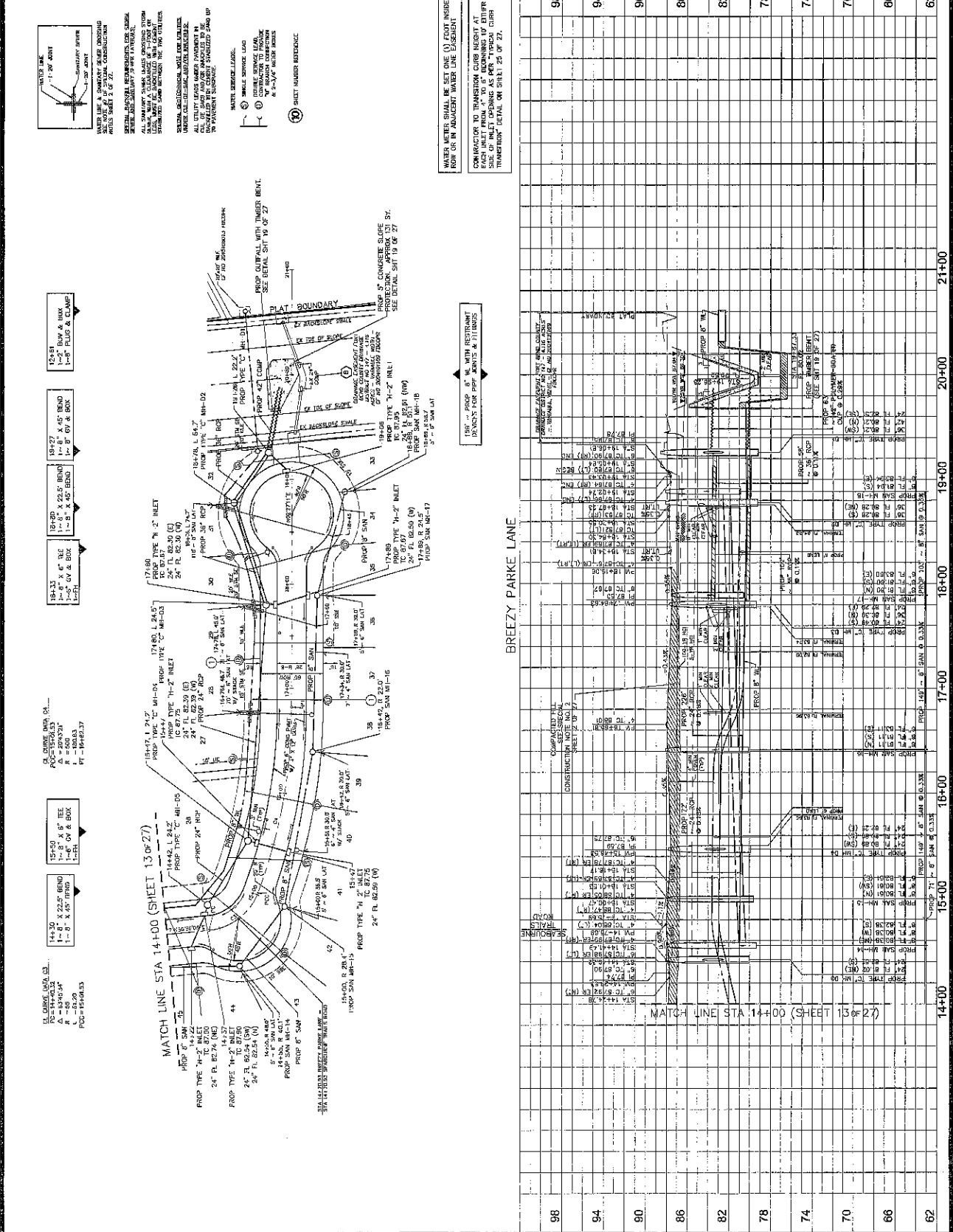

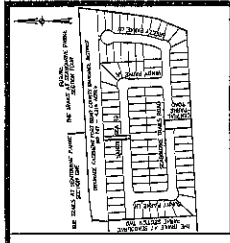

**LOCATION MAP**  
SCALE: 1" = 400'  
MAP REF: 827 MAP NO. 8441

**MARKS SHOWN:**  
1" x 3" PLUG & CLAMP  
1" x 3" PLUG & CLAMP  
24" DIA. BOX  
24" DIA. BOX

**WATER SERVICE LEAD:**  
SINGLE SERVICE LEAD  
DOUBLE SERVICE LEAD  
BY 12" DIA. WATER MAIN  
& 24" DIA. WATER MAIN

**SEWER SERVICE LEAD:**  
SINGLE SERVICE LEAD  
DOUBLE SERVICE LEAD  
BY 12" DIA. SEWER MAIN  
& 24" DIA. SEWER MAIN

**PROPOSED EXTERIOR LIGHT:**  
OVERLAP SWAMP & GLOBE  
PROJECTION - APPROX 13.5'  
SEE DETAIL SHIT TO OF 27

**NOTES:**  
1. CONTRACTOR TO VERIFY ALL EXISTING UTILITIES AND RECORD THEM ON THE AS-BUILT DRAWINGS.  
2. CONTRACTOR TO VERIFY ALL EXISTING UTILITIES AND RECORD THEM ON THE AS-BUILT DRAWINGS.  
3. CONTRACTOR TO VERIFY ALL EXISTING UTILITIES AND RECORD THEM ON THE AS-BUILT DRAWINGS.

**PAPE-DAWSON ENGINEERS**  
1000 W. 10TH ST. SUITE 100  
SEASBOARD, NC 28582  
TEL: 252-782-2200 FAX: 252-782-2201  
WWW.PAPE-DAWSON.COM

**THE TRAILS AT SEABOARD PARKE SECTION THREE**  
CITY OF SEABOARD, NC

**P&P - CENTRAL PARKE ROAD & OUTFALL A**  
CITY OF ROSENBERG  
DEPARTMENT OF PUBLIC WORKS AND ENGINEERING

**CONTRACT NO. 15-07**  
SHEET NO. 15 OF 27

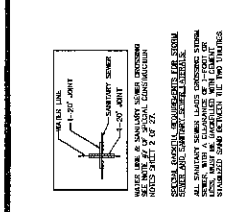

**PROPOSED SANITARY SEWER SYSTEM**  
SCALE: 1" = 40'

**PROPOSED SANITARY SEWER SYSTEM**  
SCALE: 1" = 40'

**CONTRACTOR TO VERIFY ALL EXISTING UTILITIES AND RECORD THEM ON THE AS-BUILT DRAWINGS.**

**CONTRACTOR TO VERIFY ALL EXISTING UTILITIES AND RECORD THEM ON THE AS-BUILT DRAWINGS.**

**CONTRACTOR TO VERIFY ALL EXISTING UTILITIES AND RECORD THEM ON THE AS-BUILT DRAWINGS.**

**CONTRACTOR TO VERIFY ALL EXISTING UTILITIES AND RECORD THEM ON THE AS-BUILT DRAWINGS.**

**CONTRACTOR TO VERIFY ALL EXISTING UTILITIES AND RECORD THEM ON THE AS-BUILT DRAWINGS.**

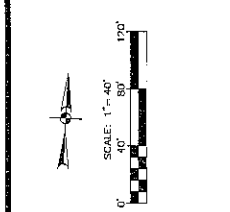

**PROPOSED SANITARY SEWER SYSTEM**  
SCALE: 1" = 40'

**CONTRACTOR TO VERIFY ALL EXISTING UTILITIES AND RECORD THEM ON THE AS-BUILT DRAWINGS.**

**CONTRACTOR TO VERIFY ALL EXISTING UTILITIES AND RECORD THEM ON THE AS-BUILT DRAWINGS.**

**CONTRACTOR TO VERIFY ALL EXISTING UTILITIES AND RECORD THEM ON THE AS-BUILT DRAWINGS.**

**CONTRACTOR TO VERIFY ALL EXISTING UTILITIES AND RECORD THEM ON THE AS-BUILT DRAWINGS.**

**CONTRACTOR TO VERIFY ALL EXISTING UTILITIES AND RECORD THEM ON THE AS-BUILT DRAWINGS.**



**PROPOSED SANITARY SEWER SYSTEM**  
SCALE: 1" = 40'

**CONTRACTOR TO VERIFY ALL EXISTING UTILITIES AND RECORD THEM ON THE AS-BUILT DRAWINGS.**

**CONTRACTOR TO VERIFY ALL EXISTING UTILITIES AND RECORD THEM ON THE AS-BUILT DRAWINGS.**

**CONTRACTOR TO VERIFY ALL EXISTING UTILITIES AND RECORD THEM ON THE AS-BUILT DRAWINGS.**

**CONTRACTOR TO VERIFY ALL EXISTING UTILITIES AND RECORD THEM ON THE AS-BUILT DRAWINGS.**

**CONTRACTOR TO VERIFY ALL EXISTING UTILITIES AND RECORD THEM ON THE AS-BUILT DRAWINGS.**



**PROPOSED SANITARY SEWER SYSTEM**  
SCALE: 1" = 40'

**CONTRACTOR TO VERIFY ALL EXISTING UTILITIES AND RECORD THEM ON THE AS-BUILT DRAWINGS.**

**CONTRACTOR TO VERIFY ALL EXISTING UTILITIES AND RECORD THEM ON THE AS-BUILT DRAWINGS.**

**CONTRACTOR TO VERIFY ALL EXISTING UTILITIES AND RECORD THEM ON THE AS-BUILT DRAWINGS.**

**CONTRACTOR TO VERIFY ALL EXISTING UTILITIES AND RECORD THEM ON THE AS-BUILT DRAWINGS.**

**CONTRACTOR TO VERIFY ALL EXISTING UTILITIES AND RECORD THEM ON THE AS-BUILT DRAWINGS.**



**PROPOSED SANITARY SEWER SYSTEM**  
SCALE: 1" = 40'

**CONTRACTOR TO VERIFY ALL EXISTING UTILITIES AND RECORD THEM ON THE AS-BUILT DRAWINGS.**

**CONTRACTOR TO VERIFY ALL EXISTING UTILITIES AND RECORD THEM ON THE AS-BUILT DRAWINGS.**

**CONTRACTOR TO VERIFY ALL EXISTING UTILITIES AND RECORD THEM ON THE AS-BUILT DRAWINGS.**

**CONTRACTOR TO VERIFY ALL EXISTING UTILITIES AND RECORD THEM ON THE AS-BUILT DRAWINGS.**

**CONTRACTOR TO VERIFY ALL EXISTING UTILITIES AND RECORD THEM ON THE AS-BUILT DRAWINGS.**

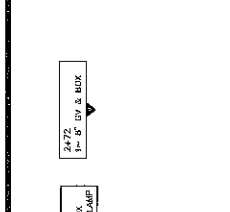

**PROPOSED SANITARY SEWER SYSTEM**  
SCALE: 1" = 40'

**CONTRACTOR TO VERIFY ALL EXISTING UTILITIES AND RECORD THEM ON THE AS-BUILT DRAWINGS.**

**CONTRACTOR TO VERIFY ALL EXISTING UTILITIES AND RECORD THEM ON THE AS-BUILT DRAWINGS.**

**CONTRACTOR TO VERIFY ALL EXISTING UTILITIES AND RECORD THEM ON THE AS-BUILT DRAWINGS.**

**CONTRACTOR TO VERIFY ALL EXISTING UTILITIES AND RECORD THEM ON THE AS-BUILT DRAWINGS.**

**CONTRACTOR TO VERIFY ALL EXISTING UTILITIES AND RECORD THEM ON THE AS-BUILT DRAWINGS.**

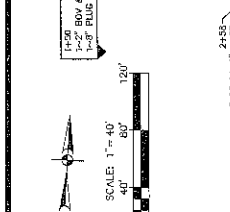

**PROPOSED SANITARY SEWER SYSTEM**  
SCALE: 1" = 40'

**CONTRACTOR TO VERIFY ALL EXISTING UTILITIES AND RECORD THEM ON THE AS-BUILT DRAWINGS.**

**CONTRACTOR TO VERIFY ALL EXISTING UTILITIES AND RECORD THEM ON THE AS-BUILT DRAWINGS.**

**CONTRACTOR TO VERIFY ALL EXISTING UTILITIES AND RECORD THEM ON THE AS-BUILT DRAWINGS.**

**CONTRACTOR TO VERIFY ALL EXISTING UTILITIES AND RECORD THEM ON THE AS-BUILT DRAWINGS.**

**CONTRACTOR TO VERIFY ALL EXISTING UTILITIES AND RECORD THEM ON THE AS-BUILT DRAWINGS.**



**PROPOSED SANITARY SEWER SYSTEM**  
SCALE: 1" = 40'

**CONTRACTOR TO VERIFY ALL EXISTING UTILITIES AND RECORD THEM ON THE AS-BUILT DRAWINGS.**

**CONTRACTOR TO VERIFY ALL EXISTING UTILITIES AND RECORD THEM ON THE AS-BUILT DRAWINGS.**

**CONTRACTOR TO VERIFY ALL EXISTING UTILITIES AND RECORD THEM ON THE AS-BUILT DRAWINGS.**

**CONTRACTOR TO VERIFY ALL EXISTING UTILITIES AND RECORD THEM ON THE AS-BUILT DRAWINGS.**

**CONTRACTOR TO VERIFY ALL EXISTING UTILITIES AND RECORD THEM ON THE AS-BUILT DRAWINGS.**

Station	Structure	Notes
98	Manhole	Proposed
94	Manhole	Proposed
90	Manhole	Proposed
86	Manhole	Proposed
82	Manhole	Proposed
78	Manhole	Proposed
74	Manhole	Proposed
70	Manhole	Proposed
66	Manhole	Proposed
62	Manhole	Proposed

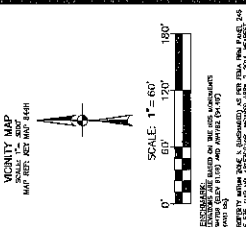
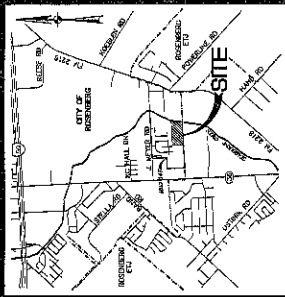

**PAPE-DAWSON ENGINEERS**  
 1233 WINDING AVENUE, SUITE 200, SEABOURNE, TEXAS 77657  
 P. 409.283.1100 FAX 409.283.1101  
 WWW.PAPE-DAWSON.COM

PROJECT NO. 2014051923  
 SECTION THREE  
 CITY OF SEABOURNE, TEXAS

**STORM WATER POLLUTION PREVENTION PLAN**  
 THE TRAILS AT SEABOURNE PARKE SECTION THREE

**CITY OF ROSEMBERG**  
 DEPARTMENT OF PUBLIC WORKS AND ENGINEERING

PROJECT NO. 2014051923  
 SHEET NO. 18 OF 27

- LEGEND**
- PLAT BOUNDARY
  - EXISTING CONTOUR
  - PROPOSED PAVEMENT / PAVING CURB
  - EXISTING/TYPICAL PAVEMENT
  - DUMP VALET
  - RESTRICTED RESERVE
  - BLACK MARKER
  - CONTRACTOR TO ESTABLISH VEGETATION WITHIN BACK OF LOT
  - RESTRICTED RESERVE
  - CONCRETE TRUCK RESTROOM AREA

- CONTRACTOR IS RESPONSIBLE FOR COORDINATING WITH ALL APPLICABLE JURISDICTIONAL AGENCIES.
- CONTRACTOR IS RESPONSIBLE FOR PROVIDING ADEQUATELY TRAINED PERSONNEL TO CONDUCT ALL WORK.
- CONTRACTOR SHALL BE RESPONSIBLE FOR OBTAINING ALL NECESSARY PERMITS AND APPROVALS FROM ALL APPLICABLE AGENCIES.
- CONTRACTOR SHALL BE RESPONSIBLE FOR OBTAINING ALL NECESSARY PERMITS AND APPROVALS FROM ALL APPLICABLE AGENCIES.
- CONTRACTOR SHALL BE RESPONSIBLE FOR OBTAINING ALL NECESSARY PERMITS AND APPROVALS FROM ALL APPLICABLE AGENCIES.
- CONTRACTOR SHALL BE RESPONSIBLE FOR OBTAINING ALL NECESSARY PERMITS AND APPROVALS FROM ALL APPLICABLE AGENCIES.
- CONTRACTOR SHALL BE RESPONSIBLE FOR OBTAINING ALL NECESSARY PERMITS AND APPROVALS FROM ALL APPLICABLE AGENCIES.
- CONTRACTOR SHALL BE RESPONSIBLE FOR OBTAINING ALL NECESSARY PERMITS AND APPROVALS FROM ALL APPLICABLE AGENCIES.
- CONTRACTOR SHALL BE RESPONSIBLE FOR OBTAINING ALL NECESSARY PERMITS AND APPROVALS FROM ALL APPLICABLE AGENCIES.
- CONTRACTOR SHALL BE RESPONSIBLE FOR OBTAINING ALL NECESSARY PERMITS AND APPROVALS FROM ALL APPLICABLE AGENCIES.

- STORM WATER POLLUTION PREVENTION NOTES**
- CONTRACTOR SHALL BE RESPONSIBLE FOR OBTAINING ALL NECESSARY PERMITS AND APPROVALS FROM ALL APPLICABLE AGENCIES.
  - CONTRACTOR SHALL BE RESPONSIBLE FOR OBTAINING ALL NECESSARY PERMITS AND APPROVALS FROM ALL APPLICABLE AGENCIES.
  - CONTRACTOR SHALL BE RESPONSIBLE FOR OBTAINING ALL NECESSARY PERMITS AND APPROVALS FROM ALL APPLICABLE AGENCIES.
  - CONTRACTOR SHALL BE RESPONSIBLE FOR OBTAINING ALL NECESSARY PERMITS AND APPROVALS FROM ALL APPLICABLE AGENCIES.
  - CONTRACTOR SHALL BE RESPONSIBLE FOR OBTAINING ALL NECESSARY PERMITS AND APPROVALS FROM ALL APPLICABLE AGENCIES.
  - CONTRACTOR SHALL BE RESPONSIBLE FOR OBTAINING ALL NECESSARY PERMITS AND APPROVALS FROM ALL APPLICABLE AGENCIES.
  - CONTRACTOR SHALL BE RESPONSIBLE FOR OBTAINING ALL NECESSARY PERMITS AND APPROVALS FROM ALL APPLICABLE AGENCIES.
  - CONTRACTOR SHALL BE RESPONSIBLE FOR OBTAINING ALL NECESSARY PERMITS AND APPROVALS FROM ALL APPLICABLE AGENCIES.
  - CONTRACTOR SHALL BE RESPONSIBLE FOR OBTAINING ALL NECESSARY PERMITS AND APPROVALS FROM ALL APPLICABLE AGENCIES.
  - CONTRACTOR SHALL BE RESPONSIBLE FOR OBTAINING ALL NECESSARY PERMITS AND APPROVALS FROM ALL APPLICABLE AGENCIES.

- CONTRACTOR SHALL BE RESPONSIBLE FOR OBTAINING ALL NECESSARY PERMITS AND APPROVALS FROM ALL APPLICABLE AGENCIES.
- CONTRACTOR SHALL BE RESPONSIBLE FOR OBTAINING ALL NECESSARY PERMITS AND APPROVALS FROM ALL APPLICABLE AGENCIES.
- CONTRACTOR SHALL BE RESPONSIBLE FOR OBTAINING ALL NECESSARY PERMITS AND APPROVALS FROM ALL APPLICABLE AGENCIES.
- CONTRACTOR SHALL BE RESPONSIBLE FOR OBTAINING ALL NECESSARY PERMITS AND APPROVALS FROM ALL APPLICABLE AGENCIES.
- CONTRACTOR SHALL BE RESPONSIBLE FOR OBTAINING ALL NECESSARY PERMITS AND APPROVALS FROM ALL APPLICABLE AGENCIES.
- CONTRACTOR SHALL BE RESPONSIBLE FOR OBTAINING ALL NECESSARY PERMITS AND APPROVALS FROM ALL APPLICABLE AGENCIES.
- CONTRACTOR SHALL BE RESPONSIBLE FOR OBTAINING ALL NECESSARY PERMITS AND APPROVALS FROM ALL APPLICABLE AGENCIES.
- CONTRACTOR SHALL BE RESPONSIBLE FOR OBTAINING ALL NECESSARY PERMITS AND APPROVALS FROM ALL APPLICABLE AGENCIES.
- CONTRACTOR SHALL BE RESPONSIBLE FOR OBTAINING ALL NECESSARY PERMITS AND APPROVALS FROM ALL APPLICABLE AGENCIES.
- CONTRACTOR SHALL BE RESPONSIBLE FOR OBTAINING ALL NECESSARY PERMITS AND APPROVALS FROM ALL APPLICABLE AGENCIES.

- CONTRACTOR SHALL BE RESPONSIBLE FOR OBTAINING ALL NECESSARY PERMITS AND APPROVALS FROM ALL APPLICABLE AGENCIES.
- CONTRACTOR SHALL BE RESPONSIBLE FOR OBTAINING ALL NECESSARY PERMITS AND APPROVALS FROM ALL APPLICABLE AGENCIES.
- CONTRACTOR SHALL BE RESPONSIBLE FOR OBTAINING ALL NECESSARY PERMITS AND APPROVALS FROM ALL APPLICABLE AGENCIES.
- CONTRACTOR SHALL BE RESPONSIBLE FOR OBTAINING ALL NECESSARY PERMITS AND APPROVALS FROM ALL APPLICABLE AGENCIES.
- CONTRACTOR SHALL BE RESPONSIBLE FOR OBTAINING ALL NECESSARY PERMITS AND APPROVALS FROM ALL APPLICABLE AGENCIES.
- CONTRACTOR SHALL BE RESPONSIBLE FOR OBTAINING ALL NECESSARY PERMITS AND APPROVALS FROM ALL APPLICABLE AGENCIES.
- CONTRACTOR SHALL BE RESPONSIBLE FOR OBTAINING ALL NECESSARY PERMITS AND APPROVALS FROM ALL APPLICABLE AGENCIES.
- CONTRACTOR SHALL BE RESPONSIBLE FOR OBTAINING ALL NECESSARY PERMITS AND APPROVALS FROM ALL APPLICABLE AGENCIES.
- CONTRACTOR SHALL BE RESPONSIBLE FOR OBTAINING ALL NECESSARY PERMITS AND APPROVALS FROM ALL APPLICABLE AGENCIES.
- CONTRACTOR SHALL BE RESPONSIBLE FOR OBTAINING ALL NECESSARY PERMITS AND APPROVALS FROM ALL APPLICABLE AGENCIES.

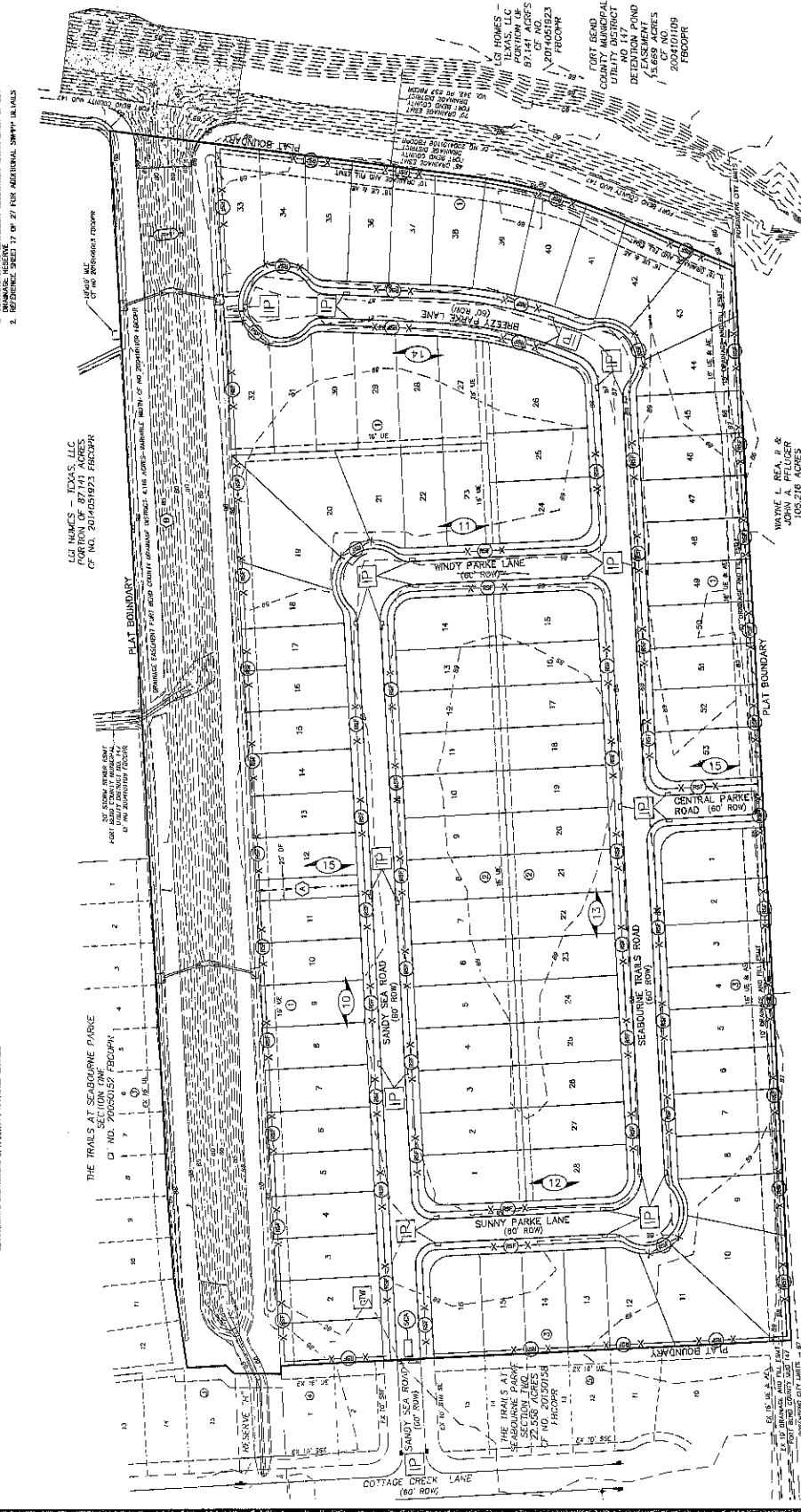

WAYNE L. REA, II & JOHN A. FLEUSER  
 CF NO. 2008069574  
 FRODOFF

FRIGOROSE ANKZAK  
 51.76 ACRES  
 CF NO. 1979631304  
 FRODOFF

**NOTES:**

1. ALL DIMENSIONS ARE IN FEET UNLESS OTHERWISE NOTED.
2. ALL DIMENSIONS ARE TO FACE UNLESS OTHERWISE NOTED.
3. ALL DIMENSIONS ARE TO CENTER UNLESS OTHERWISE NOTED.
4. ALL DIMENSIONS ARE TO SURFACE UNLESS OTHERWISE NOTED.
5. ALL DIMENSIONS ARE TO CENTER UNLESS OTHERWISE NOTED.
6. ALL DIMENSIONS ARE TO SURFACE UNLESS OTHERWISE NOTED.
7. ALL DIMENSIONS ARE TO CENTER UNLESS OTHERWISE NOTED.
8. ALL DIMENSIONS ARE TO SURFACE UNLESS OTHERWISE NOTED.
9. ALL DIMENSIONS ARE TO CENTER UNLESS OTHERWISE NOTED.
10. ALL DIMENSIONS ARE TO SURFACE UNLESS OTHERWISE NOTED.

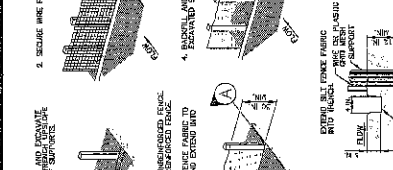
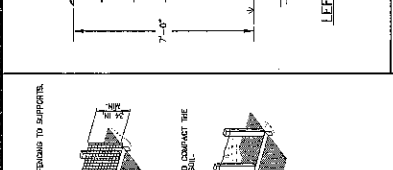
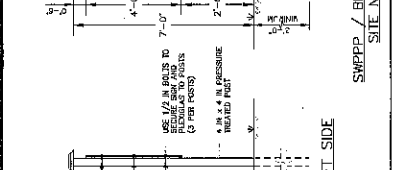
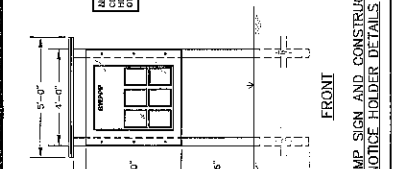
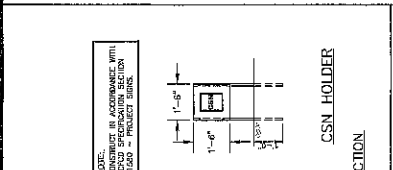
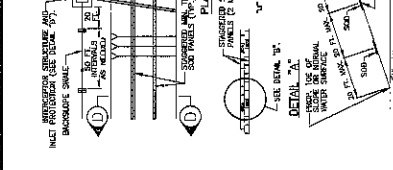
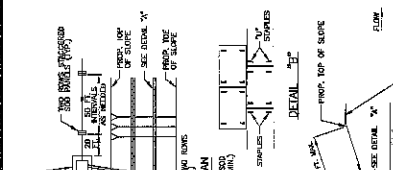
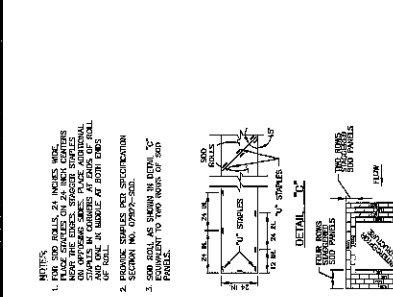

**CONCRETE TRUCK WASHOUT AREA**

CONSTRUCTION NOTES:

1. SEE SPECIFICATION SECTION NO. 02800 - STABILIZED CONSTRUCTION ACCESS.
2. SEE SPECIFICATION SECTION NO. 03100 - SILT FENCE.
3. SEE SPECIFICATION SECTION NO. 03200 - SODDING.
4. SEE SPECIFICATION SECTION NO. 03300 - INTERCEPTION STRUCTURE.
5. SEE SPECIFICATION SECTION NO. 03400 - SLOPE PROTECTION.
6. SEE SPECIFICATION SECTION NO. 03500 - SLOPE STABILIZATION.
7. SEE SPECIFICATION SECTION NO. 03600 - SLOPE REPAIR.
8. SEE SPECIFICATION SECTION NO. 03700 - SLOPE EROSION CONTROL.
9. SEE SPECIFICATION SECTION NO. 03800 - SLOPE PROTECTION.
10. SEE SPECIFICATION SECTION NO. 03900 - SLOPE STABILIZATION.

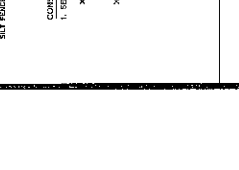
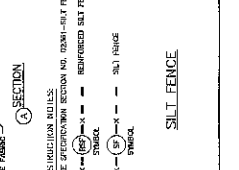
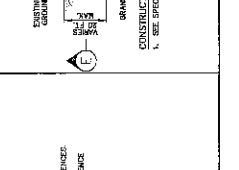
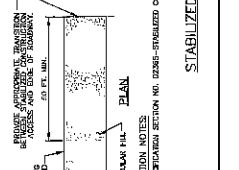
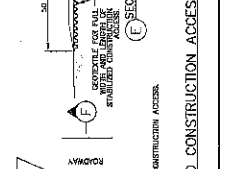
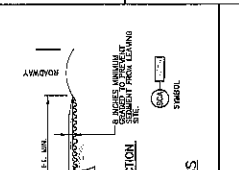
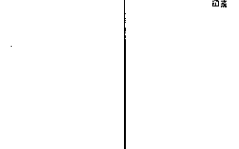
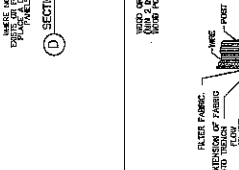
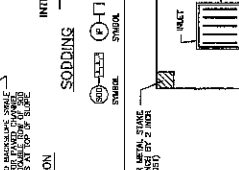
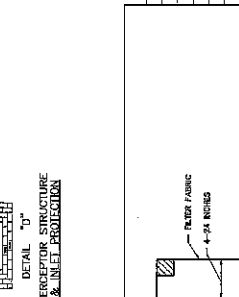

**ELDER DAM**

CONSTRUCTION NOTES:

1. SEE SPECIFICATION SECTION NO. 02800 - STABILIZED CONSTRUCTION ACCESS.
2. SEE SPECIFICATION SECTION NO. 03100 - SILT FENCE.
3. SEE SPECIFICATION SECTION NO. 03200 - SODDING.
4. SEE SPECIFICATION SECTION NO. 03300 - INTERCEPTION STRUCTURE.
5. SEE SPECIFICATION SECTION NO. 03400 - SLOPE PROTECTION.
6. SEE SPECIFICATION SECTION NO. 03500 - SLOPE STABILIZATION.
7. SEE SPECIFICATION SECTION NO. 03600 - SLOPE REPAIR.
8. SEE SPECIFICATION SECTION NO. 03700 - SLOPE EROSION CONTROL.
9. SEE SPECIFICATION SECTION NO. 03800 - SLOPE PROTECTION.
10. SEE SPECIFICATION SECTION NO. 03900 - SLOPE STABILIZATION.

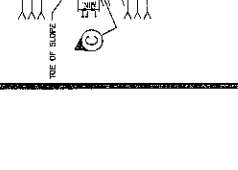
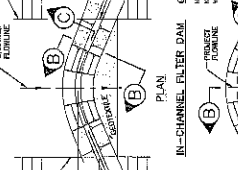
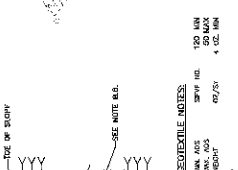
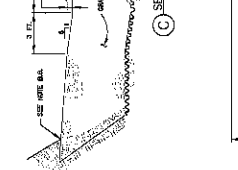
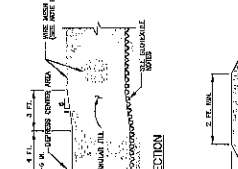
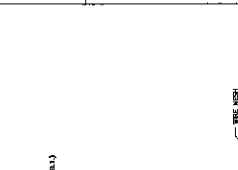
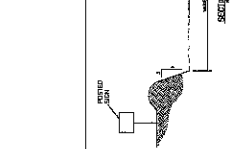
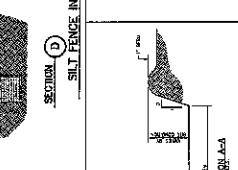
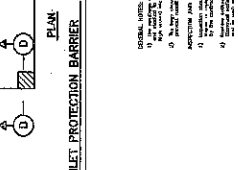
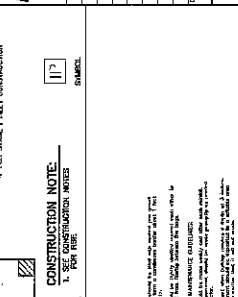

**ELDER DAM**

CONSTRUCTION NOTES:

1. SEE SPECIFICATION SECTION NO. 02800 - STABILIZED CONSTRUCTION ACCESS.
2. SEE SPECIFICATION SECTION NO. 03100 - SILT FENCE.
3. SEE SPECIFICATION SECTION NO. 03200 - SODDING.
4. SEE SPECIFICATION SECTION NO. 03300 - INTERCEPTION STRUCTURE.
5. SEE SPECIFICATION SECTION NO. 03400 - SLOPE PROTECTION.
6. SEE SPECIFICATION SECTION NO. 03500 - SLOPE STABILIZATION.
7. SEE SPECIFICATION SECTION NO. 03600 - SLOPE REPAIR.
8. SEE SPECIFICATION SECTION NO. 03700 - SLOPE EROSION CONTROL.
9. SEE SPECIFICATION SECTION NO. 03800 - SLOPE PROTECTION.
10. SEE SPECIFICATION SECTION NO. 03900 - SLOPE STABILIZATION.

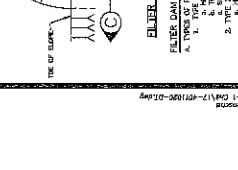
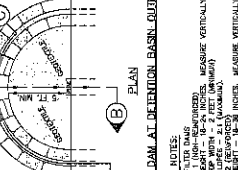
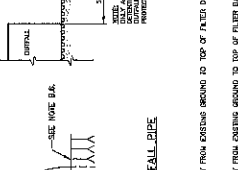
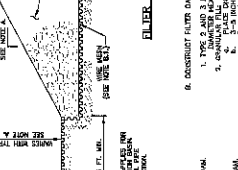
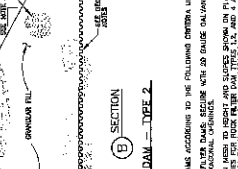
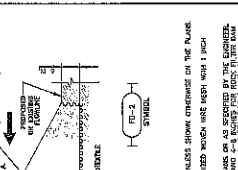
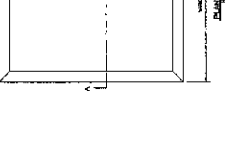
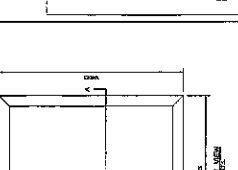
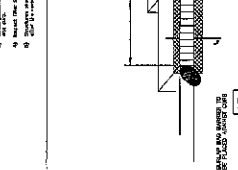
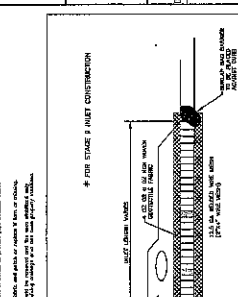

**PEPE-DAWSON ENGINEERS**

REGISTERED PROFESSIONAL ENGINEERS

STATE OF MISSISSIPPI

NO. 12345

DATE: 10/15/2024

PROJECT: STORM WATER POLLUTION PREVENTION PLAN

SECTION THREE

CITY OF ROSENBERG

DEPARTMENT OF PUBLIC WORKS AND ENGINEERING

17 of 27

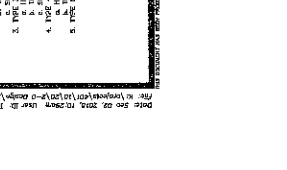
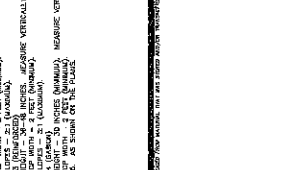
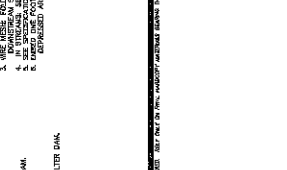
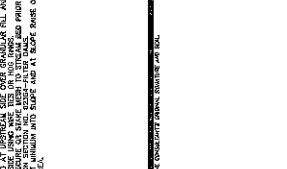
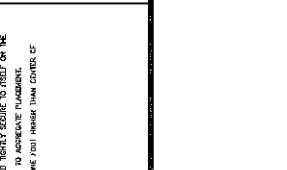
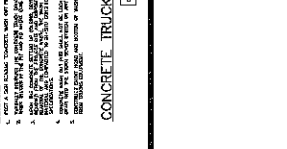
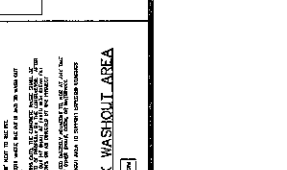
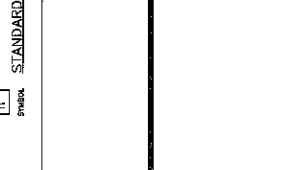
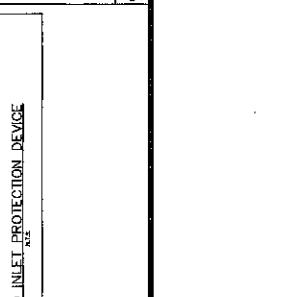

**PAPE-DAWSON ENGINEERS**

1100 ROSS AVENUE, SUITE 600, HOUSTON, TEXAS 77006  
 77006 HOUSTON, TEXAS  
 PHONE: 770-621-1100  
 TELETYPE: 770-621-1100  
 CABLE: PDAE

PROJECT NO. \_\_\_\_\_

DATE \_\_\_\_\_

ISSUE DESCRIPTION \_\_\_\_\_

BY \_\_\_\_\_

CHECKED BY \_\_\_\_\_

APPROVED BY \_\_\_\_\_

DATE \_\_\_\_\_

SCALE \_\_\_\_\_

PROJECT \_\_\_\_\_

CITY OF HOUSTON, TEXAS

**THE TRAILS AT SEABOURNE PARKE**

**SECTION THREE**

**STORM SEWER DETAILS**

**(SHEET 1 OF 2)**

**CITY OF ROSENBERG**

DEPARTMENT OF PUBLIC WORKS AND ENGINEERING

DRIVING SCALE \_\_\_\_\_

SCALE \_\_\_\_\_

SHEET NO. \_\_\_\_\_

18 OF 27

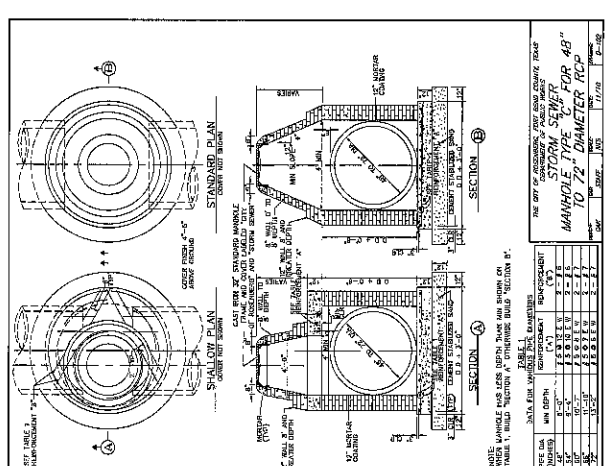
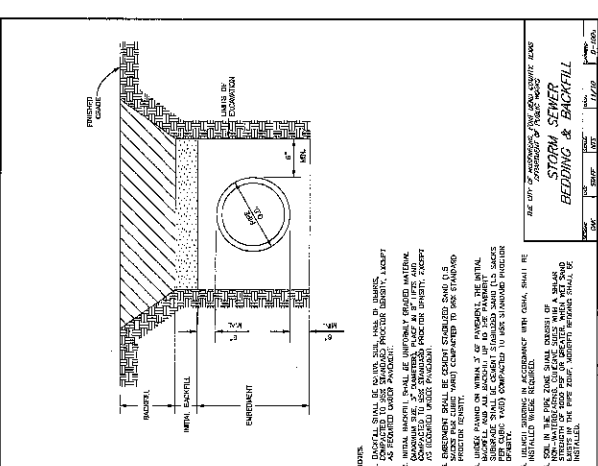
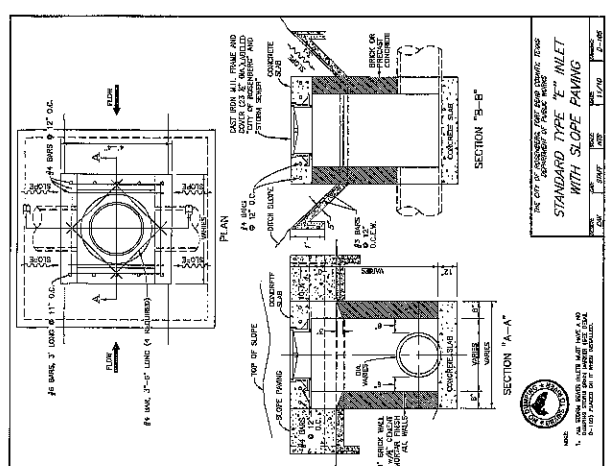
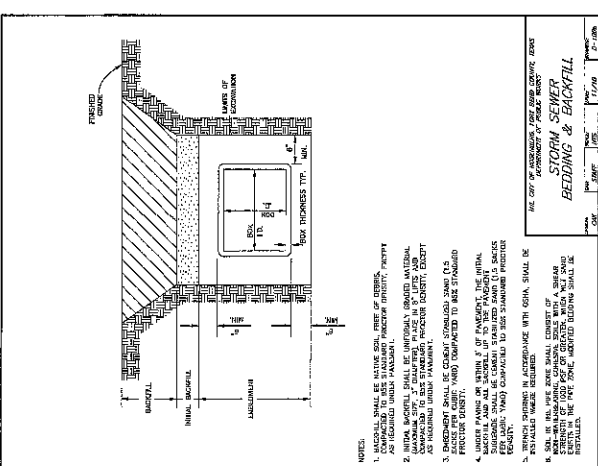
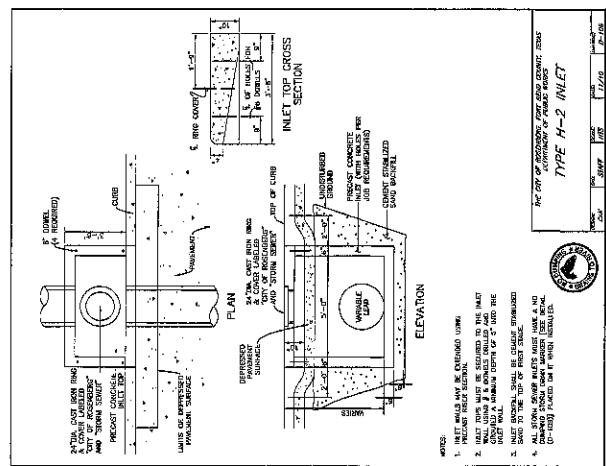
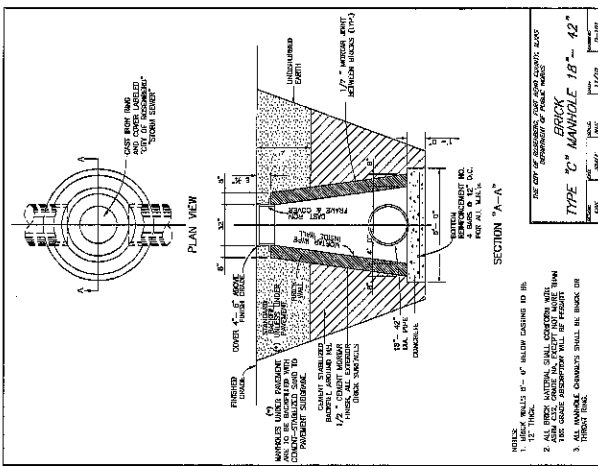

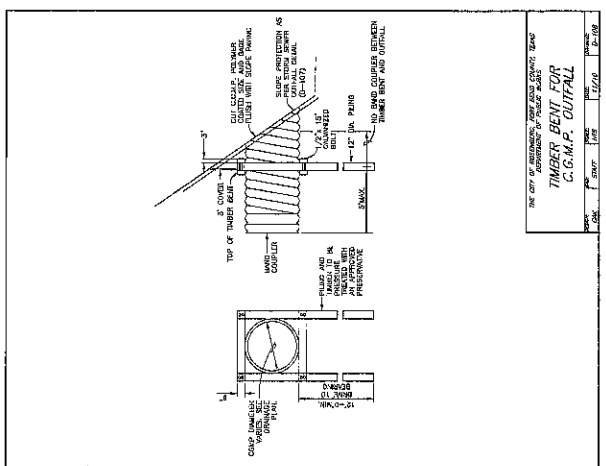
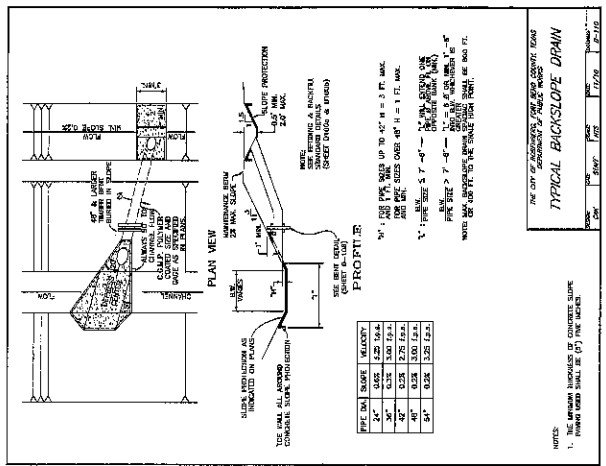
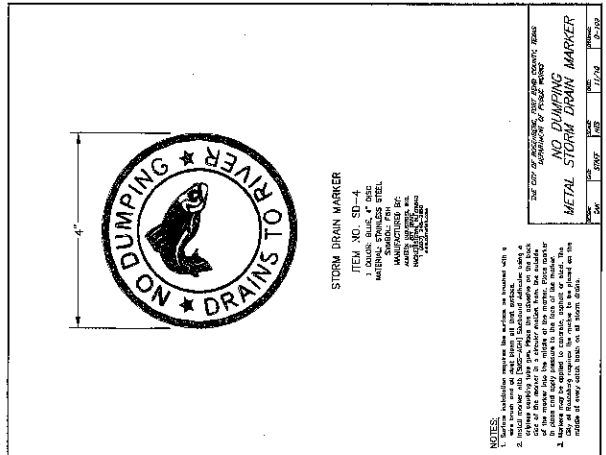
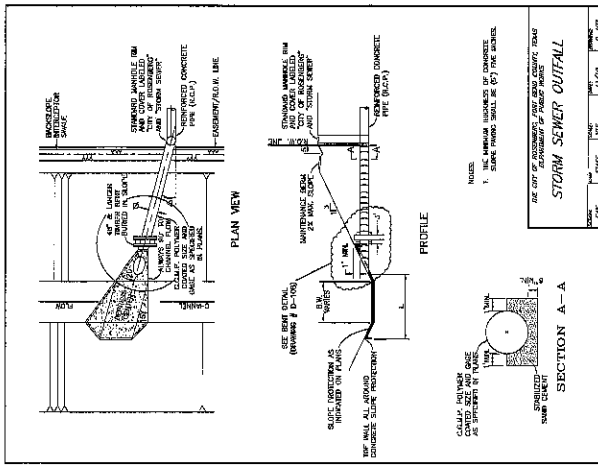
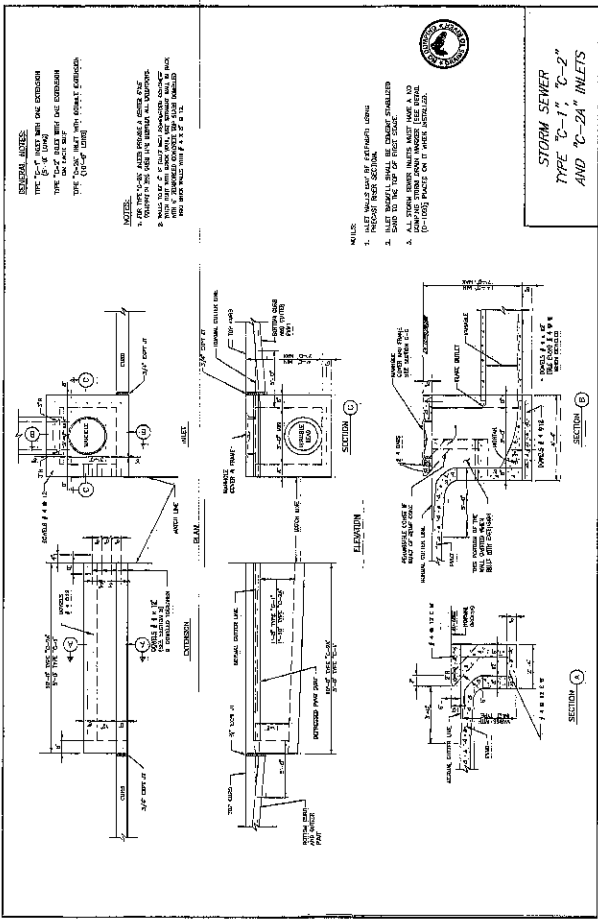

**PAPE-DAWSON ENGINEERS**

1000 S. GARDNER AVE., SUITE 200, DENVER, COLORADO 80210  
 303.733.1111  
 WWW.PAPE-DAWSON.COM

**CITY OF ROSENBERG**  
 DEPARTMENT OF PUBLIC WORKS AND ENGINEERING

**STORM SEWER DETAILS**  
 (SHEET 2 OF 2)

**THE TRAILS AT SEABOURNE PARKE SECTION THREE**  
 CITY OF ROSENBERG, TEXAS

NO. DATE REVISION

DATE ENGINE DESCRIPTION

DESIGNED BY: TRAVIS L. LEE  
 CHECKED BY: TRAVIS L. LEE  
 APPROVED BY: TRAVIS L. LEE

DATE: 11/16/17

SCALE: AS SHOWN

PROJECT NO.: 17-001

DATE: 11/16/17

SCALE: AS SHOWN

PROJECT NO.: 17-001

DATE: 11/16/17

SCALE: AS SHOWN

PROJECT NO.: 17-001

**PAPE-DAWSON ENGINEERS**  
 1001 W. WILSON ST. DALLAS, TEXAS 75202  
 P. TEL: 754-1234 F. TEL: 754-5678  
 20% PLAN REVISIONS 7-10

**CITY OF ROSENBERG**  
 DEPARTMENT OF PUBLIC WORKS AND ENGINEERING

**THE TRAILS AT SEABOURNE PARKE SECTION THREE**  
 CITY OF ROSENBERG, TEXAS

**SANITARY SEWER DETAILS (SHEET 1 OF 1)**

DATE: 11/15/10  
 DRAWN BY: J.E.  
 CHECKED BY: J.E.  
 PROJECT NO.: 11111111  
 SHEET NO.: 20 OF 27

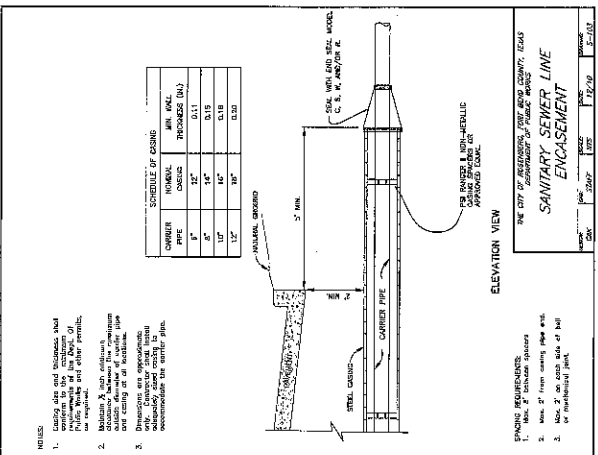
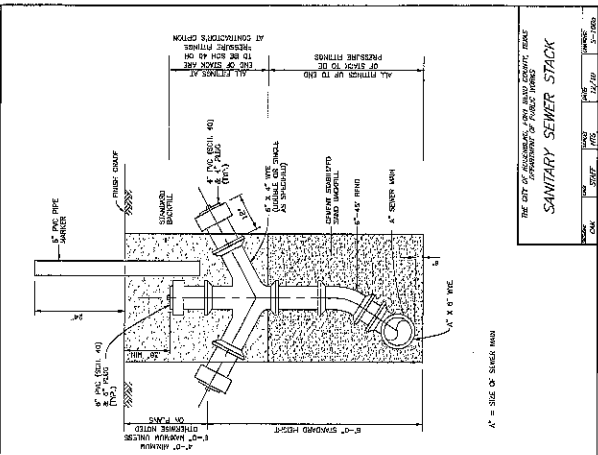
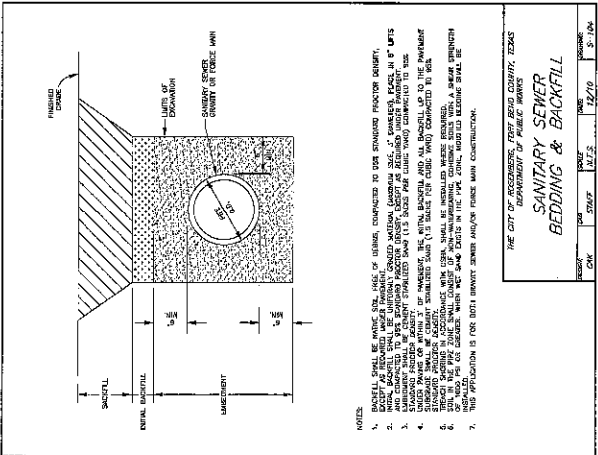
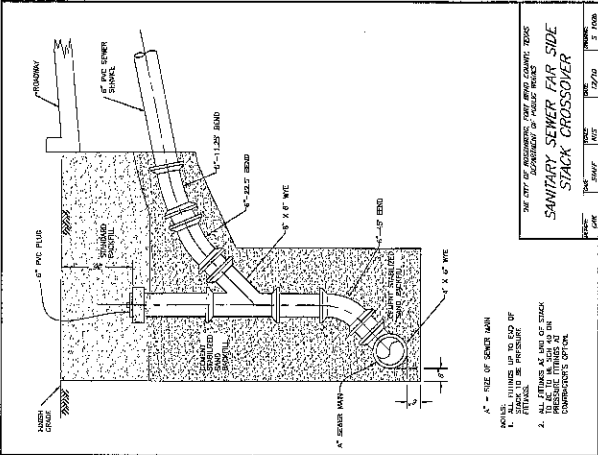
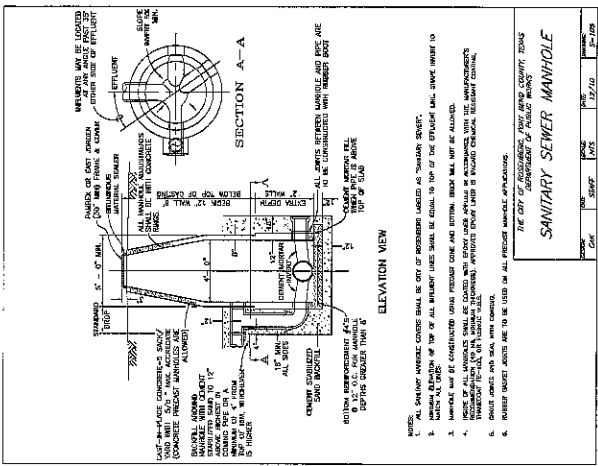
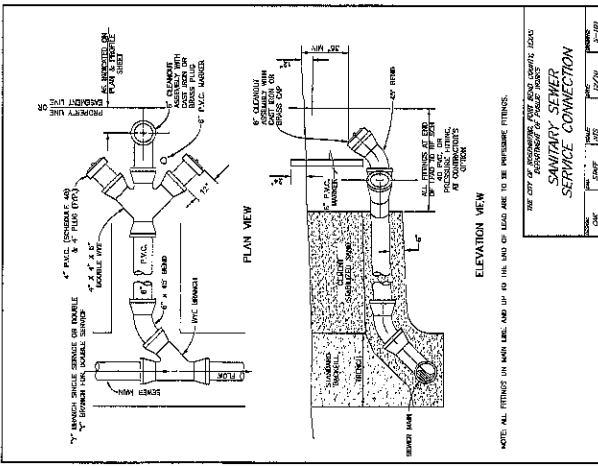

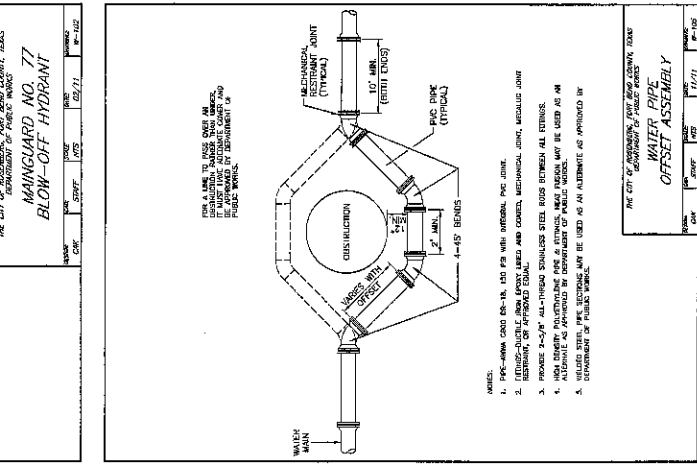
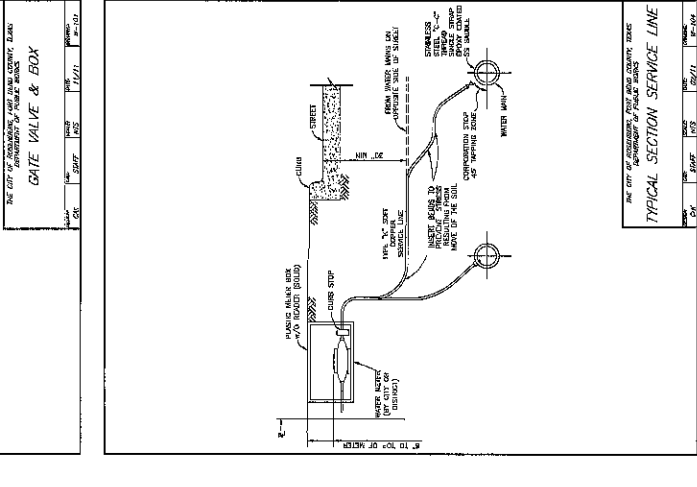
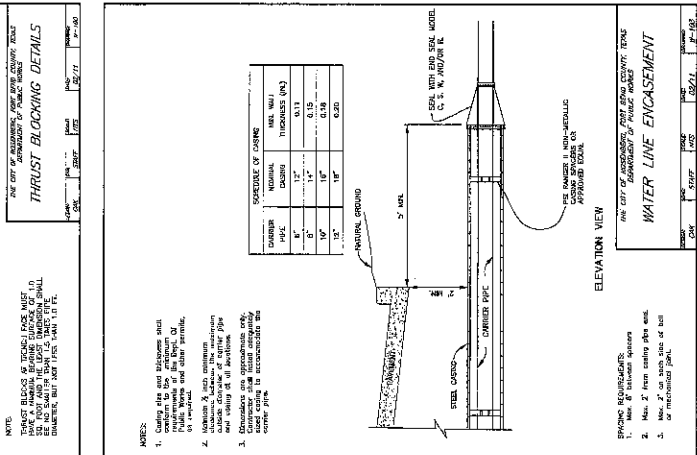
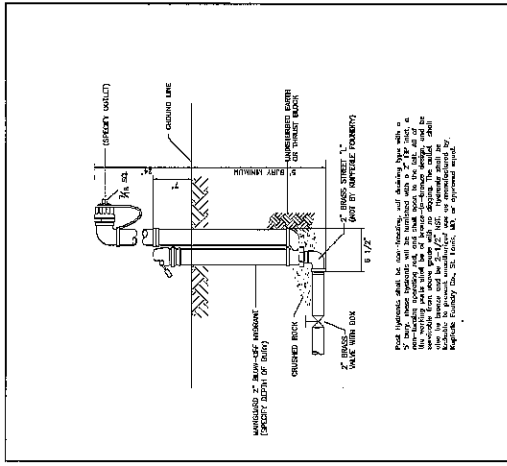
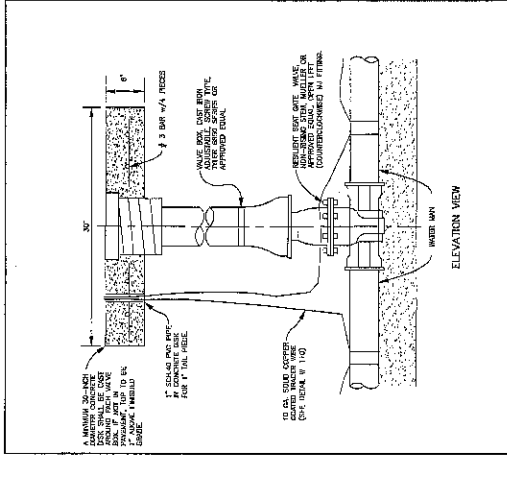
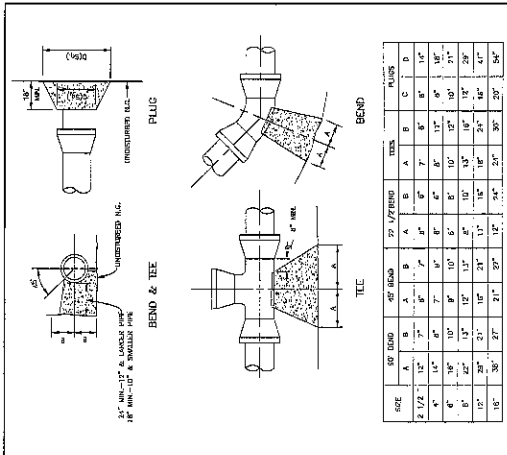

**PAPE-DAWSON ENGINEERS**  
 148 MAIN ST., SUITE 100  
 NEW YORK, N.Y. 10038  
 TEL: (212) 512-1111  
 FAX: (212) 512-1112

**CITY OF ROSENBERG**  
 DEPARTMENT OF PUBLIC WORKS AND ENGINEERING

**THE TRAILS AT SEABOURNE PARKE SECTION THREE**  
 CITY OF ROSENBERG, TEXAS

**WATER LINE DETAILS (SHEET 1 OF 2)**

**DATE:** 05/27/11  
**BY:** [Signature]  
**CHECKED:** [Signature]  
**APPROVED:** [Signature]

**SCALE:** 1" = 10'-0"

**SHEET NO. 21 OF 27**



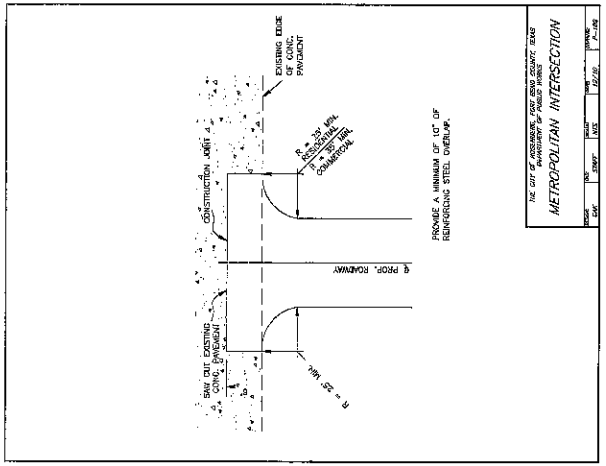
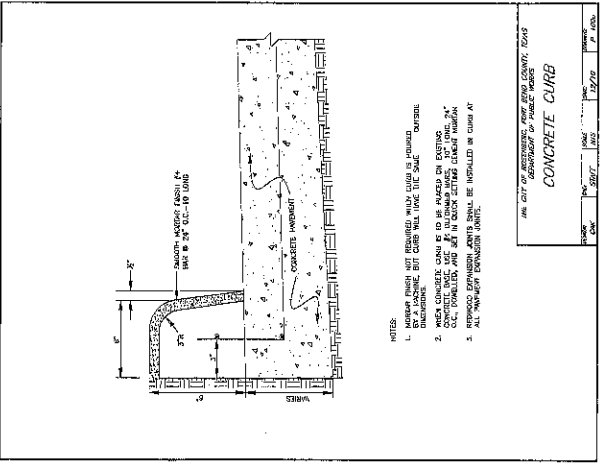
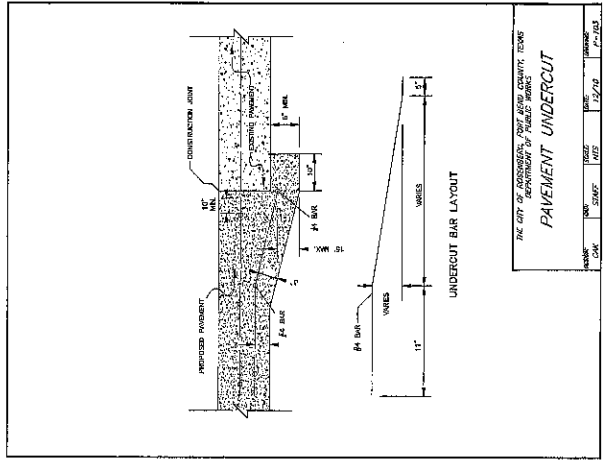
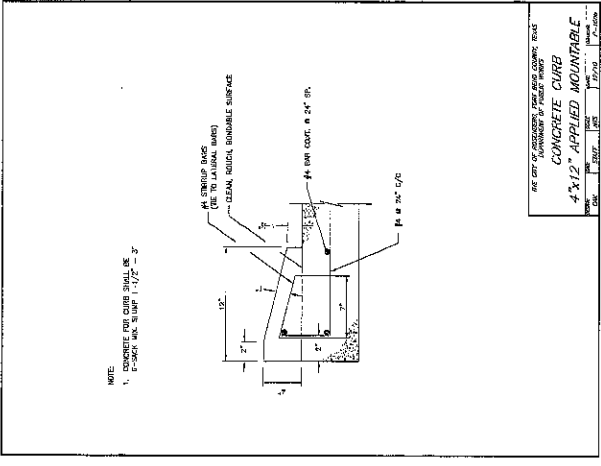
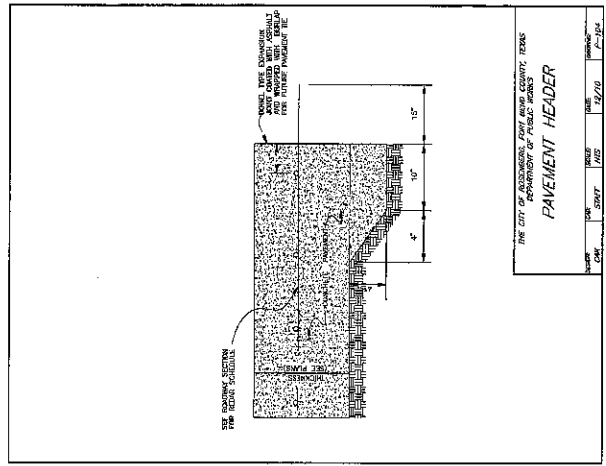
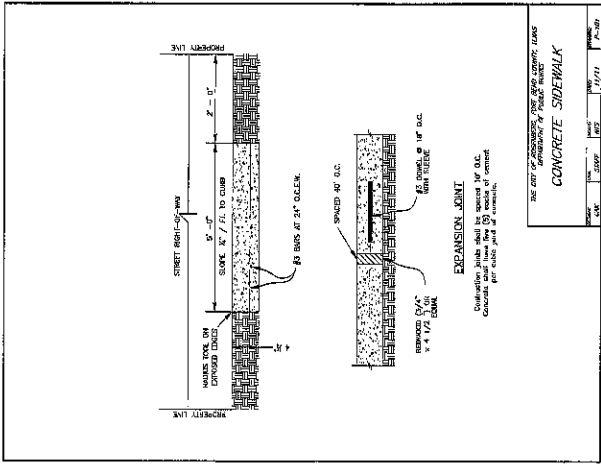

NO GUARANTEE IS MADE BY THE ENGINEER AS TO THE ACCURACY OF THE INFORMATION FURNISHED HEREON. THE ENGINEER'S RESPONSIBILITY IS LIMITED TO THE DESIGN AND CONSTRUCTION OF THE STRUCTURES SHOWN, PROVIDED AND AS SHOWN.

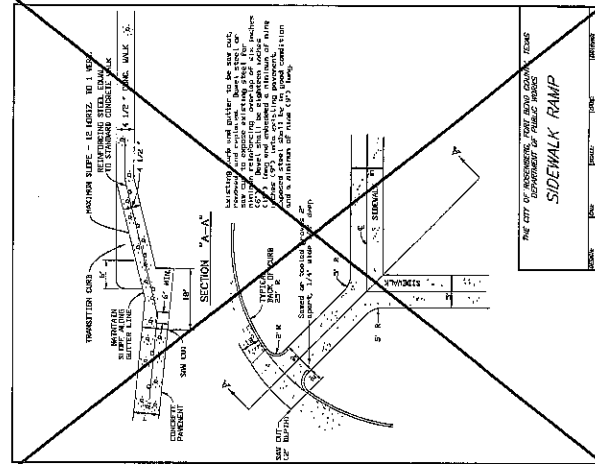
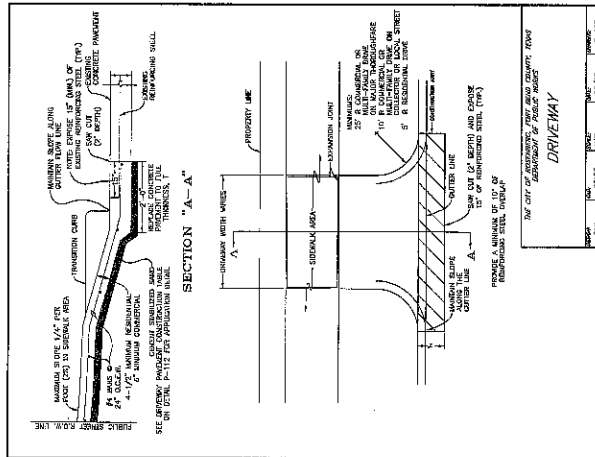
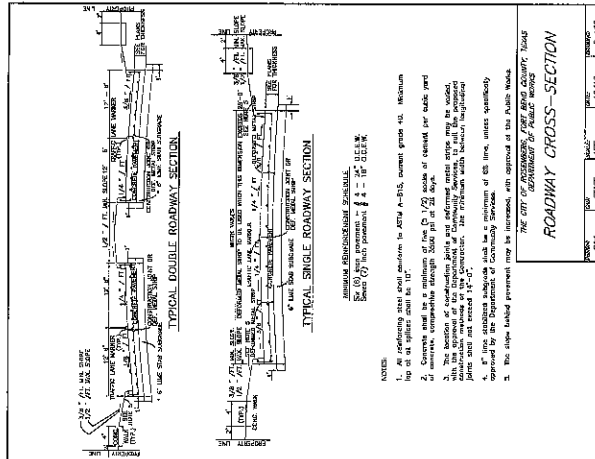
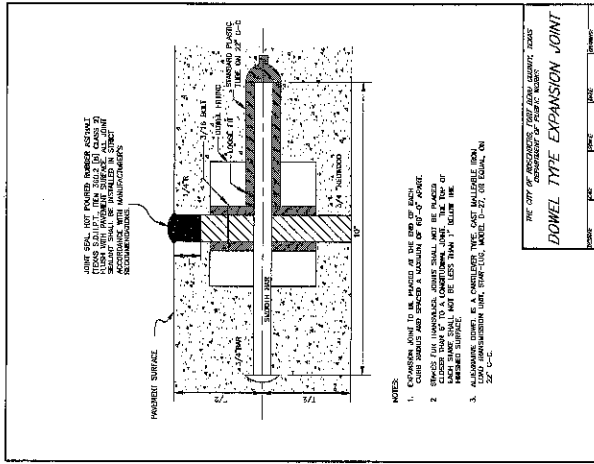
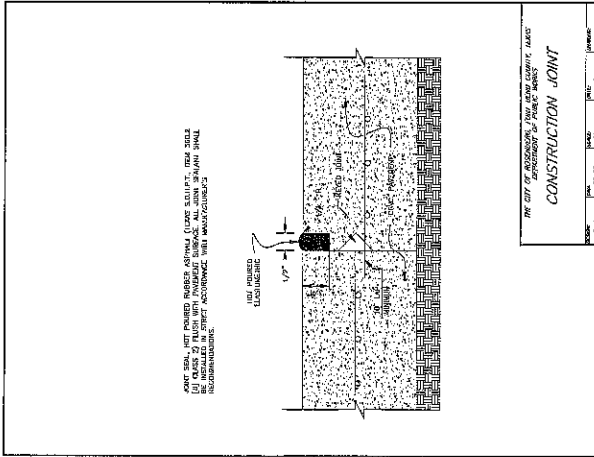
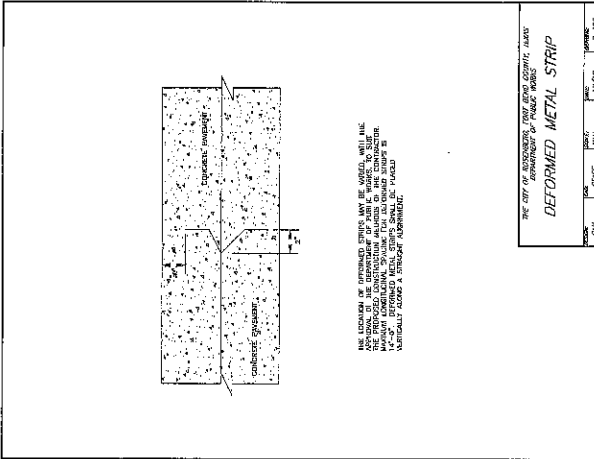

NO. DATE REVISION

**PAPE-DAWSON ENGINEERS**  
1505 WESTHELM AVE. SUITE 300 HOUSTON, TEXAS 77042  
P.O. BOX 1000 HOUSTON, TEXAS 77255

DATE: 11/11/11  
ENGINE DESCRIPTION: PAVING DETAILS

PROJECT: THE TRAILS AT SEABOURNE PARKE SECTION THREE CITY OF HOUSTON, TEXAS

DESIGNED BY: TH  
CHECKED BY: TH  
APPROVED BY: [Signature]

THE CITY OF HOUSTON, TEXAS  
DEPARTMENT OF PUBLIC WORKS AND ENGINEERING

DESIGNED SCALE: AS SHOWN  
SHEET NO. 24 OF 27



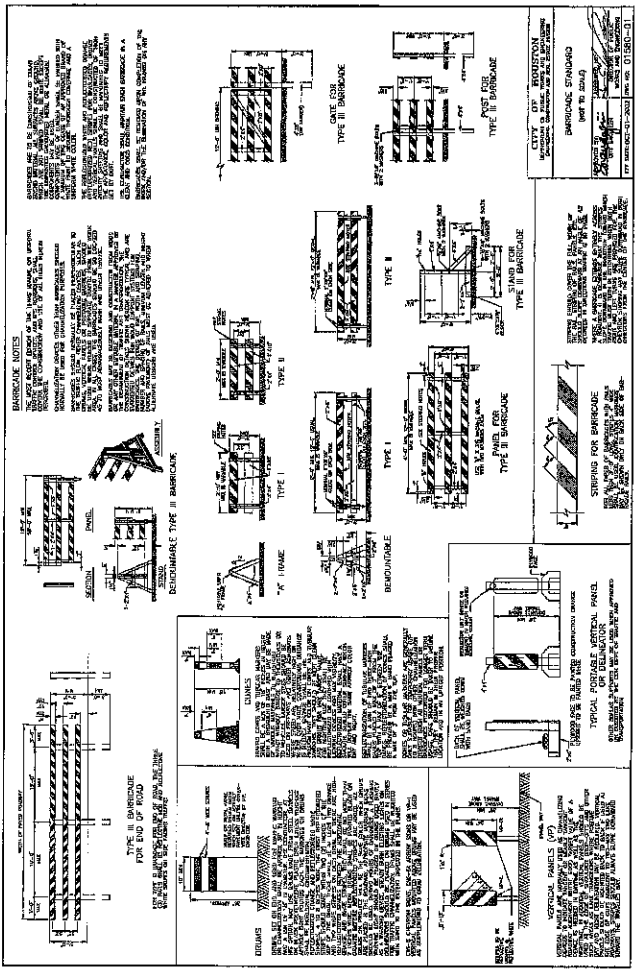
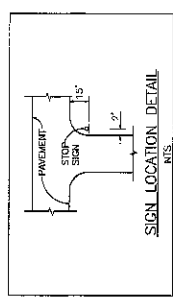
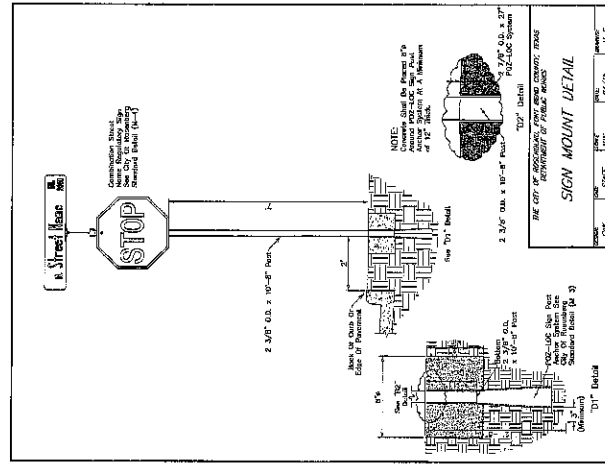
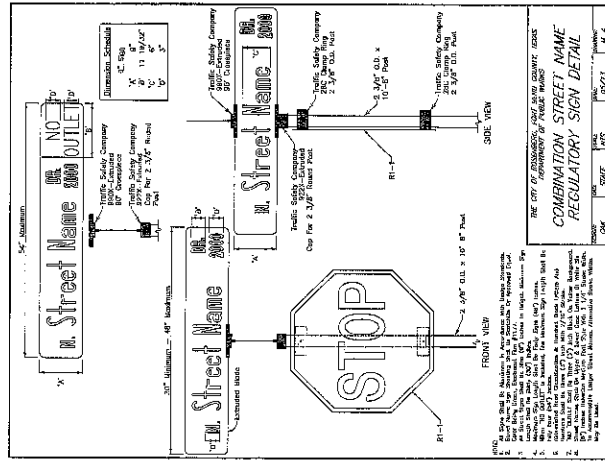
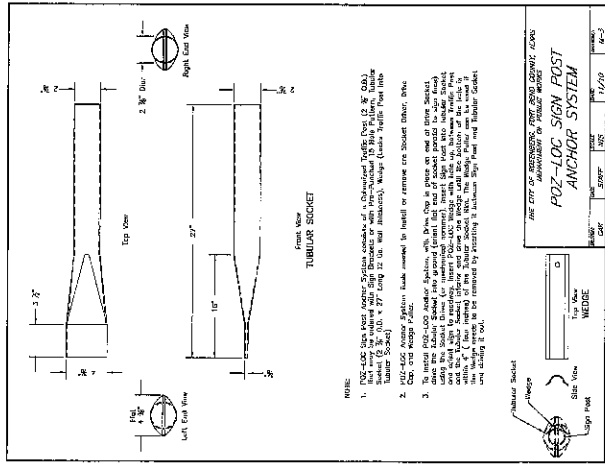

**PAPE-DAWSON ENGINEERS**

10101 W. 10th Street, Suite 100  
 Fort Worth, Texas 76132  
 Phone: (817) 336-1111  
 Fax: (817) 336-1112  
 Website: www.pape-dawson.com

**CITY OF ROSENBERG**  
 DEPARTMENT OF PUBLIC WORKS AND ENGINEERING

**THE TRAILS AT SEABOURNE PARK**  
 SECTION THREE

**MISCELLANEOUS DETAILS**  
 (SHEET 1 OF 2)

DATE: 11/20/03  
 DRAWN BY: [Name]  
 CHECKED BY: [Name]

**CONTRACT SCALE**  
 1" = 10'-0"

**SHEET NO.**  
 26 OF 27

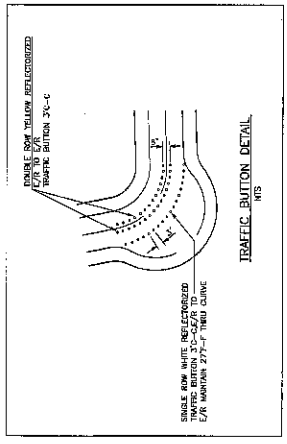
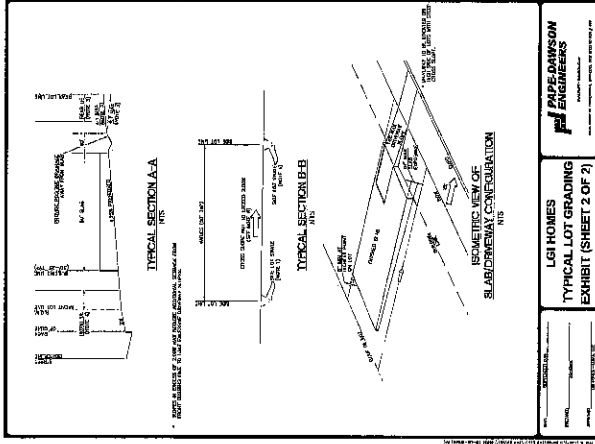
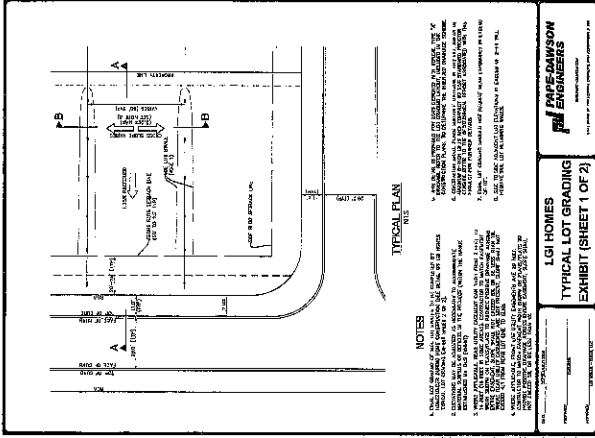

NO.	DATE	REVISION	BY

**PAPE-DAWSON ENGINEERS**  
10111 W. HUNTERS TRAIL, SUITE 100, HOUSTON, TEXAS 77036  
713.465.1111  
WWW.PAPE-DAWSON.COM

**CITY OF SEABOURNE**  
DEPARTMENT OF PUBLIC WORKS AND ENGINEERING

**THE TRAILS AT SEABOURNE PARKE SECTION THREE**  
CITY OF SEABOURNE, TEXAS

**MISCELLANEOUS DETAILS**  
(SHEET 2 OF 2)

**CITY OF ROSENBERG**  
DEPARTMENT OF PUBLIC WORKS AND ENGINEERING

DATE: 08/16/18  
PROJECT: THE TRAILS AT SEABOURNE PARKE SECTION THREE  
DRAWN BY: [Signature]  
CHECKED BY: [Signature]  
SCALE: AS SHOWN

**PAPE-DAWSON ENGINEERS**  
10111 W. HUNTERS TRAIL, SUITE 100, HOUSTON, TEXAS 77036  
713.465.1111  
WWW.PAPE-DAWSON.COM

DRAWING SCALE: AS SHOWN  
SHEET NO: 27 OF 27

THIS DOCUMENT IS THE PROPERTY OF PAPE-DAWSON ENGINEERS. IT IS TO BE USED ONLY FOR THE PROJECT AND SITE SPECIFICALLY IDENTIFIED HEREIN. IT IS NOT TO BE REPRODUCED, COPIED, OR TRANSMITTED IN ANY FORM OR BY ANY MEANS, ELECTRONIC OR MECHANICAL, INCLUDING PHOTOCOPYING, RECORDING, OR BY ANY INFORMATION STORAGE AND RETRIEVAL SYSTEM. WITHOUT THE WRITTEN PERMISSION OF PAPE-DAWSON ENGINEERS.

PERFORMANCE BOND COVERING ALL CABLE, CONDUIT AND/OR POLE LINE  
ACTIVITY IN, UNDER, ACROSS OR ALONG FORT BEND COUNTY ROAD

BOND NO. 58S207278 AUTHORIZED

THE STATE OF TEXAS

§

KNOW ALL MEN BY THESE PRESENTS:

COUNTY OF FORT BEND

§

THAT WE, Hurtado Construction Company whose address is 2115 Center Street; Richmond, Texas, 77469 Texas, hereinafter called the Principal, And Liberty Mutual Insurance Company, a Corporation existing under and by virtue of the laws of the state of Massachusetts and authorized to do an indemnifying business in the state of Texas, and whose principal office is located at 175 Berkely Street; Boston, MA 02116, whose officer residing in the State of Texas, authorized to accept service in all suits and actions brought whining said state is Jeremy Mederios and Whose address is 8350 North Central Expressway, Suite 850, Dallas, TX 75206, hereinafter called the Surety, and held and firmly bound unto, Robert e. Hebert, County Judge of Fort Bend County, Texas, or his successors in office, in the full sum of Ten Thousand Dollars and 00/100 Dollars (\$ 10,000.00) current, lawful money of the United States of America, to be paid to said Robert E. Hebert, County Judge of Fort Bend County, Texas, or his successors in office, to which payment well and truly to be made and done, we, the undersigned, bind ourselves and each of us, our heirs, executors, administrators, successors, assigns, and legal representatives, jointly and severally, by these presents.

THE CONDITION OF THIS BOND IS SUCH THAT, WHEREAS, the above bounden principal contemplates laying, constructing, maintaining and/or repairing one or more cables, conduits, and/or pole lines in, under, across and/or along roads, streets and highways, commercial driveway and median openings or modifications in the County of Fort Bend, and the State of Texas, under the jurisdiction of the Commissioners' Court of Fort Bend County, Texas, pursuant to the Commissioners' Court order adopted on the 1st day of December, A.D. 1980, recorded in Volume 13, of the Commissioners' Court Minutes of Fort Bend County, Texas, regulating same, which Commissioners' Court order is hereby referred to and made a part hereof for all purposes as though fully set out herein;

AND WHEREAS, the principal desires to provide Fort Bend County with a performance bond covering all such cable, conduit and/or pole line activity, commercial driveway and median openings or modifications;

NOW, THEREFORE, if the above bounden principal shall faithfully perform all its cable, conduit and/or pole line activity (including, but not limited to the laying, construction, maintenance and/or repair of cables, conduits and/or pole lines) in, under, across and/or along roads, streets and highways, commercial driveway and median openings or modifications in the County of Fort Bend and State of Texas, under the jurisdiction of the Commissioners Court of Fort Bend County, Texas, pursuant to and in accordance with minimum requirements and conditions of the above mentioned Commissioners' Court order set forth and specified to be by said principal done and performed, at the time and in the manner therein specified, and shall pay over and make good and reimburse Fort Bend County, all loss and damages which Fort Bend County may sustain by reason of any failure or default on the part of said principal, then this obligation shall be null and void, otherwise to remain in full force and effect.

This bond is payable at the County Courthouse in the County of Fort Bend and State of Texas.

It is understood that at any time Fort Bend County deems itself insecure under this bond, it may require further and/or additional bonds of the principal.

EXECUTED this 2nd day of December, 20 15.

Hurtado Construction Company

PRINCIPAL

BY

Liberty Mutual Insurance Company

SURETY

BY Larry H. Senkel Attorney-in-Fact

**THIS POWER OF ATTORNEY IS NOT VALID UNLESS IT IS PRINTED ON RED BACKGROUND.**

This Power of Attorney limits the acts of those named herein, and they have no authority to bind the Company except in the manner and to the extent herein stated.

Certificate No. 7089658

American Fire and Casualty Company  
The Ohio Casualty Insurance Company

Liberty Mutual Insurance Company  
West American Insurance Company

**POWER OF ATTORNEY**

KNOWN ALL PERSONS BY THESE PRESENTS: That American Fire & Casualty Company and The Ohio Casualty Insurance Company are corporations duly organized under the laws of the State of New Hampshire, that Liberty Mutual Insurance Company is a corporation duly organized under the laws of the State of Massachusetts, and West American Insurance Company is a corporation duly organized under the laws of the State of Indiana (herein collectively called the "Companies"), pursuant to and by authority herein set forth, does hereby name, constitute and appoint, Cynthia A. Peters; David A. Castillo; Jo Ann Parker; Judy M. Dold; Larry H. Senkel; Laura E. Sudduth; Mark H. Hilliard; Mary Ann Garcia

all of the city of Houston, state of TX each individually if there be more than one named, its true and lawful attorney-in-fact to make, execute, seal, acknowledge and deliver, for and on its behalf as surety and as its act and deed, any and all undertakings, bonds, recognizances and other surety obligations, in pursuance of these presents and shall be as binding upon the Companies as if they have been duly signed by the president and attested by the secretary of the Companies in their own proper persons.

IN WITNESS WHEREOF, this Power of Attorney has been subscribed by an authorized officer or official of the Companies and the corporate seals of the Companies have been affixed thereto this 19th day of August, 2015.



American Fire and Casualty Company  
The Ohio Casualty Insurance Company  
Liberty Mutual Insurance Company  
West American Insurance Company

By: David M. Carey  
David M. Carey, Assistant Secretary

STATE OF PENNSYLVANIA ss  
COUNTY OF MONTGOMERY

On this 19th day of August, 2015, before me personally appeared David M. Carey, who acknowledged himself to be the Assistant Secretary of American Fire and Casualty Company, Liberty Mutual Insurance Company, The Ohio Casualty Insurance Company, and West American Insurance Company, and that he, as such, being authorized so to do, execute the foregoing instrument for the purposes therein contained by signing on behalf of the corporations by himself as a duly authorized officer.

IN WITNESS WHEREOF, I have hereunto subscribed my name and affixed my notarial seal at Plymouth Meeting, Pennsylvania, on the day and year first above written.



COMMONWEALTH OF PENNSYLVANIA  
Notarial Seal  
Teresa Pastella, Notary Public  
Plymouth Twp., Montgomery County  
My Commission Expires March 28, 2017  
Member, Pennsylvania Association of Notaries

By: Teresa Pastella  
Teresa Pastella, Notary Public

This Power of Attorney is made and executed pursuant to and by authority of the following By-laws and Authorizations of American Fire and Casualty Company, The Ohio Casualty Insurance Company, Liberty Mutual Insurance Company, and West American Insurance Company which resolutions are now in full force and effect reading as follows:

**ARTICLE IV – OFFICERS** – Section 12. Power of Attorney. Any officer or other official of the Corporation authorized for that purpose in writing by the Chairman or the President, and subject to such limitation as the Chairman or the President may prescribe, shall appoint such attorneys-in-fact, as may be necessary to act in behalf of the Corporation to make, execute, seal, acknowledge and deliver as surety any and all undertakings, bonds, recognizances and other surety obligations. Such attorneys-in-fact, subject to the limitations set forth in their respective powers of attorney, shall have full power to bind the Corporation by their signature and execution of any such instruments and to attach thereto the seal of the Corporation. When so executed, such instruments shall be as binding as if signed by the President and attested to by the Secretary. Any power or authority granted to any representative or attorney-in-fact under the provisions of this article may be revoked at any time by the Board, the Chairman, the President or by the officer or officers granting such power or authority.

**ARTICLE XIII – Execution of Contracts – SECTION 5. Surety Bonds and Undertakings.** Any officer of the Company authorized for that purpose in writing by the chairman or the president, and subject to such limitations as the chairman or the president may prescribe, shall appoint such attorneys-in-fact, as may be necessary to act in behalf of the Company to make, execute, seal, acknowledge and deliver as surety any and all undertakings, bonds, recognizances and other surety obligations. Such attorneys-in-fact subject to the limitations set forth in their respective powers of attorney, shall have full power to bind the Company by their signature and execution of any such instruments and to attach thereto the seal of the Company. When so executed such instruments shall be as binding as if signed by the president and attested by the secretary.

**Certificate of Designation** – The President of the Company, acting pursuant to the Bylaws of the Company, authorizes David M. Carey, Assistant Secretary to appoint such attorneys-in-fact as may be necessary to act on behalf of the Company to make, execute, seal, acknowledge and deliver as surety any and all undertakings, bonds, recognizances and other surety obligations.

**Authorization** – By unanimous consent of the Company's Board of Directors, the Company consents that facsimile or mechanically reproduced signature of any assistant secretary of the Company, wherever appearing upon a certified copy of any power of attorney issued by the Company in connection with surety bonds, shall be valid and binding upon the Company with the same force and effect as though manually affixed.

I, Gregory W. Davenport, the undersigned, Assistant Secretary, of American Fire and Casualty Company, The Ohio Casualty Insurance Company, Liberty Mutual Insurance Company, and West American Insurance Company do hereby certify that the original power of attorney of which the foregoing is a full, true and correct copy of the Power of Attorney executed by said Companies, is in full force and effect and has not been revoked.

IN TESTIMONY WHEREOF, I have hereunto set my hand and affixed the seals of said Companies this 2nd day of December, 2015.



By: Gregory W. Davenport  
Gregory W. Davenport, Assistant Secretary

Not valid for mortgage, note, loan, letter of credit, currency rate, interest rate or residual value guarantees.

To confirm the validity of this Power of Attorney call 1-610-832-8240 between 9:00 am and 4:30 pm EST on any business day.



TEXAS  
IMPORTANT NOTICE

To obtain information or make a complaint:

You may call toll-free for information or to make a complaint at  
1-877-751-2641

You may also write to:

Interchange Corporate Center  
450 Plymouth Road, Suite 400  
Plymouth Meeting, PA 79462-8284

You may contact the Texas Department of Insurance to obtain information on companies, coverages, rights or complaints at  
1-800-252-3439

You may write the Texas Department of Insurance  
Consumer Protection (111-1A)  
P. O. Box 149091  
Austin, TX 78714-9091  
FAX: (512) 490-1007  
Web: <http://www.tdi.texas.gov>  
E-mail: [ConsumerProtection@tdi.texas.gov](mailto:ConsumerProtection@tdi.texas.gov)

PREMIUM OR CLAIM DISPUTES:

Should you have a dispute concerning your premium or about a claim you should first contact the agent or call 1-800-843-6446. If the dispute is not resolved, you may contact the Texas Department of Insurance.

ATTACH THIS NOTICE TO YOUR  
POLICY:

This notice is for information only and does not become a part or condition of the attached document.

NP 70 68 09 01

TEXAS  
AVISO IMPORTANTE

Para obtener informacion o para someter una queja:

Usted puede llamar al numero de telefono gratis para informacion o para someter una queja al  
1-877-751-2641

Usted tambien puede escribir a:

Interchange Corporate Center  
450 Plymouth Road, Suite 400  
Plymouth Meeting, PA 79462-8284

Puede comunicarse con el Departamento de Seguros de Texas para obtener informacion acerca de companias, coberturas, derechos o quejas al  
1-800-252-3439

Puede escribir al Departamento de Seguros de Texas Consumer Protection (111-1A)  
P. O. Box 149091  
Austin, TX 78714-9091  
FAX # (512) 490-1007  
Web: <http://www.tdi.texas.gov>  
E-mail: [ConsumerProtection@tdi.texas.gov](mailto:ConsumerProtection@tdi.texas.gov)

DISPUTAS SOBRE PRIMAS O RECLAMOS:

Si tiene una disputa concerniente a su prima o a un reclamo, debe comunicarse con el agente o primero. Si no se resuelve la disputa, puede entonces comunicarse con el departamento (TDI)

UNA ESTE AVISO A SU POLIZA:

Este aviso es solo para proposito de informacion y no se convierte en parte o condicion del documento adjunto.