



Fort Bend County Engineering  
FORT BEND COUNTY, TEXAS

Richard W. Stolleis, P.E.  
County Engineer

November 17, 2015

Commissioner Grady Prestage  
Fort Bend County Precinct 2  
3030 Texas Parkway, Suite 213  
Missouri City, Texas 77459

**RE: Mobility Project 718-769, Brand Lane  
Approval of Temporary Road Closure of Brand Lane during Construction**

Dear Commissioner:

Fort Bend County Engineering is requesting approval for a temporary road closure of Allisa Street at Brand Lane, within the Brand Lane Project during construction. The closure date is November 24th, 2015 and will remain closed until construction is completed. A map depicting the area, and detour route is attached.

If this meets your approval, we will place it on the November 24th agenda.

Sincerely,

Wesley Crawford  
Construction Coordinator

WC/mjs

Attachment: Map

cc: Mr. Michael Boenig, Allgood Construction, Inc., email: [michael@allgoodconst.com](mailto:michael@allgoodconst.com)  
Mr. Charles Russell, City of Stafford, [crussell@cityofstafford.com](mailto:crussell@cityofstafford.com)  
Ms. Cristin Emshoff, City of Stafford, [cemshoff@cityofstafford.com](mailto:cemshoff@cityofstafford.com)  
Mr. Epi Salazar, P.E., SES Horizon consulting Engineers, Inc. [epi.salazar@seshorizon.com](mailto:epi.salazar@seshorizon.com)  
File

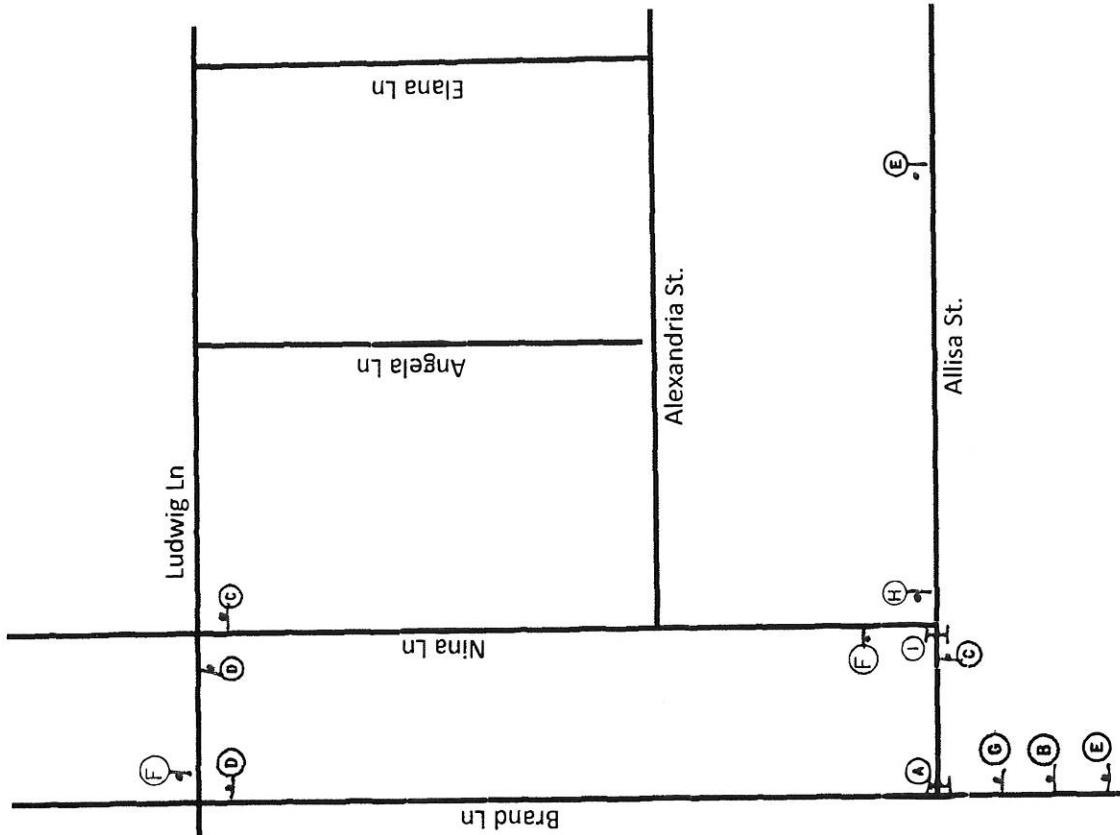

Ludwig Ln

- (A) **ROAD CLOSED**  
R11-2  
(48" x 30")
- (B) **DETOUR** ↑  
Allisa St.  
M4-9S  
(48" x 36")
- (C) **DETOUR** ↓  
BRAND LANE  
M4-9L  
(48" x 36")
- (D) **DETOUR** ↑  
Allisa St.  
M4-9R  
(48" x 36")
- (E) **DETOUR AHEAD**  
CW20-2D  
(48" x 48")
- (F) **END DETOUR**  
M4-8a  
(24" x 18")
- (G) **NO RIGHT TURN**  
R3-1  
(36" x 36")
- (H) **DETOUR** ↑  
BRAND LANE  
M4-9R  
(48" x 36")
- (I) **ROAD CLOSED THRU TRAFFIC**