



Fort Bend County Engineering  
FORT BEND COUNTY, TEXAS

Richard W. Stolleis, P.E.  
County Engineer

November 16, 2015

Judge Robert E. Hebert  
Fort Bend County Judge  
401 Jackson Street  
Richmond, Texas 77469

**Re: Sponsorship  
Public Road Connection and Temporary Asphalt Transition at Una Strada Lane, Due Strada Lane and Tre Strada Lane to West Park Toll Road Feeder Road (FM 1093) within Lakes of Bella Terra Development on behalf L.O. B. Limited Partnership**

Honorable Judge Hebert:

Fort Bend County Engineering Department has received and reviewed a request (letter attached) from Benchmark Engineering Corporation, for Fort Bend County to sponsor a project for a public road connection and temporary asphalt transition at Una Strada Lane, Due Strada Lane and Tre Strada Lane to West Park Toll Road Feeder Road (FM 1093) within Lakes of Bella Terra Development. The public road connection and asphalt transition will improve traffic flow along the West Park Toll Road Feeder Road (FM 1093).

Any and all cost involved with the project will be borne by L.O.B. Limited Partnership. There will be no cost to Fort Bend County.

The Texas Department of Transportation requests that an agency, such as Fort Bend County, act as a sponsor for the project. This means that the permit for the work will be issued in the name of Fort Bend County and the County accepts responsibility for the terms and conditions of the permit.

We recommend acceptance of the sponsorship and request that this item be placed on the 11/24/2015 Commissioner's Court agenda. We have prepared a letter to Texas Department of Transportation, for the County Judges' signature.

If there are any questions please do not hesitate to call.

Sincerely,

Rick J. Staigle, PE, PTOE  
First Assistant County Engineer

Attachment: Scope of Work

cc: Mr. Roy Cordes, Jr. FBC Attorney  
Commissioner W. A. "Andy" Meyers, Pct. 3  
File

301 Jackson St., Suite 401, Richmond, TX 77469  
Phone 281-633-7500

**DRAFT**

(To be placed on Co. Judge stationery)  
(Call to have it e-mailed by Mary Jane  
Sowa 281-633-7519)

Current date

Mr. Quincy Allen, P.E.  
District Engineer, Houston District  
Texas Department of Transportation  
P.O. Box 1386  
Houston, TX 77251-1386

**Re: Sponsorship**  
***Public Road Connection and Temporary Asphalt Transition for Una Strada Lane, Due Strada Lane and Tre Strada Lane to West Park Toll Road Feeder Road (FM 1093) within Lakes of Bella Terra Development on behalf L.O. B. Limited Partnership***

Dear Mr. Allen:

Fort Bend County has received and reviewed a request from Benchmark Engineering Corporation, for Fort Bend County to sponsor a Texas Department of Transportation project on behalf of L.O. B. Limited Partnership, for a public road connection and temporary asphalt transition at Una Strada Lane, Due Strada Lane and Tre Strada Lane to West Park Toll Road Feeder Road (FM 1093) within Lakes of Bella Terra Development, at no cost to the County.

The request was approved by Fort Bend County Commissioner's Court at their meeting dated \_\_\_\_\_. We request that a permit for the public road connection and temporary asphalt transition be issued with Fort Bend County as sponsor for this project.

If there are any questions or need for additional information, please call Rick J. Staigle in our Engineering Department at 281-633-7509.

Sincerely,

Robert E. Hebert  
Fort Bend County Judge

REH/do

Attachments: Resolution  
Drawing

cc: Mr. William H. Saour, P.E., Benchmark Engineering Corporation  
File

THE STATE OF TEXAS §

COUNTY OF FORT BEND §

**RESOLUTION TO SPONSOR A PROJECT TO CONSTRUCT A  
PUBLIC ROAD CONNECTION AND TEMPORARY ASPHALT TRANSITION AT  
UNA STRADA LANE, DUE STRADA LANE AND TRE STRADA LANE TO  
WEST PARK TOLL ROAD FEEDER ROAD (FM 1093)  
WITHIN LAKES OF BELLA TERRA DEVELOPMENT  
ON BEHALF L.O. B. LIMITED PARTNERSHIP**

On this \_\_\_\_\_ day of \_\_\_\_\_, 2015, the Commissioners Court, sitting as the governing body of Fort Bend County, Texas, at a regular meeting, upon motion of Commissioner \_\_\_\_\_, seconded by Commissioner \_\_\_\_\_, duly put and carried;

**WHEREAS**, the proposed sponsorship project includes the installation of a public road connection and temporary asphalt transition at Una Strada Lane, Due Strada Lane and Tre Strada Lane to West Park Toll Road Feeder Road (FM 1093) within Lakes of Bella Terra Development on behalf L.O. B. Limited Partnership.

**WHEREAS**, the funding for such sponsorship of the project is to be provided through sources other than Fort Bend County.

**NOW, THEREFORE, BE IT RESOLVED** that Fort Bend County expresses its support and sponsorship of such project with the Texas Department of Transportation to cause such improvements to be made at Una Strada Lane, Due Strada Lane and Tre Strada Lane to West Park Toll Road Feeder Road (FM 1093).

**FORT BEND COUNTY**

By: \_\_\_\_\_  
Robert E. Hebert, County Judge

ATTEST:

\_\_\_\_\_  
Laura Richard, County Clerk



BENCHMARK ENGINEERING CORPORATION  
ENGINEERING • PLANNING • LAND SURVEYING

TEXAS BOARD OF PROFESSIONAL ENGINEERS  
REGISTRATION NUMBER F-6788  
2401 FOUNTAINVIEW DRIVE, SUITE 500  
HOUSTON, TEXAS 77057  
(713) 266-9930

CONSULTING ENGINEERS

FAX (713) 266-3804



November 3, 2015

Honorable Robert E. Hebert  
Fort Bend County Judge  
309 S. 4<sup>th</sup> Street, Suite 719  
Richmond, Texas 77469

Re: Sponsorship Letter for Proposed Street tie-In for  
**Una Strada Lane, Due Strada Lane and Tre Strada Lane to West Park Toll Road  
Feeder Road (F.M. 1093)**  
In Fort Bend County Municipal Utility District No. 133,

Plat name: **Via Mazzinni Way Reserve Sec. 1**

Dear Mr. Hebert:

As required by the Texas Department of Transportation (TXDOT), we are in the process of preparing a permit application package to submit to TXDOT for the proposed street tie-in of Una Strada Lane, Due Strada Lane and Tre Strada Lane to West Park Toll Road Feeder Road. The proposed tie-in will be a 3-41' wide minimum concrete roadways on the east bound West Park Toll Road Feeder Road which will transition to a two lane concrete roadway with curb. In addition to this the West Park Toll Road Authority will be constructing feeder road, right hand turn lanes and the roadway connection as part of the proposed feeder road construction. There is a separate request for temporary roadways to be used until the permanent feeder road for the West Park Toll road is constructed. These roadways will be constructed in accordance with Fort Bend County Design Standards & Requirements at no expense to the county. The developer is **L.O.B. Limited Partnership**, will finance the cost of the construction. Please find attached 2 – 11"x17" reduced Fort Bend County final drawings of the proposed tie-in, as required by TXDOT street permit.

As part of the requirements by TXDOT, a sponsorship letter from Fort Bend County is necessary as a part of the submittal package. As the engineer for this development, I am hereby respectfully requesting Fort Bend County's sponsorship for this construction.

Please call me if you have any questions or need further information.

Sincerely,

BENCHMARK ENGINEERING CORPORATION

William H. Saour, P.E.  
Project Engineer



cc: Ms. Mary Jane Sowa – FBC Engineering



**REMARKS**

THIS SHEET IS FOR THE FINAL PLANT COMPANY WATER MAINS AND WATER SERVICE LINES SHOWN ON THIS SHEET. THE CONTRACTOR SHALL BE RESPONSIBLE FOR THE PROTECTION OF ALL EXISTING UTILITIES AND STRUCTURES. THE CONTRACTOR SHALL BE RESPONSIBLE FOR THE PROTECTION OF ALL EXISTING UTILITIES AND STRUCTURES. THE CONTRACTOR SHALL BE RESPONSIBLE FOR THE PROTECTION OF ALL EXISTING UTILITIES AND STRUCTURES.

**CONTRACTOR'S OBLIGATION**

THE CONTRACTOR SHALL BE RESPONSIBLE FOR THE PROTECTION OF ALL EXISTING UTILITIES AND STRUCTURES. THE CONTRACTOR SHALL BE RESPONSIBLE FOR THE PROTECTION OF ALL EXISTING UTILITIES AND STRUCTURES. THE CONTRACTOR SHALL BE RESPONSIBLE FOR THE PROTECTION OF ALL EXISTING UTILITIES AND STRUCTURES.

**APPROVALS**

DATE: \_\_\_\_\_

DATE: \_\_\_\_\_

DATE: \_\_\_\_\_

**SEAL**

DATE: \_\_\_\_\_

DATE: \_\_\_\_\_

DATE: \_\_\_\_\_

**GENERAL NOTES**

1. THE CONTRACTOR SHALL BE RESPONSIBLE FOR THE PROTECTION OF ALL EXISTING UTILITIES AND STRUCTURES. THE CONTRACTOR SHALL BE RESPONSIBLE FOR THE PROTECTION OF ALL EXISTING UTILITIES AND STRUCTURES. THE CONTRACTOR SHALL BE RESPONSIBLE FOR THE PROTECTION OF ALL EXISTING UTILITIES AND STRUCTURES.

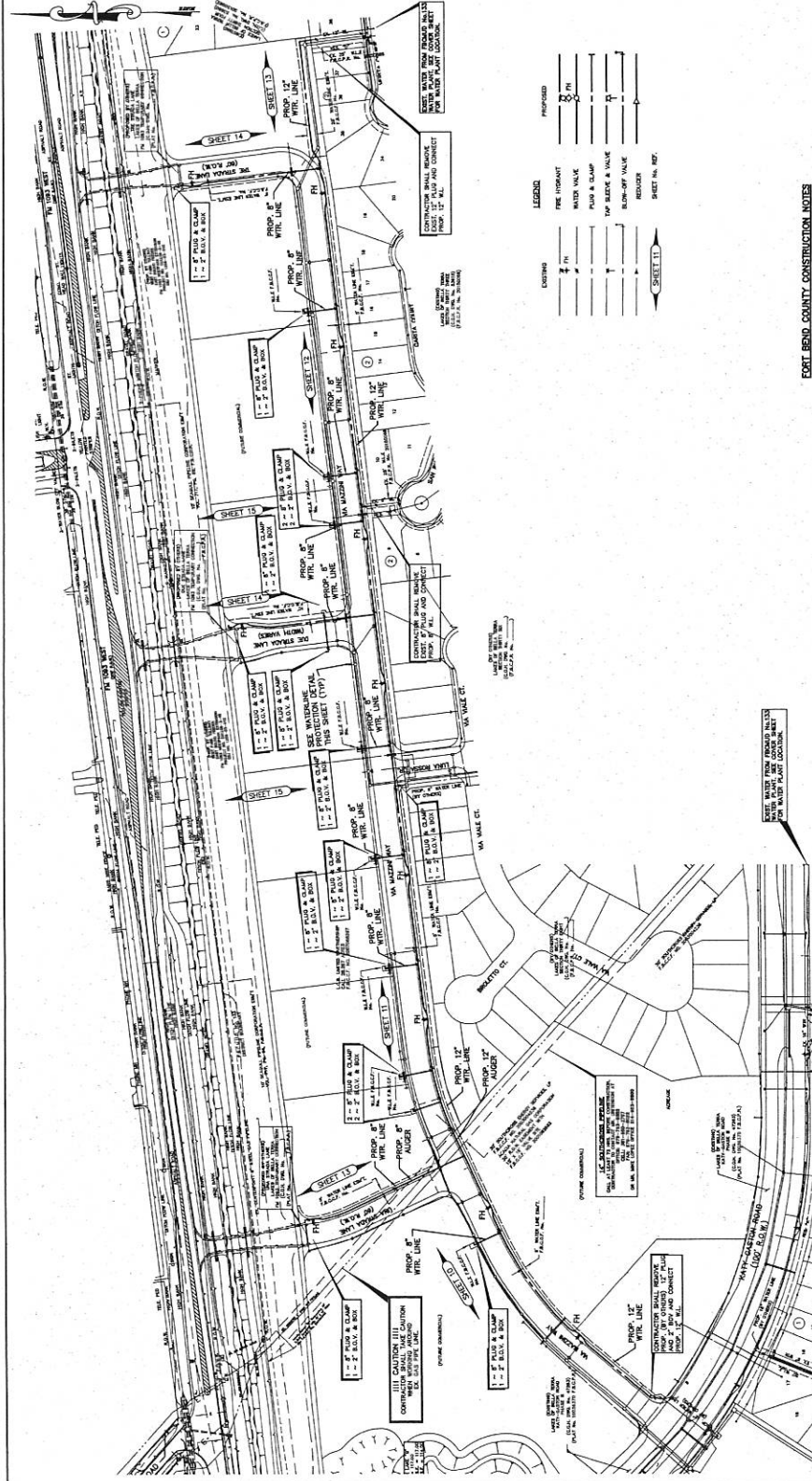

**LEGEND**

PROPOSED

EXISTING

PIPE FORECAST

WATER VALVE

PIPE & CLAMP

PIPE BENDER & VALVE

BLIND-OFF VALVE

REDUCER

SHEET NO. 12

**FOOT-BIND COUNTY CONSTRUCTION NOTES**

1. THE CONTRACTOR SHALL BE RESPONSIBLE FOR THE PROTECTION OF ALL EXISTING UTILITIES AND STRUCTURES. THE CONTRACTOR SHALL BE RESPONSIBLE FOR THE PROTECTION OF ALL EXISTING UTILITIES AND STRUCTURES. THE CONTRACTOR SHALL BE RESPONSIBLE FOR THE PROTECTION OF ALL EXISTING UTILITIES AND STRUCTURES.

**WATERLINE PROTECTION**

1. THE CONTRACTOR SHALL BE RESPONSIBLE FOR THE PROTECTION OF ALL EXISTING UTILITIES AND STRUCTURES. THE CONTRACTOR SHALL BE RESPONSIBLE FOR THE PROTECTION OF ALL EXISTING UTILITIES AND STRUCTURES. THE CONTRACTOR SHALL BE RESPONSIBLE FOR THE PROTECTION OF ALL EXISTING UTILITIES AND STRUCTURES.

**LEGEND**

WATERLINE PROTECTION

CONTRACTOR SHALL MAINTAIN AND PROTECT ALL EXISTING UTILITIES AND STRUCTURES

**CONTRACTOR SHALL MAINTAIN AND PROTECT ALL EXISTING UTILITIES AND STRUCTURES**

CONTRACTOR SHALL MAINTAIN AND PROTECT ALL EXISTING UTILITIES AND STRUCTURES. THE CONTRACTOR SHALL BE RESPONSIBLE FOR THE PROTECTION OF ALL EXISTING UTILITIES AND STRUCTURES. THE CONTRACTOR SHALL BE RESPONSIBLE FOR THE PROTECTION OF ALL EXISTING UTILITIES AND STRUCTURES.

**CONTRACTOR SHALL MAINTAIN AND PROTECT ALL EXISTING UTILITIES AND STRUCTURES**

CONTRACTOR SHALL MAINTAIN AND PROTECT ALL EXISTING UTILITIES AND STRUCTURES. THE CONTRACTOR SHALL BE RESPONSIBLE FOR THE PROTECTION OF ALL EXISTING UTILITIES AND STRUCTURES. THE CONTRACTOR SHALL BE RESPONSIBLE FOR THE PROTECTION OF ALL EXISTING UTILITIES AND STRUCTURES.

**CONTRACTOR SHALL MAINTAIN AND PROTECT ALL EXISTING UTILITIES AND STRUCTURES**

CONTRACTOR SHALL MAINTAIN AND PROTECT ALL EXISTING UTILITIES AND STRUCTURES. THE CONTRACTOR SHALL BE RESPONSIBLE FOR THE PROTECTION OF ALL EXISTING UTILITIES AND STRUCTURES. THE CONTRACTOR SHALL BE RESPONSIBLE FOR THE PROTECTION OF ALL EXISTING UTILITIES AND STRUCTURES.

**OVERALL WATER LAYOUT**

PLANT NAME: LAKES OF BELLA TERRA, VA. WATER MAINS SHEET 1

PROJECT NO.: 2015-1018

DATE: 10/15/15

APPROVED: FPC DEVELOPMENT COORDINATOR

DATE: \_\_\_\_\_

DATE: \_\_\_\_\_

DATE: \_\_\_\_\_

**CITY OF HOUSTON**

DEPARTMENT OF PUBLIC WORKS AND ENGINEERING

FILE NO. \_\_\_\_\_

DATE: \_\_\_\_\_

DATE: \_\_\_\_\_

DATE: \_\_\_\_\_

**LEGEND**

PROPOSED

EXISTING

PIPE FORECAST

WATER VALVE

PIPE & CLAMP

PIPE BENDER & VALVE

BLIND-OFF VALVE

REDUCER

SHEET NO. 12

**FOOT-BIND COUNTY CONSTRUCTION NOTES**

1. THE CONTRACTOR SHALL BE RESPONSIBLE FOR THE PROTECTION OF ALL EXISTING UTILITIES AND STRUCTURES. THE CONTRACTOR SHALL BE RESPONSIBLE FOR THE PROTECTION OF ALL EXISTING UTILITIES AND STRUCTURES. THE CONTRACTOR SHALL BE RESPONSIBLE FOR THE PROTECTION OF ALL EXISTING UTILITIES AND STRUCTURES.

**WATERLINE PROTECTION**

1. THE CONTRACTOR SHALL BE RESPONSIBLE FOR THE PROTECTION OF ALL EXISTING UTILITIES AND STRUCTURES. THE CONTRACTOR SHALL BE RESPONSIBLE FOR THE PROTECTION OF ALL EXISTING UTILITIES AND STRUCTURES. THE CONTRACTOR SHALL BE RESPONSIBLE FOR THE PROTECTION OF ALL EXISTING UTILITIES AND STRUCTURES.

**LEGEND**

WATERLINE PROTECTION

CONTRACTOR SHALL MAINTAIN AND PROTECT ALL EXISTING UTILITIES AND STRUCTURES

**CONTRACTOR SHALL MAINTAIN AND PROTECT ALL EXISTING UTILITIES AND STRUCTURES**

CONTRACTOR SHALL MAINTAIN AND PROTECT ALL EXISTING UTILITIES AND STRUCTURES. THE CONTRACTOR SHALL BE RESPONSIBLE FOR THE PROTECTION OF ALL EXISTING UTILITIES AND STRUCTURES. THE CONTRACTOR SHALL BE RESPONSIBLE FOR THE PROTECTION OF ALL EXISTING UTILITIES AND STRUCTURES.

**CONTRACTOR SHALL MAINTAIN AND PROTECT ALL EXISTING UTILITIES AND STRUCTURES**

CONTRACTOR SHALL MAINTAIN AND PROTECT ALL EXISTING UTILITIES AND STRUCTURES. THE CONTRACTOR SHALL BE RESPONSIBLE FOR THE PROTECTION OF ALL EXISTING UTILITIES AND STRUCTURES. THE CONTRACTOR SHALL BE RESPONSIBLE FOR THE PROTECTION OF ALL EXISTING UTILITIES AND STRUCTURES.

**CONTRACTOR SHALL MAINTAIN AND PROTECT ALL EXISTING UTILITIES AND STRUCTURES**

CONTRACTOR SHALL MAINTAIN AND PROTECT ALL EXISTING UTILITIES AND STRUCTURES. THE CONTRACTOR SHALL BE RESPONSIBLE FOR THE PROTECTION OF ALL EXISTING UTILITIES AND STRUCTURES. THE CONTRACTOR SHALL BE RESPONSIBLE FOR THE PROTECTION OF ALL EXISTING UTILITIES AND STRUCTURES.

**GENERAL NOTES**

1. THE CONTRACTOR SHALL BE RESPONSIBLE FOR THE PROTECTION OF ALL EXISTING UTILITIES AND STRUCTURES. THE CONTRACTOR SHALL BE RESPONSIBLE FOR THE PROTECTION OF ALL EXISTING UTILITIES AND STRUCTURES. THE CONTRACTOR SHALL BE RESPONSIBLE FOR THE PROTECTION OF ALL EXISTING UTILITIES AND STRUCTURES.

**APPROVALS**

DATE: \_\_\_\_\_

DATE: \_\_\_\_\_

DATE: \_\_\_\_\_

**SEAL**

DATE: \_\_\_\_\_

DATE: \_\_\_\_\_

DATE: \_\_\_\_\_

**GENERAL NOTES**

1. THE CONTRACTOR SHALL BE RESPONSIBLE FOR THE PROTECTION OF ALL EXISTING UTILITIES AND STRUCTURES. THE CONTRACTOR SHALL BE RESPONSIBLE FOR THE PROTECTION OF ALL EXISTING UTILITIES AND STRUCTURES. THE CONTRACTOR SHALL BE RESPONSIBLE FOR THE PROTECTION OF ALL EXISTING UTILITIES AND STRUCTURES.

**WATERLINE PROTECTION**

1. THE CONTRACTOR SHALL BE RESPONSIBLE FOR THE PROTECTION OF ALL EXISTING UTILITIES AND STRUCTURES. THE CONTRACTOR SHALL BE RESPONSIBLE FOR THE PROTECTION OF ALL EXISTING UTILITIES AND STRUCTURES. THE CONTRACTOR SHALL BE RESPONSIBLE FOR THE PROTECTION OF ALL EXISTING UTILITIES AND STRUCTURES.

**LEGEND**

WATERLINE PROTECTION

CONTRACTOR SHALL MAINTAIN AND PROTECT ALL EXISTING UTILITIES AND STRUCTURES

**CONTRACTOR SHALL MAINTAIN AND PROTECT ALL EXISTING UTILITIES AND STRUCTURES**

CONTRACTOR SHALL MAINTAIN AND PROTECT ALL EXISTING UTILITIES AND STRUCTURES. THE CONTRACTOR SHALL BE RESPONSIBLE FOR THE PROTECTION OF ALL EXISTING UTILITIES AND STRUCTURES. THE CONTRACTOR SHALL BE RESPONSIBLE FOR THE PROTECTION OF ALL EXISTING UTILITIES AND STRUCTURES.

**CONTRACTOR SHALL MAINTAIN AND PROTECT ALL EXISTING UTILITIES AND STRUCTURES**

CONTRACTOR SHALL MAINTAIN AND PROTECT ALL EXISTING UTILITIES AND STRUCTURES. THE CONTRACTOR SHALL BE RESPONSIBLE FOR THE PROTECTION OF ALL EXISTING UTILITIES AND STRUCTURES. THE CONTRACTOR SHALL BE RESPONSIBLE FOR THE PROTECTION OF ALL EXISTING UTILITIES AND STRUCTURES.

**CONTRACTOR SHALL MAINTAIN AND PROTECT ALL EXISTING UTILITIES AND STRUCTURES**

CONTRACTOR SHALL MAINTAIN AND PROTECT ALL EXISTING UTILITIES AND STRUCTURES. THE CONTRACTOR SHALL BE RESPONSIBLE FOR THE PROTECTION OF ALL EXISTING UTILITIES AND STRUCTURES. THE CONTRACTOR SHALL BE RESPONSIBLE FOR THE PROTECTION OF ALL EXISTING UTILITIES AND STRUCTURES.



**BENCHMARKS**

THE BENCH MARKS SHOWN ON THIS PLAN ARE THE PROPERTY OF THE BUREAU OF PUBLIC WORKS, CITY OF HOUSTON. THE BENCH MARKS ARE TO BE USED AS A CHECK ON THE ELEVATIONS SHOWN ON THIS PLAN. THE BENCH MARKS ARE TO BE USED AS A CHECK ON THE ELEVATIONS SHOWN ON THIS PLAN. THE BENCH MARKS ARE TO BE USED AS A CHECK ON THE ELEVATIONS SHOWN ON THIS PLAN.

**PRIVATE UTILITY LINES SHOWN**

EXISTING PRIVATE UTILITY LINES SHOWN ON THIS PLAN ARE THE PROPERTY OF THE BUREAU OF PUBLIC WORKS, CITY OF HOUSTON. THE PRIVATE UTILITY LINES ARE TO BE USED AS A CHECK ON THE ELEVATIONS SHOWN ON THIS PLAN. THE PRIVATE UTILITY LINES ARE TO BE USED AS A CHECK ON THE ELEVATIONS SHOWN ON THIS PLAN.

**DATE**

DATE: 11/15/1978

BY: [Signature]



**PROJECT INFORMATION**

PROJECT: OVERALL STORM SEWER LAYOUT

LOCATION: LAKES OF BELLA TERRA, W.A. MAZON WAY RESERVE SEC 1, FORT BEND COUNTY, TEXAS

**APPROVED FOR THE CITY**

CITY ENGINEER: [Signature]

CITY OF HOUSTON, DEPARTMENT OF PUBLIC WORKS AND ENGINEERING

**OVERALL STORM SEWER LAYOUT**

APPROXIMATION IS VALID FOR 1 YEAR.

DATE: 11/15/1978

**SCALE**

SCALE: 1" = 100'

**FILE NO.**

FILE NO.: 11-1007

**SHEET NO.**

SHEET NO.: 4 of 23

**DATE**

DATE: 11/15/1978

**LEGEND**

EXISTING: 1" x 4" MANHOLE, 1" x 2" MANHOLE, STORM MANHOLE, JUNCTION BOX

PROPOSED: 1" x 4" MANHOLE, 1" x 2" MANHOLE, STORM MANHOLE, JUNCTION BOX

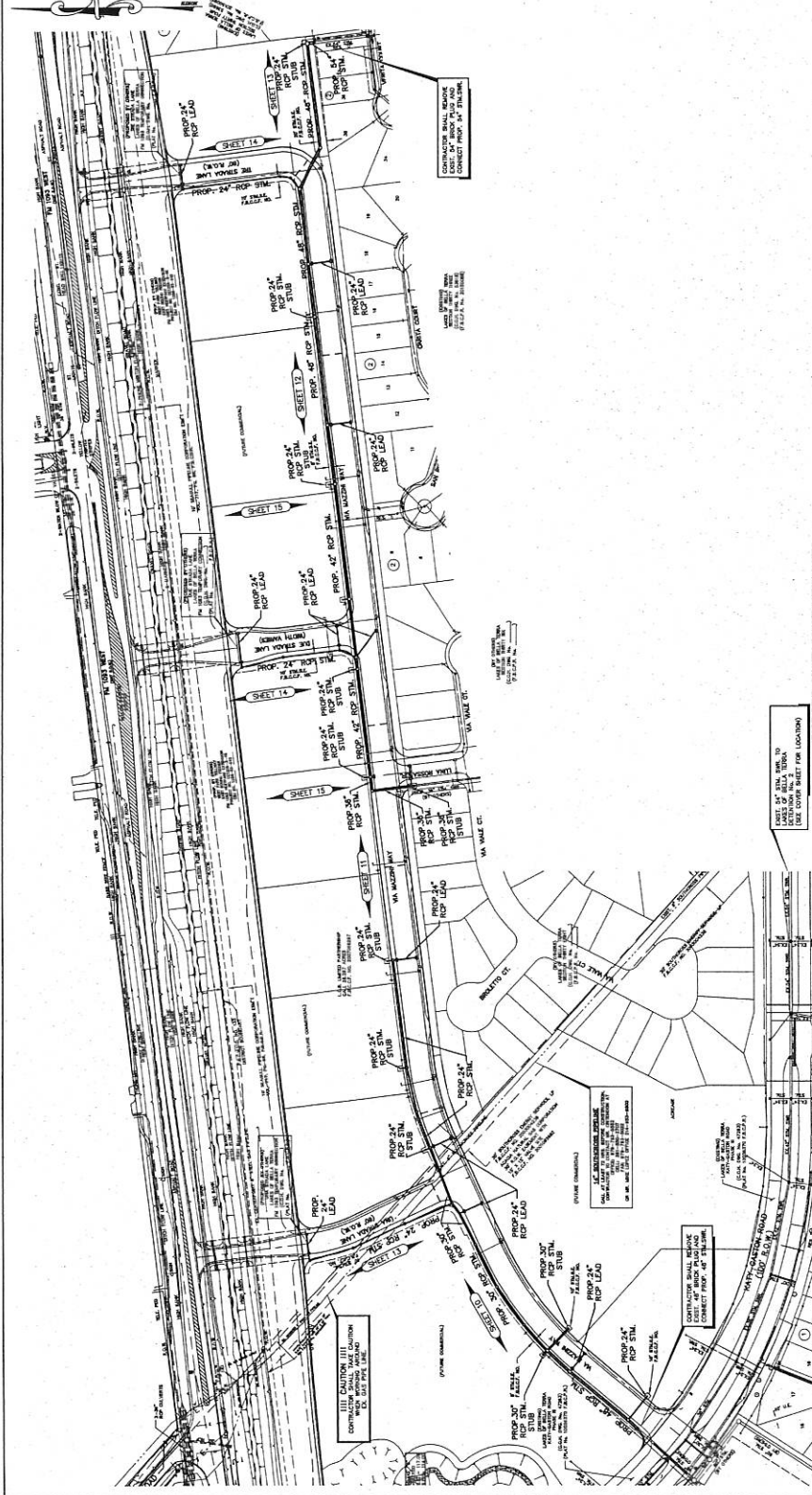

**CONSTRUCTION NOTES**

1. ALL STORM SEWER LINES SHALL BE 12\"/>

2. ALL STORM SEWER LINES SHALL BE 12\"/>

3. ALL STORM SEWER LINES SHALL BE 12\"/>

4. ALL STORM SEWER LINES SHALL BE 12\"/>

5. ALL STORM SEWER LINES SHALL BE 12\"/>

6. ALL STORM SEWER LINES SHALL BE 12\"/>

7. ALL STORM SEWER LINES SHALL BE 12\"/>

8. ALL STORM SEWER LINES SHALL BE 12\"/>

9. ALL STORM SEWER LINES SHALL BE 12\"/>

10. ALL STORM SEWER LINES SHALL BE 12\"/>

**CONTRACTOR SHALL REMOVE EXISTING PRIVATE UTILITY LINES**

CONTRACTOR SHALL REMOVE EXISTING PRIVATE UTILITY LINES SHOWN ON THIS PLAN. THE CONTRACTOR SHALL REMOVE EXISTING PRIVATE UTILITY LINES SHOWN ON THIS PLAN. THE CONTRACTOR SHALL REMOVE EXISTING PRIVATE UTILITY LINES SHOWN ON THIS PLAN.

**CONTRACTOR SHALL REMOVE EXISTING PRIVATE UTILITY LINES**

CONTRACTOR SHALL REMOVE EXISTING PRIVATE UTILITY LINES SHOWN ON THIS PLAN. THE CONTRACTOR SHALL REMOVE EXISTING PRIVATE UTILITY LINES SHOWN ON THIS PLAN. THE CONTRACTOR SHALL REMOVE EXISTING PRIVATE UTILITY LINES SHOWN ON THIS PLAN.

**CONTRACTOR SHALL REMOVE EXISTING PRIVATE UTILITY LINES**

CONTRACTOR SHALL REMOVE EXISTING PRIVATE UTILITY LINES SHOWN ON THIS PLAN. THE CONTRACTOR SHALL REMOVE EXISTING PRIVATE UTILITY LINES SHOWN ON THIS PLAN. THE CONTRACTOR SHALL REMOVE EXISTING PRIVATE UTILITY LINES SHOWN ON THIS PLAN.

**CONTRACTOR SHALL REMOVE EXISTING PRIVATE UTILITY LINES**

CONTRACTOR SHALL REMOVE EXISTING PRIVATE UTILITY LINES SHOWN ON THIS PLAN. THE CONTRACTOR SHALL REMOVE EXISTING PRIVATE UTILITY LINES SHOWN ON THIS PLAN. THE CONTRACTOR SHALL REMOVE EXISTING PRIVATE UTILITY LINES SHOWN ON THIS PLAN.

**CONTRACTOR SHALL REMOVE EXISTING PRIVATE UTILITY LINES**

CONTRACTOR SHALL REMOVE EXISTING PRIVATE UTILITY LINES SHOWN ON THIS PLAN. THE CONTRACTOR SHALL REMOVE EXISTING PRIVATE UTILITY LINES SHOWN ON THIS PLAN. THE CONTRACTOR SHALL REMOVE EXISTING PRIVATE UTILITY LINES SHOWN ON THIS PLAN.





**BENCHMARKS**

ALL BENCHMARKS SHOWN ON THIS PLAN ARE TO BE USED AS A CHECK ON THE ELEVATIONS OF THE FINISHED GRADE AND THE ELEVATIONS OF THE CENTERLINE OF THE PAVEMENT. THE BENCHMARKS ARE TO BE SET AT THE CORNERS OF THE LOTS AND AT THE INTERSECTIONS OF THE ALLEYS AND STREETS. THE BENCHMARKS ARE TO BE SET AT THE CORNERS OF THE LOTS AND AT THE INTERSECTIONS OF THE ALLEYS AND STREETS. THE BENCHMARKS ARE TO BE SET AT THE CORNERS OF THE LOTS AND AT THE INTERSECTIONS OF THE ALLEYS AND STREETS.

**PRIVATE UTILITY LINES SHOWN**

ALL PRIVATE UTILITY LINES SHOWN ON THIS PLAN ARE TO BE USED AS A CHECK ON THE ELEVATIONS OF THE FINISHED GRADE AND THE ELEVATIONS OF THE CENTERLINE OF THE PAVEMENT. THE PRIVATE UTILITY LINES ARE TO BE SET AT THE CORNERS OF THE LOTS AND AT THE INTERSECTIONS OF THE ALLEYS AND STREETS. THE PRIVATE UTILITY LINES ARE TO BE SET AT THE CORNERS OF THE LOTS AND AT THE INTERSECTIONS OF THE ALLEYS AND STREETS.



**ENGINEERING CONSULTANTS**

ENGINEERING CONSULTANTS  
 11111 WEST 28th STREET  
 FORT WORTH, TEXAS 76114-1111

**LAKES OF BELLA TERRA**  
 VIA MAZZINI WAY RESERVE SEC 1  
 FORT BEND COUNTY, TEXAS

**PAVING, GRADING AND DRAINAGE PLAN**

PLAN NAME: LAKES OF BELLA TERRA VIA MAZZINI WAY RESERVE SEC 1  
 DATE: 11/10/00  
 SCALE: 1" = 100'

**CITY OF HOUSTON**  
 DEPARTMENT OF PUBLIC WORKS AND ENGINEERING

DATE: 11/10/00  
 APPROVED: [Signature]  
 TITLE: [Title]

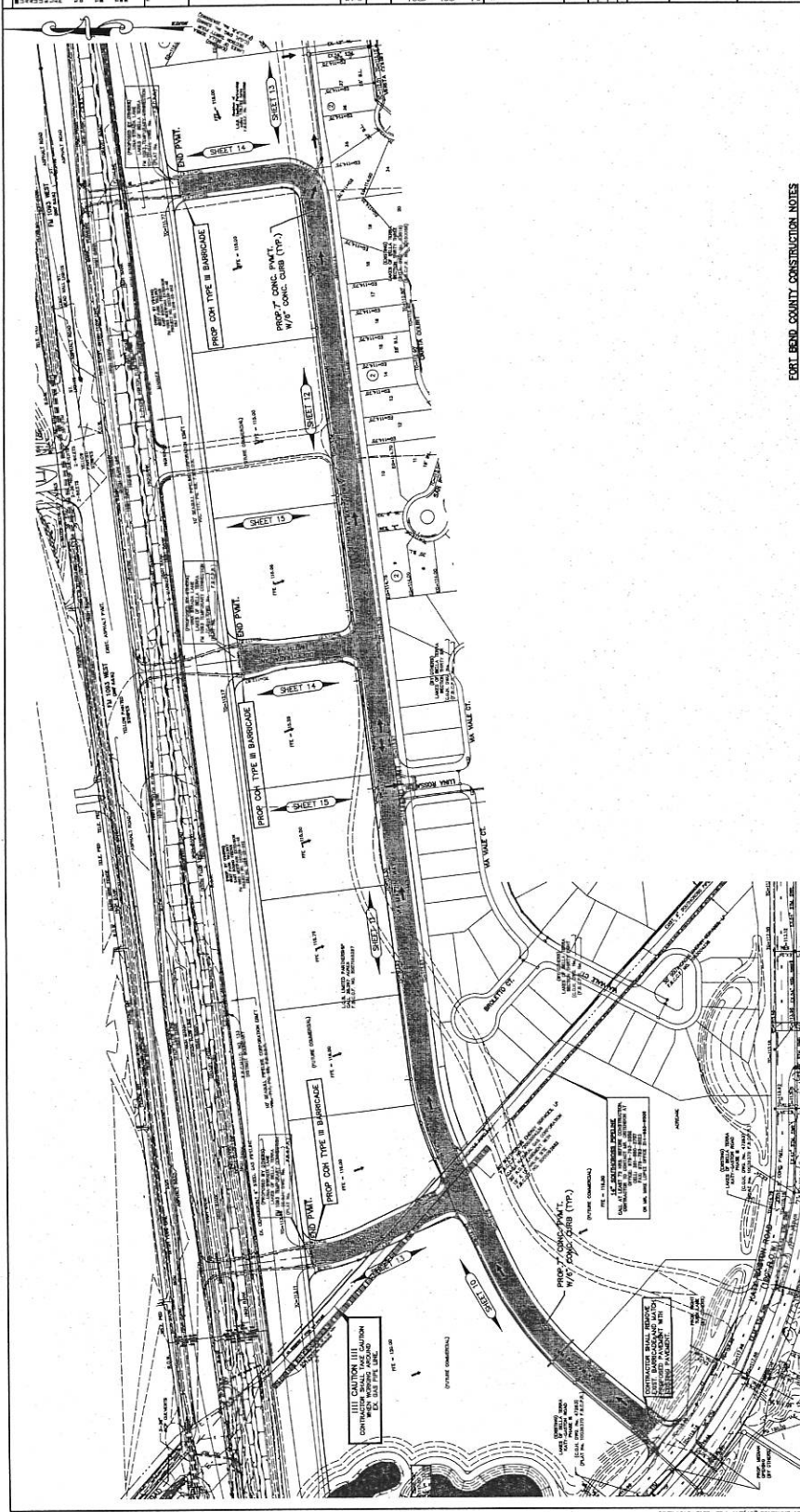

**FORT BEND COUNTY CONSTRUCTION NOTES**

1. ALL CONSTRUCTION SHALL BE IN ACCORDANCE WITH THE LATEST EDITIONS OF THE TEXAS CONSTRUCTION CODES AND THE LATEST EDITIONS OF THE TEXAS CONSTRUCTION SPECIFICATIONS.
2. ALL CONSTRUCTION SHALL BE IN ACCORDANCE WITH THE LATEST EDITIONS OF THE TEXAS CONSTRUCTION CODES AND THE LATEST EDITIONS OF THE TEXAS CONSTRUCTION SPECIFICATIONS.
3. ALL CONSTRUCTION SHALL BE IN ACCORDANCE WITH THE LATEST EDITIONS OF THE TEXAS CONSTRUCTION CODES AND THE LATEST EDITIONS OF THE TEXAS CONSTRUCTION SPECIFICATIONS.
4. ALL CONSTRUCTION SHALL BE IN ACCORDANCE WITH THE LATEST EDITIONS OF THE TEXAS CONSTRUCTION CODES AND THE LATEST EDITIONS OF THE TEXAS CONSTRUCTION SPECIFICATIONS.
5. ALL CONSTRUCTION SHALL BE IN ACCORDANCE WITH THE LATEST EDITIONS OF THE TEXAS CONSTRUCTION CODES AND THE LATEST EDITIONS OF THE TEXAS CONSTRUCTION SPECIFICATIONS.
6. ALL CONSTRUCTION SHALL BE IN ACCORDANCE WITH THE LATEST EDITIONS OF THE TEXAS CONSTRUCTION CODES AND THE LATEST EDITIONS OF THE TEXAS CONSTRUCTION SPECIFICATIONS.
7. ALL CONSTRUCTION SHALL BE IN ACCORDANCE WITH THE LATEST EDITIONS OF THE TEXAS CONSTRUCTION CODES AND THE LATEST EDITIONS OF THE TEXAS CONSTRUCTION SPECIFICATIONS.
8. ALL CONSTRUCTION SHALL BE IN ACCORDANCE WITH THE LATEST EDITIONS OF THE TEXAS CONSTRUCTION CODES AND THE LATEST EDITIONS OF THE TEXAS CONSTRUCTION SPECIFICATIONS.
9. ALL CONSTRUCTION SHALL BE IN ACCORDANCE WITH THE LATEST EDITIONS OF THE TEXAS CONSTRUCTION CODES AND THE LATEST EDITIONS OF THE TEXAS CONSTRUCTION SPECIFICATIONS.
10. ALL CONSTRUCTION SHALL BE IN ACCORDANCE WITH THE LATEST EDITIONS OF THE TEXAS CONSTRUCTION CODES AND THE LATEST EDITIONS OF THE TEXAS CONSTRUCTION SPECIFICATIONS.

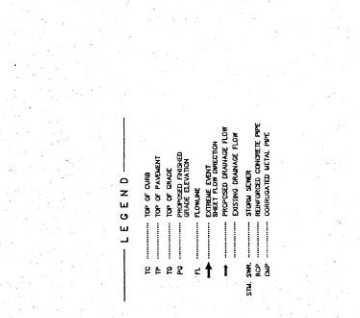



**REMARKS**

THIS PLAN IS THE PROPERTY OF THE ENGINEER AND IS NOT TO BE REPRODUCED OR COPIED IN ANY MANNER WITHOUT HIS WRITTEN CONSENT. THE ENGINEER'S LIABILITY IS LIMITED TO THE PROFESSIONAL SERVICES RENDERED BY HIM AND HE ACCEPTS NO LIABILITY FOR THE ACCURACY OF THE INFORMATION FURNISHED BY OTHERS OR FOR THE CONSTRUCTION OF THE WORK OR FOR THE SAFETY THEREOF. THE CONTRACTOR SHALL BE RESPONSIBLE FOR THE PROTECTION OF ALL UTILITIES AND STRUCTURES EXISTING ON THE SITE AND FOR THE SAFETY OF ALL PERSONS AND PROPERTY. THE CONTRACTOR SHALL MAINTAIN ACCESS TO ALL ADJACENT PROPERTIES AT ALL TIMES. THE CONTRACTOR SHALL BE RESPONSIBLE FOR OBTAINING ALL NECESSARY PERMITS AND APPROVALS FROM THE APPROPRIATE AGENCIES. THE CONTRACTOR SHALL MAINTAIN ALL RECORDS AND DRAWINGS FOR A PERIOD OF FIVE YEARS AFTER THE COMPLETION OF THE WORK.

**PRIVATE UTILITY LINES SHOWN**

THE LINES IN THIS PLAN INDICATE THE LOCATION OF ALL KNOWN PRIVATE UTILITY LINES. THE CONTRACTOR SHALL BE RESPONSIBLE FOR VERIFYING THE LOCATION AND DEPTH OF ALL UTILITIES PRIOR TO CONSTRUCTION. THE CONTRACTOR SHALL TAKE ALL NECESSARY PRECAUTIONS TO AVOID DAMAGE TO ANY UTILITIES. THE CONTRACTOR SHALL BE RESPONSIBLE FOR THE PROTECTION OF ALL UTILITIES AND STRUCTURES EXISTING ON THE SITE AND FOR THE SAFETY THEREOF.

**DATE** \_\_\_\_\_

**SCALE** \_\_\_\_\_

**PROJECT** \_\_\_\_\_

**CLIENT** \_\_\_\_\_

**ENGINEER** \_\_\_\_\_

**PROF. NO.** \_\_\_\_\_

**STATE** \_\_\_\_\_

**APPROVED**

**FOR THE DEVELOPMENT** \_\_\_\_\_

**DATE** \_\_\_\_\_

**FOR THE CITY OF HOUSTON**

**DEPARTMENT OF PUBLIC WORKS AND ENGINEERING**

**ENGINEER** \_\_\_\_\_

**PROF. NO.** \_\_\_\_\_

**STATE** \_\_\_\_\_

**FOR THE CITY OF HOUSTON**

**DEPARTMENT OF PUBLIC WORKS AND ENGINEERING**

**ENGINEER** \_\_\_\_\_

**PROF. NO.** \_\_\_\_\_

**STATE** \_\_\_\_\_

**FOR THE CITY OF HOUSTON**

**DEPARTMENT OF PUBLIC WORKS AND ENGINEERING**

**ENGINEER** \_\_\_\_\_

**PROF. NO.** \_\_\_\_\_

**STATE** \_\_\_\_\_

**FOR THE CITY OF HOUSTON**

**DEPARTMENT OF PUBLIC WORKS AND ENGINEERING**

**ENGINEER** \_\_\_\_\_

**PROF. NO.** \_\_\_\_\_

**STATE** \_\_\_\_\_

**FOR THE CITY OF HOUSTON**

**DEPARTMENT OF PUBLIC WORKS AND ENGINEERING**

**ENGINEER** \_\_\_\_\_

**PROF. NO.** \_\_\_\_\_

**STATE** \_\_\_\_\_

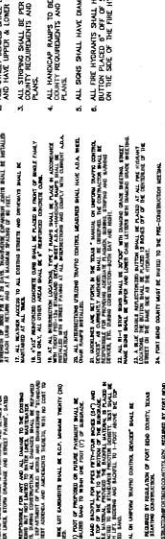
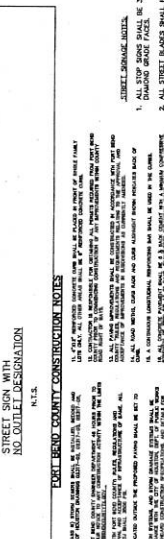
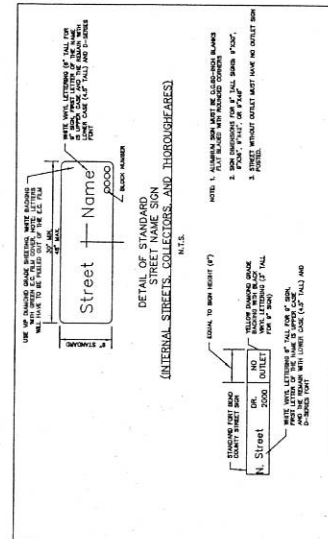
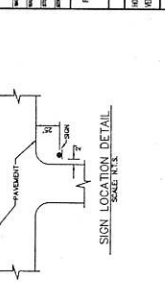
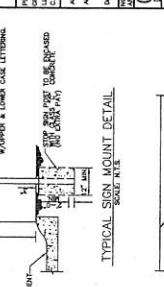
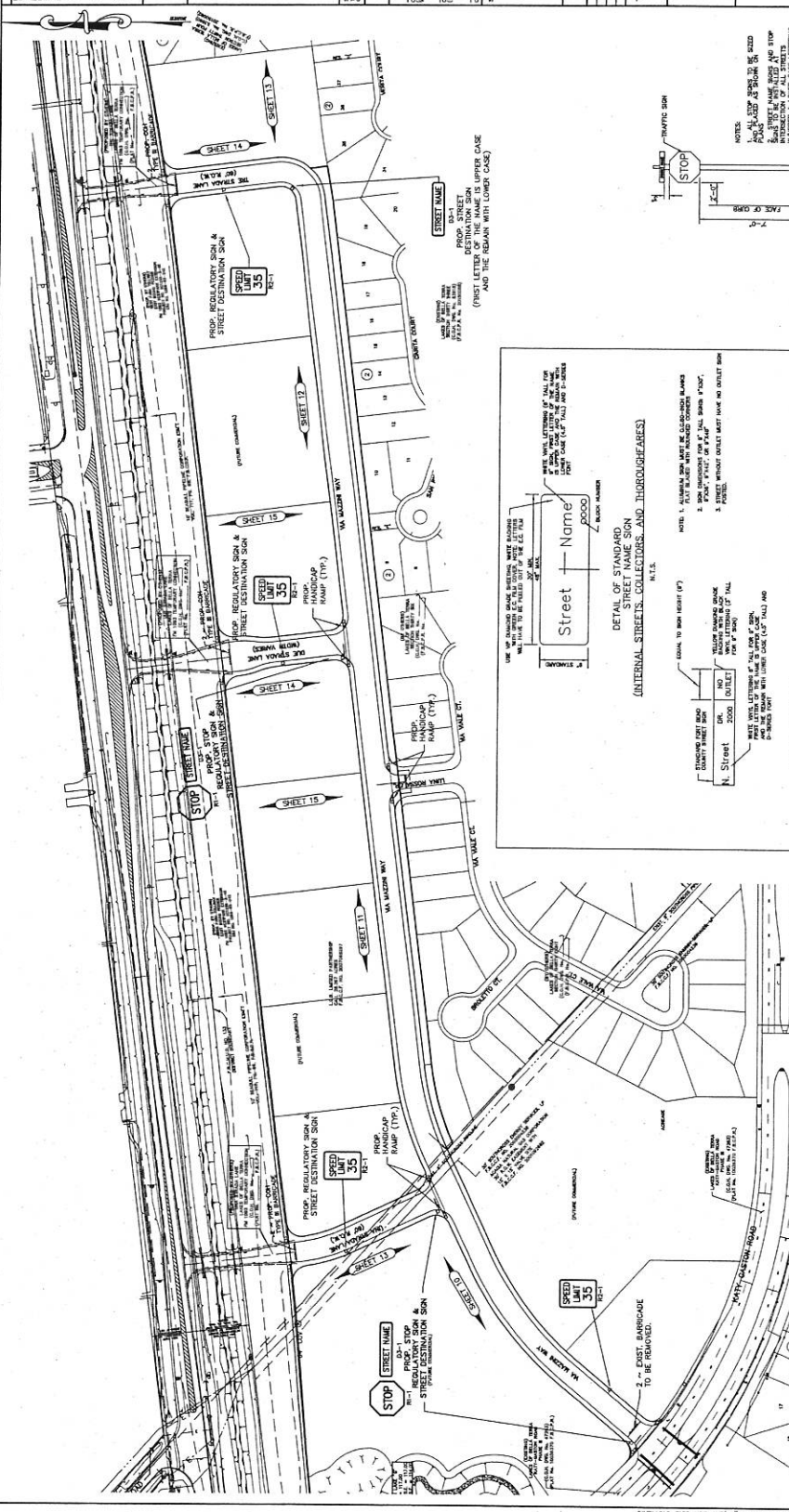

**FOR THE CITY OF HOUSTON**

**DEPARTMENT OF PUBLIC WORKS AND ENGINEERING**

**ENGINEER** \_\_\_\_\_

**PROF. NO.** \_\_\_\_\_

**STATE** \_\_\_\_\_

**FOR THE CITY OF HOUSTON**

**DEPARTMENT OF PUBLIC WORKS AND ENGINEERING**

**ENGINEER** \_\_\_\_\_

**PROF. NO.** \_\_\_\_\_

**STATE** \_\_\_\_\_

**FOR THE CITY OF HOUSTON**

**DEPARTMENT OF PUBLIC WORKS AND ENGINEERING**

**ENGINEER** \_\_\_\_\_

**PROF. NO.** \_\_\_\_\_

**STATE** \_\_\_\_\_

**FOR THE CITY OF HOUSTON**

**DEPARTMENT OF PUBLIC WORKS AND ENGINEERING**

**ENGINEER** \_\_\_\_\_

**PROF. NO.** \_\_\_\_\_

**STATE** \_\_\_\_\_

**FOR THE CITY OF HOUSTON**

**DEPARTMENT OF PUBLIC WORKS AND ENGINEERING**

**ENGINEER** \_\_\_\_\_

**PROF. NO.** \_\_\_\_\_

**STATE** \_\_\_\_\_

**FOR THE CITY OF HOUSTON**

**DEPARTMENT OF PUBLIC WORKS AND ENGINEERING**

**ENGINEER** \_\_\_\_\_

**PROF. NO.** \_\_\_\_\_

**STATE** \_\_\_\_\_

**FOR THE CITY OF HOUSTON**

**DEPARTMENT OF PUBLIC WORKS AND ENGINEERING**

**ENGINEER** \_\_\_\_\_

**PROF. NO.** \_\_\_\_\_

**STATE** \_\_\_\_\_

**FOR THE CITY OF HOUSTON**

**DEPARTMENT OF PUBLIC WORKS AND ENGINEERING**

**ENGINEER** \_\_\_\_\_

**PROF. NO.** \_\_\_\_\_

**STATE** \_\_\_\_\_

**FOR THE CITY OF HOUSTON**

**DEPARTMENT OF PUBLIC WORKS AND ENGINEERING**

**ENGINEER** \_\_\_\_\_

**PROF. NO.** \_\_\_\_\_

**STATE** \_\_\_\_\_

**FOR THE CITY OF HOUSTON**

**DEPARTMENT OF PUBLIC WORKS AND ENGINEERING**

**ENGINEER** \_\_\_\_\_

**PROF. NO.** \_\_\_\_\_

**STATE** \_\_\_\_\_

**FOR THE CITY OF HOUSTON**

**DEPARTMENT OF PUBLIC WORKS AND ENGINEERING**

**ENGINEER** \_\_\_\_\_

**PROF. NO.** \_\_\_\_\_

**STATE** \_\_\_\_\_

**FOR THE CITY OF HOUSTON**

**DEPARTMENT OF PUBLIC WORKS AND ENGINEERING**

**ENGINEER** \_\_\_\_\_

**PROF. NO.** \_\_\_\_\_

**STATE** \_\_\_\_\_





**BENCHMARKS**

1. THE BENCHMARK DATA IS AS SHOWN ON THE ATTACHED SHEETS. THE USER SHALL VERIFY THE BENCHMARK DATA AND THE LOCATION OF THE BENCHMARKS PRIOR TO CONSTRUCTION. THE USER SHALL BE RESPONSIBLE FOR THE ACCURACY OF THE BENCHMARK DATA AND THE LOCATION OF THE BENCHMARKS.

2. THE BENCHMARK DATA IS AS SHOWN ON THE ATTACHED SHEETS. THE USER SHALL VERIFY THE BENCHMARK DATA AND THE LOCATION OF THE BENCHMARKS PRIOR TO CONSTRUCTION. THE USER SHALL BE RESPONSIBLE FOR THE ACCURACY OF THE BENCHMARK DATA AND THE LOCATION OF THE BENCHMARKS.

**PRIVATE UTILITY LINES SHOWN**

1. THE PRIVATE UTILITY LINES SHOWN ON THIS PLAN ARE BASED ON RECORD DRAWINGS AND FIELD SURVEY DATA. THE USER SHALL VERIFY THE LOCATION AND DEPTH OF THE PRIVATE UTILITY LINES PRIOR TO CONSTRUCTION. THE USER SHALL BE RESPONSIBLE FOR THE ACCURACY OF THE PRIVATE UTILITY LINES SHOWN ON THIS PLAN.

2. THE PRIVATE UTILITY LINES SHOWN ON THIS PLAN ARE BASED ON RECORD DRAWINGS AND FIELD SURVEY DATA. THE USER SHALL VERIFY THE LOCATION AND DEPTH OF THE PRIVATE UTILITY LINES PRIOR TO CONSTRUCTION. THE USER SHALL BE RESPONSIBLE FOR THE ACCURACY OF THE PRIVATE UTILITY LINES SHOWN ON THIS PLAN.

**WARRANTY NOTICE**

THE ENGINEER'S RESPONSIBILITY IS LIMITED TO THE DESIGN AND CONSTRUCTION OF THE PROJECT AS SHOWN ON THESE DRAWINGS. THE ENGINEER DOES NOT WARRANT THE ACCURACY OF THE BENCHMARK DATA OR THE LOCATION OF THE BENCHMARKS. THE USER SHALL BE RESPONSIBLE FOR THE ACCURACY OF THE BENCHMARK DATA AND THE LOCATION OF THE BENCHMARKS.

**SEAL**

Professional Engineer Seal for William R. Taylor, State of Texas, License No. 12345. The seal is circular with the text "WILLIAM R. TAYLOR" and "STATE OF TEXAS" around the perimeter, and "12345" in the center.

**PROPOSED**

**PLAN AND PROFILE**

**VIA MAZZINI**

**STA. 20+00 TO 30+00**

**CITY OF HOUSTON**

**DEPARTMENT OF PUBLIC WORKS AND INSPECTION**

**APPROVED FOR CONSTRUCTION**

**DATE**

**APPROVED FOR CONSTRUCTION**

**DATE**

**APPROVED FOR CONSTRUCTION**

**DATE**

**APPROVED FOR CONSTRUCTION**

**DATE**

**APPROVED FOR CONSTRUCTION**

**DATE**

**APPROVED FOR CONSTRUCTION**

**DATE**

**APPROVED FOR CONSTRUCTION**

**DATE**

**APPROVED FOR CONSTRUCTION**

**DATE**

**APPROVED FOR CONSTRUCTION**

**DATE**

**APPROVED FOR CONSTRUCTION**

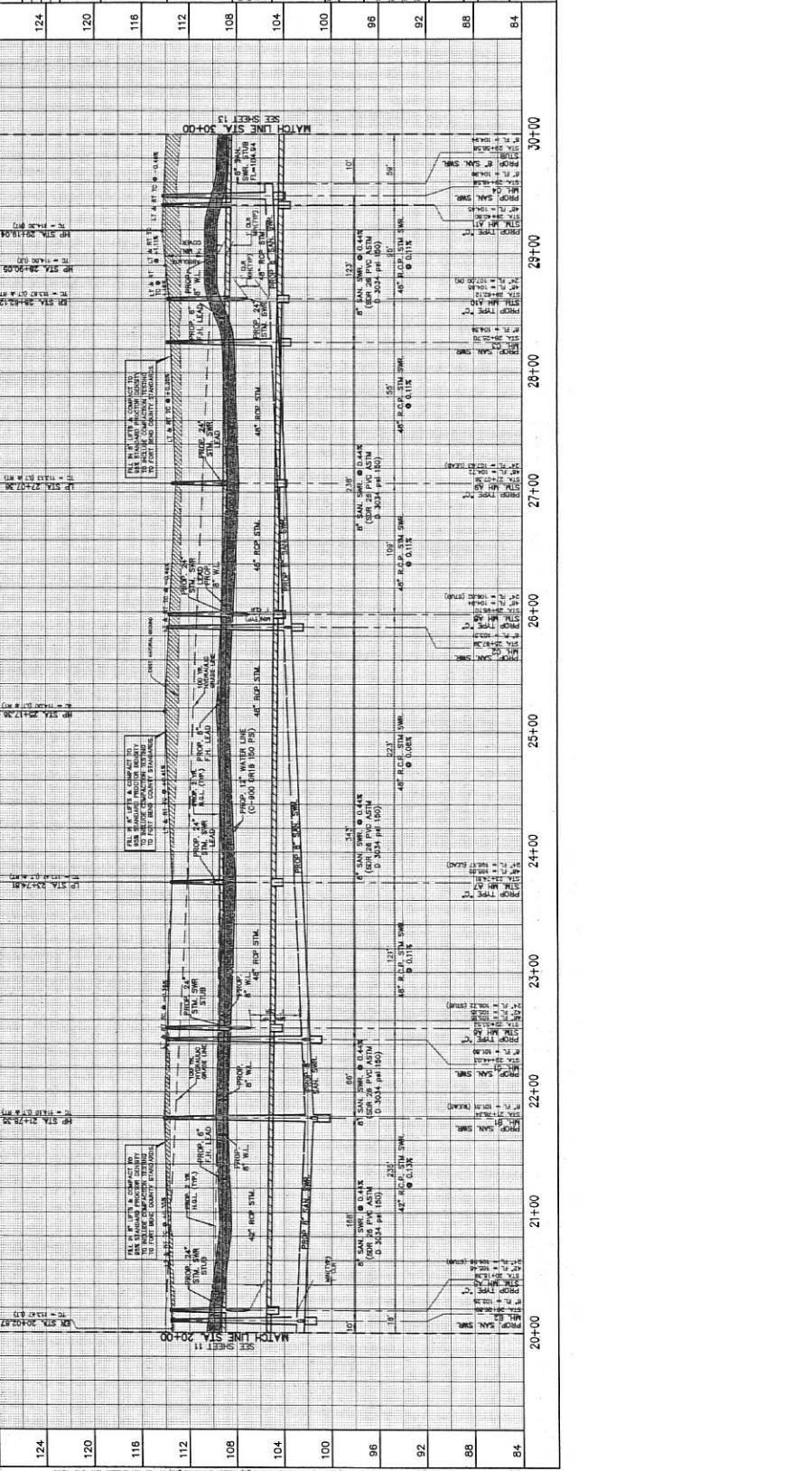
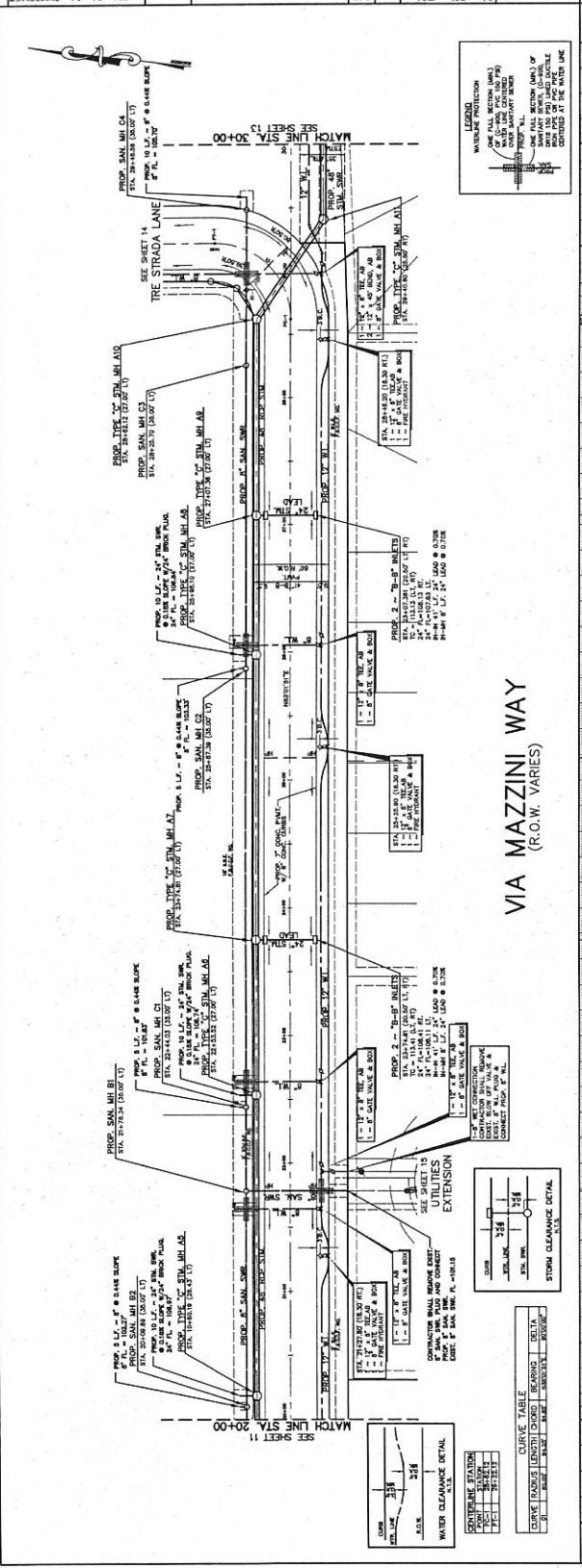

**124**

**120**

**116**

**112**

**108**

**104**

**100**

**96**

**92**

**88**

**84**

**20+00**

**21+00**

**22+00**

**23+00**

**24+00**

**25+00**

**26+00**

**27+00**

**28+00**

**29+00**

**30+00**

**2 OF 23**





**BENCHMARKS**

1. THE BENCHMARK DATA SHOWN ON THIS PLAN IS FOR INFORMATION ONLY. THE ENGINEER HAS NOT VERIFIED THE DATA AND IS NOT RESPONSIBLE FOR ITS ACCURACY.

2. THE BENCHMARK DATA SHOWN ON THIS PLAN IS FOR INFORMATION ONLY. THE ENGINEER HAS NOT VERIFIED THE DATA AND IS NOT RESPONSIBLE FOR ITS ACCURACY.

3. THE BENCHMARK DATA SHOWN ON THIS PLAN IS FOR INFORMATION ONLY. THE ENGINEER HAS NOT VERIFIED THE DATA AND IS NOT RESPONSIBLE FOR ITS ACCURACY.

4. THE BENCHMARK DATA SHOWN ON THIS PLAN IS FOR INFORMATION ONLY. THE ENGINEER HAS NOT VERIFIED THE DATA AND IS NOT RESPONSIBLE FOR ITS ACCURACY.

5. THE BENCHMARK DATA SHOWN ON THIS PLAN IS FOR INFORMATION ONLY. THE ENGINEER HAS NOT VERIFIED THE DATA AND IS NOT RESPONSIBLE FOR ITS ACCURACY.

**NOTES**

1. THE UTILITY LINES SHOWN ON THIS PLAN ARE FOR INFORMATION ONLY. THE ENGINEER HAS NOT VERIFIED THE DATA AND IS NOT RESPONSIBLE FOR ITS ACCURACY.

2. THE UTILITY LINES SHOWN ON THIS PLAN ARE FOR INFORMATION ONLY. THE ENGINEER HAS NOT VERIFIED THE DATA AND IS NOT RESPONSIBLE FOR ITS ACCURACY.

3. THE UTILITY LINES SHOWN ON THIS PLAN ARE FOR INFORMATION ONLY. THE ENGINEER HAS NOT VERIFIED THE DATA AND IS NOT RESPONSIBLE FOR ITS ACCURACY.

4. THE UTILITY LINES SHOWN ON THIS PLAN ARE FOR INFORMATION ONLY. THE ENGINEER HAS NOT VERIFIED THE DATA AND IS NOT RESPONSIBLE FOR ITS ACCURACY.

5. THE UTILITY LINES SHOWN ON THIS PLAN ARE FOR INFORMATION ONLY. THE ENGINEER HAS NOT VERIFIED THE DATA AND IS NOT RESPONSIBLE FOR ITS ACCURACY.

**DATE** \_\_\_\_\_

**SCALE** \_\_\_\_\_

**PROJECT** \_\_\_\_\_

**CLIENT** \_\_\_\_\_

**ENGINEER** \_\_\_\_\_

**PROF. NO.** \_\_\_\_\_

**STATE** \_\_\_\_\_

**PROPOSED**

**PLAN**

**UTILITIES EXTENSION**

**TO EXISTING LAKES OF BELLA TERRA**

**SECTION THIRTY THREE**

**(40' ESMT.)**

**LAKES OF BELLA TERRA**

**VA MAZZINI WAY**

**FORT BEND COUNTY, TEXAS**

**PROPOSED**

**PLAN**

**UTILITIES EXTENSION**

**TO FUTURE LAKES OF BELLA TERRA**

**SECTION THIRTY SIX**

**(60' R.O.W.)**

**LAKES OF BELLA TERRA**

**VA MAZZINI WAY**

**FORT BEND COUNTY, TEXAS**

**DATE** \_\_\_\_\_

**SCALE** \_\_\_\_\_

**PROJECT** \_\_\_\_\_

**CLIENT** \_\_\_\_\_

**ENGINEER** \_\_\_\_\_

**PROF. NO.** \_\_\_\_\_

**STATE** \_\_\_\_\_

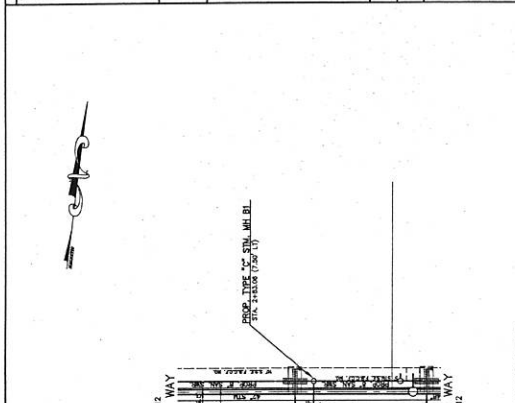

**UTILITIES EXTENSION**

**TO EXISTING LAKES OF BELLA TERRA**

**SECTION THIRTY THREE**

**(40' ESMT.)**

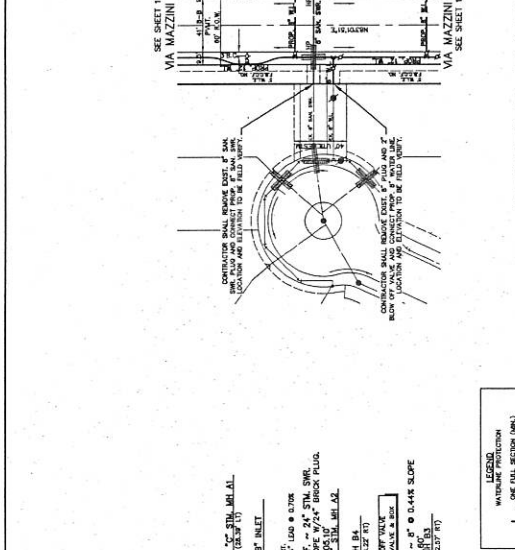

**UTILITIES EXTENSION**

**TO FUTURE LAKES OF BELLA TERRA**

**SECTION THIRTY SIX**

**(60' R.O.W.)**

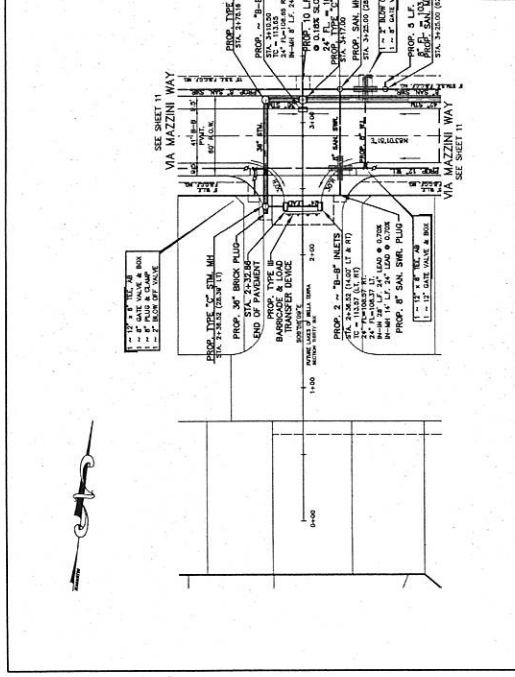

**UTILITIES EXTENSION**

**TO EXISTING LAKES OF BELLA TERRA**

**SECTION THIRTY THREE**

**(40' ESMT.)**



**UTILITIES EXTENSION**

**TO FUTURE LAKES OF BELLA TERRA**

**SECTION THIRTY SIX**

**(60' R.O.W.)**

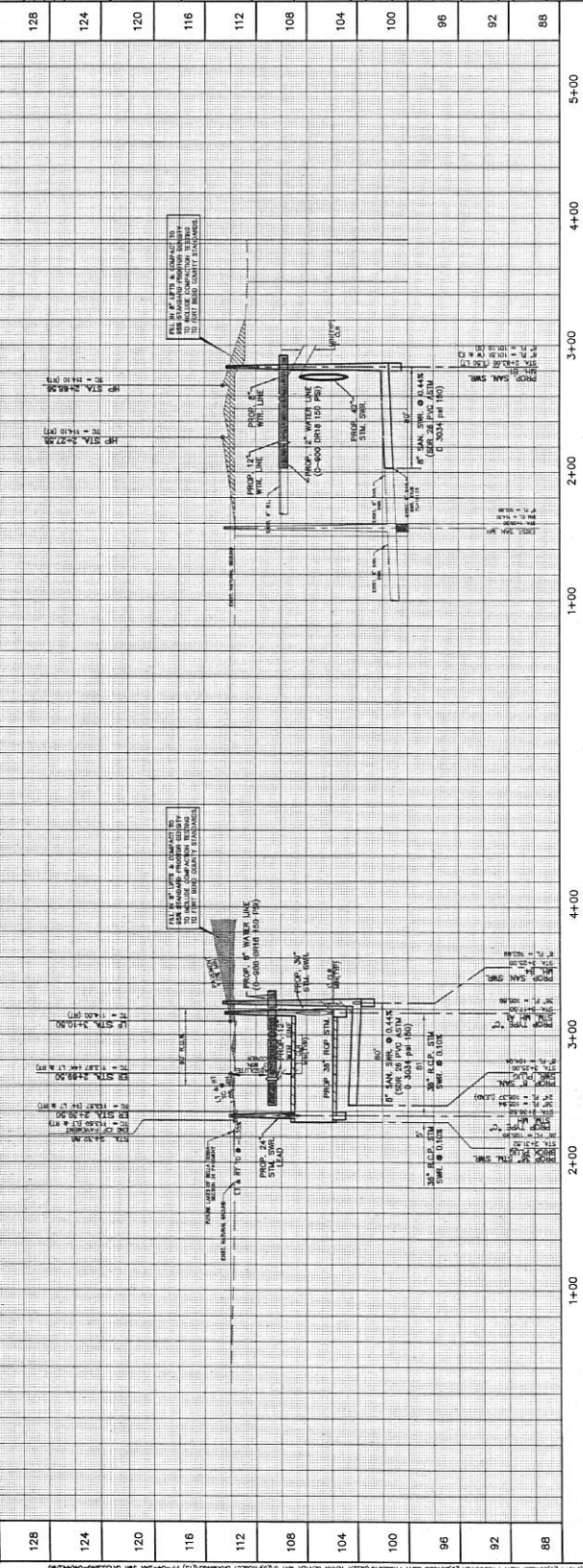

NO.	DESCRIPTION
128	128
124	124
120	120
116	116
112	112
108	108
104	104
100	100
96	96
92	92
88	88





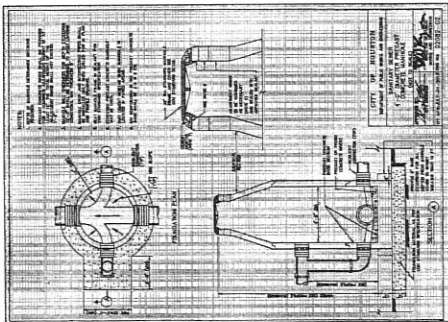

**SANITARY SEWER 4'-0" DIAMETER  
PRECAST CONCRETE MANHOLE**  
BY DATE: JAN-70, 2010  
ENG. NO. 10328-02

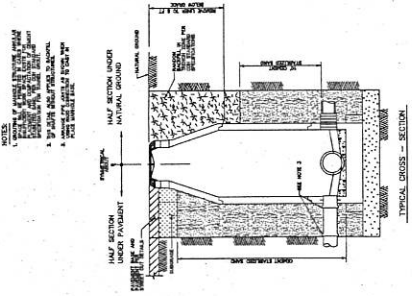

**SANITARY SEWER BACKFILL OF SHAFTS**  
BY DATE: OCT-14-02  
ENG. NO. 02071-02

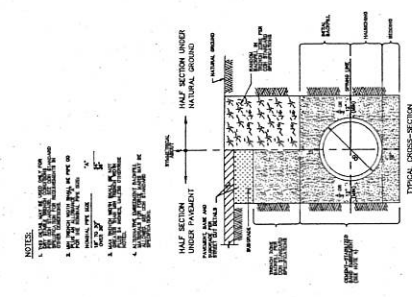

**SANITARY SEWER BEDDING AND BACKFILL  
FOR DRY STABLE TRENCH**  
BY DATE: OCT-14-02  
ENG. NO. 02071-02

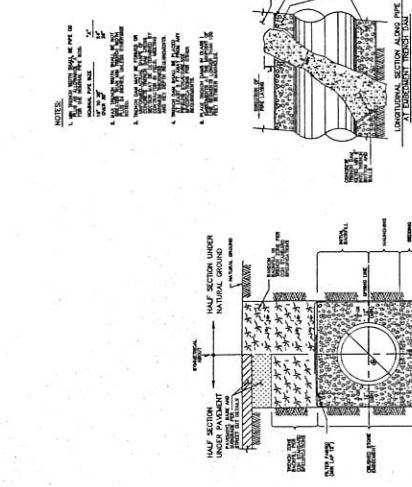

**SANITARY SEWER EMBEDMENT AND TRENCH ZONE  
BACKFILL FOR DRY OR WET STABLE TRENCH**  
BY DATE: OCT-14-02

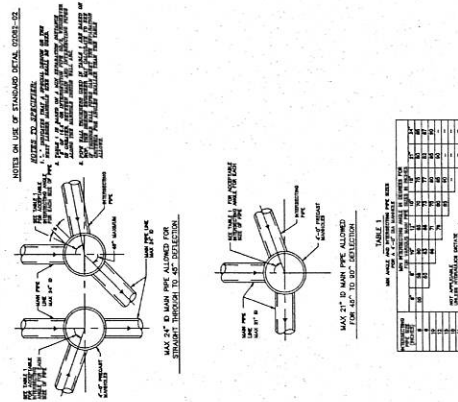

**SANITARY SEWER 4'-0" DIAMETER PRECAST  
CONCRETE MANHOLE NOTES**  
BY DATE: OCT-03-02  
ENG. NO. 02028-02

TABLE 1  
MANHOLE COVER WEIGHTS

MANHOLE COVER WEIGHT (LBS)	MANHOLE COVER WEIGHT (KGS)
100	45.4
150	68.0
200	90.7
250	113.4
300	136.1
350	158.8
400	181.4
450	204.1
500	226.8
550	249.5
600	272.2
650	294.9
700	317.5
750	340.2
800	362.9
850	385.6
900	408.3
950	431.0
1000	453.7

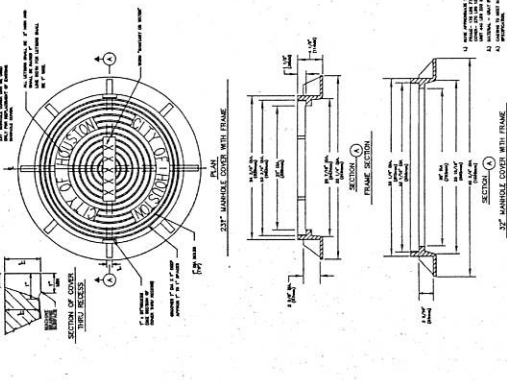

**SANITARY SEWER AND WATER  
MANHOLE FRAME AND COVER**  
BY DATE: OCT-08-08

**STANDARD SANITARY SEWER  
DETAILS**

DATE: \_\_\_\_\_  
 APPROVED: \_\_\_\_\_  
 TITLE: \_\_\_\_\_  
 CITY OF HOUSTON  
 DEPARTMENT OF PUBLIC WORKS AND UTILITIES

FILE NO. \_\_\_\_\_  
 SHEET 18 OF 23

LAKAS OF BELLA TERRA, VA MAZZINI WAY RESERVE SEC 1, FORT BEND COUNTY, TEXAS  
 PROJECT NO. 0404  
 DATE: 08/20/10  
 SHEET 18 OF 23  
 PREPARED BY: \_\_\_\_\_  
 CHECKED BY: \_\_\_\_\_  
 DATE: \_\_\_\_\_  
 TITLE: \_\_\_\_\_  
 CITY OF HOUSTON  
 DEPARTMENT OF PUBLIC WORKS AND UTILITIES



  
 MICHAEL J. ...
   
 114019
   
 STATE OF TEXAS
   
 MECHANICAL ENGINEERING - STORMWATER MANAGEMENT
   
 APPROVED FOR THE CITY OF HOUSTON
   
 DATE: 11/14/19
   
 PROJECT: STANDARD STORM WATER POLLUTION PREVENTION PLAN
   
 SHEET: 2 OF 23

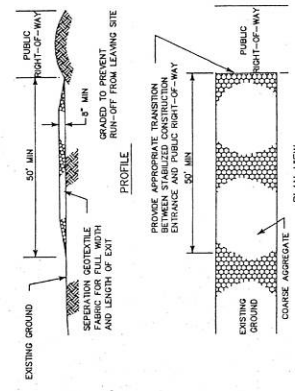

- CONSTRUCTION NOTES:**
1. SOFT SHALL BE AS SHOWN ON THE CONSTRUCTION DRAWINGS, BUT NOT LESS THAN 8 INCHES.
  2. THICKNESS SHALL BE NOT LESS THAN 8 INCHES.
  3. WIDTH SHALL BE NOT LESS THAN FULL WIDTH OF ALL POINTS OF INGRESS OR EGRESS.
  4. STABILIZATION FOR OTHER AREAS SHALL HAVE THE SAME AGGREGATE THICKNESS AND SHOWN ON THE CONSTRUCTION DRAWINGS.
  5. STABILIZED AREA MAY BE WIDENED OR LENGTHENED TO ACCOMMODATE A TRUCK WASHING AREA. AN OUTLET SEDIMENT TRAP MUST BE PROVIDED FOR THE TRUCK WASHING AREA.
  6. SEE SECTION 0188B - STABILIZED CONSTRUCTION EXIT.
  7. SEGMENT FOR THE DURATION OF THE PROJECT.

**STABILIZED CONSTRUCTION EXIT**



- CONSTRUCTION NOTES:**
1. SET POSTS AT REQUIRED SPACING.
  2. EDGEMATE A 4" TRUSS UPLOAKE ALONG THE LINE OF STAKE.
  3. ATTACH FILTER MATERIAL TO STAKES AND EXTEND IT INTO THE TRENCH.
  4. BACKFILL AND COMPACT THE EXCAVATED SOIL.

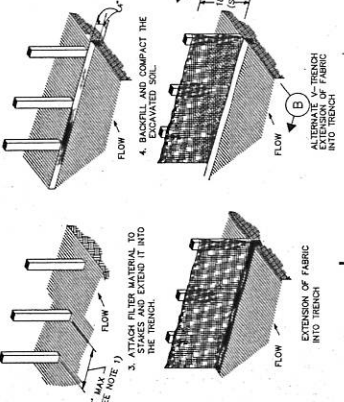

- CONSTRUCTION NOTES:**
1. 2 INCH THICK BY 2 INCH WOODEN STAKES TO BE SET AT MAX SPACING OF 3 FEET AND EMBEDDED A MIN OF 6 INCHES.
  2. ATTACH FILTER FABRIC TO WOODEN STAKES. FILTER FABRIC HEIGHT OF 36 INCHES ABOVE FINISH GROUND. STAKES SHOULD BE OVERLAPPED 6 INCHES AT THE POSTS AND FOLDED.
  3. WHEN TWO SECTIONS OF FILTER FABRIC ADJOIN EACH OTHER THEY SHALL BE OVERLAPPED 6 INCHES AT THE POSTS.
  4. SEE SECTION 0197 - FILTER FABRIC FENCE.

**FILTER FABRIC FENCE**

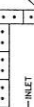

- CONSTRUCTION NOTES:**
1. SET POSTS AND EDGEMATE A 4" TRUSS UPLOAKE ALONG LINE OF POSTS (SEE NOTE 1).
  2. SECURE WIRE FASTENING TO POSTS (SEE NOTE 2).
  3. ATTACH FILTER MATERIAL TO WIRE TRENCH AND EXTEND IT INTO THE TRENCH (SEE NOTE 3).
  4. BACKFILL AND COMPACT THE EXCAVATED SOIL.

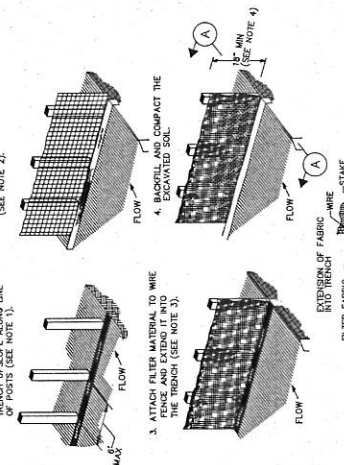

- CONSTRUCTION NOTES:**
1. SET 2 INCH BY 2 INCH WOODEN STAKES SPACED A MAX OF 6 FEET APART AND EMBEDDED A MIN OF 12 INCHES.
  2. FENCE POSTS WITH STAPLES EXTENDED SECURELY TO FILTER FABRIC.
  3. FILTER FABRIC TO BE FASTENED SECURELY TO WOODEN STAKES WITH TIES SPACED EVERY 24 INCHES AT TOP AND BOTTOM.
  4. MINIMUM HEIGHT OF FILTER SHOULD BE 18 INCHES AND A MAXIMUM OF 36 INCHES ABOVE MATERIAL GROUND.
  5. WHEN TWO SECTIONS OF FILTER CLOTH ADJOIN EACH OTHER THEY SHALL BE OVERLAPPED 6 INCHES AT THE POSTS.
  6. SEE SECTION 0198B - REINFORCED FILTER FABRIC BARRIER.

**REINFORCED FILTER FABRIC BARRIER**



**"V-DITCH" SECTION/ELEVATION**

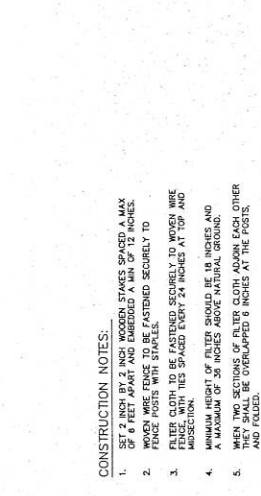

- CONSTRUCTION NOTES:**
1. SET 2 INCH BY 2 INCH WOODEN STAKES SPACED A MAX OF 6 FEET APART AND EMBEDDED A MIN OF 12 INCHES.
  2. FENCE POSTS WITH STAPLES EXTENDED SECURELY TO FILTER FABRIC.
  3. FILTER FABRIC TO BE FASTENED SECURELY TO WOODEN STAKES WITH TIES SPACED EVERY 24 INCHES AT TOP AND BOTTOM.
  4. MINIMUM HEIGHT OF FILTER SHOULD BE 18 INCHES AND A MAXIMUM OF 36 INCHES ABOVE MATERIAL GROUND.
  5. WHEN TWO SECTIONS OF FILTER CLOTH ADJOIN EACH OTHER THEY SHALL BE OVERLAPPED 6 INCHES AT THE POSTS.
  6. SEE SECTION 0198B - REINFORCED FILTER FABRIC BARRIER.

**STRAW BALE DROP INLET PROTECTION BARRIER**



**SILT FENCE INLET PROTECTION BARRIER**



**WOOD OR METAL STAKE SILT FENCE**



**COMPACTED SOIL TO PREVENT PILING**



**WOOD OR METAL STAKE SILT FENCE**



**WOOD OR METAL STAKE SILT FENCE**



**WOOD OR METAL STAKE SILT FENCE**



**WOOD OR METAL STAKE SILT FENCE**





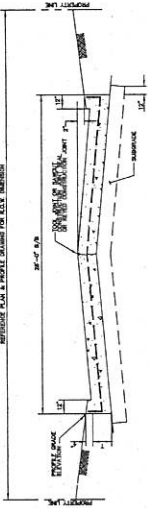

TYPICAL SECTIONS FOR CONCRETE CURB AND GUTTER SECTION FOR 36\"/>

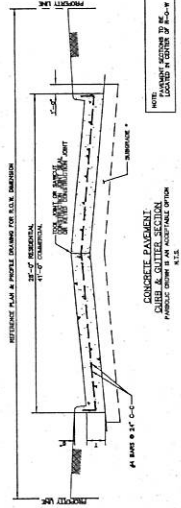

TYPICAL SECTIONS FOR MONOLITHIC CURB FOR RESIDENTIAL STREETS

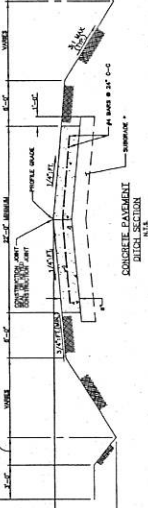

TYPICAL SECTIONS FOR CONCRETE CURB AND GUTTER SECTION FOR 48\"/>

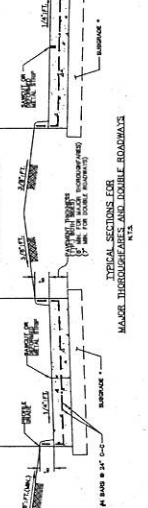

TYPICAL SECTIONS FOR MONOLITHIC CURB FOR RESIDENTIAL STREETS

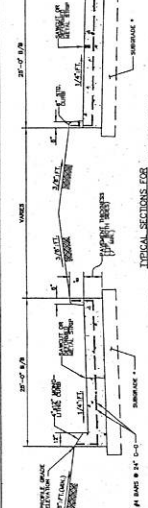

TYPICAL SECTIONS FOR CONCRETE CURB AND GUTTER SECTION FOR 48\"/>

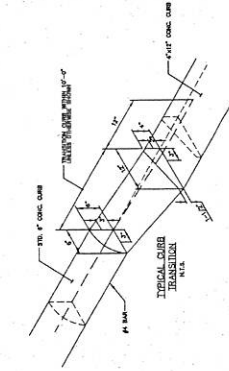

TYPICAL CURB TRANSITION

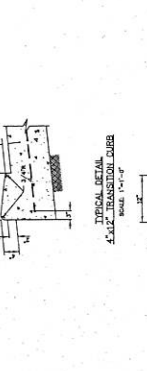

TYPICAL CURB

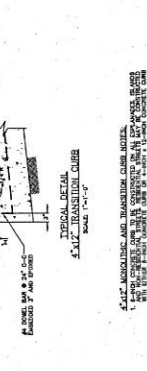

TYPICAL CURB

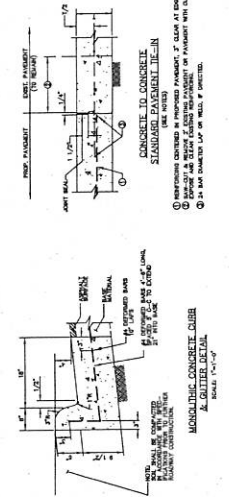

CONCRETE TO CONCRETE TRANSITION

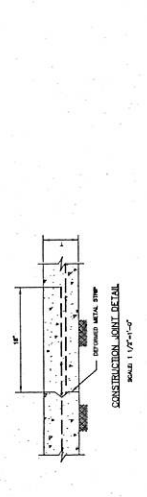

CONSTRUCTION JOINT DETAIL

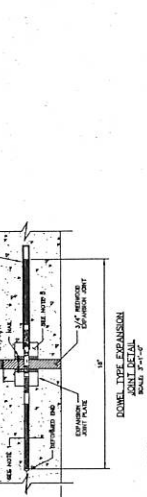

DOME TYPE EXPANSION JOINT DETAIL

NOTES:  
 1. ALL REINFORCEMENT SHALL BE PLACED IN ACCORDANCE WITH THE LATEST EDITION OF THE ACI 308R-90.  
 2. ALL REINFORCEMENT SHALL BE PLACED IN ACCORDANCE WITH THE LATEST EDITION OF THE ACI 308R-90.  
 3. ALL REINFORCEMENT SHALL BE PLACED IN ACCORDANCE WITH THE LATEST EDITION OF THE ACI 308R-90.  
 4. ALL REINFORCEMENT SHALL BE PLACED IN ACCORDANCE WITH THE LATEST EDITION OF THE ACI 308R-90.  
 5. ALL REINFORCEMENT SHALL BE PLACED IN ACCORDANCE WITH THE LATEST EDITION OF THE ACI 308R-90.

**FORT BEND COUNTY  
ENGINEERING DEPARTMENT**

PROJECT NO. **LAKES OF BELLA TERRA CENTER WAY - 3**

DATE **04/04**

BY **BCC**

CHECKED BY **BCC**

SCALE **N.T.S.**

PROJECT NO. **00\_03**

STANDARD PAVING DETAILS SHEET

**TABLE #1**  
TYPICAL LENGTH OF ESPRANADE OPENING "C" FOR PUBLIC STREET

ESPRANADE INTERSECTION	NO. LTB (1)	1 LB (1)	2 LB (1)
UNDIVIDED STREET	45'	55'	65'
DIVIDED STREET	D+10'	D+10'	D+10'

**RADIUS DIMENSIONS**

ESPRANADE	PR1	PR2
<8'	N/A	W/2
8'-35'	90'	W/2
>35'	N/A	15'

**NOTES:**  
(1) LEFT TURN BAY CONTAINING OF ESPRANADE AND/OR ESPRANADE AND/OR LEFT TURN BAY

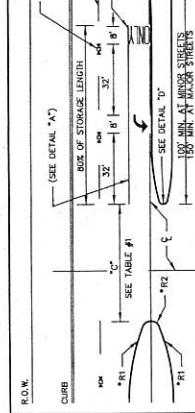
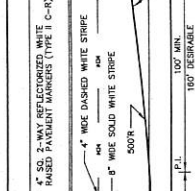
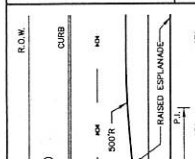
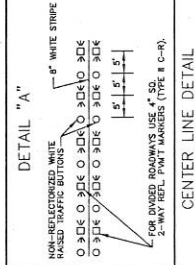
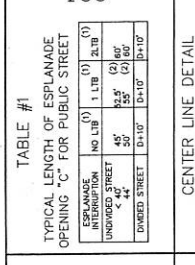

**PAYEMENT MARKER LEGEND**

SYMBOL	DESCRIPTION
4" X 4" REFLECTORIZED RAISED PAYEMENT MARKER	INDICATES DIRECTION OF TRAFFIC FLOW
NON-REFLECTIVE 4" DIA. RAISED TRAFFIC BUTTON	

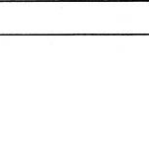
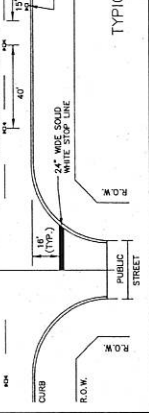
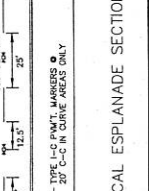
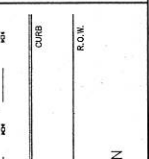
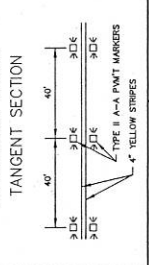
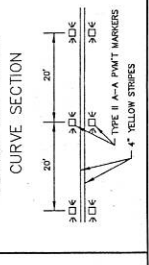
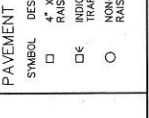

**NOTES:**

- ALL STRIPING & MARKERS SHALL CONFORM WITH THE TEXAS TRAFFIC CONTROL DEVICES FOR STREETS AND HIGHWAYS.
- ALL TRAFFIC BUTTONS AND MARKERS SHALL BE INSTALLED WITHIN THE TRAFFIC BAY.
- LEFT TURN STORAGE BAYS SHALL BE A MIN. OF 100' AT MAJOR STREETS AND A MIN. OF 150' AT MINOR STREETS.
- LEFT TURN STORAGE BAYS SHALL BE APPROX. 1000' INTERVALS WITHIN TWO-WAY LEFT TURN SECTION.
- WITHIN A TANGENT SECTION THE TYPE I-C PAYEMENT MARKERS AND BUTTONS SHALL BE INSTALLED AT 40' C-C ON ROADWAYS WITHOUT CURB AND BUTTONS.

**ESPRANADE MARKERS**  
ESPRANADE MARKERS SHALL BE PAINTED YELLOW

**TYPICAL CURB SECTION**  
PAINT FROM THE BACK OF CURB TO THE OUTER LINE

**TYPICAL TWO-WAY LEFT TURN SECTION**

**DETAIL "B"**

**DETAIL "C"**

**TWO-WAY LEFT TURN CURVE SECTION**

**TWO-WAY TANGENT SECTION**

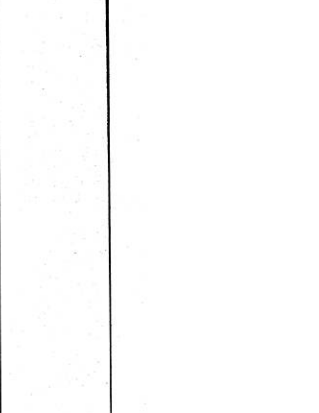
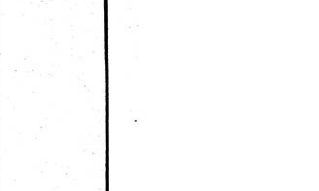
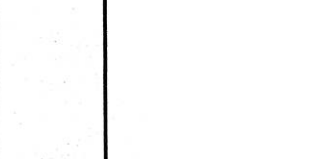
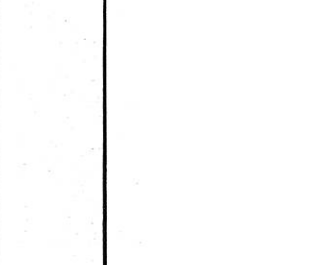
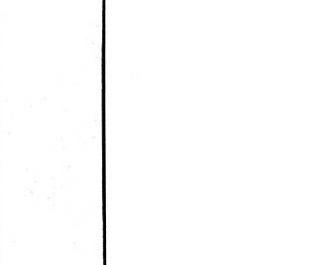
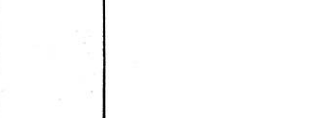
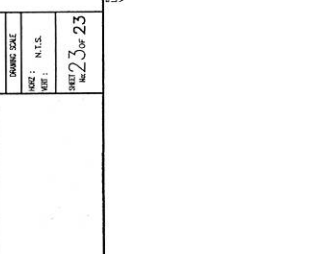
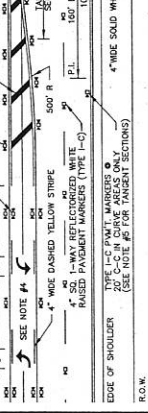
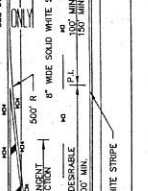
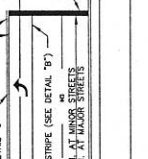
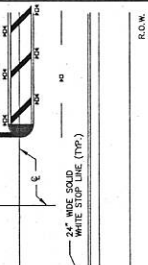
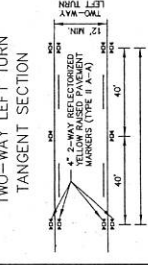
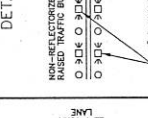
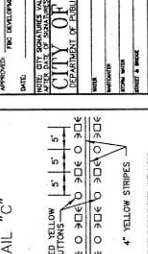
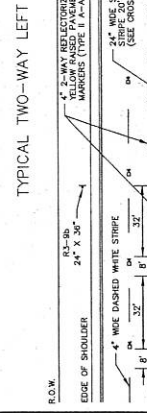
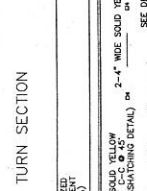
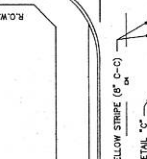
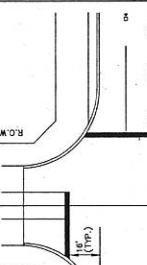
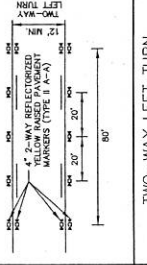
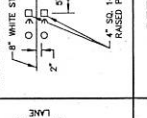
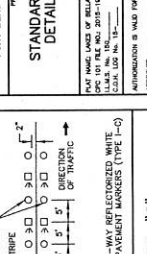
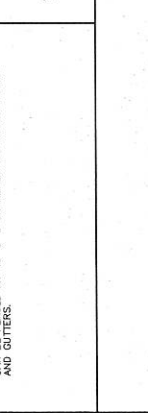
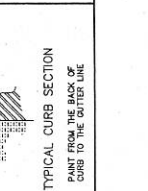
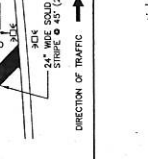
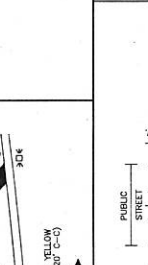
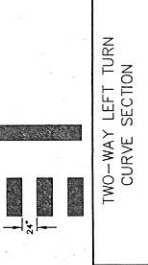
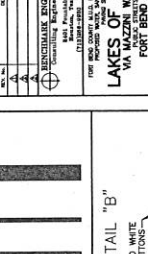

**STANDARD STRIPING DETAILS SHEET**

FOR THE CITY OF HOUSTON, TEXAS

APPROVED: THE DEVELOPMENT COORDINATOR

DATE: 11/15/19

FOR THE CITY OF HOUSTON, TEXAS

APPROVED: THE DEVELOPMENT COORDINATOR

DATE: 11/15/19

FOR THE CITY OF HOUSTON, TEXAS

APPROVED: THE DEVELOPMENT COORDINATOR

DATE: 11/15/19

**LAKES OF BELLA TERRA**  
VA. MOZZONI WAY, BESSIE SEC 1  
FORT BEND COUNTY, TEXAS

**CITY OF HOUSTON**  
DEPARTMENT OF PUBLIC WORKS AND INSURANCE

FILE NO. \_\_\_\_\_  
DRAWING SCALE \_\_\_\_\_  
DATE: N.T.S.  
SHEET 23 OF 23



BENCHMARK ENGINEERING CORPORATION  
ENGINEERING • PLANNING • LAND SURVEYING

TEXAS BOARD OF PROFESSIONAL ENGINEERS  
REGISTRATION NUMBER F-6788  
2401 FOUNTAINVIEW DRIVE, SUITE 500  
HOUSTON, TEXAS 77057  
(713) 266-9930

CONSULTINGENGINEERS

FAX (713) 266-3804



November 3, 2015

Honorable Robert E. Hebert  
Fort Bend County Judge  
309 S. 4<sup>th</sup> Street, Suite 719  
Richmond, Texas 77469

Re: Sponsorship Letter for Proposed Temporary Street tie-In for  
**Una Strada Lane, Due Strada Lane and Tre Strada Lane to FM 1093**  
In Fort Bend County Municipal Utility District No. 133,

Plat name: **Via Mazzinni Way Reserve Sec. 1**

Dear Mr. Hebert:

As required by the Texas Department of Transportation (TXDOT), we are in the process of preparing a temporary permit application package to submit to TXDOT for the proposed temporary street tie-in of Una Strada Lane, Due Strada Lane and Tre Strada Lane to FM 1093. The proposed tie-in will be a 3-24' wide minimum temporary asphalt roadways on the south side of FM 1093 which will transition to a two lane concrete roadway with curb. The temporary roadways will only be used until the permanent feeder road for the West Park Toll road is constructed. These roadways will be constructed in accordance with Fort Bend County Design Standards & Requirements at no expense to the county. The developer, is **L.O.B. Limited Partnership**, will finance the cost of the construction. Please find attached 2 – 11"x17" reduced Fort Bend County final drawings of the proposed tie-in, as required by TXDOT street permit.

As part of the requirements by TXDOT, a sponsorship letter from Fort Bend County is necessary as a part of the submittal package. As the engineer for this development, I am hereby respectfully requesting Fort Bend County's sponsorship for this construction.

Please call me if you have any questions or need further information.

Sincerely,

BENCHMARK ENGINEERING CORPORATION

William H. Saour, P.E.  
Project Engineer

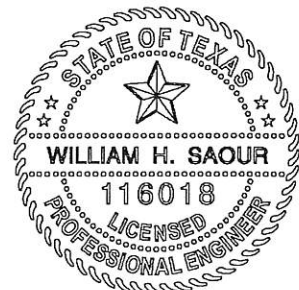

cc: Ms. Mary Jane Sowa – FBC Engineering

**FORT BEND COUNTY M.U.D. NO. 133  
CONSTRUCTION PLANS FOR PROPOSED TEMPORARY ASPHALT PAVEMENT  
CONNECTION TO F.M. 1093 FOR UNA STRADA LANE,  
DUE STRADA LANE AND TRE STRADA LANE  
SERVING**

**LAKES OF BELLA TERRA  
PUBLIC STREETS/ PUBLIC UTILITIES  
IN  
FORT BEND COUNTY, TEXAS**

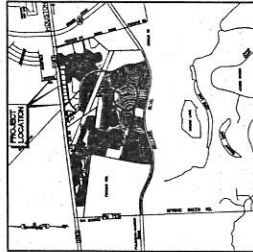
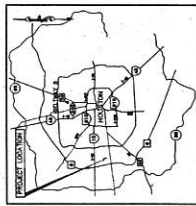

**VICINITY MAP**  
SHOWS LOCATION OF PROJECT AND SURROUNDING AREAS.  
FOR MORE INFORMATION CONTACT THE ENGINEER.  
DATE: 10/15/2003

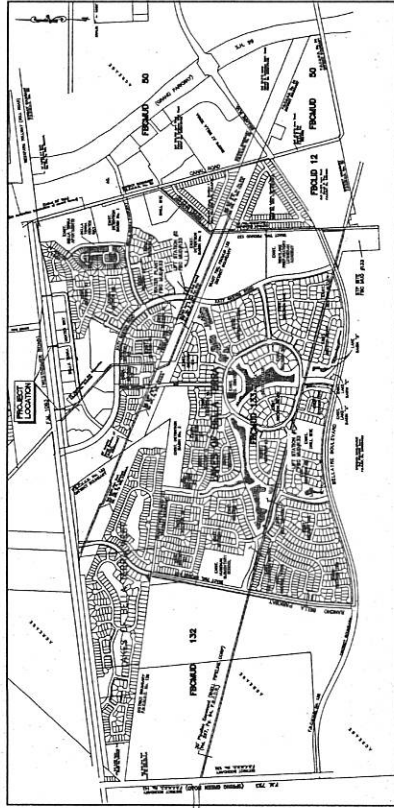

**DRAWING INDEX**

SHEET	DESCRIPTION
1	COVER SHEET
2	GENERAL NOTES
3	CONSTRUCTION PLAN
4	UTILITY PLAN
5	PROPOSED ASPHALT PAVEMENT PLAN
6	PROPOSED ASPHALT PAVEMENT PLAN
7	PROPOSED ASPHALT PAVEMENT PLAN
8	PROPOSED ASPHALT PAVEMENT PLAN
9	PROPOSED ASPHALT PAVEMENT PLAN
10	PROPOSED ASPHALT PAVEMENT PLAN
11	PROPOSED ASPHALT PAVEMENT PLAN
12	PROPOSED ASPHALT PAVEMENT PLAN
13	PROPOSED ASPHALT PAVEMENT PLAN
14	PROPOSED ASPHALT PAVEMENT PLAN
15	PROPOSED ASPHALT PAVEMENT PLAN
16	PROPOSED ASPHALT PAVEMENT PLAN

OWNER: FORT BEND COUNTY  
 PROJECT: LAKES OF BELLA TERRA  
 PREPARED BY: BENCHMARK ENGINEERING CORPORATION  
 DATE: 10/15/2003  
 DRAWING INDEX

**NOTES:**  
 1. CONTRACTOR SHALL NOTIFY THE CITY OF HOUSTON, DEPARTMENT OF PUBLIC WORKS AND ENGINEERING, OFFICE OF THE CITY ENGINEER, 48 HOURS BEFORE STARTING WORK ON THIS PROJECT. TELEPHONE NO. 832-344-0000.  
 2. FLOOD INSURANCE RATE MAP  
 3. ALL WORK SHALL BE IN ACCORDANCE WITH THE CITY OF HOUSTON, TEXAS AND UNINCORPORATED AREAS.  
 4. ALL WORK SHALL BE IN ACCORDANCE WITH THE CITY OF HOUSTON, TEXAS AND UNINCORPORATED AREAS.  
 5. ALL WORK SHALL BE IN ACCORDANCE WITH THE CITY OF HOUSTON, TEXAS AND UNINCORPORATED AREAS.  
 6. ALL WORK SHALL BE IN ACCORDANCE WITH THE CITY OF HOUSTON, TEXAS AND UNINCORPORATED AREAS.

ONE CALL NOTIFICATION SYSTEM  
 CALL BEFORE YOU DIG!!  
 (NEW SERVICE AREA OUTSIDE HOUSTON)  
 (SEE ATTACHED NOTIFICATION SHEET)



BENCHMARK ENGINEERING CORPORATION 2401 FOUNDATION SUITE 500 HOUSTON, TEXAS 77057 (713) 266-9950	
SHEET NO. 1 OF 16	DATE: 10/15/2003
PROJECT: LAKES OF BELLA TERRA PUBLIC STREETS/ PUBLIC UTILITIES	DRAWING INDEX

CONSOLIDATED COMMUNICATION  
 SIGNATURE VALID FOR ONE YEAR.

ENGINEER: RICHARD W. STOLLER, P.E.  
 DATE: \_\_\_\_\_  
 THESE SIGNATURES ARE VOID IF CONSTRUCTION HAS NOT COMMENCED IN  
 (1) YEAR FROM DATE OF APPROVAL.

APPROVED: \_\_\_\_\_  
 DEVELOPMENT COORDINATOR  
 DATE: \_\_\_\_\_

**OWNERS:**  
 L.O.B. LIMITED PARTNERSHIP  
 7500 SAN FELIPE ST. SUITE #400  
 HOUSTON, TEXAS 77057  
 Ph. & (713) 952-0200

**PREPARED BY:**  
 BENCHMARK ENGINEERING CORPORATION  
 Consulting Engineers - Planners - Surveyors  
 2401 Foundation Suite 500  
 Houston, Texas 77057 U.S.A.  
 (713) 266-9950 Fax (713) 266-3804  
 Texas Board of Professional Engineers  
 License No. 14003  
 TEP25 Permit Registration Number 10004000

FROM: THE CONSTRUCTION OF THESE FACILITIES WITHIN OR BY THE DISTRICT, THE  
 TO THE JURISDICTION OF PUBLIC WORKS AND ENGINEERING, CITY OF HOUSTON, STATING THAT  
 THIS CONSTRUCTION WILL BE COMPLETED.

DATE: 10/15/2003  
 SHEET NO. 1 OF 16  
 PROJECT: LAKES OF BELLA TERRA  
 PUBLIC STREETS/ PUBLIC UTILITIES

**BENCHMARKS**

THE BENCHMARKS SHOWN ON THIS PLAN ARE THE PROPERTY OF THE TEXAS SURVEYING BOARD AND ARE TO BE USED ONLY FOR THE PURPOSES OF THIS PROJECT. ANY OTHER USE IS PROHIBITED. THE BENCHMARKS ARE TO BE MAINTAINED AND PROTECTED AT ALL TIMES. ANY DAMAGE TO A BENCHMARK SHALL BE REPAIRED AT THE OWNERS RISK AND EXPENSE. THE BENCHMARKS ARE TO BE USED IN ACCORDANCE WITH THE SURVEYING BOARD'S REGULATIONS AND STANDARDS. THE BENCHMARKS ARE TO BE USED IN ACCORDANCE WITH THE SURVEYING BOARD'S REGULATIONS AND STANDARDS. THE BENCHMARKS ARE TO BE USED IN ACCORDANCE WITH THE SURVEYING BOARD'S REGULATIONS AND STANDARDS.

**PRIVATE UTILITY LINES SHOWN**

EXISTING PRIVATE UTILITY LINES SHOWN ON THIS PLAN ARE THE PROPERTY OF THE UTILITY COMPANIES AND ARE TO BE MAINTAINED AND PROTECTED AT ALL TIMES. ANY DAMAGE TO A UTILITY LINE SHALL BE REPAIRED AT THE OWNERS RISK AND EXPENSE. THE UTILITY LINES ARE TO BE USED IN ACCORDANCE WITH THE UTILITY COMPANIES' REGULATIONS AND STANDARDS. THE UTILITY LINES ARE TO BE USED IN ACCORDANCE WITH THE UTILITY COMPANIES' REGULATIONS AND STANDARDS. THE UTILITY LINES ARE TO BE USED IN ACCORDANCE WITH THE UTILITY COMPANIES' REGULATIONS AND STANDARDS.

**DATE:** \_\_\_\_\_

**SCALE:** \_\_\_\_\_

**PROJECT:** \_\_\_\_\_

**CLIENT:** \_\_\_\_\_

**DESIGNER:** \_\_\_\_\_

**CHECKED:** \_\_\_\_\_

**APPROVED:** \_\_\_\_\_



**OVERALL STORM SEWER LAYOUT**

**LAKES OF BLANCA TERRA**

**FORT BEND COUNTY, TEXAS**

**APPROVED:** \_\_\_\_\_

**DATE:** \_\_\_\_\_

**PROJECT:** \_\_\_\_\_

**CLIENT:** \_\_\_\_\_

**DESIGNER:** \_\_\_\_\_

**CHECKED:** \_\_\_\_\_

**APPROVED:** \_\_\_\_\_

**CITY OF HOUSTON**

**DEPARTMENT OF PUBLIC WORKS AND ENGINEERING**

**FILE NO.:** \_\_\_\_\_

**DRAWING SCALE:** \_\_\_\_\_

**DATE:** \_\_\_\_\_

**BY:** \_\_\_\_\_

**CHECKED:** \_\_\_\_\_

**APPROVED:** \_\_\_\_\_

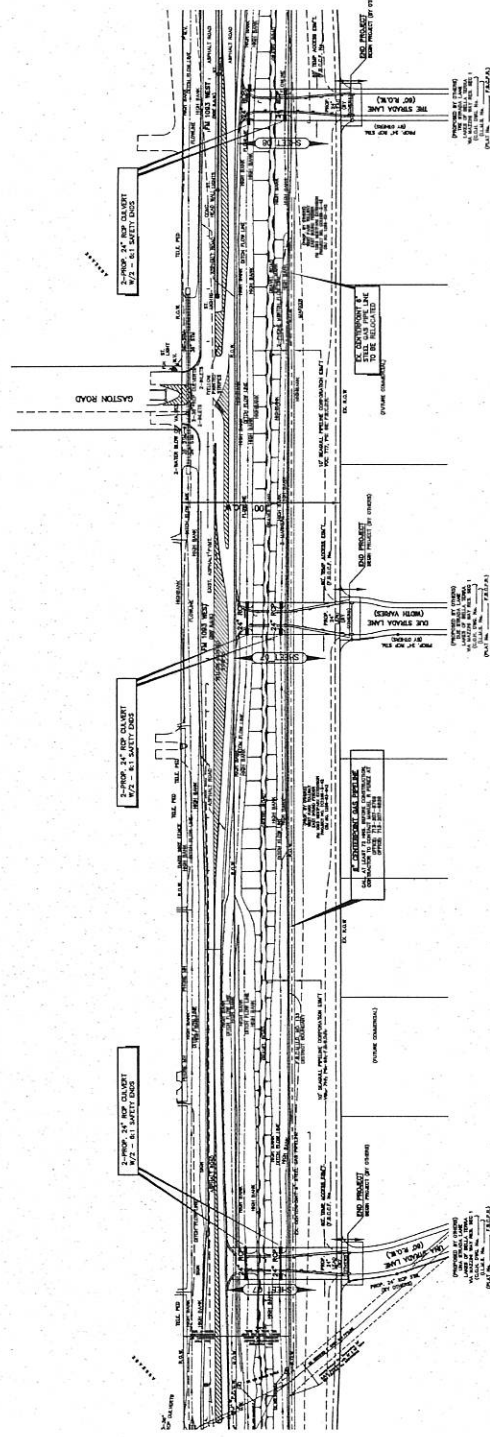

**FORT BEND COUNTY CONSTRUCTION NOTES**

1. ALL PROPOSED STORM SEWER LINES SHALL BE 12\"/>

2. ALL PROPOSED STORM SEWER LINES SHALL BE 12\"/>

3. ALL PROPOSED STORM SEWER LINES SHALL BE 12\"/>

4. ALL PROPOSED STORM SEWER LINES SHALL BE 12\"/>

5. ALL PROPOSED STORM SEWER LINES SHALL BE 12\"/>

6. ALL PROPOSED STORM SEWER LINES SHALL BE 12\"/>

7. ALL PROPOSED STORM SEWER LINES SHALL BE 12\"/>

8. ALL PROPOSED STORM SEWER LINES SHALL BE 12\"/>

9. ALL PROPOSED STORM SEWER LINES SHALL BE 12\"/>

10. ALL PROPOSED STORM SEWER LINES SHALL BE 12\"/>

**LEGEND**



**BENCHMARKS**

THESE BENCHMARKS WERE OBTAINED FROM THE TEXAS SURVEYING BOARD. THE BENCHMARKS ARE LOCATED AT THE CORNERS OF THE LAKES OF BELLA TERRA. THE BENCHMARKS ARE LOCATED AT THE CORNERS OF THE LAKES OF BELLA TERRA. THE BENCHMARKS ARE LOCATED AT THE CORNERS OF THE LAKES OF BELLA TERRA.

**LEGEND**

EXISTING  
 TYPE "A" INLET  
 TYPE "B" INLET  
 TYPE "C" INLET  
 ANTI-CLOG BOX

PROPOSED  
 TYPE "A" INLET  
 TYPE "B" INLET  
 TYPE "C" INLET  
 ANTI-CLOG BOX

**LEGEND**

ACCUMULATED ANTI-CLOG  
 ACCUMULATED C.F.E.  
 DRAINAGE AREA  
 INLET IDENTIFICATION NUMBER  
 FUTURE INLET IDENTIFICATION NUMBER  
 C.F.E. IN AREA  
 DRAINAGE BEAM POINT  
 DRAINAGE AREA LINE  
 SHEET FLIP

**FOR THE CITY OF HOUSTON**  
 DEPARTMENT OF PUBLIC WORKS AND UTILITIES

DATE: \_\_\_\_\_  
 AUTHORIZED: \_\_\_\_\_  
 APPROVED: \_\_\_\_\_

**OVERALL DRAINAGE AREA MAP**

FOR THE CITY OF HOUSTON  
 DEPARTMENT OF PUBLIC WORKS AND UTILITIES

DATE: \_\_\_\_\_  
 AUTHORIZED: \_\_\_\_\_  
 APPROVED: \_\_\_\_\_

**FOR THE CITY OF HOUSTON**  
 DEPARTMENT OF PUBLIC WORKS AND UTILITIES

DATE: \_\_\_\_\_  
 AUTHORIZED: \_\_\_\_\_  
 APPROVED: \_\_\_\_\_

**FOR THE CITY OF HOUSTON**  
 DEPARTMENT OF PUBLIC WORKS AND UTILITIES

DATE: \_\_\_\_\_  
 AUTHORIZED: \_\_\_\_\_  
 APPROVED: \_\_\_\_\_

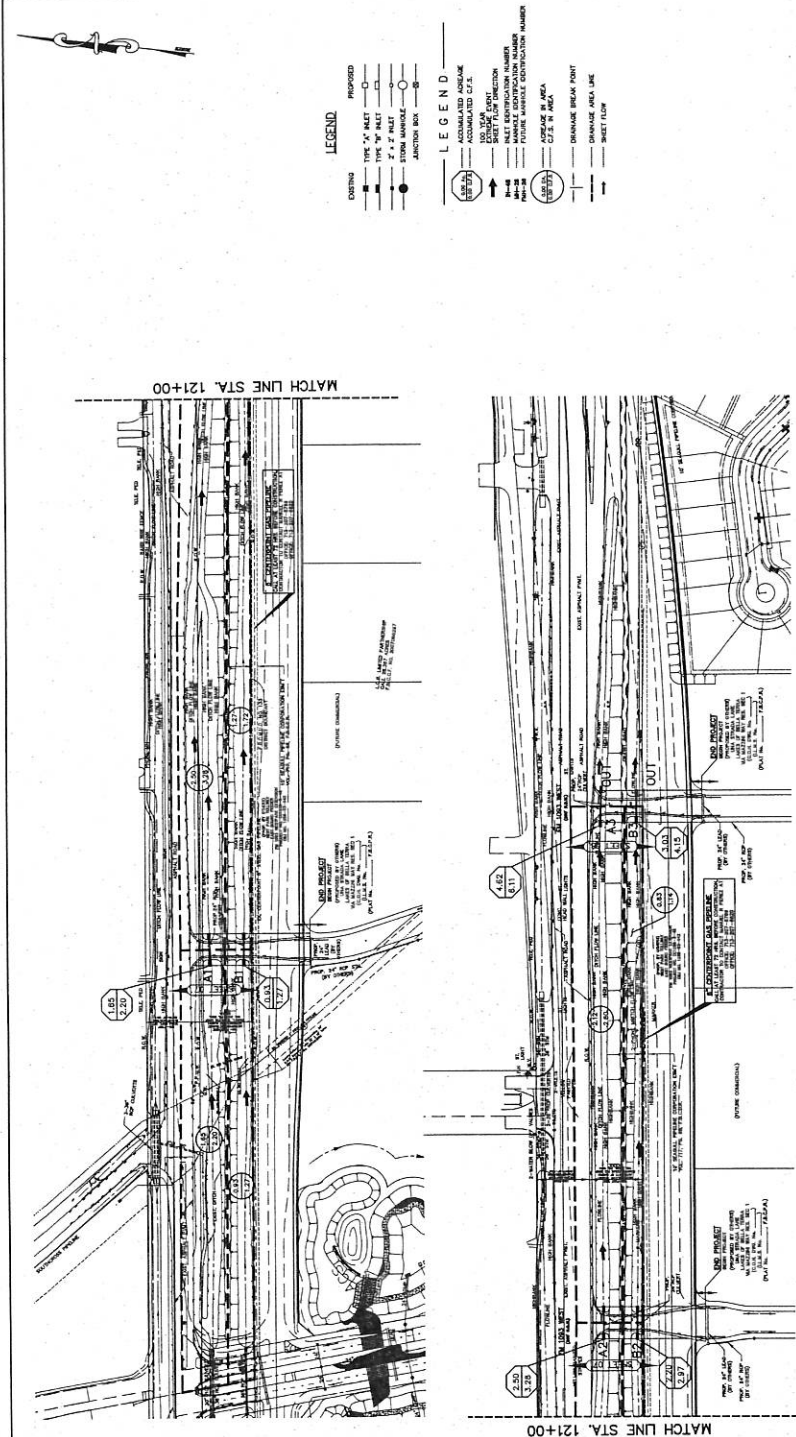

**FOR THE CITY OF HOUSTON**  
 DEPARTMENT OF PUBLIC WORKS AND UTILITIES

DATE: \_\_\_\_\_  
 AUTHORIZED: \_\_\_\_\_  
 APPROVED: \_\_\_\_\_

**FOR THE CITY OF HOUSTON**  
 DEPARTMENT OF PUBLIC WORKS AND UTILITIES

DATE: \_\_\_\_\_  
 AUTHORIZED: \_\_\_\_\_  
 APPROVED: \_\_\_\_\_

**FOR THE CITY OF HOUSTON**  
 DEPARTMENT OF PUBLIC WORKS AND UTILITIES

DATE: \_\_\_\_\_  
 AUTHORIZED: \_\_\_\_\_  
 APPROVED: \_\_\_\_\_

**FOR THE CITY OF HOUSTON**  
 DEPARTMENT OF PUBLIC WORKS AND UTILITIES

DATE: \_\_\_\_\_  
 AUTHORIZED: \_\_\_\_\_  
 APPROVED: \_\_\_\_\_

**FOR THE CITY OF HOUSTON**  
 DEPARTMENT OF PUBLIC WORKS AND UTILITIES

DATE: \_\_\_\_\_  
 AUTHORIZED: \_\_\_\_\_  
 APPROVED: \_\_\_\_\_

**FOR THE CITY OF HOUSTON**  
 DEPARTMENT OF PUBLIC WORKS AND UTILITIES

DATE: \_\_\_\_\_  
 AUTHORIZED: \_\_\_\_\_  
 APPROVED: \_\_\_\_\_

**FOR THE CITY OF HOUSTON**  
 DEPARTMENT OF PUBLIC WORKS AND UTILITIES

DATE: \_\_\_\_\_  
 AUTHORIZED: \_\_\_\_\_  
 APPROVED: \_\_\_\_\_

**FOR THE CITY OF HOUSTON**  
 DEPARTMENT OF PUBLIC WORKS AND UTILITIES

DATE: \_\_\_\_\_  
 AUTHORIZED: \_\_\_\_\_  
 APPROVED: \_\_\_\_\_

**FOR THE CITY OF HOUSTON**  
 DEPARTMENT OF PUBLIC WORKS AND UTILITIES

DATE: \_\_\_\_\_  
 AUTHORIZED: \_\_\_\_\_  
 APPROVED: \_\_\_\_\_

**FOR THE CITY OF HOUSTON**  
 DEPARTMENT OF PUBLIC WORKS AND UTILITIES

DATE: \_\_\_\_\_  
 AUTHORIZED: \_\_\_\_\_  
 APPROVED: \_\_\_\_\_

**FOR THE CITY OF HOUSTON**  
 DEPARTMENT OF PUBLIC WORKS AND UTILITIES

DATE: \_\_\_\_\_  
 AUTHORIZED: \_\_\_\_\_  
 APPROVED: \_\_\_\_\_





**BENCHMARKS**

1. THE CITY ENGINEER SHALL BE RESPONSIBLE FOR THE PROTECTION OF ALL BENCHMARKS SHOWN ON THIS PLAN. ANY BENCHMARK FOUND TO BE MISSING OR DAMAGED SHALL BE REPLACED AT THE CITY ENGINEER'S EXPENSE. THE CITY ENGINEER SHALL BE RESPONSIBLE FOR THE PROTECTION OF ALL BENCHMARKS SHOWN ON THIS PLAN. ANY BENCHMARK FOUND TO BE MISSING OR DAMAGED SHALL BE REPLACED AT THE CITY ENGINEER'S EXPENSE. THE CITY ENGINEER SHALL BE RESPONSIBLE FOR THE PROTECTION OF ALL BENCHMARKS SHOWN ON THIS PLAN. ANY BENCHMARK FOUND TO BE MISSING OR DAMAGED SHALL BE REPLACED AT THE CITY ENGINEER'S EXPENSE.

**PRIVATE UTILITY LINES SHOWN**

CALL AT LATEST 72 HOURS BEFORE CONSTRUCTION. CALL AT LATEST 72 HOURS BEFORE CONSTRUCTION. CALL AT LATEST 72 HOURS BEFORE CONSTRUCTION.

**BENJAMINE ENGINEERING CORPORATION**

1320 WEST 17TH STREET, SUITE 200  
FORT WORTH, TEXAS 76108  
PHONE: (817) 335-1111  
FAX: (817) 335-1112

**LAKES OF BELLA TERRA  
P.M. 1063 TEMPORARY CONNECTION**

FORT BEND COUNTY, TEXAS

**OVERALL SIGNAGE LAYOUT**

DATE: \_\_\_\_\_

APPROVED: \_\_\_\_\_

FOR THE CITY OF HOUSTON  
DEPARTMENT OF PUBLIC WORKS AND UTILITIES

FILE NO. \_\_\_\_\_

DRAWING SCALE: \_\_\_\_\_

DATE: \_\_\_\_\_

FOR THE CITY OF HOUSTON USE ONLY

DATE: \_\_\_\_\_

FILE NO. \_\_\_\_\_

DRAWING SCALE: \_\_\_\_\_

DATE: \_\_\_\_\_

FOR THE CITY OF HOUSTON USE ONLY

DATE: \_\_\_\_\_

FILE NO. \_\_\_\_\_

DRAWING SCALE: \_\_\_\_\_

DATE: \_\_\_\_\_

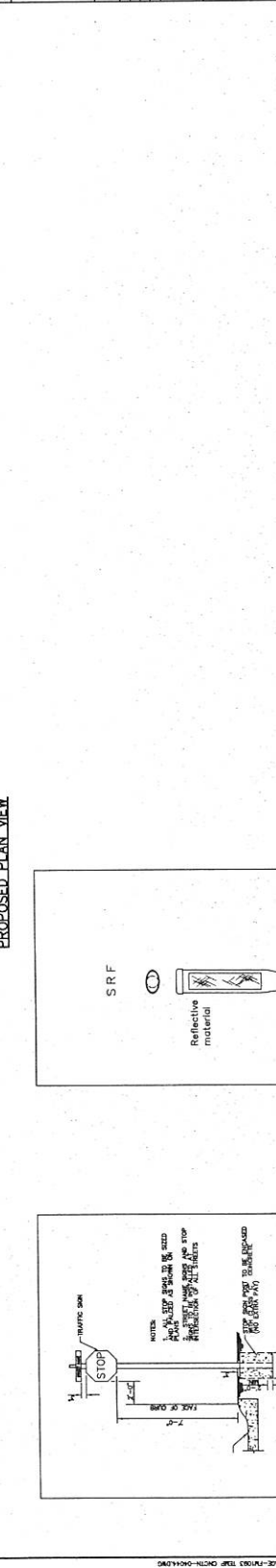
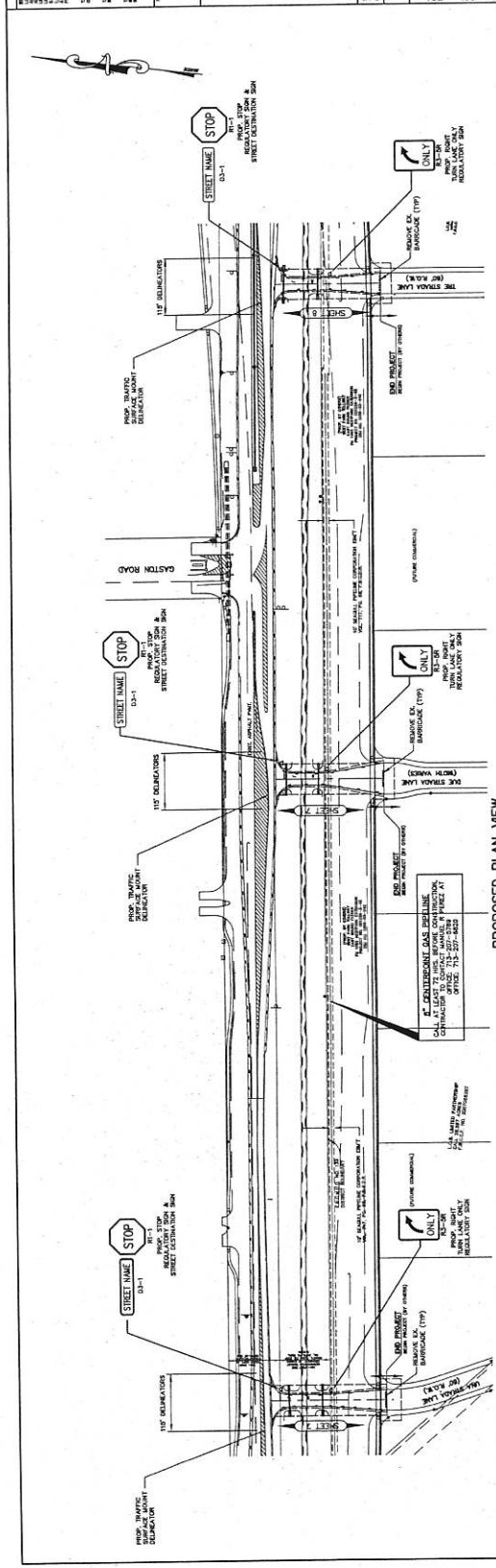

**FORT BEND COUNTY CONSTRUCTION NOTES**

1. ALL SIGNAGE SHALL BE PLACED IN FRONT OF DRIVE/FAMILY LANE ONLY. ALL OTHER SIGNS SHALL BE PLACED IN FRONT OF DRIVE/FAMILY LANE ONLY. ALL SIGNS SHALL BE PLACED IN FRONT OF DRIVE/FAMILY LANE ONLY. ALL SIGNS SHALL BE PLACED IN FRONT OF DRIVE/FAMILY LANE ONLY. ALL SIGNS SHALL BE PLACED IN FRONT OF DRIVE/FAMILY LANE ONLY.

2. ALL SIGNS SHALL BE PLACED IN FRONT OF DRIVE/FAMILY LANE ONLY. ALL SIGNS SHALL BE PLACED IN FRONT OF DRIVE/FAMILY LANE ONLY. ALL SIGNS SHALL BE PLACED IN FRONT OF DRIVE/FAMILY LANE ONLY. ALL SIGNS SHALL BE PLACED IN FRONT OF DRIVE/FAMILY LANE ONLY. ALL SIGNS SHALL BE PLACED IN FRONT OF DRIVE/FAMILY LANE ONLY.

3. ALL SIGNS SHALL BE PLACED IN FRONT OF DRIVE/FAMILY LANE ONLY. ALL SIGNS SHALL BE PLACED IN FRONT OF DRIVE/FAMILY LANE ONLY. ALL SIGNS SHALL BE PLACED IN FRONT OF DRIVE/FAMILY LANE ONLY. ALL SIGNS SHALL BE PLACED IN FRONT OF DRIVE/FAMILY LANE ONLY. ALL SIGNS SHALL BE PLACED IN FRONT OF DRIVE/FAMILY LANE ONLY.

4. ALL SIGNS SHALL BE PLACED IN FRONT OF DRIVE/FAMILY LANE ONLY. ALL SIGNS SHALL BE PLACED IN FRONT OF DRIVE/FAMILY LANE ONLY. ALL SIGNS SHALL BE PLACED IN FRONT OF DRIVE/FAMILY LANE ONLY. ALL SIGNS SHALL BE PLACED IN FRONT OF DRIVE/FAMILY LANE ONLY. ALL SIGNS SHALL BE PLACED IN FRONT OF DRIVE/FAMILY LANE ONLY.

5. ALL SIGNS SHALL BE PLACED IN FRONT OF DRIVE/FAMILY LANE ONLY. ALL SIGNS SHALL BE PLACED IN FRONT OF DRIVE/FAMILY LANE ONLY. ALL SIGNS SHALL BE PLACED IN FRONT OF DRIVE/FAMILY LANE ONLY. ALL SIGNS SHALL BE PLACED IN FRONT OF DRIVE/FAMILY LANE ONLY. ALL SIGNS SHALL BE PLACED IN FRONT OF DRIVE/FAMILY LANE ONLY.

6. ALL SIGNS SHALL BE PLACED IN FRONT OF DRIVE/FAMILY LANE ONLY. ALL SIGNS SHALL BE PLACED IN FRONT OF DRIVE/FAMILY LANE ONLY. ALL SIGNS SHALL BE PLACED IN FRONT OF DRIVE/FAMILY LANE ONLY. ALL SIGNS SHALL BE PLACED IN FRONT OF DRIVE/FAMILY LANE ONLY. ALL SIGNS SHALL BE PLACED IN FRONT OF DRIVE/FAMILY LANE ONLY.

7. ALL SIGNS SHALL BE PLACED IN FRONT OF DRIVE/FAMILY LANE ONLY. ALL SIGNS SHALL BE PLACED IN FRONT OF DRIVE/FAMILY LANE ONLY. ALL SIGNS SHALL BE PLACED IN FRONT OF DRIVE/FAMILY LANE ONLY. ALL SIGNS SHALL BE PLACED IN FRONT OF DRIVE/FAMILY LANE ONLY. ALL SIGNS SHALL BE PLACED IN FRONT OF DRIVE/FAMILY LANE ONLY.

8. ALL SIGNS SHALL BE PLACED IN FRONT OF DRIVE/FAMILY LANE ONLY. ALL SIGNS SHALL BE PLACED IN FRONT OF DRIVE/FAMILY LANE ONLY. ALL SIGNS SHALL BE PLACED IN FRONT OF DRIVE/FAMILY LANE ONLY. ALL SIGNS SHALL BE PLACED IN FRONT OF DRIVE/FAMILY LANE ONLY. ALL SIGNS SHALL BE PLACED IN FRONT OF DRIVE/FAMILY LANE ONLY.

9. ALL SIGNS SHALL BE PLACED IN FRONT OF DRIVE/FAMILY LANE ONLY. ALL SIGNS SHALL BE PLACED IN FRONT OF DRIVE/FAMILY LANE ONLY. ALL SIGNS SHALL BE PLACED IN FRONT OF DRIVE/FAMILY LANE ONLY. ALL SIGNS SHALL BE PLACED IN FRONT OF DRIVE/FAMILY LANE ONLY. ALL SIGNS SHALL BE PLACED IN FRONT OF DRIVE/FAMILY LANE ONLY.

10. ALL SIGNS SHALL BE PLACED IN FRONT OF DRIVE/FAMILY LANE ONLY. ALL SIGNS SHALL BE PLACED IN FRONT OF DRIVE/FAMILY LANE ONLY. ALL SIGNS SHALL BE PLACED IN FRONT OF DRIVE/FAMILY LANE ONLY. ALL SIGNS SHALL BE PLACED IN FRONT OF DRIVE/FAMILY LANE ONLY. ALL SIGNS SHALL BE PLACED IN FRONT OF DRIVE/FAMILY LANE ONLY.





**BENCHMARKS**

ALL BENCHMARKS SHOWN ON THESE PLANS ARE TO BE USED AS A REFERENCE POINT FOR THE LOCATION OF THE PROPOSED FACILITIES. THE BENCHMARKS ARE TO BE MAINTAINED AND PROTECTED AT ALL TIMES. ANY CHANGES TO THE BENCHMARKS SHALL BE REPORTED TO THE ENGINEER IMMEDIATELY.

DATE: 11/14/10  
 DRAWN BY: [Signature]  
 CHECKED BY: [Signature]  
 APPROVED BY: [Signature]

**PRIVATE UTILITY LINES SHOWN**

EXISTING PRIVATE UTILITY LINES ARE SHOWN ON THESE PLANS. THE ENGINEER HAS CONDUCTED VISUAL INSPECTIONS AND INTERVIEWED LOCAL RESIDENTS AND BUSINESS OWNERS TO IDENTIFY THESE LINES. THE ENGINEER HAS NOT CONDUCTED PENETRATION TESTING OR OTHER METHODS TO VERIFY THE DEPTH AND LOCATION OF THESE LINES. THE CONTRACTOR SHALL BE RESPONSIBLE FOR VERIFYING THE LOCATION AND DEPTH OF ALL PRIVATE UTILITY LINES BEFORE CONSTRUCTION.

**PROPOSED 12" SAFETY END TREATMENT @ (1)**

PROPOSED 30" x 30" x 24" PROP. CULVERT A

**PROPOSED 12" SAFETY END TREATMENT @ (2)**

PROPOSED 30" x 30" x 24" PROP. CULVERT B

**PROPOSED 12" SAFETY END TREATMENT @ (3)**

PROPOSED 30" x 30" x 24" PROP. CULVERT C

DATE: 11/14/10  
 DRAWN BY: [Signature]  
 CHECKED BY: [Signature]  
 APPROVED BY: [Signature]

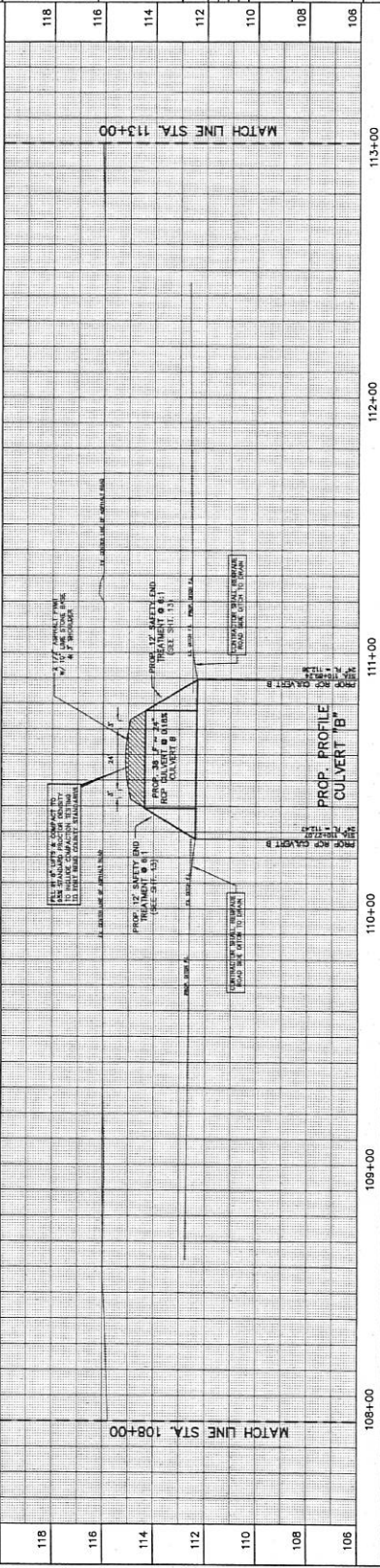
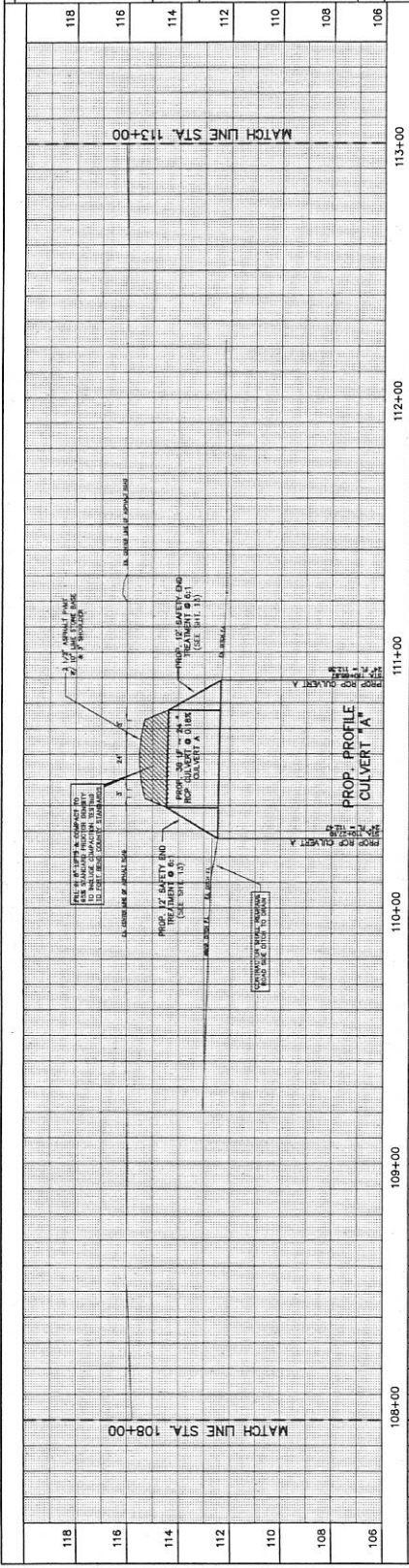

**PROFILE**

F.H. 1093 / BELLA TERRA LAKES & C'  
 STA. 108+00 TO STA. 113+00

DATE: 11/14/10  
 DRAWN BY: [Signature]  
 CHECKED BY: [Signature]  
 APPROVED BY: [Signature]

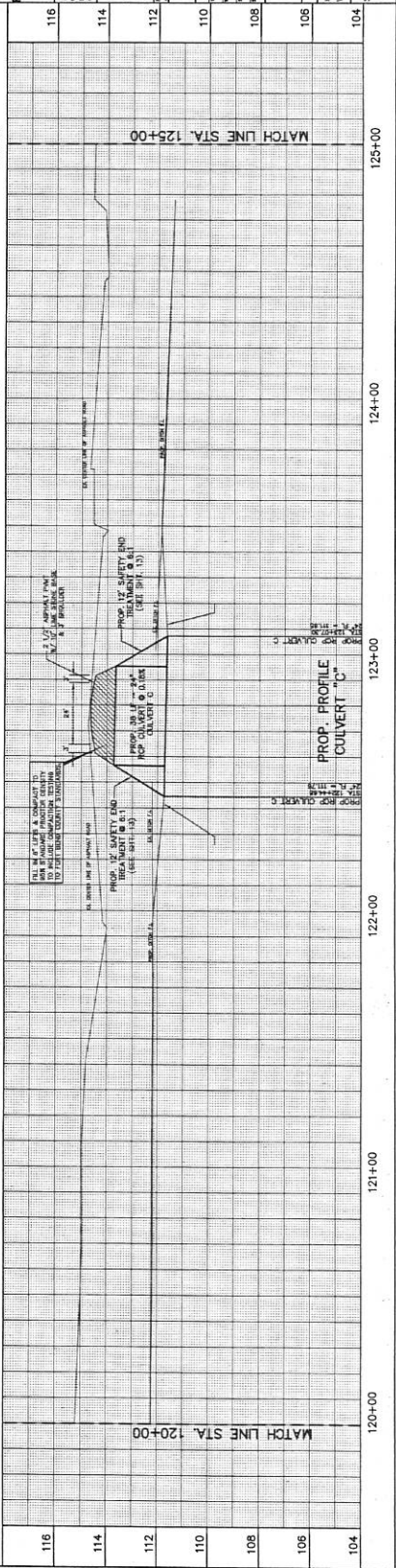

**BELLA TERRA LAKES & C'**

**PROPOSED 12" SAFETY END TREATMENT @ (1)**

PROPOSED 30" x 30" x 24" PROP. CULVERT A

**PROPOSED 12" SAFETY END TREATMENT @ (2)**

PROPOSED 30" x 30" x 24" PROP. CULVERT B

**PROPOSED 12" SAFETY END TREATMENT @ (3)**

PROPOSED 30" x 30" x 24" PROP. CULVERT C

DATE: 11/14/10  
 DRAWN BY: [Signature]  
 CHECKED BY: [Signature]  
 APPROVED BY: [Signature]

**BENCHMARKS**  
 ALL BENCHMARKS SHOWN ARE TO BE USED AS CHECKED POINTS FOR THE PROPOSED WORK. THE BENCHMARK DATA IS TO BE USED TO CONTROL THE ELEVATION OF THE PROPOSED WORK. THE BENCHMARK DATA IS TO BE USED TO CONTROL THE ELEVATION OF THE PROPOSED WORK. THE BENCHMARK DATA IS TO BE USED TO CONTROL THE ELEVATION OF THE PROPOSED WORK.

**PRIVATE UTILITY LINES SHOWN**  
 ALL PRIVATE UTILITY LINES SHOWN ARE TO BE MAINTAINED AS SHOWN. THE CONTRACTOR SHALL BE RESPONSIBLE FOR VERIFYING THE DEPTH AND LOCATION OF ALL PRIVATE UTILITY LINES. THE CONTRACTOR SHALL BE RESPONSIBLE FOR VERIFYING THE DEPTH AND LOCATION OF ALL PRIVATE UTILITY LINES. THE CONTRACTOR SHALL BE RESPONSIBLE FOR VERIFYING THE DEPTH AND LOCATION OF ALL PRIVATE UTILITY LINES.

DATE: 10/25/2011  
 DRAWN BY: [Name]  
 CHECKED BY: [Name]

**APPROVED**  
 [Signature]  
 [Title]  
 [Company]

**LAKES OF BELLA TERRA**  
 FORT BEND COUNTY, TEXAS  
 PROJECT NO. 1000000000  
 SHEET NO. 0 OF 16

**PROPOSED PROFILE 'B' & 'C'**  
 STA. 120+00 TO STA. 125+00  
**PROPOSED PROFILE 'B' & 'C'**  
 STA. 130+00 TO STA. 135+00

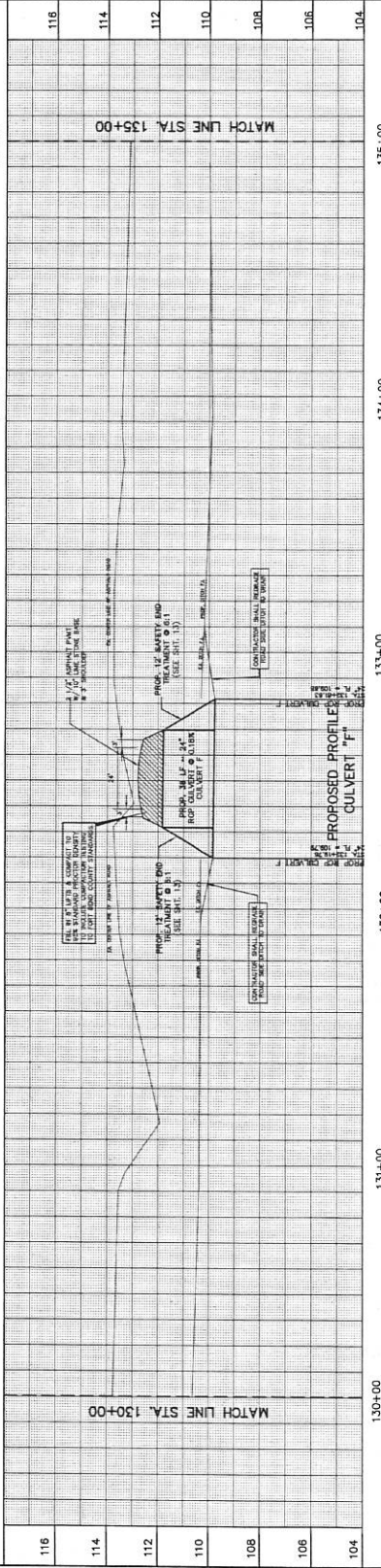
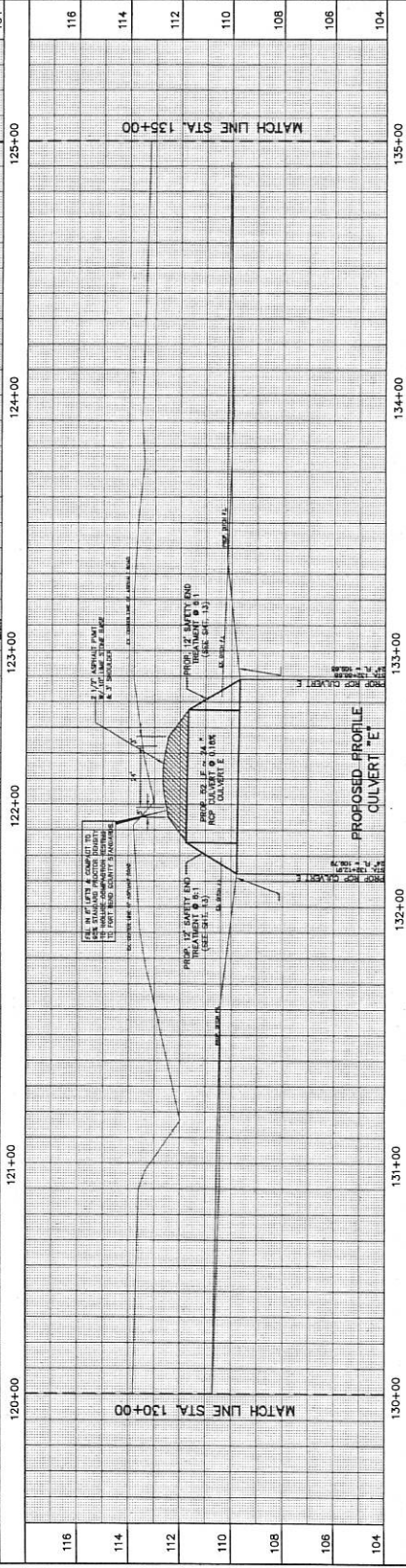
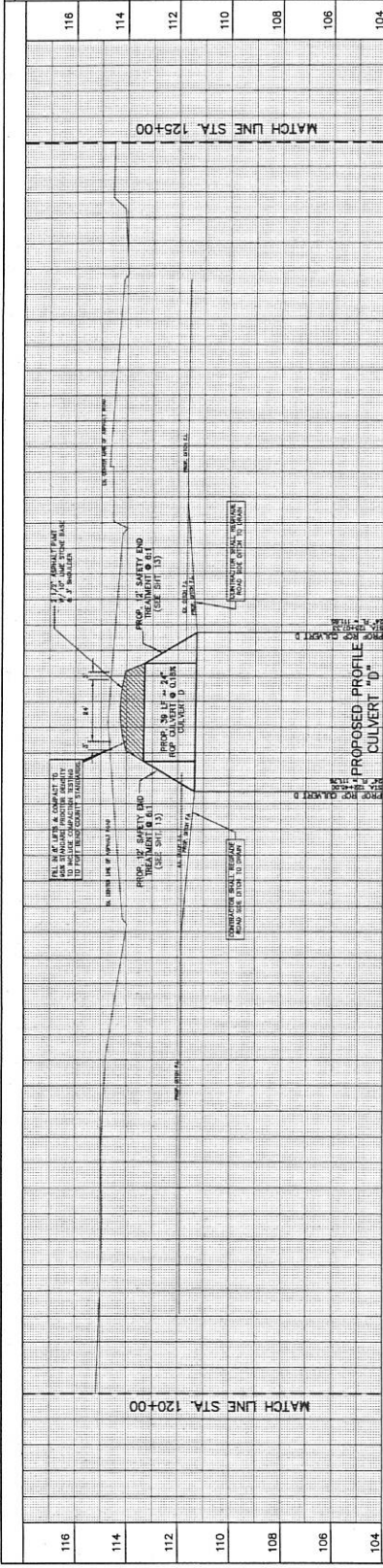

Station	Profile
120+00	120
121+00	121
122+00	122
123+00	123
124+00	124
125+00	125
130+00	130
131+00	131
132+00	132
133+00	133
134+00	134
135+00	135

**REVISIONS**

No.	Description

DATE: 10/25/2011  
 DRAWN BY: [Name]  
 CHECKED BY: [Name]  
 FILE NO. [Number]  
 SHEET NO. 0 OF 16

GENERAL CONSTRUCTION NOTES

- 1. CONTRACTOR SHALL BE RESPONSIBLE FOR OBTAINING ALL NECESSARY PERMITS AND APPROVALS FROM ALL AFFECTED AGENCIES AND AGENCIES.
2. CONTRACTOR SHALL BE RESPONSIBLE FOR OBTAINING ALL NECESSARY PERMITS AND APPROVALS FROM ALL AFFECTED AGENCIES AND AGENCIES.
3. CONTRACTOR SHALL BE RESPONSIBLE FOR OBTAINING ALL NECESSARY PERMITS AND APPROVALS FROM ALL AFFECTED AGENCIES AND AGENCIES.

GENERAL NOTES

- 1. CONTRACTOR SHALL BE RESPONSIBLE FOR OBTAINING ALL NECESSARY PERMITS AND APPROVALS FROM ALL AFFECTED AGENCIES AND AGENCIES.
2. CONTRACTOR SHALL BE RESPONSIBLE FOR OBTAINING ALL NECESSARY PERMITS AND APPROVALS FROM ALL AFFECTED AGENCIES AND AGENCIES.
3. CONTRACTOR SHALL BE RESPONSIBLE FOR OBTAINING ALL NECESSARY PERMITS AND APPROVALS FROM ALL AFFECTED AGENCIES AND AGENCIES.

TRAFFIC CONTROL

- 1. CONTRACTOR SHALL BE RESPONSIBLE FOR OBTAINING ALL NECESSARY PERMITS AND APPROVALS FROM ALL AFFECTED AGENCIES AND AGENCIES.
2. CONTRACTOR SHALL BE RESPONSIBLE FOR OBTAINING ALL NECESSARY PERMITS AND APPROVALS FROM ALL AFFECTED AGENCIES AND AGENCIES.
3. CONTRACTOR SHALL BE RESPONSIBLE FOR OBTAINING ALL NECESSARY PERMITS AND APPROVALS FROM ALL AFFECTED AGENCIES AND AGENCIES.

PAVING CONSTRUCTION NOTES

- 1. CONTRACTOR SHALL BE RESPONSIBLE FOR OBTAINING ALL NECESSARY PERMITS AND APPROVALS FROM ALL AFFECTED AGENCIES AND AGENCIES.
2. CONTRACTOR SHALL BE RESPONSIBLE FOR OBTAINING ALL NECESSARY PERMITS AND APPROVALS FROM ALL AFFECTED AGENCIES AND AGENCIES.
3. CONTRACTOR SHALL BE RESPONSIBLE FOR OBTAINING ALL NECESSARY PERMITS AND APPROVALS FROM ALL AFFECTED AGENCIES AND AGENCIES.

STORM SEWER CONSTRUCTION NOTES

- 1. CONTRACTOR SHALL BE RESPONSIBLE FOR OBTAINING ALL NECESSARY PERMITS AND APPROVALS FROM ALL AFFECTED AGENCIES AND AGENCIES.
2. CONTRACTOR SHALL BE RESPONSIBLE FOR OBTAINING ALL NECESSARY PERMITS AND APPROVALS FROM ALL AFFECTED AGENCIES AND AGENCIES.
3. CONTRACTOR SHALL BE RESPONSIBLE FOR OBTAINING ALL NECESSARY PERMITS AND APPROVALS FROM ALL AFFECTED AGENCIES AND AGENCIES.

TEXAS COMMISSION ON ENVIRONMENTAL QUALITY WATER DISTRIBUTION SYSTEM GENERAL CONSTRUCTION NOTES

- 1. CONTRACTOR SHALL BE RESPONSIBLE FOR OBTAINING ALL NECESSARY PERMITS AND APPROVALS FROM ALL AFFECTED AGENCIES AND AGENCIES.
2. CONTRACTOR SHALL BE RESPONSIBLE FOR OBTAINING ALL NECESSARY PERMITS AND APPROVALS FROM ALL AFFECTED AGENCIES AND AGENCIES.
3. CONTRACTOR SHALL BE RESPONSIBLE FOR OBTAINING ALL NECESSARY PERMITS AND APPROVALS FROM ALL AFFECTED AGENCIES AND AGENCIES.

PRIVATE UTILITY NOTES

- 1. CONTRACTOR SHALL BE RESPONSIBLE FOR OBTAINING ALL NECESSARY PERMITS AND APPROVALS FROM ALL AFFECTED AGENCIES AND AGENCIES.
2. CONTRACTOR SHALL BE RESPONSIBLE FOR OBTAINING ALL NECESSARY PERMITS AND APPROVALS FROM ALL AFFECTED AGENCIES AND AGENCIES.
3. CONTRACTOR SHALL BE RESPONSIBLE FOR OBTAINING ALL NECESSARY PERMITS AND APPROVALS FROM ALL AFFECTED AGENCIES AND AGENCIES.

Professional Engineer Seal for William H. Baker, License No. 118018, State of Texas. Includes project information for Lakes of the Bay at Bayport.

THE TEXAS BOARD OF PROFESSIONAL ENGINEERS AND ARCHITECTS. LAKES OF THE BAY AT BAYPORT. PUBLIC ENTITY, PUBLIC UTILITIES. FORT BEND COUNTY, TEXAS.

STANDARD CONSTRUCTION NOTES & DETAIL SHEET

Project information form including: Project Name, Location, Date, and City of Houston details.



**REMARKS**

FOR THE CITY OF HOUSTON, TEXAS, THE ENGINEER HAS EXAMINED THE PLANS AND SPECIFICATIONS FOR THE SANITARY OR STORM SEWER BEDDING AND BACKFILL FOR DRY STABLE TRENCH. THE PLANS AND SPECIFICATIONS COMPLY WITH THE CITY OF HOUSTON SPECIFICATIONS FOR SANITARY OR STORM SEWER BEDDING AND BACKFILL FOR DRY STABLE TRENCH. THE ENGINEER HAS NOT BEEN REQUIRED TO VERIFY THE ACCURACY OF THE DATA OR INFORMATION PROVIDED BY THE CONTRACTOR OR OTHER SOURCES. THE ENGINEER'S RESPONSIBILITY IS LIMITED TO THE DESIGN OF THE SANITARY OR STORM SEWER BEDDING AND BACKFILL FOR DRY STABLE TRENCH.

FOR THE CITY OF HOUSTON, TEXAS, THE ENGINEER HAS EXAMINED THE PLANS AND SPECIFICATIONS FOR THE SANITARY OR STORM SEWER BEDDING AND BACKFILL FOR DRY STABLE TRENCH. THE PLANS AND SPECIFICATIONS COMPLY WITH THE CITY OF HOUSTON SPECIFICATIONS FOR SANITARY OR STORM SEWER BEDDING AND BACKFILL FOR DRY STABLE TRENCH. THE ENGINEER HAS NOT BEEN REQUIRED TO VERIFY THE ACCURACY OF THE DATA OR INFORMATION PROVIDED BY THE CONTRACTOR OR OTHER SOURCES. THE ENGINEER'S RESPONSIBILITY IS LIMITED TO THE DESIGN OF THE SANITARY OR STORM SEWER BEDDING AND BACKFILL FOR DRY STABLE TRENCH.

FOR THE CITY OF HOUSTON, TEXAS, THE ENGINEER HAS EXAMINED THE PLANS AND SPECIFICATIONS FOR THE SANITARY OR STORM SEWER BEDDING AND BACKFILL FOR DRY STABLE TRENCH. THE PLANS AND SPECIFICATIONS COMPLY WITH THE CITY OF HOUSTON SPECIFICATIONS FOR SANITARY OR STORM SEWER BEDDING AND BACKFILL FOR DRY STABLE TRENCH. THE ENGINEER HAS NOT BEEN REQUIRED TO VERIFY THE ACCURACY OF THE DATA OR INFORMATION PROVIDED BY THE CONTRACTOR OR OTHER SOURCES. THE ENGINEER'S RESPONSIBILITY IS LIMITED TO THE DESIGN OF THE SANITARY OR STORM SEWER BEDDING AND BACKFILL FOR DRY STABLE TRENCH.

FOR THE CITY OF HOUSTON, TEXAS, THE ENGINEER HAS EXAMINED THE PLANS AND SPECIFICATIONS FOR THE SANITARY OR STORM SEWER BEDDING AND BACKFILL FOR DRY STABLE TRENCH. THE PLANS AND SPECIFICATIONS COMPLY WITH THE CITY OF HOUSTON SPECIFICATIONS FOR SANITARY OR STORM SEWER BEDDING AND BACKFILL FOR DRY STABLE TRENCH. THE ENGINEER HAS NOT BEEN REQUIRED TO VERIFY THE ACCURACY OF THE DATA OR INFORMATION PROVIDED BY THE CONTRACTOR OR OTHER SOURCES. THE ENGINEER'S RESPONSIBILITY IS LIMITED TO THE DESIGN OF THE SANITARY OR STORM SEWER BEDDING AND BACKFILL FOR DRY STABLE TRENCH.

FOR THE CITY OF HOUSTON, TEXAS, THE ENGINEER HAS EXAMINED THE PLANS AND SPECIFICATIONS FOR THE SANITARY OR STORM SEWER BEDDING AND BACKFILL FOR DRY STABLE TRENCH. THE PLANS AND SPECIFICATIONS COMPLY WITH THE CITY OF HOUSTON SPECIFICATIONS FOR SANITARY OR STORM SEWER BEDDING AND BACKFILL FOR DRY STABLE TRENCH. THE ENGINEER HAS NOT BEEN REQUIRED TO VERIFY THE ACCURACY OF THE DATA OR INFORMATION PROVIDED BY THE CONTRACTOR OR OTHER SOURCES. THE ENGINEER'S RESPONSIBILITY IS LIMITED TO THE DESIGN OF THE SANITARY OR STORM SEWER BEDDING AND BACKFILL FOR DRY STABLE TRENCH.

FOR THE CITY OF HOUSTON, TEXAS, THE ENGINEER HAS EXAMINED THE PLANS AND SPECIFICATIONS FOR THE SANITARY OR STORM SEWER BEDDING AND BACKFILL FOR DRY STABLE TRENCH. THE PLANS AND SPECIFICATIONS COMPLY WITH THE CITY OF HOUSTON SPECIFICATIONS FOR SANITARY OR STORM SEWER BEDDING AND BACKFILL FOR DRY STABLE TRENCH. THE ENGINEER HAS NOT BEEN REQUIRED TO VERIFY THE ACCURACY OF THE DATA OR INFORMATION PROVIDED BY THE CONTRACTOR OR OTHER SOURCES. THE ENGINEER'S RESPONSIBILITY IS LIMITED TO THE DESIGN OF THE SANITARY OR STORM SEWER BEDDING AND BACKFILL FOR DRY STABLE TRENCH.

FOR THE CITY OF HOUSTON, TEXAS, THE ENGINEER HAS EXAMINED THE PLANS AND SPECIFICATIONS FOR THE SANITARY OR STORM SEWER BEDDING AND BACKFILL FOR DRY STABLE TRENCH. THE PLANS AND SPECIFICATIONS COMPLY WITH THE CITY OF HOUSTON SPECIFICATIONS FOR SANITARY OR STORM SEWER BEDDING AND BACKFILL FOR DRY STABLE TRENCH. THE ENGINEER HAS NOT BEEN REQUIRED TO VERIFY THE ACCURACY OF THE DATA OR INFORMATION PROVIDED BY THE CONTRACTOR OR OTHER SOURCES. THE ENGINEER'S RESPONSIBILITY IS LIMITED TO THE DESIGN OF THE SANITARY OR STORM SEWER BEDDING AND BACKFILL FOR DRY STABLE TRENCH.

FOR THE CITY OF HOUSTON, TEXAS, THE ENGINEER HAS EXAMINED THE PLANS AND SPECIFICATIONS FOR THE SANITARY OR STORM SEWER BEDDING AND BACKFILL FOR DRY STABLE TRENCH. THE PLANS AND SPECIFICATIONS COMPLY WITH THE CITY OF HOUSTON SPECIFICATIONS FOR SANITARY OR STORM SEWER BEDDING AND BACKFILL FOR DRY STABLE TRENCH. THE ENGINEER HAS NOT BEEN REQUIRED TO VERIFY THE ACCURACY OF THE DATA OR INFORMATION PROVIDED BY THE CONTRACTOR OR OTHER SOURCES. THE ENGINEER'S RESPONSIBILITY IS LIMITED TO THE DESIGN OF THE SANITARY OR STORM SEWER BEDDING AND BACKFILL FOR DRY STABLE TRENCH.

FOR THE CITY OF HOUSTON, TEXAS, THE ENGINEER HAS EXAMINED THE PLANS AND SPECIFICATIONS FOR THE SANITARY OR STORM SEWER BEDDING AND BACKFILL FOR DRY STABLE TRENCH. THE PLANS AND SPECIFICATIONS COMPLY WITH THE CITY OF HOUSTON SPECIFICATIONS FOR SANITARY OR STORM SEWER BEDDING AND BACKFILL FOR DRY STABLE TRENCH. THE ENGINEER HAS NOT BEEN REQUIRED TO VERIFY THE ACCURACY OF THE DATA OR INFORMATION PROVIDED BY THE CONTRACTOR OR OTHER SOURCES. THE ENGINEER'S RESPONSIBILITY IS LIMITED TO THE DESIGN OF THE SANITARY OR STORM SEWER BEDDING AND BACKFILL FOR DRY STABLE TRENCH.

PIPE SIZE	MINIMUM DEPTH	MINIMUM COVER	MINIMUM WIDTH	MINIMUM HEIGHT	MINIMUM LENGTH	MINIMUM WEIGHT	MINIMUM STRENGTH
12"	2'	18"	50"	50"	6'-0"	200	1000
15"	3'	24"	60"	60"	6'-0"	300	1500
18"	3 1/2'	30"	70"	70"	6'-0"	400	2000
24"	4'	36"	80"	80"	6'-0"	600	3000
30"	4 1/2'	42"	90"	90"	6'-0"	800	4000
36"	5'	48"	100"	100"	6'-0"	1000	5000

**GENERAL NOTES:**

1. THE CITY OF HOUSTON SPECIFICATIONS FOR SANITARY OR STORM SEWER BEDDING AND BACKFILL FOR DRY STABLE TRENCH SHALL BE USED.

2. THE CITY OF HOUSTON SPECIFICATIONS FOR SANITARY OR STORM SEWER BEDDING AND BACKFILL FOR DRY STABLE TRENCH SHALL BE USED.

3. THE CITY OF HOUSTON SPECIFICATIONS FOR SANITARY OR STORM SEWER BEDDING AND BACKFILL FOR DRY STABLE TRENCH SHALL BE USED.

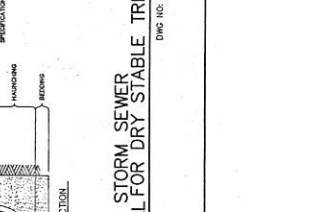
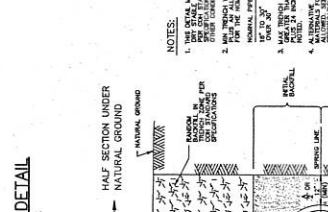
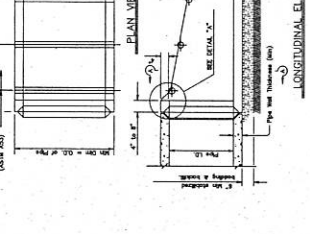
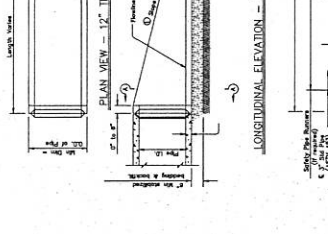
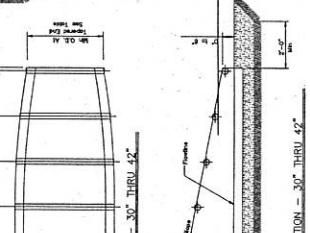
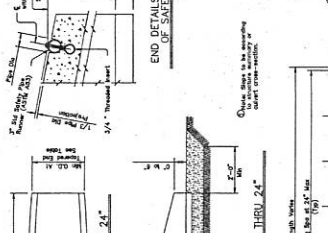
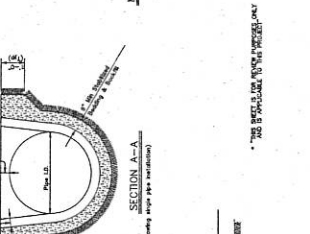
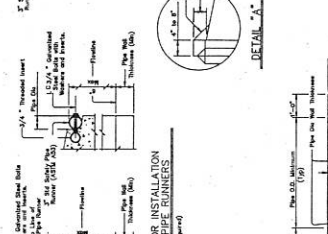
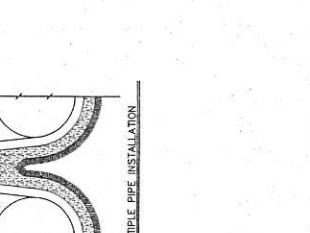
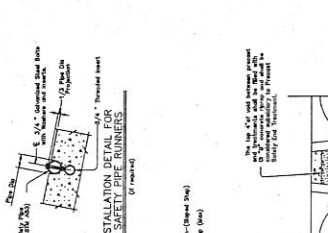

**NOTES:**

1. ALL MATERIALS TO BE USED SHALL BE IN ACCORDANCE WITH THE CITY OF HOUSTON SPECIFICATIONS FOR SANITARY OR STORM SEWER BEDDING AND BACKFILL FOR DRY STABLE TRENCH.
2. THE CITY OF HOUSTON SPECIFICATIONS FOR SANITARY OR STORM SEWER BEDDING AND BACKFILL FOR DRY STABLE TRENCH SHALL BE USED.
3. THE CITY OF HOUSTON SPECIFICATIONS FOR SANITARY OR STORM SEWER BEDDING AND BACKFILL FOR DRY STABLE TRENCH SHALL BE USED.
4. THE CITY OF HOUSTON SPECIFICATIONS FOR SANITARY OR STORM SEWER BEDDING AND BACKFILL FOR DRY STABLE TRENCH SHALL BE USED.

**SAFETY END DETAIL**  
SCALE: N.T.S.

**TYPICAL CROSS-SECTION**

**PLAN VIEW - 12\"/>**

**LONGITUDINAL ELEVATION - 30\"/>**

**SAFETY END DETAIL**  
SCALE: N.T.S.

**TYPICAL CROSS-SECTION**

**PLAN VIEW - 12\"/>**

**LONGITUDINAL ELEVATION - 30\"/>**

**SAFETY END DETAIL**  
SCALE: N.T.S.

**TYPICAL CROSS-SECTION**

**PLAN VIEW - 12\"/>**

**LONGITUDINAL ELEVATION - 30\"/>**

**SANITARY OR STORM SEWER BEDDING AND BACKFILL FOR DRY STABLE TRENCH**

EFT DATE: OCT-01-2002

DWG NO: 0327-03



# FORT BEND COUNTY ENGINEERING DEPARTMENT

LAKES OF BELLA TERRA FM 1093 TEMPORARY CONNECTION  
 SHEET NO. 0424  
 STANDARD PAVING DETAILS SHEET  
 REV. BEC  
 DATE 09/2015  
 N.T.S.  
 15/16

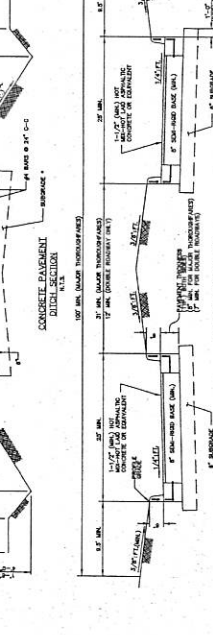
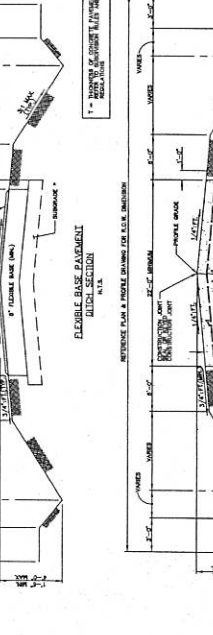
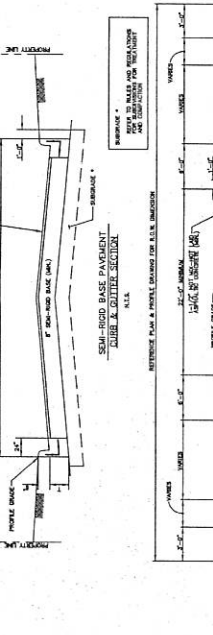
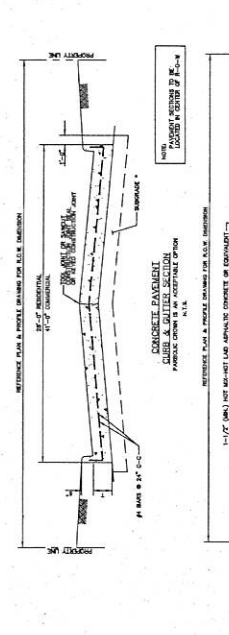
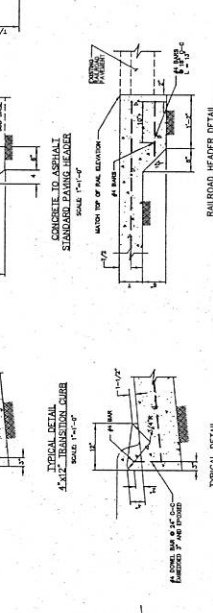
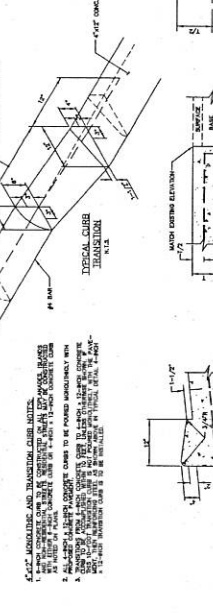
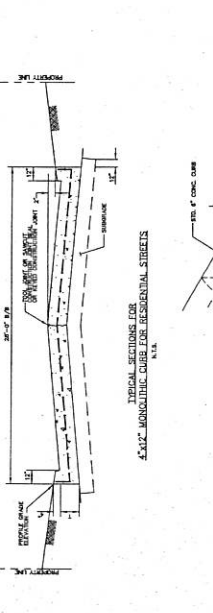
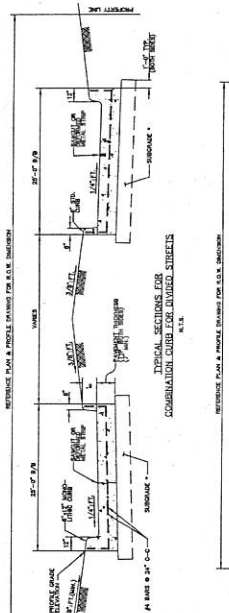
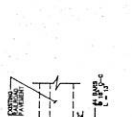
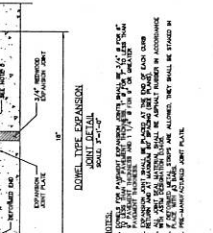
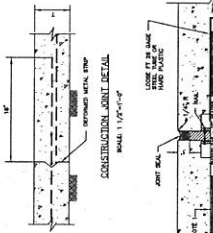
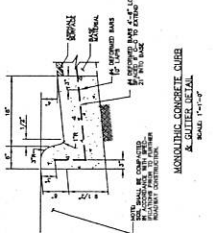
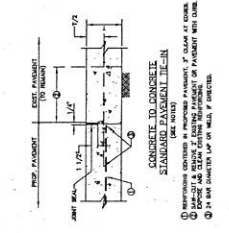

- NOTES:**
1. ALL CURBS SHALL BE 12" HIGH AND 12" WIDE UNLESS OTHERWISE NOTED.
  2. ALL CURBS SHALL BE 12" HIGH AND 12" WIDE UNLESS OTHERWISE NOTED.
  3. ALL CURBS SHALL BE 12" HIGH AND 12" WIDE UNLESS OTHERWISE NOTED.
  4. ALL CURBS SHALL BE 12" HIGH AND 12" WIDE UNLESS OTHERWISE NOTED.
  5. ALL CURBS SHALL BE 12" HIGH AND 12" WIDE UNLESS OTHERWISE NOTED.
  6. ALL CURBS SHALL BE 12" HIGH AND 12" WIDE UNLESS OTHERWISE NOTED.

