



Fort Bend County Engineering
FORT BEND COUNTY, TEXAS

Richard W. Stolleis, P.E.
County Engineer

October 31, 2014

Commissioner James Patterson, Pct. 4
Fort Bend County Precinct 4
12919 Dairy Ashford Road
Sugar Land, Texas 77478

RE: Winding Waters Lane (Riverstone) – Traffic Control Plan

Dear Commissioner Patterson:

Fort Bend County Engineering has completed and recommends approval of the traffic control plan for the above referenced subdivision. The public hearing date for acceptance of the plan is being scheduled.

A copy of the traffic control plan is attached for your review. If you should have any questions, please give me a call.

Sincerely,

A handwritten signature in cursive script, reading "Steven L. Evans".

Steven L. Evans
Construction Coordinator

SLE/cb

cc: Judge Robert E. Hebert, County Judge
Marc Grant - FBC Road & Bridge
Marc Grant - Signage Department
File

[Office] 1124 Blume Road | Rosenberg, TX 77471 * [Mailing] 301 Jackson St. | Richmond, TX 77469
Phone 281-633-7500 * Fax 281-633-7545

H:\Engineering\Development\Form_Traffic Control Letter.docx

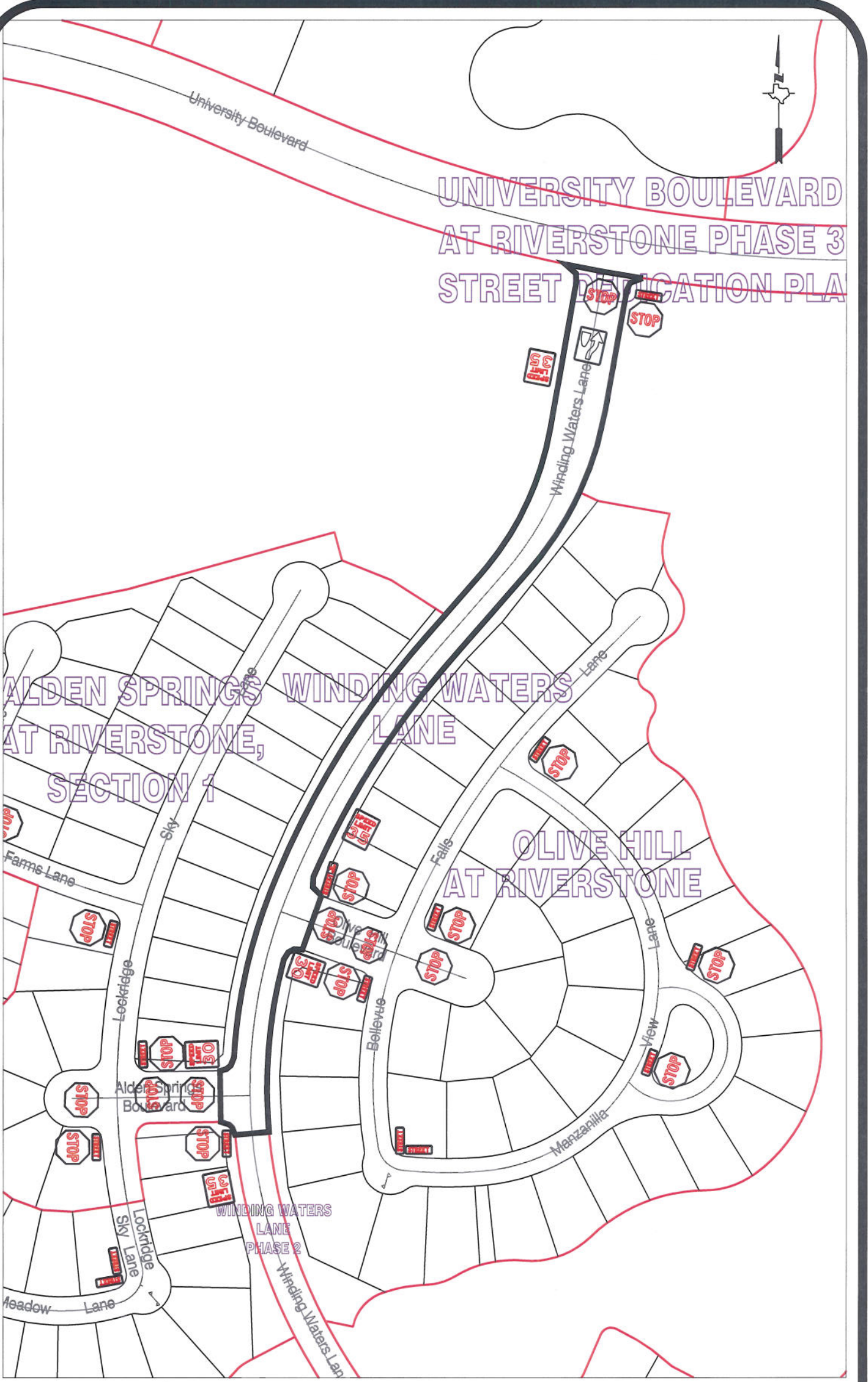

Note:

The purpose of this traffic control plan is to establish traffic control for Winding Waters Lane.

Drawn By: L. Brdecka

Date: 10-30-14

Approved By: Clay Forister, PE *CAF*

Date: 31 OCT 14

Scale

1" = 200'-0"

**Winding Waters Lane
Control Map and
Traffic Sign Layout**

Fort Bend County Engineering Dept.
1124 Blume Road
Rosenberg, Texas 77471